

**STATE OF NEW MEXICO
DEPARTMENT OF ENERGY, MINERALS AND NATURAL RESOURCES
OIL CONSERVATION DIVISION**

**APPLICATION OF COG OPERATING LLC
FOR COMPULSORY POOLING AND APPROVAL
OF NON-STANDARD SPACING UNIT,
LEA COUNTY, NEW MEXICO.**

CASE NO. 26084

EXHIBIT INDEX

Compulsory Pooling Checklist

Exhibit A	Self-Affirmed Statement of Caroline Frederick
A-1	Application & Proposed Notice of Hearing
A-2	Non-Standard Unit Plat and Notice List
A-3	C-102 for the Wells
A-4	Plat of Tracts, Tract Ownership, Applicable Lease Numbers, Unit Recapitulation, Pooled Parties
A-5	Sample Well Proposal Letter, AFEs, and Ratification Agreement
A-6	Chronology of Contact
A-7	Ownership Commitment Exhibit
Exhibit B	Self-Affirmed Statement of Tyler Patrick
B-1	Locator Map
B-2	Subsea Structure Map
B-3	Cross-Section Location Map
B-4	Stratigraphic Cross-Section
Exhibit C	Self-Affirmed Statement of Jaclyn M. McLean
C-1	Notice Letter to All Interested Parties Sent April 8, 2026 & April 15, 2026
C-2	Postal Delivery Report
C-3	Electronic Return Receipts
C-4	Affidavit of Publication for April 21, 2026

COMPULSORY POOLING APPLICATION CHECKLIST	
ALL INFORMATION IN THE APPLICATION MUST BE SUPPORTED BY SIGNED AFFIDAVITS	
Case: 26084	APPLICANT'S RESPONSE
Date: May 7, 2026	
Applicant	COG Operating LLC
Designated Operator & OGRID (affiliation if applicable)	COG Operating LLC (OGRID No. 229137)
Applicant's Counsel:	Hardy McLean LLC
Case Title:	Application of COG Operating LLC for Compulsory Pooling and Approval of Non-Standard Spacing Unit, Lea County, New Mexico.
Entries of Appearance/Intervenors:	None.
Well Family	Boater Federal Com
Formation/Pool	
Formation Name(s) or Vertical Extent:	Wolfcamp
Primary Product (Oil or Gas):	Oil
Pooling this vertical extent:	Wolfcamp A
Pool Name and Pool Code:	Dogie Draw; Wolfcamp Pool (Code 17980)
Well Location Setback Rules:	Statewide
Spacing Unit	
Type (Horizontal/Vertical)	Horizontal
Size (Acres)	960-acres
Building Blocks:	Quarter-quarter
Orientation:	North-South
Description: TRS/County	S/2 of Section 29, and all of Section 32, Township 25 South, Range 35 East, Lea County.
Standard Horizontal Well Spacing Unit (Y/N), if No, describe and is approval of non-standard unit requested in this application?	No. Approval of a non-standard spacing unit is being requested in this application.
Other Situations	
Depth Severance: Y/N. If yes, description	Yes, a depth severance exists within the Wolfcamp formation at the base of the Wolfcamp A interval, which is at a stratigraphic equivalent of approximately 12,736' TVD, as observed on the Tele Delux 32 State 4H well log (API No. 30-025-42362).
Proximity Tracts: If yes, description	N/A
Proximity Defining Well: if yes, description	N/A
Applicant's Ownership in Each Tract	Exhibit A-4
Well(s)	
Name & API (if assigned), surface and bottom hole location, footages, completion target, orientation, completion status (standard or non-standard)	Add wells as needed
Well #1	Boater Federal Com 701H (API No. <i>Pending</i>) SHL: 2,365' FNL & 1,380' FWL (Unit F), Section 29, T25S-R35E BHL: 50' FSL & 1,430' FWL (Unit N), Section 32, T25S-R35E Completion Target: Wolfcamp A (Approx. 12,550' TVD)
Well #2	Boater Federal Com 702H (API No. <i>Pending</i>) SHL: 2,365' FNL & 1,440' FWL (Unit F), Section 29, T25S-R35E BHL: 50' FSL & 2,450' FEL (Unit O), Section 32, T25S-R35E Completion Target: Wolfcamp A (Approx. 12,550' TVD)
Well #3	Boater Federal Com 703H (API No. <i>Pending</i>) SHL: 2,365' FNL & 1,385' FEL (Unit G), Section 29, T25S-R35E BHL: 50' FSL & 1,100' FEL (Unit P), Section 32, T25S-R35E Completion Target: Wolfcamp A (Approx. 12,550' TVD)
AFE Capex and Operating Costs	
Drilling Supervision/Month \$	\$14,000
Production Supervision/Month \$	\$1,400
Justification for Supervision Costs	Exhibit A-5
Requested Risk Charge	200%
Notice of Hearing	
Proposed Notice of Hearing	Exhibit A-1

Proof of Mailed Notice of Hearing (20 days before hearing)	Exhibits C-1, C-2, C-3
Proof of Published Notice of Hearing (10 days before hearing)	Exhibit C-4
Ownership Determination	
Land Ownership Schematic of the Spacing Unit	Exhibit A-4
Tract List (including lease numbers and owners)	Exhibit A-4
If approval of Non-Standard Spacing Unit is requested, Tract List (including lease numbers and owners) of Tracts subject to notice requirements.	Exhibit A-2
Pooled Parties (including ownership type)	Exhibit A-4
Unlocatable Parties to be Pooled	N/A
Ownership Depth Severance (including percentage above & below)	Exhibit A-4
Joinder	
Sample Copy of Proposal Letter	Exhibit A-5
List of Interest Owners (ie Exhibit A of JOA)	Exhibit A-4
Chronology of Contact with Non-Joined Working Interests	Exhibit A-6
Overhead Rates In Proposal Letter	Exhibit A-5
Cost Estimate to Drill and Complete	Exhibit A-5
Cost Estimate to Equip Well	Exhibit A-5
Cost Estimate for Production Facilities	Exhibit A-5
Geology	
Summary (including special considerations)	Exhibit B
Spacing Unit Schematic	Exhibit B-1
Gunbarrel/Lateral Trajectory Schematic	N/A
Well Orientation (with rationale)	Exhibit B
Target Formation	Exhibit B
HSU Cross Section	Exhibit B-3
Depth Severance Discussion	Exhibit A, B
Forms, Figures and Tables	
C-102	Exhibit A-3
Tracts	Exhibit A-4
Summary of Interests, Unit Recapitulation (Tracts)	Exhibit A-4
General Location Map (including basin)	Exhibit B-1
Well Bore Location Map	Exhibit B-1
Structure Contour Map - Subsea Depth	Exhibit B-2
Cross Section Location Map (including wells)	Exhibit B-3
Cross Section (including Landing Zone)	Exhibit B-4
Additional Information	
Special Provisions/Stipulations	N/A
CERTIFICATION: I hereby certify that the information provided in this checklist is complete and accurate.	
Printed Name (Attorney or Party Representative):	Dana S. Hardy
Signed Name (Attorney or Party Representative):	/s/ Dana S. Hardy
Date:	4/29/2026

**STATE OF NEW MEXICO
DEPARTMENT OF ENERGY, MINERALS AND NATURAL RESOURCES
OIL CONSERVATION DIVISION**

**APPLICATION OF COG OPERATING LLC
FOR COMPULSORY POOLING AND APPROVAL
OF NON-STANDARD SPACING UNIT,
LEA COUNTY, NEW MEXICO.**

CASE NO. 26084

**SELF-AFFIRMED STATEMENT
OF CAROLINE FREDERICK**

1. I am an Associate Land Negotiator with COG Operating LLC (“COG”). I am over 18 years of age, have personal knowledge of the matters addressed herein, and am competent to provide this Self-Affirmed Statement. I have previously testified before the New Mexico Oil Conservation Division (“Division”) and my credentials as an expert in petroleum land matters were accepted and made a matter of record.

2. Copies of COG’s application and proposed hearing notice are attached as **Exhibit A-1**.

3. None of the parties proposed to be pooled in this case indicated opposition to this matter proceeding by affidavit; therefore, I do not expect any opposition at the hearing.

4. COG seeks to pool all uncommitted interests in the Wolfcamp A interval of the Wolfcamp formation underlying a 960-acre, more or less, non-standard, horizontal spacing unit comprised of the S/2 of Section 29 and all of Section 32, Township 25 South, Range 35 East, Lea County, New Mexico (“Unit”).

5. The Unit will be dedicated to the following wells (“Wells”):

- a. **Boater Federal Com 701H**, which will be drilled from a surface hole location in the SE/4 NW/4 (Unit F) of Section 29, to a bottom hole location in the SE/4 SW/4 (Unit N) of Section 32;

**COG Operating LLC
Case No. 26084
Exhibit A**

- b. **Boater Federal Com 702H**, which will be drilled from a surface hole location in the SE/4 NW/4 (Unit F) of Section 29, to a bottom hole location in the SW/4 SE/4 (Unit O) of Section 32; and
 - c. **Boater Federal Com 703H**, which will be drilled from a surface hole location in the SW/4 NE/4 (Unit G) of Section 29, to a bottom hole location in the SE/4 SE/4 (Unit P) of Section 32.
6. The completed intervals of the Wells will be orthodox.
7. COG's request for approval of a non-standard spacing unit will allow it to consolidate surface facilities and will consequently prevent surface, environmental, and economic waste.
- a. The non-standard unit will allow COG to minimize surface use. Centralizing equipment for facilities for the Wells will reduce the total acreage needed for surface facilities by 4.63 acres of the total amount that would be necessary absent a non-standard unit.
 - a. Surface facilities and equipment, pipelines, and rights-of-way for one well cost approximately \$984,522. While the centralized facilities will be larger, so that they may handle production from multiple wells, I estimate the overall savings, if a non-standard unit is approved, will be approximately \$9,800,000. This will reduce the overall well costs and improve economics for the wells.
 - b. A common facility also reduces the number of flares COG may need to use in the case of an emergency from 4 to 2. Additionally, the VOC reduction is nearly 50%.

8. As a result, approval of a non-standard spacing unit is necessary to prevent waste and protect correlative rights.

9. A plat showing the offset tracts and the parties that were notified of the non-standard spacing unit is attached as **Exhibit A-2**.

10. Due to a depth severance within the Unit, Applicant seeks to pool only those uncommitted interests from the top of the Wolfcamp formation to the base of the Wolfcamp A interval at a stratigraphic equivalent of approximately 12,736' TVD, as observed on the Tele Delux 32 State 4H well log (API No. 30-025-42362).

11. **Exhibit A-3** contains the C-102s for the Wells.

12. **Exhibit A-4** contains a plat identifying ownership by tract in the Unit. This exhibit also includes any applicable lease numbers, a unit recapitulation, and the interests COG seeks to pool highlighted in yellow.

13. COG has conducted a diligent search of all county public records, including phone directories and computer databases, as well as internet searches, to locate the interest owners it seeks to pool.

14. **Exhibit A-5** contains a sample well proposal letter and AFEs sent to working interest owners for the Wells. The estimated costs reflected on the AFEs are fair and reasonable and comparable to the cost of other wells of similar depth and length drilled in the subject formation in the area. Exhibit A-5 also includes a sample ratification letter sent to record title and overriding royalty interest owners COG seeks to pool.

15. In my opinion, COG made a good-faith effort to reach voluntary joinder of uncommitted interests in the Wells as indicated by the chronology of contact described in **Exhibit A-6**.

16. The Ownership Commitment Exhibit is attached as **Exhibit A-7**. This exhibit includes a list of all owners in the Unit and identifies each owner’s ownership status, whether the owner has committed to the proposed spacing unit, and the type of commitment, *i.e.*, whether a signed letter of commitment, joint operating agreement, or verbal agreement.

17. COG requests that it be designated as the operator of the Unit and the Wells. COG requests overhead and administrative rates of \$14,000 per month while the Wells are being drilled and \$1,400 per month while the Wells are producing. These rates are fair and are comparable to the rates charged by COG and other operators in the vicinity.

18. The attached exhibits were either prepared by me or under my supervision or were compiled from company business records.

19. In my opinion, the granting of COG’s application would serve the interests of conservation, the protection of correlative rights, and the prevention of waste.

20. I understand this Self-Affirmed Statement will be used as written testimony in this case. I affirm that my testimony above is true and correct and is made under penalty of perjury under the laws of the State of New Mexico. My testimony is made as of the date next to my electronic signature below.



Caroline Frederick

4/20/2026

Date

**STATE OF NEW MEXICO
DEPARTMENT OF ENERGY, MINERALS AND NATURAL RESOURCES
OIL CONSERVATION DIVISION**

**APPLICATION OF COG OPERATING LLC
FOR COMPULSORY POOLING AND APPROVAL
OF NON-STANDARD SPACING UNIT,
LEA COUNTY, NEW MEXICO.**

CASE NO. 26084

APPLICATION

Pursuant to NMSA 1978, Section 70-2-17, COG Operating LLC (OGRID No. 229137) (“COG” or “Applicant”) applies for an order pooling all uncommitted interests in the Wolfcamp formation underlying a 960-acre, more or less, non-standard, horizontal spacing unit comprised of the S/2 of Section 29 and all of Section 32, Township 25 South, Range 35 East, Lea County, New Mexico (“Unit”). In support of this application, COG states the following.

1. Applicant is a working interest owner in the Unit and has the right to drill wells thereon.
2. Applicant seeks to dedicate the Unit to the following wells (“Wells”):
 - a. **Boater Federal Com 701H**, which will be drilled from a surface hole location in the SE/4 NW/4 (Unit F) of Section 29, to a bottom hole location in the SE/4 SW/4 (Unit N) of Section 32;
 - b. **Boater Federal Com 702H**, which will be drilled from a surface hole location in the SE/4 NW/4 (Unit F) of Section 29, to a bottom hole location in the SW/4 SE/4 (Unit O) of Section 32; and
 - c. **Boater Federal Com 703H**, which will be drilled from a surface hole location in the SW/4 NE/4 (Unit G) of Section 29, to a bottom hole location in the SE/4 SE/4 (Unit P) of Section 32.
3. The completed intervals of the Wells will be orthodox.

**COG Operating LLC
Case No. 26084
Exhibit A-1**

4. Applicant requests approval of a non-standard horizontal spacing unit pursuant to Rule 19.15.16.15(B)(5) NMAC, which will create cost efficiencies, prevent waste, and protect correlative rights.

5. Due to a depth severance within the Unit, Applicant seeks to pool only those uncommitted interests from the top of the Wolfcamp formation to the base of the Wolfcamp A interval at a stratigraphic equivalent of approximately 12,736' TVD, as observed on the Tele Delux 32 State 4H well log (API No. 30-025-42362).

6. Applicant has undertaken diligent, good-faith efforts to obtain voluntary agreements from all interest owners to participate in the drilling of the Wells but has been unable to obtain voluntary agreements from all interest owners.

7. The pooling of uncommitted interests will avoid the drilling of unnecessary wells, prevent waste, and protect correlative rights.

8. In order to allow Applicant to obtain its just and fair share of the oil and gas underlying the subject lands, all uncommitted interests in the Unit should be pooled and Applicant should be designated the operator of the Wells and Unit.

WHEREFORE, Applicant requests that this application be set for hearing before an Examiner of the Oil Conservation Division on May 7, 2026, and, after notice and hearing as required by law, the Division enter an order:

- A. Pooling all uncommitted interests in the Unit;
- B. Approving the Wells in the Unit;
- C. Approving the non-standard spacing Unit;
- D. Designating Applicant as operator of the Unit and the Wells to be drilled thereon;
- E. Authorizing Applicant to recover its costs of drilling, equipping and completing

the Wells;

- F. Approving the actual operating charges and costs of supervision while drilling and after completion, together with a provision adjusting the rates pursuant to the COPAS accounting procedures; and
- G. Imposing a 200% penalty for the risk assumed by Applicant in drilling and completing the Wells against any working interest owner who does not voluntarily participate in the drilling of the Wells.

Respectfully submitted,

HARDY McLEAN LLC

/s/ Dana S. Hardy

Dana S. Hardy

Jaclyn M. McLean

Jaime R. Fontaine

Yarithza Peña

125 Lincoln Ave., Ste. 223

Santa Fe, NM 87501

Phone: (505) 230-4410

dhardy@hardymclean.com

jmclean@hardymclean.com

jfontaine@hardymclean.com

ypena@hardymclean.com

COUNSEL FOR COG OPERATING LLC

Application of COG Operating LLC for Compulsory Pooling and Approval of Non-Standard Spacing Unit, Lea County, New Mexico. Applicant seeks an order pooling all uncommitted interests in the Wolfcamp A interval of the Wolfcamp formation underlying a 960-acre, more or less, non-standard, horizontal spacing unit comprised of the S/2 of Section 29, and all of Section 32, Township 25 South, Range 35 East, Lea County, New Mexico (“Unit”). The Unit will be dedicated to the following wells (“Wells”): **Boater Federal Com 701H**, which will be drilled from a surface hole location in the SE/4 NW/4 (Unit F) of Section 29, to a bottom hole location in the SE/4 SW/4 (Unit N) of Section 32; **Boater Federal Com 702H**, which will be drilled from a surface hole location in the SE/4 NW/4 (Unit F) of Section 29, to a bottom hole location in the SW/4 SE/4 (Unit O) of Section 32; and **Boater Federal Com 703H**, which will be drilled from a surface hole location in the SW/4 NE/4 (Unit G) of Section 29, to a bottom hole location in the SE/4 SE/4 (Unit P) of Section 32. Due to a depth severance within the Unit, Applicant seeks to pool only those uncommitted interests from the top of the Wolfcamp formation to the base of the Wolfcamp A interval at a stratigraphic equivalent of approximately 12,736’ TVD, as observed on the Tele Delux 32 State 4H well log (API No. 30-025-42362). The completed intervals of the Wells will be orthodox. Applicant requests approval of a non-standard horizontal spacing unit pursuant to Rule 19.15.16.15(B)(5) NMAC, which will create cost efficiencies, prevent waste, and protect correlative rights. Also to be considered will be the cost of drilling and completing the Wells, the allocation of the costs, the designation of Applicant as operator of the Wells and the Unit, and a 200% charge for the risk involved in drilling and completing the Wells. The Wells are located approximately 12 miles Southwest of Jal, New Mexico.

Boater Federal Com – Non-Standard Unit Offset Notification

Dogie Draw; Wolfcamp (17980)

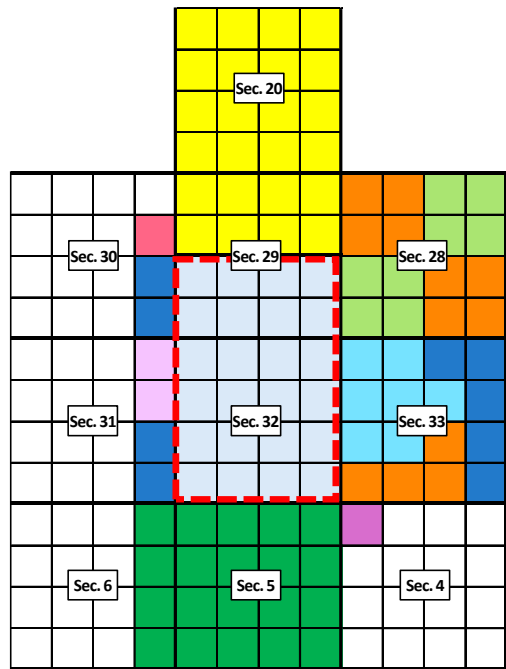

Dogie Draw; Wolfcamp (17980)
 Boater Federal Com Unit Wolfcamp A

Lease	Well	Pool	Operator	Operating Rights/Working Interest	Unleased
NM 136223	N/A	NO EXISTING WELLS IN DOGIE DRAW; WOLF CAMP (17980) OR BONE SPRING (97088) POOLS	N/A	COG OPERATING LLC	NONE
	N/A	NO EXISTING WELLS IN DOGIE DRAW; WOLF CAMP (17980) OR BONE SPRING (97088) POOLS	N/A	COG OPERATING LLC	NONE
	N/A	NO EXISTING WELLS IN DOGIE DRAW; WOLF CAMP (17980) OR BONE SPRING (97088) POOLS	N/A	COG OPERATING LLC	NONE
NM 132953	DUO SONIC 29 FEDERAL #004H, 30-025-43090	BONE SPRING (97088)	COG OPERATING LLC	COG OPERATING LLC	NONE
	GREEN BERET FEDERAL COM #501H, 30-025-47819	DOGIE DRAW; WOLF CAMP (17980)	COG OPERATING LLC	COG OPERATING LLC UNITED EXPLORATION LLC BEVERLY JEAN RENFRO BARR, TRUSTEE	NONE
	GREEN BERET FEDERAL COM #602H, 30-025-47879	DOGIE DRAW; WOLF CAMP (17980)	COG OPERATING LLC	COG OPERATING LLC UNITED EXPLORATION LLC BEVERLY JEAN RENFRO BARR, TRUSTEE	NONE
	GREEN BERET FEDERAL COM #603H, 30-025-49407	BONE SPRING (97088)	COG OPERATING LLC	COG OPERATING LLC UNITED EXPLORATION LLC BEVERLY JEAN RENFRO BARR, TRUSTEE	NONE
	GREEN BERET FEDERAL COM #701H, 30-025-47821	BONE SPRING (97088)	COG OPERATING LLC	COG OPERATING LLC UNITED EXPLORATION LLC BEVERLY JEAN RENFRO BARR, TRUSTEE	NONE
	GREEN BERET FEDERAL COM #702H, 30-025-47822	DOGIE DRAW; WOLF CAMP (17980)	COG OPERATING LLC	COG OPERATING LLC UNITED EXPLORATION LLC BEVERLY JEAN RENFRO BARR, TRUSTEE	NONE
	GREEN BERET FEDERAL COM #703H, 30-025-49408	DOGIE DRAW; WOLF CAMP (17980)	COG OPERATING LLC	COG OPERATING LLC UNITED EXPLORATION LLC BEVERLY JEAN RENFRO BARR, TRUSTEE	NONE
	GREEN BERET FEDERAL COM #704H, 30-025-49409	DOGIE DRAW; WOLF CAMP (17980)	COG OPERATING LLC	COG OPERATING LLC UNITED EXPLORATION LLC BEVERLY JEAN RENFRO BARR, TRUSTEE	NONE
	GREEN BERET FEDERAL COM #705H, 30-025-49410	DOGIE DRAW; WOLF CAMP (17980)	COG OPERATING LLC	COG OPERATING LLC UNITED EXPLORATION LLC BEVERLY JEAN RENFRO BARR, TRUSTEE	NONE
	GREEN BERET FEDERAL COM #801H, 30-025-47823	BONE SPRING (97088)	COG OPERATING LLC	COG OPERATING LLC UNITED EXPLORATION LLC BEVERLY JEAN RENFRO BARR, TRUSTEE	NONE
	GREEN BERET FEDERAL COM #802H, 30-025-49411	DOGIE DRAW; WOLF CAMP (17980)	COG OPERATING LLC	COG OPERATING LLC UNITED EXPLORATION LLC BEVERLY JEAN RENFRO BARR, TRUSTEE	NONE

COG Operating LLC
Case No. 26084
Exhibit A-2

Boater Federal Com – Non-Standard Unit Offset Notification

Dogie Draw; Wolfcamp (17980)

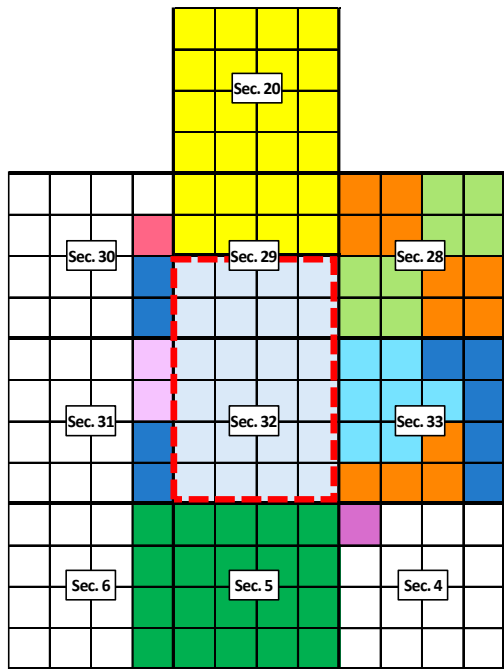

Lease	Well	Pool	Operator	Operating Rights/Working Interest	Unleased
NM 112943	AKUBRA FEDERAL COM #601H, 30-025-52961	BONE SPRING (97088) NO EXISTING WELLS IN DOGIE DRAW; WOLF CAMP (17980) POOL	COG OPERATING LLC	COG OPERATING LLC CHEVRON U.S.A. INC.	NONE
	AKUBRA FEDERAL COM #602H, 30-025-52889	BONE SPRING (97088) NO EXISTING WELLS IN DOGIE DRAW; WOLF CAMP (17980) POOL	COG OPERATING LLC	COG OPERATING LLC CHEVRON U.S.A. INC.	NONE
	AKUBRA FEDERAL COM #603H, 30-025-52890	BONE SPRING (97088) NO EXISTING WELLS IN DOGIE DRAW; WOLF CAMP (17980) POOL	COG OPERATING LLC	COG OPERATING LLC CHEVRON U.S.A. INC.	NONE
	N/A	NO EXISTING WELLS IN DOGIE DRAW; WOLF CAMP (17980) POOL	N/A	COG OPERATING LLC CHEVRON U.S.A. INC.	NONE
	N/A	NO EXISTING WELLS IN DOGIE DRAW; WOLF CAMP (17980) POOL	N/A	COG OPERATING LLC CHEVRON U.S.A. INC.	NONE
	N/A	NO EXISTING WELLS IN DOGIE DRAW; WOLF CAMP (17980) POOL	N/A	COG OPERATING LLC CHEVRON U.S.A. INC.	NONE
	N/A	NO EXISTING WELLS IN DOGIE DRAW; WOLF CAMP (17980) POOL	N/A	COG OPERATING LLC CHEVRON U.S.A. INC.	NONE
	N/A	NO EXISTING WELLS IN DOGIE DRAW; WOLF CAMP (17980) POOL	N/A	COG OPERATING LLC CHEVRON U.S.A. INC.	NONE
	N/A	NO EXISTING WELLS IN DOGIE DRAW; WOLF CAMP (17980) POOL	N/A	COG OPERATING LLC CHEVRON U.S.A. INC.	NONE
NM 045706	AKUBRA FEDERAL COM #601H, 30-025-52961	BONE SPRING (97088) NO EXISTING WELLS IN DOGIE DRAW; WOLF CAMP (17980) POOL	COG OPERATING LLC	COG OPERATING LLC CHEVRON U.S.A. INC.	NONE
	AKUBRA FEDERAL COM #602H, 30-025-52889	BONE SPRING (97088) NO EXISTING WELLS IN DOGIE DRAW; WOLF CAMP (17980) POOL	COG OPERATING LLC	COG OPERATING LLC CHEVRON U.S.A. INC.	NONE
	AKUBRA FEDERAL COM #603H, 30-025-52890	BONE SPRING (97088) NO EXISTING WELLS IN DOGIE DRAW; WOLF CAMP (17980) POOL	COG OPERATING LLC	COG OPERATING LLC CHEVRON U.S.A. INC.	NONE
	N/A	NO EXISTING WELLS IN DOGIE DRAW; WOLF CAMP (17980) POOL	N/A	COG OPERATING LLC	NONE
	N/A	NO EXISTING WELLS IN DOGIE DRAW; WOLF CAMP (17980) POOL	N/A	COG OPERATING LLC	NONE
	N/A	NO EXISTING WELLS IN DOGIE DRAW; WOLF CAMP (17980) POOL	N/A	COG OPERATING LLC	NONE
	N/A	NO EXISTING WELLS IN DOGIE DRAW; WOLF CAMP (17980) POOL	N/A	COG OPERATING LLC	NONE
	N/A	NO EXISTING WELLS IN DOGIE DRAW; WOLF CAMP (17980) POOL	N/A	COG OPERATING LLC	NONE
	N/A	NO EXISTING WELLS IN DOGIE DRAW; WOLF CAMP (17980) POOL	N/A	COG OPERATING LLC	NONE

Boater Federal Com – Non-Standard Unit Offset Notification

Dogie Draw; Wolfcamp (17980)

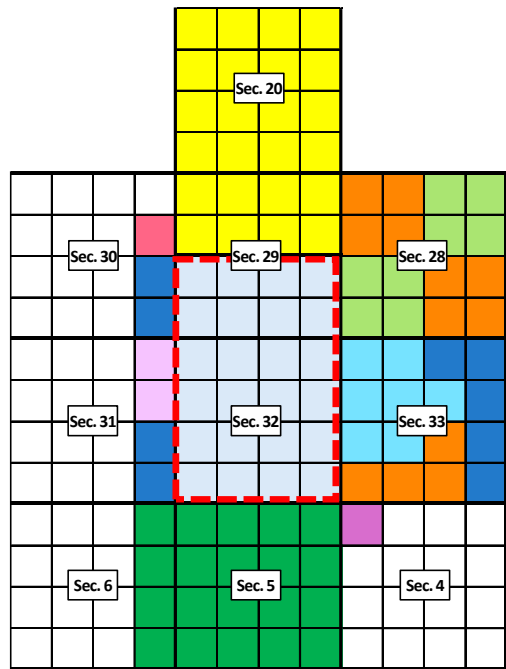

Dogie Draw; Wolfcamp (17980)
 Boater Federal Com Unit Wolfcamp A

Lease	Well	Pool	Operator	Operating Rights/Working Interest	Unleased
NM 132955	AKUBRA FEDERAL COM #601H, 30-025-52961	BONE SPRING (97088) NO EXISTING WELLS IN DOGIE DRAW; WOLF CAMP (17980) POOL	COG OPERATING LLC	COG OPERATING LLC CHEVRON U.S.A. INC.	NONE
	AKUBRA FEDERAL COM #602H, 30-025-52889	BONE SPRING (97088) NO EXISTING WELLS IN DOGIE DRAW; WOLF CAMP (17980) POOL	COG OPERATING LLC	COG OPERATING LLC CHEVRON U.S.A. INC.	NONE
	AKUBRA FEDERAL COM #603H, 30-025-52890	BONE SPRING (97088) NO EXISTING WELLS IN DOGIE DRAW; WOLF CAMP (17980) POOL	COG OPERATING LLC	COG OPERATING LLC CHEVRON U.S.A. INC.	NONE
	N/A	NO EXISTING WELLS IN DOGIE DRAW; WOLF CAMP (17980) POOL	N/A	COG OPERATING LLC	NONE
	N/A	NO EXISTING WELLS IN DOGIE DRAW; WOLF CAMP (17980) POOL	N/A	COG OPERATING LLC	NONE
	N/A	NO EXISTING WELLS IN DOGIE DRAW; WOLF CAMP (17980) POOL	N/A	COG OPERATING LLC	NONE
	N/A	NO EXISTING WELLS IN DOGIE DRAW; WOLF CAMP (17980) POOL	N/A	COG OPERATING LLC	NONE
	N/A	NO EXISTING WELLS IN DOGIE DRAW; WOLF CAMP (17980) POOL	N/A	COG OPERATING LLC	NONE
	N/A	NO EXISTING WELLS IN DOGIE DRAW; WOLF CAMP (17980) POOL	N/A	COG OPERATING LLC	NONE
NM 115000	N/A	NO EXISTING WELLS IN W/2W/2 OF SECTION 4	N/A	COG OPERATING LLC DEVON ENERGY PRODUCTION COMPANY, LP CHEVRON U.S.A. INC ENDURANCE PROPERTIES INC	NONE
NM 013647	CHARLIE MURPHY 6 TB FEDERAL COM #014H, 30-025-46484	BONE SPRING (97088) NO EXISTING WELLS IN DOGIE DRAW; WOLF CAMP (17980) POOL	MARATHON OIL PERMIAN LLC	MARATHON OIL PERMIAN LLC CHEVRON U.S.A. INC. PINTAIL PRODUCTION COMPANY OCCIDENTAL PERMIAN LIMITED PARTNERSHIP	NONE
	CAVE LION 5 TB FEDERAL #012H, 30-025-45422	BONE SPRING (97088) NO EXISTING WELLS IN DOGIE DRAW; WOLF CAMP (17980) POOL	MARATHON OIL PERMIAN LLC	MARATHON OIL PERMIAN LLC OCCIDENTAL PERMIAN LIMITED PARTNERSHIP	NONE
	CAVE LION 5 TB FEDERAL #015H, 30-025-45424	BONE SPRING (97088) NO EXISTING WELLS IN DOGIE DRAW; WOLF CAMP (17980) POOL	MARATHON OIL PERMIAN LLC	MARATHON OIL PERMIAN LLC OCCIDENTAL PERMIAN LIMITED PARTNERSHIP	NONE
	CAVE LION 5 TB FEDERAL #008H, 30-025-45419	BONE SPRING (97088) NO EXISTING WELLS IN DOGIE DRAW; WOLF CAMP (17980) POOL	MARATHON OIL PERMIAN LLC	MARATHON OIL PERMIAN LLC OCCIDENTAL PERMIAN LIMITED PARTNERSHIP	NONE

Boater Federal Com – Non-Standard Unit Offset Notification

Dogie Draw; Wolfcamp (17980)

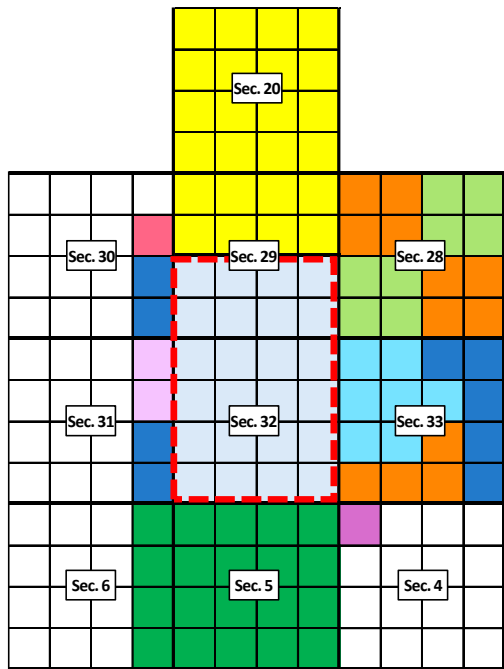

Lease	Well	Pool	Operator	Operating Rights/Working Interest	Unleased
NM 119280	SQUARE BILL FEDERAL COM #001H, 30-025-44046	BONE SPRING (97088) DOGIE DRAW; WOLF CAMP (17980)	COG OPERATING LLC	COG OPERATING LLC	NONE
	SQUARE BILL FEDERAL COM #021Y, 30-025-44397	DOGIE DRAW; WOLF CAMP (17980)	COG OPERATING LLC	COG OPERATING LLC	NONE
	SQUARE BILL FEDERAL COM #022H, 30-025-44047	DOGIE DRAW; WOLF CAMP (17980)	COG OPERATING LLC	COG OPERATING LLC	NONE
	SQUARE BILL FEDERAL COM #023H, 30-025-44048	DOGIE DRAW; WOLF CAMP (17980)	COG OPERATING LLC	COG OPERATING LLC	NONE
NM 132954	SQUARE BILL FEDERAL COM #001H, 30-025-44046	BONE SPRING (97088) DOGIE DRAW; WOLF CAMP (17980)	COG OPERATING LLC	COG OPERATING LLC	NONE
	SQUARE BILL FEDERAL COM #021Y, 30-025-44397	DOGIE DRAW; WOLF CAMP (17980)	COG OPERATING LLC	COG OPERATING LLC	NONE
	SQUARE BILL FEDERAL COM #022H, 30-025-44047	DOGIE DRAW; WOLF CAMP (17980)	COG OPERATING LLC	COG OPERATING LLC	NONE
	SQUARE BILL FEDERAL COM #023H, 30-025-44048	DOGIE DRAW; WOLF CAMP (17980)	COG OPERATING LLC	COG OPERATING LLC	NONE

Dogie Draw; Wolfcamp (17980)
 Boater Federal Com Unit Wolfcamp A

Boater Federal Com – Non-Standard Unit Offset Notification



DOGIE DRAW; WOLFCAMP (17980)	
PARTY	ADDRESS
UNITED STATES OF AMERICA BUREAU OF LAND MANAGEMENT	301 DINOSAUR TRAIL SANTA FE, NM 87508
COMMISSIONER OF PUBLIC LANDS NEW MEXICO STATE LAND OFFICE	PO BOX 1148 SANTA FE, NM 87504
UNITED EXPLORATION LLC	320 S. OAK STREET, #216 ROANOKE, TX 76262
BEVERLY JEAN RENFRO BARR, TRUSTEE	804 PARK VISTA CIRCLE SOUTHLAKE, TX 76092
CHEVRON U.S.A. INC.	6301 DEAUVILLE BLVD MIDLAND, TX 79706
DEVON ENERGY PRODUCTION COMPANY, LP	333 WEST SHERIDAN AVE OKLAHOMA CITY, OK 73102
ENDURANCE PROPERTIES INC	15455 DALLAS PKWY, SUITE 1050 ADDISON, TX 75001
OCCIDENTAL PERMIAN LIMITED PARTNERSHIP	5 GREENWAY PLAZA, SUITE 110 HOUSTON, TX 77046
PINTAIL PRODUCTION COMPANY	6767 SOUTHWEST BLVD FORT WORTH, TX 76132

C-102 Submit Electronically Via OCD Permitting	State of New Mexico Energy, Minerals & Natural Resources Department OIL CONSERVATION DIVISION	Revised July 9, 2024
		Submittal Type: <input checked="" type="checkbox"/> Initial Submittal <input type="checkbox"/> Amended Report <input type="checkbox"/> As Drilled

WELL LOCATION INFORMATION

API Number 30-025-	Pool Code 17980	Pool Name Dogie Draw; Wolfcamp
Property Code	Property Name BOATER FEDERAL COM	Well Number 701H
OGRID No. 229137	Operator Name COG OPERATING LLC	Ground Level Elevation 3279.1'
Surface Owner: <input type="checkbox"/> State <input type="checkbox"/> Fee <input type="checkbox"/> Tribal <input checked="" type="checkbox"/> Federal		Mineral Owner: <input checked="" type="checkbox"/> State <input type="checkbox"/> Fee <input type="checkbox"/> Tribal <input checked="" type="checkbox"/> Federal

Surface Location

UL	Section	Township	Range	Lot	Ft. from N/S	Ft. from E/W	Latitude	Longitude	County
F	29	25-S	35-E		2365 FNL	1380 FWL	32.102125°N	103.393618°W	LEA

Bottom Hole Location

UL	Section	Township	Range	Lot	Ft. from N/S	Ft. from E/W	Latitude	Longitude	County
N	32	25-S	35-E		50 FSL	1430 FWL	32.079752°N	103.393429°W	LEA

Dedicated Acres 960	Infill or Defining Well Defining	Defining Well API	Overlapping Spacing Unit (Y/N)	Consolidation Code Com
Order Numbers.			Well setbacks are under Common Ownership: <input checked="" type="checkbox"/> Yes <input type="checkbox"/> No	

Kick Off Point (KOP)

UL	Section	Township	Range	Lot	Ft. from N/S	Ft. from E/W	Latitude	Longitude	County
F	29	25-S	35-E		2365 FNL	1380 FWL	32.102125°N	103.393618°W	LEA

First Take Point (FTP)

UL	Section	Township	Range	Lot	Ft. from N/S	Ft. from E/W	Latitude	Longitude	County
K	29	25-S	35-E		2540 FSL	1430 FWL	32.101097°N	103.393455°W	LEA

Last Take Point (LTP)

UL	Section	Township	Range	Lot	Ft. from N/S	Ft. from E/W	Latitude	Longitude	County
N	32	25-S	35-E		100 FSL	1430 FWL	32.079889°N	103.393429°W	LEA

Unitized Area or Area of Uniform Interest	Spacing Unit Type <input checked="" type="checkbox"/> Horizontal <input type="checkbox"/> Vertical	Ground Floor Elevation: 3280.2'
---	--	---

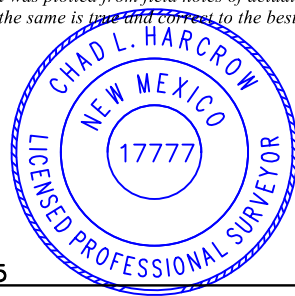
<p>OPERATOR CERTIFICATIONS</p> <p><i>I hereby certify that the information contained herein is true and complete to the best of my knowledge and belief, and, if the well is a vertical or directional well, that this organization either owns a working interest or unleased mineral interest in the land including the proposed bottom hole location or has a right to drill this well at this location pursuant to a contract with an owner of a working interest or unleased mineral interest, or to a voluntary pooling agreement or a compulsory pooling order heretofore entered by the division.</i></p> <p><i>If this well is a horizontal well, I further certify that this organization has received the consent of at least one lessee or owner of a working interest or unleased mineral interest in each tract (in the target pool or formation) in which any part of the well's completed interval will be located or obtained a compulsory pooling order from the division.</i></p>	<p>SURVEYOR CERTIFICATIONS</p> <p><i>I hereby certify that the well location shown on this plat was plotted from field notes of actual surveys made by me or under my supervision, and that the same is true and correct to the best of my belief.</i></p> <div style="text-align: right;">  <p><i>Chad Harcrow</i> 6/6/25</p> </div>	
Signature <i>Stan Wagner</i>	Date 7/7/25	Signature and Seal of Professional Surveyor
Printed Name Stan Wagner	Certificate Number 17777	Date of Survey MAY 28, 2025
Email Address	W.O.# 25-504	DRAWN BY: WN PAGE 1 OF 2

This grid represents a standard section. You may superimpose a non-standard section, or larger area, over this grid. Operators must outline the dedicated acreage in a red box, clearly show the well surface location and bottom hole location, if it is directionally drilled, with the dimensions from the section lines in the cardinal directions. If this is a horizontal wellbore show on this plat the location of the First Take Point and Last Take Point, and the point within the Completed interval (other than the First Take Point or Last Take Point) that is closest to any outer boundary of the tract.

Surveyors shall use the latest United States government survey or dependent resurvey. Well locations will be in reference to the New Mexico Principal Meridian. If the land is not surveyed, contact the OCD Engineering Bureau. Independent subdivision surveys will not be acceptable.

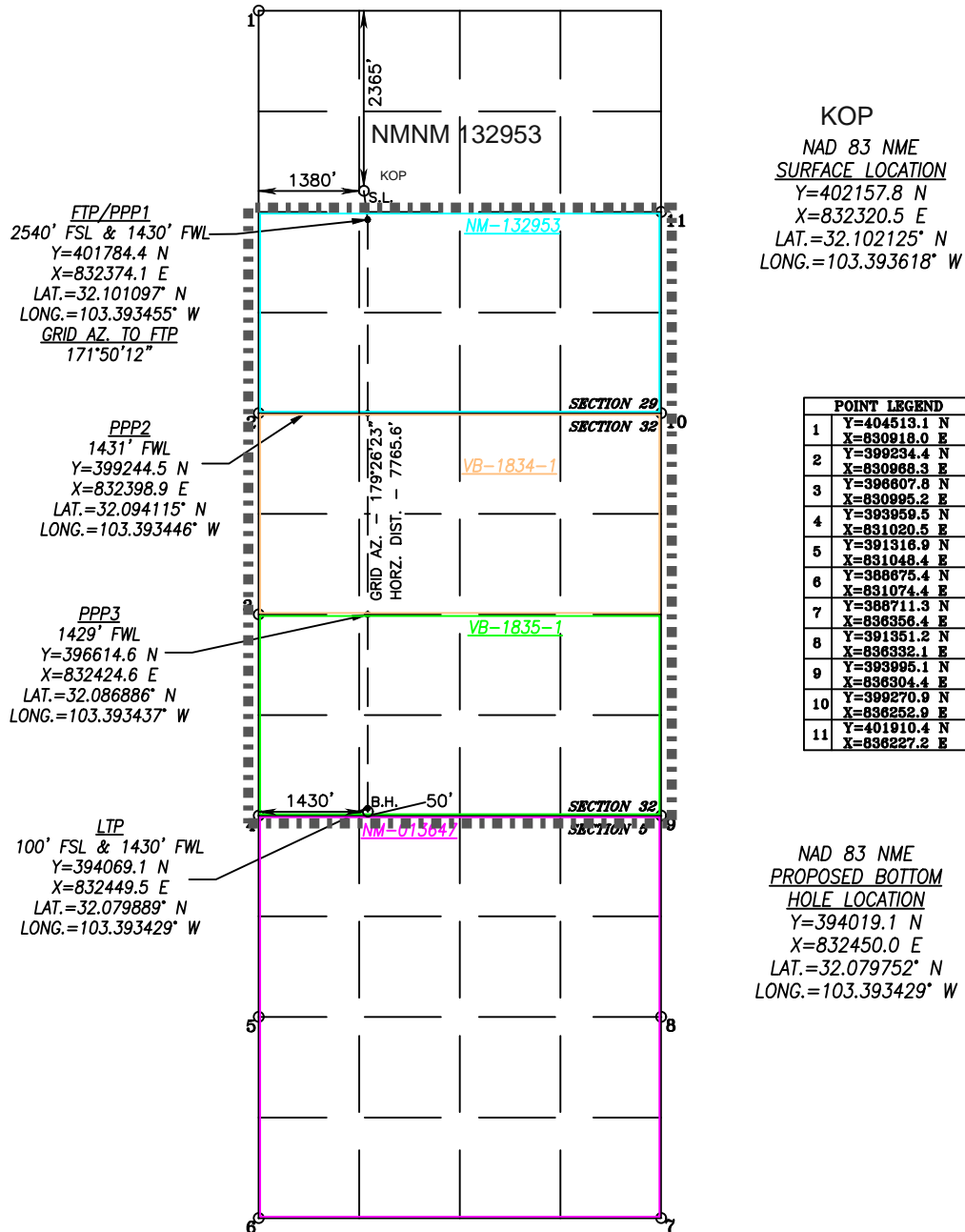

C-102 Submit Electronically Via OCD Permitting	State of New Mexico Energy, Minerals & Natural Resources Department OIL CONSERVATION DIVISION	Revised July 9, 2024			
		Submittal Type: <table border="1" style="width:100%; border-collapse: collapse;"> <tr> <td><input checked="" type="checkbox"/> Initial Submittal</td> </tr> <tr> <td><input type="checkbox"/> Amended Report</td> </tr> <tr> <td><input type="checkbox"/> As Drilled</td> </tr> </table>	<input checked="" type="checkbox"/> Initial Submittal	<input type="checkbox"/> Amended Report	<input type="checkbox"/> As Drilled
<input checked="" type="checkbox"/> Initial Submittal					
<input type="checkbox"/> Amended Report					
<input type="checkbox"/> As Drilled					

WELL LOCATION INFORMATION

API Number 30-025-	Pool Code 17980	Pool Name Dogie Draw; Wolfcamp
Property Code	Property Name BOATER FEDERAL COM	Well Number 702H
OGRID No. 229137	Operator Name COG OPERATING LLC	Ground Level Elevation 3279.2'
Surface Owner: <input type="checkbox"/> State <input type="checkbox"/> Fee <input type="checkbox"/> Tribal <input checked="" type="checkbox"/> Federal		Mineral Owner: <input checked="" type="checkbox"/> State <input type="checkbox"/> Fee <input type="checkbox"/> Tribal <input checked="" type="checkbox"/> Federal

Surface Location

UL	Section	Township	Range	Lot	Ft. from N/S	Ft. from E/W	Latitude	Longitude	County
F	29	25-S	35-E		2365 FNL	1440 FWL	32.102125°N	103.393424°W	LEA

Bottom Hole Location

UL	Section	Township	Range	Lot	Ft. from N/S	Ft. from E/W	Latitude	Longitude	County
0	32	25-S	35-E		50 FSL	2450 FEL	32.079744°N	103.388896°W	LEA

Dedicated Acres 960	Infill or Defining Well Defining	Defining Well API	Overlapping Spacing Unit (Y/N)	Consolidation Code Com
Order Numbers.			Well setbacks are under Common Ownership: <input checked="" type="checkbox"/> Yes <input type="checkbox"/> No	

Kick Off Point (KOP)

UL	Section	Township	Range	Lot	Ft. from N/S	Ft. from E/W	Latitude	Longitude	County
F	29	25-S	35-E		2365 FNL	1440 FWL	32.102125°N	103.393424°W	LEA

First Take Point (FTP)

UL	Section	Township	Range	Lot	Ft. from N/S	Ft. from E/W	Latitude	Longitude	County
J	29	25-S	35-E		2540 FSL	2450 FEL	32.101091°N	103.388921°W	LEA

Last Take Point (LTP)

UL	Section	Township	Range	Lot	Ft. from N/S	Ft. from E/W	Latitude	Longitude	County
0	32	25-S	35-E		100 FSL	2450 FEL	32.079882°N	103.388896°W	LEA

Unitized Area or Area of Uniform Interest	Spacing Unit Type <input checked="" type="checkbox"/> Horizontal <input type="checkbox"/> Vertical	Ground Floor Elevation: 3279.2'
---	--	---

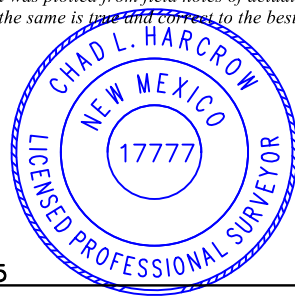
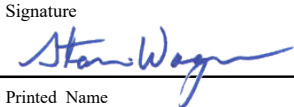
<p>OPERATOR CERTIFICATIONS</p> <p><i>I hereby certify that the information contained herein is true and complete to the best of my knowledge and belief, and, if the well is a vertical or directional well, that this organization either owns a working interest or unleased mineral interest in the land including the proposed bottom hole location or has a right to drill this well at this location pursuant to a contract with an owner of a working interest or unleased mineral interest, or to a voluntary pooling agreement or a compulsory pooling order heretofore entered by the division.</i></p> <p><i>If this well is a horizontal well, I further certify that this organization has received the consent of at least one lessee or owner of a working interest or unleased mineral interest in each tract (in the target pool or formation) in which any part of the well's completed interval will be located or obtained a compulsory pooling order from the division.</i></p>	<p>SURVEYOR CERTIFICATIONS</p> <p><i>I hereby certify that the well location shown on this plat was plotted from field notes of actual surveys made by me or under my supervision, and that the same is true and correct to the best of my belief.</i></p> <div style="text-align: right;">  <p>Chad Harcrow 6/6/25</p> </div>		
Signature 	Date 7/7/25	Signature and Seal of Professional Surveyor	
Printed Name Stan Wagner	Email Address	Certificate Number 17777	Date of Survey MAY 28, 2025
		W.O.#25-506	DRAWN BY: WN PAGE 1 OF 2

This grid represents a standard section. You may superimpose a non-standard section, or larger area, over this grid. Operators must outline the dedicated acreage in a red box, clearly show the well surface location and bottom hole location, if it is directionally drilled, with the dimensions from the section lines in the cardinal directions. If this is a horizontal wellbore show on this plat the location of the First Take Point and Last Take Point, and the point within the Completed interval (other than the First Take Point or Last Take Point) that is closest to any outer boundary of the tract.

Surveyors shall use the latest United States government survey or dependent resurvey. Well locations will be in reference to the New Mexico Principal Meridian. If the land is not surveyed, contact the OCD Engineering Bureau. Independent subdivision surveys will not be acceptable.

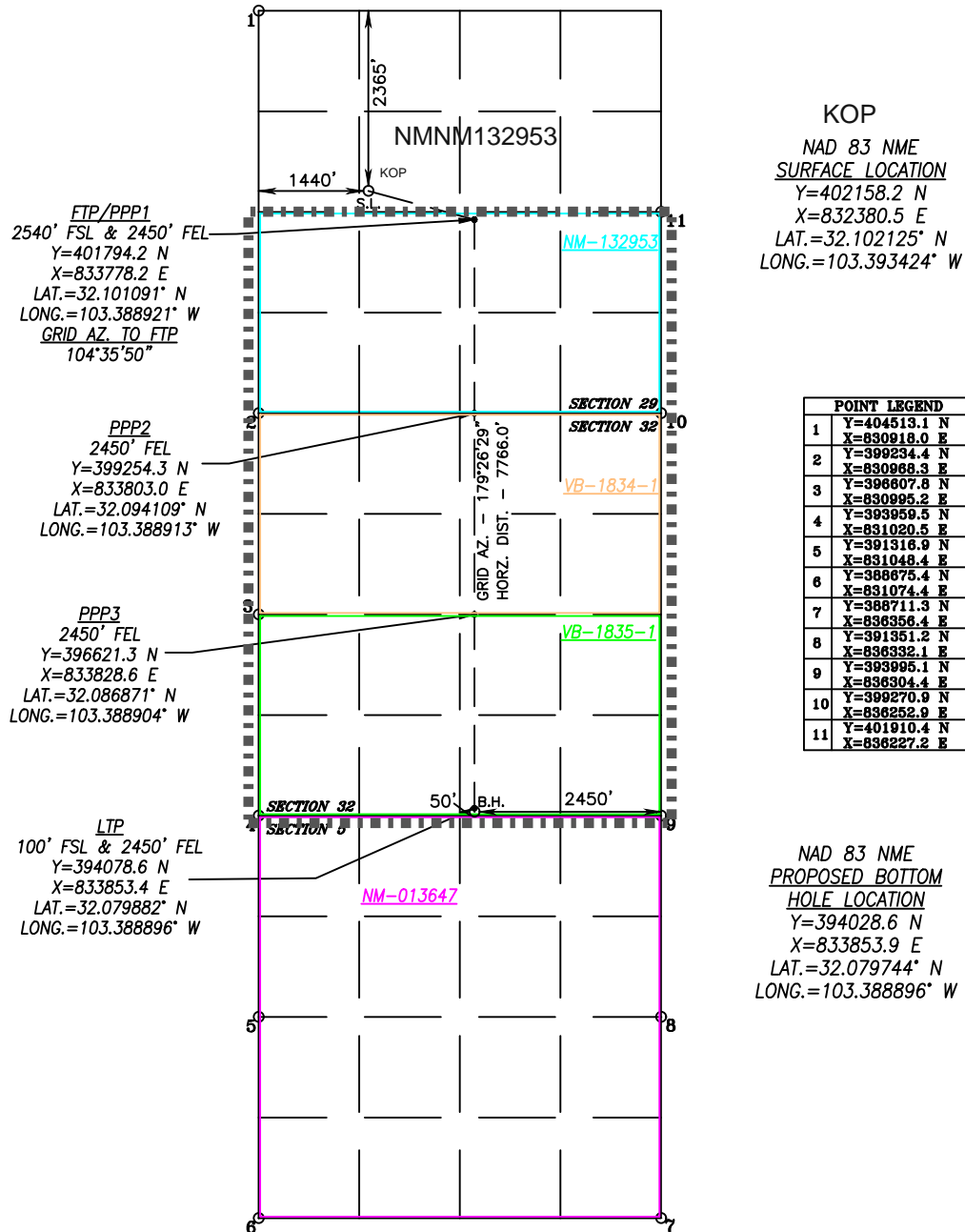

C-102 Submit Electronically Via OCD Permitting	State of New Mexico Energy, Minerals & Natural Resources Department OIL CONSERVATION DIVISION	Revised July 9, 2024			
		Submittal Type: <table style="width:100%; border: none;"> <tr> <td style="border: none;"><input checked="" type="checkbox"/> Initial Submittal</td> </tr> <tr> <td style="border: none;"><input type="checkbox"/> Amended Report</td> </tr> <tr> <td style="border: none;"><input type="checkbox"/> As Drilled</td> </tr> </table>	<input checked="" type="checkbox"/> Initial Submittal	<input type="checkbox"/> Amended Report	<input type="checkbox"/> As Drilled
<input checked="" type="checkbox"/> Initial Submittal					
<input type="checkbox"/> Amended Report					
<input type="checkbox"/> As Drilled					

WELL LOCATION INFORMATION

API Number 30-025-	Pool Code 17980	Pool Name Dogie Draw; Wolfcamp
Property Code	Property Name BOATER FEDERAL COM	Well Number 703H
OGRID No. 229137	Operator Name COG OPERATING LLC	Ground Level Elevation 3255.6'
Surface Owner: <input type="checkbox"/> State <input type="checkbox"/> Fee <input type="checkbox"/> Tribal <input checked="" type="checkbox"/> Federal		Mineral Owner: <input checked="" type="checkbox"/> State <input type="checkbox"/> Fee <input type="checkbox"/> Tribal <input checked="" type="checkbox"/> Federal

Surface Location

UL	Section	Township	Range	Lot	Ft. from N/S	Ft. from E/W	Latitude	Longitude	County
G	29	25-S	35-E		2365 FNL	1385 FEL	32.102112°N	103.385483°W	LEA

Bottom Hole Location

UL	Section	Township	Range	Lot	Ft. from N/S	Ft. from E/W	Latitude	Longitude	County
P	32	25-S	35-E		50 FSL	1100 FEL	32.079737°N	103.384538°W	LEA

Dedicated Acres 960	Infill or Defining Well Defining	Defining Well API	Overlapping Spacing Unit (Y/N)	Consolidation Code Com
Order Numbers.			Well setbacks are under Common Ownership: <input checked="" type="checkbox"/> Yes <input type="checkbox"/> No	

Kick Off Point (KOP)

UL	Section	Township	Range	Lot	Ft. from N/S	Ft. from E/W	Latitude	Longitude	County
G	29	25-S	35-E		2365 FNL	1385 FEL	32.102112°N	103.385483°W	LEA

First Take Point (FTP)

UL	Section	Township	Range	Lot	Ft. from N/S	Ft. from E/W	Latitude	Longitude	County
I	29	25-S	35-E		2540 FSL	1100 FEL	32.101083°N	103.384562°W	LEA

Last Take Point (LTP)

UL	Section	Township	Range	Lot	Ft. from N/S	Ft. from E/W	Latitude	Longitude	County
P	32	25-S	35-E		100 FSL	1100 FEL	32.079874°N	103.384538°W	LEA

Unitized Area or Area of Uniform Interest	Spacing Unit Type <input checked="" type="checkbox"/> Horizontal <input type="checkbox"/> Vertical	Ground Floor Elevation: 3255.6'
---	--	---

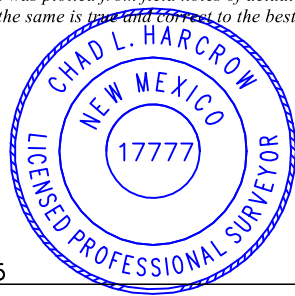
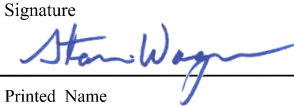
<p>OPERATOR CERTIFICATIONS</p> <p><i>I hereby certify that the information contained herein is true and complete to the best of my knowledge and belief, and, if the well is a vertical or directional well, that this organization either owns a working interest or unleased mineral interest in the land including the proposed bottom hole location or has a right to drill this well at this location pursuant to a contract with an owner of a working interest or unleased mineral interest, or to a voluntary pooling agreement or a compulsory pooling order heretofore entered by the division.</i></p> <p><i>If this well is a horizontal well, I further certify that this organization has received the consent of at least one lessee or owner of a working interest or unleased mineral interest in each tract (in the target pool or formation) in which any part of the well's completed interval will be located or obtained a compulsory pooling order from the division.</i></p>	<p>SURVEYOR CERTIFICATIONS</p> <p><i>I hereby certify that the well location shown on this plat was plotted from field notes of actual surveys made by me or under my supervision, and that the same is true and correct to the best of my belief.</i></p> <div style="text-align: right;">  <p><i>Chad Harcrow</i> 6/6/25</p> </div>	
Signature	Date	Signature and Seal of Professional Surveyor
	7/7/25	
Printed Name	Certificate Number	Date of Survey
Stan Wagner	17777	MAY 28, 2025
Email Address	W.O.#25-511	DRAWN BY: WN PAGE 1 OF 2

This grid represents a standard section. You may superimpose a non-standard section, or larger area, over this grid. Operators must outline the dedicated acreage in a red box, clearly show the well surface location and bottom hole location, if it is directionally drilled, with the dimensions from the section lines in the cardinal directions. If this is a horizontal wellbore show on this plat the location of the First Take Point and Last Take Point, and the point within the Completed interval (other than the First Take Point or Last Take Point) that is closest to any outer boundary of the tract.

Surveyors shall use the latest United States government survey or dependent resurvey. Well locations will be in reference to the New Mexico Principal Meridian. If the land is not surveyed, contact the OCD Engineering Bureau. Independent subdivision surveys will not be acceptable.

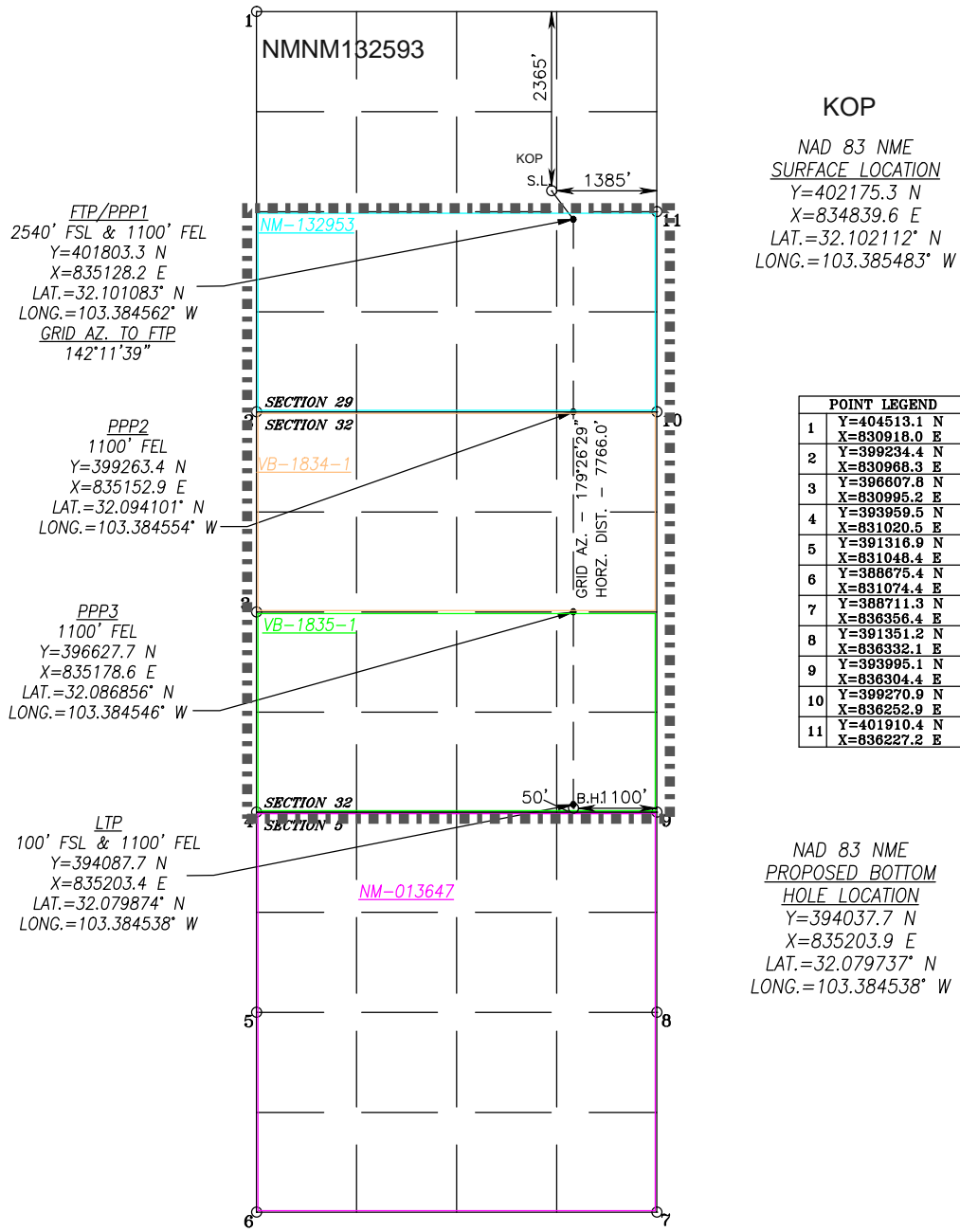

Boater Federal Com – Wolfcamp A

S2 of Section 29, All of Section 32, T25S-R35E, Lea County, NM

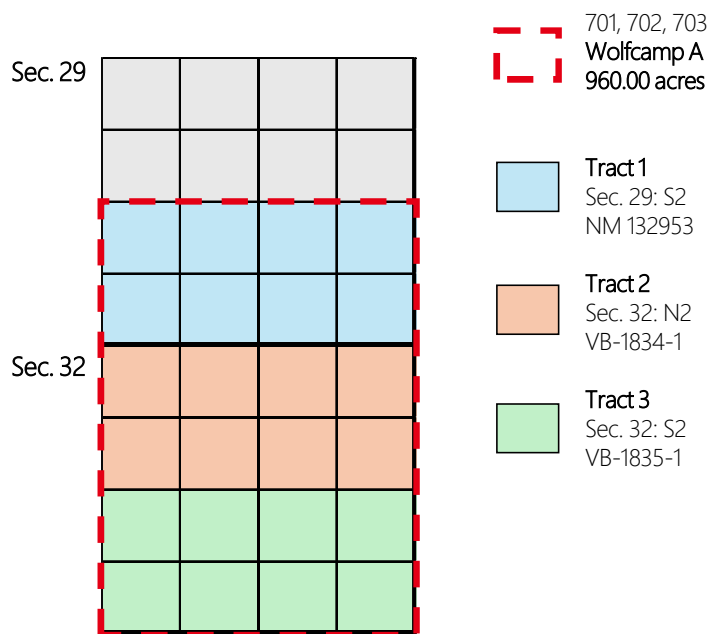

Tract 1 Ownership		
Record Title	COG OPERATING LLC	100.00%
Operating Rights/ Working Interest	COG OPERATING LLC	100.00%
Overriding Royalty Interest	MONGOOSE MINERALS LLC	12.50%

Boater Federal Com – Wolfcamp A

S2 of Section 29, All of Section 32, T25S-R35E, Lea County, NM

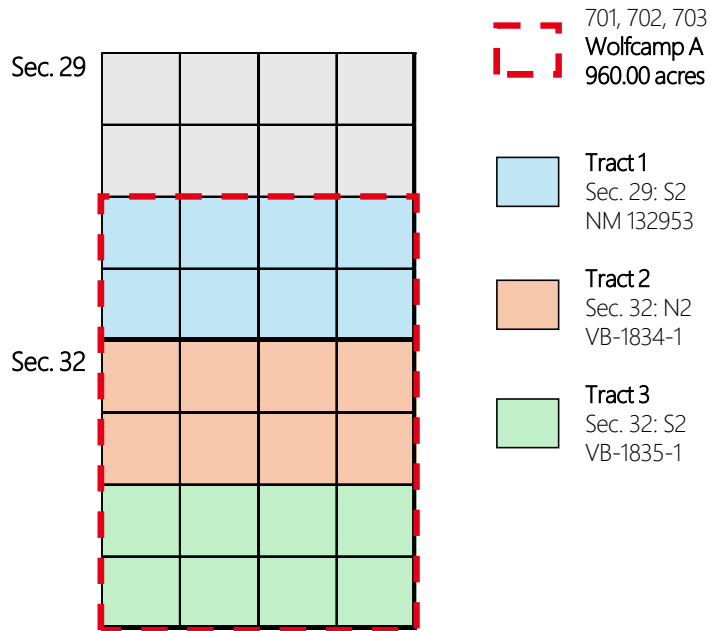

Tract 2 Ownership		
Record Title	EOG RESOURCES, INC.	100.00%
Operating Rights/ Working Interest	COG OPERATING LLC	80.00%
	OXY Y-1 COMPANY	20.00%
Overriding Royalty Interest	EOG RESOURCES, INC.	2.60%

Boater Federal Com – Wolfcamp A

S2 of Section 29, All of Section 32, T25S-R35E, Lea County, NM

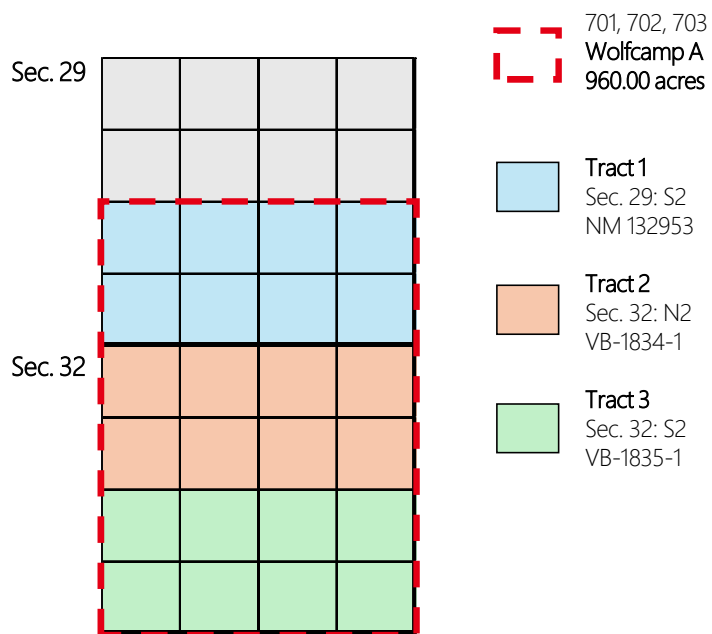

Tract 3 Ownership		
Record Title	EOG RESOURCES, INC.	100.00%
Operating Rights/ Working Interest	COG OPERATING LLC	80.00%
	OXY Y-1 COMPANY	20.00%
Overriding Royalty Interest	EOG RESOURCES, INC.	2.60%

Boater Federal Com – Wolfcamp A

S2 of Section 29, All of Section 32, T25S-R35E, Lea County, NM

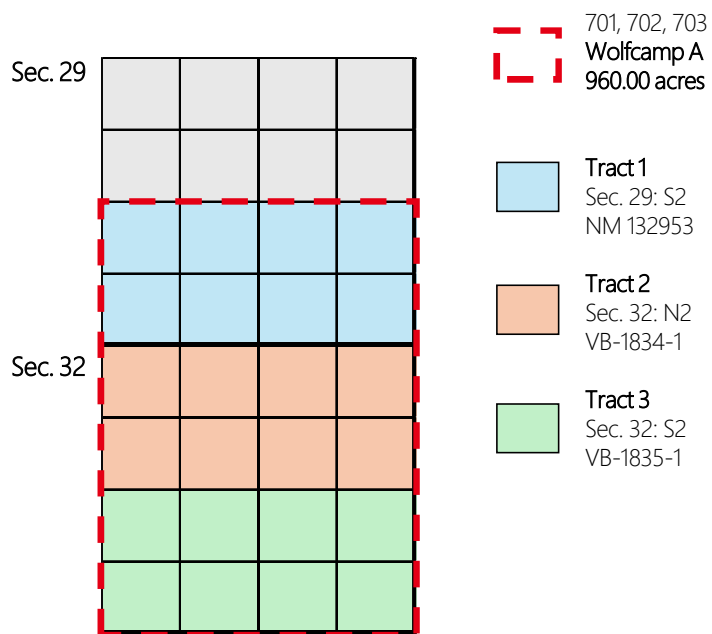

Unit Recapitulation ALL HIGHLIGHTED PARTIES ARE TO BE POOLED		
Record Title	EOG RESOURCES, INC.	100.00%
Operating Rights/ Working Interest	COG OPERATING LLC	70.766667%
	OXY Y-1 COMPANY	10.833333%
Overriding Royalty Interest	EOG RESOURCES, INC.	0.173333%
	MONGOOSE MINERALS LLC	4.166667%



Caroline Frederick
Associate Land Negotiator
 600 W. Illinois Ave.
 Midland, TX 79701

Via Federal Express

December 10, 2025

Working Interest Owners

Re: Well Proposal – Boater Federal Com – Wolfcamp A
Township 25 South – Range 35 East, N.M.P.M.
S2 of Section 29, All of Section 32
Lea County, New Mexico

Dear Interest Owner,

COG Operating LLC (“COG”), as Operator, hereby proposes to drill the following wells in the S2 of Section 29, All of Section 32, Township 25 South, Range 35 East, Lea County, New Mexico:

Well Name and Number	Boater Federal Com 701H
TVD	12,550’ (Wolfcamp A)
Surface hole location*	2,365’ FNL, 1,380’ FWL of Section 29
First take point*	2,540’ FSL, 1,430’ FWL of Section 29
Last take point*	100’ FSL, 1,430’ FWL of Section 32
Bottom hole location*	50’ FSL, 1,430’ FWL of Section 32
Estimated well cost	\$8,568,308.72, see attached Authority for Expenditure (“AFE”)

Well Name and Number	Boater Federal Com 702H
TVD	12,550’ (Wolfcamp A)
Surface hole location*	2,365’ FNL, 1,440’ FWL of Section 29
First take point*	2,540’ FSL, 2,450’ FEL of Section 29
Last take point*	100’ FSL, 2,450’ FEL of Section 32
Bottom hole location*	50’ FSL, 2,450’ FEL of Section 32
Estimated well cost	\$8,568,308.72, see attached Authority for Expenditure (“AFE”)

COG Operating LLC is a wholly owned subsidiary of ConocoPhillips

COG Operating LLC
Case No. 26084
Exhibit A-5

Well Name and Number	Boater Federal Com 703H
TVD	12,550' (Wolfcamp A)
Surface hole location*	2,365' FNL, 1,385' FEL of Section 29
First take point*	2,540' FSL, 1,100' FEL of Section 29
Last take point*	100' FSL, 1,100' FEL of Section 32
Bottom hole location*	50' FSL, 1,100' FEL of Section 32
Estimated well cost	\$8,568,308.72, see attached Authority for Expenditure ("AFE")

*Approximate location

COG proposes the wells under the terms of a new Operating Agreement which is included for your review and approval. The Operating Agreement has the following general provisions:

100%/300% Non-Consenting Penalty;
 \$19,134 Drilling and \$1,913 Producing Rate; and
 COG Operating LLC named as Operator

In the event you wish not to participate, COG would like to discuss the term assignment of your interest to COG. Please inform me if you are interested in a term assignment via email at caroline.frederick@conocophillips.com.

The Term Assignment offer terminates December 30th, 2025, and is subject to the approval of COG's management and verification of title.

If an agreement is not reached within 30 days of the date of this letter, COG will apply to the New Mexico Oil Conservation Division for compulsory pooling of your interest into horizontal spacing units for the proposed wells.

Please indicate your participation election in the space provided, sign, and return this letter, along with a signed copy of the enclosed AFE and fully executed signature pages to the JOA in the enclosed postage paid envelope.

If you have any questions, please do not hesitate to contact me at 432.222.4721 or by email at caroline.frederick@conocophillips.com.

Sincerely,

Caroline Frederick
 Associate Land Negotiator
 North Delaware Basin East

_____ I/We hereby elect to participate in the drilling and completion of the
BOATER FEDERAL COM 701H

_____ I/We hereby elect **not** to participate in the drilling and completion of the
BOATER FEDERAL COM 701H

_____ I/We hereby elect to participate in the drilling and completion of the
BOATER FEDERAL COM 702H

_____ I/We hereby elect **not** to participate in the drilling and completion of the
BOATER FEDERAL COM 702H

_____ I/We hereby elect to participate in the drilling and completion of the
BOATER FEDERAL COM 703H

_____ I/We hereby elect **not** to participate in the drilling and completion of the
BOATER FEDERAL COM 703H

By: _____
Name: _____
Title: _____
Date: _____



Caroline Frederick
Associate Land Negotiator
600 W. Illinois Ave.
Midland, TX 79701

Via Federal Express

December 10, 2025

Interest Owners

**Re: Ratification of Communitization Agreement –
Boater Federal Com – Wolfcamp A
Township 25 South – Range 35 East, N.M.P.M.
S2 of Section 29, All of Section 32
Lea County, New Mexico**

Dear Interest Owner,

Attached please find the subject Ratification of Communitization Agreement and one (1) copy of the referenced Communitization Agreement for your records. Please review and return the fully acknowledged Ratification(s) in the enclosed postage-paid envelope.

If you have any questions, please do not hesitate to contact me at 432.222.4721 or by email at caroline.frederick@conocophillips.com.

Sincerely,

Caroline Frederick

Caroline Frederick
Associate Land Negotiator
North Delaware Basin East



Caroline Frederick
Associate Land Negotiator
600 W. Illinois Ave.
Midland, TX 79701

Via Federal Express

December 9, 2025

Record Title Owners

**Re: Communitization Agreements –
Boater Federal Com – Wolfcamp A
Township 25 South – Range 35 East, N.M.P.M.
S2 of Section 29, All of Section 32
Lea County, New Mexico**

Dear Interest Owner,

Enclosed are one (1) copy of the referenced Communitization Agreements for your records and three (3) additional copies with signature pages with notary blocks for said Agreement. Within 30 days of receipt of the agreements, please execute and notarize the three additional copies with signature pages and return them in the enclosed envelope.

If you have any questions, please do not hesitate to contact me at 432.222.4721 or by email at caroline.frederick@conocophillips.com.

Sincerely,

Caroline Frederick
Associate Land Negotiator
North Delaware Basin East

**RATIFICATION OF COMMUNITIZATION AGREEMENT
BOATER FEDERAL COM – WOLFCAMP A**

STATE OF NEW MEXICO §
 §
COUNTY OF LEA §

COG Operating LLC, as Operator, executed a Communitization Agreement, effective as of the date therein, communitizing and combining the oil and gas leases set forth therein, insofar as they cover the communitized area for **Boater Federal Com** spacing and proration unit comprised of the S2 of Section 29, and ALL of Section 32, Township 25 South, Range 35 East, N.M.P.M., Lea County, New Mexico, as to the Wolfcamp A formation.

EOG Resources, Inc., whose address is **5509 Champions Drive, Midland, TX 79706**, is the owner of an overriding royalty interest located in a portion of the communitized area located in the S2 of Section 29, and ALL of Section 32, Township 25 South, Range 35 East, N.M.P.M., Lea County, New Mexico.

EOG Resources, Inc. to adopt, ratify and confirm the Communitization Agreement insofar as it covers the right, title and interest of *EOG Resources, Inc.* in and to the oil and gas leases and the lands included in the communitized area created by COG Operating LLC.

In consideration of the premises, *EOG Resources, Inc.* does hereby adopt, ratify and confirm the above-described Communitization Agreement insofar as it covers its right, title and interest in the oil and gas leases and the lands included in communitized area, and agrees that its interest is subject to all of the terms and provisions therein.

This Ratification is effective as of the effective date of the above-referenced Communitization Agreement.

EOG Resources, Inc.

Signature

By: _____
Printed Name

STATE OF _____ §
 §
COUNTY OF _____ §

The foregoing instrument was acknowledged before me on the _____ day of _____, 20____,
by _____.

NOTARY PUBLIC in and for the State of _____

Project Cost Summary

This document contains proposed and estimated project cost information which is proprietary and confidential to ConocoPhillips.



Well Name	Boater Federal Com 701H
Job Type	Drill and Complete (Wolfcamp)
State	New Mexico - 30
County/Parish	Lea - 025

Cost Feature Group	Total			
	Drilling	Completions	Equipment	Facilities
A210: TUBING			\$143,750.00	
B100: WELLHEAD & TREE			\$65,750.00	
C160: PACKERS & ACCESSORIES			\$25,000.00	
C200: SURFACE PRODUCTION EQUIPMENT			\$308,433.00	\$42,019.10
C220: SEPARATORS				\$193,623.71
C250: VALVES & FITTINGS FOR SURFACE EQUIPT				\$145,000.00
C255: METERING EQUIPMENT				\$17,578.00
C265: EMISSION REDUCING EQUIPMENT				\$75,843.22
C300: PIPELINES/ FLOWLINES				\$52,500.00
C440: DOWNHOLE GAS LIFT EQUIPMENT			\$30,000.00	
C460: ELECTRICAL SUMERSIBLE PUMP (ESP)			\$40,000.00	
C520: PRIME MOVERS, ENGINES AND MOTORS				\$5,177.78
C600: ELECTRICAL ACCESSORIES				\$64,444.44
C610: SURFACE ELECTRICAL EQUIPMENT				\$158,558.44
D110: RIGHT OF WAY				\$555.56
D200: LOCATION, ROADS, SURVEY, ETC			\$25,700.00	\$33,473.33
E100: WELLHEAD, XMAS TREE, AND ASSOCIATED EQUIPMENT	\$43,000.00	\$60,000.00		
E120: RIG COST- COMPLETION, WORKOVER SERVICE			\$16,000.00	
E600: TELECOMMUNICATION EQUIPMENT	\$23,800.00			
G300: COMPLETIONS FLUIDS & OTHER CHEMICALS			\$500.00	
M510: CONDUCTOR	\$32,000.00			
M521: CASING AND LINER- SURFACE 1	\$44,000.00			
M523: CASING AND LINER- INTERMEDIATE 1	\$336,000.00			
M531: CASING AND LINER- PRODUCTION 1	\$497,000.00			
M610: RIG SUPPLIES	\$8,400.00			
M620: BIT AND MILL	\$102,500.00			
M710: FUEL AND LUBRICANT	\$87,890.00	\$274,000.00		
M720: WATER	\$66,276.00	\$262,000.00		
M741: DRILLING FLUID AND CHEMICAL	\$222,384.00	\$25,000.00		
M742: COMPLETION FLUID AND CHEMICAL		\$173,000.00		
M770: STIMULATION PROPPANT AND GRAVEL		\$460,000.00		
O110: COMPANY PERSONNEL AND OVERHEAD	\$55,845.00	\$47,000.00		
O120: CONTRACT PERSONNEL AND OVERHEAD	\$31,450.00	\$84,000.00		
O320: FIELD OFFICE AND TRAILER	\$49,300.00			
O400: PERMIT, FEE AND LICENSE	\$42,500.00			
P100: LAND BASED TRANSPORT			\$22,700.00	\$8,333.33
Q300: DRILLING/COMPL SURFACE EQUIP RENTAL W/ OPER			\$4,000.00	
Q400: DRILLING/COMPL SURFACE EQUIP RENTAL W/O OPER			\$10,650.00	
Q410: FRAC TANK RENTAL			\$120.00	
S140: TESTING AND CERTIFICATION	\$20,000.00			
S160: ENVIRONMENTAL, HEALTH AND SAFETY SERVICE	\$97,465.00			
S210: DRILLING RIG	\$680,000.00			
S211: DRILLING RIG MOB/DEMOB	\$45,333.00			
S220: PIPE, TUBING, CASING RUNNING & HANDLING	\$55,836.00			
S230: DIRECTIONAL DRILLING, MWD/LWD, MOTOR	\$231,850.00			
S250: SOLID CONTROL	\$54,740.00			
S272: MUD LOGGING,GEOSTEERING, PVT	\$37,500.00			
S281: CEMENTING SERVICES	\$214,423.00			
S283: CEMENTING & CASING EQPT AND ACCESSORIES	\$80,000.00			
S300: TUBULAR RUNNING SERVICES			\$4,950.00	
S313: FRACTURE STIMULATION UNIT		\$781,000.00		
S317: COILED TUBBING		\$107,000.00		
S333: PERFORATING		\$239,000.00		
S412: LIQUID DISPOSAL	\$34,113.00	\$35,000.00		
S414: WATER HAULING		\$15,000.00		
S440: DST, PRODUCTION TESTING AND FLOWBACK		\$25,000.00		
S450: PUMP/KILL/PRESSURE/HOT OIL TRUCK		\$25,000.00		
S470: OTHER SPECIALIZED SERVICE	\$64,000.00	\$35,000.00		
S511: SITE PREPARATION AND ROAD WORK	\$30,333.00	\$20,000.00		
S710: LAND FREIGHT	\$113,059.00	\$45,000.00		
S820: DOWNHOLE DRILLING TOOLS & EQUIPT RENTAL	\$81,600.00	\$41,000.00		
S830: SURFACE DRILLING TOOLS & EQUIPT RENTAL	\$76,500.00			
S850: SURFACE COMP & WELL SVCS TOOLS & EQ RENTAL	\$20,400.00	\$257,000.00		
S860: WELLHEAD AND TREE RENTAL AND SERVICES	\$16,400.00			
S870: WELL AUXILIARY & SURFACE EQUIPT RENTAL		\$204,000.00		
S900: OTHER MISCELLANEOUS SERVICES & CONSUMABLES			\$31,950.00	
T110: WELLSITE CONTRACT LABOR & SUPERVISOR			\$16,800.00	
T250: TRAILER RENTALS, SANITARY, TRASH TRAILER			\$3,030.00	
U100: PERFORATING SERVICES			\$8,667.00	
V120: ENGINEERING DESIGN				\$8,333.33
VA00: OTHER SERVICE PRODUCTION / PROCESS EQUIPMENT				\$76,666.64
VB00: ELECTRICAL				\$63,222.22
VG00: CIVIL WORKS / BUILDING CONTRACTING				\$8,333.33
VR00: HOOK-UP / COMMISSIONING / DECOMM. SERVICES				\$2,777.78
W100: PERMITS, FEES, SURFACE DAMAGES				\$1,500.00
X110: PLANNER / SCHEDULER, STUDIES				\$2,666.67
X120: PROJECT LEADER				\$10,666.64
Y210: TANGIBLE - CONTINGENCY AND MISCELLANEOUS				\$29,138.21
Grand Total	\$3,595,897.00	\$3,214,000.00	\$758,000.00	\$1,000,411.72

Grand Total (\$) 8,568,308.72

Approved By:	_____	Date	_____
Last Edited By	 	Approved By	
Last Edited Date	December 2025	Approved Date	December 2025

Project Cost Summary

This document contains proposed and estimated project cost information which is proprietary and confidential to ConocoPhillips.



Well Name	Boater Federal Com 702H
Job Type	Drill and Complete (Wolfcamp)
State	New Mexico - 30
County/Parish	Lea - 025

Cost Feature Group	Total			
	Drilling	Completions	Equipment	Facilities
A210: TUBING			\$143,750.00	
B100: WELLHEAD & TREE			\$65,750.00	
C160: PACKERS & ACCESSORIES			\$25,000.00	
C200: SURFACE PRODUCTION EQUIPMENT			\$308,433.00	\$42,019.10
C220: SEPARATORS				\$193,623.71
C250: VALVES & FITTINGS FOR SURFACE EQUIPT				\$145,000.00
C255: METERING EQUIPMENT				\$17,578.00
C265: EMISSION REDUCING EQUIPMENT				\$75,843.22
C300: PIPELINES/ FLOWLINES				\$52,500.00
C440: DOWNHOLE GAS LIFT EQUIPMENT			\$30,000.00	
C460: ELECTRICAL SUMERSIBLE PUMP (ESP)			\$40,000.00	
C520: PRIME MOVERS, ENGINES AND MOTORS				\$5,177.78
C600: ELECTRICAL ACCESSORIES				\$64,444.44
C610: SURFACE ELECTRICAL EQUIPMENT				\$158,558.44
D110: RIGHT OF WAY				\$555.56
D200: LOCATION, ROADS, SURVEY, ETC			\$25,700.00	\$33,473.33
E100: WELLHEAD, XMAS TREE, AND ASSOCIATED EQUIPMENT	\$43,000.00	\$60,000.00		
E120: RIG COST- COMPLETION, WORKOVER SERVICE			\$16,000.00	
E600: TELECOMMUNICATION EQUIPMENT	\$23,800.00			
G300: COMPLETIONS FLUIDS & OTHER CHEMICALS			\$500.00	
M510: CONDUCTOR	\$32,000.00			
M521: CASING AND LINER- SURFACE 1	\$44,000.00			
M523: CASING AND LINER- INTERMEDIATE 1	\$336,000.00			
M531: CASING AND LINER- PRODUCTION 1	\$497,000.00			
M610: RIG SUPPLIES	\$8,400.00			
M620: BIT AND MILL	\$102,500.00			
M710: FUEL AND LUBRICANT	\$87,890.00	\$274,000.00		
M720: WATER	\$66,276.00	\$262,000.00		
M741: DRILLING FLUID AND CHEMICAL	\$222,384.00	\$25,000.00		
M742: COMPLETION FLUID AND CHEMICAL		\$173,000.00		
M770: STIMULATION PROPPANT AND GRAVEL		\$460,000.00		
O110: COMPANY PERSONNEL AND OVERHEAD	\$55,845.00	\$47,000.00		
O120: CONTRACT PERSONNEL AND OVERHEAD	\$31,450.00	\$84,000.00		
O320: FIELD OFFICE AND TRAILER	\$49,300.00			
O400: PERMIT, FEE AND LICENSE	\$42,500.00			
P100: LAND BASED TRANSPORT			\$22,700.00	\$8,333.33
Q300: DRILLING/COMPL SURFACE EQUIP RENTAL W/ OPER			\$4,000.00	
Q400: DRILLING/COMPL SURFACE EQUIP RENTAL W/O OPER			\$10,650.00	
Q410: FRAC TANK RENTAL			\$120.00	
S140: TESTING AND CERTIFICATION	\$20,000.00			
S160: ENVIRONMENTAL, HEALTH AND SAFETY SERVICE	\$97,465.00			
S210: DRILLING RIG	\$680,000.00			
S211: DRILLING RIG MOB/DEMOB	\$45,333.00			
S220: PIPE, TUBING, CASING RUNNING & HANDLING	\$55,836.00			
S230: DIRECTIONAL DRILLING, MWD/LWD, MOTOR	\$231,850.00			
S250: SOLID CONTROL	\$54,740.00			
S272: MUD LOGGING,GEOSTEERING, PVT	\$37,500.00			
S281: CEMENTING SERVICES	\$214,423.00			
S283: CEMENTING & CASING EQPT AND ACCESSORIES	\$80,000.00			
S300: TUBULAR RUNNING SERVICES			\$4,950.00	
S313: FRACTURE STIMULATION UNIT		\$781,000.00		
S317: COILED TUBBING		\$107,000.00		
S333: PERFORATING		\$239,000.00		
S412: LIQUID DISPOSAL	\$34,113.00	\$35,000.00		
S414: WATER HAULING		\$15,000.00		
S440: DST, PRODUCTION TESTING AND FLOWBACK		\$25,000.00		
S450: PUMP/KILL/PRESSURE/HOT OIL TRUCK		\$25,000.00		
S470: OTHER SPECIALIZED SERVICE	\$64,000.00	\$35,000.00		
S511: SITE PREPARATION AND ROAD WORK	\$30,333.00	\$20,000.00		
S710: LAND FREIGHT	\$113,059.00	\$45,000.00		
S820: DOWNHOLE DRILLING TOOLS & EQUIPT RENTAL	\$81,600.00	\$41,000.00		
S830: SURFACE DRILLING TOOLS & EQUIPT RENTAL	\$76,500.00			
S850: SURFACE COMP & WELL SVCS TOOLS & EQ RENTAL	\$20,400.00	\$257,000.00		
S860: WELLHEAD AND TREE RENTAL AND SERVICES	\$16,400.00			
S870: WELL AUXILIARY & SURFACE EQUIPT RENTAL		\$204,000.00		
S900: OTHER MISCELLANEOUS SERVICES & CONSUMABLES			\$31,950.00	
T110: WELLSITE CONTRACT LABOR & SUPERVISOR			\$16,800.00	
T250: TRAILER RENTALS, SANITARY, TRASH TRAILER			\$3,030.00	
U100: PERFORATING SERVICES			\$8,667.00	
V120: ENGINEERING DESIGN				\$8,333.33
VA00: OTHER SERVICE PRODUCTION / PROCESS EQUIPMENT				\$76,666.64
VB00: ELECTRICAL				\$63,222.22
VG00: CIVIL WORKS / BUILDING CONTRACTING				\$8,333.33
VR00: HOOK-UP / COMMISSIONING / DECOMM. SERVICES				\$2,777.78
W100: PERMITS, FEES, SURFACE DAMAGES				\$1,500.00
X110: PLANNER / SCHEDULER, STUDIES				\$2,666.67
X120: PROJECT LEADER				\$10,666.64
Y210: TANGIBLE - CONTINGENCY AND MISCELLANEOUS				\$29,138.21
Grand Total	\$3,595,897.00	\$3,214,000.00	\$758,000.00	\$1,000,411.72

Grand Total (\$) 8,568,308.72

Approved By: _____

Date _____

Last Edited By _____
 Last Edited Date December 2025

Approved By _____
 Approved Date December 2025

Project Cost Summary

This document contains proposed and estimated project cost information which is proprietary and confidential to ConocoPhillips.



Well Name	Boater Federal Com 703H
Job Type	Drill and Complete (Wolfcamp)
State	New Mexico - 30
County/Parish	Lea - 025

Cost Feature Group	Total			
	Drilling	Completions	Equipment	Facilities
A210: TUBING			\$143,750.00	
B100: WELLHEAD & TREE			\$65,750.00	
C160: PACKERS & ACCESSORIES			\$25,000.00	
C200: SURFACE PRODUCTION EQUIPMENT			\$308,433.00	\$42,019.10
C220: SEPARATORS				\$193,623.71
C250: VALVES & FITTINGS FOR SURFACE EQUIPT				\$145,000.00
C255: METERING EQUIPMENT				\$17,578.00
C265: EMISSION REDUCING EQUIPMENT				\$75,843.22
C300: PIPELINES/ FLOWLINES				\$52,500.00
C440: DOWNHOLE GAS LIFT EQUIPMENT			\$30,000.00	
C460: ELECTRICAL SUMERSIBLE PUMP (ESP)			\$40,000.00	
C520: PRIME MOVERS, ENGINES AND MOTORS				\$5,177.78
C600: ELECTRICAL ACCESSORIES				\$64,444.44
C610: SURFACE ELECTRICAL EQUIPMENT				\$158,558.44
D110: RIGHT OF WAY				\$555.56
D200: LOCATION, ROADS, SURVEY, ETC			\$25,700.00	\$33,473.33
E100: WELLHEAD, XMAS TREE, AND ASSOCIATED EQUIPMENT	\$43,000.00	\$60,000.00		
E120: RIG COST- COMPLETION, WORKOVER SERVICE			\$16,000.00	
E600: TELECOMMUNICATION EQUIPMENT	\$23,800.00			
G300: COMPLETIONS FLUIDS & OTHER CHEMICALS			\$500.00	
M510: CONDUCTOR	\$32,000.00			
M521: CASING AND LINER- SURFACE 1	\$44,000.00			
M523: CASING AND LINER- INTERMEDIATE 1	\$336,000.00			
M531: CASING AND LINER- PRODUCTION 1	\$497,000.00			
M610: RIG SUPPLIES	\$8,400.00			
M620: BIT AND MILL	\$102,500.00			
M710: FUEL AND LUBRICANT	\$87,890.00	\$274,000.00		
M720: WATER	\$66,276.00	\$262,000.00		
M741: DRILLING FLUID AND CHEMICAL	\$222,384.00	\$25,000.00		
M742: COMPLETION FLUID AND CHEMICAL		\$173,000.00		
M770: STIMULATION PROPPANT AND GRAVEL		\$460,000.00		
O110: COMPANY PERSONNEL AND OVERHEAD	\$55,845.00	\$47,000.00		
O120: CONTRACT PERSONNEL AND OVERHEAD	\$31,450.00	\$84,000.00		
O320: FIELD OFFICE AND TRAILER	\$49,300.00			
O400: PERMIT, FEE AND LICENSE	\$42,500.00			
P100: LAND BASED TRANSPORT			\$22,700.00	\$8,333.33
Q300: DRILLING/COMPL SURFACE EQUIP RENTAL W/ OPER			\$4,000.00	
Q400: DRILLING/COMPL SURFACE EQUIP RENTAL W/O OPER			\$10,650.00	
Q410: FRAC TANK RENTAL			\$120.00	
S140: TESTING AND CERTIFICATION	\$20,000.00			
S160: ENVIRONMENTAL, HEALTH AND SAFETY SERVICE	\$97,465.00			
S210: DRILLING RIG	\$680,000.00			
S211: DRILLING RIG MOB/DEMOB	\$45,333.00			
S220: PIPE, TUBING, CASING RUNNING & HANDLING	\$55,836.00			
S230: DIRECTIONAL DRILLING, MWD/LWD, MOTOR	\$231,850.00			
S250: SOLID CONTROL	\$54,740.00			
S272: MUD LOGGING,GEOSTEERING, PVT	\$37,500.00			
S281: CEMENTING SERVICES	\$214,423.00			
S283: CEMENTING & CASING EQPT AND ACCESSORIES	\$80,000.00			
S300: TUBULAR RUNNING SERVICES			\$4,950.00	
S313: FRACTURE STIMULATION UNIT		\$781,000.00		
S317: COILED TUBBING		\$107,000.00		
S333: PERFORATING		\$239,000.00		
S412: LIQUID DISPOSAL	\$34,113.00	\$35,000.00		
S414: WATER HAULING		\$15,000.00		
S440: DST, PRODUCTION TESTING AND FLOWBACK		\$25,000.00		
S450: PUMP/KILL/PRESSURE/HOT OIL TRUCK		\$25,000.00		
S470: OTHER SPECIALIZED SERVICE	\$64,000.00	\$35,000.00		
S511: SITE PREPARATION AND ROAD WORK	\$30,333.00	\$20,000.00		
S710: LAND FREIGHT	\$113,059.00	\$45,000.00		
S820: DOWNHOLE DRILLING TOOLS & EQUIPT RENTAL	\$81,600.00	\$41,000.00		
S830: SURFACE DRILLING TOOLS & EQUIPT RENTAL	\$76,500.00			
S850: SURFACE COMP & WELL SVCS TOOLS & EQ RENTAL	\$20,400.00	\$257,000.00		
S860: WELLHEAD AND TREE RENTAL AND SERVICES	\$16,400.00			
S870: WELL AUXILIARY & SURFACE EQUIPT RENTAL		\$204,000.00		
S900: OTHER MISCELLANEOUS SERVICES & CONSUMABLES			\$31,950.00	
T110: WELLSITE CONTRACT LABOR & SUPERVISOR			\$16,800.00	
T250: TRAILER RENTALS, SANITARY, TRASH TRAILER			\$3,030.00	
U100: PERFORATING SERVICES			\$8,667.00	
V120: ENGINEERING DESIGN				\$8,333.33
VA00: OTHER SERVICE PRODUCTION / PROCESS EQUIPMENT				\$76,666.64
VB00: ELECTRICAL				\$63,222.22
VG00: CIVIL WORKS / BUILDING CONTRACTING				\$8,333.33
VR00: HOOK-UP / COMMISSIONING / DECOMM. SERVICES				\$2,777.78
W100: PERMITS, FEES, SURFACE DAMAGES				\$1,500.00
X110: PLANNER / SCHEDULER, STUDIES				\$2,666.67
X120: PROJECT LEADER				\$10,666.64
Y210: TANGIBLE - CONTINGENCY AND MISCELLANEOUS				\$29,138.21
Grand Total	\$3,595,897.00	\$3,214,000.00	\$758,000.00	\$1,000,411.72

Grand Total (\$) 8,568,308.72

Approved By: _____

Date _____

Last Edited By _____
Last Edited Date December 2025

Approved By _____
Approved Date December 2025

Boater Federal Com – Chronology of Contacts

S2 of Section 29, All of Section 32, T25S-R35E, Lea County, NM



PARTY	INTEREST	ADDRESS	MAILED	ADDITIONAL COMMUNICATION
OXY Y-1 COMPANY	WI	5 GREENWAY PLAZA SUITE 110 HOUSTON, TX 77046	12/10/2025	Email communication with Oxy from 12/16/2025-1/13/2026, 1/21/2026-4/8/2026 regarding JOA negotiations. Sent legal description correction on 4/13/2026.
EOG RESOURCES, INC.	RT/ORRI	5509 CHAMPIONS DRIVE MIDLAND, TX 79706	12/10/2025	Email communication with EOG from 3/20/2026-4/8/2026 regarding record title.

Case No. 26084 - COG: Boater Federal Com 701H, 702H & 703H Wells

Owner Name	Ownership Status (Committed or Uncommitted)	Type of Commitment (JOA, Signed Letter of Commitment, or Verbal Agreement)
EOG Resources, Inc. (RT)	Uncommitted	N/A
OXY Y-1 Company (WI)	Uncommitted	N/A
EOG Resources, Inc. (ORRI)	Uncommitted	N/A
Mongoose Minerals LLC (ORRI)	Committed	COG Operating LLC & Mongoose Minerals LLC are subsidiaries of ConocoPhillips

COG Operating LLC
Case No. 26084
Exhibit A-7

**STATE OF NEW MEXICO
DEPARTMENT OF ENERGY, MINERALS AND NATURAL RESOURCES
OIL CONSERVATION DIVISION**

**APPLICATION OF COG OPERATING LLC
FOR COMPULSORY POOLING AND APPROVAL
OF NON-STANDARD SPACING UNIT,
LEA COUNTY, NEW MEXICO.**

CASE NO. 26084

**SELF-AFFIRMED STATEMENT
OF TYLER PATRICK**

1. I am a geologist with COG Operating LLC (“COG”). I am over 18 years of age, have personal knowledge of the matters addressed herein, and am competent to provide this Self-Affirmed Statement. I have previously testified before the New Mexico Oil Conservation Division (“Division”), and my credentials as an expert in petroleum geology were accepted and made a matter of record.

2. I am familiar with the geological matters that pertain to the application filed by COG in this case.

3. **Exhibit B-1** is a location map that identifies the Boater project area for the Wolfcamp A horizontal spacing unit that is the subject of this application. The map shows the approximate wellbore paths for the proposed **Boater Federal Com 701H, Boater Federal Com 702H** and **Boater Federal Com 703H** wells (“Boater Federal Com Wells”). The Boater Federal Com Wells are represented by pink dashed lines. This map also shows existing horizontal wells in the surrounding sections that are completed in the Wolfcamp formation; horizontal wells completed in the Wolfcamp A are shown in solid red lines.

4. **Exhibit B-2** is a subsea structure map that I prepared for the Wolfcamp A formation. The contour interval is 50 feet and data points used to construct the map are indicated as black well symbols. The proposed wells are depicted as described for Exhibit B-1. The structure

**COG Operating LLC
Case No. 26084
Exhibit B**

map shows the targeted formation gently dipping to the south. The structure appears consistent across the proposed spacing unit, and I do not observe any faulting, pinch outs, or other geologic impediments to drilling horizontal wells.

5. **Exhibit B-3** is a cross-section map that identifies two wells penetrating the targeted intervals used to construct a stratigraphic cross-section from A to A'. I chose the logs from these wells to create the cross-section because they penetrate the targeted intervals, are of good quality and have been subjected to petrophysical analysis of the targeted intervals. In my opinion, these well logs are representative of the geology in the subject area.

6. **Exhibit B-4** is a stratigraphic cross-section using the representative wells identified on Exhibit B-3. It contains gamma ray, resistivity and porosity logs. The proposed landing zones for the Wells are labeled on the exhibit. This cross-section demonstrates the target intervals are continuous across the Unit.

7. In my opinion, a stand-up orientation for the Wells is appropriate to properly develop the subject acreage because of consistent rock properties throughout the Unit and the preferred fracture orientation in the project area. Stand-up orientation is also consistent with the adjacent existing horizontal development.

8. Based on my geologic study of the area, the targeted interval underlying the Unit is suitable for development by horizontal wells and the tracts comprising the Unit will contribute more or less equally to the production of the Wells.

9. In my opinion, the granting of COG's application will serve the interests of conservation, the protection of correlative rights, and the prevention of waste.

10. The exhibits attached hereto were either prepared by me or under my supervision or were compiled from company business records.

11. I understand this Self-Affirmed Statement will be used as written testimony in this case. I affirm my testimony above is true and correct and is made under penalty of perjury under the laws of the State of New Mexico. My testimony is made as of the date identified next to my signature below.



TYLER PATRICK

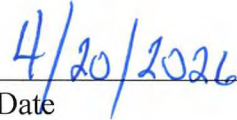





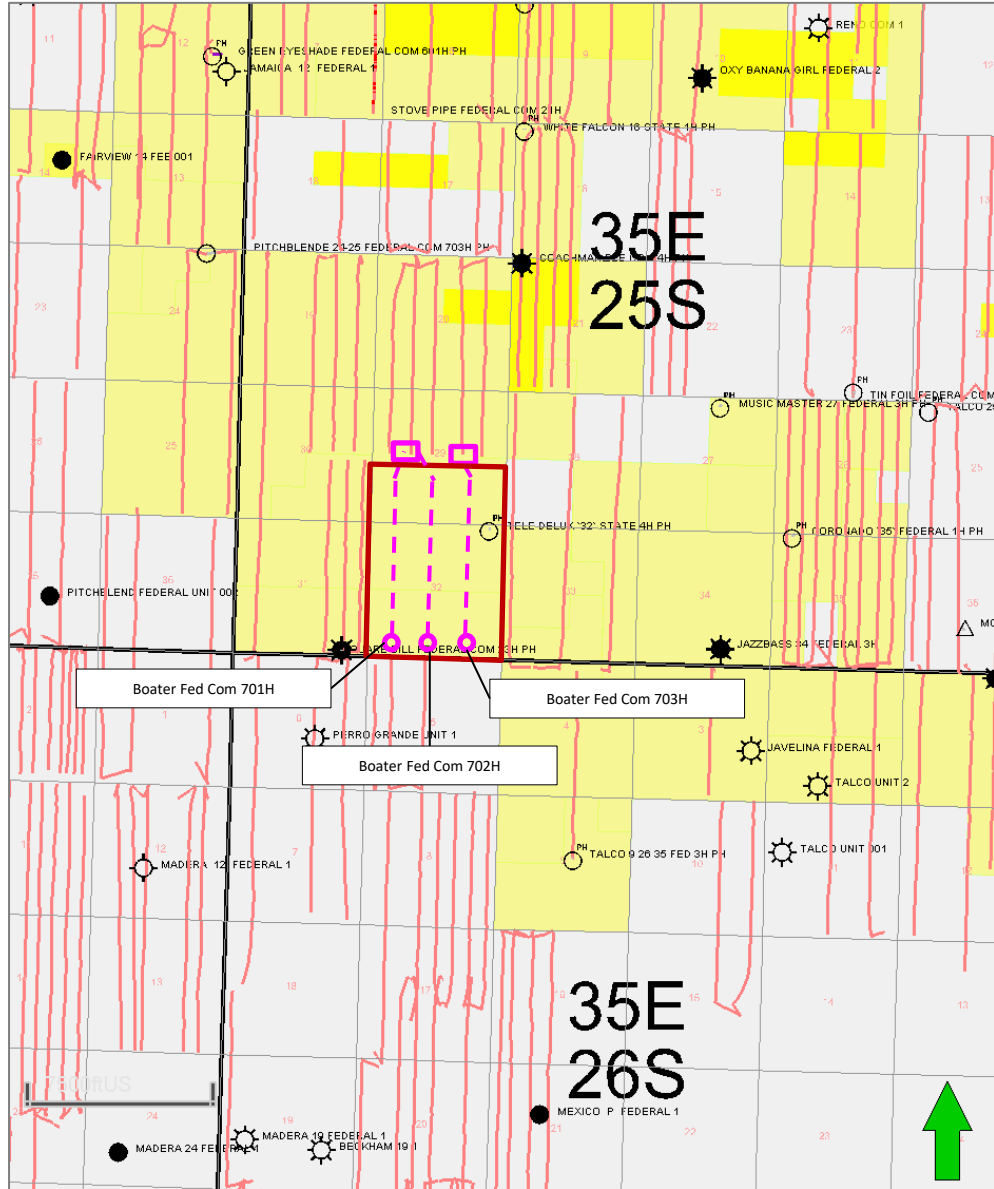

Date

Boater Federal Com (Wolfcamp) 701H, 702H, & 703H



Map Legend

-   COG - Wolfcamp Horizontal Location
-   COG - Wolfcamp Horizontal Location
-  Producing Wolfcamp Wells
-  COG Acreage

COG Operating LLC
 Case No. 26084
 Exhibit B-1

Boater Federal Com (Wolfcamp) 701H, 702H, & 703H

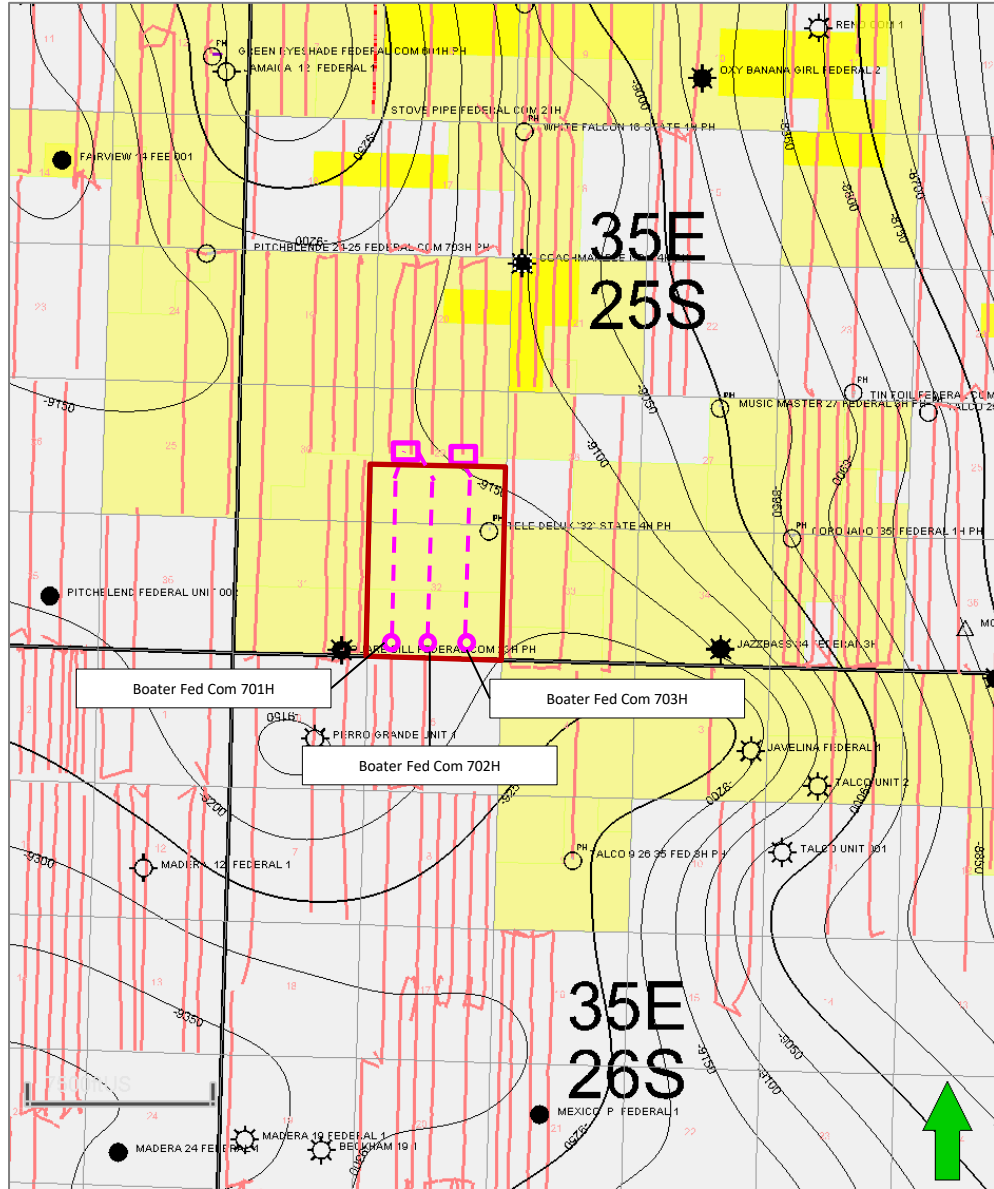

Map Legend





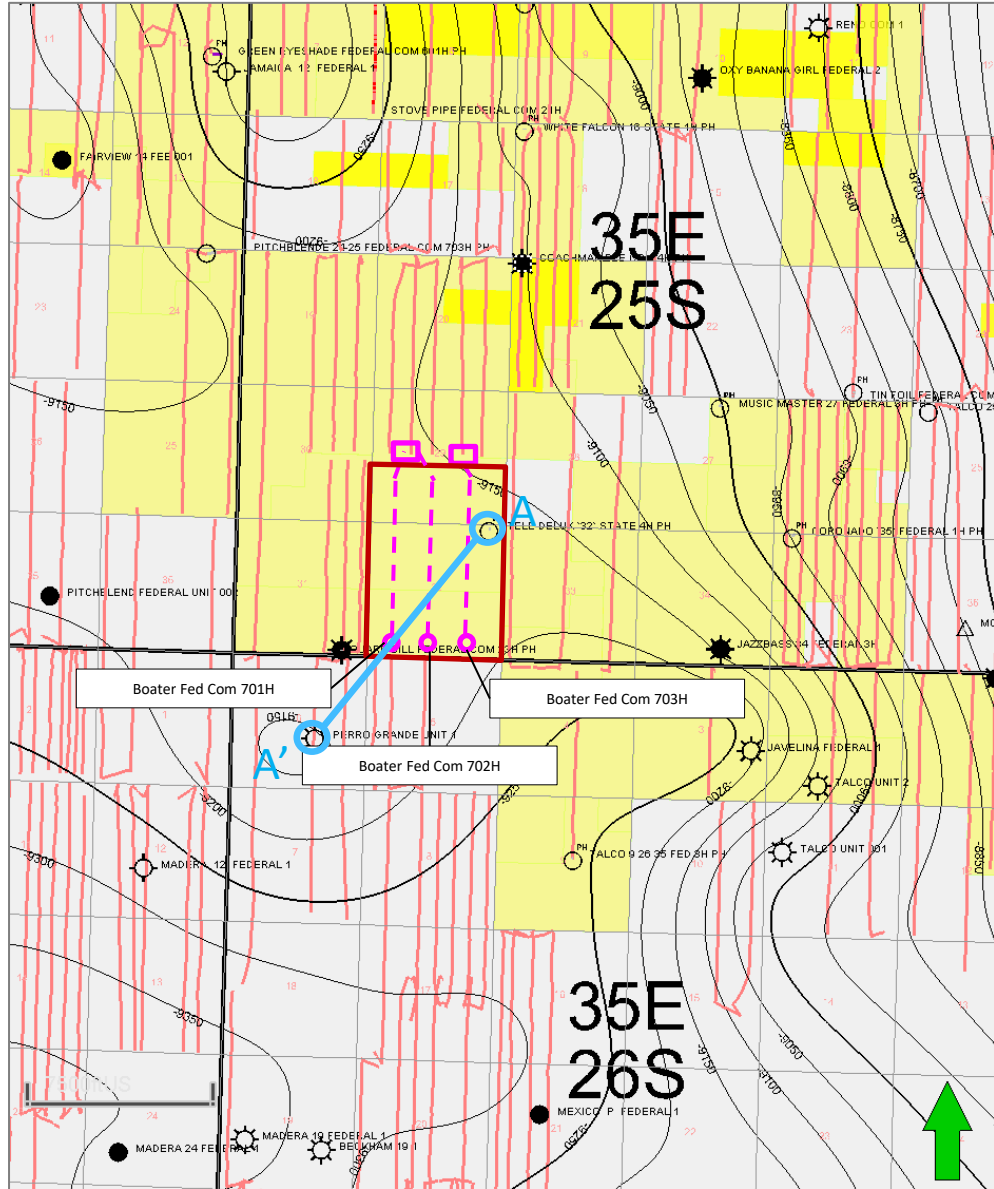

- SHL COG - Wolfcamp Horizontal Location
- BHL
- Producing Wolfcamp Wells
- Wolfcamp Structure
CI: 50'
- COG Acreage

COG Operating LLC
Case No. 26084
Exhibit B-2

Boater Federal Com (Wolfcamp) 701H, 702H, & 703H



Map Legend

-   COG - Wolfcamp Horizontal Location
-  Producing Wolfcamp Wells
-  Wolfcamp Structure
CI: 50'
-  COG Acreage
-  Cross Section Line

COG Operating LLC
Case No. 26084
Exhibit B-3

Boater Federal Com Section A-A'

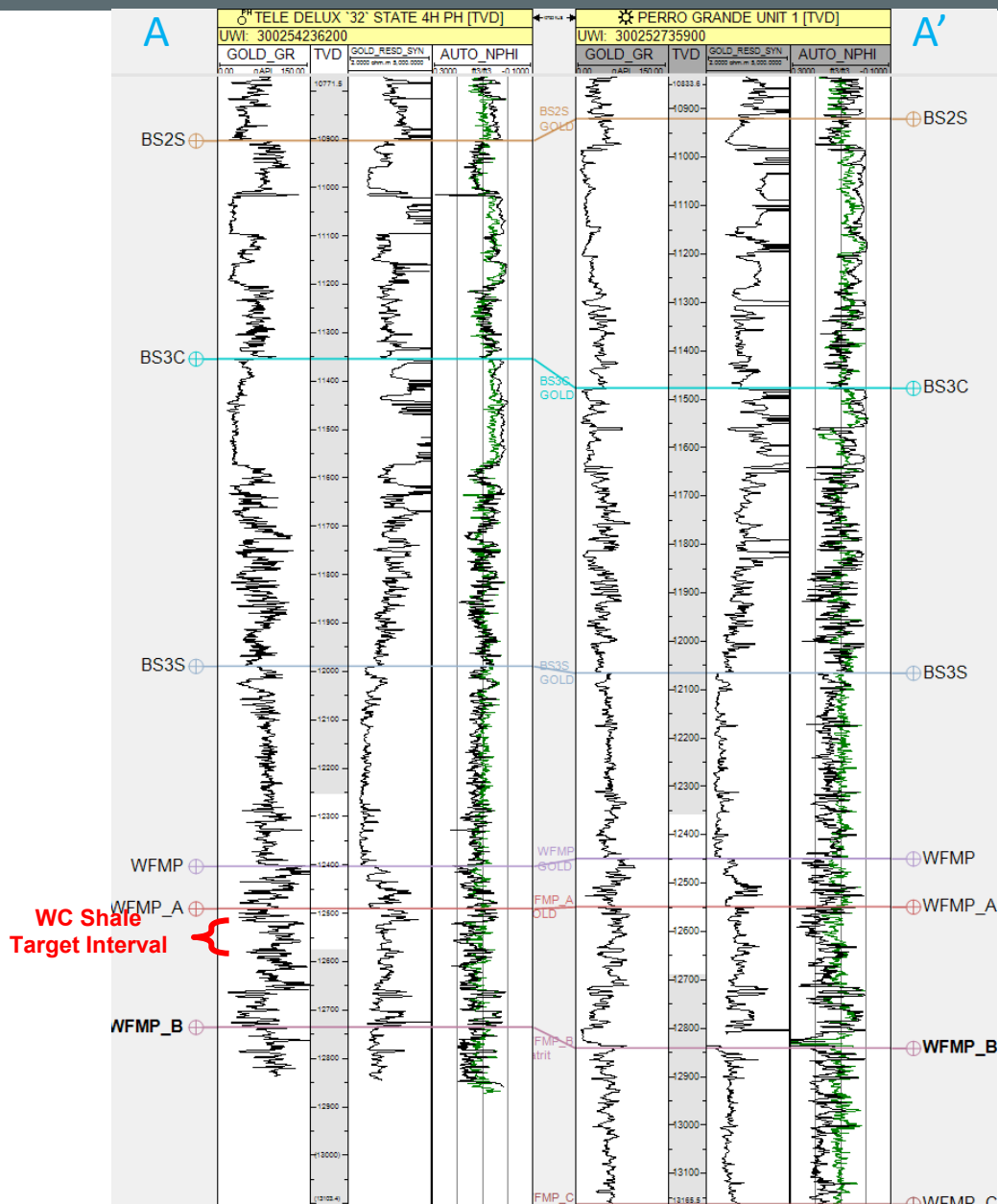

COG Operating LLC
 Case No. 26084
 Exhibit B-4

STATE OF NEW MEXICO
DEPARTMENT OF ENERGY, MINERALS AND NATURAL RESOURCES
OIL CONSERVATION DIVISION

APPLICATION OF COG OPERATING LLC FOR
COMPULSORY POOLING AND APPROVAL OF
NON-STANDARD SPACING UNIT,
LEA COUNTY, NEW MEXICO.

CASE NO. 26084

SELF-AFFIRMED STATEMENT
OF JACLYN M. MCLEAN

1. I am attorney in fact and authorized representative of COG Operating LLC the Applicant herein.

2. I am familiar with the Notice Letters attached as **Exhibit C-1**, and caused the Notice Letters, along with the Application in this case, to be sent to the parties listed in the Postal Delivery Report attached as **Exhibit C-2**.

3. Exhibit C-2 also provides the date the Notice Letters were sent, along with the delivery status of each.

4. Electronic return receipts are attached as **Exhibit C-3** as supporting documentation for proof of mailing and the information provided on Exhibit C-2.

5. On April 21, 2026, I caused a notice to be published in the Hobbs News-Sun. An Affidavit of Publication from the legal clerk of the Hobbs News-Sun along with a copy of the Notice Publication, is attached as **Exhibit C-4**.

6. I understand this Self-Affirmed Statement will be used as written testimony in the subject case. I affirm that my testimony above is true and correct and is made under penalty of perjury under the laws of the State of New Mexico. My testimony is made as of the date handwritten next to my signature below.

/s/Jaclyn M. McLean
Jaclyn M. McLean

April 29, 2026
Date

COG Operating LLC
Case No. 26084
Exhibit C



April 8, 2026

VIA CERTIFIED MAIL
RETURN RECEIPT REQUESTED

TO: ALL PARTIES ENTITLED TO NOTICE

Re: Case No. 26084 - Application of COG Operating, LLC for Compulsory Pooling and Approval Of a Non-Standard Spacing Unit, Lea County, New Mexico.

To whom it may concern:

This letter is to advise you that the enclosed application was filed with the New Mexico Oil Conservation Division. The hearing will be conducted on **May 07, 2026**, beginning at 9:00 a.m.

The hearing will be conducted in a hybrid fashion, both virtually and in-person at the Energy, Minerals, Natural Resources Department, Wendell Chino Building, Pecos Hall, 1220 South St. Francis Drive, 1st Floor, Santa Fe, NM 87505. The hearing may be held only virtually at the discretion of the Division. To confirm the manner in which the hearing will be held, and to participate virtually, please visit the OCD Hearings website at the following link: <https://www.emnrd.nm.gov/ocd/hearing-info/>. You are not required to attend this hearing, but as an owner of an interest that may be affected by these applications, you may appear and present testimony. Failure to appear at that time and become a party of record will preclude you from challenging the matter at a later date.

Pursuant to Division Rule 19.15.4.13.B, a party who intends to present evidence at the hearing shall file a pre-hearing statement and serve copies on other parties, or the attorneys of parties who are represented by counsel, at least four business days prior to the scheduled hearing, but in no event later than 5:00 p.m. Mountain Time, on the Thursday preceding the scheduled hearing date. If you are not registered with the OCD's E-Permitting system, you must submit the statement via e-mail to ocd.hearings@emnrd.nm.gov and should include: the names of the parties; whether or not the parties are represented by counsel; a concise statement of the case; the names of witnesses anticipated to be called to testify at the hearing; the approximate amount of time needed to present the case; and an identification of any procedural matters that are to be resolved prior to the hearing.

If you have any questions about this application, please contact Caroline Frederick, Landman for COG Operating, LLC at caroline.frederick@conocophillips.com.

Sincerely,
/s/ Jaclyn M. McLean
Jaclyn M. McLean

125 Lincoln Avenue, Suite 223
Santa Fe, NM 87501
505-230-4410

HardyMcClean.com

Writer:
Jaclyn M. McLean
Managing Partner
jmclean@hardymcClean.com



April 15, 2026

VIA CERTIFIED MAIL
RETURN RECEIPT REQUESTED

TO: ALL AFFECTED PARTIES – NOTICE OF APPLICATION FOR NON-STANDARD SPACING UNIT

Re: Case Nos. 26084 & 26086 - Applications of COG Operating, LLC for Compulsory Pooling and Approval of a Non-Standard Spacing Unit Lea County, New Mexico.

To whom it may concern:

This letter is to advise you that the enclosed applications were filed with the New Mexico Oil Conservation Division. You are receiving this notice because you are an affected party for the purposes of the non-standard spacing unit. The hearing will be conducted on **May 7, 2026**, beginning at 9:00 a.m.

The hearing will be conducted in a hybrid fashion, both virtually and in-person at the Energy, Minerals, Natural Resources Department, Wendell Chino Building, Pecos Hall, 1220 South St. Francis Drive, 1st Floor, Santa Fe, NM 87505. The hearing may be held only virtually at the discretion of the Division. To confirm the manner in which the hearing will be held, and to participate virtually, please visit the OCD Hearings website at the following link: <https://www.emnrd.nm.gov/ocd/hearing-info/>. You are not required to attend this hearing, but as an owner of an interest that may be affected by these applications, you may appear and present testimony. Failure to appear at that time and become a party of record will preclude you from challenging the matter at a later date.

Pursuant to Division Rule 19.15.4.13.B, a party who intends to present evidence at the hearing shall file a pre-hearing statement and serve copies on other parties, or the attorneys of parties who are represented by counsel, at least four business days prior to the scheduled hearing, but in no event later than 5:00 p.m. Mountain Time, on the Thursday preceding the scheduled hearing date. If you are not registered with the OCD’s E-Permitting system, you must submit the statement via e-mail to ocd.hearings@emnrd.nm.gov and should include: the names of the parties; whether or not the parties are represented by counsel; a concise statement of the case; the names of witnesses anticipated to be called to testify at the hearing; the approximate amount of time needed to present the case; and an identification of any procedural matters that are to be resolved prior to the hearing.

If you have any questions about these applications, please contact Caroline Frederick, Landman for COG Operating, LLC at Caroline.Frederick@conocophillips.com or 432-222-4721.

Sincerely,
/s/ Jaclyn M. McLean
Jaclyn M. McLean

125 Lincoln Avenue, Suite 223
Santa Fe, NM 87501
505-230-4410

HardyMcClean.com

Writer:
Jaclyn M. McLean
Managing Partner
jmclean@hardymclean.com

**Postal Delivery Report
COG Boater - Case No. 26084**

Recipient	Date Mailed	USPS Tracking Number	Date Received	Status
Oxy Y-1 Company	4/8/2026	9414836208551298484005	4/11/2026	DELIVERED TO AGENT PICKED UP AT USPS
EOG Resources INC	4/8/2026	9414836208551298484067	4/11/2026	DELIVERED TO AGENT PICKED UP AT USPS MIDLAND, TX 79706

**Postal Delivery Report
COG Boater - Case No. 26084
Non-Standard Spacing Unit**

Recipient	Date Mailed	USPS Tracking Number	Date Received	Status
United States of America Bureau	4/15/2026	9414836208551299043751	4/17/2026	DELIVERED FRONT DESK/RECEPTI ON/MAIL ROOM SANTA FE, NM 87508

Commissioner of Public Lands	4/15/2026	9414836208551299043850	4/20/2026	DELIVERED INDIVIDUAL PICKED UP AT PO SANTA FE, NM 87501
United Exploration	4/15/2026	9414836208551299043898	N/A	FORWARDED
Beverly Jean Renfro Barr	4/15/2026	9414836208551299045007	4/20/2026	DELIVERED LEFT WITH INDIVIDUAL SOUTHLAKE, TX 76092
Chevron USA Inc	4/15/2026	9414836208551299045052	4/20/2026	DELIVERED LEFT WITH INDIVIDUAL MIDLAND, TX 79706
Devon Energy Co LP	4/15/2026	9414836208551299045090	4/22/2026	DELIVERED INDIVIDUAL PICKED UP AT PO OKLAHOMA CITY, OK 73102
Endurance Properties Inc	4/15/2026	9414836208551299045144	N/A	ADDRESSEE UNKNOWN

Occidental Permian LP	4/15/2026	9414836208551299045151	4/18/2026	DELIVERED TO AGENT FRONT DESK/MAIL ROOM HOUSTON, TX 77046
Pintail Production Company	4/15/2026	9414836208551299045274	4/18/2026	DELIVERED LEFT WITH INDIVIDUAL FORT WORTH, TX 76132



April 18, 2026

Dear Simple Certified:

The following is in response to your request for proof of delivery on your item with the tracking number: **9414 8362 0855 1299 0437 51.**

Item Details

Status: Delivered, Front Desk/Reception/Mail Room
Status Date / Time: April 17, 2026, 11:38 am
Location: SANTA FE, NM 87508
Postal Product: First-Class Mail®
Extra Services: Certified Mail™
 Return Receipt Electronic
Recipient Name: UNITED STATES OF AMERICA BUREAU

Shipment Details

Weight: 2.0oz

Recipient Signature

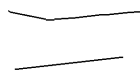
Signature of Recipient: 

Address of Recipient: 301 DINOSAUR TRL, SANTA FE,
NM 87508

Note: Scanned image may reflect a different destination address due to Intended Recipient's delivery instructions on file.

Thank you for selecting the United States Postal Service® for your mailing needs. If you require additional assistance, please contact your local Post Office™ or a Postal representative at 1-800-222-1811.

Sincerely,
United States Postal Service®
475 L'Enfant Plaza SW
Washington, D.C. 20260-0004

United States of America Bureau
 Of Land Management
 301 Dinosaur Trail
 Santa Fe , NM 87508
 Reference #: COG Boater NSP 26084 and 26086
 Item ID: COG Boater NSP 26084 and 26086

COG Operating LLC
Case No. 26084
Exhibit C-3



April 20, 2026

Dear Simple Certified:

The following is in response to your request for proof of delivery on your item with the tracking number: **9414 8362 0855 1299 0438 50**.

Item Details

Status: Delivered, Individual Picked Up at Post Office
Status Date / Time: April 20, 2026, 4:55 am
Location: SANTA FE, NM 87501
Postal Product: First-Class Mail®
Extra Services: Certified Mail™
 Return Receipt Electronic
Recipient Name: COMMISSIONER OF PUBLIC LANDS

Shipment Details

Weight: 2.0oz

Recipient Signature

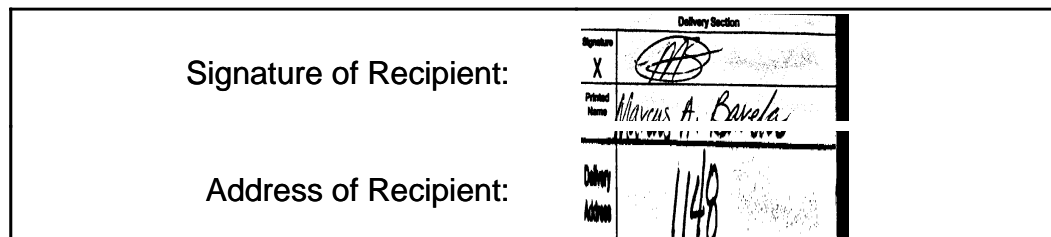

Note: Scanned image may reflect a different destination address due to Intended Recipient's delivery instructions on file.

Thank you for selecting the United States Postal Service® for your mailing needs. If you require additional assistance, please contact your local Post Office™ or a Postal representative at 1-800-222-1811.

Sincerely,
United States Postal Service®
475 L'Enfant Plaza SW
Washington, D.C. 20260-0004

Commissioner of Public Lands
 New Mexico State Land Office
 PO Box 1148
 Santa Fe, NM 87504
 Reference #: COG Boater NSP 26084 and 26086
 Item ID: COG Boater NSP 26084 and 26086



April 28, 2026

Dear Simple Certified:

The following is in response to your request for proof of delivery on your item with the tracking number: **9414 8362 0855 1299 0450 07.**

Item Details

Status: Delivered, Left with Individual
Status Date / Time: April 20, 2026, 1:55 pm
Location: SOUTHLAKE, TX 76092
Postal Product: First-Class Mail®
Extra Services: Certified Mail™
 Return Receipt Electronic
Recipient Name: BEVERLY JEAN RENFRO BARR

Shipment Details

Weight: 2.0oz

Recipient Signature

<p>Signature of Recipient:</p> <p>Address of Recipient:</p>	 804 PARK VISTA CIR, SOUTHLAKE, TX 76092
--	--

Note: Scanned image may reflect a different destination address due to Intended Recipient's delivery instructions on file.

Thank you for selecting the United States Postal Service® for your mailing needs. If you require additional assistance, please contact your local Post Office™ or a Postal representative at 1-800-222-1811.

Sincerely,
United States Postal Service®
475 L'Enfant Plaza SW
Washington, D.C. 20260-0004

Beverly Jean Renfro Barr Trustee 804 Park Vista Circle Southlake , TX 76092 Reference #: COG Boater NSP 26084 and 26086 Item ID: COG Boater NSP 26084 and 26086
--



April 28, 2026

Dear Simple Certified:

The following is in response to your request for proof of delivery on your item with the tracking number: **9414 8362 0855 1299 0450 52.**



Item Details

Status: Delivered, Left with Individual
Status Date / Time: April 20, 2026, 11:53 am
Location: MIDLAND, TX 79706
Postal Product: First-Class Mail®
Extra Services: Certified Mail™
 Return Receipt Electronic
Recipient Name: CHEVRON USA INC

Shipment Details

Weight: 2.0oz

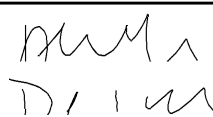
Recipient Signature

Signature of Recipient: 
 Address of Recipient: 

Note: Scanned image may reflect a different destination address due to Intended Recipient's delivery instructions on file.

Thank you for selecting the United States Postal Service® for your mailing needs. If you require additional assistance, please contact your local Post Office™ or a Postal representative at 1-800-222-1811.

Sincerely,
United States Postal Service®
475 L'Enfant Plaza SW
Washington, D.C. 20260-0004

Chevron USA Inc
 6301 Deauville Blvd
 Midland , TX 79706
 Reference #: COG Boater NSP 26084 and 26086
 Item ID: COG Boater NSP 26084 and 26086



April 28, 2026

Dear Simple Certified:

The following is in response to your request for proof of delivery on your item with the tracking number: **9414 8362 0855 1299 0450 90.**

Item Details

Status:	Delivered, Individual Picked Up at Post Office
Status Date / Time:	April 22, 2026, 7:36 am
Location:	OKLAHOMA CITY, OK 73102
Postal Product:	First-Class Mail®
Extra Services:	Certified Mail™ Return Receipt Electronic
Recipient Name:	DEVON ENERGY CO LP

Shipment Details

Weight: 2.0oz

Recipient Signature

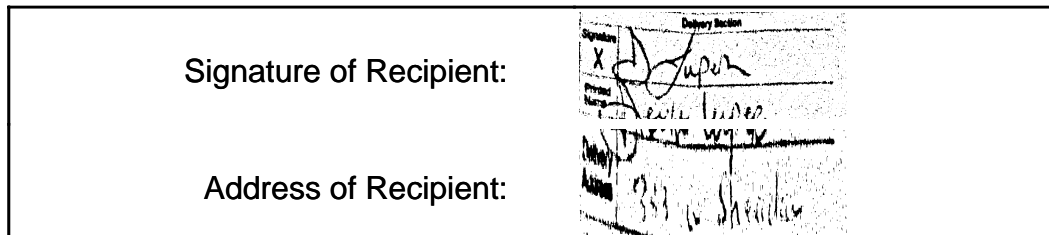

Note: Scanned image may reflect a different destination address due to Intended Recipient's delivery instructions on file.

Thank you for selecting the United States Postal Service® for your mailing needs. If you require additional assistance, please contact your local Post Office™ or a Postal representative at 1-800-222-1811.

Sincerely,
United States Postal Service®
475 L'Enfant Plaza SW
Washington, D.C. 20260-0004

Devon Energy Co LP 333 W Sheridan Ave Oklahoma City , OK 73102 Reference #: COG Boater NSP 26084 and 26086 Item ID: COG Boater NSP 26084 and 26086
--



April 19, 2026

Dear Simple Certified:

The following is in response to your request for proof of delivery on your item with the tracking number: **9414 8362 0855 1299 0451 51.**



Item Details

Status: Delivered to Agent, Front Desk/Reception/Mail Room
Status Date / Time: April 18, 2026, 10:38 am
Location: HOUSTON, TX 77046
Postal Product: First-Class Mail®
Extra Services: Certified Mail™
 Return Receipt Electronic
Recipient Name: OCCIDENTAL PERMIAN LP

Shipment Details

Weight: 2.0oz

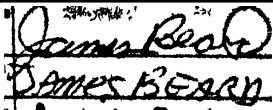
Recipient Signature

Signature of Recipient: (Authorized Agent)	
Address of Recipient:	

Note: Scanned image may reflect a different destination address due to Intended Recipient's delivery instructions on file.

Thank you for selecting the United States Postal Service® for your mailing needs. If you require additional assistance, please contact your local Post Office™ or a Postal representative at 1-800-222-1811.

Sincerely,
United States Postal Service®
475 L'Enfant Plaza SW
Washington, D.C. 20260-0004

Occidental Permian LP
 5 Greenway Plaza
 Suite 110
 Houston , TX 77046
 Reference #: COG Boater NSP 26084 and 26086
 Item ID: COG Boater NSP 26084 and 26086



April 19, 2026

Dear Simple Certified:

The following is in response to your request for proof of delivery on your item with the tracking number: **9414 8362 0855 1299 0452 74.**

Item Details

Status: Delivered, Left with Individual
Status Date / Time: April 18, 2026, 12:40 pm
Location: FORT WORTH, TX 76132
Postal Product: First-Class Mail®
Extra Services: Certified Mail™
 Return Receipt Electronic
Recipient Name: Pintail Production Company

Shipment Details

Weight: 2.0oz

Recipient Signature

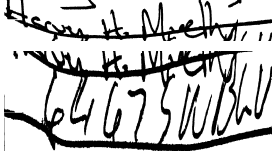
Signature of Recipient:	
Address of Recipient:	

Note: Scanned image may reflect a different destination address due to Intended Recipient's delivery instructions on file.

Thank you for selecting the United States Postal Service® for your mailing needs. If you require additional assistance, please contact your local Post Office™ or a Postal representative at 1-800-222-1811.

Sincerely,
United States Postal Service®
475 L'Enfant Plaza SW
Washington, D.C. 20260-0004

Pintail Production Company 6767 Southwest Blvd Fort Worth , TX 76132 Reference #: COG Boater NSP 26084 and 26086 Item ID: COG Boater NSP 26084 and 26086
--

Affidavit of Publication

STATE OF NEW MEXICO
COUNTY OF LEA

I, Daniel Russell, Publisher of the Hobbs News-Sun, a newspaper published at Hobbs, New Mexico, solemnly swear that the clipping attached hereto was published in the regular and entire issue of said newspaper, and not a supplement thereof for a period of 1 issue(s).

Beginning with the issue dated
April 21, 2026
and ending with the issue dated
April 21, 2026.



Publisher

Sworn and subscribed to before me this
21st day of April 2026.



Business Manager

My commission expires
January 29, 2027

(Seal) STATE OF NEW MEXICO
NOTARY PUBLIC
GUSSIE RUTH BLACK
COMMISSION # 1087526
COMMISSION EXPIRES 01/29/2027

This newspaper is duly qualified to publish legal notices or advertisements within the meaning of Section 3, Chapter 167, Laws of 1937 and payment of fees for said publication has been made.

LEGAL NOTICE April 21, 2026

This is to notify all interested parties, including; OXY Y-1 Company; EOG Resources, Inc; United States of America Bureau of Land Management, Commissioner of Public Lands New Mexico State Land Office; United Exploration LLC; Beverly Jean Renfro Barr, Trustee; Chevron U.S.A. Inc.; Devon Energy Production Company, LP; Endurance Properties Inc; Occidental Permian Limited Partnership; Pintall Production Company; Robert Enfield Trust; Sunshine Co.; SMP Patriot Mineral Holdings, LLC; Rolla R. Hinkle, III; Occidental Permian LP; and their successors and assigns; that the New Mexico Oil Conservation Division will conduct a hearing on the application submitted by COG Operating LLC, ("Applicant") for Case No. 26084. The hearing will be conducted on May 7, 2026, in a hybrid fashion, both virtually and in person at the Energy, Minerals and Natural Resources Department, 1st Floor, Santa Fe, NM 87505. To participate virtually, see the instructions posted on the OCD website; <https://www.emnrd.nm.gov/eod/hearing-info/>. In Case No. 26084, Applicant seeks an order pooling all uncommitted interests in the Wolfcamp A interval of the Wolfcamp formation underlying a 960-acre, more or less, non-standard, horizontal spacing unit comprised of the S/2 of Section 29, and all of Section 32, Township 25 South, Range 35 East, Lea County, New Mexico ("Unit"). The Unit will be dedicated to the following wells ("Wells"); **Boater Federal Com 701H**, which will be drilled from a surface hole location in the SE/4 NW/4 (Unit F) of Section 29, to a bottom hole location in the SE/4 SW/4 (Unit N) of Section 32, **Boater Federal Com 702H**, which will be drilled from a surface hole location in the SE/4 NW/4 (Unit F) of Section 29, to a bottom hole location in the SW/4 SE/4 (Unit O) of Section 32; and **Boater Federal Com 703H**, which will be drilled from a surface hole location in the SW/4 NE/4 (Unit G) of Section 29, to a bottom hole location in the SE/4 SE/4 (Unit P) of Section 32. Due to a depth severance within the Unit, Applicant seeks to pool only those uncommitted interests from the top of the Wolfcamp formation to the base of the Wolfcamp A interval at a stratigraphic equivalent of approximately 12,736' TVD, as observed on the Tele Delux 32 State 4H well log (API No. 30-025-42362). The completed intervals of the Wells will be orthodox. Applicant requests approval of a non-standard horizontal spacing unit pursuant to Rule 19.15.16.15(B)(5) NMAC, which will create cost efficiencies, prevent waste, and protect correlative rights. Also to be considered will be the cost of drilling and completing the Wells, the allocation of the costs, the designation of Applicant as operator of the Wells and the Unit, and a 200% charge for the risk involved in drilling and completing the Wells. The Wells are located approximately 12 miles Southwest of Jal, New Mexico.
#00310407

67118479

00310407

HARDY MCLEAN LLC
125 LINCOLN AVE, STE. 223
SANTA FE, NM 87501

COG Operating LLC
Case No. 26084
Exhibit C-4