

CASE 4356:

SOUTHEASTERN NEW MEXICO
NOMENCLATURE

Case Number

4356

Application
Transcripts.

Small Exhibits

ETC.

dearnley-meier reporting service, inc.

SPECIALIZING IN: DEPOSITIONS, HEARINGS, STATEMENTS, EXPERT TESTIMONY, DAILY COPY, CONVENTIONS

209 SIMA'S BLDG. • P.O. BOX 1092 • PHONE 243-6691 • ALBUQUERQUE, NEW MEXICO



1

BEFORE THE
NEW MEXICO OIL CONSERVATION COMMISSION
Santa Fe, New Mexico
May 13, 1970

EXAMINER HEARING

IN THE MATTER OF:

Southeastern nomenclature case calling
for an order for the creation, abolish-) Case No. 4356
ment, extension and contraction of certain)
pools in Lea, Eddy, Chaves and Roosevelt)
Counties, New Mexico.)

BEFORE: Daniel S. Nutter, Examiner.

TRANSCRIPT OF HEARING

MR. NUTTER: Call Case No. 4356.

MR. HATCH: Case No. 4356. Southeastern nomenclature case calling for an order for the creation, abolishment, extension and contraction of certain pools in Lea, Eddy, Chaves and Roosevelt Counties, New Mexico.

(Whereupon, Applicant's Exhibit 1 was marked for identification.)

(Witness sworn.)

JOE D. RAMEY

called as a witness, having been first duly sworn, was examined and testified as follows:

DIRECT EXAMINATION

BY MR. HATCH:

Q State your name and position for the record.

A I am Joe D. Ramey, Supervisor of the Commission's District 1.

Q Are you prepared to make recommendations to the Commission concerning the creation, abolishment, extension and contraction of certain pools in Lea, Eddy, Chaves and Roosevelt Counties, New Mexico?

A Yes, I am.

Q Are your recommendations prepared in the form of an exhibit?

A They are. It's labeled Southeast New Mexico Nomenclature Exhibit 1, paragraphs A through N.

Q All right. Would you refer to Exhibit 1, paragraphs A through N, and point out any substantial differences between it and the docket that has been distributed in this case?

A The only change I have between the exhibit and the docket is in paragraph H where I have an addition in Township 15 South, Range 30 East, Section 6, the north half.

Q Do you recommend to the Commission that the pools in paragraphs A through N be created, abolished, extended and contracted as shown on the docket and as you have corrected it here at this hearing?

A I certainly do.

Q Was Exhibit 1 prepared by you or someone under your supervision?

A Yes, it was.

MR. HATCH: We would like to introduce Exhibit 1 into evidence.

MR. NUTTER: It was which?

THE WITNESS: It was prepared under my supervision.

MR. NUTTER: Does anybody want to object to this exhibit?

THE WITNESS: If there's any objection I want a continuance.

MR. NUTTER: If there are no objections, Mr.

Ramey's exhibit will be admitted, with regrets.

(Whereupon, Applicant's
Exhibit 1 was offered and
admitted in evidence.)

MR. NUTTER: Does anyone have anything further
they wish to offer in Case 4356? We will take the case
under advisement and the hearing is adjourned.

I N D E XWITNESSPAGE

JOE D. RAMEY

Direct Examination by Mr. Hatch

2

EXHIBITMARKEDOFFERED AND
ADMITTED

Applicant's 1

2

4

I, GLENDA BURKS, Notary Public in and for the County of Bernalillo, State of New Mexico, do hereby certify that the foregoing and attached Transcript of Hearing before the New Mexico Oil Conservation Commission was reported by me; and that the same is a true and correct record of the said proceedings, to the best of my knowledge, skill and ability.

Glenda Burps
NOTARY PUBLIC

My Commission Expires:

March 12, 1973

BEFORE THE OIL CONSERVATION COMMISSION
OF THE STATE OF NEW MEXICO

IN THE MATTER OF THE HEARING
CALLED BY THE OIL CONSERVATION
COMMISSION OF NEW MEXICO FOR
THE PURPOSE OF CONSIDERING:

CASE No. 4356
Order No. R-3964

THE APPLICATION OF THE OIL CONSERVATION
COMMISSION UPON ITS OWN MOTION FOR AN
ORDER CREATING, ABOLISHING, CONTRACTING,
AND EXTENDING CERTAIN POOLS IN CHAVES,
EDDY, LEA, AND ROOSEVELT COUNTIES, NEW
MEXICO.

ORDER OF THE COMMISSION

BY THE COMMISSION:

This cause came on for hearing at 9 a.m. on May 13, 1970,
at Santa Fe, New Mexico, before the Oil Conservation Commission
of New Mexico, hereinafter referred to as the "Commission."

NOW, on this 20th day of May, 1970, the Commission, a
quorum being present, having considered the testimony presented
and the exhibits received at said hearing, and being fully advised
in the premises,

FINDS:

(1) That due public notice having been given as required by
law, the Commission has jurisdiction of this cause and the subject
matter thereof.

(2) That there is need for the creation of a new gas pool
in Lea County, New Mexico, for the production of gas from the
Morrow Sand formation, said pool to bear the designation of Baum-
Morrow Gas Pool. Said Baum-Morrow Gas Pool was discovered by the
RK Petroleum Corporation State Well No. 1, located in Unit B of
Section 27, Township 13 South, Range 32 East, NMPM. It was com-
pleted in the Morrow Sand formation on September 24, 1969. The
top of the perforations is at 10,593 feet.

(3) That there is need for the creation of a new gas pool
in Lea County, New Mexico, for the production of gas from the

CASE No. 4356

Order No. R-3964

Queen Penrose formation, said pool to bear the designation of East Querecho Plains-Queen Gas Pool. Said East Querecho Plains-Queen Gas Pool was discovered by the Robert N. Enfield Hudson Federal Well No. 1, located in Unit O of Section 30, Township 18 South, Range 33 East, NMPM. It was completed in the Queen Penrose formation on May 3, 1963. The depth to the casing shoe is 4330 feet.

(4) That there is need for the consolidation of the Bluit-San Andres Pool and the Bluit-San Andres Associated Pool, both in Roosevelt County, New Mexico, inasmuch as both pools are producing from one common source of supply. Said consolidation to be accomplished by the abolishment of the Bluit-San Andres Pool and the extension of the Bluit-San Andres Associated Pool.

(5) That there is need for the contraction of the Bagley-Pennsylvanian Pool in Lea County, New Mexico, by the deletion of certain acreage because said acreage overlaps with the North Bagley-Upper Pennsylvanian Pool. The deleted acreage is to be placed in the North Bagley-Upper Pennsylvanian Pool.

(6) That there is need for certain extensions to the Double L-Queen Pool in Chaves County, New Mexico, the Rock Tank-Lower Morrow Gas Pool and the Rock Tank-Upper Morrow Gas Pool, both in Eddy County, New Mexico, the North Bagley-Upper Pennsylvanian Pool, the Cerca-Upper Pennsylvanian Pool, the Hobbs-Blinberry Pool, the Lea-Bone Springs Pool, the Tulk-Pennsylvanian Pool, and the Tulk-Wolfcamp Pool, all in Lea County, New Mexico.

IT IS THEREFORE ORDERED:

(a) That a new pool in Lea County, New Mexico, classified as a gas pool for Morrow Sand production, is hereby created and designated as the Baum-Morrow Gas Pool, consisting of the following-described area:

TOWNSHIP 13 SOUTH, RANGE 32 EAST, NMPM
Section 27: N/2

(b) That a new pool in Lea County, New Mexico, classified as a gas pool for Queen Penrose production, is hereby created and designated as the East Querecho Plains-Queen Gas Pool, consisting of the following-described area:

TOWNSHIP 18 SOUTH, RANGE 33 EAST, NMPM
Section 30: SE/4

-3-

CASE No. 4356
Order No. R-3964

(c) That the Bluit-San Andres Pool in Roosevelt County, New Mexico, consisting of the following-described area:

TOWNSHIP 8 SOUTH, RANGE 38 EAST, NMPM

Section 7: All
Section 8: All
Section 17: All
Section 18: All

is hereby abolished.

(d) That the Bluit-San Andres Associated Pool in Roosevelt County, New Mexico, as heretofore classified, defined, and described, is hereby extended to include therein:

TOWNSHIP 8 SOUTH, RANGE 38 EAST, NMPM

Section 8: S/2
Section 17: W/2

(e) That the Bagley-Pennsylvanian Pool in Lea County, New Mexico, as heretofore classified, defined, and described, is hereby contracted by the deletion of the following-described area:

TOWNSHIP 12 SOUTH, RANGE 33 EAST, NMPM

Section 4: NE/4

(f) That the North Bagley-Upper Pennsylvanian Pool in Lea County, New Mexico, as heretofore classified, defined, and described, is hereby extended to include therein:

TOWNSHIP 11 SOUTH, RANGE 33 EAST, NMPM

Section 33: E/2

TOWNSHIP 12 SOUTH, RANGE 33 EAST, NMPM

Section 4: NE/4

(g) That the Cerca-Upper Pennsylvanian Pool in Lea County, New Mexico, as heretofore classified, defined, and described, is hereby extended to include therein:

TOWNSHIP 13 SOUTH, RANGE 34 EAST, NMPM

Section 34: NW/4

TOWNSHIP 14 SOUTH, RANGE 34 EAST, NMPM

Section 8: NW/4

-4-

CASE No. 4356
Order No. R-3964

(h) That the Double L-Queen Pool in Chaves County, New Mexico, as heretofore classified, defined, and described, is hereby extended to include therein:

TOWNSHIP 15 SOUTH, RANGE 29 EAST, NMPM
Section 12: E/2 NE/4

TOWNSHIP 15 SOUTH, RANGE 30 EAST, NMPM
Section 6: N/2

(i) That the Hobbs-Blinebry Pool in Lea County, New Mexico, as heretofore classified, defined, and described, is hereby extended to include therein:

TOWNSHIP 18 SOUTH, RANGE 38 EAST, NMPM
Section 33: NE/4

(j) That the Lea-Bone Springs Pool in Lea County, New Mexico, as heretofore classified, defined, and described, is hereby extended to include therein:

TOWNSHIP 19 SOUTH, RANGE 34 EAST, NMPM
Section 35: SE/4

TOWNSHIP 20 SOUTH, RANGE 34 EAST, NMPM
Section 2: E/2

(k) That the Rock Tank-Lower Morrow Gas Pool in Eddy County, New Mexico, as heretofore classified, defined, and described, is hereby extended to include therein:

TOWNSHIP 23 SOUTH, RANGE 24 EAST, NMPM
Section 12: All

(l) That the Rock Tank-Upper Morrow Gas Pool in Eddy County, New Mexico, as heretofore classified, defined, and described, is hereby extended to include therein:

TOWNSHIP 23 SOUTH, RANGE 24 EAST, NMPM
Section 12: All

(m) That the Tulk-Pennsylvanian Pool in Lea County, New Mexico, as heretofore classified, defined, and described, is hereby extended to include therein:

TOWNSHIP 14 SOUTH, RANGE 32 EAST, NMPM
Section 34: NE/4

-5-

CASE No. 4356

Order No. R-3964

(n) That the Tulk-Wolfcamp Pool in Lea County, New Mexico, as heretofore classified, defined, and described, is hereby extended to include therein:

TOWNSHIP 15 SOUTH, RANGE 32 EAST, NMPM
Section 9: NE/4

IT IS FURTHER ORDERED:

(1) That, pursuant to Section 65-3-14.5, NMSA 1953, contained in Chapter 271, Laws of 1969, any well which, by virtue of any of the above pool extensions, is subject to pool rules providing for spacing or proration units larger than the one which is presently dedicated thereto, shall have 60 days from the effective date of this order in which to file new Forms C-102 dedicating a standard unit for the pool to said well, or to obtain a non-standard unit approved by the Commission. Pending such compliance, the well shall receive a maximum allowable in the same proportion to a standard allowable for the pool that the acreage dedicated to the well bears to a standard unit for the pool. Failure to file Forms C-102 dedicating a standard unit to the well or to obtain a non-standard unit approved by the Commission within said 60-day period shall subject the well to cancellation of allowable.

(2) That the effective date of this order and all creations, abolishments, contractions, and extensions included herein shall be June 1, 1970.

DONE at Santa Fe, New Mexico, on the day and year hereinabove designated.

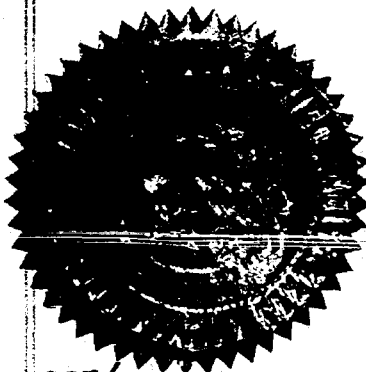

STATE OF NEW MEXICO
OIL CONSERVATION COMMISSION

David F. Cargo
DAVID F. CARGO, Chairman

Alex J. Armijo
ALEX J. ARMIJO, Member

A. L. Porter, Jr.
A. L. PORTER, Jr., Member & Secretary

esr/

DOCKET No. 12-70

DOCKET: REGULAR HEARING - WEDNESDAY - MAY 13, 1970

OIL CONSERVATION COMMISSION - 9 A.M. - MORGAN HALL, STATE LAND OFFICE
BUILDING, SANTA FE, NEW MEXICO

- ALLOWABLE: (1) Consideration of the oil allowable for June, 1970;
- (2) Consideration of the allowable production of gas for June, 1970, from fifteen prorated pools in Lea, Eddy, Roosevelt and Chaves Counties, New Mexico; also presentation of purchaser's nominations for said pools for the six-month period beginning July 1, 1970; consideration of the allowable production of gas from nine prorated pools in San Juan, Rio Arriba and Sandoval Counties, New Mexico, for June, 1970.

THE FOLLOWING CASES WILL BE HEARD BEFORE DANIEL S. NUTTER,
EXAMINER, OR ELVIS A. UTZ, ALTERNATE EXAMINER:

CASE 4354: Application of Michael P. Grace and Corinne Grace for compulsory pooling, Eddy County, New Mexico. Applicants, in the above-styled cause, seek an order pooling all mineral interests from the surface of the ground down to and including the Morrow formation underlying the N/2 of Section 11, Township 23 South, Range 26 East, South Carlsbad Field, Eddy County, New Mexico, said acreage to be dedicated to a well to be drilled in either the NE/4 NW/4 or the NW/4 NE/4 of said Section 11. Also to be considered will be the costs of drilling said well, a charge for the risk involved, a provision for the allocation of actual operating costs, and the establishment of charges for supervision of said well.

Greg Bassett
Pat Mayfield
CASE 4355: Application of Pan American Petroleum Corporation for pool consolidation, Lea County, New Mexico. Applicant, in the above-styled cause, seeks the consolidation of the North Bagley-Upper Pennsylvanian and North Bagley-Lower Pennsylvanian Pools, Lea County, New Mexico, into one pool. Applicant further requests the Lower Pennsylvanian Allowable Factor be applied to the consolidated pool.

request for info
CASE 3727 (Reopened)

Clarence
Richard Johnson
Paul Harrison
In the matter of Case 3727 being reopened pursuant to the provisions of Order No. R-3428, which order established 640-acre spacing units for the Rock Tank-Upper Morrow and Rock Tank-Lower Morrow Gas Pools, Eddy County, New Mexico, for a period of one year after first pipeline connection in either of the pools. All interested persons may appear and show cause why said pools should not be developed on 320-acre spacing units.

Regular Hearing - May 13, 1970
-2-

Docket No. 12-70

CASE 4356: Southeastern nomenclature case calling for an order for the creation, abolishment, extension and contraction of certain pools in Lea, Eddy, Chaves and Roosevelt Counties, New Mexico.

(a) Create a new pool in Lea County, New Mexico, classified as a gas pool for Morrow production and designated as the Baum-Morrow Gas Pool. The discovery well is the RK Petroleum Corporation State No. 1 located in Unit B of Section 27, Township 13 South, Range 32 East, NMPM. Said pool would comprise:

TOWNSHIP 13 SOUTH, RANGE 32 EAST, NMPM
SECTION 27: N/2

(b) Create a new pool in Lea County, New Mexico, classified as a gas pool for Queen-Penrose production and designated as the East Querecho Plains-Queen Gas Pool. The discovery well is Robert N. Enfield's Hudson Federal No. 1 located in Unit 0 of Section 30, Township 18 South, Range 33 East, NMPM.

TOWNSHIP 18 SOUTH, RANGE 33 EAST, NMPM
SECTION 30: SE/4

(c) Abolish the Bluitt-San Andres Pool in Roosevelt County, New Mexico, described as:

TOWNSHIP 8 SOUTH, RANGE 38 EAST, NMPM
SECTION 7: All
SECTION 8: All
SECTION 17: All
SECTION 18: All

(d) Extend the Bluitt-San Andres Associated Pool in Roosevelt County, New Mexico, to include therein:

TOWNSHIP 8 SOUTH, RANGE 38 EAST, NMPM
SECTION 8: S/2
SECTION 17: W/2

(e) Contract the Bagley-Pennsylvanian Pool in Lea County, New Mexico, by the deletion of the following described area;

TOWNSHIP 12 SOUTH, RANGE 33 EAST, NMPM
SECTION 4: NE/4

Regular Hearing - May 13, 1970

Docket No. 12-70

-3-

(Case 4356 continued)

(f) Extend the North Bagley-Upper Pennsylvanian Pool in Lea County, New Mexico, to include therein:

TOWNSHIP 11 SOUTH, RANGE 33 EAST, NMPM
SECTION 33: E/2

TOWNSHIP 12 SOUTH, RANGE 33 EAST, NMPM
SECTION 4: NE/4

(g) Extend the Cerca-Upper Pennsylvanian Pool in Lea County, New Mexico, to include therein:

TOWNSHIP 13 SOUTH, RANGE 34 EAST, NMPM
SECTION 34: NW/4

TOWNSHIP 14 SOUTH, RANGE 34 EAST, NMPM
SECTION 8: NW/4

(h) Extend the Double L-Queen Pool in Chaves County, New Mexico, to include therein:

TOWNSHIP 15 SOUTH, RANGE 29 EAST, NMPM
SECTION 12: E/2 NE/4

T15 S R30E
Sec 6: N/2
(i) Extend the Hobbs-Blinbry Pool in Lea County, New Mexico, to include therein:

TOWNSHIP 18 SOUTH, RANGE 38 EAST, NMPM
SECTION 33: NE/4

(j) Extend the Lea-Bone Springs Pool in Lea County, New Mexico, to include therein:

TOWNSHIP 19 SOUTH, RANGE 34 EAST, NMPM
SECTION 35: SE/4

TOWNSHIP 20 SOUTH, RANGE 34 EAST, NMPM
SECTION 2: E/2

(k) Extend the Rock Tank-Lower Morrow Gas Pool in Eddy County, New Mexico, to include therein:

TOWNSHIP 23 SOUTH, RANGE 24 EAST, NMPM
SECTION 12: All

Regular Hearing - May 13, 1970

-4-

Docket No. 12-70

(l) Extend the Rock Tank-Upper Morrow Gas Pool in Eddy County, New Mexico, to include therein:

TOWNSHIP 23 SOUTH, RANGE 24 EAST, NMPM
SECTION 12: All

(m) Extend the Tulk-Pennsylvanian Pool in Lea County, New Mexico, to include therein:

TOWNSHIP 14 SOUTH, RANGE 32 EAST, NMPM
SECTION 34: NE/4

(n) Extend the Tulk-Wolfcamp Pool in Lea County, New Mexico, to include therein:

TOWNSHIP 15 SOUTH, RANGE 32 EAST, NMPM
SECTION 9: NE/4

CASE 4301: (Continued from the March 25, 1970, Examiner Hearing)

In the matter of the hearing called by the Oil Conservation Commission on its own motion to permit Robert T. Smith and all other interested persons to appear and show cause why the following Robert T. Smith wells located in Section 32, Township 20 North, Range 9 West, McKinley County, New Mexico, should not be plugged and abandoned in accordance with a Commission-approved plugging program:

State Well No. 1 located 487 feet from the North line and 990 feet from the East line;

State "A" Well No. 1 located 400 feet from the North line and 990 feet from the East line;

State Well No. 3 located 330 feet from the North line and 330 feet from the West line;

State Well No. 6 located 220 feet from the North line and 1485 feet from the East line;

State Well No. 6-Y located approximately 5 feet West of the above-described Well No 6;

State Well No. 8 located 1155 feet from the North line and 2475 feet from the East line.

*Cont'd
June 17*

*Jack Campbell
Kenneth A. Freeman
Dist Supt.
midland*

CASE 4337: (Continued from the April 15, 1970, Examiner Hearing)
Application of Petroleum Corporation of Texas for an exception to Order No. R-3221, as amended, Eddy County, New Mexico. Applicant, in the above-styled cause, seeks an exception to Order No. R-3221, as amended, which order prohibits the disposal of water produced in conjunction with the production of oil on the surface of the ground in Lea, Eddy, Chaves, and Roosevelt Counties, New Mexico. Said exception would be for applicant's Dexter Hanagan Graridge Federal Well No. 1 located in Unit J, Section 22, Township 17 South, Range 30 East, Jackson-Abo Pool, Eddy County, New Mexico. Applicant seeks authority to dispose of salt water produced by said well in an unlined surface pit in the vicinity of said well.

Dismiss

CASE 4336: (Continued from the April 15, 1970, Examiner Hearing)
Application of Byron McKnight for an exception to Order No. R-3221, as amended, Lea County, New Mexico. Applicant, in the above-styled cause, seeks an exception to Order No. R-3221, as amended, which order prohibits the disposal of water produced in conjunction with the production of oil or gas on the surface of the ground in Lea, Eddy, Chaves and Roosevelt Counties. Said exception would be for applicant's lease comprising all of Section 19, W/2 of Section 20, NW/4 Section 29, and NW/4 Section 30, Township 19 South, Range 34 East, undesignated Yates-Seven Rivers gas pool, Lea County, New Mexico. Applicant seeks authority to dispose of salt water produced by wells on said leases in unlined surface pits on the leases.

CASE 4084: (Reopened) (Continued from the April 15, 1970, Examiner Hearing).
In the matter of Case No. 4084 being reopened pursuant to the provisions of Order No. R-3732, which order established 160-acre spacing units and an 80-acre proportional factor of 4.77 for the Feather-Wolfcamp Pool, Lea County, New Mexico. All interested parties may appear and show cause why the said pool should not be developed on less than 160-acre spacing units and to show cause why the 80-acre proportional factor of 4.77 should or should not be retained.

Clarence Humble
John Carrasquillo
Res. Engr
Hobbs

CASE 4351: (Continued from the April 29, 1970, Examiner Hearing)
Application of Humble Oil & Refining Company for well reclassification and simultaneous dedication of acreage, Lea County, New Mexico. Applicant, in the above-styled cause, seeks the reclassification of its New Mexico "G" State Well No. 5 from an oil well in the Eumont Pool to a gas well in said pool. Applicant further seeks the dedication of a standard 640-acre gas proration unit comprising all of Section 23, Township 21 South, Range 36 East, Lea County, New Mexico, to said Well No. 5 and to applicant's New Mexico "G" State Well No. 9, located, respectively in Units E and G of said Section 23, and authority to produce the allowable assigned to said unit from either of said wells in any proportion.

Cont'd to Examiner

CASE 4352: (Continued from the April 29, 1970, Examiner Hearing)
Application of Jack L. McClellan for the creation of a new gas pool or, in the alternative, the establishment of pool rules for two existing pools, Chaves and Lea Counties, New Mexico. Applicant, in the above-styled cause, seeks the creation of a new Queen gas pool comprising the following-described acreage:

CHAVES COUNTY, NEW MEXICO

TOWNSHIP 15 SOUTH, RANGE 29 EAST

Section 11: SE/4
Section 12: SW/4
Section 13: NW/4
Section 14: E/2
Section 23: NE/4 and SW/4

In the alternative applicant seeks the promulgation of special rules for the Sulimar-Queen Pool, Chaves County, and Double L-Queen Pool, Chaves and Lea Counties, New Mexico, as separate or as consolidated pools, including provisions for the classification of oil and gas wells, spacing and well location requirements for oil and gas wells, and an allocation formula for withdrawals by oil wells and gas wells.

CASE 4356: (a) CREATION OF A NEW GAS POOL

County LEA Pool BAUM-MORROW GAS

TOWNSHIP 13 South Range 32 East NMPM

6	5	4	3	2	1
7	8	9	10	11	12
18	17	16	15	14	13
19	20	21	22	23	24
30	29	28	27	26	25
31	32	33	34	35	36

PURPOSE: One completed gas well capable of producing.

RK PETROLEUM CORPORATION - State #1 in Unit B of Section 27-13-32. Completed in Morrow Sand on September 24, 1969. Top of Perforations 10,593'. Proposed pool boundary colored in red. SECTION 27: N/2

CASE 4356: (b) CREATION OF A NEW GAS POOL

County LEA Pool EAST QUERECHO PLAINS-QUEEN GAS

TOWNSHIP 18 South Range 33 East NMPM

6	5	4	3	2	1
7	8	9	10	11	12
18	17	16	15	14	13
19	20	21	22	23	24
30	29	28	27	26	25
31	32	33	34	35	36

PURPOSE: One completed gas well capable of producing.

ROBERT N. ENFIELD - Hudson Federal #1 in Unit 0 of Section 30-18-33. Completed in Queen Penrose on May 3, 1963. Depth to Casing Shoe 4330'.

Proposed pool boundary colored in red. SECTION 30: SE/4

CASE 4356: (c) ABOLISHMENT OF AN EXISTING OIL POOL

County ROOSEVELT Pool BLUITT-SAN ANDRES

TOWNSHIP 8 South Range 38 East NMPM

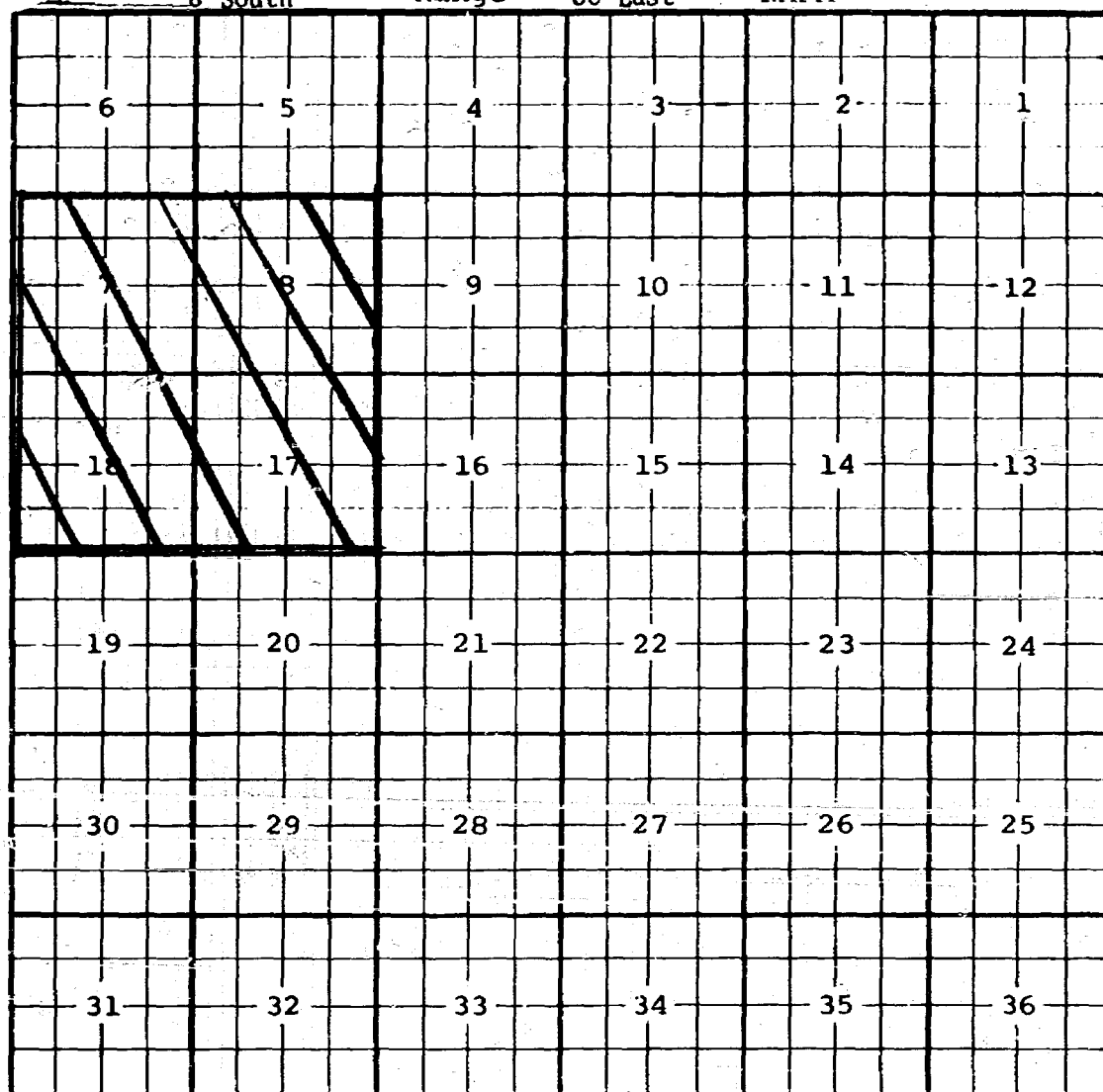

PURPOSE: This pool is now abandoned and partly overlaps with the Bluit-San Andres Associated Pool.

Proposed pool abolishment colored in blue. SECTION 7: All

SECTION 8: All

SECTION 17: All

SECTION 18: All

CASE 4356: (d) EXTENSION OF AN EXISTING OIL POOL

County ROOSEVELT Pool BLUITT-SAN ANDRES ASSOCIATED

TOWNSHIP 8 South Range 38 East NMPM

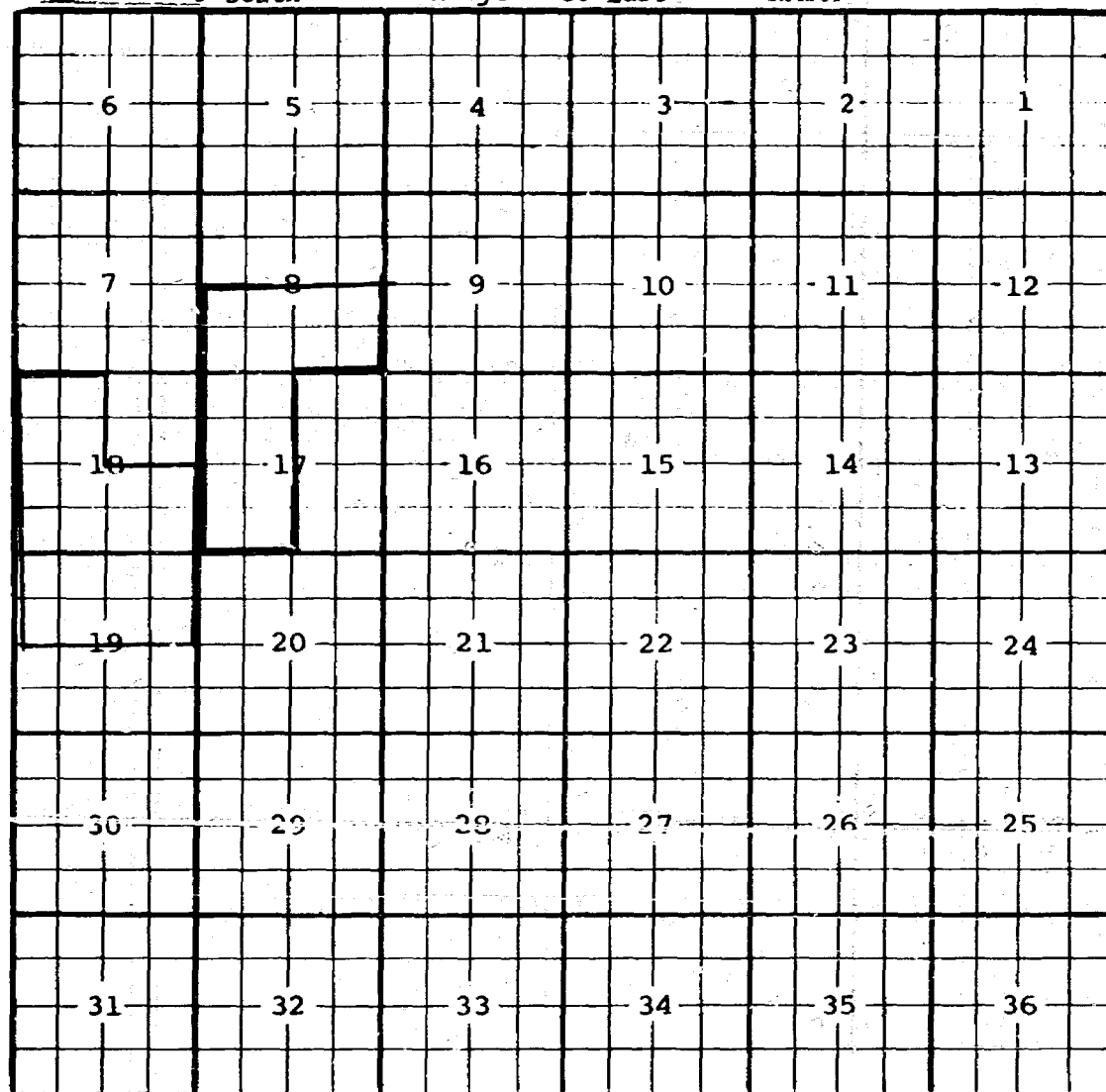

PURPOSE: To take in a portion of the abolished acreage from the Bluitt-San Andres Pool and one completed oil well capable of producing.

UNION OIL COMPANY OF CALIFORNIA - Federal "17" #1 in Unit N of Section 17-8-38. Completed in San Andres on March 19, 1970. Top of Perforations 4761'.

Pool boundary colored in red.

Proposed pool extensions colored in green. SECTION 8: S/2

SECTION 17: W/2

CASE 4356: (e) DELETION OF AN EXISTING OIL POOL

County LEA Pool BAGLEY-PENNSYLVANIAN

TOWNSHIP 12 South Range 33 East NMPM

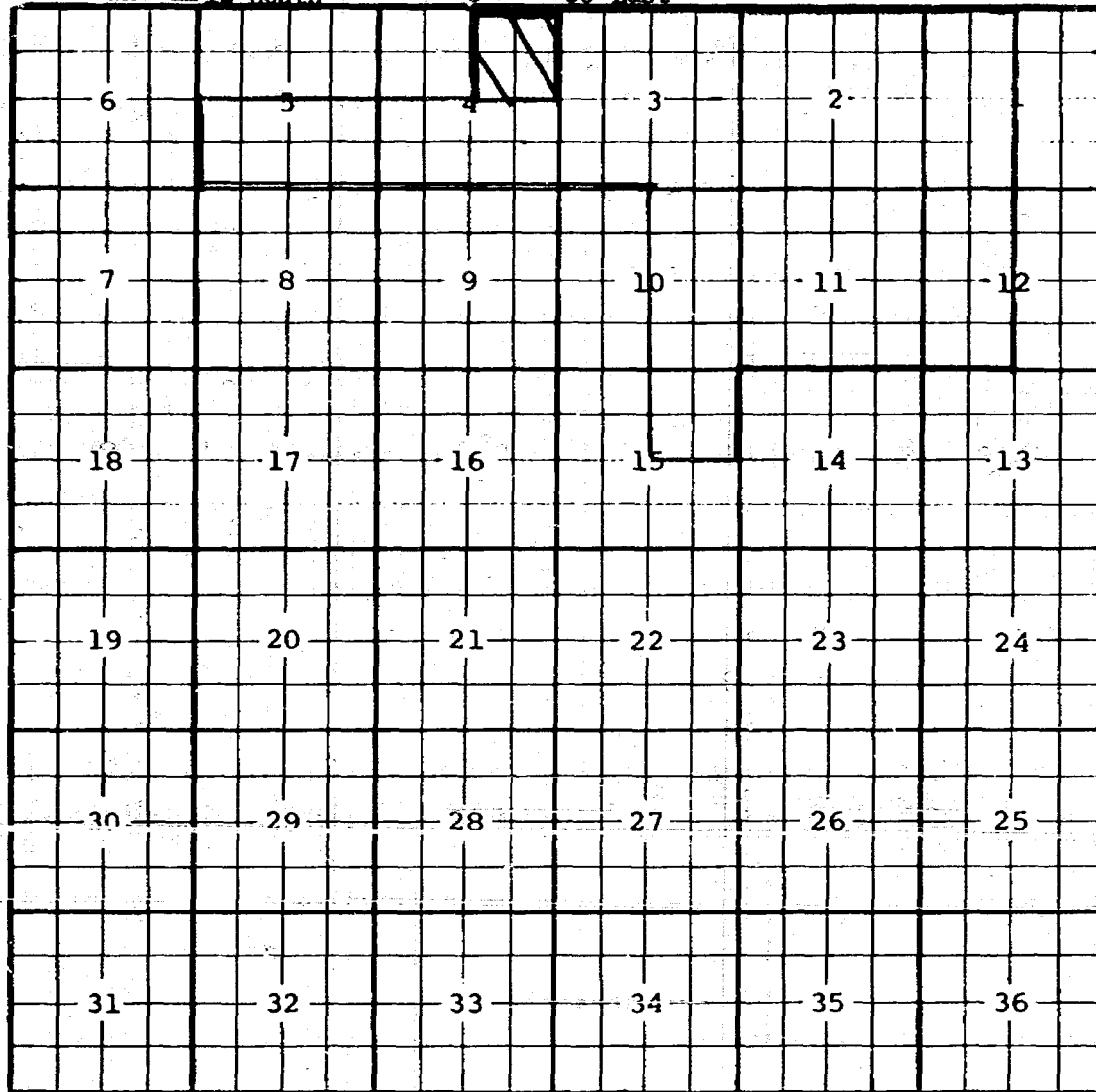

PURPOSE: Delete said acreage because it overlaps with the North Bagley-
Upper Pennsylvanian Pool.

Pool boundary colored in red.

Proposed pool contraction colored in blue. SECTION 4: NE/4

CASE 4356: (f) EXTENSION OF AN EXISTING OIL POOL (Continued on next page)

County LEA Pool NORTH BAGLEY-UPPER PENNSYLVANIAN

TOWNSHIP 11 South Range 33 East NMPM

A 6x6 grid with numbers 1 through 36. The numbers are arranged in a boustrophedon pattern, starting from the top right (1) and ending at the bottom left (36). A path of thick black lines is drawn on the grid, starting at cell 4 and ending at cell 33. The path consists of the following cells: 4, 3, 2, 11, 10, 9, 8, 17, 16, 15, 14, 23, 24, 25, 26, 27, 28, 29, 32, 33.

PURPOSE: To take in deleted acreage from the Bagley-Pennsylvanian Pool
and one completed oil well capable of producing.

Pool boundary colored in red.

Proposed pool extension colored in green. SECTION 33: E/2

CASE 4356: (f) EXTENSION OF AN EXISTING OIL POOL (Continued)

County LEA Pool NORTH BAGLEY-UPPER PENNSYLVANIAN

TOWNSHIP 12 South Range 38 East NMPM

6	5	4	3	2	1
7	8	9	10	11	12
18	17	16	15	14	13
19	20	21	22	23	24
30	29	28	27	26	25
31	32	33	34	35	36

PURPOSE: As stated on preceding page, paragraph (f), Exhibit I.

TEXAS PACIFIC OIL COMPANY - State "C" A/c-2 #2 in Unit H of Section 4-12-33. Completed in Upper Pennsylvanian on March 23, 1970. Top of Perforations 9509'.

Pool boundary colored in red.

Proposed pool extension colored in green. SECTION 4: NE/4

CASE 4356: (g) EXTENSION OF AN EXISTING OIL POOL (Continued on next page)

County	LEA	Pool	CERCA-UPPER PENNSYLVANIAN		
TOWNSHIP	13 South	Range	34 East	NMPM	
6	5	4	3	2	1
7	8	9	10	11	12
18	17	16	15	14	13
19	20	21	22	23	24
30	29	28	27	26	25
31	32	33	34	35	36

PURPOSE: Two completed oil wells capable of producing.

THE SUPERIOR OIL COMPANY - Elkan "A" #1 in Unit C of Section 34-13-34.

Completed in Upper Pennsylvanian on January 23, 1970. Top of Perforations 10,385'.

Pool boundary colored in red.

Proposed pool extension colored in green. SECTION 34: NW/4

CASE 4356: (g) EXTENSION OF AN EXISTING OIL POOL (Continued)

County LEA Pool CERCA-UPPER PENNSYLVANIAN

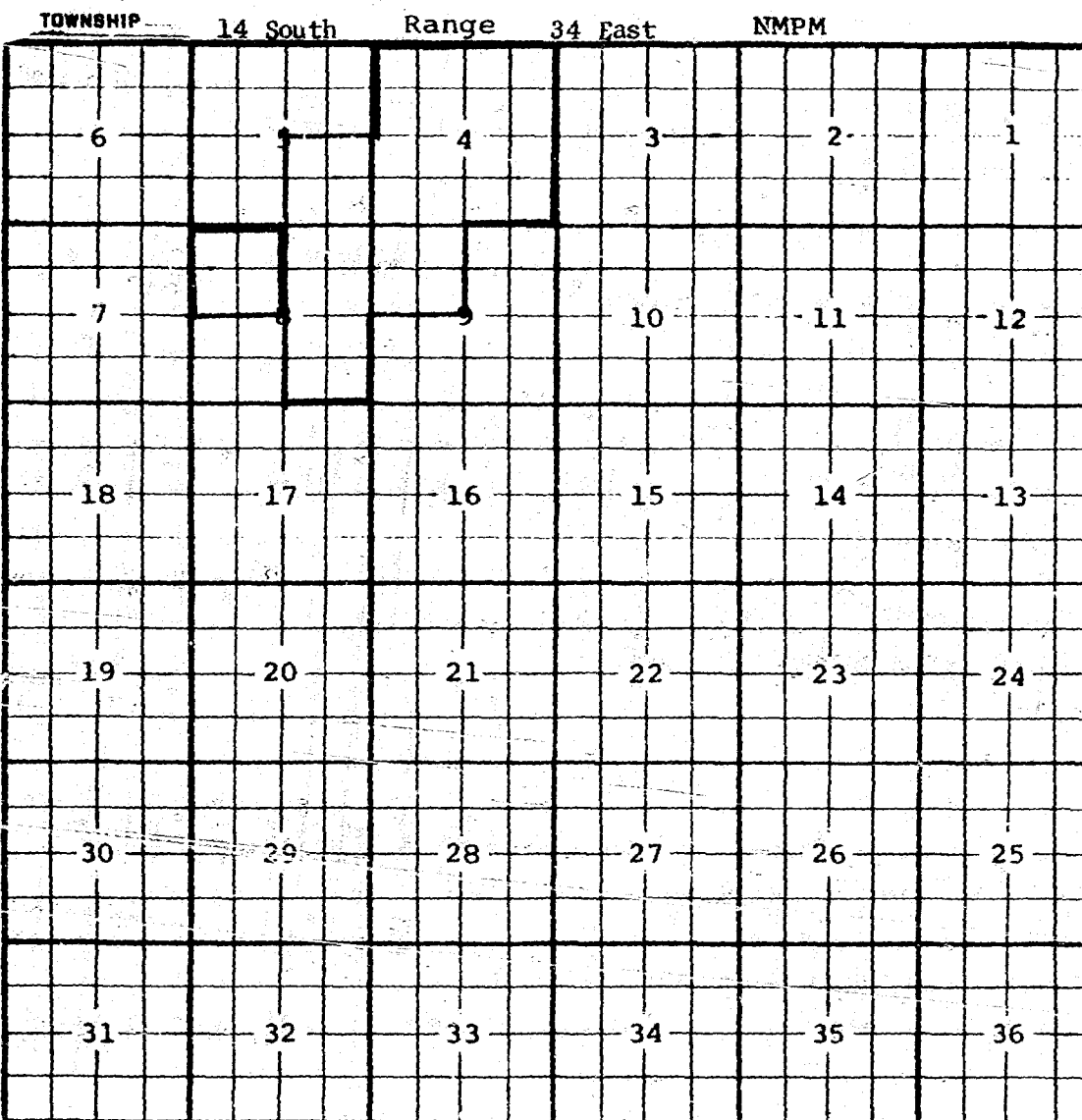

PURPOSE: As stated on preceding page, paragraph (g), Exhibit I.

AMINI OIL CORPORATION - Tenneco "B" State #1 in Unit F of Section 8-14-34.

Completed in Pennsylvanian on March 1, 1970. Top of Perforations 10,426'.

Pool boundary colored in red.

Proposed pool extension colored in green. SECTION 8: NW/4

CASE 4356: (h) EXTENSION OF AN EXISTING OIL POOL (Continued on next page)

COUNTY CHAVES POOL DOUBLE L-QUEEN

TOWNSHIP	15S	RANGE	29E	NMPM	
6	5	4	3	2	1
7	8	9	10	11	12
18	17	16	15	14	13
19	20	21	22	23	24
30	29	28	27	26	25
31	32	33	34	35	36

Purpose: One completed oil well capable of producing.

Dalport Oil Corporation, Sunset State No.1 in unit H of Section 12-15-29. Completed in Queen March 23, 1970, through perforations 1964' to 1979'.

Pool boundary colored in red.

Proposed extension colored in green.

Section 12: E/2 NE/4

CASE 4356: (h) EXTENSION OF AN EXISTING OIL POOL (Continued)

County	CHAVES	Pool	DOUBLE L-QUEEN		
TOWNSHIP	15 South	Range	30 East	NMPM	
	5	4	3	2	1
	8	9	10	11	12
18	17	16	15	14	13
19	20	21	22	23	24
30	29	28	27	26	25
31	32	33	34	35	36

PURPOSE: As stated on preceding page, paragraph (h), Exhibit I.

ADDITION--PAN AMERICAN PETROLEUM CORPORATION - Lusk "A" #1 in Unit B of
Section 6-15-30. Completed in Queen on April 21, 1970. Top of
Perforations 1980'.

ADDITION--HUMBLE OIL & REFINING COMPANY - Florence B. Lusk #1 in Unit D
of Section 6-15-30. Completed in Queen on March 7, 1970. Top
of Perforations 1953'.

ADDITION--HUMBLE OIL & REFINING COMPANY - Florence B. Lusk #2 in Unit E
of Section 6-15-30. Completed in Queen on April 17, 1970. Top
of Perforations 1953'.

Pool boundary colored in red.

Proposed pool extension colored in green. SECTION 6: N/2

CASE 4356: (i) EXTENSION OF AN EXISTING OIL POOL

County LEA Pool HOBBS-BLINEBRY

TOWNSHIP 18 South Range 38 East NMPM

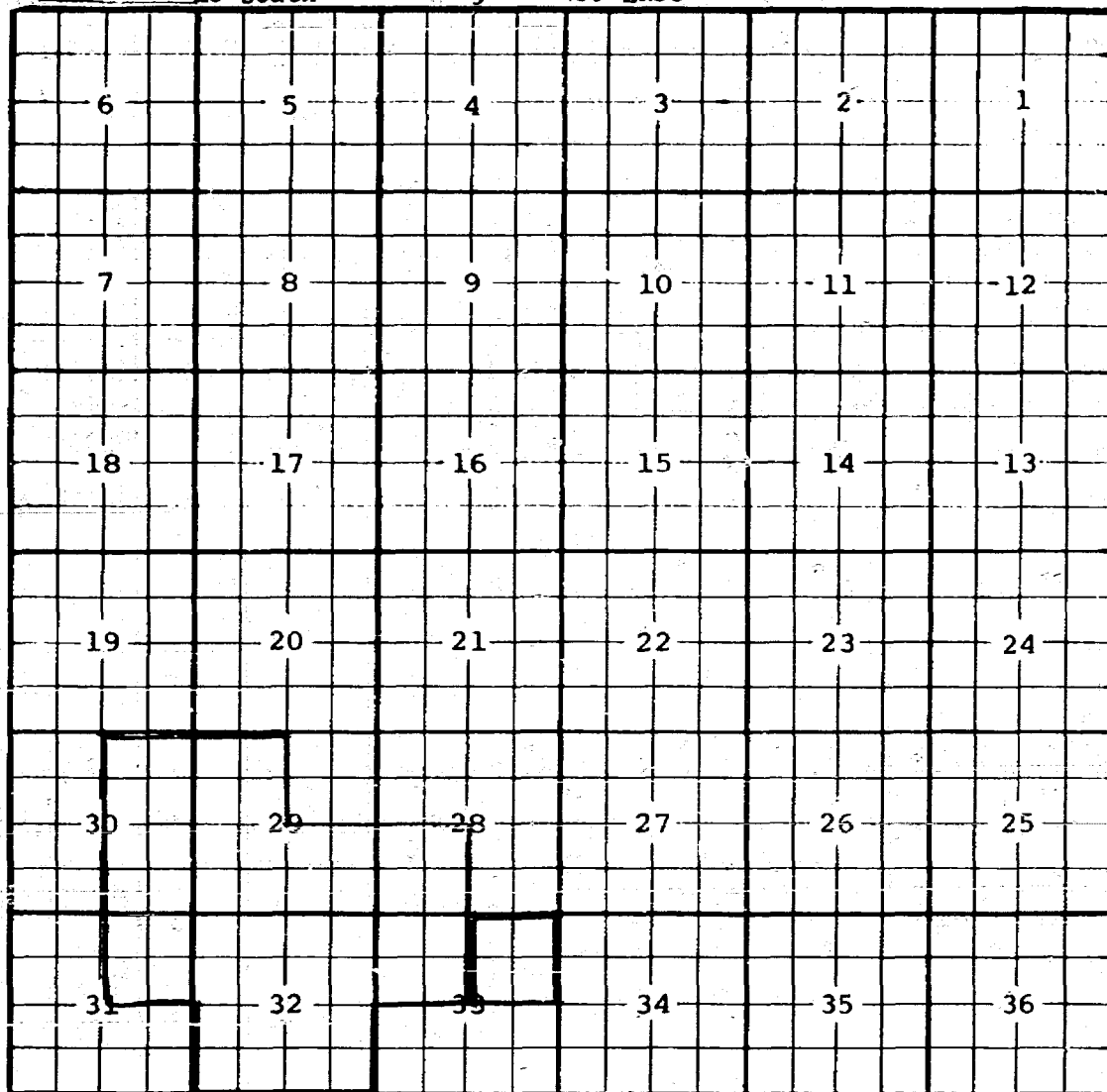

PURPOSE: One completed oil well capable of producing.

GULF OIL CORPORATION - W. D. Grimes (NCT-B) #7 in Unit B of Section 33-18-38. Completed in Blinebry on March 20, 1970. Top of Pool 5848'.

Pool boundary colored in red.

Proposed pool extension colored in green. SECTION 33: NE/4

CASE 4356: (j) EXTENSION OF AN EXISTING OIL POOL (Continued on next page)

County LEA Pool LEA-BONE SPRINGS

TOWNSHIP 19 South Range 34 East NMPM

6	5	4	3	2	1
7	8	9	10	11	12
18	17	16	15	14	13
19	20	21	22	23	24
30	29	28	27	26	25
31	32	33	34	35	36

PURPOSE: One completed oil well capable of producing.

PENNZOIL UNITED, INC. - Mescalero Ridge Unit #2 in Unit J of Section 35-19-34. Completed in Bone Spring on February 5, 1970. Top of Perforations 9672'.

Pool boundary colored in red.

Proposed pool extensions colored in green. SECTION 35: SE/4

CASE 4356: (j) EXTENSION OF AN EXISTING OIL POOL (Continued)

County LEA Pool LEA-BONE SPRINGS

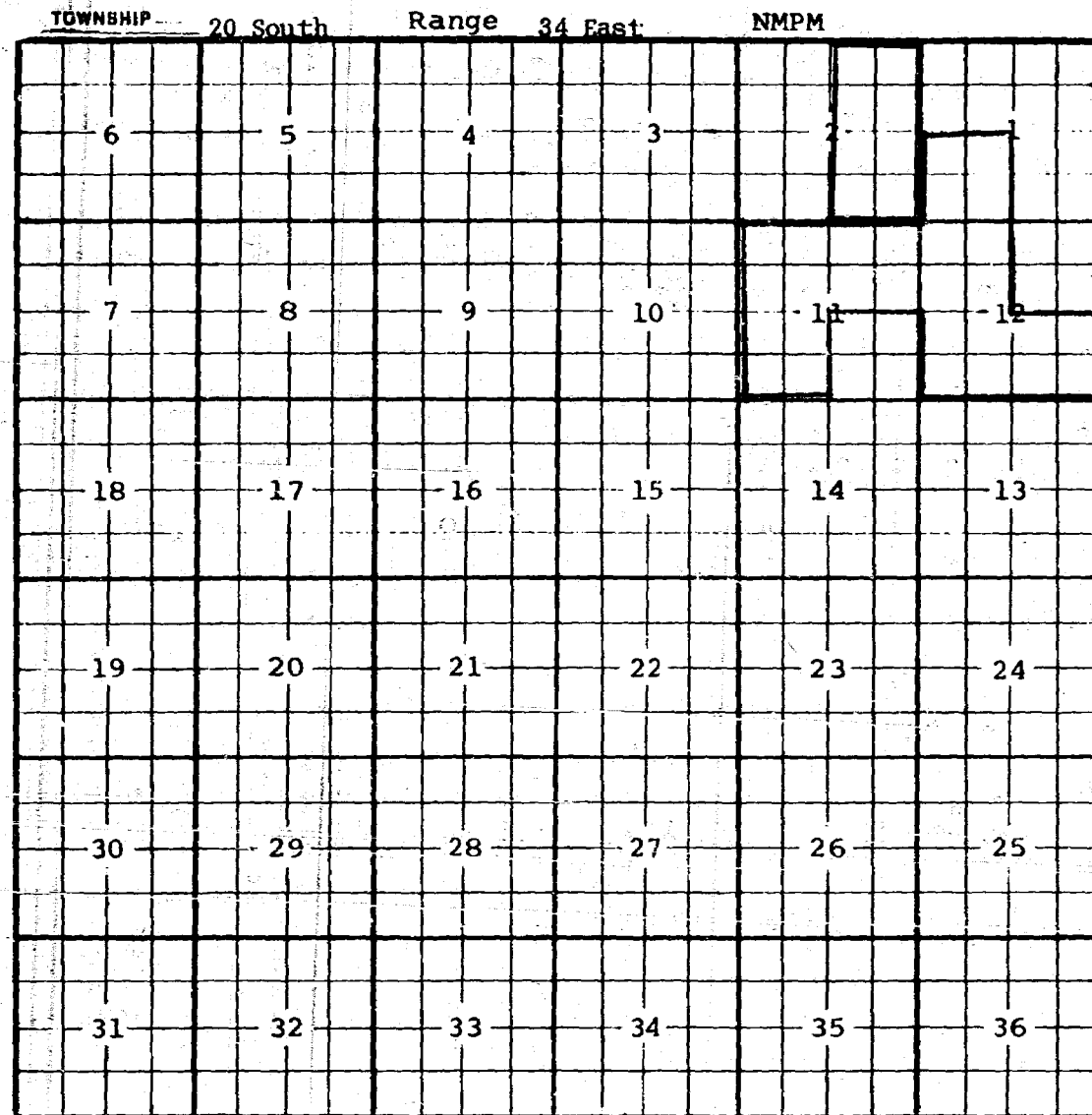

PURPOSE: As stated on preceding page, paragraph (j), Exhibit I.

Pool boundary colored in red.

Proposed pool extension colored in green. SECTION 2: E/2

CASE 4356: (k) EXTENSION OF AN EXISTING GAS POOL

COUNTY EDDY POOL ROCK TANK-LOWER MORROW

TOWNSHIP 23S RANGE 24E NMFM

6	5	4	3	2	1
7	8	9	10	11	12
18	17	16	15	14	13
19	20	21	22	23	24
30	29	28	27	26	25
31	32	33	34	35	36

Purpose: One completed gas well capable of producing.

Gulf Oil Corporation, Boothe B0 Federal Well No.1 in unit K of Section 12-23-24. Completed in Lower Morrow March 3, 1970, through perforations 10230' to 10262'.

Pool boundary colored in red.

Proposed extension colored in green.

Section 12: ALL

CASE 4356: (1) EXTENSION OF AN EXISTING GAS POOL
COUNTY EDDY POOL ROCK TANK-UPPER MORROW

COUNTY	EDDY	POOL	ROCK TANK-UPPER MORROW
--------	------	------	------------------------

TOWNSHIP 23S RANGE 24E NMPM

A 6x6 grid with numbers 1 through 36. The numbers are arranged in a boustrophedon pattern, starting from the top right (1) and ending at the bottom left (36). A 2x2 area in the top right corner, containing cells 12, 13, 11, and 14, is highlighted with a thick black border. The grid is composed of 36 small squares arranged in 6 rows and 6 columns. The numbers are placed in the center of each square. The numbers are: Row 1: 6, 5, 4, 3, 2, 1; Row 2: 7, 8, 9, 10, 11, 12; Row 3: 18, 17, 16, 15, 14, 13; Row 4: 19, 20, 21, 22, 23, 24; Row 5: 30, 29, 28, 27, 26, 25; Row 6: 31, 32, 33, 34, 35, 36. The 2x2 area in the top right corner (cells 12, 13, 11, 14) is highlighted with a thick black border.

Purpose: One completed gas well capable of producing.

Gulf Oil Corporation, Boothe BO Federal Well No.1 in unit K of
Section 12-23-24. Completed in Upper Morrow March 3, 1970,
through perforations 9926' to 10,072'.

Pool boundary colored in red.

Proposed extension colored in green.

Section 12: ALL

CASE 4356: (m) EXTENSION OF AN EXISTING OIL POOL

County LEA Pool TULK-PENNSYLVANIAN

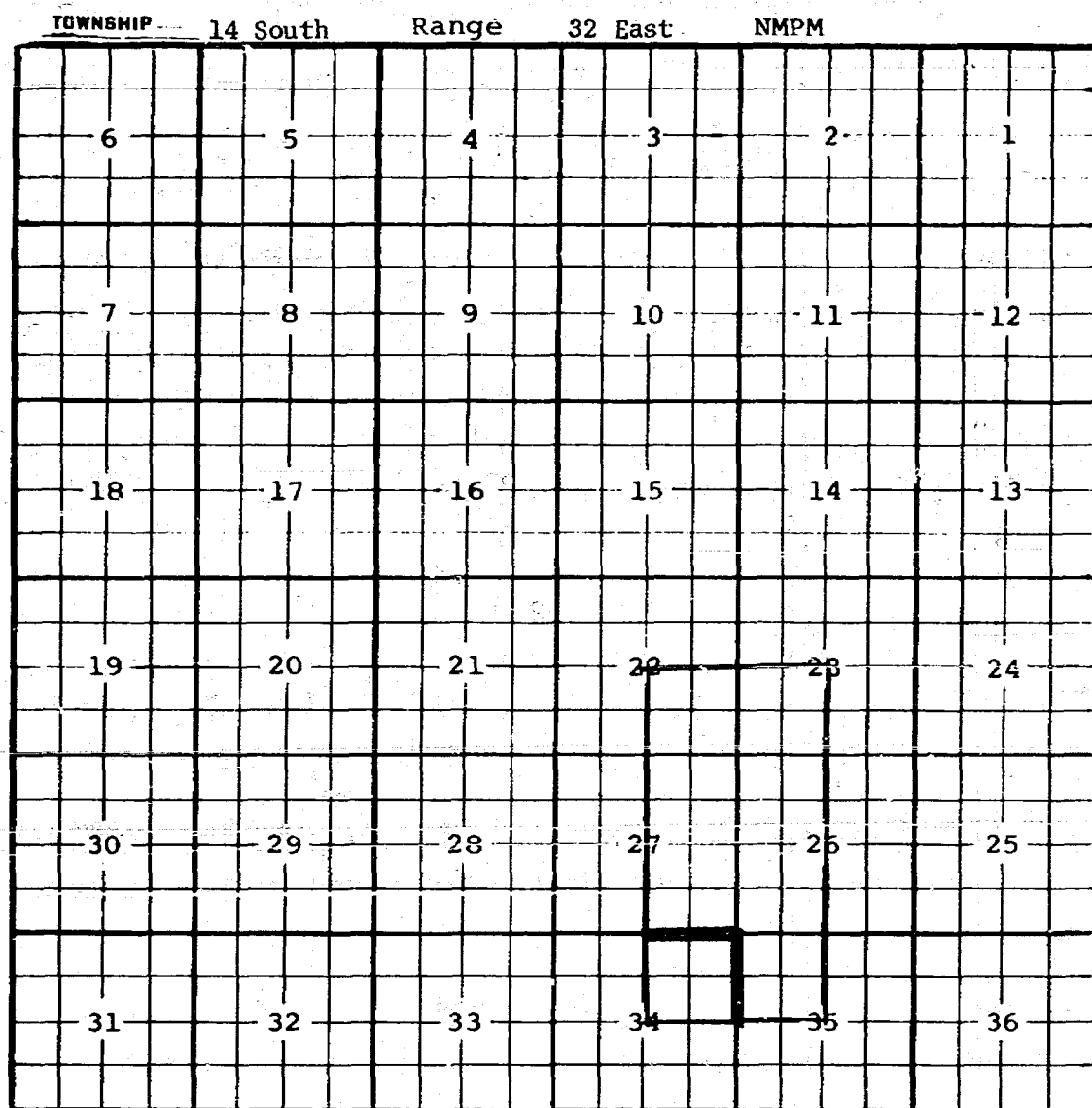

PURPOSE: One completed oil well capable of producing.

COASTAL STATES GAS PRODUCING COMPANY - State "34" #1 in Unit H of Section 34-14-32. Completed in Pennsylvanian on April 1, 1970. Top of Perforations 9744'.

Pool boundary colored in red.

Proposed pool extension colored in green. SECTION 34: NE/4

CASE 4356: (n) EXTENSION OF AN EXISTING OIL POOL

County LEA Pool TULK-WOLFCAMP

TOWNSHIP 15 South Range 32 East NMPM

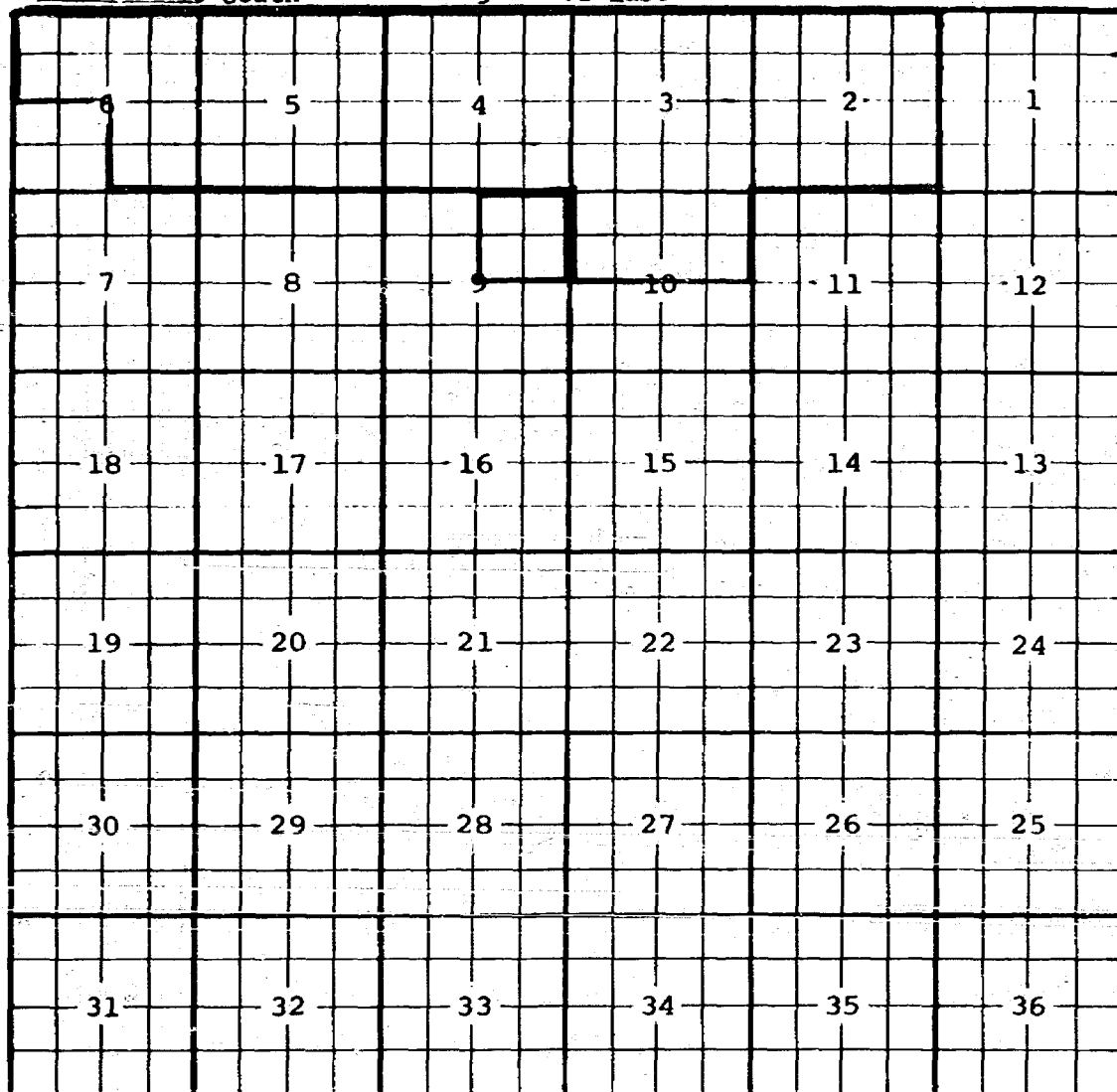

PURPOSE: One completed oil well capable of producing.

SUN OIL COMPANY - New Mexico "T" State Oil Com #1 in Unit B of Section 9-15-32. Completed in Wolfcamp on February 10, 1970. Top of Perforations 9800'.

Pool boundary colored in red.

Proposed pool extension colored in green. SECTION 9: NE/4

NOMENCLATURE ADVERTISEMENT FOR MAY, 1970

CASE 4356

In the matter of the application of the Oil Conservation Commission of New Mexico upon its own motion for an order for the creation of new pools in Lea County, New Mexico, the abolishment of an existing pool in Roosevelt County, New Mexico, the contraction of an existing pool in Lea County, New Mexico, and the extension of certain existing pools in Chaves, Eddy, Lea, and Roosevelt Counties, New Mexico, and giving notice to all persons and parties interested in the subject matter thereof to appear and show cause why such creations, abolishments, contractions, and extensions should not be made.

a) CREATE A new pool in Lea County, New Mexico, classified as a gas pool for Morrow production and designated as the Baum-Morrow Gas Pool. The discovery well is RK Petroleum Corporation, State No. 1 located in Unit B of Section 27, Township 13 South, Range 32 East, NMPM. Said pool ~~described as~~ *would comprise:*

TOWNSHIP 13 SOUTH, RANGE 32 EAST, NMPM
SECTION 27: N/2

b) CREATE A new pool in Lea County, New Mexico, classified as a gas pool for Queen-Penrose production and designated as the East Querecho Plains-Queen Gas Pool. The discovery well is Robert N. Enfield; Hudson Federal No. 1 located in Unit O of Section 30, Township 18 South, Range 33 East, NMPM. Said pool ~~described as~~ *would comprise:*

TOWNSHIP 18 SOUTH, RANGE 33 EAST, NMPM
SECTION 30: SE/4

c) ABOLISH the Bluitt-San Andres Pool in Roosevelt County, New Mexico, described as:

TOWNSHIP 8 SOUTH, RANGE 38 EAST, NMPM
SECTION 7: All
SECTION 8: All
SECTION 17: All
SECTION 18: All

d) EXTEND the Bluitt-San Andres Associated Pool in Roosevelt County, New Mexico, to include therein:

TOWNSHIP 8 SOUTH, RANGE 38 EAST, NMPM
SECTION 8: S/2
SECTION 17: W/2

e) CONTRACT the Bagley-Pennsylvanian Pool in Lea County, New Mexico, by the deletion of the following described area:

TOWNSHIP 12 SOUTH, RANGE 33 EAST, NMPM
SECTION 4: NE/4

f) EXTEND the North Bagley-Upper Pennsylvanian Pool in Lea County, New Mexico, to include therein:

TOWNSHIP 11 SOUTH, RANGE 33 EAST, NMPM
SECTION 33: E/2

TOWNSHIP 12 SOUTH, RANGE 33 EAST, NMPM
SECTION 4: NE/4

g) EXTEND the Cerca-Upper Pennsylvanian Pool in Lea County, New Mexico, to include therein:

✓ TOWNSHIP 13 SOUTH, RANGE 34 EAST, NMPM
SECTION 34: NW/4 ✓

✓ TOWNSHIP 14 SOUTH, RANGE 34 EAST, NMPM
SECTION 8: NW/4

h) EXTEND the Double L-Queen Pool in Chaves County, New Mexico, to include therein:

✓ TOWNSHIP 15 SOUTH, RANGE 29 EAST, NMPM
SECTION 12: E/2 NE/4 ✓

i) EXTEND the Hobbs-Blinebry Pool in Lea County, New Mexico, to include therein:

✓ TOWNSHIP 18 SOUTH, RANGE 38 EAST, NMPM
SECTION 33: NE/4 ✓

j) EXTEND the Lea-Bone Springs Pool in Lea County, New Mexico, to include therein:

✓ TOWNSHIP 19 SOUTH, RANGE 34 EAST, NMPM
SECTION 35: SE/4 ✓

✓ TOWNSHIP 20 SOUTH, RANGE 34 EAST, NMPM
SECTION 2: E/2

k) EXTEND the Rock Tank-Lower Morrow Gas Pool in Eddy County, New Mexico, to include therein:

✓ TOWNSHIP 23 SOUTH, RANGE 24 EAST, NMPM
SECTION 12: All ✓

l) EXTEND the Rock Tank-Upper Morrow Gas Pool in Eddy County, New Mexico, to include therein:

✓ TOWNSHIP 23 SOUTH, RANGE 24 EAST, NMPM
SECTION 12: All ✓

m) EXTEND the Tulk-Pennsylvanian Pool in Lea County, New Mexico, to include therein:

✓ TOWNSHIP 14 SOUTH, RANGE 32 EAST, NMPM
SECTION 34: NE/4 ✓

n) EXTEND the Tulk-Wolfcamp Pool in Lea County, New Mexico, to include therein:

✓ TOWNSHIP 15 SOUTH, RANGE 32 EAST, NMPM
SECTION 9: NE/4 ✓

(4) That there is need for the consolidation of the Bluitt-San Andres Pool and the Bluitt-San Andres Associated Pool, both in Roosevelt County, New Mexico, inasmuch as both pools are producing from one common source of supply. Said consolidation to be accomplished by the abolishment of the Bluitt-San Andres Pool and the extension of the Bluitt-San Andres Associated Pool.

IN THE MATTER OF THE HEARING
CALLED BY THE OIL CONSERVATION
COMMISSION OF NEW MEXICO FOR
THE PURPOSE OF CONSIDERING:

CASE NO. 4356
ORDER NO. R- 3964

THE APPLICATION OF THE OIL CONSERVATION
COMMISSION UPON ITS OWN MOTION FOR AN
ORDER CREATING, ABOLISHING, CONTRACTING,
AND EXTENDING CERTAIN POOLS IN CHAVES,
EDDY, LEA, AND ROOSEVELT COUNTIES, NEW
MEXICO.

ORDER OF THE COMMISSION

BY THE COMMISSION:

This cause came on for hearing at 9:00 a.m. on May 13, 1970, at Santa Fe, New Mexico, before the Oil Conservation Commission of New Mexico, hereinafter referred to as the "Commission".

NOW, on this day of May, 1970, the Commission, a quorum being present, having considered the testimony presented and the exhibits received at said hearing, and being fully advised in the premises,

FINDS:

(1) That due public notice having been given as required by law, the Commission has jurisdiction of this cause and the subject matter thereof.

✓ (2) That there is need for the creation of a new gas pool in Lea County, New Mexico, for the production of gas from the Morrow Sand formation, said pool to bear the designation of Baum-Morrow Gas Pool. Said Baum-Morrow Gas Pool was discovered by the RK Petroleum Corporation State Well No. 1, located in Unit B of Section 27, Township 13 South, Range 32 East, NMPM. It was completed in the Morrow Sand formation on September 24, 1969. The top of the perforations is at 10,593 feet.

✓ (3) That there is need for the creation of a new gas pool in Lea County, New Mexico, for the production of gas from the Queen Penrose formation, said pool to bear the designation of East Querecho Plains-Queen Gas Pool. Said East Querecho Plains-Queen Gas Pool was discovered by the Robert N. Enfield Hudson Federal Well No. 1, located in Unit 0 of Section 30, Township 18 South, Range 33 East, NMPM. It was completed in the Queen Penrose formation on May 3, 1963. The depth to the casing shoe is 4330 feet.

(4) That ~~there is need for the abolishment of the Bluitt-San Andres Pool in Roosevelt County, New Mexico, because said pool is now abandoned and partly overlaps with the Bluitt-San Andres Associated Pool. The abolished acreage is to be placed in the Bluitt-San Andres Associated Pool.~~ *See note*

✓ (5) That there is need for the contraction of the Bagley-Pennsylvanian Pool in Lea County, New Mexico, by the deletion of certain acreage because said acreage overlaps with the North Bagley-Upper Pennsylvanian Pool. The deleted acreage is to be placed in the North Bagley-Upper Pennsylvanian Pool.

(6) That there is need for certain extensions to the Double L-Queen Pool in Chaves County, New Mexico, the Rock Tank-Lower Morrow Gas Pool and the Rock Tank-Upper Morrow Gas Pool, both in Eddy County, New Mexico, the North Bagley-Upper Pennsylvanian Pool, the Cerca-Upper Pennsylvanian Pool, the Hobbs-Blinebry Pool, the Lea-Bone Springs Pool, the Tulk-Pennsylvanian Pool, and the Tulk-Wolfcamp Pool, all in Lea County, New Mexico, and the ~~Bluitt-San Andres Associated Pool in Roosevelt County, New Mexico.~~

IT IS THEREFORE ORDERED:

(a) That a new pool in Lea County, New Mexico, classified as a gas pool for Morrow Sand production, is hereby created and designated as the Baum-Morrow Gas Pool, consisting of the following described area:

✓ TOWNSHIP 13 SOUTH, RANGE 32 EAST, NMPM
SECTION 27: N/2

(b) That a new pool in Lea County, New Mexico, classified as a gas pool for Queen Penrose production, is hereby created and designated as the East Querecho Plains-Queen Gas Pool, consisting of the following described area:

✓ TOWNSHIP 18 SOUTH, RANGE 33 EAST, NMPM
SECTION 30: SE/4

(c) That the Bluitt-San Andres Pool in Roosevelt County, New Mexico, consisting of the following described area:

✓ TOWNSHIP 8 SOUTH, RANGE 38 EAST, NMPM
SECTION 7: All
SECTION 8: All
SECTION 17: All
SECTION 18: All

is hereby abolished.

(d) That the Bluitt-San Andres Associated Pool in Roosevelt County, New Mexico, as heretofore classified, defined, and described, is hereby extended to include therein:

✓ TOWNSHIP 8 SOUTH, RANGE 38 EAST, NMPM
SECTION 8: S/2
SECTION 17: W/2

(e) That the Bagley-Pennsylvanian Pool in Lea County, New Mexico, as heretofore classified, defined, and described, is hereby contracted by the deletion of the following described area:

✓ TOWNSHIP 12 SOUTH, RANGE 33 EAST, NMPM
SECTION 4: NE/4

(f) That the North Bagley-Upper Pennsylvanian Pool in Lea County, New Mexico, as heretofore classified, defined, and described, is hereby extended to include therein:

✓ TOWNSHIP 11 SOUTH, RANGE 33 EAST, NMPM
SECTION 33: E/2

✓ TOWNSHIP 12 SOUTH, RANGE 33 EAST, NMPM
SECTION 4: NE/4

(g) That the Cerca-Upper Pennsylvanian Pool in Lea County, New Mexico, as heretofore classified, defined, and described, is hereby extended to include therein:

✓ TOWNSHIP 13 SOUTH, RANGE 34 EAST, NMPM
SECTION 34: NW/4

✓ TOWNSHIP 14 SOUTH, RANGE 34 EAST, NMPM
SECTION 8: NW/4

(h) That the Double L-Queen Pool in Chaves County, New Mexico, as heretofore classified, defined, and described, is hereby extended to include therein:

✓ TOWNSHIP 15 SOUTH, RANGE 29 EAST, NMPM
SECTION 12: E/2 NE/4

✓ TOWNSHIP 15 SOUTH, RANGE 30 EAST, NMPM
SECTION 6: N/2

(i) That the Hobbs-Blinbry Pool in Lea County, New Mexico, as heretofore classified, defined, and described, is hereby extended to include therein:

✓ TOWNSHIP 18 SOUTH, RANGE 38 EAST, NMPM
SECTION 33: NE/4

(j) That the Lea-Bone Springs Pool in Lea County, New Mexico, as heretofore classified, defined, and described, is hereby extended to include therein:

✓ TOWNSHIP 19 SOUTH, RANGE 34 EAST, NMPM
SECTION 35: SE/4

✓ TOWNSHIP 20 SOUTH, RANGE 34 EAST, NMPM
SECTION 2: E/2

(k) That the Rock Tank-Lower Morrow Gas Pool in Eddy County, New Mexico, as heretofore classified, defined, and described, is hereby extended to include therein:

✓ TOWNSHIP 23 SOUTH, RANGE 24 EAST, NMPM
SECTION 12: All

(l) That the Rock Tank-Upper Morrow Gas Pool in Eddy County, New Mexico, as heretofore classified, defined, and described, is hereby extended to include therein:

✓ TOWNSHIP 23 SOUTH, RANGE 24 EAST, NMPM
SECTION 12: All

(m) That the Tulk-Pennsylvanian Pool in Lea County, New Mexico, as heretofore classified, defined, and described, is hereby extended to include therein:

✓ TOWNSHIP 14 SOUTH, RANGE 32 EAST, NMPM
SECTION 34: NE/4

(n) That the Tulk-Wolfcamp Pool in Lea County, New Mexico, as heretofore classified, defined, and described, is hereby extended to include therein:

✓ TOWNSHIP 15 SOUTH, RANGE 32 EAST, NMPM
SECTION 9: NE/4

IT IS FURTHER ORDERED:

(1) That, pursuant to Section 65-3-14.5, NMSA 1953, contained in Chapter 271, Laws of 1969, any well which, by virtue of any of the above pool extensions, is subject to pool rules providing for spacing or proration units larger than the one which is presently dedicated thereto, shall have 60 days from the effective date of this order in which to file new Forms C-102 dedicating a standard unit for the pool to said well, or to obtain a non-standard unit approved by the Commission. Pending such compliance, the well shall receive a maximum allowable in the same proportion to a standard allowable for the pool that the acreage dedicated to the well bears to a standard unit for the pool. Failure to file Forms C-102 dedicating a standard unit to the well or to obtain a non-standard unit approved by the Commission within said 60-day period shall subject the well to cancellation of allowable.

✓ (2) That the effective date of this order and all creations, abolishments, contractions, and extensions included herein shall be June 1, 1970.

DONE at Santa Fe, New Mexico, on the day and year hereinabove designated.

STATE OF NEW MEXICO
OIL CONSERVATION COMMISSION

DAVID F. CARGO, Chairman

ALEX ARMIJO, Member

A. L. PORTER, Jr., Member & Secretary

S E A L

CASE 4357: Appli. of STALLWORTH
OIL & GAS FOR AN UNORTHODOX OIL
WELL LOCATION, EDDY COUNTY.

Deviations