

NEW MEXICO
GILBERT TROTTING, RIO ARriba COUNTY,

DOCKET MAILED

Dec 9/25/81

Case No.

7370

Application

Transcripts.

Small Exhibits

ETC

STATE OF NEW MEXICO
ENERGY AND MINERALS DEPARTMENT
OIL CONSERVATION DIVISION
STATE LAND OFFICE BLDG.
SANTA FE, NEW MEXICO
7 October 1981

EXAMINER HEARING

IN THE MATTER OF:

Application of Southland Royalty
Company for compulsory pooling,
Rio Arriba County, New Mexico.

CASE
7370

BEFORE: Daniel S. Nutter

TRANSCRIPT OF HEARING

A P P E A R A N C E S

For the Oil Conservation
Division:

W. Perry Pearce, Esq.
Legal Counsel to the Division
State Land Office Bldg.
Santa Fe, New Mexico 87501

For the Applicant:

MR. NUTTER: Call Case Number 7370.

MR. PEARCE: Application of Southland
Royalty Company for compulsory pooling, Rio Arriba County,
New Mexico.

MR. CARR: May it please the Examiner,
Southland Royalty Company requests that this case be dismissed.

MR. NUTTER: Case 7370 will be dismissed.

(Hearing concluded.)

C E R T I F I C A T E

I, SALLY W. BOYD, C.S.R., DO HEREBY CERTIFY that the foregoing Transcript of Hearing before the Oil Conservation Division was reported by me; that the said transcript is a full, true, and correct record of the hearing, prepared by me to the best of my ability.

Sally W. Boyd CSR

I do hereby certify that the foregoing is a complete record of the proceedings in the Examiner hearing of Case No. 7372, heard by me on 10/7 1981

[Signature], Examiner
Oil Conservation Division

SALLY W. BOYD, C.S.R.

Rt. 1 Box 193-B

Sanita Fe, New Mexico 87501

Phone (505) 455-7409



STATE OF NEW MEXICO
ENERGY AND MINERALS DEPARTMENT
OIL CONSERVATION DIVISION

BRUCE KING
GOVERNOR
LARRY KEHOE
SECRETARY

POST OFFICE BOX 2088
STATE LAND OFFICE BUILDING
SANTA FE, NEW MEXICO 87501
(505) 827-2434

October 16, 1981

Mr. William F. Carr
Campbell, Byrd & Black
Attorneys at Law
Post Office Box 2208
Santa Fe, New Mexico 87501

Re: CASE NO. 7370
ORDER NO. R-6906

Applicant:

~~Southland Royalty Company~~

Dear Sir:

Enclosed herewith are two copies of the above-referenced
Division order recently entered in the subject case.

Yours very truly,

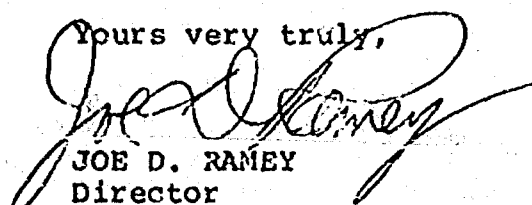
JOE D. RAMEY
Director

JDR/fd

Copy of order also sent to:

Hobbs OCD _____
Artesia OCD _____
Aztec OCD _____

Other _____

STATE OF NEW MEXICO
ENERGY AND MINERALS DEPARTMENT
OIL CONSERVATION DIVISION

IN THE MATTER OF THE HEARING
CALLED BY THE OIL CONSERVATION
DIVISION FOR THE PURPOSE OF
CONSIDERING:

CASE NO. 7370
Order No. R-6806

APPLICATION OF SOUTHLAND ROYALTY
COMPANY FOR COMPULSORY POOLING,
RIO ARriba COUNTY, NEW MEXICO.

ORDER OF THE DIVISION

BY THE DIVISION:

This cause came on for hearing at 9 a.m. on October 7, 1981, at Santa Fe, New Mexico, before Examiner Daniel S. Nutter.

NOW, on this 15th day of October, 1981, the Division Director, having considered the record and the recommendations of the Examiner, and being fully advised in the premises,

FINDS:

That the applicant's request for dismissal should be granted.

IT IS THEREFORE ORDERED:

That Case No. 7370 is hereby dismissed.

DONE at Santa Fe, New Mexico, on the day and year hereinabove designated.

STATE OF NEW MEXICO
OIL CONSERVATION DIVISION



JOE D. RAMEY,
Director

Dockets Nos. 31-81 and 34-81 are tentatively set for October 21 and November 4, 1981. Applications for hearing must be filed at least 22 days in advance of hearing date.

DOCKET: COMMISSION HEARING - MONDAY - OCTOBER 5, 1981

OIL CONSERVATION COMMISSION - 9 A.M.
ROOM 205, STATE LAND OFFICE BUILDING,
SANTA FE, NEW MEXICO

BEST AVAILABLE COPY

CASE 7372: Application of Navajo Refining Company for a determination of preference to purchase state royalty oil pursuant to Section 19-10-68, NMSA, 1978.

Docket No. 32-81

DOCKET: EXAMINER HEARING - WEDNESDAY - OCTOBER 7, 1981

9 A.M. - OIL CONSERVATION DIVISION CONFERENCE ROOM
STATE LAND OFFICE BUILDING, SANTA FE, NEW MEXICO

The following cases will be heard before Daniel S. Mutter, Examiner, or Richard L. Stamets, Alternate Examiner:

- CASE 7363: Application of Gulf Oil Corporation for a unit agreement, Chaves County, New Mexico. Applicant, in the above-styled cause, seeks approval for the East White Ranch Unit Area, comprising 1920 acres, more or less, of Federal lands in Township 13 South, Range 30 East.
- CASE 7364: Application of Gulf Oil Corporation for a unit agreement, Eddy County, New Mexico. Applicant, in the above-styled cause, seeks approval for the East Chosa Draw Unit Area comprising 5120 acres, more or less, of Federal and State lands in Township 25 South, Range 25 East.
- CASE 7365: Application of Yates Petroleum Corporation for the amendment of Order R-6406, Eddy County, New Mexico. Applicant, in the above-styled cause, seeks the amendment of Order No. R-6406, to permit recompletion of its State "JM" No. 2 Well, drilled at an unorthodox Morrow location 660 feet from the South line and 660 feet from the East line of said Section 25, Township 18 South, Range 24 East, in any and all Wolfcamp and Pennsylvanian pays in said well.
- CASE 7354: (Continued from the September 23, 1981, Examiner Hearing)
Application of Corona Oil Company, for a pilot steam-enhanced oil recovery project, Guadalupe County, New Mexico. Applicant, in the above-styled cause, seeks authority to institute a pilot steam-enhanced oil recovery project in the Santa Rosa formation by using two existing wells and three additional wells to be drilled to complete a five spot pattern located in the NE/4 NW/4 of Section 17, Township 11 North, Range 26 East.
- CASE 7352: (Continued from the September 23, 1981 Examiner Hearing)
Application of Energy Reserves Group for creation of a new gas pool and an unorthodox location, Roosevelt County, New Mexico. Applicant, in the above-styled cause, seeks creation of a new Cisco gas pool for its Miller Com Well No. 1, located in Unit M of Section 12, Township 6 South, Range 33 East. Applicant further seeks approval of an unorthodox location for its Miller "A" Well No. 1-Y, to be drilled 1800 feet from the South line and 1700 feet from the East line of Section 11 of the same township. The S/2 of said Section 11 to be dedicated to the well.
- CASE 7366: Application of Read & Stevens, Inc., for compulsory pooling, Eddy County, New Mexico. Applicant, in the above-styled cause, seeks an order pooling all mineral interests in the Strawn, Atoka and Morrow formations underlying the W/2 of Section 19, Township 23 South, Range 28 East, to be dedicated to a well to be drilled at a standard location thereon. Also to be considered will be the cost of drilling and completing said well and the allocation of the cost thereof as well as actual operating costs and charges for supervision, designation of applicant as operator of the well, and a charge for risk involved in drilling said well.
- CASE 7367: Application of Anadarko Production Company for compulsory pooling, Eddy County, New Mexico. Applicant, in the above-styled cause, seeks an order pooling all mineral interests in the Wolfcamp and Pennsylvanian formations underlying the N/2 of Section 12, Township 19 South, Range 25 East, to be dedicated to a well to be drilled at a standard location thereon. Also to be considered will be the cost of drilling and completing said well and the allocation of the cost thereof as well as actual operating costs and charges for supervision, designation of applicant as operator of the well, and a charge for risk involved in drilling said well.

BEST AVAILABLE COPY

CASE 7368: Application of Doyle Hartman for an unorthodox gas well location, Lea County, New Mexico. Applicant, in the above-styled cause, seeks approval for the unorthodox location of a well to be drilled 1980 feet from the South line and 990 feet from the West line of Section 17, Township 24 South, Range 37 East, Jalmat Gas Pool, the S/2 of said Section 17 to be dedicated to the well.

CASE 7369: Application of Morris R. Antwell for compulsory pooling, Lea County, New Mexico. Applicant, in the above-styled cause, seeks an order pooling all mineral interests in the Blinebry and Drinkard formations underlying the NW/4 SE/4 of Section 8, Township 20 South, Range 38 East, to be dedicated to a well to be drilled at a standard location thereon. Also to be considered will be the cost of drilling and completing said well and the allocation of the cost thereof as well as actual operating costs and charges for supervision, designation of applicant as operator of the well, and a charge for risk involved in drilling said well.

CASE 7370: Application of Southland Royalty Company for compulsory pooling, Rio Arriba County, New Mexico. Applicant, in the above-styled cause, seeks an order pooling all mineral interests in the Pictured Cliffs and Fruitland formations, East Blanco Field, underlying the NW/4 of Section 35, Township 30 North, Range 4 West, to be dedicated to a well to be drilled at a standard location thereon. Also to be considered will be the cost of drilling and completing said well and the allocation of the cost thereof as well as actual operating costs and charges for supervision, designation of applicant as operator of the well, and a charge for risk involved in drilling said well.

CASE 7023: (Reopened and Readvertised)

In the matter of case 7023 being reopened pursuant to the provisions of Order No. R-6489, which order created the Stingray-Pennsylvanian Pool and promulgated special rules therefor, including provision for 80-acre spacing. All interested parties may appear and show cause why said pool should not be developed on 40-acre proration units.

CASE 7347: (Continued and Readvertised)

Application of Tenneco Oil Company for an unorthodox gas well location, Lea County, New Mexico. Applicant, in the above-styled cause, seeks approval for the unorthodox Pennsylvanian location of a well to be drilled 660 feet from the South line and 860 feet from the West line of Section 20, Township 16 South, Range 34 East, Kemnitz Field, the W/2 of said Section 20 to be dedicated to the well.

CASE 7371: In the matter of the hearing called by the Oil Conservation Division on its own motion for an order creating, redesignating, extending vertical limits, and contracting and extending horizontal limits of certain pools in Chaves, Eddy, Lea, and Roosevelt Counties, New Mexico.

(a) CREATE a new pool in Lea County, New Mexico, classified as an oil pool for Wolfcamp production and designated as the Antelope Ridge-Wolfcamp Pool. The discovery well is Coquina Oil Corporation Alexander Well No. 1 located in Unit G of Section 10, Township 24 South, Range 34 East, NMPM. Said pool would comprise:

TOWNSHIP 24 SOUTH, RANGE 34 EAST, NMPM
Section 10: NE/4

(b) CREATE a new pool in Lea County, New Mexico, classified as an oil pool for Bone Spring production and designated as the Brinninstool-Bone Spring Pool. The discovery well is Amoco Production Company State IK Well No. 1 located in Unit C of Section 10, Township 23 South, Range 33 East, NMPM. Said pool would comprise:

TOWNSHIP 23 SOUTH, RANGE 33 EAST, NMPM
Section 10: NW/4

(c) CREATE a new pool in Lea County, New Mexico, classified as an oil pool for Wolfcamp production and designated as the Brinninstool-Wolfcamp Pool. The discovery well is Amoco Production Company Federal H Well No. 1 located in Unit L of Section 26, Township 23 South, Range 33 East, NMPM. Said pool would comprise:

TOWNSHIP 23 SOUTH, RANGE 33 EAST, NMPM
Section 26: SW/4

(d) CREATE a new pool in Eddy County, New Mexico, classified as a gas pool for Wolfcamp production and designated as the Collins Ranch-Wolfcamp Gas Pool. The discovery well is the Yates Petroleum Corporation State DP Well No. 1 located in Unit D of Section 35, Township 17 South, Range 24 East, NMPM. Said pool would comprise:

TOWNSHIP 17 SOUTH, RANGE 24 EAST, NMPM
Section 35: N/2

(e) CREATE a new pool in Lea County, New Mexico, classified as a gas pool for Atoka production and designated as the Fairview Mills-Atoka Gas Pool. The discovery well is the Enserch Exploration, Inc. T. G. Bates Well No. 1 located in Unit C of Section 14, Township 25 South, Range 34 East, NMPM. Said pool would comprise:

TOWNSHIP 25 SOUTH, RANGE 34 EAST, NMPM
Section 14: N/2

(f) CREATE a new pool in Lea County, New Mexico, classified as an oil pool for Wolfcamp production and designated as the Gem-Wolfcamp Pool. The discovery well is the Amoco Production Company Federal AW Well No. 1 located in Unit E of Section 26, Township 19 South, Range 32 East, NMPM. Said pool would comprise:

TOWNSHIP 19 SOUTH, RANGE 32 EAST, NMPM
Section 26: NW/4

(g) CREATE a new pool in Lea County, New Mexico, classified as an oil pool for Tubb production and designated as the Hardy-Tubb Pool. The discovery well is the Conoco Inc. State F Well No. 10 located in Unit V of Section 1, Township 21 South, Range 36 East, NMPM. Said pool would comprise:

TOWNSHIP 21 SOUTH, RANGE 36 EAST, NMPM
Section 1: SW/4

(h) CREATE a new pool in Chaves County, New Mexico, classified as a gas pool for Upper Pennsylvanian production and designated as the Moriah-Upper Pennsylvanian Gas Pool. The discovery well is the Tom L. Ingram Moriah Well No. 2 located in Unit J of Section 7, Township 10 South, Range 29 East, NMPM. Said pool would comprise:

TOWNSHIP 10 SOUTH, RANGE 29 EAST, NMPM
Section 7: S/2

(i) CREATE a new pool in Chaves County, New Mexico, classified as a gas pool for Atoka production and designated as the Moriah-Atoka Gas Pool. The discovery well is the Tom L. Ingram Moriah Well No. 1 located in Unit J of Section 7, Township 10 South, Range 29 East, NMPM. Said pool would comprise:

TOWNSHIP 10 SOUTH, RANGE 29 EAST, NMPM
Section 7: S/2

(j) CREATE a new pool in Lea County, New Mexico, classified as a gas pool for Queen production and designated as the West Reeves-Queen Gas Pool. The discovery well is the Collier Energy, Inc. Mesa State Well No. 1 located in Unit F of Section 20, Township 18 South, Range 35 East, NMPM. Said pool would comprise:

TOWNSHIP 18 SOUTH, RANGE 35 EAST, NMPM
Section 20: NW/4

(k) CONTRACT the Cato-San Andres Pool in Chaves County, New Mexico, by the deletion of the following described area:

TOWNSHIP 8 SOUTH, RANGE 31 EAST, NMPM
Section 5: NW/4 SW/4

(l) CONTRACT the East Weir-Blinebry Pool in Lea County, New Mexico, by the deletion of the following described area:

TOWNSHIP 20 SOUTH, RANGE 38 EAST, NMPM
Section 7: N/2 N/2
Section 8: N/2 N/2
Section 9: W/2 NW/4

(m) EXTEND the vertical limits of the Cave-Grayburg Pool in Eddy County, New Mexico, to include the San Andres formation and redesignate said pool as the Cave-Grayburg-San Andres Pool.

(n) EXTEND the Antelope Sink-Morrow Gas Pool in Eddy County, New Mexico, to include therein:

TOWNSHIP 18 SOUTH, RANGE 24 EAST, NMPM
Section 33: S/2

TOWNSHIP 19 SOUTH, RANGE 24 EAST, NMPM
Section 4: E/2

BEST AVAILABLE COPY

- (o) EXTEND the Atoka-Yeso Pool in Eddy County, New Mexico, to include therein:

TOWNSHIP 18 SOUTH, RANGE 26 EAST, NMPH
Section 27: S/2 NE/4, S/2 NW/4, N/2 SE/4
and N/2 SW/4

- (p) EXTEND the Baum-Upper Pennsylvanian Pool in Lea County, New Mexico, to include therein:

TOWNSHIP 13 SOUTH, RANGE 32 EAST, NMPH
Section 23: SW/4

- (q) EXTEND the Blinbry Oil and Gas Pool in Lea County, New Mexico, to include therein:

TOWNSHIP 22 SOUTH, RANGE 37 EAST, NMPH
Section 16: SW/4

- (r) EXTEND the Boyd-Morrow Gas Pool in Eddy County, New Mexico to include therein:

TOWNSHIP 18 SOUTH, RANGE 25 EAST, NMPH
Section 34: W/2

- (s) EXTEND the Bull's Eye-San Andres Pool in Chaves County, New Mexico, to include therein:

TOWNSHIP 8 SOUTH, RANGE 28 EAST, NMPH
Section 12: NE/4 SW/4 and E/2 NW/4

- (t) EXTEND the East Crossroads-San Andres Pool in Lea County, New Mexico, to include therein:

TOWNSHIP 10 SOUTH, RANGE 37 EAST, NMPH
Section 7: All

- (u) EXTEND the Crow Flats-Morrow Gas Pool in Eddy County, New Mexico, to include therein:

TOWNSHIP 16 SOUTH, RANGE 27 EAST, NMPH
Section 25: E/2
Section 36: E/2

- (v) EXTEND the Culebra Bluff-Atoka Gas Pool in Eddy County, New Mexico, to include therein:

TOWNSHIP 23 SOUTH, RANGE 28 EAST, NMPH
Section 15: W/2

- (w) EXTEND the South Culebra Bluff-Bone Spring Pool in Eddy County, New Mexico, to include therein:

TOWNSHIP 23 SOUTH, RANGE 28 EAST, NMPH
Section 27: N/2 SE/4

- (x) EXTEND the D-K Abo pool in Lea County, New Mexico, to include therein:

TOWNSHIP 20 SOUTH, RANGE 39 EAST, NMPH
Section 31: NW/4

- (y) EXTEND the Happy Valley-Morrow Gas Pool in Eddy County, New Mexico, to include therein:

TOWNSHIP 22 SOUTH, RANGE 26 EAST, NMPH
Section 16: E/2
Section 20: N/2

- (z) EXTEND the East Hightower-Upper Pennsylvanian Pool in Lea County, New Mexico to include therein:

TOWNSHIP 12 SOUTH, RANGE 34 EAST, NMPH
Section 31: NE/4 and E/2 NW/4

- (aa) EXTEND the Imperial-Tubb Drinkard Pool in Lea County, New Mexico, to include therein:

TOWNSHIP 23 SOUTH, RANGE 37 EAST, NMPH
Section 27: NW/4

BEST AVAILABLE COPY

- (bb) EXTEND the Jalmat-Yates-Seven Rivers Pool in Lea County, New Mexico to include therein:

TOWNSHIP 22 SOUTH, RANGE 35 EAST, NMPM
Section 15: NE/4

- (cc) EXTEND the Kemnitz-Morrow Gas Pool in Lea County, New Mexico, to include therein:

TOWNSHIP 16 SOUTH, RANGE 34 EAST, NMPM
Section 9: N/2

- (dd) EXTEND the Linda-San Andres Pool in Chaves County, New Mexico, to include therein:

TOWNSHIP 6 SOUTH, RANGE 26 EAST, NMPM
Section 29: NW/4

- (ee) EXTEND the North Loving-Morrow Gas Pool in Eddy County, New Mexico, to include therein:

TOWNSHIP 23 SOUTH, RANGE 28 EAST, NMPM
Section 5: S/2
Section 8: N/2
Section 9: W/2

- (ff) EXTEND the Northeast Lovington-Pennsylvanian Pool in Lea County, New Mexico, to include therein:

TOWNSHIP 16 SOUTH, RANGE 37 EAST, NMPM
Section 18: NW/4

- (gg) EXTEND the Malaga-Atoka Gas Pool in Eddy County, New Mexico, to include therein:

TOWNSHIP 24 SOUTH, RANGE 28 EAST, NMPM
Section 15: N/2

- (hh) EXTEND the Midway-Devonian Pool in Lea County, New Mexico, to include therein:

TOWNSHIP 17 SOUTH, RANGE 37 EAST, NMPM
Section 8: NW/4

- (ii) EXTEND the West Milnesand-San Andres Pool in Roosevelt County, New Mexico, to include therein:

TOWNSHIP 8 SOUTH, RANGE 34 EAST, NMPM
Section 17: SE/4

- (jj) EXTEND the Penasco Draw-San Andres-Yeso Associated Pool in Eddy County, New Mexico to include therein:

TOWNSHIP 18 SOUTH, RANGE 25 EAST, NMPM
Section 32: S/2 NE/4 and SE/4
Section 33: S/2 NW/4 and SW/4

TOWNSHIP 19 SOUTH, RANGE 25 EAST, NMPM
Section 4: NW/4
Section 5: N/2 NE/4 and SE/4 NE/4

- (kk) EXTEND the Quail Ridge-Morrow Gas Pool in Lea County, New Mexico, to include therein:

TOWNSHIP 19 SOUTH, RANGE 34 EAST, NMPM
Section 19: N/2

- (ll) EXTEND THE Querecho Plains-Lower Bone Spring Pool in Lea County, New Mexico, to include therein:

TOWNSHIP 18 SOUTH, RANGE 32 EAST, NMPM
Section 28: S/2

- (mm) EXTEND the Rocky Arroyo-Wolfcamp Gas Pool in Eddy County, New Mexico, to include therein:

TOWNSHIP 22 SOUTH, RANGE 22 EAST, NMPM
Section 9: SW/4
Section 16: NW/4

CARRISBEE HEARING - Wednesday - October 7, 1961.

(nr.) EXTEND the South Salt Lake-Morrow Gas Pool in Lea County, New Mexico, to include therein:

TOWNSHIP 21 SOUTH, RANGE 32 EAST, NMPM
Section 7: E/2
Section 18: N/2

(oo) EXTEND the West Sand Dunes-Morrow Gas Pool in Eddy County, New Mexico, to include therein:

TOWNSHIP 23 SOUTH, RANGE 31 EAST, NMPM
Section 32: N/2

(pp) REDESIGNATE the Sand Ranch-Atoka Gas Pool in Chaves County, New Mexico, to the Sand Ranch-Morrow Gas Pool, as said pool is producing from the Morrow formation rather than the Atoka, and EXTEND the horizontal limits of said pool to include therein:

TOWNSHIP 10 SOUTH, RANGE 29 EAST, NMPM
Section 14: S/2

(qq) EXTEND the San Simon-Wolfcamp Pool in Lea County, New Mexico, to include therein:

TOWNSHIP 22 SOUTH, RANGE 35 EAST, NMPM
Section 6: SE/4
Section 7: E/2

(rr) EXTEND the Sawyer-San Andres Associated Pool in Lea County, New Mexico, to include therein:

TOWNSHIP 9 SOUTH, RANGE 38 EAST, NMPM
Section 7: SW/4

(ss) EXTEND the Spencer-San Andres Pool in Lea County, New Mexico, to include therein:

TOWNSHIP 17 SOUTH, RANGE 36 EAST, NMPM
Section 23: SE/4

(tt) EXTEND the Tomahawk-San Andres Pool in Chaves County, New Mexico, to include therein:

TOWNSHIP 7 SOUTH, RANGE 31 EAST, NMPM
Section 36: NW/4

(uu) EXTEND the Tom-Tom-San Andres Pool in Chaves County, New Mexico, to include therein:

TOWNSHIP 8 SOUTH, RANGE 31 EAST, NMPM
Section 5: S/2 SW/4
Section 8: N/2 NW/4

(vv) EXTEND the Tonto-Wolfcamp Pool in Lea County, New Mexico, to include therein:

TOWNSHIP 19 SOUTH, RANGE 33 EAST, NMPM
Section 27: E/2

(ww) EXTEND the Turkey Track-Morrow Gas Pool in Eddy County, New Mexico, to include therein:

TOWNSHIP 19 SOUTH, RANGE 29 EAST, NMPM
Section 3: S/2

(xx) EXTEND the Wantz-Abo Pool in Lea County, New Mexico, to include therein:

TOWNSHIP 22 SOUTH, RANGE 37 EAST, NMPM
Section 10: NE/4

(yy) EXTEND the North Young-Bone Spring Pool in Lea County, New Mexico to include therein:

TOWNSHIP 18 SOUTH, RANGE 32 EAST, NMPM
Section 10: NE/4

CAMPBELL, BYRD & BLACK, P.A.
LAWYERS

JACK M. CAMPBELL
HARL D. BYRD
BRUCE D. BLACK
MICHAEL B. CAMPBELL
WILLIAM F. CARR
BRADFORD C. BERGE
WILLIAM G. WARDLE

JEFFERSON PLACE
SUITE 1 - 110 NORTH GUADALUPE
POST OFFICE BOX 2208
SANTA FE, NEW MEXICO 87501
TELEPHONE: (505) 988-4421
TELECOPIER: (505) 983-6043

September 10, 1981

Mr. Joe D. Ramey
Division Director
Oil Conservation Division
New Mexico Department of
Energy & Minerals
Post Office Box 2088
Santa Fe, New Mexico 87501

Case 7370

Re: Application of Southland Royalty Company for
Compulsory Pooling, Rio Arriba County, New Mexico

Dear Mr. Ramey:

Enclosed in triplicate is the application of Southland
Royalty Company in the above-referenced matter.

The applicant requests that this matter be included on the
docket for the examiner hearing scheduled to be held on
October 14, 1981.

7

Very truly yours,

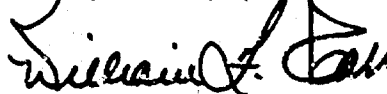

William F. Carr

WFC:lr

Enclosures

cc: Mr. John Zent
Mr. Bob Fielder

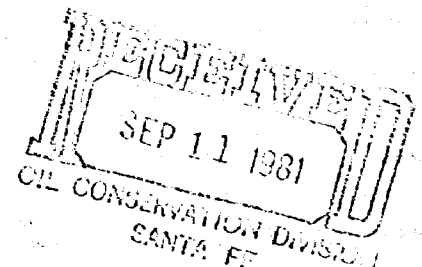

BEFORE THE
OIL CONSERVATION DIVISION
NEW MEXICO DEPARTMENT OF ENERGY AND MINERALS

IN THE MATTER OF THE APPLICATION
OF SOUTHLAND ROYALTY COMPANY FOR
COMPULSORY POOLING, RIO ARRIBA
COUNTY, NEW MEXICO.

Case 7370

APPLICATION

Comes now SOUTHLAND ROYALTY COMPANY, by and through its undersigned attorneys and, as provided by Section 70-2-17, New Mexico Statutes Annotated, 1978 Compilation, hereby makes application for an order pooling all of the mineral interests in the Pictured Cliffs and Fruitland formations, East Blanco Pictured Cliffs Pool in an under the NW/4 of Section 35, Township 30 North, Range 4 West, N.M.P.M., Rio Arriba County, New Mexico, and in support thereof would show the Division:

1. Applicant owns or controls through farmout 95.4% of the working interest in and under the NW/4 of Section 35, and applicant has the right to drill thereon.
2. Applicant proposes to dedicate the above-referenced pooled unit containing 165.29 acres to its Rueben Canyon No. 1 Well to be drilled at an orthodox location 1730 feet from the North line and 940 feet from the West line of said Section 35.
3. Applicant has sought and obtained either voluntary agreement for pooling or farmout from all other working interest owners in the NW/4 of said Section 35 except the following:

Sister Mary Carmella Trujillo, Andrea
T. Lucero and unknown heirs of Ramon
Roybal, deceased.

4.6% WI

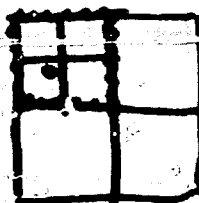

4. Said pooling of interest and well completion will avoid the drilling of unnecessary wells, will prevent waste and will protect correlative rights.

5. In order to permit the applicant to obtain its just and fair share of the oil and gas underlying the subject lands, the mineral interest should be pooled, and applicant should be designated the operator of the well to be drilled.

WHEREFORE, applicant prays that this application be set for hearing before the Division's duly appointed examiner, and that after notice and hearing as required by law, the Division enter its order pooling the lands, including provisions designating the applicant as operator of the well, providing for applicant to recover its costs of drilling, equipping and completing the well, its costs of supervision while drilling, and after completion, including overhead charges, and assessing a risk factor for the risk assumed by the applicant in drilling, completing and equipping the well, and making such other and further provisions as may be proper in the premises.

Respectfully submitted,

CAMPBELL, BYRD & BLACK, P.A.

By

William F. Carr

Post Office Box 2208

Santa Fe, New Mexico 87501

Attorneys for Applicant

STATE OF NEW MEXICO
ENERGY AND MINERALS DEPARTMENT
OIL CONSERVATION DIVISION

IN THE MATTER OF THE HEARING
CALLED BY THE OIL CONSERVATION
DIVISION FOR THE PURPOSE OF
CONSIDERING:

*Application of Santhland
Royalty Company, for company
Sandy location, Rio Arriba
County, New Mexico.*
ORDER OF THE DIVISION

CASE NO. 7370
Order No. R-6806

BY THE DIVISION:

This cause came on for hearing at 9 a.m. on October 7, 1981, at Santa Fe, New Mexico. before Examiner Daniel S. Nutter..

NOW, on this day of October, 1981, the Division Director, having considered the record and the recommendations of the Examiner, and being fully advised in the premises,

FINDS:

That the applicant's request for dismissal should be granted.

IT IS THEREFORE ORDERED:

That Case No. 7370 is hereby dismissed.

DONE at Santa Fe, New Mexico, on the day and year hereinabove designated.

STATE OF NEW MEXICO
OIL CONSERVATION DIVISION

JOE D. RAMEY,

RLL