

Case No.

6209

Large Exhibits

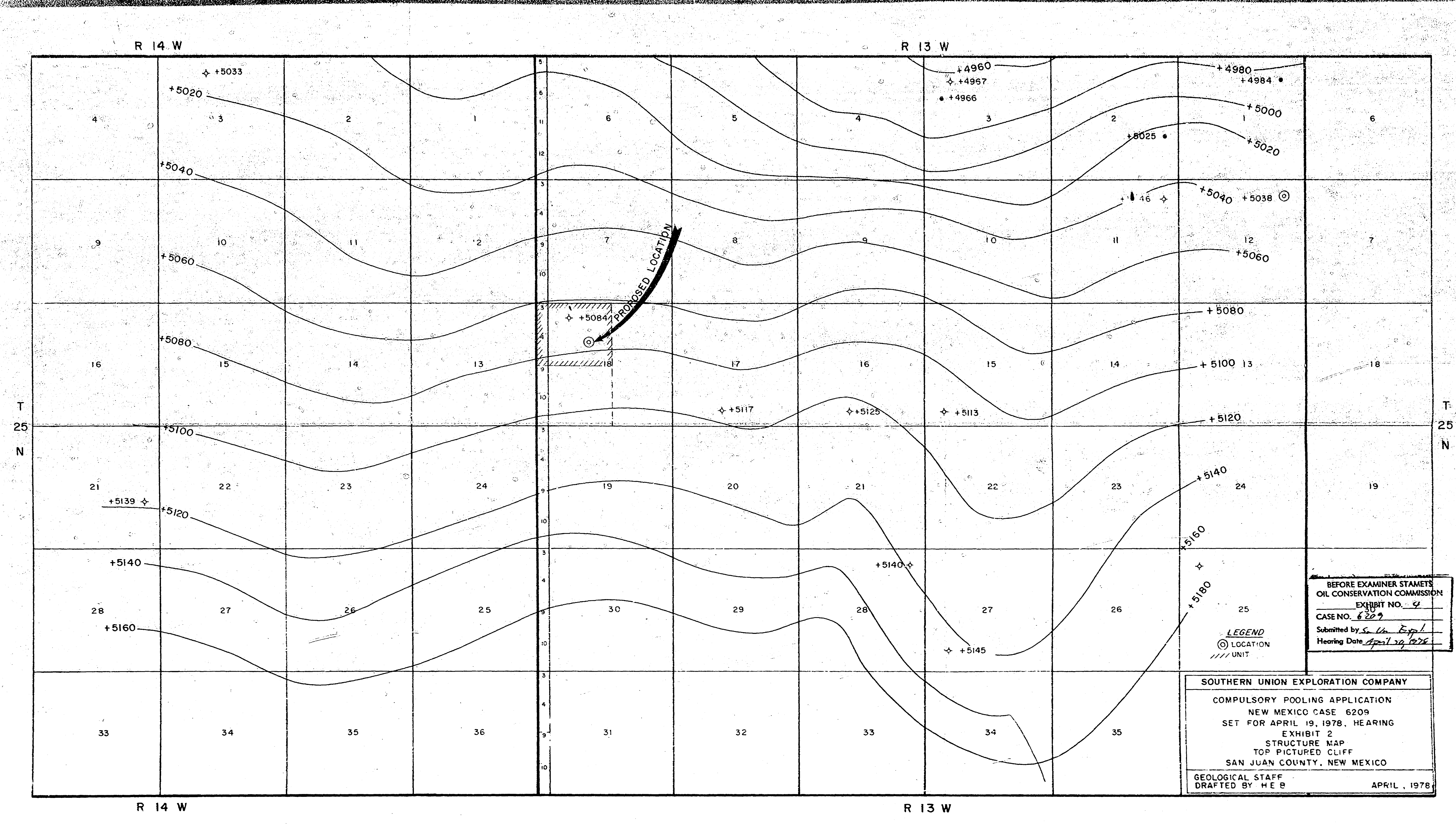



SOUTHERN UNION EXPLORATION COMPANY
 COMPULSORY POOLING APPLICATION
 NEW MEXICO CASE 6209
 SET FOR APRIL 19, 1978, HEARING
 EXHIBIT 2
 STRUCTURE MAP
 TOP PICTURED CLIFF
 SAN JUAN COUNTY, NEW MEXICO
 GEOLOGICAL STAFF
 DRAFTED BY H E B APRIL, 1978

