

Case No.  
6454

Large Exhibits

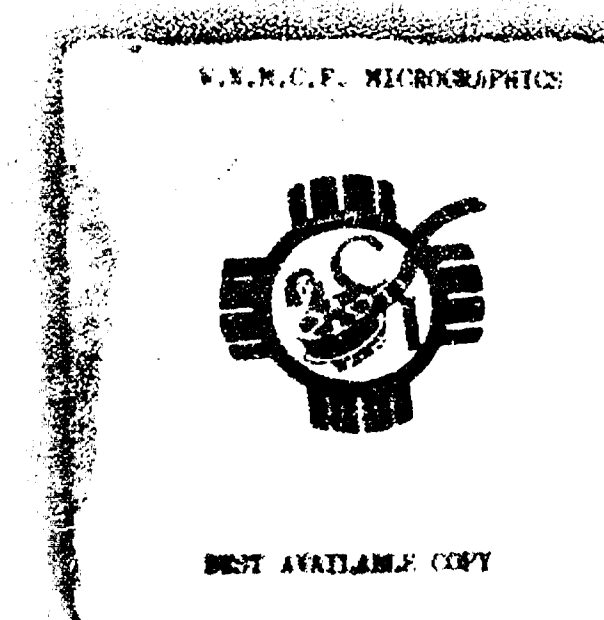

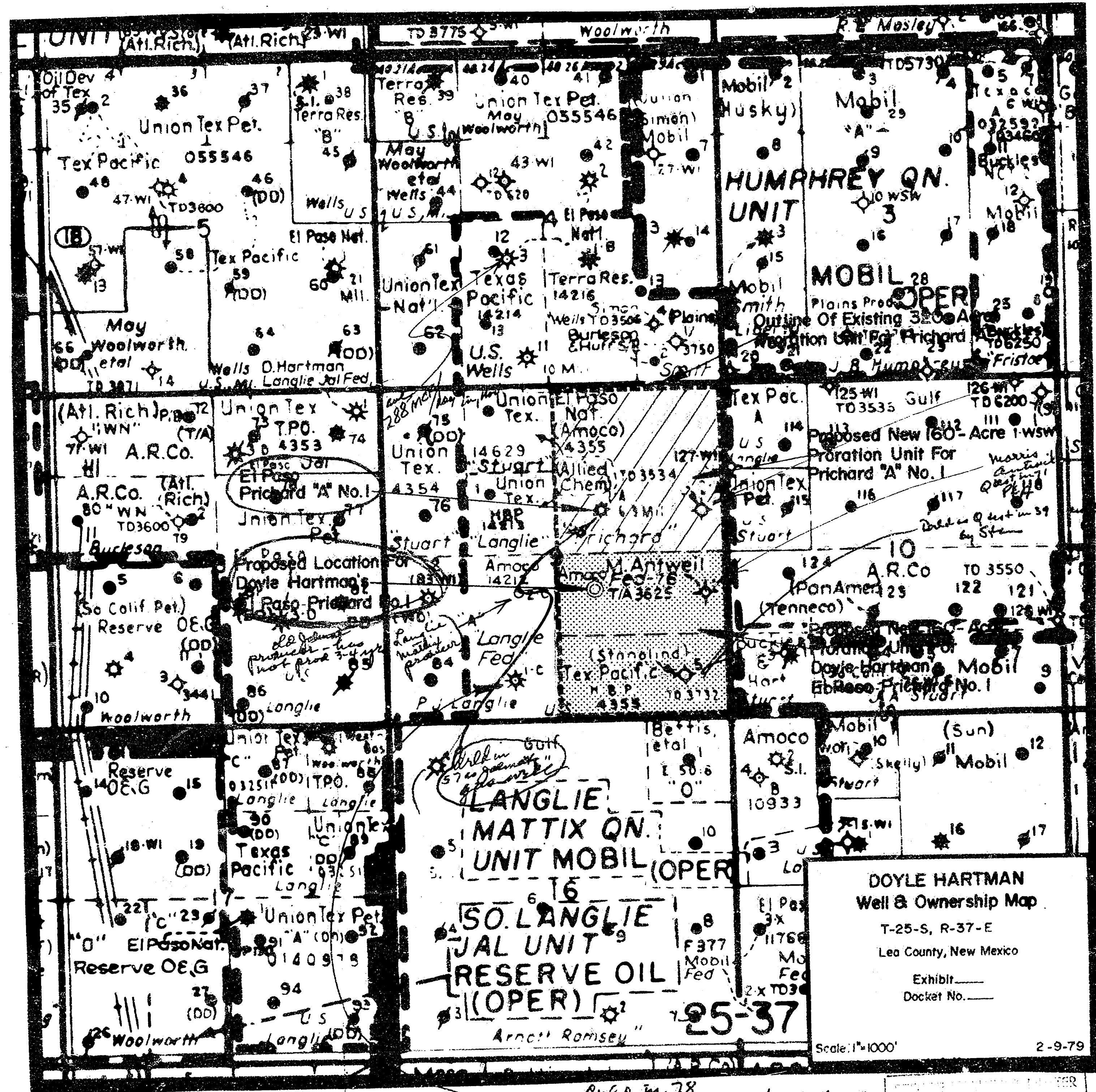

Drilled in 78  
see post 527 mcf/day in her 78

Scale 1"=1000'  
2-9-79

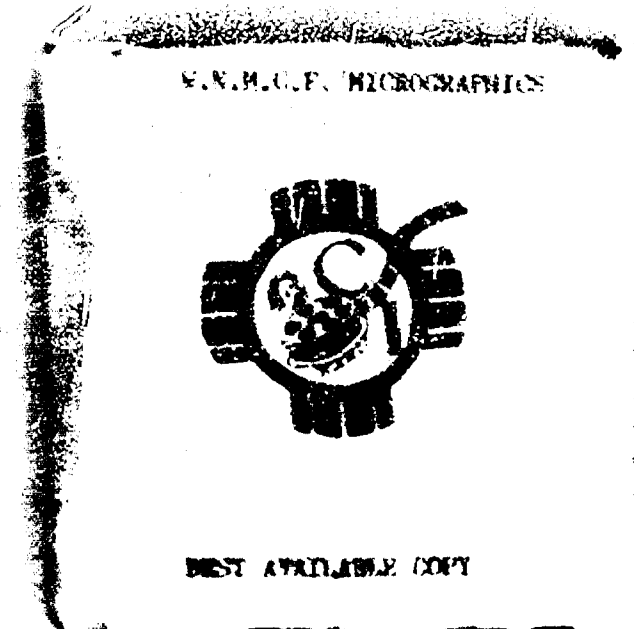



Production History  
 El Paso Natural Gas Co.  
 Prichard, La. No. 1  
 1060FNL 01060 FEL (G)  
 Sec. 9, T-23-S, R-37-E  
 Lea County, New Mexico

Jama Gas Pool  
 Present Production Unit Size = 320 acres

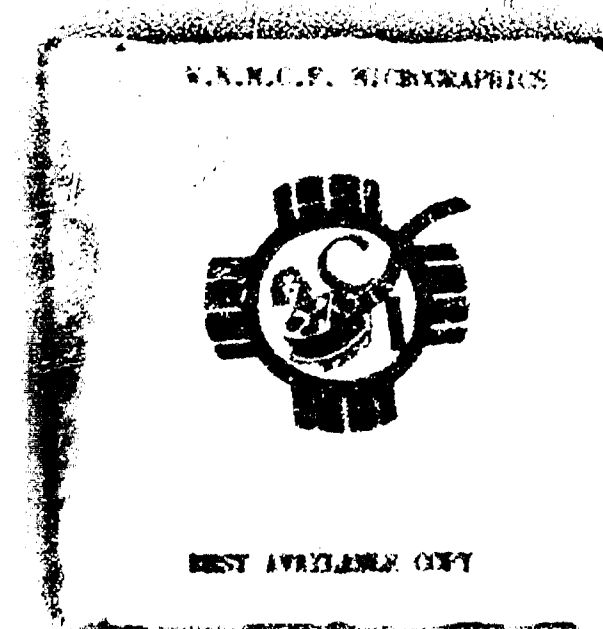
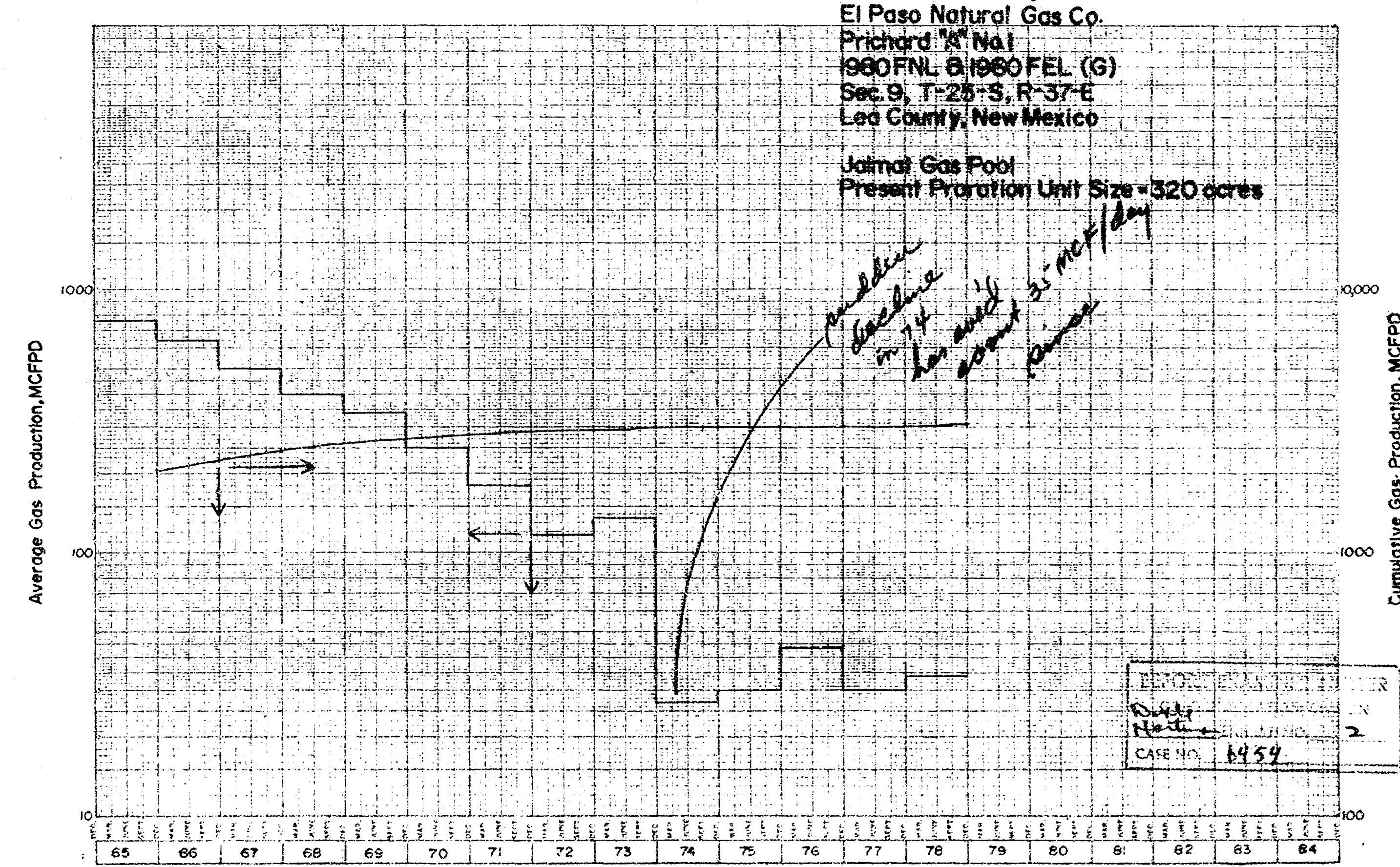



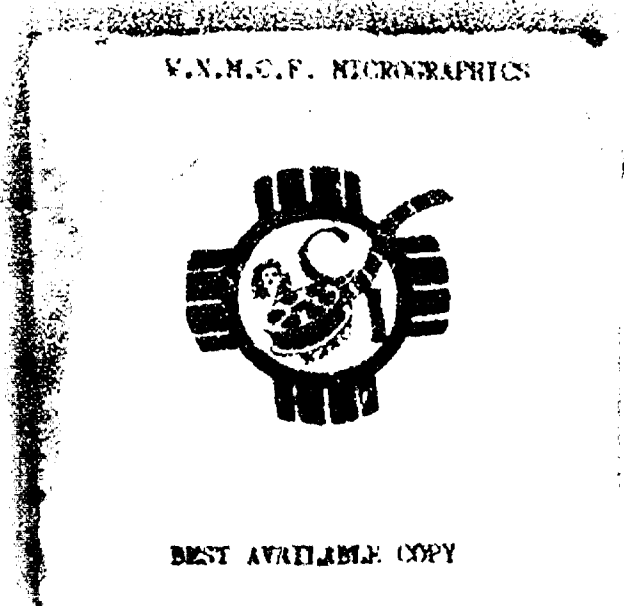
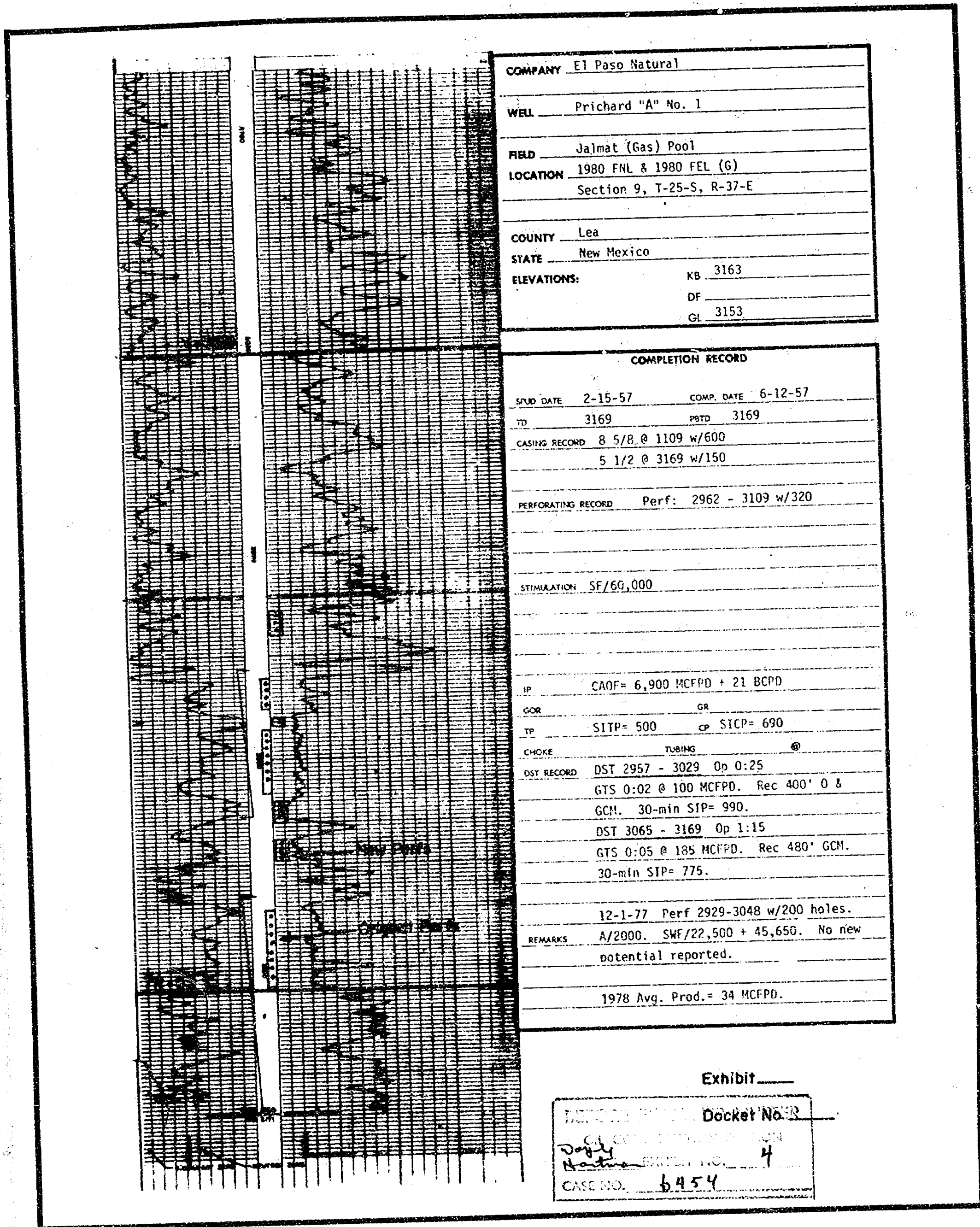



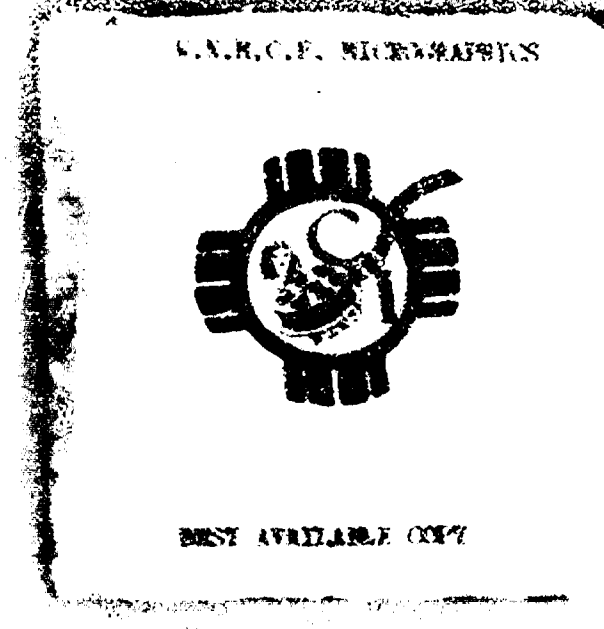
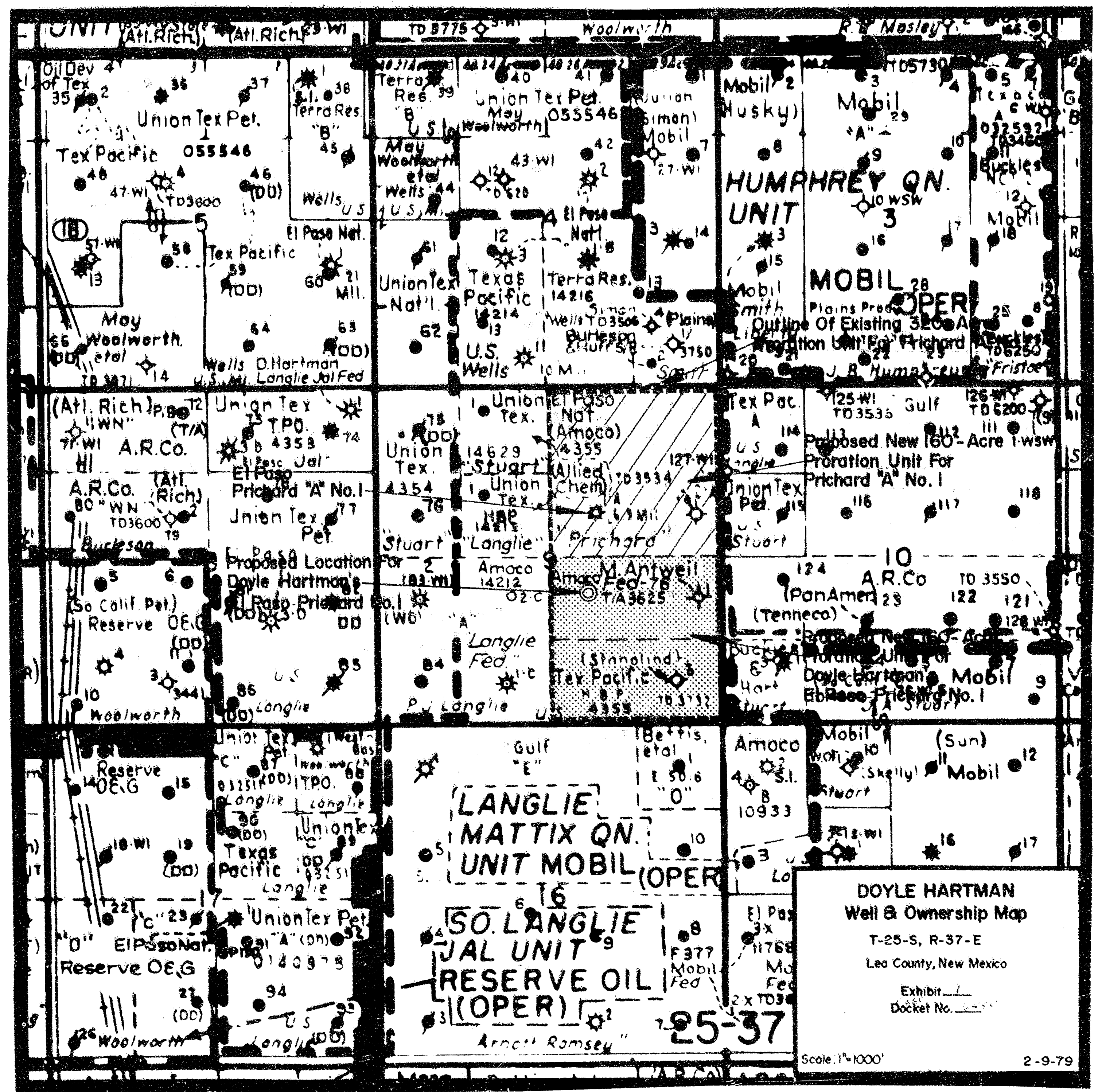



Production History  
El Paso Natural Gas Co.  
Prichard No. 1  
980 FNL 81980 FEL (G)  
Sec. 9, T-25-S, R-37-E  
Lea County, New Mexico

Jalmar Gas Pool  
Present Production Unit Size = 320 acres

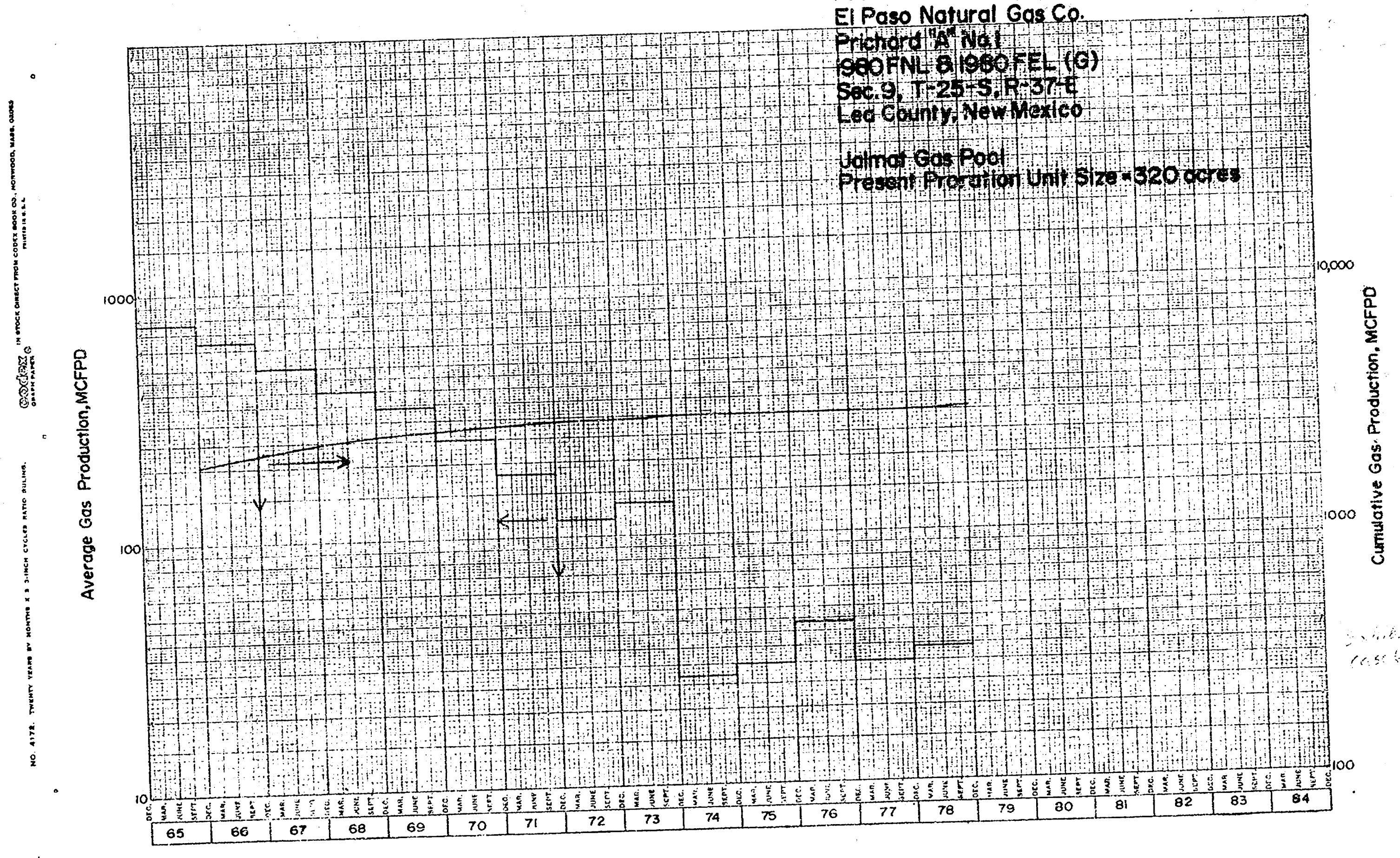

PRODUCTION HISTORY  
 EL PASO NATURAL GAS CO.  
 Pritchard #1 No. 1  
 O-8-255-375  
 Lea County, N. M.  
 (Joint Gas Pool)

YEAR	GAS PRODUCTION (MCF)	AVERAGE DAILY (MCF/D)	CUMULATIVE PRODUCTION (MCF)
1965	281,458	771	2037
1966	231,240	639	2270
1967	180,998	496	2451
1968	144,443	396	2595
1969	122,641	336	2718
1970	89,950	246	2809
1971	66,138	181	2874
1972	42,215	116	2917
1973	49,130	135	2966
1974	10,010	27	2976
1975	11,040	30	2987
1976	15,702	43	3002
1977	10,016	30	3013
1978	11,352	34	3025





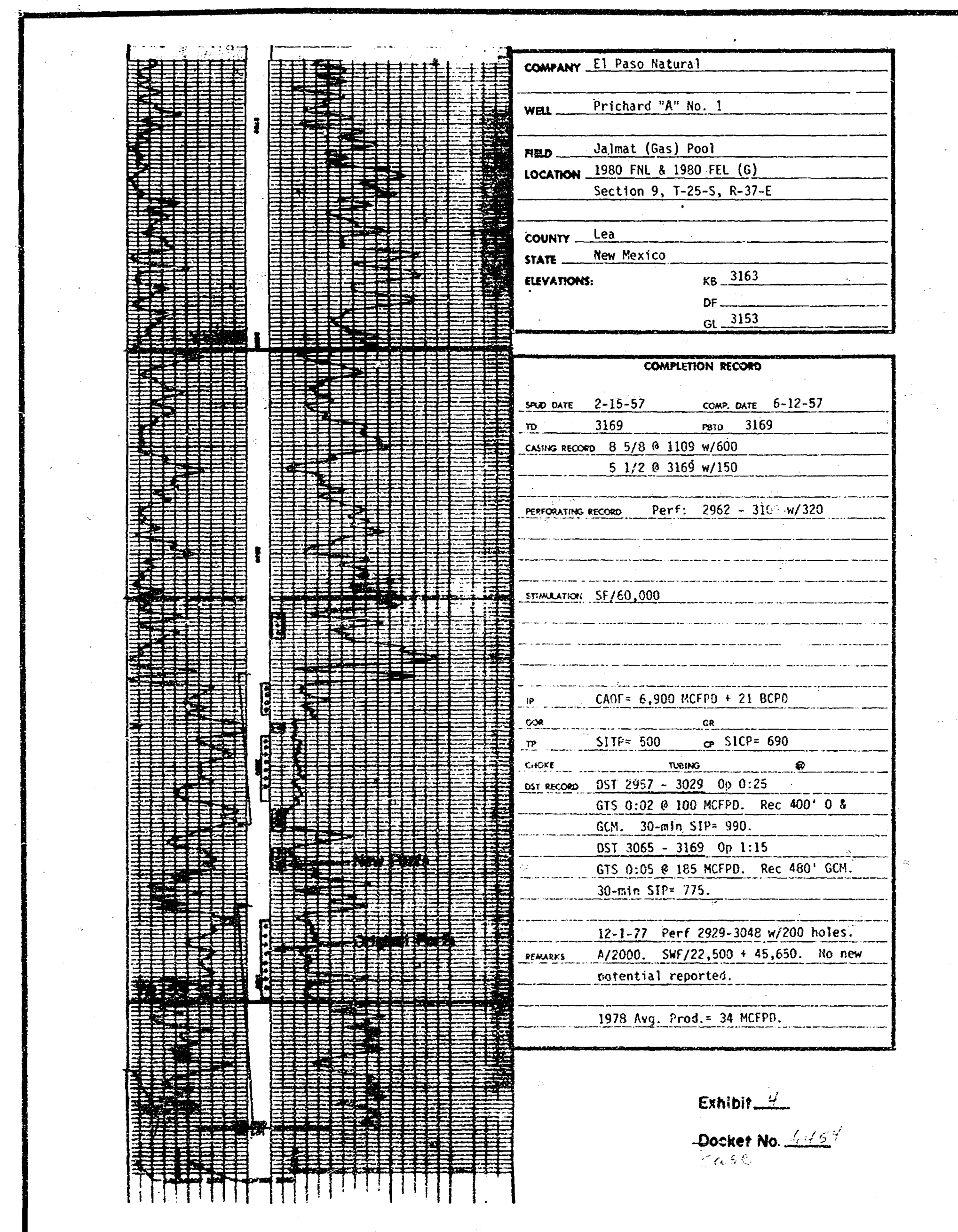

Exhibit 4  
Docket No. 4124  
P. 150





Production History  
 El Paso Natural Gas Co.  
 Prichard A. No. 1  
 900FNL B, 1900 FEL (G)  
 Sec. 8, T-25-S, R-37-E  
 Lea County, New Mexico  
 Jalmit Gas Pool  
 Present Production Unit Size = 320 acres

