

CASE 5200: Appli. of MONSANTO CO.
FOR A TRIPLE COMPLETION, EDDY
COUNTY, NEW MEXICO.

CASE No.
52000

Application,
Transcripts,
Small Exhibits
ETC.

BEFORE THE
NEW MEXICO OIL CONSERVATION COMMISSION
Santa Fe, New Mexico
March 27, 1974

EXAMINER HEARING

IN THE MATTER OF:

Application of Monsanto Company
for a triple completion, Eddy
County, New Mexico.

Case No.
5200

BEFORE: Daniel S. Nutter, Examiner.

TRANSCRIPT OF HEARING

A P P E A R A N C E S

For the New Mexico Oil
Conservation Commission:

William Carr, Esq.
Legal Counsel for the
Commission
State Land Office Bldg.
Santa Fe, New Mexico

For the Applicant:

Clarence Hinkle, Esq.
Hinkle, Bondurant, Cox &
Eaton
600 Hinkle Building
Roswell, New Mexico

I N D E X

PAGE

ED SCHOLL

Direct Examination by Mr. Hinkle
Cross Examination by Mr. Nutter

3
8

E X H I B I T S

Marked

Admitted

Applicant's Exhibits Nos.
1 through 8

--

8

SCHOLL-DIRECT

CASE 5200

Page 3

MR. NUTTER: We call the next case, Case 5200.

MR. CARR: Case 5200. Application of Monsanto Company for a triple completion, Eddy County, New Mexico.

MR. HINKLE: Clarence Hinkle, Hinkle, Bondurant, Cox & ~~Baton~~, Roswell, appearing on behalf of Monsanto. We have one witness we would like to have sworn and 2 exhibits.

(Witness sworn.)

ED SCHOLL

called as a witness, having been first duly sworn, was examined and testified as follows:

DIRECT EXAMINATION

BY MR. HINKLE:

Q State your name, your residence, and by whom you are employed.

A My name is Ed Scholl, I live in Midland, Texas, and I am employed by Monsanto Company as District Engineer.

Q Have you previously testified before the Commission?

A Yes.

Q Your qualifications as a Petroleum Engineer are a matter of record with the Commission?

A Yes, they are.

Q Have you made a study of the area that's involved,

THE NYE REPORTING SERVICE
STATE-WIDE DEPOSITION NOTARIES
225 JOHNSON STREET
SANTA FE, NEW MEXICO 87501
TEL. (505) 982-0386

of the well that's involved in this particular Case?

A Yes, I have.

MR. HINKLE: Are the Witness' qualifications sufficient?

MR. NUTTER: Yes, they are.

BY MR. HINKLE:

Q Have you prepared or has there been prepared under your direction two exhibits for introduction?

A Yes, Exhibit 1 and No. 2.

Q Refer to Exhibit 1 and explain what this is and what it shows.

A Exhibit 1 is a plat of the Burton Flat Area showing the proposed triple completion of Monsanto Wilder-spin No. 1 located in Unit F on the map; Section 11, Township 21 South, Range 27 East, Eddy County, New Mexico. It shows the off-set Burton Flats Unit to the north, the south off-set well Coquina J.M. State, which is located in the south half of Section 11; the west off-set, the Gulf Cerf No. 1, which is a dual Strawn and Morrow well, and an adjacent Coquina Well in the south half of Section 10 which is also a dual Strawn and Morrow Well.

Q There have been no triple completions in this area?

A No, there have not.

Q State briefly the history of the well which you propose to have triple completion?

A Yes. The Well was spudded on December the 27th in 1973 and reached TD in February of 1974. We encountered Wolfcamp Zones, Strawn Zones, and Morrow Zones in the Well and TD was reached, as I said, in February; 7-inch pipe was run, and I'd like now to refer to Exhibit 2, if I may. Exhibit No. 2 is a diagrammatic sketch of the proposed completion, triple completion, of the Wilderspin No. 1. We have actually run this pipe in the hole as we have depicted on this diagram. The primary string is at 2-3/8ths N-80 tubing which is the Morrow string, which is set on an Otis WC packer set at 11,900 feet. The secondary string is a Strawn 2-3/8ths tubing set on an Otis Dual packer 10,250 feet, and the third string is the 2 and 16th inches flush-joint N-80 Wolfcamp tubing string set on triple packer at 9500 feet. The procedure on doing this work was work from the top down. We perforated the Wolfcamp Zone from 9660 to 9710 with a casing gun with 11.4-pound mud in the hole -- and incidentally the pressure was around 5700 to 5800 pounds when we were working on this -- we then ran the Otis WC packer set at

11,100 on a wire line, and started running our primary string with the other two packers fixed on this tubing string, and a portion of the secondary string, the Strawn string, piggy-back between these two packers. We ran this primary string, we tested it to 5000 pounds and it held all right, the packer held all right; we then started running our secondary string and then our third string, because our packers were run on our primary strings. We displaced with water and the Wolfcamp flowed in at the rate of 1,000,000 a day and about 116 barrels of condensate a day. We then oriented, perforated the Strawn formation from 10,398 to 10,430 and we brought it in and treated it for a rate of about 14,000,000 cubic feet a day so we know we have real good separation between these two packers.

We then perforated the Morrow through tubing in the primary string, and after treatment it was tested at the rate of about 5,000,000 a day and with about 1100 pounds on it. Incidentally, the 7/8ths casing was set at 11,700 feet; we cemented with 750 sacks of cement and temperature surveys indicate that the cement is up to 7400 feet, which should clearly give us enough coverage on our cement for protection of all three zones.

Q In your opinion, will the completion, and the manner in which it has been completed as shown by this diagrammatic sketch, Exhibit No. 2, confine the production to the respective zones?

A Yes, we feel it will, and we have tested it very extensively when we were running it.

Q Are any of these zones being produced at the present time?

A Yes, the Wolfcamp is being produced as a single well, and the Wolfcamp is producing about 800 mcf per day with 116 barrels of condensate.

Q Is there any urgency to the approval of this Application so that the other zones can be produced?

A Yes, there is. We are under an emergency FPC Contract on this thing for 180 days, and of course, with 14,000,000 cubic feet shut-in at the Strawn, it means about \$6000 to Monsanto and partners a day.

Q A day?

A A day, and plus \$2500 a day on the Morrow that is shut-in. We certainly hope that we could get approval to open these zones just as soon as possible.

If I may, one other thing, we are taking four points as soon as pipeline connections are finished, which

SCHOLL-DIRECT
CROSS

CASE 5200

Page..... 8

they are. As soon as we get permission to produce these, we'll take the 4-point and the packer-leaker test and we have not taken a 4-point to the atmosphere because we didn't really want to waste the gas, since we knew it was such a good well.

Q In your opinion, will approval of this Application be in the interests of conservation, prevention of waste and protect correlative rights?

A Yes, it will.

MR. HINKLE: I'd like to offer Exhibits 1 and 2.

MR. NUTTER: Monsanto Exhibits 1 and 2 will be admitted into evidence.

(Whereupon Applicant's Exhibits Nos. 1 and 2 were admitted into evidence.)

MR. HINKLE: That's all I have on direct.

CROSS EXAMINATION

BY MR. NUTTER:

Q Mr. Scholl, is there any other Wolfcamp production indicated in any of the other wells in this area?

A Coquina has, south of us on the J.M. State, has a Wolfcamp, Strawn and Morrow Zones indicated in their well. I don't know what they are doing with the Wolfcamp. I think they're testing it right now through pipe, but I don't have any results of this test.

A I see.

THE NYE REPORTING SERVICE
STATE-WIDE DEPOSITION NOTARIES
225 JOHNSON STREET
SANTA FE, NEW MEXICO 87501
TEL. (505) 982-0386

A It really kicked on them, that well.

Q But you don't know what zones they are going to complete the well to produce --

A (Interrupting) No, all I know is that they have the three zones.

Q How about this No. 5 Burton Flats Well to the north?

A I think the Burton Flat No. 5 is a strange well in that it is wet in the Morrow, yet it is structurally high so it must be a different zone. We tried to complete in the Strawn but we got water.

We have temporarily abandoned the well pending evaluation of the Wilderspin to take a velocity survey in the Strawn and see if this isn't some extraneous water source.

Q I see. It's not producing now, but you haven't given up hopes?

A Right.

MR. NUTTER: Were there any further questions of Mr. Scholl? He may be excused. Anything further, Mr. Hinkle?

MR. HINKLE: No.

MR. NUTTER: Does anyone have anything to offer

CASE 5200

Page 10

in Case 5200? We will take the Case under advisement.

THE NYE REPORTING SERVICE
STATE-WIDE DEPOSITION NOTARIES
225 JOHNSON STREET
SANTA FE, NEW MEXICO 87501
TEL. (505) 982-0386

STATE OF NEW MEXICO)
) SS.
COUNTY OF SANTA FE)

I, RICHARD L. NYE, Court Reporter, do hereby certify that the foregoing and attached Transcript of Hearing before the New Mexico Oil Conservation Commission was reported by me, and the same is a true and correct record of the said proceedings, to the best of my knowledge, skill and ability.

RICHARD L. NYE, Court Reporter

I do hereby certify that the foregoing is a complete record of the proceedings in the Examiner hearing of Case No. 5200, heard by me on 3/27, 1974.

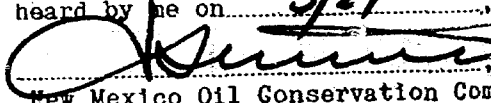
Examiner
New Mexico Oil Conservation Commission



OIL CONSERVATION COMMISSION

STATE OF NEW MEXICO
P. O. BOX 2088 - SANTA FE
87501

I. R. TRUJILLO
CHAIRMAN

LAND COMMISSIONER
ALEX J. ARMUJO
MEMBER

STATE GEOLOGIST
A. L. PORTER, JR.
SECRETARY - DIRECTOR

April 2, 1974

Mr. Clarence Hinkle
Hinkle, Bondurant, Cox & Eaton
Attorneys at Law
Post Office Box 10
Roswell, New Mexico 88201

Re: CASE NO. 5200
ORDER NO. R-4760
Applicant:
Monsanto Company

Dear Sir:

Enclosed herewith are two copies of the above-referenced Commission order recently entered in the subject case.

Very truly yours,

A. L. Porter, Jr.

A. L. PORTER, Jr.
Secretary-Director

ALP/ir

Copy of order also sent to:

Hobbs OCC	<u>X</u>
Artesia OCC	<u>X</u>
Aztec OCC	

Other _____

BEFORE THE OIL CONSERVATION COMMISSION
OF THE STATE OF NEW MEXICO

IN THE MATTER OF THE HEARING
CALLED BY THE OIL CONSERVATION
COMMISSION OF NEW MEXICO FOR
THE PURPOSE OF CONSIDERING:

CASE NO. 5200
Order No. R-4760

APPLICATION OF MONSANTO COMPANY
FOR A TRIPLE COMPLETION, EDDY
COUNTY, NEW MEXICO.

ORDER OF THE COMMISSION

BY THE COMMISSION:

This cause came on for hearing at 9 o'clock a.m. on March 27, 1974, at Santa Fe, New Mexico, before Examiner Daniel S. Nutter.

NOW, on this 2nd day of April, 1974, the Commission, a quorum being present, having considered the testimony, the record, and the recommendations of the Examiner, and being fully advised in the premises,

FINDS:

(1) That due public notice having been given as required by law, the Commission has jurisdiction of this cause and the subject matter thereof.

(2) That the applicant, Monsanto Company, seeks authority to complete its Wilderspin Well No. 1, located in Unit F of Section 11, Township 21 South, Range 27 East, NMPM, Burton Flats Field, Eddy County, New Mexico, as a triple completion (conventional) to produce gas from the Wolfcamp, Strawn and Morrow formations through three parallel strings of tubing, with packers set at approximately 9500 feet, 10,250 feet, and 11,100 feet.

(3) That the mechanics of the proposed triple completion are feasible and in accord with good conservation practices.

(4) That approval of the subject application will prevent waste and protect correlative rights.

IT IS THEREFORE ORDERED:

(1) That the applicant, Monsanto Company, is hereby authorized to complete its Wilderspin Well No. 1, located in Unit F of Section 11, Township 21 South, Range 27 East, NMPM, Burton Flats Field, Eddy County, New Mexico, as a triple

-2-

Case No. 5200
Order No. R-4760

completion (conventional) to produce gas from the Wolfcamp, Strawn and Morrow formations through three parallel strings of tubing, with an upper packer set at approximately 9500 feet and separation of the producing zones accomplished by two other packers, one set at approximately 10,250 feet and the other at approximately 11,100 feet.

PROVIDED HOWEVER, that the applicant shall complete, operate, and produce said well in accordance with the provisions of Rule 112-A of the Commission Rules and Regulations insofar as said rule is not inconsistent with this order;

PROVIDED FURTHER, that the applicant shall take packer-leakage tests upon completion and annually thereafter during the Annual Shut-In Pressure Test Period for the Burton Flats-Morrow Gas Pool.

(2) That jurisdiction of this cause is retained for the entry of such further orders as the Commission may deem necessary.

DONE at Santa Fe, New Mexico, on the day and year hereinabove designated.

STATE OF NEW MEXICO
OIL CONSERVATION COMMISSION

I. R. TRUJILLO, Chairman

ALEX J. ARMIJO, Member

A. L. PORTER, Jr., Member & Secretary

S E A L

dr/

DOCKET: EXAMINER HEARING - WEDNESDAY - MARCH 27, 1974

9 A.M. - OIL CONSERVATION COMMISSION CONFERENCE ROOM,
STATE LAND OFFICE BUILDING - SANTA FE, NEW MEXICO

The following cases will be heard before Daniel S. Nutter, Examiner, or Richard L. Stamets, Alternate Examiner:

CASE 5188: (Continued from the March 13, 1974, Examiner Hearing)

Application of Continental Oil Company for downhole commingling, Lea County, New Mexico. Applicant, in the above-styled cause, seeks authority to commingle Drinkard and Blinbry production in the wellbore of its Lockhart B-1 Well No. 8 located in Unit H of Section 1, Township 22 South, Range 36 East, Lea County, New Mexico.

CASE 5194: Application of Kersey & Company for a waterflood project, Eddy County, New Mexico. Applicant, in the above-styled cause, seeks authority to institute a waterflood project by the injection of water into the Queen-Grayburg formation through one well on its Creek Lease in Section 23, Township 18 South, Range 30 East, Leo Pool, Eddy County, New Mexico.

CASE 5195: Application of J. M. Huber Corporation for compulsory pooling, Lea County, New Mexico. Applicant, in the above-styled cause, seeks an order pooling all mineral interests, including those of Harry V. Allen or his devisees, underlying the E/2 of the SE/4 of Section 21, Township 12 South, Range 37 East, Southwest Gladiola-Devonian Pool, Lea County, New Mexico. Also to be considered will be the cost of drilling and completing said well and the allocation of such costs, as well as actual operating costs and charges for supervision. Also to be considered is the designation of applicant as operator of the well and a charge for risk involved in drilling said well.

CASE 5196: Application of Kimbell Oil Company for downhole commingling, Rio Arriba County, New Mexico. Applicant, in the above-styled cause, seeks approval for the downhole commingling in the wellbore of Blanco-Mesa-verde and Basin-Dakota gas production in its Warren Federal Well No. 3 located in Unit P of Section 26 and in its Salazar Federal Well No. 3 located in Unit H of Section 27, and Otero-Gallup Oil and Basin-Dakota gas production in its Warren-Salazar Well No. 2 located in Unit M of Section 26, all in Township 25 North, Range 6 West, Rio Arriba County, New Mexico.

CASE 5197: Application of Skelly Oil Company for a waterflood project and a dual completion, Lea County, New Mexico. Applicant, in the above-styled cause, seeks authority to institute a waterflood project by the injection of water into the Seven Rivers-Queen formation in its J. C. Johnson Well No. 4 located in Unit D of Section 20, Township 23 South, Range 37 East, Langlie-Mattix Pool, Lea County, New Mexico. Applicant further seeks authority to dually complete said well for water injection and for the production of gas from the Jalmat Gas Pool. Applicant also seeks an administrative procedure for said project for approval of additional injection wells without notice and hearing.

CASE 5198: Application of Texaco Inc. for salt water disposal, Lea County, New Mexico. Applicant, in the above-styled cause, seeks authority to dispose of produced salt water into the Grayburg formation in the perforated interval from 3815 feet to 4068 feet in its V. M. Henderson Well No. 3 located in Unit H of Section 30, Township 21 South, Range 37 East, Penrose Skelly Pool, Lea County, New Mexico.

CASE 5199: Application of Wm. G. Ross for an unorthodox gas well location, Eddy County, New Mexico. Applicant, in the above-styled cause, seeks, as an exception to the Atoka-Pennsylvanian Gas Pool Rules, authority to drill a gas well 1650 feet from the South line and 660 feet from the East line of Section 10, Township 18 South, Range 26 East, Atoka-Pennsylvanian Gas Pool, Eddy County, New Mexico, the E/2 of said Section 10 to be dedicated to the well.

CASE 5200: Application of Monsanto Company for a triple completion, Eddy County, New Mexico. Applicant, in the above-styled cause, seeks approval for the triple completion (conventional) of its Wilderspin Well No. 1 located in Unit F of Section 11, Township 21 South, Range 27 East, Burton Flats Field, Eddy County, New Mexico, in such a manner as to produce gas from the Wolfcamp, Strawn, and Morrow formations through three parallel strings of tubing.

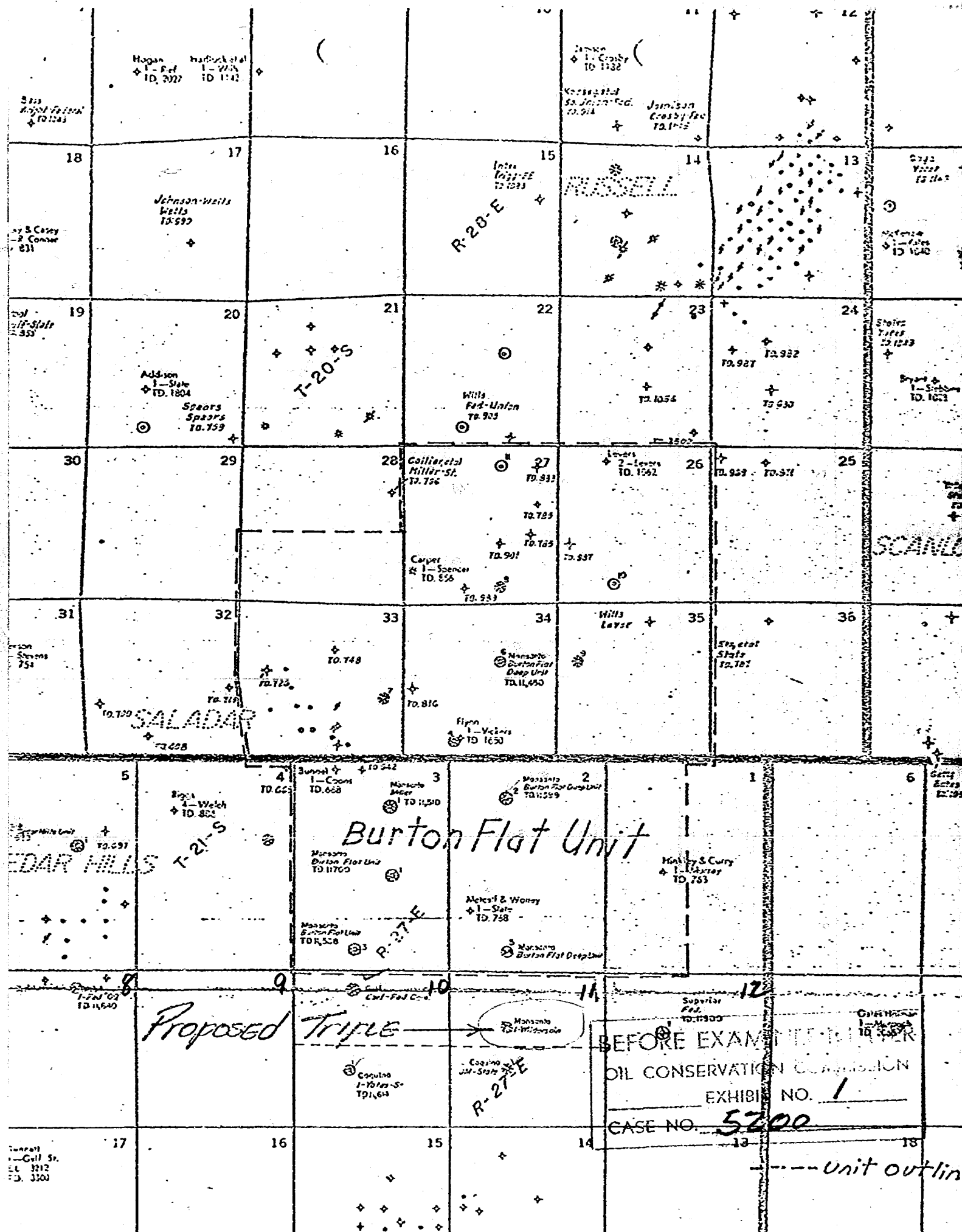

BEFORE EXAMINER NUTTER
OIL CONSERVATION COMMISSION
EXHIBIT NO. 2
CASE NO. 5200

MONSANTO COMPANY
Wilderspin #1
Eddy Co. New Mexico

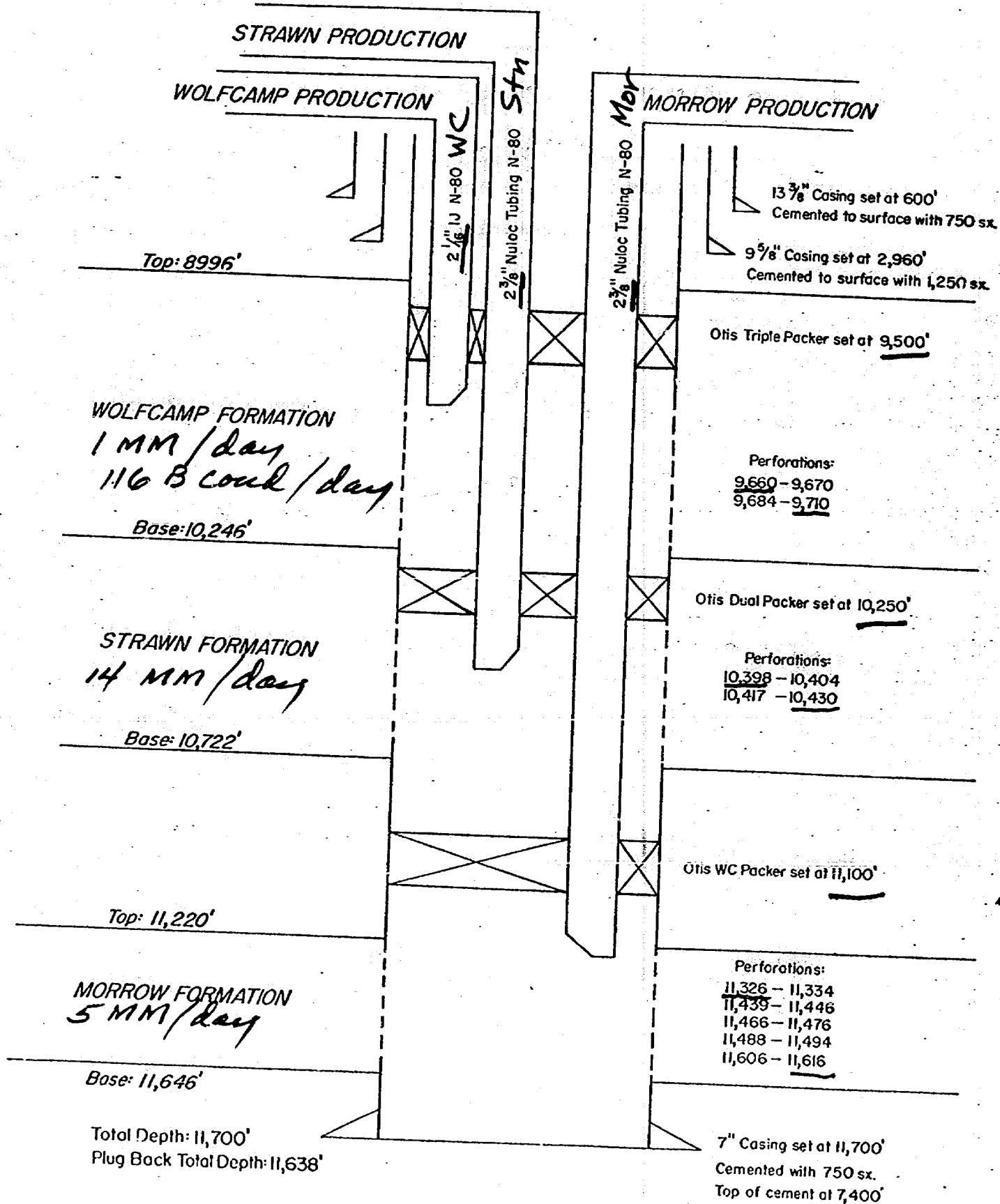

Monsanto

Monsanto Company
317 First Savings & Loan Building
101 North Marienfeld
Midland, Texas 79701
Phone: (915) 683-3306

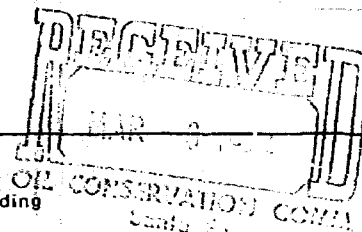

March 4, 1974

Cue 5200

New Mexico Oil Conservation Commission
P.O. Box 2088
Santa Fe, New Mexico 87501

Attn: Mr. A. L. Porter Jr.
Secretary Director

RE: Application for Triple
Wolfcamp-Strawn-Morrow Completion;
Monsanto Company
Wilderspin Well No. 1
Burton Flat Field
1980' FNL & 1980' FWL
Sec. 11, T-21S, R-27E
Eddy Co., New Mexico

Gentlemen:

Monsanto Company respectfully submits application to triple gas-gas-gas
complete the captioned well through three strings of tubing in 7" casing.
Enclosed are copies of:

1. C-107
2. Diagrammatic Sketch
3. Plat of Offset Operators
4. Logs (Follow under separate cover)

Please set this matter for hearing at your earliest convenience.

Yours very truly,

MONSANTO COMPANY

A. W. Wood
A. W. Wood
District Production Manager

AWW:
EMS:mm
Encls.

BUCKET MAILED

Date 3/14/74

cc: NMOCC, PO Drawer DD, Artesia, New Mexico 88210; Attn: Bill Gresset

Clarence Hinkle, P.O. Box 10, Roswell, New Mexico 88201
Offset Operators: Coquina Oil Corp., The Superior Oil Co. & Gulf Oil Co., U.S.
J. D. Rushing - Houston, Texas

NEW MEXICO OIL CONSERVATION COMMISSION
SANTA FE, NEW MEXICO
APPLICATION FOR MULTIPLE COMPLETION

Case 5-200
Form C-107
5-1-61

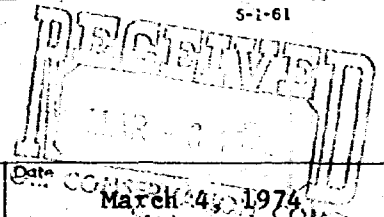

Operator MONSANTO COMPANY		County EDDY		Date March 4, 1974
Address 101 N. Marienfeld, Midland, Texas 79701		Lease WILDERSPIN		Well No. 1
Location of Well	Unit F	Section 11	Township 21S	Range 27E

1. Has the New Mexico Oil Conservation Commission heretofore authorized the multiple completion of a well in these same pools or in the same zones within one mile of the subject well? YES _____ NO X
2. If answer is yes, identify one such instance: Order No. _____; Operator Lease, and Well No.: _____

3. The following facts are submitted:	Upper Zone	Intermediate Zone	Lower Zone
a. Name of Pool and Formation	Wolfcamp	Strawn	Morrow
b. Top and Bottom of Pay Section (Perforations)	9660 - 9710	10,398 - 10,430	11,326 - 11,616
c. Type of production (Oil or Gas)	Gas	Gas	Gas
d. Method of Production (Flowing or Artificial Lift)	Flowing	Flowing	Flowing

4. The following are attached. (Please check YES or NO)

- | | | |
|-------------------------------------|--------------------------|---|
| Yes | No | |
| <input checked="" type="checkbox"/> | <input type="checkbox"/> | a. Diagrammatic Sketch of the Multiple Completion, showing all casing strings, including diameters and setting depths, centralizers and/or turbolizers and location thereof, quantities used and top of cement, perforated intervals, tubing strings, including diameters and setting depth, location and type of packers and side door chokes, and such other information as may be pertinent. |
| <input checked="" type="checkbox"/> | <input type="checkbox"/> | b. Plat showing the location of all wells on applicant's lease, all offset wells on offset leases, and the names and addresses of operators of all leases offsetting applicant's lease. |
| <input checked="" type="checkbox"/> | <input type="checkbox"/> | c. Waivers consenting to such multiple completion from each offset operator, or in lieu thereof, evidence that said offset operators have been furnished copies of the application.* |
| <input checked="" type="checkbox"/> | <input type="checkbox"/> | d. Electrical log of the well or other acceptable log with tops and bottoms of producing zones and intervals of perforation indicated thereon. (If such log is not available at the time application is filed, it shall be submitted as provided by Rule 112A.) |

5. List all offset operators to the lease on which this well is located together with their correct mailing address.

Coquina Oil Corp. **200 Bldg. of the Southwest, Midland, Texas 79701**

The Superior Oil Company **Box 1900, Midland, Texas 79701**

Gulf Oil Company, U.S. **Box 2100, Midland, Texas 79701**

6. Were all operators listed in Item 5 above notified and furnished a copy of this application? YES X NO _____. If answer is yes, give date of such notification 3/4/74.

CERTIFICATE: I, the undersigned, state that I am the District Production Mgr. of the Monsanto Company (company), and that I am authorized by said company to make this report; and that this report was prepared under my supervision and direction and that the facts stated therein are true, correct and complete to the best of my knowledge.

A. W. Wood
Signature

A. W. Wood

*Should waivers from all offset operators not accompany an application for administrative approval, the New Mexico Oil Conservation Commission will hold the application for a period of twenty (20) days from date of receipt by the Commission's Santa Fe office. If, after said twenty-day period, no protest nor request for hearing is received by the Santa Fe office, the application will then be processed.

NOTE: If the proposed multiple completion will result in an unorthodox well location and/or a non-standard proration unit in one or more of the producing zones, then separate application for approval of the same should be filed simultaneously with this application.

NEW MEXICO OIL CONSERVATION COMMISSION
SANTA FE, NEW MEXICO
APPLICATION FOR MULTIPLE COMPLETION

Form C-107
5-1-61

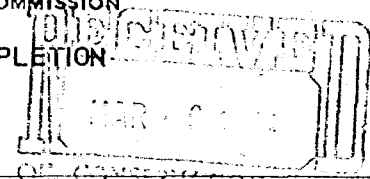

Operator MONSANTO COMPANY		County EDDY		Date of Commission March 4, 1974	
Address 101 N. Marienfeld, Midland, Texas 79701		Lease WILDERSPIN		Well No. 1	
Location of Well F	Unit F	Section 11	Township 21S	Range 27E	

1. Has the New Mexico Oil Conservation Commission heretofore authorized the multiple completion of a well in these same pools or in the same zones within one mile of the subject well? YES _____ NO X
2. If answer is yes, identify one such instance: Order No. _____; Operator Lease, and Well No.: _____

3. The following facts are submitted:	Upper Zone	Intermediate Zone	Lower Zone
a. Name of Pool and Formation	Wolfcamp	Strawn	Morrow
b. Top and Bottom of Pay Section (Perforations)	9660 - 9710	10,398 - 10,430	11,326 - 11,616
c. Type of production (Oil or Gas)	Gas	Gas	Gas
d. Method of Production (Flowing or Artificial Lift)	Flowing	Flowing	Flowing

4. The following are attached. (Please check YES or NO)

- | | | |
|-------------------------------------|--------------------------|---|
| Yes | No | |
| <input checked="" type="checkbox"/> | <input type="checkbox"/> | a. Diagrammatic Sketch of the Multiple Completion, showing all casing strings, including diameters and setting depths, centralizers and/or turbolizers and location thereof, quantities used and top of cement, perforated intervals, tubing strings, including diameters and setting depth, location and type of packers and side door chokes, and such other information as may be pertinent. |
| <input checked="" type="checkbox"/> | <input type="checkbox"/> | b. Plat showing the location of all wells on applicant's lease, all offset wells on offset leases, and the names and addresses of operators of all leases offsetting applicant's lease. |
| <input checked="" type="checkbox"/> | <input type="checkbox"/> | c. Waivers consenting to such multiple completion from each offset operator, or in lieu thereof, evidence that said offset operators have been furnished copies of the application.* |
| <input checked="" type="checkbox"/> | <input type="checkbox"/> | d. Electrical log of the well or other acceptable log with tops and bottoms of producing zones and intervals of perforation indicated thereon. (If such log is not available at the time application is filed it shall be submitted as provided by Rule 112-A.) |

5. List all offset operators to the lease on which this well is located together with their correct mailing address.

Coquina Oil Corp. **200 Bldg. of the Southwest, Midland, Texas 79701**

The Superior Oil Company **Box 1900, Midland, Texas 79701**

Gulf Oil Company, U.S. **Box 2100, Midland, Texas 79701**

6. Were all operators listed in Item 5 above notified and furnished a copy of this application? YES X NO _____. If answer is yes, give date of such notification 3/4/74.

CERTIFICATE: I, the undersigned, state that I am the District Production Mgr. of the Monsanto Company (company), and that I am authorized by said company to make this report; and that this report was prepared under my supervision and direction and that the facts stated therein are true, correct and complete to the best of my knowledge.

A. W. Wood
Signature **A. W. Wood**

*Should waivers from all offset operators not accompany an application for administrative approval, the New Mexico Oil Conservation Commission will hold the application for a period of twenty (20) days from date of receipt by the Commission's Santa Fe office. If, after said twenty-day period, no protest nor request for hearing is received by the Santa Fe office, the application will then be processed.

NOTE: If the proposed multiple completion will result in an unorthodox well location and/or a non-standard perforation unit in one or more of the producing zones, then separate application for approval of the same should be filed simultaneously with this application.

NEW MEXICO OIL CONSERVATION COMMISSION
SANTA FE, NEW MEXICO
APPLICATION FOR MULTIPLE COMPLETION

Form C-107
5-1-61

OIL CONSERVATION COMMISSION *Can 5200*

Operator MONSANTO COMPANY		County EDDY	Date March 4, 1974
Address 101 N. Marienfeld, Midland, Texas 79701		Lease WILDERSPIN	Well No. 1
Location of Well	Unit F	Section 11	Township 21S
			Range 27E

1. Has the New Mexico Oil Conservation Commission heretofore authorized the multiple completion of a well in these same pools or in the same zones within one mile of the subject well? YES _____ NO X

2. If answer is yes, identify one such instance: Order No. _____ ; Operator Lease, and Well No.: _____

3. The following facts are submitted:	Upper Zone	Intermediate Zone	Lower Zone
a. Name of Pool and Formation	Wolfcamp	Strawn	Morrow
b. Top and Bottom of Pay Section (Perforations)	9660 - 9710	10,398 - 10,430	11,326 - 11,616
c. Type of production (Oil or Gas)	Gas	Gas	Gas
d. Method of Production (Flowing or Artificial Lift)	Flowing	Flowing	Flowing

4. The following are attached. (Please check YES or NO)

- | | | |
|-------------------------------------|--------------------------|---|
| Yes | No | |
| <input checked="" type="checkbox"/> | <input type="checkbox"/> | a. Diagrammatic Sketch of the Multiple Completion, showing all casing strings, including diameters and setting depths, centralizers and/or turbolizers and location thereof, quantities used and top of cement, perforated intervals, tubing strings, including diameters and setting depth, location and type of packers and side door chokes, and such other information as may be pertinent. |
| <input checked="" type="checkbox"/> | <input type="checkbox"/> | b. Plat showing the location of all wells on applicant's lease, all offset wells on offset leases, and the names and addresses of operators of all leases offsetting applicant's lease. |
| <input checked="" type="checkbox"/> | <input type="checkbox"/> | c. Waivers consenting to such multiple completion from each offset operator, or in lieu thereof, evidence that said offset operators have been furnished copies of the application.* |
| <input checked="" type="checkbox"/> | <input type="checkbox"/> | d. Electrical log of the well or other acceptable log with tops and bottoms of producing zones and intervals of perforation indicated thereon. (If such log is not available at the time application is filed it shall be submitted as provided by Rule 112-A.) |

5. List all offset operators to the lease on which this well is located together with their correct mailing address.

Coquina Oil Corp. 200 Bldg. of the Southwest, Midland, Texas 79701

The Superior Oil Company Box 1900, Midland, Texas 79701

Gulf Oil Company, U.S. Box 2100, Midland, Texas 79701

6. Were all operators listed in Item 5 above notified and furnished a copy of this application? YES X NO _____. If answer is yes, give date of such notification 3/4/74.

CERTIFICATE: I, the undersigned, state that I am the District Production Mgr. of the Monsanto Company (company), and that I am authorized by said company to make this report; and that this report was prepared under my supervision and direction and that the facts stated therein are true, correct and complete to the best of my knowledge.

A. W. Wood
Signature **A. W. Wood**

*Should waivers from all offset operators not accompany an application for administrative approval, the New Mexico Oil Conservation Commission will hold the application for a period of twenty (20) days from date of receipt by the Commission's Santa Fe office. If, after said twenty-day period, no protest nor request for hearing is received by the Santa Fe office, the application will then be processed.

NOTE: If the proposed multiple completion will result in an unorthodox well location and/or a non-standard perforation unit in one or more of the producing zones, then separate application for approval of the same should be filed simultaneously with this application.

NEW MEXICO OIL CONSERVATION COMMISSION
SANTA FE, NEW MEXICO
APPLICATION FOR MULTIPLE COMPLETION

Form C-107
5-1-61

Case 5200

Operator MONSANTO COMPANY		County EDDY	Date March 4, 1974
Address 101 N. Marienfeld, Midland, Texas 79701		Lease WILDERSPIN	Well No. 1
Location of Well	Unit F	Section 11	Range 27E

1. Has the New Mexico Oil Conservation Commission heretofore authorized the multiple completion of a well in these same pools or in the same zones within one mile of the subject well? YES _____ NO X
2. If answer is yes, identify one such instance: Order No. _____; Operator Lease, and Well No.: _____

3. The following facts are submitted:	Upper Zone	Intermediate Zone	Lower Zone
a. Name of Pool and Formation	Wolfcamp	Strawn	Morrow
b. Top and Bottom of Pay Section (Perforations)	9660 - 9710	10,398 - 10,430	11,326 - 11,616
c. Type of production (Oil or Gas)	Gas	Gas	Gas
d. Method of Production (Flowing or Artificial Lift)	Flowing	Flowing	Flowing

4. The following are attached. (Please check YES or NO)

- | | | |
|-------------------------------------|--------------------------|---|
| Yes | No | |
| <input checked="" type="checkbox"/> | <input type="checkbox"/> | a. Diagrammatic Sketch of the Multiple Completion, showing all casing strings, including diameters and setting depths, centralizers and/or turbolizers and location thereof, quantities used and top of cement, perforated intervals, tubing strings, including diameters and setting depth, location and type of packers and side door chokes, and such other information as may be pertinent. |
| <input checked="" type="checkbox"/> | <input type="checkbox"/> | b. Plat showing the location of all wells on applicant's lease, all offset wells on offset leases, and the names and addresses of operators of all leases offsetting applicant's lease. |
| <input checked="" type="checkbox"/> | <input type="checkbox"/> | c. Waivers consenting to such multiple completion from each offset operator, or in lieu thereof, evidence that said offset operators have been furnished copies of the application.* |
| <input checked="" type="checkbox"/> | <input type="checkbox"/> | d. Electrical log of the well or other acceptable log with tops and bottoms of producing zones and intervals of perforation indicated thereon. (If such log is not available at the time application is filed it shall be submitted as provided by Rule 112-A.) |

5. List all offset operators to the lease on which this well is located together with their correct mailing address.

Coquina Oil Corp. **200 Bldg. of the Southwest, Midland, Texas 79701**

The Superior Oil Company **Box 1900, Midland, Texas 79701**

Gulf Oil Company, U.S. **Box 2100, Midland, Texas 79701**

6. Were all operators listed in Item 5 above notified and furnished a copy of this application? YES X NO _____. If answer is yes, give date of such notification 3/4/74.

CERTIFICATE: I, the undersigned, state that I am the District Production Mgr. of the Monsanto Company (company), and that I am authorized by said company to make this report; and that this report was prepared under my supervision and direction and that the facts stated therein are true, correct and complete to the best of my knowledge.

A. W. Wood
Signature **A. W. Wood**

*Should waivers from all offset operators not accompany an application for administrative approval, the New Mexico Oil Conservation Commission will hold the application for a period of twenty (20) days from date of receipt by the Commission's Santa Fe office. If, after said twenty-day period, no protest nor request for hearing is received by the Santa Fe office, the application will then be processed.

NOTE: If the proposed multiple completion will result in an unorthodox well location and/or a non-standard perforation unit in one or more of the producing zones, then separate application for approval of the same should be filed simultaneously with this application.

NEW MEXICO OIL CONSERVATION COMMISSION
SANTA FE, NEW MEXICO
APPLICATION FOR MULTIPLE COMPLETION

Form C-107
5-1-61

Case 5200

Operator MONSANTO COMPANY		County EDDY	Date March 4, 1974
Address 101 N. Marienfeld, Midland, Texas 79701		Lease WILDERSPIN	Well No. 1
Location of Well	Unit F	Section 11	Township 21S
			Range 27E

1. Has the New Mexico Oil Conservation Commission heretofore authorized the multiple completion of a well in these same pools or in the same zones within one mile of the subject well? YES _____ NO X
2. If answer is yes, identify one such instance: Order No. _____; Operator Lease, and Well No.: _____

3. The following facts are submitted:	Upper Zone	Intermediate Zone	Lower Zone
a. Name of Pool and Formation	Wolfcamp	Strawn	Morrow
b. Top and Bottom of Pay Section (Perforations)	9660 - 9710	10,398 - 10,430	11,326 - 11,616
c. Type of production (Oil or Gas)	Gas	Gas	Gas
d. Method of Production (Flowing or Artificial Lift)	Flowing	Flowing	Flowing

4. The following are attached. (Please check YES or NO)

Yes	No	
<input checked="" type="checkbox"/>	<input type="checkbox"/>	a. Diagrammatic Sketch of the Multiple Completion, showing all casing strings, including diameters and setting depths, centralizers and/or turbolizers and location thereof, quantities used and top of cement, perforated intervals, tubing strings, including diameters and setting depth, location and type of packers and side door chokes, and such other information as may be pertinent.
<input checked="" type="checkbox"/>	<input type="checkbox"/>	b. Plat showing the location of all wells on applicant's lease, all offset wells on offset leases, and the names and addresses of operators of all leases offsetting applicant's lease.
<input checked="" type="checkbox"/>	<input type="checkbox"/>	c. Waivers consenting to such multiple completion from each offset operator, or in lieu thereof, evidence that said offset operators have been furnished copies of the application.*
<input checked="" type="checkbox"/>	<input type="checkbox"/>	d. Electrical log of the well or other acceptable log with tops and bottoms of producing zones and intervals of perforation indicated thereon. (If such log is not available at the time application is filed, it shall be submitted as provided by Rule 112-A.)

5. List all offset operators to the lease on which this well is located together with their correct mailing address.

Coquina Oil Corp. **200 Bldg. of the Southwest, Midland, Texas 79701**

The Superior Oil Company **Box 1900, Midland, Texas 79701**

Gulf Oil Company, U.S. **Box 2100, Midland, Texas 79701**

6. Were all operators listed in Item 5 above notified and furnished a copy of this application? YES X NO _____. If answer is yes, give date of such notification 3/4/74.

CERTIFICATE: I, the undersigned, state that I am the District Production Mgr. of the Monsanto Company (company), and that I am authorized by said company to make this report; and that this report was prepared under my supervision and direction and that the facts stated therein are true, correct and complete to the best of my knowledge.

A. W. Wood
Signature **A. W. Wood**

*Should waivers from all offset operators not accompany an application for administrative approval, the New Mexico Oil Conservation Commission will hold the application for a period of twenty (20) days from date of receipt by the Commission's Santa Fe office. If, after said twenty-day period, no protest nor request for hearing is received by the Santa Fe office, the application will then be processed.

NOTE: If the proposed multiple completion will result in an unorthodox well location and/or a non-standard proration unit in one or more of the producing zones, then separate application for approval of the same should be filed simultaneously with this application.

NEW MEXICO OIL CONSERVATION COMMISSION
SANTA FE, NEW MEXICO
APPLICATION FOR MULTIPLE COMPLETION

Form C-107
5-1-61

Case
5200

Operator MONSANTO COMPANY		County EDDY	Date March 4, 1974
Address 101 N. Marienfeld, Midland, Texas 79701		Lease WILDERSPIN	Well No. 1
Location of Well F	Unit 11	Township 21S	Range 27E

1. Has the New Mexico Oil Conservation Commission heretofore authorized the multiple completion of a well in these same pools or in the same zones within one mile of the subject well? YES _____ NO X
2. If answer is yes, identify one such instance: Order No. _____; Operator Lease, and Well No.: _____

3. The following facts are submitted:	Upper Zone	Intermediate Zone	Lower Zone
a. Name of Pool and Formation	Wolfcamp	Strawn	Morrow
b. Top and Bottom of Pay Section (Perforations)	9660 - 9710	10,398 - 10,430	11,326 - 11,616
c. Type of production (Oil or Gas)	Gas	Gas	Gas
d. Method of Production (Flowing or Artificial Lift)	Flowing	Flowing	Flowing

4. The following are attached. (Please check YES or NO)

- | | | |
|-------------------------------------|--------------------------|---|
| Yes | No | |
| <input checked="" type="checkbox"/> | <input type="checkbox"/> | a. Diagrammatic Sketch of the Multiple Completion, showing all casing strings, including diameters and setting depths, centralizers and/or turbolizers and location thereof, quantities used and top of cement, perforated intervals, tubing strings, including diameters and setting depth, location and type of packers and side door chokes, and such other information as may be pertinent. |
| <input checked="" type="checkbox"/> | <input type="checkbox"/> | b. Plat showing the location of all wells on applicant's lease, all offset wells on offset leases, and the names and addresses of operators of all leases offsetting applicant's lease. |
| <input checked="" type="checkbox"/> | <input type="checkbox"/> | c. Waivers consenting to such multiple completion from each offset operator, or in lieu thereof, evidence that said offset operators have been furnished copies of the application.* |
| <input checked="" type="checkbox"/> | <input type="checkbox"/> | d. Electrical log of the well or other acceptable log with tops and bottoms of producing zones and intervals of perforation indicated thereon. (If such log is not available at the time application is filed it shall be submitted as provided by Rule 112-A.) |

5. List all offset operators to the lease on which this well is located together with their correct mailing address.

Coquina Oil Corp. **200 Bldg. of the Southwest, Midland, Texas 79701**

The Superior Oil Company **Box 1900, Midland, Texas 79701**

Gulf Oil Company, U.S. **Box 2100, Midland, Texas 79701**

6. Were all operators listed in Item 5 above notified and furnished a copy of this application? YES X NO _____. If answer is yes, give date of such notification 3/4/74.

CERTIFICATE: I, the undersigned, state that I am the District Production Mgr. of the Monsanto Company (company), and that I am authorized by said company to make this report; and that this report was prepared under my supervision and direction and that the facts stated therein are true, correct and complete to the best of my knowledge.

A. W. Wood
Signature **A. W. Wood**

*Should waivers from all offset operators not accompany an application for administrative approval, the New Mexico Oil Conservation Commission will hold the application for a period of twenty (20) days from date of receipt by the Commission's Santa Fe office. If, after said twenty-day period, no protest nor request for hearing is received by the Santa Fe office, the application will then be processed.

NOTE: If the proposed multiple completion will result in an unorthodox well location and/or a non-standard proration unit in one or more of the producing zones, then separate application for approval of the same should be filed simultaneously with this application.

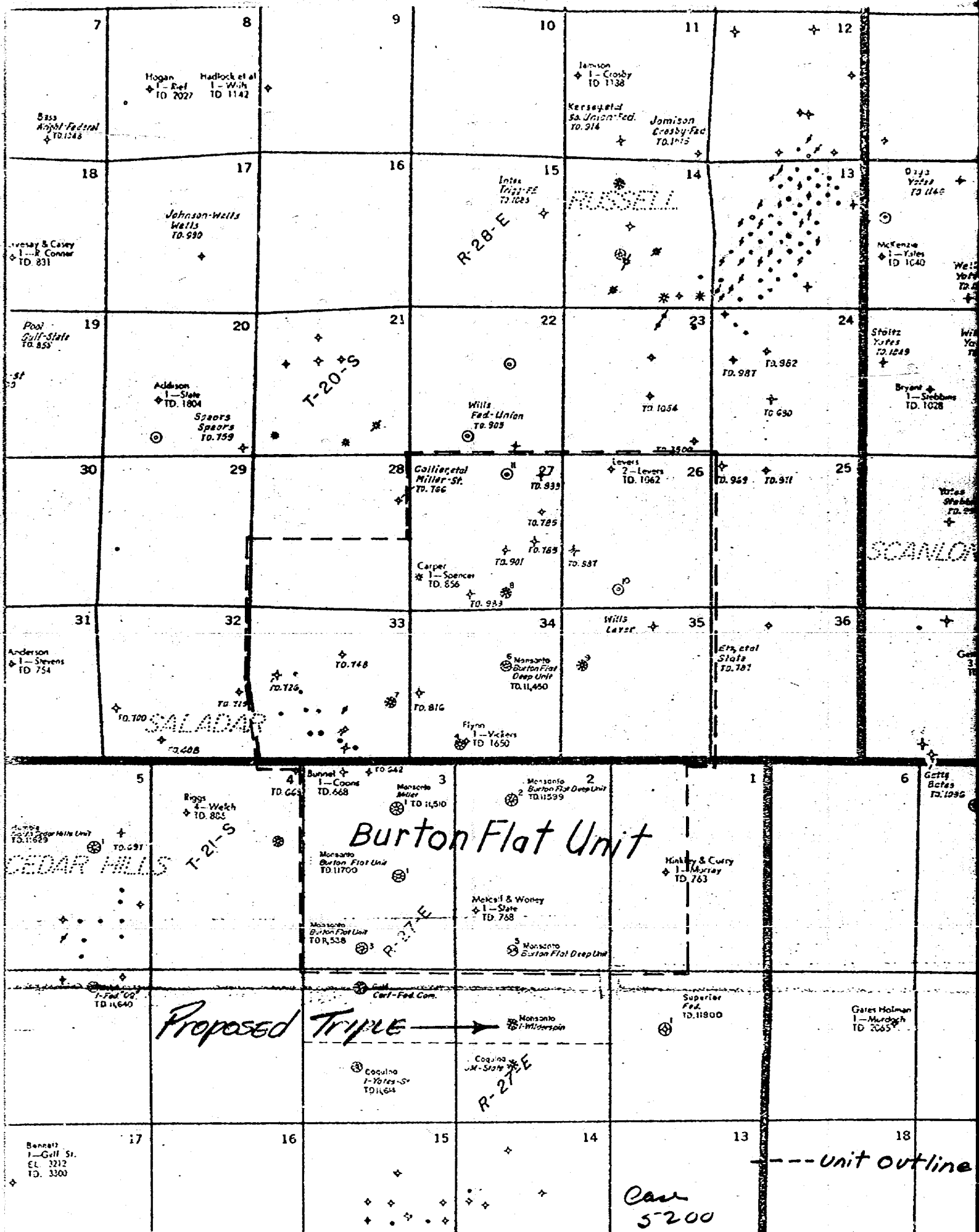

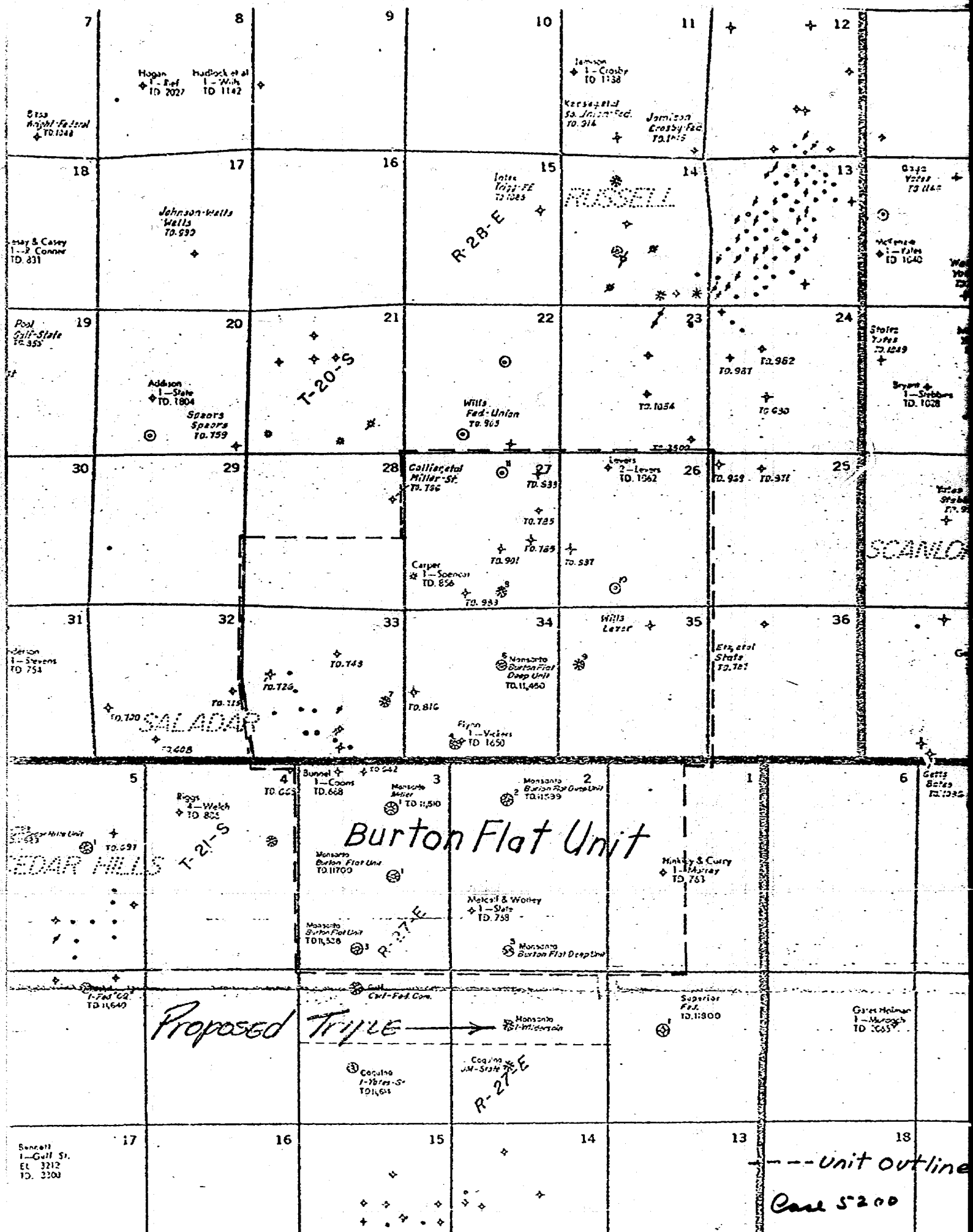

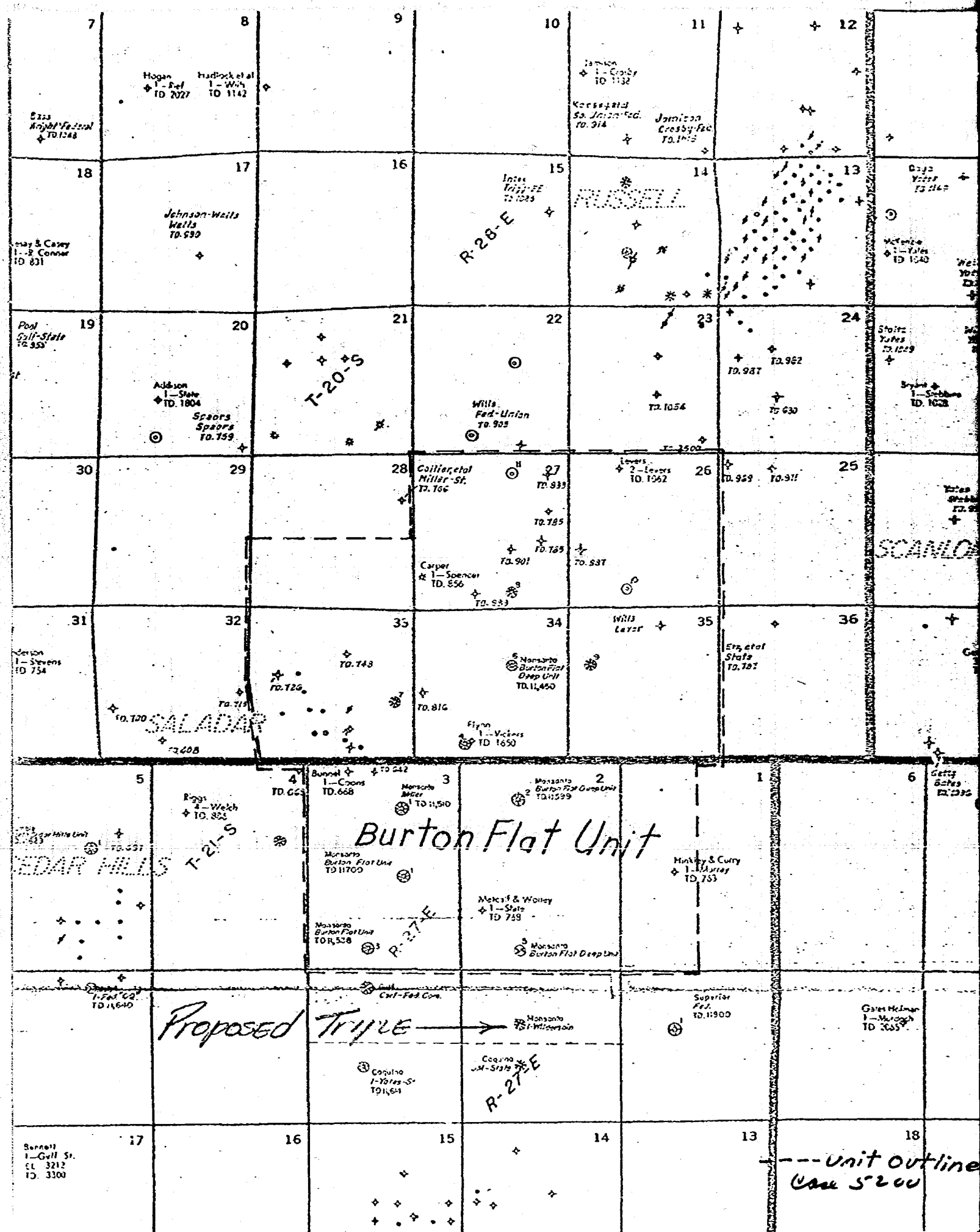

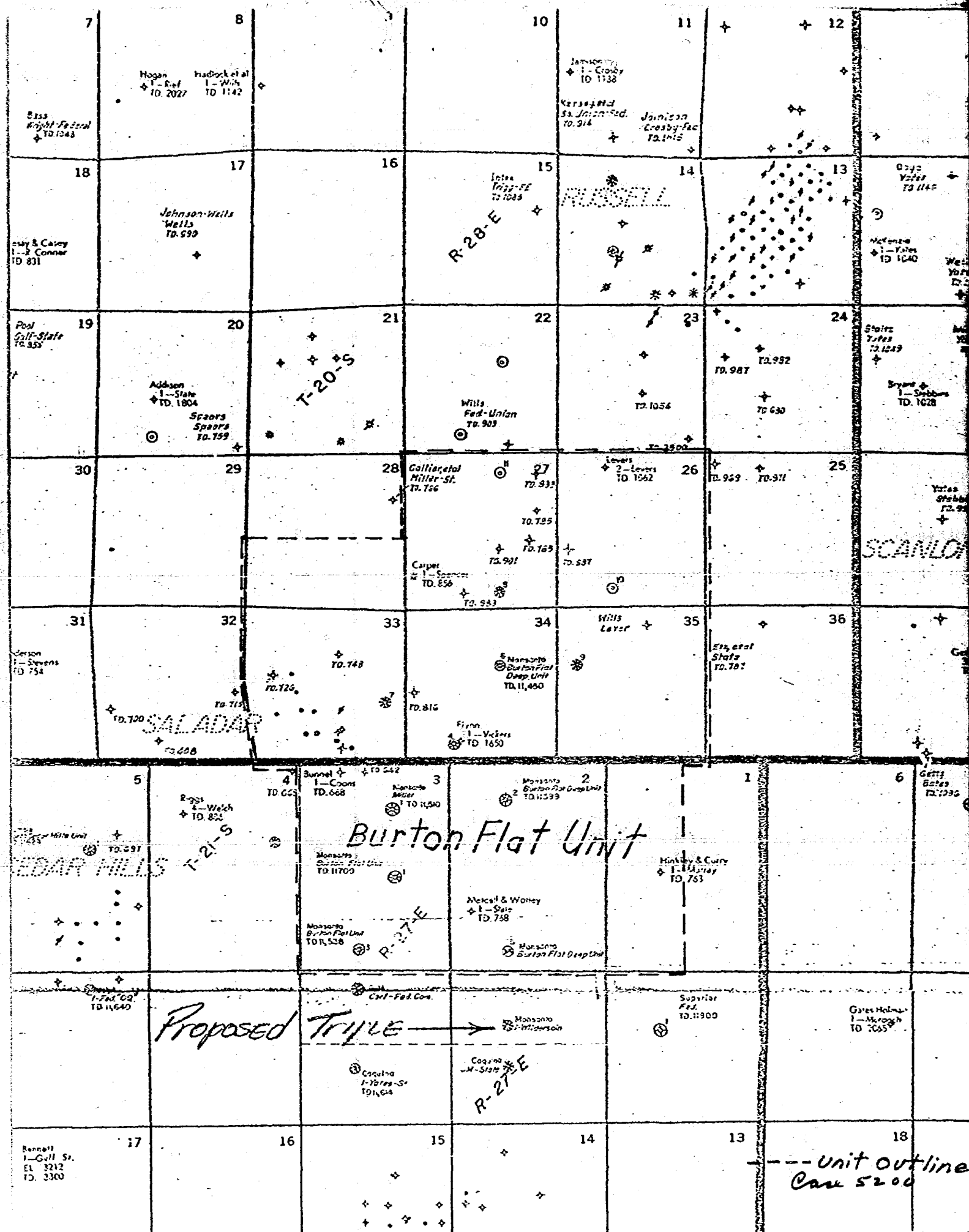

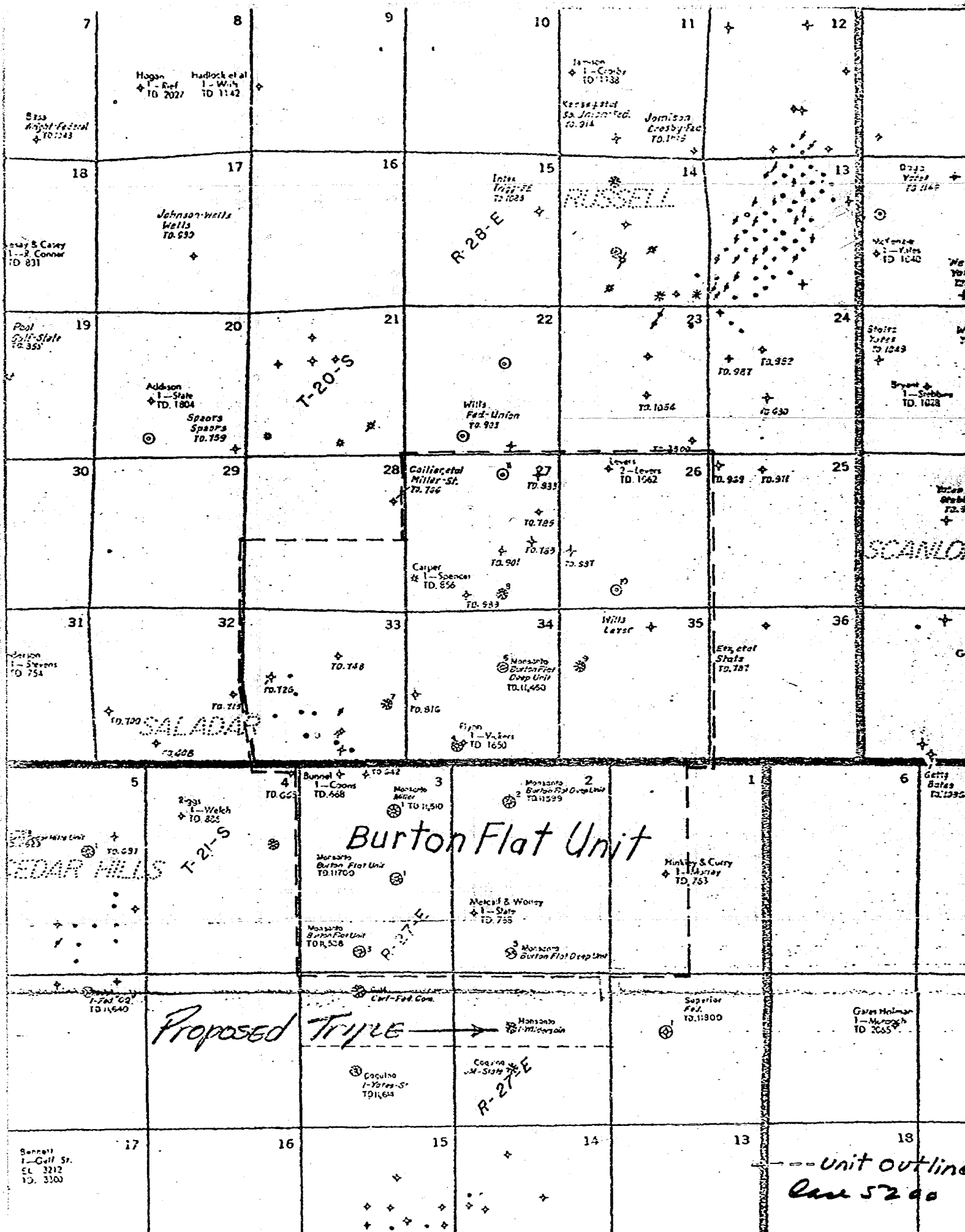

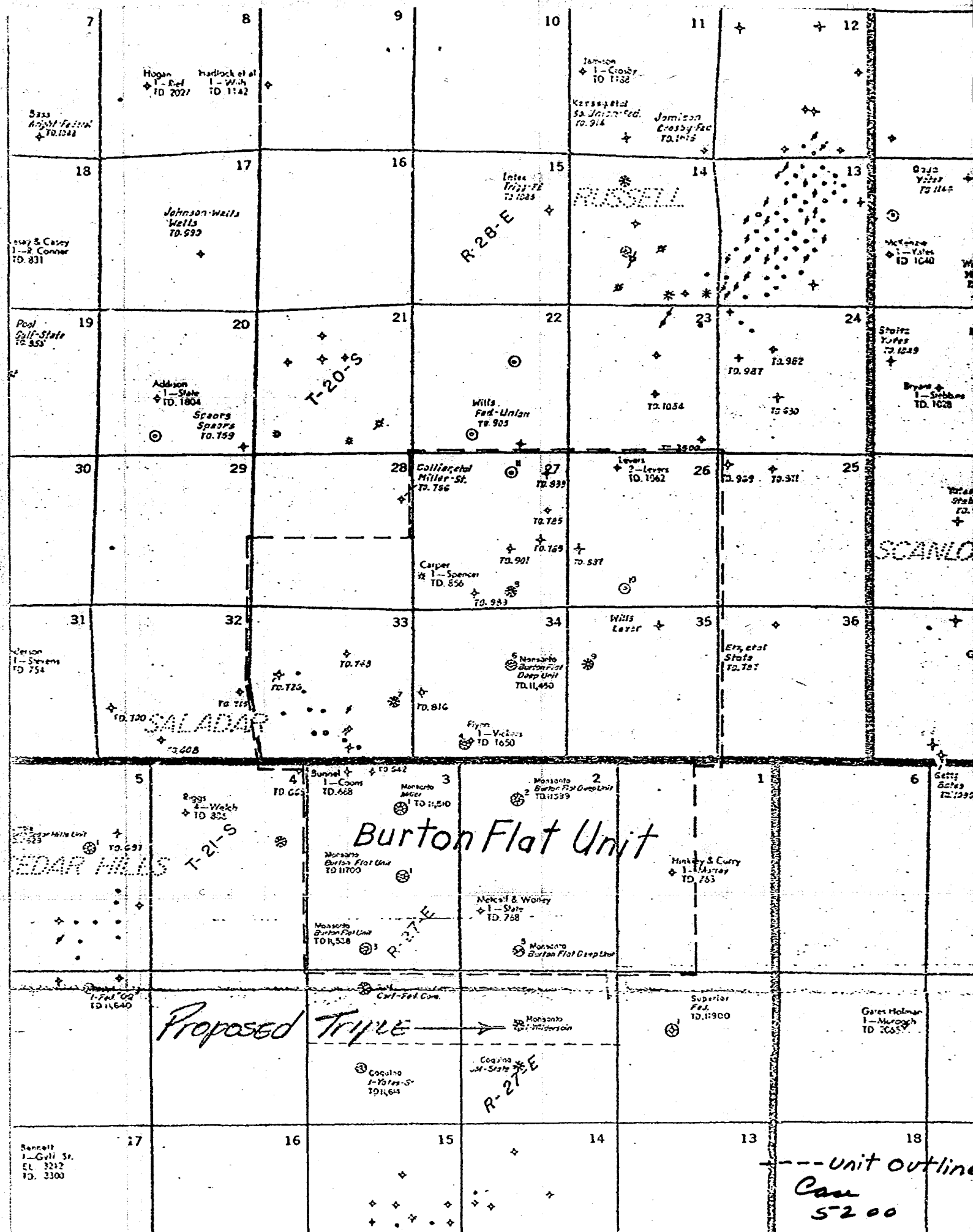

MONSANTO COMPANY
Wilderspin #1
Eddy Co. New Mexico

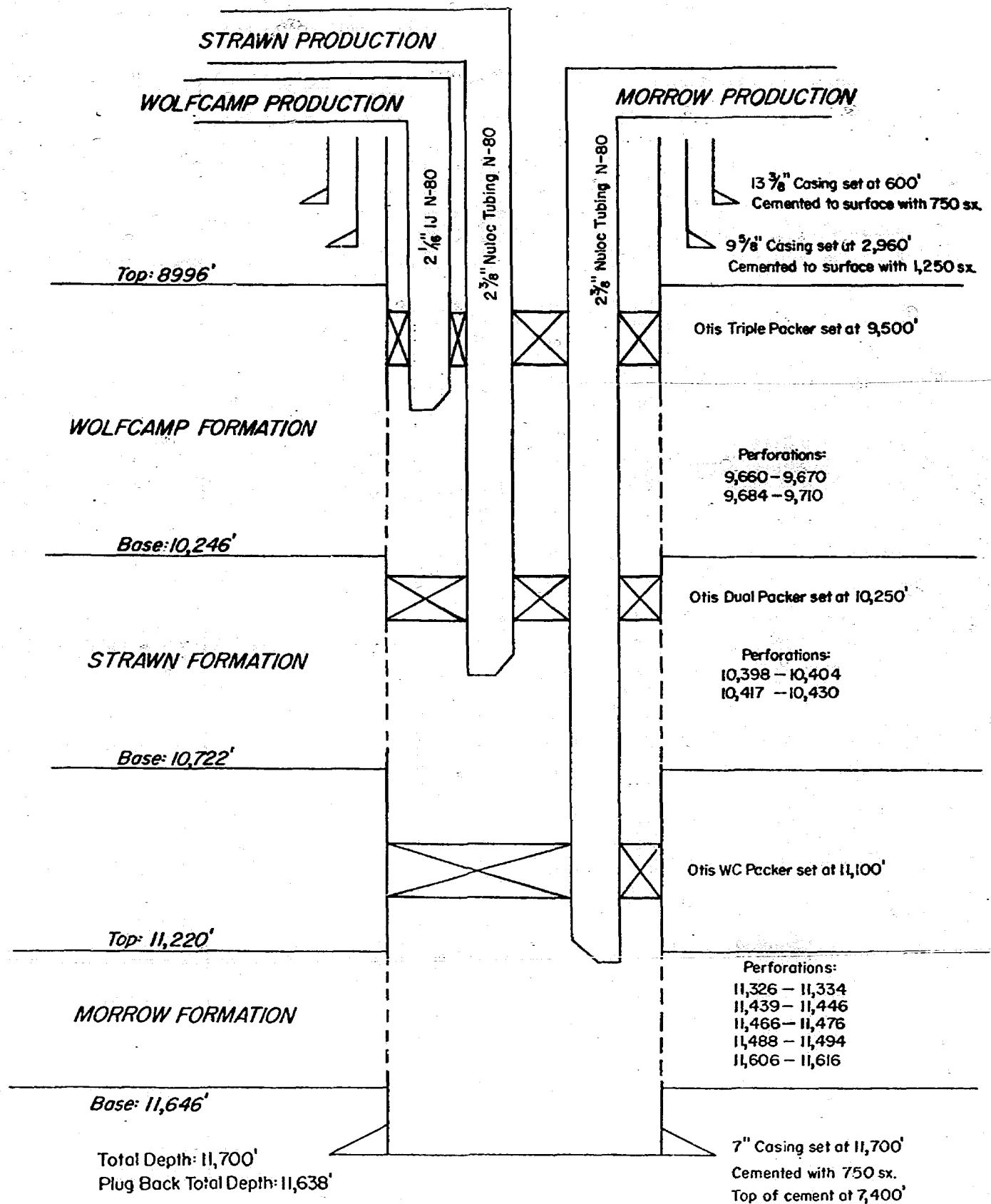

Case 5200

DRAFT

jr/

BEFORE THE OIL CONSERVATION COMMISSION
OF THE STATE OF NEW MEXICO

IN THE MATTER OF THE HEARING
CALLED BY THE OIL CONSERVATION
COMMISSION OF NEW MEXICO FOR
THE PURPOSE OF CONSIDERING:

CASE No. 5200

Order No. R-4760

APPLICATION OF MONSANTO COMPANY
FOR A TRIPLE COMPLETION, EDDY COUNTY,
NEW MEXICO.

ORDER OF THE COMMISSION

BY THE COMMISSION:

This cause came on for hearing at 9 o'clock a.m. on
March 27, 1987, at Santa Fe, New Mexico, before Examiner
Daniel S. Nutter.

NOW, on this day of April, 1987, the Commission,
a quorum being present, having considered the testimony, the record,
and the recommendations of the Examiner, and being fully advised
in the premises,

FINDS:

(1) That due public notice having been given as required by
law, the Commission has jurisdiction of this cause and the subject
matter thereof.

(2) That the applicant, Monsanto Company,
seeks authority to complete its Wilderspin

Well No. 1, located in Unit F of Section 11, Township

21 South, Range 27 East, NMPM, Eddy County, New
~~XXXXXX~~ ~~West~~

Mexico, as a triple completion (conventional) to produce gas
~~(conventional)~~ ~~(conventional)~~ ~~(conventional)~~

and formations
from the Wolfcamp, Strawn, Morrow ~~pool~~ through three
parallel strings of tubing, with ~~upper~~ packers set at approximately
9500 feet, 10,250 feet, and 11,100 feet.

(3) That the mechanics of the proposed triple completion are feasible and in accord with good conservation practices.

(4) That approval of the subject application will prevent waste and protect correlative rights.

IT IS THEREFORE ORDERED:

(1) That the applicant, Monsanto Company,
is hereby authorized to complete its Wilderspin
Well No. 1, located in Unit F of Section 11, Township
Burton Flats Field,
21 ~~South~~ Range 27 East, NMPM, Eddy County, New
~~XXXX~~ Mexico, as a triple completion ^(conventional) ~~(combination)~~ to produce gas
^(Kudryntse) ~~(Kudryntse)~~
from the Wolfcamp, Strawn, and Morrow ^{formation} ~~Rock~~ through three
^{an upper}
parallel strings of tubing, with packers set at
approximately 9500 feet, ~~10,250 feet, and~~
~~11,100 feet~~ and separation of the producing
zones accomplished by two other packers, one
set at approximately 10,250 feet and the
other at approximately 11,100 feet.
PROVIDED HOWEVER, that the applicant shall complete, operate,
and produce said well in accordance with the provisions of Rule
112-A of the Commission Rules and Regulations insofar as said rule
is not inconsistent with this order;

PROVIDED FURTHER, that the applicant shall take packer-leakage
tests upon completion and annually thereafter during the Annual Shut-In
Pressure
~~Gas-Oil Ratio~~ Test Period for the Burton Flats-Morrow Gas Pool.
~~Deliverability~~

(2) That jurisdiction of this cause is retained for the
entry of such further orders as the Commission may deem necessary.

DONE at Santa Fe, New Mexico, on the day and year herein-
above designated.