

Case No.

503

---

Application, Transcript,  
Small Exhibits, Etc.

CASE 503: Continental Oil Company  
Dual Completion: A. E. Meyer B-9 No. 1  
NE SW 9-21S-36E Lea County

BEFORE THE OIL CONSERVATION COMMISSION  
OF THE STATE OF NEW MEXICO

IN THE MATTER OF THE HEARING  
CALLED BY THE OIL CONSERVATION  
COMMISSION OF NEW MEXICO FOR  
THE PURPOSE OF CONSIDERING:

CASE NO. 503  
ORDER No. R-292

THE APPLICATION OF CONTINENTAL  
OIL COMPANY FOR AN ORDER GRANTING  
PERMISSION TO DUALY COMPLETE AND  
PRODUCE ITS MEYER B-9, WELL NO. 1,  
LOCATED IN THE NE/4 SW/4 OF SECTION 9,  
TOWNSHIP 21 SOUTH, RANGE 36 EAST, NMPM,  
LEA COUNTY, NEW MEXICO.

ORDER OF THE COMMISSION

BY THE COMMISSION:

This cause came on for hearing at 9 o'clock a.m. on March 17, 1953, at Santa Fe, New Mexico, before the Oil Conservation Commission, hereinafter referred to as the "Commission".

NOW, on this 31<sup>ST</sup> day of *MARCH*, 1953, the Commission, a quorum being present, having considered the records and the testimony adduced, and being fully advised in the premises,

FINDS:

(1) That due notice having been given as required by law, the Commission has jurisdiction of the case and the persons and subject matter thereof.

(2) That applicant's Meyer B-9, Well No. 1, NE/4 SW/4, Section 9, Township 21 South, Range 36 East, NMPM, Lea County, New Mexico, was completed in December 1934 as an oil well producing from the Grayburg formation of the Eunice-Monument Pool in the open-hole interval 3769-3900, having drilled through the Yates-Seven Rivers-Queen formation of the Eumont Gas Pool at an approximate depth of 2990-3725.

(3) That although recent experiments tend to show that mechanical packers and other devices are ordinarily available for successful dual/multiple completions of oil - gas wells, the Commission is unconvinced of the soundness as a waste-prevention practice, of such dual/multiple completions as a general practice in New Mexico without specific controls over each such project.

IT IS THEREFORE ORDERED:

That the applicant herein, Continental Oil Company, be, and it hereby is authorized to dually complete and produce its Meyer B-9, Well No. 1, NE/4 SW/4 Section 9, Township 21 South, Range 36 East, NMPM, Lea County, New Mexico, in such a manner that gas from the Yates-Seven Rivers Queen formation of the Eumont Gas Pool may be produced through the annular space between the casing and the tubing, and oil from the Grayburg formation of the Eunice-Monument Pool through the tubing by proper perforations and the installation of a proper packer;

Case No. 503  
Order No. R-292

PROVIDED, HOWEVER, That this approval shall be subject to like approval by the United States Geological Survey and that upon the actual dual completion of such subject well applicant shall submit to the District Office of the Commission in which the well is located an approved copy of the appropriate Federal government form showing the actual work done, plus copies of Oil Conservation Commission Form C-104, Form C-110, and Form C-122 outlining the information required on those forms by existing Rules and Regulations.

PROVIDED, HOWEVER, That subject well shall be completed, and thereafter produced, in such a manner that there will be no commingling within the well bore, either within or outside the casing of gas, oil and gas, or oil produced from either or both of the separate strata, and,

PROVIDED FURTHER, That said subject well for dual completion and production shall be equipped in such a way that reservoir pressures may be determined separately for each of the two specified strata, and further, be equipped with all necessary connections required to permit recording meters to be installed and used, at any time, as may be required by the Commission or its representatives, in order that natural gas, oil, or oil and gas from each separate stratum may be accurately measured and the gas-oil ratio thereof determined, and,

PROVIDED FURTHER, That the operator applicant shall make any and all tests, including segregation tests, but not excluding other tests and/or determinations at any convenient time and in such manner as deemed necessary by the Commission; the original and all subsequent tests shall be witnessed by representatives of the Commission and by representatives of offset operators, if any there be, at their election, and the results of each test properly attested to by the applicant herein and all witnesses, and shall be filed with the Commission within ten (10) days after the completion of such test, and,

PROVIDED FURTHER, That upon the actual dual completion of such subject well, applicant shall submit to the Commission a diagrammatic sketch of the mechanical installation which was actually used to complete and produce the seal between the strata, and a special report of production, gas/oil ratio and reservoir pressure determination of each producing zone or stratum immediately following completion.

IT IS FURTHER ORDERED: That jurisdiction of this cause is hereby retained by the Commission for such further order or orders as may seem necessary or convenient for the prevention of waste and/or protection of correlative rights; upon failure of applicant to comply with any requirement of this order after proper notice and hearing, the Commission may terminate the authority hereby granted and require applicant or its successors and assigns to limit its activities to regular single-zone production in the interests of conservation.

DONE at Santa Fe, New Mexico, on the day and year hereinabove designated.

STATE OF NEW MEXICO  
OIL CONSERVATION COMMISSION

  
EDWIN L. MECHEM, Chairman

  
E. S. WALKER, Member

  
R. R. SPURR, Secretary

S E A L

BEFORE THE OIL CONSERVATION COMMISSION  
OF THE  
STATE OF NEW MEXICO

IN THE MATTER OF THE APPLICATION OF  
CONTINENTAL OIL COMPANY FOR AN ORDER  
GRANTING IT PERMISSION TO DUALY COMPLETE  
A. E. MEYER B-9 NO. 1 WELL, EUNICE POOL,  
NE/4 SW/4, SECTION 9, T.21S, R.36E,  
N.M.P.M. LEA COUNTY, NEW MEXICO

CASE NO. 502

A P P L I C A T I O N

Comes now CONTINENTAL OIL COMPANY, a Delaware corporation, herein-  
after called "Applicant", and respectfully requests the Oil Conservation  
Commission of the State of New Mexico to issue an order authorizing Applicant  
to dually complete its A. E. Meyer B-9 No. 1 well, located 1980 feet North  
of the South line and 1980 feet East of the West line of the SW/4, Section  
9, T.21S, R.36E, N.M.P.M., Lea County, New Mexico, in the Grayburg formation  
and the Yates, Seven Rivers, and Queen formations, and in support thereof  
would show the following:

Said well was completed December 16, 1934 in the Grayburg forma-  
tion as an oil well and Applicant now desires to complete the same in the  
Yates, Seven Rivers, and Queen formations as a gas well also, and Applicant  
represents that it is practical and economically feasible to so dually  
complete said well in such a manner as that there will be no commingling  
fluids between the oil and gas reservoirs.

Attached to this Application is a plat showing the location  
the subject well and surrounding wells and leaseholds.

WHEREFORE, Applicant respectfully requests that this matter  
set down for hearing on due notice and that upon final hearing the  
Conservation Commission of the State of New Mexico enter its order  
ing Applicant to dually complete said well in accordance with the  
application and rules and regulations of the Commission.

DONE at Hobbs, New Mexico, this 26th day of January,

CONTINENTAL OIL CO.

By C. E. WILSON  
C. E. WILSON  
Dist. Supt  
West Texas  
Productive

BEFORE THE OIL CONSERVATION COMMISSION

OF THE

STATE OF NEW MEXICO

IN THE MATTER OF THE APPLICATION OF  
CONTINENTAL OIL COMPANY FOR AN ORDER  
GRANTING IT PERMISSION TO DUALY COMPLETE  
A. E. MEYER B-9 NO. 1 WELL, MUNICE POOL,  
NE/4 SW/4, SECTION 9, T.21S, R.36E,  
N.M.P.M. LEA COUNTY, NEW MEXICO

CASE NO. 503

A P P L I C A T I O N

Comes now CONTINENTAL OIL COMPANY, a Delaware corporation, herein-  
after called "Applicant", and respectfully requests the Oil Conservation  
Commission of the State of New Mexico to issue an order authorizing Applicant  
to dually complete its A. E. Meyer B-9 No. 1 well, located 1980 feet North  
of the South line and 1980 feet East of the West line of the SW/4, Section  
9, T.21S, R.36E, N.M.P.M., Lea County, New Mexico, in the Grayburg formation  
and the Yates, Seven Rivers, and Queen formations, and in support thereof  
would show the following:

Said well was completed December 16, 1934 in the Grayburg forma-  
tion as an oil well and Applicant now desires to complete the same in the  
Yates, Seven Rivers, and Queen formations as a gas well also, and Applicant  
represents that it is practical and economically feasible to so dually  
complete said well in such a manner as that there will be no commingling of  
fluids between the oil and gas reservoirs.

Attached to this Application is a plat showing the location of  
the subject well and surrounding wells and leaseholds.

WHEREFORE, Applicant respectfully requests that this matter be  
set down for hearing on due notice and that upon final hearing the Oil  
Conservation Commission of the State of New Mexico enter its order authoriz-  
ing Applicant to dually complete said well in accordance with the foregoing  
application and rules and regulations of the Commission.

DONE at Hobbs, New Mexico, this 26th day of January, 1953.

CONTINENTAL OIL COMPANY

By C. C. Wilson  
C. C. WILSON  
Dist. Supt., New Mexico Dist.  
West Texas-New Mexico Divn.  
Production Department

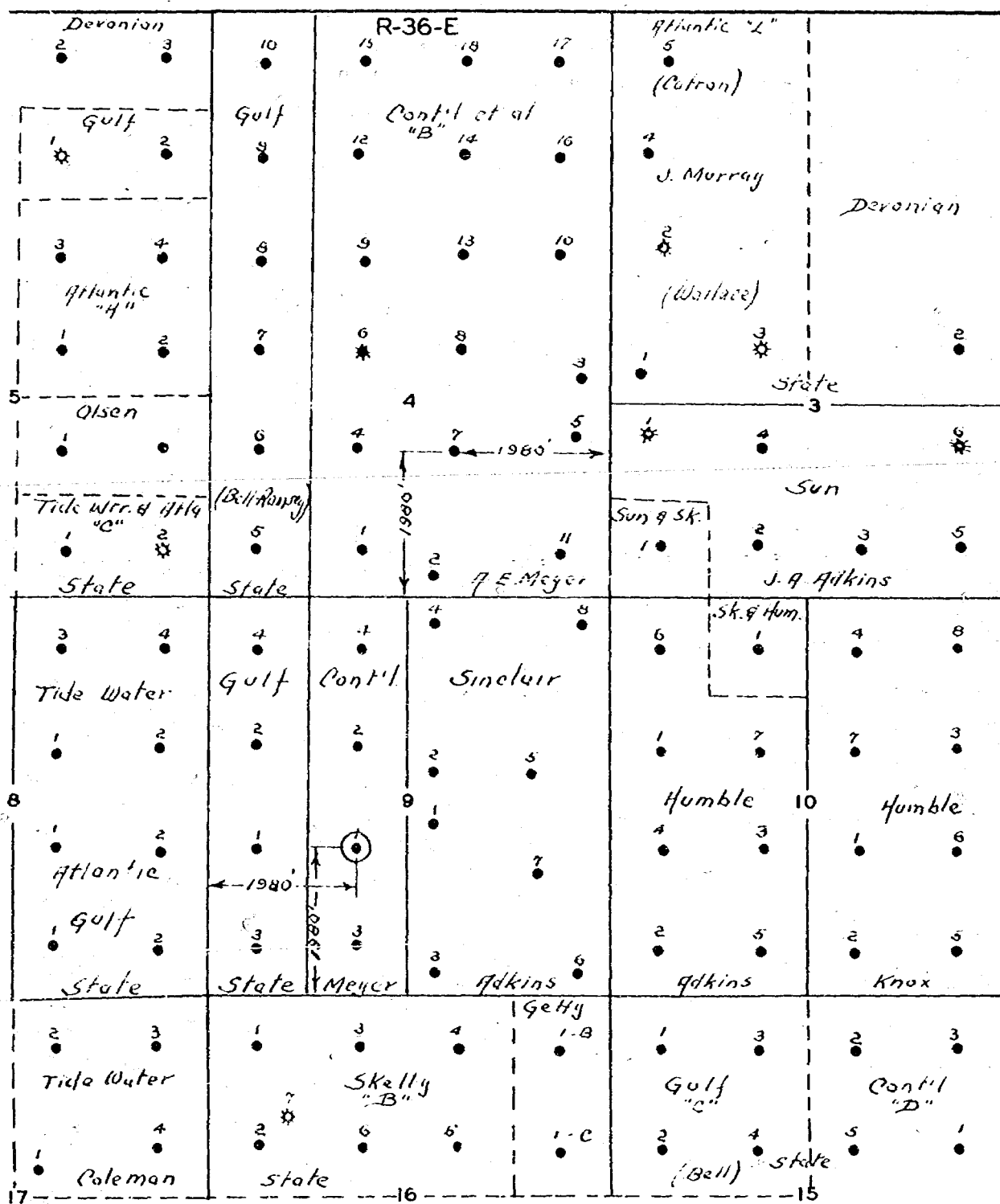

CONTINENTAL OIL COMPANY  
LEASE MAP - EUNICE AREA  
SCALE: 1" = 2000'

CONTINENTAL OIL COMPANY  
MEYER B-9110.1

COMPLETION

PROPOSED DUAL COMPLETION

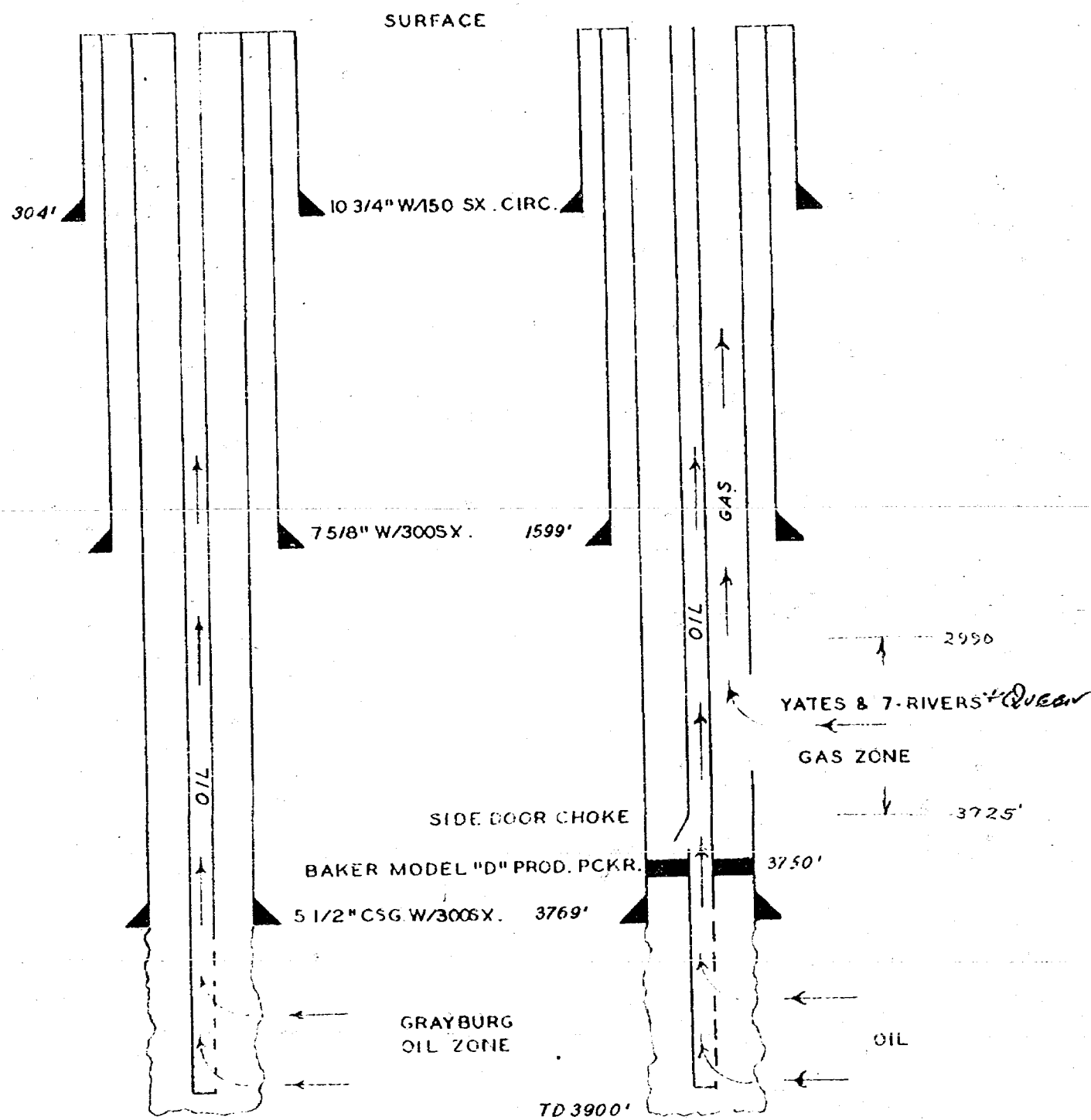

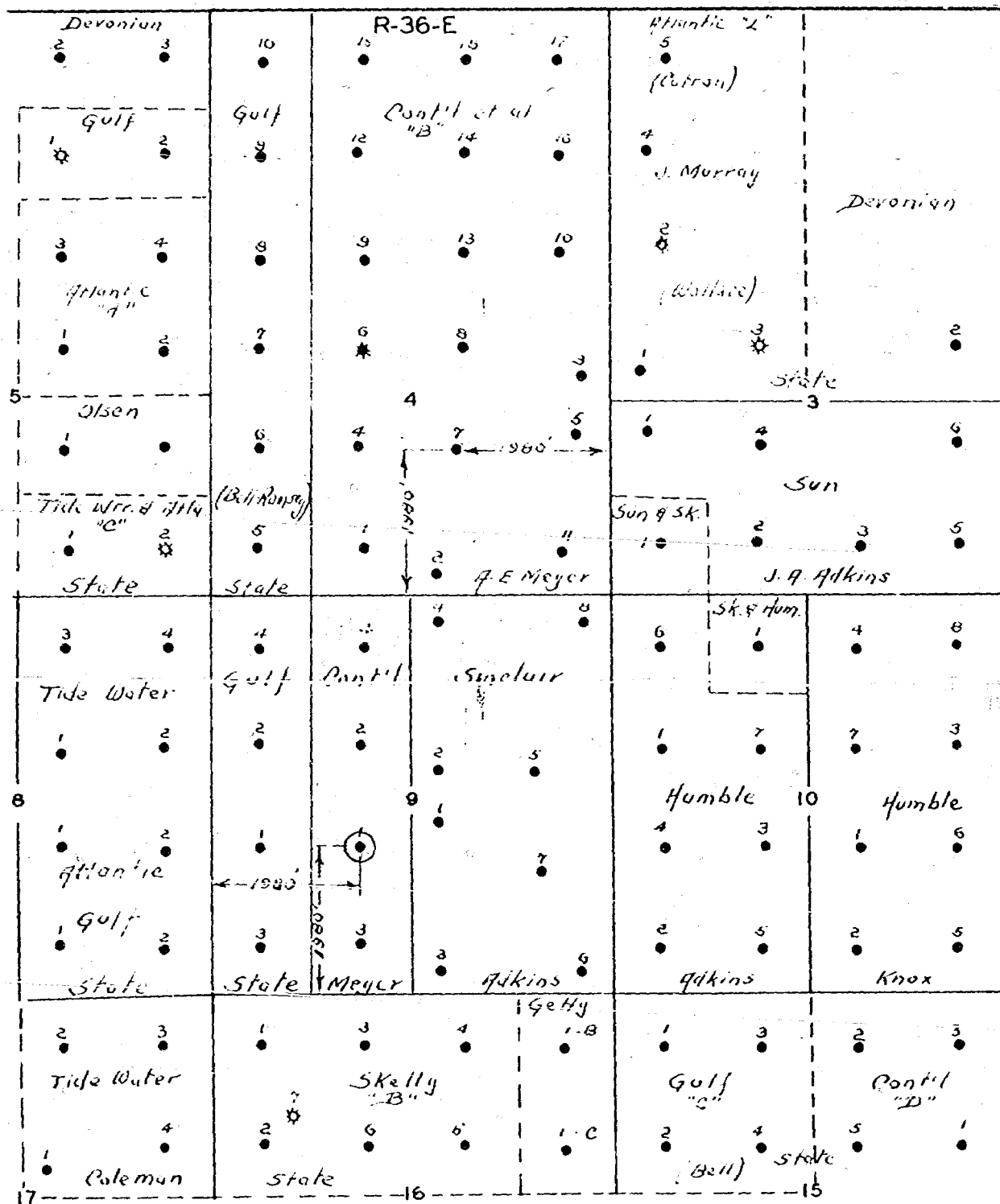

CONTINENTAL OIL COMPANY  
LEASE MAP - EUNICE AREA  
SCALE: 1" = 2000'

II. M. LIST. OFFICE

503 C 2

JAN. 28, 1953



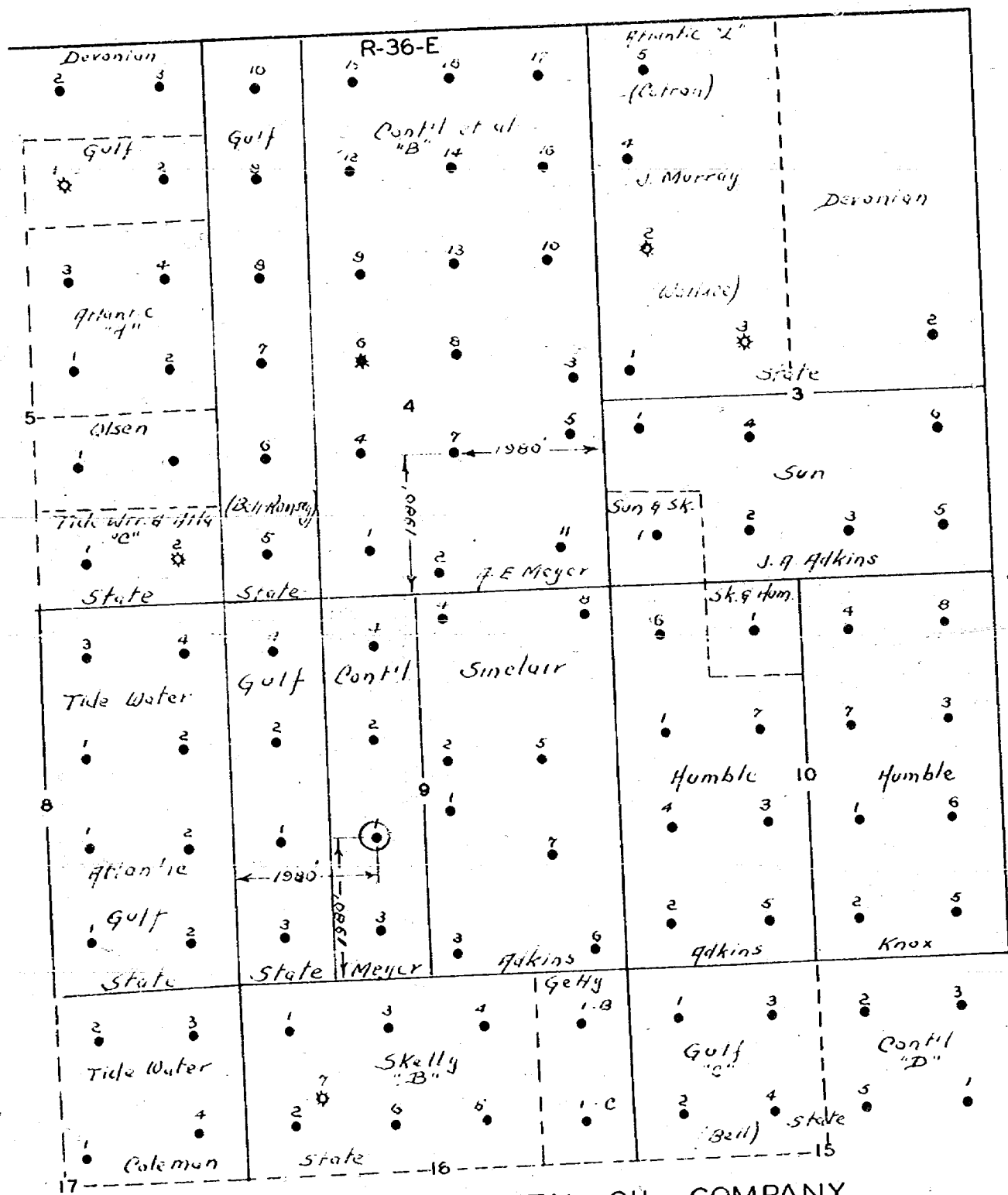

CONTINENTAL OIL COMPANY  
LEASE MAP - EUNICE AREA  
SCALE: 1" = 2000'

JAN. 28, 1952

U. M. DIST. OFFICE