

Case No.

519

Application, Transcript,  
Small Exhibits, Etc.

NO.  
CASE 519: Sinclair Oil & Gas Company  
Dual Completion Oil & Gas Well No. 4  
SE NW 23-22S-37E Lea County

BEFORE THE  
OIL CONSERVATION COMMISSION  
STATE OF NEW MEXICO

Santa Fe, New Mexico  
March 17, 1953

TRANSCRIPT OF HEARING  
CASE NO. 519

ADA DEARNLEY & ASSOCIATES  
COURT REPORTERS  
ROOM 12, CROMWELL BLDG  
PHONES 7-9645 AND 5-9546  
ALBUQUERQUE, NEW MEXICO

OIL CONSERVATION COMMISSION  
SANTA FE, N. M.  
MAR 30 1953

BEFORE THE  
OIL CONSERVATION COMMISSION  
STATE OF NEW MEXICO

Santa Fe, New Mexico  
March 17, 1953

In the Matter of:

Sinclair Oil and Gas Company's application  
for permission to dually complete (gas-oil)  
its Ollie Boyd Well No. 4, SE NW, 23-22S-37E,  
Drinkard Pool, Lea County.

Case No. 519

TRANSCRIPT OF HEARING

(Notice of Publication read by Mr. Graham.)

MR. ALMAN: J. B. Alman, Junior, for Sinclair.

W. J. ROGERS,

having been first duly sworn, testified as follows:

DIRECT EXAMINATION

By MR. ALMAN:

Q State your name and address, please.

A W. J. Rogers, Midland, Texas.

Q By whom are you employed?

A How long?

Q By whom?

A Sinclair Oil and Gas Company.

Q In what capacity?

A Division Production Engineer.

Q Have you previously qualified to testify as an engineer  
before this Commission?

A Not before this Commission.

ADA DEARNLEY & ASSOCIATES  
COURT REPORTERS  
ROOM 105-106, EL CORTEZ BLDG.  
PHONES 7-9645 AND 5-9546  
ALBUQUERQUE, NEW MEXICO

Q State your education and background to qualify you.

A I graduated in the year 1937 at Texas Western with a degree in mining engineering, Bachelor of Science.

Q How long have you been engaged in the profession of petroleum engineer?

A Since 1937, that would be 15 years.

MR. ALMAN: Does the Commission accept the qualifications of this witness?

MR. SPURRIER: They will.

Q I hand you a plat marked Exhibit A and ask you if this plat was prepared under your supervision?

A Yes, sir.

Q Are the entries on the plat correct, to the best of your knowledge?

A Yes, sir.

Q Would you explain them?

A The plat shows all the wells on Sinclair's Ollie Boyd lease in Section 23, Township 22 South, Range 37 East. It also shows the offset operators and offset wells.

Q Are you familiar with the application on the Ollie Boyd No. 4 well?

A Yes, sir.

Q Was that well drilled in full compliance with the orders, rules and regulations of this Commission?

A Yes, sir.

Q Is the applicant the full owner of the working interest of the lease involved?

A That is correct.

Q I will hand you here an instrument marked Exhibit C and ask you to state to the Commission what this is.

A This is an electric log on the Ollie Boyd No. 4, Slumber J Electric Log.

Q How deep has the well been drilled?

A It was drilled to a total depth of 6,418.

Q Will you give me the top and bottom of the Drinkard as found in this well?

A The Drinkard is found from 5,392 to 5,450.

Q I believe that is the Blinebry.

A I am sorry, that is the Blinebry. The Drinkard is from 6,385 to 6,414.

Q What is the top and bottom of the Blinebry as found in the well?

A Blinebry top is 5,392 and the bottom 5,450.

Q Is the well now completed in the Drinkard?

A Yes, sir.

Q What is it producing?

A It is flowing 8 barrels of oil and no water per day.

Q You want to dually complete this well in the Blinebry and Drinkard, is that correct?

A Yes, sir.

Q I hand you what has been marked Exhibit B and ask you if you prepared this instrument?

A Yes, sir, it was prepared under my supervision.

Q Does it show the method of dual completion?

A Yes, sir.

Q Go ahead.

ADA DEARNLEY & ASSOCIATES  
COURT REPORTERS  
ROOM 105-106, EL CORTEZ BLDG.  
PHONES 7-9645 AND 5-9546  
ALBUQUERQUE, NEW MEXICO

A It shows the production packer will be set at approximately 6300, it shows that the Drinkard will be produced through the tubing and the Blinebry gas zone will be produced through the annular space.

Q If this application is granted, will the production be separately produced, reported and measured at the surface?

A Yes, sir.

Q Has the well been cased?

A Yes, sir.

Q Would you state the casing program together with the cement used?

A Seven inch casing was set on bottom, or within one foot of bottom at 6417. The well was cemented with 350 sacks by temperature survey, the top of the cement was indicated to be at a depth of 4349, nine by seven inch.

Q That is above the top of the upper formation?

A That is correct.

Q Do you have any other information about the well which you think is applicable to this case?

A No, sir, I believe not.

Q Those are all the questions we have.

MR. ALMAN: We offer in evidence Exhibits A, B and C.

MR. SPURRIER: Without objection they will be received.

Does anyone have a question of the witness? If not the witness may be excused.

(Witness excused.)

MR. SPURRIER: Any comments in the case? If not we will take the case under advisement.

STATE OF NEW MEXICO )  
                          : SS.  
COUNTY OF BERNALILLO )

I, ADA DEARNLEY, hereby certify that the above and foregoing transcript of proceedings in Case No. 519, taken before the Oil Conservation Commission on March 17, 1953, at Santa Fe, New Mexico, is a true and correct record.

Dated in Albuquerque, New Mexico, this 25th day of March, 1953.

Ada Dearnley  
Notary Public

My Commission Expires:  
June 19, 1955.

ADA DEARNLEY & ASSOCIATES  
COURT REPORTERS  
ROOM 105-106, EL CORTEZ BLDG.  
PHONES 7-9645 AND 5-9546  
ALBUQUERQUE, NEW MEXICO



March 6, 1953

Mr. T. H. Hammett  
Sinclair Oil & Gas Company  
Sinclair Building  
TULSA, OKLAHOMA

Dear Mr. Hammett:

Your application for dual completion of your Ollie Boyd  
Well No. 4, SE/4 NW/4 Sect. 23, Twp. 22 South, Rge. 37  
East, NMFM, has been set up as Case 519 and is scheduled  
for the March 17, 1953, hearing of the Oil Conservation  
Commission.

Very truly yours,

For R. R. Spurrier

RRS:mr

*Case 519*

# SINCLAIR OIL & GAS COMPANY

SINCLAIR BUILDING

TULSA, OKLAHOMA

February 16, 1953

T. H. HAMMETT  
VICE-PRESIDENT

Mr. R. R. Spurrier, Secretary  
New Mexico Oil Conservation Commission  
Santa Fe, New Mexico

Dear Sir:

Enclosed herewith, in triplicate, find our Application for permit to dually complete our Well No. 4, Ollie Boyd, located in the SE NW of Section 23-22S-37E, Lea County, New Mexico in the Drinkard and Blinbry common sources of supply.

Will you please acknowledge receipt of this Application, and set same down for hearing at an early date, advising the undersigned date hearing is to be had?

Yours very truly,

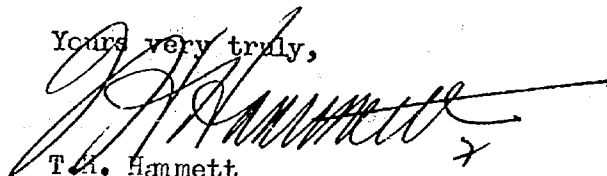

T. H. Hammett

/as

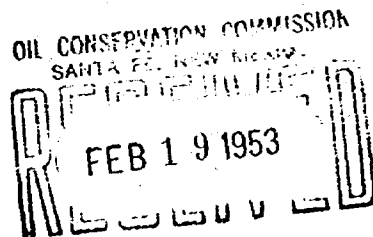

OIL CONSERVATION COMMISSION  
P. O. BOX 871  
SANTA FE, NEW MEXICO

April 8, 1953

Mr. T. H. Hammett  
Sinclair Oil & Gas Company  
Sinclair Building  
TULSA, OKLAHOMA

Dear Sir:

We attach two official copies of Order R-308 issued in  
Case 519, which was heard by the Commission upon your  
company's petition at the regular March 17 hearing.

Very truly yours,

W. B. Macey  
Chief Engineer

WBM:nr

C  
O  
P  
Y

Exhibit A

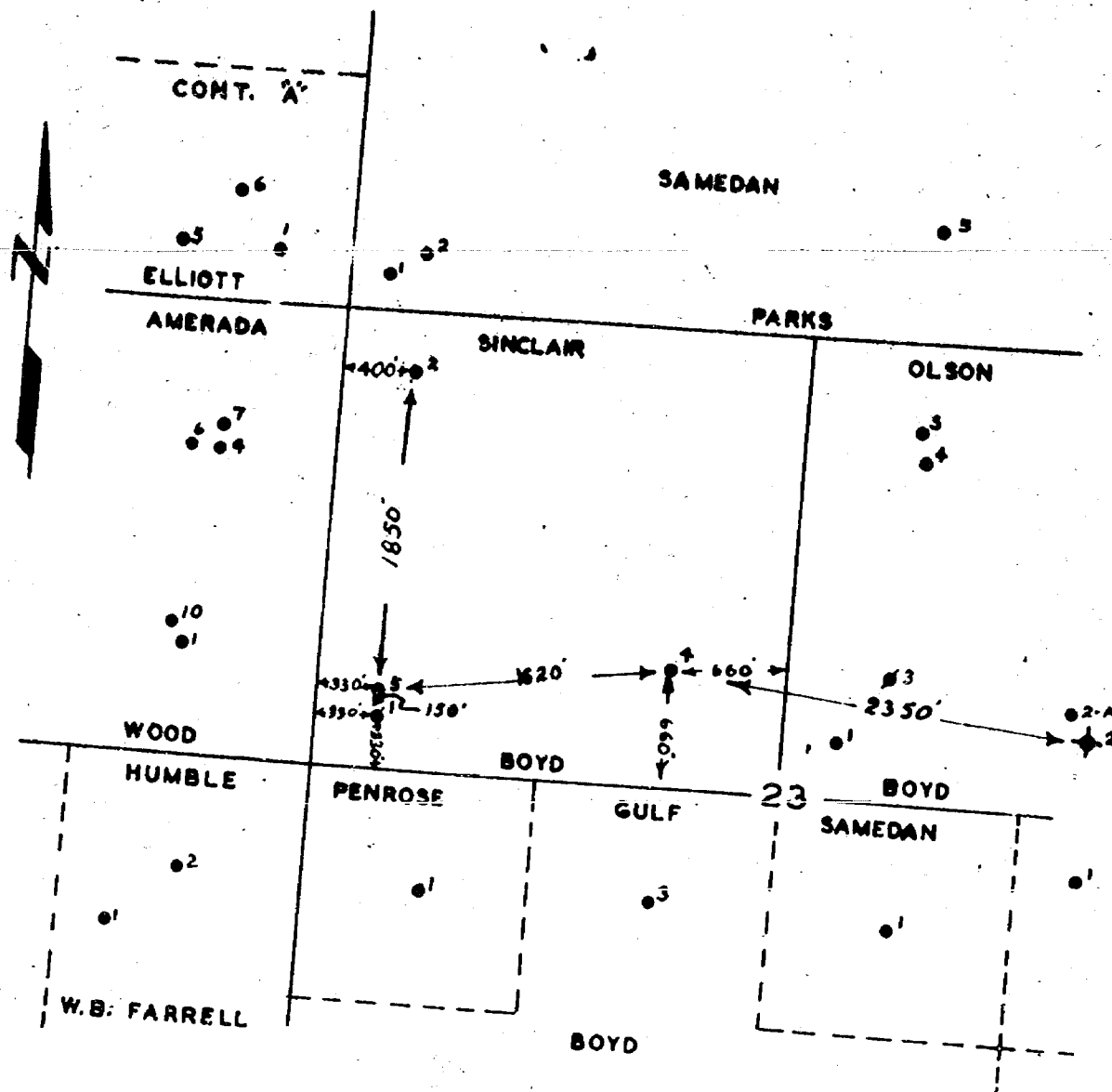

NOTE:  
 PORTION OF SEC. 23, 22, 14 & 15.  
 22 SOUTH & R-37-E LEA CO.  
 NEW MEXICO

SINCLAIR OIL & GAS

PRODUCTION DEPARTMENT  
 12-3-52

SCALE: 1"=1000'  
 DRAWN: F.W.T.

MIDLAND,  
 TEXAS

BEFORE THE OIL CONSERVATION COMMISSION  
OF THE STATE OF NEW MEXICO

IN THE MATTER OF THE HEARING  
CALLED BY THE OIL CONSERVATION  
COMMISSION OF NEW MEXICO FOR  
THE PURPOSE OF CONSIDERING:

CASE NO. 519  
Order No. R-308

THE APPLICATION OF SINCLAIR OIL  
AND GAS COMPANY FOR AN ORDER  
GRANTING PERMISSION TO DUALY  
COMPLETE AND PRODUCE ITS OLLIE  
BOYD WELL NO. 4, LOCATED IN THE  
SE/4 NW/4 OF SECTION 23, TOWNSHIP  
22 SOUTH, RANGE 37 EAST, NMPM, LEA  
COUNTY, NEW MEXICO.

ORDER OF THE COMMISSION

BY THE COMMISSION:

This cause came on for hearing at 9 o'clock a.m. on March 17, 1953, at Santa Fe, New Mexico, before the Oil Conservation Commission, hereinafter referred to as the "Commission".

NOW, on this 31<sup>ST</sup> day of *MARCH*, 1953, the Commission, a quorum being present, having considered the records and the testimony adduced, and being fully advised in the premises,

FINDS:

(1) That due notice having been given as required by law, the Commission has jurisdiction of the case and the persons and subject matter thereof.

(2) That the applicant's Ollie Boyd Well No. 4, SE/4 NW/4 Section 23, Township 22 South, Range 37 East, NMPM, Lea County, New Mexico, was completed in October 1946 as an oil well producing from the Drinkard formation of the Drinkard Pool through casing perforations 6385-6414, having drilled through the Blinebry gas zone of the Blinebry Gas Pool at an approximate depth of 5395-5450.

(3) That although recent experiments tend to show that mechanical packers and other devices are ordinarily available for successful dual/multiple completions of oil - gas wells, the Commission is unconvinced of the soundness as a waste-prevention practice, of such dual/multiple completions as a general practice in New Mexico without specific controls over each such project.

IT IS THEREFORE ORDERED:

That the applicant herein, Sinclair Oil and Gas Company, be, and it hereby is authorized to dually complete and produce its Ollie Boyd Well No. 4, SE/4 NW/4 Section 23, Township 22 South, Range 37 East, NMPM, Lea County, New Mexico, in such a manner that gas from the Blinebry formation of the Blinebry Gas Pool may be produced through the annular space between the casing and the tubing, and oil from the Drinkard formation of the Drinkard Pool through the tubing by proper perforations and the installation of a proper packer;

Case No. 519 - Order No. R-308

PROVIDED, HOWEVER, That upon the actual dual completion of such subject well applicant shall submit to the District Office of the Commission in which the subject well is located Form C-103, Form C-104, Form C-110 and Form C-122 outlining the information required on these forms by existing Rules and Regulations.

PROVIDED, HOWEVER, That subject well shall be completed, and thereafter produced, in such a manner that there will be no commingling within the well bore, either within or outside the casing of gas, oil and gas, or oil produced from either or both of the separate strata, and,

PROVIDED FURTHER, That said subject well for dual completion and production shall be equipped in such a way that reservoir pressures may be determined separately for each of the two specified strata, and further, be equipped with all necessary connections required to permit recording meters to be installed and used, at any time, as may be required by the Commission or its representatives, in order that natural gas, oil, or oil and gas from each separate stratum may be accurately measured and the gas-oil ratio thereof determined, and,

PROVIDED FURTHER, That the operator applicant shall make any and all tests, including segregation tests, but not excluding other tests and/or determinations at any convenient time and in such manner as deemed necessary by the Commission; the original and all subsequent tests shall be witnessed by representatives of the Commission and by representatives of offset operators, if any there be, at their election, and the results of each test properly attested to by the applicant herein and all witnesses, and shall be filed with the Commission within ten (10) days after the completion of such test, and,

PROVIDED FURTHER, That upon the actual dual completion of such subject well, applicant shall submit to the Commission a diagrammatic sketch of the mechanical installation which was actually used to complete and produce the seal between the strata, and a special report of production, gas/oil ratio and reservoir pressure determination of each producing zone or stratum immediately following completion.

IT IS FURTHER ORDERED: That jurisdiction of this cause is hereby retained by the Commission for such further order or orders as may seem necessary or convenient for the prevention of waste and/or protection of correlative rights; upon failure of applicant to comply with any requirement of this order after proper notice and hearing, the Commission may terminate the authority hereby granted and require applicant or its successors and assigns to limit its activities to regular single-zone production in the interests of conservation.

DONE at Santa Fe, New Mexico, on the day and year hereinabove designated.

STATE OF NEW MEXICO  
OIL CONSERVATION COMMISSION

  
EDWIN L. MECHEM, Chairman

  
E. S. WALKER, Member

  
R. R. SPURRIER, Secretary

S E A L

DIAGRAMMATIC SKETCH SHOWING DUAL COMPLETION INSTALLATION  
WITHOUT CROSS-OVER PACKER

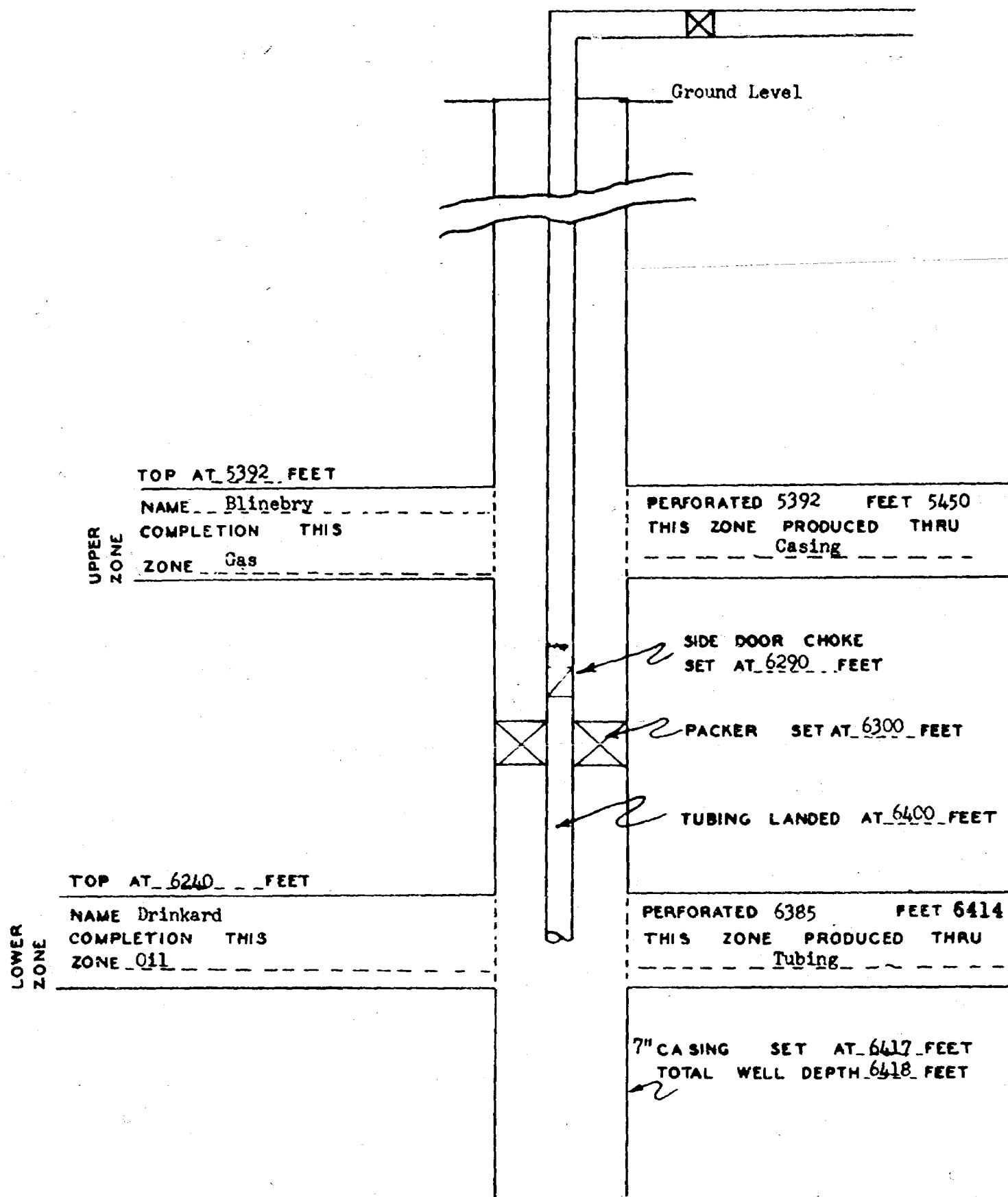

COMPANY: Sinclair Oil & Gas Company

LEASE: Clie Boyd #4

FIELD: Drinkard

DATE: 12-3-52

BEFORE THE OIL CONSERVATION COMMISSION  
OF  
THE STATE OF NEW MEXICO

IN THE MATTER OF THE APPLICATION OF )  
SINCLAIR OIL & GAS COMPANY FOR A )  
PERMIT TO DUALY COMPLETE ITS ) CAUSE NO. 519  
OLLIE BOYD WELL NO. 4, LOCATED IN )  
THE SE $\frac{1}{4}$  NW $\frac{1}{4}$  SEC. 23, TWP. 22 S., ) FILED \_\_\_\_\_  
RGE. 37 E., LEA COUNTY, NEW MEXICO, )  
IN THE DRINKARD AND BLINEBRY COMMON ) HEARING SET 3-17-53  
SOURCES OF SUPPLY. )

A P P L I C A T I O N

Comes now Sinclair Oil & Gas Company and respectfully shows to the Oil Conservation Commission as follows, to wit:

1. That Applicant is the owner of an oil and gas lease covering, among other lands, the

Southeast Quarter of Northwest Quarter  
(SE $\frac{1}{4}$  NW $\frac{1}{4}$ ) of Section Twenty-three (23),  
Township Twenty-two (22) South, Range  
Thirty-seven (37) East, Lea County,  
New Mexico,

upon which it has heretofore drilled its Ollie Boyd Well No. 4 as a producer from the Blinebry formation; that attached hereto, marked Exhibit A and made a part hereof, is a plat showing the location of said well, together with the location of all off-set drilling and producing wells and dry holes and the names of the lessees of record.

2. That said Ollie Boyd Well No. 4 was completed on October 9, 1946, at a total depth of 6418 feet; that 7-inch O.D. production casing was set at 6417 feet; that said casing was perforated between the interval of 6385 feet and 6414 feet opposite the Drinkard formation and said well has been producing oil therefrom; that Applicant discovered gas in the Blinebry formation between the approximate depths of 5395 feet and 5450 feet.

3. That Applicant desires and herewith proposes that it be permitted to dually complete said Ollie Boyd Well No. 4 by perforating the 7-inch O.D. production casing between the approximate interval of 5392 feet and 5450 feet opposite the Blinebry formation, then setting a production type packer at the approximate depth of 6300 feet and thereafter separately producing oil from the Drinkard formation through the tubing and gas from the Blinebry formation through the annular space between the tubing and the casing.

4. That attached hereto, marked Exhibit B and made a part hereof, is a schematic diagram of the proposed dual installation.

5. That the proposed dual completion method is mechanically feasible and will result in separate production and reporting from the Drinkard and Blinebry common sources of supply; that Applicant has drilled, completed and produced said Ollie Boyd Well No. 4 in compliance with the rules and regulations of this Commission and will continue to comply with said rules and regulations if permitted to dually complete said well in the manner proposed.

6. That the completion of the well in the manner proposed will not result in waste, as defined by law, nor in the violation of the correlative rights of any offsetting operators or royalty owners, but on the contrary, such a completion is in the interest of conservation and the protection of correlative rights.

WHEREFORE, Applicant prays that this matter be set down for hearing, that notice thereof be given as required by law and that upon final hearing this Commission enter its order permitting Applicant to dually complete its Ollie Boyd Well No. 4 in the Drinkard formation and the Blinebry formation common sources of supply.

SINCLAIR OIL & GAS COMPANY

By Ralph W. Garrett

Robt. L. Juler

Gus. D. Almon, Jr.

Dudley C. Phillips

Its Attorneys

DCP:ap

Exhibit A

CONT. A

SAMEDAN

ELLIOTT

PARKS

AMERADA

SINOCLAIR

OLSON

WOOD

HUMBLE

W.B. FARRELL

PENROSE

GULF

BOYD

BOYD

BOYD

23

2350'

660'

620'

1850'

400'

330'

150'

609'

2-A

1

2

3

4

5

6

7

8

9

10

NOTE:  
 PORTION OF SEC. 23, 22, 14 & 15.  
 22 SOUTH & R-37-E LEA CO.  
 NEW MEXICO

SINOCLAIR OIL & GAS

PRODUCTION DEPARTMENT  
 12-3-52

SCALE: 1"=1000'  
 DRAWN: F.W.T.

MIDLAND,  
 TEXAS

DIAGRAMMATIC SKETCH SHOWING DUAL COMPLETION INSTALLATION  
WITHOUT CROSS-OVER PACKER

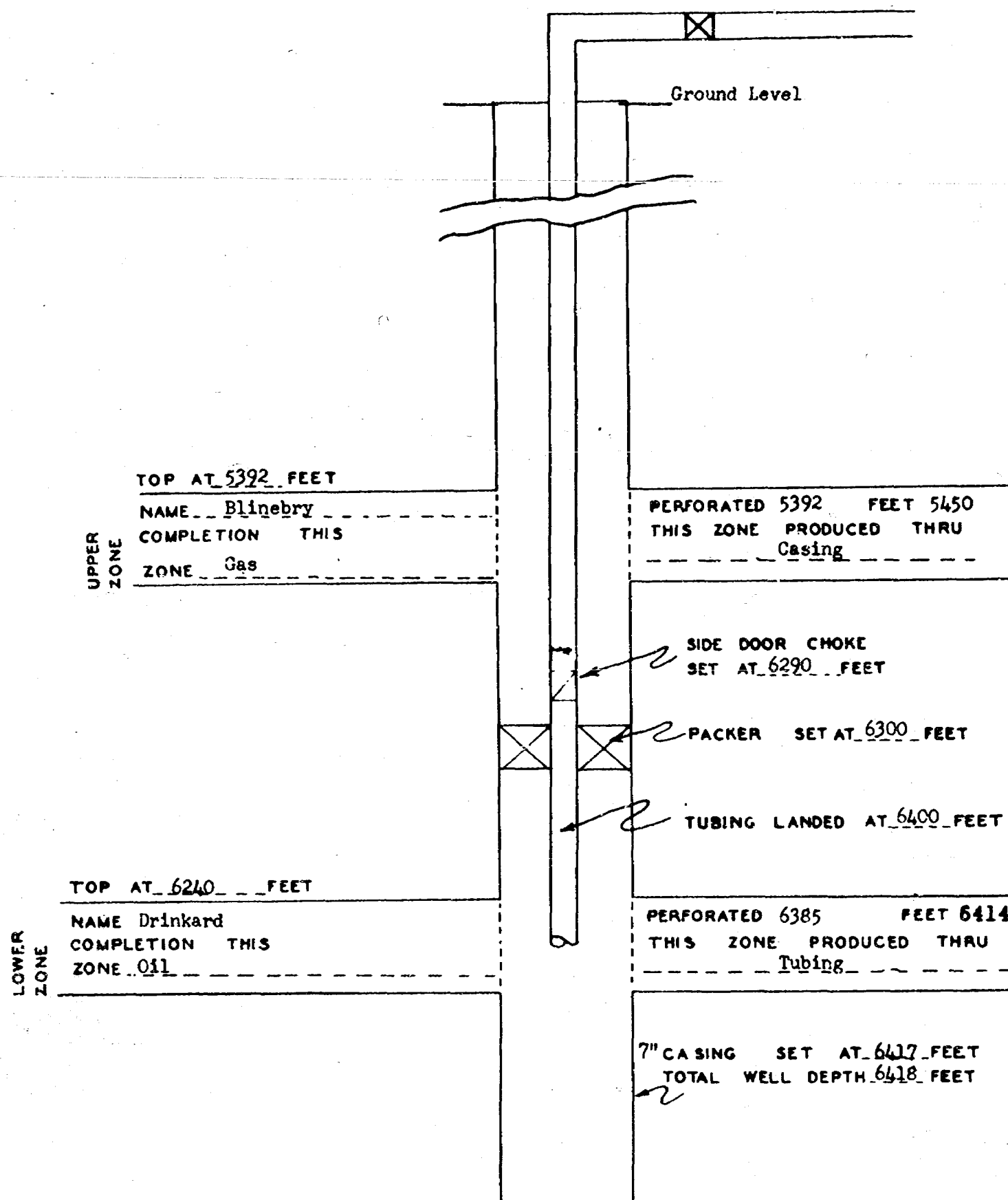

COMPANY: Sinclair Oil & Gas Company

LEASE: Ollie Boyd #4

FIELD: Drinkard

DATE: 12-3-52

