

Case No.

931

Application, Transcript,
Small Exhibits, Etc.

Handwritten signature

CASE 931: Application of El Paso Natural
Gas for 440-acre non-standard gas pro-
duction unit, Jalmet, Gregory Federal #1

BEFORE THE OIL CONSERVATION COMMISSION
OF THE STATE OF NEW MEXICO

IN THE MATTER OF THE HEARING
CALLED BY THE OIL CONSERVATION
COMMISSION OF THE STATE OF NEW
MEXICO FOR THE PURPOSE OF
CONSIDERING:

CASE NO. 931
Order No. R-687

THE APPLICATION OF EL PASO NATURAL
GAS COMPANY FOR AN ORDER GRANTING
APPROVAL OF AN EXCEPTION PURSUANT
TO RULE 5 (a) OF THE SPECIAL RULES AND
REGULATIONS FOR THE JALMAT GAS POOL
OF ORDER NO. R-520 IN ESTABLISHMENT OF
A NON-STANDARD GAS PRORATION UNIT OF
440 CONTIGUOUS ACRES CONSISTING OF S/2,
S/2 NW/4, AND NW/4 NW/4 OF SECTION 33,
TOWNSHIP 25 SOUTH, RANGE 37 EAST, NMPM,
LEA COUNTY, NEW MEXICO.

ORDER OF THE COMMISSION

BY THE COMMISSION:

This cause came on for hearing at 9 o'clock a.m. on July 14, 1955
and on August 17, 1955, at Santa Fe, New Mexico, before the Oil Conservation
Commission, hereinafter referred to as the "Commission".

NOW, on this 15th day of September, 1955, the Commission, a
quorum being present, having considered the records and testimony adduced,
and being fully advised in the premises,

FINDS:

(1) That due notice of the time and place of hearing and the purpose
thereof having been given as required by law, the Commission has jurisdiction
of this case and the subject matter thereof.

(2) That pursuant to provisions of Rule 5 (a) of the Special Rules
and Regulations of the Jalmat Gas Pool of Order No. R-520, the Commission
has power and authority to permit the formation of a gas proration unit consist-
ing of other than a legal section after notice and hearing by the Commission.

(3) That applicant, El Paso Natural Gas Company is the owner of
the gas rights in Lea County, New Mexico on land consisting of other than a
legal section, and described as follows, to-wit:

TOWNSHIP 25 SOUTH, RANGE 37 EAST, NMPM
S/2, S/2 NW/4, and NW/4 NW/4 Section 33

containing 440 acres, more or less.

(4) That applicant, El Paso Natural Gas Company, has a producing well on the aforesaid lease known as Gregory Federal No. 1, located 1650 feet from the South and East lines of Section 33, Township 25 South, Range 37 East, NMPM, Lea County, New Mexico.

(5) That the aforesaid well was completed and in production on May 19, 1955, and is located within the horizontal and vertical limits of the pool heretofore delineated and designated as the Jalmat Gas Pool.

(6) That it is impractical to pool applicant's said lease with adjoining acreage in the Jalmat Gas Pool and that the owners of adjoining acreage in said section have not objected to the formation of the proposed proration unit of 440 acres.

(7) That unless a proration unit consisting of applicant's aforesaid acreage is permitted, applicant will be deprived of the opportunity to recover its just and equitable share of the natural gas in the Jalmat Gas Pool.

(8) That creation of a proration unit consisting of the aforesaid acreage will not cause but will prevent waste, and will protect correlative rights.

IT IS THEREFORE ORDERED:

(1) That the application of El Paso Natural Gas Company for approval of a non-standard gas proration unit consisting of the following described acreage:

TOWNSHIP 25 SOUTH, RANGE 37 EAST, NMPM
S/2, S/2 NW/4 and NW/4 NW/4 Section 33

be and the same is hereby approved, and a proration unit consisting of aforesaid acreage is hereby created.

(2) That applicant's well, Gregory Federal No. 1, located in the Jalmat Gas Pool, shall be granted an allowable in the proportion that the above described 440 acre unit bears to the standard or orthodox proration unit for said pool, all until further order of the Commission.

DONE at Santa Fe, New Mexico on the day and year hereinabove designated.

STATE OF NEW MEXICO
OIL CONSERVATION COMMISSION

John F. Simms
JOHN F. SIMMS, Chairman

E. S. Walker
E. S. WALKER, Member

W. B. Macey
W. B. MACEY, Member and Secretary



BEFORE THE
Oil Conservation Commission
SANTA FE, NEW MEXICO
August 17, 1955

IN THE MATTER OF:

CASE NO. 931

TRANSCRIPT OF PROCEEDINGS

ADA DEARNLEY AND ASSOCIATES
COURT REPORTERS
605 SIMMS BUILDING
TELEPHONE 3-6691
ALBUQUERQUE, NEW MEXICO

BEFORE THE
OIL CONSERVATION COMMISSION
Santa Fe, New Mexico

IN THE MATTER OF:

Application of El Paso Natural Gas Company
for approval of a 440-acre non-standard
gas proration unit in the Jalmat Gas Pool,
Lea County, New Mexico, to consist of S/2,
S/2 NW/4, NW/4 NW/4 of Section 33, Town-
ship 25 South, Range 37 East, and to be
dedicated to applicant's Gregory Federal
No. 1 Well located in the NW/4 SE/4 of
said Section 33.

Case No. 931

BEFORE:

Honorable John F. Simms
Mr. E. S. (Johnny) Walker
Mr. William B. Macey

TRANSCRIPT OF HEARING

MR. MACEY: The next case on the docket is Case 931.

MR. HOWELL: We have two witnesses to be sworn.

(Witnesses sworn.)

J. J. BOWDEN,

called as a witness, having been first duly sworn, testified as follows:

DIRECT EXAMINATION

By MR. HOWELL:

Q Will you please state your name?

A J. J. Bowden.

Q What position, if any, do you have with El Paso Natural Gas Company?

A Area Landman with the Lease Department.

Q Are you familiar with the ownership of oil and gas leasehold

rights in Section 33 of Township 25 South, Range 37 East, in Lea County, New Mexico?

A Yes, I am.

MR. HOWELL: A plat covering all of Section 33 and some adjoining wells has been prepared. Will you mark that plat as El Paso's Exhibit No. 1?

(Marked El Paso Natural Gas Company's Exhibit 1, for identification.)

Q With reference to El Paso's Exhibit Number 1, will you state to the Commission the ownership of the oil and gas leasehold rights on those portions of Section 33 which are included within this application, which are outlined on the plat by a slashed line?

A The area covered by the slashed line as to the gas rights, the El Paso Natural Gas Company is the owner to all depths. All of the south half of Section 33, except the east half of the southeast quarter, is owned by the Anderson-Pritchard Oil Corporation. The southeast --

Q (Interrupting) As to the what rights?

A As to the oil rights. R. Olsen Oil Company owns the oil rights in the remaining portion of Section 33 covered by the slashed line.

Q All right now, in the northwest what is the ownership?

A In the northeast of the northwest it is our understanding that Stanolind Oil and Gas Company owns the oil and gas rights; in the northeast quarter, it is our understanding that the northwest of the northeast oil and gas rights are held by Gulf, and the remaining acreage in the northeast quarter of Section 33 is held by J. M. Kelly.

Q As to the remaining portion of the northwest quarter, what is

the ownership of the oil rights?

A It is our understanding that R. Olsen Oil Company has the remaining portion.

Q Was notice of this hearing given to Stanolind Oil and Gas Company, Gulf, and to J. M. Kelly?

A Yes, sir.

Q They were not requested to furnish a waiver, however?

A No, sir, they were not requested to furnish a waiver.

MR. HOWELL: Will you please mark as Exhibit No. 2 a telegram from R. Olsen, which reads: "I hereby consent to your application to form non-standard gas proration unit in Jalmat Pool, Lea County, New Mexico, as applied for in Case 931 set for hearing July 14, 1955, for your Gregory Federal No. 1 Well. Letter follows. Signed: R. Olsen."

(Marked El Paso Natural Gas Company's Exhibit No. 2, for identification.)

Q Was that telegram received pursuant to the notice given to Mr. Olsen?

A That is my understanding.

MR. HOWELL: I think that is all.

MR. MACEY: Any questions of the witness? If not the witness may be excused.

(Witness excused.)

M A R I O N E. S P I T L E R ,

called as a witness, having been first duly sworn, testified as follows:

DIRECT EXAMINATION

By MR. HOWELL:

Q State your name, please.

A Marion E. Spitler.

Q Have you testified before the Commission as a Geologist before?

A No, I have not.

Q Will you state your training, professional training and the nature of the work that you have done?

A I graduated in 1953 from Texas Western College, with a Bachelor of Science Degree in Geology, with a minor in Chemistry, and since that time I have been working for El Paso, at Jal, New Mexico, as an exploration and production geologist, working primarily in Southeast New Mexico.

Q What is your present status with El Paso Natural Gas Company, what position do you hold?

A At this time I am a geologist.

Q Have you prepared and supervised the preparation of certain studies and data with reference to this Section 33, Township 25 South, Range 37 East?

A Yes, sir.

Q Will you state to the Commission what wells are presently located on the Section 33, within the area covered by this application?

A Yes, sir, if you will let me have that data sheet, please.

(Marked El Paso Natural Gas Company's
Exhibit No. 3, for identification.)

A There are nine wells located on that 440-acre unit. One is the Anderson-Pritchard Gregory Federal No. 1; the El Paso Natural Gas Gregory Federal No. 1; the R. Olsen Company Gregory No. 2, Gregory No. 3, Gregory No. 4, Gregory A-5, Gregory A-6 and the R.

Olsen, personal, Gregory 1 and 2.

Q Have you prepared a schedule showing each well, the pool in which it is classified, if so classified; the formation in which the well is completed; the producing interval; the type of completion; completion date; initial potential; the allowables; gas-oil ratios for August 1955 as to oil wells, and for June 1955 as to gas wells; the bottom hole pressure where available; the cumulative production of gas from wells into El Paso Natural Gas Company's system?

A Yes, sir.

Q Is that data accumulated in the schedule on El Paso's Exhibit No. 3?

A Yes, sir.

Q What pools are the other wells located within this 440 acres covered by this application, located and completed at the present time?

A All of the other wells completed in this proposed unit are from the Langlie-Mattix Pool.

Q Is that an oil pool?

A Yes, sir.

Q This El Paso Natural Gas Gregory Federal No. 1 is completed in what formation?

A It is completed entirely in the Yates Formation within the limits of the Jalmat Gas Pool.

Q Is that located within the horizontal limits of the Jalmat Gas Pool?

A Yes, sir, it is.

Q Within the vertical limits of the Jalmat Gas Pool?

A Yes, sir.

Q Has the R. Olsen Gregory No. 1, which is located apparently in the northwest quarter of the southwest quarter of Section 33 -- Let me correct that. Has the R. Olsen Gregory No. 2 been classified at the present time?

A No, it has not.

Q Do you have available as to the formation in which it is completed?

A Yes, sir.

Q In what interval is it completed?

A It is completed from 2970 to 3110 and through perforation.

Q Have you made any studies to determine whether or not the entire 440 acres covered by the application can reasonably be expected to be productive of gas?

A Yes, sir, I have prepared a cross section here which outlines the vertical limits of the Jalmat pay. It also shows the tops of the various formations and illustrates the continuity of the Yates sand throughout that 440-acre unit.

MR. HOWELL: We will mark this cross section as El Paso' Natural Gas Company's Exhibit No. 4.

(Marked El Paso Natural Gas Company's Exhibit No. 4, for identification.)

Q What accesses did you take for your cross section to cover the tract that is within this application.

A The two cross sections are labeled AA Prime, PB Prime.

Q What wells does AA Prime cover?

A AA Prime starts in the northwest quarter of the section, that is the R. Olsen Oil Company Gregory No. 3 and goes on through the Gregory No. 4, southeast to the El Paso Gregory Federal No. 1; and

then the R. Olsen Oil Company Gregory A No. 6. The second section, BB Prime, which is approximately east incorporates the R. Olsen, personal, Gregory No. 2 and that Gregory Federal No. 1; the El Paso Natural Gas Gregory Federal No. 1 and the R. Olsen Gregory A No. 6.

Q Is it No. 6 or No. 5?

A No. 5, I beg your pardon.

Q What was the basis of the cross section, as to logs? Did you obtain logs of each of these wells?

A Yes. These are gamma ray Neutron logs which I have correlated to the best of my knowledge, in picking each top in the Jalmat and Langlie-Mattix pays.

Q Have you shown the correlation by drawing lines which are roughly, horizontal, across the various logs?

A Yes, sir.

Q And connected the various pays?

A Yes, sir.

Q What formations are shown to be penetrated by each of these wells?

A Well, the Tansil, Yates, Seven Rivers and Queen.

Q Is the Yates Formation the one from which the El Paso Natural Gas Company Gregory Federal No. 1 is producing?

A That is correct.

Q Do you find the Yates Formation present, and correlated in the other wells located throughout the 440-acre tract?

A Yes.

Q In your opinion, is the entire 440 acres reasonably productive of gas from the Yates Formation?

A Yes, sir, I believe it is.

Q What is the initial potential of the El Paso Natural Gas Company Gregory Federal No. 1?

A It had an absolute openflow of 19,000,000.

Q When was it completed?

A April the 26th, 1955.

Q It hasn't been given an allowable up to the present time, or do you know?

A No, sir, it has not.

Q In your opinion, can this well make an allowable that would be incident to a proration unit of 440 acres?

A I believe it will.

Q In your opinion, will this well adequately drain the 440 acres covered by this application?

A Yes, sir.

Q In your opinion, would the granting of this application and our proration unit of 440 acres for this well conserve the oil and gas resources and protect correlative rights?

A Yes.

MR. HOWELL: We would like to offer in evidence the four exhibits, El Paso Natural Gas Company's Exhibits 1 through 4, inclusive.

MR. MACEY: Without objection they will be received. Anything further?

MR. HOWELL: That is all from this witness.

MR. MACEY: Anyone have a question of the witness?

CROSS EXAMINATION

By MR. NUTTER:

Q I believe that the subject well in this case is the Gregory

Federal No. 1, El Paso Natural's Gregory Federal No. 1 completed in the Yates?

A Yes.

Q That will be in the Jalmat Pool?

A Yes, sir.

Q What about this R. Olsen No. 4 which is in the southwest quarter of the northwest quarter, what pool is that completed in?

A That well is classified in the Langlie-Mattix.

Q There is an interval there that is in the Middle Seven Rivers that is open, however?

A Yes, sir, to the best of my knowledge that is correct.

Q Which is also in the Jalmat?

A Yes.

Q Now, the R. Olsen, Personal, Gregory No. 2, I guess it is, which is in the northwest quarter of the southwest quarter is also open in the Middle Seven Rivers, is it not?

A Well, yes. The well hasn't been classified and the pay has not been established as yet. However, I do, from the information I have, I believe a part of the perforations are in the Jalmat.

MR. NUTTER: I believe those are the only two that I thought might be in the Jalmat Pool.

By MR. MONTGOMERY:

Q Our records indicate something a little different. The R. Olsen's wells in the east half, southeast quarter, five and six, our records show that possibly they have Seven Rivers and Queen open.

A Yes, probably your records are not up to date, because since those two wells were completed they have been reworked and liners have been set in them and they have cased off everything in the

Jalmat pay.

MR. MONTGOMERY: Thank you.

MR. MACEY: Mr. Montgomery, have you classified these wells, the ones that are in question between the two pays?

MR. MONTGOMERY: Yes, sir, if they have both sections open why I always put it in the oil pool.

MR. MACEY: Anyone else have a question of the witness? If nothing further the witness may be excused.

(Witness excused.)

MR. HOWELL: That is all we have.

MR. MACEY: Anyone have anything further in this case? If nothing further we will take the case under advisement.

STATE OF NEW MEXICO)
COUNTY OF BERNALILLO) SS.

I, ADA DEARNLEY, Court Reporter, do hereby certify that the foregoing and attached transcript of proceedings before the New Mexico Oil Conservation Commission at Santa Fe, New Mexico, is a true and correct record to the best of my knowledge, skill and ability.

IN WITNESS WHEREOF I have affixed my hand and notarial seal this 25th day of August, 1955.

Notary Public, Court Reporter

My Commission Expires:
June 19, 1959

BEFORE THE
Oil Conservation Commission

SANTA FE, NEW MEXICO
July 14, 1955

IN THE MATTER OF:

CASE NO. 931 and 932

TRANSCRIPT OF PROCEEDINGS

ADA DEARNLEY AND ASSOCIATES

COURT REPORTERS
605 SIMMS BUILDING
TELEPHONE 3-6691
ALBUQUERQUE, NEW MEXICO

BEFORE THE
OIL CONSERVATION COMMISSION
Santa Fe, New Mexico
July 14, 1955

IN THE MATTER OF:

Application of El Paso Natural Gas Company
for approval of a 440-acre non-standard gas
proration unit in the Jalmat Gas Pool, Lea
County, New Mexico, to consist of S/2, S/2
NW/4, NW/4 NW/4 of Section 33, Township 25
South, Range 37 East, and to be dedicated
to applicant's Gregory Federal No. 1 Well
located in the NW/4 SE/4 of said Section 33.

No. 931

IN THE MATTER OF:

Application of El Paso Natural Gas Company
of approval of a 320-acre non-standard gas
proration unit in the Jalmat Gas Pool, Lea
County, New Mexico, to consist of W/2
Section 29, Township 26 South, Range 37 East
and to be dedicated to applicant's M. L.
Parker No. 2 Well, NW/4 NW/4 of said Section
29.

No. 932

BEFORE:

Honorable John F. Simms
Mr. E. S. (Johnny) Walker
Mr. William B. Macey

TRANSCRIPT OF HEARING

MR. MACEY: The next cases on the docket are Cases 931 and
932. Mr. Howell.

MR. HOWELL: If it please the Commission, the El Paso
Natural Gas Company, the proponent, would like to ask for a contin-
uance of these cases to the August hearing.

In Case 931 there has been a well completed by another operator
within this 440-acre area and we could not have the completion data

which we think we should have before us in order to present it to the Commission; and in the other case, we have some question of notice we would like to resolve. We move for continuance in both cases.

MR. MACEY: Is there objection to continuance of Cases 931 and 932? If not, they will be heard at the August 17 hearing.

* * * * *

STATE OF NEW MEXICO)
 : ss
COUNTY OF BERNALILLO)

I, ADA DEARNLEY, Court Reporter, do hereby certify that the foregoing and attached transcript of proceedings before the New Mexico Oil Conservation Commission at Santa Fe, New Mexico, is a true and correct record to the best of my knowledge, skill and ability.

IN WITNESS WHEREOF I have affixed my hand and notarial seal this 19th day of July, 1955.

Ada Dearnley
Notary Public, Court Reporter

My commission expires:

June 19, 1959.

OIL CONSERVATION COMMISSION

P. O. BOX 871

SANTA FE, NEW MEXICO

September 20, 1955

Mr. R. L. Hamblin
El Paso Natural Gas Company
P.O. Box 1492
El Paso, Texas

Dear Sir:

We enclose a copy of Order R-683 and Order R-687 issued September 15, 1955, by the Oil Conservation Commission in Cases 932 and 931 respectively, which were heard at the July 14th and August 17th hearings.

Very truly yours,

W. B. Macey
Secretary - Director

WBM:brp
Encls. 2

C
O
P
Y

Memo

From Dean Miller

To Jack Gurler

Re case 931

OK to approve. Only question regarding this particular NSP is the fact that a couple of the wells on the included acreage are open to the Galmat as well as the Langlie Mattix oil pools. Montgomery assures me however that there's no question as to whether or not we should grant the NSP because when a well is open to both an oil pool and a gas pool, he classifies it ~~as an~~ ^{in the} oil pool with no dedication to the gas pool.

There would only be one well completed in the Jalmat gas pool then under Montgomery's system of classification. That one well is applicant's Gregory-Federal No. 1, located NW/4 SE/4 Sec 33, T 25S, R 37E.

Unless the application is granted, applicant will be deprived an opportunity to produce his just and equitable share of the gas in the Jalmat Gas Pool.

Approval of said application is in the interest of prevention of waste and the protection of correlative rights.

BEFORE THE
OIL CONSERVATION COMMISSION
SANTA FE, NEW MEXICO
EPNG EXHIBIT No. 2
CASE 931

E. P. N. G. CO.
EL PASO, TEXAS
TELETYPE ROOM

WUS4 DL PD DUPLICATE OF TELEGRAM TELEPHONED

OKLAHOMA CITY OKLA JULY 9 350PMC 1955

1955 JUL 11 AM 8:12

MR WOODRUFF

EL PASO TEX

I HEREBY CONSENT TO YOUR APPLICATION TO FORM NON STANDARD
GAS PRORATION UNIT IN JALMAT POOL LEA COUNTY NEW MEXICO
AS APPLIED FOR IN CASE 931 SET FOR HEARING JULY 14, 1955
FOR YOUR GREGORY FEDERAL 1 WELL LETTER FOLLOWS

R OLSEN.

806A.

N
WESTERN
UNION
WESTERN
UNION

004

OWNERSHIP AND LOCATION PLAT
ILLUSTRATING THE PROPORTION UNIT
REQUESTED
FOR THE
E.L. PASO NATURAL GAS CO.,
GREGORY FEDERAL #1

R-37-E

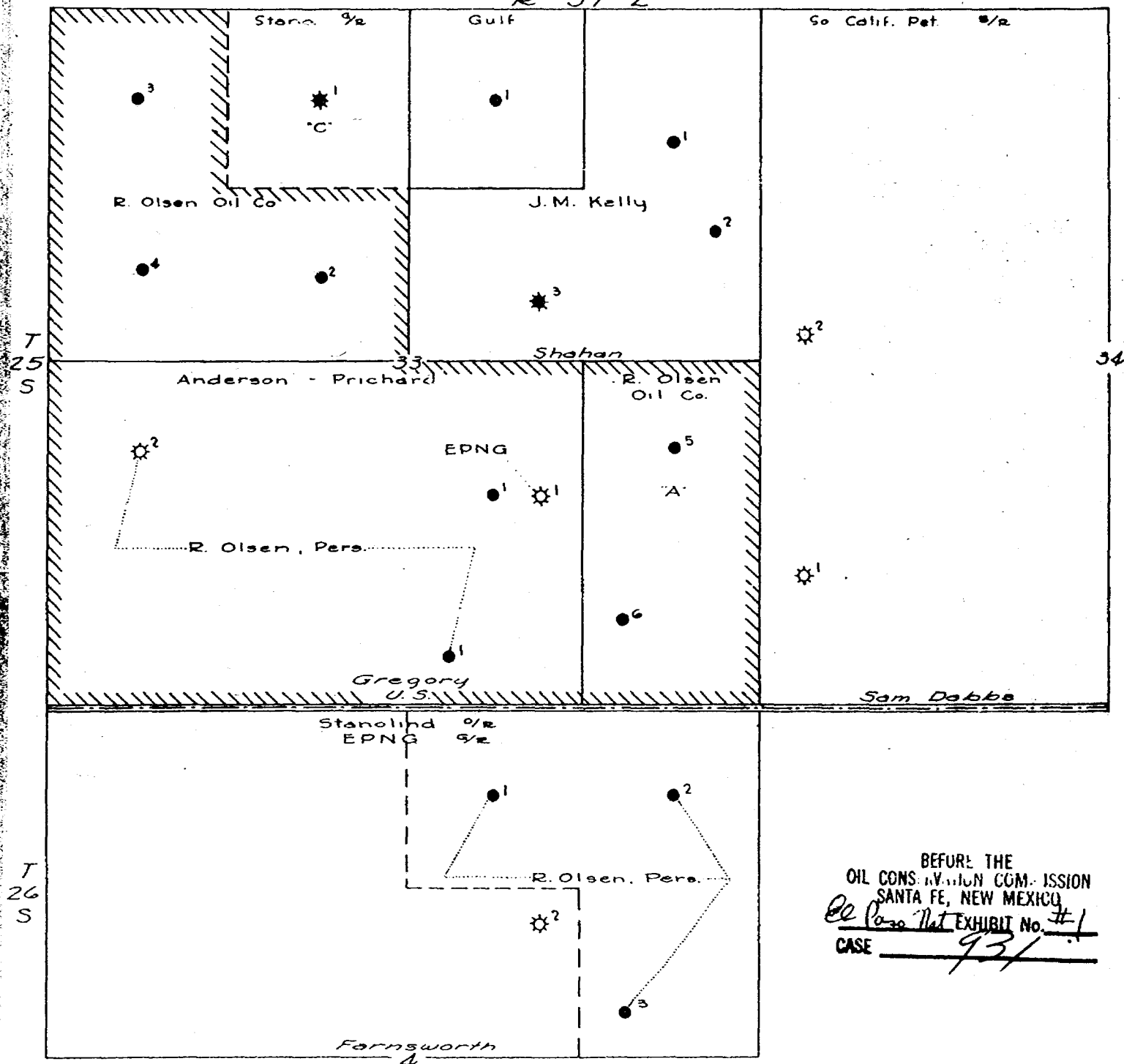

SCALE: 1" = 1000 FT.

BEFORE THE
OIL CONSERVATION COMMISSION
SANTA FE, NEW MEXICO
EXHIBIT No. #1
CASE 931

931

OWNERSHIP AND LOCATION PLAT
ILLUSTRATING THE PRORATION UNIT
REQUESTED
FOR THE
EL PASO NATURAL GAS CO.,
GREGORY FEDERAL #1

R-37-E

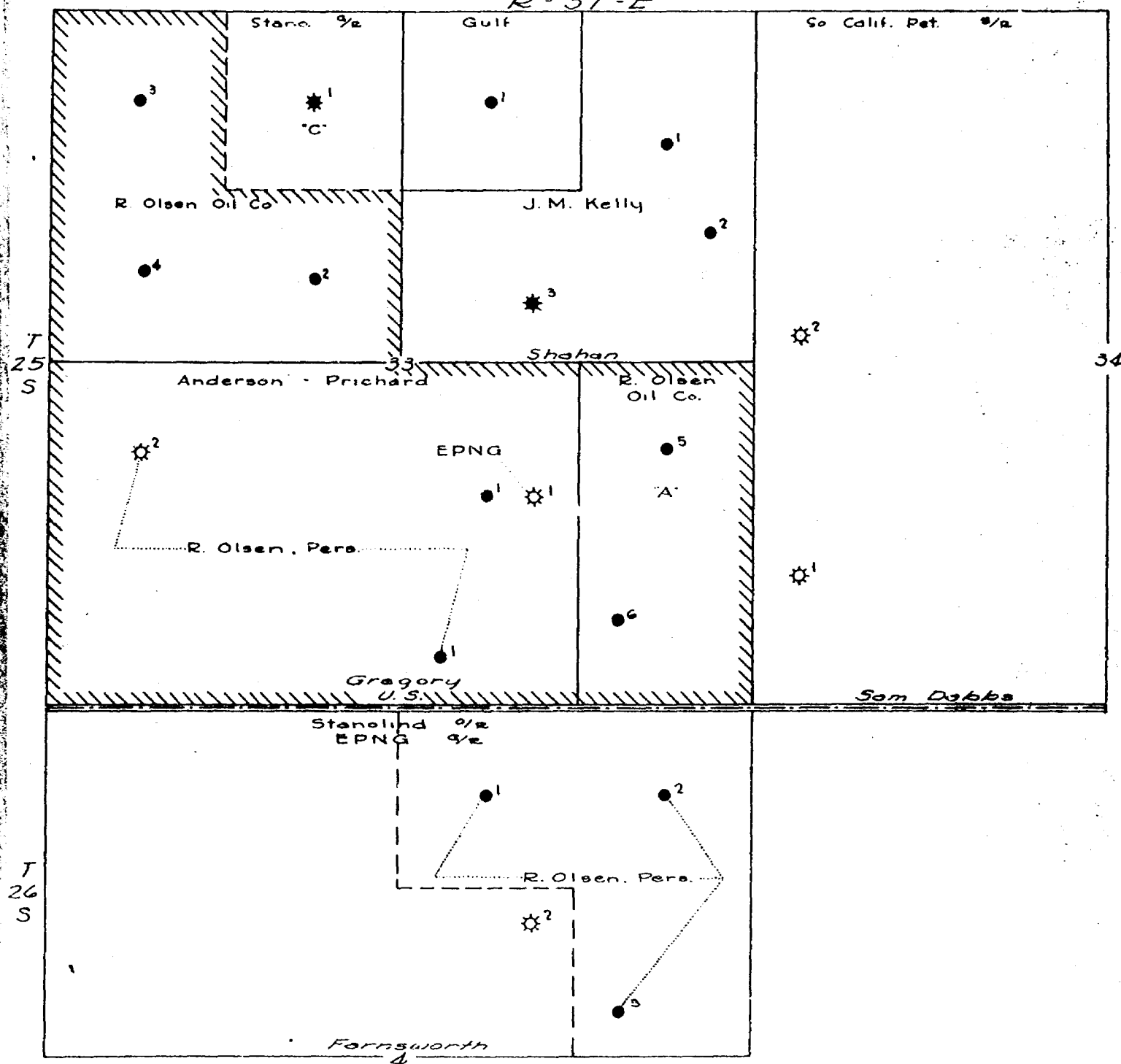

SCALE: 1" = 1000 FT.

OWNERSHIP AND LOCATION PLAT
 ILLUSTRATING THE PROPORTION UNIT
 REQUESTED
 FOR THE
 EL PASO NATURAL GAS CO.,
 GREGORY FEDERAL #1

R-37-E

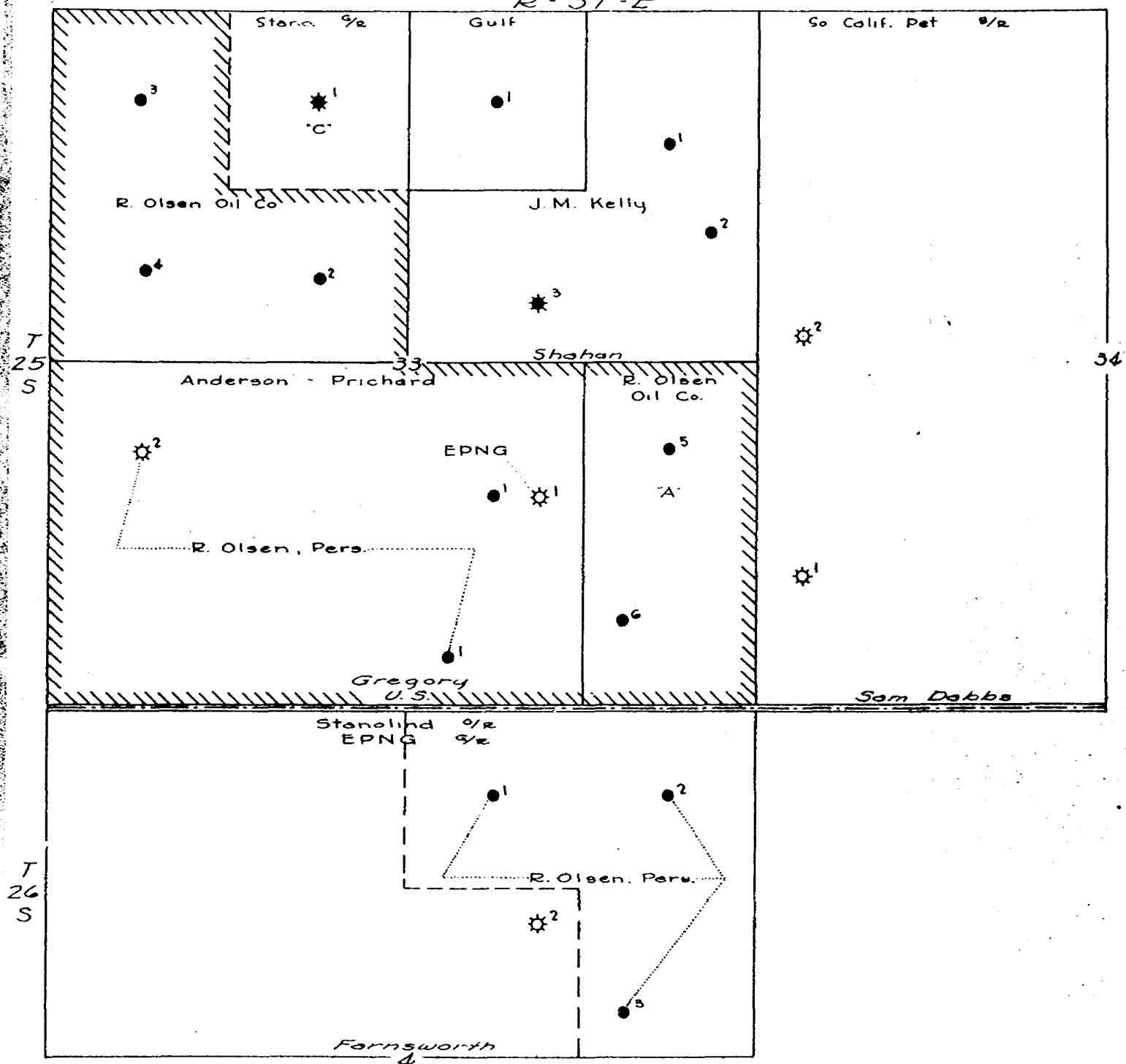

SCALE: 1" = 1000 FT.

BEFORE THE OIL CONSERVATION COMMISSION OF THE STATE OF NEW MEXICO

In the Matter of the Application of El Paso Natural Gas Company for an Exception to Rule 5 (a) and 5 (b) of the Special Rules for the Jalmat Gas Pool, Lea County, New Mexico, for its Gregory Federal #1 Well, NW/4 SE/4 Section 33, Township 25 South, Range 37 East, N.M.P.M., Lea County, New Mexico

CASE NO. 721

To The Honorable Commission:

Come now El Paso Natural Gas Company and requests the Commission to grant an exception to Rule 5(a) and 5(b) of the Special Rules for the Jalmat Gas Pool for its Gregory Federal #1 Well, and for its grounds therefor states:

1. Applicant seeks an unorthodox gas proration unit consisting of the S/2, S/2 NW/4, and NW/4 NW/4 of Section 33, Township 25 South, Range 37 East, N.M.P.M., containing 440.00 acres, more or less, and the allocation of an appropriate gas allowable to said unit.
2. The well to which applicant seeks to have the allowable granted to is its Gregory Federal #1 Well and is situated 1650 feet from the South and East lines of said Section 33. That said well was completed on May 19, 1955, to a total depth of 3075 feet with an IPF of 19000 MCFPD.
3. The proposed unorthodox gas proration unit consists of contiguous quarter-quarter sections.
4. The proposed unorthodox gas proration unit lies wholly within a single governmental section.
5. The entire proposed unorthodox gas proration unit may reasonably be presumed to be productive of gas.
6. The length or width of the unorthodox gas proration unit does not exceed 5280 feet.
7. There is attached hereto a plat showing the acreage to be dedicated to the unorthodox gas proration unit, the location of the well, and the offset ownership.
8. The granting of the exception requested herein will not adversely affect the correlative rights of any offset owner and will protect the correlative rights of applicant, will prevent waste, will avoid the drilling of unnecessary wells, and is in the interest of conservation.

Wherefore, applicant requests the commission to set this matter down for hearing, to publish notice as required by law and to issue its order granting applicant an exception to the rules of the commission noted herein for its Gregory Federal #1 Well, and allocating to the said well a 440 acre gas proration unit consisting of the S/2, S/2 NW/4, and NW/4 NW/4 of Section 33, Township 25 South, Range 37 East, N.M.P.M.

EL PASO NATURAL GAS COMPANY

By

R. L. Hamblin
R. L. HAMBLIN

THE STATE OF TEXAS

COUNTY OF EL PASO

On the 25th day of June, 1955, before me personally appeared R. L. Hamblin, to me known to be the person who executed the foregoing application and states that the foregoing statements are true to the best of his knowledge and belief.

IN WITNESS WHEREOF, I have hereunto set my hand and seal on the day and year first above written.

My Commission Expires:

June 1, 1957

Joseph B. Borden
Notary Public in and for the
County of El Paso, State of Texas

Case 9.31

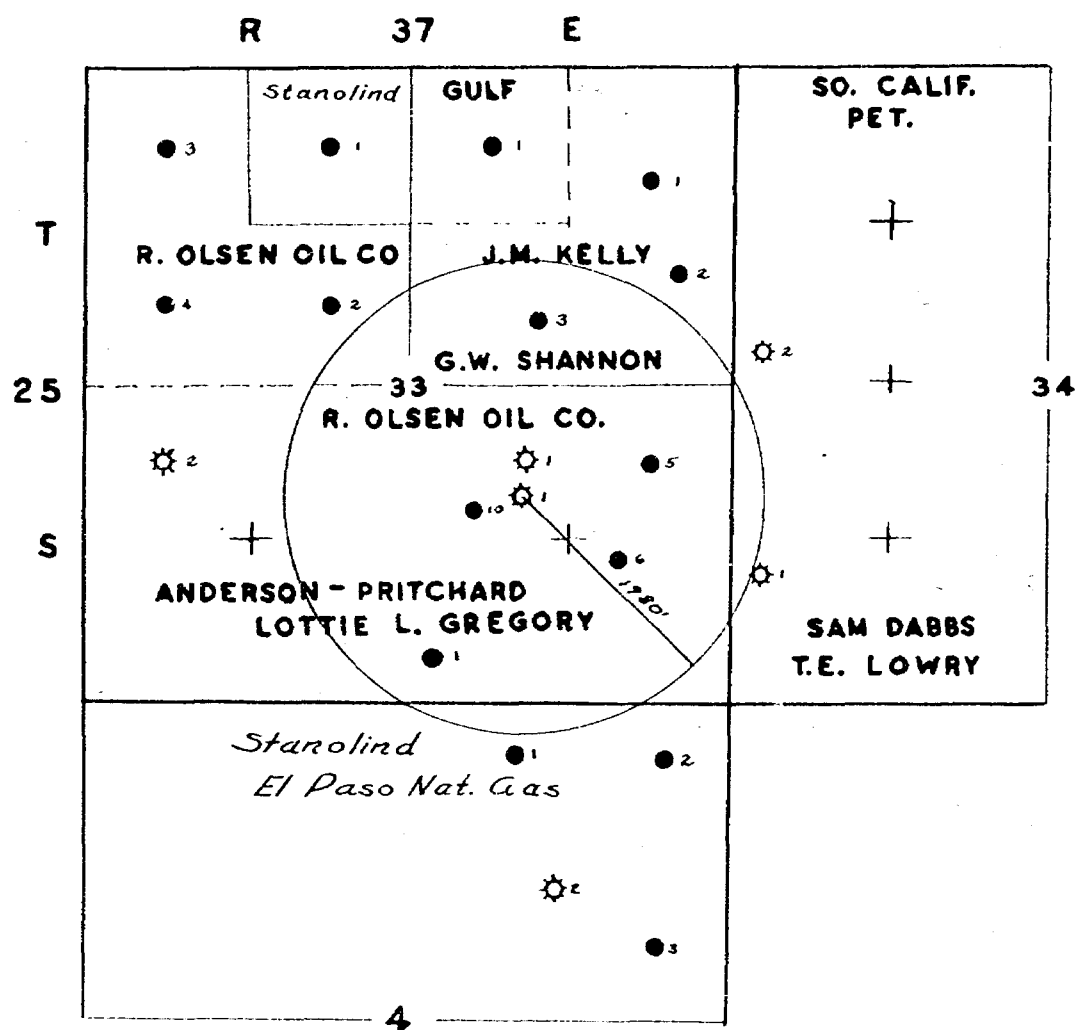

OWNERSHIP AND LOCATION PLAT
ILLUSTRATING THE PROPORTION UNIT
REQUESTED

FOR THE
EL PASO NATURAL GAS CO.,
GREGORY FEDERAL #1

R-37-E

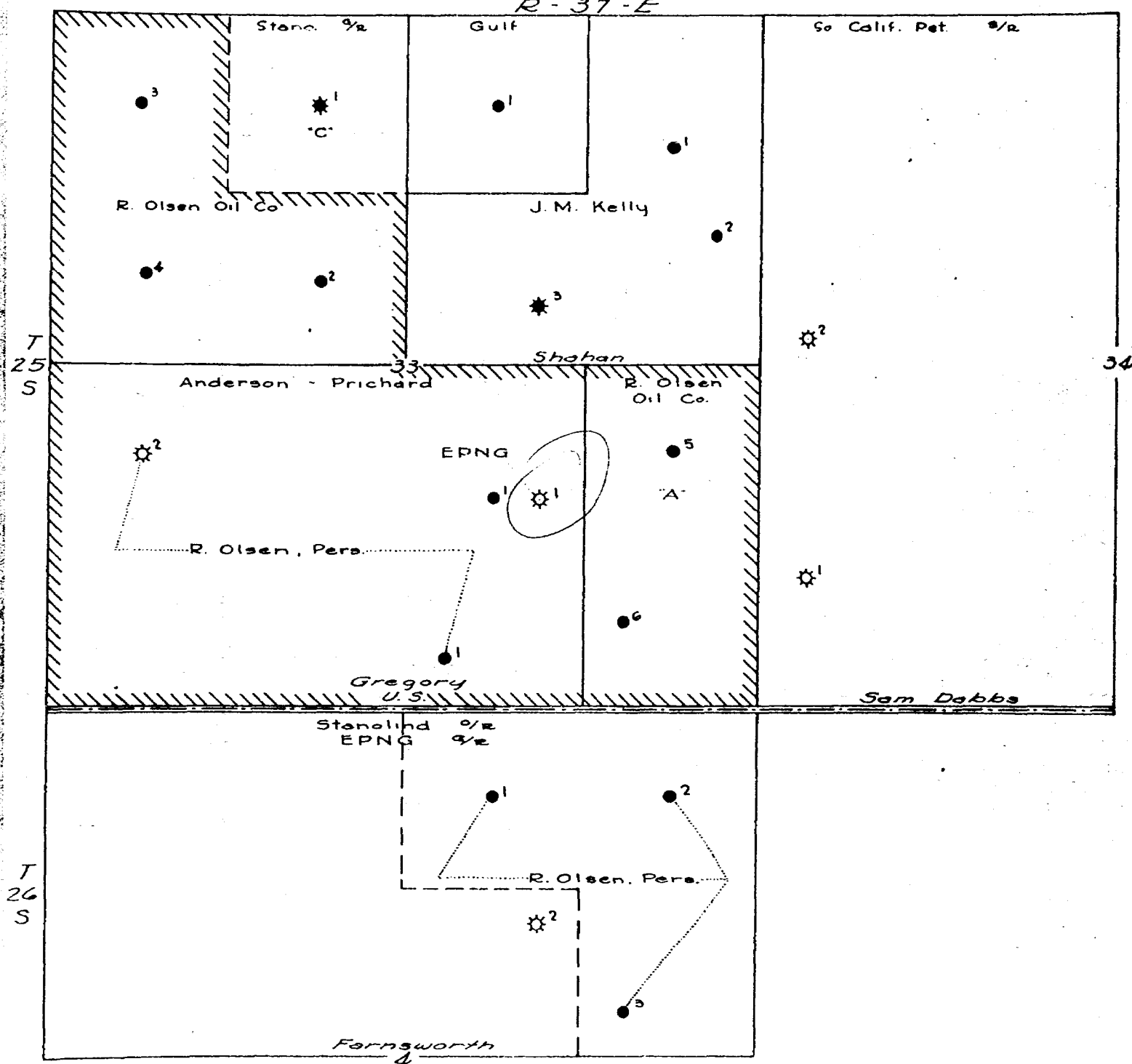

SCALE: 1" = 1000 FT.