

CONFIDENTIAL - SECURITY INFORMATION

Case No.

1282

Application, Transcript,
Small Exhibits, Etc.

BEFORE THE
OIL CONSERVATION COMMISSION
Santa Fe, New Mexico
July 17, 1957

TRANSCRIPT OF HEARING

Case 1282

DEARNLEY - MEIER & ASSOCIATES
INCORPORATED
GENERAL LAW REPORTERS
ALBUQUERQUE - SANTA FE
3-6691 2-2211

BEFORE THE
OIL CONSERVATION COMMISSION
Santa Fe, New Mexico
July 17, 1957

IN THE MATTER OF:

Southeastern New Mexico Nomenclature case calling for an order creating new pools and extending and deleting certain areas from existing pools in Eddy and Lea Counties, New Mexico.

(a) Create a new oil pool for Grayburg production, designated as the Teague-Grayburg Pool, and described as:

TOWNSHIP 23 SOUTH, RANGE 37 EAST
Section 20: SE/4

Case
1282

(b) Create a new oil pool for Pennsylvanian production, designated as the Kemnitz-Pennsylvanian Pool, and described as:

TOWNSHIP 16 SOUTH, RANGE 33 EAST
Section 13: SE/4

(c) Extend the Dollarhide-Drinkard Pool to include:

TOWNSHIP 24 SOUTH, RANGE 38 EAST
Section 19: NW/4
Section 20: W/2 SW/4

(d) Extend the Drinkard Pool to include:

TOWNSHIP 22 SOUTH, RANGE 37 EAST
Section 27: E/2 NE/4

(e) Extend the Gladiola Pool to include:

TOWNSHIP 12 SOUTH, RANGE 37 EAST
Section 25: N/2 NE/4

TOWNSHIP 12 SOUTH, RANGE 38 EAST

Section 17: NW/4

Section 18: N/2 NE/4

- (f) Extend the North Gladiola-Devonian Pool to include:

TOWNSHIP 11 SOUTH, RANGE 38 EAST

Section 32: SE/4

TOWNSHIP 12 SOUTH, RANGE 38 EAST

Section 6: SW/4

Section 7: NW/4

Section 8: NW/4

- (g) Extend the West Henshaw-Grayburg Pool to include:

TOWNSHIP 16 SOUTH, RANGE 30 EAST

Section 4: SE/4

Section 5: SE/4

Section 8: NE/4

- (h) Extend the Langlie-Mattix Pool to include:

TOWNSHIP 23 SOUTH, RANGE 36 EAST

Section 4: E/2 SE/4

- (i) Extend the Pearl-Queen Pool to include:

TOWNSHIP 19 SOUTH, RANGE 35 EAST

Section 22: S/2 SE/4

- (j) Extend the Townsend-Wolfcamp Pool to include:

TOWNSHIP 16 SOUTH, RANGE 36 EAST

Section 6: W/2 SW/4

- (k) Extend the Terry-Blinebry Pool to include:

TOWNSHIP 21 SOUTH, RANGE 37 EAST

Section 3: Lot 16

Section 4: Lot 1

- (1) Delete the following area from the Blinebry Gas Pool:

TOWNSHIP 21 SOUTH, RANGE 37 EAST

Section 3: Lot 16

Section 4: Lot 1

BEFORE:

Mr. A. I. Benton
Mr. Murray Morgan
Honorable Edwin L. Mechem

TRANSCRIPT OF HEARING

MR. PORTER: The next case to be considered will be Case 1232.

MR. COOLEY: Southeastern New Mexico Nomenclature case calling for an order creating new pools and extending and deleting certain areas from existing pools in Eddy and Lea Counties, New Mexico.

R. F. MONTGOMERY

called as a witness, having been first duly sworn, testified as follows:

DIRECT EXAMINATION

By MR. COOLEY:

Q State your name and position?

A R. F. Montgomery, Proration Manager, Oil Conservation Commission.

Q Mr. Montgomery, in your official capacity as Proration Manager for the Oil Conservation Commission, have you had an opportunity to make a study of the order creating new pools and extending and deleting certain areas from existing pools in Eddy and Lea Counties, New Mexico?

A I have.

Q Mr. Montgomery, do you have any recommendation concerning

(a) The creation of a new oil pool for Grayburg production?

A We do, but due to the legalities, it is my recommendation that we dismiss this case and readvertise it for the following regular hearing.

MR. COOLEY: Let the record show that there was an error in advertisement in the New Mexican.

MR. PORTER: In other words, you are recommending that Paragraph A be continued? A Dismissed.

MR. PORTER: Oh, dismissed.

Q Do you have any recommendations concerning the creation of a new oil pool for Pennsylvanian production in Township 16 South, Range 33 East?

A I do. I recommend that pool be created as advertised. The discovery well was the Sinclair Oil and Gas Company Seaman Unit No. 1 located in Unit P of Section 13-16-33, completed in the Pennsylvanian on 10/1/56, top of the perforation is 11,230 feet.

Q Is it your recommendation that the Kemnitz-Pennsylvanian Pool be the Pennsylvanian formation?

A I do.

Q Have you any recommendations concerning the extension of the Dollarhide (Drinkard) in Township 24 South, Range 38 East?

A It is my recommendation that the pool be extended as advertised.

Q What are your recommendations concerning the extension

of the Drinkard Pool?

A My recommendation is that the Drinkard Pool be extended as advertised plus an unadvertised portion being the North half of the Northeast Quarter of Section 23, Township 22 South, Range 37 East.

Q Do you have any recommendation concerning the extension of the Gladiola Pool?

A My recommendation is that the pool be extended as advertised.

Q What are your recommendations concerning the North Gladiola-Devonian?

A My recommendation is that that pool be extended as advertised.

Q What are your recommendations concerning the extension of the West Henshaw-Grayburg Pool?

A My recommendation is that due to another error in legal advertisement, that this portion of Case 1282 be dismissed.

MR. COOLEY: Let the record show that the error in advertisement occurred in the Artesia Daily Press.

Q What are your recommendations concerning the extension of the Langlie-Mattix?

A My recommendation is that the Langlie-Mattix be extended as advertised.

Q What are your recommendations concerning the Pearl-Queen Pool?

A My recommendation is that that pool be extended as advertised.

Q Do you have any recommendations concerning the extension of the Townsend-Wolfcamp Pool?

A I recommend that pool be extended as advertised.

Q In the advertisement and on the docket we have Paragraphs K and L of Case 1282 concerning the extension of the Terry-Blinebry and deletion of the same acreage from the Blinebry Gas Pool.

What are your recommendations concerning these two paragraphs?

A My recommendation is that this portion of the case be dismissed and readvertised at the next monthly hearing in order that we can also delete a portion from the Blinebry Oil Pool, which we failed to advertise. The order on these particular fields requires that the horizontal limits not overlap, and we failed to put that portion in it.

Q Do you have any further recommendations?

A That's all I have.

Q Do you have any exhibits in this case?

A I do. I have Exhibits 2, 3, 4, 5, 6, 7 and 8.

Q Wait a minute, you have Exhibit 7?

A I had previously marked these Exhibits 1 through 15, but due to the errors in legal advertisement -- shall I remark them?

Q You had better mark them right, Exhibit 1 is for creation of the Kennitz.

A I have that as Exhibit 2.

Q All right, Exhibit 2.

A Exhibit 3 is the Dollarhide-Drinkard, 4 is the Drinkard 5 and 6 are the Gladiola, Seven is North Gladiola, Eight is North Gladiola-Devonian, and Exhibit 10, Langlie-Mattix, Exhibit 11, Pearl-Queen, Exhibit 12, Townsend-Wolfcamp. That's all.

Q Were these exhibits prepared by you or under your supervision?

A They were.

MR. COOLEY: I move the Commission to accept Exhibits 2 through 8, 10 through 12.

MR. PORTER: Without objection, Exhibits through 2, 3, 4, 5, 6, 7, 8, 10, 11 and 12 will be admitted.

Does anyone have a question of Mr. Montgomery? The witness may be excused.

(Witness excused)

MR. PORTER: If there is nothing further in this case, we will take it under advisement and take up next Case 1283.

C E R T I F I C A T E

STATE OF NEW MEXICO)
: SS
COUNTY OF BERNALILLO)

I, *Ada Dearnley*, Court Reporter, do hereby certify that the foregoing and attached transcript of proceedings before the New Mexico Oil Conservation Commission at Santa Fe, New Mexico, is a true and correct record to the best of my knowledge, skill and ability.

IN WITNESS WHEREOF I have affixed my hand and notarial seal this *8th* day of August, 1957.

Ada Dearnley
Notary Public-Court Reporter

My commission expires:

June 12, 1957

OIL CONSERVATION COMMISSION

HOBBS, NEW MEXICO

S.F.
Hobbs
Carteria

In the matter of the application of the Oil Conservation Commission of New Mexico upon its own motion for an order for the extension and creation of certain pools in Lea and Eddy Counties, New Mexico, and giving notice to all persons and parties interested in the subject matter thereof to appear and show cause why such extensions and creations should not be made:

- (a) Create a new pool in Lea County, New Mexico, classified as an oil pool for Grayburg production, designated as the Teague Grayburg Pool, and described as:

Twp. 23 South, Range 37 East

SE/4 of Section 20

- (b) Create a new pool in Lea County for Penn. production, designated as the Kemnitz Pennsylvania Pool, and described as:

T 16 S, R 33 E

SE/4 Sec 13

- (c) Extend the Dollarhide-Drinkard Pool boundary in Lea County, New Mexico to include therein:

Twp. 24 South, Range 38 East

NW/4 of Section 19

N/2 SW/4 of Section 20

and such other etc.

- (d) Extend the Drinkard Pool boundary in Lea County, New Mexico to include therein:

Twp. 22 South, Range 37 East

E/2 NE/4 of Section 27

and such other etc.

- (e) Extend the Gladiola Pool boundary in Lea County, New Mexico to include therein:

Twp. 12 South, Range 37 East

N/2 NE/4 of Section 25

Twp. 12 South, Range 38 East

NW/4 of Section 17

N/2 NE/4 of Section 18

and such other etc.

- (f) Extend the North Gladiola-Devonian Pool boundary in Lea County, New Mexico to include therein:

Twp. 12 South, Range 38 East

SW/4 of Section 6

NW/4 of Section 7

NW/4 of Section 8

Con't on next page

C

O

P

Y

Reverse the
order of these
two extensions

11-28-57
SW/4 of Section 6 R 38 E
NW/4 of Section 7
NW/4 of Section 8
SW 1/4 6?

OIL CONSERVATION COMMISSION

HOBBS, NEW MEXICO

North Galdiola Dev. Con't

Twp. 11 South, Range 38 East
SE/4 of Section 32

and such other etc.

(g) Extend the Grayburg Kealy Pool boundary in Eddy County, New Mexico to include therein:

Twp. 17 South, Range 29 East
NE/4 of Section 23

and such other etc.

(g) Extend the West Hanshaw Grayburg Pool boundary in Eddy County, New Mexico to include therein:

Twp. 16 South, Range 30 East
SE/4 of Section 4
SE/4 of Section 5
NE/4 of Section 8

and such other etc.

(L) Extend the Langlie-Mattix Pool boundary in Lea County, New Mexico to include therein:

Twp. 23 South, Range 36 East
E/2 SE/4 of Section 4

and such other etc.

(M) Extend the Pearl-Queen Pool boundary in Lea County, New Mexico to include therein:

Twp. 19 South, Range 35 East
S/2 SE/4 of Section 22

and such other etc.

(N) Extend the Roberts Pool boundary in Lea County, New Mexico to include therein:

Twp. 17 South, Range 33 East
SE/4 of Section 8

and such other etc.

(J) Extend the Townsend-Wolfcamp Pool boundary in Lea County, New Mexico to include therein:

Twp. 16 South, Range 36 East
W/2 SW/4 of Section 6

and such other etc.

C
O
P
Y

(k) Extend the Terry-Blinebry Pool boundary in Lea County, New Mexico,
to include therein:

Township 21 South, Range 37 East
Section 3: Lot 16
Section 4: Lot 1

(l) Delete the following area from the Blinebry Gas Pool in Lea
County, New Mexico:

Township 21 South, Range 37 East
Section 3: Lot 16
Section 4: Lot 1

Providing further - - -

**BEFORE THE OIL CONSERVATION COMMISSION
OF THE STATE OF NEW MEXICO**

**IN THE MATTER OF THE HEARING
CALLED BY THE OIL CONSERVATION
COMMISSION OF THE STATE OF NEW
MEXICO FOR THE PURPOSE OF
CONSIDERING:**

CASE NO. 1282
Order No. R-1023

**THE APPLICATION OF THE OIL
CONSERVATION COMMISSION UPON
ITS OWN MOTION FOR AN ORDER
CREATING, EXTENDING, AND
CONTRACTING CERTAIN POOLS IN
EDDY AND LEA COUNTIES, NEW
MEXICO.**

ORDER OF THE COMMISSION

BY THE COMMISSION:

This cause came on for hearing at 9 o'clock a.m. on July 17, 1957, at Santa Fe, New Mexico, before the Oil Conservation Commission of New Mexico, hereinafter referred to as the "Commission."

NOW, on this 30th day of July, 1957, the Commission, a quorum being present, having considered the testimony presented and the exhibits received at said hearing, and being fully advised in the premises,

FINDS:

(1) That due public notice having been given as required by law, the Commission has jurisdiction of this cause and the subject matter thereof.

(2) That the proposed creation of a new pool in Lea County, New Mexico, for the production of oil from the Grayburg formation, said pool to bear the designation Teague Grayburg Pool, should be dismissed for readvertisement.

(3) That there is need for the creation of a new pool in Lea County, New Mexico, for the production of oil from the Pennsylvanian formation, said pool to bear the designation Kennitz-Pennsylvanian Pool. Said Kennitz-Pennsylvanian Pool was discovered by Sinclair Oil and Gas Company, Seaman Unit No. 1, located in the SE/4 SE/4 Section 13, Township 16 South, Range 33 East, NEPM. It was completed October 1, 1956. The top of the perforations is at 11,230 feet.

(4) That there is need for certain extensions to the Dollarhide-Drinkard Pool, the Drinkard Pool, the Gladiola Pool, the North Gladiola-Devonian Pool, the Langlie-Mattix Pool, the Pearl-Queen Pool, and the Townsend-Wolfcamp Pool, all in Lea County, New Mexico. Further, that the proposed extension of the West Henshaw-Grayburg Pool in Eddy County, New Mexico, and the proposed extension of the Terry-Blinebry Oil Pool in Lea County, New Mexico, and the deletion of certain areas from the Blinebry Gas Pool in Lea County, New Mexico, should be dismissed for readvertisement.

IT IS THEREFORE ORDERED:

(a) That the proposed creation of a new pool in Lea County, New Mexico, to be known as the Teague-Grayburg Pool and classified as an oil pool for Grayburg production, and consisting of the following described area:

TOWNSHIP 23 SOUTH, RANGE 37 EAST, NMPM
Section 20: NE/4

be and the same is hereby dismissed.

(b) That a new pool in Lea County, New Mexico, classified as an oil pool for Pennsylvanian production, be and the same is hereby created and designated as the Kennitz-Pennsylvanian Pool consisting of the following described area:

TOWNSHIP 16 SOUTH, RANGE 33 EAST, NMPM
Section 13: SE/4

(c) That the Dellarhide-Drinkard Pool in Lea County, New Mexico, as heretofore classified, defined, and described, be and the same is hereby extended to include therein:

TOWNSHIP 24 SOUTH, RANGE 36 EAST, NMPM
Section 19: NW/4
Section 20: W/2 SW/4

(d) That the Drinkard Pool in Lea County, New Mexico, as heretofore classified, defined, and described, be and the same is hereby extended to include therein:

TOWNSHIP 22 SOUTH, RANGE 37 EAST, NMPM
Section 27: E/2 NE/4
Section 28: N/2 NE/4

(e) That the Gladiola Pool in Lea County, New Mexico, as heretofore classified, defined, and described, be and the same is hereby extended to include therein:

TOWNSHIP 12 SOUTH, RANGE 37 EAST, NMPM
Section 25: N/2 NE/4

TOWNSHIP 12 SOUTH, RANGE 38 EAST, NMPM
Section 17: NW/4
Section 18: N/2 NE/4

(f) That the North Gladiola-Devonian Pool in Lea County, New Mexico, as heretofore classified, defined, and described, be and the same is hereby extended to include therein:

TOWNSHIP 11 SOUTH, RANGE 38 EAST, NMPM
Section 32: SE/4

TOWNSHIP 12 SOUTH, RANGE 36 EAST, NMPM
Section 6: SW/4
Section 7: NW/4
Section 8: NW/4

-3-

Case No. 1282
Order No. R-1023

(g) That the proposed extension of the West Henshaw Grayburg Pool in Eddy County, New Mexico, to include therein

TOWNSHIP 16 SOUTH, RANGE 30 EAST, NMPM

Section 4: SE/4
Section 5: SE/4
Section 8: NE/4

be and the same is hereby dismissed.

(h) That the Langlie-Mattix Pool in Lea County, New Mexico, as heretofore classified, defined, and described, be and the same is hereby extended to include therein:

TOWNSHIP 23 SOUTH, RANGE 36 EAST, NMPM

Section 4: E/2 SE/4

(i) That the Pearl-Queen Pool in Lea County, New Mexico, as heretofore classified, defined, and described, be and the same is hereby extended to include therein:

TOWNSHIP 19 SOUTH, RANGE 35 EAST, NMPM

Section 22: S/2 NE/4

(j) That the Townsend-Wolfcamp Pool in Lea County, New Mexico, as heretofore classified, defined, and described, be and the same is hereby extended to include therein:

TOWNSHIP 16 SOUTH, RANGE 36 EAST, NMPM

Section 8: W/2 SW/4

(k) That the proposed extension to the Terry-Blinebry Oil Pool in Lea County, New Mexico, to include therein

TOWNSHIP 21 SOUTH, RANGE 37 EAST, NMPM

Section 3: Lot 16
Section 4: Lot 1

be and the same is hereby dismissed.

(l) That the proposed deletion of the following area from the Blinebry Gas Pool in Lea County, New Mexico

TOWNSHIP 21 SOUTH, RANGE 37 EAST, NMPM

Section 3: Lot 16
Section 4: Lot 1

be and the same is hereby dismissed.

DONE at Santa Fe, New Mexico, on the day and year hereinabove designated.

STATE OF NEW MEXICO
OIL CONSERVATION COMMISSION

E. L. Nechem
EDWIN L. NECHEM, Chairman

M. E. Morgan
MURRAY E. MORGAN, Member

A. L. Porter, Jr.
A. L. PORTER, Jr., Member & Secretary



Return To O.C.C.
S.F.

Case 1282: (I) Extension of an existing pool

County LEA Pool PEARL-QUEEN

TOWNSHIP 19 South, RANGE 35 East, NEW MEXICO PRINCIPAL MERIDIAN

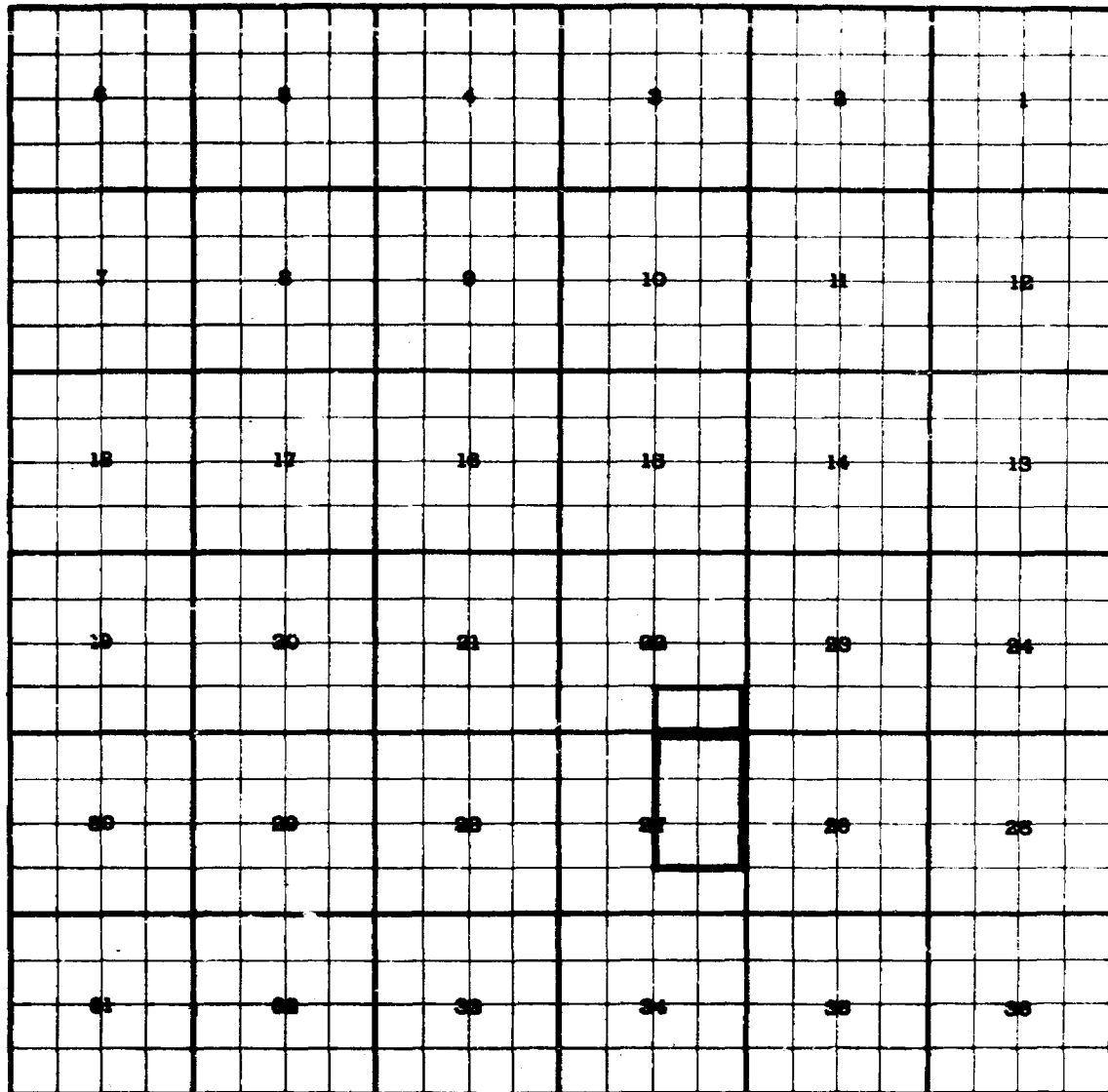

Purpose: To extend the pool for the inclusion of

Shell Oil Company Kimberlin #1 In Unit O of Sec. 22-19-35

comp 5/1/57 in *Quesada* top part 4659

Pool Boundary: Colored in Red

Proposed Extension colored in Green S/2 SE/4

Case 1282: Extension of an Existing Pool

County LEA Pool LANGLIE-MATTIX

TOWNSHIP 23 South, RANGE 36 East, NEW MEXICO PRINCIPAL MERIDIAN

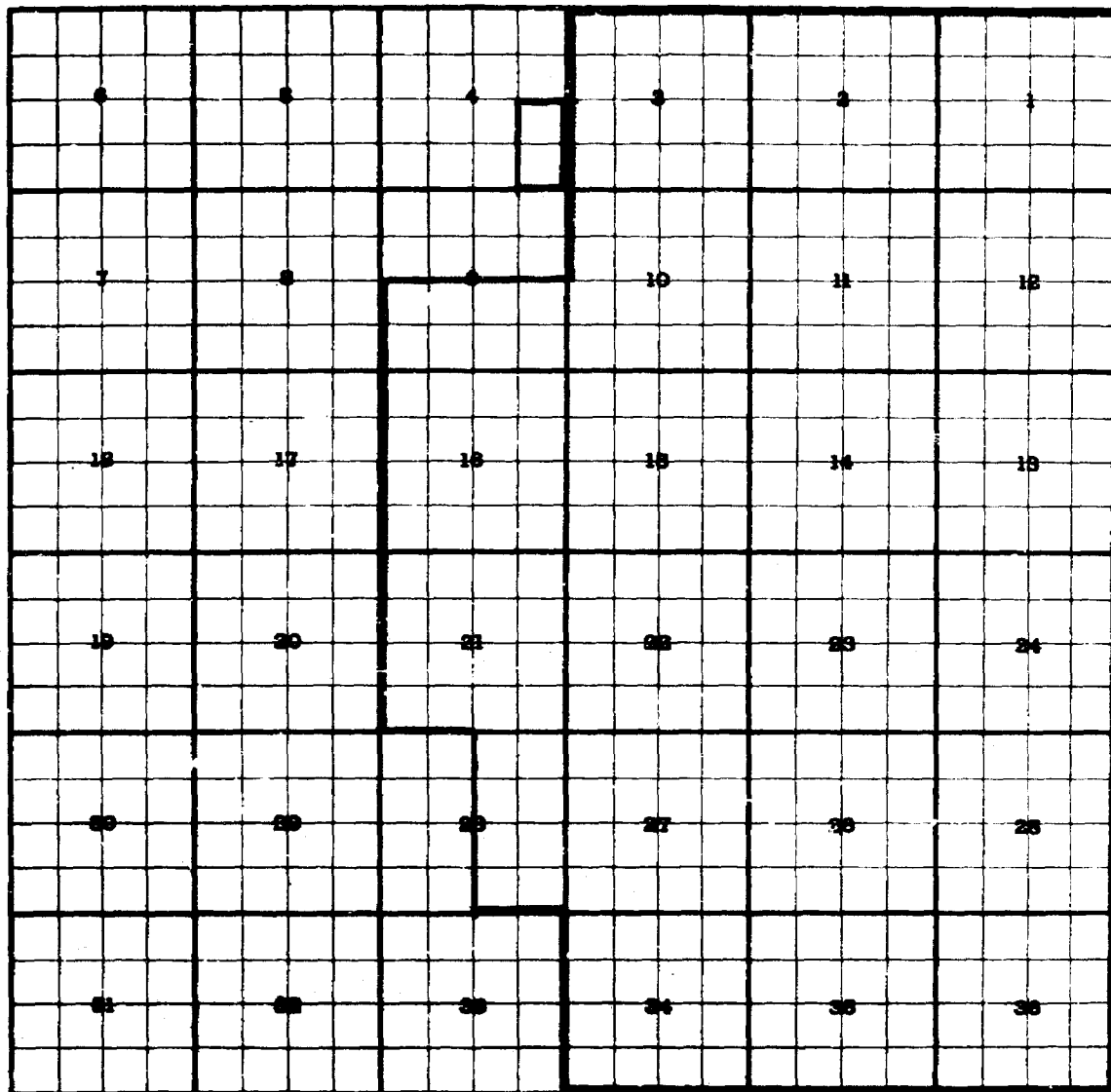

Purpose: To extend the pool for the inclusion of

Gulf Oil Corp. J. F. Janda "J" #2 in Unit P of Sec. 4-23-36

comp. 5/1/57 in Queen top parf. 3694

Pool Boundary: Colored in Red

Proposed extension colored in Green E/2 SE/4

Case 1282: (J) Extension of an existing pool

County LEA Pool Townsend-Wolfcamp

Continuous to Township 16 Range 35

10-11

TOWNSHIP 16 South, RANGE 35 East, NEW MEXICO PRINCIPAL MERIDIAN

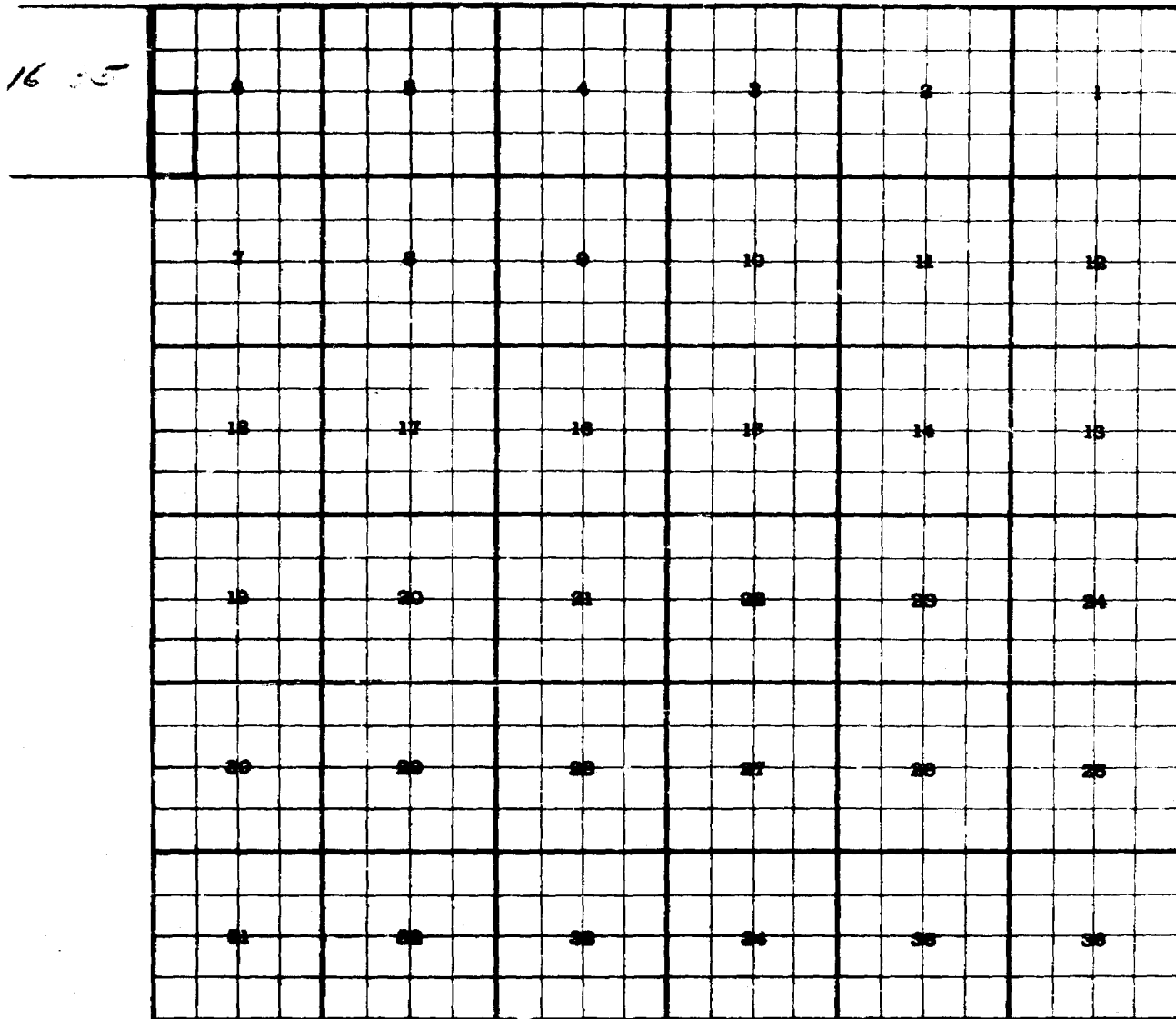

Purpose: To extend the pool to include

Austral Oil Exploration Company Inc. W. M. Snyder "A" #1 In Unit I
of Section 6-16-36 comp 5/17/57 in Wolfcamp top perf. 10,652

Pool Boundary: Colored in Red

Proposed extension colored in Green W/2 SW/4 of Section 6

Case 1282: (F) Extension of an existing pool

7

County LEA Pool NORTH GLADIOLA-DEVONIAN

TOWNSHIP 11 South, RANGE 38 East, NEW MEXICO PRINCIPAL MERIDIAN

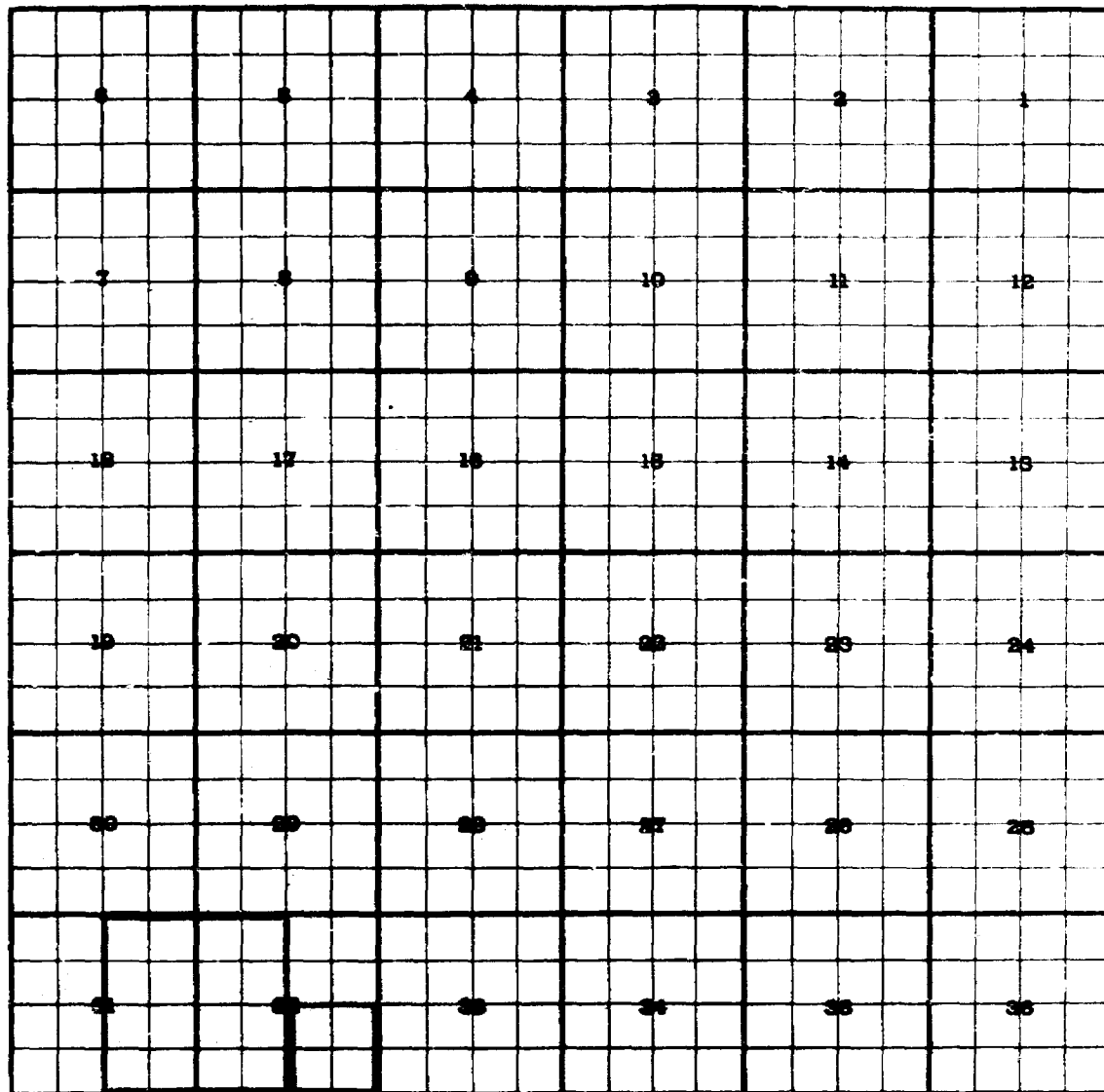

Continuous to Township 12, Range 38

Pool Boundary: Colored in Red.

Proposed Extension colored in Green SE/4 of Section 32

Case 1282: (E) Extension of an existing pool

County ISA Pool GLADIOLA

12-13

TOWNSHIP 12 South, RANGE 38 East, NEW MEXICO PRINCIPAL MERIDIAN

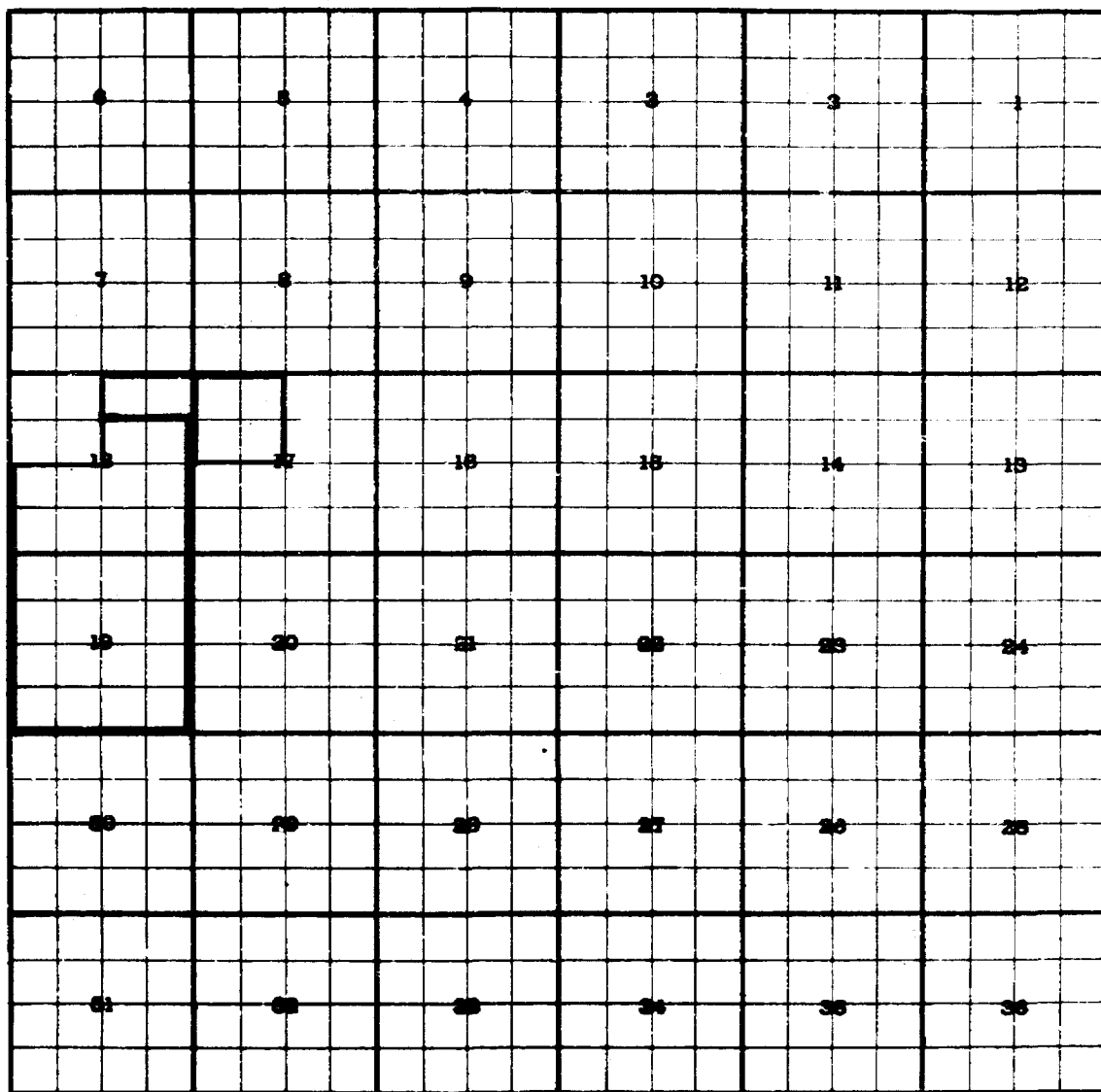

Purpose: To extend the pool for the inclusion of
Sinclair Oil & Gas Co. Henry A. Harris #2 in Unit A of Sec. 18-12-38
comp. 6/1/57 in Devonian top perf. 11,964

Pool Boundary: Colored in Red

Proposed Extension Colored in Green NW/4 of Section 17

N/2 NE/4 of Section 18

Also to include: Hancock Oil Co. S. P. Johnson et al #1 in Unit E of
Sec. 17-12-38 comp 6/27/57 in Devonian
top perf. 11,989

Case 1282: (E) Extension of an existing pool

County LEA Pool GLADIOLA

12-13

TOWNSHIP 12 South, RANGE 37 East, NEW MEXICO PRINCIPAL MERIDIAN

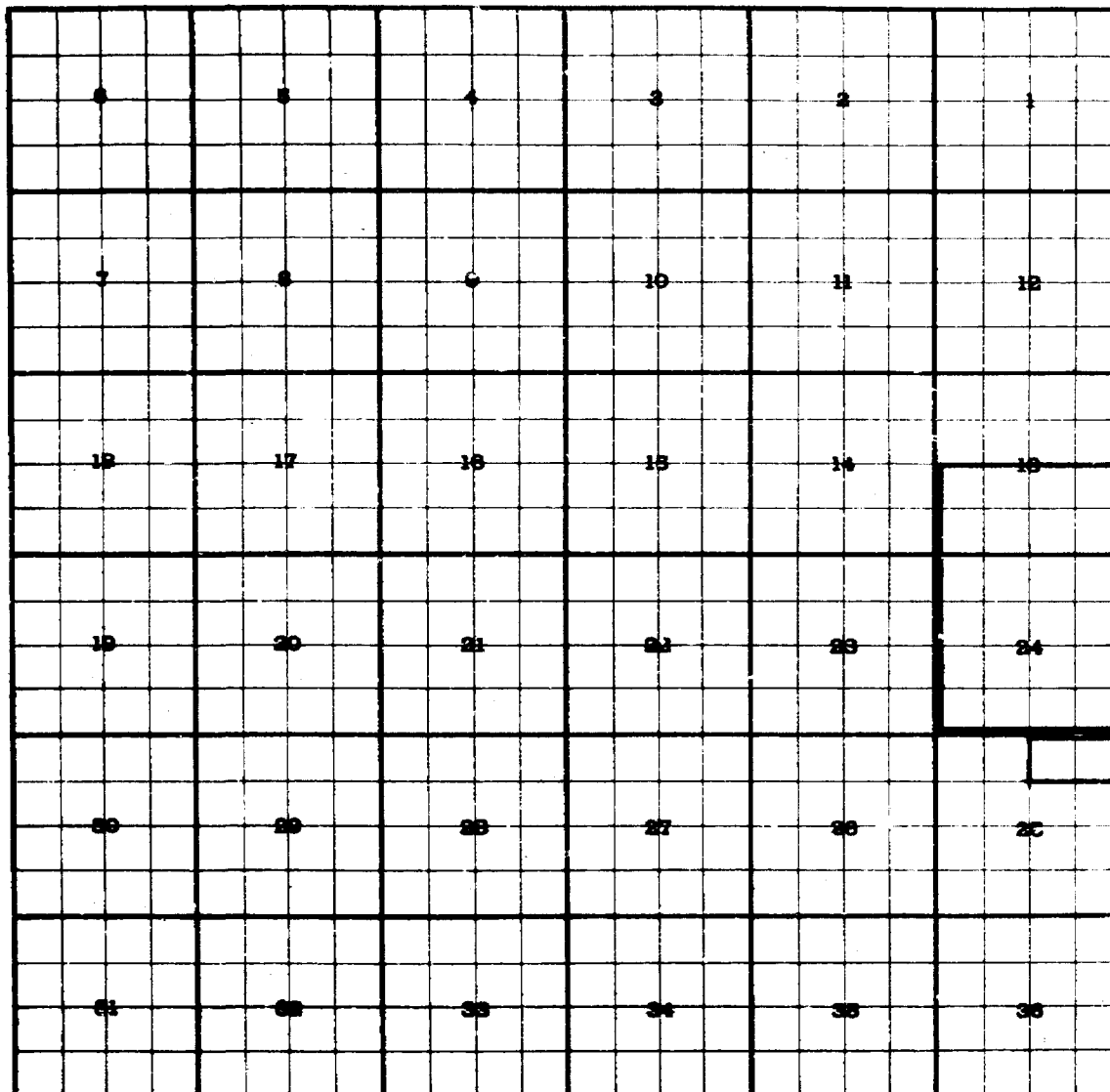

Purpose: To extend the pool for the inclusion of

Jake L. Hamon H. R. Fields #1 in Unit A of Section 25-12-37

comp. 6/22/57 in Devonian top perf. 11,940

Pool Boundary: Colored in Red

Proposed Boundary Colored in Green N/2 NE/4 Section 25

Case 1282: (F) Extension of an Existing Pool

County LEA Pool NORTH GLADIOLA-DEVONIAN

12-13

TOWNSHIP 12 South, RANGE 38 East, NEW MEXICO PRINCIPAL MERIDIAN

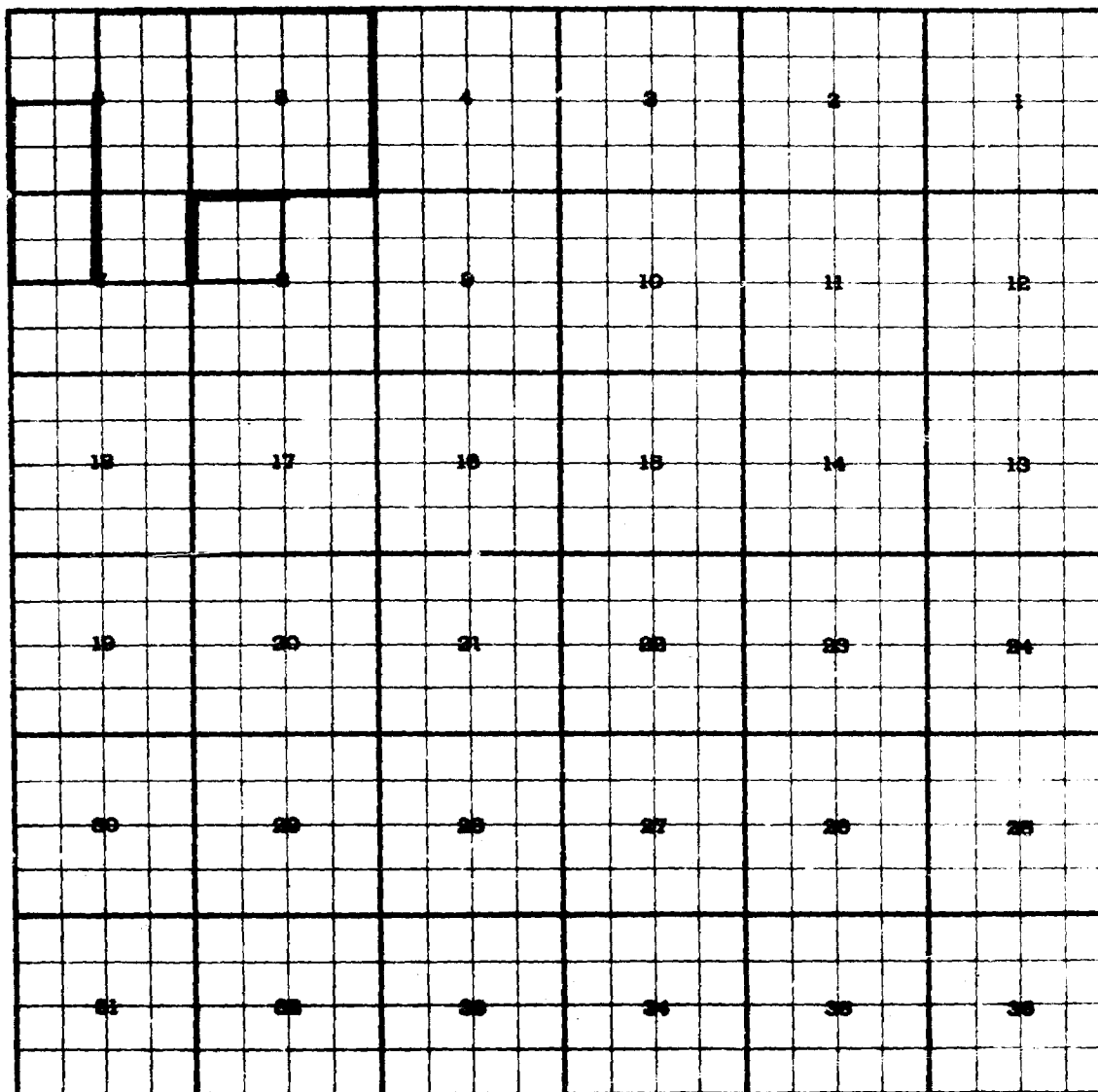

Purpose: To extend the pool for the inclusion of

Warren Pet. Corp. C. E. Oberhaltzer #1 in Unit C of Sec. 7-12-38

comp. 6/5/57 in Devonian top perf. 12,023

Ralph Lowe Continental-Wallace #1 in Unit M Sec. 6-12-38 comp 5/25/57

in Devonian top perf. 12,023

Warren Pet. Corp. M. M. Harris #1 in Unit C of Sec. 8-12-38 comp 6/30/57

in Devonian top perf. 12,009

P. ol Boundary: Colored in Red

Proposed Extension Colored in Green NW/4 of Section 7

Case 1282: (B) Creation of a new pool

2

County LEA Pool KEMNITZ-PENNSYLVANIAN
11-12 Pennsylvanian

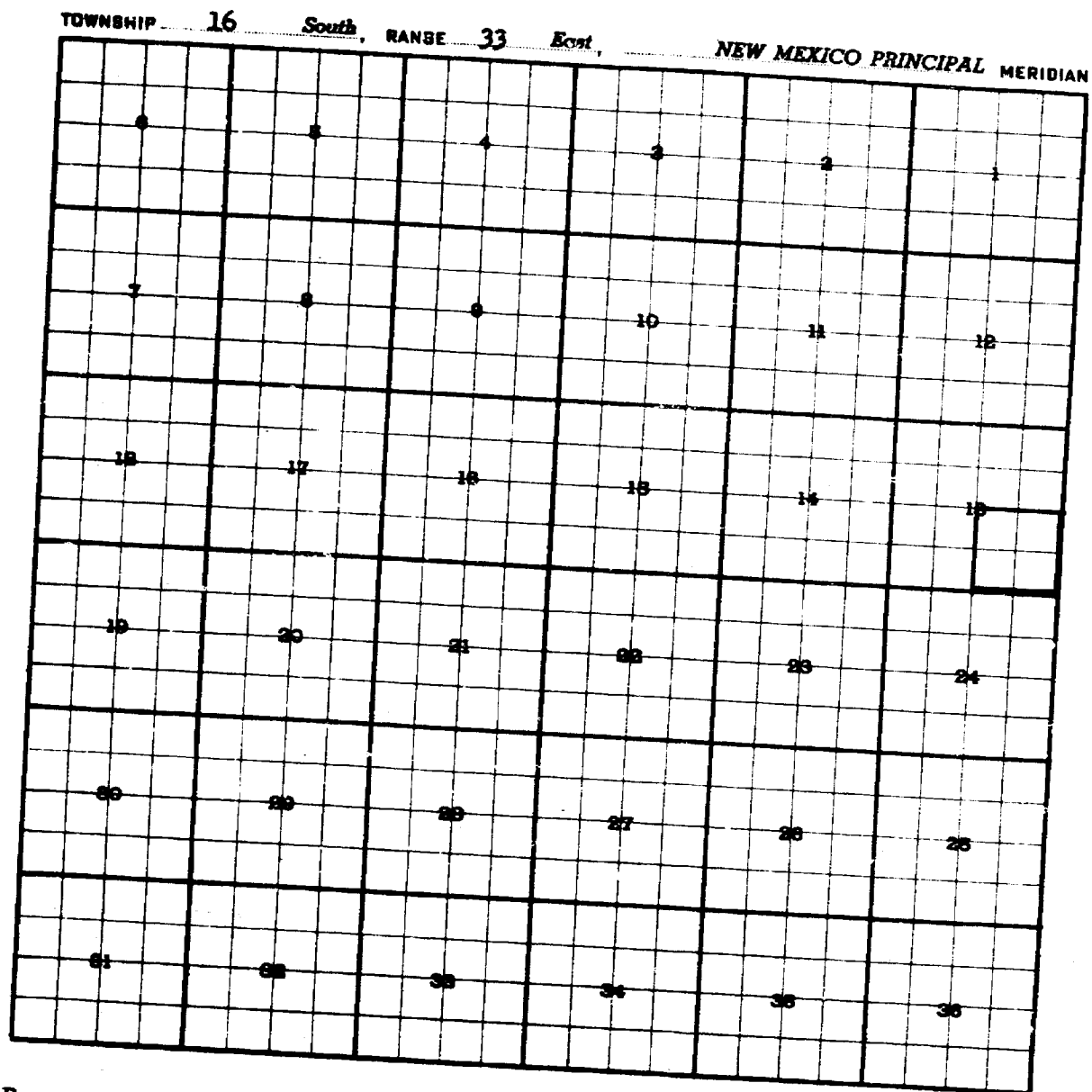

Purpose: To create a new pool for the inclusion of-
Sinclair Oil & Gas Co. Seaman Unit #1 in Unit P of Sec. 13-16-33
comp. in Pennsylvanian 10/1/56
top perf. 11,230

Proposed Boundary: Colored in Red SE/4 of Section 13

Case 1282: (C) Extension of an existing pool

County LEA Pool DOLLARHIDE (DRINKARD)

6-7

TOWNSHIP 24 South, RANGE 38 East, NEW MEXICO PRINCIPAL MERIDIAN

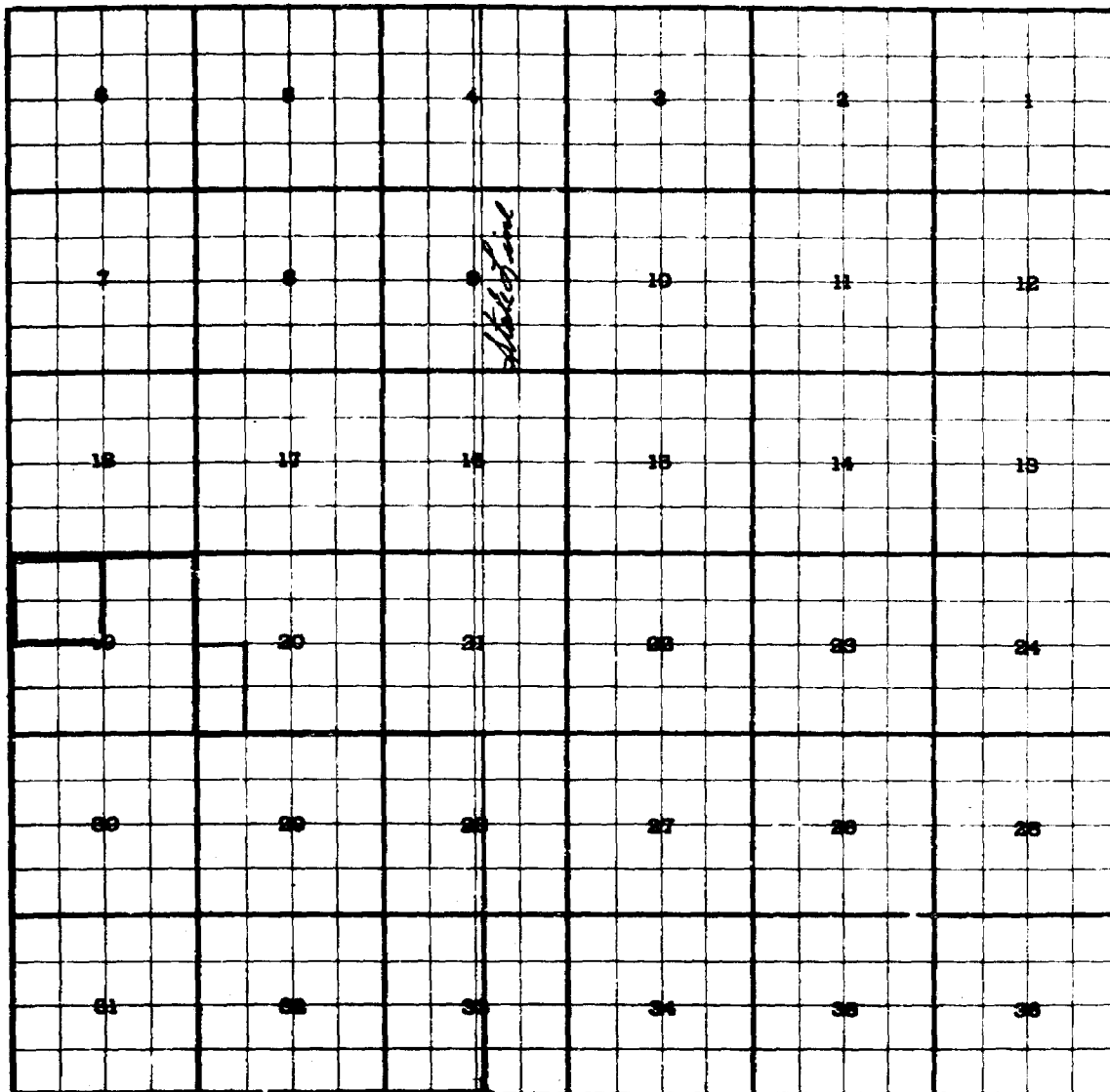

Purpose: To extend the pool for the inclusion of
The Texas Company United Royalty et al "A" #3 in Unit F of
Section 19-24-38 comp 5/4/57 in Drinkard top
perf. 6619

Pool Boundary: Colored in Red

Proposed Extension Colored in Green NW/4 Section 19
W/2 SW/4 Section 20

Case 1282: (C) Extension of an existing pool

Part of this case unadvertised

County

LEA

Pool

DRINKARD

4

6-7

TOWNSHIP 22 South, RANGE 37 East, NEW MEXICO PRINCIPAL MERIDIAN

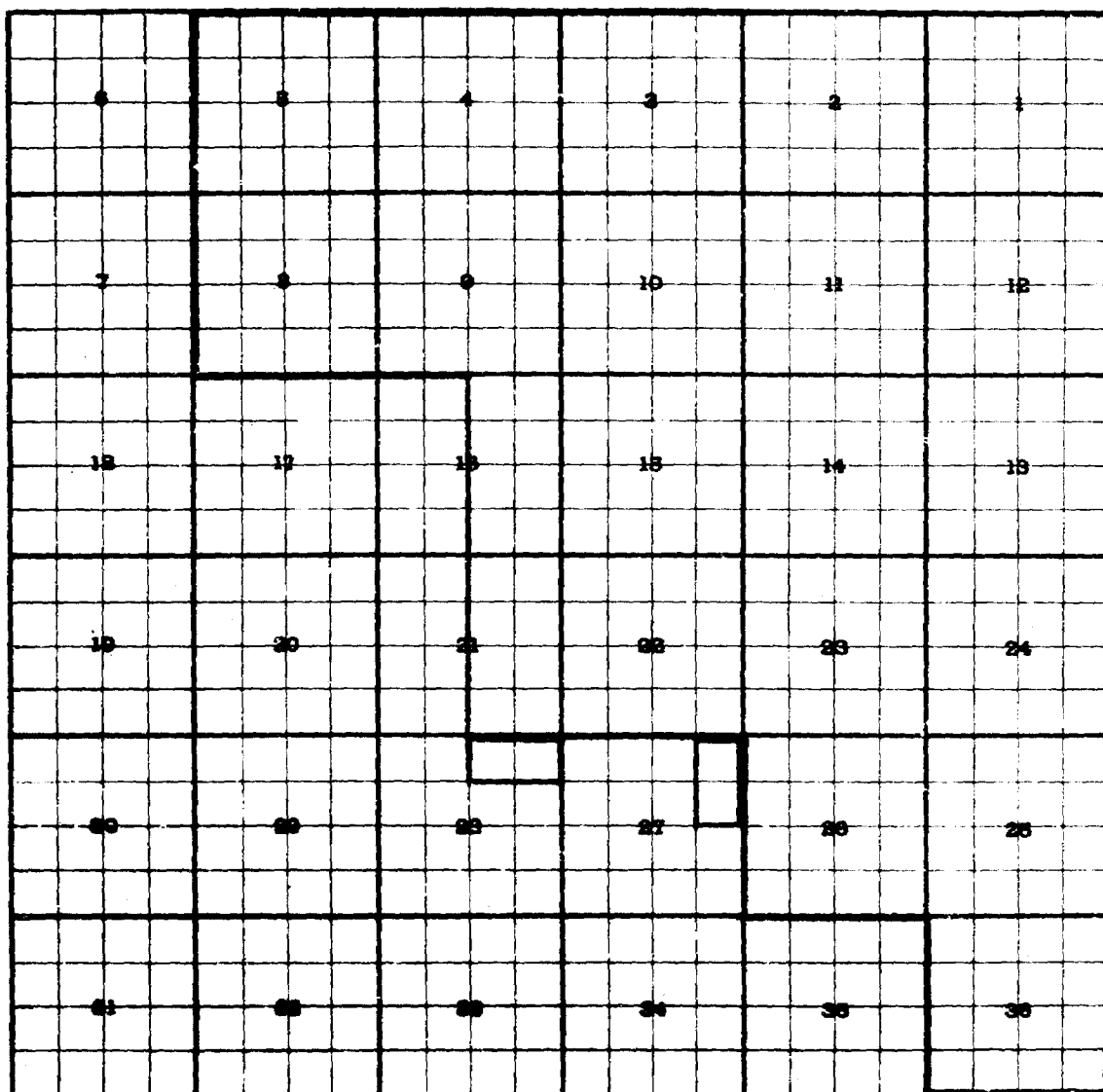

Purpose: To extend the pool for the inclusion of

Skelly Oil Company J. V. Baker #10 in Unit A of Section 27-22-37

comp. 5/24/57 in Drinkard top perf. 6385

Pool Boundary: Colored in Red

Proposed Extension Colored in Green E/2 NE/4 of Section 27 Adv. Unadv. N/2 NE/4

Also- Sinclair Oil and Gas Annie Christmas #3 in Unit B of Sec. 28-22-37 comp. Sec. 28

UNADVERTISED

7/1/57 in Abo Top Perf. 6443

N/2

DOCKET: REGULAR HEARING JULY 17, 1957

Oil Conservation Commission 9 a.m., Mabry Hall, State Capitol, Santa Fe, NM

ALLOWABLE: (1) Consideration of the oil allowable for August, 1957.

(2) Consideration of the allowable production of gas for August, 1957, from the seven prorated pools in Lea County, New Mexico; also consideration of the allowable production of gas from the six prorated pools in San Juan and Rio Arriba Counties, New Mexico, for August, 1957.

CASE 1275: Application of Shell Oil Company for an exception to Rule 309 of the Commission Rules and Regulations to permit the transportation of oil from the basic lease prior to measurement, and to produce more than eight wells into a central plant, and to commingle production from the participating area of the Carson Unit with production from other wells in the area. Applicant, in the above-styled cause, seeks an order authorizing off-lease measurement of oil produced from the Bisti-Lower Gallup Oil Pool and an undesignated Lower Gallup Oil Pool in Township 25 North, Range 11 West, and Township 25 North, Range 12 West, San Juan County, New Mexico, by means of an automatic custody transfer system; and to authorize the production of more than eight wells into a central testing and measuring plant and further, to authorize the commingling of non-participating area production with participating area production in the Carson Unit, with royalty payments to be calculated by means of periodic production rate tests.

CASE 1276: Application of Amerada Petroleum Corporation for an order amending Order No. R-991 insofar as said order pertains to the Bagley-Lower Pennsylvanian Gas Pool, Lea County, New Mexico. Applicant, in the above-styled cause, seeks an order amending Order No. R-991 to extend the horizontal limits of the Bagley-Lower Pennsylvanian Gas Pool to include the S/2 Section 34, Township 11 South, Range 33 East, and the NE/4 Section 3, Township 12 South, Range 33 East, Lea County, New Mexico, and to increase the size of the standard drilling unit for said pool from 160 acres to 320 acres and to enter such other rules and regulations for said pool as the Commission may deem necessary.

CASE 1277: Application of the Oil Conservation Commission at the request of Wilson Oil Company for an order establishing a new oil pool with special pool rules in the Potash-Oil Area, Lea County, New Mexico, in accordance with Section 3, Paragraph III, of Order R-111-A. Applicant, in the above-styled cause, seeks an order creating a new oil pool in the area of Wilson Oil Company's recently completed oil well located in the NE/4 NE/4 Section 21, Township 20 South, Range 34 East, Lea County, New Mexico; and for the promulgation of special pool rules to govern future drilling in said pool in order to afford adequate protection for the potash deposits in the area.

CASE 1278: In the matter of the hearing called by the Oil Conservation Commission upon its own motion to permit Roy T. Short and the Hartford Accident and Indemnity Company and all other interested parties to appear and show cause why the Roy T. Short, et al, Millard Eidson No. B-3 Well located in the SW/4 SE/4 of Section 26, Township 16 South, Range 35 East, in the Shoe Bar Area of Lea County, New Mexico, should not be ordered plugged and abandoned in accordance with the Rules and Regulations of the Oil Conservation Commission of New Mexico.

CASE 1279: In the matter of the hearing called by the Oil Conservation Commission upon its own motion to permit Roy T. Short, M. N. Hamilton, Apache Basin Oil Company, and Basin Oil Company, and all other interested parties to appear and show cause why the hole located 660 feet from the South and West lines of Section 25, Township 16 South, Range 35 East, Lea County, New Mexico, should not be ordered plugged and abandoned in accordance with the Rules and Regulations of the Oil Conservation Commission of New Mexico.

CASE 1280: Application of Sunray Mid-Continent Oil Company for an order authorizing a pilot secondary recovery project in the Bisti-Lower Gallup Oil Pool in exception to Rule 701 of the Commission Rules and Regulations. Applicant, in the above-styled cause, seeks an order authorizing it to drill and operate a well at a point five feet southeast of the northwest corner of Section 6, Township 25 North, Range 12 West, San Juan County, New Mexico, for the injection of liquified petroleum gases and dry gas into the Lower Gallup formation of the Bisti-Lower Gallup Oil Pool for the purpose of secondary recovery of oil from said pool.

CASE 1281: Application of Skelly Oil Company for approval of an unorthodox oil well location in an undesignated oil pool in Rio Arriba County, New Mexico, in exception to Rule 104 of the Commission Rules and Regulations. Applicant, in the above-styled cause, seeks an order authorizing an unorthodox oil well location in an undesignated oil pool for its Jicarilla "B" Well No. 2 located 1590 feet from the South line and 990 feet from the East line of Section 31, Township 25 North, Range 5 West, Rio Arriba County, New Mexico. Said well was projected as a gas well in accordance with the Commission gas well location rules but was found to be productive of oil.

CASE 1282: Southeastern New Mexico Nomenclature case calling for an order creating new pools and extending and deleting certain areas from existing pools in Eddy and Lea Counties, New Mexico.

(a) Create a new oil pool for Grayburg production, designated as the Teague-Grayburg Pool, and described as:

TOWNSHIP 23 SOUTH, RANGE 37 EAST
Section 20: SE/4

- (b) Create a new oil pool for Pennsylvanian production, designated as the Kennitz-Pennsylvanian Pool, and described as:

TOWNSHIP 16 SOUTH, RANGE 33 EAST
Section 13: SE/4

- (c) Extend the Dollarhide-Drinkard Pool to include:

TOWNSHIP 24 SOUTH, RANGE 38 EAST
Section 19: NW/4
Section 20: W/2 SW/4

- (d) Extend the Drinkard Pool to include:

TOWNSHIP 22 SOUTH, RANGE 37 EAST
Section 27: E/2 NE/4

- (e) Extend the Gladiola Pool to include:

TOWNSHIP 12 SOUTH, RANGE 37 EAST
Section 25: N/2 NE/4

TOWNSHIP 12 SOUTH, RANGE 38 EAST
Section 17: NW/4
Section 18: N/2 NE/4

- (f) Extend the North Gladiola-Devonian Pool to include:

TOWNSHIP 11 SOUTH, RANGE 38 EAST
Section 32: SE/4

TOWNSHIP 12 SOUTH, RANGE 38 EAST
Section 6: SW/4
Section 7: NW/4
Section 8: NW/4

- (g) Extend the West Henshaw-Grayburg Pool to include:

TOWNSHIP 16 SOUTH, RANGE 30 EAST
Section 4: SE/4
Section 5: SE/4
Section 8: NE/4

- (h) Extend the Langlie-Mattix Pool to include:

TOWNSHIP 23 SOUTH, RANGE 36 EAST
Section 4: E/2 SE/4

- (i) Extend the Pearl-Queen Pool to include:

TOWNSHIP 19 SOUTH, RANGE 35 EAST
Section 22: S/2 SE/4

- (j) Extend the Townsend-Wolfcamp Pool to include:

TOWNSHIP 16 SOUTH, RANGE 36 EAST
Section 8: W/2 SW/4

- (k) Extend the Terry-Blinebry Pool to include:

TOWNSHIP 21 SOUTH, RANGE 37 EAST
Section 3: Lot 16
Section 4: Lot 1

- (l) Delete the following area from the Blinebry Gas Pool:

TOWNSHIP 21 SOUTH, RANGE 37 EAST
Section 3: Lot 16
Section 4: Lot 1

CASE 1283: Northwestern New Mexico nomenclature case calling for an order extending existing pools in San Juan and Rio Arriba Counties, New Mexico.

- (a) Extend the Aztec-Pictured Cliffs Pool to include:

TOWNSHIP 28 NORTH, RANGE 9 WEST
All of Sections 9, 10, 11, 12, 13, & 14
Section 15: E/2 & SW/4
Section 24: All

TOWNSHIP 31 NORTH, RANGE 11 WEST
Section 34: All

- (b) Extend the Otero-Pictured Cliffs Pool to include:

TOWNSHIP 23 NORTH, RANGE 5 WEST
Section 9: E/2
Section 16: N/2

TOWNSHIP 24 NORTH, RANGE 5 WEST
Section 13: SW/4
Section 14: S/2
Section 21: NE/4
Section 22: N/2 & SE/4
All of Sections 23, 24, & 25
Section 31: S/2

- (c) Extend the South Blanco-Pictured Cliffs Pool to include:

TOWNSHIP 24 NORTH, RANGE 4 WEST
Section 5: W/2

TOWNSHIP 27 NORTH, RANGE 8 WEST
Section 4: All

(d) Extend the Blanco-Mesaverde Pool to include:

TOWNSHIP 28 NORTH, RANGE 9 WEST
Section 32: All

(e) Extend the Bisti-Lower Gallup Oil Pool to include:

TOWNSHIP 26 NORTH, RANGE 13 WEST
Section 36: NW/4

(f) Extend the Verde-Gallup Oil Pool to include:

TOWNSHIP 31 NORTH, RANGE 14 WEST
Section 18: All

TOWNSHIP 31 NORTH, RANGE 15 WEST
Section 13: N/2

CONTINUED CASES

CASE 1221: Application of the Oil Conservation Commission on its own motion for an order amending Commission Order R-586 insofar as it relates to the Byers-Queen and Tubb Gas Pools. Applicant, in the above-styled cause, seeks an order amending the Special Rules and Regulations for the Tubb Gas Pool to make provision in said rules for the regulation of oil wells completed within the defined limits of said pool; and further to consider the deletion of that portion of Order R-586 relating to the Byers-Queen Gas Pool.

CASE 1261: Application of Gulf Oil Corporation and Western Oil Fields, Inc., for an order force pooling certain acreage in the Blinebry and Tubb Gas Pools, Lea County, New Mexico. Applicants, in the above-styled cause, seek an order force pooling the interests of all persons having any right, title or interest in the Blinebry and Tubb formations underlying the SW/4 Section 30, Township 22 South, Range 38 East, Lea County, New Mexico.

CASE 1262: Application of Gulf Oil Corporation and Western Oil Fields, Inc., for an order force pooling certain acreage in the Blinebry and Tubb Gas Pools, Lea County, New Mexico. Applicants, in the above-styled cause, seek an order force pooling the interest of all persons having any right, title or interest in the Blinebry and Tubb formations underlying the SE/4 Section 30, Township 22 South, Range 38 East, Lea County, New Mexico.

CASE 1263: Application of Gulf Oil Corporation and Western Oil Fields, Inc., for an order force pooling certain acreage in the Blinebry and Tubb Gas Pools, Lea County, New Mexico. Applicants, in the above-styled cause, seek an order force pooling the interests of all persons having any right, title or interest in the Blinebry and Tubb formations underlying the NE/4 Section 25, Township 22 South, Range 37 East, Lea County, New Mexico.

CASE 1264: Application of Gulf Oil Corporation and Western Oil Fields, Inc., for an order force pooling certain acreage in the Blinebry and Tubb Gas Pools, Lea County, New Mexico. Applicants, in the above-styled cause, seek an order force pooling the interests of all persons having any right, title or interest in the Blinebry and Tubb formations underlying the SE/4 Section 25, Township 22 South, Range 37 East, Lea County, New Mexico.

CASE 1265: Application of R. Olsen Oil Company for an order force pooling certain acreage in the Justis Gas Pool, Lea County, New Mexico. Applicant, in the above-styled cause, seeks an order force pooling the interests of all persons having any right, title or interest in the Glorieta formation of the Justis Gas Pool underlying the NE/4 Section 23, Township 25 South, Range 37 East, Lea County, New Mexico.

ir/