

CASE 2812:

SOUTHEASTERN NEW MEXICO  
NOMENCLATURE

*Handwritten:*  
J. B. ...  
...

CASE No.  
2812

Application,  
TRANSCRIPTS,  
SMALL Exhibits  
ETC.

TO BE DISMISSED

TOWNSHIP	18	RANGE	23	NEW MEXICO PRINCIPAL MERIDIAN			
	6	5	4	3	2	1	
	7	8	9	10	11	12	
	18	17	16	15	14	13	
	19	20	21	22	23	24	
	30	29	28	27	26	25	
	31	32	33	34	35	36	

Unit K of Section 30-18-23. Completed in Strawn (Pennsylvanian)  
January 12, 1963. Top of perforations 7326.

Proposed pool boundary colored in green. Section 30: All  
TO BE DISMISSED PENDING FURTHER STUDY.

CASE 2812: (b) CREATION OF A NEW OIL POOL

COUNTY LEA POOL MIDWAY-ABO

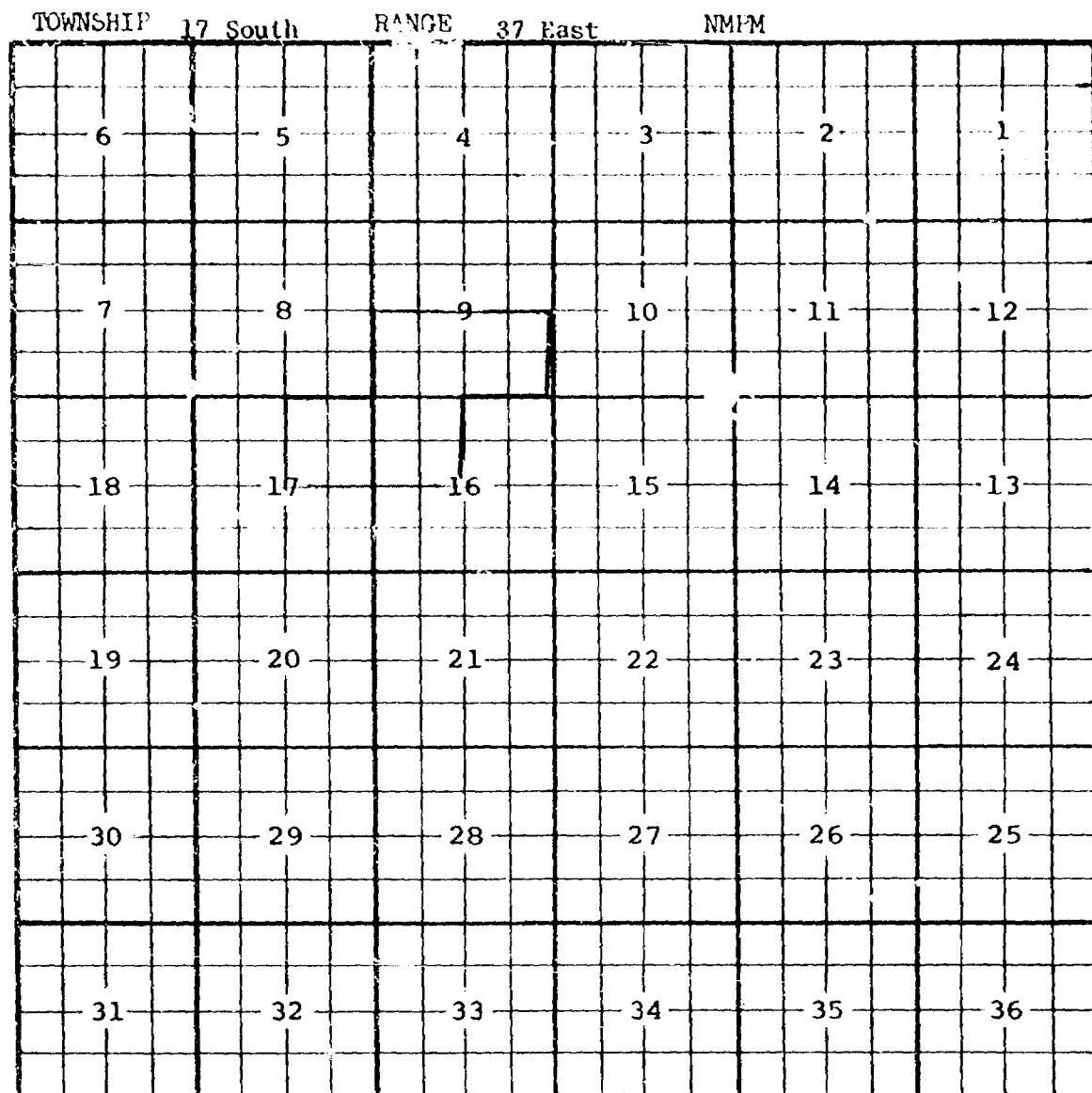

PURPOSE: Three completed oil wells capable of producing and three drilling wells in S/2 of Section 9 and NE/4 of Section 17-17-37.

CONSOLIDATED OIL & GAS COMPANY, INC. - Southern Union State #1-16 in Unit D of Section 16-17-37. Completed in Abo on October 4, 1962. Top of Perforations 8861'.

SOUTHERN UNION PRODUCTION COMPANY - Lovington State #1 in Unit C of Section 16-17-37. Completed in Abo on February 19, 1963. Top of Perforations 8958'.

SOUTHERN UNION PRODUCTION COMPANY - Lovington State #1-9 in Unit M of Section 9-17-37. Completed in Abo on April 11, 1963. Top of Perforations 8813'.

Proposed pool boundary colored in red. SECTION 9: S/2

SECTION 16: NW/4

SECTION 17: NE/4

CASE 2812: (C) CREATION OF A NEW OIL POOL

County EDDY Pool PENASCO-SAN ANDRES

TOWNSHIP 18						RANGE 25						NEW MEXICO PRINCIPAL MERIDIAN					
6		5		4		3		2		1							
7		8		9		10		11		12							
18		17		16		15		14		13							
19		20		21		22		23		24							
30		29		28		27		26		25							
31		32		33		34		35		36							

Purpose: One completed oil well capable of producing.  
Discovery Well: Yates Petroleum Corporation - Yates Fed.  
No. 1 in Unit E of section 25-18-25. Completed in San  
Andres, December 16, 1962. Top of perforations 1382'.

Proposed Pool Boundary colored in green. Section 25: NW/4

DELETION

CASE 2812: (d) DELETION OF AN EXISTING OIL POOL (Continued on next page)

County EDDY Pool ROBINSON (GRAYBURG-SAN ANDRES)

TOWNSHIP	16S	RANGE	31E	NEW MEXICO PRINCIPAL MERIDIAN
6	5	4	3	2
7	8	9	10	11
18	17	16	15	14
19	20	21	22	23
30	29	28	27	26
31	32	33	34	35
				36

Purpose: To consolidate three pools producing from the same formations, Robinson, North Robinson and Grayburg Jackson.

Pool boundary colored in red.

Proposed deletion colored in blue. Section 25: S/2 & S/2 NE/4

Section 35 & 36: All

CASE 2812: (d) DELETION OF AN EXISTING OIL POOL

County **EDDY** Pool **ROBINSON (GRAYBURG-SAN ANDRES)**

TOWNSHIP 17S RANGE 31E NEW MEXICO PRINCIPAL MERIDIAN

1 2 3 4 5 6 7 8 9 10 11 12 13 14 15 16 17 18 19 20 21 22 23 24 25 26 27 28 29 30 31 32 33 34 35 36

Purpose: As stated on page one of this exhibit.

Pool boundary colored in red.

Proposed deletion colored in blue. Section 1: S/2 & W/2 NW/4

Section 2: All

Section 11: E/2 &amp; N/2 NW/4

ABOLISHMENT

CASE 2812: (e) ABOLISHMENT OF AN EXISTING OIL POOL

County EDDY Pool NORTH ROBINSON-QUEEN-GRAYBURG-SAN ANTONIO

TOWNSHIP	16S	RANGE	31E	NEW MEXICO	PRINCIPAL MERIDIAN
6	5	4	3	2	1
7	8	9	10	11	12
18	17	16	15	14	13
19	20	21	22	23	24
30	29	28	27	26	25
31	32	33	34	35	36

Purpose: To consolidate three pools producing from the same formations; Robinson, North Robinson and Grayburg Jackson.

Proposed abolishment colored in blue. Section 24: NE/4

CASE 2812: (f) EXTENSION OF AN EXISTING OIL POOL (Continued on nextpage)

County EDDY Pool GRAYBURG - JACKSON

TOWNSHIP	16	RANGE	31	NEW MEXICO PRINCIPAL MERIDIAN		
	6	5	4	3	2	1
	7	8	9	10	11	12
	18	17	16	15	14	13
	19	20	21	22	23	24
	30	29	28	27	26	25
	31	32	33	34	35	36

Purpose: To combine three pools producing from the same formations; Robinson, North Robinson and Grayburg Jackson and one gas well capable of producing.

Pool boundary colored in red.

Proposed extension colored in green. Section 24: W/2 SE/4 & SW/4 NE/4

Section 25: S/2 & NE/4

Section 35 & 36: All

CASE 2812: (f) EXTENSION OF AN EXISTING OIL POOL (Continued)

County EDDY Pool GRAYBURG JACKSON

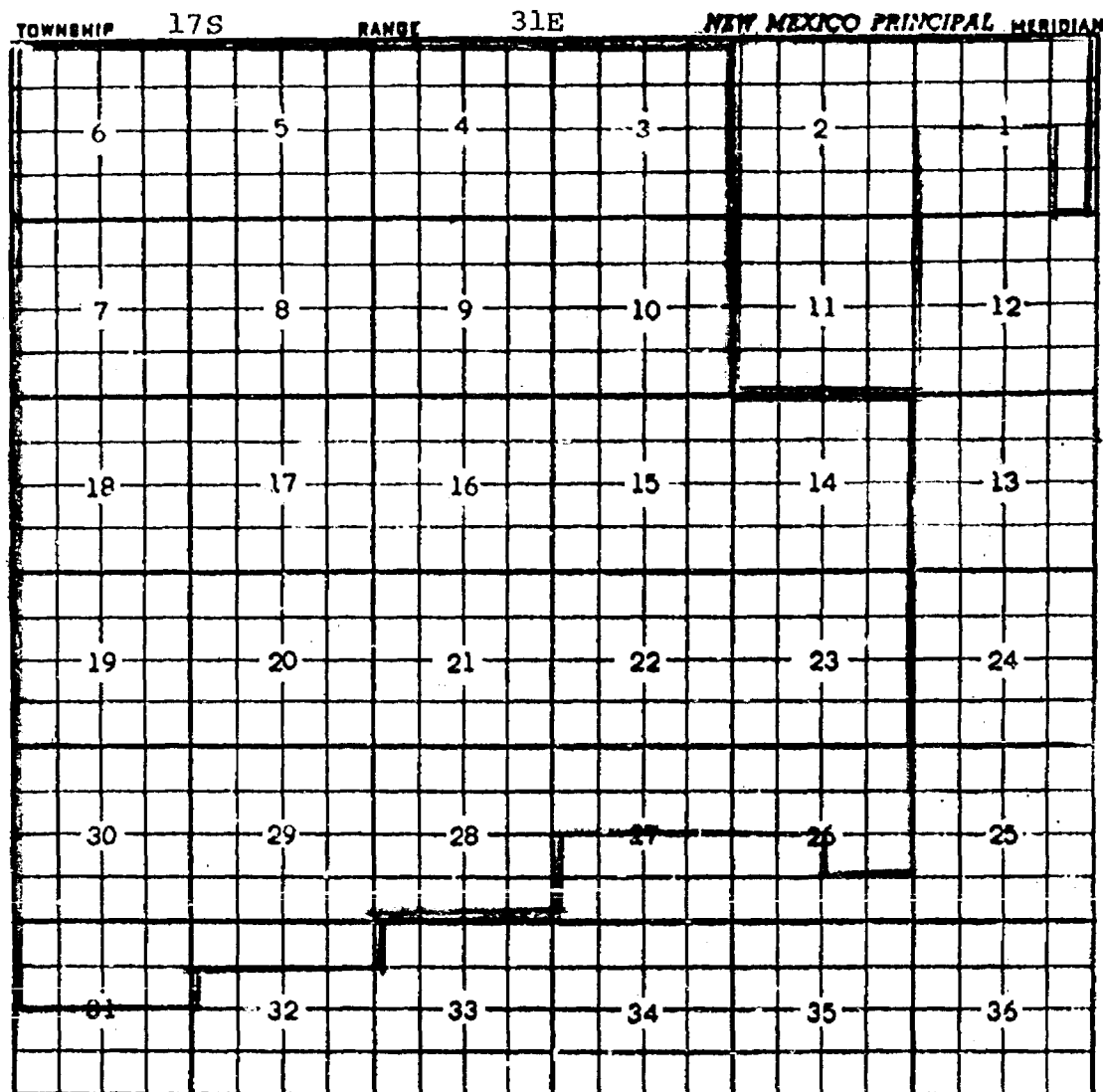

Purpose: As stated on page one of this exhibit.

Fren Oil Co. - Max Friess, Well No. 15 in Unit A of  
Section 1-17-31. Completed in Queen, April 28, 1960.

Top of perforations 3096', a gas well.

Pool boundary colored in red.

Proposed extensions colored in green. Section 1: N/2 & E/2 SE/4

Section 2 & 11: All

CASE 2812: (g) EXTENSION OF AN EXISTING OIL POOL (Continued on next page)

County EDDY Pool ARTESIA

TOWNSHIP		17S	RANGE		28E	NEW MEXICO PRINCIPAL MERIDIAN	
6		5	4		3	2 1	
7		8	9		10	11 12	
18		17	16		15	14 13	
19		20	21		22	23 24	
30		29	28		27	26 25	
31		32	33		34	35 36	

Purpose: Two completed oil wells capable of producing.

Addition: International-Yates - State 647, Well No. 191 in Unit D of Section 36-17-28. Completed in Grayburg, April 26, 1963. Top of perforations 2323'.

Pool boundary colored in red.

Proposed extension colored in green. Addition:

Section 36:NW/4 NW/4

CASE 2812: (g) EXTENSION OF AN EXISTING OIL POOL (Continued)

County EDDY Pool ARTESIA

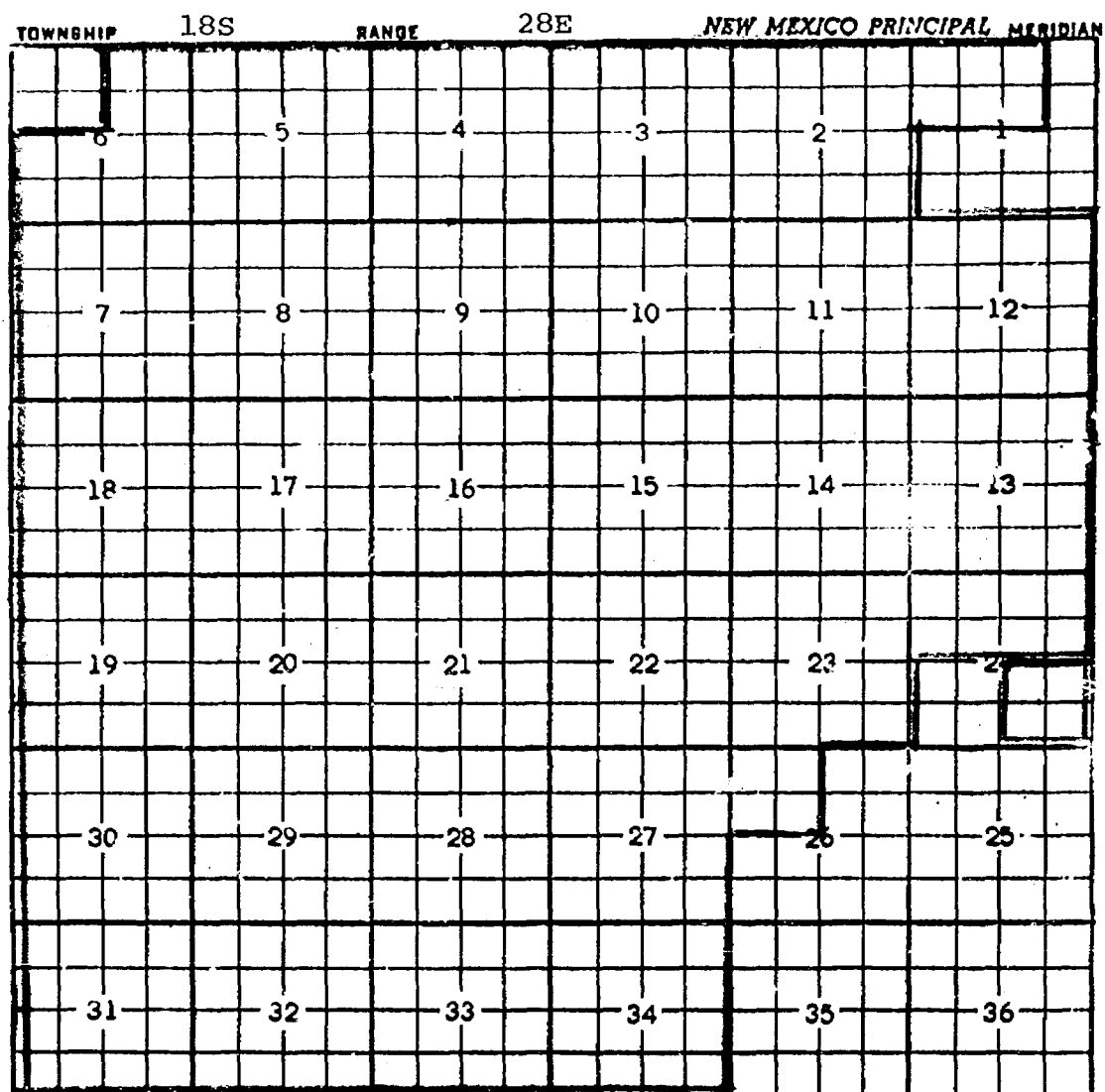

Purpose: As stated on page one of this exhibit.

Simms & Reese Oil Co. - Gulf St. Well No. 1 in Unit P of  
Section 24-18-28. Completed in Grayburg, December 23, 1962.  
Top of perforations 2261'.

Pool boundary colored in red.

Proposed extensions colored in green. Section 24: SE/4

CASE 2812: (h) EXTENSION OF AN EXISTING OIL POOL.

County EDDY Pool CORRAL CANYON - DELAWARE

TOWNSHIP 25S RANGE 30E NEW MEXICO PRINCIPAL MERIDIAN

6 5 4 3 2 1

7 8 9 10 11 12

13 14 15 16 17 18

19 20 21 22 23 24

25 26 27 28 29 30

31 32 33 34 35 36

Purpose: One completed oil well capable of producing.

Perry R. Bass - Continental Fed, Well No. 1 in Unit D of  
Section 20-25-30. Completed in Delaware, March 20, 1963.

Top of perforations 3664'.

Pool boundary colored in red.

Proposed extension colored in green. Section 17: W/2 SW/4

Section 20: NW/4 NW/4

CASE 2812: (i) EXTENSION OF AN EXISTING OIL POOL

County EDDY Pool HENSHAW - WOLFCAMP

TOWNSHIP	16S	RANGE	30E	NEW MEXICO PRINCIPAL MERIDIAN
6	5	4	3	2
7	8	9	10	11
18	17	16	15	14
19	20	21	22	23
30	29	28	27	26
31	32	33	34	35

Purpose: One completed oil well capable of producing.

Shell Oil Co. - Henshaw Deep Unit, Well No. 6 in Unit I  
of Section 23-16-30. Completed in Wolfcamp, February 1, 1963.

Top of perforations 8697'.

Pool boundary colored in red.

Proposed extension colored in green. Section 23: SE/4

CASE 2812: (j) EXTENSION OF AN EXISTING OIL POOL.

County EDDY Pool HIGH LONESOME

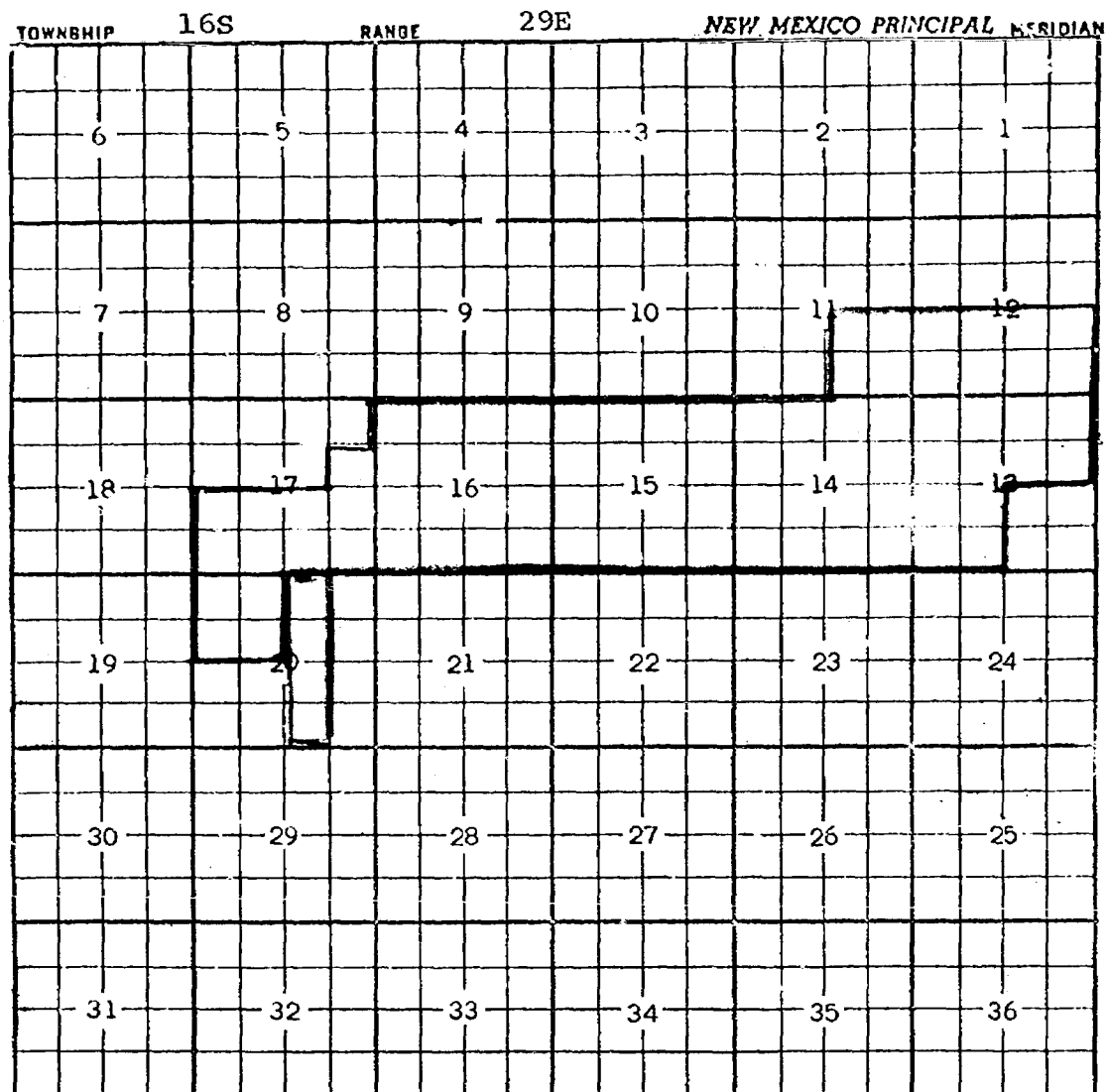

Purpose: One completed gas well capable of producing.  
General Western Petroleum Corp. - Brainard Fed., Well No. 1  
in Unit O of Section 20-16-29. Completed in Queen, March 21,  
1961. Top of perforations 1810'.

Pool boundary colored in red.  
Proposed extension colored in green. Section 20: W/2 E/2

CASE 2812: (k) EXTENSION OF AN EXISTING OIL POOL

COUNTY LEA POOL INBE-PENNSYLVANIAN

TOWNSHIP 11 South						RANGE 34 East						NMPM					
6			5			4			3			2			1		
7			8			9			10			11			12		
18			17			16			15			14			13		
19			20			21			22			23			24		
30			29			28			27			26			25		
31			32			33			34			35			36		

PURPOSE: One completed oil well capable of producing.

L. R. FRENCH, JR. - Gulf State #2 in Unit C of Section 18-11-34. Completed in Pennsylvanian (Bough C) on December 28, 1962. Top of Perforations 9794'.

ADDITION--SOUTHERN NATURAL GAS COMPANY - State "B" #1 in Unit N of Section 7-11-34. Completed in Bough C on March 23, 1963. Top of Perforations 9784'.

Pool boundary colored in red.

Proposed pool extension colored in green. SECTION 18: W/2 NE/4 and NW/4

ADDITION---SECTION 7: E/2 SW/4

CASE 2812: (1) EXTENSION OF AN EXISTING OIL POOL (Continued)

COUNTY	LEA	POOL	NORTH JUSTIS-BLINEBRY				
TOWNSHIP	24 South	RANGE	37 East	NMPM			
6	5	4	3	2	1		
7	8	9	10	11	12		
18	17	16	15	14	13		
19	20	21	22	23	24		
30	29	28	27	26	25		
31	32	33	34	35	36		

PURPOSE: As stated on preceding page, paragraph (1), Exhibit I  
 ADDITION--GULF OIL CORPORATION - W. A. Ramsay C #5 in Unit D of Section  
 36-24-37. Completed in Blinebry on April 23, 1963. Top of  
 Perforations 5532'.  
 Pool boundary colored in red.  
 Proposed pool extension colored in green. ADDITION--SECTION 36: NW/4

CASE 2812: (1) EXTENSION OF AN EXISTING OIL POOL (Continued on next page)

COUNTY LEA POOL NORTH JUSTIS-BLINEBRY

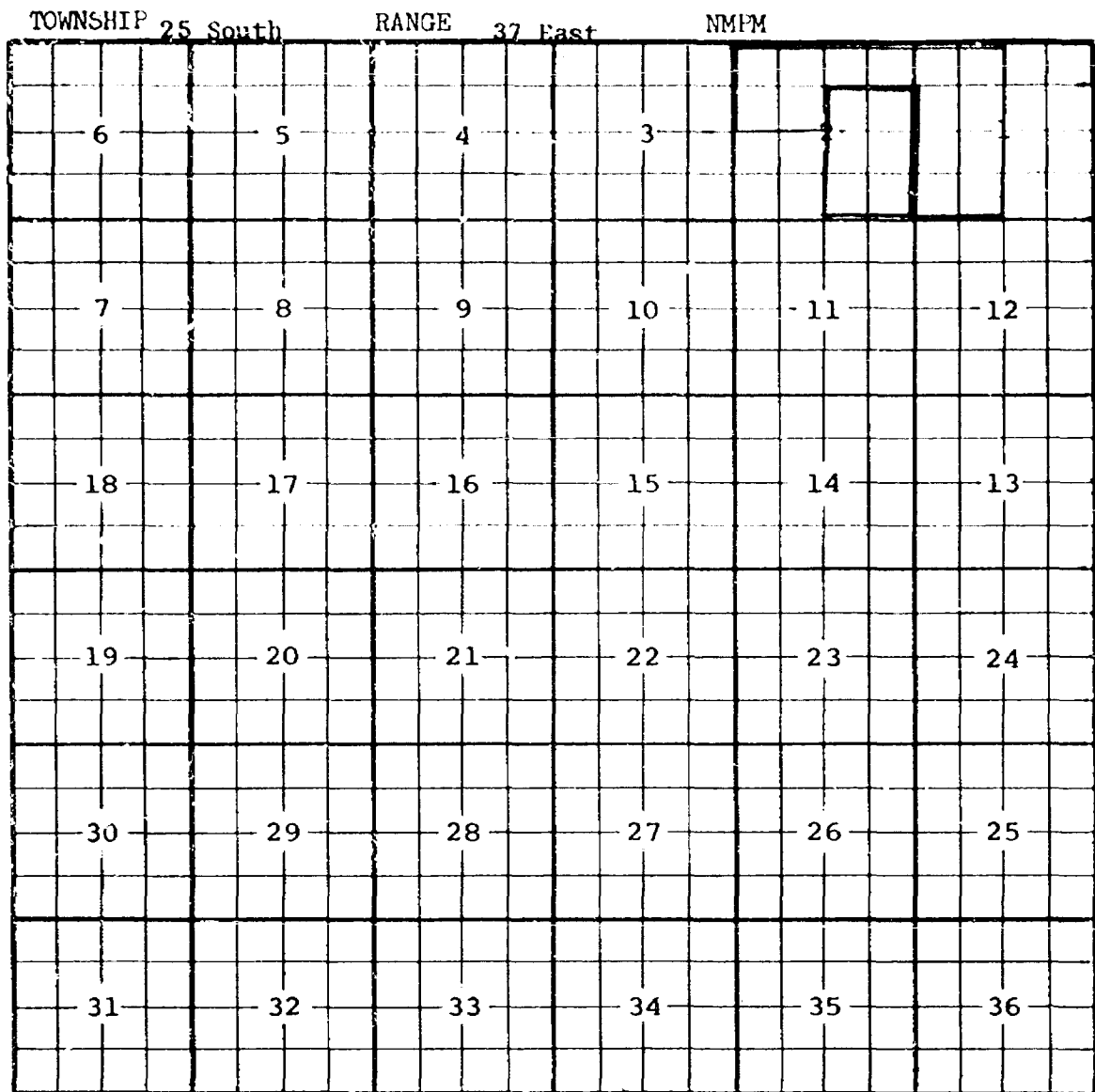

PURPOSE: One completed oil well capable of producing.

CONTINENTAL OIL COMPANY - State A-2 #3 in Unit O of Section 2-25-37.

Completed in Blinebry on March 14, 1963. Top of Perforations 5362'.

Pool boundary colored in red.

Proposed extension colored in green. SECTION 2: S/2 NE/4 and SE/4

CASE 2812: (m) EXTENSION OF AN EXISTING OIL POOL

COUNTY LEA POOL NORTH JUSTIS-DEVONIAN

TOWNSHIP 25 South RANGE 37 East NM-M

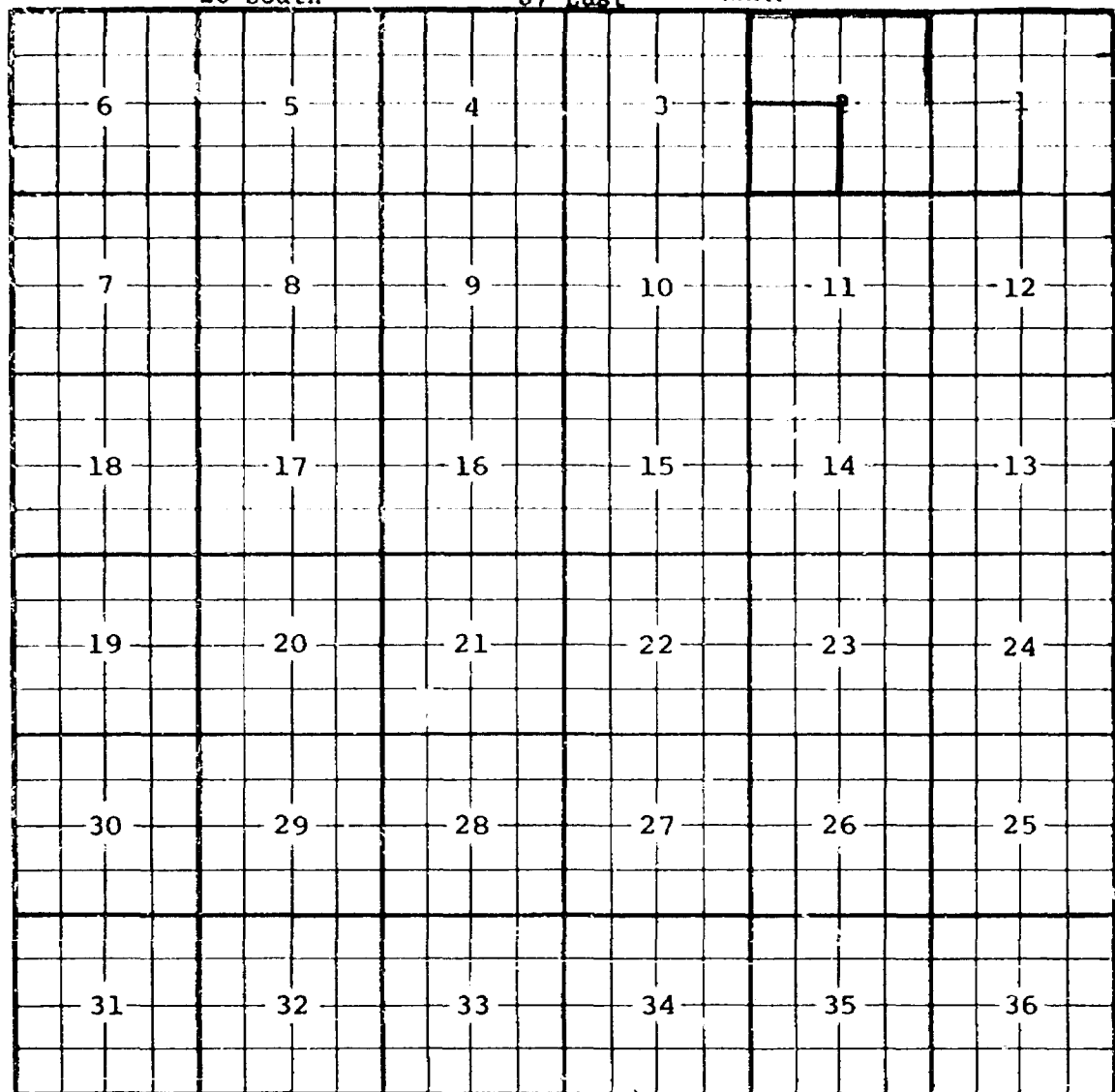

PURPOSE: One completed oil well capable of producing.

TEXACO, INC. - State of New Mexico "BZ" NCT-10 #1 in Unit K of Section 2-25-37. Completed in Devonian on March 10, 1963. Top of Perforations 7025'.

Pool boundary colored in red.

Proposed pool extension colored in green. SECTION2: SW/4

CASE 2812: (n) EXTENSION OF AN EXISTING OIL POOL

COUNTY LEA POOL NORTH JUSTIS-TURR/DRINKARD

TOWNSHIP 25 South RANGE 37 East NMIM

6	5	4	3	2	1
7	8	9	10	11	12
18	17	16	15	14	13
19	20	21	22	23	24
30	29	28	27	26	25
31	32	33	34	35	36

PURPOSE: One completed oil well capable of producing.

TEXACO, INC. - State of New Mexico BZ NCT-10 #1 in Unit K of Section 2-25-37. Completed in Drinkard on March 1, 1963. Top of Perforations 6031'.

Pool boundary colored in red.

Proposed pool extension colored in green. SECTION 2: SW/4

CASE 2812: (o) EXTENSION OF AN EXISTING OIL POOL (Continued on next page)

COUNTY	LEA	POOL	PEARL-QUEEN		
TOWNSHIP	19 South	RANGE	34 East	NMIM	
6	5	4	3	2	1
7	8	9	10	11	12
18	17	16	15	14	13
19	20	21	22	23	24
30	29	28	27	26	25
31	32	33	34	35	36

PURPOSE: Two completed oil wells capable of producing.

CACTUS DRILLING COMPANY - Pure State #1 in Unit P of Section 36-19-34.

Completed in Queen on March 31, 1963. Top of Perforations 4881'.

Pool boundary colored in red.

Proposed pool extension colored in green. SECTION 36: SE/4

CASE 2812: (o) EXTENSION OF AN EXISTING OIL POOL (Continued)

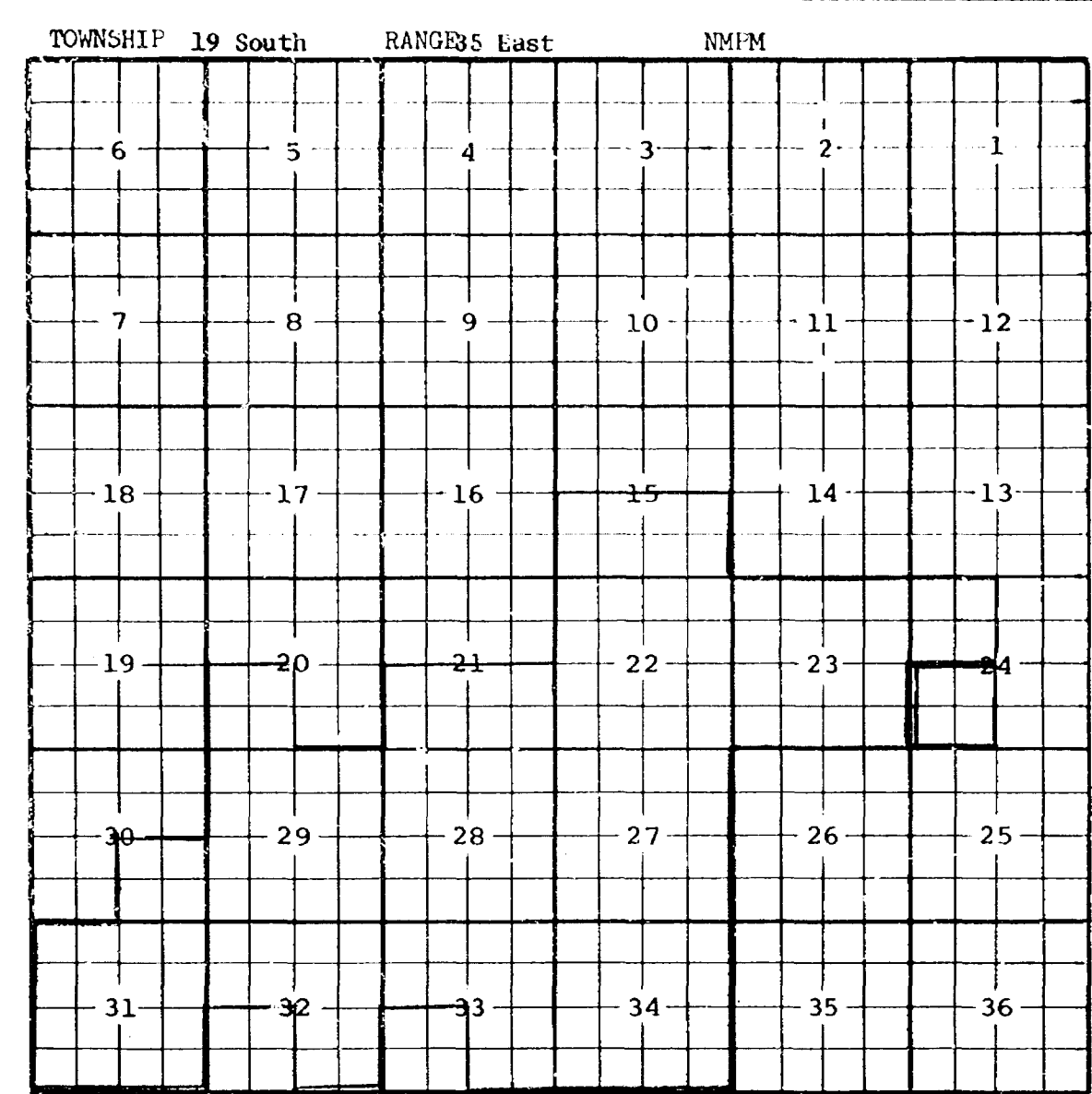

PURPOSE: As stated on preceding page, paragraph (o), Exhibit I

ADDITION-----E. L. FUNDINGSLAND - Texaco Lea #1 in Unit L of Section 24-19-35. Com-  
pleted in Queen on April 24, 1963. Top of Perforations 4912'.  
Pool boundary colored in red.  
Proposed pool extension colored in green. ADDITION--SECTION 24: SW/4

CASE 2812: (o) EXTENSION OF AN EXISTING OIL POOL (Continued)

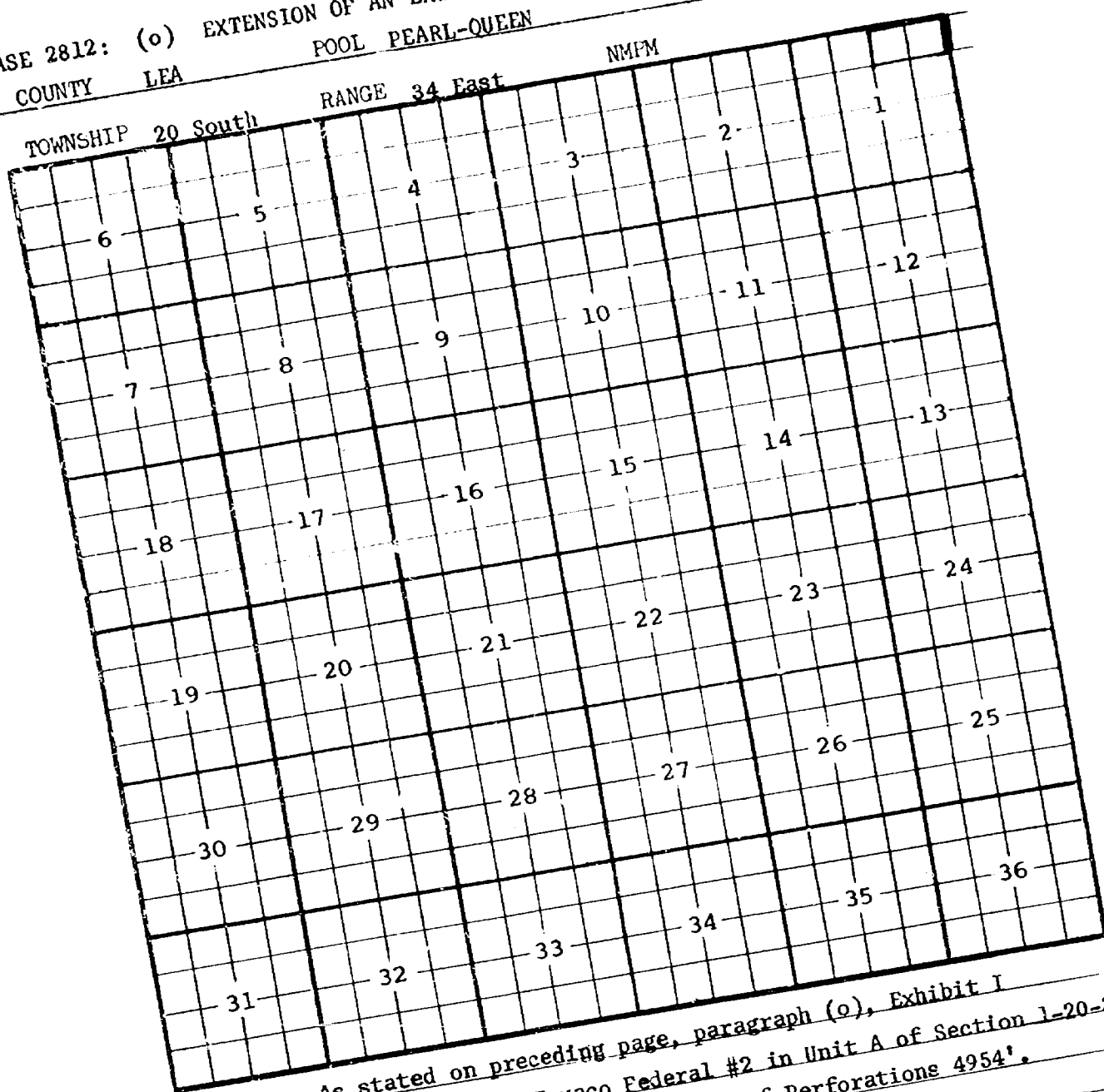

PURPOSE: As stated on preceding page, paragraph (o), Exhibit I  
 CACTUS DRILLING COMPANY - Texaco Federal #2 in Unit A of Section 1-20-34.  
 Completed in Queen on March 7, 1963. Top of Perforations 4954'.  
 Pool boundary colored in red.  
 Proposed pool extension colored in green. SECTION 1: N/2 NE/4

CASE 2812: (2) EXTENSION OF AN EXISTING GAS POOL

COUNTY LEA

POOL SAWYER-SAN ANDRES GAS

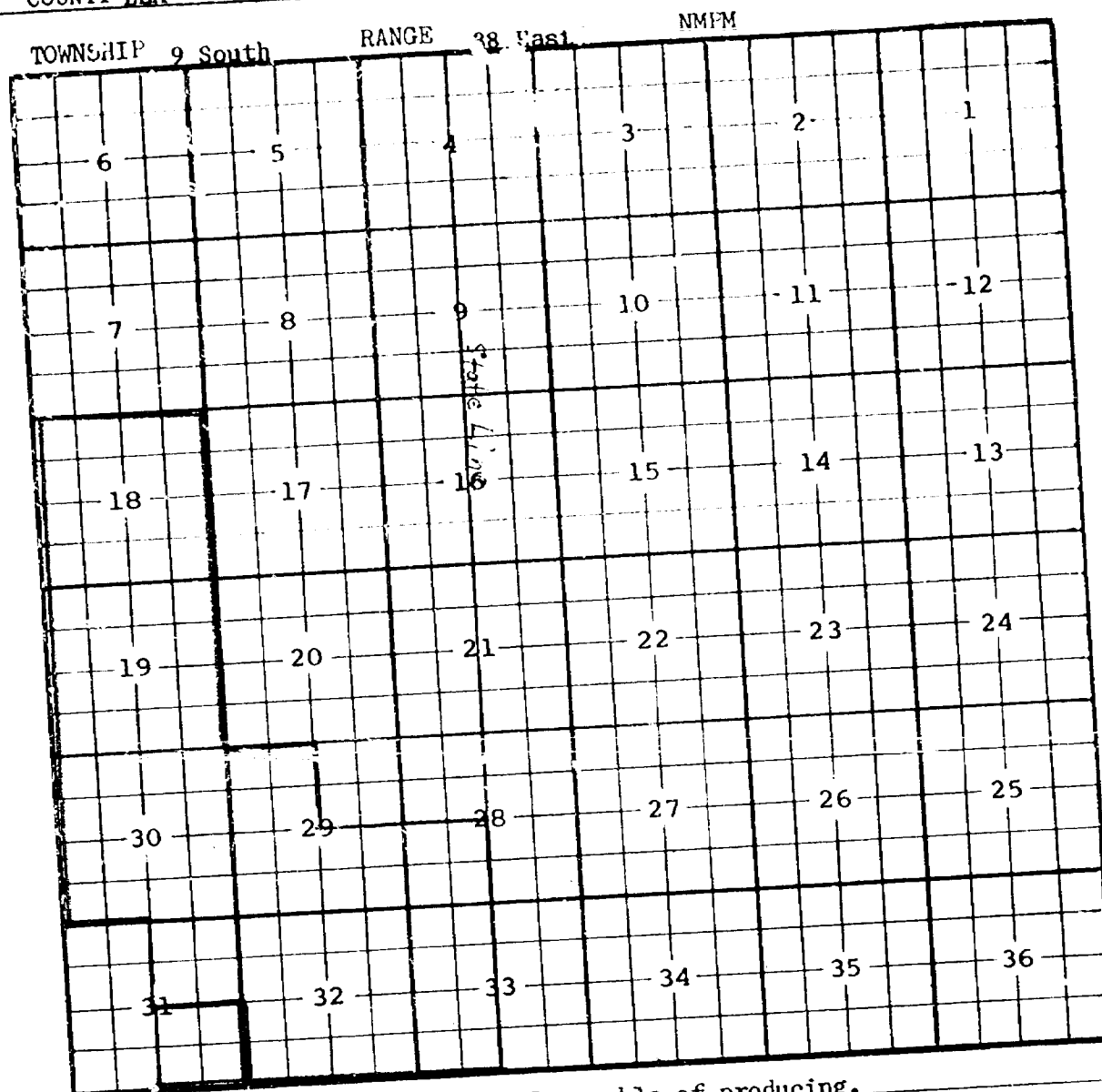

PURPOSE: One completed gas well capable of producing.

PEARSON-SIBERT OIL COMPANY OF TEXAS - Union Federal #2 in Unit P of

Section 31-9-38. Completed in San Andres on January 21, 1960. Top of Perforations 4927'.

Pool boundary colored in red.

Proposed pool extension colored in green. SECTION 31: SE/4

CASE 2812: (q) EXTENSION OF AN EXISTING OIL POOL

COUNTY LEA

POOL VACUUM-DEVONIAN

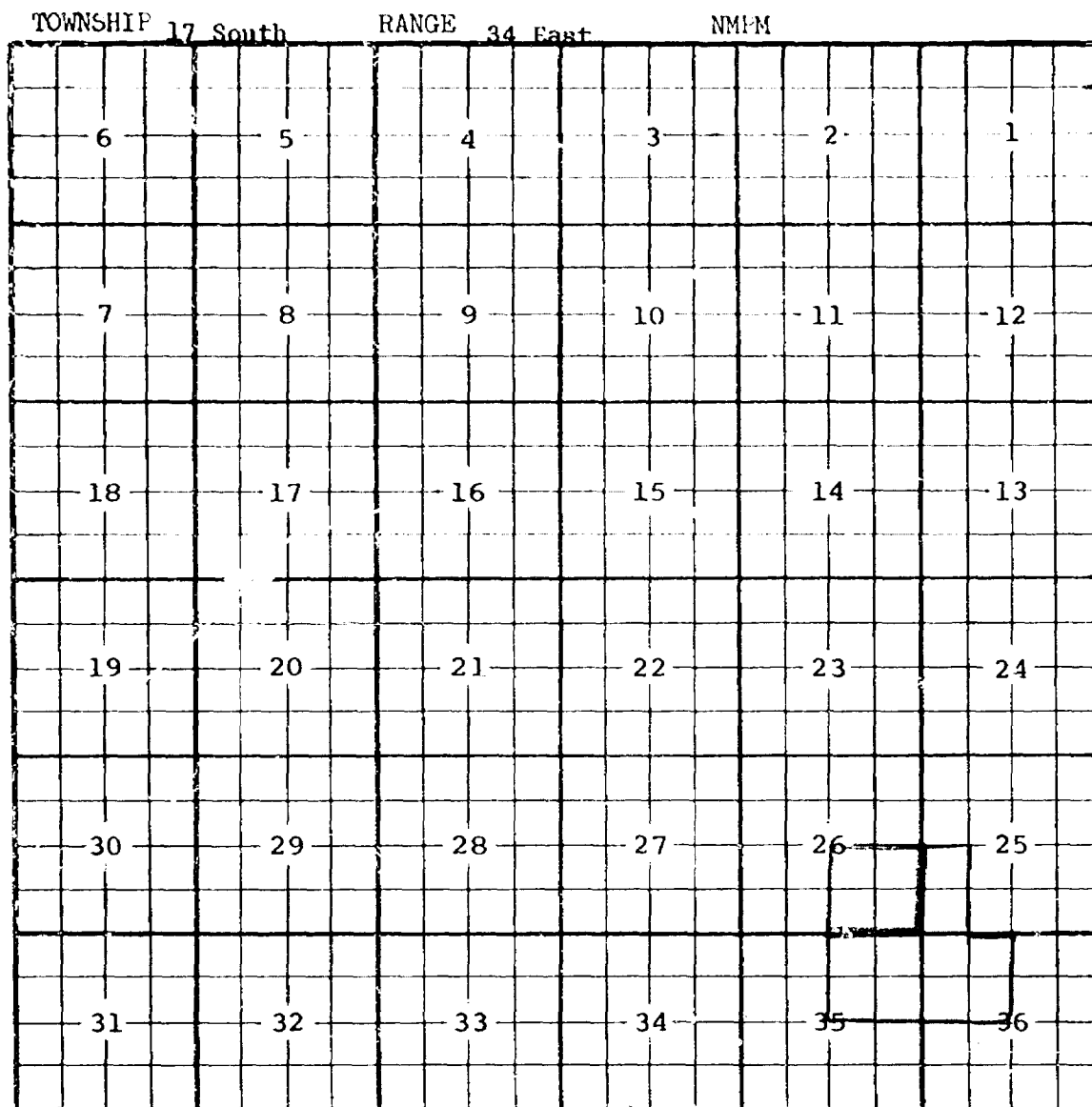

PURPOSE: One completed oil well capable of producing.

TEXACO, INC. - State of New Mexico "O" #11 in Unit F of Section 34-17-34. Completed in Devonian on February 27, 1963. Top of Perforations 12,091'.

ADDITION--MARATHON OIL COMPANY - State McCallister #5 in Unit M of Section 25-17-34. Completed in Devonian on May 1, 1963. Top of Perforations 12,004'.

Pool boundary colored in red.

Proposed pool extensions colored in green. SECTION 35: NE/4

SECTION 36: NW/4

ADDITION---SECTION 25: W/2 SW/4

CASE 2812: (r) EXTENSION OF AN EXISTING OIL POOL  
COUNTY LEA POOL VACUUM-GLORIETA

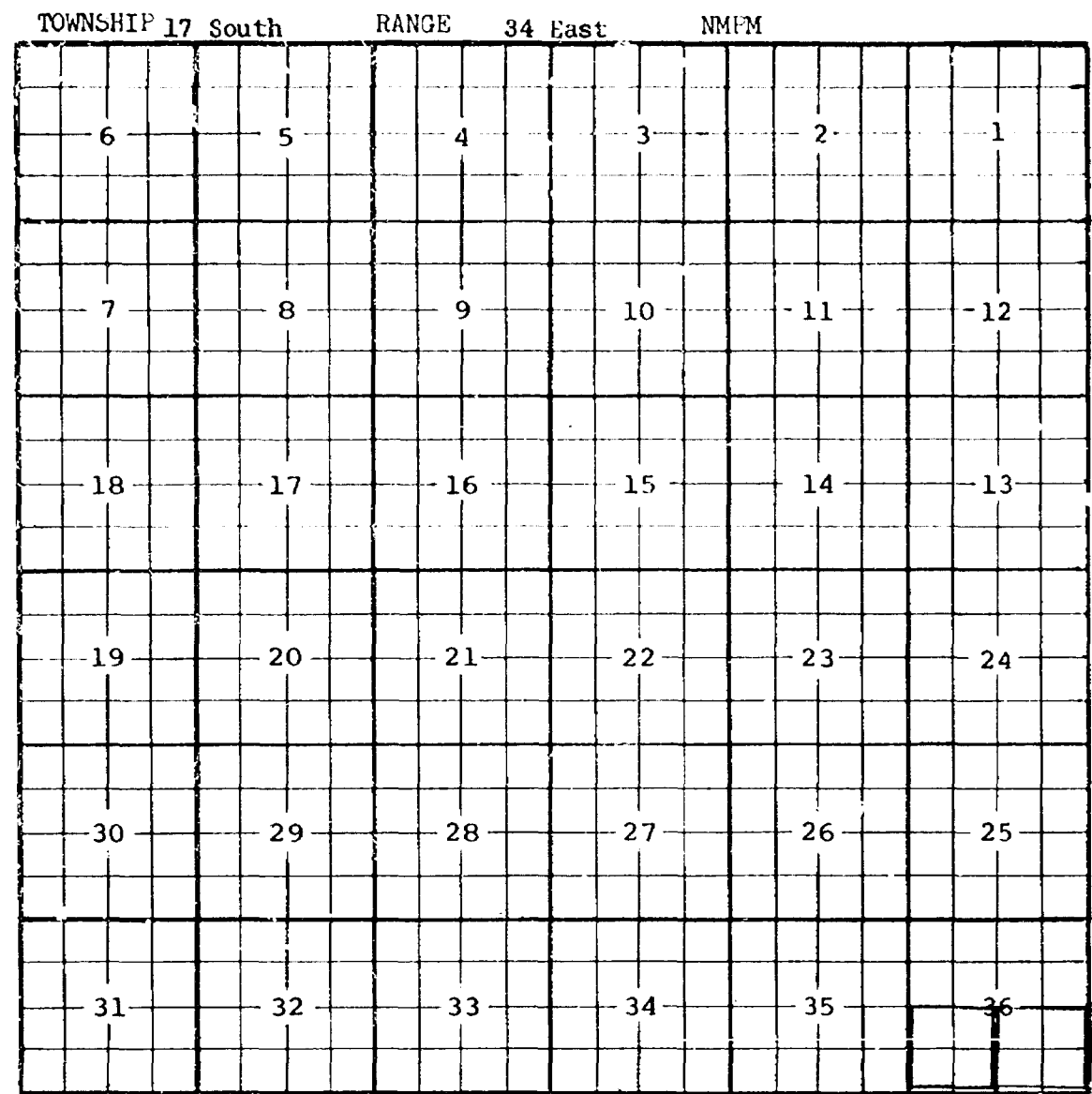

PURPOSE: One completed oil well capable of producing.

TEXACO, INC. - State of New Mexico O NCT-1 #13 in Unit N of Section 36-17-34. Completed in Glorieta on February 10, 1963. Top of Perforations 5916'.

Pool boundary colored in red.

Proposed pool extension colored in green. SECTION 36: SW/4

CASE 2812: (s) EXTENSION OF AN EXISTING OIL POOL (Continued on next page)

COUNTY LEA POOL WANTZ-ABO

TOWNSHIP 21 South RANGE 37 East NMPM

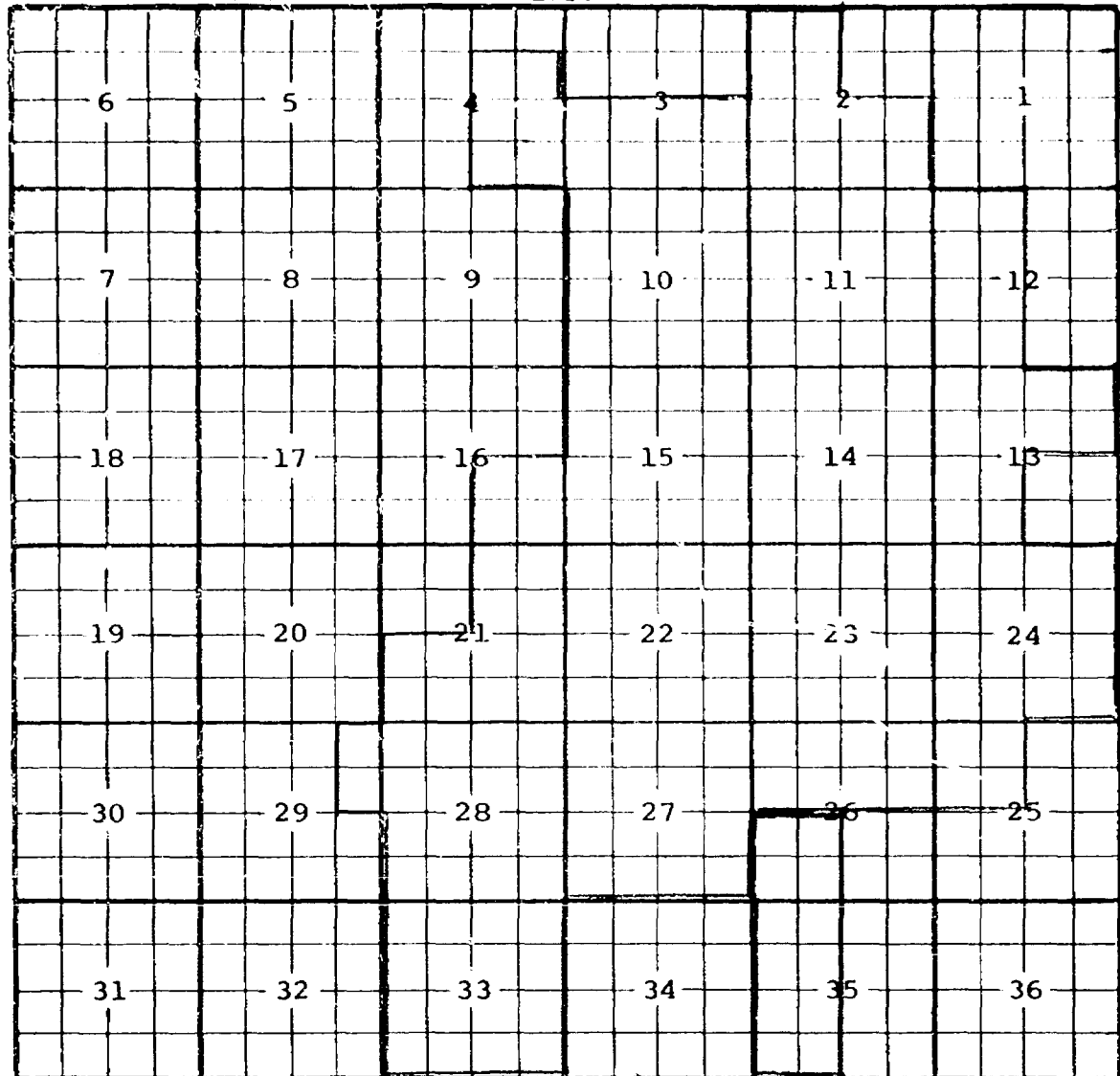

PURPOSE: To take in acreage for Humble Oil & Refining Company, State V.

#24 in Unit J of Section 2-22-37.

Pool boundary colored in red.

Proposed pool extension colored in green. SECTION 26: SW/4

SECTION 35: W/2

CASE 2812: (s) EXTENSION OF AN EXISTING OIL POOL (Continued)  
COUNTY LEA POOL WANTZ-ABO

TOWNSHIP	22 South	RANGE	37 East	NMIM	
6	5	4	3	2	1
7	8	9	10	11	12
18	17	16	15	14	13
19	20	21	22	23	24
30	29	28	27	26	25
31	32	33	34	35	36

PURPOSE: As stated on preceding page, paragraph (s), Exhibit I

Pool boundary colored in red.

Proposed pool extension colored in green. SECTION 2: All

CASE 2812: (t) EXTENSION OF AN EXISTING OIL POOL

COUNTY CHAVES POOL WEST HENSHAW-GRAYBURG

TOWNSHIP 15 South RANGE 30 East NM 10

6	5	4	3	2	1
7	8	9	10	11	12
18	17	16	15	14	13
19	20	21	22	23	24
30	29	28	27	26	25
31	32	33	34	35	36

PURPOSE: One completed oil well capable of producing.

TEXACO, INC. - K. McIntosh Federal #1 in Unit M of Section 34-15-30/

Completed in Premier on March 3, 1961. Top of Perforations 3128'.

Pool boundary colored in red.

Proposed pool extension colored in green. SECTION 33: S/2 SE/4

SECTION 34: SW/4 SW/4

CASE 2812: (u) EXTENSION OF AN EXISTING OIL POOL.

County CHAVES Pool DIABLO SAN ANDRES

TOWNSHIP			10S	RANGE			27E	NEW MEXICO PRINCIPAL MERIDIAN									
6			5			4			3			2			1		
7			8			9			10			11			12		
18			17			16			15			14			13		
19			20			21			22			23			24		
30			29			28			27			26			25		
31			32			33			34			35			36		

Purpose: Two completed oil wells capable of producing.

E. A. Hanson - Penrose State, Well No. 1 in Unit D of

Section 22-10-27. Completed in San Andres, February 1, 1963.

Top of perforations 2083'.

E. A. Hanson - South State, Well No. 1 in Unit A of

Section 21-10-27. Completed in San Andres, February 1, 1963.

Top of perforations 2085'.

Pool boundary colored in red.

Proposed extensions colored in green. Section 21: NE/4 NE/4

Section 22: NW/4 NW/4

CASE 2812: (v) EXTENSION OF AN EXISTING OIL POOL

County CHAVES Pool WINDMILL - SAN ANDRES

TOWNSHIP	15S	RANGE	28E	NEW MEXICO PRINCIPAL MERIDIAN	
6	5	4	3	2	1
7	8	9	10	11	12
18	17	16	15	14	13
19	20	21	22	23	24
30	29	28	27	26	25
31	32	33	34	35	36

Purpose: One completed oil well capable of producing.  
Olen F. Featherstone - Federal, Well No. 1 in Unit D of  
Section 15-15-28. Completed in San Andres, January 24, 1963.  
Top of perforations 2518'.

Pool boundary colored in red.  
Proposed extension colored in green. Section 10: W/2 SW/4  
Section 15: NW/4 N 1/4

CASE 2812: (w) EXTENSION OF AN EXISTING OIL POOL  
COUNTY ROOSEVELT POOL WEST ALLISON-PENNSYLVANIAN

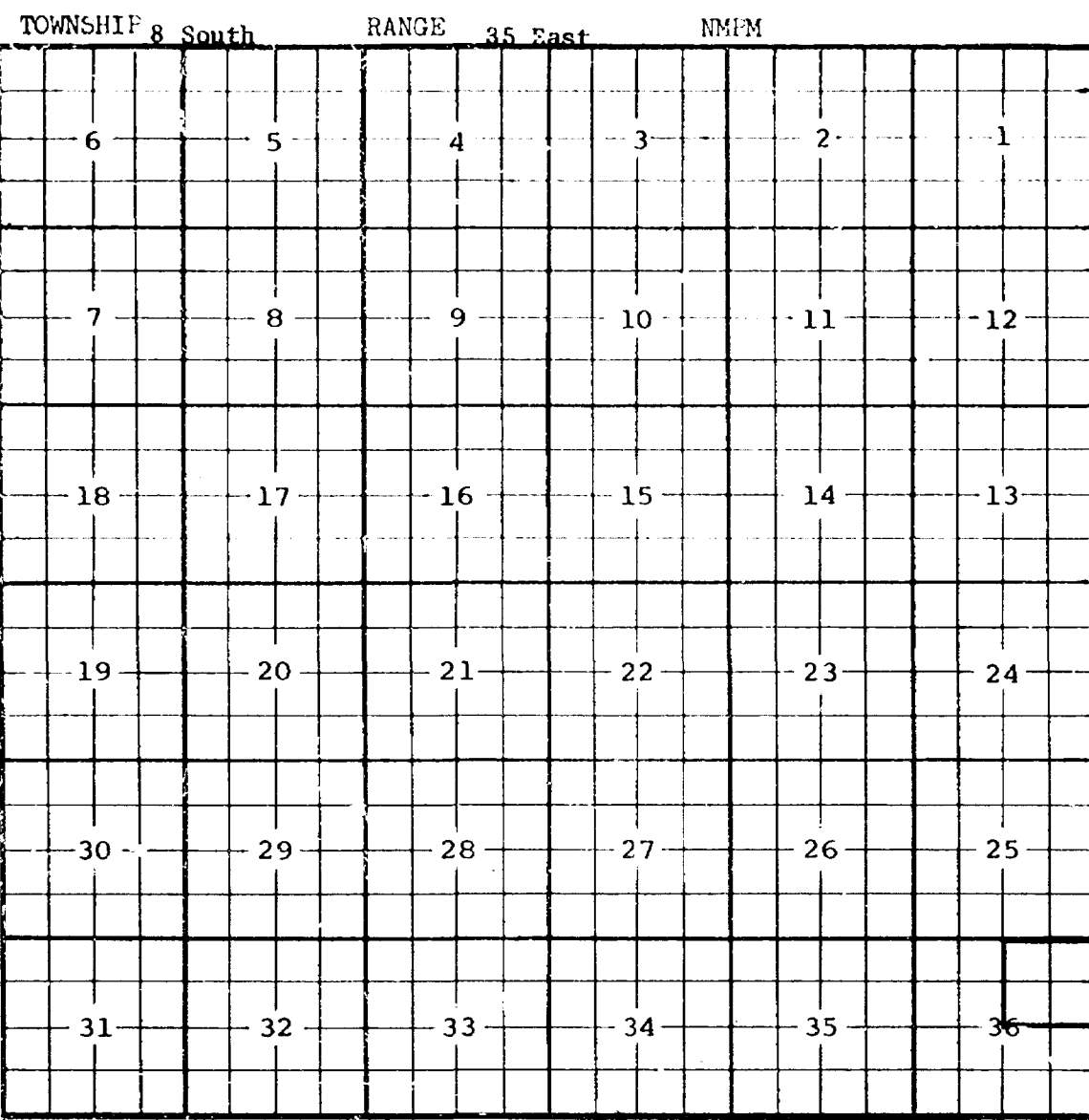

PURPOSE: One completed oil well capable of producing.  
ASHMUN & HILLIARD NO. 5 LTD. - Atlantic State #1 in Unit B of Section 36-  
8-35. Completed in Pennsylvanian (Bough C) on December 3, 1962. Top of  
Perforations 9780'.  
Pool boundary colored in red.  
Proposed pool extension colored in green. SECTION 36: NE/4

CASE 2812: (x) EXTENSION OF AN EXISTING OIL POOL, (Continued on next page)

COUNTY ROOSEVELT POOL MILNESAND-SAN ANDRES

TOWNSHIP 8 South				RANGE 34 East				NMPM			
6	5	4	3	2	1						
7	8	9	10	11	12						
18	17	16	15	14	13						
19	20	21	22	23	24						
30	29	28	27	26	25						
31	32	33	34	35	36						

PURPOSE: Five completed oil wells capable of producing.

LEN MAYER - Theresa #1 in Unit P of Section 1-8-34. Completed in San Andres on January 23, 1963. Top of Perforations 4600'.

SUN OIL COMPANY - G. M. Cosby #1 in Unit G of Section 12-8-34. Completed in San Andres on February 17, 1963. Top of Perforations 4609'.

SUN OIL COMPANY - G. M. Cosby #2 in Unit H of Section 12-8-34. Completed in San Andres on April 6, 1963. Top of Perforations 4607'.

ROBERT A. DEAN - Weathersby #6 in Unit K of Section 24-8-34. Completed in San Andres on January 10, 1963. Top of Perforations 4637'.

Pool boundary colored in red.

Proposed Pool extensions colored in green. SECTION 1: S/2 SE/4

SECTION 12: NE/4

SECTION 24: SW/4

CASE 2812: (x) EXTENSION OF AN EXISTING OIL POOL (Continued)  
COUNTY ROOSEVELT POOL MILNESAND-SAN ANDRES

TOWNSHIP 8 South				RANGE 35 East				NMFM			
6		5		4		3		2		1	
7		8		9		10		11		12	
18		17		16		15		14		13	
19		20		21		22		23		24	
30		29		28		27		26		25	
31		32		33		34		35		36	

PURPOSE: As stated on preceding page, paragraph (x), Exhibit I  
BTA OIL PRODUCERS - Betts-Sanderson #1 in Unit I of Section 5-8-35. Com-  
pleted in San Andres on February 21, 1963. Top of Perforations 4572'.  
Pool boundary colored in red.  
Proposed pool extension colored in green. SECTION 5: N/2 SE/4

CASE 2812:: (y) EXTENSION OF AN EXISTING OIL POOL

COUNTY ROOSEVELT POOL SOUTH PRAIRIE-PENNSYLVANIAN

TOWNSHIP 8 South RANGE 36 East NM: M

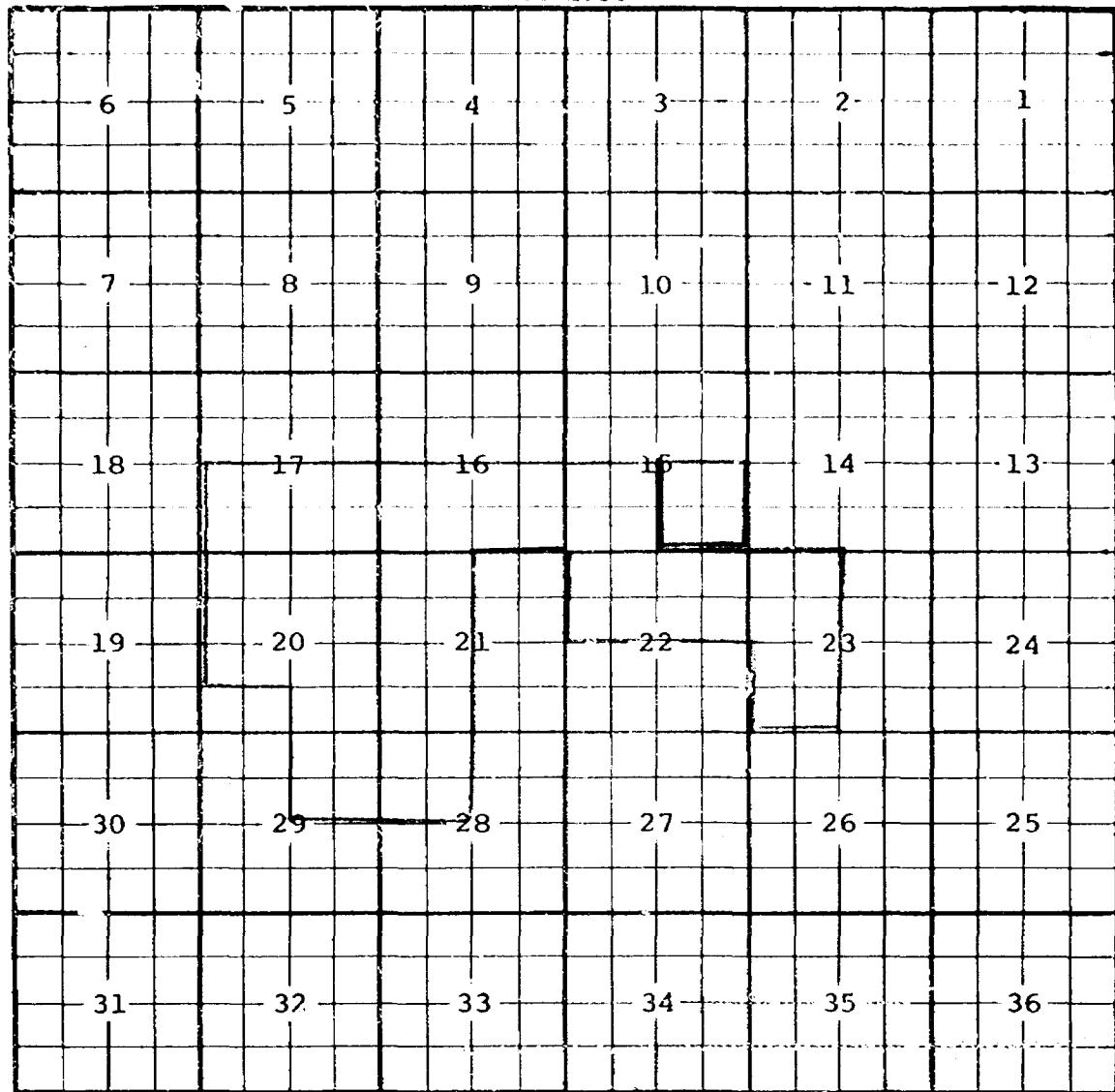

PURPOSE: One completed oil well capable of producing.

MAX PRAY - T. S. Massey #1 in Unit O of Section 15-8-36. Completed in Bough C on February 8, 1963. Top of Perforations 9687'.

Pool boundary colored in red.

Proposed pool extension colored in green. SECTION 15: SE/4

NOMENCLATURE ADVERTISEMENT FOR MAY, 1963

CASE 2812

In the matter of the application of the Oil Conservation Commission of New Mexico upon its own motion for an order for the creation, ~~of new pools~~ in Eddy and Lea Counties, New Mexico, the abolishment of certain ~~existing~~ pools in Eddy County, New Mexico, and extensions of certain ~~existing~~ pools in Chaves, Eddy, Lea, and Roosevelt Counties, New Mexico, and giving notice to all persons and parties interested in the subject matter thereof to appear and show cause why such ~~creations~~, abolishments, and extensions should not be made.

*Construction*

a) CREATE A new pool in Eddy County, New Mexico, classified as a gas pool for Strawn production, designated as the Antelope Sink-Strawn Gas Pool, and described as:

TOWNSHIP 18 SOUTH, RANGE 23 EAST, NMPM  
SECTION 30: All

b) CREATE A new pool in Lea County, New Mexico, classified as an oil pool for Abo production, designated as the Midway-Abo Pool, and described as:

TOWNSHIP 17 SOUTH, RANGE 37 EAST, NMPM  
SECTION 9: S/2  
SECTION 16: NW/4  
SECTION 17: NE/4

c) CREATE A new pool in Eddy County, New Mexico, classified as an oil pool for San Andres production, designated as the Penasco-San Andres Pool, and described as:

TOWNSHIP 18 SOUTH, RANGE 25 EAST, NMPM  
SECTION 25: NW/4

*Contract*

d) ~~ABOLISH~~ the Robinson(Grayburg-San Andres) Pool in Eddy County, New Mexico, *and Lea* by deletion described as: *of following described acreage in Eddy County:*

TOWNSHIP 16 SOUTH, RANGE 31 EAST, NMPM  
SECTION 25: S/2 and S/2 NE/4  
SECTION 35: All  
SECTION 36: All

TOWNSHIP 17 SOUTH, RANGE 31 EAST, NMPM  
SECTION 1: S/2 and E/2 NW/4  
SECTION 2: All  
SECTION 11: E/2 and N/2 NW/4

e) ABOLISH the North Robinson-Queen-Grayburg-San Andres Pool in Eddy County, New Mexico, described as:

TOWNSHIP 16 SOUTH, RANGE 31 EAST, NMPM  
SECTION 24: NE/4

*f)* f) EXTEND the Grayburg-Jackson Pool in Eddy County, New Mexico, to include therein:

TOWNSHIP 16 SOUTH, RANGE 31 EAST, NMPM  
SECTION 24: W/2 SE/4 and SW/4 NE/4  
SECTION 25: S/2 and NE/4  
SECTION 35: All  
SECTION 36: All

TOWNSHIP 17 SOUTH, RANGE 31 EAST, NMPM  
SECTION 1: N/2 and E/2 SE/4  
SECTION 2: All  
SECTION 11: All

*g)* g) EXTEND the Artesia Pool in Eddy County, New Mexico, to include therein:

TOWNSHIP 18 SOUTH, RANGE 28 EAST, NMPM  
SECTION 24: SE/4

No. 14-63

DOCKET: REGULAR HEARING - WEDNESDAY : MAY 15, 1963

OIL CONSERVATION COMMISSION - 9 A.M., ELKS CLUB, 200 NORTH RICHARDSON  
AVENUE, ROSWELL, NEW MEXICO

- ALLOWABLE: (1) Consideration of the oil allowable for June, 1963.
- (2) Consideration of the allowable production of gas for June, 1963, from ten prorated pools in Lea and Eddy Counties, New Mexico, and also presentation of purchasers' nominations for said pools for the six-month period beginning July 1, 1963; consideration of the allowable production of gas from nine prorated pools in San Juan, Rio Arriba and Sandoval Counties, New Mexico for June, 1963.
- CASE 2802: Application of J. R. Cone for a unit agreement, Lea County, New Mexico. Applicant, in the above-styled cause, seeks approval of the Cone Jalmat Yates Pool Unit Area comprising 1,760 acres of State land in Township 22 South, Range 35 East, Lea County, New Mexico.
- CASE 2803: Application of J. R. Cone for a waterflood project, Lea County, New Mexico. Applicant, in the above-styled cause, seeks authority to institute a waterflood project by the injection of water into the Yates formation, Jalmat Pool, through 4 wells located in Units J, L and N of Section 13, and Unit D of Section 24, Township 22 South, Range 35 East, Lea County, New Mexico.
- CASE 2804: Application of John W. Gates for compulsory pooling, Eddy County, New Mexico. Applicant, in the above-styled cause, seeks an order force pooling all mineral interests in the White City-Pennsylvanian Gas Pool underlying all of Section 29, Township 24 South, Range 26 East, Eddy County, New Mexico.
- CASE 2805: Application of Newmont Oil Company for an amendment of Order No. R-2178-B. Applicant, in the above-styled cause, seeks an amendment of Order No. R-2178-B, which order established an administrative procedure for expansion by stages of the Loco Hills Sand Unit Waterflood Project, Eddy County, New Mexico. Said amendment is necessitated by unexpected delay in commencing initial injection in the unit area.
- CASE 2806: Application of Sun Oil Company for compulsory pooling, Lea County, New Mexico. Applicant, in the above-styled cause,

seeks an order force pooling all mineral interests in the Oil-Center Blinebry Pool underlying the W/2 SW/4 of Section 3, Township 21 South, Range 36 East, Lea County, New Mexico.

CASE 2807: In the matter of the hearing called by the Oil Conservation Commission on its own motion to consider a revision of Rule 1301 of the Commission Rules and Regulations to include Grant, Sierra, Hidalgo, and Luna Counties in Oil Conservation Commission District No. 2, headquarters Artesia, New Mexico.

CASE 2808: In the matter of the hearing called by the Oil Conservation Commission on its own motion to consider a revision of Rule 112 of the Commission Rules and Regulations to permit the administrative approval by the Secretary-Director of the Commission of triple completions (conventional).

CASE 2809: In the matter of the hearing called by the Oil Conservation Commission on its own motion to consider a revision of Rule 701-B, 701-C, and 701-E of the Commission Rules and Regulations insofar as said rules relate to the method of making application for hearings or administrative approval for injection or disposal wells.

CASE 2810: In the matter of the hearing called by the Oil Conservation Commission on its own motion to consider the revision of Rule 401 of the Commission Rules and Regulations to require open flow potential tests of natural gas wells upon completion and after workovers only rather than annually as now required.

CASE 2811: In the matter of the hearing called by the Oil Conservation Commission on its own motion to consider the revision of Rule 402 of the Commission Rules and Regulations to require shut-in pressures of natural gas wells annually only rather than semi-annually as now required.

CASE 2812: Southeastern New Mexico nomenclature case calling for an order for the creation, contraction, abolishment, and extension of certain pools in Chaves, Eddy, Lea, and Roosevelt Counties, New Mexico.

(a) Create a new gas pool for Strawn production, designated as the Antelope Sink-Strawn Gas Pool, and described as:

TOWNSHIP 18 SOUTH, RANGE 23 EAST, NMPM  
Section 30: All

- (b) Create a new oil pool for Abo production, designated as the Midway-Abo Pool, and described as:

TOWNSHIP 17 SOUTH, RANGE 37 EAST, NMPM

Section 9: S/2

Section 16: NW/4

Section 17: NE/4

- (c) Create a new oil pool for San Andres production, designated as the Penasco-San Andres Pool, and described as:

TOWNSHIP 18 SOUTH, RANGE 25 EAST, NMPM

Section 25: NW/4

- (d) Contract the Robinson (Grayburg-San Andres) Pool in Eddy and Lea Counties, New Mexico, by deletion of the following-described acreage in Eddy County:

TOWNSHIP 16 SOUTH, RANGE 31 EAST, NMPM

Section 25: S/2 and S/2 NE/4

Section 35: All

Section 36: All

TOWNSHIP 17 SOUTH, RANGE 31 EAST, NMPM

Section 1: S/2 and E/2 NW/4

Section 2: All

Section 11: E/2 and N/2 NW/4

- (e) Abolish the North Robinson-Queen-Grayburg-San Andres Pool in Eddy County, described as:

TOWNSHIP 16 SOUTH, RANGE 31 EAST, NMPM

Section 24: NE/4

- (f) Extend the Grayburg-Jackson Pool to include:

TOWNSHIP 16 SOUTH, RANGE 31 EAST, NMPM

Section 24: W/2 SE/4 and SW/4 NE/4

Section 25: S/2 and NE/4

Section 35: All

Section 36: All

TOWNSHIP 17 SOUTH, RANGE 31 EAST, NMPM

Section 1: N/2 and E/2 SE/4

Section 2: All

Section 11: All

- (g) Extend the Artesia Pool to include:

TOWNSHIP 18 SOUTH, RANGE 28 EAST, NMPM  
Section 24: SE/4

- (h) Extend the Corral Canyon-Delaware Pool to include:

TOWNSHIP 25 SOUTH, RANGE 30 EAST, NMPM  
Section 17: W/2 SW/4  
Section 20: NW/4 NW/4

- (i) Extend the Henshaw-Wolfcamp Pool to include:

TOWNSHIP 16 SOUTH, RANGE 30 EAST, NMPM  
Section 23: SE/4

- (j) Extend the High Lonesome Pool to include:

TOWNSHIP 16 SOUTH, RANGE 29 EAST, NMPM  
Section 20: E/2 E/2

- (k) Extend the Inbe-Pennsylvanian Pool to include:

TOWNSHIP 11 SOUTH, RANGE 34 EAST, NMPM  
Section 18: W/2 NE/4 and NW/4

- (l) Extend the North Justis-Blinebry Pool to include:

TOWNSHIP 25 SOUTH, RANGE 37 EAST, NMPM  
Section 2: S/2 NE/4 and SE/4

- (m) Extend the North Justis-Devonian Pool to include:

TOWNSHIP 25 SOUTH, RANGE 37 EAST, NMPM  
Section 2: SW/4

- (n) Extend the North Justis-Tubb Drinkard Pool to include:

TOWNSHIP 25 SOUTH, RANGE 37 EAST, NMPM  
Section 2: SW/4

- (o) Extend the Pearl-Queen Pool to include:

TOWNSHIP 19 SOUTH, RANGE 34 EAST, NMPM  
Section 36: SE/4

TOWNSHIP 20 SOUTH, RANGE 34 EAST, NMPM  
Section 1: N/2 NE/4

- (p) Extend the Sawyer-San Andres Gas Pool to include:  
TOWNSHIP 9 SOUTH, RANGE 38 EAST, NMPM  
Section 31: SE/4
- (q) Extend the Vacuum-Devonian Pool to include:  
TOWNSHIP 17 SOUTH, RANGE 34 EAST, NMPM  
Section 35: NE/4  
Section 36: NW/4
- (r) Extend the Vacuum-Glorieta Pool to include:  
TOWNSHIP 17 SOUTH, RANGE 34 EAST, NMPM  
Section 36: SW/4
- (s) Extend the Wantz-Abo Pool to include:  
TOWNSHIP 21 SOUTH, RANGE 37 EAST, NMPM  
Section 26: SW/4  
Section 35: W/2  
  
TOWNSHIP 22 SOUTH, RANGE 37 EAST, NMPM  
Section 2: All
- (t) Extend the West Henshaw-Grayburg Pool to include:  
TOWNSHIP 15 SOUTH, RANGE 30 EAST, NMPM  
Section 33: S/2 SE/4  
Section 34: SW/4 SW/4
- (u) Extend the Diablo-San Andres Pool to include:  
TOWNSHIP 10 SOUTH, RANGE 27 EAST, NMPM  
Section 21: NE/4 NE/4  
Section 22: NW/4 NW/4
- (v) Extend the Windmill-San Andres Pool to include:  
TOWNSHIP 15 SOUTH, RANGE 28 EAST, NMPM  
Section 10: W/2 SW/4  
Section 15: NW/4 NW/4
- (w) Extend the West Allison-Pennsylvanian Pool to include:  
TOWNSHIP 8 SOUTH, RANGE 35 EAST, NMPM  
Section 36: NE/4

- (x) Extend the Milnesand-San Andres Pool to include:

TOWNSHIP 8 SOUTH, RANGE 34 EAST, NMPM

Section 1: S/2 SE/4

Section 12: NE/4

Section 24: SW/4

TOWNSHIP 8 SOUTH, RANGE 35 EAST, NMPM

Section 5: N/2 SE/4

- (y) Extend the South Prairie-Pennsylvanian Pool to include:

TOWNSHIP 8 SOUTH, RANGE 36 EAST, NMPM

Section 15: SE/4

CASE 2813:

Northwestern New Mexico nomenclature case calling for an order extending certain existing pools in Rio Arriba, San Juan, and Sandoval Counties, New Mexico.

- (a) Extend the Aztec-Pictured Cliffs Pool to include:

TOWNSHIP 30 NORTH, RANGE 10 WEST, NMPM

Section 14: SW/4

Section 23: N/2

Section 24: NW/4

- (b) Extend the Blanco-Pictured Cliffs Pool to include:

TOWNSHIP 30 NORTH, RANGE 9 WEST, NMPM

Section 20: S/2

- (c) Extend the South Blanco-Pictured Cliffs Pool to include:

TOWNSHIP 23 NORTH, RANGE 2 WEST, NMPM

Section 2: All

Section 3: E/2

Section 11: All

Section 12: W/2

TOWNSHIP 27 NORTH, RANGE 5 WEST, NMPM

Section 34: SW/4

- (d) Extend the Blanco-Mesaverde Pool to include:

TOWNSHIP 32 NORTH, RANGE 5 WEST, NMPM

Partial Section 18: All

Partial Section 19: All

-7-

Docket No. 14-63

- (e) Extend the Puerto Chiquito-Gallup Oil Pool to include:

TOWNSHIP 27 NORTH, RANGE 1 EAST, NMPM  
Section 20: SE/4 SW/4

- (f) Extend the Verde-Gallup Oil Pool to include:

TOWNSHIP 31 NORTH, RANGE 15 WEST, NMPM  
Section 10: SE/4 SW/4

iqg/

BEFORE THE OIL CONSERVATION COMMISSION  
OF THE STATE OF NEW MEXICO

IN THE MATTER OF THE HEARING  
CALLED BY THE OIL CONSERVATION  
COMMISSION OF THE STATE OF  
NEW MEXICO FOR THE PURPOSE  
OF CONSIDERING:

CASE NO. 2812  
ORDER NO. R-2485

THE APPLICATION OF THE OIL  
CONSERVATION COMMISSION UPON  
ITS OWN MOTION FOR AN ORDER  
CREATING, CONTRACTING, ABOLISHING,  
AND EXTENDING CERTAIN POOLS IN  
CHAVES, EDDY, LEA, AND ROOSEVELT  
COUNTIES, NEW MEXICO.

ORDER OF THE COMMISSION

BY THE COMMISSION:

This cause came on for hearing at 9 o'clock a.m., on May 15, 1963, at Roswell, New Mexico, before the Oil Conservation Commission of New Mexico, hereinafter referred to as the "Commission."

NOW, on this 20<sup>th</sup> day of May, 1963, the Commission, a quorum being present, having considered the testimony presented and the exhibits received at said hearing, and being fully advised in the premises,

FINDS:

- (1) That due public notice having been given as required by law, the Commission has jurisdiction of this cause and the subject matter thereof.
- (2) That the proposed creation of a new pool in Section 30, Township 18 South, Range 23 East, Eddy County, New Mexico, for the production of gas from the Strawn (Pennsylvanian) formation should be dismissed pending further study.
- (3) That there is need for the creation of a new pool in Lea County, New Mexico, for the production of oil from the Abo formation, said pool to bear the designation of Midway-Abo Pool. Said Midway-Abo Pool was discovered by Consolidated Oil & Gas Company, Inc., Southern Union State No. 1-16, located in Unit D of Section 16, Township 17 South, Range 37 East, NMPM. It was completed in Abo on October 4, 1962. The top of the perforations is at 8861 feet.

(4) That there is need for the creation of a new pool in Eddy County, New Mexico, for the production of oil from the San Andres formation, said pool to bear the designation of Penasco-San Andres Pool. Said Penasco-San Andres Pool was discovered by Yates Petroleum Corporation, Yates Federal No. 1, located in Unit E of Section 25, Township 18 South, Range 25 East, NMPM. It was completed in San Andres on December 16, 1962. The top of the perforations is at 1382 feet.

(5) That there is need for the consolidation of the Robinson Pool, the North Robinson Queen-Grayburg-San Andres Pool and the Grayburg-Jackson Pool, Eddy County, New Mexico, inasmuch as the pools produce from the same formations, said consolidation to be accomplished by the contraction of the Robinson Pool, abolishment of the North Robinson Queen-Grayburg-San Andres Pool, and extension of the Grayburg-Jackson Pool.

(6) That there is need for certain extensions to the Diablo-San Andres Pool, the West Henshaw-Grayburg Pool, and the Windmill-San Andres Pool, all in Chaves County, New Mexico, the Artesia Pool, the Corral Canyon-Delaware Pool, the Henshaw-Wolfcamp Pool, and the High Lonesome Pool, all in Eddy County, New Mexico, the West Allison-Pennsylvanian Pool, the Milnesand-San Andres Pool, and the South Prairie-Pennsylvanian Pool, all in Roosevelt County, New Mexico, the Inbe-Pennsylvanian Pool, the North Justis-Blinebry Pool, the North Justis-Devonian Pool, the North Justis Tubb-Drinkard Pool, the Pearl-Queen Pool, the Sawyer-San Andres Gas Pool, the Vacuum-Devonian Pool, the Vacuum-Glorieta Pool, and the Wantz-Abo Pool, all in Lea County, New Mexico.

IT IS THEREFORE ORDERED:

(a) That the proposed creation of a new pool in Eddy County, New Mexico, classified as a gas pool for Strawn production, designated as the Antelope Sink-Strawn Gas Pool, consisting of the following-described area:

TOWNSHIP 18 SOUTH, RANGE 23 EAST, NMPM  
SECTION 30: All

is hereby dismissed.

(b) That a new pool in Lea County, New Mexico, classified as an oil pool for Abo production, is hereby created and designated as the Midway-Abo Pool, consisting of the following described area:

-3-

Case No. 2812

Order No. R-2485

TOWNSHIP 17 SOUTH, RANGE 37 EAST, NMPM

SECTION 9: S/2

SECTION 16: NW/4

SECTION 17: NE/4

(c) That a new pool in Eddy County, New Mexico, classified as an oil pool for San Andres production, is hereby created and designated as the Penasco-San Andres Pool, consisting of the following described area:

TOWNSHIP 18 SOUTH, RANGE 25 EAST, NMPM

SECTION 25: NW/4

(d) That the Robinson Pool in Eddy and Lea Counties, New Mexico, as heretofore classified, defined, and described, is hereby contracted by the deletion of the following described area in Eddy County:

TOWNSHIP 16 SOUTH, RANGE 31 EAST, NMPM

SECTION 25: S/2 and S/2 NE/4

SECTION 35: All

SECTION 36: All

TOWNSHIP 17 SOUTH, RANGE 31 EAST, NMPM

SECTION 1: S/2 and W/2 NW/4

SECTION 2: All

SECTION 11: E/2 and N/2 NW/4

(e) That the North Robinson Queen-Grayburg-San Andres Pool in Eddy County, New Mexico, consisting of the following described area:

TOWNSHIP 16 SOUTH, RANGE 31 EAST, NMPM

SECTION 24: NE/4

is hereby abolished.

(f) That the Grayburg-Jackson Pool in Eddy County, New Mexico, as heretofore classified, defined, and described, is hereby extended to include therein:

TOWNSHIP 16 SOUTH, RANGE 31 EAST, NMPM

SECTION 24: W/2 SE/4 and SW/4 NE/4

SECTION 25: S/2 and NE/4

SECTION 35: All

SECTION 36: All

Case No. 2612  
Order No. R-2485

TOWNSHIP 17 SOUTH, RANGE 31 EAST, NMPM  
SECTION 1: N/2 and E/2 SE/4  
SECTION 2: All  
SECTION 11: All

(g) That the Artesia Pool in Eddy County, New Mexico, as heretofore classified, defined, and described, is hereby extended to include therein:

TOWNSHIP 17 SOUTH, RANGE 28 EAST, NMPM  
SECTION 36: NW/4 NW/4

TOWNSHIP 18 SOUTH, RANGE 28 EAST, NMPM  
SECTION 24: SE/4

(h) That the Corral Canyon-Delaware Pool in Eddy County, New Mexico, as heretofore classified, defined, and described, is hereby extended to include therein:

TOWNSHIP 25 SOUTH, RANGE 30 EAST, NMPM  
SECTION 17: W/2 SW/4  
SECTION 20: NW/4 NW/4

(i) That the Henshaw-Wolfcamp Pool in Eddy County, New Mexico, as heretofore classified, defined, and described, is hereby extended to include therein:

TOWNSHIP 16 SOUTH, RANGE 30 EAST, NMPM  
SECTION 23: SE/4

(j) That the High Lonesome Pool in Eddy County, New Mexico, as heretofore classified, defined, and described, is hereby extended to include therein:

TOWNSHIP 16 SOUTH, RANGE 29 EAST, NMPM  
SECTION 20: W/2 E/2

(k) That the Inbe-Pennsylvanian Pool in Lea County, New Mexico, as heretofore classified, defined, and described, is hereby extended to include therein:

TOWNSHIP 11 SOUTH, RANGE 34 EAST, NMPM  
SECTION 7: E/2 SW/4  
SECTION 18: W/2 NE/4 and NW/4

(l) That the North Justis-Blinbry Pool in Lea County, New Mexico, as heretofore classified, defined, and described, is hereby extended to include therein:

-5-

Case No. 2812

Order No. R-2485

TOWNSHIP 24 SOUTH, RANGE 37 EAST, NMPM  
SECTION 36: NW/4

TOWNSHIP 25 SOUTH, RANGE 37 EAST, NMPM  
SECTION 2: S/2 NE/4 and SE/4

(m) That the North Justis-Devonian Pool in Lea County, New Mexico, as heretofore classified, defined, and described, is hereby extended to include therein:

TOWNSHIP 25 SOUTH, RANGE 37 EAST, NMPM  
SECTION 2: SW/4

(n) That the North Justis Tubb-Drinkard Pool in Lea County, New Mexico, as heretofore classified, defined, and described, is hereby extended to include therein:

TOWNSHIP 25 SOUTH, RANGE 37 EAST, NMPM  
SECTION 2: SW/4

(o) That the Pearl-Queen Pool in Lea County, New Mexico, as heretofore classified, defined, and described, is hereby extended to include therein:

TOWNSHIP 19 SOUTH, RANGE 34 EAST, NMPM  
SECTION 36: SE/4

TOWNSHIP 19 SOUTH, RANGE 35 EAST, NMPM  
SECTION 24: SW/4

TOWNSHIP 20 SOUTH, RANGE 34 EAST, NMPM  
SECTION 1: N/2 NE/4

(p) That the Sawyer-San Andres Gas Pool in Lea County, New Mexico, as heretofore classified, defined, and described, is hereby extended to include therein:

TOWNSHIP 9 SOUTH, RANGE 38 EAST, NMPM  
SECTION 31: SE/4

(q) That the Vacuum-Devonian Pool in Lea County, New Mexico, as heretofore classified, defined, and described, is hereby extended to include therein:

TOWNSHIP 17 SOUTH, RANGE 34 EAST, NMPM  
SECTION 25: W/2 SW/4  
SECTION 35: NE/4  
SECTION 36: NW/4

(r) That the Vacuna-Glorieta Pool in Lea County, New Mexico, as heretofore classified, defined, and described, is hereby extended to include therein:

TOWNSHIP 17 SOUTH, RANGE 34 EAST, NMPM  
SECTION 36: SW/4

(s) That the Wantz-Abo Pool in Lea County, New Mexico, as heretofore classified, defined, and described, is hereby extended to include therein:

TOWNSHIP 21 SOUTH, RANGE 37 EAST, NMPM  
SECTION 26: SW/4  
SECTION 35: W/2

TOWNSHIP 22 SOUTH, RANGE 37 EAST, NMPM  
SECTION 2: All

(t) That the West Henshaw-Grayburg Pool in Chaves County, New Mexico, as heretofore classified, defined, and described, is hereby extended to include therein:

TOWNSHIP 15 SOUTH, RANGE 30 EAST, NMPM  
SECTION 33: S/2 SE/4  
SECTION 34: SW/4 SW/4

(u) That the Diablo-San Andres Pool in Chaves County, New Mexico, as heretofore classified, defined, and described, is hereby extended to include therein:

TOWNSHIP 10 SOUTH, RANGE 27 EAST, NMPM  
SECTION 21: NE/4 NE/4  
SECTION 22: NW/4 NW/4

(v) That the Windmill-San Andres Pool in Chaves County, New Mexico, as heretofore classified, defined, and described, is hereby extended to include therein:

TOWNSHIP 15 SOUTH, RANGE 28 EAST, NMPM  
SECTION 10: W/2 SW/4  
SECTION 15: NW/4 NW/4

(w) That the West Allison-Pennsylvanian Pool in Roosevelt County, New Mexico, as heretofore classified, defined, and described, is hereby extended to include therein:

TOWNSHIP 8 SOUTH, RANGE 35 EAST, NMPM  
SECTION 36: NE/4

-7-

Case No. 2812

Order No. R-2495

(x) That the Milnesand-San Andres Pool in Roosevelt County, New Mexico, as heretofore classified, defined, and described, is hereby extended to include therein:

TOWNSHIP 8 SOUTH, RANGE 34 EAST, NMPM

SECTION 1: S/2 SE/4

SECTION 12: NE/4

SECTION 24: SW/4

TOWNSHIP 8 SOUTH, RANGE 35 EAST, NMPM

SECTION 5: N/2 SE/4

(y) That the South Prairie-Pennsylvanian Pool in Roosevelt County, New Mexico, as heretofore classified, defined, and described, is hereby extended to include therein:

TOWNSHIP 8 SOUTH, RANGE 36 EAST, NMPM

SECTION 15: SE/4

IT IS FURTHER ORDERED:

That the effective date of this order and all creations, abolishments, deletions, and extensions included herein shall be June 1, 1963.

DONE at Santa Fe, New Mexico, on the day and year hereinabove designated.

STATE OF NEW MEXICO  
OIL CONSERVATION COMMISSION

*Jack M. Campbell*  
JACK M. CAMPBELL, Chairman

*E. S. Walker*  
E. S. WALKER, Member

*A. L. Porter, Jr.*  
A. L. PORTER, Jr., Member & Secretary

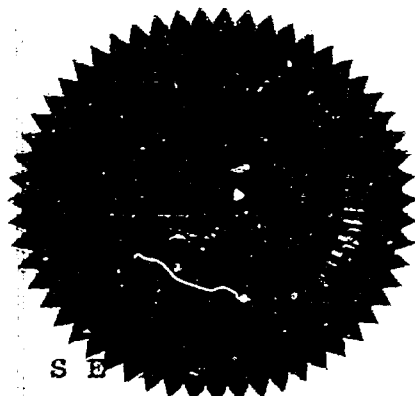

S E

iqg/

*St. James*  
*Post*

May 2, 1941

Oil Conservation Commission  
P. O. Box 100  
Albuquerque, New Mexico

Re: Proposed New Interstate  
District II

Dear John:

My interest in the location of the Inkelone  
Gas-Straw Gas Pool has been aroused, especially by  
the statement of the Inkelone Gas-Straw Gas Pool  
Road and the proposed road. The gas is  
placed in the proposed location at the top  
bearing and the location of the gas is much  
more important as the Inkelone Gas Pool.

Thank,

R. B. Starnes

R. B. Starnes

cc: J. E. Kapteina, Oil Conservation Commission, Santa Fe  
New Mexico.

DEARNLEY-MEIER REPORTING SERVICE, Inc.

FARMINGTON, N. M.  
PHONE 325-1182

SANTA FE, N. M.  
PHONE 983-3971

ALBUQUERQUE, N. M.  
PHONE 243-6691

BEFORE THE  
OIL CONSERVATION COMMISSION  
Roswell, New Mexico  
May 15, 1963

IN THE MATTER OF:

Southeastern New Mexico nomenclature  
case calling for an order for the  
creation, contraction, abolishment,  
and extension of certain pools in  
Chaves, Eddy, Lea, and Roosevelt  
Counties, New Mexico.

Case 2812

BEFORE: Honorable Jack H. Campbell  
Mr. A. L. "Pete" Porter  
Mr. E. S. "Johnny" Walker

TRANSCRIPT OF HEARING

MR. PORTER: We will take up Case 2812.

MR. DURRETT: Southeastern New Mexico nomenclature case  
calling for an order for the creation, contraction, abolishment,  
and extension of certain pools in Chaves, Eddy, Lea, and Roose-  
velt Counties, New Mexico.

If the Commission please, J. H. Durrett, Junior, appearing  
on behalf of the Commission and its staff. I'll have one witness  
in this case I would like to have sworn at this time.

MR. PORTER: Mr. Runyan, will you stand and be sworn.

(Witness sworn.)

JOHN W. RUNYAN

called as a witness, having been first duly sworn, testified as



DEARNLEY-MEIER REPORTING SERVICE, Inc.

FARMINGTON, N. M.  
PHONE 325-1182

SANTA FE, N. M.  
PHONE 983-3971

ALBUQUERQUE, N. M.  
PHONE 243-6691

follows:

DIRECT EXAMINATION

BY MR. DURRITT:

Q Mr. Runyan, will you please state your full name and position for the record?

A John W. Runyan, Geologist, New Mexico Oil Conservation Commission.

Q Are you prepared to recommend to the Commission today that it issue an order creating, contracting, abolishing and extending certain pools in Chaves, Eddy, Lea and Roosevelt Counties, New Mexico, and have you prepared your recommendation in the form of an exhibit?

A Yes, sir.

Q Is that marked Exhibit 1?

A Yes, sir.

(Whereupon, Commission's Exhibit No. 1 was marked for identification.)

Q Is this exhibit similar to the docket in this case that has been prepared and distributed here today?

A Yes, sir, with some exception in certain paragraphs.

Q You have some changes?

A Yes.

Q Would you refer to your exhibit and the docket and set



DEARNLEY-MEIER REPORTING SERVICE, Inc.

FARMINGTON, N. M.  
PHONE 325-1182

SANTA FE, N. M.  
PHONE 983-3971

ALBUQUERQUE, N. M.  
PHONE 243-6691

out the changes that you would like to have made thereon?

A I recommend the proposed creation of the gas pool, called the Antelope Sink-Strawn Gas Pool, be dismissed.

Q While we're on that, Mr. Runyan, before we leave this paragraph, that is paragraph (a) of the docket, is that correct?

A That is correct.

Q Your reason for wanting this dismissed is that you propose to change the name and will want to readvertise this, is that correct?

A That is correct.

Q Would you proceed on?

A Paragraphs (b) through (f) are as advertised.

MR. PORTER: Through (f)?

A (f), yes, sir. Paragraph (g) has an addition of Township 17 South, Range 28 East, Section 36, Northwest Quarter of the Northwest Quarter.

Paragraphs (h) through (j) are as advertised. Paragraph (k) has an addition of Township 11 South, Range 34 East, Section 7, the East Half of the Southwest Quarter. Paragraph (l) has an addition, Township 24 South, Range 37 East, Section 36, Northwest Quarter; Paragraphs (m) and (n) are as advertised.

Paragraph (o) has an addition, Township 19 South, Range 35 East, Section 24, Southwest Quarter. Paragraph (p), as advertised.



DEARNLEY-MEIER REPORTING SERVICE, Inc.

FARMINGTON, N. M.  
PHONE 325-1182

SANTA FE, N. M.  
PHONE 983-3871

ALBUQUERQUE, N. M.  
PHONE 243-6691

(q) has an addition, Township 17 South, Range 34 East, Section 25, the West Half of the Southwest Quarter. The remaining paragraphs, (r) through (y) are as advertised.

Q Was Exhibit 1 prepared by you or under your direct supervision?

A Yes, sir.

MR. DURRETT: If the Commission please, I move the introduction of Exhibit 1 at this time, and simultaneously move the Commission to dismiss paragraph (a) of that exhibit. And that concludes my examination of this witness.

MR. PORTER: Mr. Durrett, does Exhibit 1 show the paragraph to be dismissed, is that noted on the exhibit?

A I believe it is.

MR. DURRETT: I believe it is, Mr. Commissioner.

Q Will you please state for the record, Mr. Runyan, whether or not that is designated on the exhibit that we want to dismiss this paragraph?

A Yes, it is so designated.

MR. PORTER: Does the exhibit also show the changes that were not advertised, Mr. Runyan?

A The additions, yes, sir.

MR. PORTER: The additions. Without objection, this exhibit will be admitted to the record.



(Whereupon, Commission's Exhibit No. 1 was introduced and admitted in evidence.)

MR. PORTER: Does anyone have any statement to make in connection with the Southeast nomenclature case? The Commission will take the case under advisement.

Gentlemen, I believe that concludes our docket. I can't keep from noting the contrast between this hearing and one that we had down here a few years ago. We had about twelve cases this morning which we have concluded in less than two hours and a half. As I recall, we went better than two days and a half on one case previously.

If there is nothing else to come before the Commission, the hearing is adjourned.

DEARNLEY-MEIER REPORTING SERVICE, Inc.

FARMINGTON, N. M.  
PHONE 325-1182

SANTA FE, N. M.  
PHONE 983-3971

ALBUQUERQUE, N. M.  
PHONE 243-6691



DEARNLEY-MEIER REPORTING SERVICE, Inc.

FARMINGTON, N. M.  
PHONE 325-1182

SANTA FE, N. M.  
PHONE 983-3971

ALBUQUERQUE, N. M.  
PHONE 243-6691

STATE OF NEW MEXICO )  
 ) ss  
COUNTY OF BERNALILLO )

I, ADA DEARNLEY, Court Reporter, do hereby certify that the foregoing and attached transcript of proceedings before the New Mexico Oil Conservation Commission at Roswell, New Mexico, is a true and correct record to the best of my knowledge, skill and ability.

IN WITNESS WHEREOF I have affixed my hand and notarial seal this 5th day of June, 1963.

*Ada Dearnley*  
Notary Public-Court Reporter

My commission expires:

June 19, 1963.



BEFORE THE OIL CONSERVATION COMMISSION  
OF THE STATE OF NEW MEXICO

IN THE MATTER OF THE HEARING  
CALLED BY THE OIL CONSERVATION  
COMMISSION OF THE STATE OF  
NEW MEXICO FOR THE PURPOSE  
OF CONSIDERING:

CASE NO. 2812  
ORDER NO. R- 2485

THE APPLICATION OF THE OIL  
CONSERVATION COMMISSION UPON  
ITS OWN MOTION FOR AN ORDER *Contracting*  
CREATING, ~~DELETING~~, ABOLISHING,  
AND EXTENDING CERTAIN POOLS IN  
CHAVES, EDDY, LEA, AND ROOSEVELT  
COUNTIES, NEW MEXICO.

ORDER OF THE COMMISSION

BY THE COMMISSION:

This cause came on for hearing at 9 o'clock a.m. on May 15, 1963,  
at Roswell, New Mexico, before the Oil Conservation Commission of New  
Mexico, hereinafter referred to as the "Commission."

NOW, on this \_\_\_\_\_ day of May, 1963, the Commission, a quorum being  
present, having considered the testimony presented and the exhibits re-  
ceived at said hearing, and being fully advised in the premises,

FINDS:

(1) That due public notice having been given as required by law,  
the Commission has jurisdiction of this cause and subject matter thereof.

*(2) That the proposed creation of a new pool in Section 30,  
Township 18 South, Range 23 East, Eddy County, New Mexico, for  
the production of gas from the Strawn (Pennsylvanian)  
formation should be dismissed pending further study.*

✓ (3) That there is need for the creation of a new pool in Lea County,  
New Mexico, for the production of oil from the Abo formation, said pool to  
bear the designation of Midway-Abo Pool. Said Midway-Abo Pool was dis-  
covered by Consolidated Oil & Gas Company, Inc., Southern Union State No.  
1-16, located in ~~the NW/4~~, Unit D of Section 16, Township 17 South, Range  
37 East, NMPM. It was completed in Abo on October 4, 1962. The top of  
perforations is 8861 feet.

✓ (4) That there is need for the creation of a new pool in Eddy County,  
New Mexico, for the production of oil from the San Andres formation, said  
pool to bear the designation of Penasco-San Andres Pool. Said Penasco-  
San Andres Pool was discovered by Yates Petroleum Corporation, Yates Federal  
No. 1, located in ~~the NW/4~~, Unit E of Section 25, Township 18 South, Range  
25 East, NMPM. It was completed in San Andres on December 16, 1962. The  
top of perforations is 1382 feet.

*(5) That there is need for the consolidation of the Robinson Pool, the  
North Robinson Queen-Grayburg-San Andres Pool and the Grayburg-Jackson  
Pool, Eddy County, New Mexico, inasmuch as the pools produce from the  
same formations, said consolidation to be accomplished by the  
contraction of the Robinson Pool, abolishment of the North Robinson  
Queen-Grayburg-San Andres Pool, and extension of the Grayburg-  
Jackson Pool.*

(6) That there is need for certain extensions to the Diablo-San  
Andres Pool, the West Henshaw-Grayburg Pool, and the Windmill-San Andres  
Pool, all in Chaves County, New Mexico, the Artesia Pool, the Corral Canyon-  
Delaware Pool, ~~the Grayburg-Jackson Pool~~, the Henshaw-Wolfcamp Pool, and  
the High Lonsome Pool, all in Eddy County, New Mexico, the West Allison-  
Pennsylvanian Pool, the Milnesand-San Andres Pool, and the South Prairie-  
Pennsylvanian Pool, all in Roosevelt County, New Mexico, the Inbe-  
Pennsylvanian Pool, the North Justis-Blinbry Pool, the North Justis-

Devonian Pool, the North Justis Tubb-Drinkard Pool, the Pearl-Queen Pool, the Sawyer-San Andres Gas Pool, the Vacuum-Devonian Pool, the Vacuum-Glorieta Pool, and the Wantz-Abo Pool, all in Lea County, New Mexico.

IT IS THEREFORE ORDERED:

(a) *That the proposed creation of a new pool in Eddy County, New Mexico, classified as a gas pool for Strawn production, designated as the Antelope Sink-Strawn Gas Pool, consisting of the following-described area:*

*Township 18 South, Range 23 East, NMPM*

*Section 30: All*

*is hereby dismissed.*

(b) That a new pool in Lea County, New Mexico, classified as an oil pool for Abo production, is hereby created and designated as the Midway-Abo Pool, consisting of the following described area:

TOWNSHIP 17 SOUTH, RANGE 37 EAST, NMPM

SECTION 9: S/2

SECTION 16: NW/4

SECTION 17: NE/4

(c) That a new pool in Eddy County, New Mexico, classified as an oil pool for San Andres production, is hereby created and designated as the Penasco-San Andres Pool, consisting of the following described area:

TOWNSHIP 18 SOUTH, RANGE 25 EAST, NMPM

SECTION 25: NW/4

(d) That the Robinson-~~Grayburg~~/San Andres Pool in Eddy County, New Mexico, as heretofore classified, defined, and described, is hereby contracted by the deletion of the following described area in *Eddy County, and Lea Counties,*

TOWNSHIP 16 SOUTH, RANGE 31 EAST, NMPM

SECTION 25: S/2 and S/2 NE/4

SECTION 35: All

SECTION 36: All

TOWNSHIP 17 SOUTH, RANGE 31 EAST, NMPM

SECTION 1: S/2 and W/2 NW/4

SECTION 2: All

SECTION 11: E/2 and N/2 NW/4

(e) That the North Robinson-Queen-Grayburg-San Andres Pool in Eddy County, New Mexico, consisting of the following described area:

TOWNSHIP 16 SOUTH, RANGE 31 EAST, NMPM

SECTION 24: NE/4

is hereby abolished.

(f) That the Grayburg-Jackson Pool in Eddy County, New Mexico, as heretofore classified, defined, and described, is hereby extended to include therein:

TOWNSHIP 16 SOUTH, RANGE 31 EAST, NMPM

SECTION 24: W/2 SE/4 and SW/4 NE/4

SECTION 25: S/2 and NE/4

SECTION 35: All

SECTION 36: All

TOWNSHIP 17 SOUTH, RANGE 31 EAST, NMPM

SECTION 1: N/2 and E/2 SE/4

SECTION 2: All

SECTION 11: All

(g) That the Artesia Pool in Eddy County, New Mexico, as heretofore classified, defined, and described, is hereby extended to include therein:

TOWNSHIP 17 SOUTH, RANGE 28 EAST, NMPM

SECTION 36: NW/4 NW/4

TOWNSHIP 18 SOUTH, RANGE 28 EAST, NMPM

SECTION 24: SE/4

(h) That the Corral Canyon-Delaware Pool in Eddy County, New Mexico, as heretofore classified, defined, and described, is hereby extended to include therein:

✓ TOWNSHIP 25 SOUTH, RANGE 30 EAST, NMPM  
SECTION 17: W/2 SW/4  
SECTION 20: NW/4 NW/4

(i) That the Henshaw-Wolfcamp Pool in Eddy County, New Mexico, as heretofore classified, defined, and described, is hereby extended to include therein:

✓ TOWNSHIP 16 SOUTH, RANGE 30 EAST, NMPM  
SECTION 23: SE/4

(j) That the High Lonesome Pool in Eddy County, New Mexico, as heretofore classified, defined, and described, is hereby extended to include therein:

✓ TOWNSHIP 16 SOUTH, RANGE 29 EAST, NMPM  
SECTION 20: W/2 E/2

(k) That the Inbe-Pennsylvanian Pool in Lea County, New Mexico, as heretofore classified, defined, and described, is hereby extended to include therein:

✓ TOWNSHIP 11 SOUTH, RANGE 34 EAST, NMPM  
SECTION 7: E/2 SW/4  
SECTION 18: W/2 NE/4 and NW/4

(l) That the North Justis-Blaine Pool in Lea County, New Mexico, as heretofore classified, defined, and described, is hereby extended to include therein:

✓ TOWNSHIP 24 SOUTH, RANGE 37 EAST, NMPM  
SECTION 36: NW/4

✓ TOWNSHIP 20 SOUTH, RANGE 37 EAST, NMPM  
SECTION 2: S/2 NE/4 and SE/4

(m) That the North Justis-Devonian Pool in Lea County, New Mexico, as heretofore classified, defined, and described, is hereby extended to include therein:

✓ TOWNSHIP 25 SOUTH, RANGE 37 EAST, NMPM  
SECTION 2: SW/4

(n) That the North Justis-Tubb-Drinkard Pool in Lea County, New Mexico, as heretofore classified, defined, and described, is hereby extended to include therein:

✓ TOWNSHIP 25 SOUTH, RANGE 37 EAST, NMPM  
SECTION 2: SW/4

(o) That the Pearl-Queen Pool in Lea County, New Mexico, as heretofore classified, defined, and described, is hereby extended to include therein:

✓ TOWNSHIP 19 SOUTH, RANGE 34 EAST, NMPM  
SECTION 36: SE/4

✓ TOWNSHIP 19 SOUTH, RANGE 35 EAST, NMPM  
SECTION 24: SW/4

✓ TOWNSHIP 20 SOUTH, RANGE 34 EAST, NMPM  
SECTION 1: N/2 NE/4

(p) That the Sawyer-San Andres Gas Pool in Lea County, New Mexico, as heretofore classified, defined, and described, is hereby extended to include therein:

✓ TOWNSHIP 9 SOUTH, RANGE 38 EAST, NMPM  
SECTION 31: SE/4

(q) That the Vacuum-Devonian Pool in Lea County, New Mexico, as heretofore classified, defined, and described, is hereby extended to

include therein:

✓ TOWNSHIP 17 SOUTH, RANGE 34 EAST, NMPM  
SECTION 25: W/2 SW/4  
SECTION 35: NE/4  
SECTION 36: NW/4

(r) That the Vacuum-Glorieta Pool in Lea County, New Mexico, as heretofore classified, defined, and described, is hereby extended to include therein:

✓ TOWNSHIP 17 SOUTH, RANGE 34 EAST, NMPM  
SECTION 36: SW/4

(s) That the Wantz-Abo Pool in Lea County, New Mexico, as heretofore classified, defined, and described, is hereby extended to include therein:

✓ TOWNSHIP 21 SOUTH, RANGE 37 EAST, NMPM  
SECTION 26: SW/4  
SECTION 35: W/2

✓ TOWNSHIP 22 SOUTH, RANGE 37 EAST, NMPM  
SECTION 2: All

(t) That the West Henshaw-Grayburg Pool in Chaves County, New Mexico, as heretofore classified, defined, and described, is hereby extended to include therein:

✓ TOWNSHIP 15 SOUTH, RANGE 30 EAST, NMPM  
SECTION 33: S/2 SE/4  
SECTION 34: SW/4 SW/4

(u) That the Diablo-San Andres Pool in Chaves County, New Mexico, as heretofore classified, defined, and described, is hereby extended to include therein:

✓ TOWNSHIP 10 SOUTH, RANGE 27 EAST, NMPM  
SECTION 21: NE/4 NE/4  
SECTION 22: NW/4 NW/4

(v) That the Windmill-San Andres Pool in Chaves County, New Mexico, as heretofore classified, defined, and described, is hereby extended to include therein:

✓ TOWNSHIP 15 SOUTH, RANGE 28 EAST, NMPM  
SECTION 10: W/2 SW/4  
SECTION 15: NW/4 NW/4

(w) That the West Allison-Pennsylvanian Pool in Roosevelt County, New Mexico, as heretofore classified, defined, and described, is hereby extended to include therein:

✓ TOWNSHIP 8 SOUTH, RANGE 35 EAST, NMPM  
SECTION 36: NE/4

(x) That the Milnesand-San Andres Pool in Roosevelt County, New Mexico, as heretofore classified, defined, and described, is hereby extended to include therein:

✓ TOWNSHIP 8 SOUTH, RANGE 34 EAST, NMPM  
SECTION 1: S/2 SE/4  
SECTION 12: NE/4  
SECTION 24: SW/4

✓ TOWNSHIP 8 SOUTH, RANGE 35 EAST, NMPM  
SECTION 5: N/2 SE/4

(y) That the South Prairie-Pennsylvanian Pool in Roosevelt County, New Mexico, as heretofore classified, defined, and described, is hereby extended to include therein:

✓ TOWNSHIP 8 SOUTH, RANGE 36 EAST, NMPM  
SECTION 15: SE/4

-5-  
CASE NO. 2812  
ORDER NO. \_\_\_\_\_

IT IS FURTHER ORDERED:

That the effective date of this order and all creations, abolishments, deletions, and extensions included herein shall be June 1, 1963.

DONE at Roswell, New Mexico, on the day and year hereinabove designated.

STATE OF NEW MEXICO  
OIL CONSERVATION COMMISSION

JACK M. CAMPBELL, Chairman

E. S. Walker, Member

A. L. Porter, Jr., Member & Secretary

S E A L