

CASE 3494: Application of TEXACO
- for a non-standard gas well
location, Lea County, N. Mex.

CASE No.
3494

Application,
TRANSCRIPTS,
SMALL Exhibits
ETC.

State of New Mexico
Oil Conservation Commission



STATE GEOLOGIST
A. L. PORTER, JR.
SECRETARY - DIRECTOR

TEXACO INC.

OTHER

BEFORE THE OIL CONSERVATION COMMISSION
OF THE STATE OF NEW MEXICO

IN THE MATTER OF THE HEARING
CALLED BY THE OIL CONSERVATION
COMMISSION OF NEW MEXICO FOR
THE PURPOSE OF CONSIDERING:

CASE No. 3494
Order No. R-3158

APPLICATION OF TEXACO INC.
FOR A NON-STANDARD GAS WELL
LOCATION, LEA COUNTY, NEW
MEXICO.

ORDER OF THE COMMISSION

BY THE COMMISSION:

This cause came on for hearing at 9 a.m. on November 30, 1966, at Santa Fe, New Mexico, before Examiner Daniel S. Nutter.

NOW, on this 6th day of December, 1966, the Commission, a quorum being present, having considered the testimony, the record, and the recommendations of the Examiner, and being fully advised in the premises,

FINDS:

(1) That due public notice having been given as required by law, the Commission has jurisdiction of this cause and the subject matter thereof.

(2) That the applicant, Texaco Inc., seeks approval of an unorthodox location for its Cotton Draw Unit Well No. 64, located 660 feet from the North line and 1652 feet from the West line of Section 18, Township 25 South, Range 32 East, NMPM, undesignated Devonian gas pool, Lea County, New Mexico.

(3) That the subject well was drilled at the above-described non-standard location inadvertently.

(4) That approval of the subject application will prevent waste and will not violate correlative rights.

-2-

CASE No. 3494

Order No. R-3158

IT IS THEREFORE ORDERED:

(1) That an unorthodox location is hereby approved for the Texaco Cotton Draw Unit Well No. 64, located 660 feet from the North line and 1652 feet from the West line of Section 18, Township 25 South, Range 32 East, NMPM, undesignated Devonian gas pool, Lea County, New Mexico.

(2) That jurisdiction of this cause is retained for the entry of such further orders as the Commission may deem necessary.

DONE at Santa Fe, New Mexico, on the day and year hereinabove designated.

STATE OF NEW MEXICO
OIL CONSERVATION COMMISSION

JACK M. CAMPBELL, Chairman

GUYTON B. HAYS, Member

A. L. PORTER, Jr., Member & Secretary

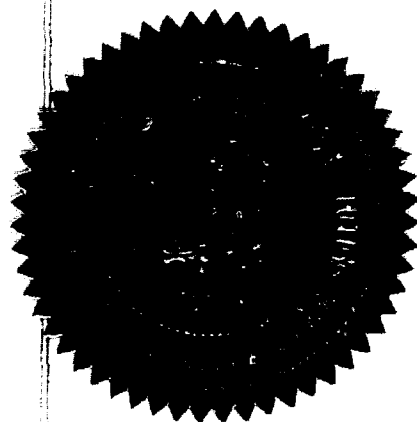

esr/

OIL CONSERVATION COMMISSION
SANTA FE, NEW MEXICO

Date 12/2/64

CASE 3494

Hearing Date 9am 11/30/66
DSN/DSF

My recommendations for an order in the above numbered cases are as follows:

Enter an order approving
the man-std loc of Texas
Cotton Drow Unit Well No 64
as a Devonian Gas Well 660'
FNL & 1652' FWL of Sec
18 T 25S R³²~~33~~E Lea Co, N. Mex.
The well has the N/2 of said Sec
18 dedicated to it.

Approval will prevent waste
and will not violate correla-
tive rights.

San Antonio

DOCKET: EXAMINER HEARING - WEDNESDAY - NOVEMBER 30, 1966

9 A.M. - OIL CONSERVATION COMMISSION CONFERENCE ROOM,
STATE LAND OFFICE BUILDING - SANTA FE, NEW MEXICO

The following cases will be heard before Daniel S. Nutter, Examiner, or Elvis A. Utz, Alternate Examiner:

CASE 3492: Application of Midwest Oil Corporation for special pool rules, Lea County, New Mexico. Applicant, in the above-styled cause, seeks the promulgation of special pool rules for the Cinta Roja-Morrow Gas Pool, Lea County, New Mexico, including a provision for 640-acre proration units.

CASE 3493: Application of H. N. Sweeney for a unit agreement, Eddy County, New Mexico. Applicant, in the above-styled cause, seeks approval of its Hale Unit Area comprising 1920 acres, more or less, of Federal, State and Fee lands in Township 20 South, Range 30 East, Eddy County, New Mexico.

CASE 3494: Application of Texaco Inc. for a non-standard gas well location, Lea County, New Mexico. Applicant, in the above-styled cause, seeks approval of its Cotton Draw Unit Well No. 64 at an unorthodox gas well location 660 feet from the North line and 1652 feet from the West line of Section 18, Township 25 South, Range 32 East, in an undesignated Devonian gas pool, Lea County, New Mexico.

CASE 3495: Application of Burleson & Huff for a non-standard proration unit and a non-standard location, Lea County, New Mexico. Applicant, in the above-styled cause, seeks the approval of a 50.30-acre non-standard oil proration unit comprising all of Lot 3, Section 2, Township 16 South, Range 32 East, North Anderson Ranch-Wolfcamp Pool, Lea County, New Mexico, to be dedicated to a well to be drilled at a non-standard location for said pool 390 feet from the North line and 330 feet from the East line of said Lot 3.

CASE 3496: Application of Newmont Oil Company for a waterflood expansion, Eddy County, New Mexico. Applicant, in the above-styled cause, seeks authority to expand its West Square Lake Waterflood Project, Square Lake Pool, by the conversion to water injection of its Continental State Well No. 1, located 1980 feet from the North line and 1990 feet from the West line of Section 36, Township 16 South, Range 30 East, Eddy County, New Mexico.

CASE 3497: Application of Me-Tex Supply Company for a non-standard gas proration unit and a non-standard gas well location, Lea County, New Mexico. Applicant, in the above-styled cause, seeks the approval of a non-standard gas proration unit comprising Lots 5, 6, 11, 12, 13, and 14 of Section 3, Township 21 South, Range

(Case 3497 continued)

36 East, Eumont Gas Pool, Lea County, New Mexico, to be dedicated to its Wallace State Well No. 3 located at an unorthodox location 3,300 feet from the South line and 1980 feet from the West line of said Section 3. Applicant further seeks the assignment to said proration unit of the accumulated underproduction presently carried by its Wallace State Well No. 2 located in Unit L of said Section 3, said well currently being dedicated to a 160-acre non-standard gas proration unit comprising Lots 5, 6, 11, and 12 of said Section 3, and also the assignment to said unit of the accumulated underproduction presently carried by the aforesaid Wallace State Well No. 3, said well currently being dedicated to an 80-acre non-standard proration unit comprising Lots 13 and 14 of said Section 3.

CASE 3498: Application of Pan American Petroleum Corporation for a pressure maintenance project, San Juan County, New Mexico. Applicant, in the above-styled cause, seeks authority to institute a pressure maintenance project in the Piñon Gallup Oil Pool by the injection of water into the Gallup formation through five wells located in Section 19, Township 28 North, Range 11 West and Sections 14, 15, and 24, Township 28 North, Range 12 West, San Juan County, New Mexico. Applicant further seeks the promulgation of special rules for the operation of said project.

CASE 3499: Application of Pan American Petroleum Corporation for pressure interference tests, Chaves County, New Mexico. Applicant, in the above-styled cause, seeks authority to conduct a pressure interference test in the Cato-San Andres Pool, Chaves County, New Mexico, by shutting in a number of its wells in said pool and producing its Baskett "D" Well No. 1 located in Unit G, Section 11, Township 8 South, Range 30 East, Chaves County, New Mexico. Applicant also seeks authority to transfer the allowable from other wells on said Baskett "D" lease to Well No. 1, to temporarily overproduce said lease, and to make-up the overproduction at the conclusion of the test period by curtailment of wells on said lease. Applicant further seeks authority to accumulate underproduction on any lease where wells will be shut-in, for production upon conclusion of the interference tests.

TEXACO
INC.

PETROLEUM PRODUCTS



DOMESTIC PRODUCING DEPARTMENT
MIDLAND DIVISION

P. O. BOX 3109
MIDLAND, TEXAS 79704

October 25, 1966

APPLICATION FOR HEARING
NON-STANDARD GAS WELL LOCATION
LEA COUNTY, NEW MEXICO

New Mexico Oil
Conservation Commission
P. O. Box 2088
Santa Fe, New Mexico

Attn: Mr. A. L. Porter, Jr.

Gentlemen:

It is respectfully requested that an examiner hearing be scheduled in Santa Fe, New Mexico on the next regularly scheduled hearing date to consider the application of Texaco Inc. for a non-standard location for Texaco's Cotton Draw Unit Well No. 64 in Lea County, New Mexico. At this hearing the applicant will seek an order granting exception to the wildcat gas well location requirements set out in Statewide Rule 104. B.I.(a).

Texaco's Cotton Draw Unit Well No. 64, for which this application is being made, is located as shown by the attached plat 660' FNL and 1652' FWL of Section 18, T-25-S, R-32-E, Lea County, New Mexico. The N/2 of Section 18, comprising 320 acres, has been dedicated to this well. This well was drilled within an initial Devonian participating area covering 2558.64 acres, being described as all of Sections 12 and 13, T-25-S, R-31-E, and all of Sections 7 and 18, T-25-S, R-32-E, Lea County, New Mexico, between the depths of 16,490' and 16,537'. The working interest of the entire initial Devonian participating area is owned 50% by Texaco Inc. and 50% by Pauley Petroleum, Inc. with Texaco Inc. being the operator. All of the royalty interest is owned by the United States Government. The nearest producing wells are those wells two miles east in the Paducah (Delaware) Field. From this it is seen that there are no offset operators to the applicant's well and that the ownership of the entire initial Devonian participating area is common.

DOCKET MAILED

Date 11-18-66

-2-

The subject well was completed as a discovery gas well in the Devonian formation May 19, 1966. On October 22, 1966 the well was connected to the gas purchaser and production commenced. The well produces from a Devonian interval in an open hole section from the bottom of a 7-5/8" OD liner set at 16,492' to total depth of 16,537'.

A copy of this application for hearing is being sent to the State of New Mexico who approved the initial participating area June 30, 1966 and a copy is being sent to the U. S. Geological Survey who approved the initial participating area August 5, 1966.

Yours very truly,

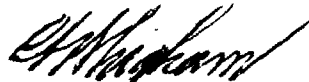

C. L. Whigham
Division Proration Engineer

CLW:jl
Attach.

cc: Commissioner of Public Lands

U. S. Geological Survey

New Mexico Oil Conservation Commission (Hobbs)

dearnley-meier reporting company, inc.

SPECIALIZING IN: DEPOSITIONS, HEARINGS, STATEMENTS, EXPERT TESTIMONY, DAILY COPY, CONVENTIONS

1120 SIMAS BLDG. • P. O. BOX 1092 • PHONE 243-6691 • ALBUQUERQUE, NEW MEXICO



BEFORE THE NEW MEXICO
OIL CONSERVATION COMMISSION
SANTA FE, NEW MEXICO
November 30, 1966

EXAMINER HEARING

In the matter of:

Application of Texaco, Inc., for
a nonstandard gas well location,
Lea County, New Mexico,

CASE NUMBER
3494

BEFORE:

DANIEL S. NUTTER, Examiner

TRANSCRIPT OF HEARING

MR. HATCH: Case 3494. Application of Texaco Inc., for a nonstandard gas well location, Lea County, New Mexico.

MR. KELLY: Booker Kelly of White, Gilbert, Koke and Kelly, Santa Fe, New Mexico. On behalf of the applicant I have one witness and ask that he be sworn.

(Witness sworn)

EDWIN DALE MCCARTER, called as a witness on behalf of the applicant, having first been duly sworn, was examined as follows:

DIRECT EXAMINATION

BY MR. KELLY:

Q Would you state your name and position and employer, please?

A I am Edwin Dale McCarter. I am currently District Proration Engineer for Texaco Incorporated at Hobbs, New Mexico.

Q Had you previously testified as an expert witness before this Commission?

A No, I have not.

Q Would you briefly state your qualifications for the Examiner?

A I graduated from Louisiana State University in 1961 with a degree of Bachelor of Science in Petroleum Engineering. Upon graduation, I commenced employment with Texaco at Pampa, Texas. I have served in various capacities

within the Petroleum Engineering Department of Texaco and as stated before, I now serve as District Proration Engineer, Hobbs, New Mexico.

Q And as part of your duties, are you familiar with the application and the subject well?

A Yes, sir. I am.

MR. KELLY: Are the witness' qualifications acceptable?

MR. NUTTER: They are.

(Whereupon, Applicants Exhibits 1 through 3 marked for identification)

Q (By Mr. Kelly) Would you briefly state what Texaco seeks by this application, referring to what has been marked as Exhibit No. 1?

A Texaco seeks the Commission approval of the non-standard location of the wildcat gas well, being their Cotton Draw Unit Well No. 64, located 660 feet from the north line and 1652 feet from the West Line Section 18, Township 25 South, Range 32 East.

Q What is the location of this well in the extent of deviation?

A This well -- the orthodox location for this well, would be 1980 from the West Line and 660 from the North Line. It's deviation is 328 feet West from the standard location.

dearnley-meier

SPECIALIZING IN: DEPOSITIONS, HEARINGS, STATEMENTS, EXPERT TESTIMONY, DAILY COPY, CONVENTIONS

1120 SIMMS BLDG. • P.O. BOX 1092 • PHONE 243-6691 • ALBUQUERQUE, NEW MEXICO 87101
1203 FIRST NATIONAL BANK EAST • PHONE 256-1294 • ALBUQUERQUE, NEW MEXICO 87108



PAGE 4

Referring to Exhibit -- is this 1?

Q Yes.

A You will notice in Section 18 that Number 64 has been designated as a gas well symbol. The standard location is indicated immediately to its right.

Q Just a plain circle?

A Just a plain circle

Q Now referring to what has been marked as Exhibit No. 2, which is the Form C-102, which was furnished by Texaco to the Commission, would you explain how this area arose or the non-standard location arose?

A This is an approved application of permit to drill to the U.S.G.S. along with the Form C-102, attached New Mexico Conservation and Commission Form C-102, indicating the dedicated acreage. The dedicated acreage, is also indicated on the form 9331-C of the U.S.G.S. as a hundred and sixty acres. This location was staked or picked in error at its conception by the erroneous thought that 160 acres would be assigned to the well. If 160 acres would have been assigned to the well, it would have been an orthodox location

Q Actually 320 is the state-wide unit for wells of this depth. Is that correct?

A Yes, sir. Being Pennsylvania age or older, it was designated as a Devonian Wildcat location.

Q So it was merely an initial mistake that the well was set on patterns for 160, but 160 was not the proper spacing?

A Yes, sir.

Q Now, what is the present status of the well?

A The well is currently producing under the authorization of the Commission, under the temporary allowable to land owner incorporated gasoline and this sale actually commenced full time here, I think, last Friday.

Q Now how was this mistake caught?

A This mistake was caught by the New Mexico Oil Conservation Commission, Hobbs District Office.

C Q And as a result that was after the well was completed, is that right?

A Yes, sir.

Q (By Mr. Kelly) And as a result of that, you did file another Form C-102 which is marked Exhibit No. 3. Is that right?

A Yes, sir. To correct the dedicated acreage and also at that time we made application for a hearing for an unorthodox location.

Q Now, referring back to Exhibit No. 1, would you explain the situation as far as the acreage that is dedicated to the well and its surrounding acreage?

A The acreage dedicated to the well, currently is the

North half of Section 18. The participating area for drilling the well is comprised of Sections 7 and 18 of Township 25, South 32, East; Section 12 and 13 of Township 25, South, Range 3], East. This participating area being approved by the Commission, State Land Office and the U.S.G.S.

Q And Texaco is the operator of the Unit?

A Texaco is the operator. The Exhibit 1 designates who owns the acreage on all tracts within the entire Cotton Draw Unit Boundary, designated in the lower right-hand corner of each tract, the tract number. As can be seen from this Exhibit, the Texaco and Polly, each own Fifty percent of the acreage inside the entire participating area of the Devonion prospect.

Q So the position of the actual well would not affect correlative rights since the operator and owners are the same?

A That is correct.

Q Now, was there any -- would there be any geological or other reason for this location other than the area that you have testified to?

A No, sir, I am sure seismic was used to determine the structure and it was located near the crest although I don't think 328 feet would have made much difference.

Q What is the capacity of this well?

A It's potentialled for 92 million cubic feet a day.

That is at open flow.

Q In your opinion, would the granting of this application have any affect on correlative rights?

A No, sir.

Q Was Exhibit No. 1 prepared by you or under your supervision?

A Yes, sir.

Q Exhibit 2 and 3 are the Form C-102 which was furnished to the Commission by Texaco?

A Yes.

MR. KELLY: We move the introduction of the Exhibits.

MR. NUTTER: Texaco's Exhibits 1, 2 and 3 will be admitted in evidence.

(Whereupon, Applicant's Exhibits
1 through 3 admitted in evidence.)

MR. KELLY: That's all we have on Direct.

CROSS EXAMINATION

BY MR. NUTTER:

Q Is your name McCarter?

A McCarter.

Q Mr. McCarter, I noticed the other day **someplace**, that a second well was being drilled in this pool. What is the location of that well?

A This well is located 1980 from the north and East

dearnley-meier

SPECIALIZING IN: DEPOSITIONS, HEARINGS, STATEMENTS, EXPERT TESTIMONY, DAILY COPY, CONVENTIONS
1120 SIMMS BLDG. • P.O. BOX 1092 • PHONE 243-6691 • ALBUQUERQUE, NEW MEXICO 87101
1205 FIRST NATIONAL BANK EAST • PHONE 256-1294 • ALBUQUERQUE, NEW MEXICO 87108

PAGE 8

lines of Section 2 Township 25, South, 31, East. It is so designated by a small circle in No. 65.

Q I see. It might interest you to note or to know that we have noticed quite a few publicity items regarding this well put out by Polly Petroleum Company?

A Yes sir.

Q I noticed the other day, that you had contracted to sell 265 billion dollars worth of gas from this well. It may have been a typographical error?

A Polly released that.

MR. NUTTER: Are there any further questions of Mr. McCarter? He may be excused.

(Witness excused)

MR. NUTTER: Do you have anything further Mr. Kelly?

MR. KELLY: No.

Mr. Nutter: Does anyone have anything they wish to offer in Case 3494? We will take the case under advisement and call a fifteen minute recess.

dearnley-meier reporting service, inc.

SPECIALIZING IN: DEPOSITIONS, HEARINGS, STATEMENTS, EXPERT TESTIMONY, DAILY COPY, CONVENTIONS

1120 SIMMS BLDG. • P.O. BOX 1092 • PHONE 243-6691 • ALBUQUERQUE, NEW MEXICO 87101
1205 FIRST NATIONAL BANK EAST • PHONE 256-1294 • ALBUQUERQUE, NEW MEXICO 87108

STATE OF NEW MEXICO)
) ss
COUNTY OF BERNALILLO)

I, JERRY POTTS, Notary Public in and for the County of Bernalillo, State of New Mexico, do hereby certify that the foregoing and attached transcript of hearing was reported by me in stenotype and that the same was reduced to typewritten transcript under my personal supervision and contains a true and correct record of said proceedings, to the best of my knowledge, skill and ability.

NOTARY PUBLIC

My Commission Expires:

July 10, 1970

I do hereby certify that the foregoing is a complete record of the proceedings in the Examiner hearing of Case No. 3494 heard by us on 11/30, 1966.

Examiner
New Mexico Oil Conservation Commission

UNITED STATES
DEPARTMENT OF THE INTERIOR
GEOLOGICAL SURVEY

APPLICATION FOR PERMIT TO DRILL, DEEPEN, OR PLUG BACK

1a. TYPE OF WORK DRILL <input checked="" type="checkbox"/> DEEPEN <input type="checkbox"/> PLUG BACK <input type="checkbox"/>			4. LEASE DESIGNATION AND SERIAL NO. LC-061873-A		
b. TYPE OF WELL OIL WELL <input type="checkbox"/> GAS WELL <input checked="" type="checkbox"/> OTHER <input type="checkbox"/> SINGLE ZONE <input checked="" type="checkbox"/> MULTIPLE ZONE <input type="checkbox"/>			5. IF INDIAN, ALLOTTEE OR TRIBE NAME -----		
2. NAME OF OPERATOR Texaco Inc.			7. UNIT AGREEMENT NAME -----		
3. ADDRESS OF OPERATOR P.O. Box 3109, Midland, Texas			8. FARM OR LEASE NAME Cotton Draw Unit		
6. LOCATION OF WELL (Report location clearly and in accordance with any State requirements.) At surface 660' FNL & 1652' FWL, Sec. 18 At proposed prod. zone			9. WELL NO. 64		
14. DISTANCE IN MILES AND DIRECTION FROM NEAREST TOWN OR POST OFFICE 21 miles Southeast of Malaga, New Mexico			10. FIELD AND POOL, OR WILDCAT Rank Wildcat - Devonian		
16. DISTANCE FROM PROPOSED LOCATION TO NEAREST PROPERTY OR LEASE LINE, FT. (Also to nearest drg. unit line, if any) 660'			11. SEC., T., R., M., OR S.W. 1/4 AND SURVEY OR AREA Sec. 18, T25S-R32E		
18. DISTANCE FROM PROPOSED LOCATION TO NEAREST WELL, DRILLING, COMPLETED, OR APPLIED FOR, ON THIS LEASE, FT. 10,625'			12. COUNTY OR PARISH 13. STATE Lea New Mexico		
20. NO. OF ACRES IN LEASE 35,144.36			17. NO. OF ACRES ASSIGNED TO THIS WELL 160		
21. ELEVATIONS (Show whether DF, RT, OR, etc.) Not Available			19. PROPOSED DEPTH 17,500'		
22. APPROX. DATE WORK WILL START At once			20. ROTARY OR CABLE TOOLS Rotary		

23. PROPOSED CASING AND CEMENTING PROGRAM

SIZE OF HOLE	SIZE OF CASING	WEIGHT PER FOOT	SETTING DEPTH	QUANTITY OF CEMENT
26"	20"	94#	800'	1600* Cement will be circu-
17 1/2"	13 3/8"	54.5# 61# 68#	2# 4425'	4800** lated on all casing-
12 1/4"	10 3/4"	53.5#	12900'	3900*** string. A caliper will
8 3/8"	7 5/8" liner	39#	12000'-16100'	800**** be run & 25% excess
6 1/2"	5" liner	18#	15500'-17500'	500***** cement will be used.
Set tie-back from	7"	26#	0'-12000'	1200*****
0 to 15500'	5 1/2"	20#	12000'-15500'	

*Cement w/1200 sx class "C", 8% gel followed by 400 sx Class "C" neat. Exact volume fm caliper survey. Use 20% excess. **Cement w/4200 sx TLW 12.44#/gal 95% wtr. followed by 600 sx class "C" neat. Set DV tools at 7500' & 4000'. ***Cement with 900 sx TLW 12.2#/gal w/1/4# Flocele & Retarder & FL additive + 1000 sx Trinity Inferno 16.47#/gal; 1000 sx TLW 12.2#/gal w/1/4# Flocele & FL additive; 1000 sx TLW 12.44#/gal 95% wtr. ****Cement with 800 sx Trinity Inferno 16.25#/gal (vol. from Caliper) 25% excess. *****Cement with 500 sx Trinity Inferno 16.25#/gal. *****Cement w/900 sx Class "C" 4% gel followed by 300 sx Trinity Inferno. COMPLETION PROGRAM: Selectively perf. after analysis of bottom hole conditions.

IN ABOVE SPACE DESCRIBE PROPOSED PROGRAM: If proposal is to deepen or plug back, give data on present productive zone and proposed new productive zone. If proposal is to drill or deepen directionally, give pertinent data on subsurface locations and measured and true vertical depths. Give blowout preventer program, if any.

24. SIGNED T. G. Landwermer TITLE Civil Engineer DATE 9/13/65
(This space for Federal or State office use)

PERMIT NO. _____ APPROVAL DATE _____

APPROVED BY _____ TITLE _____ DATE _____
CONDITIONS OF APPROVAL, IF ANY: _____

FORMATION TOPS EXPECTED			
Delaware Sand	4450'	Dean Wolfcamp	11,350'
Cherry Canyon	5350'	Strawn	13,880'
Bone Spring	8350'	Morrow Clastic	14,900'
		Lower Miss.	16,100'
		Devonian	16,480'
		Total Depth	17,500'

*See Instructions On Reverse Side

APPROVED

9/15/65

BEFORE EXAMINER NUTTER

OIL CONSERVATION COMMISSION

EXHIBIT NO. 2

CASE NO. 2100

**NEW MEXICO OIL CONSERVATION COMMISSION
WELL LOCATION AND ACREAGE DEDICATION PLAT**

Form C-102
Superseded C-128
Effective 1-1-65

All distances must be from the outer boundaries of the Section.

Operator TEXACO Inc.			Lease Cotton Draw Unit		Well No. 64
Unit No. C	Section 18	Township 25 S	Range 32 E	County Lea	
Actual Outcrop Location of Well: 660 feet from the North line and 1652 feet from the West line Sec. 18					
Ground Level Elev. Not Available	Producing Formation Devonian		Pool Wildcat	Dedicated Acreage 40 Acres	

1. Outline the acreage dedicated to the subject well by colored pencil or hachure marks on the plat below.
2. If more than one lease is dedicated to the well, outline each and identify the ownership thereof (both as to working interest and royalty).
3. If more than one lease of different ownership is dedicated to the well, have the interests of all owners been consolidated by communitization, unitization, force-pooling, etc?

☒ Yes ☐ No If answer is "yes," type of consolidation Unitization & Development Agreement

If answer is "no," list the owners and tract descriptions which have actually been consolidated. (Use reverse side of this form if necessary.) _____

No allowable will be assigned to the well until all interests have been consolidated (by communitization, unitization, forced-pooling, or otherwise) or until a non-standard unit, eliminating such interests, has been approved by the Commission.

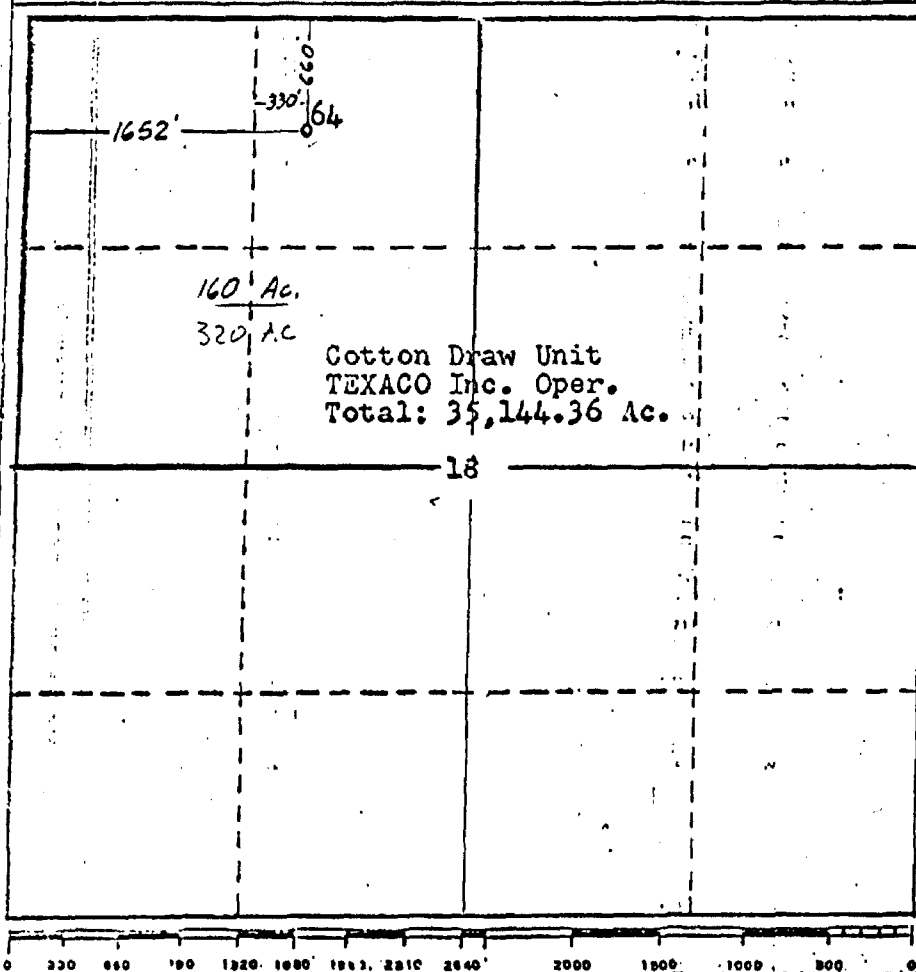

CERTIFICATION	
I hereby certify that the information contained herein is true and complete to the best of my knowledge and belief.	
<i>T. G. Landwermeyer</i>	
Name	T. G. Landwermeyer
Position	Civil Engineer
Company	TEXACO Inc.
Date	9/13/65
I hereby certify that the well location shown on this plat was plotted from field notes of actual surveys made by me or under my supervision, and that the same is true and correct to the best of my knowledge and belief.	
Date Surveyed	9/12/65
Registered Professional Engineer and/or Land Surveyor	
<i>T. G. Landwermeyer</i>	
Certificate No.	17617

NEW MEXICO OIL CONSERVATION COMMISSION
WELL LOCATION AND ACREAGE DEDICATION PLAT

Form C-162
Supersedes C-128
Effective 1-1-65

All distances must be from the outer boundaries of the Section.

Operator TEXACO Inc.		Lease Cotton Draw Unit		Well No. 64
Unit Letter C	Section 18	Township 25 S	Range 32 E	County Lea
Actual Footage Location of Well:				
660	feet from the	North	1652	feet from the
				West
				Sec. 18
Ground Level Elev. Not Available	Producing Formation Devonian	Pool Wildcat	Dedicated Acreage: 320 Acres	

1. Outline the acreage dedicated to the subject well by colored pencil or hachure marks on the plat below.
2. If more than one lease is dedicated to the well, outline each and identify the ownership thereof (both as to working interest and royalty).
3. If more than one lease of different ownership is dedicated to the well, have the interests of all owners been consolidated by communitization, unitization, force-pooling, etc?

☒ Yes ☐ No If answer is "yes," type of consolidation Unitization & Development Agreement

If answer is "no," list the owners and tract descriptions which have actually been consolidated. (Use reverse side of this form if necessary.)

No allowable will be assigned to the well until all interests have been consolidated (by communitization, unitization, forced-pooling, or otherwise) or until a non-standard unit, eliminating such interests, has been approved by the Commission.

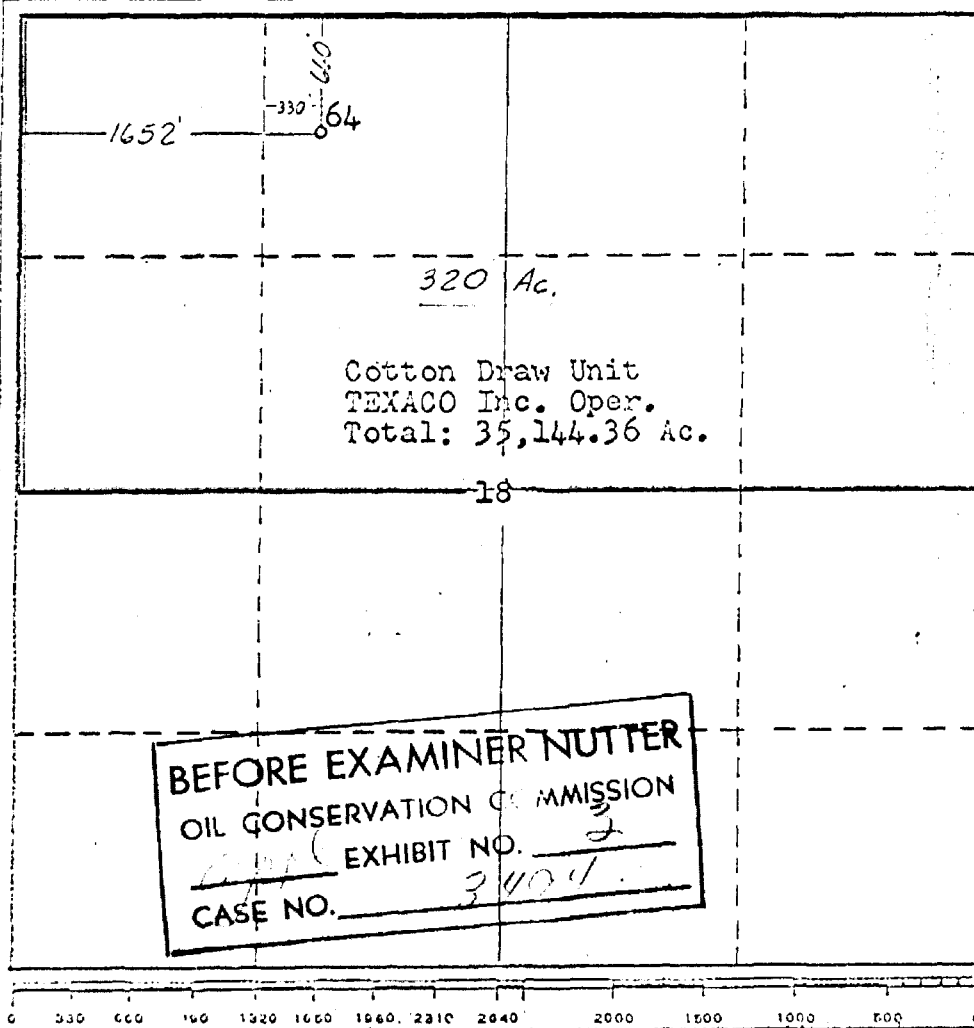

CERTIFICATION

I hereby certify that the information contained herein is true and complete to the best of my knowledge and belief.

Name J. J. Velten
Position
Division Civil Engineer
Company
TEXACO Inc.
Date
10/21/66

I hereby certify that the well location shown on this plat was plotted from field notes of actual surveys made by me or under my supervision, and that the same is true and correct to the best of my knowledge and belief.

Date Surveyed
9/12/66
Registered Professional Engineer and/or Land Surveyor
J. J. Velten
Certificate No.
8174

Memo

From
D. S. NUTTER
CHIEF ENGINEER

To

Mr. [unclear]
Re [unclear] [unclear]
for [unclear] [unclear]
[unclear] [unclear] [unclear]
[unclear] [unclear] [unclear]
[unclear] [unclear] [unclear]