

**2RF-190 -  
DIRE WOLF TRUCKIN  
CONTAINMENT AND  
RECYCLE FACILITY ID  
[fVV2311751535].**

**C-147/Modification of the  
dimensions of the containment  
and treatment pad.**

**[7377] EOG RESOURCES INC  
06/13/2023**

**C-147 Registration Package for Dire Wolf Truckin  
Containment and Recycle Facility**

**Section 13, Township 26-S, Range 30-E, Eddy County**

**NMOCD Permit # 2RF-190**

**Prepared for:  
EOG Resources, Inc.  
5509 Champions Drive  
Midland, TX 79706**

Prepared by:  
Cold Peak Environmental, LLC  
15 Smith Road, Suite 2008  
Midland, TX 79705

Galan Kelley  
[GKelley@coldpeakenviro.com](mailto:GKelley@coldpeakenviro.com)  
(361) 701-8465



May 26, 2023

EMNRD/OCD  
Attn: Victoria Venegas  
1220 South St. Francis Dr.  
Santa Fe, NM 87505

Re: EOG Resources, Inc.  
Dire Wolf Truckin Containment and Recycle Facility  
NMOCD Permit # 2RF-190

Dear Mrs. Venegas,

Cold Peak Environmental, LLC, on behalf of EOG Resources, Inc., submits the attached C-147 registration to amend / modify NMOCD Permit # 2RF-190.

Thank you for allowing EOG Resources to promote water reuse in the State of New Mexico. Please find attached the C-147 form with accompanying documentation for the Truckin Containment and Recycle Facility amendment.

The objective of this amendment is to modify the dimensions of the containment and treatment pad in order to optimize operational efficiency.

Please do not hesitate to contact me with any questions, comments, or concerns.

Sincerely,

Galan Kelley  
Cold Peak Environmental, LLC  
Chief Executive Officer

# **Form C-147**



4.

**Bonding:**

- ☒ Covered under bonding pursuant to 19.15.8 NMAC per 19.15.34.15(A)(2) NMAC (These containments are limited to only the wells owned or operated by the owners of the containment.)
- ☐ Bonding in accordance with 19.15.34.15(A)(1). Amount of bond \$ \_\_\_\_\_ (work on these facilities cannot commence until bonding amounts are approved)
- ☐ Attach closure cost estimate and documentation on how the closure cost was calculated.

5.

**Fencing:**

- ☐ Four foot height, four strands of barbed wire evenly spaced between one and four feet
- ☒ Alternate. Please specify Fencing was approved by NMOCD in the original submission that was approved on 04/28/2023.

6.

**Signs:**

- ☒ 12"x 24", 2" lettering, providing Operator's name, site location, and emergency telephone numbers
- ☐ Signed in compliance with 19.15.16.8 NMAC

7.

**Variances:**

ALL VAIRIANCE REQUESTS HAVE BEEN APPROVED BY NMOCD IN THE ORIGINAL SUBMISSION THAT WAS APPROVED ON 04/28/2023.

Justifications and/or demonstrations that the proposed variance will afford reasonable protection against contamination of fresh water, human health, and the environment.

**Check the below box only if a variance is requested:**

☒ Variance(s): Requests must be submitted to the appropriate division district for consideration of approval. If a Variance is requested, include the variance information on a separate page and attach it to the C-147 as part of the application.

**If a Variance is requested, it must be approved prior to implementation.**

**ALL VARIANCES HAVE BEEN APPROVED BY NMOCD IN THE ORIGINAL SUBMISSION THAT WAS APPROVED 04/28/2023.**

8.

**Siting Criteria for Recycling Containment**

**Instructions:** The applicant must provide attachments that demonstrate compliance for each siting criteria below as part of the application. Potential examples of the siting attachment source material are provided below under each criteria.

**General siting****Ground water is less than 50 feet below the bottom of the Recycling Containment.**

NM Office of the State Engineer - iWATERS database search; USGS; Data obtained from nearby wells

☐ Yes ☒ No  
☐ NA

Within incorporated municipal boundaries or within a defined municipal fresh water well field covered under a municipal ordinance adopted pursuant to NMSA 1978, Section 3-27-3, as amended.

- Written confirmation or verification from the municipality; written approval obtained from the municipality

☐ Yes ☒ No  
☐ NA

Within the area overlying a subsurface mine.

- Written confirmation or verification or map from the NM EMNRD-Mining and Minerals Division

☐ Yes ☒ No

Within an unstable area.

- Engineering measures incorporated into the design; NM Bureau of Geology & Mineral Resources; USGS; NM Geological Society; topographic map

☐ Yes ☒ No

Within a 100-year floodplain. FEMA map

☐ Yes ☒ No

Within 300 feet of a continuously flowing watercourse, or 200 feet of any other significant watercourse, or lakebed, sinkhole, or playa lake (measured from the ordinary high-water mark).

- Topographic map; visual inspection (certification) of the proposed site

☐ Yes ☒ No

Within 1000 feet from a permanent residence, school, hospital, institution, or church in existence at the time of initial application.

- Visual inspection (certification) of the proposed site; aerial photo; satellite image

☐ Yes ☒ No

Within 500 horizontal feet of a spring or a fresh water well used for domestic or stock watering purposes, in existence at the time of initial application.

- NM Office of the State Engineer - iWATERS database search; visual inspection (certification) of the proposed site

☐ Yes ☒ No

Within 500 feet of a wetland.

- US Fish and Wildlife Wetland Identification map; topographic map; visual inspection (certification) of the proposed site

☐ Yes ☒ No

9.

**Recycling Facility and/or Containment Checklist:****Instructions:** Each of the following items must be attached to the application. Indicate, by a check mark in the box, that the documents are attached.

- ☒ Design Plan - based upon the appropriate requirements.
- ☒ Operating and Maintenance Plan - based upon the appropriate requirements.
- ☒ Closure Plan - based upon the appropriate requirements.
- ☒ Site Specific Groundwater Data -
- ☒ Siting Criteria Compliance Demonstrations -
- ☒ Certify that notice of the C-147 (only) has been sent to the surface owner(s)

10.

**Operator Application Certification:**

I hereby certify that the information and attachments submitted with this application are true, accurate and complete to the best of my knowledge and belief.

Name (Print): Olivia Desser Title: Water Resource ManagerSignature: Olivia Desser Date: 5/26/2023e-mail address: Olivia\_Desser@eogresources.com Telephone: (432) 247-6359

11.

OCD Representative Signature: Victoria Venegas Approval Date: 06/14/2023Title: Environmental Specialist OCD Permit Number: 2RF-190☒ OCD Conditions \_\_\_\_\_☐ Additional OCD Conditions on Attachment

# **C-147 Detail**





## C-147 DETAIL

### Dire Wolf Truckin Containment Pit – Amendment

#### RECYCLING CONTAINMENT DETAIL

---

EOG is proposing to construct a multi-liner dual containment pit utilizing leak detection systems to ensure an intact leak-free barrier system. As depicted in the attached design plan and schematics, *Truckin Reuse Pit*, the proposed pits will incorporate standards that meet or exceed the required standards per 19.15.34.12 NMAC. The proposed recycle containment will be approximately 645' x 266' inside floor dimensions each with 4:1 inside and outside berm grades. The approximate wall height will average 7ft from outside ground level to ensure no surface water run-on will occur. The top of the levee shall be approximately 20ft wide 2% outside sloping grade to ensure no surface water run-on will occur. The containment pit floor and wall preparation will include laser-finished grade free of rocks, debris, and sharp edges, compacted to a density to ensure an unyielding base. At the onset of pit construction, all vegetative material and topsoil will be removed and stockpiled at the outside toe of the levee slopes. The interior liner system of the containment pit will consist of a 10-ounce geotextile felt base layer to protect the secondary geomembrane liner from any protruding floor irregularities. The secondary geomembrane liner will be composed of 40 mil HDPE. Between the secondary and primary liners will consist of 200 mil geonet sloping to the leak detection trough. The primary liner consists of a 60 mil HDPE liner. All liners will meet or exceed EPA SW-846 method 9090A. All seams will be oriented vertically with 4–6-inch liner overlap and all seam testing shall exceed all guidelines. As depicted in the attached design plan, *Truckin Reuse Pit*, the proposed containment pit will include a center-aligned leak detection trough and collection sump completed with perforated pipe and pump casing allowing for the installation of a leak detection pump system. Both inlet and discharge manifold systems, depicted in *Truckin Reuse Pit*, will be installed to prevent any liner damage from water entrance velocity or hose installation. Two audible bird deterrents will be utilized to deter any native birds and wildlife from the containment pit area.

# **Recycling Containment**

## **Design Drawings**



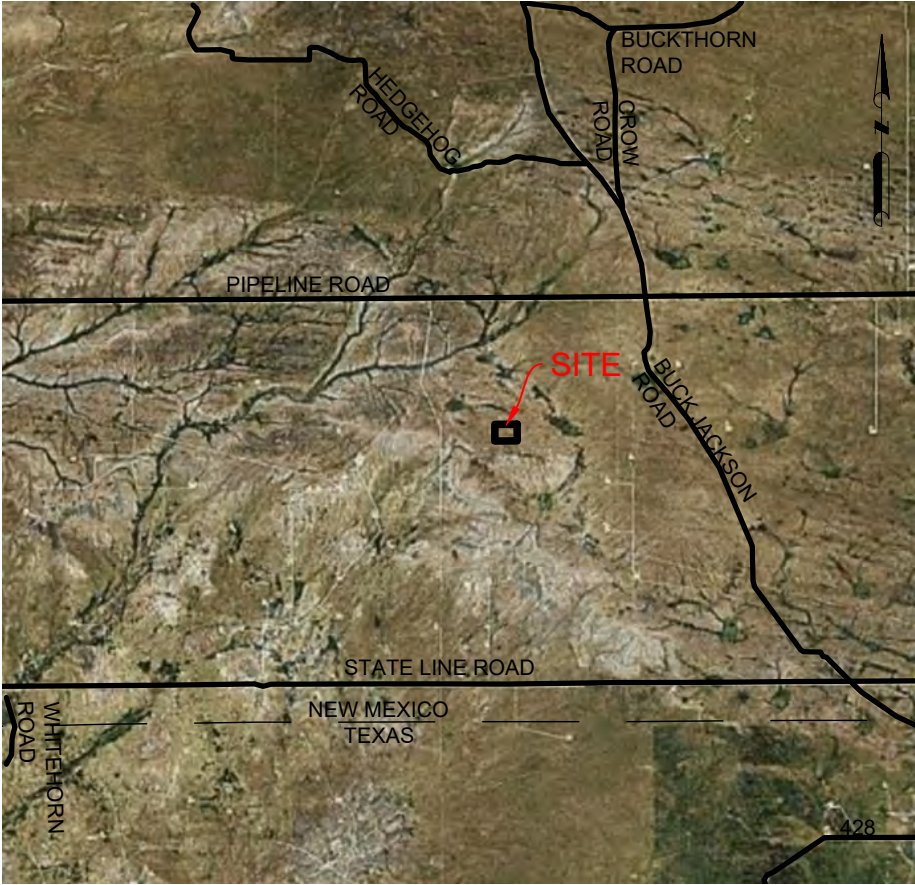

REGIONAL MAP  
N.T.S.

- NOTES:
- COORDINATES ARE GRID AS DERIVED FROM GPS OBSERVATIONS AND ARE BASED ON STATE PLANE COORDINATES FOR NEW MEXICO EAST ZONE NAD-83 AND US SURVEY FOOT.
  - EXISTING UTILITY LOCATIONS SHOWN ARE TAKEN FROM AVAILABLE RECORDS PROVIDED BY THE UTILITY OWNER AND FIELD LOCATIONS OF SURFACE APPURTENANCES. LOCATIONS SHOWN ARE GENERALLY SCHEMATIC IN NATURE AND MAY NOT ACCURATELY REFLECT THE SIZE AND LOCATION OF EACH INDIVIDUAL UTILITY. SOME UTILITY LINES MAY NOT BE SHOWN.
  - ANY DAMAGES THAT MAY OCCUR TO REAL PROPERTY OR EXISTING IMPROVEMENTS SHALL BE RESTORED BY THE CONTRACTOR TO AT LEAST THE SAME CONDITION THAT THE REAL PROPERTY OR EXISTING IMPROVEMENTS WERE IN PRIOR TO THE DAMAGES.

EOG RESOURCES, INC.  
TRUCKIN REUSE PIT  
EDDY COUNTY, NEW MEXICO  
CONSTRUCTION PLAN

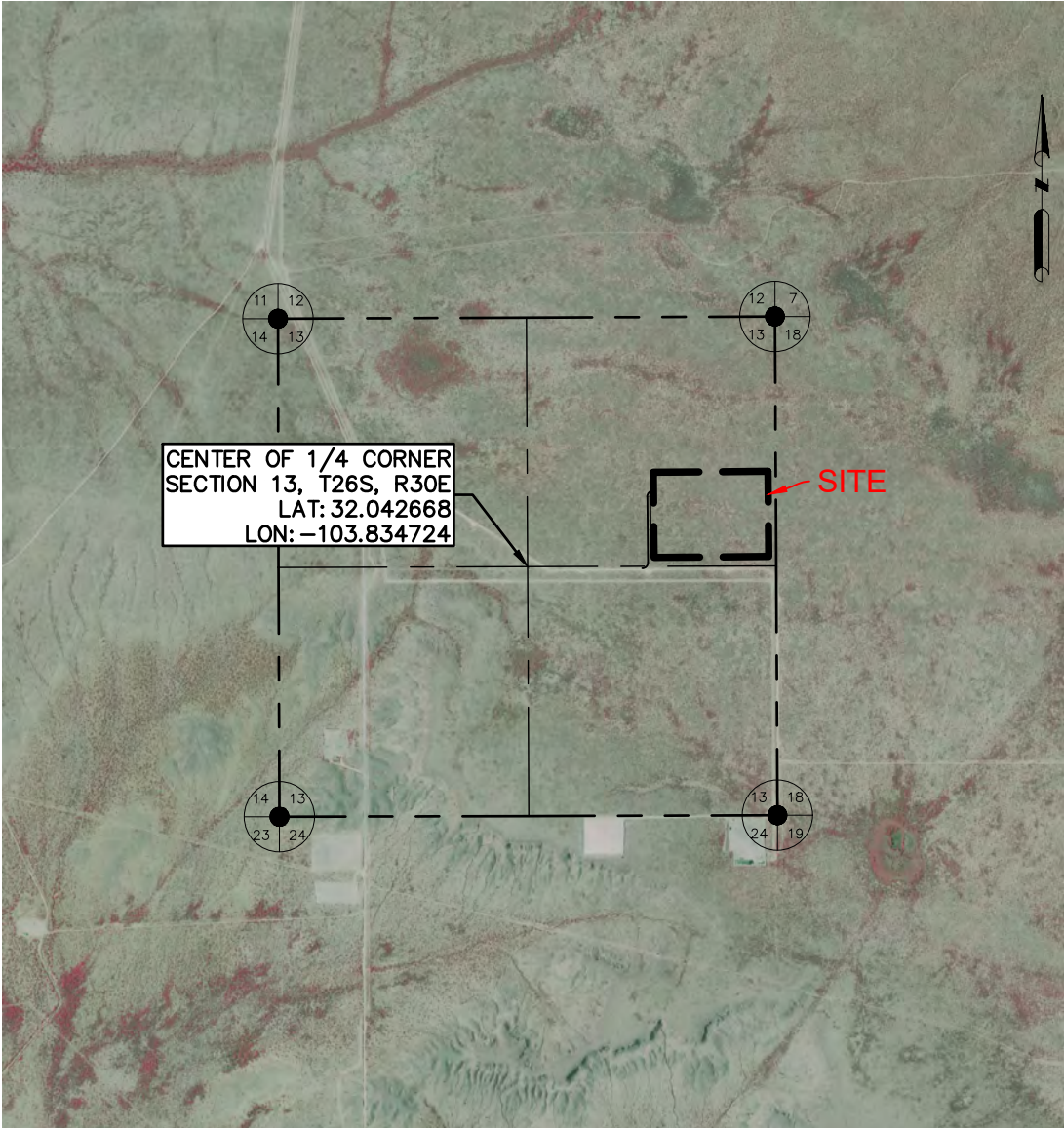

VICINITY MAP  
N.T.S.

DATA SOURCE:  
AERIAL: NAIP 2020

PUBLICLY AVAILABLE DATA SOURCES HAVE NOT BEEN INDEPENDENTLY VERIFIED BY ASCENT.

DISCLAIMER:  
THIS PLOT DOES NOT REPRESENT A MONUMENTED LAND SURVEY AND SHOULD NOT BE RELIED UPON TO DETERMINE BOUNDARY LINES, PROPERTY OWNERSHIP OR OTHER PROPERTY INTERESTS. PARCEL LINES, IF DEPICTED HAVE NOT BEEN FIELD VERIFIED AND MAY BE BASED UPON PUBLICLY AVAILABLE DATA THAT ALSO HAS NOT BEEN INDEPENDENTLY VERIFIED.

Sheet List Table		
Sheet Number	Sheet Title	Sheet Revision Number
01	COVER SHEET	2
02	POND LAYOUT	2
03	POND CALCULATIONS	2
04	CROSS SECTIONS	2
05	DETAILS 1	1
06	DETAILS 2	1
07	DETAILS 3	0



ASCENT  
GEOMATICS SOLUTIONS  
8620 WOLFF COURT  
WESTMINSTER, CO 80031  
(303) 928-7128

PREPARED FOR:  
**eog resources**

SHEET NAME:  
COVER SHEET  
TRUCKIN REUSE PIT  
SE 1/4 NE 1/4 SECTION 13  
T26S, R30E, NEW MEXICO P.M.  
EDDY COUNTY, NEW MEXICO

REV.	DESCRIPTION	BY	DATE
0	ISSUED FOR CONSTRUCTION	AS	12/16/22
1	ISSUED FOR CONSTRUCTION	AS	5/2/23
2	ISSUED FOR CONSTRUCTION	AS	5/15/23

DRAWING DATE:  
12/16/22  
DRAFTED BY:  
AS  
SHEET NO.  
01 OF 07



EOG RESOURCES, INC.  
TRUCKIN REUSE PIT  
EDDY COUNTY, NEW MEXICO  
CONSTRUCTION PLAN

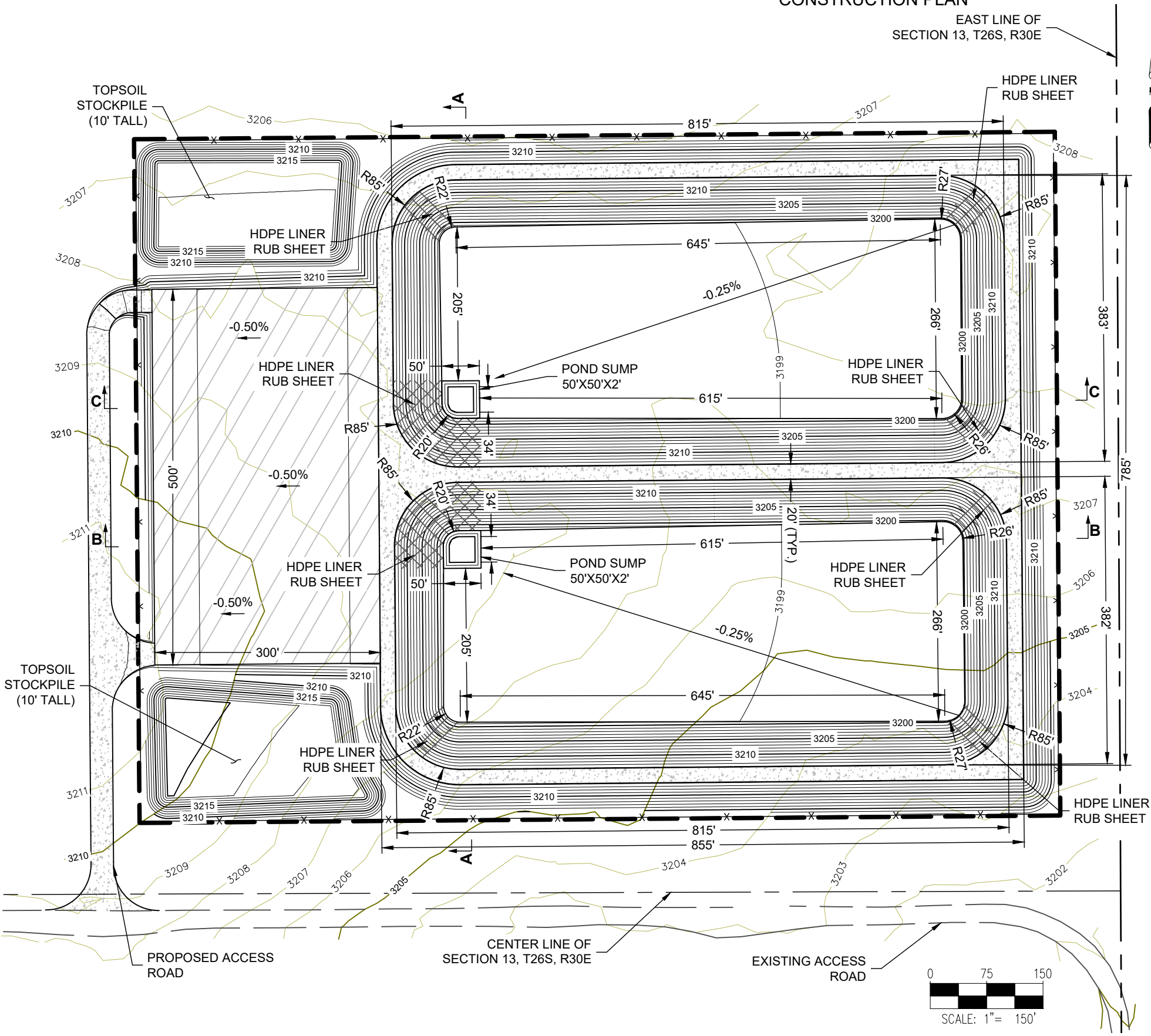

LEGEND:

- 5280 EXISTING MAJOR CONTOUR
- 5280 EXISTING MINOR CONTOUR
- 5280 PROPOSED MAJOR CONTOUR
- 5280 PROPOSED MINOR CONTOUR
- SECTION LINE
- CENTER-SECTION LINE
- OIL & GAS LOCATION
- PROPOSED FENCE
- PROPOSED BERM DRIVE & ACCESS ROAD
- PROPOSED EQUIPMENT PAD
- PROPOSED RUB SHEET

NOTES:

1. WATER LEVEL IN REUSE PITS SHALL NOT EXCEED THE 3' FREEBOARD ELEVATION, 3,211.20-FT.
2. THE BASE OF ALL FILL EMBANKMENTS SHALL BE KEYED INTO EXISTING COMPACTED SUBGRADE A MINIMUM OF 2 FEET.
3. ALL REUSE PIT EMBANKMENT FILL MATERIAL SHALL BE COMPACTED IN 6 INCH (MAXIMUM) LIFTS TO 95% OF THE MAXIMUM MODIFIED PROCTOR DENSITY (MINIMUM) AT THE OPTIMUM MOISTURE CONTENT (-2% TO 2%) TO ACHIEVE MAXIMUM DENSITY IN ACCORDANCE WITH ASTM D1557.
4. IF EXCESS MATERIAL IS ENCOUNTERED, THIS CAN BE DISPOSED OF IN THE STOCKPILE AREA.



DISCLAIMER:  
THIS PLOT DOES NOT REPRESENT A MONUMENTED LAND SURVEY AND SHOULD NOT BE RELIED UPON TO DETERMINE BOUNDARY LINES, PROPERTY OWNERSHIP OR OTHER PROPERTY INTERESTS. PARCEL LINES, IF DEPICTED HAVE NOT BEEN FIELD VERIFIED AND MAY BE BASED UPON PUBLICLY AVAILABLE DATA THAT ALSO HAS NOT BEEN INDEPENDENTLY VERIFIED.

ASCENT GEOMATICS SOLUTIONS  
8620 WOLFF COURT  
WESTMINSTER, CO 80031  
(303) 928-7128

PREPARED FOR:

**eo resources**

SHEET NAME:

POND LAYOUT

TRUCKIN REUSE PIT

SE 1/4 NE 1/4 SECTION 13  
T26S, R30E, NEW MEXICO P.M.  
EDDY COUNTY, NEW MEXICO

REV.	DESCRIPTION	BY	DATE
0	ISSUED FOR CONSTRUCTION	AS	12/16/22
1	ISSUED FOR CONSTRUCTION	AS	5/2/23
2	ISSUED FOR CONSTRUCTION	AS	5/15/23

DRAWING DATE:

12/16/22

DRAFTED BY:

AS

SHEET NO.

02 OF 07

EOG RESOURCES, INC.  
TRUCKIN REUSE PIT  
EDDY COUNTY, NEW MEXICO  
CONSTRUCTION PLAN

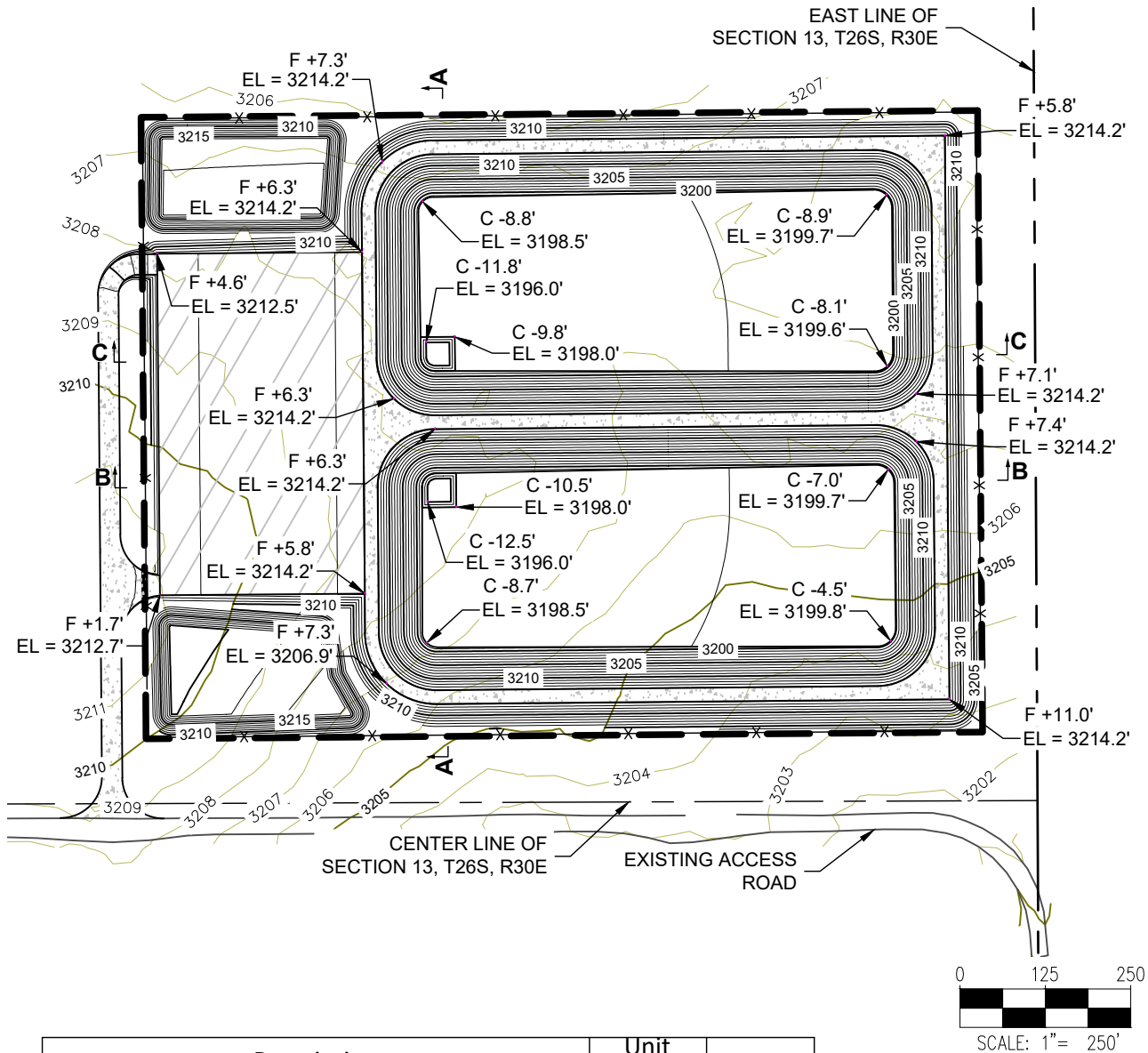

Description		Unit Quantity	Unit
Liner Areas	Out-Slope Area	108,605	SQ.FT
	Pond Area	610,689	SQ.FT
	Rub Sheet	31,819	SQ.FT
Piping	6" HDPE Casing Pipe	151	LN.FT
	4" HDPE Collection Pipe	1,448	LN.FT
	12 HDPE Suction Line	154	LN.FT
Roads	Site Access Road & Berm Drive (6" Gravel)	120,263	SQ.FT
Fences	6' Chain Link Fence	4,176	LN.FT
	Access Gate, 2-Truck, 2-Walk	4	EA
Mass Grading	Clearing and Grubbing	25.59	ACRE

TRUCKIN REUSE PIT STAGE STORAGE					
ELEV	DEPTH (FT)	AREA (ACRES)	VOL (BBLs)	VOL (ACRE FT)	VOL(CY)
3,196.00	0.00	0.03	0.00	0.00	0.00
3,196.50	0.50	0.03	111.66	0.01	23.22
3,197.00	1.00	0.04	249.51	0.03	51.89
3,197.50	1.50	0.05	416.14	0.05	86.54
3,198.00	2.00	0.06	614.13	0.08	127.71
3,198.50	2.50	1.26	3,159.13	0.41	656.93
3,199.00	3.00	2.62	10,686.53	1.38	2,222.24
3,199.50	3.50	3.92	23,384.34	3.01	4,862.72
3,200.00	4.00	4.31	39,354.09	5.07	8,183.59
3,200.50	4.50	4.40	56,246.05	7.25	11,696.23
3,201.00	5.00	4.49	73,477.04	9.47	15,279.37
3,201.50	5.50	4.57	91,049.28	11.74	18,933.47
3,202.00	6.00	4.66	108,965.01	14.04	22,659.00
3,202.50	6.50	4.75	127,226.47	16.40	26,456.43
3,203.00	7.00	4.84	145,835.89	18.80	30,326.21
3,203.50	7.50	4.93	164,795.51	21.24	34,268.82
3,204.00	8.00	5.02	184,107.55	23.73	38,284.71
3,204.50	8.50	5.12	203,774.27	26.27	42,374.36
3,205.00	9.00	5.21	223,797.88	28.85	46,538.22
3,205.50	9.50	5.30	244,180.63	31.47	50,776.76
3,206.00	10.00	5.39	264,924.75	34.15	55,090.45
3,206.50	10.50	5.49	286,032.47	36.87	59,479.75
3,207.00	11.00	5.58	307,506.04	39.64	63,945.12
3,207.50	11.50	5.68	329,347.67	42.45	68,487.04
3,208.00	12.00	5.77	351,559.62	45.31	73,105.95
3,208.50	12.50	5.87	374,144.11	48.22	77,802.34
3,209.00	13.00	5.97	397,103.38	51.18	82,576.67
3,209.50	13.50	6.06	420,439.67	54.19	87,429.39
3,210.00	14.00	6.16	444,155.20	57.25	92,360.98
3,210.50	14.50	6.26	468,252.22	60.35	97,371.89
3,211.00	15.00	6.36	492,732.95	63.51	102,462.60
3,211.20	15.20	6.40	502,633.12	64.79	104,521.32
3,211.50	15.50	6.46	517,599.51	66.72	107,633.54
3,212.00	16.00	6.56	542,854.38	69.97	112,885.23
3,212.50	16.50	6.66	568,499.68	73.28	118,218.10
3,213.00	17.00	6.76	594,537.64	76.63	123,632.63
3,213.50	17.50	6.87	620,970.49	80.04	129,129.28
3,214.00	18.00	6.97	647,800.46	83.50	134,708.51
3,214.20	18.20	7.01	658,644.09	84.89	136,963.41

\*INFORMATION ABOVE IS IDENTICAL FOR EACH POND

EARTHWORKS QUANTITIES		
TOTAL CUT FOR SITE	102,620	CY
TOTAL FILL FOR SITE	91,251	CY
TOPSOIL (6" DEPTH)	17,889	CY
TOTAL EXPORT	0	CY
TOTAL GRADING AREA	22.04	ACRES

\*VOLUMES ASSUME A CUT FACTOR OF 0.85.

POND SUMMARY		
MAX VOLUME	658,644.09	BBLs
MAX AREA	7.01	ACRES
MAX ELEVATION OF POND	3214.20	FT
3' FREEBOARD ELEVATION	3211.20	FT
VOLUME AT FREEBOARD	502,633.12	BBLs

\*INFORMATION ABOVE IS IDENTICAL FOR EACH POND

DISCLAIMER:  
THIS PLOT DOES NOT REPRESENT A MONUMENTED LAND SURVEY  
AND SHOULD NOT BE RELIED UPON TO DETERMINE BOUNDARY LINES,  
PROPERTY OWNERSHIP OR OTHER PROPERTY INTERESTS. PARCEL  
LINES, IF DEPICTED HAVE NOT BEEN FIELD VERIFIED AND MAY BE  
BASED UPON PUBLICLY AVAILABLE DATA THAT ALSO HAS NOT BEEN  
INDEPENDENTLY VERIFIED.



ASCENT GEOMATICS SOLUTIONS  
8620 WOLFF COURT  
WESTMINSTER, CO 80031  
(303) 928-7128

PREPARED FOR:



SHEET NAME:

POND CALCULATIONS

TRUCKIN REUSE PIT

SE 1/4 NE 1/4 SECTION 13

T26S, R30E, NEW MEXICO P.M.

EDDY COUNTY, NEW MEXICO

BY	DATE	BY	DATE
AS	12/16/22	MA	12/16/22
AS	12/16/22	MS	12/16/22
AS	12/16/22	MS	12/16/22

REV.	REVISION DESCRIPTION
0	ISSUED FOR CONSTRUCTION
1	ISSUED FOR CONSTRUCTION
2	ISSUED FOR CONSTRUCTION

DRAWING DATE:  
12/16/22

DRAFTED BY:  
AS

SHEET NO.  
03 OF 07





EOG RESOURCES, INC.  
TRUCKIN REUSE PIT  
EDDY COUNTY, NEW MEXICO  
CONSTRUCTION PLAN



ASCENT  
GEOMATICS SOLUTIONS  
8620 WOLFF COURT  
WESTMINSTER, CO 80031  
(303) 928-7128

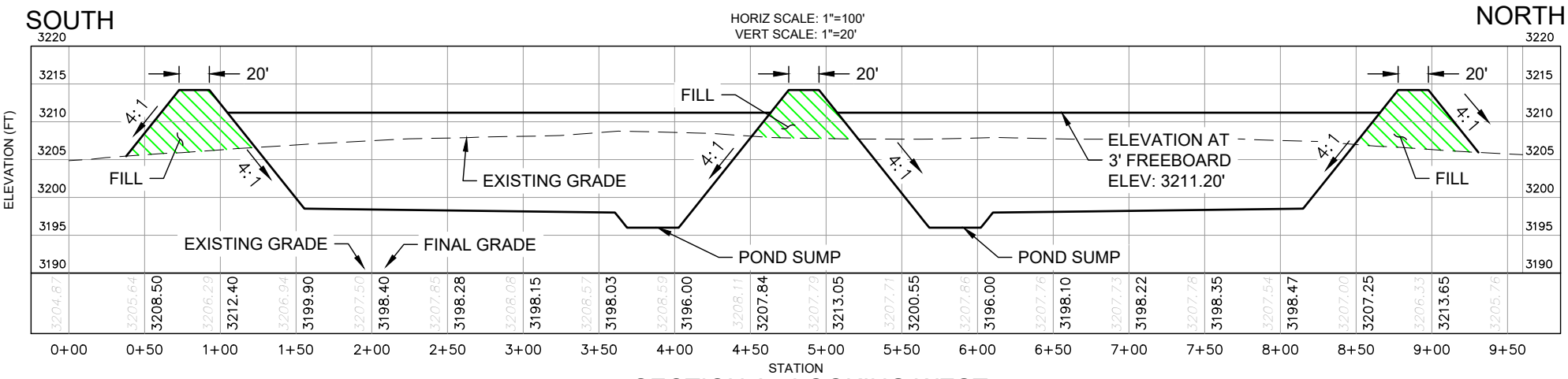

SECTION A - LOOKING WEST

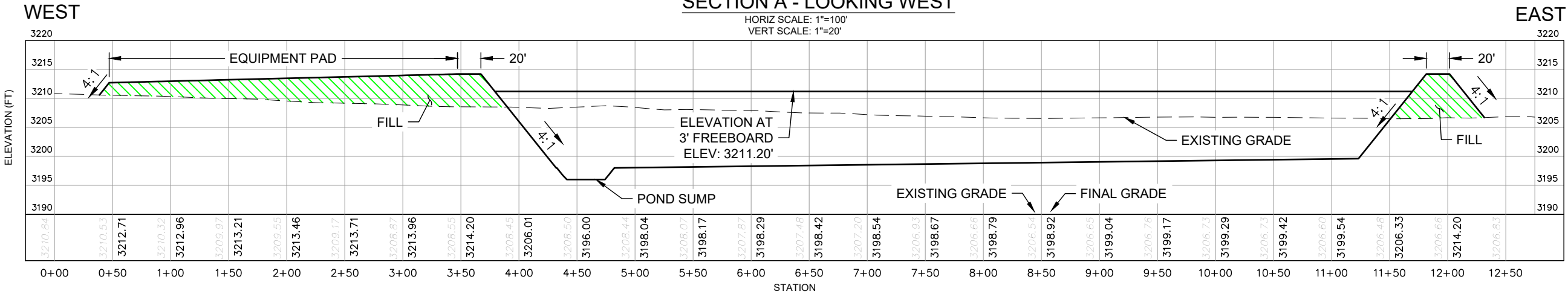

SECTION B - LOOKING NORTH

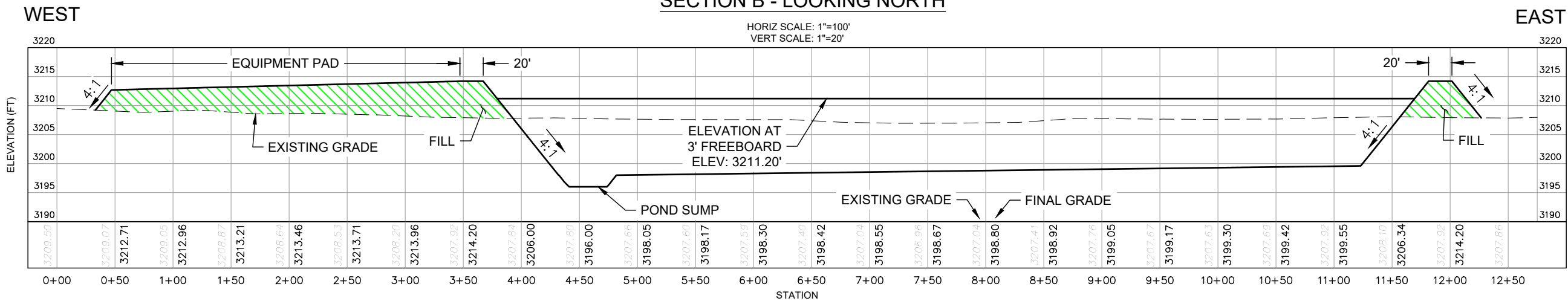

SECTION C - LOOKING NORTH

DISCLAIMER:  
THIS PLOT DOES NOT REPRESENT A MONUMENTED LAND SURVEY  
AND SHOULD NOT BE RELIED UPON TO DETERMINE BOUNDARY LINES,  
PROPERTY OWNERSHIP OR OTHER PROPERTY INTERESTS. PARCEL  
LINES, IF DEPICTED HAVE NOT BEEN FIELD VERIFIED AND MAY BE  
BASED UPON PUBLICLY AVAILABLE DATA THAT ALSO HAS NOT BEEN  
INDEPENDENTLY VERIFIED.

PREPARED FOR:



CROSS SECTIONS

TRUCKIN REUSE PIT  
SE 1/4 NE 1/4 SECTION 13  
T26S, R30E, NEW MEXICO P.M.  
EDDY COUNTY, NEW MEXICO

REV.	REVISION DESCRIPTION	BY	DATE
0	ISSUED FOR CONSTRUCTION	AS	12/16/22
1	ISSUED FOR CONSTRUCTION	AS	5/2/23
2	ISSUED FOR CONSTRUCTION	AS	5/15/23

DRAWING DATE: 12/16/22  
DRAFTED BY: AS  
SHEET NO. 04 OF 07

P:\EOG\_B220075\PROD\Grading\5\_Details.dwg

EOG RESOURCES, INC.  
TRUCKIN REUSE PIT  
EDDY COUNTY, NEW MEXICO  
CONSTRUCTION PLAN

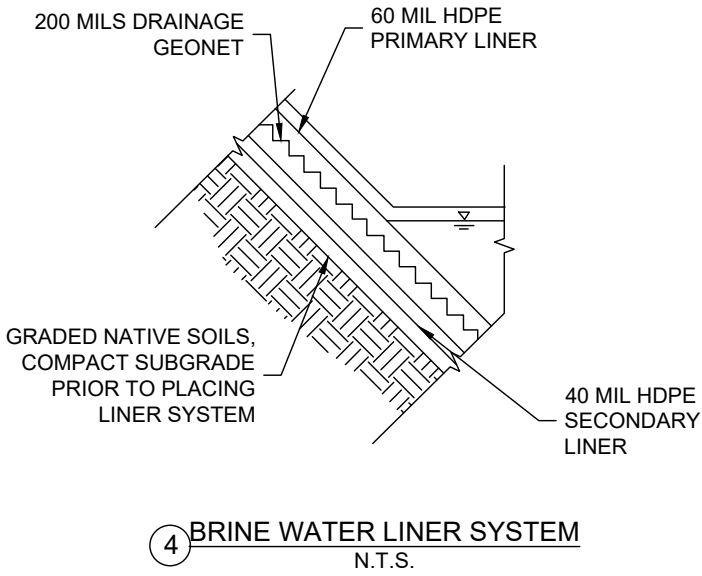
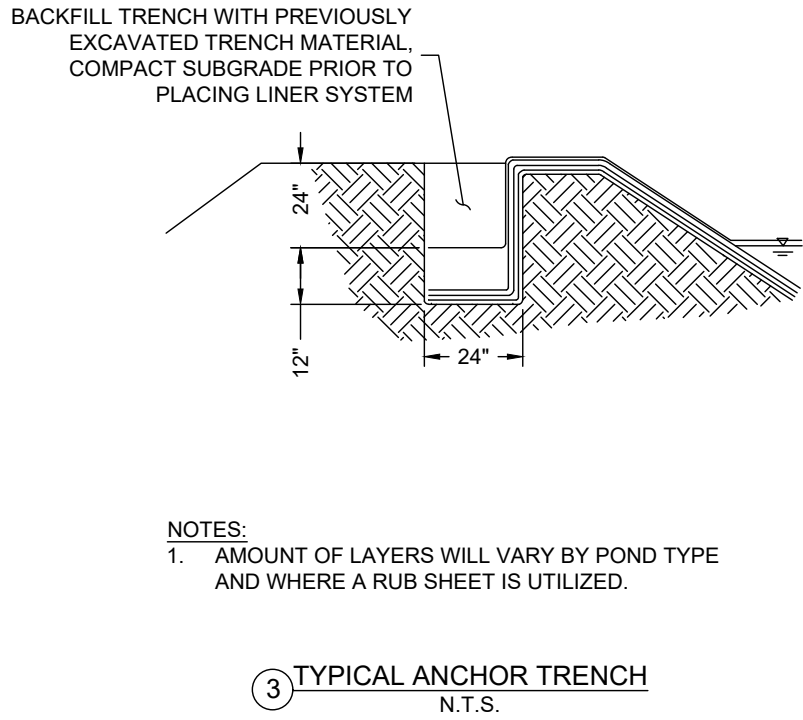
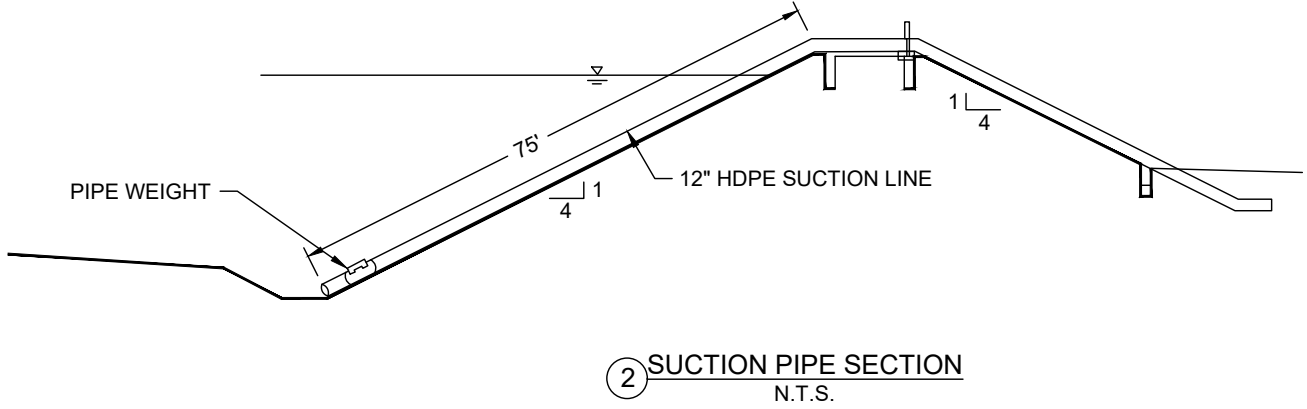
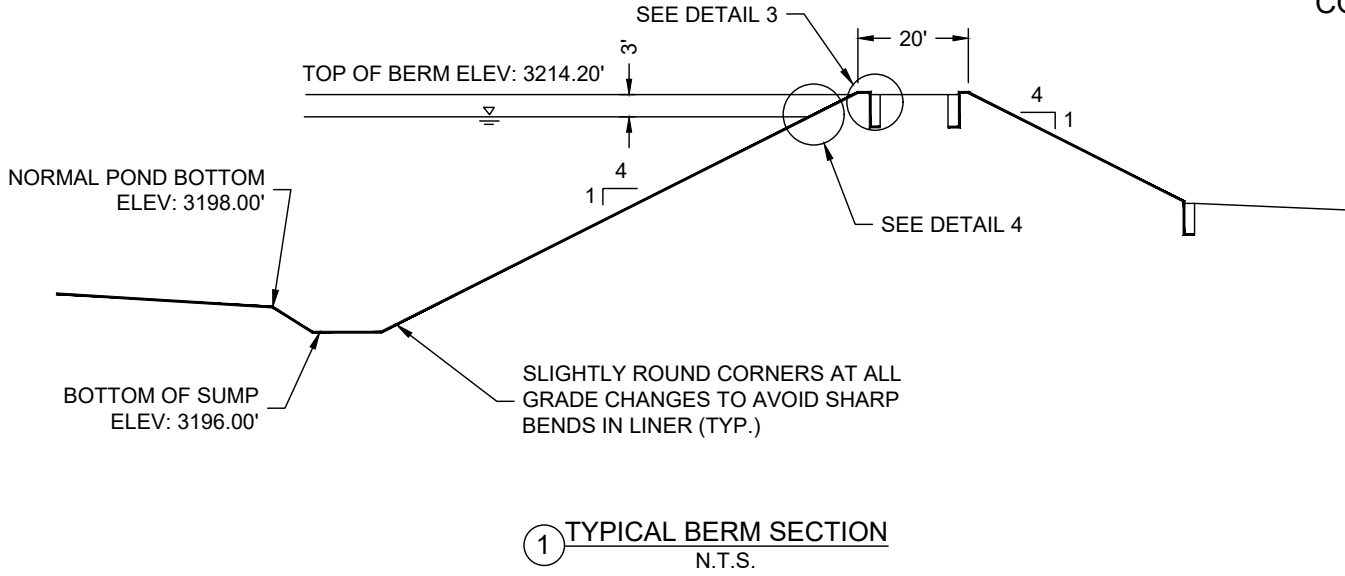

NOTES:  
1. AMOUNT OF LAYERS WILL VARY BY POND TYPE  
AND WHERE A RUB SHEET IS UTILIZED.



ASCENT GEOMATICS SOLUTIONS  
8620 WOLFF COURT  
WESTMINSTER, CO 80031  
(303) 928-7128

PREPARED FOR:

TRUCKIN REUSE PIT  
SE 1/4 NE 1/4 SECTION 13  
T26S, R30E, NEW MEXICO P.M.  
EDDY COUNTY, NEW MEXICO

REV.	DESCRIPTION	BY	DATE
0	ISSUED FOR CONSTRUCTION	AS	12/16/22
1	ISSUED FOR CONSTRUCTION	AS	5/2/23

DRAWING DATE: 12/16/22

DRAFTED BY: AS

SHEET NO. 05 OF 07

EOG RESOURCES, INC.  
TRUCKIN REUSE PIT  
EDDY COUNTY, NEW MEXICO  
CONSTRUCTION PLAN

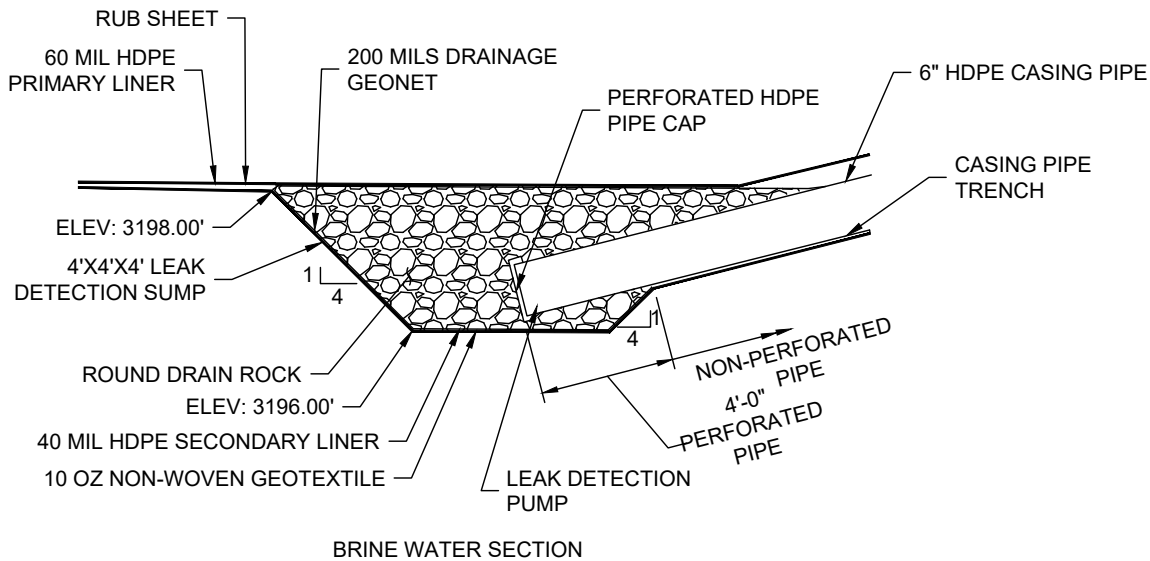

5 LEAK DETECTION SUMP  
N.T.S.

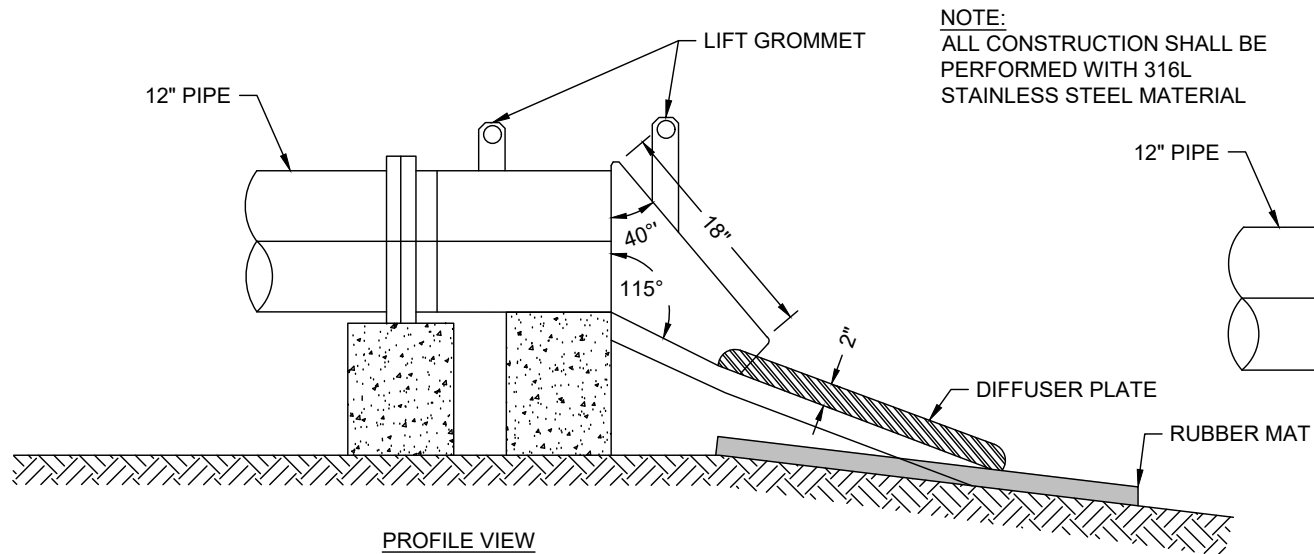

6 POND FILL APPARATUS  
N.T.S.

NOTE:  
ALL CONSTRUCTION SHALL BE  
PERFORMED WITH 316L  
STAINLESS STEEL MATERIAL

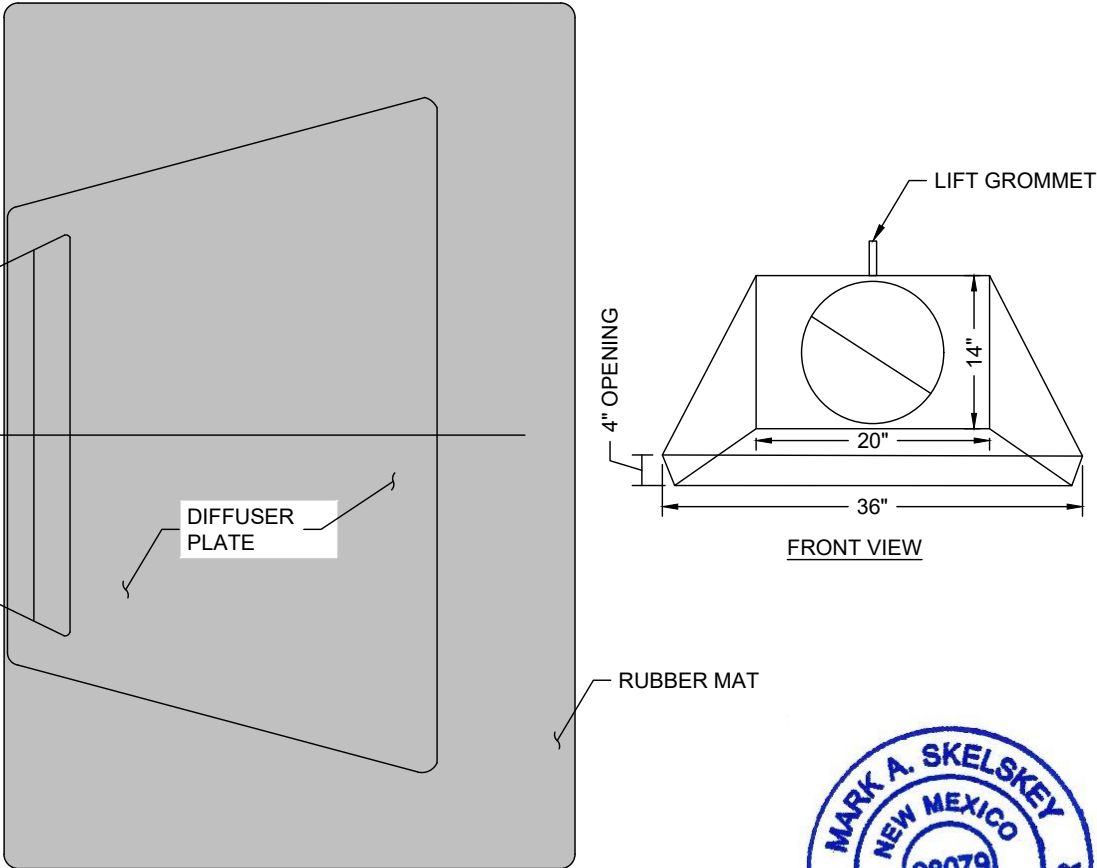
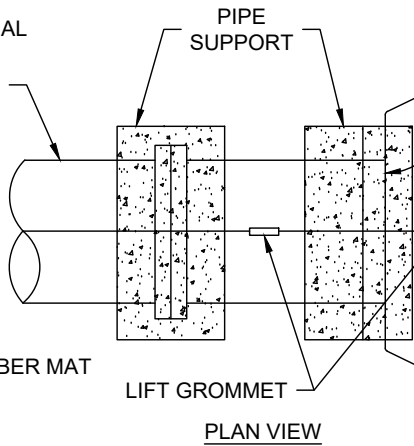

ASCENT GEOMATICS SOLUTIONS  
8620 WOLFF COURT  
WESTMINSTER, CO 80031  
(303) 928-7128

PREPARED FOR:

SE 1/4 NE 1/4 SECTION 13  
T26S, R30E, NEW MEXICO P.M.  
EDDY COUNTY, NEW MEXICO

REV.	DESCRIPTION	BY	DATE	DATE	DATE
0	ISSUED FOR CONSTRUCTION	AS	12/16/22	12/16/22	12/16/22
1	ISSUED FOR CONSTRUCTION	AS	5/2/23	5/2/23	5/2/23

DRAWING DATE: 12/16/22

DRAFTED BY: AS

SHEET NO. 06 OF 07



P:\EOG\_B220075\PROD\Grading\5\_Details.dwg

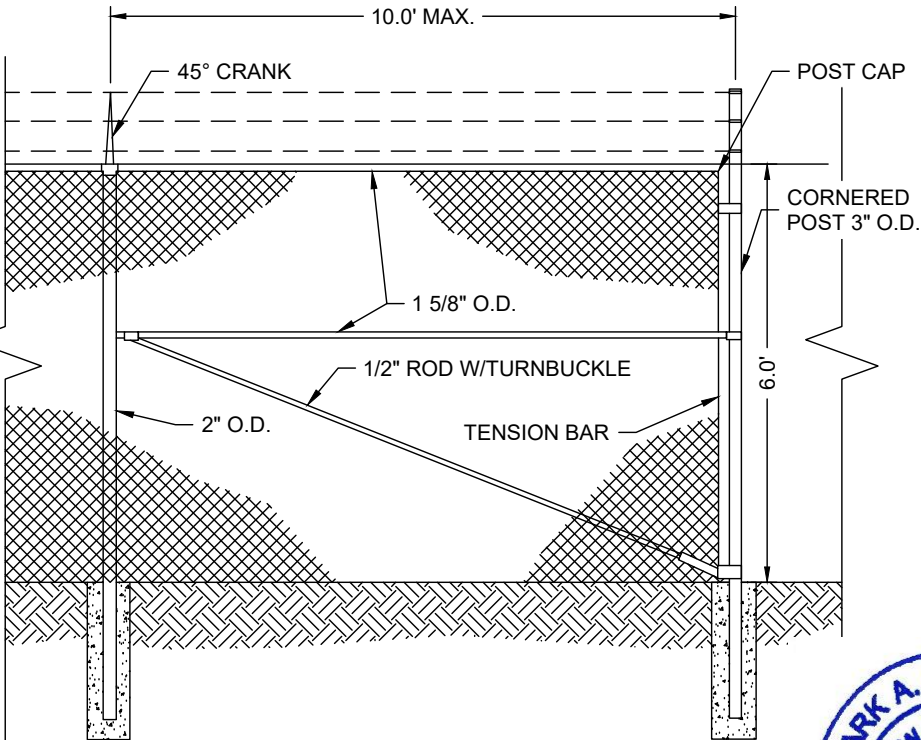
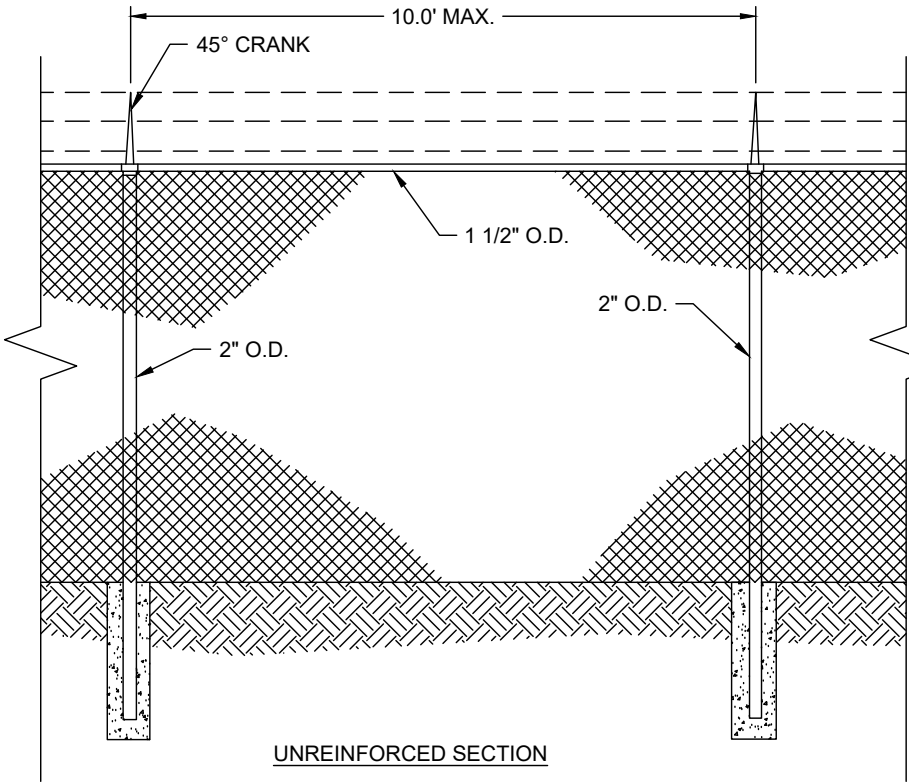
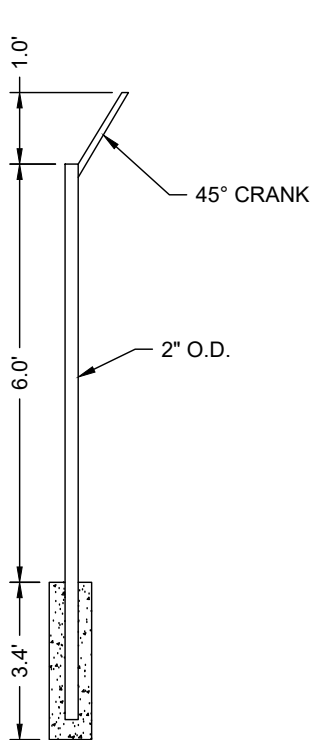
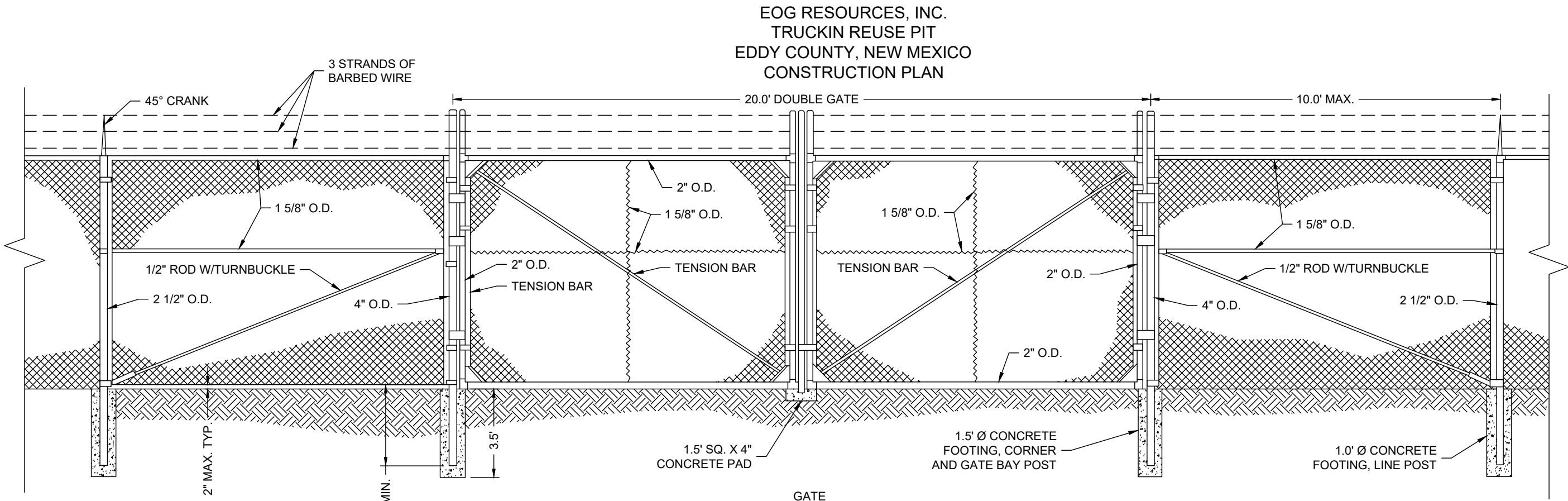

7 PERMANENT 6' CHAINLINK FENCE WITH BARBED WIRE DETAIL  
N.T.S.



05.02.2023

ASCENT GEOMATICS SOLUTIONS  
8620 WOLFF COURT  
WESTMINSTER, CO 80031  
(303) 928-7128

PREPARED FOR:

SE 1/4 NE 1/4 SECTION 13  
T26S, R30E, NEW MEXICO P.M.  
EDDY COUNTY, NEW MEXICO

REV.	DESCRIPTION	BY	DATE	BY	DATE
0	ISSUED FOR CONSTRUCTION	AS	12/16/22	MA	12/16/22

DRAWING DATE: 12/16/22

DRAFTED BY: AS

SHEET NO. 07 OF 07

**District I**  
1625 N. French Dr., Hobbs, NM 88240  
Phone:(575) 393-6161 Fax:(575) 393-0720  
**District II**  
811 S. First St., Artesia, NM 88210  
Phone:(575) 748-1283 Fax:(575) 748-9720  
**District III**  
1000 Rio Brazos Rd., Aztec, NM 87410  
Phone:(505) 334-6178 Fax:(505) 334-6170  
**District IV**  
1220 S. St Francis Dr., Santa Fe, NM 87505  
Phone:(505) 476-3470 Fax:(505) 476-3462

**State of New Mexico**  
**Energy, Minerals and Natural Resources**  
**Oil Conservation Division**  
**1220 S. St Francis Dr.**  
**Santa Fe, NM 87505**

CONDITIONS  
  
Action 224346

CONDITIONS

Operator: EOG RESOURCES INC P.O. Box 2267 Midland, TX 79702	OGRID: 7377
	Action Number: 224346
	Action Type: [C-147] Water Recycle Long (C-147L)

CONDITIONS

Created By	Condition	Condition Date
vvenegas	NMOC has reviewed the recycling containment permit modification and related documents, submitted by [7377] EOG RESOURCES on 06/06/2023, for 2RF-190 - DIRE WOLF TRUCKIN CONTAINMENT AND RECYCLE FACILITY ID [fVV2311751535]. [7377] EOG RESOURCES requested the modification of the dimensions of the containment and treatment pad for 2RF-190 - DIRE WOLF TRUCKIN CONTAINMENT AND RECYCLE FACILITY ID [fVV2311751535]. This modification request is approved. • [7377] EOG RESOURCES INC will comply with the conditions previously approved for permit 2RF-190 - DIRE WOLF TRUCKIN CONTAINMENT AND RECYCLE FACILITY ID [fVV2311751535]. No changes to the operations procedures, maintenance, and monitoring procedures, or closing procedures will be made aside from the change of dimensions of the containment and treatment pad included in the modification request documentation.	6/14/2023