

Drone Imagery Date: Nov. 21, 2022



U.S. Feet
Scale 1"=60'

Rev. 8 - Issued for Information Updated Plan	Oct. 27, 2023	Drafted by: Marcos Barriga	(Elite Optz.)
Preliminary Version 0		Reviewed by:	(Elite Optz.)
Rev. 9 - Issued for Information Updated Plan	Feb. 18, 2024	Drafted by: Marcos Barriga	(Elite Optz.)
Preliminary Version 0		Reviewed by:	(Elite Optz.)
Rev. 10 - Issued for Information Updated Plan	May 2, 2024	Drafted by: Marcos Barriga	(Elite Optz.)
Preliminary Version 0		Reviewed by:	(Elite Optz.)
Job. #: 21-EliteOptz-0009-Rev10		Page 1 of 4	

As-Built Aerial Overview of
Caza Petroleum, LLC.
Forehand Ranch 22 State 8H & 9H
Unit K, Sec. 22, T23S, R27E
2310' FSL & 2030' FWL
8H (API #30-015-43555) & 9H (API #30-015-44063)



Disclaimer: This drawing is intended for Caza Petroleum, LLC. internal purposes only and is not to be relied upon as a boundary survey or to establish real property interests. Survey information shown on this drawing was gathered between the dates of: Jan. 28, 2021 and Apr. 29, 2024. Survey information was collected using a combination of GNSS observations and geo-referenced aerial drone imagery when required. Observations refer to: NAD83 (2011) Datum, New Mexico State Plane Coordinate System, East Zone (3001), US Survey Feet, CSF=0.99990909. This drawing includes additional information that was collected from various sources including first hand observations, walk-through photos when applicable and third party information as well as information provided by Caza Petroleum, LLC. Caza Petroleum, LLC. is to verify the accuracy of all information as presented on this drawing. Elite Optimization, LP. is not responsible for design by engineer of records, erection or operation of any facilities represented by this drawing. This drawing is not an official engineering drawing or land survey drawing; this drawing is not to be used for construction.



Equipment Layout Plan up to date as of: Apr. 29, 2024

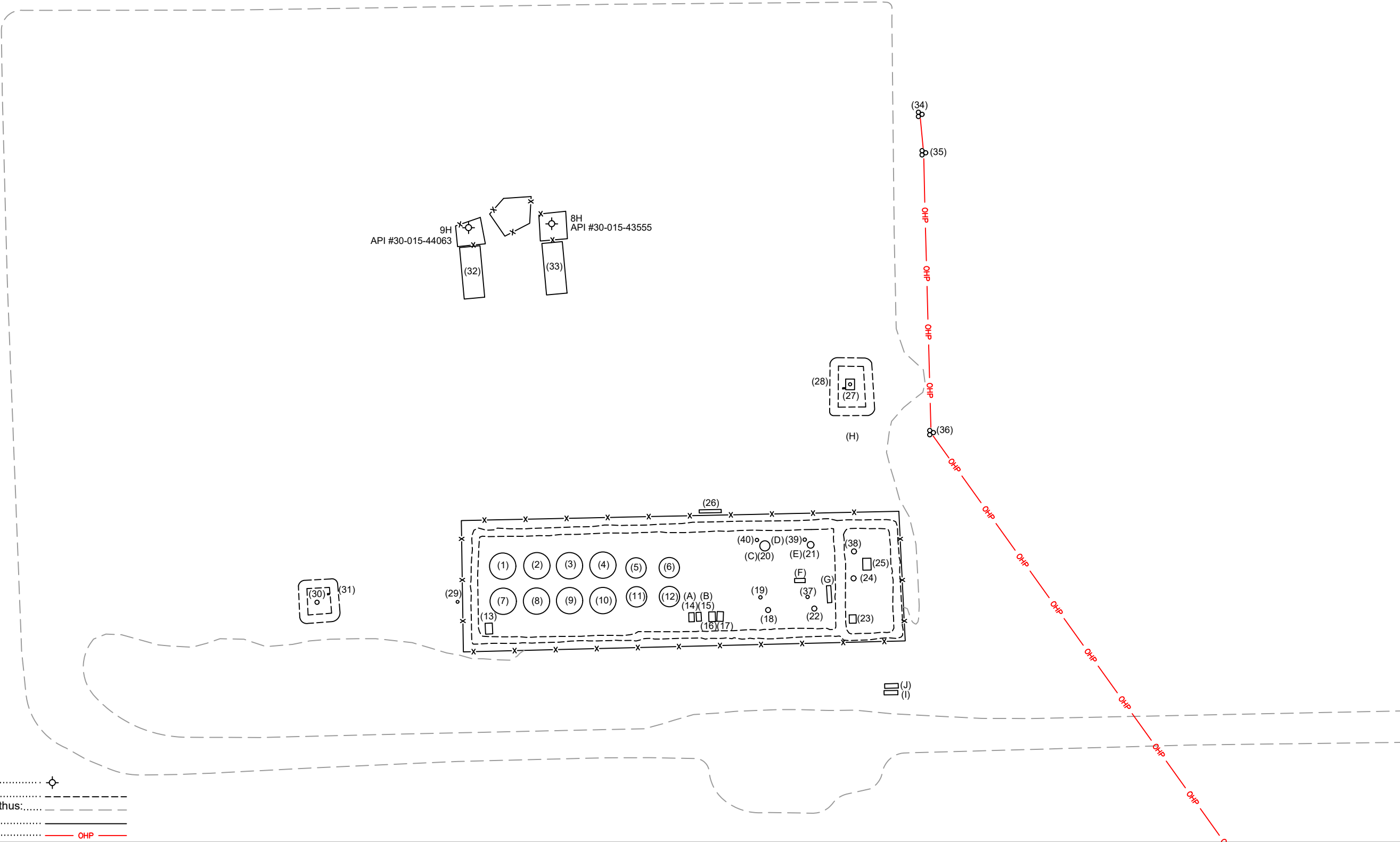

LEGEND:
Wellhead is shown thus:
Berms/Containments/Skids are shown thus:
Pad Edge/Approaches/Lease Roads are shown thus:.....
Fences are shown thus:.....
Overhead Power are shown thus:..... OHP

N

U.S. Feet
Scale 1"=60'

Rev. 8 - Issued for Information Updated Plan	Oct. 27, 2023	Drafted by: Marcos Barriga	(Elite Optz.)
Preliminary Version 0		Reviewed by:	(Elite Optz.)
Rev. 9 - Issued for Information Updated Plan	Feb. 18, 2024	Drafted by: Marcos Barriga	(Elite Optz.)
Preliminary Version 0		Reviewed by:	(Elite Optz.)
Rev. 10 - Issued for Information Updated Plan	May 2, 2024	Drafted by: Marcos Barriga	(Elite Optz.)
Preliminary Version 0		Reviewed by:	(Elite Optz.)
Job. #: 21-EliteOptz-0009-Rev10		Page 2 of 4	

As-Built Equipment Layout Plan for
Caza Petroleum, LLC.
Forehand Ranch 22 State 8H & 9H
Unit K, Sec. 22, T23S, R27E
2310' FSL & 2030' FWL
8H (API #30-015-43555) & 9H (API #30-015-44063)



Disclaimer: This drawing is intended for Caza Petroleum, LLC. internal purposes only and is not to be relied upon as a boundary survey or to establish real property interests. Survey information shown on this drawing was gathered between the dates of: Jan. 28, 2021 and Apr. 29, 2024. Survey information was collected using a combination of GNSS observations and geo-referenced aerial drone imagery when required. Observations refer to: NAD83 (2011) Datum, New Mexico State Plane Coordinate System, East Zone (3001), US Survey Feet, CSF=0.99990909. This drawing includes additional information that was collected from various sources including first hand observations, walk-through photos when applicable and third party information as well as information provided by Caza Petroleum, LLC. Caza Petroleum, LLC. is to verify the accuracy of all information as presented on this drawing. Elite Optimization, LP. is not responsible for design by engineer of records, erection or operation of any facilities represented by this drawing. This drawing is not an official engineering drawing or land survey drawing; this drawing is not to be used for construction.



ELP Ref.	Piece	Year	Manufacturer	Serial No.	Model No.	Dimensions	Additional Info.	Lat.	Long.
1	Tank	2014	Edge Manufacturing	1212-27	--	15.5 x 16 - 500 BBL	DP 8 oz	32.289026	-104.179869
2	Tank	--	Unknown	No Tag	--	--	--	32.289027	-104.179803
3	Tank	2017	Azteca Fabrication	CA1965	--	15.5 x 16 - 500 BBL	--	32.289028	-104.179739
4	Tank	2017	Azteca Fabrication	CA1968	--	15.5 x 16 - 500 BBL	--	32.289028	-104.179679
5	Tank	2008	Permian Tank	46717	--	12 x 20 - 400 BBL	DP 16 oz	32.289024	-104.179613
6	Tank	--	Unknown	No Tag	--	12 x 20 - 400 BBL	--	32.289024	-104.179551
7	Tank	2012	Smith Industries	39094	--	15.5 x 16 - 500 BBL	DP 8 oz	32.288970	-104.179867
8	Tank	2012	Smith Industries	39559	--	15.5 x 16 - 500 BBL	DP 8 oz	32.288969	-104.179802
9	Tank	2017	Azteca Fabrication	CA1966	--	15.5 x 16 - 500 BBL	--	32.288973	-104.179742
10	Tank	2017	Azteca Fabrication	CA1967	--	15.5 x 16 - 500 BBL	--	32.288971	-104.179677
11	Tank	2011	Unknown	G4264-11	--	12 x 20 - 400 BBL	--	32.288976	-104.179615
12	Tank	2011	Unknown	G4263-11	--	12 x 20 - 400 BBL	--	32.288977	-104.179550
13	Transfer Pump	--	MPX Pumps	MC14481	Pro Flo	--	1.5x3-6, 75 HP	32.288930	-104.179894
14	Transfer Pump	--	Accelerated Production	MC14483	MPX	--	7.5 HP	32.288943	-104.179507
15	Transfer Pump	--	Accelerated Production	MC14486	MPX	--	1.5x3-6, 10 HP	32.288944	-104.179494
16	Recycle Pump	--	Roper Pumps	G-972399	--	--	2 HP	32.288950	-104.179471
17	Recycle Pump	--	Roper Pumps	G-917902	--	--	2 HP	32.288949	-104.179455
18	Vert. Separator	2017	Azteca Fabrication	CA1982	--	--	MAP 1440 psi @ 150 F	32.288955	-104.179362
19	Fuel Pot	--	--	N/A	--	--	Vert. Sep. CA1982	32.288977	-104.179378
20	Vert. Heater Treater	2017	Azteca Fabrication	CA1980	--	--	MAWP 125 psi @ 120 F (9H Well)	32.289060	-104.179369
21	Vert. Heater Treater	2015	Refurbished	000-1	--	4 x 20	--	32.289061	-104.179283
22	Vert. Separator	2017	Azteca Fabrication	CA1983	--	--	MAWP 1440 psi @ 150 F	32.288957	-104.179276
23	Inlet Header	--	--	N/A	--	--	--	32.288940	-104.179202
24	Vert. Separator	2017	Azteca Fabrication	CA1981	--	--	MAWP 125 psi @ 120 F	32.289007	-104.179202
25	VRU	--	Platinum	Skid# 1348	--	--	--	32.289029	-104.179171
26	Elec. Panels	--	--	N/A	--	--	--	32.289116	-104.179477
27	Flare - HP	--	--	Not Available	--	--	--	32.289319	-104.179204
28	Flare Control	--	Ignition Management System / Platinum	2019052800031	Edge-600	--	--	32.289314	-104.179217
29	Fuel Pot	--	--	N/A	--	--	--	32.288969	-104.179955
30	Combustor	--	--	N/A	--	--	--	32.288968	-104.180220
31	Combustor Ignition Control	--	Ignition Management System / Platinum	2019082600007	Edge-600	--	--	32.288979	-104.180200
32	Pumping Unit	2014	Shores Lift Solutions	SLS14-1625	TM912D-365-168TH	--	--	32.289486	-104.179922
33	Pumping Unit	2013	Jack Artificial Lift	SLS-13-1176	TM912D-365-168TH	--	--	32.289500	-104.179765
34	Transformer (No Meter)	--	--	No Meter	--	--	(3) 25 kVa	32.289755	-104.179069
35	Transformer & Meter	--	--	Meter #30193871	--	--	(3) 37 kVa	32.289691	-104.179062
36	Transformer & Meter	--	Xcel Energy	Meter #94736000	--	--	(3) 37.5 / 42 kVa	32.289241	-104.179053
37	Fuel Pot	--	--	--	--	--	Vert Sep. CA1983	32.288977	-104.179288
38	Vert. Separator	2022	Pessco	2323	--	30 x 10	WP 250 psi, TP 325 psi	32.289051	-104.179200
39	Fuel Pot	--	--	--	--	--	Vert. Heater Treater 000-1	32.289067	-104.179296
40	Fuel Pot	--	--	--	--	--	Heater Treater CA1980	32.289067	-104.179389
A	Meter - Water	--	Turbines Inc.	12704207	--	--	--	32.288949	-104.179507
B	Meter - Water	--	Turbines Inc.	1715490	--	--	--	32.288949	-104.179495
C	Meter - Water	2019	Rosemount	14950977	8750WDMT2M1FTSA020CA1/Z5M4G1	--	Heater Treater CA1980	32.289049	-104.179394
D	Meter - Oil	--	Endress + Hauser	T80C1516000	Pro Mass 301	--	Heater Treater CA1980, Removed and off to side	32.289065	-104.179351
E	Meter - Water	2019	Rosemount	14950978	8750WDMT2M1FTSA020CA1/Z5M4G1	--	--	32.289051	-104.179311
F	Meter - Gas	--	Workhorse	3122678	--	--	ABB S/N T124800381	32.289005	-104.179303
G	Meter - Gas	--	Precision Flow	SF19617	--	--	ABB S/N T174903218	32.288982	-104.179246
H	Meter - Flare	--	Turbines Inc	2137409	--	--	--	32.289237	-104.179201
I	Meter - Gas	--	Canalta	D0302291	--	--	ABB S/N T171979037	32.288822	-104.179131
J	Meter - Gas	--	Canalta	S0223362	--	--	--	32.288837	-104.179138

Rev. 8 - Issued for Information Updated Plan

Preliminary Version 0

Oct. 27, 2023

Drafted by: Marcos Barriga (Elite Optz.)

Reviewed by: (Elite Optz.)

Approved by: (Caza Petro.)

Rev. 9 - Issued for Information Updated Plan

Preliminary Version 0

Feb. 18, 2024

Drafted by: Marcos Barriga (Elite Optz.)

Reviewed by: (Elite Optz.)

Approved by: (Caza Petro.)

Rev. 10 - Issued for Information Updated Plan

Preliminary Version 0

May 2, 2024

Drafted by: Marcos Barriga (Elite Optz.)

Reviewed by: (Elite Optz.)

Approved by: (Caza Petro.)

Job. #: 21-EliteOptz-0009-Rev10

Page 3 of 4

As-Built Equipment & Meter List for

Caza Petroleum, LLC.

Forehand Ranch 22 State 8H & 9H

Unit K, Sec. 22, T23S, R27E

2310' FSL & 2030' FWL

8H (API #30-015-43555) & 9H (API #30-015-44063)

Caza

Petroleum, LLC

Disclaimer: This drawing is intended for Caza Petroleum, LLC. internal purposes only and is not to be relied upon as a boundary survey or to establish real property interests. Survey information shown on this drawing was gathered between the dates of: Jan. 28, 2021 and Apr. 29, 2024. Survey information was collected using a combination of GNSS observations and geo-referenced aerial drone imagery when required. Observations refer to: NAD83 (2011) Datum, New Mexico State Plane Coordinate System, East Zone (3001), US Survey Feet, CSF=0.99990909 This drawing includes additional information that was collected from various sources including first hand observations, walk-through photos when applicable and third party information as well as information provided by Caza Petroleum, LLC. Caza Petroleum, LLC. is to verify the accuracy of all information as presented on this drawing. Elite Optimization, LP. is not responsible for design by engineer of records, erection or operation of any facilities represented by this drawing. This drawing is not an official engineering drawing or land survey drawing; this drawing is not to be used for construction.

ELITE

OPTIMIZATION

(Paper: 11 x 17)

Received by OCD: 10/10/2024 1:40:00 PM

Released to Imaging: 10/14/2024 10:17:29 AM

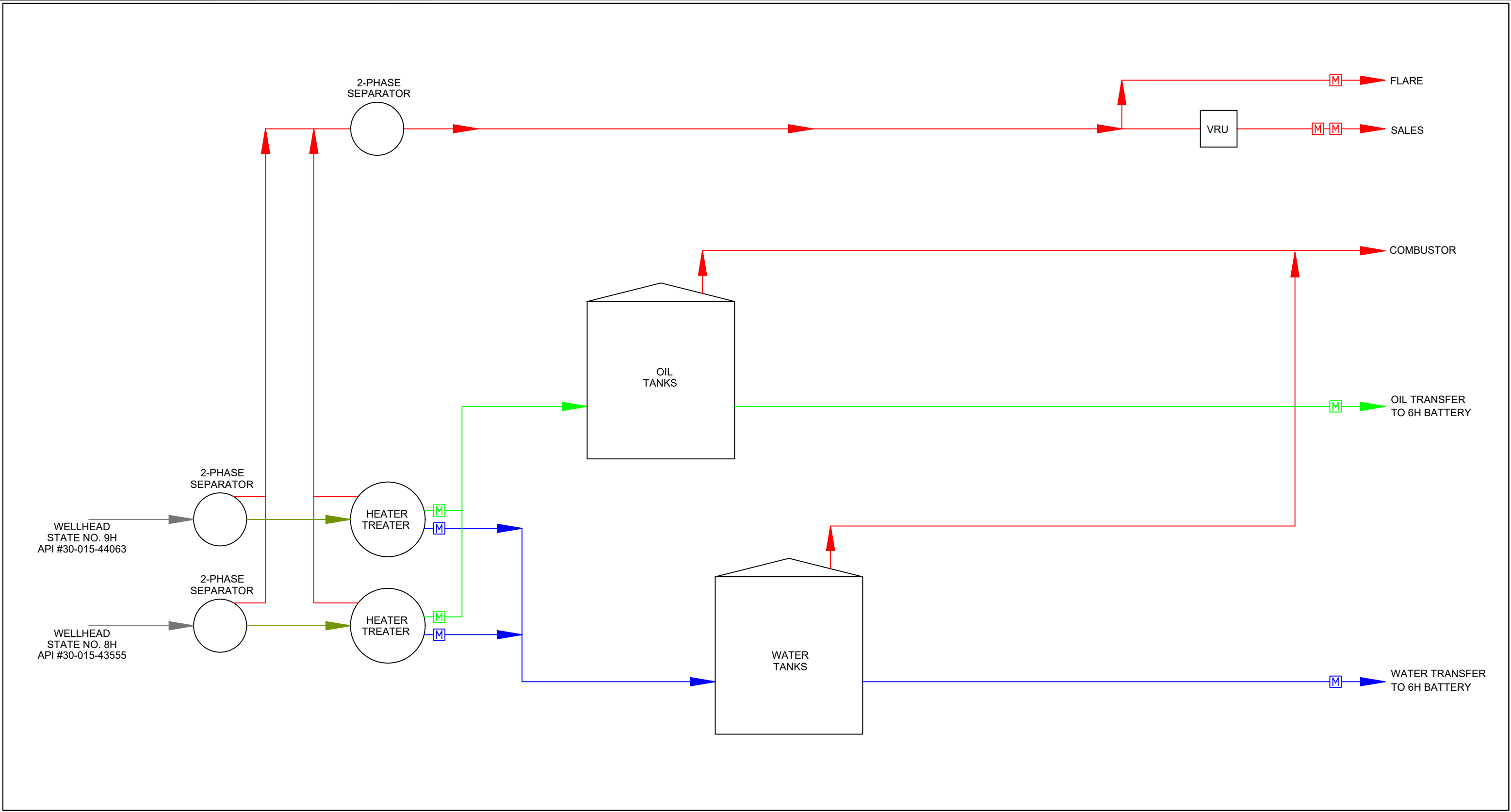

LEGEND:

Wellstream is shown thus:.....

Gas is shown thus:.....

Oil is shown thus:.....

Water is shown thus:.....

Oil & Water / Bad Oil is shown thus:.....

Gas Meter is shown thus:.....

Oil Meter is shown thus:.....

Water Meter is shown thus:.....

Rev. 8 - Issued for Information Updated Plan	Oct. 27, 2023	Drafted by: Marcos Barriga (Elite Optz.)
Preliminary Version 0		Reviewed by: (Elite Optz.)
Rev. 9 - Issued for Information Updated Plan	Feb. 18, 2024	Drafted by: Marcos Barriga (Elite Optz.)
Preliminary Version 0		Reviewed by: (Elite Optz.)
Rev. 10 - Issued for Information Updated Plan	May 2, 2024	Drafted by: Marcos Barriga (Elite Optz.)
Preliminary Version 0		Reviewed by: (Elite Optz.)
Job. #: 21-EliteOptz-0009-Rev10		Approved by: (Caza Petro.)

As-Built Process Flow Diagram for Caza Petroleum, LLC.

Forehand Ranch 22 State 8H & 9H

Unit K, Sec. 22, T23S, R27E

2310' FSL & 2030' FWL

8H (API #30-015-43555) & 9H (API #30-015-44063)

Caza Petroleum, LLC

Disclaimer: This drawing is intended for Caza Petroleum, LLC. internal purposes only and is not to be relied upon as a boundary survey or to establish real property interests. Survey information shown on this drawing was gathered between the dates of: Jan. 28, 2021 and Apr. 29, 2024. Survey information was collected using a combination of GNSS observations and geo-referenced aerial drone imagery when required. Observations refer to: NAD83 (2011) Datum, New Mexico State Plane Coordinate System, East Zone (3001), US Survey Feet, CSF=0.99990909. This drawing includes additional information that was collected from various sources including first hand observations, walk-through photos when applicable and third party information as well as information provided by Caza Petroleum, LLC. Caza Petroleum, LLC. is to verify the accuracy of all information as presented on this drawing. Elite Optimization, LP. is not responsible for design by engineer of records, erection or operation of any facilities represented by this drawing. This drawing is not an official engineering drawing or land survey drawing; this drawing is not to be used for construction.

ELITE OPTIMIZATION

District I
1625 N. French Dr., Hobbs, NM 88240
Phone:(575) 393-6161 Fax:(575) 393-0720
District II
811 S. First St., Artesia, NM 88210
Phone:(575) 748-1283 Fax:(575) 748-9720
District III
1000 Rio Brazos Rd., Aztec, NM 87410
Phone:(505) 334-6178 Fax:(505) 334-6170
District IV
1220 S. St Francis Dr., Santa Fe, NM 87505
Phone:(505) 476-3470 Fax:(505) 476-3462

State of New Mexico
Energy, Minerals and Natural Resources
Oil Conservation Division
1220 S. St Francis Dr.
Santa Fe, NM 87505

QUESTIONS

Action 391690

QUESTIONS

Operator: CAZA OPERATING, LLC 200 N Loraine St Midland, TX 79701	OGRID: 249099
	Action Number: 391690
	Action Type: [UF-FAC] TB Registration (TB-REG)

QUESTIONS

Facility Details	
<i>Please answer all the questions in this group.</i>	
Name of the facility	Forehand Ranch 22 State Nos.8H-9H Production Facility
Date the facility was opened	01/17/2018
Depth to ground water, if known	100

Verification	
Does the operator have other facilities with a matching name	No
Are there other facilites located within approximately 50 feet	No

District I
1625 N. French Dr., Hobbs, NM 88240
Phone:(575) 393-6161 Fax:(575) 393-0720
District II
811 S. First St., Artesia, NM 88210
Phone:(575) 748-1283 Fax:(575) 748-9720
District III
1000 Rio Brazos Rd., Aztec, NM 87410
Phone:(505) 334-6178 Fax:(505) 334-6170
District IV
1220 S. St Francis Dr., Santa Fe, NM 87505
Phone:(505) 476-3470 Fax:(505) 476-3462

State of New Mexico
Energy, Minerals and Natural Resources
Oil Conservation Division
1220 S. St Francis Dr.
Santa Fe, NM 87505

ACKNOWLEDGMENTS

Action 391690

ACKNOWLEDGMENTS

Operator: CAZA OPERATING, LLC 200 N Loraine St Midland, TX 79701	OGRID: 249099
	Action Number: 391690
	Action Type: [UF-FAC] TB Registration (TB-REG)

ACKNOWLEDGMENTS

<input checked="" type="checkbox"/>	I certify that I am authorized to register a facility on behalf of the responsible operator.
<input checked="" type="checkbox"/>	I certify that I will notify OCD of any changes of ownership for this facility.
<input checked="" type="checkbox"/>	I certify that I will notify OCD when this facility is closed.