

Drone Imagery Date: Sept. 5, 2023



N

U.S. Feet

Scale 1"=50'

Rev. 5 - Issued for Information Updated Plan	August 1, 2023	Drafted by: Marcos Barriga (Elite Optz.)
Preliminary Version 0		Reviewed by: (Caza Petro.)
Rev. 6 - Issued for Information Updated Plan	Oct. 2, 2023	Drafted by: Marcos Barriga (Elite Optz.)
Preliminary Version 0		Reviewed by: (Caza Petro.)
Rev. 7 - Issued for Information Updated Plan	Oct. 12, 2023	Drafted by: Marcos Barriga (Elite Optz.)
Preliminary Version 0		Reviewed by: (Caza Petro.)
Job. #: 21-EliteOptz-0042-Rev7		Approved by: (Caza Petro.)

Aerial As-Built Overview of

Caza Petroleum, LLC.

Igloo 19 State 1H, 3H & 4H

Tank Battery

Unit O, Sec. 19, T20S, R35E

1H (API #30-025-42356), 3H (API #30-025-42357) & 4H (API #30-025-42358)

Caza
Petroleum, LLC

Disclaimer: This drawing is intended for Caza Petroleum, LLC. internal purposes only and is not to be relied upon as a boundary survey or to establish real property interests. Survey information shown on this drawing was gathered between the dates of: Nov. 13, 2021 and Oct. 5, 2023. Survey information was collected using a combination of GNSS observations and geo-referenced aerial drone imagery when required. Observations refer to: NAD83 (2011) Datum, New Mexico State Plane Coordinate System, East Zone (3001), US Survey Feet, CSF=0.99990909. This drawing includes additional information that was collected from various sources including first hand observations, walk-through photos when applicable and third party information as well as information provided by Caza Petroleum, LLC. Caza Petroleum, LLC. is to verify the accuracy of all information as presented on this drawing. Elite Optimization, LP. is not responsible for design by engineer of records, erection or operation of any facilities represented by this drawing. This drawing is not an official engineering drawing or land survey drawing; this drawing is not to be used for construction.

Equipment Layout Plan up to date as of: Oct. 5, 2023

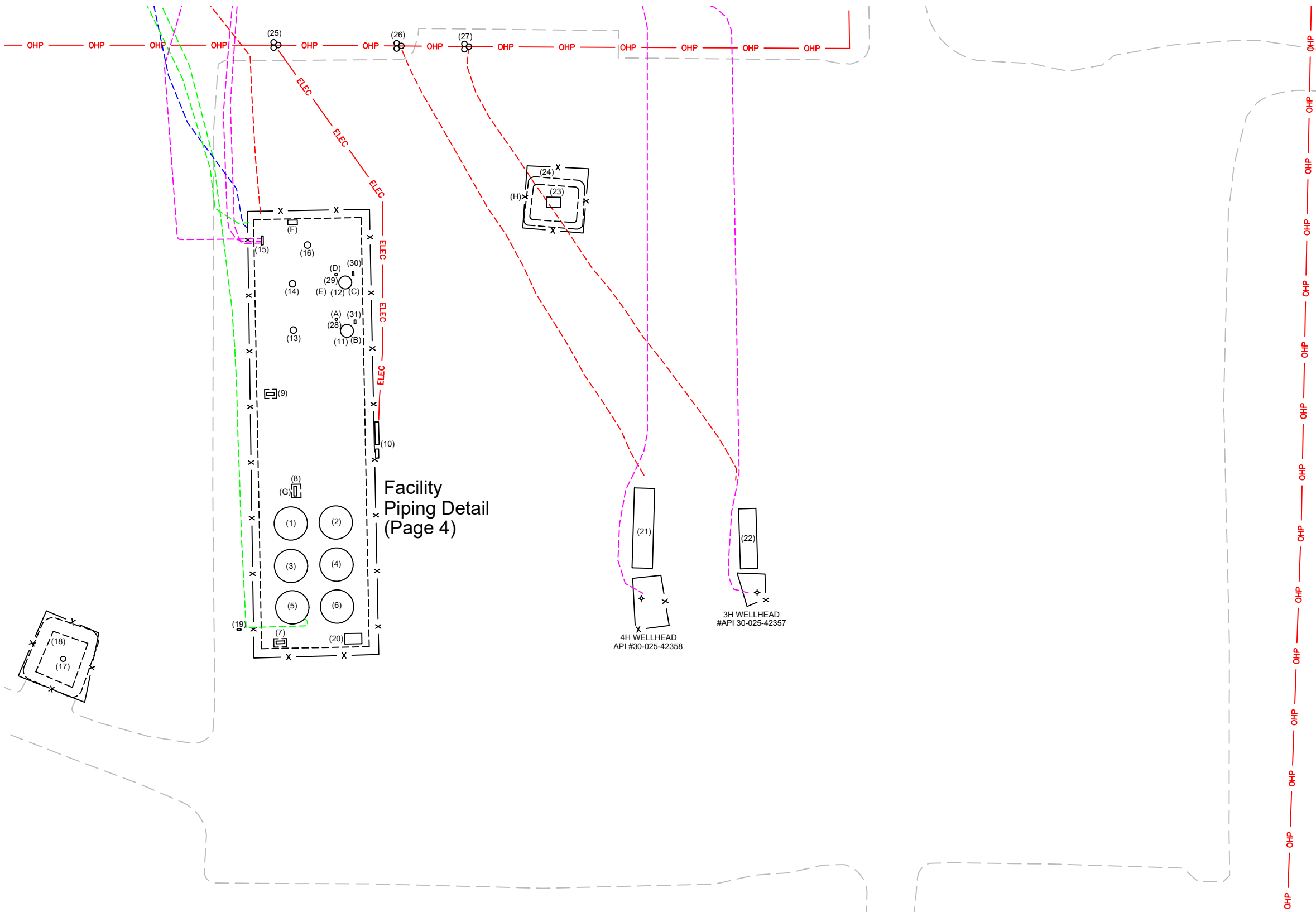

- LEGEND:**
- Wellhead is shown thus:
 - Berms/Containments/Skids are shown thus:
 - Pad Edge is shown thus:
 - Fences are shown thus:
 - As-built UG Flowline is shown thus:
 - As-built UG Oil Line is shown thus:
 - As-built UG Water Line is shown thus:
 - As-built UG Gas Line is shown thus:
 - As-built UG Oil & Water Line is shown thus:
 - As-built AG Oil Line is shown thus:
 - As-built AG Water Line is shown thus:
 - As-built AG Gas Line is shown thus:
 - As-built AG Oil & Water Line is shown thus:

N

U.S. Feet
Scale 1"=50'

Rev. 5 - Issued for Information Updated Plan	August 1, 2023	Drafted by: Marcos Barriga	(Elite Optz.)
Preliminary Version 0		Reviewed by:	(Caza Petro.)
Rev. 6 - Issued for Information Updated Plan	Oct. 2, 2023	Drafted by: Marcos Barriga	(Elite Optz.)
Preliminary Version 0		Reviewed by:	(Caza Petro.)
Rev. 7 - Issued for Information Updated Plan	Oct. 12, 2023	Drafted by: Marcos Barriga	(Elite Optz.)
Preliminary Version 0		Reviewed by:	(Caza Petro.)
Job. #: 21-EliteOptz-0042-Rev7		Page 2 of 5	

As-Built Equipment Layout Plan for
Caza Petroleum, LLC.
Igloo 19 State 1H, 3H & 4H
Tank Battery
Unit O, Sec. 19, T20S, R35E
1H (API #30-025-42356), 3H (API #30-025-42357) & 4H (API #30-025-42358)

Disclaimer: This drawing is intended for Caza Petroleum, LLC. internal purposes only and is not to be relied upon as a boundary survey or to establish real property interests. Survey information shown on this drawing was gathered between the dates of: Nov. 13, 2021 and Oct. 5, 2023. Survey information was collected using a combination of GNSS observations and geo-referenced aerial drone imagery when required. Observations refer to: NAD83 (2011) Datum, New Mexico State Plane Coordinate System, East Zone (3001), US Survey Feet, CSF=0.99990909. This drawing includes additional information that was collected from various sources including first hand observations, walk-through photos when applicable and third party information as well as information provided by Caza Petroleum, LLC. Caza Petroleum, LLC. is to verify the accuracy of all information as presented on this drawing. Elite Optimization, LP. is not responsible for design by engineer of records, erection or operation of any facilities represented by this drawing. This drawing is not an official engineering drawing or land survey drawing; this drawing is not to be used for construction.

Ref.	Piece	Year	Manufacturer	Serial No.	Model No.	Dimensions	Additional Info.	Long.	Lat.
1	Water Tank	2018	Wolfberry MFG	J414-4-0155	--	15.5 x 16 - 500 BBL	DP 8 oz	-103.494580	32.552029
2	Water Tank	2013	Edge Manufacturing	ST1169-P	--	15.5 x 16 - 500 BBL	DP 8 oz	-103.494512	32.552030
3	Oil Tank	2017	Wolfberry MFG	J414-5-0142	--	15.5 x 16 - 500 BBL	DP 8 oz	-103.494579	32.551977
4	Oil Tank	2017	Wolfberry MFG	J414-5-0149	--	15.5 x 16 - 500 BBL	DP 8 oz	-103.494511	32.551978
5	Oil Tank	2017	Wolfberry MFG	J414-5-0143	--	15.5 x 16 - 500 BBL	DP 8 oz, Igloo State #2H	-103.494579	32.551923
6	Oil Tank	2017	Wolfberry MFG	J414-5-0146	--	15.5 x 16 - 500 BBL	DP 8 oz	-103.494512	32.551924
7	Transfer Pump	--	Replicate Pumps	10627D	5196	--	1.5 x 3-8, 20HP	-103.494596	32.551879
8	Water Pump	2018	Goulds Pumps	N745H922-2	--	--	7.5HP	-103.494570	32.552076
9	Recycle Pump	--	--	No Tag	--	--	1.5HP	-103.494609	32.552200
10	Panel Racks	--	--	N/A	--	--	--	-103.494447	32.552138
11	Vert. Heater Treater	2021	Pessco	2037	--	6 x 20	WP 125 psi, TP 200 psi	-103.494493	32.552278
12	Vert. Heater Treater	2021	Pessco	2038	--	6 x 20	WP 125 psi, TP 200 psi	-103.494491	32.552340
13	Vert. Separator	2021	Pessco	2040	--	36 x 10	WP 250 psi, TP 325 psi	-103.494574	32.552280
14	Vert. Separator	2021	Pessco	2039	--	36 x 10	WP 250 psi, TP 325 psi	-103.494574	32.552340
15	Inlet Header	--	--	N/A	--	--	--	-103.494612	32.552399
16	Flare Scrubber	2019	Fox Tank	1127	--	30 x 10	DP 125 psi, 2PH	-103.494551	32.552388
17	Combustor	--	--	N/A	--	--	--	-103.494926	32.551860
18	Combustor Ignition Control	--	Ignition Management / Platinum Control	2019052800017	Edge-600	--	--	-103.494936	32.551889
19	Jatco Pot	--	Jatco Inc.	N/A	J-5000CX	--	--	-103.494661	32.551892
20	VRU	2021	Platinum	PVR-2022	--	--	--	-103.494487	32.551884
21	Pumping Unit	2013	Shores Lift	SJ13-8045	C640-385-168TL	--	Igloo State #4H	-103.494047	32.552024
22	Pumping Unit	2017	Lufkin Industries	1710130G0640365162	CG-640D-365-168	--	Igloo State #3H	-103.493886	32.552005
23	HP Flare	--	--	Not Available	--	--	--	-103.494177	32.552442
24	Combustor Ignition Control	--	Ignition Management / Platinum Control	2019052800023	Edge-600	--	--	-103.494193	32.552477
25	Transformer (No Meter)	--	--	No Meter	--	--	(3) 75/84 kVA	-103.494601	32.552645
26	Transformer (No Meter)	--	--	No Meter	--	--	(3) 37.5 kVA	-103.494411	32.552648
27	Transformer (No Meter)	--	--	No Meter	--	--	(3) 37.5 kVA	-103.494308	32.552647
28	Fuel Pot	--	--	--	--	--	Heater Treater 2037	-103.494508	32.552293
29	Fuel Pot	--	--	--	--	--	Heater Treater 2038	-103.494509	32.552351
30	Control Box	--	Platinum	2021102200023	--	--	Heater Treater 02038	-103.494482	32.552351
31	Control Box	--	Platinum	2019071100010	--	--	Heater Treater 02037	-103.494480	32.552293
A	Meter - Water	2019	Rosemount	14944618	8750WDMT2M1FTSA020CA1/Z5M4G1	--	--	-103.494512	32.552296
B	Meter - Oil	--	Endress + Hauser	T5OA251600	Promass 300	--	--	-103.494486	32.552258
C	Meter - Oil	--	Endress + Hauser	TA0C1416000	Promass 300	--	--	-103.494487	32.552326
D	Meter - Water	--	Turbines Inc.	2129176	E-Series	--	--	-103.494514	32.552358
E	Meter - Gas	2021	Turbines Inc.	F17886	--	--	--	-103.494529	32.552321
F	Meter - Gas	--	Precision Solo Flow	SF22286	Precision 14.3	--	ABB S/N T212433174	-103.494574	32.552418
G	Meter - Water	--	NuFlo	12184121846	NUFLO MC-III	--	--	-103.494579	32.552067
H	Meter - Flare	--	Turbines Inc.	2216187	F103-P-AH-CH-HGL-IB-IG-OG-PB-PX-XN-ZU-1TO	--	--	-103.494216	32.552441

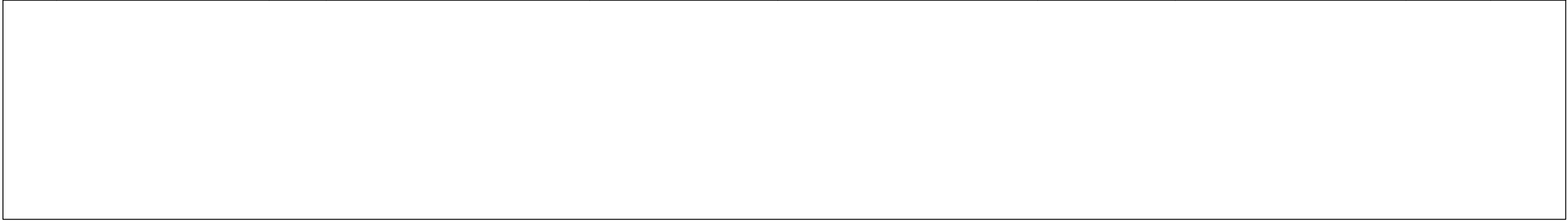

Rev. 5 - Issued for Information Updated Plan

Preliminary Version 0

August 1, 2023

Oct. 2, 2023

Drafted by: Marcos Barriga (Elite Optz.)

Reviewed by: (Caza Petro.)

Approved by: (Caza Petro.)

Rev. 6 - Issued for Information Updated Plan

Preliminary Version 0

Oct. 2, 2023

Oct. 12, 2023

Drafted by: Marcos Barriga (Elite Optz.)

Reviewed by: (Caza Petro.)

Approved by: (Caza Petro.)

Rev. 7 - Issued for Information Updated Plan

Preliminary Version 0

Oct. 12, 2023

Drafted by: Marcos Barriga (Elite Optz.)

Reviewed by: (Elite Optz.)

Approved by: (Caza Petro.)

Job. #: 21-EliteOptz-0042-Rev7

Page 3 of 5

As-Built Equipment & Meter List for

Caza Petroleum, LLC.

Igloo 19 State 1H, 3H & 4H

Tank Battery

Unit O, Sec. 19, T20S, R35E

1H (API #30-025-42356), 3H (API #30-025-42357) & 4H (API #30-025-42358)

Disclaimer: This drawing is intended for Caza Petroleum, LLC. internal purposes only and is not to be relied upon as a boundary survey or to establish real property interests. Survey information shown on this drawing was gathered between the dates of: Nov. 13, 2021 and Oct. 5, 2023. Survey information was collected using a combination of GNSS observations and geo-referenced aerial drone imagery when required. Observations refer to: NAD83 (2011) Datum, New Mexico State Plane Coordinate System, East Zone (3001), US Survey Feet, CSF=0.99990909 This drawing includes additional information that was collected from various sources including first hand observations, walk-through photos when applicable and third party information as well as information provided by Caza Petroleum, LLC. Caza Petroleum, LLC. is to verify the accuracy of all information as presented on this drawing. Elite Optimization, LP. is not responsible for design by engineer of records, erection or operation of any facilities represented by this drawing. This drawing is not an official engineering drawing or land survey drawing; this drawing is not to be used for construction.

Page 4 of 7
Received by OCD: 10/14/2024 2:04:43 PM
Released to Imaging: 10/14/2024 2:16:34 PM

Piping Detail is up to date as of: Sept. 5, 2023

LEGEND:
Berms/Containments/Skids are shown thus:
Pad Edge is shown thus:
Fences are shown thus: X
As-built UG Flowline is shown thus:
As-built UG Oil Line is shown thus:
As-built UG Water Line is shown thus:
As-built UG Gas Line is shown thus:
As-built UG Oil & Water Line is shown thus:
As-built AG Oil Line is shown thus:
As-built AG Water Line is shown thus:
As-built AG Gas Line is shown thus:
As-built AG Oil & Water Line is shown thus:
Valve Open is shown thus:
Valve Closed is shown thus:
Valve that varies Open/Closed is shown thus:

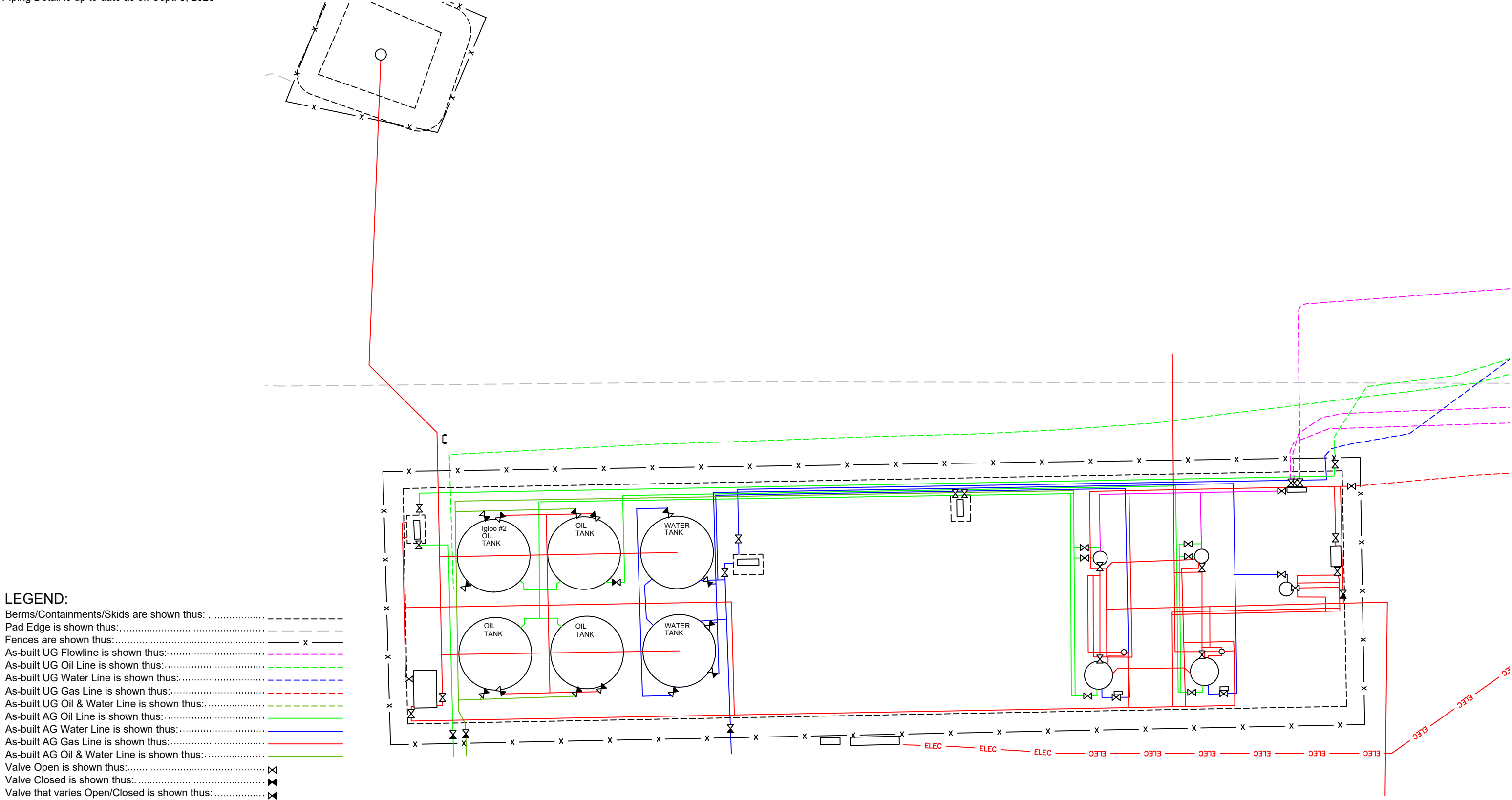

U.S. Feet
Scale 1"=20'

Rev. 5 - Issued for Information Updated Plan	August 1, 2023	Drafted by: Marcos Barriga	(Elite Optz.)
Preliminary Version 0		Reviewed by:	(Caza Petro.)
Rev. 6 - Issued for Information Updated Plan	Oct. 2, 2023	Drafted by: Marcos Barriga	(Elite Optz.)
Preliminary Version 0		Reviewed by:	(Caza Petro.)
Rev. 7 - Issued for Information Updated Plan	Oct. 12, 2023	Drafted by: Marcos Barriga	(Elite Optz.)
Preliminary Version 0		Reviewed by:	(Elite Optz.)
		Approved by:	(Caza Petro.)

Job. #: 21-EliteOptz-0042-Rev7

Page 4 of 5

As-Built Piping Detail for
Caza Petroleum, LLC.
Igloo 19 State 1H, 3H & 4H
Tank Battery
Unit O, Sec. 19, T20S, R35E
1H (API #30-025-42356), 3H (API #30-025-42357) & 4H (API #30-025-42358)



Disclaimer: This drawing is intended for Caza Petroleum, LLC. internal purposes only and is not to be relied upon as a boundary survey or to establish real property interests. Survey information shown on this drawing was gathered between the dates of: Nov. 13, 2021 and Oct. 5, 2023. Survey information was collected using a combination of GNSS observations and geo-referenced aerial drone imagery when required. Observations refer to: NAD83 (2011) Datum, New Mexico State Plane Coordinate System, East Zone (3001), US Survey Feet, CSF=0.99990909. This drawing includes additional information that was collected from various sources including first hand observations, walk-through photos when applicable and third party information as well as information provided by Caza Petroleum, LLC. Caza Petroleum, LLC. is to verify the accuracy of all information as presented on this drawing. Elite Optimization, LP. is not responsible for design by engineer of records, erection or operation of any facilities represented by this drawing. This drawing is not an official engineering drawing or land survey drawing; this drawing is not to be used for construction.



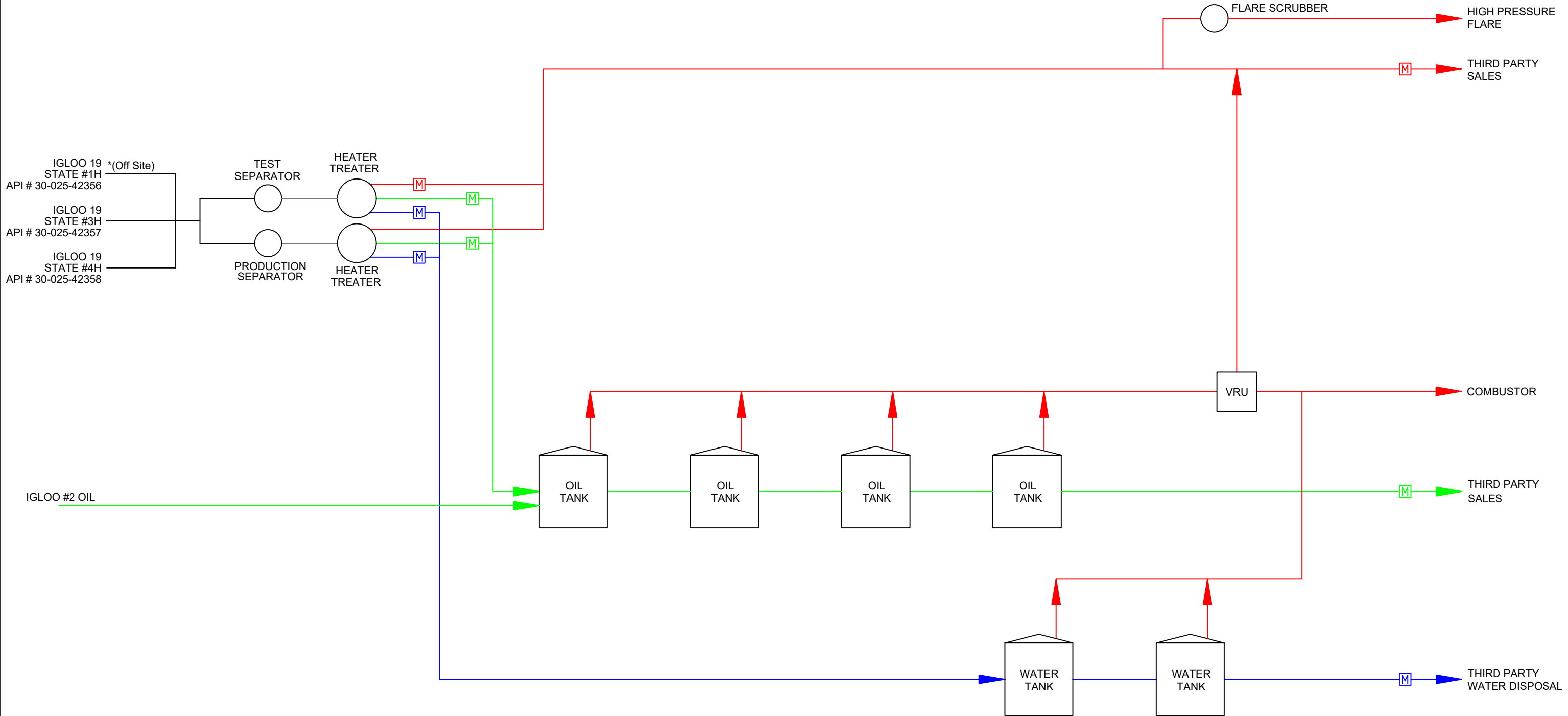

LEGEND:

Wellstream is shown thus:.....	—
Gas is shown thus:.....	—
Oil is shown thus:.....	—
Water is shown thus:.....	—
Oil & Water / Bad Oil is shown thus:.....	—
Gas Meter is shown thus:.....	[M]
Oil Meter is shown thus:.....	[M]
Water Meter is shown thus:.....	[M]

Rev. 5 - Issued for Information Updated Plan	August 1, 2023	Drafted by: Marcos Barriga (Elite Optz.)	Reviewed by: (Caza Petro.)
Preliminary Version 0		Approved by: (Caza Petro.)	
Rev. 6 - Issued for Information Updated Plan	Oct. 2, 2023	Drafted by: Marcos Barriga (Elite Optz.)	Reviewed by: (Caza Petro.)
Preliminary Version 0		Approved by: (Caza Petro.)	
Rev. 7 - Issued for Information Updated Plan	Oct. 12, 2023	Drafted by: Marcos Barriga (Elite Optz.)	Reviewed by: (Elite Optz.)
Preliminary Version 0		Approved by: (Caza Petro.)	
Job. #: 21-EliteOptz-0042-Rev7			

As-Built Process Flow Diagram for Caza Petroleum, LLC.
Igloo 19 State 1H, 3H & 4H Tank Battery
Unit O, Sec. 19, T20S, R35E
1H (API #30-025-42356), 3H (API #30-025-42357) & 4H (API #30-025-42358)



Disclaimer: This drawing is intended for Caza Petroleum, LLC. internal purposes only and is not to be relied upon as a boundary survey or to establish real property interests. Survey information shown on this drawing was gathered between the dates of: Nov. 13, 2021 and Oct. 5, 2023. Survey information was collected using a combination of GNSS observations and geo-referenced aerial drone imagery when required. Observations refer to: NAD83 (2011) Datum, New Mexico State Plane Coordinate System, East Zone (3001), US Survey Feet, CSF=0.99990909. This drawing includes additional information that was collected from various sources including first hand observations, walk-through photos when applicable and third party information as well as information provided by Caza Petroleum, LLC. Caza Petroleum, LLC. is to verify the accuracy of all information as presented on this drawing. Elite Optimization, LP. is not responsible for design by engineer of records, erection or operation of any facilities represented by this drawing. This drawing is not an official engineering drawing or land survey drawing; this drawing is not to be used for construction.

District I
1625 N. French Dr., Hobbs, NM 88240
Phone:(575) 393-6161 Fax:(575) 393-0720
District II
811 S. First St., Artesia, NM 88210
Phone:(575) 748-1283 Fax:(575) 748-9720
District III
1000 Rio Brazos Rd., Aztec, NM 87410
Phone:(505) 334-6178 Fax:(505) 334-6170
District IV
1220 S. St Francis Dr., Santa Fe, NM 87505
Phone:(505) 476-3470 Fax:(505) 476-3462

State of New Mexico
Energy, Minerals and Natural Resources
Oil Conservation Division
1220 S. St Francis Dr.
Santa Fe, NM 87505

QUESTIONS

Action 392475

QUESTIONS

Operator: CAZA OPERATING, LLC 200 N Loraine St Midland, TX 79701	OGRID: 249099
	Action Number: 392475
	Action Type: [UF-FAC] TB Registration (TB-REG)

QUESTIONS

Facility Details	
<i>Please answer all the questions in this group.</i>	
Name of the facility	Igloo 19 State Nos. 1H 3H 4H Production Facility
Date the facility was opened	11/09/2016
Depth to ground water, if known	64

Verification	
Does the operator have other facilities with a matching name	No
Are there other facilites located within approximately 50 feet	No

District I
1625 N. French Dr., Hobbs, NM 88240
Phone:(575) 393-6161 Fax:(575) 393-0720
District II
811 S. First St., Artesia, NM 88210
Phone:(575) 748-1283 Fax:(575) 748-9720
District III
1000 Rio Brazos Rd., Aztec, NM 87410
Phone:(505) 334-6178 Fax:(505) 334-6170
District IV
1220 S. St Francis Dr., Santa Fe, NM 87505
Phone:(505) 476-3470 Fax:(505) 476-3462

State of New Mexico
Energy, Minerals and Natural Resources
Oil Conservation Division
1220 S. St Francis Dr.
Santa Fe, NM 87505

ACKNOWLEDGMENTS

Action 392475

ACKNOWLEDGMENTS

Operator: CAZA OPERATING, LLC 200 N Loraine St Midland, TX 79701	OGRID: 249099
	Action Number: 392475
	Action Type: [UF-FAC] TB Registration (TB-REG)

ACKNOWLEDGMENTS

<input checked="" type="checkbox"/>	I certify that I am authorized to register a facility on behalf of the responsible operator.
<input checked="" type="checkbox"/>	I certify that I will notify OCD of any changes of ownership for this facility.
<input checked="" type="checkbox"/>	I certify that I will notify OCD when this facility is closed.