

District I  
1625 N. French Dr., Hobbs, NM 88240  
District II  
811 S. First St., Artesia, NM 88210  
District III  
1000 Rio Brazos Road, Aztec, NM 87410  
District IV  
1220 S. St. Francis Dr., Santa Fe, NM 87505

State of New Mexico  
Energy Minerals and Natural  
Resources Department  
  
Oil Conservation Division  
1220 South St. Francis Dr.  
Santa Fe, NM 87505

Form C-141  
Revised August 24, 2018  
Submit to appropriate OCD District office

Incident ID	NPAC0727726121
District RP	
Facility ID	
Application ID	

## Closure

The responsible party must attach information demonstrating they have complied with all applicable closure requirements and any conditions or directives of the OCD. This demonstration should be in the form of a comprehensive report (electronic submittals in .pdf format are preferred) including a scaled site map, sampling diagrams, relevant field notes, photographs of any excavation prior to backfilling, laboratory data including chain of custody documents of final sampling, and a narrative of the remedial activities. Refer to 19.15.29.12 NMAC.

**Closure Report Attachment Checklist:** *Each of the following items must be included in the closure report.*

- ☒ A scaled site and sampling diagram as described in 19.15.29.11 NMAC
- ☐ Photographs of the remediated site prior to backfill or photos of the liner integrity if applicable (Note: appropriate OCD District office must be notified 2 days prior to liner inspection). **No photos available as this spill is from 2007.**
- ☒ Laboratory analyses of final sampling (Note: appropriate ODC District office must be notified 2 days prior to final sampling)
- ☒ Description of remediation activities

**Please see attached closure report which was already approved as noted by the final C-141 at the end of the report.**

I hereby certify that the information given above is true and complete to the best of my knowledge and understand that pursuant to OCD rules and regulations all operators are required to report and/or file certain release notifications and perform corrective actions for releases which may endanger public health or the environment. The acceptance of a C-141 report by the OCD does not relieve the operator of liability should their operations have failed to adequately investigate and remediate contamination that pose a threat to groundwater, surface water, human health or the environment. In addition, OCD acceptance of a C-141 report does not relieve the operator of responsibility for compliance with any other federal, state, or local laws and/or regulations. The responsible party acknowledges they must substantially restore, reclaim, and re-vegetate the impacted surface area to the conditions that existed prior to the release or their final land use in accordance with 19.15.29.13 NMAC including notification to the OCD when reclamation and re-vegetation are complete.

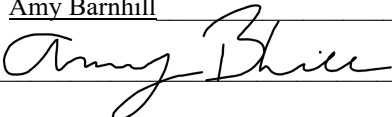
Printed Name: Amy Barnhill Title: Waste and Water Specialist  
Signature:  Date: 8-11-21  
email: [ABarnhill@chevron.com](mailto:ABarnhill@chevron.com) Telephone: 432-687-7108

Incident ID	
District RP	
Facility ID	
Application ID	

**OCD Only**

Received by: \_\_\_\_\_ Date: \_\_\_\_\_

Closure approval by the OCD does not relieve the responsible party of liability should their operations have failed to adequately investigate and remediate contamination that poses a threat to groundwater, surface water, human health, or the environment nor does not relieve the responsible party of compliance with any other federal, state, or local laws and/or regulations.

Closure Approved by: Jennifer Nobui Date: 03/31/2022

Printed Name: Jennifer Nobui Title: Environmental Specialist A

# Ocotillo ENVIRONMENTAL

Dirt Work • On-Site Remediation • Soil Testing • Excavation

## RECEIVED

January 24, 2008

JAN 30 2008

Mr. Larry Johnson  
Environmental Engineer  
Oil Conservation Division  
New Mexico Energy, Minerals and Natural Resources Department  
1625 N. French Drive  
Hobbs, New Mexico 88240

## HOBBS OCD

**Re: Spill Remediation Report, Lovington Paddock Unit #7,  
Unit Letter P (SE/4, SE/4), Section 25, Township 16 South, Range 36 East,  
Lea County, New Mexico  
(Latitude: N 32 deg. 53 min. 12.85 sec. / Longitude: W 103 deg. 18 min. 1.02 sec.)  
IRP #1604**

Dear Mr. Johnson:

Chevron MidContinent SBU (Chevron) has retained Ocotillo Environmental, LLC (Ocotillo) to remediate impacts to soil from a leak at an injection line located approximately 75 feet east of the Lovington Paddock Unit #7 well. The well is located in the southeast quarter (SE/4) of the southeast quarter (SE/4), Section 25, Township 16 South, Range 36 East, Lea County, New Mexico (Site). Approximately 20 barrels of produced water was released from the injection line on September 26, 2007, and approximately 15 barrels was recovered from the site. A C-141 was submitted to the New Mexico Oil Conservation Division (NMOCD) on October 1, 2007. A Spill Investigation Workplan was submitted to the NMOCD on October 4, 2007, and verbal approval of the plan was granted on October 11, 2007. A Spill Remediation Workplan was submitted to the NMOCD on December 10, 2007, and approval was granted on December 14, 2007. Figure 1 shows the site location.

Based on published literature (1961), well records of the New Mexico State Engineer, and well records of the United States Geological Survey, groundwater occurs at approximately 65 feet bgs in the well located nearest the Site. No domestic water wells are located within 1,000 feet of the site. The NMOCD has established recommended remediation action levels (RRALs) for benzene, total BTEX and TPH resulting from spills of natural gas liquids ("Guidelines for Remediation of Leaks, Spills and Releases, August 13, 1993"). Remediation levels for benzene, total BTEX and TPH were calculated using the following NMOCD criteria:

Criteria	Result	Ranking Score
Depth-to-Groundwater	50 - 99 Feet	10
Wellhead Protection Area	No	0
Distance to Surface Water Body	>1000 Horizontal Feet	0
<b>Total:</b>		<b>10</b>

OK to  
Close  
Chris Williams  
1/30/08  
RPT #1604

P.O. Box 1816 • Hobbs, NM 88241  
Office (505) 393-6371 • Fax (505) 393-6374



Mr. Larry Johnson  
Page 2  
January 24, 2008

The following RRALs have been assigned based on NMOCD criteria:

<b>Benzene</b>	<b>10 mg/kg</b>
<b>Total BTEX</b>	<b>50 mg/kg</b>
<b>TPH</b>	<b>1,000 mg/kg</b>

#### **Initial Investigation**

On November 13, 2007, Ocotillo installed five (5) soil borings (BH-1 through BH-5) at the site in order to assess the horizontal and vertical limits of the spill. Soil had been previously scraped from the surface of the spill area to a depth of approximately one foot below ground surface (bgs) and stockpiled on site. Figure 2 shows the locations of the soil borings.

As reported in the Spill Remediation Workplan, TPH concentrations in all samples were below the RRAL of 1,000 mg/kg. Chloride concentrations in samples from borings BH-1, BH-4 and BH-5 were all below the RRAL of 250 mg/kg. The sample from boring BH-2 at a depth of 0-2' bgs reported a chloride concentration of 3,200 mg/kg. All other samples from boring BH-2 reported chloride concentrations below 250 mg/kg.

#### **Remediation Activities**

On January 14, 2008, a soil sample was collected from the present surface (1 foot bgs) in the area of boring BH-1, and submitted to Cardinal Laboratory (Cardinal) for chloride analysis. The laboratory reported a chloride concentration of 4,480 mg/kg. On January 15, 2008, Ocotillo began excavation of the impacted soil in the vicinity of boring BH-2. Soil was excavated to a depth of approximately 2.5 to 3 feet bgs until soil samples were collected from the bottom (SS-1, SS-2 and SS-3) and sides (N Comp, S Comp, and E Comp) of the excavation for laboratory analysis of chlorides. Table 1 provides a summary of the laboratory results. Figure 2 shows the sample locations. Appendix A provides a copy of the laboratory reports and chain of custody documentation.

Referring to Table 1, soil samples collected from the bottom (SS-1, SS-2 and SS-3), north (N Comp), and east (E Comp) sides reported chloride concentrations above 250 mg/kg. Excavation continued in the vicinity of boring BH-2 on January 16, 2008, until confirmation samples were collected from the bottom (SS-4, SS-5 and SS-6), north and east sides of the excavation. Soil was also excavated from the area of boring BH-1 to a depth of approximately 2 feet bgs until a confirmation sample was collected. All samples were delivered to Cardinal for laboratory analysis of chlorides. Table 1 provides a summary of the laboratory results. Figure 2 shows the sample locations. Appendix A provides a copy of the laboratory reports and chain of custody documentation.

Referring to Table 1, final samples collected from the area of borings BH-1 and BH-2 reported chloride concentrations below 250 mg/kg.

All stockpiled and newly excavated soil (approximately 360 yards) was removed from the site to an NMOCD approved disposal facility. The excavation was backfilled with soil from the New Mexico State Pit #294.

Mr. Larry Johnson  
Page 3  
January 24, 2008

Chevron respectfully requests that the Lovington Paddock #7 site be closed by the NMOCD. A final C141 form is attached as the last page of this report.

If you have any questions or need additional information, please call Mr. Larry Ridenour at (505) 396-4414 x102, or myself at (505) 441-7244. We may also be reached by email at [Lridenour@chevron.com](mailto:Lridenour@chevron.com) or [Cindy.Crain@gmail.com](mailto:Cindy.Crain@gmail.com).

Sincerely,  
***Ocotillo Environmental, LLC***

A handwritten signature in cursive script, reading "Cindy K. Crain".

Cindy K. Crain, P.G.  
Environmental Manager

cc: Larry Ridenour, Chevron

## **FIGURES**



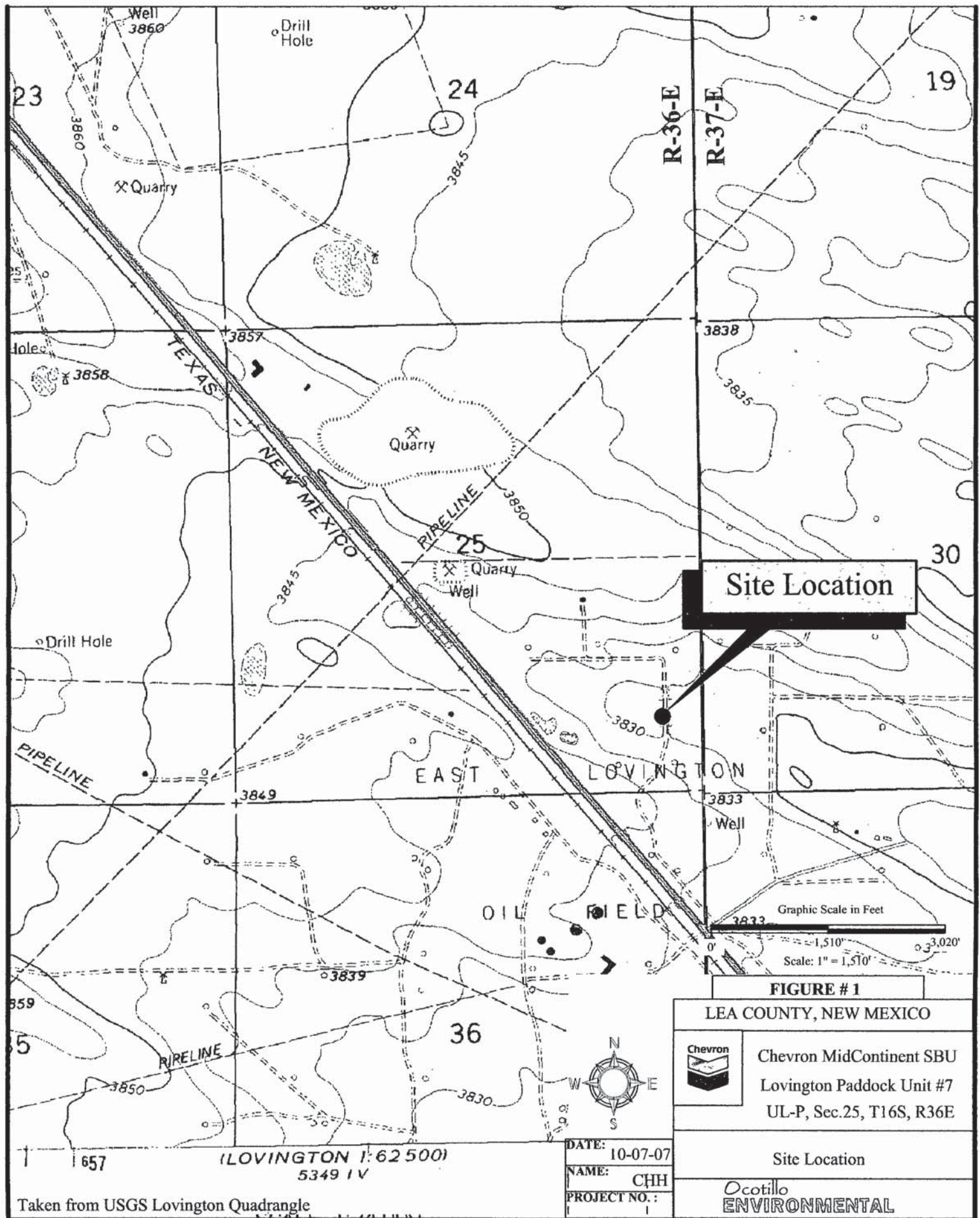

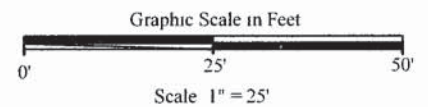
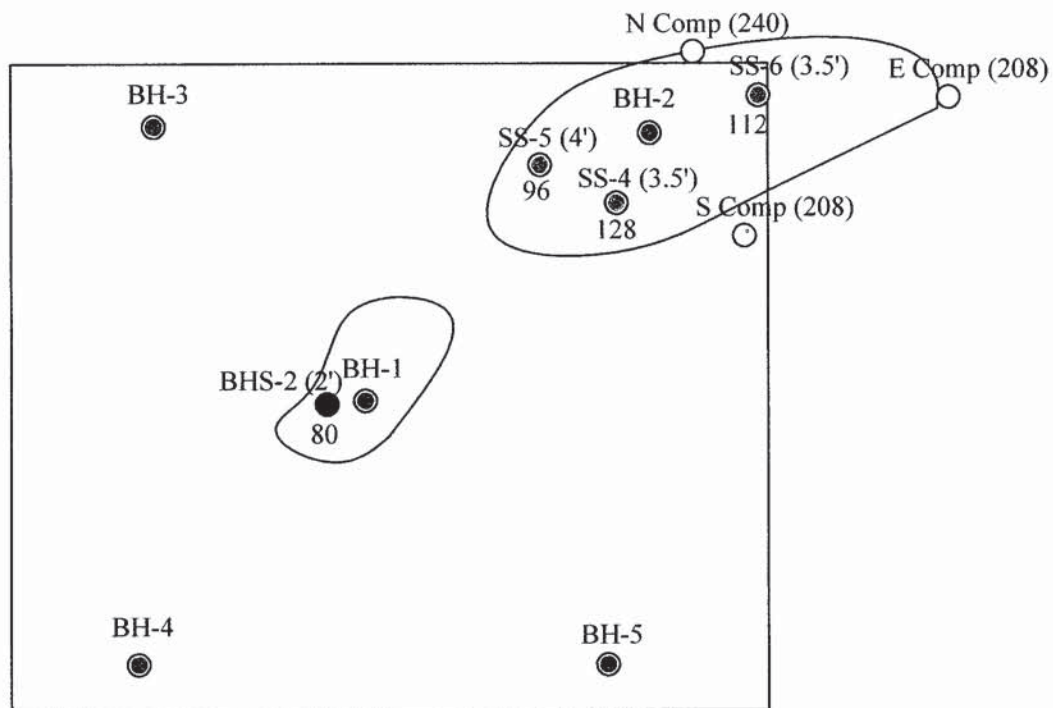
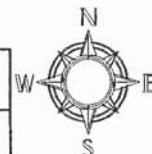

Figure # 2

LEA COUNTY, NEW MEXICO



Chevron MidContinent SBU  
Lovington Paddock Unit #7  
UL-P, Sec. 25, T16S, R36E



## LEGEND



Soil Boring Location

SS-1 Soil Sample Location with  
(3,5') depth (feet) and Chloride  
concentration (mg/kg)  
128



Spill Area Boundary



Excavation Area

DATE: 1-28-08

NAME: MAC

PROJECT NO.: 1107-007B

Site Drawing With Soil Boring and Sample  
Locations

Ocotillo  
ENVIRONMENTAL



**TABLE**

**Table 1:**  
**Summary of Laboratory Analysis of Soil Samples**  
**Chevron MidContinent Alaska, Lovington Paddock #7**  
**Section 25, Township 16 South, Range 36 East**  
**Lea County, New Mexico**

Sample Date	Soil Boring Number	Sample Depth (feet BGS)	TPH (GRO) C6 - C12 mg/kg	TPH (DRO) C12 - C28 mg/kg	TPH (ORO) C28 - C35 mg/kg	Total TPH C6 - C35 mg/kg	Chloride (mg/kg)
RRAL						1000	250
1/14/08	BH-1	1	---	---	---	---	4,480.0
1/16/08	BHS-2	2	---	---	---	---	80.0
11/13/07	BH-1	5-7	<16.7	<16.7	<16.7	<50.1	94.5
		10-12	<16.7	<16.7	<16.7	<50.1	96.5
		15-17	---	---	---	---	42.5
		20-22	---	---	---	---	42.5
11/13/07	BH-2	0-2	<16.1	61.6	<16.1	61.6	3,200.0
1/15/08	SS-1	2.5	---	---	---	---	528.0
1/16/08	SS-4	3.5	---	---	---	---	128.0
1/15/08	SS-2	3	---	---	---	---	464.0
1/16/08	SS-5	4	---	---	---	---	96.0
1/15/08	SS-3	2.5	---	---	---	---	416.0
1/16/08	SS-6	3.5	---	---	---	---	112.0
1/15/08	N Wall Comp	---	---	---	---	---	560.0
1/16/08	N Wall Comp	---	---	---	---	---	240.0
1/15/08	S Wall Comp	---	---	---	---	---	208.0
1/15/08	E Wall Comp	---	---	---	---	---	928.0
1/16/08	E Wall Comp	---	---	---	---	---	208.0
11/13/07		5-7	<16.5	<16.5	<16.5	<49.5	234.0
11/13/07		10-12	---	---	---	---	191.0
11/13/07		15-17	---	---	---	---	128.0
11/13/07		20-22	---	---	---	---	63.8
11/13/07		25-27	---	---	---	---	42.5
11/13/07	BH-3	0-2	<15.9	75.3	44.1	119.4	67.7
11/13/07		5-7	<15.7	<15.7	<15.7	<47.1	223.0
11/13/07		10-12	---	---	---	---	255.0
11/13/07		15-17	---	---	---	---	234.0
11/13/07		20-22	---	---	---	---	277.0
11/13/07		25-27	---	---	---	---	170.0
11/13/07		30-32	---	---	---	---	128.0
11/13/07	BH-4	0-2	<15.3	<15.3	<15.3	<45.9	43.4
11/13/07		5-7	<15.3	<15.3	<15.3	<45.9	43.4
11/13/07		10-12	---	---	---	---	42.5
11/13/07		15-17	---	---	---	---	42.5
11/13/07	BH-5	0-2	<15.4	<15.4	<15.4	<46.2	65.5
11/13/07		5-7	<15.7	<15.7	<15.7	<47.1	44.4
11/13/07		10-12	---	---	---	---	21.3
11/13/07		15-17	---	---	---	---	21.3
11/13/07		20-22	---	---	---	---	42.5

## Notes:

1. BGS: Depth in feet below ground surface
2. mg/kg: Milligrams per kilogram
3. GRO: Gasoline Range Organics
4. DRO: Diesel Range Organics
5. ORO: Oil Range Organics

**APPENDIX A**

**ANALYTICAL DATA AND CHAIN OF CUSTODY**

**DOCUMENTATION**





# ARDINAL LABORATORIES

PHONE (575) 393-2326 • 101 E. MARLAND • HOBBS, NM 88240

ANALYTICAL RESULTS FOR  
OCOTILLO ENVIRONMENTAL, LLC  
ATTN: CINDY CRAIN  
P.O. BOX 1816  
HOBBS, NM 88241  
FAX TO: (432) 272-0304

Receiving Date: 01/14/08  
Reporting Date: 01/15/08  
Project Owner: CHEVRON (1107-007B)  
Project Name: LOVINGTON PADDOCK UNIT #7  
Project Location: LEA COUNTY, NM

Analysis Date: 01/14/08  
Sampling Date: 01/14/08  
Sample Type: SOIL  
Sample Condition: INTACT  
Sample Received By: ML  
Analyzed By: KS

[illegible]

**METHOD:** Standard Methods

4500-CIB

Note: Analysis performed on a 1:4 w:v aqueous extract.

*Kristen Duplato*  
Chemist

01/15/08  
Date

H14080 OCO

PLEASE NOTE **Liability and Damages** **Cardinal's** liability and client's exclusive remedy for any claim arising, whether based in contract or tort, shall be limited to the amount paid by client for analyses. All claims, including those for negligence and any other cause whatsoever shall be deemed waived unless made in writing and received by **Cardinal** within thirty (30) days after completion of the applicable service. In no event shall **Cardinal** be liable for incidental or consequential damages, including, without limitation, business interruptions, loss of use, or loss of profits incurred by client, its subsidiaries, affiliates or successors arising out of or related to the performance of services hereunder by **Cardinal**, regardless of whether such claim is based upon any of the above-stated reasons or otherwise.

ARDINAL LABORATORIES

Released to Imaging: 3/31/2022 2:10:26 PM

† Cardinal cannot accept verbal changes. Please fax written changes to 505-393-2476





PHONE (575) 393-2326 • 101 E. MARLAND • HOBBS, NM 88240

ANALYTICAL RESULTS FOR  
OCOTILLO ENVIRONMENTAL, LLC  
ATTN: CINDY CRAIN  
P.O. BOX 1816  
HOBBS, NM 88241  
FAX TO: (432) 272-0304

Receiving Date: 01/15/08  
Reporting Date: 01/16/08  
Project Owner: CHEVRON (1107-007B)  
Project Name: LOVINGTON PADDOCK UNIT #7  
Project Location: LEA COUNTY, NM

Analysis Date: 01/16/08  
Sampling Date: 01/15/08  
Sample Type: SOIL  
Sample Condition: COOL & INTACT  
Sample Received By: ML  
Analyzed By: HM

LAB NO.	SAMPLE ID	Cl <sup>-</sup> (mg/kg)
H14091-1	SS-1 @ 2.5'	528
H14091-2	SS-2 @ 3'	464
H14091-3	SS-3 @ 2.5'	416
H14091-4	NORTH WALL COMP-S	560
H14091-5	SOUTH WALL COMP-S	208
H14091-6	EAST WALL COMP-S	928
Quality Control		500
True Value QC		500
% Recovery		100
Relative Percent Difference		< 0.1

METHOD: Standard Methods 4500-ClB

Note: Analyses performed on 1:4 w:v aqueous extracts.

*John S. Marino*  
Chemist

01-16-08  
Date

H14091 QCO

PLEASE NOTE **Liability and Damages** **Cardinal's** liability and client's exclusive remedy for any claim arising, whether based in contract or tort, shall be limited to the amount paid by client for analyses. All claims, including those for negligence and any other cause whatsoever shall be deemed waived unless made in writing and received by **Cardinal** within thirty (30) days after completion of the applicable service. In no event shall **Cardinal** be liable for incidental or consequential damages, including, without limitation, business interruptions, loss of use, or loss of profits incurred by client, its subsidiaries, affiliates or successors arising out of or related to the performance of services hereunder by **Cardinal**, regardless of whether such claim is based upon any of the above-stated reasons or otherwise.



## CHAIN-OF-CUSTODY AND ANALYSIS REQUEST

## CARDINAL LABORATORIES

101 East Marland, Hobbs, NM 88240 2111 Beechwood, Abilene, TX 79603  
(505) 393-2326 FAX (505) 393-2476 (325) 673-7001 FAX (325) 673-7020

BILL TO		ANALYSIS REQUEST										
P.O. #:												
Company: Oct 110												
Attn:												
Address:												
City:												
State:												
Phone #:												
Fax #:												
Company Name: Oct 110 Engineering	State: NM	Zip: 88240										
Project Manager: Cindy Chavin	Phone #: 575-441-7244	Fax #: 432-272-0304										
Address: 2125 French Dr.	Project #: 1107-007B	Project Owner: Chevron										
City: Hobbs	Project Name: Livingston Peddick Unit #7											
State: NM	Project Location: Lea County NM											
Zip: 88240	Sampler Name: Steve Cannon											
Phone #: 575-441-7244												
Fax #: 432-272-0304												

Lab I.D.	Sample I.D.	MATRIX			PRESERV			DATE	TIME
		GROUNDWATER	WASTEWATER	SOIL	SLUDGE	OTHER	ACID/BASE		
114091-1	55-1 @ 2.5'							1-15-07	11:15
-2	55-2 @ 3'							"	11:07
-3	55-3 @ 2.5'							"	11:25
-4	Northwell Camp 5							"	11:11
-5	Southwell Camp 5							"	11:19
-6	Eastwell Camp 5							"	11:28

PLEASE NOTE: Liability and Damages. Cardinal's liability and client's exclusive remedy for any claim arising from this contract or tort, shall be limited to the amount paid by the client for the analysis. All claims, including those for negligence and any other cause whatsoever shall be deemed waived unless made in writing and received by Cardinal within 30 days after completion of the applicable service. In no event shall Cardinal be liable for incidental or consequential damages, including without limitation, business interruptions, loss of use, or loss of profits incurred by client, its subsidiaries, affiliates or successors arising out of or related to the performance of services hereunder by Cardinal, regardless of whether such claim is based upon any of the above stated reasons or otherwise.

Relinquished By: <u>Steve Cannon</u>	Date: <u>1-15-07</u>	Received By: <u>Andy DeBut</u>	Phone Result: <input type="checkbox"/> Yes <input checked="" type="checkbox"/> No	Add'l Phone #: <u>432-272-0304</u>
Relinquished By: <u>Steve Cannon</u>	Time: <u>2:05 PM</u>	Received By: <u>Andy DeBut</u>	Fax Result: <input type="checkbox"/> Yes <input checked="" type="checkbox"/> No	Add'l Fax #: <u>ASAP Please</u>
Remarks: <u>Fix #432-272-0304</u>				

Delivered By: (Circle One)  
Sampler - UPS - Bus - Other:

Sample Condition  
Cool Intact  
☒ Yes ☐ No

CHECKED BY:  
(Initials)  
WJB

† Cardinal cannot accept verbal changes. Please fax written changes to 505-393-2476



PHONE (575) 393-2326 • 101 E. MARLAND • HOBBS, NM 88240

ANALYTICAL RESULTS FOR  
OCOTILLO ENVIRONMENTAL, LLC  
ATTN: CINDY CRAIN  
P.O. BOX 1816  
HOBBS, NM 88241  
FAX TO: (432) 272-0304

Receiving Date: 01/16/08  
Reporting Date: 01/17/08  
Project Owner: CHEVRON (1107-007B)  
Project Name: LOVINGTON PADDOCK UNIT #7  
Project Location: LEA COUNTY, NM

Analysis Date: 01/16/08  
Sampling Date: 01/16/08  
Sample Type: SOIL  
Sample Condition: COOL & INTACT  
Sample Received By: HM  
Analyzed By: KS

LAB NO.	SAMPLE ID	Cl <sup>-</sup> (mg/kg)
H14098B-1	SS-4 @ 3.5'	128
H14098B-2	SS-5 @ 4'	96
H14098B-3	SS-6 @ 3.5'	112
H14098B-4	COMP S NORTH WALL	240
H14098B-5	COMP S EAST WALL	208
H14098B-6	BHS #2	80
Quality Control		500
True Value QC		500
% Recovery		100
Relative Percent Difference		2.0

METHOD: Standard Methods	4500-Cl <sup>-</sup> B
--------------------------	------------------------

Note: Analyses performed on 1:4 w:v aqueous extracts.

Kirsten Sepulveda  
Chemist

01/17/08  
Date

H14098B OCO

PLEASE NOTE **Liability and Damages.** Cardinal's liability and client's exclusive remedy for any claim arising, whether based in contract or tort, shall be limited to the amount paid by client for analyses. All claims, including those for negligence and any other cause whatsoever shall be deemed waived unless made in writing and received by Cardinal within thirty (30) days after completion of the applicable service. In no event shall Cardinal be liable for incidental or consequential damages, including, without limitation, business interruptions, loss of use, or loss of profits incurred by client, its subsidiaries, affiliates or successors arising out of or related to the performance of services hereunder by Cardinal, regardless of whether such claim is based upon any of the above-stated reasons or otherwise.



## CHAIN-OF-CUSTODY AND ANALYSIS REQUEST

## CARDINAL LABORATORIES

101 East Marland, Hobbs, NM 88240 2111 Beechwood, Abilene, TX 79603  
(505) 393-2326 FAX (505) 393-2476 (325) 673-7001 FAX (325) 673-7020

BILL TO		ANALYSIS REQUEST									
Company Name: <u>Cardillo Environmental</u>		P.O. #:									
Project Manager: <u>Cindy Crain</u>		Company: <u>Cardillo</u>									
Address: <u>3125 French Dr</u>		Attn:									
City: <u>Hobbs</u> State: <u>NM</u> Zip: <u>88240</u>		Address:									
Phone #: <u>575-441-7244</u> Fax #: <u>432-272-0304</u>		City:									
Project #: <u>1107-007B</u> Project Owner: <u>Chevron</u>		State:									
Project Name: <u>Livingston Padlock Unit #7</u>		Phone #:									
Project Location: <u>Lea County NM</u>		Fax #:									
Lab I.D.	Sample I.D.	(G)RAB OR (C)OMP	# CONTAINERS	MATRIX	PRESERV	SAMPLING	DATE	TIME			
H140981	55-4 @ 3.5'	Q		GROUNDWATER	OTHER: SLUDGE		1-16-07	11:31			
-2	55-5 @ 4'	Q		WASTEWATER	ICE / COOL		"	11:36			
-3	55-6 @ 3.5'	Q		OIL	OTHER:		"	11:42			
-4	Comp 5 Northwell	Q		SOIL			"	11:49			
-5	Comp 5 Southwell	Q		WASTEWATER			"	11:52			
-6	BH5 #2	Q		GROUNDWATER			"	11:23			

PLEASE NOTE: Liability and Damages. Cardinal's liability and client's exclusive remedy for any claim arising whether based in contract or tort, shall be limited to the amount paid by the client for the analysis. All claims, including those for negligence and any other cause whatsoever shall be deemed waived unless made in writing and received by Cardinal within 30 days after completion of the applicable service. In no event shall Cardinal be liable for incidental or consequential damages, including without limitation, business interruptions, loss of use, or loss of profits incurred by client, its subsidiaries, affiliates or successors arising out of or related to the performance of services hereunder by Cardinal, regardless of whether such claim is based upon any of the above stated reasons or otherwise.

Relinquished By: <u>[Signature]</u>	Received By: <u>Hope L. M. Grew</u>	Phone Result: <input type="checkbox"/> Yes <input checked="" type="checkbox"/> No	Add'l Phone #: <u>432-272-0304</u>
Date: <u>1-16-07</u>	Date: <u>1-16-07</u>	Fax Result: <input checked="" type="checkbox"/> Yes <input type="checkbox"/> No	Add'l Fax #: <u></u>
Time: <u>1:34pm</u>	Time: <u></u>	REMARKS: <u>Fax # 432-272-0304</u> <u>ASAP please</u>	
Delivered By: (Circle One) <u>UPS</u>	Sample Condition Cool: <input type="checkbox"/> Yes <input checked="" type="checkbox"/> No Intact: <input type="checkbox"/> Yes <input checked="" type="checkbox"/> No	CHECKED BY: <u>[Signature]</u> (Initials)	

NOTE: Thanks to Cindy about CUC - sample id not matching - she said the sample ID was correct & gave me permission to change CUC. 01-16-07

† Cardinal cannot accept verbal changes. Please fax written changes to 505-393-2476



## **C141 DOCUMENTATION**

District I  
1625 N. French Dr., Hobbs, NM 88240  
District II  
1301 W. Grand Avenue, Artesia, NM 88210  
District III  
1000 Rio Brazos Road, Aztec, NM 87410  
District IV  
1220 S. St. Francis Dr., Santa Fe, NM 87505

State of New Mexico  
Energy Minerals and Natural Resources

Oil Conservation Division  
1220 South St. Francis Dr.  
Santa Fe, NM 87505

Form C-141  
Revised October 10, 2003

Submit 2 Copies to appropriate  
District Office in accordance  
with Rule 116 on back  
side of form

### Release Notification and Corrective Action

#### OPERATOR

☒ Initial Report

☐ Final Report

Name of Company Chevron Midcontinent LP	Contact Larry Ridenour
Address HCR 60 Box 423 Lovington, N.M. 88260	Telephone No. 505-396-4414 X 102
Facility Name Lovington Paddock Unit #7	Facility Type Injection line
Surface Owner City of Lovington	Mineral Owner State of NM
Lease No. 9077-2	

#### LOCATION OF RELEASE

Unit Letter P	Section 25	Township 16S	Range 36E	Feet from the 330	South Line	Feet from the 330	East Line	County Lea
------------------	---------------	-----------------	--------------	----------------------	------------	----------------------	-----------	---------------

Latitude N 32 deg 53 min 12.85 sec Longitude W 103 deg 18 min 1.02 sec  
API #30-025-03747

#### NATURE OF RELEASE

Type of Release Produced water	Volume of Release 20 BW	Volume Recovered 15 bbl fluids.
Source of Release injection line	Date and Hour of Occurrence 09/26/07 7:15 AM	Date and Hour of Discovery 09/26/07 7:30 am
Was Immediate Notice Given? <input checked="" type="checkbox"/> Yes <input type="checkbox"/> No <input type="checkbox"/> Not Required	If YES, To Whom? Pat Caperton	
By Whom? Larry Ridenour	Date and Hour 9/27/2007 10:25 AM.	
Was a Watercourse Reached? <input type="checkbox"/> Yes <input checked="" type="checkbox"/> No	If YES, Volume Impacting the Watercourse.	

If a Watercourse was Impacted, Describe Fully.\*



Describe Cause of Problem and Remedial Action Taken.\*

Fiberglass line parted in collar. Leak detected by SCADA system and was shut in very shortly thereafter. Roustabout gang was dispatched with enviro vat to pick up standing water. Picked up 15 bbls of water total. Estimate total spill at 20 bbls water with skim of oil. Emergency one call was done and contaminated dirt removal began on 9/27/07.  
Chlorides 35,300

Describe Area Affected and Cleanup Action Taken.\*

Affected area is approximately 100' diameter circle. Leak has been turned over to Ocotillo Environmental for delineation, evaluation, and formulation of remediation plan to be approved by Chevron and NMOCD:

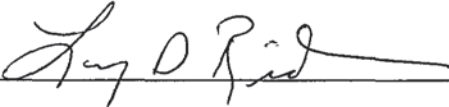
I hereby certify that the information given above is true and complete to the best of my knowledge and understand that pursuant to NMOCD rules and regulations all operators are required to report and/or file certain release notifications and perform corrective actions for releases which may endanger public health or the environment. The acceptance of a C-141 report by the NMOCD marked as "Final Report" does not relieve the operator of liability should their operations have failed to adequately investigate and remediate contamination that pose a threat to ground water, surface water, human health or the environment. In addition, NMOCD acceptance of a C-141 report does not relieve the operator of responsibility for compliance with any other federal, state, or local laws and/or regulations.

Signature: 	OIL CONSERVATION DIVISION	
Printed Name: Larry Ridenour	Approved by District Supervisor: 	
Title: Operations Representative	Approval Date: 10-3-07	Expiration Date: 12-3-07
E-mail Address LRidenour@chevron.com	Conditions of Approval:	Attached <input type="checkbox"/>
Date: 10/01/2007 Phone: 396-4414 X 102	SUBMIT FINAL C-141 w/ SUPPORTING DOCUMENTATION	

\* Attach Additional Sheets If Necessary

RP# 1604



District I  
1625 N French Dr., Hobbs, NM 88240  
District II  
1301 W. Grand Avenue, Artesia, NM 88210  
District III  
1000 Rio Brazos Road, Aztec, NM 87410  
District IV  
1220 S. St. Francis Dr., Santa Fe, NM 87505

State of New Mexico  
Energy Minerals and Natural Resources

Oil Conservation Division  
1220 South St. Francis Dr.  
Santa Fe, NM 87505

Form C-141  
Revised October 10, 2003

Submit 2 Copies to appropriate  
District Office in accordance  
with Rule 116 on back  
side of form

### Release Notification and Corrective Action

#### OPERATOR

☐ Initial Report ☒ Final Report

Name of Company	Chevron Midcontinent LP	Contact	Larry Ridenour
Address	HCR 60 Box 423 Lovington, NM 88260	Telephone No	(505) 396-4414 x 102
Facility Name	Lovington Paddock #7	Facility Type	Injection Line
Surface Owner:	City of Lovington	Mineral Owner:	State of NM
		Lease No. 9077-2 IRP # 1604 API # 30-025-03747	

#### LOCATION OF RELEASE

Unit Letter	Section	Township	Range	Feet from the	North/South Line	Feet from the	East/West Line	County
P	25	16S	36E	330	South	330	East	Lea

Latitude N 32 deg. 53 min. 12.85 sec. Longitude W 103 deg. 18 min. 1.02 sec.

#### NATURE OF RELEASE

Type of Release <sup>1</sup>	Produced Water	Volume of Release	20 BW	Volume Recovered	15 bbl fluids
Source of Release	Injection line	Date and Hour of Occurrence	9/26/07 7:15 AM	Date and Hour of Discovery	9/26/07 7:30 AM
Was Immediate Notice Given?	<input checked="" type="checkbox"/> Yes <input type="checkbox"/> No <input type="checkbox"/> Not Required	If YES, To Whom?	Pat Caperton		
By Whom?	Larry Ridenour	Date and Hour	9/27/07 10:25 AM		
Was a Watercourse Reached?	<input type="checkbox"/> Yes <input checked="" type="checkbox"/> No	If YES, Volume Impacting the Watercourse			
If a Watercourse was Impacted, Describe Fully.*					
Describe Cause of Problem and Remedial Action Taken.*					
Fiberglass line parted in collar. Leak detected by SCADA system and was shut in very shortly thereafter. Roustabout gang was dispatched with enviro vat to pick up standing water. Picked up 15 bbls of water total. Estimate total spill at 20 bbls water with skim of oil. Emergency one call was done and contaminated dirt removal began on 9/27/07 Chlorides: 35,300					
Describe Area Affected and Cleanup Action Taken.*					
An area approximately 100' x 80' was excavated to a depth of one to two feet bgs. Soil borings were installed in order to assess the horizontal and vertical limits of the spill. Additional soil was excavated at the center and northeast portions of the site until confirmation samples reported all chloride and TPH concentrations below the New Mexico clean up standards. Impacted soil was hauled to an NMOCD approved disposal facility, and the area was backfilled with clean soil from the State of New Mexico pit #294.					
I hereby certify that the information given above is true and complete to the best of my knowledge and understand that pursuant to NMOCD rules and regulations all operators are required to report and/or file certain release notifications and perform corrective actions for releases which may endanger public health or the environment. The acceptance of a C-141 report by the NMOCD marked as "Final Report" does not relieve the operator of liability should their operations have failed to adequately investigate and remediate contamination that pose a threat to ground water, surface water, human health or the environment. In addition, NMOCD acceptance of a C-141 report does not relieve the operator of responsibility for compliance with any other federal, state, or local laws and/or regulations.					
Signature:	<u>Larry Ridenour</u>				
Printed Name:	Larry Ridenour				
Title:	Operations Representative				
E-mail Address:	Lridenour@chevron.com				
Date:	1/24/08				
Phone:	(505) 396-4414 x 102				
			OIL CONSERVATION DIVISION		
			Approved by District Supervisor: <u>Chris Williams</u>		
			Approval Date: <u>1/30/08</u> Expiration Date: <u>1/30/08</u>		
			Conditions of Approval:		
			Attached <input type="checkbox"/>		

\* Attach Additional Sheets If Necessary



**District I**

1625 N. French Dr., Hobbs, NM 88240  
Phone:(575) 393-6161 Fax:(575) 393-0720

**District II**

811 S. First St., Artesia, NM 88210  
Phone:(575) 748-1283 Fax:(575) 748-9720

**District III**

1000 Rio Brazos Rd., Aztec, NM 87410  
Phone:(505) 334-6178 Fax:(505) 334-6170

**District IV**

1220 S. St Francis Dr., Santa Fe, NM 87505  
Phone:(505) 476-3470 Fax:(505) 476-3462

**State of New Mexico**  
**Energy, Minerals and Natural Resources**  
**Oil Conservation Division**  
**1220 S. St Francis Dr.**  
**Santa Fe, NM 87505**

CONDITIONS

Action 41389

**CONDITIONS**

Operator: CHEVRON U S A INC 6301 Deauville Blvd Midland, TX 79706	OGRID: 4323
	Action Number: 41389
	Action Type: [C-141] Release Corrective Action (C-141)

**CONDITIONS**

Created By	Condition	Condition Date
jnobui	Closure Report Approved. Closure was approved on signed old C141 form on 01/30/2008 by Chris Williams.	3/31/2022