

Closure Report

nRM2022461212

Site Description

Site Name:	PRIZE FED #7
Company:	OXY
Legal Description:	U/L: I, SECTION 27, T22S, R32E
County:	EDDY COUNTY, NM
GPS Coordinates:	N32.36164 W103.65727

Release Data

Date of Release:	6/13/2020
Type of Release:	PRODUCED WATER & CRUDE OIL
Source of Release:	FATIGUE ON FLOWLINE
Volume of Release:	30 BBLS CRUDE OIL/ 100 BBLS PRODUCED WATER
Volume Recovered:	1 BBLS CRUDE OIL/ 15 BBLS PRODUCED WATER

Remediation Specifications

Remediation Parameters	Leak area near SP1, SP4-SP6, and SP9-SP10 (Blue shade) will be excavated to a depth of 1 foot. Leak area near SP3 (Pink Shade) will be excavated to a depth of 7 feet. Leak area new SP2, SP7 and SP8 (Green Shade) will be excavated to a depth of 2 feet. Oxy will collect sidewall and bottom confirmation samples every 200 sq feet. The estimated amount of soil to be excavated is 529 cubic yards. Remediation will be completed within 90day of approval.
Remediation Activities:	7/27/2020 & 8/5/2021

Plan Sent to OCD:		FROM CLIFF TO BLM NM AND WADE
OCD Approval of Plan:	3/31/2021	FROM @STATE.NM.US TO WADE AND CLIFF
Plan Sent to BLM:	2/8/2021	FROM CLIFF TO SPILL@BLM AND WADE
BLM Approval of Plan:	2/16/2021	FROM JAMOS@BLM.GOV TO WADE AND CLIFF

Supporting Documentation

C 141 PAGE 6	SIGNED	
SITE DIAGRAM	GOOGLE EARTH MAP WITH CONFIRMATION SAMPLES	
PICTURES	CLOSURE PICTURES	
LAB SUMMARY	CLOSURE SAMPLES	
LAB ANALYSIS	CLOSURE SAMPLES	
SAMPLING NOTIFICATION	7/7/2021	

Request for Closure

Based on the completion of the remediation plan as agreed upon, BBC International requests closure approval from NMOCD.

Cliff Brunson, President of BBC International Inc.

10/1/2021

Form C-141

Page 6

State of New Mexico
Oil Conservation Division

Incident ID	nRM2022461212
District RP	
Facility ID	
Application ID	

Closure

The responsible party must attach information demonstrating they have complied with all applicable closure requirements and any conditions or directives of the OCD. This demonstration should be in the form of a comprehensive report (electronic submittals in .pdf format are preferred) including a scaled site map, sampling diagrams, relevant field notes, photographs of any excavation prior to backfilling, laboratory data including chain of custody documents of final sampling, and a narrative of the remedial activities. Refer to 19.15.29.12 NMAC.

Closure Report Attachment Checklist: *Each of the following items must be included in the closure report.*

- ☐ A scaled site and sampling diagram as described in 19.15.29.11 NMAC
- ☐ Photographs of the remediated site prior to backfill or photos of the liner integrity if applicable (Note: appropriate OCD District office must be notified 2 days prior to liner inspection)
- ☐ Laboratory analyses of final sampling (Note: appropriate ODC District office must be notified 2 days prior to final sampling)
- ☐ Description of remediation activities

I hereby certify that the information given above is true and complete to the best of my knowledge and understand that pursuant to OCD rules and regulations all operators are required to report and/or file certain release notifications and perform corrective actions for releases which may endanger public health or the environment. The acceptance of a C-141 report by the OCD does not relieve the operator of liability should their operations have failed to adequately investigate and remediate contamination that pose a threat to groundwater, surface water, human health or the environment. In addition, OCD acceptance of a C-141 report does not relieve the operator of responsibility for compliance with any other federal, state, or local laws and/or regulations. The responsible party acknowledges they must substantially restore, reclaim, and re-vegetate the impacted surface area to the conditions that existed prior to the release or their final land use in accordance with 19.15.29.13 NMAC including notification to the OCD when reclamation and re-vegetation are complete.

Printed Name: Wade Dittrich Title: Environmental Coordinator
Signature:  Date: 9-9-21
email: wade_dittrich@oxy.com Telephone: (575) 390-2828

OCD Only

Received by: _____ Date: _____

Closure approval by the OCD does not relieve the responsible party of liability should their operations have failed to adequately investigate and remediate contamination that poses a threat to groundwater, surface water, human health, or the environment nor does not relieve the responsible party of compliance with any other federal, state, or local laws and/or regulations.

Closure Approved by: Jennifer Nobui Date: 04/29/2022
Printed Name: Jennifer Nobui Title: Environmental Specialist A

From: [Cliff Brunson](#)
To: ["Enviro. OCD, EMNRD"](#)
Cc: ["Wade Dittrich"](#); ["Ken Swinney"](#); ["Jennifer Gilkey"](#); [Isabel Ramirez](#)
Subject: OXY - Prize Fed #7 - Sampling Notification
Date: Wednesday, July 7, 2021 3:46:00 PM

This is a notification that BBC will conduct confirmation sampling on behalf of OXY at the Prize Fed #7 (Incident ID # NRM2022461212) on Friday, July 9 at 9:30 a.m.

Cliff P. Brunson, CEI, CRS
President
BBC International, Inc.
World-Wide Environmental Specialists
Mailing Address:
P. O. Box 805
Hobbs, NM 88241-0805 USA
Shipping Address:
1324 W. Marland St.
Hobbs, NM 88240 USA
Phone: (575) 397-6388
Fax: (575) 397-0397
E-Mail: cbrunson@bbcinternational.com



Confidentiality Notice: This electronic transmission (and any attached documents) is intended only for the person(s) to whom it is addressed and may contain information that is privileged, confidential, or otherwise protected from disclosure. If you have received this transmission in error, please immediately notify the sender by e-mail or by telephone call to (575) 397-6388 for handling instructions. Any disclosure or distribution of the contents of this transmission by anyone other than the named recipient(s) is strictly prohibited.

PRIZE FED #7

LEAK DATE 6-13-20
ID#NRM2022461212
LEA COUNTY, NM

Legend

- 1'
- 2'
- 7FT EXCAVATION
- BOTTOM CONFIRMATION SAMPLE POINTS
- SIDEWALL CONFIRMATION SAMPLE POINTS

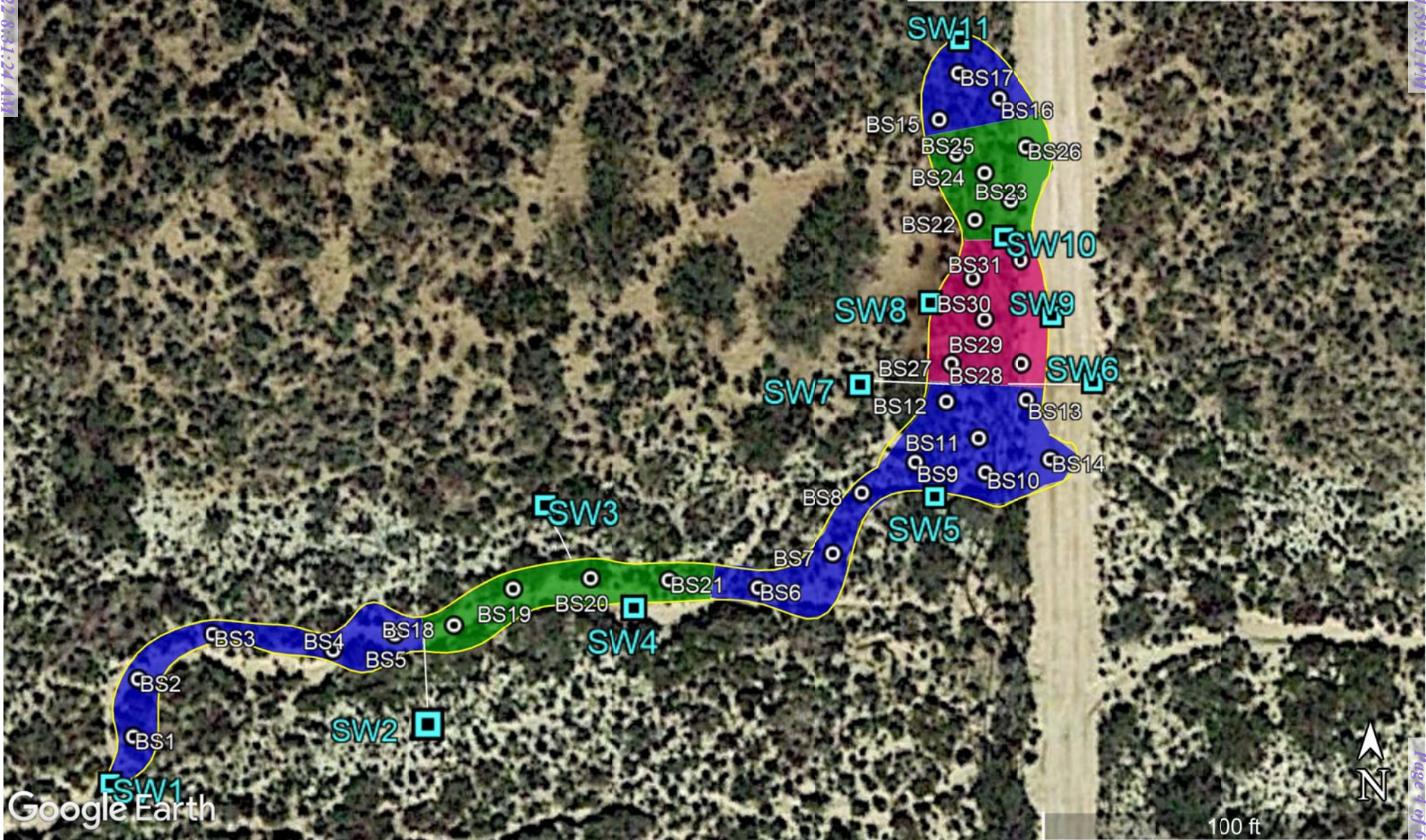

OXY PRIZE FED #7 6-13-20

BS 1 @ 1'	N32.361428	W-103.657908
BS2 @ 1'	N32.361470	W-103.657904
BS 3@ 1'	N32.361502	W-103.657840
BS 4@ 1'	N32.361490	W-103.657738
BS 5 @ 1'	N32.361502	W-103.657685
BS 6@ 1'	N32.361536	W-103.657375
BS 7@ 1'	N32.361561	W-103.657310
BS 8 @ 1'	N32.361604	W-103.657286
BS 9@ 1'	N32.361626	W-103.657240
BS 10 @ 1'	N32.361619	W-103.657181
BS 11 @ 1'	N32.361643	W-103.657186
BS 12 @ 1'	N32.361670	W-103.657214
BS 13 @ 1'	N32.361672	W-103.657145
BS 14 @ 1'	N32.361628	W-103.657125
BS 15 @ 1'	N32.361874	W-103.657220
BS 16 @ 1'	N32.361889	W-103.657169
BS 17 @ 1'	N32.361907	W-103.657204
BS 18 @ 2'	N32.361509	W-103.657634
BS 19@ 2'	N32.361535	W-103.657584
BS 20@ 2'	N32.361543	W-103.657518
BS 21 @ 2'	N32.361541	W-103.657450
BS 22 @ 2'	N32.361801	W-103.657190
BS 23 @ 2'	N32.361815	W-103.657159
BS 24 @ 2'	N32.361835	W-103.657181
BS 25 @ 2'	N32.361848	W-103.657205
BS 26 @ 2'	N32.361854	W-103.657145
BS 27 @ 7'	N32.361698	W-103.657209
BS 28 @ 7'	N32.361698	W-103.657149
BS 29 @ 7'	N32.361730	W-103.657181

OXY PRIZE FED #7 6-13-20

BS 30 @7'	N32.361759	W-103.657191
BS 31 @7'	N32.361772	W-103.657150
SW 1	N32.361395	W-103.657928
SW 2	N32.361501	W-103.657659
SW 3	N32.361554	W-103.657531
SW 4	N32.361521	W-103.657480
SW 5	N32.361601	W-103.657223
SW 6	N32.361683	W-103.657151
SW 7	N32.361683	W-103.657204
SW 8	N32.361742	W-103.657227
SW 9	N32.361732	W-103.657123
SW10	N32.361789	W-103.657165
SW11	N32.361931	W-103.657202



PRIZE FED #7
(6-13-20)



PRIZE FED #7
(6-13-20)



PRIZE FED #7
(6-13-20)





PRIZE FED #7
(6-13-20)



Laboratory Analytical Results Summary
PRIZE FED #7
6-13-20

		Sample ID	BOTTOM 1 @ 1'	BOTTOM 2 @ 1'	BOTTOM 3 @ 1'	BOTTOM 4 @ 1'	BOTTOM 5 @ 1'	BOTTOM 6 @ 1'	BOTTOM 7 @ 1'	BOTTOM 8 @ 1'	BOTTOM 9 @ 1'	BOTTOM 10 @ 1'	BOTTOM 11 @ 1'	BOTTOM 12 @ 1'	BOTTOM 13 @ 1'	BOTTOM 14 @ 1'	BOTTOM 15 @ 1'	BOTTOM 16 @ 1'	BOTTOM 17 @ 1'
Analyte	Method	Date	7/9/21	7/9/21	7/9/21	7/9/21	7/9/21	7/9/21	7/9/21	7/9/21	7/9/21	7/9/21	7/9/21	7/9/21	7/9/21	7/9/21	7/9/21	7/9/21	7/9/21
			mg/kg	mg/kg	mg/kg	mg/kg	mg/kg	mg/kg	mg/kg	mg/kg	mg/kg	mg/kg	mg/kg	mg/kg	mg/kg	mg/kg	mg/kg	mg/kg	mg/kg
Benzene	BTEX 8021B		<0.050	<0.050	<0.050	<0.050	<0.050	<0.050	<0.050	<0.050	<0.050	<0.050	<0.050	<0.050	<0.050	<0.050	<0.050	<0.050	<0.050
Toluene	BTEX 8021B		<0.050	<0.050	<0.050	<0.050	<0.050	<0.050	<0.050	<0.050	<0.050	<0.050	<0.050	<0.050	<0.050	<0.050	<0.050	<0.050	<0.050
Ethylbenzene	BTEX 8021B		<0.050	<0.050	<0.050	<0.050	<0.050	<0.050	<0.050	<0.050	<0.050	<0.050	<0.050	<0.050	<0.050	<0.050	<0.050	<0.050	<0.050
Total Xylenes	BTEX 8021B		<0.150	<0.150	<0.150	<0.150	<0.150	<0.150	<0.150	<0.150	<0.150	<0.150	<0.150	<0.150	<0.150	<0.150	<0.150	<0.150	<0.150
Total BTEX	BTEX 8021B		<0.300	<0.300	<0.300	<0.300	<0.300	<0.300	<0.300	<0.300	<0.300	<0.300	<0.300	<0.300	<0.300	<0.300	<0.300	<0.300	<0.300
Chloride	SM4500Cl-B		16.0	16.0	<16.0	32.0	<16.0	<16.0	16.0	<16.0	16.0	16.0	<16.0	<16.0	<16.0	<16.0	16.0	16.0	16.0
GRO	TPH 8015M		<10.0	<10.0	<10.0	<10.0	<10.0	<10.0	<10.0	<10.0	<10.0	<10.0	<10.0	<10.0	<10.0	<10.0	<10.0	<10.0	<10.0
DRO	TPH 8015M		<10.0	<10.0	<10.0	<10.0	<10.0	<10.0	<10.0	<10.0	<10.0	<10.0	<10.0	<10.0	<10.0	<10.0	<10.0	<10.0	<10.0
EXT DRO	TPH 8015M		<10.0	<10.0	<10.0	<10.0	<10.0	<10.0	<10.0	<10.0	<10.0	<10.0	<10.0	<10.0	<10.0	<10.0	<10.0	<10.0	<10.0

		Sample ID	BOTTOM 18 @ 2'	BOTTOM 19 @ 2'	BOTTOM 20 @ 2'	BOTTOM 21 @ 2'	BOTTOM 22 @ 2'	BOTTOM 23 @ 2'	BOTTOM 24 @ 2'	BOTTOM 25 @ 2'	BOTTOM 26 @ 2'
Analyte	Method	Date	7/9/21	7/9/21	7/9/21	7/9/21	7/9/21	7/9/21	7/9/21	7/9/21	7/9/21
			mg/kg	mg/kg	mg/kg	mg/kg	mg/kg	mg/kg	mg/kg	mg/kg	mg/kg
Benzene	BTEX 8021B		<0.050	<0.050	<0.050	<0.050	<0.050	<0.050	<0.050	<0.050	<0.050
Toluene	BTEX 8021B		<0.050	<0.050	<0.050	<0.050	<0.050	<0.050	<0.050	<0.050	<0.050
Ethylbenzene	BTEX 8021B		<0.050	<0.050	<0.050	<0.050	<0.050	<0.050	<0.050	<0.050	<0.050
Total Xylenes	BTEX 8021B		<0.150	<0.150	<0.150	<0.150	<0.150	<0.150	<0.150	<0.150	<0.150
Total BTEX	BTEX 8021B		<0.300	<0.300	<0.300	<0.300	<0.300	<0.300	<0.300	<0.300	<0.300
Chloride	SM4500Cl-B		<16.0	32.0	<16.0	16.0	16.0	<16.0	<16.0	<16.0	<16.0
GRO	TPH 8015M		<10.0	<10.0	<10.0	<10.0	<10.0	<10.0	<10.0	<10.0	<10.0
DRO	TPH 8015M		<10.0	<10.0	<10.0	<10.0	<10.0	<10.0	<10.0	<10.0	<10.0
EXT DRO	TPH 8015M		<10.0	<10.0	<10.0	<10.0	<10.0	<10.0	<10.0	<10.0	<10.0

		Sample ID	BOTTOM 27 @ 7'	BOTTOM 28 @ 7'	BOTTOM 29 @ 7'	BOTTOM 30 @ 7'	BOTTOM 31 @ 7'
Analyte	Method	Date	7/9/21	7/9/21	7/9/21	7/9/21	7/9/21
			mg/kg	mg/kg	mg/kg	mg/kg	mg/kg
Benzene	BTEX 8021B		<0.050	<0.050	<0.050	<0.050	<0.050
Toluene	BTEX 8021B		<0.050	<0.050	<0.050	<0.050	<0.050
Ethylbenzene	BTEX 8021B		<0.050	<0.050	<0.050	<0.050	<0.050
Total Xylenes	BTEX 8021B		<0.150	<0.150	<0.150	<0.150	<0.150
Total BTEX	BTEX 8021B		<0.300	<0.300	<0.300	<0.300	<0.300
Chloride	SM4500Cl-B		16.0	<16.0	<16.0	16.0	<16.0
GRO	TPH 8015M		<10.0	<10.0	<10.0	<10.0	<10.0
DRO	TPH 8015M		<10.0	<10.0	<10.0	<10.0	<10.0
EXT DRO	TPH 8015M		<10.0	<10.0	<10.0	<10.0	<10.0

		Sample ID	SW 1	SW 2	SW 3	SW 4	SW 5	SW 6	SW 7	SW 8	SW 9	SW 10	SW 11
Analyte	Method	Date	7/9/21	7/9/21	7/9/21	7/9/21	7/9/21	7/9/21	7/9/21	7/9/21	7/9/21	7/9/21	7/9/21
			mg/kg	mg/kg	mg/kg	mg/kg	mg/kg	mg/kg	mg/kg	mg/kg	mg/kg	mg/kg	mg/kg
Benzene	BTEX 8021B		<0.050	<0.050	<0.050	<0.050	<0.050	<0.050	<0.050	<0.050	<0.050	<0.050	<0.050
Toluene	BTEX 8021B		<0.050	<0.050	<0.050	<0.050	<0.050	<0.050	<0.050	<0.050	<0.050	<0.050	<0.050
Ethylbenzene	BTEX 8021B		<0.050	<0.050	<0.050	<0.050	<0.050	<0.050	<0.050	<0.050	<0.050	<0.050	<0.050
Total Xylenes	BTEX 8021B		<0.150	<0.150	<0.150	<0.150	<0.150	<0.150	<0.150	<0.150	<0.150	<0.150	<0.150
Total BTEX	BTEX 8021B		<0.300	<0.300	<0.300	<0.300	<0.300	<0.300	<0.300	<0.300	<0.300	<0.300	<0.300
Chloride	SM4500Cl-B		<16.0	<16.0	<16.0	<16.0	<16.0	16.0	16.0	16.0	<16.0	<16.0	<16.0
GRO	TPH 8015M		<10.0	<10.0	<10.0	<10.0	<10.0	<10.0	<10.0	<10.0	<10.0	<10.0	<10.0
DRO	TPH 8015M		<10.0	<10.0	<10.0	<10.0	<10.0	<10.0	<10.0	<10.0	<10.0	<10.0	<10.0
EXT DRO	TPH 8015M		<10.0	<10.0	<10.0	<10.0	<10.0	<10.0	<10.0	<10.0	<10.0	<10.0	<10.0



PHONE (575) 393-2326 ° 101 E. MARLAND ° HOBBS, NM 88240

July 15, 2021

Cliff Brunson

BBC International, Inc.

P.O. Box 805

Hobbs, NM 88241

RE: PRIZE FED #7

Enclosed are the results of analyses for samples received by the laboratory on 07/12/21 16:40.

Cardinal Laboratories is accredited through Texas NELAP under certificate number T104704398-20-13. Accreditation applies to drinking water, non-potable water and solid and chemical materials. All accredited analytes are denoted by an asterisk (*). For a complete list of accredited analytes and matrices visit the TCEQ website at www.tceq.texas.gov/field/qa/lab_accred_certif.html.

Cardinal Laboratories is accredited through the State of Colorado Department of Public Health and Environment for:

Method EPA 552.2	Haloacetic Acids (HAA-5)
Method EPA 524.2	Total Trihalomethanes (TTHM)
Method EPA 524.4	Regulated VOCs (V1, V2, V3)

Accreditation applies to public drinking water matrices.

This report meets NELAP requirements and is made up of a cover page, analytical results, and a copy of the original chain-of-custody. If you have any questions concerning this report, please feel free to contact me.

Sincerely,

A handwritten signature in black ink that reads "Celey D. Keene". The signature is written in a cursive style with a large, stylized 'C' and 'K'.

Celey D. Keene

Lab Director/Quality Manager



PHONE (575) 393-2326 ° 101 E. MARLAND ° HOBBS, NM 88240

Analytical Results For:

BBC International, Inc.
 Cliff Brunson
 P.O. Box 805
 Hobbs NM, 88241
 Fax To: (575) 397-0397

Received: 07/12/2021
 Reported: 07/15/2021
 Project Name: PRIZE FED #7
 Project Number: (6-13-20)
 Project Location: OXY - LEA CO NM

Sampling Date: 07/09/2021
 Sampling Type: Soil
 Sampling Condition: Cool & Intact
 Sample Received By: Jodi Henson

Sample ID: BOTTOM 1 @ 1' (H211803-01)

BTX 8021B		mg/kg		Analyzed By: MS					
Analyte	Result	Reporting Limit	Analyzed	Method Blank	BS	% Recovery	True Value QC	RPD	Qualifier
Benzene*	<0.050	0.050	07/13/2021	ND	2.12	106	2.00	1.58	
Toluene*	<0.050	0.050	07/13/2021	ND	2.04	102	2.00	1.50	
Ethylbenzene*	<0.050	0.050	07/13/2021	ND	1.97	98.7	2.00	1.78	
Total Xylenes*	<0.150	0.150	07/13/2021	ND	6.02	100	6.00	1.55	
Total BTX	<0.300	0.300	07/13/2021	ND					

Surrogate: 4-Bromofluorobenzene (PID) 113 % 69.9-140

Chloride, SM4500Cl-B		mg/kg		Analyzed By: GM					
Analyte	Result	Reporting Limit	Analyzed	Method Blank	BS	% Recovery	True Value QC	RPD	Qualifier
Chloride	16.0	16.0	07/13/2021	ND	400	100	400	3.92	

TPH 8015M		mg/kg		Analyzed By: MS					
Analyte	Result	Reporting Limit	Analyzed	Method Blank	BS	% Recovery	True Value QC	RPD	Qualifier
GRO C6-C10*	<10.0	10.0	07/13/2021	ND	215	107	200	2.27	
DRO >C10-C28*	<10.0	10.0	07/13/2021	ND	206	103	200	9.82	
EXT DRO >C28-C36	<10.0	10.0	07/13/2021	ND					

Surrogate: 1-Chlorooctane 81.5 % 44.3-133

Surrogate: 1-Chlorooctadecane 76.1 % 38.9-142

Cardinal Laboratories

*=Accredited Analyte

PLEASE NOTE: Liability and Damages. Cardinal's liability and client's exclusive remedy for any claim arising, whether based in contract or tort, shall be limited to the amount paid by client for analyses. All claims, including those for negligence and any other cause whatsoever shall be deemed waived unless made in writing and received by Cardinal within thirty (30) days after completion of the applicable service. In no event shall Cardinal be liable for incidental or consequential damages, including, without limitation, business interruptions, loss of use, or loss of profits incurred by client, its subsidiaries, affiliates or successors arising out of or related to the performance of the services hereunder by Cardinal, regardless of whether such claim is based upon any of the above stated reasons or otherwise. Results relate only to the samples identified above. This report shall not be reproduced except in full with written approval of Cardinal Laboratories.

Celey D. Keene, Lab Director/Quality Manager



PHONE (575) 393-2326 ° 101 E. MARLAND ° HOBBS, NM 88240

Analytical Results For:

BBC International, Inc.
 Cliff Brunson
 P.O. Box 805
 Hobbs NM, 88241
 Fax To: (575) 397-0397

Received: 07/12/2021
 Reported: 07/15/2021
 Project Name: PRIZE FED #7
 Project Number: (6-13-20)
 Project Location: OXY - LEA CO NM

Sampling Date: 07/09/2021
 Sampling Type: Soil
 Sampling Condition: Cool & Intact
 Sample Received By: Jodi Henson

Sample ID: BOTTOM 2 @ 1' (H211803-02)

BTX 8021B		mg/kg		Analyzed By: MS						
Analyte	Result	Reporting Limit	Analyzed	Method Blank	BS	% Recovery	True Value QC	RPD	Qualifier	
Benzene*	<0.050	0.050	07/13/2021	ND	2.12	106	2.00	1.58		
Toluene*	<0.050	0.050	07/13/2021	ND	2.04	102	2.00	1.50		
Ethylbenzene*	<0.050	0.050	07/13/2021	ND	1.97	98.7	2.00	1.78		
Total Xylenes*	<0.150	0.150	07/13/2021	ND	6.02	100	6.00	1.55		
Total BTX	<0.300	0.300	07/13/2021	ND						

Surrogate: 4-Bromofluorobenzene (PID) 114 % 69.9-140

Chloride, SM4500Cl-B		mg/kg		Analyzed By: GM					
Analyte	Result	Reporting Limit	Analyzed	Method Blank	BS	% Recovery	True Value QC	RPD	Qualifier
Chloride	16.0	16.0	07/13/2021	ND	400	100	400	3.92	

TPH 8015M		mg/kg		Analyzed By: MS					
Analyte	Result	Reporting Limit	Analyzed	Method Blank	BS	% Recovery	True Value QC	RPD	Qualifier
GRO C6-C10*	<10.0	10.0	07/13/2021	ND	215	107	200	2.27	
DRO >C10-C28*	<10.0	10.0	07/13/2021	ND	206	103	200	9.82	
EXT DRO >C28-C36	<10.0	10.0	07/13/2021	ND					

Surrogate: 1-Chlorooctane 84.1 % 44.3-133

Surrogate: 1-Chlorooctadecane 79.2 % 38.9-142

Cardinal Laboratories

*=Accredited Analyte

PLEASE NOTE: Liability and Damages. Cardinal's liability and client's exclusive remedy for any claim arising, whether based in contract or tort, shall be limited to the amount paid by client for analyses. All claims, including those for negligence and any other cause whatsoever shall be deemed waived unless made in writing and received by Cardinal within thirty (30) days after completion of the applicable service. In no event shall Cardinal be liable for incidental or consequential damages, including, without limitation, business interruptions, loss of use, or loss of profits incurred by client, its subsidiaries, affiliates or successors arising out of or related to the performance of the services hereunder by Cardinal, regardless of whether such claim is based upon any of the above stated reasons or otherwise. Results relate only to the samples identified above. This report shall not be reproduced except in full with written approval of Cardinal Laboratories.

Celey D. Keene, Lab Director/Quality Manager



PHONE (575) 393-2326 ° 101 E. MARLAND ° HOBBS, NM 88240

Analytical Results For:

BBC International, Inc.
 Cliff Brunson
 P.O. Box 805
 Hobbs NM, 88241
 Fax To: (575) 397-0397

Received: 07/12/2021
 Reported: 07/15/2021
 Project Name: PRIZE FED #7
 Project Number: (6-13-20)
 Project Location: OXY - LEA CO NM

Sampling Date: 07/09/2021
 Sampling Type: Soil
 Sampling Condition: Cool & Intact
 Sample Received By: Jodi Henson

Sample ID: BOTTOM 3 @ 1' (H211803-03)

BTEx 8021B		mg/kg		Analyzed By: MS						
Analyte	Result	Reporting Limit	Analyzed	Method Blank	BS	% Recovery	True Value QC	RPD	Qualifier	
Benzene*	<0.050	0.050	07/13/2021	ND	2.12	106	2.00	1.58		
Toluene*	<0.050	0.050	07/13/2021	ND	2.04	102	2.00	1.50		
Ethylbenzene*	<0.050	0.050	07/13/2021	ND	1.97	98.7	2.00	1.78		
Total Xylenes*	<0.150	0.150	07/13/2021	ND	6.02	100	6.00	1.55		
Total BTEx	<0.300	0.300	07/13/2021	ND						

Surrogate: 4-Bromofluorobenzene (PID) 113 % 69.9-140

Chloride, SM4500CI-B		mg/kg		Analyzed By: GM						
Analyte	Result	Reporting Limit	Analyzed	Method Blank	BS	% Recovery	True Value QC	RPD	Qualifier	
Chloride	<16.0	16.0	07/13/2021	ND	400	100	400	3.92		

TPH 8015M		mg/kg		Analyzed By: MS					
Analyte	Result	Reporting Limit	Analyzed	Method Blank	BS	% Recovery	True Value QC	RPD	Qualifier
GRO C6-C10*	<10.0	10.0	07/13/2021	ND	215	107	200	2.27	
DRO >C10-C28*	<10.0	10.0	07/13/2021	ND	206	103	200	9.82	
EXT DRO >C28-C36	<10.0	10.0	07/13/2021	ND					

Surrogate: 1-Chlorooctane 76.6 % 44.3-133

Surrogate: 1-Chlorooctadecane 71.8 % 38.9-142

Cardinal Laboratories

*=Accredited Analyte

PLEASE NOTE: Liability and Damages. Cardinal's liability and client's exclusive remedy for any claim arising, whether based in contract or tort, shall be limited to the amount paid by client for analyses. All claims, including those for negligence and any other cause whatsoever shall be deemed waived unless made in writing and received by Cardinal within thirty (30) days after completion of the applicable service. In no event shall Cardinal be liable for incidental or consequential damages, including, without limitation, business interruptions, loss of use, or loss of profits incurred by client, its subsidiaries, affiliates or successors arising out of or related to the performance of the services hereunder by Cardinal, regardless of whether such claim is based upon any of the above stated reasons or otherwise. Results relate only to the samples identified above. This report shall not be reproduced except in full with written approval of Cardinal Laboratories.

Celey D. Keene, Lab Director/Quality Manager



PHONE (575) 393-2326 ° 101 E. MARLAND ° HOBBS, NM 88240

Analytical Results For:

BBC International, Inc.
 Cliff Brunson
 P.O. Box 805
 Hobbs NM, 88241
 Fax To: (575) 397-0397

Received: 07/12/2021
 Reported: 07/15/2021
 Project Name: PRIZE FED #7
 Project Number: (6-13-20)
 Project Location: OXY - LEA CO NM

Sampling Date: 07/09/2021
 Sampling Type: Soil
 Sampling Condition: Cool & Intact
 Sample Received By: Jodi Henson

Sample ID: BOTTOM 4 @ 1' (H211803-04)

BTX 8021B		mg/kg		Analyzed By: MS						
Analyte	Result	Reporting Limit	Analyzed	Method Blank	BS	% Recovery	True Value QC	RPD	Qualifier	
Benzene*	<0.050	0.050	07/13/2021	ND	2.12	106	2.00	1.58		
Toluene*	<0.050	0.050	07/13/2021	ND	2.04	102	2.00	1.50		
Ethylbenzene*	<0.050	0.050	07/13/2021	ND	1.97	98.7	2.00	1.78		
Total Xylenes*	<0.150	0.150	07/13/2021	ND	6.02	100	6.00	1.55		
Total BTX	<0.300	0.300	07/13/2021	ND						

Surrogate: 4-Bromofluorobenzene (PID) 113 % 69.9-140

Chloride, SM4500Cl-B		mg/kg		Analyzed By: GM					
Analyte	Result	Reporting Limit	Analyzed	Method Blank	BS	% Recovery	True Value QC	RPD	Qualifier
Chloride	32.0	16.0	07/13/2021	ND	400	100	400	3.92	

TPH 8015M		mg/kg		Analyzed By: MS					
Analyte	Result	Reporting Limit	Analyzed	Method Blank	BS	% Recovery	True Value QC	RPD	Qualifier
GRO C6-C10*	<10.0	10.0	07/13/2021	ND	215	107	200	2.27	
DRO >C10-C28*	<10.0	10.0	07/13/2021	ND	206	103	200	9.82	
EXT DRO >C28-C36	<10.0	10.0	07/13/2021	ND					

Surrogate: 1-Chlorooctane 78.7 % 44.3-133

Surrogate: 1-Chlorooctadecane 74.2 % 38.9-142

Cardinal Laboratories

*=Accredited Analyte

PLEASE NOTE: Liability and Damages. Cardinal's liability and client's exclusive remedy for any claim arising, whether based in contract or tort, shall be limited to the amount paid by client for analyses. All claims, including those for negligence and any other cause whatsoever shall be deemed waived unless made in writing and received by Cardinal within thirty (30) days after completion of the applicable service. In no event shall Cardinal be liable for incidental or consequential damages, including, without limitation, business interruptions, loss of use, or loss of profits incurred by client, its subsidiaries, affiliates or successors arising out of or related to the performance of the services hereunder by Cardinal, regardless of whether such claim is based upon any of the above stated reasons or otherwise. Results relate only to the samples identified above. This report shall not be reproduced except in full with written approval of Cardinal Laboratories.

Celey D. Keene, Lab Director/Quality Manager



PHONE (575) 393-2326 ° 101 E. MARLAND ° HOBBS, NM 88240

Analytical Results For:

BBC International, Inc.
 Cliff Brunson
 P.O. Box 805
 Hobbs NM, 88241
 Fax To: (575) 397-0397

Received: 07/12/2021
 Reported: 07/15/2021
 Project Name: PRIZE FED #7
 Project Number: (6-13-20)
 Project Location: OXY - LEA CO NM

Sampling Date: 07/09/2021
 Sampling Type: Soil
 Sampling Condition: Cool & Intact
 Sample Received By: Jodi Henson

Sample ID: BOTTOM 5 @ 1' (H211803-05)

BTX 8021B		mg/kg		Analyzed By: MS						
Analyte	Result	Reporting Limit	Analyzed	Method Blank	BS	% Recovery	True Value QC	RPD	Qualifier	
Benzene*	<0.050	0.050	07/13/2021	ND	2.12	106	2.00	1.58		
Toluene*	<0.050	0.050	07/13/2021	ND	2.04	102	2.00	1.50		
Ethylbenzene*	<0.050	0.050	07/13/2021	ND	1.97	98.7	2.00	1.78		
Total Xylenes*	<0.150	0.150	07/13/2021	ND	6.02	100	6.00	1.55		
Total BTX	<0.300	0.300	07/13/2021	ND						

Surrogate: 4-Bromofluorobenzene (PID) 113 % 69.9-140

Chloride, SM4500CI-B		mg/kg		Analyzed By: GM						
Analyte	Result	Reporting Limit	Analyzed	Method Blank	BS	% Recovery	True Value QC	RPD	Qualifier	
Chloride	<16.0	16.0	07/13/2021	ND	400	100	400	3.92		

TPH 8015M		mg/kg		Analyzed By: MS					
Analyte	Result	Reporting Limit	Analyzed	Method Blank	BS	% Recovery	True Value QC	RPD	Qualifier
GRO C6-C10*	<10.0	10.0	07/13/2021	ND	215	107	200	2.27	
DRO >C10-C28*	<10.0	10.0	07/13/2021	ND	206	103	200	9.82	
EXT DRO >C28-C36	<10.0	10.0	07/13/2021	ND					

Surrogate: 1-Chlorooctane 83.1 % 44.3-133

Surrogate: 1-Chlorooctadecane 79.0 % 38.9-142

Cardinal Laboratories

*=Accredited Analyte

PLEASE NOTE: Liability and Damages. Cardinal's liability and client's exclusive remedy for any claim arising, whether based in contract or tort, shall be limited to the amount paid by client for analyses. All claims, including those for negligence and any other cause whatsoever shall be deemed waived unless made in writing and received by Cardinal within thirty (30) days after completion of the applicable service. In no event shall Cardinal be liable for incidental or consequential damages, including, without limitation, business interruptions, loss of use, or loss of profits incurred by client, its subsidiaries, affiliates or successors arising out of or related to the performance of the services hereunder by Cardinal, regardless of whether such claim is based upon any of the above stated reasons or otherwise. Results relate only to the samples identified above. This report shall not be reproduced except in full with written approval of Cardinal Laboratories.

Celey D. Keene, Lab Director/Quality Manager



PHONE (575) 393-2326 ° 101 E. MARLAND ° HOBBS, NM 88240

Analytical Results For:

BBC International, Inc.
 Cliff Brunson
 P.O. Box 805
 Hobbs NM, 88241
 Fax To: (575) 397-0397

Received: 07/12/2021
 Reported: 07/15/2021
 Project Name: PRIZE FED #7
 Project Number: (6-13-20)
 Project Location: OXY - LEA CO NM

Sampling Date: 07/09/2021
 Sampling Type: Soil
 Sampling Condition: Cool & Intact
 Sample Received By: Jodi Henson

Sample ID: BOTTOM 6 @ 1' (H211803-06)

BTX 8021B		mg/kg		Analyzed By: MS						
Analyte	Result	Reporting Limit	Analyzed	Method Blank	BS	% Recovery	True Value QC	RPD	Qualifier	
Benzene*	<0.050	0.050	07/13/2021	ND	2.12	106	2.00	1.58		
Toluene*	<0.050	0.050	07/13/2021	ND	2.04	102	2.00	1.50		
Ethylbenzene*	<0.050	0.050	07/13/2021	ND	1.97	98.7	2.00	1.78		
Total Xylenes*	<0.150	0.150	07/13/2021	ND	6.02	100	6.00	1.55		
Total BTX	<0.300	0.300	07/13/2021	ND						

Surrogate: 4-Bromofluorobenzene (PID) 114 % 69.9-140

Chloride, SM4500Cl-B		mg/kg		Analyzed By: GM						
Analyte	Result	Reporting Limit	Analyzed	Method Blank	BS	% Recovery	True Value QC	RPD	Qualifier	
Chloride	<16.0	16.0	07/13/2021	ND	416	104	400	3.92		

TPH 8015M		mg/kg		Analyzed By: MS					
Analyte	Result	Reporting Limit	Analyzed	Method Blank	BS	% Recovery	True Value QC	RPD	Qualifier
GRO C6-C10*	<10.0	10.0	07/13/2021	ND	215	107	200	2.27	
DRO >C10-C28*	<10.0	10.0	07/13/2021	ND	206	103	200	9.82	
EXT DRO >C28-C36	<10.0	10.0	07/13/2021	ND					

Surrogate: 1-Chlorooctane 84.5 % 44.3-133

Surrogate: 1-Chlorooctadecane 79.6 % 38.9-142

Cardinal Laboratories

*=Accredited Analyte

PLEASE NOTE: Liability and Damages. Cardinal's liability and client's exclusive remedy for any claim arising, whether based in contract or tort, shall be limited to the amount paid by client for analyses. All claims, including those for negligence and any other cause whatsoever shall be deemed waived unless made in writing and received by Cardinal within thirty (30) days after completion of the applicable service. In no event shall Cardinal be liable for incidental or consequential damages, including, without limitation, business interruptions, loss of use, or loss of profits incurred by client, its subsidiaries, affiliates or successors arising out of or related to the performance of the services hereunder by Cardinal, regardless of whether such claim is based upon any of the above stated reasons or otherwise. Results relate only to the samples identified above. This report shall not be reproduced except in full with written approval of Cardinal Laboratories.

Celey D. Keene, Lab Director/Quality Manager



PHONE (575) 393-2326 • 101 E. MARLAND • HOBBS, NM 88240

Analytical Results For:

BBC International, Inc.
 Cliff Brunson
 P.O. Box 805
 Hobbs NM, 88241
 Fax To: (575) 397-0397

Received: 07/12/2021
 Reported: 07/15/2021
 Project Name: PRIZE FED #7
 Project Number: (6-13-20)
 Project Location: OXY - LEA CO NM

Sampling Date: 07/09/2021
 Sampling Type: Soil
 Sampling Condition: Cool & Intact
 Sample Received By: Jodi Henson

Sample ID: BOTTOM 7 @ 1' (H211803-07)

BTEx 8021B		mg/kg		Analyzed By: MS					
Analyte	Result	Reporting Limit	Analyzed	Method Blank	BS	% Recovery	True Value QC	RPD	Qualifier
Benzene*	<0.050	0.050	07/13/2021	ND	2.12	106	2.00	1.58	
Toluene*	<0.050	0.050	07/13/2021	ND	2.04	102	2.00	1.50	
Ethylbenzene*	<0.050	0.050	07/13/2021	ND	1.97	98.7	2.00	1.78	
Total Xylenes*	<0.150	0.150	07/13/2021	ND	6.02	100	6.00	1.55	
Total BTEx	<0.300	0.300	07/13/2021	ND					

Surrogate: 4-Bromofluorobenzene (PID) 112 % 69.9-140

Chloride, SM4500CI-B		mg/kg		Analyzed By: GM					
Analyte	Result	Reporting Limit	Analyzed	Method Blank	BS	% Recovery	True Value QC	RPD	Qualifier
Chloride	16.0	16.0	07/13/2021	ND	416	104	400	3.92	

TPH 8015M		mg/kg		Analyzed By: MS					
Analyte	Result	Reporting Limit	Analyzed	Method Blank	BS	% Recovery	True Value QC	RPD	Qualifier
GRO C6-C10*	<10.0	10.0	07/13/2021	ND	215	107	200	2.27	
DRO >C10-C28*	<10.0	10.0	07/13/2021	ND	206	103	200	9.82	
EXT DRO >C28-C36	<10.0	10.0	07/13/2021	ND					

Surrogate: 1-Chlorooctane 75.9 % 44.3-133

Surrogate: 1-Chlorooctadecane 71.8 % 38.9-142

Cardinal Laboratories

*=Accredited Analyte

PLEASE NOTE: Liability and Damages. Cardinal's liability and client's exclusive remedy for any claim arising, whether based in contract or tort, shall be limited to the amount paid by client for analyses. All claims, including those for negligence and any other cause whatsoever shall be deemed waived unless made in writing and received by Cardinal within thirty (30) days after completion of the applicable service. In no event shall Cardinal be liable for incidental or consequential damages, including, without limitation, business interruptions, loss of use, or loss of profits incurred by client, its subsidiaries, affiliates or successors arising out of or related to the performance of the services hereunder by Cardinal, regardless of whether such claim is based upon any of the above stated reasons or otherwise. Results relate only to the samples identified above. This report shall not be reproduced except in full with written approval of Cardinal Laboratories.

Celey D. Keene, Lab Director/Quality Manager



PHONE (575) 393-2326 ° 101 E. MARLAND ° HOBBS, NM 88240

Analytical Results For:

BBC International, Inc.
 Cliff Brunson
 P.O. Box 805
 Hobbs NM, 88241
 Fax To: (575) 397-0397

Received: 07/12/2021
 Reported: 07/15/2021
 Project Name: PRIZE FED #7
 Project Number: (6-13-20)
 Project Location: OXY - LEA CO NM

Sampling Date: 07/09/2021
 Sampling Type: Soil
 Sampling Condition: Cool & Intact
 Sample Received By: Jodi Henson

Sample ID: BOTTOM 8 @ 1' (H211803-08)

BTX 8021B		mg/kg		Analyzed By: MS						
Analyte	Result	Reporting Limit	Analyzed	Method Blank	BS	% Recovery	True Value QC	RPD	Qualifier	
Benzene*	<0.050	0.050	07/13/2021	ND	2.12	106	2.00	1.58		
Toluene*	<0.050	0.050	07/13/2021	ND	2.04	102	2.00	1.50		
Ethylbenzene*	<0.050	0.050	07/13/2021	ND	1.97	98.7	2.00	1.78		
Total Xylenes*	<0.150	0.150	07/13/2021	ND	6.02	100	6.00	1.55		
Total BTX	<0.300	0.300	07/13/2021	ND						

Surrogate: 4-Bromofluorobenzene (PID) 112 % 69.9-140

Chloride, SM4500Cl-B		mg/kg		Analyzed By: GM						
Analyte	Result	Reporting Limit	Analyzed	Method Blank	BS	% Recovery	True Value QC	RPD	Qualifier	
Chloride	<16.0	16.0	07/13/2021	ND	416	104	400	3.92		

TPH 8015M		mg/kg		Analyzed By: MS					
Analyte	Result	Reporting Limit	Analyzed	Method Blank	BS	% Recovery	True Value QC	RPD	Qualifier
GRO C6-C10*	<10.0	10.0	07/13/2021	ND	215	107	200	2.27	
DRO >C10-C28*	<10.0	10.0	07/13/2021	ND	206	103	200	9.82	
EXT DRO >C28-C36	<10.0	10.0	07/13/2021	ND					

Surrogate: 1-Chlorooctane 82.6 % 44.3-133

Surrogate: 1-Chlorooctadecane 77.8 % 38.9-142

Cardinal Laboratories

*=Accredited Analyte

PLEASE NOTE: Liability and Damages. Cardinal's liability and client's exclusive remedy for any claim arising, whether based in contract or tort, shall be limited to the amount paid by client for analyses. All claims, including those for negligence and any other cause whatsoever shall be deemed waived unless made in writing and received by Cardinal within thirty (30) days after completion of the applicable service. In no event shall Cardinal be liable for incidental or consequential damages, including, without limitation, business interruptions, loss of use, or loss of profits incurred by client, its subsidiaries, affiliates or successors arising out of or related to the performance of the services hereunder by Cardinal, regardless of whether such claim is based upon any of the above stated reasons or otherwise. Results relate only to the samples identified above. This report shall not be reproduced except in full with written approval of Cardinal Laboratories.

Celey D. Keene, Lab Director/Quality Manager



PHONE (575) 393-2326 • 101 E. MARLAND • HOBBS, NM 88240

Analytical Results For:

BBC International, Inc.
 Cliff Brunson
 P.O. Box 805
 Hobbs NM, 88241
 Fax To: (575) 397-0397

Received: 07/12/2021
 Reported: 07/15/2021
 Project Name: PRIZE FED #7
 Project Number: (6-13-20)
 Project Location: OXY - LEA CO NM

Sampling Date: 07/09/2021
 Sampling Type: Soil
 Sampling Condition: Cool & Intact
 Sample Received By: Jodi Henson

Sample ID: BOTTOM 9 @ 1' (H211803-09)

BTEx 8021B		mg/kg		Analyzed By: MS					
Analyte	Result	Reporting Limit	Analyzed	Method Blank	BS	% Recovery	True Value QC	RPD	Qualifier
Benzene*	<0.050	0.050	07/13/2021	ND	2.12	106	2.00	1.58	
Toluene*	<0.050	0.050	07/13/2021	ND	2.04	102	2.00	1.50	
Ethylbenzene*	<0.050	0.050	07/13/2021	ND	1.97	98.7	2.00	1.78	
Total Xylenes*	<0.150	0.150	07/13/2021	ND	6.02	100	6.00	1.55	
Total BTEx	<0.300	0.300	07/13/2021	ND					

Surrogate: 4-Bromofluorobenzene (PID) 114 % 69.9-140

Chloride, SM4500Cl-B		mg/kg		Analyzed By: GM						
Analyte	Result	Reporting Limit	Analyzed	Method Blank	BS	% Recovery	True Value QC	RPD	Qualifier	
Chloride	16.0	16.0	07/13/2021	ND	416	104	400	3.92		

TPH 8015M		mg/kg		Analyzed By: MS					
Analyte	Result	Reporting Limit	Analyzed	Method Blank	BS	% Recovery	True Value QC	RPD	Qualifier
GRO C6-C10*	<10.0	10.0	07/13/2021	ND	215	107	200	2.27	
DRO >C10-C28*	<10.0	10.0	07/13/2021	ND	206	103	200	9.82	
EXT DRO >C28-C36	<10.0	10.0	07/13/2021	ND					

Surrogate: 1-Chlorooctane 78.0 % 44.3-133

Surrogate: 1-Chlorooctadecane 72.8 % 38.9-142

Cardinal Laboratories

*=Accredited Analyte

PLEASE NOTE: Liability and Damages. Cardinal's liability and client's exclusive remedy for any claim arising, whether based in contract or tort, shall be limited to the amount paid by client for analyses. All claims, including those for negligence and any other cause whatsoever shall be deemed waived unless made in writing and received by Cardinal within thirty (30) days after completion of the applicable service. In no event shall Cardinal be liable for incidental or consequential damages, including, without limitation, business interruptions, loss of use, or loss of profits incurred by client, its subsidiaries, affiliates or successors arising out of or related to the performance of the services hereunder by Cardinal, regardless of whether such claim is based upon any of the above stated reasons or otherwise. Results relate only to the samples identified above. This report shall not be reproduced except in full with written approval of Cardinal Laboratories.

Celey D. Keene, Lab Director/Quality Manager



PHONE (575) 393-2326 • 101 E. MARLAND • HOBBS, NM 88240

Analytical Results For:

BBC International, Inc.
 Cliff Brunson
 P.O. Box 805
 Hobbs NM, 88241
 Fax To: (575) 397-0397

Received: 07/12/2021
 Reported: 07/15/2021
 Project Name: PRIZE FED #7
 Project Number: (6-13-20)
 Project Location: OXY - LEA CO NM

Sampling Date: 07/09/2021
 Sampling Type: Soil
 Sampling Condition: Cool & Intact
 Sample Received By: Jodi Henson

Sample ID: BOTTOM 10 @ 1' (H211803-10)

BTEx 8021B		mg/kg		Analyzed By: MS						
Analyte	Result	Reporting Limit	Analyzed	Method Blank	BS	% Recovery	True Value QC	RPD	Qualifier	
Benzene*	<0.050	0.050	07/13/2021	ND	2.12	106	2.00	1.58		
Toluene*	<0.050	0.050	07/13/2021	ND	2.04	102	2.00	1.50		
Ethylbenzene*	<0.050	0.050	07/13/2021	ND	1.97	98.7	2.00	1.78		
Total Xylenes*	<0.150	0.150	07/13/2021	ND	6.02	100	6.00	1.55		
Total BTEx	<0.300	0.300	07/13/2021	ND						

Surrogate: 4-Bromofluorobenzene (PID) 113 % 69.9-140

Chloride, SM4500Cl-B		mg/kg		Analyzed By: GM						
Analyte	Result	Reporting Limit	Analyzed	Method Blank	BS	% Recovery	True Value QC	RPD	Qualifier	
Chloride	16.0	16.0	07/13/2021	ND	416	104	400	3.92		

TPH 8015M		mg/kg		Analyzed By: MS					
Analyte	Result	Reporting Limit	Analyzed	Method Blank	BS	% Recovery	True Value QC	RPD	Qualifier
GRO C6-C10*	<10.0	10.0	07/13/2021	ND	215	107	200	2.27	
DRO >C10-C28*	<10.0	10.0	07/13/2021	ND	206	103	200	9.82	
EXT DRO >C28-C36	<10.0	10.0	07/13/2021	ND					

Surrogate: 1-Chlorooctane 71.8 % 44.3-133

Surrogate: 1-Chlorooctadecane 67.2 % 38.9-142

Cardinal Laboratories

*=Accredited Analyte

PLEASE NOTE: Liability and Damages. Cardinal's liability and client's exclusive remedy for any claim arising, whether based in contract or tort, shall be limited to the amount paid by client for analyses. All claims, including those for negligence and any other cause whatsoever shall be deemed waived unless made in writing and received by Cardinal within thirty (30) days after completion of the applicable service. In no event shall Cardinal be liable for incidental or consequential damages, including, without limitation, business interruptions, loss of use, or loss of profits incurred by client, its subsidiaries, affiliates or successors arising out of or related to the performance of the services hereunder by Cardinal, regardless of whether such claim is based upon any of the above stated reasons or otherwise. Results relate only to the samples identified above. This report shall not be reproduced except in full with written approval of Cardinal Laboratories.

Celey D. Keene, Lab Director/Quality Manager



PHONE (575) 393-2326 ° 101 E. MARLAND ° HOBBS, NM 88240

Analytical Results For:

BBC International, Inc.
 Cliff Brunson
 P.O. Box 805
 Hobbs NM, 88241
 Fax To: (575) 397-0397

Received: 07/12/2021
 Reported: 07/15/2021
 Project Name: PRIZE FED #7
 Project Number: (6-13-20)
 Project Location: OXY - LEA CO NM

Sampling Date: 07/09/2021
 Sampling Type: Soil
 Sampling Condition: Cool & Intact
 Sample Received By: Jodi Henson

Sample ID: BOTTOM 11 @ 1' (H211803-11)

BTEx 8021B		mg/kg		Analyzed By: MS					
Analyte	Result	Reporting Limit	Analyzed	Method Blank	BS	% Recovery	True Value QC	RPD	Qualifier
Benzene*	<0.050	0.050	07/13/2021	ND	2.12	106	2.00	1.58	
Toluene*	<0.050	0.050	07/13/2021	ND	2.04	102	2.00	1.50	
Ethylbenzene*	<0.050	0.050	07/13/2021	ND	1.97	98.7	2.00	1.78	
Total Xylenes*	<0.150	0.150	07/13/2021	ND	6.02	100	6.00	1.55	
Total BTEx	<0.300	0.300	07/13/2021	ND					

Surrogate: 4-Bromofluorobenzene (PID) 113 % 69.9-140

Chloride, SM4500CI-B		mg/kg		Analyzed By: GM						
Analyte	Result	Reporting Limit	Analyzed	Method Blank	BS	% Recovery	True Value QC	RPD	Qualifier	
Chloride	<16.0	16.0	07/13/2021	ND	416	104	400	3.92		

TPH 8015M		mg/kg		Analyzed By: MS					
Analyte	Result	Reporting Limit	Analyzed	Method Blank	BS	% Recovery	True Value QC	RPD	Qualifier
GRO C6-C10*	<10.0	10.0	07/13/2021	ND	215	107	200	2.27	
DRO >C10-C28*	<10.0	10.0	07/13/2021	ND	206	103	200	9.82	
EXT DRO >C28-C36	<10.0	10.0	07/13/2021	ND					

Surrogate: 1-Chlorooctane 81.5 % 44.3-133

Surrogate: 1-Chlorooctadecane 76.8 % 38.9-142

Cardinal Laboratories

*=Accredited Analyte

PLEASE NOTE: Liability and Damages. Cardinal's liability and client's exclusive remedy for any claim arising, whether based in contract or tort, shall be limited to the amount paid by client for analyses. All claims, including those for negligence and any other cause whatsoever shall be deemed waived unless made in writing and received by Cardinal within thirty (30) days after completion of the applicable service. In no event shall Cardinal be liable for incidental or consequential damages, including, without limitation, business interruptions, loss of use, or loss of profits incurred by client, its subsidiaries, affiliates or successors arising out of or related to the performance of the services hereunder by Cardinal, regardless of whether such claim is based upon any of the above stated reasons or otherwise. Results relate only to the samples identified above. This report shall not be reproduced except in full with written approval of Cardinal Laboratories.

Celey D. Keene, Lab Director/Quality Manager



PHONE (575) 393-2326 ° 101 E. MARLAND ° HOBBS, NM 88240

Analytical Results For:

BBC International, Inc.
 Cliff Brunson
 P.O. Box 805
 Hobbs NM, 88241
 Fax To: (575) 397-0397

Received: 07/12/2021
 Reported: 07/15/2021
 Project Name: PRIZE FED #7
 Project Number: (6-13-20)
 Project Location: OXY - LEA CO NM

Sampling Date: 07/09/2021
 Sampling Type: Soil
 Sampling Condition: Cool & Intact
 Sample Received By: Jodi Henson

Sample ID: BOTTOM 12 @ 1' (H211803-12)

BTEx 8021B		mg/kg		Analyzed By: MS					
Analyte	Result	Reporting Limit	Analyzed	Method Blank	BS	% Recovery	True Value QC	RPD	Qualifier
Benzene*	<0.050	0.050	07/13/2021	ND	2.12	106	2.00	1.58	
Toluene*	<0.050	0.050	07/13/2021	ND	2.04	102	2.00	1.50	
Ethylbenzene*	<0.050	0.050	07/13/2021	ND	1.97	98.7	2.00	1.78	
Total Xylenes*	<0.150	0.150	07/13/2021	ND	6.02	100	6.00	1.55	
Total BTEx	<0.300	0.300	07/13/2021	ND					

Surrogate: 4-Bromofluorobenzene (PID) 113 % 69.9-140

Chloride, SM4500CI-B		mg/kg		Analyzed By: GM						
Analyte	Result	Reporting Limit	Analyzed	Method Blank	BS	% Recovery	True Value QC	RPD	Qualifier	
Chloride	<16.0	16.0	07/13/2021	ND	416	104	400	3.92		

TPH 8015M		mg/kg		Analyzed By: MS					
Analyte	Result	Reporting Limit	Analyzed	Method Blank	BS	% Recovery	True Value QC	RPD	Qualifier
GRO C6-C10*	<10.0	10.0	07/13/2021	ND	215	107	200	2.27	
DRO >C10-C28*	<10.0	10.0	07/13/2021	ND	206	103	200	9.82	
EXT DRO >C28-C36	<10.0	10.0	07/13/2021	ND					

Surrogate: 1-Chlorooctane 79.8 % 44.3-133

Surrogate: 1-Chlorooctadecane 75.1 % 38.9-142

Cardinal Laboratories

*=Accredited Analyte

PLEASE NOTE: Liability and Damages. Cardinal's liability and client's exclusive remedy for any claim arising, whether based in contract or tort, shall be limited to the amount paid by client for analyses. All claims, including those for negligence and any other cause whatsoever shall be deemed waived unless made in writing and received by Cardinal within thirty (30) days after completion of the applicable service. In no event shall Cardinal be liable for incidental or consequential damages, including, without limitation, business interruptions, loss of use, or loss of profits incurred by client, its subsidiaries, affiliates or successors arising out of or related to the performance of the services hereunder by Cardinal, regardless of whether such claim is based upon any of the above stated reasons or otherwise. Results relate only to the samples identified above. This report shall not be reproduced except in full with written approval of Cardinal Laboratories.

Celey D. Keene, Lab Director/Quality Manager



PHONE (575) 393-2326 • 101 E. MARLAND • HOBBS, NM 88240

Analytical Results For:

BBC International, Inc.
 Cliff Brunson
 P.O. Box 805
 Hobbs NM, 88241
 Fax To: (575) 397-0397

Received: 07/12/2021
 Reported: 07/15/2021
 Project Name: PRIZE FED #7
 Project Number: (6-13-20)
 Project Location: OXY - LEA CO NM

Sampling Date: 07/09/2021
 Sampling Type: Soil
 Sampling Condition: Cool & Intact
 Sample Received By: Jodi Henson

Sample ID: BOTTOM 13 @ 1' (H211803-13)

BTX 8021B		mg/kg		Analyzed By: MS					
Analyte	Result	Reporting Limit	Analyzed	Method Blank	BS	% Recovery	True Value QC	RPD	Qualifier
Benzene*	<0.050	0.050	07/13/2021	ND	2.12	106	2.00	1.58	
Toluene*	<0.050	0.050	07/13/2021	ND	2.04	102	2.00	1.50	
Ethylbenzene*	<0.050	0.050	07/13/2021	ND	1.97	98.7	2.00	1.78	
Total Xylenes*	<0.150	0.150	07/13/2021	ND	6.02	100	6.00	1.55	
Total BTX	<0.300	0.300	07/13/2021	ND					

Surrogate: 4-Bromofluorobenzene (PID) 113 % 69.9-140

Chloride, SM4500CI-B		mg/kg		Analyzed By: GM						
Analyte	Result	Reporting Limit	Analyzed	Method Blank	BS	% Recovery	True Value QC	RPD	Qualifier	
Chloride	<16.0	16.0	07/13/2021	ND	416	104	400	3.92		

TPH 8015M		mg/kg		Analyzed By: MS					
Analyte	Result	Reporting Limit	Analyzed	Method Blank	BS	% Recovery	True Value QC	RPD	Qualifier
GRO C6-C10*	<10.0	10.0	07/13/2021	ND	215	107	200	2.27	
DRO >C10-C28*	<10.0	10.0	07/13/2021	ND	206	103	200	9.82	
EXT DRO >C28-C36	<10.0	10.0	07/13/2021	ND					

Surrogate: 1-Chlorooctane 80.9 % 44.3-133

Surrogate: 1-Chlorooctadecane 76.2 % 38.9-142

Cardinal Laboratories

*=Accredited Analyte

PLEASE NOTE: Liability and Damages. Cardinal's liability and client's exclusive remedy for any claim arising, whether based in contract or tort, shall be limited to the amount paid by client for analyses. All claims, including those for negligence and any other cause whatsoever shall be deemed waived unless made in writing and received by Cardinal within thirty (30) days after completion of the applicable service. In no event shall Cardinal be liable for incidental or consequential damages, including, without limitation, business interruptions, loss of use, or loss of profits incurred by client, its subsidiaries, affiliates or successors arising out of or related to the performance of the services hereunder by Cardinal, regardless of whether such claim is based upon any of the above stated reasons or otherwise. Results relate only to the samples identified above. This report shall not be reproduced except in full with written approval of Cardinal Laboratories.

Celey D. Keene, Lab Director/Quality Manager



PHONE (575) 393-2326 ° 101 E. MARLAND ° HOBBS, NM 88240

Analytical Results For:

BBC International, Inc.
 Cliff Brunson
 P.O. Box 805
 Hobbs NM, 88241
 Fax To: (575) 397-0397

Received: 07/12/2021
 Reported: 07/15/2021
 Project Name: PRIZE FED #7
 Project Number: (6-13-20)
 Project Location: OXY - LEA CO NM

Sampling Date: 07/09/2021
 Sampling Type: Soil
 Sampling Condition: Cool & Intact
 Sample Received By: Jodi Henson

Sample ID: BOTTOM 14 @ 1' (H211803-14)

BTEx 8021B		mg/kg		Analyzed By: MS						
Analyte	Result	Reporting Limit	Analyzed	Method Blank	BS	% Recovery	True Value QC	RPD	Qualifier	
Benzene*	<0.050	0.050	07/13/2021	ND	2.12	106	2.00	1.58		
Toluene*	<0.050	0.050	07/13/2021	ND	2.04	102	2.00	1.50		
Ethylbenzene*	<0.050	0.050	07/13/2021	ND	1.97	98.7	2.00	1.78		
Total Xylenes*	<0.150	0.150	07/13/2021	ND	6.02	100	6.00	1.55		
Total BTEx	<0.300	0.300	07/13/2021	ND						

Surrogate: 4-Bromofluorobenzene (PID) 113 % 69.9-140

Chloride, SM4500CI-B		mg/kg		Analyzed By: GM						
Analyte	Result	Reporting Limit	Analyzed	Method Blank	BS	% Recovery	True Value QC	RPD	Qualifier	
Chloride	<16.0	16.0	07/13/2021	ND	416	104	400	3.92		

TPH 8015M		mg/kg		Analyzed By: MS					
Analyte	Result	Reporting Limit	Analyzed	Method Blank	BS	% Recovery	True Value QC	RPD	Qualifier
GRO C6-C10*	<10.0	10.0	07/13/2021	ND	212	106	200	2.71	
DRO >C10-C28*	<10.0	10.0	07/13/2021	ND	223	111	200	7.96	
EXT DRO >C28-C36	<10.0	10.0	07/13/2021	ND					

Surrogate: 1-Chlorooctane 88.8 % 44.3-133

Surrogate: 1-Chlorooctadecane 93.6 % 38.9-142

Cardinal Laboratories

*=Accredited Analyte

PLEASE NOTE: Liability and Damages. Cardinal's liability and client's exclusive remedy for any claim arising, whether based in contract or tort, shall be limited to the amount paid by client for analyses. All claims, including those for negligence and any other cause whatsoever shall be deemed waived unless made in writing and received by Cardinal within thirty (30) days after completion of the applicable service. In no event shall Cardinal be liable for incidental or consequential damages, including, without limitation, business interruptions, loss of use, or loss of profits incurred by client, its subsidiaries, affiliates or successors arising out of or related to the performance of the services hereunder by Cardinal, regardless of whether such claim is based upon any of the above stated reasons or otherwise. Results relate only to the samples identified above. This report shall not be reproduced except in full with written approval of Cardinal Laboratories.

Celey D. Keene, Lab Director/Quality Manager



PHONE (575) 393-2326 ° 101 E. MARLAND ° HOBBS, NM 88240

Analytical Results For:

BBC International, Inc.
 Cliff Brunson
 P.O. Box 805
 Hobbs NM, 88241
 Fax To: (575) 397-0397

Received: 07/12/2021
 Reported: 07/15/2021
 Project Name: PRIZE FED #7
 Project Number: (6-13-20)
 Project Location: OXY - LEA CO NM

Sampling Date: 07/09/2021
 Sampling Type: Soil
 Sampling Condition: Cool & Intact
 Sample Received By: Jodi Henson

Sample ID: BOTTOM 15 @ 1' (H211803-15)

BTX 8021B		mg/kg		Analyzed By: MS						
Analyte	Result	Reporting Limit	Analyzed	Method Blank	BS	% Recovery	True Value QC	RPD	Qualifier	
Benzene*	<0.050	0.050	07/13/2021	ND	2.07	104	2.00	7.87		
Toluene*	<0.050	0.050	07/13/2021	ND	2.18	109	2.00	9.05		
Ethylbenzene*	<0.050	0.050	07/13/2021	ND	2.09	104	2.00	8.80		
Total Xylenes*	<0.150	0.150	07/13/2021	ND	6.20	103	6.00	8.78		
Total BTX	<0.300	0.300	07/13/2021	ND						

Surrogate: 4-Bromofluorobenzene (PID) 99.1 % 69.9-140

Chloride, SM4500CI-B		mg/kg		Analyzed By: GM						
Analyte	Result	Reporting Limit	Analyzed	Method Blank	BS	% Recovery	True Value QC	RPD	Qualifier	
Chloride	16.0	16.0	07/13/2021	ND	416	104	400	3.92		

TPH 8015M		mg/kg		Analyzed By: MS					
Analyte	Result	Reporting Limit	Analyzed	Method Blank	BS	% Recovery	True Value QC	RPD	Qualifier
GRO C6-C10*	<10.0	10.0	07/13/2021	ND	212	106	200	2.71	
DRO >C10-C28*	<10.0	10.0	07/13/2021	ND	223	111	200	7.96	
EXT DRO >C28-C36	<10.0	10.0	07/13/2021	ND					

Surrogate: 1-Chlorooctane 91.3 % 44.3-133

Surrogate: 1-Chlorooctadecane 97.8 % 38.9-142

Cardinal Laboratories

*=Accredited Analyte

PLEASE NOTE: Liability and Damages. Cardinal's liability and client's exclusive remedy for any claim arising, whether based in contract or tort, shall be limited to the amount paid by client for analyses. All claims, including those for negligence and any other cause whatsoever shall be deemed waived unless made in writing and received by Cardinal within thirty (30) days after completion of the applicable service. In no event shall Cardinal be liable for incidental or consequential damages, including, without limitation, business interruptions, loss of use, or loss of profits incurred by client, its subsidiaries, affiliates or successors arising out of or related to the performance of the services hereunder by Cardinal, regardless of whether such claim is based upon any of the above stated reasons or otherwise. Results relate only to the samples identified above. This report shall not be reproduced except in full with written approval of Cardinal Laboratories.

Celey D. Keene, Lab Director/Quality Manager



PHONE (575) 393-2326 ° 101 E. MARLAND ° HOBBS, NM 88240

Analytical Results For:

BBC International, Inc.
 Cliff Brunson
 P.O. Box 805
 Hobbs NM, 88241
 Fax To: (575) 397-0397

Received: 07/12/2021
 Reported: 07/15/2021
 Project Name: PRIZE FED #7
 Project Number: (6-13-20)
 Project Location: OXY - LEA CO NM

Sampling Date: 07/09/2021
 Sampling Type: Soil
 Sampling Condition: Cool & Intact
 Sample Received By: Jodi Henson

Sample ID: BOTTOM 16 @ 1' (H211803-16)

BTX 8021B		mg/kg		Analyzed By: MS					
Analyte	Result	Reporting Limit	Analyzed	Method Blank	BS	% Recovery	True Value QC	RPD	Qualifier
Benzene*	<0.050	0.050	07/13/2021	ND	2.07	104	2.00	7.87	
Toluene*	<0.050	0.050	07/13/2021	ND	2.18	109	2.00	9.05	
Ethylbenzene*	<0.050	0.050	07/13/2021	ND	2.09	104	2.00	8.80	
Total Xylenes*	<0.150	0.150	07/13/2021	ND	6.20	103	6.00	8.78	
Total BTX	<0.300	0.300	07/13/2021	ND					

Surrogate: 4-Bromofluorobenzene (PID) 101 % 69.9-140

Chloride, SM4500Cl-B		mg/kg		Analyzed By: GM						
Analyte	Result	Reporting Limit	Analyzed	Method Blank	BS	% Recovery	True Value QC	RPD	Qualifier	
Chloride	16.0	16.0	07/13/2021	ND	416	104	400	3.92		

TPH 8015M		mg/kg		Analyzed By: MS					
Analyte	Result	Reporting Limit	Analyzed	Method Blank	BS	% Recovery	True Value QC	RPD	Qualifier
GRO C6-C10*	<10.0	10.0	07/13/2021	ND	212	106	200	2.71	
DRO >C10-C28*	<10.0	10.0	07/13/2021	ND	223	111	200	7.96	
EXT DRO >C28-C36	<10.0	10.0	07/13/2021	ND					

Surrogate: 1-Chlorooctane 87.8 % 44.3-133

Surrogate: 1-Chlorooctadecane 90.7 % 38.9-142

Cardinal Laboratories

*=Accredited Analyte

PLEASE NOTE: Liability and Damages. Cardinal's liability and client's exclusive remedy for any claim arising, whether based in contract or tort, shall be limited to the amount paid by client for analyses. All claims, including those for negligence and any other cause whatsoever shall be deemed waived unless made in writing and received by Cardinal within thirty (30) days after completion of the applicable service. In no event shall Cardinal be liable for incidental or consequential damages, including, without limitation, business interruptions, loss of use, or loss of profits incurred by client, its subsidiaries, affiliates or successors arising out of or related to the performance of the services hereunder by Cardinal, regardless of whether such claim is based upon any of the above stated reasons or otherwise. Results relate only to the samples identified above. This report shall not be reproduced except in full with written approval of Cardinal Laboratories.

Celey D. Keene, Lab Director/Quality Manager



PHONE (575) 393-2326 ° 101 E. MARLAND ° HOBBS, NM 88240

Analytical Results For:

BBC International, Inc.
 Cliff Brunson
 P.O. Box 805
 Hobbs NM, 88241
 Fax To: (575) 397-0397

Received: 07/12/2021
 Reported: 07/15/2021
 Project Name: PRIZE FED #7
 Project Number: (6-13-20)
 Project Location: OXY - LEA CO NM

Sampling Date: 07/09/2021
 Sampling Type: Soil
 Sampling Condition: Cool & Intact
 Sample Received By: Jodi Henson

Sample ID: BOTTOM 17 @ 1' (H211803-17)

BTX 8021B		mg/kg		Analyzed By: MS					
Analyte	Result	Reporting Limit	Analyzed	Method Blank	BS	% Recovery	True Value QC	RPD	Qualifier
Benzene*	<0.050	0.050	07/13/2021	ND	2.07	104	2.00	7.87	
Toluene*	<0.050	0.050	07/13/2021	ND	2.18	109	2.00	9.05	
Ethylbenzene*	<0.050	0.050	07/13/2021	ND	2.09	104	2.00	8.80	
Total Xylenes*	<0.150	0.150	07/13/2021	ND	6.20	103	6.00	8.78	
Total BTX	<0.300	0.300	07/13/2021	ND					

Surrogate: 4-Bromofluorobenzene (PID) 102 % 69.9-140

Chloride, SM4500CI-B		mg/kg		Analyzed By: GM						
Analyte	Result	Reporting Limit	Analyzed	Method Blank	BS	% Recovery	True Value QC	RPD	Qualifier	
Chloride	16.0	16.0	07/13/2021	ND	416	104	400	3.92		

TPH 8015M		mg/kg		Analyzed By: MS					
Analyte	Result	Reporting Limit	Analyzed	Method Blank	BS	% Recovery	True Value QC	RPD	Qualifier
GRO C6-C10*	<10.0	10.0	07/13/2021	ND	212	106	200	2.71	
DRO >C10-C28*	<10.0	10.0	07/13/2021	ND	223	111	200	7.96	
EXT DRO >C28-C36	<10.0	10.0	07/13/2021	ND					

Surrogate: 1-Chlorooctane 94.1 % 44.3-133

Surrogate: 1-Chlorooctadecane 96.8 % 38.9-142

Cardinal Laboratories

*=Accredited Analyte

PLEASE NOTE: Liability and Damages. Cardinal's liability and client's exclusive remedy for any claim arising, whether based in contract or tort, shall be limited to the amount paid by client for analyses. All claims, including those for negligence and any other cause whatsoever shall be deemed waived unless made in writing and received by Cardinal within thirty (30) days after completion of the applicable service. In no event shall Cardinal be liable for incidental or consequential damages, including, without limitation, business interruptions, loss of use, or loss of profits incurred by client, its subsidiaries, affiliates or successors arising out of or related to the performance of the services hereunder by Cardinal, regardless of whether such claim is based upon any of the above stated reasons or otherwise. Results relate only to the samples identified above. This report shall not be reproduced except in full with written approval of Cardinal Laboratories.

Celey D. Keene, Lab Director/Quality Manager



PHONE (575) 393-2326 • 101 E. MARLAND • HOBBS, NM 88240

Analytical Results For:

BBC International, Inc.
 Cliff Brunson
 P.O. Box 805
 Hobbs NM, 88241
 Fax To: (575) 397-0397

Received: 07/12/2021
 Reported: 07/15/2021
 Project Name: PRIZE FED #7
 Project Number: (6-13-20)
 Project Location: OXY - LEA CO NM

Sampling Date: 07/09/2021
 Sampling Type: Soil
 Sampling Condition: Cool & Intact
 Sample Received By: Jodi Henson

Sample ID: BOTTOM 18 @ 2' (H211803-18)

BTX 8021B		mg/kg		Analyzed By: MS						
Analyte	Result	Reporting Limit	Analyzed	Method Blank	BS	% Recovery	True Value QC	RPD	Qualifier	
Benzene*	<0.050	0.050	07/13/2021	ND	2.07	104	2.00	7.87		
Toluene*	<0.050	0.050	07/13/2021	ND	2.18	109	2.00	9.05		
Ethylbenzene*	<0.050	0.050	07/13/2021	ND	2.09	104	2.00	8.80		
Total Xylenes*	<0.150	0.150	07/13/2021	ND	6.20	103	6.00	8.78		
Total BTX	<0.300	0.300	07/13/2021	ND						

Surrogate: 4-Bromofluorobenzene (PID) 101 % 69.9-140

Chloride, SM4500CI-B		mg/kg		Analyzed By: GM						
Analyte	Result	Reporting Limit	Analyzed	Method Blank	BS	% Recovery	True Value QC	RPD	Qualifier	
Chloride	<16.0	16.0	07/13/2021	ND	416	104	400	3.92		

TPH 8015M		mg/kg		Analyzed By: MS					
Analyte	Result	Reporting Limit	Analyzed	Method Blank	BS	% Recovery	True Value QC	RPD	Qualifier
GRO C6-C10*	<10.0	10.0	07/13/2021	ND	212	106	200	2.71	
DRO >C10-C28*	<10.0	10.0	07/13/2021	ND	223	111	200	7.96	
EXT DRO >C28-C36	<10.0	10.0	07/13/2021	ND					

Surrogate: 1-Chlorooctane 99.5 % 44.3-133

Surrogate: 1-Chlorooctadecane 102 % 38.9-142

Cardinal Laboratories

*=Accredited Analyte

PLEASE NOTE: Liability and Damages. Cardinal's liability and client's exclusive remedy for any claim arising, whether based in contract or tort, shall be limited to the amount paid by client for analyses. All claims, including those for negligence and any other cause whatsoever shall be deemed waived unless made in writing and received by Cardinal within thirty (30) days after completion of the applicable service. In no event shall Cardinal be liable for incidental or consequential damages, including, without limitation, business interruptions, loss of use, or loss of profits incurred by client, its subsidiaries, affiliates or successors arising out of or related to the performance of the services hereunder by Cardinal, regardless of whether such claim is based upon any of the above stated reasons or otherwise. Results relate only to the samples identified above. This report shall not be reproduced except in full with written approval of Cardinal Laboratories.

Celey D. Keene, Lab Director/Quality Manager



PHONE (575) 393-2326 ° 101 E. MARLAND ° HOBBS, NM 88240

Analytical Results For:

BBC International, Inc.
 Cliff Brunson
 P.O. Box 805
 Hobbs NM, 88241
 Fax To: (575) 397-0397

Received: 07/12/2021
 Reported: 07/15/2021
 Project Name: PRIZE FED #7
 Project Number: (6-13-20)
 Project Location: OXY - LEA CO NM

Sampling Date: 07/09/2021
 Sampling Type: Soil
 Sampling Condition: Cool & Intact
 Sample Received By: Jodi Henson

Sample ID: BOTTOM 19 @ 2' (H211803-19)

BTX 8021B		mg/kg		Analyzed By: MS					
Analyte	Result	Reporting Limit	Analyzed	Method Blank	BS	% Recovery	True Value QC	RPD	Qualifier
Benzene*	<0.050	0.050	07/13/2021	ND	2.07	104	2.00	7.87	
Toluene*	<0.050	0.050	07/13/2021	ND	2.18	109	2.00	9.05	
Ethylbenzene*	<0.050	0.050	07/13/2021	ND	2.09	104	2.00	8.80	
Total Xylenes*	<0.150	0.150	07/13/2021	ND	6.20	103	6.00	8.78	
Total BTX	<0.300	0.300	07/13/2021	ND					

Surrogate: 4-Bromofluorobenzene (PID) 102 % 69.9-140

Chloride, SM4500CI-B		mg/kg		Analyzed By: GM						
Analyte	Result	Reporting Limit	Analyzed	Method Blank	BS	% Recovery	True Value QC	RPD	Qualifier	
Chloride	32.0	16.0	07/13/2021	ND	416	104	400	3.92		

TPH 8015M		mg/kg		Analyzed By: MS					
Analyte	Result	Reporting Limit	Analyzed	Method Blank	BS	% Recovery	True Value QC	RPD	Qualifier
GRO C6-C10*	<10.0	10.0	07/13/2021	ND	212	106	200	2.71	
DRO >C10-C28*	<10.0	10.0	07/13/2021	ND	223	111	200	7.96	
EXT DRO >C28-C36	<10.0	10.0	07/13/2021	ND					

Surrogate: 1-Chlorooctane 100 % 44.3-133

Surrogate: 1-Chlorooctadecane 102 % 38.9-142

Cardinal Laboratories

*=Accredited Analyte

PLEASE NOTE: Liability and Damages. Cardinal's liability and client's exclusive remedy for any claim arising, whether based in contract or tort, shall be limited to the amount paid by client for analyses. All claims, including those for negligence and any other cause whatsoever shall be deemed waived unless made in writing and received by Cardinal within thirty (30) days after completion of the applicable service. In no event shall Cardinal be liable for incidental or consequential damages, including, without limitation, business interruptions, loss of use, or loss of profits incurred by client, its subsidiaries, affiliates or successors arising out of or related to the performance of the services hereunder by Cardinal, regardless of whether such claim is based upon any of the above stated reasons or otherwise. Results relate only to the samples identified above. This report shall not be reproduced except in full with written approval of Cardinal Laboratories.

Celey D. Keene, Lab Director/Quality Manager



PHONE (575) 393-2326 ° 101 E. MARLAND ° HOBBS, NM 88240

Analytical Results For:

BBC International, Inc.
 Cliff Brunson
 P.O. Box 805
 Hobbs NM, 88241
 Fax To: (575) 397-0397

Received: 07/12/2021
 Reported: 07/15/2021
 Project Name: PRIZE FED #7
 Project Number: (6-13-20)
 Project Location: OXY - LEA CO NM

Sampling Date: 07/09/2021
 Sampling Type: Soil
 Sampling Condition: Cool & Intact
 Sample Received By: Jodi Henson

Sample ID: BOTTOM 20 @ 2' (H211803-20)

BTX 8021B		mg/kg		Analyzed By: MS						
Analyte	Result	Reporting Limit	Analyzed	Method Blank	BS	% Recovery	True Value QC	RPD	Qualifier	
Benzene*	<0.050	0.050	07/13/2021	ND	2.07	104	2.00	7.87		
Toluene*	<0.050	0.050	07/13/2021	ND	2.18	109	2.00	9.05		
Ethylbenzene*	<0.050	0.050	07/13/2021	ND	2.09	104	2.00	8.80		
Total Xylenes*	<0.150	0.150	07/13/2021	ND	6.20	103	6.00	8.78		
Total BTX	<0.300	0.300	07/13/2021	ND						

Surrogate: 4-Bromofluorobenzene (PID) 101 % 69.9-140

Chloride, SM4500CI-B		mg/kg		Analyzed By: GM						
Analyte	Result	Reporting Limit	Analyzed	Method Blank	BS	% Recovery	True Value QC	RPD	Qualifier	
Chloride	<16.0	16.0	07/13/2021	ND	416	104	400	3.92		

TPH 8015M		mg/kg		Analyzed By: MS					
Analyte	Result	Reporting Limit	Analyzed	Method Blank	BS	% Recovery	True Value QC	RPD	Qualifier
GRO C6-C10*	<10.0	10.0	07/13/2021	ND	212	106	200	2.71	
DRO >C10-C28*	<10.0	10.0	07/13/2021	ND	223	111	200	7.96	
EXT DRO >C28-C36	<10.0	10.0	07/13/2021	ND					

Surrogate: 1-Chlorooctane 96.1 % 44.3-133

Surrogate: 1-Chlorooctadecane 99.6 % 38.9-142

Cardinal Laboratories

*=Accredited Analyte

PLEASE NOTE: Liability and Damages. Cardinal's liability and client's exclusive remedy for any claim arising, whether based in contract or tort, shall be limited to the amount paid by client for analyses. All claims, including those for negligence and any other cause whatsoever shall be deemed waived unless made in writing and received by Cardinal within thirty (30) days after completion of the applicable service. In no event shall Cardinal be liable for incidental or consequential damages, including, without limitation, business interruptions, loss of use, or loss of profits incurred by client, its subsidiaries, affiliates or successors arising out of or related to the performance of the services hereunder by Cardinal, regardless of whether such claim is based upon any of the above stated reasons or otherwise. Results relate only to the samples identified above. This report shall not be reproduced except in full with written approval of Cardinal Laboratories.

Celey D. Keene, Lab Director/Quality Manager



PHONE (575) 393-2326 • 101 E. MARLAND • HOBBS, NM 88240

Analytical Results For:

BBC International, Inc.
 Cliff Brunson
 P.O. Box 805
 Hobbs NM, 88241
 Fax To: (575) 397-0397

Received: 07/12/2021
 Reported: 07/15/2021
 Project Name: PRIZE FED #7
 Project Number: (6-13-20)
 Project Location: OXY - LEA CO NM

Sampling Date: 07/09/2021
 Sampling Type: Soil
 Sampling Condition: Cool & Intact
 Sample Received By: Jodi Henson

Sample ID: BOTTOM 21 @ 2' (H211803-21)

BTX 8021B		mg/kg		Analyzed By: MS					
Analyte	Result	Reporting Limit	Analyzed	Method Blank	BS	% Recovery	True Value QC	RPD	Qualifier
Benzene*	<0.050	0.050	07/13/2021	ND	2.07	104	2.00	7.87	
Toluene*	<0.050	0.050	07/13/2021	ND	2.18	109	2.00	9.05	
Ethylbenzene*	<0.050	0.050	07/13/2021	ND	2.09	104	2.00	8.80	
Total Xylenes*	<0.150	0.150	07/13/2021	ND	6.20	103	6.00	8.78	
Total BTX	<0.300	0.300	07/13/2021	ND					

Surrogate: 4-Bromofluorobenzene (PID) 100 % 69.9-140

Chloride, SM4500CI-B		mg/kg		Analyzed By: GM						
Analyte	Result	Reporting Limit	Analyzed	Method Blank	BS	% Recovery	True Value QC	RPD	Qualifier	
Chloride	16.0	16.0	07/13/2021	ND	416	104	400	3.92		

TPH 8015M		mg/kg		Analyzed By: MS					
Analyte	Result	Reporting Limit	Analyzed	Method Blank	BS	% Recovery	True Value QC	RPD	Qualifier
GRO C6-C10*	<10.0	10.0	07/13/2021	ND	212	106	200	2.71	
DRO >C10-C28*	<10.0	10.0	07/13/2021	ND	223	111	200	7.96	
EXT DRO >C28-C36	<10.0	10.0	07/13/2021	ND					

Surrogate: 1-Chlorooctane 97.6 % 44.3-133

Surrogate: 1-Chlorooctadecane 100 % 38.9-142

Cardinal Laboratories

*=Accredited Analyte

PLEASE NOTE: Liability and Damages. Cardinal's liability and client's exclusive remedy for any claim arising, whether based in contract or tort, shall be limited to the amount paid by client for analyses. All claims, including those for negligence and any other cause whatsoever shall be deemed waived unless made in writing and received by Cardinal within thirty (30) days after completion of the applicable service. In no event shall Cardinal be liable for incidental or consequential damages, including, without limitation, business interruptions, loss of use, or loss of profits incurred by client, its subsidiaries, affiliates or successors arising out of or related to the performance of the services hereunder by Cardinal, regardless of whether such claim is based upon any of the above stated reasons or otherwise. Results relate only to the samples identified above. This report shall not be reproduced except in full with written approval of Cardinal Laboratories.

Celey D. Keene, Lab Director/Quality Manager



PHONE (575) 393-2326 ° 101 E. MARLAND ° HOBBS, NM 88240

Analytical Results For:

BBC International, Inc.
 Cliff Brunson
 P.O. Box 805
 Hobbs NM, 88241
 Fax To: (575) 397-0397

Received: 07/12/2021
 Reported: 07/15/2021
 Project Name: PRIZE FED #7
 Project Number: (6-13-20)
 Project Location: OXY - LEA CO NM

Sampling Date: 07/09/2021
 Sampling Type: Soil
 Sampling Condition: Cool & Intact
 Sample Received By: Jodi Henson

Sample ID: BOTTOM 22 @ 2' (H211803-22)

BTX 8021B		mg/kg		Analyzed By: MS					
Analyte	Result	Reporting Limit	Analyzed	Method Blank	BS	% Recovery	True Value QC	RPD	Qualifier
Benzene*	<0.050	0.050	07/13/2021	ND	2.07	104	2.00	7.87	
Toluene*	<0.050	0.050	07/13/2021	ND	2.18	109	2.00	9.05	
Ethylbenzene*	<0.050	0.050	07/13/2021	ND	2.09	104	2.00	8.80	
Total Xylenes*	<0.150	0.150	07/13/2021	ND	6.20	103	6.00	8.78	
Total BTX	<0.300	0.300	07/13/2021	ND					

Surrogate: 4-Bromofluorobenzene (PID) 99.2 % 69.9-140

Chloride, SM4500CI-B		mg/kg		Analyzed By: GM						
Analyte	Result	Reporting Limit	Analyzed	Method Blank	BS	% Recovery	True Value QC	RPD	Qualifier	
Chloride	16.0	16.0	07/13/2021	ND	416	104	400	3.92		

TPH 8015M		mg/kg		Analyzed By: MS					
Analyte	Result	Reporting Limit	Analyzed	Method Blank	BS	% Recovery	True Value QC	RPD	Qualifier
GRO C6-C10*	<10.0	10.0	07/13/2021	ND	212	106	200	2.71	
DRO >C10-C28*	<10.0	10.0	07/13/2021	ND	223	111	200	7.96	
EXT DRO >C28-C36	<10.0	10.0	07/13/2021	ND					

Surrogate: 1-Chlorooctane 86.5 % 44.3-133

Surrogate: 1-Chlorooctadecane 90.0 % 38.9-142

Cardinal Laboratories

*=Accredited Analyte

PLEASE NOTE: Liability and Damages. Cardinal's liability and client's exclusive remedy for any claim arising, whether based in contract or tort, shall be limited to the amount paid by client for analyses. All claims, including those for negligence and any other cause whatsoever shall be deemed waived unless made in writing and received by Cardinal within thirty (30) days after completion of the applicable service. In no event shall Cardinal be liable for incidental or consequential damages, including, without limitation, business interruptions, loss of use, or loss of profits incurred by client, its subsidiaries, affiliates or successors arising out of or related to the performance of the services hereunder by Cardinal, regardless of whether such claim is based upon any of the above stated reasons or otherwise. Results relate only to the samples identified above. This report shall not be reproduced except in full with written approval of Cardinal Laboratories.

Celey D. Keene, Lab Director/Quality Manager



PHONE (575) 393-2326 ° 101 E. MARLAND ° HOBBS, NM 88240

Analytical Results For:

BBC International, Inc.
 Cliff Brunson
 P.O. Box 805
 Hobbs NM, 88241
 Fax To: (575) 397-0397

Received: 07/12/2021
 Reported: 07/15/2021
 Project Name: PRIZE FED #7
 Project Number: (6-13-20)
 Project Location: OXY - LEA CO NM

Sampling Date: 07/09/2021
 Sampling Type: Soil
 Sampling Condition: Cool & Intact
 Sample Received By: Jodi Henson

Sample ID: BOTTOM 23 @ 2' (H211803-23)

BTX 8021B		mg/kg		Analyzed By: MS						
Analyte	Result	Reporting Limit	Analyzed	Method Blank	BS	% Recovery	True Value QC	RPD	Qualifier	
Benzene*	<0.050	0.050	07/13/2021	ND	2.07	104	2.00	7.87		
Toluene*	<0.050	0.050	07/13/2021	ND	2.18	109	2.00	9.05		
Ethylbenzene*	<0.050	0.050	07/13/2021	ND	2.09	104	2.00	8.80		
Total Xylenes*	<0.150	0.150	07/13/2021	ND	6.20	103	6.00	8.78		
Total BTX	<0.300	0.300	07/13/2021	ND						

Surrogate: 4-Bromofluorobenzene (PID) 100 % 69.9-140

Chloride, SM4500CI-B		mg/kg		Analyzed By: GM						
Analyte	Result	Reporting Limit	Analyzed	Method Blank	BS	% Recovery	True Value QC	RPD	Qualifier	
Chloride	16.0	16.0	07/13/2021	ND	416	104	400	3.92		

TPH 8015M		mg/kg		Analyzed By: MS					
Analyte	Result	Reporting Limit	Analyzed	Method Blank	BS	% Recovery	True Value QC	RPD	Qualifier
GRO C6-C10*	<10.0	10.0	07/13/2021	ND	212	106	200	2.71	
DRO >C10-C28*	<10.0	10.0	07/13/2021	ND	223	111	200	7.96	
EXT DRO >C28-C36	<10.0	10.0	07/13/2021	ND					

Surrogate: 1-Chlorooctane 94.3 % 44.3-133

Surrogate: 1-Chlorooctadecane 99.2 % 38.9-142

Cardinal Laboratories

*=Accredited Analyte

PLEASE NOTE: Liability and Damages. Cardinal's liability and client's exclusive remedy for any claim arising, whether based in contract or tort, shall be limited to the amount paid by client for analyses. All claims, including those for negligence and any other cause whatsoever shall be deemed waived unless made in writing and received by Cardinal within thirty (30) days after completion of the applicable service. In no event shall Cardinal be liable for incidental or consequential damages, including, without limitation, business interruptions, loss of use, or loss of profits incurred by client, its subsidiaries, affiliates or successors arising out of or related to the performance of the services hereunder by Cardinal, regardless of whether such claim is based upon any of the above stated reasons or otherwise. Results relate only to the samples identified above. This report shall not be reproduced except in full with written approval of Cardinal Laboratories.

Celey D. Keene, Lab Director/Quality Manager



PHONE (575) 393-2326 • 101 E. MARLAND • HOBBS, NM 88240

Analytical Results For:

BBC International, Inc.
 Cliff Brunson
 P.O. Box 805
 Hobbs NM, 88241
 Fax To: (575) 397-0397

Received: 07/12/2021
 Reported: 07/15/2021
 Project Name: PRIZE FED #7
 Project Number: (6-13-20)
 Project Location: OXY - LEA CO NM

Sampling Date: 07/09/2021
 Sampling Type: Soil
 Sampling Condition: Cool & Intact
 Sample Received By: Jodi Henson

Sample ID: BOTTOM 24 @ 2' (H211803-24)

BTX 8021B		mg/kg		Analyzed By: MS					
Analyte	Result	Reporting Limit	Analyzed	Method Blank	BS	% Recovery	True Value QC	RPD	Qualifier
Benzene*	<0.050	0.050	07/13/2021	ND	2.07	104	2.00	7.87	
Toluene*	<0.050	0.050	07/13/2021	ND	2.18	109	2.00	9.05	
Ethylbenzene*	<0.050	0.050	07/13/2021	ND	2.09	104	2.00	8.80	
Total Xylenes*	<0.150	0.150	07/13/2021	ND	6.20	103	6.00	8.78	
Total BTX	<0.300	0.300	07/13/2021	ND					

Surrogate: 4-Bromofluorobenzene (PID) 99.3 % 69.9-140

Chloride, SM4500CI-B		mg/kg		Analyzed By: GM						
Analyte	Result	Reporting Limit	Analyzed	Method Blank	BS	% Recovery	True Value QC	RPD	Qualifier	
Chloride	<16.0	16.0	07/13/2021	ND	416	104	400	3.92		

TPH 8015M		mg/kg		Analyzed By: MS					
Analyte	Result	Reporting Limit	Analyzed	Method Blank	BS	% Recovery	True Value QC	RPD	Qualifier
GRO C6-C10*	<10.0	10.0	07/13/2021	ND	212	106	200	2.71	
DRO >C10-C28*	<10.0	10.0	07/13/2021	ND	223	111	200	7.96	
EXT DRO >C28-C36	<10.0	10.0	07/13/2021	ND					

Surrogate: 1-Chlorooctane 95.4 % 44.3-133

Surrogate: 1-Chlorooctadecane 102 % 38.9-142

Cardinal Laboratories

*=Accredited Analyte

PLEASE NOTE: Liability and Damages. Cardinal's liability and client's exclusive remedy for any claim arising, whether based in contract or tort, shall be limited to the amount paid by client for analyses. All claims, including those for negligence and any other cause whatsoever shall be deemed waived unless made in writing and received by Cardinal within thirty (30) days after completion of the applicable service. In no event shall Cardinal be liable for incidental or consequential damages, including, without limitation, business interruptions, loss of use, or loss of profits incurred by client, its subsidiaries, affiliates or successors arising out of or related to the performance of the services hereunder by Cardinal, regardless of whether such claim is based upon any of the above stated reasons or otherwise. Results relate only to the samples identified above. This report shall not be reproduced except in full with written approval of Cardinal Laboratories.

Celey D. Keene, Lab Director/Quality Manager



PHONE (575) 393-2326 ° 101 E. MARLAND ° HOBBS, NM 88240

Analytical Results For:

BBC International, Inc.
 Cliff Brunson
 P.O. Box 805
 Hobbs NM, 88241
 Fax To: (575) 397-0397

Received: 07/12/2021
 Reported: 07/15/2021
 Project Name: PRIZE FED #7
 Project Number: (6-13-20)
 Project Location: OXY - LEA CO NM

Sampling Date: 07/09/2021
 Sampling Type: Soil
 Sampling Condition: Cool & Intact
 Sample Received By: Jodi Henson

Sample ID: BOTTOM 25 @ 2' (H211803-25)

BTX 8021B		mg/kg		Analyzed By: MS					
Analyte	Result	Reporting Limit	Analyzed	Method Blank	BS	% Recovery	True Value QC	RPD	Qualifier
Benzene*	<0.050	0.050	07/13/2021	ND	2.07	104	2.00	7.87	
Toluene*	<0.050	0.050	07/13/2021	ND	2.18	109	2.00	9.05	
Ethylbenzene*	<0.050	0.050	07/13/2021	ND	2.09	104	2.00	8.80	
Total Xylenes*	<0.150	0.150	07/13/2021	ND	6.20	103	6.00	8.78	
Total BTX	<0.300	0.300	07/13/2021	ND					

Surrogate: 4-Bromofluorobenzene (PID) 103 % 69.9-140

Chloride, SM4500CI-B		mg/kg		Analyzed By: GM						
Analyte	Result	Reporting Limit	Analyzed	Method Blank	BS	% Recovery	True Value QC	RPD	Qualifier	
Chloride	<16.0	16.0	07/13/2021	ND	416	104	400	3.92		

TPH 8015M		mg/kg		Analyzed By: MS					
Analyte	Result	Reporting Limit	Analyzed	Method Blank	BS	% Recovery	True Value QC	RPD	Qualifier
GRO C6-C10*	<10.0	10.0	07/13/2021	ND	212	106	200	2.71	
DRO >C10-C28*	<10.0	10.0	07/13/2021	ND	223	111	200	7.96	
EXT DRO >C28-C36	<10.0	10.0	07/13/2021	ND					

Surrogate: 1-Chlorooctane 96.4 % 44.3-133

Surrogate: 1-Chlorooctadecane 102 % 38.9-142

Cardinal Laboratories

*=Accredited Analyte

PLEASE NOTE: Liability and Damages. Cardinal's liability and client's exclusive remedy for any claim arising, whether based in contract or tort, shall be limited to the amount paid by client for analyses. All claims, including those for negligence and any other cause whatsoever shall be deemed waived unless made in writing and received by Cardinal within thirty (30) days after completion of the applicable service. In no event shall Cardinal be liable for incidental or consequential damages, including, without limitation, business interruptions, loss of use, or loss of profits incurred by client, its subsidiaries, affiliates or successors arising out of or related to the performance of the services hereunder by Cardinal, regardless of whether such claim is based upon any of the above stated reasons or otherwise. Results relate only to the samples identified above. This report shall not be reproduced except in full with written approval of Cardinal Laboratories.

Celey D. Keene, Lab Director/Quality Manager



PHONE (575) 393-2326 ° 101 E. MARLAND ° HOBBS, NM 88240

Analytical Results For:

BBC International, Inc.
 Cliff Brunson
 P.O. Box 805
 Hobbs NM, 88241
 Fax To: (575) 397-0397

Received: 07/12/2021
 Reported: 07/15/2021
 Project Name: PRIZE FED #7
 Project Number: (6-13-20)
 Project Location: OXY - LEA CO NM

Sampling Date: 07/09/2021
 Sampling Type: Soil
 Sampling Condition: Cool & Intact
 Sample Received By: Jodi Henson

Sample ID: BOTTOM 26 @ 2' (H211803-26)

BTX 8021B		mg/kg		Analyzed By: MS					
Analyte	Result	Reporting Limit	Analyzed	Method Blank	BS	% Recovery	True Value QC	RPD	Qualifier
Benzene*	<0.050	0.050	07/13/2021	ND	2.07	104	2.00	7.87	
Toluene*	<0.050	0.050	07/13/2021	ND	2.18	109	2.00	9.05	
Ethylbenzene*	<0.050	0.050	07/13/2021	ND	2.09	104	2.00	8.80	
Total Xylenes*	<0.150	0.150	07/13/2021	ND	6.20	103	6.00	8.78	
Total BTX	<0.300	0.300	07/13/2021	ND					

Surrogate: 4-Bromofluorobenzene (PID) 101 % 69.9-140

Chloride, SM4500CI-B		mg/kg		Analyzed By: GM						
Analyte	Result	Reporting Limit	Analyzed	Method Blank	BS	% Recovery	True Value QC	RPD	Qualifier	
Chloride	<16.0	16.0	07/13/2021	ND	416	104	400	0.00		

TPH 8015M		mg/kg		Analyzed By: MS					
Analyte	Result	Reporting Limit	Analyzed	Method Blank	BS	% Recovery	True Value QC	RPD	Qualifier
GRO C6-C10*	<10.0	10.0	07/13/2021	ND	212	106	200	2.71	
DRO >C10-C28*	<10.0	10.0	07/13/2021	ND	223	111	200	7.96	
EXT DRO >C28-C36	<10.0	10.0	07/13/2021	ND					

Surrogate: 1-Chlorooctane 91.7 % 44.3-133

Surrogate: 1-Chlorooctadecane 98.6 % 38.9-142

Cardinal Laboratories

*=Accredited Analyte

PLEASE NOTE: Liability and Damages. Cardinal's liability and client's exclusive remedy for any claim arising, whether based in contract or tort, shall be limited to the amount paid by client for analyses. All claims, including those for negligence and any other cause whatsoever shall be deemed waived unless made in writing and received by Cardinal within thirty (30) days after completion of the applicable service. In no event shall Cardinal be liable for incidental or consequential damages, including, without limitation, business interruptions, loss of use, or loss of profits incurred by client, its subsidiaries, affiliates or successors arising out of or related to the performance of the services hereunder by Cardinal, regardless of whether such claim is based upon any of the above stated reasons or otherwise. Results relate only to the samples identified above. This report shall not be reproduced except in full with written approval of Cardinal Laboratories.

Celey D. Keene, Lab Director/Quality Manager



PHONE (575) 393-2326 • 101 E. MARLAND • HOBBS, NM 88240

Analytical Results For:

BBC International, Inc.
 Cliff Brunson
 P.O. Box 805
 Hobbs NM, 88241
 Fax To: (575) 397-0397

Received: 07/12/2021
 Reported: 07/15/2021
 Project Name: PRIZE FED #7
 Project Number: (6-13-20)
 Project Location: OXY - LEA CO NM

Sampling Date: 07/09/2021
 Sampling Type: Soil
 Sampling Condition: Cool & Intact
 Sample Received By: Jodi Henson

Sample ID: BOTTOM 27 @ 7' (H211803-27)

BTX 8021B		mg/kg		Analyzed By: MS					
Analyte	Result	Reporting Limit	Analyzed	Method Blank	BS	% Recovery	True Value QC	RPD	Qualifier
Benzene*	<0.050	0.050	07/13/2021	ND	2.07	104	2.00	7.87	
Toluene*	<0.050	0.050	07/13/2021	ND	2.18	109	2.00	9.05	
Ethylbenzene*	<0.050	0.050	07/13/2021	ND	2.09	104	2.00	8.80	
Total Xylenes*	<0.150	0.150	07/13/2021	ND	6.20	103	6.00	8.78	
Total BTX	<0.300	0.300	07/13/2021	ND					

Surrogate: 4-Bromofluorobenzene (PID) 102 % 69.9-140

Chloride, SM4500CI-B		mg/kg		Analyzed By: GM						
Analyte	Result	Reporting Limit	Analyzed	Method Blank	BS	% Recovery	True Value QC	RPD	Qualifier	
Chloride	16.0	16.0	07/13/2021	ND	416	104	400	0.00		

TPH 8015M		mg/kg		Analyzed By: MS					
Analyte	Result	Reporting Limit	Analyzed	Method Blank	BS	% Recovery	True Value QC	RPD	Qualifier
GRO C6-C10*	<10.0	10.0	07/13/2021	ND	212	106	200	2.71	
DRO >C10-C28*	<10.0	10.0	07/13/2021	ND	223	111	200	7.96	
EXT DRO >C28-C36	<10.0	10.0	07/13/2021	ND					

Surrogate: 1-Chlorooctane 90.6 % 44.3-133

Surrogate: 1-Chlorooctadecane 96.0 % 38.9-142

Cardinal Laboratories

*=Accredited Analyte

PLEASE NOTE: Liability and Damages. Cardinal's liability and client's exclusive remedy for any claim arising, whether based in contract or tort, shall be limited to the amount paid by client for analyses. All claims, including those for negligence and any other cause whatsoever shall be deemed waived unless made in writing and received by Cardinal within thirty (30) days after completion of the applicable service. In no event shall Cardinal be liable for incidental or consequential damages, including, without limitation, business interruptions, loss of use, or loss of profits incurred by client, its subsidiaries, affiliates or successors arising out of or related to the performance of the services hereunder by Cardinal, regardless of whether such claim is based upon any of the above stated reasons or otherwise. Results relate only to the samples identified above. This report shall not be reproduced except in full with written approval of Cardinal Laboratories.

Celey D. Keene, Lab Director/Quality Manager



PHONE (575) 393-2326 • 101 E. MARLAND • HOBBS, NM 88240

Analytical Results For:

BBC International, Inc.
 Cliff Brunson
 P.O. Box 805
 Hobbs NM, 88241
 Fax To: (575) 397-0397

Received: 07/12/2021
 Reported: 07/15/2021
 Project Name: PRIZE FED #7
 Project Number: (6-13-20)
 Project Location: OXY - LEA CO NM

Sampling Date: 07/09/2021
 Sampling Type: Soil
 Sampling Condition: Cool & Intact
 Sample Received By: Jodi Henson

Sample ID: BOTTOM 28 @ 7' (H211803-28)

BTX 8021B		mg/kg		Analyzed By: MS					
Analyte	Result	Reporting Limit	Analyzed	Method Blank	BS	% Recovery	True Value QC	RPD	Qualifier
Benzene*	<0.050	0.050	07/13/2021	ND	2.07	104	2.00	7.87	
Toluene*	<0.050	0.050	07/13/2021	ND	2.18	109	2.00	9.05	
Ethylbenzene*	<0.050	0.050	07/13/2021	ND	2.09	104	2.00	8.80	
Total Xylenes*	<0.150	0.150	07/13/2021	ND	6.20	103	6.00	8.78	
Total BTX	<0.300	0.300	07/13/2021	ND					

Surrogate: 4-Bromofluorobenzene (PID) 102 % 69.9-140

Chloride, SM4500CI-B		mg/kg		Analyzed By: GM						
Analyte	Result	Reporting Limit	Analyzed	Method Blank	BS	% Recovery	True Value QC	RPD	Qualifier	
Chloride	<16.0	16.0	07/13/2021	ND	416	104	400	0.00		

TPH 8015M		mg/kg		Analyzed By: MS					
Analyte	Result	Reporting Limit	Analyzed	Method Blank	BS	% Recovery	True Value QC	RPD	Qualifier
GRO C6-C10*	<10.0	10.0	07/13/2021	ND	212	106	200	2.71	
DRO >C10-C28*	<10.0	10.0	07/13/2021	ND	223	111	200	7.96	
EXT DRO >C28-C36	<10.0	10.0	07/13/2021	ND					

Surrogate: 1-Chlorooctane 98.4 % 44.3-133

Surrogate: 1-Chlorooctadecane 106 % 38.9-142

Cardinal Laboratories

*=Accredited Analyte

PLEASE NOTE: Liability and Damages. Cardinal's liability and client's exclusive remedy for any claim arising, whether based in contract or tort, shall be limited to the amount paid by client for analyses. All claims, including those for negligence and any other cause whatsoever shall be deemed waived unless made in writing and received by Cardinal within thirty (30) days after completion of the applicable service. In no event shall Cardinal be liable for incidental or consequential damages, including, without limitation, business interruptions, loss of use, or loss of profits incurred by client, its subsidiaries, affiliates or successors arising out of or related to the performance of the services hereunder by Cardinal, regardless of whether such claim is based upon any of the above stated reasons or otherwise. Results relate only to the samples identified above. This report shall not be reproduced except in full with written approval of Cardinal Laboratories.

Celey D. Keene, Lab Director/Quality Manager



PHONE (575) 393-2326 ° 101 E. MARLAND ° HOBBS, NM 88240

Analytical Results For:

BBC International, Inc.
 Cliff Brunson
 P.O. Box 805
 Hobbs NM, 88241
 Fax To: (575) 397-0397

Received: 07/12/2021
 Reported: 07/15/2021
 Project Name: PRIZE FED #7
 Project Number: (6-13-20)
 Project Location: OXY - LEA CO NM

Sampling Date: 07/09/2021
 Sampling Type: Soil
 Sampling Condition: Cool & Intact
 Sample Received By: Jodi Henson

Sample ID: BOTTOM 29 @ 7' (H211803-29)

BTX 8021B		mg/kg		Analyzed By: MS					
Analyte	Result	Reporting Limit	Analyzed	Method Blank	BS	% Recovery	True Value QC	RPD	Qualifier
Benzene*	<0.050	0.050	07/13/2021	ND	2.07	104	2.00	7.87	
Toluene*	<0.050	0.050	07/13/2021	ND	2.18	109	2.00	9.05	
Ethylbenzene*	<0.050	0.050	07/13/2021	ND	2.09	104	2.00	8.80	
Total Xylenes*	<0.150	0.150	07/13/2021	ND	6.20	103	6.00	8.78	
Total BTX	<0.300	0.300	07/13/2021	ND					

Surrogate: 4-Bromofluorobenzene (PID) 96.9 % 69.9-140

Chloride, SM4500CI-B		mg/kg		Analyzed By: GM						
Analyte	Result	Reporting Limit	Analyzed	Method Blank	BS	% Recovery	True Value QC	RPD	Qualifier	
Chloride	<16.0	16.0	07/13/2021	ND	416	104	400	0.00		

TPH 8015M		mg/kg		Analyzed By: MS					
Analyte	Result	Reporting Limit	Analyzed	Method Blank	BS	% Recovery	True Value QC	RPD	Qualifier
GRO C6-C10*	<10.0	10.0	07/13/2021	ND	212	106	200	2.71	
DRO >C10-C28*	<10.0	10.0	07/13/2021	ND	223	111	200	7.96	
EXT DRO >C28-C36	<10.0	10.0	07/13/2021	ND					

Surrogate: 1-Chlorooctane 91.5 % 44.3-133

Surrogate: 1-Chlorooctadecane 96.2 % 38.9-142

Cardinal Laboratories

*=Accredited Analyte

PLEASE NOTE: Liability and Damages. Cardinal's liability and client's exclusive remedy for any claim arising, whether based in contract or tort, shall be limited to the amount paid by client for analyses. All claims, including those for negligence and any other cause whatsoever shall be deemed waived unless made in writing and received by Cardinal within thirty (30) days after completion of the applicable service. In no event shall Cardinal be liable for incidental or consequential damages, including, without limitation, business interruptions, loss of use, or loss of profits incurred by client, its subsidiaries, affiliates or successors arising out of or related to the performance of the services hereunder by Cardinal, regardless of whether such claim is based upon any of the above stated reasons or otherwise. Results relate only to the samples identified above. This report shall not be reproduced except in full with written approval of Cardinal Laboratories.

Celey D. Keene, Lab Director/Quality Manager



PHONE (575) 393-2326 • 101 E. MARLAND • HOBBS, NM 88240

Analytical Results For:

BBC International, Inc.
 Cliff Brunson
 P.O. Box 805
 Hobbs NM, 88241
 Fax To: (575) 397-0397

Received: 07/12/2021
 Reported: 07/15/2021
 Project Name: PRIZE FED #7
 Project Number: (6-13-20)
 Project Location: OXY - LEA CO NM

Sampling Date: 07/09/2021
 Sampling Type: Soil
 Sampling Condition: Cool & Intact
 Sample Received By: Jodi Henson

Sample ID: BOTTOM 30 @ 7' (H211803-30)

BTX 8021B		mg/kg		Analyzed By: MS						
Analyte	Result	Reporting Limit	Analyzed	Method Blank	BS	% Recovery	True Value QC	RPD	Qualifier	
Benzene*	<0.050	0.050	07/13/2021	ND	2.07	104	2.00	7.87		
Toluene*	<0.050	0.050	07/13/2021	ND	2.18	109	2.00	9.05		
Ethylbenzene*	<0.050	0.050	07/13/2021	ND	2.09	104	2.00	8.80		
Total Xylenes*	<0.150	0.150	07/13/2021	ND	6.20	103	6.00	8.78		
Total BTX	<0.300	0.300	07/13/2021	ND						

Surrogate: 4-Bromofluorobenzene (PID) 102 % 69.9-140

Chloride, SM4500CI-B		mg/kg		Analyzed By: GM						
Analyte	Result	Reporting Limit	Analyzed	Method Blank	BS	% Recovery	True Value QC	RPD	Qualifier	
Chloride	16.0	16.0	07/13/2021	ND	416	104	400	0.00		

TPH 8015M		mg/kg		Analyzed By: MS					
Analyte	Result	Reporting Limit	Analyzed	Method Blank	BS	% Recovery	True Value QC	RPD	Qualifier
GRO C6-C10*	<10.0	10.0	07/13/2021	ND	212	106	200	2.71	
DRO >C10-C28*	<10.0	10.0	07/13/2021	ND	223	111	200	7.96	
EXT DRO >C28-C36	<10.0	10.0	07/13/2021	ND					

Surrogate: 1-Chlorooctane 96.2 % 44.3-133

Surrogate: 1-Chlorooctadecane 101 % 38.9-142

Cardinal Laboratories

*=Accredited Analyte

PLEASE NOTE: Liability and Damages. Cardinal's liability and client's exclusive remedy for any claim arising, whether based in contract or tort, shall be limited to the amount paid by client for analyses. All claims, including those for negligence and any other cause whatsoever shall be deemed waived unless made in writing and received by Cardinal within thirty (30) days after completion of the applicable service. In no event shall Cardinal be liable for incidental or consequential damages, including, without limitation, business interruptions, loss of use, or loss of profits incurred by client, its subsidiaries, affiliates or successors arising out of or related to the performance of the services hereunder by Cardinal, regardless of whether such claim is based upon any of the above stated reasons or otherwise. Results relate only to the samples identified above. This report shall not be reproduced except in full with written approval of Cardinal Laboratories.

Celey D. Keene, Lab Director/Quality Manager



PHONE (575) 393-2326 • 101 E. MARLAND • HOBBS, NM 88240

Analytical Results For:

BBC International, Inc.
 Cliff Brunson
 P.O. Box 805
 Hobbs NM, 88241
 Fax To: (575) 397-0397

Received: 07/12/2021
 Reported: 07/15/2021
 Project Name: PRIZE FED #7
 Project Number: (6-13-20)
 Project Location: OXY - LEA CO NM

Sampling Date: 07/09/2021
 Sampling Type: Soil
 Sampling Condition: Cool & Intact
 Sample Received By: Jodi Henson

Sample ID: BOTTOM 31 @ 7' (H211803-31)

BTX 8021B		mg/kg		Analyzed By: MS					
Analyte	Result	Reporting Limit	Analyzed	Method Blank	BS	% Recovery	True Value QC	RPD	Qualifier
Benzene*	<0.050	0.050	07/13/2021	ND	2.07	104	2.00	7.87	
Toluene*	<0.050	0.050	07/13/2021	ND	2.18	109	2.00	9.05	
Ethylbenzene*	<0.050	0.050	07/13/2021	ND	2.09	104	2.00	8.80	
Total Xylenes*	<0.150	0.150	07/13/2021	ND	6.20	103	6.00	8.78	
Total BTX	<0.300	0.300	07/13/2021	ND					

Surrogate: 4-Bromofluorobenzene (PID) 101 % 69.9-140

Chloride, SM4500CI-B		mg/kg		Analyzed By: GM						
Analyte	Result	Reporting Limit	Analyzed	Method Blank	BS	% Recovery	True Value QC	RPD	Qualifier	
Chloride	<16.0	16.0	07/13/2021	ND	416	104	400	0.00		

TPH 8015M		mg/kg		Analyzed By: MS					
Analyte	Result	Reporting Limit	Analyzed	Method Blank	BS	% Recovery	True Value QC	RPD	Qualifier
GRO C6-C10*	<10.0	10.0	07/13/2021	ND	212	106	200	2.71	
DRO >C10-C28*	<10.0	10.0	07/13/2021	ND	223	111	200	7.96	
EXT DRO >C28-C36	<10.0	10.0	07/13/2021	ND					

Surrogate: 1-Chlorooctane 91.3 % 44.3-133

Surrogate: 1-Chlorooctadecane 95.0 % 38.9-142

Cardinal Laboratories

*=Accredited Analyte

PLEASE NOTE: Liability and Damages. Cardinal's liability and client's exclusive remedy for any claim arising, whether based in contract or tort, shall be limited to the amount paid by client for analyses. All claims, including those for negligence and any other cause whatsoever shall be deemed waived unless made in writing and received by Cardinal within thirty (30) days after completion of the applicable service. In no event shall Cardinal be liable for incidental or consequential damages, including, without limitation, business interruptions, loss of use, or loss of profits incurred by client, its subsidiaries, affiliates or successors arising out of or related to the performance of the services hereunder by Cardinal, regardless of whether such claim is based upon any of the above stated reasons or otherwise. Results relate only to the samples identified above. This report shall not be reproduced except in full with written approval of Cardinal Laboratories.

Celey D. Keene, Lab Director/Quality Manager



PHONE (575) 393-2326 ° 101 E. MARLAND ° HOBBS, NM 88240

Analytical Results For:

BBC International, Inc.
 Cliff Brunson
 P.O. Box 805
 Hobbs NM, 88241
 Fax To: (575) 397-0397

Received: 07/12/2021
 Reported: 07/15/2021
 Project Name: PRIZE FED #7
 Project Number: (6-13-20)
 Project Location: OXY - LEA CO NM

Sampling Date: 07/09/2021
 Sampling Type: Soil
 Sampling Condition: Cool & Intact
 Sample Received By: Jodi Henson

Sample ID: SIDEWALL 1 (H211803-32)

BTEx 8021B		mg/kg		Analyzed By: MS					
Analyte	Result	Reporting Limit	Analyzed	Method Blank	BS	% Recovery	True Value QC	RPD	Qualifier
Benzene*	<0.050	0.050	07/13/2021	ND	2.07	104	2.00	7.87	
Toluene*	<0.050	0.050	07/13/2021	ND	2.18	109	2.00	9.05	
Ethylbenzene*	<0.050	0.050	07/13/2021	ND	2.09	104	2.00	8.80	
Total Xylenes*	<0.150	0.150	07/13/2021	ND	6.20	103	6.00	8.78	
Total BTEx	<0.300	0.300	07/13/2021	ND					

Surrogate: 4-Bromofluorobenzene (PID) 98.8 % 69.9-140

Chloride, SM4500CI-B		mg/kg		Analyzed By: GM						
Analyte	Result	Reporting Limit	Analyzed	Method Blank	BS	% Recovery	True Value QC	RPD	Qualifier	
Chloride	<16.0	16.0	07/13/2021	ND	416	104	400	0.00		

TPH 8015M		mg/kg		Analyzed By: MS					
Analyte	Result	Reporting Limit	Analyzed	Method Blank	BS	% Recovery	True Value QC	RPD	Qualifier
GRO C6-C10*	<10.0	10.0	07/13/2021	ND	208	104	200	1.94	
DRO >C10-C28*	<10.0	10.0	07/13/2021	ND	209	104	200	3.11	
EXT DRO >C28-C36	<10.0	10.0	07/13/2021	ND					

Surrogate: 1-Chlorooctane 74.6 % 44.3-133

Surrogate: 1-Chlorooctadecane 72.7 % 38.9-142

Cardinal Laboratories

*=Accredited Analyte

PLEASE NOTE: Liability and Damages. Cardinal's liability and client's exclusive remedy for any claim arising, whether based in contract or tort, shall be limited to the amount paid by client for analyses. All claims, including those for negligence and any other cause whatsoever shall be deemed waived unless made in writing and received by Cardinal within thirty (30) days after completion of the applicable service. In no event shall Cardinal be liable for incidental or consequential damages, including, without limitation, business interruptions, loss of use, or loss of profits incurred by client, its subsidiaries, affiliates or successors arising out of or related to the performance of the services hereunder by Cardinal, regardless of whether such claim is based upon any of the above stated reasons or otherwise. Results relate only to the samples identified above. This report shall not be reproduced except in full with written approval of Cardinal Laboratories.

Celey D. Keene, Lab Director/Quality Manager



PHONE (575) 393-2326 ° 101 E. MARLAND ° HOBBS, NM 88240

Analytical Results For:

BBC International, Inc.
 Cliff Brunson
 P.O. Box 805
 Hobbs NM, 88241
 Fax To: (575) 397-0397

Received: 07/12/2021
 Reported: 07/15/2021
 Project Name: PRIZE FED #7
 Project Number: (6-13-20)
 Project Location: OXY - LEA CO NM

Sampling Date: 07/09/2021
 Sampling Type: Soil
 Sampling Condition: Cool & Intact
 Sample Received By: Jodi Henson

Sample ID: SIDEWALL 2 (H211803-33)

BTX 8021B		mg/kg		Analyzed By: MS						
Analyte	Result	Reporting Limit	Analyzed	Method Blank	BS	% Recovery	True Value QC	RPD	Qualifier	
Benzene*	<0.050	0.050	07/13/2021	ND	2.07	104	2.00	7.87		
Toluene*	<0.050	0.050	07/13/2021	ND	2.18	109	2.00	9.05		
Ethylbenzene*	<0.050	0.050	07/13/2021	ND	2.09	104	2.00	8.80		
Total Xylenes*	<0.150	0.150	07/13/2021	ND	6.20	103	6.00	8.78		
Total BTX	<0.300	0.300	07/13/2021	ND						

Surrogate: 4-Bromofluorobenzene (PID) 97.7 % 69.9-140

Chloride, SM4500CI-B		mg/kg		Analyzed By: GM						
Analyte	Result	Reporting Limit	Analyzed	Method Blank	BS	% Recovery	True Value QC	RPD	Qualifier	
Chloride	<16.0	16.0	07/13/2021	ND	416	104	400	0.00		

TPH 8015M		mg/kg		Analyzed By: MS					
Analyte	Result	Reporting Limit	Analyzed	Method Blank	BS	% Recovery	True Value QC	RPD	Qualifier
GRO C6-C10*	<10.0	10.0	07/13/2021	ND	208	104	200	1.94	
DRO >C10-C28*	<10.0	10.0	07/13/2021	ND	209	104	200	3.11	
EXT DRO >C28-C36	<10.0	10.0	07/13/2021	ND					

Surrogate: 1-Chlorooctane 78.5 % 44.3-133

Surrogate: 1-Chlorooctadecane 74.8 % 38.9-142

Cardinal Laboratories

*=Accredited Analyte

PLEASE NOTE: Liability and Damages. Cardinal's liability and client's exclusive remedy for any claim arising, whether based in contract or tort, shall be limited to the amount paid by client for analyses. All claims, including those for negligence and any other cause whatsoever shall be deemed waived unless made in writing and received by Cardinal within thirty (30) days after completion of the applicable service. In no event shall Cardinal be liable for incidental or consequential damages, including, without limitation, business interruptions, loss of use, or loss of profits incurred by client, its subsidiaries, affiliates or successors arising out of or related to the performance of the services hereunder by Cardinal, regardless of whether such claim is based upon any of the above stated reasons or otherwise. Results relate only to the samples identified above. This report shall not be reproduced except in full with written approval of Cardinal Laboratories.

Celey D. Keene, Lab Director/Quality Manager



PHONE (575) 393-2326 ° 101 E. MARLAND ° HOBBS, NM 88240

Analytical Results For:

BBC International, Inc.
 Cliff Brunson
 P.O. Box 805
 Hobbs NM, 88241
 Fax To: (575) 397-0397

Received: 07/12/2021
 Reported: 07/15/2021
 Project Name: PRIZE FED #7
 Project Number: (6-13-20)
 Project Location: OXY - LEA CO NM

Sampling Date: 07/09/2021
 Sampling Type: Soil
 Sampling Condition: Cool & Intact
 Sample Received By: Jodi Henson

Sample ID: SIDEWALL 3 (H211803-34)

BTX 8021B		mg/kg		Analyzed By: MS						
Analyte	Result	Reporting Limit	Analyzed	Method Blank	BS	% Recovery	True Value QC	RPD	Qualifier	
Benzene*	<0.050	0.050	07/13/2021	ND	2.07	104	2.00	7.87		
Toluene*	<0.050	0.050	07/13/2021	ND	2.18	109	2.00	9.05		
Ethylbenzene*	<0.050	0.050	07/13/2021	ND	2.09	104	2.00	8.80		
Total Xylenes*	<0.150	0.150	07/13/2021	ND	6.20	103	6.00	8.78		
Total BTX	<0.300	0.300	07/13/2021	ND						

Surrogate: 4-Bromofluorobenzene (PID) 102 % 69.9-140

Chloride, SM4500CI-B		mg/kg		Analyzed By: GM						
Analyte	Result	Reporting Limit	Analyzed	Method Blank	BS	% Recovery	True Value QC	RPD	Qualifier	
Chloride	<16.0	16.0	07/13/2021	ND	416	104	400	0.00		

TPH 8015M		mg/kg		Analyzed By: MS					
Analyte	Result	Reporting Limit	Analyzed	Method Blank	BS	% Recovery	True Value QC	RPD	Qualifier
GRO C6-C10*	<10.0	10.0	07/13/2021	ND	208	104	200	1.94	
DRO >C10-C28*	<10.0	10.0	07/13/2021	ND	209	104	200	3.11	
EXT DRO >C28-C36	<10.0	10.0	07/13/2021	ND					

Surrogate: 1-Chlorooctane 74.0 % 44.3-133

Surrogate: 1-Chlorooctadecane 71.0 % 38.9-142

Cardinal Laboratories

*=Accredited Analyte

PLEASE NOTE: Liability and Damages. Cardinal's liability and client's exclusive remedy for any claim arising, whether based in contract or tort, shall be limited to the amount paid by client for analyses. All claims, including those for negligence and any other cause whatsoever shall be deemed waived unless made in writing and received by Cardinal within thirty (30) days after completion of the applicable service. In no event shall Cardinal be liable for incidental or consequential damages, including, without limitation, business interruptions, loss of use, or loss of profits incurred by client, its subsidiaries, affiliates or successors arising out of or related to the performance of the services hereunder by Cardinal, regardless of whether such claim is based upon any of the above stated reasons or otherwise. Results relate only to the samples identified above. This report shall not be reproduced except in full with written approval of Cardinal Laboratories.

Celey D. Keene, Lab Director/Quality Manager



PHONE (575) 393-2326 ° 101 E. MARLAND ° HOBBS, NM 88240

Analytical Results For:

BBC International, Inc.
 Cliff Brunson
 P.O. Box 805
 Hobbs NM, 88241
 Fax To: (575) 397-0397

Received: 07/12/2021
 Reported: 07/15/2021
 Project Name: PRIZE FED #7
 Project Number: (6-13-20)
 Project Location: OXY - LEA CO NM

Sampling Date: 07/09/2021
 Sampling Type: Soil
 Sampling Condition: Cool & Intact
 Sample Received By: Jodi Henson

Sample ID: SIDEWALL 4 (H211803-35)

BTEx 8021B		mg/kg		Analyzed By: MS						
Analyte	Result	Reporting Limit	Analyzed	Method Blank	BS	% Recovery	True Value QC	RPD	Qualifier	
Benzene*	<0.050	0.050	07/13/2021	ND	2.12	106	2.00	0.580		
Toluene*	<0.050	0.050	07/13/2021	ND	2.02	101	2.00	0.860		
Ethylbenzene*	<0.050	0.050	07/13/2021	ND	1.95	97.7	2.00	0.575		
Total Xylenes*	<0.150	0.150	07/13/2021	ND	5.95	99.2	6.00	0.391		
Total BTEx	<0.300	0.300	07/13/2021	ND						

Surrogate: 4-Bromofluorobenzene (PID) 113 % 69.9-140

Chloride, SM4500CI-B		mg/kg		Analyzed By: GM						
Analyte	Result	Reporting Limit	Analyzed	Method Blank	BS	% Recovery	True Value QC	RPD	Qualifier	
Chloride	<16.0	16.0	07/13/2021	ND	416	104	400	0.00		

TPH 8015M		mg/kg		Analyzed By: MS					
Analyte	Result	Reporting Limit	Analyzed	Method Blank	BS	% Recovery	True Value QC	RPD	Qualifier
GRO C6-C10*	<10.0	10.0	07/13/2021	ND	208	104	200	1.94	
DRO >C10-C28*	<10.0	10.0	07/13/2021	ND	209	104	200	3.11	
EXT DRO >C28-C36	<10.0	10.0	07/13/2021	ND					

Surrogate: 1-Chlorooctane 73.4 % 44.3-133

Surrogate: 1-Chlorooctadecane 71.6 % 38.9-142

Cardinal Laboratories

*=Accredited Analyte

PLEASE NOTE: Liability and Damages. Cardinal's liability and client's exclusive remedy for any claim arising, whether based in contract or tort, shall be limited to the amount paid by client for analyses. All claims, including those for negligence and any other cause whatsoever shall be deemed waived unless made in writing and received by Cardinal within thirty (30) days after completion of the applicable service. In no event shall Cardinal be liable for incidental or consequential damages, including, without limitation, business interruptions, loss of use, or loss of profits incurred by client, its subsidiaries, affiliates or successors arising out of or related to the performance of the services hereunder by Cardinal, regardless of whether such claim is based upon any of the above stated reasons or otherwise. Results relate only to the samples identified above. This report shall not be reproduced except in full with written approval of Cardinal Laboratories.

Celey D. Keene, Lab Director/Quality Manager



PHONE (575) 393-2326 ° 101 E. MARLAND ° HOBBS, NM 88240

Analytical Results For:

BBC International, Inc.
 Cliff Brunson
 P.O. Box 805
 Hobbs NM, 88241
 Fax To: (575) 397-0397

Received: 07/12/2021
 Reported: 07/15/2021
 Project Name: PRIZE FED #7
 Project Number: (6-13-20)
 Project Location: OXY - LEA CO NM

Sampling Date: 07/09/2021
 Sampling Type: Soil
 Sampling Condition: Cool & Intact
 Sample Received By: Jodi Henson

Sample ID: SIDEWALL 5 (H211803-36)

BTEx 8021B		mg/kg		Analyzed By: MS						
Analyte	Result	Reporting Limit	Analyzed	Method Blank	BS	% Recovery	True Value QC	RPD	Qualifier	
Benzene*	<0.050	0.050	07/13/2021	ND	2.12	106	2.00	0.580		
Toluene*	<0.050	0.050	07/13/2021	ND	2.02	101	2.00	0.860		
Ethylbenzene*	<0.050	0.050	07/13/2021	ND	1.95	97.7	2.00	0.575		
Total Xylenes*	<0.150	0.150	07/13/2021	ND	5.95	99.2	6.00	0.391		
Total BTEx	<0.300	0.300	07/13/2021	ND						

Surrogate: 4-Bromofluorobenzene (PID) 113 % 69.9-140

Chloride, SM4500CI-B		mg/kg		Analyzed By: GM						
Analyte	Result	Reporting Limit	Analyzed	Method Blank	BS	% Recovery	True Value QC	RPD	Qualifier	
Chloride	<16.0	16.0	07/13/2021	ND	416	104	400	0.00		

TPH 8015M		mg/kg		Analyzed By: MS					
Analyte	Result	Reporting Limit	Analyzed	Method Blank	BS	% Recovery	True Value QC	RPD	Qualifier
GRO C6-C10*	<10.0	10.0	07/13/2021	ND	208	104	200	1.94	
DRO >C10-C28*	<10.0	10.0	07/13/2021	ND	209	104	200	3.11	
EXT DRO >C28-C36	<10.0	10.0	07/13/2021	ND					

Surrogate: 1-Chlorooctane 74.6 % 44.3-133

Surrogate: 1-Chlorooctadecane 72.8 % 38.9-142

Cardinal Laboratories

*=Accredited Analyte

PLEASE NOTE: Liability and Damages. Cardinal's liability and client's exclusive remedy for any claim arising, whether based in contract or tort, shall be limited to the amount paid by client for analyses. All claims, including those for negligence and any other cause whatsoever shall be deemed waived unless made in writing and received by Cardinal within thirty (30) days after completion of the applicable service. In no event shall Cardinal be liable for incidental or consequential damages, including, without limitation, business interruptions, loss of use, or loss of profits incurred by client, its subsidiaries, affiliates or successors arising out of or related to the performance of the services hereunder by Cardinal, regardless of whether such claim is based upon any of the above stated reasons or otherwise. Results relate only to the samples identified above. This report shall not be reproduced except in full with written approval of Cardinal Laboratories.

Celey D. Keene, Lab Director/Quality Manager



PHONE (575) 393-2326 ° 101 E. MARLAND ° HOBBS, NM 88240

Analytical Results For:

BBC International, Inc.
 Cliff Brunson
 P.O. Box 805
 Hobbs NM, 88241
 Fax To: (575) 397-0397

Received: 07/12/2021
 Reported: 07/15/2021
 Project Name: PRIZE FED #7
 Project Number: (6-13-20)
 Project Location: OXY - LEA CO NM

Sampling Date: 07/09/2021
 Sampling Type: Soil
 Sampling Condition: Cool & Intact
 Sample Received By: Jodi Henson

Sample ID: SIDEWALL 6 (H211803-37)

BTX 8021B			mg/kg							
			Analyzed By: MS							
Analyte	Result	Reporting Limit	Analyzed	Method Blank	BS	% Recovery	True Value QC	RPD	Qualifier	
Benzene*	<0.050	0.050	07/13/2021	ND	2.12	106	2.00	0.580		
Toluene*	<0.050	0.050	07/13/2021	ND	2.02	101	2.00	0.860		
Ethylbenzene*	<0.050	0.050	07/13/2021	ND	1.95	97.7	2.00	0.575		
Total Xylenes*	<0.150	0.150	07/13/2021	ND	5.95	99.2	6.00	0.391		
Total BTX	<0.300	0.300	07/13/2021	ND						

Surrogate: 4-Bromofluorobenzene (PID) 113 % 69.9-140

Chloride, SM4500CI-B			mg/kg							
			Analyzed By: GM							
Analyte	Result	Reporting Limit	Analyzed	Method Blank	BS	% Recovery	True Value QC	RPD	Qualifier	
Chloride	16.0	16.0	07/13/2021	ND	416	104	400	0.00		

TPH 8015M			mg/kg							
			Analyzed By: MS							
Analyte	Result	Reporting Limit	Analyzed	Method Blank	BS	% Recovery	True Value QC	RPD	Qualifier	
GRO C6-C10*	<10.0	10.0	07/13/2021	ND	208	104	200	1.94		
DRO >C10-C28*	<10.0	10.0	07/13/2021	ND	209	104	200	3.11		
EXT DRO >C28-C36	<10.0	10.0	07/13/2021	ND						

Surrogate: 1-Chlorooctane 77.8 % 44.3-133

Surrogate: 1-Chlorooctadecane 75.3 % 38.9-142

Cardinal Laboratories

*=Accredited Analyte

PLEASE NOTE: Liability and Damages. Cardinal's liability and client's exclusive remedy for any claim arising, whether based in contract or tort, shall be limited to the amount paid by client for analyses. All claims, including those for negligence and any other cause whatsoever shall be deemed waived unless made in writing and received by Cardinal within thirty (30) days after completion of the applicable service. In no event shall Cardinal be liable for incidental or consequential damages, including, without limitation, business interruptions, loss of use, or loss of profits incurred by client, its subsidiaries, affiliates or successors arising out of or related to the performance of the services hereunder by Cardinal, regardless of whether such claim is based upon any of the above stated reasons or otherwise. Results relate only to the samples identified above. This report shall not be reproduced except in full with written approval of Cardinal Laboratories.

Celey D. Keene, Lab Director/Quality Manager



PHONE (575) 393-2326 ° 101 E. MARLAND ° HOBBS, NM 88240

Analytical Results For:

BBC International, Inc.
 Cliff Brunson
 P.O. Box 805
 Hobbs NM, 88241
 Fax To: (575) 397-0397

Received: 07/12/2021
 Reported: 07/15/2021
 Project Name: PRIZE FED #7
 Project Number: (6-13-20)
 Project Location: OXY - LEA CO NM

Sampling Date: 07/09/2021
 Sampling Type: Soil
 Sampling Condition: Cool & Intact
 Sample Received By: Jodi Henson

Sample ID: SIDEWALL 7 (H211803-38)

BTX 8021B		mg/kg		Analyzed By: MS						
Analyte	Result	Reporting Limit	Analyzed	Method Blank	BS	% Recovery	True Value QC	RPD	Qualifier	
Benzene*	<0.050	0.050	07/13/2021	ND	2.12	106	2.00	0.580		
Toluene*	<0.050	0.050	07/13/2021	ND	2.02	101	2.00	0.860		
Ethylbenzene*	<0.050	0.050	07/13/2021	ND	1.95	97.7	2.00	0.575		
Total Xylenes*	<0.150	0.150	07/13/2021	ND	5.95	99.2	6.00	0.391		
Total BTX	<0.300	0.300	07/13/2021	ND						

Surrogate: 4-Bromofluorobenzene (PID) 113 % 69.9-140

Chloride, SM4500CI-B		mg/kg		Analyzed By: GM					
Analyte	Result	Reporting Limit	Analyzed	Method Blank	BS	% Recovery	True Value QC	RPD	Qualifier
Chloride	16.0	16.0	07/13/2021	ND	416	104	400	0.00	

TPH 8015M		mg/kg		Analyzed By: MS					
Analyte	Result	Reporting Limit	Analyzed	Method Blank	BS	% Recovery	True Value QC	RPD	Qualifier
GRO C6-C10*	<10.0	10.0	07/13/2021	ND	208	104	200	1.94	
DRO >C10-C28*	<10.0	10.0	07/13/2021	ND	209	104	200	3.11	
EXT DRO >C28-C36	<10.0	10.0	07/13/2021	ND					

Surrogate: 1-Chlorooctane 74.0 % 44.3-133

Surrogate: 1-Chlorooctadecane 71.8 % 38.9-142

Cardinal Laboratories

*=Accredited Analyte

PLEASE NOTE: Liability and Damages. Cardinal's liability and client's exclusive remedy for any claim arising, whether based in contract or tort, shall be limited to the amount paid by client for analyses. All claims, including those for negligence and any other cause whatsoever shall be deemed waived unless made in writing and received by Cardinal within thirty (30) days after completion of the applicable service. In no event shall Cardinal be liable for incidental or consequential damages, including, without limitation, business interruptions, loss of use, or loss of profits incurred by client, its subsidiaries, affiliates or successors arising out of or related to the performance of the services hereunder by Cardinal, regardless of whether such claim is based upon any of the above stated reasons or otherwise. Results relate only to the samples identified above. This report shall not be reproduced except in full with written approval of Cardinal Laboratories.

Celey D. Keene, Lab Director/Quality Manager



PHONE (575) 393-2326 ° 101 E. MARLAND ° HOBBS, NM 88240

Analytical Results For:

BBC International, Inc.
 Cliff Brunson
 P.O. Box 805
 Hobbs NM, 88241
 Fax To: (575) 397-0397

Received: 07/12/2021
 Reported: 07/15/2021
 Project Name: PRIZE FED #7
 Project Number: (6-13-20)
 Project Location: OXY - LEA CO NM

Sampling Date: 07/09/2021
 Sampling Type: Soil
 Sampling Condition: Cool & Intact
 Sample Received By: Jodi Henson

Sample ID: SIDEWALL 8 (H211803-39)

BTEx 8021B		mg/kg		Analyzed By: MS						
Analyte	Result	Reporting Limit	Analyzed	Method Blank	BS	% Recovery	True Value QC	RPD	Qualifier	
Benzene*	<0.050	0.050	07/13/2021	ND	2.12	106	2.00	0.580		
Toluene*	<0.050	0.050	07/13/2021	ND	2.02	101	2.00	0.860		
Ethylbenzene*	<0.050	0.050	07/13/2021	ND	1.95	97.7	2.00	0.575		
Total Xylenes*	<0.150	0.150	07/13/2021	ND	5.95	99.2	6.00	0.391		
Total BTEx	<0.300	0.300	07/13/2021	ND						

Surrogate: 4-Bromofluorobenzene (PID) 113 % 69.9-140

Chloride, SM4500CI-B		mg/kg		Analyzed By: GM						
Analyte	Result	Reporting Limit	Analyzed	Method Blank	BS	% Recovery	True Value QC	RPD	Qualifier	
Chloride	16.0	16.0	07/13/2021	ND	416	104	400	0.00		

TPH 8015M		mg/kg		Analyzed By: MS					
Analyte	Result	Reporting Limit	Analyzed	Method Blank	BS	% Recovery	True Value QC	RPD	Qualifier
GRO C6-C10*	<10.0	10.0	07/13/2021	ND	208	104	200	1.94	
DRO >C10-C28*	<10.0	10.0	07/13/2021	ND	209	104	200	3.11	
EXT DRO >C28-C36	<10.0	10.0	07/13/2021	ND					

Surrogate: 1-Chlorooctane 75.5 % 44.3-133

Surrogate: 1-Chlorooctadecane 73.8 % 38.9-142

Cardinal Laboratories

*=Accredited Analyte

PLEASE NOTE: Liability and Damages. Cardinal's liability and client's exclusive remedy for any claim arising, whether based in contract or tort, shall be limited to the amount paid by client for analyses. All claims, including those for negligence and any other cause whatsoever shall be deemed waived unless made in writing and received by Cardinal within thirty (30) days after completion of the applicable service. In no event shall Cardinal be liable for incidental or consequential damages, including, without limitation, business interruptions, loss of use, or loss of profits incurred by client, its subsidiaries, affiliates or successors arising out of or related to the performance of the services hereunder by Cardinal, regardless of whether such claim is based upon any of the above stated reasons or otherwise. Results relate only to the samples identified above. This report shall not be reproduced except in full with written approval of Cardinal Laboratories.

Celey D. Keene, Lab Director/Quality Manager



PHONE (575) 393-2326 ° 101 E. MARLAND ° HOBBS, NM 88240

Analytical Results For:

BBC International, Inc.
 Cliff Brunson
 P.O. Box 805
 Hobbs NM, 88241
 Fax To: (575) 397-0397

Received: 07/12/2021
 Reported: 07/15/2021
 Project Name: PRIZE FED #7
 Project Number: (6-13-20)
 Project Location: OXY - LEA CO NM

Sampling Date: 07/09/2021
 Sampling Type: Soil
 Sampling Condition: Cool & Intact
 Sample Received By: Jodi Henson

Sample ID: SIDEWALL 9 (H211803-40)

BTEx 8021B		mg/kg		Analyzed By: MS						
Analyte	Result	Reporting Limit	Analyzed	Method Blank	BS	% Recovery	True Value QC	RPD	Qualifier	
Benzene*	<0.050	0.050	07/13/2021	ND	2.12	106	2.00	0.580		
Toluene*	<0.050	0.050	07/13/2021	ND	2.02	101	2.00	0.860		
Ethylbenzene*	<0.050	0.050	07/13/2021	ND	1.95	97.7	2.00	0.575		
Total Xylenes*	<0.150	0.150	07/13/2021	ND	5.95	99.2	6.00	0.391		
Total BTEX	<0.300	0.300	07/13/2021	ND						

Surrogate: 4-Bromofluorobenzene (PID) 114 % 69.9-140

Chloride, SM4500Cl-B		mg/kg		Analyzed By: GM						
Analyte	Result	Reporting Limit	Analyzed	Method Blank	BS	% Recovery	True Value QC	RPD	Qualifier	
Chloride	<16.0	16.0	07/13/2021	ND	416	104	400	0.00		

TPH 8015M		mg/kg		Analyzed By: MS					
Analyte	Result	Reporting Limit	Analyzed	Method Blank	BS	% Recovery	True Value QC	RPD	Qualifier
GRO C6-C10*	<10.0	10.0	07/13/2021	ND	208	104	200	1.94	
DRO >C10-C28*	<10.0	10.0	07/13/2021	ND	209	104	200	3.11	
EXT DRO >C28-C36	<10.0	10.0	07/13/2021	ND					

Surrogate: 1-Chlorooctane 76.7 % 44.3-133

Surrogate: 1-Chlorooctadecane 74.6 % 38.9-142

Cardinal Laboratories

*=Accredited Analyte

PLEASE NOTE: Liability and Damages. Cardinal's liability and client's exclusive remedy for any claim arising, whether based in contract or tort, shall be limited to the amount paid by client for analyses. All claims, including those for negligence and any other cause whatsoever shall be deemed waived unless made in writing and received by Cardinal within thirty (30) days after completion of the applicable service. In no event shall Cardinal be liable for incidental or consequential damages, including, without limitation, business interruptions, loss of use, or loss of profits incurred by client, its subsidiaries, affiliates or successors arising out of or related to the performance of the services hereunder by Cardinal, regardless of whether such claim is based upon any of the above stated reasons or otherwise. Results relate only to the samples identified above. This report shall not be reproduced except in full with written approval of Cardinal Laboratories.

Celey D. Keene, Lab Director/Quality Manager



PHONE (575) 393-2326 ° 101 E. MARLAND ° HOBBS, NM 88240

Analytical Results For:

BBC International, Inc.
 Cliff Brunson
 P.O. Box 805
 Hobbs NM, 88241
 Fax To: (575) 397-0397

Received: 07/12/2021
 Reported: 07/15/2021
 Project Name: PRIZE FED #7
 Project Number: (6-13-20)
 Project Location: OXY - LEA CO NM

Sampling Date: 07/09/2021
 Sampling Type: Soil
 Sampling Condition: Cool & Intact
 Sample Received By: Jodi Henson

Sample ID: SIDEWALL 10 (H211803-41)

BTEx 8021B		mg/kg		Analyzed By: MS						
Analyte	Result	Reporting Limit	Analyzed	Method Blank	BS	% Recovery	True Value QC	RPD	Qualifier	
Benzene*	<0.050	0.050	07/13/2021	ND	2.12	106	2.00	0.580		
Toluene*	<0.050	0.050	07/13/2021	ND	2.02	101	2.00	0.860		
Ethylbenzene*	<0.050	0.050	07/13/2021	ND	1.95	97.7	2.00	0.575		
Total Xylenes*	<0.150	0.150	07/13/2021	ND	5.95	99.2	6.00	0.391		
Total BTEx	<0.300	0.300	07/13/2021	ND						

Surrogate: 4-Bromofluorobenzene (PID) 112 % 69.9-140

Chloride, SM4500CI-B		mg/kg		Analyzed By: GM						
Analyte	Result	Reporting Limit	Analyzed	Method Blank	BS	% Recovery	True Value QC	RPD	Qualifier	
Chloride	<16.0	16.0	07/13/2021	ND	416	104	400	0.00		

TPH 8015M		mg/kg		Analyzed By: MS					
Analyte	Result	Reporting Limit	Analyzed	Method Blank	BS	% Recovery	True Value QC	RPD	Qualifier
GRO C6-C10*	<10.0	10.0	07/13/2021	ND	208	104	200	1.94	
DRO >C10-C28*	<10.0	10.0	07/13/2021	ND	209	104	200	3.11	
EXT DRO >C28-C36	<10.0	10.0	07/13/2021	ND					

Surrogate: 1-Chlorooctane 75.2 % 44.3-133

Surrogate: 1-Chlorooctadecane 73.6 % 38.9-142

Cardinal Laboratories

*=Accredited Analyte

PLEASE NOTE: Liability and Damages. Cardinal's liability and client's exclusive remedy for any claim arising, whether based in contract or tort, shall be limited to the amount paid by client for analyses. All claims, including those for negligence and any other cause whatsoever shall be deemed waived unless made in writing and received by Cardinal within thirty (30) days after completion of the applicable service. In no event shall Cardinal be liable for incidental or consequential damages, including, without limitation, business interruptions, loss of use, or loss of profits incurred by client, its subsidiaries, affiliates or successors arising out of or related to the performance of the services hereunder by Cardinal, regardless of whether such claim is based upon any of the above stated reasons or otherwise. Results relate only to the samples identified above. This report shall not be reproduced except in full with written approval of Cardinal Laboratories.

Celey D. Keene, Lab Director/Quality Manager



PHONE (575) 393-2326 ° 101 E. MARLAND ° HOBBS, NM 88240

Analytical Results For:

BBC International, Inc.
 Cliff Brunson
 P.O. Box 805
 Hobbs NM, 88241
 Fax To: (575) 397-0397

Received: 07/12/2021
 Reported: 07/15/2021
 Project Name: PRIZE FED #7
 Project Number: (6-13-20)
 Project Location: OXY - LEA CO NM

Sampling Date: 07/09/2021
 Sampling Type: Soil
 Sampling Condition: Cool & Intact
 Sample Received By: Jodi Henson

Sample ID: SIDEWALL 11 (H211803-42)

BTX 8021B		mg/kg		Analyzed By: MS					
Analyte	Result	Reporting Limit	Analyzed	Method Blank	BS	% Recovery	True Value QC	RPD	Qualifier
Benzene*	<0.050	0.050	07/13/2021	ND	2.12	106	2.00	0.580	
Toluene*	<0.050	0.050	07/13/2021	ND	2.02	101	2.00	0.860	
Ethylbenzene*	<0.050	0.050	07/13/2021	ND	1.95	97.7	2.00	0.575	
Total Xylenes*	<0.150	0.150	07/13/2021	ND	5.95	99.2	6.00	0.391	
Total BTX	<0.300	0.300	07/13/2021	ND					

Surrogate: 4-Bromofluorobenzene (PID) 112 % 69.9-140

Chloride, SM4500CI-B		mg/kg		Analyzed By: GM						
Analyte	Result	Reporting Limit	Analyzed	Method Blank	BS	% Recovery	True Value QC	RPD	Qualifier	
Chloride	<16.0	16.0	07/13/2021	ND	416	104	400	0.00		

TPH 8015M		mg/kg		Analyzed By: MS					
Analyte	Result	Reporting Limit	Analyzed	Method Blank	BS	% Recovery	True Value QC	RPD	Qualifier
GRO C6-C10*	<10.0	10.0	07/13/2021	ND	208	104	200	1.94	
DRO >C10-C28*	<10.0	10.0	07/13/2021	ND	209	104	200	3.11	
EXT DRO >C28-C36	<10.0	10.0	07/13/2021	ND					

Surrogate: 1-Chlorooctane 72.4 % 44.3-133

Surrogate: 1-Chlorooctadecane 70.2 % 38.9-142

Cardinal Laboratories

*=Accredited Analyte

PLEASE NOTE: Liability and Damages. Cardinal's liability and client's exclusive remedy for any claim arising, whether based in contract or tort, shall be limited to the amount paid by client for analyses. All claims, including those for negligence and any other cause whatsoever shall be deemed waived unless made in writing and received by Cardinal within thirty (30) days after completion of the applicable service. In no event shall Cardinal be liable for incidental or consequential damages, including, without limitation, business interruptions, loss of use, or loss of profits incurred by client, its subsidiaries, affiliates or successors arising out of or related to the performance of the services hereunder by Cardinal, regardless of whether such claim is based upon any of the above stated reasons or otherwise. Results relate only to the samples identified above. This report shall not be reproduced except in full with written approval of Cardinal Laboratories.

Celey D. Keene, Lab Director/Quality Manager



PHONE (575) 393-2326 ° 101 E. MARLAND ° HOBBS, NM 88240

Notes and Definitions

BS-3	Blank spike recovery outside of lab established statistical limits, but still within method limits. Data is not adversely affected.
ND	Analyte NOT DETECTED at or above the reporting limit
RPD	Relative Percent Difference
**	Samples not received at proper temperature of 6°C or below.
***	Insufficient time to reach temperature.
-	Chloride by SM4500Cl-B does not require samples be received at or below 6°C Samples reported on an as received basis (wet) unless otherwise noted on report

Cardinal Laboratories

*=Accredited Analyte

PLEASE NOTE: Liability and Damages. Cardinal's liability and client's exclusive remedy for any claim arising, whether based in contract or tort, shall be limited to the amount paid by client for analyses. All claims, including those for negligence and any other cause whatsoever shall be deemed waived unless made in writing and received by Cardinal within thirty (30) days after completion of the applicable service. In no event shall Cardinal be liable for incidental or consequential damages, including, without limitation, business interruptions, loss of use, or loss of profits incurred by client, its subsidiaries, affiliates or successors arising out of or related to the performance of the services hereunder by Cardinal, regardless of whether such claim is based upon any of the above stated reasons or otherwise. Results relate only to the samples identified above. This report shall not be reproduced except in full with written approval of Cardinal Laboratories.

A handwritten signature in black ink, appearing to read "Celey D. Keene".

Celey D. Keene, Lab Director/Quality Manager



ARDINAL LABORATORIES

101 East Marland, Hobbs, NM 88240
(505) 393-2326 FAX (505) 393-2476

CHAIN-OF-CUSTODY AND ANALYSIS REQUEST

Company Name: BBC International, Inc. Project Manager: Cliff Brunson Address: P.O. Box 805 City: Hobbs Phone #: 575-397-6388 State: NM Zip: 88241 Fax #: 575-397-0397 Project #: Project Name: <u>Feize Feel # 7</u> Project Location: Project Owner: Oxy Sample Name: ROGER HERNANDEZ Sampler Name:		P.O. #: Company: OXY Attn: WADE Address: City: State: Zip: Phone #: Fax #:	
FOR LAB USE ONLY		BILL TO	
Lab I.D. H21803		Sample I.D.	
1 Bottom 1' 1' (G)RAB OR (C)OMP. 2 Bottom 2' 1' # CONTAINERS 3 Bottom 3' 1' GROUNDWATER 4 Bottom 4' 1' WASTEWATER 5 Bottom 5' 1' SOIL 6 Bottom 6' 1' OIL 7 Bottom 7' 1' SLUDGE 8 Bottom 8' 1' OTHER : 9 Bottom 9' 1' ACID/BASE: 10 Bottom 10' 1' ICE / COOL 11 Bottom 11' 1' OTHER :		MATRIX PRESERV SAMPLING	
DATE TIME		CL BTEX TPH EXT	
Relinquished By: <u>R. Hernandez</u> Date: <u>7.11.21</u> Time: <u>10:40</u> Relinquished By: <u>John Henderson</u> Date: <u>7.11.21</u> Time: <u>10:40</u> Received By: <u>John Henderson</u> Date: <u>7.11.21</u> Time: <u>10:40</u>		ANALYSIS REQUEST	
Delivered By: (Circle One) Sampler - UPS - Bus - Other: <u>-15.00 / #113</u> Sample Condition Cool / Intact Yes <input checked="" type="checkbox"/> No <input type="checkbox"/> Checked By: <u>[Signature]</u> Initials: <u>[Signature]</u>		Phone Result: <input type="checkbox"/> Yes <input type="checkbox"/> No <input type="checkbox"/> Add'l Phone #: <u> </u> Fax Result: <input type="checkbox"/> Yes <input type="checkbox"/> No <input type="checkbox"/> Add'l Fax #: <u> </u> REMARKS:	

† Cardinal cannot accept verbal changes. Please fax written changes to 505-393-2476



ARDINAL LABORATORIES
101 East Marland, Hobbs, NM 88240
(505) 393-2326 FAX (505) 393-2476

CHAIN-OF-CUSTODY AND ANALYSIS REQUEST

Company Name: BBC International, Inc. Project Manager: Cliff Brunson Address: P.O. Box 805 City: Hobbs Phone #: 575-397-6388 Project #: Project Name: Project Location: Sampler Name: ROGER HERNANDEZ		State: NM Zip: 88241 Fax #: 575-397-0397 Project Owner: Oxy City: State: Zip: Phone #: Fax #:		BILL TO P.O. #: Company: OXY Attn: WADE Address: City: State: Zip: Phone #: Fax #:		ANALYSIS REQUEST					
Lab I.D. Sample I.D.	11 Bottom 11 @ 1' 12 Bottom 12 @ 1' 13 Bottom 13 @ 1' 14 Bottom 14 @ 1' 15 Bottom 15 @ 1' 16 Bottom 16 @ 1' 17 Bottom 17 @ 1' 18 Bottom 18 @ 2' 19 Bottom 19 @ 2' 20 Bottom 20 @ 2'	(G)RAB OR (C)OMP. # CONTAINERS GROUNDWATER WASTEWATER SOIL OIL SLUDGE OTHER : ACID/BASE: ICE / COOL OTHER :	MATRIX PRESERV SAMPLING	DATE TIME	CL BTEX TPH EXT						
PLEASE NOTE: Liability and Damages. Cardinal's liability and client's exclusive remedy for any claim arising whether based in contract or tort, shall be limited to the amount paid by the client for the analyses. All claims including those for negligence and any other cause whatsoever shall be deemed waived unless made in writing and received by Cardinal within 30 days after completion of the applicable service. In no event shall Cardinal be liable for incidental or consequential damages, including without limitation, business interruptions, loss of use, or loss of profits incurred by client, its subsidiaries, affiliates or successors arising out of or related to the performance of services hereunder by Cardinal, regardless of whether such claim is based upon any of the above stated reasons or otherwise.											
Relinquished By: Roger Hernandez Date: 7.11.21 Time: 10:40 Relinquished By:		Received By: Roger Hernandez Date: 7.11.21 Time: 10:40 Received By:		Phone Result: <input type="checkbox"/> Yes <input type="checkbox"/> No Add'l Phone #: Fax Result: <input type="checkbox"/> Yes <input type="checkbox"/> No Add'l Fax #: REMARKS:							
Delivered By: (Circle One) Sampler - UPS - Bus - Other: -15.02/#113 Sample Condition Cool <input checked="" type="checkbox"/> Intact <input type="checkbox"/> Yes <input checked="" type="checkbox"/> No <input type="checkbox"/> Checked By: (Initials)											



CARDINAL LABORATORIES

101 East Marland, Hobbs, NM 88240
(505) 393-2326 FAX (505) 393-2476

CHAIN-OF-CUSTODY AND ANALYSIS REQUEST

Company Name: BBC International, Inc.

Project Manager: Cliff Brunson

Address: P.O. Box 805

City: Hobbs

Phone #: 575-397-6388

Project #:

Project Name:

Project Location:

Sampler Name: ROGER HERNANDEZ

State: NM zip: 88241

Fax #: 575-397-0397

Project Owner: Oxy

Price fed # 7

Phone #:

Fax #:

P.O. #:

Company: OXY

Attn: WADE

Address:

City:

State: zip:

Phone #:

Fax #:

BILL TO

ANALYSIS REQUEST

Lab I.D.	Sample I.D.	(G)RAB OR (C)OMP.	# CONTAINERS	MATRIX						DATE	TIME	CL	BTEX	TPH EXT
				GROUNDWATER	WASTEWATER	SOIL	OIL	SLUDGE	OTHER :					
21	Bottom	2102	1							3.9.21	1130			
22	Bottom	2202	1							3.9.21	1135			
23	Bottom	2302	1							3.9.21	1140			
24	Bottom	2402	1							3.9.21	1145			
25	Bottom	2502	1							3.9.21	1150			
26	Bottom	2602	1							3.9.21	1155			
27	Bottom	2702	1							3.9.21	1200			
28	Bottom	2802	1							3.9.21	1205			
29	Bottom	2902	1							3.9.21	1210			
30	Bottom	3002	1							3.9.21	1215			

PLEASE NOTE: Liability and Damages. Cardinal's liability and client's exclusive remedy for any claim arising whether caused in contract or tort, shall be limited to the amount paid by the client for the analyses. All claims, including those for negligence and any other cause whatsoever shall be deemed waived unless made in writing and received by Cardinal within 30 days after completion of the applicable service. In no event shall Cardinal be liable for incidental or consequential damages, including without limitation, business interruptions, loss of use, or loss of profits incurred by client, its subsidiaries, affiliates or successors arising out of or related to the performance of services hereunder by Cardinal, regardless of whether such claim is based upon any of the above stated reasons or otherwise.

Relinquished By: *Cliff Brunson*

Date: 3.12.21

Time: 10:40

Received By: *Medi Hernandez*

Date: 3.12.21

Time: 10:40

Received By: *Medi Hernandez*

Date: 3.12.21

Time: 10:40

Received By: *Medi Hernandez*

Date: 3.12.21

Time: 10:40

Received By: *Medi Hernandez*

Date: 3.12.21

Time: 10:40

Received By: *Medi Hernandez*

Date: 3.12.21

Time: 10:40

Received By: *Medi Hernandez*

Date: 3.12.21

Time: 10:40

Received By: *Medi Hernandez*

Date: 3.12.21

Time: 10:40

Received By: *Medi Hernandez*

Date: 3.12.21

Time: 10:40

Received By: *Medi Hernandez*

Date: 3.12.21

Time: 10:40

Received By: *Medi Hernandez*

Date: 3.12.21

Time: 10:40

Received By: *Medi Hernandez*

Date: 3.12.21

Time: 10:40

Received By: *Medi Hernandez*

Delivered By: (Circle One)

Sampler - UPS - Bus - Other: -15.001 #113

Sample Condition

Cool ☒ Intact ☒

Yes ☒ No ☐

Yes ☒ No ☐

Checked By: *Medi Hernandez*

Phone Result: ☐ Yes ☐ No ☐

Fax Result: ☐ Yes ☐ No ☐

Remarks:

Cardinal cannot accept verbal changes. Please fax written changes to 505-393-2476



ARDINAL LABORATORIES
101 East Marland, Hobbs, NM 88240
(505) 393-2326 FAX (505) 393-2476

CHAIN-OF-CUSTODY AND ANALYSIS REQUEST

BILL TO

ANALYSIS REQUEST

Company Name: BBC International, Inc.		P.O. #:	
Project Manager: Cliff Brunson		Company: OXY	
Address: P.O. Box 805		Attn: WADE	
City: Hobbs		Address:	
Phone #: 575-397-6388		Fax #: 575-397-0397	
Project #:		City:	
Project Name: <i>PRIZE FEE # 7</i>		State:	
Project Location:		Phone #:	
Sample Name: ROGER HERNANDEZ		Fax #:	

Lab I.D.	Sample I.D.	(G)RAB OR (C)OMP.	# CONTAINERS	MATRIX						DATE	TIME	CL	BTX	TPH EXT
				GROUNDWATER	WASTEWATER	SOIL	OIL	SLUDGE	OTHER :					
31	Bottom 3/10 7'	G	1							3.9.21	1220			
32	SIDEWALL									3.9.21	1225			
33	SIDEWALL									3.9.21	1230			
34	SIDEWALL									3.9.21	1235			
35	SIDEWALL									3.9.21	1240			
36	SIDEWALL									3.9.21	1245			
37	SIDEWALL									3.9.21	1250			
38	SIDEWALL									3.9.21	1255			
39	SIDEWALL									3.9.21	1300			
40	SIDEWALL									3.9.21	1305			

Relinquished By: <i>[Signature]</i>	Date: 7.12.21	Received By: <i>[Signature]</i>	Date: 7.12.21
Relinquished By:	Date:	Received By:	Date:
Time:		Time:	

Delivered By: (Circle One)	Sample Condition	CHECKED BY:
Sampler - UPS - Bus - Other: <i>-15.02/4113</i>	<input checked="" type="checkbox"/> Cool <input type="checkbox"/> Intact <input type="checkbox"/> Yes <input type="checkbox"/> No	<i>[Signature]</i>

† Cardinal cannot accept verbal changes. Please fax written changes to 505-393-2476



CARDINAL LABORATORIES
101 East Marland, Hobbs, NM 88240
(505) 393-2326 FAX (505) 393-2476

CHAIN-OF-CUSTODY AND ANALYSIS REQUEST

585

BILL TO

ANALYSIS REQUEST

Company Name: BBC International, Inc.

Project Manager: Cliff Brunson

Address: P.O. Box 805

City: Hobbs

Phone #: 575-397-6388

Project #:

Project Name:

Project Location:

Sampler Name: ROGER HERNANDEZ

State: NM Zip: 88241

Fax #: 575-397-0397

Project Owner: Oxy

Project Name: *Prize Fed # 7*

Project Location:

Sampler Name: ROGER HERNANDEZ

P.O. #:

Company: OXY

Attn: WADE

Address:

City:

State: Zip:

Phone #:

Fax #:

Lab I.D.

Sample I.D.

41 SIDEWALL 10
42 SIDEWALL 11

(G)RAB OR (C)OMP.

CONTAINERS

GROUNDWATER

WASTEWATER

SOIL

OIL

SLUDGE

OTHER :

ACID/BASE:

ICE / COOL

OTHER :

DATE

TIME

CL

BTEX

TPH EXT

MATRIX

PRESERV

SAMPLING

PLEASE NOTE: Liability and Damages. Cardinal's liability and clients' exclusive remedy for any claim arising whether based in contract or tort, shall be limited to the amount paid by the client for the analyses. All claims, including those for negligence and any other cause whatsoever shall be deemed waived unless made in writing and received by Cardinal within 30 days after completion of the applicable service. In no event shall Cardinal be liable for incidental or consequential damages, including without limitation, business interruptions, loss of use, or loss of profits incurred by client, its subsidiaries, affiliates or successors arising out of or related to the performance of services hereunder by Cardinal, regardless of whether such claim is based upon any of the above stated reasons or otherwise.

Relinquished By:

Sign: R. Hernandez

Date: 11.2.21

Time: 10:40

Received By:

Sign: R. Hernandez

Date:

Time:

Relinquished By:

Sign: R. Hernandez

Phone Result:

☐ Yes ☐ No

Fax Result:

☐ Yes ☐ No

Add'l Phone #:

Add'l Fax #:

REMARKS:

Delivered By: (Circle One)

Sampler - UPS - Bus - Other:

-15.00 / #113

Sample Condition
Cool ☐ Intact ☐
Yes ☐ No ☐

CHECKED BY:

Sign: R. Hernandez

† Cardinal cannot accept verbal changes. Please fax written changes to 505-393-2476

District I

1625 N. French Dr., Hobbs, NM 88240
Phone:(575) 393-6161 Fax:(575) 393-0720

District II

811 S. First St., Artesia, NM 88210
Phone:(575) 748-1283 Fax:(575) 748-9720

District III

1000 Rio Brazos Rd., Aztec, NM 87410
Phone:(505) 334-6178 Fax:(505) 334-6170

District IV

1220 S. St Francis Dr., Santa Fe, NM 87505
Phone:(505) 476-3470 Fax:(505) 476-3462

State of New Mexico
Energy, Minerals and Natural Resources
Oil Conservation Division
1220 S. St Francis Dr.
Santa Fe, NM 87505

CONDITIONS

Action 92730

CONDITIONS

Operator: OXY USA INC P.O. Box 4294 Houston, TX 772104294	OGRID: 16696
	Action Number: 92730
	Action Type: [C-141] Release Corrective Action (C-141)

CONDITIONS

Created By	Condition	Condition Date
jnobui	Closure Report Approved.	4/29/2022