

CARMONA RESOURCES



SITE INFORMATION

Closure Report
Asio Otus CTB (02.17.22)
Incident #: NAPP2206232853
Eddy County, New Mexico
Unit K Sec 18 T26S R27E
32.039692°, -104.231634°

Produced Water Release
Point of Release: Alarm Failure
Release Date: 02/17/2022
Volume Released: 12.478 Barrels of Produced Water
Volume Recovered: 12 Barrels of Produced Water

CARMONA RESOURCES



Prepared for:
Concho Operating, LLC
15 West London Road
Loving, New Mexico 88256

Prepared by:
Carmona Resources, LLC
310 West Wall Street
Suite 415
Midland, Texas 79701

310 West Wall Street, Suite 415
Midland TX, 79701
432.813.1992



TABLE OF CONTENTS

1.0 SITE INFORMATION AND BACKGROUND

2.0 SITE CHARACTERIZATION AND GROUNDWATER

3.0 NMAC REGULATORY CRITERIA

4.0 LINER INSPECTION ACTIVITIES

5.0 CONCLUSIONS

FIGURES

FIGURE 1 OVERVIEW FIGURE 2 TOPOGRAPHIC

FIGURE 3 SECONDARY CONTAINMENT MAP

APPENDICES

APPENDIX A PHOTOS

APPENDIX B INITIAL C-141 AND FINAL/NMOCD CORRESPONDENCE

APPENDIX C SITE CHARACTERIZATION AND GROUNDWATER

March 15, 2022

Mike Bratcher
District Supervisor
Oil Conservation Division, District 2
811 S. First Street
Artesia, New Mexico 88210

**Re: Closure Report
Asio Otus CTB (02.17.22)
Concho Operating, LLC
Incident ID NAPP2206232853
Site Location: Unit K, S18, T26S, R27E
(Lat 32.039692°, Long -104.231634°)
Eddy County, New Mexico**

To whom it may concern:

On behalf of Concho Operating, LLC (COG), Carmona Resources, LLC has prepared this letter to document liner inspection activities for Asio Otus CTB (02.17.22). The site is located at 32.039692°, -104.231634° within Unit K, S18, T26S, R27E, in Eddy County, New Mexico (Figures 1 and 2).

1.0 Site information and Background

Based on the initial C-141 obtained from the New Mexico Oil Conservation Division (NMOCD), the release was discovered on February 17, 2022, due to an alarm failure. It resulted in approximately twelve point four seven eight (12.478) barrels of produced water. Twelve (12) barrels were recovered. See figure 3. The initial C-141 form is attached in Appendix B.

2.0 Site Characterization and Groundwater

The site is located within a medium karst area. Based on a review of the New Mexico Office of State Engineers and USGS databases, no known water sources are within a 0.50-mile radius of the location. The closest well is located approximately 1.34 miles Northwest of the site in S12, T26S, R26E and was drilled in 2018. The well has a reported depth to groundwater of 12.60' feet below ground surface (ft bgs). A copy of the associated *USGS – National Water Information System* report is attached in Appendix C.

3.0 NMAC Regulatory Criteria

Per the NMOCD regulatory criteria established in 19.15.29.12 NMAC, the following criteria were utilized in assessing the site.

- Benzene: 10 milligrams per kilogram (mg/kg).
- Benzene, toluene, ethylbenzene, and total xylenes (BTEX): 50 mg/kg.
- TPH: 100 mg/kg (GRO + DRO + MRO).
- Chloride: 600 mg/kg



4.0 Liner Inspection Activities

On March 8, 2022, Carmona Resources, LLC conducted liner inspection activities to assess the liner's integrity within the facility. Carmona Resources, LLC personnel proceeded to inspect the liner visually. The liner was found to be intact with no integrity issues. Refer to the Photolog.

5.0 Conclusions

Based on the liner inspection throughout the facility, no further actions are required at the site. The final C-141 is attached, and COG formally requests closure of the spill. If you have any questions regarding this report or need additional information, don't hesitate to contact us at 432-813-1992.

Sincerely,

Carmona Resources, LLC

Mike Carmona
Environmental Manager

Clinton Merritt
Environmental Manager

FIGURES

CARMONA RESOURCES



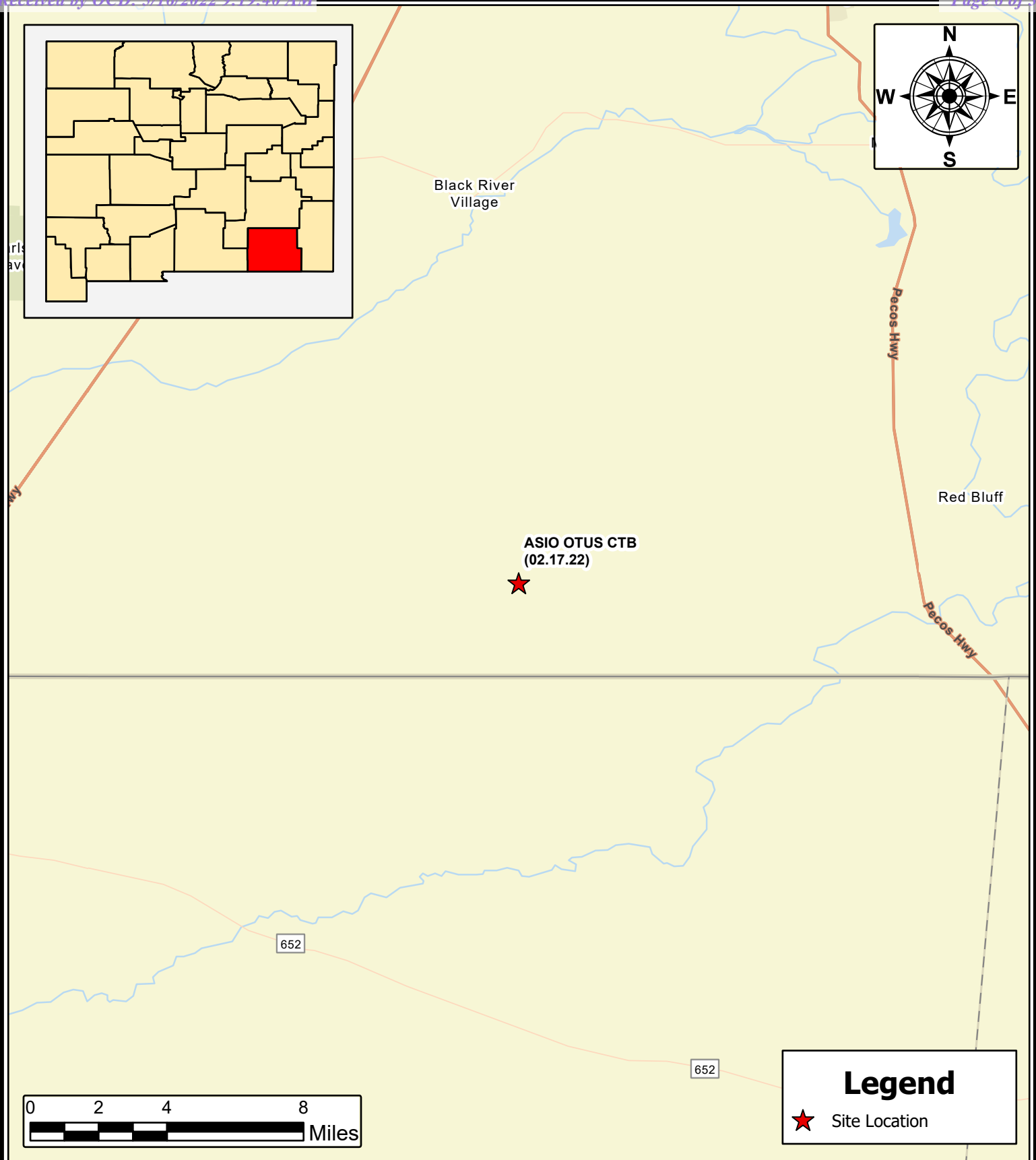

OVERVIEW MAP
COG OPERATING
ASIO OTUS CTB (02.17.22)
EDDY COUNTY, NEW MEXICO
32.039692, -104.231634

SCALE: As Shown

Date: 3/14/2022



Carmona Resources
310 West Wall Street, Suite 415
Midland, Texas 79701

NOTES:

1. Base Image: ESRI Maps & Data 2013
2. Map Projection: NAD 1983 UTM Zone 13N

DRAWING NUMBER:

FIGURE 1

SHEET NUMBER:

1 of 1

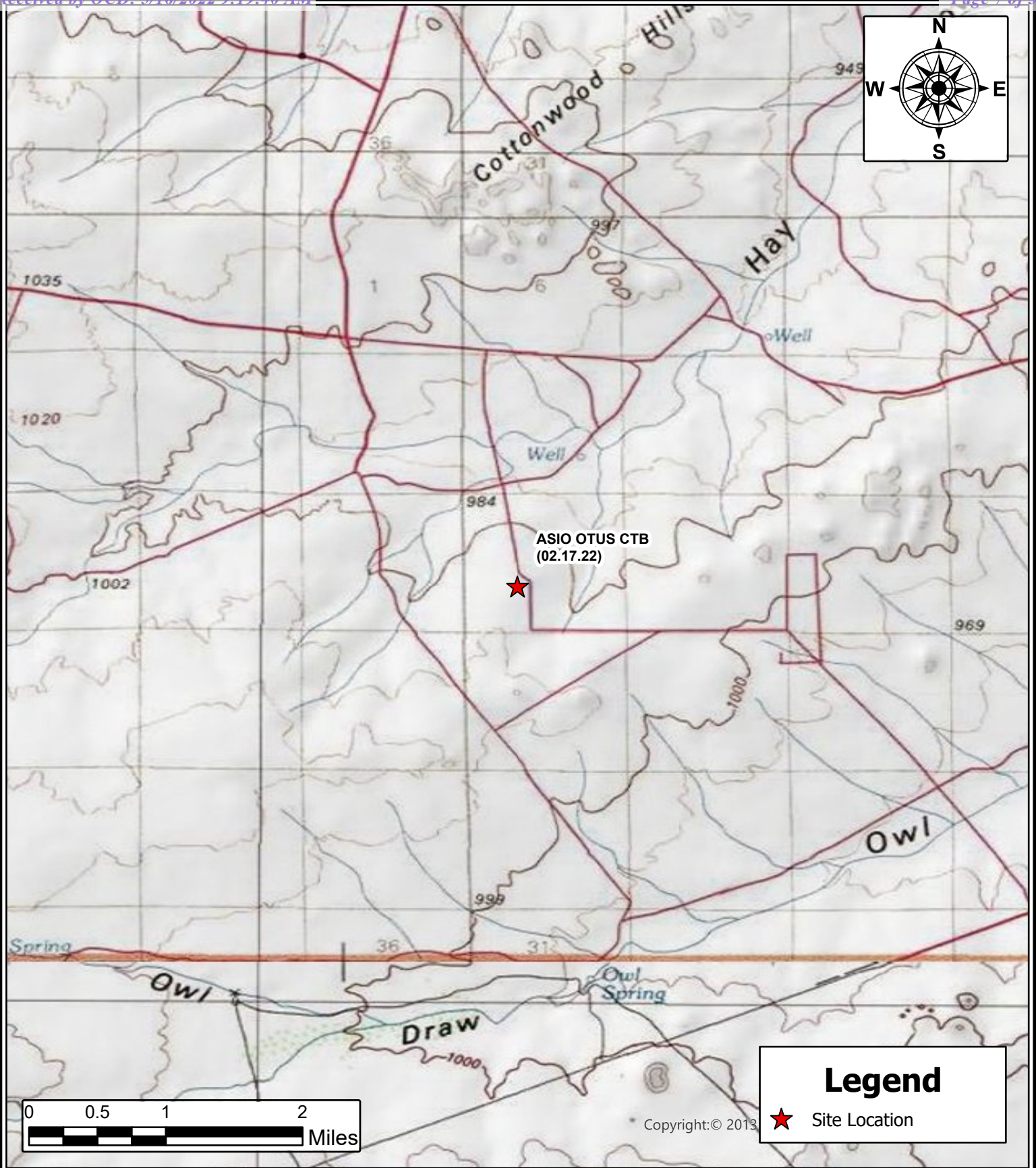

TOPOGRAPHIC MAP COG OPERATING ASIO OTUS CTB (02.17.22) EDDY COUNTY, NEW MEXICO 32.039692, -104.231634	
SCALE: As Shown	Date: 3/14/2022

<p>CARMONA RESOURCES</p>  <p>Carmona Resources 310 West Wall Street, Suite 415 Midland, Texas 79701</p>

<p>NOTES:</p> <p>1. Base Image: ESRI Maps & Data 2013 2. Map Projection: NAD 1983 UTM Zone 13N</p>

DRAWING NUMBER:
FIGURE 2
SHEET NUMBER:
1 of 1



0 30 60 120
Feet

Legend

 Lined Facility

SECONDARY CONTAINMENT MAP
COG OPERATING
ASIO OTUS CTB (02.17.22)
EDDY COUNTY, NEW MEXICO
32.039692, -104.231634

SCALE: As Shown

Date: 3/14/2022



Carmona Resources
310 West Wall Street, Suite 415
Midland, Texas 79701

NOTES:

1. Base Image: ESRI Maps & Data 2013
2. Map Projection: NAD 1983 UTM Zone 13N

DRAWING NUMBER:

FIGURE 3

SHEET NUMBER:

1 of 1

APPENDIX A

CARMONA RESOURCES



PHOTOGRAPHIC LOG

Concho Operating, LLC

Photograph No. 1

Facility: Asio Otus CTB (02.17.22)

County: Eddy County, New Mexico

Description:

View East of lined facility.



Photograph No. 2

Facility: Asio Otus CTB (02.17.22)

County: Eddy County, New Mexico

Description:

View North of lined facility.



Photograph No. 3

Facility: Asio Otus CTB (02.17.22)

County: Eddy County, New Mexico

Description:

View East of lined facility.



PHOTOGRAPHIC LOG**Concho Operating, LLC****Photograph No. 4****Facility:** Asio Otus CTB (02.17.22)**County:** Eddy County, New Mexico**Description:**

View Northeast of lined facility.

**Photograph No. 5****Facility:** Asio Otus CTB (02.17.22)**County:** Eddy County, New Mexico**Description:**

View Northwest of lined facility.

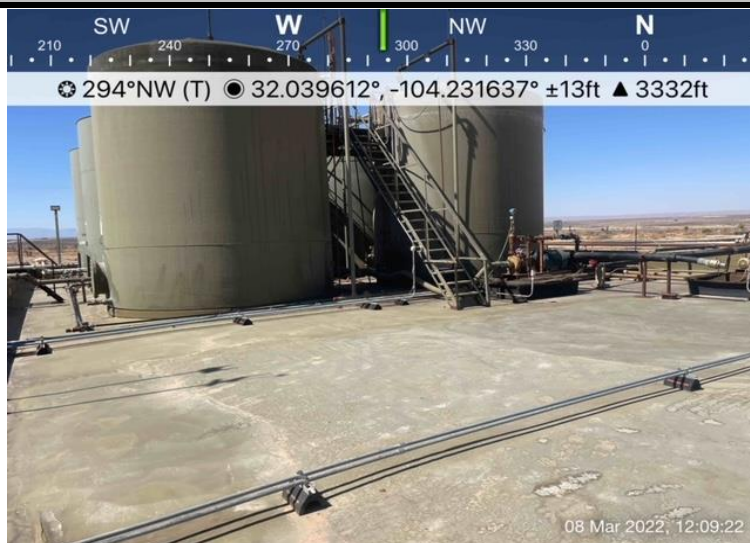
**Photograph No. 6****Facility:** Asio Otus CTB (02.17.22)**County:** Eddy County, New Mexico**Description:**

View East of lined facility.



PHOTOGRAPHIC LOG

Concho Operating, LLC

Photograph No. 7

Facility: Asio Otus CTB (02.17.22)

County: Eddy County, New Mexico

Description:

View West of lined facility.



Photograph No. 8

Facility: Asio Otus CTB (02.17.22)

County: Eddy County, New Mexico

Description:

View East of lined facility.



Photograph No. 9

Facility: Asio Otus CTB (02.17.22)

County: Eddy County, New Mexico

Description:

View Southwest of lined facility.



APPENDIX B

CARMONA RESOURCES



District I
1625 N. French Dr., Hobbs, NM 88240
District II
811 S. First St., Artesia, NM 88210
District III
1000 Rio Brazos Road, Aztec, NM 87410
District IV
1220 S. St. Francis Dr., Santa Fe, NM 87505

State of New Mexico
Energy Minerals and Natural
Resources Department

Oil Conservation Division
1220 South St. Francis Dr.
Santa Fe, NM 87505

Form C-141
Revised August 24, 2018
Submit to appropriate OCD District office

Incident ID	
District RP	
Facility ID	
Application ID	

Release Notification

Responsible Party

Responsible Party	OGRID
Contact Name	Contact Telephone
Contact email	Incident # (assigned by OCD)
Contact mailing address	

Location of Release Source

Latitude _____ Longitude _____
(NAD 83 in decimal degrees to 5 decimal places)

Site Name	Site Type
Date Release Discovered	API# (if applicable)

Unit Letter	Section	Township	Range	County

Surface Owner: ☐ State ☐ Federal ☐ Tribal ☐ Private (Name: _____)

Nature and Volume of Release

Material(s) Released (Select all that apply and attach calculations or specific justification for the volumes provided below)

<input type="checkbox"/> Crude Oil	Volume Released (bbls)	Volume Recovered (bbls)
<input type="checkbox"/> Produced Water	Volume Released (bbls)	Volume Recovered (bbls)
	Is the concentration of dissolved chloride in the produced water >10,000 mg/l?	<input type="checkbox"/> Yes <input type="checkbox"/> No
<input type="checkbox"/> Condensate	Volume Released (bbls)	Volume Recovered (bbls)
<input type="checkbox"/> Natural Gas	Volume Released (Mcf)	Volume Recovered (Mcf)
<input type="checkbox"/> Other (describe)	Volume/Weight Released (provide units)	Volume/Weight Recovered (provide units)

Cause of Release

State of New Mexico
Oil Conservation Division

Incident ID	
District RP	
Facility ID	
Application ID	

Was this a major release as defined by 19.15.29.7(A) NMAC? <input type="checkbox"/> Yes <input type="checkbox"/> No	If YES, for what reason(s) does the responsible party consider this a major release?
If YES, was immediate notice given to the OCD? By whom? To whom? When and by what means (phone, email, etc)?	

Initial Response

The responsible party must undertake the following actions immediately unless they could create a safety hazard that would result in injury

<input type="checkbox"/> The source of the release has been stopped.	
<input type="checkbox"/> The impacted area has been secured to protect human health and the environment.	
<input type="checkbox"/> Released materials have been contained via the use of berms or dikes, absorbent pads, or other containment devices.	
<input type="checkbox"/> All free liquids and recoverable materials have been removed and managed appropriately.	
If all the actions described above have <u>not</u> been undertaken, explain why:	
Per 19.15.29.8 B. (4) NMAC the responsible party may commence remediation immediately after discovery of a release. If remediation has begun, please attach a narrative of actions to date. If remedial efforts have been successfully completed or if the release occurred within a lined containment area (see 19.15.29.11(A)(5)(a) NMAC), please attach all information needed for closure evaluation.	
I hereby certify that the information given above is true and complete to the best of my knowledge and understand that pursuant to OCD rules and regulations all operators are required to report and/or file certain release notifications and perform corrective actions for releases which may endanger public health or the environment. The acceptance of a C-141 report by the OCD does not relieve the operator of liability should their operations have failed to adequately investigate and remediate contamination that pose a threat to groundwater, surface water, human health or the environment. In addition, OCD acceptance of a C-141 report does not relieve the operator of responsibility for compliance with any other federal, state, or local laws and/or regulations.	
Printed Name: _____	Title: _____
Signature: <u>Battani Espinoza</u>	Date: _____
email: _____	Telephone: _____
<u>OCD Only</u>	
Received by: _____	Date: _____

Facility Name & Number:	Osio Otus Fed 3H Battery
Asset Area:	Carlsbad 2 South
Release Discovery Date & Time:	2/17/2022
Release Type:	Produced Water
Provide any known details about the event:	Both water tanks filled and overflowed/About 11 bbls recovered

Spill Calculation - On Pad Surface Pool Spill

Convert Irregular shape into a series of rectangles	Length (ft.)	Width (ft.)	Deepest point in each of the areas (in.)	No. of boundaries of "shore" in each area	Estimated <u>Pool</u> Area (sq. ft.)	Estimated Average Depth (ft.)	Estimated volume of each pool area (bbl.)	Penetration allowance (ft.)	Total Estimated Volume of Spill (bbl.)
Rectangle A	60.0	40.0	0.35	1	2400.000	0.029	12.460	0.001	12.478
Rectangle B					0.000	#DIV/0!	#DIV/0!	#DIV/0!	#DIV/0!
Rectangle C					0.000	#DIV/0!	#DIV/0!	#DIV/0!	#DIV/0!
Rectangle D					0.000	#DIV/0!	#DIV/0!	#DIV/0!	#DIV/0!
Rectangle E					0.000	#DIV/0!	#DIV/0!	#DIV/0!	#DIV/0!
Rectangle F					0.000	#DIV/0!	#DIV/0!	#DIV/0!	#DIV/0!
Rectangle G					0.000	#DIV/0!	#DIV/0!	#DIV/0!	#DIV/0!
Rectangle H					0.000	#DIV/0!	#DIV/0!	#DIV/0!	#DIV/0!
Rectangle I					0.000	#DIV/0!	#DIV/0!	#DIV/0!	#DIV/0!
Rectangle J					0.000	#DIV/0!	#DIV/0!	#DIV/0!	#DIV/0!
Total Volume Release:									12.478

Incident ID	
District RP	
Facility ID	
Application ID	

Site Assessment/Characterization

This information must be provided to the appropriate district office no later than 90 days after the release discovery date.

What is the shallowest depth to groundwater beneath the area affected by the release?	_____ (ft bgs)
Did this release impact groundwater or surface water?	<input type="checkbox"/> Yes <input type="checkbox"/> No
Are the lateral extents of the release within 300 feet of a continuously flowing watercourse or any other significant watercourse?	<input type="checkbox"/> Yes <input type="checkbox"/> No
Are the lateral extents of the release within 200 feet of any lakebed, sinkhole, or playa lake (measured from the ordinary high-water mark)?	<input type="checkbox"/> Yes <input type="checkbox"/> No
Are the lateral extents of the release within 300 feet of an occupied permanent residence, school, hospital, institution, or church?	<input type="checkbox"/> Yes <input type="checkbox"/> No
Are the lateral extents of the release within 500 horizontal feet of a spring or a private domestic fresh water well used by less than five households for domestic or stock watering purposes?	<input type="checkbox"/> Yes <input type="checkbox"/> No
Are the lateral extents of the release within 1000 feet of any other fresh water well or spring?	<input type="checkbox"/> Yes <input type="checkbox"/> No
Are the lateral extents of the release within incorporated municipal boundaries or within a defined municipal fresh water well field?	<input type="checkbox"/> Yes <input type="checkbox"/> No
Are the lateral extents of the release within 300 feet of a wetland?	<input type="checkbox"/> Yes <input type="checkbox"/> No
Are the lateral extents of the release overlying a subsurface mine?	<input type="checkbox"/> Yes <input type="checkbox"/> No
Are the lateral extents of the release overlying an unstable area such as karst geology?	<input type="checkbox"/> Yes <input type="checkbox"/> No
Are the lateral extents of the release within a 100-year floodplain?	<input type="checkbox"/> Yes <input type="checkbox"/> No
Did the release impact areas not on an exploration, development, production, or storage site?	<input type="checkbox"/> Yes <input type="checkbox"/> No

Attach a comprehensive report (electronic submittals in .pdf format are preferred) demonstrating the lateral and vertical extents of soil contamination associated with the release have been determined. Refer to 19.15.29.11 NMAC for specifics.

Characterization Report Checklist: *Each of the following items must be included in the report.*

- ☐ Scaled site map showing impacted area, surface features, subsurface features, delineation points, and monitoring wells.
- ☐ Field data
- ☐ Data table of soil contaminant concentration data
- ☐ Depth to water determination
- ☐ Determination of water sources and significant watercourses within ½-mile of the lateral extents of the release
- ☐ Boring or excavation logs
- ☐ Photographs including date and GIS information
- ☐ Topographic/Aerial maps
- ☐ Laboratory data including chain of custody

If the site characterization report does not include completed efforts at remediation of the release, the report must include a proposed remediation plan. That plan must include the estimated volume of material to be remediated, the proposed remediation technique, proposed sampling plan and methods, anticipated timelines for beginning and completing the remediation. The closure criteria for a release are contained in Table 1 of 19.15.29.12 NMAC, however, use of the table is modified by site- and release-specific parameters.

State of New Mexico
Oil Conservation Division

Incident ID	
District RP	
Facility ID	
Application ID	

I hereby certify that the information given above is true and complete to the best of my knowledge and understand that pursuant to OCD rules and regulations all operators are required to report and/or file certain release notifications and perform corrective actions for releases which may endanger public health or the environment. The acceptance of a C-141 report by the OCD does not relieve the operator of liability should their operations have failed to adequately investigate and remediate contamination that pose a threat to groundwater, surface water, human health or the environment. In addition, OCD acceptance of a C-141 report does not relieve the operator of responsibility for compliance with any other federal, state, or local laws and/or regulations.

Printed Name: _____ Title: _____

Signature: _____ Date: _____

email: _____ Telephone: _____

OCD Only

Received by: _____ Date: _____

Incident ID	
District RP	
Facility ID	
Application ID	

Closure

The responsible party must attach information demonstrating they have complied with all applicable closure requirements and any conditions or directives of the OCD. This demonstration should be in the form of a comprehensive report (electronic submittals in .pdf format are preferred) including a scaled site map, sampling diagrams, relevant field notes, photographs of any excavation prior to backfilling, laboratory data including chain of custody documents of final sampling, and a narrative of the remedial activities. Refer to 19.15.29.12 NMAC.

Closure Report Attachment Checklist: *Each of the following items must be included in the closure report.*

- ☐ A scaled site and sampling diagram as described in 19.15.29.11 NMAC
- ☐ Photographs of the remediated site prior to backfill or photos of the liner integrity if applicable (Note: appropriate OCD District office must be notified 2 days prior to liner inspection)
- ☐ Laboratory analyses of final sampling (Note: appropriate ODC District office must be notified 2 days prior to final sampling)
- ☐ Description of remediation activities

I hereby certify that the information given above is true and complete to the best of my knowledge and understand that pursuant to OCD rules and regulations all operators are required to report and/or file certain release notifications and perform corrective actions for releases which may endanger public health or the environment. The acceptance of a C-141 report by the OCD does not relieve the operator of liability should their operations have failed to adequately investigate and remediate contamination that pose a threat to groundwater, surface water, human health or the environment. In addition, OCD acceptance of a C-141 report does not relieve the operator of responsibility for compliance with any other federal, state, or local laws and/or regulations. The responsible party acknowledges they must substantially restore, reclaim, and re-vegetate the impacted surface area to the conditions that existed prior to the release or their final land use in accordance with 19.15.29.13 NMAC including notification to the OCD when reclamation and re-vegetation are complete.

Printed Name: _____ Title: _____

Signature: _____ Date: _____

email: _____ Telephone: _____

OCD Only

Received by: _____ Date: _____

Closure approval by the OCD does not relieve the responsible party of liability should their operations have failed to adequately investigate and remediate contamination that poses a threat to groundwater, surface water, human health, or the environment nor does not relieve the responsible party of compliance with any other federal, state, or local laws and/or regulations.

Closure Approved by: _____ Date: _____

Printed Name: _____ Title: _____

APPENDIX C

CARMONA RESOURCES





Nearest Water Wells

COG Operating

Legend

 0.50 Mile Radius

 1.34 Miles

 1.57 Miles

 2.31 Miles

 Asio Otus CTB (02.17.22)

 USGS Water Well

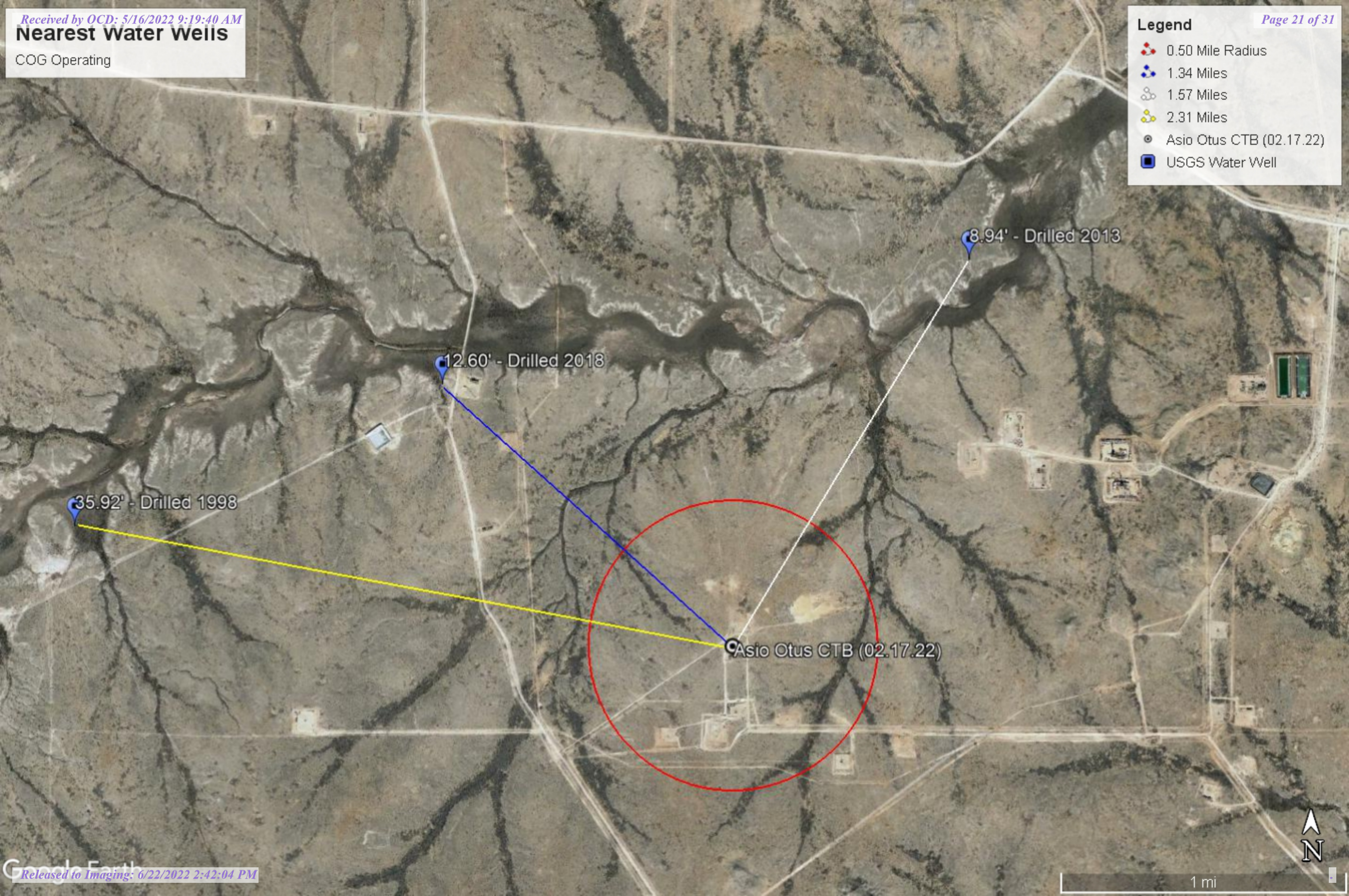

Medium Karst

COG Operating

Legend

- Asio Otus CTB (02.17.22)
- MEDIUM

Asio Otus CTB (02.17.22)



1 mi



New Mexico Office of the State Engineer

Water Column/Average Depth to Water

(A CLW##### in the POD suffix indicates the POD has been replaced & no longer serves a water right file.)

(R=POD has been replaced,
O=orphaned,
C=the file is closed)

(quarters are 1=NW 2=NE 3=SW 4=SE)

(quarters are smallest to largest) (NAD83 UTM in meters)

(In feet)

POD Number	POD Sub-Code	basin	County	Q 64	Q 16	Q 4	Sec	Tws	Rng	X	Y	Depth Well	Depth Water	Water Column
C 02218	CUB	ED		4	1	4	07	26S	27E	573039	3546725*	35		
C 02219	CUB	ED		4	4	4	05	26S	27E	575033	3547948*	35		
C 02474	CUB	ED		4	3	02		26S	27E	578964	3548029*	100		
C 02475	CUB	ED		2	4	13		26S	27E	581450	3545252*	100		
C 02476	CUB	ED		4	1	24		26S	27E	580653	3544032*	150		
C 02930	C	ED		2	3	4	22	26S	27E	577938	3543284*	100	50	50
C 04269 POD1	CUB	ED		4	2	3	18	26S	27E	572620	3545176	105		
C 04573 POD1	CUB	ED		3	1	1	11	26S	27E	578524	3547472	104	35	69
C 04573 POD2	CUB	ED		3	1	1	11	26S	27E	578565	3547561	104	35	69
C 04573 POD3	CUB	ED		4	1	1	11	26S	27E	578584	3547602	100	36	64

Average Depth to Water: **39 feet**

Minimum Depth: **35 feet**

Maximum Depth: **50 feet**

Record Count: 10

PLSS Search:

Township: 26S

Range: 27E

*UTM location was derived from PLSS - see Help

The data is furnished by the NMOSE/ISC and is accepted by the recipient with the expressed understanding that the OSE/ISC make no warranties, expressed or implied, concerning the accuracy, completeness, reliability, usability, or suitability for any particular purpose of the data.

3/7/22 7:37 PM

Page 1 of 1

WATER COLUMN/ AVERAGE
DEPTH TO WATER



USGS Home
Contact USGS
Search USGS

National Water Information System: Web Interface

USGS Water Resources

Data Category:

Groundwater

Geographic Area:

New Mexico

GO

Click to hide News Bulletins

- Explore the *NEW* [USGS National Water Dashboard](#) interactive map to access real-time water data from over 13,500 stations nationwide.
- [Full News](#) 

Groundwater levels for New Mexico

Click to hide state-specific text

 Important: [Next Generation Monitoring Location Page](#)

Search Results -- 1 sites found

Agency code = usgs

site_no list =

- 320320104145101

Minimum number of levels = 1

[Save file of selected sites](#) to local disk for future upload

USGS 320320104145101 26S.26E.12.34120

Eddy County, New Mexico

Latitude 32°03'09.7", Longitude 104°14'56.7" NAD83

Land-surface elevation 3,230.90 feet above NGVD29

This well is completed in the Other aquifers (N9999OTHER) national aquifer.

This well is completed in the Alluvium, Bolson Deposits and Other Surface Deposits (110AVMB) local aquifer.

Output formats

[Table of data](#)

[Tab-separated data](#)

[Graph of data](#)

[Reselect period](#)

Date	Time	? Water-level date-time accuracy	? Parameter code	Water level, feet below land surface	Water level, feet above specific vertical datum	Referenced vertical datum	? Status	? Method of measurement	? Measuring agency	? Source measu
1978-01-25			D 62610		3217.55	NGVD29	1	Z		
1978-01-25			D 62611		3219.22	NAVD88	1	Z		
1978-01-25			D 72019	13.35			1	Z		
1992-11-18			D 62610		3218.87	NGVD29	1	S		
1992-11-18			D 62611		3220.54	NAVD88	1	S		
1992-11-18			D 72019	12.03			1	S		
1998-01-13			D 62610		3215.24	NGVD29	1	S		
1998-01-13			D 62611		3216.91	NAVD88	1	S		
1998-01-13			D 72019	15.66			1	S		
2003-01-28			D 62610		3214.44	NGVD29	1	S		USGS
2003-01-28			D 62611		3216.11	NAVD88	1	S		USGS
2003-01-28			D 72019	16.46			1	S		USGS
2013-01-09 22:10 UTC			m 62610		3213.80	NGVD29	1	S		USGS
2013-01-09 22:10 UTC			m 62611		3215.47	NAVD88	1	S		USGS
2013-01-09 22:10 UTC			m 72019	17.10			1	S		USGS

Date	Time	? Water-level date-time accuracy	? Parameter code	Water level, feet below land surface	Water level, feet above specific vertical datum	Referenced vertical datum	? Status	? Method of measurement	? Measuring agency	? Source measu
2018-02-15	22:14 UTC	m	62610		3218.30	NGVD29	1	S	USGS	
2018-02-15	22:14 UTC	m	62611		3219.97	NAVD88	1	S	USGS	
2018-02-15	22:14 UTC	m	72019	12.60			1	S	USGS	

Explanation

Section	Code	Description
Water-level date-time accuracy	D	Date is accurate to the Day
Water-level date-time accuracy	m	Date is accurate to the Minute
Parameter code	62610	Groundwater level above NGVD 1929, feet
Parameter code	62611	Groundwater level above NAVD 1988, feet
Parameter code	72019	Depth to water level, feet below land surface
Referenced vertical datum	NAVD88	North American Vertical Datum of 1988
Referenced vertical datum	NGVD29	National Geodetic Vertical Datum of 1929
Status	1	Static
Method of measurement	S	Steel-tape measurement.
Method of measurement	Z	Other.
Measuring agency		Not determined
Measuring agency	USGS	U.S. Geological Survey
Source of measurement		Not determined
Source of measurement	S	Measured by personnel of reporting agency.
Water-level approval status	A	Approved for publication -- Processing and review completed.

[Questions about sites/data?](#)

[Feedback on this web site](#)

[Automated retrievals](#)

[Help](#)

[Data Tips](#)

[Explanation of terms](#)

[Subscribe for system changes](#)

[News](#)

Accessibility FOIA Privacy Policies and Notices

[U.S. Department of the Interior](#) | [U.S. Geological Survey](#)

Title: Groundwater for New Mexico: Water Levels

URL: <https://nwis.waterdata.usgs.gov/nm/nwis/gwlevels?>



Page Contact Information: [New Mexico Water Data Maintainer](#)

Page Last Modified: 2022-03-07 21:50:17 EST

0.37 0.33 nadww01



USGS Home
Contact USGS
Search USGS

National Water Information System: Web Interface

USGS Water Resources

Data Category:

Groundwater

Geographic Area:

New Mexico

GO

Click to hide News Bulletins

- Explore the *NEW* [USGS National Water Dashboard](#) interactive map to access real-time water data from over 13,500 stations nationwide.
- [Full News](#) 

Groundwater levels for New Mexico

Click to hide state-specific text

 Important: [Next Generation Monitoring Location Page](#)

Search Results -- 1 sites found

Agency code = usgs

site_no list =

• 320343104110201

Minimum number of levels = 1

[Save file of selected sites](#) to local disk for future upload

USGS 320343104110201 26S.27E.08.13230

Eddy County, New Mexico

Latitude 32°03'32.4", Longitude 104°13'03.9" NAD83

Land-surface elevation 3,182.10 feet above NGVD29

This well is completed in the Other aquifers (N9999OTHER) national aquifer.

This well is completed in the Castile Formation (312CSTL) local aquifer.

Output formats

[Table of data](#)

[Tab-separated data](#)

[Graph of data](#)

[Reselect period](#)

Date	Time	? Water-level date-time accuracy	? Parameter code	Water level, feet below land surface	Water level, feet above specific vertical datum	Referenced vertical datum	? Status	? Method of measurement	? Measuring agency	? Source measu
1978-01-03			D 62610		3164.52	NGVD29	1	Z		
1978-01-03			D 62611		3166.18	NAVD88	1	Z		
1978-01-03			D 72019	17.58			1	Z		
1983-01-05			D 62610		3166.54	NGVD29	1	Z		
1983-01-05			D 62611		3168.20	NAVD88	1	Z		
1983-01-05			D 72019	15.56			1	Z		
1987-10-08			D 62610		3167.72	NGVD29	1	Z		
1987-10-08			D 62611		3169.38	NAVD88	1	Z		
1987-10-08			D 72019	14.38			1	Z		
1992-11-04			D 62610		3165.85	NGVD29	1	S		
1992-11-04			D 62611		3167.51	NAVD88	1	S		
1992-11-04			D 72019	16.25			1	S		
1998-01-13			D 62610		3165.45	NGVD29	1	S		
1998-01-13			D 62611		3167.11	NAVD88	1	S		
1998-01-13			D 72019	16.65			1	S		

Date	Time	? Water-level date-time accuracy	? Parameter code	Water level, feet below land surface	Water level, feet above specific vertical datum	Referenced vertical datum	? Status	? Method of measurement	? Measuring agency	? Source measu
2003-01-28			D	62610	3164.88	NGVD29	1	S	USGS	
2003-01-28			D	62611	3166.54	NAVD88	1	S	USGS	
2003-01-28			D	72019	17.22		1	S	USGS	
2013-01-09	21:45 UTC		m	62610	3173.16	NGVD29	1	S	USGS	
2013-01-09	21:45 UTC		m	62611	3174.82	NAVD88	1	S	USGS	
2013-01-09	21:45 UTC		m	72019	8.94		1	S	USGS	

Explanation

Section	Code	Description
Water-level date-time accuracy	D	Date is accurate to the Day
Water-level date-time accuracy	m	Date is accurate to the Minute
Parameter code	62610	Groundwater level above NGVD 1929, feet
Parameter code	62611	Groundwater level above NAVD 1988, feet
Parameter code	72019	Depth to water level, feet below land surface
Referenced vertical datum	NAVD88	North American Vertical Datum of 1988
Referenced vertical datum	NGVD29	National Geodetic Vertical Datum of 1929
Status	1	Static
Method of measurement	S	Steel-tape measurement.
Method of measurement	Z	Other.
Measuring agency		Not determined
Measuring agency	USGS	U.S. Geological Survey
Source of measurement		Not determined
Source of measurement	S	Measured by personnel of reporting agency.
Water-level approval status	A	Approved for publication -- Processing and review completed.

[Questions about sites/data?](#)[Feedback on this web site](#)[Automated retrievals](#)[Help](#)[Data Tips](#)[Explanation of terms](#)[Subscribe for system changes](#)[News](#)[Accessibility](#) [FOIA](#) [Privacy](#) [Policies and Notices](#)[U.S. Department of the Interior](#) | [U.S. Geological Survey](#)

Title: Groundwater for New Mexico: Water Levels

URL: <https://nwis.waterdata.usgs.gov/nm/nwis/gwlevels/>Page Contact Information: [New Mexico Water Data Maintainer](#)

Page Last Modified: 2022-03-07 21:43:34 EST

0.36 0.33 nadww01



USGS Home
Contact USGS
Search USGS

National Water Information System: Web Interface

USGS Water Resources

Data Category:
Groundwater

Geographic Area:
New Mexico

GO

- Click to hideNews Bulletins
- Explore the NEW [USGS National Water Dashboard](#) interactive map to access real-time water data from over 13,500 stations nationwide.
 - [Full News](#)

Groundwater levels for New Mexico

Click to hide state-specific text

i Important: [Next Generation Monitoring Location Page](#)

Search Results -- 1 sites found

Agency code = usgs
site_no list =

- 320244104161501

Minimum number of levels = 1
[Save file of selected sites](#) to local disk for future upload

USGS 320244104161501 26S.26E.15.24444

Eddy County, New Mexico
Latitude 32°02'44", Longitude 104°16'15" NAD27
Land-surface elevation 3,280 feet above NAVD88
The depth of the well is 53 feet below land surface.
This well is completed in the Other aquifers (N9999OTHER) national aquifer.
This well is completed in the Alluvium, Bolson Deposits and Other Surface Deposits (110AVMB) local aquifer.

Output formats

Table of data
Tab-separated data
Graph of data
Reselect period

Date	Time	? Water-level date-time accuracy	? Parameter code	Water level, feet below land surface	Water level, feet above specific vertical datum	Referenced vertical datum	? Status	? Method of measurement	? Measuring agency	? Source measur
1983-08-24			D 62610		3246.37	NGVD29	1		Z	
1983-08-24			D 62611		3248.04	NAVD88	1		Z	
1983-08-24			D 72019	31.96			1		Z	
1987-10-08			D 62610		3248.64	NGVD29	1		Z	
1987-10-08			D 62611		3250.31	NAVD88	1		Z	
1987-10-08			D 72019	29.69			1		Z	
1992-11-18			D 62610		3246.72	NGVD29	1		S	
1992-11-18			D 62611		3248.39	NAVD88	1		S	
1992-11-18			D 72019	31.61			1		S	
1998-01-08			D 62610		3242.41	NGVD29	1		S	
1998-01-08			D 62611		3244.08	NAVD88	1		S	
1998-01-08			D 72019	35.92			1		S	

Explanation		
Section	Code	Description
Water-level date-time accuracy	D	Date is accurate to the Day
Parameter code	62610	Groundwater level above NGVD 1929, feet
Parameter code	62611	Groundwater level above NAVD 1988, feet
Parameter code	72019	Depth to water level, feet below land surface
Referenced vertical datum	NAVD88	North American Vertical Datum of 1988
Referenced vertical datum	NGVD29	National Geodetic Vertical Datum of 1929
Status	1	Static
Method of measurement	S	Steel-tape measurement.
Method of measurement	Z	Other.
Measuring agency		Not determined
Source of measurement		Not determined
Water-level approval status	A	Approved for publication -- Processing and review completed.

- [Questions about sites/data?](#)
[Feedback on this web site](#)
[Automated retrievals](#)
[Help](#)
[Data Tips](#)
[Explanation of terms](#)
[Subscribe for system changes](#)
[News](#)

[Accessibility](#) [FOIA](#) [Privacy](#) [Policies and Notices](#)
[U.S. Department of the Interior](#) | [U.S. Geological Survey](#)
Title: Groundwater for New Mexico: Water Levels
URL: <https://nwis.waterdata.usgs.gov/nm/nwis/gwlevels?>



Page Contact Information: [New Mexico Water Data Maintainer](#)
Page Last Modified: 2022-03-07 21:48:48 EST
0.33 0.3 nadww01

Incident ID	
District RP	
Facility ID	
Application ID	

Closure

The responsible party must attach information demonstrating they have complied with all applicable closure requirements and any conditions or directives of the OCD. This demonstration should be in the form of a comprehensive report (electronic submittals in .pdf format are preferred) including a scaled site map, sampling diagrams, relevant field notes, photographs of any excavation prior to backfilling, laboratory data including chain of custody documents of final sampling, and a narrative of the remedial activities. Refer to 19.15.29.12 NMAC.

Closure Report Attachment Checklist: *Each of the following items must be included in the closure report.*

- ☐ A scaled site and sampling diagram as described in 19.15.29.11 NMAC
- ☐ Photographs of the remediated site prior to backfill or photos of the liner integrity if applicable (Note: appropriate OCD District office must be notified 2 days prior to liner inspection)
- ☐ Laboratory analyses of final sampling (Note: appropriate ODC District office must be notified 2 days prior to final sampling)
- ☐ Description of remediation activities

I hereby certify that the information given above is true and complete to the best of my knowledge and understand that pursuant to OCD rules and regulations all operators are required to report and/or file certain release notifications and perform corrective actions for releases which may endanger public health or the environment. The acceptance of a C-141 report by the OCD does not relieve the operator of liability should their operations have failed to adequately investigate and remediate contamination that pose a threat to groundwater, surface water, human health or the environment. In addition, OCD acceptance of a C-141 report does not relieve the operator of responsibility for compliance with any other federal, state, or local laws and/or regulations. The responsible party acknowledges they must substantially restore, reclaim, and re-vegetate the impacted surface area to the conditions that existed prior to the release or their final land use in accordance with 19.15.29.13 NMAC including notification to the OCD when reclamation and re-vegetation are complete.

Printed Name: _____ Title: _____

Signature: _____ Date: _____

email: _____ Telephone: _____

OCD Only

Received by: Robert Hamlet Date: 6/22/2022

Closure approval by the OCD does not relieve the responsible party of liability should their operations have failed to adequately investigate and remediate contamination that poses a threat to groundwater, surface water, human health, or the environment nor does not relieve the responsible party of compliance with any other federal, state, or local laws and/or regulations.

Closure Approved by: Robert Hamlet Date: 6/22/2022

Printed Name: Robert Hamlet Title: Environmental Specialist - Advanced

District I
1625 N. French Dr., Hobbs, NM 88240
Phone:(575) 393-6161 Fax:(575) 393-0720
District II
811 S. First St., Artesia, NM 88210
Phone:(575) 748-1283 Fax:(575) 748-9720
District III
1000 Rio Brazos Rd., Aztec, NM 87410
Phone:(505) 334-6178 Fax:(505) 334-6170
District IV
1220 S. St Francis Dr., Santa Fe, NM 87505
Phone:(505) 476-3470 Fax:(505) 476-3462

State of New Mexico
Energy, Minerals and Natural Resources
Oil Conservation Division
1220 S. St Francis Dr.
Santa Fe, NM 87505

CONDITIONS

Action 106934

CONDITIONS

Operator: COG OPERATING LLC 600 W Illinois Ave Midland, TX 79701	OGRID: 229137
	Action Number: 106934
	Action Type: [C-141] Release Corrective Action (C-141)

CONDITIONS

Created By	Condition	Condition Date
rhamlet	We have received your closure report and final C-141 for Incident #NAPP2206232853 ASIO OTUS CTB, thank you. This closure is approved.	6/22/2022