



EOG Resources, Inc.
Artesia Division Office
104 S. 4th Street
Artesia, N. M. 88210

July 29, 2022

NMOCD
1220 South St. Francis Drive
Santa Fe, NM 87505

Re: Gissler B #88
30-015-40847
I-11-17S-30E
Eddy County, New Mexico
2RP-2743
Incident #nAB1502026861

EOG Resources, Inc. is submitting the enclosed Closure Report for the above referenced site. The report is being submitted in reference to the C-141 submitted January 19, 2015, by Burnett Oil Company. EOG Resources, Inc. has included a C-141 Final on the current form with this Closure Report, and hereby requests closure.

If you have any questions, feel free to call me at (575) 748-1471.

Respectfully,

Chase Settle

Chase Settle
Rep Safety & Environmental Sr
EOG Resources, Inc.

Gissler B #88
Closure Report
#nAB1502026861



July 29, 2022

Gissler B #88
Closure Report
30-015-40847
I-11-17S-30E
Eddy County, NM
2RP-2743
Incident # nAB1502026861
July 29, 2022

Gissler B #88
Closure Report
#nAB1502026861



July 29, 2022

Table of Contents

I. Location..... 1

II. Background..... 1

III. Scope of Work Completed..... 1

IV. Closure Request..... 1

Appendices:

Appendix A: Burnett Oil Company Closure Report

Appendix B: Current C-141 Closure Form

Gissler B #88
Closure Report
#nAB1502026861



July 29, 2022

I. Location

The site is located approximately 3.2 miles northeast of Loco Hills, New Mexico in Eddy County.

II. Background

On January 16, 2015, Burnett Oil Company (Burnett) had a release at the Gissler B #88 due to a slipped liner on a polish rod. This caused a release of 100 barrels of produced water and 20 barrels of crude oil, with 85 barrels of produced water and 10 barrels of crude oil recovered.

Burnett retained Diversified Environmental (DFSI) to address the remediation of the release.

III. Scope of Work Completed

DFSI conducted soil sampling activities, both field screening and laboratory analysis. The site was excavated from six (6) inches to two (2) feet in depth based on the soil analytical results. DFSI conducted all excavation and backfill activities between the soil sampling date of January 27, 2015, and the seeding date of February 13, 2015. Further details of work completed by DFSI is included with the Burnett Closure Report that is attached as Appendix A.

IV. Closure Request

This Incident was discovered during the divestiture process of the well at the end of 2021. The Closure Report included as Appendix A was provided to EOG Resources, Inc. by Burnett Oil Company after a request was made for information on the release. After review of the work completed by Burnett and their consultant (DFSI), EOG believes enough evidence exists to determine that remediation activities were completed appropriately for the site. The release occurred prior to passage of the current Spill Rule (NMAC 19.15.29), therefore all hydrocarbon results were within the guidelines for that time period, and the chloride results meet the current guidance.

Based on the remediation of the site, EOG Resources, Inc. requests Closure of nAB1502026861, the current C-141 Closure Form is included with this Closure Report as Appendix B.

Gissler B #88
Closure Report
#nAB1502026861



July 29, 2022

Appendix A

Burnett Oil Closure Report

Burnett Oil Co., Inc.

Gissler B 88

CLOSURE REPORT

API No. 30-015-40847

Release Date: January 16, 2015

Unit Letter I, Section 11, Township 17 South, Range 30 East

NMOCD Case #: 2R-2743

April 20, 2016

Prepared by:

Michael Burton, Environmental Operations Director
Diversified Field Service, Inc.
206 W. Snyder
Hobbs, NM 88240
Phone: (575)964-8394
Fax: (575)393-8396

Burnett Oil Co., Inc.

Table of Contents

- 1 Introduction
- 2 Site Activities
- 3 Conclusion

APPENDICES

Appendix I – Initial C-141

Appendix II – Soil Delineation Map

Appendix III –Laboratory Analysis

Appendix IV – Site Photos

Appendix V – Seeding Report

Appendix VI – Final C-141

Diversified Field Service, Inc.
3412 N. Dal Paso
Hobbs, NM 88240
(575) 964-8394

Burnett Oil Co., Inc.

April 20, 2016

Gissler B 88

1 INTRODUCTION

Burnett Oil Co., Inc. (Burnett) has retained Diversified Environmental (DFSI) to address environmental issues for the site detailed herein.

The site is located northeast of Loco Hills, NM, in Eddy County. On January 16, 2015, the spill site resulted from a slipped liner on a polish rod. The impacted area is within the location pad, with small impact area southwest of the location into the nearby pasture. A total of approximately 100 barrels of produced water and 20 barrels of oil were released with 85 barrels of produced water and 10 barrels of oil recovered. An initial C-141 was submitted to the NMOCD on January 19, 2015 and approved on January 20, 2015 (Appendix I).

2 SITE ACTIVITIES

On January 27, 2015, DFSI personnel were on site to obtain samples within the leak area (Appendix II). Ten samples were obtained and field sampled for chloride levels, as well as BTEX. The BTEX samples were performed using a Mini Rae Photoionization Detector (PID). All clean samples were submitted for laboratory analysis at Cardinal Laboratories of Hobbs, NM (Appendix III), resulting in concentrations that decreased with depth to below NMOCD and BLM regulatory standards.

A work plan was submitted to NMOCD and BLM on January 29, 2015. DFSI personnel were on site to scrape the impacted area on the pad 6" bgs (Appendix IV) and backfilled with clean, imported caliche. The release within the pasture was excavated to a depth of 1' bgs, with the exception of SP2, which was excavated to a depth of 2' bgs. The excavation was backfilled to ground surface with clean, imported soil and contoured to the surrounding area. Contaminated soil was properly disposed of at an NMOCD approved facility. The pasture was seeded with a LPC mix (Appendix V).

3 CONCLUSION

According to the New Mexico Office of the State Engineer, an updated study of the depth to groundwater in the area averages 300 ft. bgs. Based on the report and work completed, any remaining chloride and BTEX components in the vadose zone will not affect groundwater beneath this site, with vegetation expected to return to normal; therefore, DFSI, on behalf of Burnett, submits the final C-141 (Appendix VI) and respectfully requests the closure of this regulatory file.

Diversified Field Service, Inc.

Page 1

Appendix I

INITIAL C-141

Diversified Field Service, Inc.
206 W. Snyder
Hobbs, NM 88240
(575) 964-8394

District I
1625 N. French Dr., Hobbs, NM 88240
District II
811 S. First St., Artesia, NM 88210
District III
1000 Rio Brazos Road, Aztec, NM 87410
District IV
1220 S. St. Francis Dr., Santa Fe, NM 87505

State of New Mexico
Energy Minerals and Natural Resources
Oil Conservation Division
1220 South St. Francis Dr.
Santa Fe, NM 87505

Form C-141
Revised August 8, 2011

Submit 1 Copy to appropriate District Office in
accordance with 19.15.29 NMAC.

Release Notification and Corrective Action

NAB15020210861 OPERATOR ☒ Initial Report ☐ Final Report

Name of Company <u>Burnett Oil Co., Inc.</u> <u>3080</u>	Contact <u>Leslie Garvis</u>
Address <u>801 Cherry Street - Suite 1500, Ft. Worth, TX 76102</u>	Telephone No. <u>817-583-8730</u>
Facility Name <u>Gissler B 88</u>	Facility Type <u>Oil Well</u>

Surface Owner <u>BLM</u>	Mineral Owner <u>BLM</u>	API No. <u>30-015-40847</u>
--------------------------	--------------------------	-----------------------------

LOCATION OF RELEASE

Unit Letter	Section	Township	Range	Feet from the	North/South Line	Feet from the	East/West Line	County
I	11	17S	30E	1650	South	330	East	Eddy

Latitude 32.8463087 Longitude 103.9351954

NATURE OF RELEASE

Type of Release <u>Water/Oil</u>	Volume of Release <u>100/20</u>	Volume Recovered <u>85/10</u>
Source of Release <u>Pumping Unit</u>	Date and Hour of Occurrence <u>1/16/15</u>	Date and Hour of Discovery <u>1/16/15 1600</u>
Was Immediate Notice Given? <input checked="" type="checkbox"/> Yes <input type="checkbox"/> No <input type="checkbox"/> Not Required	If YES, To Whom? <u>BLM-Robertson / OCD-Patterson/ Email notification on 1/17/15</u>	
By Whom? <u>Johnny Titsworth - Burnett</u>	Date and Hour <u>1/16/15 approx 1615</u>	
Was a Watercourse Reached? <input type="checkbox"/> Yes <input checked="" type="checkbox"/> No	If YES, Volume Impacting the Watercourse. <u>N/A</u>	

If a Watercourse was Impacted, Describe Fully.*

N/A

NM OIL CONSERVATION
ARTESIA DISTRICT

JAN 19 2015

Describe Cause of Problem and Remedial Action Taken.*

Liner on polish rod slipped. Liner was reattached and bolts tightened.

RECEIVED

Describe Area Affected and Cleanup Action Taken.*

Majority of the release stayed on the location pad. Some flowed to the SW corner of the location and a nearby pasture. The pasture area affected was approximately 30'x50'. All standing fluid was vacuumed up. The pad and the pasture will be assessed and remediated according to BLM & NMOCD guidelines.

I hereby certify that the information given above is true and complete to the best of my knowledge and understand that pursuant to NMOCD rules and regulations all operators are required to report and/or file certain release notifications and perform corrective actions for releases which may endanger public health or the environment. The acceptance of a C-141 report by the NMOCD marked as "Final Report" does not relieve the operator of liability should their operations have failed to adequately investigate and remediate contamination that pose a threat to ground water, surface water, human health or the environment. In addition, NMOCD acceptance of a C-141 report does not relieve the operator of responsibility for compliance with any other federal, state, or local laws and/or regulations.

Signature: <u>Leslie Garvis</u>	OIL CONSERVATION DIVISION	
Printed Name: <u>Leslie Garvis</u>	Approved by Environmental Specialist: <u>Huber</u>	
Title: <u>Regulatory Coordinator</u>	Approval Date: <u>1/20/15</u>	Expiration Date: <u>NA</u>
E-mail Address: <u>lgarvis@burnettoil.com</u>	Conditions of Approval:	Attached <input type="checkbox"/>
Date: <u>1/19/16</u>	Phone: <u>817-332-5108</u>	

* Attach Additional Sheets If Necessary

2RP-2743

Appendix II

SOIL DELINEATION MAP

Diversified Field Service, Inc.
206 W. Snyder
Hobbs, NM 88240
(575) 964-8394

SP1									
Depth	CI-	PID	Lab CI-	GRO	DRO	B	T	E	X
SS	7497								
1'	224	2.3	80	<10	<10	<0.05	<0.05	<0.05	<0.15

SP2									
Depth	CI-	PID	Lab CI-	GRO	DRO	B	T	E	X
SS	3498								
1'	149	24.6	32	67.8	570	<0.05	<0.05	<0.05	<0.15

SP3									
Depth	CI-	PID	Lab CI-	GRO	DRO	B	T	E	X
SS	10746								
1'	249	24.6	64	<10	<10	<0.05	<0.05	<0.05	<0.15

SP4									
Depth	CI-	PID	Lab CI-	GRO	DRO	B	T	E	X
SS	2499								
1'	599	68	224	62.4	566	<0.05	<0.05	<0.05	<0.15

SP5									
Depth	CI-	PID	Lab CI-	GRO	DRO	B	T	E	X
SS	2749								
1'	249	7.3	48	<10	<10	<0.05	<0.05	<0.05	<0.15

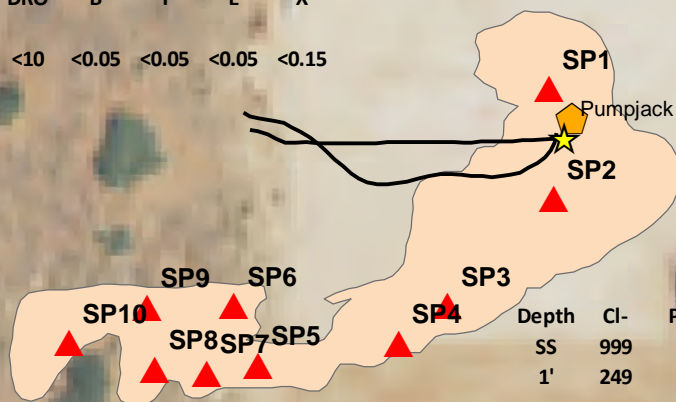

SP6									
Depth	CI-	PID	Lab CI-	GRO	DRO	B	T	E	X
SS	999								
1'	249	1	144	<10	<10	<0.05	<0.05	<0.05	<0.15

SP7									
Depth	CI-	PID	Lab CI-	GRO	DRO	B	T	E	X
SS	2499								
1'	249	3.1	<16	<10	<10	<0.05	<0.05	<0.05	<0.15

SP8									
Depth	CI-	PID	Lab CI-	GRO	DRO	B	T	E	X
SS	5198								
1'	249	4.9	32	<10	<10	<0.05	<0.05	<0.05	<0.15

SP9									
Depth	CI-	PID	Lab CI-	GRO	DRO	B	T	E	X
SS	2499								
1'	2799								
2'	249	9	<16	<10	<10	<0.05	<0.05	<0.05	<0.15

SP10									
Depth	CI-	PID	Lab CI-	GRO	DRO	B	T	E	X
SS	1724								
1'	524	22.2	224	<10	<10	<0.05	<0.05	<0.05	<0.15

Legend

- Source
- Pumpjack
- Sample Points
- Above Ground Line
- Oil and Produced Water (23,741 sq ft)



Burnett
Gissler B 88
Unit Letter I, Sec. 11, T17S, R30E
Eddy County, NM
API #: 30-015-40847
NMOCD Case: 2R-2743

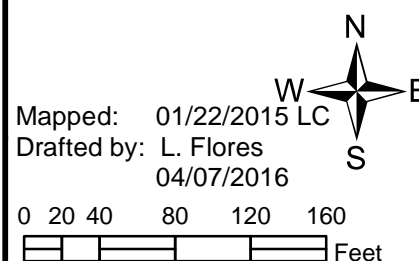

Appendix III

LABORATORY ANALYSIS

Diversified Field Service, Inc.
206 W. Snyder
Hobbs, NM 88240
(575) 964-8394



PHONE (575) 393-2326 ° 101 E. MARLAND ° HOBBS, NM 88240

January 29, 2015

JOHNNY TITSWORTH

Burnett Oil Co., Inc

801 Cherry St. - Suite 1500

Fort Worth, TX 76102-6881

RE: GISSLER B #88

Enclosed are the results of analyses for samples received by the laboratory on 01/27/15 13:35.

Cardinal Laboratories is accredited through Texas NELAP under certificate number T104704398-13-5. Accreditation applies to drinking water, non-potable water and solid and chemical materials. All accredited analytes are denoted by an asterisk (*). For a complete list of accredited analytes and matrices visit the TCEQ website at www.tceq.texas.gov/field/qa/lab_accred_certif.html.

Cardinal Laboratories is accredited through the State of Colorado Department of Public Health and Environment for:

Method EPA 552.2	Haloacetic Acids (HAA-5)
Method EPA 524.2	Total Trihalomethanes (TTHM)
Method EPA 524.4	Regulated VOCs (V1, V2, V3)

Accreditation applies to public drinking water matrices.

This report meets NELAP requirements and is made up of a cover page, analytical results, and a copy of the original chain-of-custody. If you have any questions concerning this report, please feel free to contact me.

Sincerely,

A handwritten signature in black ink that reads "Celey D. Keene". The signature is written in a cursive, flowing style.

Celey D. Keene

Lab Director/Quality Manager



PHONE (575) 393-2326 ° 101 E. MARLAND ° HOBBS, NM 88240

Analytical Results For:

Burnett Oil Co., Inc
 JOHNNY TITSWORTH
 801 Cherry St. - Suite 1500
 Fort Worth TX, 76102-6881
 Fax To: None

Received: 01/27/2015
 Reported: 01/29/2015
 Project Name: GISSLER B #88
 Project Number: NONE GIVEN
 Project Location: NOT GIVEN

Sampling Date: 01/27/2015
 Sampling Type: Soil
 Sampling Condition: Cool & Intact
 Sample Received By: Jodi Henson

Sample ID: SP. 1 @ 1' (H500251-01)

BTX 8021B		mg/kg		Analyzed By: ms					
Analyte	Result	Reporting Limit	Analyzed	Method Blank	BS	% Recovery	True Value QC	RPD	Qualifier
Benzene*	<0.050	0.050	01/28/2015	ND	1.67	83.4	2.00	9.24	
Toluene*	<0.050	0.050	01/28/2015	ND	1.63	81.4	2.00	8.09	
Ethylbenzene*	<0.050	0.050	01/28/2015	ND	1.55	77.4	2.00	9.75	
Total Xylenes*	<0.150	0.150	01/28/2015	ND	4.67	77.8	6.00	9.79	
Total BTX	<0.300	0.300	01/28/2015	ND					

Surrogate: 4-Bromofluorobenzene (PID) 101 % 61-154

Chloride, SM4500Cl-B		mg/kg		Analyzed By: AP						
Analyte	Result	Reporting Limit	Analyzed	Method Blank	BS	% Recovery	True Value QC	RPD	Qualifier	
Chloride	80.0	16.0	01/28/2015	ND	432	108	400	3.77		

TPH 8015M		mg/kg		Analyzed By: MS					
Analyte	Result	Reporting Limit	Analyzed	Method Blank	BS	% Recovery	True Value QC	RPD	Qualifier
GRO C6-C10	<10.0	10.0	01/27/2015	ND	190	95.1	200	3.71	
DRO >C10-C28	<10.0	10.0	01/27/2015	ND	190	95.1	200	5.24	

Surrogate: 1-Chlorooctane 96.3 % 47.2-157

Surrogate: 1-Chlorooctadecane 112 % 52.1-176

Cardinal Laboratories

*=Accredited Analyte

PLEASE NOTE: Liability and Damages. Cardinal's liability and client's exclusive remedy for any claim arising, whether based in contract or tort, shall be limited to the amount paid by client for analyses. All claims, including those for negligence and any other cause whatsoever shall be deemed waived unless made in writing and received by Cardinal within thirty (30) days after completion of the applicable service. In no event shall Cardinal be liable for incidental or consequential damages, including, without limitation, business interruptions, loss of use, or loss of profits incurred by client, its subsidiaries, affiliates or successors arising out of or related to the performance of the services hereunder by Cardinal, regardless of whether such claim is based upon any of the above stated reasons or otherwise. Results relate only to the samples identified above. This report shall not be reproduced except in full with written approval of Cardinal Laboratories.

Celey D. Keene, Lab Director/Quality Manager



PHONE (575) 393-2326 ° 101 E. MARLAND ° HOBBS, NM 88240

Analytical Results For:

Burnett Oil Co., Inc
 JOHNNY TITSWORTH
 801 Cherry St. - Suite 1500
 Fort Worth TX, 76102-6881
 Fax To: None

Received: 01/27/2015
 Reported: 01/29/2015
 Project Name: GISSLER B #88
 Project Number: NONE GIVEN
 Project Location: NOT GIVEN

Sampling Date: 01/27/2015
 Sampling Type: Soil
 Sampling Condition: Cool & Intact
 Sample Received By: Jodi Henson

Sample ID: SP. 2 @ 1' (H500251-02)

BTX 8021B		mg/kg		Analyzed By: ms					
Analyte	Result	Reporting Limit	Analyzed	Method Blank	BS	% Recovery	True Value QC	RPD	Qualifier
Benzene*	<0.050	0.050	01/28/2015	ND	1.67	83.4	2.00	9.24	
Toluene*	<0.050	0.050	01/28/2015	ND	1.63	81.4	2.00	8.09	
Ethylbenzene*	<0.050	0.050	01/28/2015	ND	1.55	77.4	2.00	9.75	
Total Xylenes*	<0.150	0.150	01/28/2015	ND	4.67	77.8	6.00	9.79	
Total BTX	<0.300	0.300	01/28/2015	ND					

Surrogate: 4-Bromofluorobenzene (PID) 100 % 61-154

Chloride, SM4500CI-B		mg/kg		Analyzed By: AP					
Analyte	Result	Reporting Limit	Analyzed	Method Blank	BS	% Recovery	True Value QC	RPD	Qualifier
Chloride	32.0	16.0	01/28/2015	ND	432	108	400	3.77	

TPH 8015M		mg/kg		Analyzed By: MS					
Analyte	Result	Reporting Limit	Analyzed	Method Blank	BS	% Recovery	True Value QC	RPD	Qualifier
GRO C6-C10	67.8	50.0	01/27/2015	ND	190	95.1	200	3.71	
DRO >C10-C28	570	50.0	01/27/2015	ND	190	95.1	200	5.24	

Surrogate: 1-Chlorooctane 96.4 % 47.2-157

Surrogate: 1-Chlorooctadecane 139 % 52.1-176

Cardinal Laboratories

*=Accredited Analyte

PLEASE NOTE: Liability and Damages. Cardinal's liability and client's exclusive remedy for any claim arising, whether based in contract or tort, shall be limited to the amount paid by client for analyses. All claims, including those for negligence and any other cause whatsoever shall be deemed waived unless made in writing and received by Cardinal within thirty (30) days after completion of the applicable service. In no event shall Cardinal be liable for incidental or consequential damages, including, without limitation, business interruptions, loss of use, or loss of profits incurred by client, its subsidiaries, affiliates or successors arising out of or related to the performance of the services hereunder by Cardinal, regardless of whether such claim is based upon any of the above stated reasons or otherwise. Results relate only to the samples identified above. This report shall not be reproduced except in full with written approval of Cardinal Laboratories.

Celey D. Keene, Lab Director/Quality Manager



PHONE (575) 393-2326 ° 101 E. MARLAND ° HOBBS, NM 88240

Analytical Results For:

Burnett Oil Co., Inc
 JOHNNY TITSWORTH
 801 Cherry St. - Suite 1500
 Fort Worth TX, 76102-6881
 Fax To: None

Received: 01/27/2015
 Reported: 01/29/2015
 Project Name: GISSLER B #88
 Project Number: NONE GIVEN
 Project Location: NOT GIVEN

Sampling Date: 01/27/2015
 Sampling Type: Soil
 Sampling Condition: Cool & Intact
 Sample Received By: Jodi Henson

Sample ID: SP. 3 @ 1' (H500251-03)

BTX 8021B		mg/kg		Analyzed By: ms						
Analyte	Result	Reporting Limit	Analyzed	Method Blank	BS	% Recovery	True Value QC	RPD	Qualifier	
Benzene*	<0.050	0.050	01/28/2015	ND	1.67	83.4	2.00	9.24		
Toluene*	<0.050	0.050	01/28/2015	ND	1.63	81.4	2.00	8.09		
Ethylbenzene*	<0.050	0.050	01/28/2015	ND	1.55	77.4	2.00	9.75		
Total Xylenes*	<0.150	0.150	01/28/2015	ND	4.67	77.8	6.00	9.79		
Total BTX	<0.300	0.300	01/28/2015	ND						

Surrogate: 4-Bromofluorobenzene (PID) 102 % 61-154

Chloride, SM4500Cl-B		mg/kg		Analyzed By: AP					
Analyte	Result	Reporting Limit	Analyzed	Method Blank	BS	% Recovery	True Value QC	RPD	Qualifier
Chloride	64.0	16.0	01/28/2015	ND	432	108	400	3.77	

TPH 8015M		mg/kg		Analyzed By: MS					
Analyte	Result	Reporting Limit	Analyzed	Method Blank	BS	% Recovery	True Value QC	RPD	Qualifier
GRO C6-C10	<10.0	10.0	01/27/2015	ND	190	95.1	200	3.71	
DRO >C10-C28	<10.0	10.0	01/27/2015	ND	190	95.1	200	5.24	

Surrogate: 1-Chlorooctane 97.5 % 47.2-157

Surrogate: 1-Chlorooctadecane 110 % 52.1-176

Cardinal Laboratories

*=Accredited Analyte

PLEASE NOTE: Liability and Damages. Cardinal's liability and client's exclusive remedy for any claim arising, whether based in contract or tort, shall be limited to the amount paid by client for analyses. All claims, including those for negligence and any other cause whatsoever shall be deemed waived unless made in writing and received by Cardinal within thirty (30) days after completion of the applicable service. In no event shall Cardinal be liable for incidental or consequential damages, including, without limitation, business interruptions, loss of use, or loss of profits incurred by client, its subsidiaries, affiliates or successors arising out of or related to the performance of the services hereunder by Cardinal, regardless of whether such claim is based upon any of the above stated reasons or otherwise. Results relate only to the samples identified above. This report shall not be reproduced except in full with written approval of Cardinal Laboratories.

Celey D. Keene, Lab Director/Quality Manager



PHONE (575) 393-2326 • 101 E. MARLAND • HOBBS, NM 88240

Analytical Results For:

Burnett Oil Co., Inc
 JOHNNY TITSWORTH
 801 Cherry St. - Suite 1500
 Fort Worth TX, 76102-6881
 Fax To: None

Received: 01/27/2015
 Reported: 01/29/2015
 Project Name: GISSLER B #88
 Project Number: NONE GIVEN
 Project Location: NOT GIVEN

Sampling Date: 01/27/2015
 Sampling Type: Soil
 Sampling Condition: Cool & Intact
 Sample Received By: Jodi Henson

Sample ID: SP. 4 @ 1' (H500251-04)

BTX 8021B		mg/kg		Analyzed By: ms						
Analyte	Result	Reporting Limit	Analyzed	Method Blank	BS	% Recovery	True Value QC	RPD	Qualifier	
Benzene*	<0.050	0.050	01/28/2015	ND	1.67	83.4	2.00	9.24		
Toluene*	<0.050	0.050	01/28/2015	ND	1.63	81.4	2.00	8.09		
Ethylbenzene*	<0.050	0.050	01/28/2015	ND	1.55	77.4	2.00	9.75		
Total Xylenes*	<0.150	0.150	01/28/2015	ND	4.67	77.8	6.00	9.79		
Total BTX	<0.300	0.300	01/28/2015	ND						

Surrogate: 4-Bromofluorobenzene (PID) 104 % 61-154

Chloride, SM4500Cl-B		mg/kg		Analyzed By: AP					
Analyte	Result	Reporting Limit	Analyzed	Method Blank	BS	% Recovery	True Value QC	RPD	Qualifier
Chloride	224	16.0	01/28/2015	ND	432	108	400	3.77	

TPH 8015M		mg/kg		Analyzed By: MS					
Analyte	Result	Reporting Limit	Analyzed	Method Blank	BS	% Recovery	True Value QC	RPD	Qualifier
GRO C6-C10	62.4	50.0	01/27/2015	ND	190	95.1	200	3.71	
DRO >C10-C28	566	50.0	01/27/2015	ND	190	95.1	200	5.24	

Surrogate: 1-Chlorooctane 106 % 47.2-157

Surrogate: 1-Chlorooctadecane 126 % 52.1-176

Cardinal Laboratories

*=Accredited Analyte

PLEASE NOTE: Liability and Damages. Cardinal's liability and client's exclusive remedy for any claim arising, whether based in contract or tort, shall be limited to the amount paid by client for analyses. All claims, including those for negligence and any other cause whatsoever shall be deemed waived unless made in writing and received by Cardinal within thirty (30) days after completion of the applicable service. In no event shall Cardinal be liable for incidental or consequential damages, including, without limitation, business interruptions, loss of use, or loss of profits incurred by client, its subsidiaries, affiliates or successors arising out of or related to the performance of the services hereunder by Cardinal, regardless of whether such claim is based upon any of the above stated reasons or otherwise. Results relate only to the samples identified above. This report shall not be reproduced except in full with written approval of Cardinal Laboratories.

Celey D. Keene, Lab Director/Quality Manager



PHONE (575) 393-2326 ° 101 E. MARLAND ° HOBBS, NM 88240

Analytical Results For:

Burnett Oil Co., Inc
 JOHNNY TITSWORTH
 801 Cherry St. - Suite 1500
 Fort Worth TX, 76102-6881
 Fax To: None

Received: 01/27/2015
 Reported: 01/29/2015
 Project Name: GISSLER B #88
 Project Number: NONE GIVEN
 Project Location: NOT GIVEN

Sampling Date: 01/27/2015
 Sampling Type: Soil
 Sampling Condition: Cool & Intact
 Sample Received By: Jodi Henson

Sample ID: SP. 5 @ 1' (H500251-05)

BTEx 8021B		mg/kg		Analyzed By: ms					
Analyte	Result	Reporting Limit	Analyzed	Method Blank	BS	% Recovery	True Value QC	RPD	Qualifier
Benzene*	<0.050	0.050	01/28/2015	ND	1.67	83.4	2.00	9.24	
Toluene*	<0.050	0.050	01/28/2015	ND	1.63	81.4	2.00	8.09	
Ethylbenzene*	<0.050	0.050	01/28/2015	ND	1.55	77.4	2.00	9.75	
Total Xylenes*	<0.150	0.150	01/28/2015	ND	4.67	77.8	6.00	9.79	
Total BTEx	<0.300	0.300	01/28/2015	ND					

Surrogate: 4-Bromofluorobenzene (PID) 101 % 61-154

Chloride, SM4500Cl-B		mg/kg		Analyzed By: AP					
Analyte	Result	Reporting Limit	Analyzed	Method Blank	BS	% Recovery	True Value QC	RPD	Qualifier
Chloride	48.0	16.0	01/28/2015	ND	432	108	400	3.77	

TPH 8015M		mg/kg		Analyzed By: MS					
Analyte	Result	Reporting Limit	Analyzed	Method Blank	BS	% Recovery	True Value QC	RPD	Qualifier
GRO C6-C10	<10.0	10.0	01/27/2015	ND	190	95.1	200	3.71	
DRO >C10-C28	<10.0	10.0	01/27/2015	ND	190	95.1	200	5.24	

Surrogate: 1-Chlorooctane 102 % 47.2-157

Surrogate: 1-Chlorooctadecane 117 % 52.1-176

Cardinal Laboratories

*=Accredited Analyte

PLEASE NOTE: Liability and Damages. Cardinal's liability and client's exclusive remedy for any claim arising, whether based in contract or tort, shall be limited to the amount paid by client for analyses. All claims, including those for negligence and any other cause whatsoever shall be deemed waived unless made in writing and received by Cardinal within thirty (30) days after completion of the applicable service. In no event shall Cardinal be liable for incidental or consequential damages, including, without limitation, business interruptions, loss of use, or loss of profits incurred by client, its subsidiaries, affiliates or successors arising out of or related to the performance of the services hereunder by Cardinal, regardless of whether such claim is based upon any of the above stated reasons or otherwise. Results relate only to the samples identified above. This report shall not be reproduced except in full with written approval of Cardinal Laboratories.

Celey D. Keene, Lab Director/Quality Manager



PHONE (575) 393-2326 ° 101 E. MARLAND ° HOBBS, NM 88240

Analytical Results For:

Burnett Oil Co., Inc
 JOHNNY TITSWORTH
 801 Cherry St. - Suite 1500
 Fort Worth TX, 76102-6881
 Fax To: None

Received: 01/27/2015
 Reported: 01/29/2015
 Project Name: GISSLER B #88
 Project Number: NONE GIVEN
 Project Location: NOT GIVEN

Sampling Date: 01/27/2015
 Sampling Type: Soil
 Sampling Condition: Cool & Intact
 Sample Received By: Jodi Henson

Sample ID: SP. 6 @ 1' (H500251-06)

BTEx 8021B		mg/kg		Analyzed By: ms						
Analyte	Result	Reporting Limit	Analyzed	Method Blank	BS	% Recovery	True Value QC	RPD	Qualifier	
Benzene*	<0.050	0.050	01/28/2015	ND	1.67	83.4	2.00	9.24		
Toluene*	<0.050	0.050	01/28/2015	ND	1.63	81.4	2.00	8.09		
Ethylbenzene*	<0.050	0.050	01/28/2015	ND	1.55	77.4	2.00	9.75		
Total Xylenes*	<0.150	0.150	01/28/2015	ND	4.67	77.8	6.00	9.79		
Total BTEx	<0.300	0.300	01/28/2015	ND						

Surrogate: 4-Bromofluorobenzene (PID) 101 % 61-154

Chloride, SM4500CI-B		mg/kg		Analyzed By: AP						
Analyte	Result	Reporting Limit	Analyzed	Method Blank	BS	% Recovery	True Value QC	RPD	Qualifier	
Chloride	144	16.0	01/28/2015	ND	432	108	400	3.77		

TPH 8015M		mg/kg		Analyzed By: MS					
Analyte	Result	Reporting Limit	Analyzed	Method Blank	BS	% Recovery	True Value QC	RPD	Qualifier
GRO C6-C10	<10.0	10.0	01/27/2015	ND	190	95.1	200	3.71	
DRO >C10-C28	<10.0	10.0	01/27/2015	ND	190	95.1	200	5.24	

Surrogate: 1-Chlorooctane 98.1 % 47.2-157

Surrogate: 1-Chlorooctadecane 115 % 52.1-176

Cardinal Laboratories

*=Accredited Analyte

PLEASE NOTE: Liability and Damages. Cardinal's liability and client's exclusive remedy for any claim arising, whether based in contract or tort, shall be limited to the amount paid by client for analyses. All claims, including those for negligence and any other cause whatsoever shall be deemed waived unless made in writing and received by Cardinal within thirty (30) days after completion of the applicable service. In no event shall Cardinal be liable for incidental or consequential damages, including, without limitation, business interruptions, loss of use, or loss of profits incurred by client, its subsidiaries, affiliates or successors arising out of or related to the performance of the services hereunder by Cardinal, regardless of whether such claim is based upon any of the above stated reasons or otherwise. Results relate only to the samples identified above. This report shall not be reproduced except in full with written approval of Cardinal Laboratories.

Celey D. Keene, Lab Director/Quality Manager



PHONE (575) 393-2326 ° 101 E. MARLAND ° HOBBS, NM 88240

Analytical Results For:

Burnett Oil Co., Inc
JOHNNY TITSWORTH
801 Cherry St. - Suite 1500
Fort Worth TX, 76102-6881
Fax To: None

Received: 01/27/2015
Reported: 01/29/2015
Project Name: GISSLER B #88
Project Number: NONE GIVEN
Project Location: NOT GIVEN

Sampling Date: 01/27/2015
Sampling Type: Soil
Sampling Condition: Cool & Intact
Sample Received By: Jodi Henson

Sample ID: SP. 7 @ 1' (H500251-07)

BTEx 8021B		mg/kg		Analyzed By: ms						
Analyte	Result	Reporting Limit	Analyzed	Method Blank	BS	% Recovery	True Value QC	RPD	Qualifier	
Benzene*	<0.050	0.050	01/28/2015	ND	1.67	83.4	2.00	9.24		
Toluene*	<0.050	0.050	01/28/2015	ND	1.63	81.4	2.00	8.09		
Ethylbenzene*	<0.050	0.050	01/28/2015	ND	1.55	77.4	2.00	9.75		
Total Xylenes*	<0.150	0.150	01/28/2015	ND	4.67	77.8	6.00	9.79		
Total BTEx	<0.300	0.300	01/28/2015	ND						

Surrogate: 4-Bromofluorobenzene (PID) 99.6 % 61-154

Chloride, SM4500CI-B		mg/kg		Analyzed By: AP						
Analyte	Result	Reporting Limit	Analyzed	Method Blank	BS	% Recovery	True Value QC	RPD	Qualifier	
Chloride	<16.0	16.0	01/28/2015	ND	432	108	400	3.77		

TPH 8015M		mg/kg		Analyzed By: MS					
Analyte	Result	Reporting Limit	Analyzed	Method Blank	BS	% Recovery	True Value QC	RPD	Qualifier
GRO C6-C10	<10.0	10.0	01/27/2015	ND	190	95.1	200	3.71	
DRO >C10-C28	<10.0	10.0	01/27/2015	ND	190	95.1	200	5.24	

Surrogate: 1-Chlorooctane 98.0 % 47.2-157

Surrogate: 1-Chlorooctadecane 112 % 52.1-176

Cardinal Laboratories

*=Accredited Analyte

PLEASE NOTE: Liability and Damages. Cardinal's liability and client's exclusive remedy for any claim arising, whether based in contract or tort, shall be limited to the amount paid by client for analyses. All claims, including those for negligence and any other cause whatsoever shall be deemed waived unless made in writing and received by Cardinal within thirty (30) days after completion of the applicable service. In no event shall Cardinal be liable for incidental or consequential damages, including, without limitation, business interruptions, loss of use, or loss of profits incurred by client, its subsidiaries, affiliates or successors arising out of or related to the performance of the services hereunder by Cardinal, regardless of whether such claim is based upon any of the above stated reasons or otherwise. Results relate only to the samples identified above. This report shall not be reproduced except in full with written approval of Cardinal Laboratories.

Celey D. Keene, Lab Director/Quality Manager



PHONE (575) 393-2326 ° 101 E. MARLAND ° HOBBS, NM 88240

Analytical Results For:

Burnett Oil Co., Inc
 JOHNNY TITSWORTH
 801 Cherry St. - Suite 1500
 Fort Worth TX, 76102-6881
 Fax To: None

Received: 01/27/2015
 Reported: 01/29/2015
 Project Name: GISSLER B #88
 Project Number: NONE GIVEN
 Project Location: NOT GIVEN

Sampling Date: 01/27/2015
 Sampling Type: Soil
 Sampling Condition: Cool & Intact
 Sample Received By: Jodi Henson

Sample ID: SP. 8 @ 1' (H500251-08)

BTEx 8021B		mg/kg		Analyzed By: ms						
Analyte	Result	Reporting Limit	Analyzed	Method Blank	BS	% Recovery	True Value QC	RPD	Qualifier	
Benzene*	<0.050	0.050	01/28/2015	ND	1.67	83.4	2.00	9.24		
Toluene*	<0.050	0.050	01/28/2015	ND	1.63	81.4	2.00	8.09		
Ethylbenzene*	<0.050	0.050	01/28/2015	ND	1.55	77.4	2.00	9.75		
Total Xylenes*	<0.150	0.150	01/28/2015	ND	4.67	77.8	6.00	9.79		
Total BTEx	<0.300	0.300	01/28/2015	ND						

Surrogate: 4-Bromofluorobenzene (PID) 102 % 61-154

Chloride, SM4500Cl-B		mg/kg		Analyzed By: AP						
Analyte	Result	Reporting Limit	Analyzed	Method Blank	BS	% Recovery	True Value QC	RPD	Qualifier	
Chloride	32.0	16.0	01/28/2015	ND	432	108	400	3.77		

TPH 8015M		mg/kg		Analyzed By: MS					
Analyte	Result	Reporting Limit	Analyzed	Method Blank	BS	% Recovery	True Value QC	RPD	Qualifier
GRO C6-C10	<10.0	10.0	01/27/2015	ND	190	95.1	200	3.71	
DRO >C10-C28	<10.0	10.0	01/27/2015	ND	190	95.1	200	5.24	

Surrogate: 1-Chlorooctane 97.5 % 47.2-157

Surrogate: 1-Chlorooctadecane 110 % 52.1-176

Cardinal Laboratories

*=Accredited Analyte

PLEASE NOTE: Liability and Damages. Cardinal's liability and client's exclusive remedy for any claim arising, whether based in contract or tort, shall be limited to the amount paid by client for analyses. All claims, including those for negligence and any other cause whatsoever shall be deemed waived unless made in writing and received by Cardinal within thirty (30) days after completion of the applicable service. In no event shall Cardinal be liable for incidental or consequential damages, including, without limitation, business interruptions, loss of use, or loss of profits incurred by client, its subsidiaries, affiliates or successors arising out of or related to the performance of the services hereunder by Cardinal, regardless of whether such claim is based upon any of the above stated reasons or otherwise. Results relate only to the samples identified above. This report shall not be reproduced except in full with written approval of Cardinal Laboratories.

Celey D. Keene, Lab Director/Quality Manager



PHONE (575) 393-2326 ° 101 E. MARLAND ° HOBBS, NM 88240

Analytical Results For:

Burnett Oil Co., Inc
 JOHNNY TITSWORTH
 801 Cherry St. - Suite 1500
 Fort Worth TX, 76102-6881
 Fax To: None

Received: 01/27/2015
 Reported: 01/29/2015
 Project Name: GISSLER B #88
 Project Number: NONE GIVEN
 Project Location: NOT GIVEN

Sampling Date: 01/27/2015
 Sampling Type: Soil
 Sampling Condition: Cool & Intact
 Sample Received By: Jodi Henson

Sample ID: SP. 9 @ 2' (H500251-09)

BTX 8021B		mg/kg		Analyzed By: ms						
Analyte	Result	Reporting Limit	Analyzed	Method Blank	BS	% Recovery	True Value QC	RPD	Qualifier	
Benzene*	<0.050	0.050	01/28/2015	ND	1.67	83.4	2.00	9.24		
Toluene*	<0.050	0.050	01/28/2015	ND	1.63	81.4	2.00	8.09		
Ethylbenzene*	<0.050	0.050	01/28/2015	ND	1.55	77.4	2.00	9.75		
Total Xylenes*	<0.150	0.150	01/28/2015	ND	4.67	77.8	6.00	9.79		
Total BTX	<0.300	0.300	01/28/2015	ND						

Surrogate: 4-Bromofluorobenzene (PID) 101 % 61-154

Chloride, SM4500Cl-B		mg/kg		Analyzed By: AP						
Analyte	Result	Reporting Limit	Analyzed	Method Blank	BS	% Recovery	True Value QC	RPD	Qualifier	
Chloride	<16.0	16.0	01/28/2015	ND	432	108	400	3.77		

TPH 8015M		mg/kg		Analyzed By: MS					
Analyte	Result	Reporting Limit	Analyzed	Method Blank	BS	% Recovery	True Value QC	RPD	Qualifier
GRO C6-C10	<10.0	10.0	01/27/2015	ND	190	95.1	200	3.71	
DRO >C10-C28	<10.0	10.0	01/27/2015	ND	190	95.1	200	5.24	

Surrogate: 1-Chlorooctane 100 % 47.2-157

Surrogate: 1-Chlorooctadecane 112 % 52.1-176

Cardinal Laboratories

*=Accredited Analyte

PLEASE NOTE: Liability and Damages. Cardinal's liability and client's exclusive remedy for any claim arising, whether based in contract or tort, shall be limited to the amount paid by client for analyses. All claims, including those for negligence and any other cause whatsoever shall be deemed waived unless made in writing and received by Cardinal within thirty (30) days after completion of the applicable service. In no event shall Cardinal be liable for incidental or consequential damages, including, without limitation, business interruptions, loss of use, or loss of profits incurred by client, its subsidiaries, affiliates or successors arising out of or related to the performance of the services hereunder by Cardinal, regardless of whether such claim is based upon any of the above stated reasons or otherwise. Results relate only to the samples identified above. This report shall not be reproduced except in full with written approval of Cardinal Laboratories.

Celey D. Keene, Lab Director/Quality Manager



PHONE (575) 393-2326 ° 101 E. MARLAND ° HOBBS, NM 88240

Analytical Results For:

Burnett Oil Co., Inc
 JOHNNY TITSWORTH
 801 Cherry St. - Suite 1500
 Fort Worth TX, 76102-6881
 Fax To: None

Received: 01/27/2015
 Reported: 01/29/2015
 Project Name: GISSLER B #88
 Project Number: NONE GIVEN
 Project Location: NOT GIVEN

Sampling Date: 01/27/2015
 Sampling Type: Soil
 Sampling Condition: Cool & Intact
 Sample Received By: Jodi Henson

Sample ID: SP. 10 @ 1' (H500251-10)

BTX 8021B		mg/kg		Analyzed By: ms					
Analyte	Result	Reporting Limit	Analyzed	Method Blank	BS	% Recovery	True Value QC	RPD	Qualifier
Benzene*	<0.050	0.050	01/28/2015	ND	1.67	83.4	2.00	9.24	
Toluene*	<0.050	0.050	01/28/2015	ND	1.63	81.4	2.00	8.09	
Ethylbenzene*	<0.050	0.050	01/28/2015	ND	1.55	77.4	2.00	9.75	
Total Xylenes*	<0.150	0.150	01/28/2015	ND	4.67	77.8	6.00	9.79	
Total BTX	<0.300	0.300	01/28/2015	ND					

Surrogate: 4-Bromofluorobenzene (PID) 102 % 61-154

Chloride, SM4500CI-B		mg/kg		Analyzed By: AP					
Analyte	Result	Reporting Limit	Analyzed	Method Blank	BS	% Recovery	True Value QC	RPD	Qualifier
Chloride	224	16.0	01/28/2015	ND	432	108	400	3.77	

TPH 8015M		mg/kg		Analyzed By: MS					
Analyte	Result	Reporting Limit	Analyzed	Method Blank	BS	% Recovery	True Value QC	RPD	Qualifier
GRO C6-C10	<10.0	10.0	01/27/2015	ND	190	95.1	200	3.71	
DRO >C10-C28	<10.0	10.0	01/27/2015	ND	190	95.1	200	5.24	

Surrogate: 1-Chlorooctane 103 % 47.2-157

Surrogate: 1-Chlorooctadecane 115 % 52.1-176

Cardinal Laboratories

*=Accredited Analyte

PLEASE NOTE: Liability and Damages. Cardinal's liability and client's exclusive remedy for any claim arising, whether based in contract or tort, shall be limited to the amount paid by client for analyses. All claims, including those for negligence and any other cause whatsoever shall be deemed waived unless made in writing and received by Cardinal within thirty (30) days after completion of the applicable service. In no event shall Cardinal be liable for incidental or consequential damages, including, without limitation, business interruptions, loss of use, or loss of profits incurred by client, its subsidiaries, affiliates or successors arising out of or related to the performance of the services hereunder by Cardinal, regardless of whether such claim is based upon any of the above stated reasons or otherwise. Results relate only to the samples identified above. This report shall not be reproduced except in full with written approval of Cardinal Laboratories.

Celey D. Keene, Lab Director/Quality Manager



PHONE (575) 393-2326 ° 101 E. MARLAND ° HOBBS, NM 88240

Notes and Definitions

ND	Analyte NOT DETECTED at or above the reporting limit
RPD	Relative Percent Difference
**	Samples not received at proper temperature of 6°C or below.
***	Insufficient time to reach temperature.
-	Chloride by SM4500Cl-B does not require samples be received at or below 6°C Samples reported on an as received basis (wet) unless otherwise noted on report

Cardinal Laboratories

*=Accredited Analyte

PLEASE NOTE: Liability and Damages. Cardinal's liability and client's exclusive remedy for any claim arising, whether based in contract or tort, shall be limited to the amount paid by client for analyses. All claims, including those for negligence and any other cause whatsoever shall be deemed waived unless made in writing and received by Cardinal within thirty (30) days after completion of the applicable service. In no event shall Cardinal be liable for incidental or consequential damages, including, without limitation, business interruptions, loss of use, or loss of profits incurred by client, its subsidiaries, affiliates or successors arising out of or related to the performance of the services hereunder by Cardinal, regardless of whether such claim is based upon any of the above stated reasons or otherwise. Results relate only to the samples identified above. This report shall not be reproduced except in full with written approval of Cardinal Laboratories.

A handwritten signature in black ink, appearing to read "Celey D. Keene".

Celey D. Keene, Lab Director/Quality Manager



CHAIN-OF-CUSTODY AND ANALYSIS REQUEST

101 East Marland, Hobbs, NM 88240
(575) 393-2326 FAX (575) 393-2476

Company Name: <u>Burnett</u>		BILL TO		ANALYSIS REQUEST																				
Project Manager: <u>Mike Burton</u>		P.O. #:																						
Address:		Company: <u>Burnett</u>																						
City: State: Zip:		Attn: <u>John Titzworth</u>																						
Phone #: Fax #:		Address:																						
Project #: Project Owner:		City:																						
Project Name: <u>Gissler B88</u>		State: Zip:																						
Project Location:		Phone #:																						
Sampler Name:		Fax #:																						
FOR LAB USE ONLY				MATRIX		PRESERV		SAMPLING																
Lab I.D.	Sample I.D.	(G/RABOR C) OMP	# CONTAINERS	GROUNDWATER	WASTEWATER	SOIL	OIL	SLUDGE	OTHER	ACID/BASE	ICE / COOL	OTHER	DATE	TIME										
<u>H500251</u>																								
1	<u>SP1E1</u>	<u>G</u>	<u>1</u>			<u>X</u>				<u>X</u>			<u>1-27-15</u>	<u>10:02</u>	<div style="position: relative; width: 100%; height: 100%;"> X </div>									
2	<u>SP2E1</u>	<u>G</u>	<u>1</u>			<u>X</u>				<u>X</u>			<u>1-27-15</u>	<u>10:09</u>										
3	<u>SP3E1</u>	<u>G</u>	<u>1</u>			<u>X</u>				<u>X</u>			<u>1-27-15</u>	<u>10:13</u>										
4	<u>SP4E1</u>	<u>G</u>	<u>1</u>			<u>X</u>				<u>X</u>			<u>1-27-15</u>	<u>10:16</u>										
5	<u>SP5E1</u>	<u>G</u>	<u>1</u>			<u>X</u>				<u>X</u>			<u>1-27-15</u>	<u>10:18</u>										
6	<u>SP6E1</u>	<u>G</u>	<u>1</u>			<u>X</u>				<u>X</u>			<u>1-27-15</u>	<u>10:32</u>										
7	<u>SP7E1</u>	<u>G</u>	<u>1</u>			<u>X</u>				<u>X</u>			<u>1-27-15</u>	<u>11:03</u>										
8	<u>SP8E1</u>	<u>G</u>	<u>1</u>			<u>X</u>				<u>X</u>			<u>1-27-15</u>	<u>11:17</u>										
9	<u>SP9E2</u>	<u>G</u>	<u>1</u>			<u>X</u>				<u>X</u>			<u>1-27-15</u>	<u>11:31</u>										
10	<u>SP10E1</u>	<u>G</u>	<u>1</u>			<u>X</u>				<u>X</u>			<u>1-27-15</u>	<u>11:40</u>										

PLEASE NOTE: Liability and Damages: Cardinal's liability and client's exclusive remedy for any claim arising whether based in contract or tort, shall be limited to the amount paid by the client for the analyses. All claims including those for negligence and any other cause whatsoever shall be deemed waived unless made in writing and received by Cardinal within 30 days after completion of the applicable service. In no event shall Cardinal be liable for incidental or consequential damages, including without limitation, business interruptions, loss of use, or loss of profits incurred by client, its subsidiaries, affiliates or successors arising out of or related to the performance of services hereunder by Cardinal, regardless of whether such claim is based upon any of the above stated reasons or otherwise.

Relinquished By: <u>[Signature]</u>	Date: <u>1/27/15</u> Time: <u>1:35</u>	Received By: <u>[Signature]</u>	Phone Result: <input type="checkbox"/> Yes <input type="checkbox"/> No Fax Result: <input type="checkbox"/> Yes <input type="checkbox"/> No REMARKS: <u>Stitzworth@burnettoil.com</u> <u>mburton@diversifiedfsi.com</u> <u>lcronshaw@diversifiedfsi.com</u>
Relinquished By:	Date:	Received By:	
Delivered By: (Circle One) Sampler - UPS - Bus - Other:	Date:	Sample Condition Cool <input checked="" type="checkbox"/> Yes <input type="checkbox"/> No Intact <input checked="" type="checkbox"/> Yes <input type="checkbox"/> No	CHECKED BY: <u>[Signature]</u> (Initials)

† Cardinal cannot accept verbal changes. Please fax written changes to (575) 393-2326

#54

Appendix IV

SITE PHOTOS

Diversified Field Service, Inc.
206 W. Snyder
Hobbs, NM 88240
(575) 964-8394

Burnett Gissler B 88

PHOTO PAGE



Site prior, facing southwest

1/21/2015



Site prior, facing east

1/21/2015



Excavating site, facing southwest



Scraping site



Backfilling site



Backfilling site



Pad completed



Pad completed



Backfilled pasture area



Backfilled pasture area



Seeding site



Seeding site

Appendix V

SEED REPORT

Diversified Field Service, Inc.
206 W. Snyder
Hobbs, NM 88240
(575) 964-8394

DIVERSIFIED FIELD SERVICES, INC.

Project: Burnett oil & Gas
Gisster 88
Seed and lbs used: ^{1 bag} 25 pd. LPC

Date Started: 2/13/15
Date Completed: 2/13/15

Supervisor: 

Bamert Seed Company Inc.

1897 CR 1018 Muleshoe, TX 79347

(800) 262-9892

Permit # TX00905

LPC Sand Shinery with Ragweed/Saltbush 150 bulk #

INV55149

Description	Pure Seed	Germ	Dormant	Hard Seed	Origin
Bluestem Big, "Kaw" (Andropogon gerardii)	15.87%	92.00%	0.00%	0.00%	TX
Bluestem Sand, "Woodward" (Andropogon hallii)	13.51%	90.00%	0.00%	0.00%	TX
Bluestem, Little "Cimarron" (Schizachyrium scoparium)	8.21%	31.00%	57.00%	0.00%	TX
Bristlegrass Plains, "VNS" (Setaria vulpiseta)	13.34%	84.00%	7.00%	0.00%	TX
Coreopsis Plains (Coreopsis tinctoria)	5.03%	97.00%	0.00%	0.00%	TX
Dropseed, Sand, "VNS" (Sporobolus cryptandrus)	2.56%	9.00%	86.00%	0.00%	
Fourwing Saltbush, "VNS" (Atriplex canescens)	12.96%	75.00%	0.00%	0.00%	NM
Ragweed, Western (Ambrosia L.)	5.72%	6.00%	79.00%	0.00%	
Purity: 77.19%	Inert Matter: 16.80%	Other Crop Seed: 5.97%	Weed Seed: 0.05%		

Noxious Weeds: None

Test Date: 09/2014

Net Wt: 25.00 lbs

Appendix VI

FINAL C-141

Diversified Field Service, Inc.
206 W. Snyder
Hobbs, NM 88240
(575) 964-8394

District I
1625 N. French Dr., Hobbs, NM 88240
District II
811 S. First St., Artesia, NM 88210
District III
1000 Rio Brazos Road, Aztec, NM 87410
District IV
1220 S. St. Francis Dr., Santa Fe, NM 87505

State of New Mexico
Energy Minerals and Natural Resources
Oil Conservation Division
1220 South St. Francis Dr.
Santa Fe, NM 87505

Form C-141
Revised August 8, 2011

Submit 1 Copy to appropriate District Office in
accordance with 19.15.29 NMAC.

Release Notification and Corrective Action

OPERATOR

☐ Initial Report ☒ Final Report

Name of Company: Burnett Oil Co., Inc.	Contact: Leslie Garvis
Address: 801 Cherry Street – Suite 1500, Ft. Worth, TX 76102	Telephone No.: 817-583-8730
Facility Name: Gissler B 88	Facility Type: Oil Well
Surface Owner: BLM	Mineral Owner: BLM
API No. 30-015-40847	

LOCATION OF RELEASE

Unit Letter	Section	Township	Range	Feet from the	North/South Line	Feet from	East/West Line	County
I	11	17S	30E	1650	South	330	East	Eddy

Latitude: 32.8463087 Longitude: -103.9351954

NATURE OF RELEASE

Type of Release: Water / Oil	Volume of Release (barrels): 100 / 20	Volume Recovered (barrels): 85 / 10
Source of Release: Pumping Unit	Date and Hour of Occurrence 01/16/2015	Date and Hour of Discovery 01/16/2015 1600
Was Immediate Notice Given? <input checked="" type="checkbox"/> Yes <input type="checkbox"/> No <input type="checkbox"/> Not Required	If YES, To Whom? BLM – Robertson / OCD – Patterson / Email Notification on 01/17/2015	
By Whom? Johnny Titsworth – Burnett	Date and Hour: 01/16/2015 approximately 1615	
Was a Watercourse Reached? <input type="checkbox"/> Yes <input checked="" type="checkbox"/> No	If YES, Volume Impacting the Watercourse. n/a	

If a Watercourse was Impacted, Describe Fully.*

Describe Cause of Problem and Remedial Action Taken.*

Liner on polish rod slipped. Liner was reattached and bolts tightened. Majority of the release stayed on the location pad. Some flowed to the SW corner of the location and a nearby pasture. The pasture area affected was approximately 30'x50. All standing fluid was vacuumed up.

Describe Area Affected and Cleanup Action Taken.

On January 27, 2015, DFSI personnel were on site to obtain samples within the leak area. Ten samples were obtained and field sampled for chloride levels, as well as BTEX. The BTEX samples were performed using a Mini Rae Photoionization Detector (PID). All clean samples were submitted for laboratory analysis at Cardinal Laboratories of Hobbs, NM, resulting in concentrations that decreased with depth to below NMOCD and BLM regulatory standards. A work plan was submitted to NMOCD and BLM on January 29, 2015. DFSI personnel were on site to scrape the impacted area on the pad 6" bgs and backfilled with clean, imported caliche. The release within the pasture was excavated to a depth of 1' bgs, with the exception of SP2, which was excavated to a depth of 2' bgs. The excavation was backfilled to ground surface with clean, imported soil and contoured to the surrounding area. Contaminated soil was properly disposed of at an NMOCD approved facility. The pasture was seeded with a blend of native vegetation.

I hereby certify that the information given above is true and complete to the best of my knowledge and understand that pursuant to NMOCD rules and regulations all operators are required to report and/or file certain release notifications and perform corrective actions for releases which may endanger public health or the environment. The acceptance of a C-141 report by the NMOCD marked as "Final Report" does not relieve the operator of liability should their operations have failed to adequately investigate and remediate contamination that pose a threat to ground water, surface water, human health or the environment. In addition, NMOCD acceptance of a C-141 report does not relieve the operator of responsibility for compliance with any other federal, state, or local laws and/or regulations.

		<u>OIL CONSERVATION DIVISION</u>	
Signature:		Approved by Environmental Specialist: <i>Ashley Maxwell</i>	
Printed Name: Leslie Garvis		Approval Date: 12/15/2022	
Title: Regulatory Coordinator		Expiration Date:	
E-mail Address: lgarvis@burnettoil.com		Conditions of Approval:	
Date: 04/20/2016 Phone: 817-332-5108		Attached <input type="checkbox"/>	

* Attach Additional Sheets If Necessary

2RP-2743

Gissler B #88
Closure Report
#nAB1502026861



July 29, 2022

Appendix B

Current C-141 Closure Form

District I
1625 N. French Dr., Hobbs, NM 88240
District II
811 S. First St., Artesia, NM 88210
District III
1000 Rio Brazos Road, Aztec, NM 87410
District IV
1220 S. St. Francis Dr., Santa Fe, NM 87505

State of New Mexico
Energy Minerals and Natural
Resources Department

Oil Conservation Division
1220 South St. Francis Dr.
Santa Fe, NM 87505

Form C-141
Revised August 24, 2018
Submit to appropriate OCD District office

Incident ID	nAB1502026861
District RP	2RP-2743
Facility ID	
Application ID	

Release Notification

Responsible Party

Responsible Party EOG Resources, Inc.	OGRID 7377
Contact Name Chase Settle	Contact Telephone 575-748-1471
Contact email Chase_Settle@eogresources.com	Incident # (assigned by OCD) nAB1502026861
Contact mailing address 104 S. 4th Street, Artesia, NM 88210	

Location of Release Source

Latitude 32.84630 Longitude -103.93518
(NAD 83 in decimal degrees to 5 decimal places)

Site Name Gissler B #88	Site Type Oil Well
Date Release Discovered 01/16/2015	API# (if applicable) 30-015-40847

Unit Letter	Section	Township	Range	County
I	11	17S	30E	Eddy

Surface Owner: ☐ State ☒ Federal ☐ Tribal ☐ Private (Name: _____)

Nature and Volume of Release

Material(s) Released (Select all that apply and attach calculations or specific justification for the volumes provided below)

<input checked="" type="checkbox"/> Crude Oil	Volume Released (bbls) 20	Volume Recovered (bbls) 10
<input checked="" type="checkbox"/> Produced Water	Volume Released (bbls) 100	Volume Recovered (bbls) 85
	Is the concentration of dissolved chloride in the produced water >10,000 mg/l?	<input checked="" type="checkbox"/> Yes <input type="checkbox"/> No
<input type="checkbox"/> Condensate	Volume Released (bbls)	Volume Recovered (bbls)
<input type="checkbox"/> Natural Gas	Volume Released (Mcf)	Volume Recovered (Mcf)
<input type="checkbox"/> Other (describe)	Volume/Weight Released (provide units)	Volume/Weight Recovered (provide units)

Cause of Release Please refer to original C-141 for details of 2RP-2743.

Incident ID	nAB1502026861
District RP	2RP-2743
Facility ID	
Application ID	

Was this a major release as defined by 19.15.29.7(A) NMAC? <input checked="" type="checkbox"/> Yes <input type="checkbox"/> No	If YES, for what reason(s) does the responsible party consider this a major release? Volume released was greater than 25 barrels.
If YES, was immediate notice given to the OCD? By whom? To whom? When and by what means (phone, email, etc)? Yes, by Johnny Titsworth (Burnett) to Robertson (BLM) and Patterson (OCD) through email on 01/17/15.	

Initial Response

The responsible party must undertake the following actions immediately unless they could create a safety hazard that would result in injury

<input checked="" type="checkbox"/> The source of the release has been stopped. <input checked="" type="checkbox"/> The impacted area has been secured to protect human health and the environment. <input checked="" type="checkbox"/> Released materials have been contained via the use of berms or dikes, absorbent pads, or other containment devices. <input checked="" type="checkbox"/> All free liquids and recoverable materials have been removed and managed appropriately.	
If all the actions described above have <u>not</u> been undertaken, explain why: 	
Per 19.15.29.8 B. (4) NMAC the responsible party may commence remediation immediately after discovery of a release. If remediation has begun, please attach a narrative of actions to date. If remedial efforts have been successfully completed or if the release occurred within a lined containment area (see 19.15.29.11(A)(5)(a) NMAC), please attach all information needed for closure evaluation.	
I hereby certify that the information given above is true and complete to the best of my knowledge and understand that pursuant to OCD rules and regulations all operators are required to report and/or file certain release notifications and perform corrective actions for releases which may endanger public health or the environment. The acceptance of a C-141 report by the OCD does not relieve the operator of liability should their operations have failed to adequately investigate and remediate contamination that pose a threat to groundwater, surface water, human health or the environment. In addition, OCD acceptance of a C-141 report does not relieve the operator of responsibility for compliance with any other federal, state, or local laws and/or regulations.	
Printed Name: <u>Chase Settle</u>	Title: <u>Rep Safety & Environmental Sr</u>
Signature: <u>Chase Settle</u>	Date: <u>07/29/2022</u>
email: <u>Chase_Settle@eogresources.com</u>	Telephone: <u>575-748-1471</u>
<u>OCD Only</u> Received by: _____ Date: _____	

Incident ID	nAB1502026861
District RP	2RP-2743
Facility ID	
Application ID	

Closure

The responsible party must attach information demonstrating they have complied with all applicable closure requirements and any conditions or directives of the OCD. This demonstration should be in the form of a comprehensive report (electronic submittals in .pdf format are preferred) including a scaled site map, sampling diagrams, relevant field notes, photographs of any excavation prior to backfilling, laboratory data including chain of custody documents of final sampling, and a narrative of the remedial activities. Refer to 19.15.29.12 NMAC.

Closure Report Attachment Checklist: *Each of the following items must be included in the closure report.*

- ☒ A scaled site and sampling diagram as described in 19.15.29.11 NMAC
- ☒ Photographs of the remediated site prior to backfill or photos of the liner integrity if applicable (Note: appropriate OCD District office must be notified 2 days prior to liner inspection)
- ☒ Laboratory analyses of final sampling (Note: appropriate ODC District office must be notified 2 days prior to final sampling)
- ☒ Description of remediation activities

I hereby certify that the information given above is true and complete to the best of my knowledge and understand that pursuant to OCD rules and regulations all operators are required to report and/or file certain release notifications and perform corrective actions for releases which may endanger public health or the environment. The acceptance of a C-141 report by the OCD does not relieve the operator of liability should their operations have failed to adequately investigate and remediate contamination that pose a threat to groundwater, surface water, human health or the environment. In addition, OCD acceptance of a C-141 report does not relieve the operator of responsibility for compliance with any other federal, state, or local laws and/or regulations. The responsible party acknowledges they must substantially restore, reclaim, and re-vegetate the impacted surface area to the conditions that existed prior to the release or their final land use in accordance with 19.15.29.13 NMAC including notification to the OCD when reclamation and re-vegetation are complete.

Printed Name: Chase Settle

Title: Rep Safety & Environmental Sr

Signature: Chase Settle

Date: 07/29/2022

email: Chase_Settle@eogresources.com

Telephone: 575-748-1471

OCD Only

Received by: _____

Date: _____

Closure approval by the OCD does not relieve the responsible party of liability should their operations have failed to adequately investigate and remediate contamination that poses a threat to groundwater, surface water, human health, or the environment nor does not relieve the responsible party of compliance with any other federal, state, or local laws and/or regulations.

Closure Approved by: Ashley Maxwell

Date: 12/15/2022

Printed Name: Ashley Maxwell

Title: Environmental Specialist

District I

1625 N. French Dr., Hobbs, NM 88240
Phone:(575) 393-6161 Fax:(575) 393-0720

District II

811 S. First St., Artesia, NM 88210
Phone:(575) 748-1283 Fax:(575) 748-9720

District III

1000 Rio Brazos Rd., Aztec, NM 87410
Phone:(505) 334-6178 Fax:(505) 334-6170

District IV

1220 S. St Francis Dr., Santa Fe, NM 87505
Phone:(505) 476-3470 Fax:(505) 476-3462

State of New Mexico
Energy, Minerals and Natural Resources
Oil Conservation Division
1220 S. St Francis Dr.
Santa Fe, NM 87505

CONDITIONS

Action 129926

CONDITIONS

Operator: EOG RESOURCES INC P.O. Box 2267 Midland, TX 79702	OGRID: 7377
	Action Number: 129926
	Action Type: [C-141] Release Corrective Action (C-141)

CONDITIONS

Created By	Condition	Condition Date
amaxwell	None	12/15/2022