



303 Veterans Airpark Lane Midland, TX 79705

## **Remediation Plan**

November 17, 2022

Re: McCallister CTB  
Case nAPP2223049852

### **Background:**

On 8/15/2022 a release occurred due to a steel 3-inch circulation and divert line failed. The release (GPS: 32.80238997, -103.5183757) is located west of Hobbs, New Mexico in unit letter M section 25 township 17S range 34E. A groundwater survey was conducted utilizing NMOSE wells of record. The nearest well suggest groundwater beneath the release to be 75 feet.

On 10/13/2022 vertical delineation was conducted utilizing a hand auger to a depth of 1 foot. All samples collected were submitted to a commercial laboratory for analysis of chloride, TPH, and BTEX. On 11/10/2022 vertical delineation was continued to a depth of 4.5 feet. All samples collected were submitted for analysis. 5-point horizontal surface composite samples were collected not to exceed 200 square feet and submitted to a commercial laboratory for analysis of chloride, TPH, and BTEX.

### **Remediation Plan:**

Apache corporation proposes that the release around SP 1 be excavated to a depth of 4 feet. SP 2 be excavated to a depth of 3.2 feet. SP 3 be excavated to a depth of 4.5 feet. 5-point bottom and wall samples will be collected not to exceed 400 square feet. All excavated material (250 yards) will be hauled to an OCD approved disposal facility. Once laboratory results are below table one standards for releases 51-100 feet to groundwater the excavation will be backfilled with clean imported caliche to restore the surface. The remediation will be completed within 90 days of OCD approval of the plan.

Enclosed: C-141, Groundwater Data, Maps, Sample Data, and Laboratory Results.

Submitted by.

*Larry Baker*

**Environmental Technician Sr. Staff**

[larry.baker@apachecorp.com](mailto:larry.baker@apachecorp.com)

**Cell# 432-215-2284**

|                |                |
|----------------|----------------|
| Incident ID    | NAPP2223049852 |
| District RP    |                |
| Facility ID    |                |
| Application ID |                |

## Site Assessment/Characterization

*This information must be provided to the appropriate district office no later than 90 days after the release discovery date.*

|   |   |
|---|---|
| What is the shallowest depth to groundwater beneath the area affected by the release?   | <u>75'</u> (ft bgs)   |
| Did this release impact groundwater or surface water?   | <input type="checkbox"/> Yes <input checked="" type="checkbox"/> No |
| Are the lateral extents of the release within 300 feet of a continuously flowing watercourse or any other significant watercourse?  | <input type="checkbox"/> Yes <input checked="" type="checkbox"/> No |
| Are the lateral extents of the release within 200 feet of any lakebed, sinkhole, or playa lake (measured from the ordinary high-water mark)?  | <input type="checkbox"/> Yes <input checked="" type="checkbox"/> No |
| Are the lateral extents of the release within 300 feet of an occupied permanent residence, school, hospital, institution, or church?  | <input type="checkbox"/> Yes <input checked="" type="checkbox"/> No |
| Are the lateral extents of the release within 500 horizontal feet of a spring or a private domestic fresh water well used by less than five households for domestic or stock watering purposes? | <input type="checkbox"/> Yes <input checked="" type="checkbox"/> No |
| Are the lateral extents of the release within 1000 feet of any other fresh water well or spring?  | <input type="checkbox"/> Yes <input checked="" type="checkbox"/> No |
| Are the lateral extents of the release within incorporated municipal boundaries or within a defined municipal fresh water well field?   | <input type="checkbox"/> Yes <input checked="" type="checkbox"/> No |
| Are the lateral extents of the release within 300 feet of a wetland?  | <input type="checkbox"/> Yes <input checked="" type="checkbox"/> No |
| Are the lateral extents of the release overlying a subsurface mine?   | <input type="checkbox"/> Yes <input checked="" type="checkbox"/> No |
| Are the lateral extents of the release overlying an unstable area such as karst geology?  | <input type="checkbox"/> Yes <input checked="" type="checkbox"/> No |
| Are the lateral extents of the release within a 100-year floodplain?  | <input type="checkbox"/> Yes <input checked="" type="checkbox"/> No |
| Did the release impact areas <b>not</b> on an exploration, development, production, or storage site?  | <input type="checkbox"/> Yes <input checked="" type="checkbox"/> No |

Attach a comprehensive report (electronic submittals in .pdf format are preferred) demonstrating the lateral and vertical extents of soil contamination associated with the release have been determined. Refer to 19.15.29.11 NMAC for specifics.

### **Characterization Report Checklist:** *Each of the following items must be included in the report.*

- ☒ Scaled site map showing impacted area, surface features, subsurface features, delineation points, and monitoring wells.
- ☒ Field data
- ☒ Data table of soil contaminant concentration data
- ☒ Depth to water determination
- ☒ Determination of water sources and significant watercourses within ½-mile of the lateral extents of the release
- ☒ Boring or excavation logs
- ☐ Photographs including date and GIS information
- ☒ Topographic/Aerial maps
- ☒ Laboratory data including chain of custody

If the site characterization report does not include completed efforts at remediation of the release, the report must include a proposed remediation plan. That plan must include the estimated volume of material to be remediated, the proposed remediation technique, proposed sampling plan and methods, anticipated timelines for beginning and completing the remediation. The closure criteria for a release are contained in Table 1 of 19.15.29.12 NMAC, however, use of the table is modified by site- and release-specific parameters.

State of New Mexico  
Oil Conservation Division

Page 4

|                |                |
|----------------|----------------|
| Incident ID    | NAPP2223049852 |
| District RP    |                |
| Facility ID    |                |
| Application ID |                |

I hereby certify that the information given above is true and complete to the best of my knowledge and understand that pursuant to OCD rules and regulations all operators are required to report and/or file certain release notifications and perform corrective actions for releases which may endanger public health or the environment. The acceptance of a C-141 report by the OCD does not relieve the operator of liability should their operations have failed to adequately investigate and remediate contamination that pose a threat to groundwater, surface water, human health or the environment. In addition, OCD acceptance of a C-141 report does not relieve the operator of responsibility for compliance with any other federal, state, or local laws and/or regulations.

Printed Name: Larry Baker Title: Environmental Tech Sr. Staff  
Signature: Larry Baker Date: 11/17/2022  
email: larry.baker@apachecorp.com Telephone: 432-215-2284

**OCD Only**

Received by: Jocelyn Harimon Date: 11/17/2022

|                |                |
|----------------|----------------|
| Incident ID    | NAPP2223049852 |
| District RP    |                |
| Facility ID    |                |
| Application ID |                |

## Remediation Plan

**Remediation Plan Checklist:** *Each of the following items must be included in the plan.*

- ☒ Detailed description of proposed remediation technique
- ☒ Scaled sitemap with GPS coordinates showing delineation points
- ☒ Estimated volume of material to be remediated
- ☒ Closure criteria is to Table 1 specifications subject to 19.15.29.12(C)(4) NMAC
- ☒ Proposed schedule for remediation (note if remediation plan timeline is more than 90 days OCD approval is required)

**Deferral Requests Only:** *Each of the following items must be confirmed as part of any request for deferral of remediation.*

- ☐ Contamination must be in areas immediately under or around production equipment where remediation could cause a major facility deconstruction.
- ☐ Extents of contamination must be fully delineated.
- ☐ Contamination does not cause an imminent risk to human health, the environment, or groundwater.

I hereby certify that the information given above is true and complete to the best of my knowledge and understand that pursuant to OCD rules and regulations all operators are required to report and/or file certain release notifications and perform corrective actions for releases which may endanger public health or the environment. The acceptance of a C-141 report by the OCD does not relieve the operator of liability should their operations have failed to adequately investigate and remediate contamination that pose a threat to groundwater, surface water, human health or the environment. In addition, OCD acceptance of a C-141 report does not relieve the operator of responsibility for compliance with any other federal, state, or local laws and/or regulations.

Printed Name: Larry Baker Title: Environmental Tech Sr. Staff  
Signature: Larry Baker Date: 11/17/2022  
email: larry.baker@apachecorp.com Telephone: 432-215-2284

**OCD Only**

Received by: Jocelyn Harimon Date: 11/17/2022

☐ Approved ☒ Approved with Attached Conditions of Approval ☐ Denied ☐ Deferral Approved

Signature: Jennifer Nobui Date: 12/15/2022



Show search results for 32.802...

L-06698

L-05008  
2

L-05106

L-04899

L-05025

L-05335  
2

L-05003

L-14399-POD2

L-14399-POD1

L-14043-POD2

L-14180-POD3

L-14180-POD2

L-14044-POD2

L-14044-POD1

L-13635-POD1

L-07481  
3

L-05392  
2

L-04247-X

L-02217

L-14311-POD1

State Highway 238

State Highway 238

238

L-02724-POD8

1:9027

0.2km

Released to Imaging: 12/15/2022 4:09:16 PM

-103.537 32.795 Degrees





# New Mexico Office of the State Engineer

## Point of Diversion Summary

(quarters are 1=NW 2=NE 3=SW 4=SE)  
(quarters are smallest to largest) (NAD83 UTM in meters)

| Well Tag | POD Number | Q64 | Q16 | Q4 | Sec | Tws | Rng    | X        | Y                        |
|----------|------------|-----|-----|----|-----|-----|--------|----------|--------------------------|
| L        | 05106      | 1   | 3   | 25 | 17S | 34E | 638524 | 3630547* | <input type="checkbox"/> |

Driller License: 46

Driller Company: ABBOTT BROTHERS COMPANY

Driller Name:

Drill Start Date: 04/15/1963

Drill Finish Date: 04/15/1963

Plug Date: 05/05/1964

Log File Date: 05/24/1963

PCW Rev Date:

Source: Shallow

Pump Type:

Pipe Discharge Size:

Estimated Yield:

Casing Size: 7.00

Depth Well: 150 feet

Depth Water: 95 feet

Water Bearing Stratifications:

Top Bottom Description

95 150 Sandstone/Gravel/Conglomerate

Casing Perforations:

Top Bottom

95 150

\*UTM location was derived from PLSS - see Help

The data is furnished by the NMOSE/ISC and is accepted by the recipient with the expressed understanding that the OSE/ISC make no warranties, expressed or implied, concerning the accuracy, completeness, reliability, usability, or suitability for any particular purpose of the data.

11/17/22 8:23 AM

POINT OF DIVERSION SUMMARY



# New Mexico Office of the State Engineer

## Point of Diversion Summary

(quarters are 1=NW 2=NE 3=SW 4=SE)  
(quarters are smallest to largest) (NAD83 UTM in meters)

| Well Tag | POD Number | Q64 | Q16 | Q4 | Sec | Tws | Rng    | X        | Y                        |
|----------|------------|-----|-----|----|-----|-----|--------|----------|--------------------------|
| L        | 05025      | 3   | 3   | 25 | 17S | 34E | 638530 | 3630143* | <input type="checkbox"/> |

Driller License: 46

Driller Company: ABBOTT BROTHERS COMPANY

Driller Name:

Drill Start Date: 12/21/1962

Drill Finish Date: 12/21/1962

Plug Date: 05/02/1964

Log File Date: 12/31/1962

PCW Rev Date:

Source: Shallow

Pump Type:

Pipe Discharge Size:

Estimated Yield:

Casing Size: 7.00

Depth Well: 157 feet

Depth Water: 95 feet

Water Bearing Stratifications:

Top Bottom Description

95 157 Sandstone/Gravel/Conglomerate

Casing Perforations:

Top Bottom

95 157

\*UTM location was derived from PLSS - see Help

The data is furnished by the NMOSE/ISC and is accepted by the recipient with the expressed understanding that the OSE/ISC make no warranties, expressed or implied, concerning the accuracy, completeness, reliability, usability, or suitability for any particular purpose of the data.

11/17/22 8:26 AM

POINT OF DIVERSION SUMMARY



# New Mexico Office of the State Engineer

## Point of Diversion Summary

(quarters are 1=NW 2=NE 3=SW 4=SE)  
(quarters are smallest to largest) (NAD83 UTM in meters)

| Well Tag | POD Number | Q64 | Q16 | Q4 | Sec | Tws | Rng | X      | Y                                 |
|----------|------------|-----|-----|----|-----|-----|-----|--------|-----------------------------------|
| L        | 04899      | 2   | 4   | 4  | 26  | 17S | 34E | 638226 | 3630235* <input type="checkbox"/> |

|                          |                  |                             |                  |
|--------------------------|------------------|-----------------------------|------------------|
| <b>Driller License:</b>  | 111              | <b>Driller Company:</b>     | BURKE, EDWARD B. |
| <b>Driller Name:</b>     | BURKE, EDWARD B. |                             |                  |
| <b>Drill Start Date:</b> | 12/11/1962       | <b>Drill Finish Date:</b>   | 12/11/1962       |
| <b>Log File Date:</b>    | 12/19/1962       | <b>PCW Rev Date:</b>        |                  |
| <b>Pump Type:</b>        |                  | <b>Pipe Discharge Size:</b> |                  |
| <b>Casing Size:</b>      | 7.00             | <b>Depth Well:</b>          | 135 feet         |
|                          |                  | <b>Depth Water:</b>         | 85 feet          |

| Water Bearing Stratifications: | Top | Bottom | Description                   |
|--------------------------------|-----|--------|-------------------------------|
|                                | 85  | 135    | Sandstone/Gravel/Conglomerate |

| Casing Perforations: | Top | Bottom |
|----------------------|-----|--------|
|                      | 101 | 132    |

\*UTM location was derived from PLSS - see Help

The data is furnished by the NMOSE/ISC and is accepted by the recipient with the expressed understanding that the OSE/ISC make no warranties, expressed or implied, concerning the accuracy, completeness, reliability, usability, or suitability for any particular purpose of the data.

11/17/22 8:27 AM

POINT OF DIVERSION SUMMARY





# New Mexico Office of the State Engineer

## Point of Diversion Summary

(quarters are 1=NW 2=NE 3=SW 4=SE)  
(quarters are smallest to largest) (NAD83 UTM in meters)

| Well Tag | POD Number | Q64 | Q16 | Q4 | Sec | Tws | Rng    | X        | Y                        |
|----------|------------|-----|-----|----|-----|-----|--------|----------|--------------------------|
| L        | 02308      | 4   | 4   | 25 | 17S | 34E | 639736 | 3630168* | <input type="checkbox"/> |

|                          |               |                             |                          |
|--------------------------|---------------|-----------------------------|--------------------------|
| <b>Driller License:</b>  | 144           | <b>Driller Company:</b>     | QUARLES DRILLING COMPANY |
| <b>Driller Name:</b>     | QUARLES, J.R. |                             |                          |
| <b>Drill Start Date:</b> | 08/07/1953    | <b>Drill Finish Date:</b>   | 08/12/1953               |
| <b>Log File Date:</b>    | 10/07/1953    | <b>PCW Rev Date:</b>        |                          |
| <b>Pump Type:</b>        |               | <b>Pipe Discharge Size:</b> |                          |
| <b>Casing Size:</b>      | 5.63          | <b>Depth Well:</b>          | 130 feet                 |
|                          |               | <b>Depth Water:</b>         | 76 feet                  |

| Water Bearing Stratifications: | Top | Bottom | Description                   |
|--------------------------------|-----|--------|-------------------------------|
|                                | 78  | 130    | Sandstone/Gravel/Conglomerate |

| Casing Perforations: | Top | Bottom |
|----------------------|-----|--------|
|                      | 100 | 120    |

\*UTM location was derived from PLSS - see Help

The data is furnished by the NMOSE/ISC and is accepted by the recipient with the expressed understanding that the OSE/ISC make no warranties, expressed or implied, concerning the accuracy, completeness, reliability, usability, or suitability for any particular purpose of the data.

11/17/22 8:28 AM

POINT OF DIVERSION SUMMARY



# New Mexico Office of the State Engineer

## Point of Diversion Summary

(quarters are 1=NW 2=NE 3=SW 4=SE)  
(quarters are smallest to largest) (NAD83 UTM in meters)

| Well Tag | POD Number | Q64 | Q16 | Q4 | Sec | Tws | Rng    | X        | Y                        |
|----------|------------|-----|-----|----|-----|-----|--------|----------|--------------------------|
| L        | 02217      | 2   | 4   | 25 | 17S | 34E | 639730 | 3630571* | <input type="checkbox"/> |

|                          |               |                             |               |                             |
|--------------------------|---------------|-----------------------------|---------------|-----------------------------|
| <b>Driller License:</b>  | 136           | <b>Driller Company:</b>     | SHELTON, G.L. |                             |
| <b>Driller Name:</b>     | SHELTON, G.L. |                             |               |                             |
| <b>Drill Start Date:</b> | 05/25/1953    | <b>Drill Finish Date:</b>   | 06/10/1953    | <b>Plug Date:</b>           |
| <b>Log File Date:</b>    | 06/15/1953    | <b>PCW Rev Date:</b>        | 07/12/1954    | <b>Source:</b> Shallow      |
| <b>Pump Type:</b>        |               | <b>Pipe Discharge Size:</b> |               | <b>Estimated Yield:</b>     |
| <b>Casing Size:</b>      | 5.63          | <b>Depth Well:</b>          | 120 feet      | <b>Depth Water:</b> 75 feet |

| Water Bearing Stratifications: | Top | Bottom | Description                   |
|--------------------------------|-----|--------|-------------------------------|
|                                | 84  | 90     | Sandstone/Gravel/Conglomerate |
|                                | 115 | 120    | Sandstone/Gravel/Conglomerate |

| Casing Perforations: | Top | Bottom |
|----------------------|-----|--------|
|                      | 80  | 120    |

\*UTM location was derived from PLSS - see Help

The data is furnished by the NMOSE/ISC and is accepted by the recipient with the expressed understanding that the OSE/ISC make no warranties, expressed or implied, concerning the accuracy, completeness, reliability, usability, or suitability for any particular purpose of the data.

11/17/22 8:29 AM

POINT OF DIVERSION SUMMARY



Show search results for 32.802...

1:18055

Released to Imaging: 12/15/2022 4:09:16 PM

2. -103.546 32.787 Degrees

Department of Energy Office of Legacy Management | OSE GIS, EDAC, USGS | Land Office Geographic In...

POWERED BY  
**esr**

## Delineation Samples

| Sample Date | Sample ID | Depth | Chloride Lab | Benzene | Toulene | Ethybenzene | Total Xylenes | Total BTEX | GRO   | DRO   | EXT DRO | GPS Coordinates             |
|-------------|-----------|-------|--------------|---------|---------|-------------|---------------|------------|-------|-------|---------|-----------------------------|
| 10/13/2022  | SP 1      | S     | 256          | 3.94    | 99.8    | 108         | 169           | 381        | 1410  | 11100 | 2320    | 32.8022982,<br>-103.5184303 |
| 10/13/2022  |           | 1'    | 768          | 0.224   | 5.32    | 11.1        | 13.9          | 30.6       | 315   | 6690  | 2300    |                             |
| 11/10/2022  |           | 2'    |              | <1.00   | 14.7    | 30.1        | 83.8          | 129        | 1380  | 14400 | 3060    |                             |
| 11/10/2022  |           | 3'    | 624          | <0.050  | 0.932   | 2.43        | 4.32          | 7.68       | 147   | 3590  | 1120    |                             |
| 11/10/2022  |           | 4'    |              | <0.050  | 0.082   | 0.375       | 0.768         | 1.22       | <50.0 | 759   | 188     |                             |
| 10/13/2022  | SP2       | S     | 672          | <0.500  | 9.23    | 30.9        | 132           | 172        | 3920  | 38700 | 7240    | 32.8022982,<br>-103.5183616 |
| 10/13/2022  |           | 1'    | 320          | <0.500  | 9.3     | 17.8        | 28.4          | 55.5       | 725   | 7960  | 2560    |                             |
| 11/10/2022  |           | 2'    |              | 0.514   | 22.1    | 42.2        | 75            | 140        | 1900  | 16600 | 3540    |                             |
| 11/10/2022  |           | 3'    |              | <0.050  | 1.18    | 4.8         | 15            | 21         | 499   | 6600  | 1390    |                             |
| 11/10/2022  |           | 3' 2" |              | <0.050  | 0.088   | 0.529       | 1.18          | 1.79       | <50.0 | 957   | 243     |                             |
| 10/13/2022  | SP3       | S     | 176          | 1.81    | 108     | 177         | 283           | 570        | 4450  | 29100 | 5820    | 32.8024059,<br>-103.5183851 |
| 10/13/2022  |           | 1'    | 80           | <0.500  | 27.8    | 55.2        | 81.2          | 164        | 1100  | 7330  | 1630    |                             |
| 11/10/2022  |           | 2'    |              | <0.500  | 25.4    | 46          | 85            | 156        | 1960  | 16000 | 6360    |                             |
| 11/10/2022  |           | 3'    |              | <0.050  | 0.78    | 3.65        | 7             | 11.4       | 191   | 3240  | 827     |                             |
| 11/10/2022  |           | 4'    |              | <0.050  | 0.956   | 4.42        | 8.37          | 13.7       | 252   | 4040  | 875     |                             |
| 11/10/2022  |           | 4.5   |              | <0.050  | 0.265   | 0.875       | 1.85          | 2.99       | 23.7  | 313   | 92.8    |                             |
| 11/10/2022  | HC1       | S     | 80           | <0.050  | <0.050  | <0.050      | <0.150        | <0.300     | <10.0 | 12.9  | <10.0   | 32.8022492,<br>-103.5184575 |
| 11/10/2022  | HC2       | S     | 80           | <0.050  | <0.050  | <0.050      | <0.150        | <0.300     | <10.0 | <10.0 | <10.0   | 32.8024169,<br>-103.5182704 |





HC2

SR3

SP1

SP2

HC1

70 ft



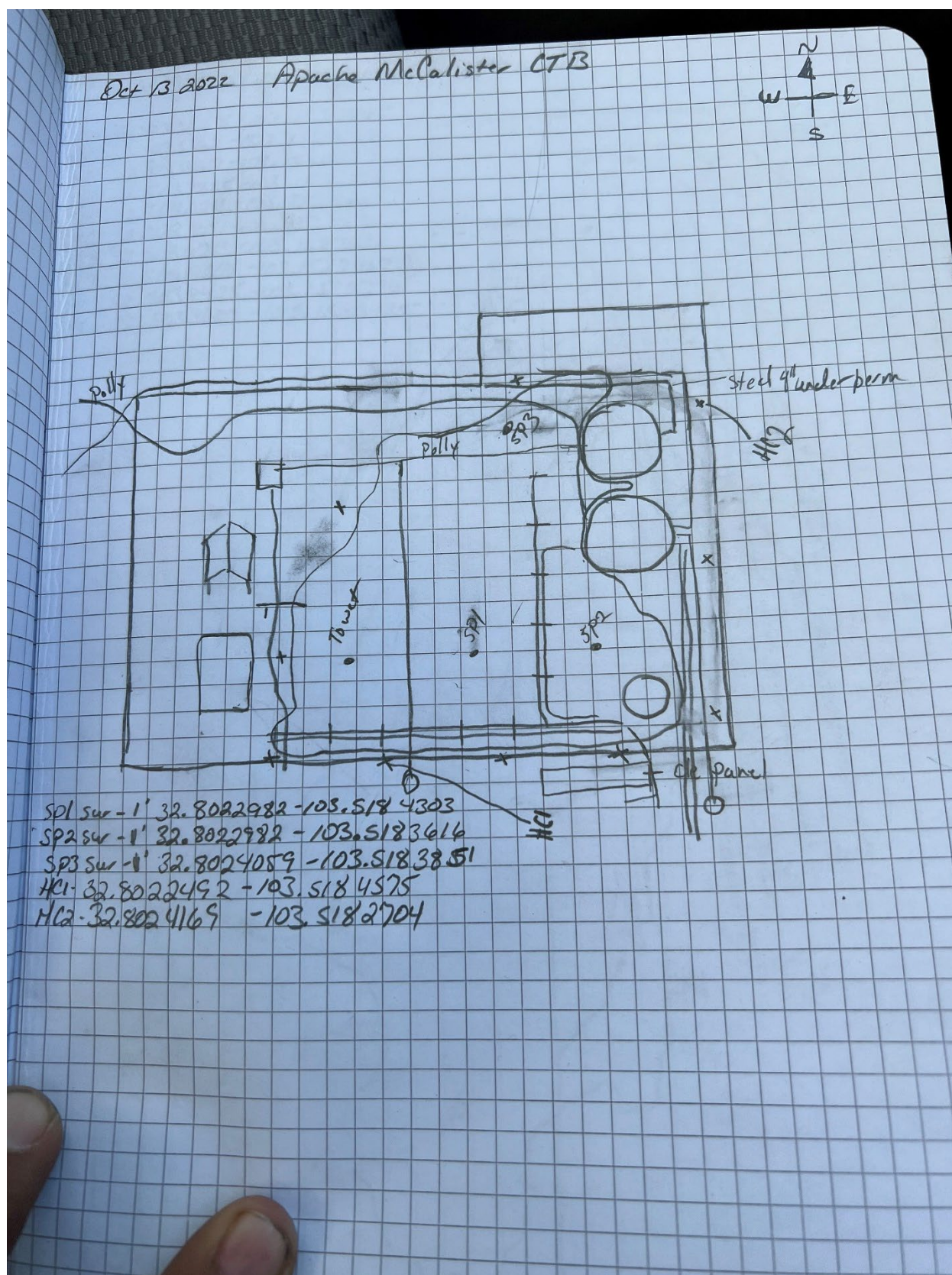



PHONE (575) 393-2326 ° 101 E. MARLAND ° HOBBS, NM 88240

---

October 18, 2022

BRUCE BAKER

APACHE CORP - HOBBS

2350 W. MARLAND BLVD.

HOBBS, NM 88240

RE: MCCALISTER CTB

Enclosed are the results of analyses for samples received by the laboratory on 10/13/22 11:31.

Cardinal Laboratories is accredited through Texas NELAP under certificate number T104704398-22-15. Accreditation applies to drinking water, non-potable water and solid and chemical materials. All accredited analytes are denoted by an asterisk (\*). For a complete list of accredited analytes and matrices visit the TCEQ website at [www.tceq.texas.gov/field/qa/lab\\_accred\\_certif.html](http://www.tceq.texas.gov/field/qa/lab_accred_certif.html).

Cardinal Laboratories is accredited through the State of Colorado Department of Public Health and Environment for:

|                  |                              |
|------------------|------------------------------|
| Method EPA 552.2 | Haloacetic Acids (HAA-5)     |
| Method EPA 524.2 | Total Trihalomethanes (TTHM) |
| Method EPA 524.4 | Regulated VOCs (V1, V2, V3)  |

Accreditation applies to public drinking water matrices.

This report meets NELAP requirements and is made up of a cover page, analytical results, and a copy of the original chain-of-custody. If you have any questions concerning this report, please feel free to contact me.

Sincerely,

A handwritten signature in black ink that reads "Celey D. Keene". The signature is written in a cursive, flowing style.

Celey D. Keene

Lab Director/Quality Manager



PHONE (575) 393-2326 • 101 E. MARLAND • HOBBS, NM 88240

**Analytical Results For:**

APACHE CORP - HOBBS  
 BRUCE BAKER  
 2350 W. MARLAND BLVD.  
 HOBBS NM, 88240  
 Fax To: (575) 393-2432

|                   |                |                     |                |
|-------------------|----------------|---------------------|----------------|
| Received:         | 10/13/2022     | Sampling Date:      | 10/13/2022     |
| Reported:         | 10/18/2022     | Sampling Type:      | Soil           |
| Project Name:     | MCCALISTER CTB | Sampling Condition: | Cool & Intact  |
| Project Number:   | NONE GIVEN     | Sample Received By: | Tamara Oldaker |
| Project Location: | NOT GIVEN      |                     |                |

**Sample ID: SP 1 @ SURFACE (H224830-01)**

| BTX 8021B             |             | mg/kg           |            | Analyzed By: JH |      |            |               |       |           |
|-----------------------|-------------|-----------------|------------|-----------------|------|------------|---------------|-------|-----------|
| Analyte               | Result      | Reporting Limit | Analyzed   | Method Blank    | BS   | % Recovery | True Value QC | RPD   | Qualifier |
| <b>Benzene*</b>       | <b>3.94</b> | 1.00            | 10/17/2022 | ND              | 2.14 | 107        | 2.00          | 3.58  |           |
| <b>Toluene*</b>       | <b>99.8</b> | 1.00            | 10/17/2022 | ND              | 2.06 | 103        | 2.00          | 3.64  |           |
| <b>Ethylbenzene*</b>  | <b>108</b>  | 1.00            | 10/17/2022 | ND              | 2.05 | 103        | 2.00          | 0.866 |           |
| <b>Total Xylenes*</b> | <b>169</b>  | 3.00            | 10/17/2022 | ND              | 6.19 | 103        | 6.00          | 0.946 |           |
| <b>Total BTX</b>      | <b>381</b>  | 6.00            | 10/17/2022 | ND              |      |            |               |       |           |

Surrogate: 4-Bromofluorobenzene (PID) 113 % 69.9-140

| Chloride, SM4500Cl-B |            | mg/kg           |            | Analyzed By: GM |     |            |               |      |           |
|----------------------|------------|-----------------|------------|-----------------|-----|------------|---------------|------|-----------|
| Analyte              | Result     | Reporting Limit | Analyzed   | Method Blank    | BS  | % Recovery | True Value QC | RPD  | Qualifier |
| <b>Chloride</b>      | <b>256</b> | 16.0            | 10/17/2022 | ND              | 432 | 108        | 400           | 0.00 |           |

| TPH 8015M                  |              | mg/kg           |            | Analyzed By: MS |     |            |               |      |           | S-06 |
|----------------------------|--------------|-----------------|------------|-----------------|-----|------------|---------------|------|-----------|------|
| Analyte                    | Result       | Reporting Limit | Analyzed   | Method Blank    | BS  | % Recovery | True Value QC | RPD  | Qualifier |      |
| <b>GRO C6-C10*</b>         | <b>1410</b>  | 100             | 10/15/2022 | ND              | 225 | 112        | 200           | 3.68 |           |      |
| <b>DRO &gt;C10-C28*</b>    | <b>11100</b> | 100             | 10/15/2022 | ND              | 231 | 116        | 200           | 3.10 |           |      |
| <b>EXT DRO &gt;C28-C36</b> | <b>2320</b>  | 100             | 10/15/2022 | ND              |     |            |               |      |           |      |

Surrogate: 1-Chlorooctane 286 % 45.3-161

Surrogate: 1-Chlorooctadecane 893 % 46.3-178

Cardinal Laboratories

\*=Accredited Analyte

PLEASE NOTE: Liability and Damages. Cardinal's liability and client's exclusive remedy for any claim arising, whether based in contract or tort, shall be limited to the amount paid by client for analyses. All claims, including those for negligence and any other cause whatsoever shall be deemed waived unless made in writing and received by Cardinal within thirty (30) days after completion of the applicable service. In no event shall Cardinal be liable for incidental or consequential damages, including, without limitation, business interruptions, loss of use, or loss of profits incurred by client, its subsidiaries, affiliates or successors arising out of or related to the performance of the services hereunder by Cardinal, regardless of whether such claim is based upon any of the above stated reasons or otherwise. Results relate only to the samples identified above. This report shall not be reproduced except in full with written approval of Cardinal Laboratories.

Celey D. Keene, Lab Director/Quality Manager





PHONE (575) 393-2326 ° 101 E. MARLAND ° HOBBS, NM 88240

**Analytical Results For:**

APACHE CORP - HOBBS  
 BRUCE BAKER  
 2350 W. MARLAND BLVD.  
 HOBBS NM, 88240  
 Fax To: (575) 393-2432

|                   |                |                     |                |
|-------------------|----------------|---------------------|----------------|
| Received:         | 10/13/2022     | Sampling Date:      | 10/13/2022     |
| Reported:         | 10/18/2022     | Sampling Type:      | Soil           |
| Project Name:     | MCCALISTER CTB | Sampling Condition: | Cool & Intact  |
| Project Number:   | NONE GIVEN     | Sample Received By: | Tamara Oldaker |
| Project Location: | NOT GIVEN      |                     |                |

**Sample ID: SP 2 @ SURFACE (H224830-02)**

| BTX 8021B      |        | mg/kg           |            | Analyzed By: JH |      |            |               | S-04  |           |
|----------------|--------|-----------------|------------|-----------------|------|------------|---------------|-------|-----------|
| Analyte        | Result | Reporting Limit | Analyzed   | Method Blank    | BS   | % Recovery | True Value QC | RPD   | Qualifier |
| Benzene*       | <0.500 | 0.500           | 10/17/2022 | ND              | 2.14 | 107        | 2.00          | 3.58  |           |
| Toluene*       | 9.23   | 0.500           | 10/17/2022 | ND              | 2.06 | 103        | 2.00          | 3.64  |           |
| Ethylbenzene*  | 30.9   | 0.500           | 10/17/2022 | ND              | 2.05 | 103        | 2.00          | 0.866 |           |
| Total Xylenes* | 132    | 1.50            | 10/17/2022 | ND              | 6.19 | 103        | 6.00          | 0.946 |           |
| Total BTX      | 172    | 3.00            | 10/17/2022 | ND              |      |            |               |       |           |

Surrogate: 4-Bromofluorobenzene (PID) 168 % 69.9-140

| Chloride, SM4500CI-B |        | mg/kg           |            | Analyzed By: GM |     |            |               |      |           |
|----------------------|--------|-----------------|------------|-----------------|-----|------------|---------------|------|-----------|
| Analyte              | Result | Reporting Limit | Analyzed   | Method Blank    | BS  | % Recovery | True Value QC | RPD  | Qualifier |
| Chloride             | 672    | 16.0            | 10/17/2022 | ND              | 432 | 108        | 400           | 0.00 |           |

| TPH 8015M        |        | mg/kg           |            | Analyzed By: MS |     |            |               | S-06 |           |
|------------------|--------|-----------------|------------|-----------------|-----|------------|---------------|------|-----------|
| Analyte          | Result | Reporting Limit | Analyzed   | Method Blank    | BS  | % Recovery | True Value QC | RPD  | Qualifier |
| GRO C6-C10*      | 3920   | 100             | 10/15/2022 | ND              | 225 | 112        | 200           | 3.68 |           |
| DRO >C10-C28*    | 38700  | 100             | 10/15/2022 | ND              | 231 | 116        | 200           | 3.10 |           |
| EXT DRO >C28-C36 | 7240   | 100             | 10/15/2022 | ND              |     |            |               |      |           |

Surrogate: 1-Chlorooctane 1430 % 45.3-161

Surrogate: 1-Chlorooctadecane 1680 % 46.3-178

Cardinal Laboratories

\*=Accredited Analyte

PLEASE NOTE: Liability and Damages. Cardinal's liability and client's exclusive remedy for any claim arising, whether based in contract or tort, shall be limited to the amount paid by client for analyses. All claims, including those for negligence and any other cause whatsoever shall be deemed waived unless made in writing and received by Cardinal within thirty (30) days after completion of the applicable service. In no event shall Cardinal be liable for incidental or consequential damages, including, without limitation, business interruptions, loss of use, or loss of profits incurred by client, its subsidiaries, affiliates or successors arising out of or related to the performance of the services hereunder by Cardinal, regardless of whether such claim is based upon any of the above stated reasons or otherwise. Results relate only to the samples identified above. This report shall not be reproduced except in full with written approval of Cardinal Laboratories.

Celey D. Keene, Lab Director/Quality Manager



PHONE (575) 393-2326 ° 101 E. MARLAND ° HOBBS, NM 88240

**Analytical Results For:**

APACHE CORP - HOBBS  
 BRUCE BAKER  
 2350 W. MARLAND BLVD.  
 HOBBS NM, 88240  
 Fax To: (575) 393-2432

Received: 10/13/2022  
 Reported: 10/18/2022  
 Project Name: MCCALISTER CTB  
 Project Number: NONE GIVEN  
 Project Location: NOT GIVEN

Sampling Date: 10/13/2022  
 Sampling Type: Soil  
 Sampling Condition: Cool & Intact  
 Sample Received By: Tamara Oldaker

**Sample ID: SP 3 @ SURFACE (H224830-03)**

| BTX 8021B             |             | mg/kg           |            | Analyzed By: JH |      |            |               | S-04  |           |
|-----------------------|-------------|-----------------|------------|-----------------|------|------------|---------------|-------|-----------|
| Analyte               | Result      | Reporting Limit | Analyzed   | Method Blank    | BS   | % Recovery | True Value QC | RPD   | Qualifier |
| <b>Benzene*</b>       | <b>1.81</b> | 1.00            | 10/15/2022 | ND              | 2.14 | 107        | 2.00          | 3.58  |           |
| <b>Toluene*</b>       | <b>108</b>  | 1.00            | 10/15/2022 | ND              | 2.06 | 103        | 2.00          | 3.64  |           |
| <b>Ethylbenzene*</b>  | <b>177</b>  | 1.00            | 10/15/2022 | ND              | 2.05 | 103        | 2.00          | 0.866 |           |
| <b>Total Xylenes*</b> | <b>283</b>  | 3.00            | 10/15/2022 | ND              | 6.19 | 103        | 6.00          | 0.946 |           |
| <b>Total BTX</b>      | <b>570</b>  | 6.00            | 10/15/2022 | ND              |      |            |               |       |           |

Surrogate: 4-Bromofluorobenzene (PID) 148 % 69.9-140

| Chloride, SM4500CI-B |            | mg/kg           |            | Analyzed By: GM |     |            |               |      |           |
|----------------------|------------|-----------------|------------|-----------------|-----|------------|---------------|------|-----------|
| Analyte              | Result     | Reporting Limit | Analyzed   | Method Blank    | BS  | % Recovery | True Value QC | RPD  | Qualifier |
| <b>Chloride</b>      | <b>176</b> | 16.0            | 10/17/2022 | ND              | 432 | 108        | 400           | 0.00 |           |

| TPH 8015M                  |              | mg/kg           |            | Analyzed By: MS |     |            |               | S-06 |           |
|----------------------------|--------------|-----------------|------------|-----------------|-----|------------|---------------|------|-----------|
| Analyte                    | Result       | Reporting Limit | Analyzed   | Method Blank    | BS  | % Recovery | True Value QC | RPD  | Qualifier |
| <b>GRO C6-C10*</b>         | <b>4450</b>  | 100             | 10/15/2022 | ND              | 225 | 112        | 200           | 3.68 |           |
| <b>DRO &gt;C10-C28*</b>    | <b>29100</b> | 100             | 10/15/2022 | ND              | 231 | 116        | 200           | 3.10 |           |
| <b>EXT DRO &gt;C28-C36</b> | <b>5820</b>  | 100             | 10/15/2022 | ND              |     |            |               |      |           |

Surrogate: 1-Chlorooctane 809 % 45.3-161

Surrogate: 1-Chlorooctadecane 1120 % 46.3-178

Cardinal Laboratories

\*=Accredited Analyte

PLEASE NOTE: Liability and Damages. Cardinal's liability and client's exclusive remedy for any claim arising, whether based in contract or tort, shall be limited to the amount paid by client for analyses. All claims, including those for negligence and any other cause whatsoever shall be deemed waived unless made in writing and received by Cardinal within thirty (30) days after completion of the applicable service. In no event shall Cardinal be liable for incidental or consequential damages, including, without limitation, business interruptions, loss of use, or loss of profits incurred by client, its subsidiaries, affiliates or successors arising out of or related to the performance of the services hereunder by Cardinal, regardless of whether such claim is based upon any of the above stated reasons or otherwise. Results relate only to the samples identified above. This report shall not be reproduced except in full with written approval of Cardinal Laboratories.

Celey D. Keene, Lab Director/Quality Manager



PHONE (575) 393-2326 ° 101 E. MARLAND ° HOBBS, NM 88240

**Analytical Results For:**

APACHE CORP - HOBBS  
 BRUCE BAKER  
 2350 W. MARLAND BLVD.  
 HOBBS NM, 88240  
 Fax To: (575) 393-2432

Received: 10/13/2022  
 Reported: 10/18/2022  
 Project Name: MCCALISTER CTB  
 Project Number: NONE GIVEN  
 Project Location: NOT GIVEN

Sampling Date: 10/13/2022  
 Sampling Type: Soil  
 Sampling Condition: Cool & Intact  
 Sample Received By: Tamara Oldaker

**Sample ID: SP 1 @ 1' (H224830-04)**

| BTX 8021B             |              | mg/kg           |            | Analyzed By: JH |      |            |               | S-04  |           |
|-----------------------|--------------|-----------------|------------|-----------------|------|------------|---------------|-------|-----------|
| Analyte               | Result       | Reporting Limit | Analyzed   | Method Blank    | BS   | % Recovery | True Value QC | RPD   | Qualifier |
| <b>Benzene*</b>       | <b>0.224</b> | 0.100           | 10/17/2022 | ND              | 2.14 | 107        | 2.00          | 3.58  |           |
| <b>Toluene*</b>       | <b>5.32</b>  | 0.100           | 10/17/2022 | ND              | 2.06 | 103        | 2.00          | 3.64  |           |
| <b>Ethylbenzene*</b>  | <b>11.1</b>  | 0.100           | 10/17/2022 | ND              | 2.05 | 103        | 2.00          | 0.866 |           |
| <b>Total Xylenes*</b> | <b>13.9</b>  | 0.300           | 10/17/2022 | ND              | 6.19 | 103        | 6.00          | 0.946 |           |
| <b>Total BTX</b>      | <b>30.6</b>  | 0.600           | 10/17/2022 | ND              |      |            |               |       |           |

Surrogate: 4-Bromofluorobenzene (PID) 187 % 69.9-140

| Chloride, SM4500CI-B |            | mg/kg           |            | Analyzed By: GM |     |            |               |      |           |
|----------------------|------------|-----------------|------------|-----------------|-----|------------|---------------|------|-----------|
| Analyte              | Result     | Reporting Limit | Analyzed   | Method Blank    | BS  | % Recovery | True Value QC | RPD  | Qualifier |
| <b>Chloride</b>      | <b>768</b> | 16.0            | 10/17/2022 | ND              | 432 | 108        | 400           | 0.00 |           |

| TPH 8015M                  |             | mg/kg           |            | Analyzed By: MS |     |            |               | S-06 |           |
|----------------------------|-------------|-----------------|------------|-----------------|-----|------------|---------------|------|-----------|
| Analyte                    | Result      | Reporting Limit | Analyzed   | Method Blank    | BS  | % Recovery | True Value QC | RPD  | Qualifier |
| <b>GRO C6-C10*</b>         | <b>315</b>  | 100             | 10/15/2022 | ND              | 225 | 112        | 200           | 3.68 |           |
| <b>DRO &gt;C10-C28*</b>    | <b>6690</b> | 100             | 10/15/2022 | ND              | 231 | 116        | 200           | 3.10 |           |
| <b>EXT DRO &gt;C28-C36</b> | <b>2300</b> | 100             | 10/15/2022 | ND              |     |            |               |      |           |

Surrogate: 1-Chlorooctane 140 % 45.3-161

Surrogate: 1-Chlorooctadecane 221 % 46.3-178

Cardinal Laboratories

\*=Accredited Analyte

PLEASE NOTE: Liability and Damages. Cardinal's liability and client's exclusive remedy for any claim arising, whether based in contract or tort, shall be limited to the amount paid by client for analyses. All claims, including those for negligence and any other cause whatsoever shall be deemed waived unless made in writing and received by Cardinal within thirty (30) days after completion of the applicable service. In no event shall Cardinal be liable for incidental or consequential damages, including, without limitation, business interruptions, loss of use, or loss of profits incurred by client, its subsidiaries, affiliates or successors arising out of or related to the performance of the services hereunder by Cardinal, regardless of whether such claim is based upon any of the above stated reasons or otherwise. Results relate only to the samples identified above. This report shall not be reproduced except in full with written approval of Cardinal Laboratories.

Celey D. Keene, Lab Director/Quality Manager



PHONE (575) 393-2326 ° 101 E. MARLAND ° HOBBS, NM 88240

**Analytical Results For:**

APACHE CORP - HOBBS  
 BRUCE BAKER  
 2350 W. MARLAND BLVD.  
 HOBBS NM, 88240  
 Fax To: (575) 393-2432

|                   |                |                     |                |
|-------------------|----------------|---------------------|----------------|
| Received:         | 10/13/2022     | Sampling Date:      | 10/13/2022     |
| Reported:         | 10/18/2022     | Sampling Type:      | Soil           |
| Project Name:     | MCCALISTER CTB | Sampling Condition: | Cool & Intact  |
| Project Number:   | NONE GIVEN     | Sample Received By: | Tamara Oldaker |
| Project Location: | NOT GIVEN      |                     |                |

**Sample ID: SP 2 @ 1' (H224830-05)**

| BTEX 8021B     |        | mg/kg           |            | Analyzed By: JH |      |            |               |       |           |
|----------------|--------|-----------------|------------|-----------------|------|------------|---------------|-------|-----------|
| Analyte        | Result | Reporting Limit | Analyzed   | Method Blank    | BS   | % Recovery | True Value QC | RPD   | Qualifier |
| Benzene*       | <0.500 | 0.500           | 10/15/2022 | ND              | 2.14 | 107        | 2.00          | 3.58  |           |
| Toluene*       | 9.30   | 0.500           | 10/15/2022 | ND              | 2.06 | 103        | 2.00          | 3.64  |           |
| Ethylbenzene*  | 17.8   | 0.500           | 10/15/2022 | ND              | 2.05 | 103        | 2.00          | 0.866 |           |
| Total Xylenes* | 28.4   | 1.50            | 10/15/2022 | ND              | 6.19 | 103        | 6.00          | 0.946 |           |
| Total BTEX     | 55.5   | 3.00            | 10/15/2022 | ND              |      |            |               |       |           |

Surrogate: 4-Bromofluorobenzene (PID) 106 % 69.9-140

| Chloride, SM4500CI-B |        | mg/kg           |            | Analyzed By: GM |     |            |               |      |           |      |
|----------------------|--------|-----------------|------------|-----------------|-----|------------|---------------|------|-----------|------|
| Analyte              | Result | Reporting Limit | Analyzed   | Method Blank    | BS  | % Recovery | True Value QC | RPD  | Qualifier |      |
| Chloride             | 320    | 16.0            | 10/17/2022 | ND              | 432 | 108        | 400           | 0.00 |           |      |
| TPH 8015M            |        | mg/kg           |            | Analyzed By: MS |     |            |               |      |           | S-06 |

Surrogate: 1-Chlorooctane 211 % 45.3-161

Surrogate: 1-Chlorooctadecane 378 % 46.3-178

Cardinal Laboratories

\*=Accredited Analyte

PLEASE NOTE: Liability and Damages. Cardinal's liability and client's exclusive remedy for any claim arising, whether based in contract or tort, shall be limited to the amount paid by client for analyses. All claims, including those for negligence and any other cause whatsoever shall be deemed waived unless made in writing and received by Cardinal within thirty (30) days after completion of the applicable service. In no event shall Cardinal be liable for incidental or consequential damages, including, without limitation, business interruptions, loss of use, or loss of profits incurred by client, its subsidiaries, affiliates or successors arising out of or related to the performance of the services hereunder by Cardinal, regardless of whether such claim is based upon any of the above stated reasons or otherwise. Results relate only to the samples identified above. This report shall not be reproduced except in full with written approval of Cardinal Laboratories.

Celey D. Keene, Lab Director/Quality Manager





PHONE (575) 393-2326 ° 101 E. MARLAND ° HOBBS, NM 88240

**Analytical Results For:**

APACHE CORP - HOBBS  
 BRUCE BAKER  
 2350 W. MARLAND BLVD.  
 HOBBS NM, 88240  
 Fax To: (575) 393-2432

Received: 10/13/2022  
 Reported: 10/18/2022  
 Project Name: MCCALISTER CTB  
 Project Number: NONE GIVEN  
 Project Location: NOT GIVEN

Sampling Date: 10/13/2022  
 Sampling Type: Soil  
 Sampling Condition: Cool & Intact  
 Sample Received By: Tamara Oldaker

**Sample ID: SP 3 @ 1' (H224830-06)**

| BTX 8021B      |        | mg/kg           |            | Analyzed By: JH |      |            |               |       |           |
|----------------|--------|-----------------|------------|-----------------|------|------------|---------------|-------|-----------|
| Analyte        | Result | Reporting Limit | Analyzed   | Method Blank    | BS   | % Recovery | True Value QC | RPD   | Qualifier |
| Benzene*       | <0.500 | 0.500           | 10/15/2022 | ND              | 2.14 | 107        | 2.00          | 3.58  |           |
| Toluene*       | 27.8   | 0.500           | 10/15/2022 | ND              | 2.06 | 103        | 2.00          | 3.64  |           |
| Ethylbenzene*  | 55.2   | 0.500           | 10/15/2022 | ND              | 2.05 | 103        | 2.00          | 0.866 |           |
| Total Xylenes* | 81.2   | 1.50            | 10/15/2022 | ND              | 6.19 | 103        | 6.00          | 0.946 |           |
| Total BTX      | 164    | 3.00            | 10/15/2022 | ND              |      |            |               |       |           |

Surrogate: 4-Bromofluorobenzene (PID) 126 % 69.9-140

| Chloride, SM4500CI-B |        | mg/kg           |            | Analyzed By: GM |     |            |               |      |           |      |
|----------------------|--------|-----------------|------------|-----------------|-----|------------|---------------|------|-----------|------|
| Analyte              | Result | Reporting Limit | Analyzed   | Method Blank    | BS  | % Recovery | True Value QC | RPD  | Qualifier |      |
| Chloride             | 80.0   | 16.0            | 10/17/2022 | ND              | 432 | 108        | 400           | 0.00 |           |      |
| TPH 8015M            |        | mg/kg           |            | Analyzed By: MS |     |            |               |      |           | S-06 |

Surrogate: 1-Chlorooctane 270 % 45.3-161

Surrogate: 1-Chlorooctadecane 365 % 46.3-178

Cardinal Laboratories

\*=Accredited Analyte

PLEASE NOTE: Liability and Damages. Cardinal's liability and client's exclusive remedy for any claim arising, whether based in contract or tort, shall be limited to the amount paid by client for analyses. All claims, including those for negligence and any other cause whatsoever shall be deemed waived unless made in writing and received by Cardinal within thirty (30) days after completion of the applicable service. In no event shall Cardinal be liable for incidental or consequential damages, including, without limitation, business interruptions, loss of use, or loss of profits incurred by client, its subsidiaries, affiliates or successors arising out of or related to the performance of the services hereunder by Cardinal, regardless of whether such claim is based upon any of the above stated reasons or otherwise. Results relate only to the samples identified above. This report shall not be reproduced except in full with written approval of Cardinal Laboratories.

Celey D. Keene, Lab Director/Quality Manager



PHONE (575) 393-2326 • 101 E. MARLAND • HOBBS, NM 88240

### Notes and Definitions

|       |  |
|-------|--|
| S-06  | The recovery of this surrogate is outside control limits due to sample dilution required from high analyte concentration and/or matrix interference's.         |
| S-04  | The surrogate recovery for this sample is outside of established control limits due to a sample matrix effect.   |
| QM-07 | The spike recovery was outside acceptance limits for the MS and/or MSD. The batch was accepted based on acceptable LCS recovery.                               |
| ND    | Analyte NOT DETECTED at or above the reporting limit   |
| RPD   | Relative Percent Difference  |
| **    | Samples not received at proper temperature of 6°C or below.  |
| ***   | Insufficient time to reach temperature.  |
| -     | Chloride by SM4500Cl-B does not require samples be received at or below 6°C<br>Samples reported on an as received basis (wet) unless otherwise noted on report |

Cardinal Laboratories

\*=Accredited Analyte

PLEASE NOTE: Liability and Damages. Cardinal's liability and client's exclusive remedy for any claim arising, whether based in contract or tort, shall be limited to the amount paid by client for analyses. All claims, including those for negligence and any other cause whatsoever shall be deemed waived unless made in writing and received by Cardinal within thirty (30) days after completion of the applicable service. In no event shall Cardinal be liable for incidental or consequential damages, including, without limitation, business interruptions, loss of use, or loss of profits incurred by client, its subsidiaries, affiliates or successors arising out of or related to the performance of the services hereunder by Cardinal, regardless of whether such claim is based upon any of the above stated reasons or otherwise. Results relate only to the samples identified above. This report shall not be reproduced except in full with written approval of Cardinal Laboratories.

A handwritten signature in black ink, appearing to read "Celey D. Keene", is written over a horizontal line.

Celey D. Keene, Lab Director/Quality Manager



PHONE (575) 393-2326 ° 101 E. MARLAND ° HOBBS, NM 88240

---

November 16, 2022

BRUCE BAKER

APACHE CORP - HOBBS

2350 W. MARLAND BLVD.

HOBBS, NM 88240

RE: MCCALISTER CTB

Enclosed are the results of analyses for samples received by the laboratory on 11/10/22 16:33.

Cardinal Laboratories is accredited through Texas NELAP under certificate number T104704398-22-15. Accreditation applies to drinking water, non-potable water and solid and chemical materials. All accredited analytes are denoted by an asterisk (\*). For a complete list of accredited analytes and matrices visit the TCEQ website at [www.tceq.texas.gov/field/qa/lab\\_accred\\_certif.html](http://www.tceq.texas.gov/field/qa/lab_accred_certif.html).

Cardinal Laboratories is accredited through the State of Colorado Department of Public Health and Environment for:

|                  |                              |
|------------------|------------------------------|
| Method EPA 552.2 | Haloacetic Acids (HAA-5)     |
| Method EPA 524.2 | Total Trihalomethanes (TTHM) |
| Method EPA 524.4 | Regulated VOCs (V1, V2, V3)  |

Accreditation applies to public drinking water matrices.

This report meets NELAP requirements and is made up of a cover page, analytical results, and a copy of the original chain-of-custody. If you have any questions concerning this report, please feel free to contact me.

Sincerely,

A handwritten signature in black ink that reads "Celey D. Keene". The signature is written in a cursive, flowing style.

Celey D. Keene

Lab Director/Quality Manager





PHONE (575) 393-2326 ° 101 E. MARLAND ° HOBBS, NM 88240

**Analytical Results For:**

APACHE CORP - HOBBS  
 BRUCE BAKER  
 2350 W. MARLAND BLVD.  
 HOBBS NM, 88240  
 Fax To: (575) 393-2432

|                   |                |                     |                |
|-------------------|----------------|---------------------|----------------|
| Received:         | 11/10/2022     | Sampling Date:      | 11/10/2022     |
| Reported:         | 11/16/2022     | Sampling Type:      | Soil           |
| Project Name:     | MCCALISTER CTB | Sampling Condition: | Cool & Intact  |
| Project Number:   | NONE GIVEN     | Sample Received By: | Tamara Oldaker |
| Project Location: | NOT GIVEN      |                     |                |

**Sample ID: SP 1 @ 2' (H225351-01)**

| BTEX 8021B            |             | mg/kg           |            | Analyzed By: JH |      |            |               |       |           |
|-----------------------|-------------|-----------------|------------|-----------------|------|------------|---------------|-------|-----------|
| Analyte               | Result      | Reporting Limit | Analyzed   | Method Blank    | BS   | % Recovery | True Value QC | RPD   | Qualifier |
| Benzene*              | <1.00       | 1.00            | 11/14/2022 | ND              | 2.00 | 99.8       | 2.00          | 0.859 |           |
| <b>Toluene*</b>       | <b>14.7</b> | 1.00            | 11/14/2022 | ND              | 2.11 | 105        | 2.00          | 0.598 |           |
| <b>Ethylbenzene*</b>  | <b>30.1</b> | 1.00            | 11/14/2022 | ND              | 2.05 | 102        | 2.00          | 0.489 |           |
| <b>Total Xylenes*</b> | <b>83.8</b> | 3.00            | 11/14/2022 | ND              | 6.21 | 104        | 6.00          | 0.194 |           |
| <b>Total BTEX</b>     | <b>129</b>  | 6.00            | 11/14/2022 | ND              |      |            |               |       |           |

Surrogate: 4-Bromofluorobenzene (PID) 114 % 69.9-140

| TPH 8015M                  |              | mg/kg           |            | Analyzed By: MS |     |            |               |      |           | S-06 |
|----------------------------|--------------|-----------------|------------|-----------------|-----|------------|---------------|------|-----------|------|
| Analyte                    | Result       | Reporting Limit | Analyzed   | Method Blank    | BS  | % Recovery | True Value QC | RPD  | Qualifier |      |
| <b>GRO C6-C10*</b>         | <b>1380</b>  | 100             | 11/14/2022 | ND              | 217 | 109        | 200           | 7.62 |           |      |
| <b>DRO &gt;C10-C28*</b>    | <b>14400</b> | 100             | 11/14/2022 | ND              | 231 | 115        | 200           | 7.63 |           |      |
| <b>EXT DRO &gt;C28-C36</b> | <b>3060</b>  | 100             | 11/14/2022 | ND              |     |            |               |      |           |      |

Surrogate: 1-Chlorooctane 319 % 45.3-161

Surrogate: 1-Chlorooctadecane 634 % 46.3-178

Cardinal Laboratories

\*=Accredited Analyte

PLEASE NOTE: Liability and Damages. Cardinal's liability and client's exclusive remedy for any claim arising, whether based in contract or tort, shall be limited to the amount paid by client for analyses. All claims, including those for negligence and any other cause whatsoever shall be deemed waived unless made in writing and received by Cardinal within thirty (30) days after completion of the applicable service. In no event shall Cardinal be liable for incidental or consequential damages, including, without limitation, business interruptions, loss of use, or loss of profits incurred by client, its subsidiaries, affiliates or successors arising out of or related to the performance of the services hereunder by Cardinal, regardless of whether such claim is based upon any of the above stated reasons or otherwise. Results relate only to the samples identified above. This report shall not be reproduced except in full with written approval of Cardinal Laboratories.

Celey D. Keene, Lab Director/Quality Manager



PHONE (575) 393-2326 ° 101 E. MARLAND ° HOBBS, NM 88240

**Analytical Results For:**

APACHE CORP - HOBBS  
 BRUCE BAKER  
 2350 W. MARLAND BLVD.  
 HOBBS NM, 88240  
 Fax To: (575) 393-2432

Received: 11/10/2022  
 Reported: 11/16/2022  
 Project Name: MCCALISTER CTB  
 Project Number: NONE GIVEN  
 Project Location: NOT GIVEN

Sampling Date: 11/10/2022  
 Sampling Type: Soil  
 Sampling Condition: Cool & Intact  
 Sample Received By: Tamara Oldaker

**Sample ID: SP 1 @ 3' (H225351-02)**

| BTEx 8021B            |              | mg/kg           | Analyzed By: JH |              |      |            |               | S-04  |           |
|-----------------------|--------------|-----------------|-----------------|--------------|------|------------|---------------|-------|-----------|
| Analyte               | Result       | Reporting Limit | Analyzed        | Method Blank | BS   | % Recovery | True Value QC | RPD   | Qualifier |
| Benzene*              | <0.050       | 0.050           | 11/14/2022      | ND           | 2.00 | 99.8       | 2.00          | 0.859 |           |
| <b>Toluene*</b>       | <b>0.932</b> | 0.050           | 11/14/2022      | ND           | 2.11 | 105        | 2.00          | 0.598 |           |
| <b>Ethylbenzene*</b>  | <b>2.43</b>  | 0.050           | 11/14/2022      | ND           | 2.05 | 102        | 2.00          | 0.489 |           |
| <b>Total Xylenes*</b> | <b>4.32</b>  | 0.150           | 11/14/2022      | ND           | 6.21 | 104        | 6.00          | 0.194 |           |
| <b>Total BTEX</b>     | <b>7.68</b>  | 0.300           | 11/14/2022      | ND           |      |            |               |       |           |

Surrogate: 4-Bromofluorobenzene (PID) 221 % 69.9-140

| Chloride, SM4500Cl-B |            | mg/kg           | Analyzed By: AC |              |     |            |               |      |           |
|----------------------|------------|-----------------|-----------------|--------------|-----|------------|---------------|------|-----------|
| Analyte              | Result     | Reporting Limit | Analyzed        | Method Blank | BS  | % Recovery | True Value QC | RPD  | Qualifier |
| <b>Chloride</b>      | <b>624</b> | 16.0            | 11/11/2022      | ND           | 400 | 100        | 400           | 3.92 |           |

| TPH 8015M                  |             | mg/kg           | Analyzed By: MS |              |     |            |               | S-06 |           |
|----------------------------|-------------|-----------------|-----------------|--------------|-----|------------|---------------|------|-----------|
| Analyte                    | Result      | Reporting Limit | Analyzed        | Method Blank | BS  | % Recovery | True Value QC | RPD  | Qualifier |
| <b>GRO C6-C10*</b>         | <b>147</b>  | 50.0            | 11/14/2022      | ND           | 217 | 109        | 200           | 7.62 |           |
| <b>DRO &gt;C10-C28*</b>    | <b>3590</b> | 50.0            | 11/14/2022      | ND           | 231 | 115        | 200           | 7.63 |           |
| <b>EXT DRO &gt;C28-C36</b> | <b>1120</b> | 50.0            | 11/14/2022      | ND           |     |            |               |      |           |

Surrogate: 1-Chlorooctane 107 % 45.3-161

Surrogate: 1-Chlorooctadecane 202 % 46.3-178

Cardinal Laboratories

\*=Accredited Analyte

PLEASE NOTE: Liability and Damages. Cardinal's liability and client's exclusive remedy for any claim arising, whether based in contract or tort, shall be limited to the amount paid by client for analyses. All claims, including those for negligence and any other cause whatsoever shall be deemed waived unless made in writing and received by Cardinal within thirty (30) days after completion of the applicable service. In no event shall Cardinal be liable for incidental or consequential damages, including, without limitation, business interruptions, loss of use, or loss of profits incurred by client, its subsidiaries, affiliates or successors arising out of or related to the performance of the services hereunder by Cardinal, regardless of whether such claim is based upon any of the above stated reasons or otherwise. Results relate only to the samples identified above. This report shall not be reproduced except in full with written approval of Cardinal Laboratories.

Celey D. Keene, Lab Director/Quality Manager



PHONE (575) 393-2326 ° 101 E. MARLAND ° HOBBS, NM 88240

**Analytical Results For:**

APACHE CORP - HOBBS  
 BRUCE BAKER  
 2350 W. MARLAND BLVD.  
 HOBBS NM, 88240  
 Fax To: (575) 393-2432

|                   |                |                     |                |
|-------------------|----------------|---------------------|----------------|
| Received:         | 11/10/2022     | Sampling Date:      | 11/10/2022     |
| Reported:         | 11/16/2022     | Sampling Type:      | Soil           |
| Project Name:     | MCCALISTER CTB | Sampling Condition: | Cool & Intact  |
| Project Number:   | NONE GIVEN     | Sample Received By: | Tamara Oldaker |
| Project Location: | NOT GIVEN      |                     |                |

**Sample ID: SP 1 @ 4' (H225351-03)**

| BTEx 8021B     |        | mg/kg           |            | Analyzed By: JH |      |            |               |       |           |
|----------------|--------|-----------------|------------|-----------------|------|------------|---------------|-------|-----------|
| Analyte        | Result | Reporting Limit | Analyzed   | Method Blank    | BS   | % Recovery | True Value QC | RPD   | Qualifier |
| Benzene*       | <0.050 | 0.050           | 11/14/2022 | ND              | 2.00 | 99.8       | 2.00          | 0.859 |           |
| Toluene*       | 0.082  | 0.050           | 11/14/2022 | ND              | 2.11 | 105        | 2.00          | 0.598 |           |
| Ethylbenzene*  | 0.375  | 0.050           | 11/14/2022 | ND              | 2.05 | 102        | 2.00          | 0.489 |           |
| Total Xylenes* | 0.768  | 0.150           | 11/14/2022 | ND              | 6.21 | 104        | 6.00          | 0.194 |           |
| Total BTEX     | 1.22   | 0.300           | 11/14/2022 | ND              |      |            |               |       |           |

Surrogate: 4-Bromofluorobenzene (PID) 101 % 69.9-140

| TPH 8015M        |        | mg/kg           |            | Analyzed By: MS |     |            |               |      |           |
|------------------|--------|-----------------|------------|-----------------|-----|------------|---------------|------|-----------|
| Analyte          | Result | Reporting Limit | Analyzed   | Method Blank    | BS  | % Recovery | True Value QC | RPD  | Qualifier |
| GRO C6-C10*      | <50.0  | 50.0            | 11/14/2022 | ND              | 217 | 109        | 200           | 7.62 |           |
| DRO >C10-C28*    | 759    | 50.0            | 11/14/2022 | ND              | 231 | 115        | 200           | 7.63 |           |
| EXT DRO >C28-C36 | 188    | 50.0            | 11/14/2022 | ND              |     |            |               |      |           |

Surrogate: 1-Chlorooctane 88.3 % 45.3-161

Surrogate: 1-Chlorooctadecane 124 % 46.3-178

Cardinal Laboratories

\*=Accredited Analyte

PLEASE NOTE: Liability and Damages. Cardinal's liability and client's exclusive remedy for any claim arising, whether based in contract or tort, shall be limited to the amount paid by client for analyses. All claims, including those for negligence and any other cause whatsoever shall be deemed waived unless made in writing and received by Cardinal within thirty (30) days after completion of the applicable service. In no event shall Cardinal be liable for incidental or consequential damages, including, without limitation, business interruptions, loss of use, or loss of profits incurred by client, its subsidiaries, affiliates or successors arising out of or related to the performance of the services hereunder by Cardinal, regardless of whether such claim is based upon any of the above stated reasons or otherwise. Results relate only to the samples identified above. This report shall not be reproduced except in full with written approval of Cardinal Laboratories.

Celey D. Keene, Lab Director/Quality Manager





PHONE (575) 393-2326 ° 101 E. MARLAND ° HOBBS, NM 88240

**Analytical Results For:**

APACHE CORP - HOBBS  
 BRUCE BAKER  
 2350 W. MARLAND BLVD.  
 HOBBS NM, 88240  
 Fax To: (575) 393-2432

|                   |                |                     |                |
|-------------------|----------------|---------------------|----------------|
| Received:         | 11/10/2022     | Sampling Date:      | 11/10/2022     |
| Reported:         | 11/16/2022     | Sampling Type:      | Soil           |
| Project Name:     | MCCALISTER CTB | Sampling Condition: | Cool & Intact  |
| Project Number:   | NONE GIVEN     | Sample Received By: | Tamara Oldaker |
| Project Location: | NOT GIVEN      |                     |                |

**Sample ID: SP 2 @ 2' (H225351-04)**

| BTEx 8021B            |              | mg/kg           |            | Analyzed By: JH |      |            |               |       |           |
|-----------------------|--------------|-----------------|------------|-----------------|------|------------|---------------|-------|-----------|
| Analyte               | Result       | Reporting Limit | Analyzed   | Method Blank    | BS   | % Recovery | True Value QC | RPD   | Qualifier |
| <b>Benzene*</b>       | <b>0.514</b> | 0.500           | 11/14/2022 | ND              | 2.00 | 99.8       | 2.00          | 0.859 |           |
| <b>Toluene*</b>       | <b>22.1</b>  | 0.500           | 11/14/2022 | ND              | 2.11 | 105        | 2.00          | 0.598 |           |
| <b>Ethylbenzene*</b>  | <b>42.2</b>  | 0.500           | 11/14/2022 | ND              | 2.05 | 102        | 2.00          | 0.489 |           |
| <b>Total Xylenes*</b> | <b>75.0</b>  | 1.50            | 11/14/2022 | ND              | 6.21 | 104        | 6.00          | 0.194 |           |
| <b>Total BTEX</b>     | <b>140</b>   | 3.00            | 11/14/2022 | ND              |      |            |               |       |           |

Surrogate: 4-Bromofluorobenzene (PID) 126 % 69.9-140

| TPH 8015M                  |              | mg/kg           |            | Analyzed By: MS |     |            |               |      |           | S-06 |
|----------------------------|--------------|-----------------|------------|-----------------|-----|------------|---------------|------|-----------|------|
| Analyte                    | Result       | Reporting Limit | Analyzed   | Method Blank    | BS  | % Recovery | True Value QC | RPD  | Qualifier |      |
| <b>GRO C6-C10*</b>         | <b>1900</b>  | 100             | 11/14/2022 | ND              | 217 | 109        | 200           | 7.62 |           |      |
| <b>DRO &gt;C10-C28*</b>    | <b>16600</b> | 100             | 11/14/2022 | ND              | 231 | 115        | 200           | 7.63 |           |      |
| <b>EXT DRO &gt;C28-C36</b> | <b>3540</b>  | 100             | 11/14/2022 | ND              |     |            |               |      |           |      |

Surrogate: 1-Chlorooctane 413 % 45.3-161

Surrogate: 1-Chlorooctadecane 727 % 46.3-178

Cardinal Laboratories

\*=Accredited Analyte

PLEASE NOTE: Liability and Damages. Cardinal's liability and client's exclusive remedy for any claim arising, whether based in contract or tort, shall be limited to the amount paid by client for analyses. All claims, including those for negligence and any other cause whatsoever shall be deemed waived unless made in writing and received by Cardinal within thirty (30) days after completion of the applicable service. In no event shall Cardinal be liable for incidental or consequential damages, including, without limitation, business interruptions, loss of use, or loss of profits incurred by client, its subsidiaries, affiliates or successors arising out of or related to the performance of the services hereunder by Cardinal, regardless of whether such claim is based upon any of the above stated reasons or otherwise. Results relate only to the samples identified above. This report shall not be reproduced except in full with written approval of Cardinal Laboratories.

Celey D. Keene, Lab Director/Quality Manager



PHONE (575) 393-2326 ° 101 E. MARLAND ° HOBBS, NM 88240

**Analytical Results For:**

APACHE CORP - HOBBS  
 BRUCE BAKER  
 2350 W. MARLAND BLVD.  
 HOBBS NM, 88240  
 Fax To: (575) 393-2432

|                   |                |                     |                |
|-------------------|----------------|---------------------|----------------|
| Received:         | 11/10/2022     | Sampling Date:      | 11/10/2022     |
| Reported:         | 11/16/2022     | Sampling Type:      | Soil           |
| Project Name:     | MCCALISTER CTB | Sampling Condition: | Cool & Intact  |
| Project Number:   | NONE GIVEN     | Sample Received By: | Tamara Oldaker |
| Project Location: | NOT GIVEN      |                     |                |

**Sample ID: SP 2 @ 3' (H225351-05)**

| BTX 8021B      |        | mg/kg           |            | Analyzed By: JH |      |            |               | S-04  |           |
|----------------|--------|-----------------|------------|-----------------|------|------------|---------------|-------|-----------|
| Analyte        | Result | Reporting Limit | Analyzed   | Method Blank    | BS   | % Recovery | True Value QC | RPD   | Qualifier |
| Benzene*       | <0.050 | 0.050           | 11/14/2022 | ND              | 2.00 | 99.8       | 2.00          | 0.859 |           |
| Toluene*       | 1.18   | 0.050           | 11/14/2022 | ND              | 2.11 | 105        | 2.00          | 0.598 |           |
| Ethylbenzene*  | 4.80   | 0.050           | 11/14/2022 | ND              | 2.05 | 102        | 2.00          | 0.489 |           |
| Total Xylenes* | 15.0   | 0.150           | 11/14/2022 | ND              | 6.21 | 104        | 6.00          | 0.194 |           |
| Total BTX      | 21.0   | 0.300           | 11/14/2022 | ND              |      |            |               |       |           |

Surrogate: 4-Bromofluorobenzene (PID) 287 % 69.9-140

| TPH 8015M        |        | mg/kg           |            | Analyzed By: MS |     |            |               | S-06 |           |
|------------------|--------|-----------------|------------|-----------------|-----|------------|---------------|------|-----------|
| Analyte          | Result | Reporting Limit | Analyzed   | Method Blank    | BS  | % Recovery | True Value QC | RPD  | Qualifier |
| GRO C6-C10*      | 499    | 50.0            | 11/14/2022 | ND              | 217 | 109        | 200           | 7.62 |           |
| DRO >C10-C28*    | 6600   | 50.0            | 11/14/2022 | ND              | 231 | 115        | 200           | 7.63 |           |
| EXT DRO >C28-C36 | 1390   | 50.0            | 11/14/2022 | ND              |     |            |               |      |           |

Surrogate: 1-Chlorooctane 165 % 45.3-161

Surrogate: 1-Chlorooctadecane 352 % 46.3-178

Cardinal Laboratories

\*=Accredited Analyte

PLEASE NOTE: Liability and Damages. Cardinal's liability and client's exclusive remedy for any claim arising, whether based in contract or tort, shall be limited to the amount paid by client for analyses. All claims, including those for negligence and any other cause whatsoever shall be deemed waived unless made in writing and received by Cardinal within thirty (30) days after completion of the applicable service. In no event shall Cardinal be liable for incidental or consequential damages, including, without limitation, business interruptions, loss of use, or loss of profits incurred by client, its subsidiaries, affiliates or successors arising out of or related to the performance of the services hereunder by Cardinal, regardless of whether such claim is based upon any of the above stated reasons or otherwise. Results relate only to the samples identified above. This report shall not be reproduced except in full with written approval of Cardinal Laboratories.

Celey D. Keene, Lab Director/Quality Manager



PHONE (575) 393-2326 ° 101 E. MARLAND ° HOBBS, NM 88240

**Analytical Results For:**

APACHE CORP - HOBBS  
 BRUCE BAKER  
 2350 W. MARLAND BLVD.  
 HOBBS NM, 88240  
 Fax To: (575) 393-2432

|                   |                |                     |                |
|-------------------|----------------|---------------------|----------------|
| Received:         | 11/10/2022     | Sampling Date:      | 11/10/2022     |
| Reported:         | 11/16/2022     | Sampling Type:      | Soil           |
| Project Name:     | MCCALISTER CTB | Sampling Condition: | Cool & Intact  |
| Project Number:   | NONE GIVEN     | Sample Received By: | Tamara Oldaker |
| Project Location: | NOT GIVEN      |                     |                |

**Sample ID: SP 2 @ 3'2" (H225351-06)**

| BTX 8021B      |        | mg/kg           |            | Analyzed By: JH |      |            |               |       |           |
|----------------|--------|-----------------|------------|-----------------|------|------------|---------------|-------|-----------|
| Analyte        | Result | Reporting Limit | Analyzed   | Method Blank    | BS   | % Recovery | True Value QC | RPD   | Qualifier |
| Benzene*       | <0.050 | 0.050           | 11/14/2022 | ND              | 2.00 | 99.8       | 2.00          | 0.859 |           |
| Toluene*       | 0.088  | 0.050           | 11/14/2022 | ND              | 2.11 | 105        | 2.00          | 0.598 |           |
| Ethylbenzene*  | 0.529  | 0.050           | 11/14/2022 | ND              | 2.05 | 102        | 2.00          | 0.489 |           |
| Total Xylenes* | 1.18   | 0.150           | 11/14/2022 | ND              | 6.21 | 104        | 6.00          | 0.194 |           |
| Total BTX      | 1.79   | 0.300           | 11/14/2022 | ND              |      |            |               |       |           |

Surrogate: 4-Bromofluorobenzene (PID) 112 % 69.9-140

| TPH 8015M        |        | mg/kg           |            | Analyzed By: MS |     |            |               |      |           |
|------------------|--------|-----------------|------------|-----------------|-----|------------|---------------|------|-----------|
| Analyte          | Result | Reporting Limit | Analyzed   | Method Blank    | BS  | % Recovery | True Value QC | RPD  | Qualifier |
| GRO C6-C10*      | <50.0  | 50.0            | 11/14/2022 | ND              | 217 | 109        | 200           | 7.62 |           |
| DRO >C10-C28*    | 957    | 50.0            | 11/14/2022 | ND              | 231 | 115        | 200           | 7.63 |           |
| EXT DRO >C28-C36 | 243    | 50.0            | 11/14/2022 | ND              |     |            |               |      |           |

Surrogate: 1-Chlorooctane 95.8 % 45.3-161

Surrogate: 1-Chlorooctadecane 136 % 46.3-178

Cardinal Laboratories

\*=Accredited Analyte

PLEASE NOTE: Liability and Damages. Cardinal's liability and client's exclusive remedy for any claim arising, whether based in contract or tort, shall be limited to the amount paid by client for analyses. All claims, including those for negligence and any other cause whatsoever shall be deemed waived unless made in writing and received by Cardinal within thirty (30) days after completion of the applicable service. In no event shall Cardinal be liable for incidental or consequential damages, including, without limitation, business interruptions, loss of use, or loss of profits incurred by client, its subsidiaries, affiliates or successors arising out of or related to the performance of the services hereunder by Cardinal, regardless of whether such claim is based upon any of the above stated reasons or otherwise. Results relate only to the samples identified above. This report shall not be reproduced except in full with written approval of Cardinal Laboratories.

Celey D. Keene, Lab Director/Quality Manager





PHONE (575) 393-2326 ° 101 E. MARLAND ° HOBBS, NM 88240

**Analytical Results For:**

APACHE CORP - HOBBS  
 BRUCE BAKER  
 2350 W. MARLAND BLVD.  
 HOBBS NM, 88240  
 Fax To: (575) 393-2432

|                   |                |                     |                |
|-------------------|----------------|---------------------|----------------|
| Received:         | 11/10/2022     | Sampling Date:      | 11/10/2022     |
| Reported:         | 11/16/2022     | Sampling Type:      | Soil           |
| Project Name:     | MCCALISTER CTB | Sampling Condition: | Cool & Intact  |
| Project Number:   | NONE GIVEN     | Sample Received By: | Tamara Oldaker |
| Project Location: | NOT GIVEN      |                     |                |

**Sample ID: SP 3 @ 2' (H225351-07)**

| BTEx 8021B     |        | mg/kg           |            | Analyzed By: JH |      |            |               |       |           |
|----------------|--------|-----------------|------------|-----------------|------|------------|---------------|-------|-----------|
| Analyte        | Result | Reporting Limit | Analyzed   | Method Blank    | BS   | % Recovery | True Value QC | RPD   | Qualifier |
| Benzene*       | <0.500 | 0.500           | 11/14/2022 | ND              | 2.00 | 99.8       | 2.00          | 0.859 |           |
| Toluene*       | 25.4   | 0.500           | 11/14/2022 | ND              | 2.11 | 105        | 2.00          | 0.598 |           |
| Ethylbenzene*  | 46.0   | 0.500           | 11/14/2022 | ND              | 2.05 | 102        | 2.00          | 0.489 |           |
| Total Xylenes* | 85.0   | 1.50            | 11/14/2022 | ND              | 6.21 | 104        | 6.00          | 0.194 |           |
| Total BTEX     | 156    | 3.00            | 11/14/2022 | ND              |      |            |               |       |           |

Surrogate: 4-Bromofluorobenzene (PID) 131 % 69.9-140

| TPH 8015M        |        | mg/kg           |            | Analyzed By: MS |     |            |               |      |           | S-06 |
|------------------|--------|-----------------|------------|-----------------|-----|------------|---------------|------|-----------|------|
| Analyte          | Result | Reporting Limit | Analyzed   | Method Blank    | BS  | % Recovery | True Value QC | RPD  | Qualifier |      |
| GRO C6-C10*      | 1960   | 100             | 11/14/2022 | ND              | 217 | 109        | 200           | 7.62 |           |      |
| DRO >C10-C28*    | 16000  | 100             | 11/14/2022 | ND              | 231 | 115        | 200           | 7.63 |           |      |
| EXT DRO >C28-C36 | 6360   | 100             | 11/14/2022 | ND              |     |            |               |      |           |      |

Surrogate: 1-Chlorooctane 349 % 45.3-161

Surrogate: 1-Chlorooctadecane 649 % 46.3-178

Cardinal Laboratories

\*=Accredited Analyte

PLEASE NOTE: Liability and Damages. Cardinal's liability and client's exclusive remedy for any claim arising, whether based in contract or tort, shall be limited to the amount paid by client for analyses. All claims, including those for negligence and any other cause whatsoever shall be deemed waived unless made in writing and received by Cardinal within thirty (30) days after completion of the applicable service. In no event shall Cardinal be liable for incidental or consequential damages, including, without limitation, business interruptions, loss of use, or loss of profits incurred by client, its subsidiaries, affiliates or successors arising out of or related to the performance of the services hereunder by Cardinal, regardless of whether such claim is based upon any of the above stated reasons or otherwise. Results relate only to the samples identified above. This report shall not be reproduced except in full with written approval of Cardinal Laboratories.

Celey D. Keene, Lab Director/Quality Manager



PHONE (575) 393-2326 ° 101 E. MARLAND ° HOBBS, NM 88240

**Analytical Results For:**

APACHE CORP - HOBBS  
 BRUCE BAKER  
 2350 W. MARLAND BLVD.  
 HOBBS NM, 88240  
 Fax To: (575) 393-2432

|                   |                |                     |                |
|-------------------|----------------|---------------------|----------------|
| Received:         | 11/10/2022     | Sampling Date:      | 11/10/2022     |
| Reported:         | 11/16/2022     | Sampling Type:      | Soil           |
| Project Name:     | MCCALISTER CTB | Sampling Condition: | Cool & Intact  |
| Project Number:   | NONE GIVEN     | Sample Received By: | Tamara Oldaker |
| Project Location: | NOT GIVEN      |                     |                |

**Sample ID: SP 3 @ 3' (H225351-08)**

| BTX 8021B      |              | mg/kg           |            | Analyzed By: JH |      |            |               | S-04  |           |
|----------------|--------------|-----------------|------------|-----------------|------|------------|---------------|-------|-----------|
| Analyte        | Result       | Reporting Limit | Analyzed   | Method Blank    | BS   | % Recovery | True Value QC | RPD   | Qualifier |
| Benzene*       | <0.050       | 0.050           | 11/14/2022 | ND              | 2.00 | 99.8       | 2.00          | 0.859 |           |
| Toluene*       | <b>0.780</b> | 0.050           | 11/14/2022 | ND              | 2.11 | 105        | 2.00          | 0.598 |           |
| Ethylbenzene*  | <b>3.65</b>  | 0.050           | 11/14/2022 | ND              | 2.05 | 102        | 2.00          | 0.489 |           |
| Total Xylenes* | <b>7.00</b>  | 0.150           | 11/14/2022 | ND              | 6.21 | 104        | 6.00          | 0.194 |           |
| Total BTX      | <b>11.4</b>  | 0.300           | 11/14/2022 | ND              |      |            |               |       |           |

Surrogate: 4-Bromofluorobenzene (PID) 176 % 69.9-140

| TPH 8015M        |             | mg/kg           |            | Analyzed By: MS |     |            |               | S-06 |           |
|------------------|-------------|-----------------|------------|-----------------|-----|------------|---------------|------|-----------|
| Analyte          | Result      | Reporting Limit | Analyzed   | Method Blank    | BS  | % Recovery | True Value QC | RPD  | Qualifier |
| GRO C6-C10*      | <b>191</b>  | 50.0            | 11/14/2022 | ND              | 217 | 109        | 200           | 7.62 |           |
| DRO >C10-C28*    | <b>3240</b> | 50.0            | 11/14/2022 | ND              | 231 | 115        | 200           | 7.63 |           |
| EXT DRO >C28-C36 | <b>827</b>  | 50.0            | 11/14/2022 | ND              |     |            |               |      |           |

Surrogate: 1-Chlorooctane 120 % 45.3-161

Surrogate: 1-Chlorooctadecane 221 % 46.3-178

Cardinal Laboratories

\*=Accredited Analyte

PLEASE NOTE: Liability and Damages. Cardinal's liability and client's exclusive remedy for any claim arising, whether based in contract or tort, shall be limited to the amount paid by client for analyses. All claims, including those for negligence and any other cause whatsoever shall be deemed waived unless made in writing and received by Cardinal within thirty (30) days after completion of the applicable service. In no event shall Cardinal be liable for incidental or consequential damages, including, without limitation, business interruptions, loss of use, or loss of profits incurred by client, its subsidiaries, affiliates or successors arising out of or related to the performance of the services hereunder by Cardinal, regardless of whether such claim is based upon any of the above stated reasons or otherwise. Results relate only to the samples identified above. This report shall not be reproduced except in full with written approval of Cardinal Laboratories.

Celey D. Keene, Lab Director/Quality Manager



PHONE (575) 393-2326 ° 101 E. MARLAND ° HOBBS, NM 88240

**Analytical Results For:**

APACHE CORP - HOBBS  
 BRUCE BAKER  
 2350 W. MARLAND BLVD.  
 HOBBS NM, 88240  
 Fax To: (575) 393-2432

|                   |                |                     |                |
|-------------------|----------------|---------------------|----------------|
| Received:         | 11/10/2022     | Sampling Date:      | 11/10/2022     |
| Reported:         | 11/16/2022     | Sampling Type:      | Soil           |
| Project Name:     | MCCALISTER CTB | Sampling Condition: | Cool & Intact  |
| Project Number:   | NONE GIVEN     | Sample Received By: | Tamara Oldaker |
| Project Location: | NOT GIVEN      |                     |                |

**Sample ID: SP 3 @ 4' (H225351-09)**

| BTX 8021B      |              | mg/kg           |            | Analyzed By: JH |      |            |               | S-04  |           |
|----------------|--------------|-----------------|------------|-----------------|------|------------|---------------|-------|-----------|
| Analyte        | Result       | Reporting Limit | Analyzed   | Method Blank    | BS   | % Recovery | True Value QC | RPD   | Qualifier |
| Benzene*       | <0.050       | 0.050           | 11/14/2022 | ND              | 2.00 | 99.8       | 2.00          | 0.859 |           |
| Toluene*       | <b>0.956</b> | 0.050           | 11/14/2022 | ND              | 2.11 | 105        | 2.00          | 0.598 |           |
| Ethylbenzene*  | <b>4.42</b>  | 0.050           | 11/14/2022 | ND              | 2.05 | 102        | 2.00          | 0.489 |           |
| Total Xylenes* | <b>8.37</b>  | 0.150           | 11/14/2022 | ND              | 6.21 | 104        | 6.00          | 0.194 |           |
| Total BTX      | <b>13.7</b>  | 0.300           | 11/14/2022 | ND              |      |            |               |       |           |

Surrogate: 4-Bromofluorobenzene (PID) 188 % 69.9-140

| TPH 8015M        |             | mg/kg           |            | Analyzed By: MS |     |            |               | S-06 |           |
|------------------|-------------|-----------------|------------|-----------------|-----|------------|---------------|------|-----------|
| Analyte          | Result      | Reporting Limit | Analyzed   | Method Blank    | BS  | % Recovery | True Value QC | RPD  | Qualifier |
| GRO C6-C10*      | <b>252</b>  | 50.0            | 11/14/2022 | ND              | 217 | 109        | 200           | 7.62 |           |
| DRO >C10-C28*    | <b>4040</b> | 50.0            | 11/14/2022 | ND              | 231 | 115        | 200           | 7.63 |           |
| EXT DRO >C28-C36 | <b>875</b>  | 50.0            | 11/14/2022 | ND              |     |            |               |      |           |

Surrogate: 1-Chlorooctane 133 % 45.3-161

Surrogate: 1-Chlorooctadecane 253 % 46.3-178

Cardinal Laboratories

\*=Accredited Analyte

PLEASE NOTE: Liability and Damages. Cardinal's liability and client's exclusive remedy for any claim arising, whether based in contract or tort, shall be limited to the amount paid by client for analyses. All claims, including those for negligence and any other cause whatsoever shall be deemed waived unless made in writing and received by Cardinal within thirty (30) days after completion of the applicable service. In no event shall Cardinal be liable for incidental or consequential damages, including, without limitation, business interruptions, loss of use, or loss of profits incurred by client, its subsidiaries, affiliates or successors arising out of or related to the performance of the services hereunder by Cardinal, regardless of whether such claim is based upon any of the above stated reasons or otherwise. Results relate only to the samples identified above. This report shall not be reproduced except in full with written approval of Cardinal Laboratories.

Celey D. Keene, Lab Director/Quality Manager





PHONE (575) 393-2326 ° 101 E. MARLAND ° HOBBS, NM 88240

**Analytical Results For:**

APACHE CORP - HOBBS  
 BRUCE BAKER  
 2350 W. MARLAND BLVD.  
 HOBBS NM, 88240  
 Fax To: (575) 393-2432

|                   |                |                     |                |
|-------------------|----------------|---------------------|----------------|
| Received:         | 11/10/2022     | Sampling Date:      | 11/10/2022     |
| Reported:         | 11/16/2022     | Sampling Type:      | Soil           |
| Project Name:     | MCCALISTER CTB | Sampling Condition: | Cool & Intact  |
| Project Number:   | NONE GIVEN     | Sample Received By: | Tamara Oldaker |
| Project Location: | NOT GIVEN      |                     |                |

**Sample ID: SP 3 @ 4'5" (H225351-10)**

| BTX 8021B      |        | mg/kg           |            | Analyzed By: JH |      |            |               |       |           |
|----------------|--------|-----------------|------------|-----------------|------|------------|---------------|-------|-----------|
| Analyte        | Result | Reporting Limit | Analyzed   | Method Blank    | BS   | % Recovery | True Value QC | RPD   | Qualifier |
| Benzene*       | <0.050 | 0.050           | 11/14/2022 | ND              | 2.00 | 99.8       | 2.00          | 0.859 |           |
| Toluene*       | 0.265  | 0.050           | 11/14/2022 | ND              | 2.11 | 105        | 2.00          | 0.598 |           |
| Ethylbenzene*  | 0.875  | 0.050           | 11/14/2022 | ND              | 2.05 | 102        | 2.00          | 0.489 |           |
| Total Xylenes* | 1.85   | 0.150           | 11/14/2022 | ND              | 6.21 | 104        | 6.00          | 0.194 |           |
| Total BTX      | 2.99   | 0.300           | 11/14/2022 | ND              |      |            |               |       |           |

Surrogate: 4-Bromofluorobenzene (PID) 110 % 69.9-140

| TPH 8015M        |        | mg/kg           |            | Analyzed By: MS |     |            |               |      |           |
|------------------|--------|-----------------|------------|-----------------|-----|------------|---------------|------|-----------|
| Analyte          | Result | Reporting Limit | Analyzed   | Method Blank    | BS  | % Recovery | True Value QC | RPD  | Qualifier |
| GRO C6-C10*      | 23.7   | 10.0            | 11/15/2022 | ND              | 217 | 109        | 200           | 7.62 |           |
| DRO >C10-C28*    | 313    | 10.0            | 11/15/2022 | ND              | 231 | 115        | 200           | 7.63 |           |
| EXT DRO >C28-C36 | 92.8   | 10.0            | 11/15/2022 | ND              |     |            |               |      |           |

Surrogate: 1-Chlorooctane 90.4 % 45.3-161

Surrogate: 1-Chlorooctadecane 88.7 % 46.3-178

Cardinal Laboratories

\*=Accredited Analyte

PLEASE NOTE: Liability and Damages. Cardinal's liability and client's exclusive remedy for any claim arising, whether based in contract or tort, shall be limited to the amount paid by client for analyses. All claims, including those for negligence and any other cause whatsoever shall be deemed waived unless made in writing and received by Cardinal within thirty (30) days after completion of the applicable service. In no event shall Cardinal be liable for incidental or consequential damages, including, without limitation, business interruptions, loss of use, or loss of profits incurred by client, its subsidiaries, affiliates or successors arising out of or related to the performance of the services hereunder by Cardinal, regardless of whether such claim is based upon any of the above stated reasons or otherwise. Results relate only to the samples identified above. This report shall not be reproduced except in full with written approval of Cardinal Laboratories.

Celey D. Keene, Lab Director/Quality Manager



PHONE (575) 393-2326 ° 101 E. MARLAND ° HOBBS, NM 88240

**Analytical Results For:**

APACHE CORP - HOBBS  
 BRUCE BAKER  
 2350 W. MARLAND BLVD.  
 HOBBS NM, 88240  
 Fax To: (575) 393-2432

Received: 11/10/2022  
 Reported: 11/16/2022  
 Project Name: MCCALISTER CTB  
 Project Number: NONE GIVEN  
 Project Location: NOT GIVEN

Sampling Date: 11/10/2022  
 Sampling Type: Soil  
 Sampling Condition: Cool & Intact  
 Sample Received By: Tamara Oldaker

**Sample ID: HC 1 SURFACE (H225351-11)**

| BTEX 8021B     |        | mg/kg           |            | Analyzed By: JH |      |            |               |       |           |  |
|----------------|--------|-----------------|------------|-----------------|------|------------|---------------|-------|-----------|--|
| Analyte        | Result | Reporting Limit | Analyzed   | Method Blank    | BS   | % Recovery | True Value QC | RPD   | Qualifier |  |
| Benzene*       | <0.050 | 0.050           | 11/14/2022 | ND              | 2.00 | 99.8       | 2.00          | 0.859 |           |  |
| Toluene*       | <0.050 | 0.050           | 11/14/2022 | ND              | 2.11 | 105        | 2.00          | 0.598 |           |  |
| Ethylbenzene*  | <0.050 | 0.050           | 11/14/2022 | ND              | 2.05 | 102        | 2.00          | 0.489 |           |  |
| Total Xylenes* | <0.150 | 0.150           | 11/14/2022 | ND              | 6.21 | 104        | 6.00          | 0.194 |           |  |
| Total BTEX     | <0.300 | 0.300           | 11/14/2022 | ND              |      |            |               |       |           |  |

Surrogate: 4-Bromofluorobenzene (PID) 89.7 % 69.9-140

| Chloride, SM4500CI-B |        | mg/kg           |            | Analyzed By: AC |     |            |               |      |           |  |
|----------------------|--------|-----------------|------------|-----------------|-----|------------|---------------|------|-----------|--|
| Analyte              | Result | Reporting Limit | Analyzed   | Method Blank    | BS  | % Recovery | True Value QC | RPD  | Qualifier |  |
| Chloride             | 80.0   | 16.0            | 11/11/2022 | ND              | 400 | 100        | 400           | 3.92 |           |  |

| TPH 8015M        |        | mg/kg           |            | Analyzed By: MS |     |            |               |      |           |
|------------------|--------|-----------------|------------|-----------------|-----|------------|---------------|------|-----------|
| Analyte          | Result | Reporting Limit | Analyzed   | Method Blank    | BS  | % Recovery | True Value QC | RPD  | Qualifier |
| GRO C6-C10*      | <10.0  | 10.0            | 11/14/2022 | ND              | 217 | 109        | 200           | 7.62 |           |
| DRO >C10-C28*    | 12.9   | 10.0            | 11/14/2022 | ND              | 231 | 115        | 200           | 7.63 |           |
| EXT DRO >C28-C36 | <10.0  | 10.0            | 11/14/2022 | ND              |     |            |               |      |           |

Surrogate: 1-Chlorooctane 68.6 % 45.3-161

Surrogate: 1-Chlorooctadecane 76.2 % 46.3-178

Cardinal Laboratories

\*=Accredited Analyte

PLEASE NOTE: Liability and Damages. Cardinal's liability and client's exclusive remedy for any claim arising, whether based in contract or tort, shall be limited to the amount paid by client for analyses. All claims, including those for negligence and any other cause whatsoever shall be deemed waived unless made in writing and received by Cardinal within thirty (30) days after completion of the applicable service. In no event shall Cardinal be liable for incidental or consequential damages, including, without limitation, business interruptions, loss of use, or loss of profits incurred by client, its subsidiaries, affiliates or successors arising out of or related to the performance of the services hereunder by Cardinal, regardless of whether such claim is based upon any of the above stated reasons or otherwise. Results relate only to the samples identified above. This report shall not be reproduced except in full with written approval of Cardinal Laboratories.

Celey D. Keene, Lab Director/Quality Manager



PHONE (575) 393-2326 ° 101 E. MARLAND ° HOBBS, NM 88240

**Analytical Results For:**

APACHE CORP - HOBBS  
 BRUCE BAKER  
 2350 W. MARLAND BLVD.  
 HOBBS NM, 88240  
 Fax To: (575) 393-2432

Received: 11/10/2022  
 Reported: 11/16/2022  
 Project Name: MCCALISTER CTB  
 Project Number: NONE GIVEN  
 Project Location: NOT GIVEN

Sampling Date: 11/10/2022  
 Sampling Type: Soil  
 Sampling Condition: Cool & Intact  
 Sample Received By: Tamara Oldaker

**Sample ID: HC 2 SURFACE (H225351-12)**

| BTEx 8021B     |        | mg/kg           |            | Analyzed By: JH |      |            |               |       |           |  |
|----------------|--------|-----------------|------------|-----------------|------|------------|---------------|-------|-----------|--|
| Analyte        | Result | Reporting Limit | Analyzed   | Method Blank    | BS   | % Recovery | True Value QC | RPD   | Qualifier |  |
| Benzene*       | <0.050 | 0.050           | 11/14/2022 | ND              | 2.00 | 99.8       | 2.00          | 0.859 |           |  |
| Toluene*       | <0.050 | 0.050           | 11/14/2022 | ND              | 2.11 | 105        | 2.00          | 0.598 |           |  |
| Ethylbenzene*  | <0.050 | 0.050           | 11/14/2022 | ND              | 2.05 | 102        | 2.00          | 0.489 |           |  |
| Total Xylenes* | <0.150 | 0.150           | 11/14/2022 | ND              | 6.21 | 104        | 6.00          | 0.194 |           |  |
| Total BTEx     | <0.300 | 0.300           | 11/14/2022 | ND              |      |            |               |       |           |  |

Surrogate: 4-Bromofluorobenzene (PID) 89.0 % 69.9-140

| Chloride, SM4500Cl-B |        | mg/kg           |            | Analyzed By: AC |     |            |               |      |           |  |
|----------------------|--------|-----------------|------------|-----------------|-----|------------|---------------|------|-----------|--|
| Analyte              | Result | Reporting Limit | Analyzed   | Method Blank    | BS  | % Recovery | True Value QC | RPD  | Qualifier |  |
| Chloride             | 80.0   | 16.0            | 11/11/2022 | ND              | 400 | 100        | 400           | 3.92 |           |  |

| TPH 8015M        |        | mg/kg           |            | Analyzed By: MS |     |            |               |      |           |
|------------------|--------|-----------------|------------|-----------------|-----|------------|---------------|------|-----------|
| Analyte          | Result | Reporting Limit | Analyzed   | Method Blank    | BS  | % Recovery | True Value QC | RPD  | Qualifier |
| GRO C6-C10*      | <10.0  | 10.0            | 11/14/2022 | ND              | 217 | 109        | 200           | 7.62 |           |
| DRO >C10-C28*    | <10.0  | 10.0            | 11/14/2022 | ND              | 231 | 115        | 200           | 7.63 |           |
| EXT DRO >C28-C36 | <10.0  | 10.0            | 11/14/2022 | ND              |     |            |               |      |           |

Surrogate: 1-Chlorooctane 55.1 % 45.3-161

Surrogate: 1-Chlorooctadecane 61.9 % 46.3-178

Cardinal Laboratories

\*=Accredited Analyte

PLEASE NOTE: Liability and Damages. Cardinal's liability and client's exclusive remedy for any claim arising, whether based in contract or tort, shall be limited to the amount paid by client for analyses. All claims, including those for negligence and any other cause whatsoever shall be deemed waived unless made in writing and received by Cardinal within thirty (30) days after completion of the applicable service. In no event shall Cardinal be liable for incidental or consequential damages, including, without limitation, business interruptions, loss of use, or loss of profits incurred by client, its subsidiaries, affiliates or successors arising out of or related to the performance of the services hereunder by Cardinal, regardless of whether such claim is based upon any of the above stated reasons or otherwise. Results relate only to the samples identified above. This report shall not be reproduced except in full with written approval of Cardinal Laboratories.

Celey D. Keene, Lab Director/Quality Manager

PHONE (575) 393-2326 • 101 E. MARLAND • HOBBS, NM 88240

---

### Notes and Definitions

|       |  |
|-------|--|
| S-06  | The recovery of this surrogate is outside control limits due to sample dilution required from high analyte concentration and/or matrix interference's.         |
| S-04  | The surrogate recovery for this sample is outside of established control limits due to a sample matrix effect.   |
| QM-07 | The spike recovery was outside acceptance limits for the MS and/or MSD. The batch was accepted based on acceptable LCS recovery.                               |
| ND    | Analyte NOT DETECTED at or above the reporting limit   |
| RPD   | Relative Percent Difference  |
| **    | Samples not received at proper temperature of 6°C or below.  |
| ***   | Insufficient time to reach temperature.  |
| -     | Chloride by SM4500Cl-B does not require samples be received at or below 6°C<br>Samples reported on an as received basis (wet) unless otherwise noted on report |

---

Cardinal Laboratories

\*=Accredited Analyte

PLEASE NOTE: Liability and Damages. Cardinal's liability and client's exclusive remedy for any claim arising, whether based in contract or tort, shall be limited to the amount paid by client for analyses. All claims, including those for negligence and any other cause whatsoever shall be deemed waived unless made in writing and received by Cardinal within thirty (30) days after completion of the applicable service. In no event shall Cardinal be liable for incidental or consequential damages, including, without limitation, business interruptions, loss of use, or loss of profits incurred by client, its subsidiaries, affiliates or successors arising out of or related to the performance of the services hereunder by Cardinal, regardless of whether such claim is based upon any of the above stated reasons or otherwise. Results relate only to the samples identified above. This report shall not be reproduced except in full with written approval of Cardinal Laboratories.

A handwritten signature in black ink, appearing to read "Celey D. Keene", is written over a horizontal line.

Celey D. Keene, Lab Director/Quality Manager



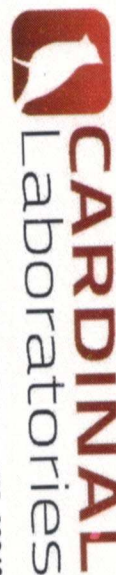

101 East Marland, Hobbs, NM 88240  
(575) 393-2326 FAX (575) 393-2476

CHAIN-OF-CUSTODY AND ANALYSIS REQUEST

[illegible]



ANALYSIS REQUEST

Page 16 of 16





101 East Marland, Hobbs, NM 88240  
(575) 393-2326 FAX (575) 393-2476

# CHAIN-OF-CUSTODY AND ANALYSIS REQUEST

|  |  |                                    |  |              |  |                  |  |
|--|--|------------------------------------|--|--------------|--|------------------|--|
| Company Name: <u>Apache</u>            |  | P.O. #:                            |  | BILL TO      |  | ANALYSIS REQUEST |  |
| Project Manager: <u>Bruce Baker</u>    |  | Company:                           |  |              |  |                  |  |
| Address:                               |  | Attn:                              |  |              |  |                  |  |
| City: <u>Hobbs</u>                     |  | State: <u>NM</u> Zip: <u>88240</u> |  |              |  |                  |  |
| Phone #:                               |  | Address:                           |  |              |  |                  |  |
| Project #:                             |  | City:                              |  |              |  |                  |  |
| Project Name:                          |  | State:                             |  |              |  |                  |  |
| Project Location: <u>McAlister CTB</u> |  | Phone #:                           |  |              |  |                  |  |
| Sampler Name: <u>Jose Duesade</u>      |  | Fax #:                             |  |              |  |                  |  |
| FOR LAB USE ONLY                       |  | MATRIX                             |  | PRESERV      |  | SAMPLING         |  |
| Lab I.D.                               |  | (G) RAB OR (C) OMP.                |  | # CONTAINERS |  | DATE             |  |
| Sample I.D.                            |  | GROUNDWATER                        |  | WASTEWATER   |  | TIME             |  |
|  |  | SOIL                               |  | OIL          |  |                  |  |
|  |  | SLUDGE                             |  | OTHER:       |  |                  |  |
|  |  | ACID/BASE:                         |  | ICE / COOL   |  |                  |  |
|  |  | OTHER:                             |  |              |  |                  |  |

| Lab I.D.       | Sample I.D.           | (G) RAB OR (C) OMP. | # CONTAINERS | GROUNDWATER | WASTEWATER | SOIL | OIL | SLUDGE | OTHER: | ACID/BASE: | ICE / COOL | OTHER: | DATE         | TIME            | CI       | BTEX     | EXT TPH  |
|----------------|-----------------------|---------------------|--------------|-------------|------------|------|-----|--------|--------|------------|------------|--------|--------------|-----------------|----------|----------|----------|
| <u>H224830</u> | <u>1 SP10 Surface</u> | <u>G</u>            | <u>1</u>     |             |            |      |     |        |        |            |            |        | <u>10/13</u> | <u>8:32 AM</u>  | <u>1</u> | <u>1</u> | <u>1</u> |
|                | <u>2 SP20 Surface</u> | <u>G</u>            | <u>1</u>     |             |            |      |     |        |        |            |            |        | <u>10/13</u> | <u>8:39 AM</u>  | <u>1</u> | <u>1</u> | <u>1</u> |
|                | <u>3 SP30 Surface</u> | <u>G</u>            | <u>1</u>     |             |            |      |     |        |        |            |            |        | <u>10/13</u> | <u>8:30 AM</u>  | <u>1</u> | <u>1</u> | <u>1</u> |
|                | <u>4 SP101</u>        | <u>G</u>            | <u>1</u>     |             |            |      |     |        |        |            |            |        | <u>10/13</u> | <u>10:00 PM</u> | <u>1</u> | <u>1</u> | <u>1</u> |
|                | <u>5 SP201</u>        | <u>G</u>            | <u>1</u>     |             |            |      |     |        |        |            |            |        | <u>10/13</u> | <u>10:02 PM</u> | <u>1</u> | <u>1</u> | <u>1</u> |
|                | <u>6 SP301</u>        | <u>G</u>            | <u>1</u>     |             |            |      |     |        |        |            |            |        | <u>10/13</u> | <u>10:04 PM</u> | <u>1</u> | <u>1</u> | <u>1</u> |

|                                      |  |  |  |                                  |  |  |  |
|--------------------------------------|--|--|--|----------------------------------|--|--|--|
| Relinquished By: <u>Jose Duesade</u> |  | Date: <u>10/13</u>   |  | Received By: <u>Janara Delat</u> |  | Date: <u>11/31</u>                                     |  |
| Relinquished By:                     |  | Date:  |  | Received By:                     |  | Date:  |  |
| Time: <u>11:31</u>                   |  | Time:  |  | Time:                            |  | Time:  |  |
| Observed Temp. °C: <u>39</u>         |  | Sample Condition: <u>Cool Intact</u>   |  | CHECKED BY: <u>(Initials)</u>    |  | Turnaround Time: <u>Standard</u>                       |  |
| Corrected Temp. °C: <u>33</u>        |  | Cool <input checked="" type="checkbox"/> Intact <input checked="" type="checkbox"/> Yes <input type="checkbox"/> No <input type="checkbox"/> |  |                                  |  | Thermometer ID #113                                    |  |
|                                      |  | Correction Factor -0.6°C   |  |                                  |  | Bacteria (only) Sample Condition                       |  |
|                                      |  |  |  |                                  |  | Cool Intact <input type="checkbox"/> Observed Temp. °C |  |
|                                      |  |  |  |                                  |  | Corrected Temp. °C                                     |  |

REMARKS: E-Mail Results

Verbal Result: ☐ Yes ☐ No ☐ Add'l Phone #:

All Results are emailed. Please provide Email address:

**District I**

1625 N. French Dr., Hobbs, NM 88240  
Phone:(575) 393-6161 Fax:(575) 393-0720

**District II**

811 S. First St., Artesia, NM 88210  
Phone:(575) 748-1283 Fax:(575) 748-9720

**District III**

1000 Rio Brazos Rd., Aztec, NM 87410  
Phone:(505) 334-6178 Fax:(505) 334-6170

**District IV**

1220 S. St Francis Dr., Santa Fe, NM 87505  
Phone:(505) 476-3470 Fax:(505) 476-3462

**State of New Mexico**  
**Energy, Minerals and Natural Resources**  
**Oil Conservation Division**  
**1220 S. St Francis Dr.**  
**Santa Fe, NM 87505**

CONDITIONS

Action 159780

**CONDITIONS**

|   |   |
|---|---|
| Operator:<br>APACHE CORPORATION<br>303 Veterans Airpark Ln<br>Midland, TX 79705 | OGRID:<br>873   |
|   | Action Number:<br>159780                                  |
|   | Action Type:<br>[C-141] Release Corrective Action (C-141) |

**CONDITIONS**

| Created By | Condition   | Condition Date |
|------------|---|----------------|
| jnobui     | Remediation Plan approved with Conditions. Composite confirmation samples will be collected from the bottom of the excavation from areas representing no more than four hundred (400) square feet, and from the sidewalls of the excavation from areas representing no more than two hundred (200) square feet. Sidewall samples should be delineated to 600 mg/kg for chlorides and 100 mg/kg for TPH to define the edge of the release, regardless of the depth to groundwater. | 12/15/2022     |