



EOG Resources, Inc.
Artesia Division Office
104 S. 4th Street
Artesia, N. M. 88210

August 30, 2022

Bradford Billings
EMNRD
1220 South St. Francis Drive
Santa Fe, NM 87505

Re: Anadarko Pardue Farms ANQ Com #1
30-015-22212
F-27-21S-24E
Eddy County, NM
2RP-468
nMLB1031337060

EOG Resources, Inc. is submitting the enclosed Closure Report for the above referenced site which currently has an open incident on the NMOCD E-Permitting website. The report is being submitted in reference to the C-141 Initial dated October 13, 2010, and the original C-141 Final submitted September 27, 2011. EOG Resources, Inc. has included a C-141 Final on the most current form in this Closure Report, and hereby requests closure of the open incident.

If you have any questions, feel free to call me at (575) 748-1471.

Respectfully,

Chase Settle

Chase Settle
Rep Safety & Environmental Sr
EOG Resources, Inc.

Anadarko Pardue Farms ANQ Com #1
Closure Report
#nMLB1031337060



August 30, 2022

Anadarko Pardue Farms ANQ Com #1

Closure Report

30-015-22212

F-27-21S-24E

Eddy County, NM

August 30, 2022

nMLB1031337060

Anadarko Pardue Farms ANQ Com #1
Closure Report
#nMLB1031337060



August 30, 2022

Table of Contents

I.	Location.....	1
II.	Background.....	1
III.	Scope of Work Completed.....	1
IV.	Closure Request.....	1

Appendices:

Appendix A: Original C-141 Initial

Appendix B: Internal YPC Documents/Photos

Appendix C: NMOCD Correspondence

Appendix D: Original Closure Report

Appendix E: Current C-141 Closure

Anadarko Pardue Farms ANQ Com #1
Closure Report
#nMLB1031337060



August 30, 2022

I. Location

The site is located in Eddy County, New Mexico approximately 10.6 miles southwest of Seven Rivers.

II. Background

On September 7, 2010, Yates Petroleum Corporation (YPC) had a release of 18 barrels of crude oil at the Anadarko Pardue ANQ Com #1 when a circulating pump failure occurred, allowing an approximate area of 21 feet by 10 feet to be impacted within the berm of the battery. A vacuum truck was mobilized to the site to begin retrieval of the standing fluid upon discovery of the release, with a dirt contractor performing excavation of the visually impacted soils the following day. A C-141 Initial (Appendix A) was submitted to NMOCD on October 13, 2010.

III. Scope of Work Completed

YPC begin assessing the release through the collection of soil samples and performing analysis through the internal laboratory it maintained during that time period, as indicated on the Status Report page included with other internal documents as Appendix B. These first initial samples exhibited total petroleum hydrocarbon (TPH) results above the Recommended Remediation Action Level (RRAL) for according to the *New Mexico Oil Conservation Division (NMOCD) Guidelines for Remediation of Leaks, Spills and Releases*, dated August 13, 1993. YPC through the course of addressing the release, determined that the best way to fully address the impacts around the equipment would be to downsize the facility and reduce the number of production tanks within the battery. The decision was made to start the downsizing at the southernmost tanks to properly address the release that had occurred in September 2010. An email was sent to NMOCD on December 6, 2010, explaining the decision to pursue this effort. This is included in Appendix C.

Once the production tanks and equipment were removed from the release area, the excavation was increased to a depth of four (4) feet below grade surface (bgs). Confirmation soil sampling then occurred on January 14, 2011, with these samples submitted to Cardinal Laboratory for analysis. Results (Appendix D) of the confirmation sampling event indicated that the excavation had removed all impacted soils above the RRALs, meeting the closure criteria for the era.

Backfill of the excavation was undertaken beginning in May, along with further reconstruction of the battery. On September 27, 2011, the original C-141 Final was submitted to NMOCD requesting closure of 2RP-468. These documents are included as Appendix D.

IV. Closure Request

This release, remediation work, and original C-141 Final submission occurred prior to the passage of the current Spill Rule (NMAC 19.15.29), therefore the requirements for a scaled site map and excavation photographs cannot be accommodated as they were not required by NMOCD during the time of this incident occurring.

Based on the confirmation soil analytical results, EOG Resources, Inc. believes enough evidence is provided to substantiate that remedial activities were completed correctly for the time period, and requests Closure of nMLB1031337060 (2RP-468), the current C-141 Closure Form is included with this Closure Report as Appendix E.

Anadarko Pardue Farms ANQ Com #1
Closure Report
#nMLB1031337060



August 30, 2022

Appendix A

Original C-141 Initial

District I
1625 N. French Dr., Hobbs, NM 88240
District II
1301 W. Grand Avenue, Artesia, NM 88210
District III
1000 Rio Brazos Road, Aztec, NM 87410
District IV
1220 S. St. Francis Dr., Santa Fe, NM 87505

State of New Mexico
Energy Minerals and Natural Resources
Oil Conservation Division
1220 South St. Francis Dr.
Santa Fe, NM 87505

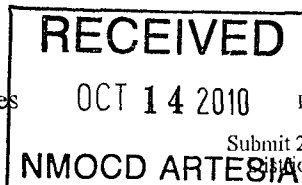

Form C-141
Revised October 10, 2003
Submit 2 Copies to appropriate
Office in accordance
with Rule 116 on back
side of form

Release Notification and Corrective Action

OPERATOR

☒ Initial Report ☐ Final Report

nmcb 1031337060

Name of Company Yates Petroleum Corporation	OGRID Number 25575	Contact Amanda Trujillo
Address 104 S. 4 TH Street	Telephone No. 575-748-1471	
Facility Name Anadarko Pardue ANQ Battery	API Number 30-015-22212	Facility Type Gas well
		Order Number 2RP- 468

Surface Owner Federal	Mineral Owner Federal	Lease No.
--------------------------	--------------------------	-----------

LOCATION OF RELEASE

Unit Letter F	Section 27	Township 21S	Range 24E	Feet from the 2310	North/South Line North	Feet from the 1980	East/West Line West	County Eddy
------------------	---------------	-----------------	--------------	-----------------------	---------------------------	-----------------------	------------------------	----------------

NATURE OF RELEASE

Type of Release Oil	Volume of Release 18 bbl	Volume Recovered 10
Source of Release Valve not fully closed	Date and Hour of Occurrence 9/7/2010	Date and Hour of Discovery 9/7/2010 - PM
Was Immediate Notice Given? <input checked="" type="checkbox"/> Yes <input type="checkbox"/> No <input type="checkbox"/> Not Required	If YES, To Whom? Mike Bratcher - NMOC D/Artesia	
By Whom? Amanda Trujillo - Yates Petroleum Corporation	Date and Hour 09/10/2010 pm	
Was a Watercourse Reached? <input type="checkbox"/> Yes <input checked="" type="checkbox"/> No	If YES, Volume Impacting the Watercourse. N/A	
If a Watercourse was Impacted, Describe Fully.* N/A		
Describe Cause of Problem and Remedial Action Taken.* Circulating pump failed and catch valve ran over because valve was not fully closed. Fluid circulated back through valve. A vacuum truck was called to pick up standing fluids. A clean up crew was then dispatched to remove all visibly contaminated material.		
Describe Area Affected and Cleanup Action Taken.* An approximate size of 21' x 10' was impacted. The impacted area is located near the last oil tank. Soil from the pooling areas was excavated and disposed of at an NMOC D approved facility. Crew excavated contaminated soils; soils were placed directly onto plastic. Vertical and horizontal delineation samples will taken and analysis ran for TPH and BTEX once a contaminated material has been removed. Chlorides sampling available upon request. Depth to Ground Water: >100' (approx. 100', per New Mexico Office of the State Engineer); Wellhead Protection Area: No; Distance to Surface Water Body: >1000'; SITE RANKING IS 0. Based on site ground water quality and enclosed analytical results. - No Analytical Results		
I hereby certify that the information given above is true and complete to the best of my knowledge and understand that pursuant to NMOC D rules and regulations all operators are required to report and/or file certain release notifications and perform corrective actions for releases which may endanger public health or the environment. The acceptance of a C-141 report by the NMOC D marked as "Final Report" does not relieve the operator of liability should their operations have failed to adequately investigate and remediate contamination that pose a threat to ground water, surface water, human health or the environment. In addition, NMOC D acceptance of a C-141 report does not relieve the operator of responsibility for compliance with any other federal, state, or local laws and/or regulations.		

OIL CONSERVATION DIVISION

Signature: <i>A Trujillo</i>	Approved By <i>Mike Bratcher</i>	
Printed Name: Amanda Trujillo	Approval Date: NOV 09 2010 Expiration Date:	
Title: Environmental Scientist	Conditions of Approval:	
E-mail Address: atrujillo@yatespetroleum.com	Attached <input type="checkbox"/>	
Date: Wednesday, October 13, 2010 Phone: 575-748-4310	REMEDATION per OCD Rules and Guidelines. SUBMIT REMEDIATION PROPOSAL BY: 12/9/2010	

* Attach Additional Sheets If Necessary

*Delineation for BTEX,
TAH & Chloride required*

Bratcher, Mike, EMNRD

From: Amanda Trujillo [atrujillo@yatespetroleum.com]
Sent: Thursday, October 14, 2010 5:25 PM
To: Bratcher, Mike, EMNRD
Subject: RE: Anadarko Pardue ANQ Com
Attachments: Anadarko Pardue ANQ #1(Inital 9-7-2010) .pdf

Attached is the C-141

Thank you ☺

Amanda N. Trujillo
Environmental Scientist
Yates Petroleum Corporation
Office 575-748-4310
Cell 575-703-6537
Email atrujillo@yatespetroleum.com

-----Original Message-----

From: Amanda Trujillo
Sent: Friday, September 10, 2010 4:03 PM
To: 'Bratcher, Mike, EMNRD'
Cc: Jerry Fanning
Subject: Anadarko Pardue ANQ Com

Mr. Mike Bratcher:

Yates Petroleum reports a release at the following location:

Anadarko Pardue ANQ Com
Sec. 27,Township 21 South, Range 24 East
Eddy County
Date of Release: 09/07/10
Approximately 18 barrels of Oil were released
Approximately 10 barrels were recovered
Cause of release has been isolated and repairs are in progress
Site will be evaluated and a work plan for remediation will be submitted for consideration

If you should have any questions please feel free to contact me at the number below.

Amanda N. Trujillo
Environmental Scientist
Yates Petroleum Corporation
Office 575-748-4310
Cell 575-703-6537
Email atrujillo@yatespetroleum.com

Anadarko Pardue Farms ANQ Com #1
Closure Report
#nMLB1031337060



August 30, 2022

Appendix B

Internal YPC Documents/Photos



BREAKS, SPILLS AND LEAKS REPORT

Person Reporting GARY HICKOX Time Reported: 3:30 am ☒ pm
Person Reported to (Field Supervisor) Joe PALMA Time Reported: 3:31 am ☒ pm
Environmental Notification Coordinator _____ Time Reported: _____ am ☐ pm

1. LOCATION:
Name of well or facility: ANADARKO PARQUE AND COM / TANKS & BATTERY
Location F Section 27 Township T21S Range R24E County: EDDY CO NM
Surface Owner: _____ Mineral Owner: Fee ☐ Federal ☒ State ☐
2310FNL 1970 FOL
API: 30-015-22212

2. TIME OF INCIDENT:
Date: 9-7-2010 Time: 3:00 am ☒ pm

3. SOURCE AND CAUSE: Circulating pump failed AND Catch Valve RAN over
Valve Not fully closed. Circulated back through valve

4. TYPE OF DISCHARGE
☒ Crude Oil ☐ Condensate ☐ Produced Water ☐ Gas ☐ Other _____

5. QUANTITY:
Estimated Volumes Discharged: 18 bbls Barrels of Oil 0 Barrels of Water
Barrels of _____
MCF Gas _____
Estimated Volumes Recovered: 10 bbls Barrels of Oil 0 Barrels of Water
Barrels of _____

6. SITE CHARACTERISTICS:
Weather Conditions: Sunny Dry 96° Soil Type and Condition: pea gravel / dirt
Distance & Direction to fresh water wells or watercourse: ? Did NOT ESCAPE Containment
Secondary Containment type & condition: pea gravel Filled over dirt -
Miscellaneous: _____

7. IMMEDIATE CORRECTIVE ACTION:
Action and time taken to control incident: Called Vac Truck (Jim's Wtr Service) to
suck up puddled oil. Medrano's Roostboats For clean up
the morning of the Sept 8 2010 on site 7AM this morning

BREAKS, SPILLS AND LEAKS REPORT

8. SITE ASSESMENT

Exact Location of Spill: (sketch)

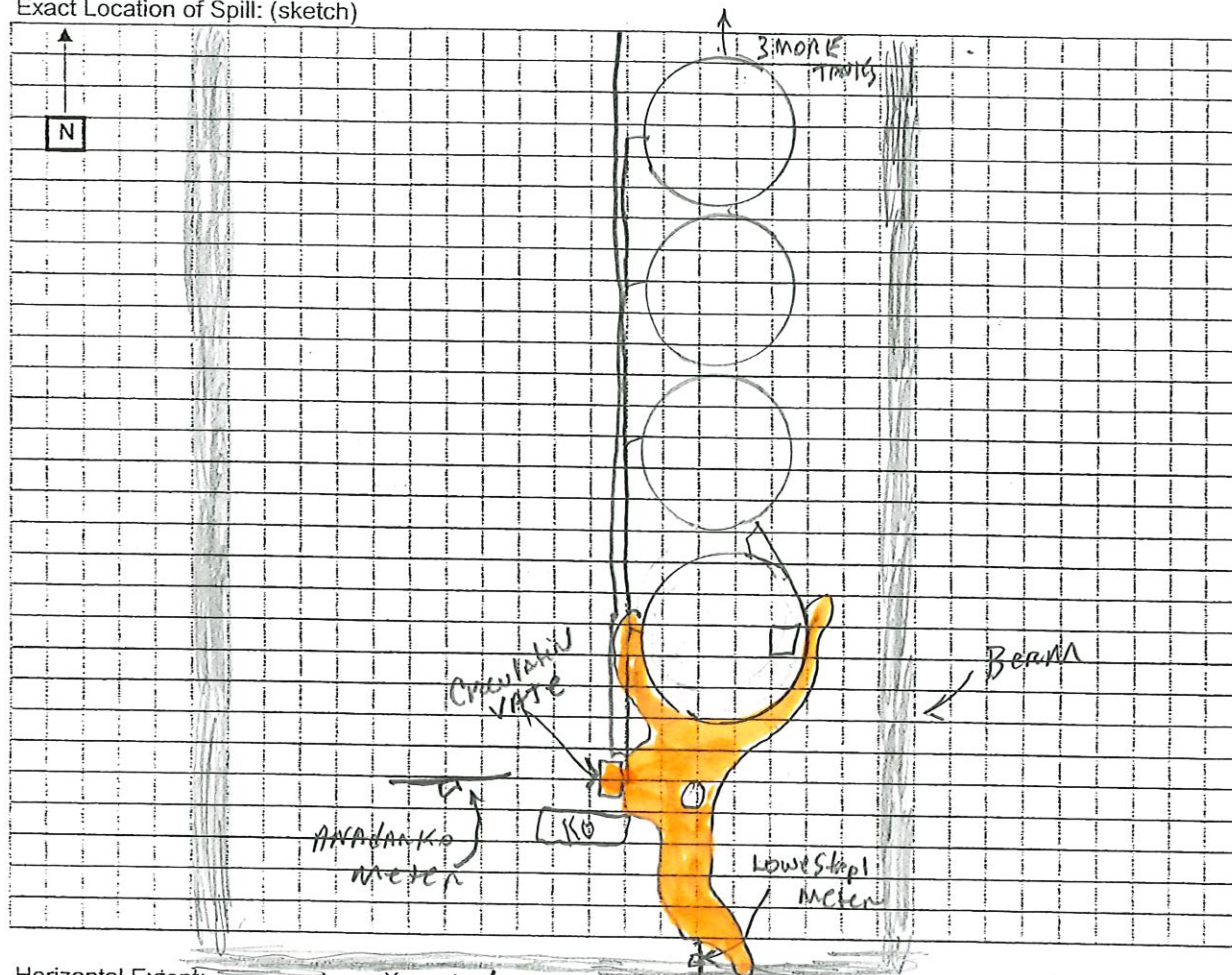

Horizontal Extent: 21' X 10' Estimated Vertical Extent: SOAKED 1" feet / inches

Degree of Contamination: ☒ Highly Contaminated/Saturated ☐ Unsaturated

9. REMEDIAL ACTION:

☐ Excavate, and landfarm on location

☒ Excavate, remove and replace remove soil gravel & replace soil gravel

☐ Treat in place

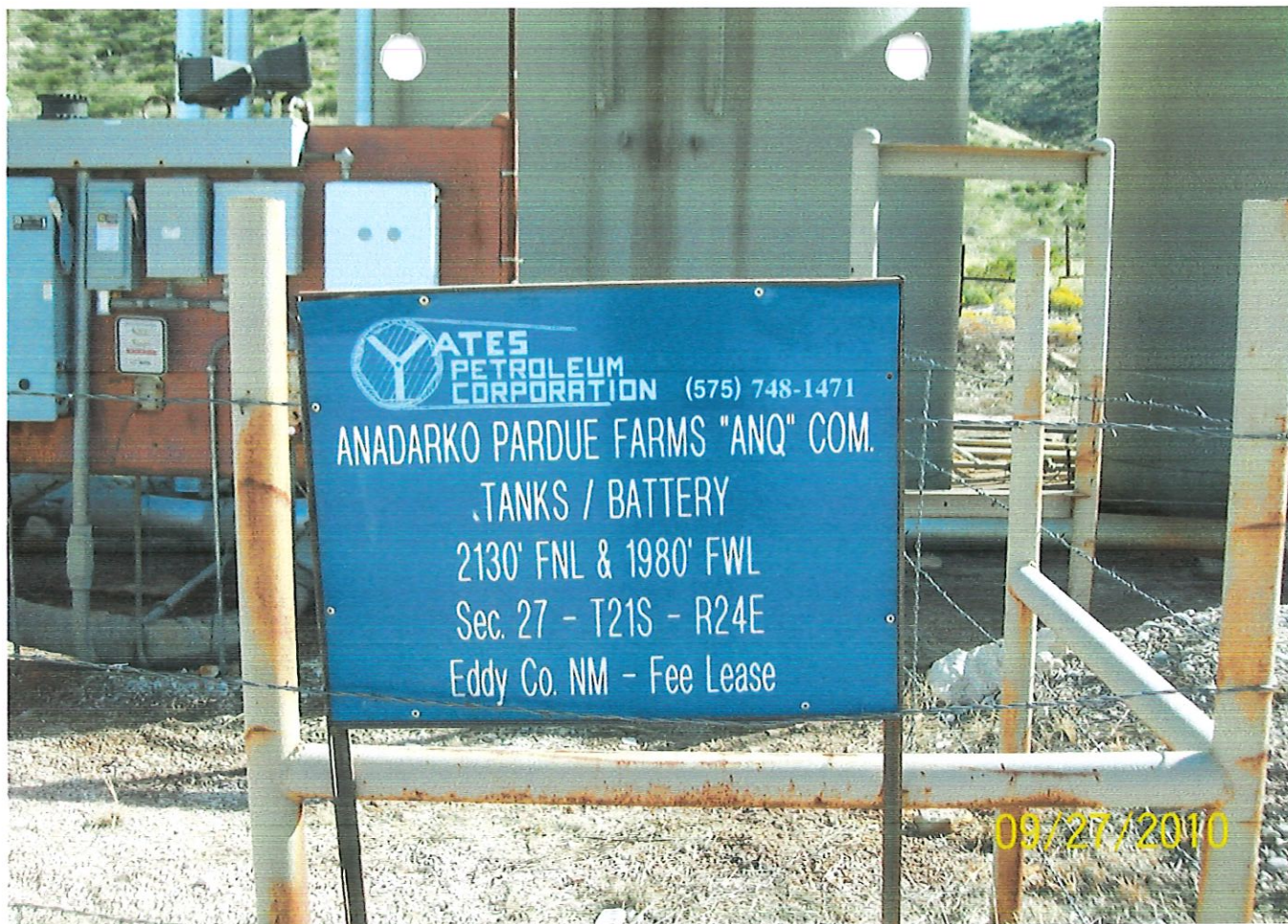





Status Report

Well/Location Name: Anadarko Pardue Farms ANQ Battery

Field Supervisor: Junior Orquiz

Location: Unit F Section 27, T21S-R24E

Eddy County, NM

Latitude:

Longitude:

API# 30-015-22212

Surface Owner: Federal

Mineral Owner: Federal

Lease No.

Directions: SOUTH ON 285 TO KINCAID ROAD, TURN WEST AND GO DOWN TO PENASCO GAS PLANT, FOLLOW EAST FENCE NORTH TO LOCATION

SITE RANKING IS ZERO (0), Depth to Ground Water: <100' (approx. 100'), Wellhead Protection Area: No, Distance to Surface Water Body: >1000'.

Date	Comment
9/12/10	sight inspection
10/5/2010	Inspected spill took samples ran in Lab. TPH was out of range
11/8/10	Samples showed High GROs
11/17/10	Jerry & Amanda reevaluated spill. decided battery is in a high profile area and downsizing the battery was the best move.
11/23/10	New berm was built and time frame was est to reconstruct battery. Clean up will begin on the west side of the battery
12/6/10	Talked to S. Medrano. He said tanks were being cleaned. Tanks should be removed Friday and excavation will likely start Monday Dec. 13.
12/14/10	emailed Bratcher to give him notice of reconstruction. See email excavation undertaken began. Visible contamination at 2.5' depth. Area size approx 50' x 30'
1/4/10	Socorro Medrano called said excavation was complete.
1/6/10	Sampled/sent to cardinal on 1/7/10
1/14/10	Samples came back within limits for site ranking of zero emailed Junior told him it was ok to backfill
5/19/11	Backfill & reconstruction of Battery begin.
9/27/11	Request closure.

11/23/2010

Anadarko Pardue Farms ANQ Com #1
Closure Report
#nMLB1031337060



August 30, 2022

Appendix C

NMOCD Correspondence

Amanda Trujillo

From: Amanda Trujillo
Sent: Monday, December 06, 2010 3:40 PM
To: 'Bratcher, Mike, EMNRD'
Cc: Jerry Fanning
Subject: RE: Anadarko Pardue ANQ Com

Mike:

In addressing the release at the Anadarko Pardue Battery, we have decided to downsize the battery, due to decreased production. I wanted to give you heads up in the event anyone from the OCD decided to take a look at the release and wondered why there so much work being done. I will contact you when we are ready to do the witnessed sampling.

Thank you,

Amanda N. Trujillo
Environmental Scientist
Yates Petroleum Corporation
Office 575-748-4310
Cell 575-703-6537
Email atrujillo@yatespetroleum.com

-----Original Message-----

From: Amanda Trujillo
Sent: Thursday, October 14, 2010 5:25 PM
To: 'Bratcher, Mike, EMNRD'
Subject: RE: Anadarko Pardue ANQ Com

Attached is the C-141

Thank you ☺

Amanda N. Trujillo
Environmental Scientist
Yates Petroleum Corporation
Office 575-748-4310
Cell 575-703-6537
Email atrujillo@yatespetroleum.com

-----Original Message-----

From: Amanda Trujillo
Sent: Friday, September 10, 2010 4:03 PM
To: 'Bratcher, Mike, EMNRD'
Cc: Jerry Fanning
Subject: Anadarko Pardue ANQ Com

Mr. Mike Bratcher:

Yates Petroleum reports a release at the following location:

Anadarko Pardue ANQ Com
Sec. 27, Township 21 South, Range 24 East
Eddy County
Date of Release: 09/07/10
Approximately 18 barrels of Oil were released
Approximately 10 barrels were recovered

12/6/2010

Cause of release has been isolated and repairs are in progress.
Site will be evaluated and a work plan for remediation will be submitted for consideration

If you should have any questions please feel free to contact me at the number below.

Amanda N. Trujillo
Environmental Scientist
Yates Petroleum Corporation
Office 575-748-4310
Cell 575-703-6537
Email atrujillo@yatespetroleum.com

12/6/2010

Anadarko Pardue Farms ANQ Com #1
Closure Report
#nMLB1031337060



August 30, 2022

Appendix D

Original Closure Report

Page 19 of 31
Received by CD: 8/31/2022 12:43:44 PM
Released to Imaging: 3/7/2023 12:58:06 PM

District I
1625 N. French Dr., Hobbs, NM 88240
District II
301 W. Grand Avenue, Artesia, NM 88210
District III
1000 Rio Brazos Road, Aztec, NM 87410
District IV
1220 S. St. Francis Dr., Santa Fe, NM 87505

State of New Mexico
Energy Minerals and Natural Resources
Oil Conservation Division
1220 South St. Francis Dr.
Santa Fe, NM 87505

Form C-141
Revised October 10, 2003

Submit 2 Copies to appropriate
District Office in accordance
with Rule 116 on back
side of form

Release Notification and Corrective Action

OPERATOR

☐ Initial Report ☒ Final Report

Name of Company Yates Petroleum Corporation	OGRID Number 25575	Contact Amanda Trujillo
Address 104 S. 4 TH Street	Telephone No. 575-748-1471	
Facility Name Anadarko Pardue ANQ Battery	API Number 30-015-22212	Facility Type Gas well
		Order Number 2RP-
Surface Owner Federal	Mineral Owner Federal	Lease No.

LOCATION OF RELEASE

Unit Letter F	Section 27	Township 21S	Range 24E	Feet from the 2310	North/South Line North	Feet from the 1980	East/West Line West	County Eddy
------------------	---------------	-----------------	--------------	-----------------------	---------------------------	-----------------------	------------------------	----------------

NATURE OF RELEASE

Type of Release Oil	Volume of Release 18 bbl	Volume Recovered 10
Source of Release Valve not fully closed	Date and Hour of Occurrence 9/7/2010	Date and Hour of Discovery 9/7/2010 - PM
Was Immediate Notice Given? <input checked="" type="checkbox"/> Yes <input type="checkbox"/> No <input type="checkbox"/> Not Required	If YES, To Whom? Mike Bratcher – NMOCD/Artesia	
By Whom? Amanda Trujillo – Yates Petroleum Corporation	Date and Hour 09/10/2010 pm	
Was a Watercourse Reached? <input type="checkbox"/> Yes <input checked="" type="checkbox"/> No	If YES, Volume Impacting the Watercourse. N/A	
If a Watercourse was Impacted, Describe Fully.* N/A		
Describe Cause of Problem and Remedial Action Taken.* Circulating pump failed and catch valve ran over because valve was not fully closed. Fluid circulated back through valve. A vacuum truck was called to pick up standing fluids. A clean up crew was then dispatched to remove all visibly contaminated material.		
Describe Area Affected and Cleanup Action Taken.* An approximate size of 21' x 10' was impacted. The impacted area is located near the last oil tank. Soil from the pooling areas was excavated and disposed of at an NMOCD approved facility. Crew excavated contaminated soils; soils were placed directly onto plastic. Vertical and horizontal delineation samples will taken and analysis ran for TPH and BTEX once a contaminated material has been removed. Chlorides sampling available upon request. Depth to Ground Water: >100' (approx. 100', per New Mexico Office of the State Engineer); Wellhead Protection Area: No; Distance to Surface Water Body: >1000'; SITE RANKING IS 0. Based on site ground water quality and enclosed analytical results.		
I hereby certify that the information given above is true and complete to the best of my knowledge and understand that pursuant to NMOCD rules and regulations all operators are required to report and/or file certain release notifications and perform corrective actions for releases which may endanger public health or the environment. The acceptance of a C-141 report by the NMOCD marked as "Final Report" does not relieve the operator of liability should their operations have failed to adequately investigate and remediate contamination that pose a threat to ground water, surface water, human health or the environment. In addition, NMOCD acceptance of a C-141 report does not relieve the operator of responsibility for compliance with any other federal, state, or local laws and/or regulations.		

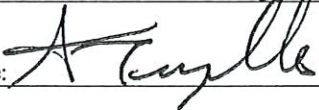
Signature: 	<u>OIL CONSERVATION DIVISION</u>	
Printed Name: Amanda Trujillo	Approved by District Supervisor:	
Title: Environmental Scientist	Approval Date:	Expiration Date:
E-mail Address: atrujillo@yatespetroleum.com	Conditions of Approval:	
Date: Tuesday, September 27, 2011 Phone: 575-748-4310	Attached <input type="checkbox"/>	

Attach Additional Sheets If Necessary

YATES PETROLEUM CORPORATION

Friday, January 14, 2011

Anadarko Pardue Farms ANQ Com
Prop #010711_001

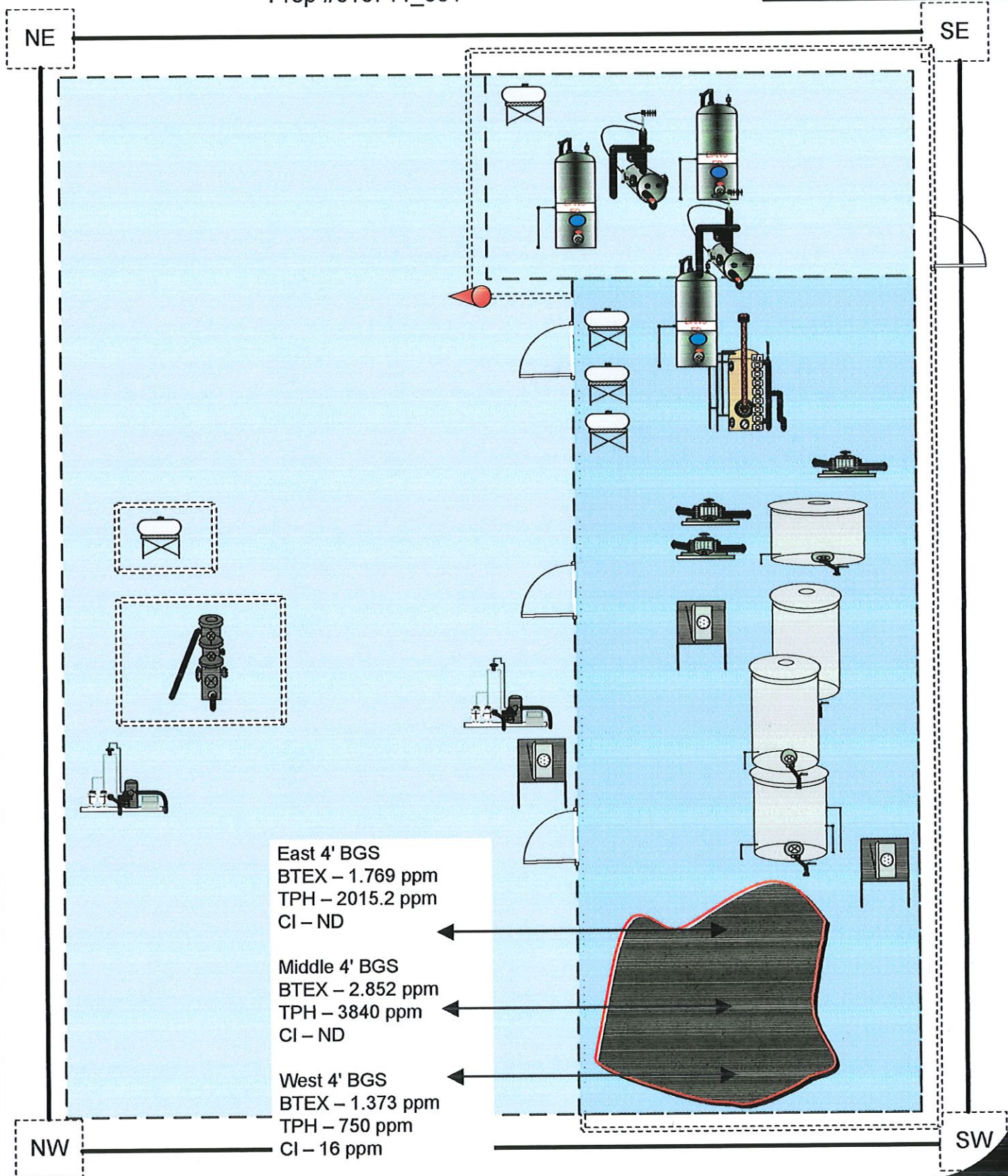



PHONE (575) 393-2326 • 101 E. MARLAND • HOBBS, NM 88240

January 14, 2011

AMANDA TRUJILLO

Yates Energy Petroleum Corp

105 S 4th Street

Artesia, NM 88210

RE: ANADARKO PARDU BATTERY

Enclosed are the results of analyses for samples received by the laboratory on 01/07/11 14:00.

Cardinal Laboratories is accredited through Texas NELAP for:

Method SW-846 8021	Benzene, Toluene, Ethyl Benzene, and Total Xylenes
Method SW-846 8260	Benzene, Toluene, Ethyl Benzene, and Total Xylenes
Method TX 1005	Total Petroleum Hydrocarbons

Certificate number T104704398-08-TX. Accreditation applies to solid and chemical materials and non-potable water matrices.

Cardinal Laboratories is accredited through the State of Colorado Department of Public Health and Environment for:

Method EPA 552.2	Haloacetic Acids (HAA-5)
Method EPA 524.2	Total Trihalomethanes (TTHM)
Method EPA 524.4	Regulated VOCs (V2, V3)

Accreditation applies to public drinking water matrices.

This report meets NELAP requirements and is made up of a cover page, analytical results, and a copy of the original chain-of-custody. If you have any questions concerning this report, please feel free to contact me.

Sincerely,

Celey D. Keene
Lab Director/Quality Manager



PHONE (575) 393-2326 • 101 E. MARLAND • HOBBS, NM 88240

Analytical Results For:

Yates Energy Petroleum Corp
 AMANDA TRUJILLO
 105 S 4th Street
 Artesia NM, 88210
 Fax To: (505) 748-4635

Received: 01/07/2011
 Reported: 01/14/2011
 Project Name: ANADARKO PARDU BATTERY
 Project Number: NONE GIVEN
 Project Location: NOT GIVEN

Sampling Date: 01/06/2011
 Sampling Type: Soil
 Sampling Condition: Cool & Intact
 Sample Received By: Jodi Henson

Sample ID: WEST 4' BGS (H100047-01)

BTX 8021B		mg/kg		Analyzed By: CMS					
Analyte	Result	Reporting Limit	Analyzed	Method Blank	BS	% Recovery	True Value QC	RPD	Qualifier
Benzene*	<0.050	0.050	01/12/2011	ND	1.72	86.1	2.00	5.22	
Toluene*	0.143	0.050	01/12/2011	ND	1.83	91.5	2.00	2.75	
Ethylbenzene*	<0.050	0.050	01/12/2011	ND	2.03	102	2.00	0.932	
Total Xylenes*	1.23	0.150	01/12/2011	ND	6.32	105	6.00	0.155	

Surrogate: 4-Bromofluorobenzene (PIL) 124 % 70-130

Chloride, SM4500Cl-B		mg/kg		Analyzed By: HM					
Analyte	Result	Reporting Limit	Analyzed	Method Blank	BS	% Recovery	True Value QC	RPD	Qualifier
Chloride	16.0	16.0	01/10/2011	ND	432	108	400	3.64	

TPH 8015M		mg/kg		Analyzed By: AB					
Analyte	Result	Reporting Limit	Analyzed	Method Blank	BS	% Recovery	True Value QC	RPD	Qualifier
GRO C6-C10	<10.0	10.0	01/12/2011	ND	250	100	250	4.12	
DRO >C10-C28	750	10.0	01/12/2011	ND	238	95.1	250	3.38	

Surrogate: 1-Chlorooctane 81.5 % 70-130

Surrogate: 1-Chlorooctadecane 87.2 % 70-130

Cardinal Laboratories

*=Accredited Analyte

PLEASE NOTE: Liability and Damages. Cardinal's liability and client's exclusive remedy for any claim arising, whether based in contract or tort, shall be limited to the amount paid by client for analyses. All claims, including those for negligence and any other cause whatsoever shall be deemed waived unless made in writing and received by Cardinal within thirty (30) days after completion of the applicable service. In no event shall Cardinal be liable for incidental or consequential damages, including, without limitation, business interruptions, loss of use, or loss of profits incurred by client, its subsidiaries, affiliates or successors arising out of or related to the performance of the services hereunder by Cardinal, regardless of whether such claim is based upon any of the above stated reasons or otherwise. Results relate only to the samples identified above. This report shall not be reproduced except in full with written approval of Cardinal Laboratories.

Celey D. Keene, Lab Director/Quality Manager

Page 2 of 6



PHONE (575) 393-2326 • 101 E. MARLAND • HOBBS, NM 88240

Analytical Results For:

Yates Energy Petroleum Corp
 AMANDA TRUJILLO
 105 S 4th Street
 Artesia NM, 88210
 Fax To: (505) 748-4635

Received: 01/07/2011
 Reported: 01/14/2011
 Project Name: ANADARKO PARDU BATTERY
 Project Number: NONE GIVEN
 Project Location: NOT GIVEN

Sampling Date: 01/06/2011
 Sampling Type: Soil
 Sampling Condition: Cool & Intact
 Sample Received By: Jodi Henson

Sample ID: MIDDLE 4' BGS (H100047-02)

BTX 8021B			mg/kg						
			Analyzed By: CMS						
Analyte	Result	Reporting Limit	Analyzed	Method Blank	BS	% Recovery	True Value QC	RPD	Qualifier
Benzene*	<0.050	0.050	01/12/2011	ND	1.72	86.1	2.00	5.22	
Toluene*	0.351	0.050	01/12/2011	ND	1.83	91.5	2.00	2.75	
Ethylbenzene*	0.261	0.050	01/12/2011	ND	2.03	102	2.00	0.932	
Total Xylenes*	2.24	0.150	01/12/2011	ND	6.32	105	6.00	0.155	

Surrogate: 4-Bromofluorobenzene (PIL) 114 % 70-130

Chloride, SM4500Cl-B			mg/kg						
			Analyzed By: HM						
Analyte	Result	Reporting Limit	Analyzed	Method Blank	BS	% Recovery	True Value QC	RPD	Qualifier
Chloride	<16.0	16.0	01/10/2011	ND	432	108	400	3.64	

TPH 8015M			mg/kg						
			Analyzed By: AB						
Analyte	Result	Reporting Limit	Analyzed	Method Blank	BS	% Recovery	True Value QC	RPD	Qualifier
GRO C6-C10	51.5	10.0	01/12/2011	ND	250	100	250	4.12	
DRO >C10-C28	3840	100	01/12/2011	ND	238	95.1	250	3.38	

Surrogate: 1-Chlorooctane 86.0 % 70-130

Surrogate: 1-Chlorooctadecane 92.5 % 70-130

Cardinal Laboratories

*=Accredited Analyte

PLEASE NOTE: Liability and Damages. Cardinal's liability and client's exclusive remedy for any claim arising, whether based in contract or tort, shall be limited to the amount paid by client for analyses. All claims, including those for negligence and any other cause whatsoever shall be deemed waived unless made in writing and received by Cardinal within thirty (30) days after completion of the applicable service. In no event shall Cardinal be liable for incidental or consequential damages, including, without limitation, business interruptions, loss of use, or loss of profits incurred by client, its subsidiaries, affiliates or successors arising out of or related to the performance of the services hereunder by Cardinal, regardless of whether such claim is based upon any of the above stated reasons or otherwise. Results relate only to the samples identified above. This report shall not be reproduced except in full with written approval of Cardinal Laboratories.

Celey D. Keene, Lab Director/Quality Manager

Page 3 of 6



PHONE (575) 393-2326 • 101 E. MARLAND • HOBBS, NM 88240

Analytical Results For:

Yates Energy Petroleum Corp
 AMANDA TRUJILLO
 105 S 4th Street
 Artesia NM, 88210
 Fax To: (505) 748-4635

Received: 01/07/2011
 Reported: 01/14/2011
 Project Name: ANADARKO PARDU BATTERY
 Project Number: NONE GIVEN
 Project Location: NOT GIVEN

Sampling Date: 01/06/2011
 Sampling Type: Soil
 Sampling Condition: Cool & Intact
 Sample Received By: Jodi Henson

Sample ID: EAST 4' BGS (H100047-03)

BTX 8021B		mg/kg		Analyzed By: CMS					
Analyte	Result	Reporting Limit	Analyzed	Method Blank	BS	% Recovery	True Value QC	RPD	Qualifier
Benzene*	<0.050	0.050	01/12/2011	ND	1.72	86.1	2.00	5.22	
Toluene*	0.120	0.050	01/12/2011	ND	1.83	91.5	2.00	2.75	
Ethylbenzene*	0.159	0.050	01/12/2011	ND	2.03	102	2.00	0.932	
Total Xylenes*	1.49	0.150	01/12/2011	ND	6.32	105	6.00	0.155	

Surrogate: 4-Bromofluorobenzene (PIL) 128 % 70-130

Chloride, SM4500CI-B		mg/kg		Analyzed By: HM					
Analyte	Result	Reporting Limit	Analyzed	Method Blank	BS	% Recovery	True Value QC	RPD	Qualifier
Chloride	<16.0	16.0	01/10/2011	ND	432	108	400	3.64	

TPH 8015M		mg/kg		Analyzed By: AB					
Analyte	Result	Reporting Limit	Analyzed	Method Blank	BS	% Recovery	True Value QC	RPD	Qualifier
GRO C6-C10	35.2	10.0	01/12/2011	ND	250	100	250	4.12	
DRO >C10-C28	1980	10.0	01/12/2011	ND	238	95.1	250	3.38	

Surrogate: 1-Chlorooctane 85.4 % 70-130

Surrogate: 1-Chlorooctadecane 82.8 % 70-130

Cardinal Laboratories

* = Accredited Analyte

PLEASE NOTE: Liability and Damages. Cardinal's liability and client's exclusive remedy for any claim arising, whether based in contract or tort, shall be limited to the amount paid by client for analyses. All claims, including those for negligence and any other cause whatsoever shall be deemed waived unless made in writing and received by Cardinal within thirty (30) days after completion of the applicable service. In no event shall Cardinal be liable for incidental or consequential damages, including, without limitation, business interruptions, loss of use, or loss of profits incurred by client, its subsidiaries, affiliates or successors arising out of or related to the performance of the services hereunder by Cardinal, regardless of whether such claim is based upon any of the above stated reasons or otherwise. Results relate only to the samples identified above. This report shall not be reproduced except in full with written approval of Cardinal Laboratories.

Celey D. Keene, Lab Director/Quality Manager

Page 4 of 6



CARDINAL Laboratories

PHONE (575) 393-2326 • 101 E. MARLAND • HOBBS, NM 88240

Notes and Definitions

- S-04 The surrogate recovery for this sample is outside of established control limits due to a sample matrix effect.
- ND Analyte NOT DETECTED at or above the reporting limit
- RPD Relative Percent Difference
- ** Samples not received at proper temperature of 6°C or below.
- *** Insufficient time to reach temperature.
- Chloride by SM4500Cl-B does not require samples be received at or below 6°C
Samples reported on an as received basis (wet) unless otherwise noted on report

Cardinal Laboratories

*=Accredited Analyte

PLEASE NOTE: Liability and Damages. Cardinal's liability and client's exclusive remedy for any claim arising, whether based in contract or tort, shall be limited to the amount paid by client for analyses. All claims, including those for negligence and any other cause whatsoever shall be deemed waived unless made in writing and received by Cardinal within thirty (30) days after completion of the applicable service. In no event shall Cardinal be liable for incidental or consequential damages, including, without limitation, business interruptions, loss of use, or loss of profits incurred by client, its subsidiaries, affiliates or successors arising out of or related to the performance of the services hereunder by Cardinal, regardless of whether such claim is based upon any of the above stated reasons or otherwise. Results relate only to the samples identified above. This report shall not be reproduced except in full with written approval of Cardinal Laboratories.

Celey D. Keene, Lab Director/Quality Manager



CARDINAL LABORATORIES
101 East Marland, Hobbs, NM 88240

CHAIN OF CUSTODY RECORD AND ANALYSIS REQUEST

(505) 393-2326 FAX (505) 393-2476

Project Manager: Amanda Trujillo Project Name: Anadarko Pardu Battery

Company Address: 105 South 4th Street Project #:

City/State/Zip: Artesia, NM 88210 Project Loc: Anadarko Pardu Battery

Telephone No: 575-748-4310 PO #:

Fax No: Report Format: Standard TRRP NPDES

Sampler Signature: atrujillo@yatespetroleum.com

ORDER #:		LAB # (lab use only)		Beginning Depth		Ending Depth		Date Sampled		Time Sampled		Field # of Containers		Preservation & # of Containers		Matrix		Analyze For:		Laboratory Comments:	
H1000 FIELD COPY		West 4' BGS		4' 6"		1/6/2011		9:00 AM		1		1		1		S		SAR / ESP / CEC		N	
		Middle 4' BGS		4' 6"		1/6/2011		9:00 AM		1		1		1		S		BTEX 8021B/5020 or BTEX 8260		N	
		East 4' BGS		4' 6"		1/6/2011		9:00 AM		1		1		1		S		Volatiles		N	
																		Metals: As Ag Ba Cd Cr Pb Hg Se		N	
																		Chlorides		N	
																		RUSH TAT (Per Schedule) 24, 48, 72 hrs		N	

Special Instructions: Please place chloride results on separate report. Thank you.

Relinquished by: [Signature] Date: 01/07/11 Time: 11:23 AM

Relinquished by: [Signature] Date: 1/7/11 Time:

Relinquished by: [Signature] Date: Time:

Temperature Upon Receipt: 1.5 °C

Anadarko Pardue Farms ANQ Com #1
Closure Report
#nMLB1031337060



August 30, 2022

Appendix E

Current C-141 Closure

District I
1625 N. French Dr., Hobbs, NM 88240
District II
811 S. First St., Artesia, NM 88210
District III
1000 Rio Brazos Road, Aztec, NM 87410
District IV
1220 S. St. Francis Dr., Santa Fe, NM 87505

State of New Mexico
Energy Minerals and Natural
Resources Department

Oil Conservation Division
1220 South St. Francis Dr.
Santa Fe, NM 87505

Form C-141
Revised August 24, 2018
Submit to appropriate OCD District office

Incident ID	nMLB1031337060
District RP	2RP-468
Facility ID	
Application ID	

Release Notification

Responsible Party

Responsible Party EOG Resources, Inc.	OGRID 7377
Contact Name Chase Settle	Contact Telephone 575-748-1471
Contact email Chase_Settle@eogresources.com	Incident # (assigned by OCD) nMLB1031337060
Contact mailing address 104 S. 4th Street, Artesia, NM 88210	

Location of Release Source

Latitude 32.45146 Longitude -104.48801
(NAD 83 in decimal degrees to 5 decimal places)

Site Name Anadarko Pardue Farms ANQ Com #1	Site Type Battery
Date Release Discovered 09/07/2010	API# (if applicable) 30-015-22212

Unit Letter	Section	Township	Range	County
F	27	21S	24E	Eddy

Surface Owner: ☐ State ☐ Federal ☐ Tribal ☒ Private (Name: Pardue & Joyce)

Nature and Volume of Release

Material(s) Released (Select all that apply and attach calculations or specific justification for the volumes provided below)

<input checked="" type="checkbox"/> Crude Oil	Volume Released (bbls) 18	Volume Recovered (bbls) 10
<input type="checkbox"/> Produced Water	Volume Released (bbls)	Volume Recovered (bbls)
	Is the concentration of dissolved chloride in the produced water >10,000 mg/l?	<input type="checkbox"/> Yes <input type="checkbox"/> No
<input type="checkbox"/> Condensate	Volume Released (bbls)	Volume Recovered (bbls)
<input type="checkbox"/> Natural Gas	Volume Released (Mcf)	Volume Recovered (Mcf)
<input type="checkbox"/> Other (describe)	Volume/Weight Released (provide units)	Volume/Weight Recovered (provide units)

Cause of Release Please refer to the original C-141 for details of 2RP-468.

Oil Conservation Division

Incident ID	nMLB1031337060
District RP	2RP-468
Facility ID	
Application ID	

Was this a major release as defined by 19.15.29.7(A) NMAC? <input type="checkbox"/> Yes <input checked="" type="checkbox"/> No	If YES, for what reason(s) does the responsible party consider this a major release?
If YES, was immediate notice given to the OCD? By whom? To whom? When and by what means (phone, email, etc)?	

Initial Response

The responsible party must undertake the following actions immediately unless they could create a safety hazard that would result in injury

<input checked="" type="checkbox"/> The source of the release has been stopped. <input checked="" type="checkbox"/> The impacted area has been secured to protect human health and the environment. <input checked="" type="checkbox"/> Released materials have been contained via the use of berms or dikes, absorbent pads, or other containment devices. <input checked="" type="checkbox"/> All free liquids and recoverable materials have been removed and managed appropriately.	
If all the actions described above have <u>not</u> been undertaken, explain why:	
Per 19.15.29.8 B. (4) NMAC the responsible party may commence remediation immediately after discovery of a release. If remediation has begun, please attach a narrative of actions to date. If remedial efforts have been successfully completed or if the release occurred within a lined containment area (see 19.15.29.11(A)(5)(a) NMAC), please attach all information needed for closure evaluation.	
I hereby certify that the information given above is true and complete to the best of my knowledge and understand that pursuant to OCD rules and regulations all operators are required to report and/or file certain release notifications and perform corrective actions for releases which may endanger public health or the environment. The acceptance of a C-141 report by the OCD does not relieve the operator of liability should their operations have failed to adequately investigate and remediate contamination that pose a threat to groundwater, surface water, human health or the environment. In addition, OCD acceptance of a C-141 report does not relieve the operator of responsibility for compliance with any other federal, state, or local laws and/or regulations.	
Printed Name: <u>Chase Settle</u>	Title: <u>Rep Safety & Environmental Sr</u>
Signature: <u>Chase Settle</u>	Date: <u>08/30/2022</u>
email: <u>Chase_Settle@eogresources.com</u>	Telephone: <u>575-748-1471</u>
<u>OCD Only</u>	
Received by: _____	Date: _____

Incident ID	nMLB1031337060
District RP	2RP-468
Facility ID	
Application ID	

Closure

The responsible party must attach information demonstrating they have complied with all applicable closure requirements and any conditions or directives of the OCD. This demonstration should be in the form of a comprehensive report (electronic submittals in .pdf format are preferred) including a scaled site map, sampling diagrams, relevant field notes, photographs of any excavation prior to backfilling, laboratory data including chain of custody documents of final sampling, and a narrative of the remedial activities. Refer to 19.15.29.12 NMAC.

Closure Report Attachment Checklist: *Each of the following items must be included in the closure report.*

- ☒ A scaled site and sampling diagram as described in 19.15.29.11 NMAC
- ☐ Photographs of the remediated site prior to backfill or photos of the liner integrity if applicable (Note: appropriate OCD District office must be notified 2 days prior to liner inspection)
- ☒ Laboratory analyses of final sampling (Note: appropriate ODC District office must be notified 2 days prior to final sampling)
- ☒ Description of remediation activities

I hereby certify that the information given above is true and complete to the best of my knowledge and understand that pursuant to OCD rules and regulations all operators are required to report and/or file certain release notifications and perform corrective actions for releases which may endanger public health or the environment. The acceptance of a C-141 report by the OCD does not relieve the operator of liability should their operations have failed to adequately investigate and remediate contamination that pose a threat to groundwater, surface water, human health or the environment. In addition, OCD acceptance of a C-141 report does not relieve the operator of responsibility for compliance with any other federal, state, or local laws and/or regulations. The responsible party acknowledges they must substantially restore, reclaim, and re-vegetate the impacted surface area to the conditions that existed prior to the release or their final land use in accordance with 19.15.29.13 NMAC including notification to the OCD when reclamation and re-vegetation are complete.

Printed Name: Chase Settle

Title: Rep Safety & Environmental Sr

Signature: Chase Settle

Date: 08/30/2022

email: Chase_Settle@eogresources.com

Telephone: 575-748-1471

OCD Only

Received by: OCD

Date: 8/31/2022

Closure approval by the OCD does not relieve the responsible party of liability should their operations have failed to adequately investigate and remediate contamination that poses a threat to groundwater, surface water, human health, or the environment nor does not relieve the responsible party of compliance with any other federal, state, or local laws and/or regulations.

Closure Approved by: Ashley Maxwell

Date: 3/7/2023

Printed Name: Ashley Maxwell

Title: Environmental Specialist

District I
1625 N. French Dr., Hobbs, NM 88240
Phone:(575) 393-6161 Fax:(575) 393-0720
District II
811 S. First St., Artesia, NM 88210
Phone:(575) 748-1283 Fax:(575) 748-9720
District III
1000 Rio Brazos Rd., Aztec, NM 87410
Phone:(505) 334-6178 Fax:(505) 334-6170
District IV
1220 S. St Francis Dr., Santa Fe, NM 87505
Phone:(505) 476-3470 Fax:(505) 476-3462

State of New Mexico
Energy, Minerals and Natural Resources
Oil Conservation Division
1220 S. St Francis Dr.
Santa Fe, NM 87505

CONDITIONS

Action 139879

CONDITIONS

Operator: EOG RESOURCES INC P.O. Box 2267 Midland, TX 79702	OGRID: 7377
	Action Number: 139879
	Action Type: [C-141] Release Corrective Action (C-141)

CONDITIONS

Created By	Condition	Condition Date
amaxwell	None	3/7/2023