

Status Report

Well/Location Name: **Mango BRM State #1H**

Field Supervisor: J. Palma

Location: Section 27, T20S-R35E; 100' FNL & 2310' FWL; (Unit C, NENW)

Lea County, NM

Latitude: 32.55103

Longitude: 103.44576

API # 30-025-40517

Surface Owner: State

Mineral Owner: State

Directions: BETWEEN CARLSBAD AND HOBBS ON HWY 62/180 @ MM68, GO SOUTH ON HWY 176 FOR 19.3 MILES, (3/10 MILE EAST OF MM 19). TURN LEFT (NORTH) ON PEARSON RD (CR 30) FOR 4.32 MILES. TURN LEFT (WEST) AT Y AND GO 5.10 MILES. STAY ON MAIN ROAD HEADING WEST/NORTH WEST. AFTER 4.9 MILES THER WILL BE A CATTLE WATERING ON THE NORTH SIDE OF THE ROAD, TURN LEFT (SOUTH) AND GO .9 MILE. TURN RIGHT (WEST) AND GO 300' TO LOCATION.

SITE RANKING IS TEN (10). Depth to Ground Water: 50-99' (approx. 70', per ChevronTexaco Trend Map), Wellhead Protection Area: No, Distance to Surface Water Body: >1000'.

[illegible]

MANGO BRM STATE #1H

SEC 27/TWN 20S/RNG 35E/UNT C

LEA COUNTY, NEW MEXICO

BETWEEN CARLSBAD AND HOBBS ON HWY 62/180 @ MM68, GO SOUTH ON HWY 176 FOR 19.3 MILES, (3/10 MILE EAST OF MM 19). TURN LEFT (NORTH) ON PEARSON RD (CR 30) FOR 4.32 MILES. TURN LEFT (WEST) AT Y AND GO 5.10 MILES. STAY ON MAIN ROAD HEADING WEST/NORTH WEST. AFTER 4.9 MILES THERE WILL BE A CATTLE WATERING ON THE NORTH SIDE OF THE ROAD, TURN LEFT (SOUTH) AND GO .9 MILE. TURN RIGHT (WEST) AND GO 300' TO LOCATION.

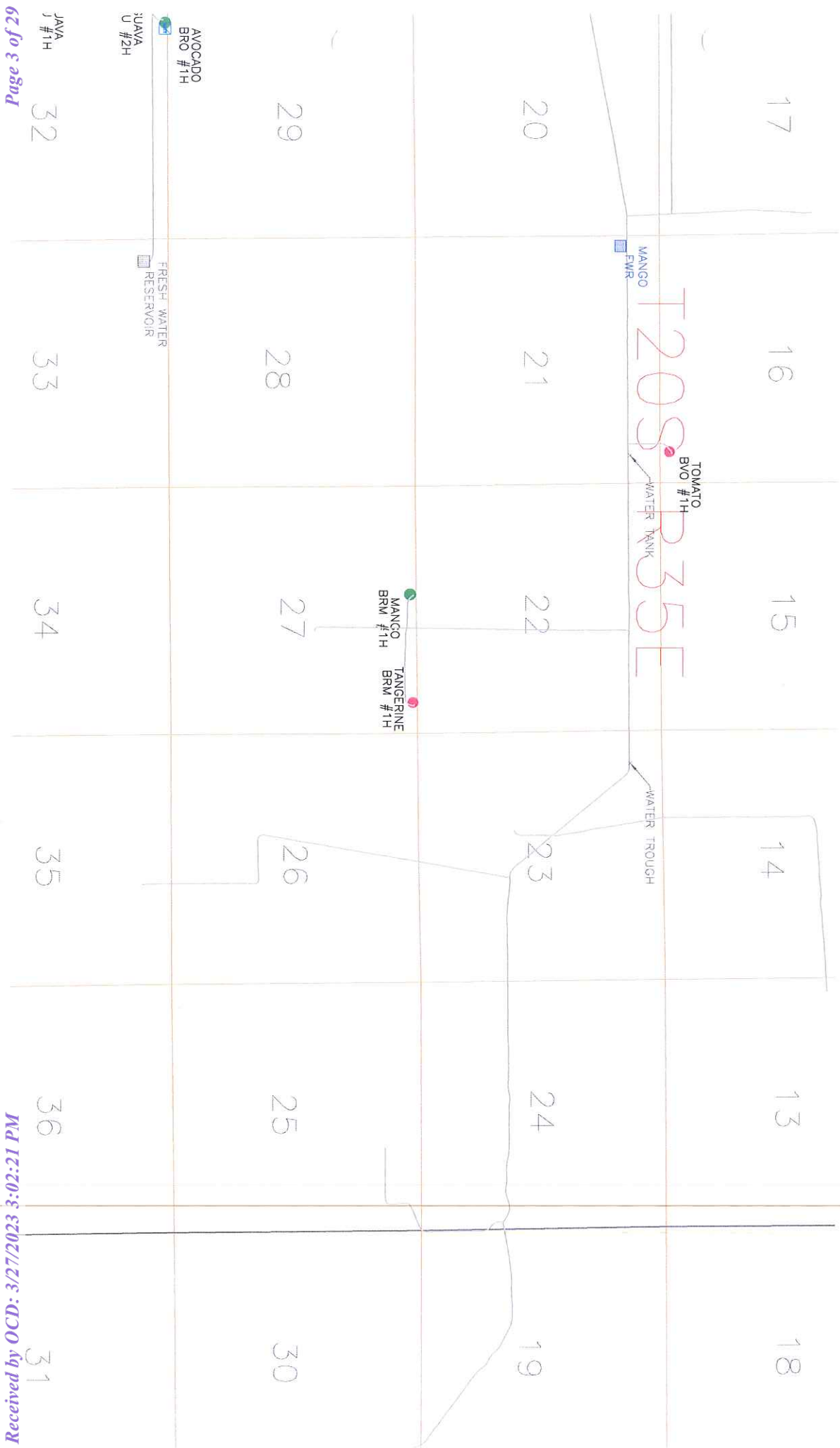



Scout Ticket

Thu Dec 11, 2014

30025405170000

General Information

IH MANGO BRM STATE

Data Source:	PI	IC:	
API:	30025405170000	County:	LEA
State:	NEW MEXICO	Operator:	YATES PETROLEUM CORP
Field:	FEATHERSTONE	Current Operator:	YATES PETROLEUM CORPORATION
Current Status:		Final Well Class:	PILOT HOLE (P)
Initial Class:	PILOT HOLE (P)	Target Objective:	PILOT
Status:	PILOT	Hole Direction:	VERTICAL
Permit:	on Apr 12, 2012	Abandonment Date:	
First Report Date:	Apr 13, 2012	Projected Formation:	BONE SPRING
Projected TD:	10,850 FT	Formation at TD:	BONE SPRING
Geologic Province:	PERMIAN BASIN	Play Type:	
Play Name:			

Location

Section, Twp., Range:	27 20S 35E	Data Source:	PI
Spot Code:			
Footage NS EW Origin:	100 FNL 2310 FWL CONGRESS SECTION		
Principal Meridian:	NEW MEXICO		
Lat/Long:	+32.5510300 -103.4457600	Lat/Long Source:	TS
		Datum:	NAD27

Location Narrative

Data Source	Type	Remark
PI	SCALED_FOOT	REGULATORY
PI	IRREG_SECT	N

Dates and Depths

Data Source:	PI	Spud Date Code:	A
Spud:	Jun 15, 2014	TD Date:	Jul 06, 2014
TD:	10,850 FT	PlugBack Depth:	10,106 FT
TVD:		Formation Name TD:	BONE SPRING
Formation Code TD:	452BSPG	KB. Elevation:	3,703 FT
Ref. Elevation:	3,703 FT KB	LTD:	10,860 FT
Ground Elevation:	3,682 FT GR		
Contractor:	NOMAC DRILLING	Final Drilling:	Jul 06, 2014
Completed:	Jul 06, 2014	Rig #:	22
Rig Release Date:			
Tool:	ROTARY		

Casing, Liner, Tubing

Casing	Data Source	Size	Base Depth	Cement
CASING	PI	20 IN	60 FT	177 SACK
CASING	PI	30 IN	13 FT	
CASING	PI	9 5/8 IN	5,857 FT	1,981 SACK
CASING	PI	13 3/8 IN	1,970 FT	1,285 SACK

Drilling Journal

Mud Records

Data Source	Depth	Unit	Weight	Unit
PI				

District I
1625 N. French Dr., Hobbs, NM 88240
District II
811 S. First St., Artesia, NM 88210
District III
1000 Rio Brazos Road, Aztec, NM 87410
District IV
1220 S. St. Francis Dr., Santa Fe, NM 87505

State of New Mexico
Energy Minerals and Natural Resources

Oil Conservation Division
1220 South St. Francis Dr.
Santa Fe, NM 87505

Form C-141
Revised August 8, 2011

Submit 1 Copy to appropriate District Office in
accordance with 19.15.29 NMAC.

Release Notification and Corrective Action

OPERATOR

☐ Initial Report ☒ Final Report

Name of Company Yates Petroleum Corporation	Contact Bob Asher
Address 104 S. 4 th Street	Telephone No. 575-748-1471
Facility Name Mango BRM State #1H	Facility Type Battery

Surface Owner State	Mineral Owner State	API No. 30-025-40517
------------------------	------------------------	-------------------------

LOCATION OF RELEASE

Unit Letter C	Section 27	Township 20S	Range 35E	Feet from the 100	North/South Line North	Feet from the 2310	East/West Line West	County Lea
------------------	---------------	-----------------	--------------	----------------------	---------------------------	-----------------------	------------------------	---------------

Latitude 32.55103 Longitude 103.44576

NATURE OF RELEASE

Type of Release Crude Oil	Volume of Release 10 B/O	Volume Recovered 5 B/O
Source of Release Supply line	Date and Hour of Occurrence 11/17/2014; AM	Date and Hour of Discovery 11/17/2014; AM
Was Immediate Notice Given? <input type="checkbox"/> Yes <input checked="" type="checkbox"/> No <input type="checkbox"/> Not Required	If YES, To Whom? N/A	
By Whom? N/A	Date and Hour N/A	
Was a Watercourse Reached? <input type="checkbox"/> Yes <input checked="" type="checkbox"/> No	If YES, Volume Impacting the Watercourse.	

If a Watercourse was Impacted, Describe Fully.*

Describe Cause of Problem and Remedial Action Taken.*

The supply line was frozen, causing the release. Wells were shut off and vacuum truck(s) were called.

Describe Area Affected and Cleanup Action Taken.*

An approximate area of 50' X 200' on production pad and 90' x 300' (overspray/off pad). Production equipment was shut off and vacuum trucks were called to remove remaining oil. Impacted soils will be scraped and hauled to a NMOCD approved facility. Vegetation on overspray area will be Micro Blazed. Vertical and horizontal delineation samples will be taken and analysis ran for TPH & BTEX. If initial analytical results for TPH & BTEX are under RRAL's (site ranking is 10) a Final Report, C-141 will be submitted to the OCD requesting closure. **Depth to Ground Water: 50-99' (approximately 70' per ChevronTexaco Trend Map), Wellhead Protection Area: No, Distance to Surface Water Body: >1000', SITE RANKING IS 10. Based on requested site samples and enclosed results, Yates Petroleum Corporation requests closure.**

I hereby certify that the information given above is true and complete to the best of my knowledge and understand that pursuant to NMOCD rules and regulations all operators are required to report and/or file certain release notifications and perform corrective actions for releases which may endanger public health or the environment. The acceptance of a C-141 report by the NMOCD marked as "Final Report" does not relieve the operator of liability should their operations have failed to adequately investigate and remediate contamination that pose a threat to ground water, surface water, human health or the environment. In addition, NMOCD acceptance of a C-141 report does not relieve the operator of responsibility for compliance with any other federal, state, or local laws and/or regulations.

Signature: 		<u>OIL CONSERVATION DIVISION</u>	
Printed Name: Robert Asher		Approved by Environmental Specialist:	
Title: NM Environmental Regulatory Supervisor	Approval Date:	Expiration Date:	
E-mail Address: boba@yatespetroleum.com	Conditions of Approval:		Attached <input type="checkbox"/>
Date: December 8, 2014	Phone: 575-748-4217	1RP-3444	

Attach Additional Sheets If Necessary

District I
1625 N. French Dr., Hobbs, NM 88240
District II
811 S. First St., Artesia, NM 88210
District III
1000 Rio Brazos Road, Aztec, NM 87410
District IV
1220 S. St. Francis Dr., Santa Fe, NM 87505

HOBBS OCD

DEC 10 2014

RECEIVED

State of New Mexico
Energy Minerals and Natural Resources

Oil Conservation Division
1220 South St. Francis Dr.
Santa Fe, NM 87505

Form C-141
Revised August 8, 2011

Submit 1 Copy to appropriate District Office in
accordance with 19.15.29 NMAC.

Release Notification and Corrective Action

OPERATOR

☒ Initial Report ☐ Final Report

Name of Company Yates Petroleum Corporation	Contact Bob Asher
Address 104 S. 4 th Street	Telephone No. 575-748-1471
Facility Name Mango BRM State #1H	Facility Type Battery
Surface Owner State	Mineral Owner State
API No. 30-025-40517	

LOCATION OF RELEASE

Unit Letter	Section	Township	Range	Feet from the	North/South Line	Feet from the	East/West Line	County
C	27	20S	35E	100	North	2310	West	Lea

Latitude 32.55103 Longitude 103.44576

NATURE OF RELEASE

Type of Release Crude Oil	Volume of Release 10 B/O	Volume Recovered 5 B/O
Source of Release Supply line	Date and Hour of Occurrence 11/17/2014; AM	Date and Hour of Discovery 11/17/2014; AM
Was Immediate Notice Given? <input type="checkbox"/> Yes <input checked="" type="checkbox"/> No <input type="checkbox"/> Not Required	If YES, To Whom? N/A	
By Whom? N/A	Date and Hour N/A	
Was a Watercourse Reached? <input type="checkbox"/> Yes <input checked="" type="checkbox"/> No	If YES, Volume Impacting the Watercourse.	

If a Watercourse was Impacted, Describe Fully.*

Describe Cause of Problem and Remedial Action Taken.*

The supply line was frozen, causing the release. Wells were shut off and vacuum truck(s) were called.

Describe Area Affected and Cleanup Action Taken.*

An approximate area of 50' X 200' oil production pad and 90' x 300' (overspray/off pad). Production equipment was shut off and vacuum trucks were called to remove remaining oil. Impacted soils will be scraped and hauled to a NMOCD approved facility. Vegetation on overspray area will be Micro Blazed. Vertical and horizontal delineation samples will be taken and analysis ran for TPH & BTEX. If initial analytical results for TPH & BTEX are under RRAL's (site ranking is 10) a Final Report, C-141 will be submitted to the OCD requesting closure. If the analytical results are above the RRAL's a work-plan will be submitted to the OCD. Depth to Ground Water: 50-99' (approximately 70' per ChevronTexaco Trend Map), Wellhead Protection Area: No, Distance to Surface Water Body: >1000', SITE RANKING IS 10.

I hereby certify that the information given above is true and complete to the best of my knowledge and understand that pursuant to NMOCD rules and regulations all operators are required to report and/or file certain release notifications and perform corrective actions for releases which may endanger public health or the environment. The acceptance of a C-141 report by the NMOCD marked as "Final Report" does not relieve the operator of liability should their operations have failed to adequately investigate and remediate contamination that pose a threat to ground water, surface water, human health or the environment. In addition, NMOCD acceptance of a C-141 report does not relieve the operator of responsibility for compliance with any other federal, state, or local laws and/or regulations.

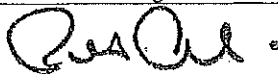
Signature: 	OIL CONSERVATION DIVISION	
Printed Name: Robert Asher	Approved by Environmental Specialist:	
Title: NM Environmental Regulatory Supervisor	Approval Date: 12-10-15	Expiration Date: 2-10-15
E-mail Address: boba@yatespetroleum.com	Conditions of Approval: Site Sample required	Attached <input type="checkbox"/>
Date: December 8, 2014 Phone: 575-748-4217	IRP- Release & remediate per report 70' RRAL grade, Sublet Fair C-141 by 2-10-15 11/14 3442 9856 11/14 7443 0069	

* Attach Additional Sheets If Necessary

DEC 11 2014

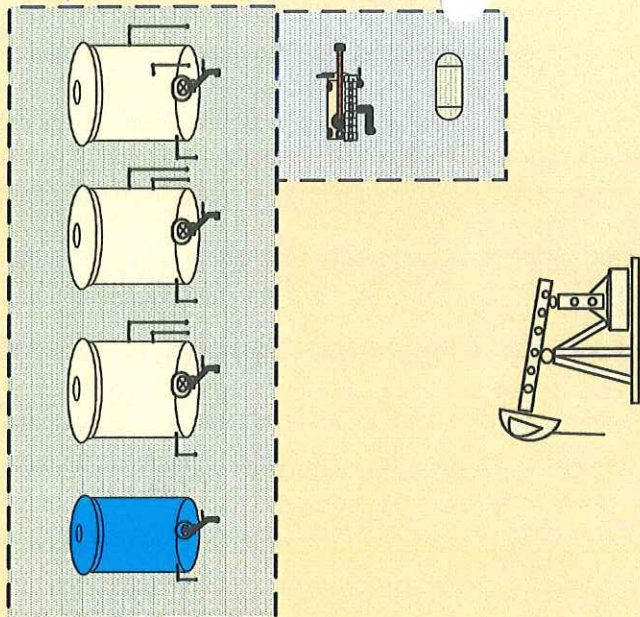

NOT TO SCALE

Analytical Report-160BF07 (Hall)	Sample Area	Sample Date	Sample Type	Depth	BTEX	GRO	DRO
0.5P	Release/Scraped/Sample Area-Pad	8/23/2016	Grab/Auger	6"	ND	ND	1100
1.0P	Release/Scraped/Sample Area-Pad	8/23/2016	Grab/Auger	12"	ND	ND	24
1.5P	Release/Scraped/Sample Area-Pad	8/23/2016	Grab/Auger	18"	ND	ND	ND
Analytical Report-160BF07 (Hall)	Sample Area	Sample Date	Sample Type	Depth	BTEX	GRO	DRO
0.5E	Release/Overspray/Sample Area-Pasture	8/23/2016	Grab/Auger	6"	ND	ND	ND
1.0E	Release/Overspray/Sample Area-Pasture	8/23/2016	Grab/Auger	12"	ND	ND	ND
1.5E	Release/Overspray/Sample Area-Pasture	8/23/2016	Grab/Auger	18"	ND	ND	ND

Mango BRM State #1H, Section 27, T20S-R35E, Lea County, New Mexico

Site Ranking is Ten (10). Depth to Ground Water 50'-99' (approx. 70', per Trend Map).

All results are ppm. X - Sample Points

Released : 10 B/O; Recovered: 5 B/O. Release Date: 11/17/2014





Hall Environmental Analysis Laboratory
4901 Hawkins NE
Albuquerque, NM 87109
TEL: 505-345-3975 FAX: 505-345-4107
Website: www.hallenvironmental.com

September 16, 2016

Robert Asher
Yates Petroleum Corporation
105 South Fourth Street
Artesia, NM 88210
TEL: (575) 748-4111
FAX

RE: Mango BRM State 1H

OrderNo.: 1608F07

Dear Robert Asher:

Hall Environmental Analysis Laboratory received 6 sample(s) on 8/25/2016 for the analyses presented in the following report.

This report is a revised report and it replaces the original report issued September 01, 2016.

These were analyzed according to EPA procedures or equivalent. To access our accredited tests please go to www.hallenvironmental.com or the state specific web sites. See the sample checklist and/or the Chain of Custody for information regarding the sample receipt temperature and preservation. Data qualifiers or a narrative will be provided if the sample analysis or analytical quality control parameters require a flag. All samples are reported as received unless otherwise indicated.

Please don't hesitate to contact HEAL for any additional information or clarifications.

Sincerely,

A handwritten signature in black ink, appearing to read "Andy Freeman", is written over a horizontal line.

Andy Freeman
Laboratory Manager
4901 Hawkins NE
Albuquerque, NM 87109

Analytical Report

Lab Order 1608F07

Date Reported: 9/16/2016

Hall Environmental Analysis Laboratory, Inc.

CLIENT: Yates Petroleum Corporation

Client Sample ID: 0.5P

Project: Mango BRM State 1H

Collection Date: 8/23/2016 10:20:00 AM

Lab ID: 1608F07-001

Matrix: SOIL

Received Date: 8/25/2016 9:20:00 AM

Analyses	Result	PQL	Qual	Units	DF	Date Analyzed	Batch
EPA METHOD 8015M/D: DIESEL RANGE ORGANICS							Analyst: TOM
Diesel Range Organics (DRO)	1100	100		mg/Kg	10	8/31/2016 1:14:10 PM	27220
Surr: DNOP	0	70-130	S	%Rec	10	8/31/2016 1:14:10 PM	27220
EPA METHOD 8015D: GASOLINE RANGE							Analyst: NSB
Gasoline Range Organics (GRO)	ND	4.9		mg/Kg	1	8/29/2016 1:54:28 PM	27186
Surr: BFB	83.5	68.3-144		%Rec	1	8/29/2016 1:54:28 PM	27186
EPA METHOD 8021B: VOLATILES							Analyst: NSB
Benzene	ND	0.024		mg/Kg	1	8/29/2016 1:54:28 PM	27186
Toluene	ND	0.049		mg/Kg	1	8/29/2016 1:54:28 PM	27186
Ethylbenzene	ND	0.049		mg/Kg	1	8/29/2016 1:54:28 PM	27186
Xylenes, Total	ND	0.097		mg/Kg	1	8/29/2016 1:54:28 PM	27186
Surr: 4-Bromofluorobenzene	101	80-120		%Rec	1	8/29/2016 1:54:28 PM	27186

Refer to the QC Summary report and sample login checklist for flagged QC data and preservation information.

Qualifiers:	*	Value exceeds Maximum Contaminant Level.	B	Analyte detected in the associated Method Blank
	D	Sample Diluted Due to Matrix	E	Value above quantitation range
	H	Holding times for preparation or analysis exceeded	J	Analyte detected below quantitation limits
	ND	Not Detected at the Reporting Limit	P	Sample pH Not In Range
	R	RPD outside accepted recovery limits	RL	Reporting Detection Limit
	S	% Recovery outside of range due to dilution or matrix	W	Sample container temperature is out of limit as specified

Page 1 of 9

Analytical Report

Lab Order 1608F07

Date Reported: 9/16/2016

Hall Environmental Analysis Laboratory, Inc.

CLIENT: Yates Petroleum Corporation

Client Sample ID: 1.0P

Project: Mango BRM State 1H

Collection Date: 8/23/2016 10:28:00 AM

Lab ID: 1608F07-002

Matrix: SOIL

Received Date: 8/25/2016 9:20:00 AM

Analyses	Result	PQL	Qual	Units	DF	Date Analyzed	Batch
EPA METHOD 8015M/D: DIESEL RANGE ORGANICS							Analyst: TOM
Diesel Range Organics (DRO)	24	9.9		mg/Kg	1	8/30/2016 3:49:54 PM	27220
Surr: DNOP	78.6	70-130		%Rec	1	8/30/2016 3:49:54 PM	27220
EPA METHOD 8015D: GASOLINE RANGE							Analyst: NSB
Gasoline Range Organics (GRO)	ND	5.0		mg/Kg	1	8/29/2016 3:04:54 PM	27186
Surr: BFB	82.6	68.3-144		%Rec	1	8/29/2016 3:04:54 PM	27186
EPA METHOD 8021B: VOLATILES							Analyst: NSB
Benzene	ND	0.025		mg/Kg	1	8/29/2016 3:04:54 PM	27186
Toluene	ND	0.050		mg/Kg	1	8/29/2016 3:04:54 PM	27186
Ethylbenzene	ND	0.050		mg/Kg	1	8/29/2016 3:04:54 PM	27186
Xylenes, Total	ND	0.10		mg/Kg	1	8/29/2016 3:04:54 PM	27186
Surr: 4-Bromofluorobenzene	99.4	80-120		%Rec	1	8/29/2016 3:04:54 PM	27186

Refer to the QC Summary report and sample login checklist for flagged QC data and preservation information.

Qualifiers:	*	Value exceeds Maximum Contaminant Level.	B	Analyte detected in the associated Method Blank
	D	Sample Diluted Due to Matrix	E	Value above quantitation range
	H	Holding times for preparation or analysis exceeded	J	Analyte detected below quantitation limits
	ND	Not Detected at the Reporting Limit	P	Sample pH Not in Range
	R	RPD outside accepted recovery limits	RL	Reporting Detection Limit
	S	% Recovery outside of range due to dilution or matrix	W	Sample container temperature is out of limit as specified

Page 2 of 9

Analytical Report

Lab Order 1608F07

Date Reported: 9/16/2016

Hall Environmental Analysis Laboratory, Inc.

CLIENT: Yates Petroleum Corporation

Client Sample ID: 1.5P

Project: Mango BRM State 1H

Collection Date: 8/23/2016 10:36:00 AM

Lab ID: 1608F07-003

Matrix: SOIL

Received Date: 8/25/2016 9:20:00 AM

Analyses	Result	PQL	Qual	Units	DF	Date Analyzed	Batch
EPA METHOD 8015M/D: DIESEL RANGE ORGANICS							Analyst: TOM
Diesel Range Organics (DRO)	ND	9.9		mg/Kg	1	8/30/2016 4:18:00 PM	27220
Surr: DNOP	84.4	70-130		%Rec	1	8/30/2016 4:18:00 PM	27220
EPA METHOD 8015D: GASOLINE RANGE							Analyst: NSB
Gasoline Range Organics (GRO)	ND	4.8		mg/Kg	1	8/29/2016 3:28:20 PM	27186
Surr: BFB	84.7	68.3-144		%Rec	1	8/29/2016 3:28:20 PM	27186
EPA METHOD 8021B: VOLATILES							Analyst: NSB
Benzene	ND	0.024		mg/Kg	1	8/29/2016 3:28:20 PM	27186
Toluene	ND	0.048		mg/Kg	1	8/29/2016 3:28:20 PM	27186
Ethylbenzene	ND	0.048		mg/Kg	1	8/29/2016 3:28:20 PM	27186
Xylenes, Total	ND	0.096		mg/Kg	1	8/29/2016 3:28:20 PM	27186
Surr: 4-Bromofluorobenzene	102	80-120		%Rec	1	8/29/2016 3:28:20 PM	27186

Refer to the QC Summary report and sample login checklist for flagged QC data and preservation information.

Qualifiers:	*	Value exceeds Maximum Contaminant Level.	B	Analyte detected in the associated Method Blank
	D	Sample Diluted Due to Matrix	E	Value above quantitation range
	H	Holding times for preparation or analysis exceeded	J	Analyte detected below quantitation limits
	ND	Not Detected at the Reporting Limit	P	Sample pH Not In Range
	R	RPD outside accepted recovery limits	RL	Reporting Detection Limit
	S	% Recovery outside of range due to dilution or matrix	W	Sample container temperature is out of limit as specified

Page 3 of 9

Analytical Report

Lab Order 1608F07

Date Reported: 9/16/2016

Hall Environmental Analysis Laboratory, Inc.

CLIENT: Yates Petroleum Corporation

Client Sample ID: 0.5E

Project: Mango BRM State 1H

Collection Date: 8/23/2016 10:46:00 AM

Lab ID: 1608F07-004

Matrix: SOIL

Received Date: 8/25/2016 9:20:00 AM

Analyses	Result	PQL	Qual	Units	DF	Date Analyzed	Batch
EPA METHOD 8015M/D: DIESEL RANGE ORGANICS							Analyst: TOM
Diesel Range Organics (DRO)	ND	10		mg/Kg	1	8/30/2016 4:46:14 PM	27220
Surr: DNOP	81.9	70-130		%Rec	1	8/30/2016 4:46:14 PM	27220
EPA METHOD 8015D: GASOLINE RANGE							Analyst: NSB
Gasoline Range Organics (GRO)	ND	4.7		mg/Kg	1	8/29/2016 3:51:45 PM	27186
Surr: BFB	84.3	68.3-144		%Rec	1	8/29/2016 3:51:45 PM	27186
EPA METHOD 8021B: VOLATILES							Analyst: NSB
Benzene	ND	0.023		mg/Kg	1	8/29/2016 3:51:45 PM	27186
Toluene	ND	0.047		mg/Kg	1	8/29/2016 3:51:45 PM	27186
Ethylbenzene	ND	0.047		mg/Kg	1	8/29/2016 3:51:45 PM	27186
Xylenes, Total	ND	0.094		mg/Kg	1	8/29/2016 3:51:45 PM	27186
Surr: 4-Bromofluorobenzene	101	80-120		%Rec	1	8/29/2016 3:51:45 PM	27186

Refer to the QC Summary report and sample login checklist for flagged QC data and preservation information.

Qualifiers:	*	Value exceeds Maximum Contaminant Level.	B	Analyte detected in the associated Method Blank
	D	Sample Diluted Due to Matrix	E	Value above quantitation range
	H	Holding times for preparation or analysis exceeded	J	Analyte detected below quantitation limits
	ND	Not Detected at the Reporting Limit	P	Sample pH Not In Range
	R	RPD outside accepted recovery limits	RL	Reporting Detection Limit
	S	% Recovery outside of range due to dilution or matrix	W	Sample container temperature is out of limit as specified

Analytical Report
 Lab Order 1608F07
 Date Reported: 9/16/2016

Hall Environmental Analysis Laboratory, Inc.

CLIENT: Yates Petroleum Corporation **Client Sample ID:** 1.0E
Project: Mango BRM State 1H **Collection Date:** 8/23/2016 10:52:00 AM
Lab ID: 1608F07-005 **Matrix:** SOIL **Received Date:** 8/25/2016 9:20:00 AM

Analyses	Result	PQL	Qual	Units	DF	Date Analyzed	Batch
EPA METHOD 8015M/D: DIESEL RANGE ORGANICS							Analyst: TOM
Diesel Range Organics (DRO)	ND	10		mg/Kg	1	8/30/2016 5:14:04 PM	27220
Surr: DNOP	92.8	70-130		%Rec	1	8/30/2016 5:14:04 PM	27220
EPA METHOD 8015D: GASOLINE RANGE							Analyst: NSB
Gasoline Range Organics (GRO)	ND	4.9		mg/Kg	1	8/29/2016 4:15:15 PM	27186
Surr: BFB	84.2	68.3-144		%Rec	1	8/29/2016 4:15:15 PM	27186
EPA METHOD 8021B: VOLATILES							Analyst: NSB
Benzene	ND	0.025		mg/Kg	1	8/29/2016 4:15:15 PM	27186
Toluene	ND	0.049		mg/Kg	1	8/29/2016 4:15:15 PM	27186
Ethylbenzene	ND	0.049		mg/Kg	1	8/29/2016 4:15:15 PM	27186
Xylenes, Total	ND	0.099		mg/Kg	1	8/29/2016 4:15:15 PM	27186
Surr: 4-Bromofluorobenzene	101	80-120		%Rec	1	8/29/2016 4:15:15 PM	27186

Refer to the QC Summary report and sample login checklist for flagged QC data and preservation information.

Qualifiers:	*	Value exceeds Maximum Contaminant Level.	B	Analyte detected in the associated Method Blank
	D	Sample Diluted Due to Matrix	E	Value above quantitation range
	H	Holding times for preparation or analysis exceeded	J	Analyte detected below quantitation limits
	ND	Not Detected at the Reporting Limit	P	Sample pH Not In Range
	R	RPD outside accepted recovery limits	RL	Reporting Detection Limit
	S	% Recovery outside of range due to dilution or matrix	W	Sample container temperature is out of limit as specified

Analytical Report

Lab Order 1608F07

Date Reported: 9/16/2016

Hall Environmental Analysis Laboratory, Inc.

CLIENT: Yates Petroleum Corporation

Client Sample ID: 1.5E

Project: Mango BRM State 1H

Collection Date: 8/23/2016 10:59:00 AM

Lab ID: 1608F07-006

Matrix: SOIL

Received Date: 8/25/2016 9:20:00 AM

Analyses	Result	PQL	Qual	Units	DF	Date Analyzed	Batch
EPA METHOD 8015M/D: DIESEL RANGE ORGANICS							Analyst: TOM
Diesel Range Organics (DRO)	ND	9.6		mg/Kg	1	8/30/2016 5:42:03 PM	27220
Surr: DNOP	87.0	70-130		%Rec	1	8/30/2016 5:42:03 PM	27220
EPA METHOD 8015D: GASOLINE RANGE							Analyst: NSB
Gasoline Range Organics (GRO)	ND	4.9		mg/Kg	1	8/29/2016 4:38:36 PM	27186
Surr: BFB	83.6	68.3-144		%Rec	1	8/29/2016 4:38:36 PM	27186
EPA METHOD 8021B: VOLATILES							Analyst: NSB
Benzene	ND	0.024		mg/Kg	1	8/29/2016 4:38:36 PM	27186
Toluene	ND	0.049		mg/Kg	1	8/29/2016 4:38:36 PM	27186
Ethylbenzene	ND	0.049		mg/Kg	1	8/29/2016 4:38:36 PM	27186
Xylenes, Total	ND	0.098		mg/Kg	1	8/29/2016 4:38:36 PM	27186
Surr: 4-Bromofluorobenzene	99.3	80-120		%Rec	1	8/29/2016 4:38:36 PM	27186

Refer to the QC Summary report and sample login checklist for flagged QC data and preservation information.

Qualifiers:	*	Value exceeds Maximum Contaminant Level.	B	Analyte detected in the associated Method Blank	Page 6 of 9
	D	Sample Diluted Due to Matrix	E	Value above quantitation range	
	H	Holding times for preparation or analysis exceeded	J	Analyte detected below quantitation limits	
	ND	Not Detected at the Reporting Limit	P	Sample pH Not In Range	
	R	RPD outside accepted recovery limits	RL	Reporting Detection Limit	
	S	% Recovery outside of range due to dilution or matrix	W	Sample container temperature is out of limit as specified	

QC SUMMARY REPORT

Hall Environmental Analysis Laboratory, Inc.

WO#: 1608F07

16-Sep-16

Client: Yates Petroleum Corporation

Project: Mango BRM State 1H

Sample ID	LCS-27220	SampType:	LCS	TestCode:	EPA Method 8015M/D: Diesel Range Organics					
Client ID:	LCSS	Batch ID:	27220	RunNo:	36852					
Prep Date:	8/29/2016	Analysis Date:	8/30/2016	SeqNo:	1142472	Units:	mg/Kg			
Analyte	Result	PQL	SPK value	SPK Ref Val	%REC	LowLimit	HighLimit	%RPD	RPDLimit	Qual
Diesel Range Organics (DRO)	45	10	50.00	0	90.4	62.6	124			
Surr: DNOP	4.3		5.000		86.1	70	130			

Sample ID	MB-27220	SampType:	MBLK	TestCode:	EPA Method 8015M/D: Diesel Range Organics					
Client ID:	PBS	Batch ID:	27220	RunNo:	36852					
Prep Date:	8/29/2016	Analysis Date:	8/30/2016	SeqNo:	1142473	Units:	mg/Kg			
Analyte	Result	PQL	SPK value	SPK Ref Val	%REC	LowLimit	HighLimit	%RPD	RPDLimit	Qual
Diesel Range Organics (DRO)	ND	10								
Surr: DNOP	11		10.00		110	70	130			

Qualifiers:

- | | |
|---|---|
| * Value exceeds Maximum Contaminant Level. | B Analyte detected in the associated Method Blank |
| D Sample Diluted Due to Matrix | E Value above quantitation range |
| H Holding times for preparation or analysis exceeded | J Analyte detected below quantitation limits |
| ND Not Detected at the Reporting Limit | P Sample pH Not In Range |
| R RPD outside accepted recovery limits | RL Reporting Detection Limit |
| S % Recovery outside of range due to dilution or matrix | W Sample container temperature is out of limit as specified |

QC SUMMARY REPORT

Hall Environmental Analysis Laboratory, Inc.

WO#: 1608F07
16-Sep-16

Client: Yates Petroleum Corporation
Project: Mango BRM State 1H

Sample ID	MB-27186	SampType:	MBLK	TestCode:	EPA Method 8015D: Gasoline Range					
Client ID:	PBS	Batch ID:	27186	RunNo:	36828					
Prep Date:	8/26/2016	Analysis Date:	8/29/2016	SeqNo:	1141862	Units:	mg/Kg			
Analyte	Result	PQL	SPK value	SPK Ref Val	%REC	LowLimit	HighLimit	%RPD	RPDLimit	Qual
Gasoline Range Organics (GRO)	ND	5.0								
Surr: BFB	850		1000		84.6	68.3	144			

Sample ID	LCS-27186	SampType:	LCS	TestCode:	EPA Method 8015D: Gasoline Range					
Client ID:	LCSS	Batch ID:	27186	RunNo:	36828					
Prep Date:	8/26/2016	Analysis Date:	8/29/2016	SeqNo:	1141863	Units:	mg/Kg			
Analyte	Result	PQL	SPK value	SPK Ref Val	%REC	LowLimit	HighLimit	%RPD	RPDLimit	Qual
Gasoline Range Organics (GRO)	22	5.0	25.00	0	89.4	80	120			
Surr: BFB	910		1000		90.7	68.3	144			

Qualifiers:

- * Value exceeds Maximum Contaminant Level.
- D Sample Diluted Due to Matrix
- H Holding times for preparation or analysis exceeded
- ND Not Detected at the Reporting Limit
- R RPD outside accepted recovery limits
- S % Recovery outside of range due to dilution or matrix
- B Analyte detected in the associated Method Blank
- E Value above quantitation range
- J Analyte detected below quantitation limits
- P Sample pH Not In Range
- RL Reporting Detection Limit
- W Sample container temperature is out of limit as specified

QC SUMMARY REPORT

Hall Environmental Analysis Laboratory, Inc.

WO#: 1608F07

16-Sep-16

Client: Yates Petroleum Corporation

Project: Mango BRM State 1H

Sample ID	MB-27186	SampType:	MBLK	TestCode:	EPA Method 8021B: Volatiles					
Client ID:	PBS	Batch ID:	27186	RunNo:	36828					
Prep Date:	8/26/2016	Analysis Date:	8/29/2016	SeqNo:	1141891	Units:	mg/Kg			
Analyte	Result	PQL	SPK value	SPK Ref Val	%REC	LowLimit	HighLimit	%RPD	RPDLimit	Qual
Benzene	ND	0.025								
Toluene	ND	0.050								
Ethylbenzene	ND	0.050								
Xylenes, Total	ND	0.10								
Surr: 4-Bromofluorobenzene	1.0		1.000		102	80	120			

Sample ID	LCS-27186	SampType: LCS			TestCode: EPA Method 8021B: Volatiles					
Client ID:	LCSS	Batch ID: 27186			RunNo: 36828					
Prep Date:	8/26/2016	Analysis Date: 8/29/2016			SeqNo: 1141892		Units: mg/Kg			
Analyte	Result	PQL	SPK value	SPK Ref Val	%REC	LowLimit	HighLimit	%RPD	RPDLimit	Qual
Benzene	0.89	0.025	1.000	0	89.0	75.3	123			
Toluene	0.90	0.050	1.000	0	90.0	80	124			
Ethylbenzene	0.92	0.050	1.000	0	92.2	82.8	121			
Xylenes, Total	2.8	0.10	3.000	0	92.5	83.9	122			
Surr: 4-Bromofluorobenzene	1.1		1.000		107	80	120			

Qualifiers:

- | | |
|---|---|
| * Value exceeds Maximum Contaminant Level. | B Analyte detected in the associated Method Blank |
| D Sample Diluted Due to Matrix | E Value above quantitation range |
| H Holding times for preparation or analysis exceeded | J Analyte detected below quantitation limits |
| ND Not Detected at the Reporting Limit | P Sample pH Not In Range |
| R RPD outside accepted recovery limits | RL Reporting Detection Limit |
| S % Recovery outside of range due to dilution or matrix | W Sample container temperature is out of limit as specified |

Page 9 of 9



Hall Environmental Analysis Laboratory
4901 Hawkins NE
Albuquerque, NM 87109
TEL: 505-345-3975 FAX: 505-345-4107
Website: www.hallenvironmental.com

Sample Log-In Check List

Client Name: Yates Petroleum Corpora

Work Order Number: 1608F07

RcptNo: 1

Received by/date:

AG

08/25/16

Logged By: Ashley Gallegos

8/25/2016 9:20:00 AM

AG

Completed By: Ashley Gallegos

8/25/2016 5:54:49 PM

AG

Reviewed By:

my

08/26/16

Chain of Custody

1. Custody seals intact on sample bottles? Yes ☐ No ☐ Not Present ☒
2. Is Chain of Custody complete? Yes ☒ No ☐ Not Present ☐
3. How was the sample delivered? Courier

Log In

4. Was an attempt made to cool the samples? Yes ☒ No ☐ NA ☐
5. Were all samples received at a temperature of $>0^{\circ}\text{C}$ to 6.0°C ? Yes ☒ No ☐ NA ☐
6. Sample(s) in proper container(s)? Yes ☒ No ☐
7. Sufficient sample volume for indicated test(s)? Yes ☒ No ☐
8. Are samples (except VOA and ONG) properly preserved? Yes ☒ No ☐
9. Was preservative added to bottles? Yes ☐ No ☒ NA ☐
10. VOA vials have zero headspace? Yes ☐ No ☐ No VOA Vials ☒
11. Were any sample containers received broken? Yes ☐ No ☒
12. Does paperwork match bottle labels?
(Note discrepancies on chain of custody) Yes ☒ No ☐
13. Are matrices correctly identified on Chain of Custody? Yes ☒ No ☐
14. Is it clear what analyses were requested? Yes ☒ No ☐
15. Were all holding times able to be met?
(If no, notify customer for authorization.) Yes ☒ No ☐

of preserved
bottles checked
for pH:

(<2 or >12 unless noted)

Adjusted?

Checked by:

Special Handling (if applicable)

16. Was client notified of all discrepancies with this order? Yes ☐ No ☐ NA ☒

Person Notified:

Date:

By Whom:

Via: ☐ eMail ☐ Phone ☐ Fax ☐ In Person

Regarding:

Client Instructions:

17. Additional remarks:

18. Cooler Information

Cooler No	Temp $^{\circ}\text{C}$	Condition	Seal Intact	Seal No	Seal Date	Signed By
1	3.2	Good	Yes			

Chain-of-Custody Record

Client: Yates Petroleum Corporation
Project Name: _____
Project #: _____
Project Manager: Robert Asher
PO# 205632
Sample Temperature: 30.0°F
Sample Type: Ice
Container Type and #: 1 - 4oz.
Preservative Type: Ice
HEAL No. 11008807



4901 Hawkins NE - Albuquerque, NM 87109
Tel. 505-345-3975 Fax 505-345-4107

Analysis Request

Date	Time	Matrix	Sample Request ID	Container Type and #	Preservative Type	HEAL No.	BTEX + MTBE + TMB's (802)	BTEX + MTBE + TPH (Gas only)	TPH Method 8015F (Gas/Diesel)	TPH (Method 418.1)	EDB (Method 504.1)	8310 (PNA or PAH)	RCRA 8 Metals	Anions (Cl)	8081 Pesticides / 8082 PCB's	8260B (VOA)	8270 (Semi-VOA)	Air Bubbles (Y or N)
2/23/16	10:20 AM	Soil	0.5P	1 - 4oz.	Ice	-001	X	X	X					X				
2/23/16	10:28 AM	Soil	1.0P	1 - 4oz.	Ice	-002	X	X	X					X				
2/23/16	10:36 AM	Soil	1.5P	1 - 4oz.	Ice	-003	X	X	X					X				
2/23/16	10:46 AM	Soil	0.5E	1 - 4oz.	Ice	-004	X	X	X					X				
2/23/16	10:52 AM	Soil	1.0E	1 - 4oz.	Ice	-005	X	X	X					X				
2/23/16	10:59 AM	Soil	1.5E	1 - 4oz.	Ice	-006	X	X	X					X				

Relinquished by: [Signature] Date: 3/24/16 Time: 1:04 PM
Received by: [Signature] Date: 03/25/16 Time: 09:20

If necessary, samples submitted to Hall Environmental may be subcontracted to other accredited laboratories. This serves as notice of this possibility. Any sub-contracted data will be clearly notated on the analytical report.

District I
1625 N. French Dr., Hobbs, NM 88240
District II
811 S. First St., Artesia, NM 88210
District III
1000 Rio Brazos Road, Aztec, NM 87410
District IV
1220 S. St. Francis Dr., Santa Fe, NM 87505

HOBBS OCD

State of New Mexico
Energy Minerals and Natural Resources
Oil Conservation Division
1220 South St. Francis Dr.
Santa Fe, NM 87505

Form C-141
Revised August 8, 2011

Submit 1 Copy to appropriate District Office in
accordance with 19.15.29 NMAC.

Release Notification and Corrective Action**OPERATOR**
☒ Initial Report ☐ Final Report

Name of Company Yates Petroleum Corporation	Contact Bob Asher
Address 104 S. 4 th Street	Telephone No. 575-748-1471
Facility Name Mango BRM State #1H	Facility Type Battery
Surface Owner State	Mineral Owner State
API No. 30-025-40517	

LOCATION OF RELEASE

Unit Letter C	Section 27	Township 20S	Range 35E	Feet from the 100	North/South Line North	Feet from the 2310	East/West Line West	County Lea
------------------	---------------	-----------------	--------------	----------------------	---------------------------	-----------------------	------------------------	---------------

Latitude 32.55103 Longitude 103.44576

NATURE OF RELEASE

Type of Release Crude Oil	Volume of Release 10 B/O	Volume Recovered 5 B/O
Source of Release Supply line	Date and Hour of Occurrence 11/17/2014; AM	Date and Hour of Discovery 11/17/2014; AM
Was Immediate Notice Given? <input type="checkbox"/> Yes <input checked="" type="checkbox"/> No <input type="checkbox"/> Not Required	If YES, To Whom? N/A	
By Whom? N/A	Date and Hour N/A	
Was a Watercourse Reached? <input type="checkbox"/> Yes <input checked="" type="checkbox"/> No	If YES, Volume Impacting the Watercourse.	

If a Watercourse was Impacted, Describe Fully.*

Describe Cause of Problem and Remedial Action Taken.*

The supply line was frozen, causing the release. Wells were shut off and vacuum truck(s) were called.

Describe Area Affected and Cleanup Action Taken.*

An approximate area of 50' X 200' on production pad and 90' x 300' (overspray/off pad). Production equipment was shut off and vacuum trucks were called to remove remaining oil. Impacted soils will be scraped and hauled to a NMOCD approved facility. Vegetation on overspray area will be Micro Blazed. Vertical and horizontal delineation samples will be taken and analysis ran for TPH & BTEX. If initial analytical results for TPH & BTEX are under RRAL's (site ranking is 10) a Final Report, C-141 will be submitted to the OCD requesting closure. If the analytical results are above the RRAL's a work plan will be submitted to the OCD. Depth to Ground Water: 50-99' (approximately 70' per Chevron/Texaco Trend Map), Wellhead Protection Area: No, Distance to Surface Water Body: >1000', SITE RANKING IS 10.

I hereby certify that the information given above is true and complete to the best of my knowledge and understand that pursuant to NMOCD rules and regulations all operators are required to report and/or file certain release notifications and perform corrective actions for releases which may endanger public health or the environment. The acceptance of a C-141 report by the NMOCD marked as "Final Report" does not relieve the operator of liability should their operations have failed to adequately investigate and remediate contamination that pose a threat to ground water, surface water, human health or the environment. In addition, NMOCD acceptance of a C-141 report does not relieve the operator of responsibility for compliance with any other federal, state, or local laws and/or regulations.

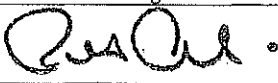
Signature: 	OIL CONSERVATION DIVISION	
Printed Name: Robert Asher	Approved by Environmental Specialist:	
Title: NM Environmental Regulatory Supervisor	Approval Date: <u>12-10-15</u>	Expiration Date: <u>2-10-15</u>
E-mail Address: boba@yatespetroleum.com	Conditions of Approval: <u>Site Sample request</u> <u>RRP- Release & remediate per NMAC</u> <u>70 NMOCD guidelines, Submit Final</u> <u>C-141 by 2-10-15</u>	
Date: December 8, 2014 Phone: 575-748-4217	Attached <input type="checkbox"/> <u>1RP- 3744</u> <u>25575</u> <u>77014 3442 9856</u> <u>77014 7443 0069</u>	

* Attach Additional Sheets If Necessary

DEC 11 2014









Tanna Adams

From: Tanna Adams
Sent: Monday, December 08, 2014 4:43 PM
To: tomas.oberding@state.nm.us
Cc: Bob Asher
Subject: Mango BRM State #1H
Attachments: Mango BRM State #1H.pdf

Dr. Oberding,

Please find attached the signed C141 Initial report for the below listed location:

Mango BRM State #1H
30-025-40517
Section 27, T20S-R35E
100 FNL & 2310 FWL
Lea County, New Mexico

Thank you,

Tanna Adams
Yates Petroleum Corporation
Environmental Tech
Environmental Department
TCAdams@yatespetroleum.com

District I
1625 N. French Dr., Hobbs, NM 88240
District II
811 S. First St., Artesia, NM 88210
District III
700 Rio Brazos Road, Aztec, NM 87410
District IV
1220 S. St. Francis Dr., Santa Fe, NM 87505

State of New Mexico
Energy Minerals and Natural Resources

Oil Conservation Division
1220 South St. Francis Dr.
Santa Fe, NM 87505

Form C-141
Revised August 8, 2011

Submit 1 Copy to appropriate District Office in
accordance with 19.15.29 NMAC.

Release Notification and Corrective Action

OPERATOR

☒ Initial Report ☐ Final Report

Name of Company Yates Petroleum Corporation	Contact Bob Asher
Address 104 S. 4 th Street	Telephone No. 575-748-1471
Facility Name Mango BRM State #1H	Facility Type Battery

Surface Owner State	Mineral Owner State	API No. 30-025-40517
------------------------	------------------------	-------------------------

LOCATION OF RELEASE

Unit Letter C	Section 27	Township 20S	Range 35E	Feet from the 100	North/South Line North	Feet from the 2310	East/West Line West	County Lea
------------------	---------------	-----------------	--------------	----------------------	---------------------------	-----------------------	------------------------	---------------

Latitude 32.55103 Longitude 103.44576

NATURE OF RELEASE

Type of Release Crude Oil	Volume of Release 10 B/O	Volume Recovered 5 B/O
Source of Release Supply line	Date and Hour of Occurrence 11/17/2014; AM	Date and Hour of Discovery 11/17/2014; AM
Was Immediate Notice Given? <input type="checkbox"/> Yes <input checked="" type="checkbox"/> No <input type="checkbox"/> Not Required	If YES, To Whom? N/A	
By Whom? N/A	Date and Hour N/A	
Was a Watercourse Reached? <input type="checkbox"/> Yes <input checked="" type="checkbox"/> No	If YES, Volume Impacting the Watercourse.	

If a Watercourse was Impacted, Describe Fully.*

Describe Cause of Problem and Remedial Action Taken.*

The supply line was frozen, causing the release. Wells were shut off and vacuum truck(s) were called.

Describe Area Affected and Cleanup Action Taken.*

An approximate area of 50' X 200' on production pad and 90' x 300' (overspray/off pad). Production equipment was shut off and vacuum trucks were called to remove remaining oil. Impacted soils will be scraped and hauled to a NMOCD approved facility. Vegetation on overspray area will be Micro Blazed. Vertical and horizontal delineation samples will be taken and analysis ran for TPH & BTEX. If initial analytical results for TPH & BTEX are under RRAL's (site ranking is 10) a Final Report, C-141 will be submitted to the OCD requesting closure. If the analytical results are above the RRAL's a work plan will be submitted to the OCD. **Depth to Ground Water: 50-99' (approximately 70' per ChevronTexaco Trend Map), Wellhead Protection Area: No, Distance to Surface Water Body: >1000', SITE RANKING IS 10.**

I hereby certify that the information given above is true and complete to the best of my knowledge and understand that pursuant to NMOCD rules and regulations all operators are required to report and/or file certain release notifications and perform corrective actions for releases which may endanger public health or the environment. The acceptance of a C-141 report by the NMOCD marked as "Final Report" does not relieve the operator of liability should their operations have failed to adequately investigate and remediate contamination that pose a threat to ground water, surface water, human health or the environment. In addition, NMOCD acceptance of a C-141 report does not relieve the operator of responsibility for compliance with any other federal, state, or local laws and/or regulations.

Signature: 		<u>OIL CONSERVATION DIVISION</u>	
Printed Name: Robert Asher		Approved by Environmental Specialist:	
Title: NM Environmental Regulatory Supervisor	Approval Date:	Expiration Date:	
E-mail Address: boba@yatespetroleum.com	Conditions of Approval:		Attached <input type="checkbox"/>
Date: December 8, 2014	Phone: 575-748-4217	2RP-	

Attach Additional Sheets If Necessary



BREAKS, SPILLS AND LEAKS REPORT

Person Reporting Rick Quintela Time Reported: 7 am pm
 Person Reported to (Field Supervisor) J. Palma Time Reported: 7 am pm
 Environmental Notification Coordinator _____ Time Reported: _____ am pm

1. LOCATION:

Name of well or facility: Mango "BRM" State # 1-H

Location N.M., Lea County Section 27 Township 20 Range 35E County: Lea

Surface Owner: LSE #VO-8090 API #30-025-40517 Mineral Owner: Fee ☐ Federal ☐ State ☒

2. TIME OF INCIDENT:

Date: 11-17-14 Time: 5 am pm

3. SOURCE AND CAUSE: Frozen Supply line to dump

4. TYPE OF DISCHARGE

☒ Crude Oil ☐ Condensate ☐ Produced Water ☐ Gas ☐ Other _____

5. QUANTITY:

Estimated Volumes Discharged: 10 Barrels of Oil _____ Barrels of Water _____
 _____ Barrels of _____
 _____ MCF Gas _____

Estimated Volumes Recovered: 5 Barrels of Oil _____ Barrels of Water _____
 _____ Barrels of _____

6. SITE CHARACTERISTICS:

Weather Conditions: Freezing 15° Soil Type and Condition: Hard Pack caliche

Distance & Direction to fresh water wells or watercourse: _____

Secondary Containment type & condition: Battery / Location

Miscellaneous: All standing oil was on Location, Some overspray outside of location

7. IMMEDIATE CORRECTIVE ACTION:

Action and time taken to control incident: Shut off pump, Shut in well / 1 hr
Micro Blaze applied to Pasture, Removed surface oil on location w/ Vac Truck, + removed top soil

BREAKS, SPILLS AND LEAKS REPORT

8. SITE ASSESSMENT

Exact Location of Spill: (sketch)

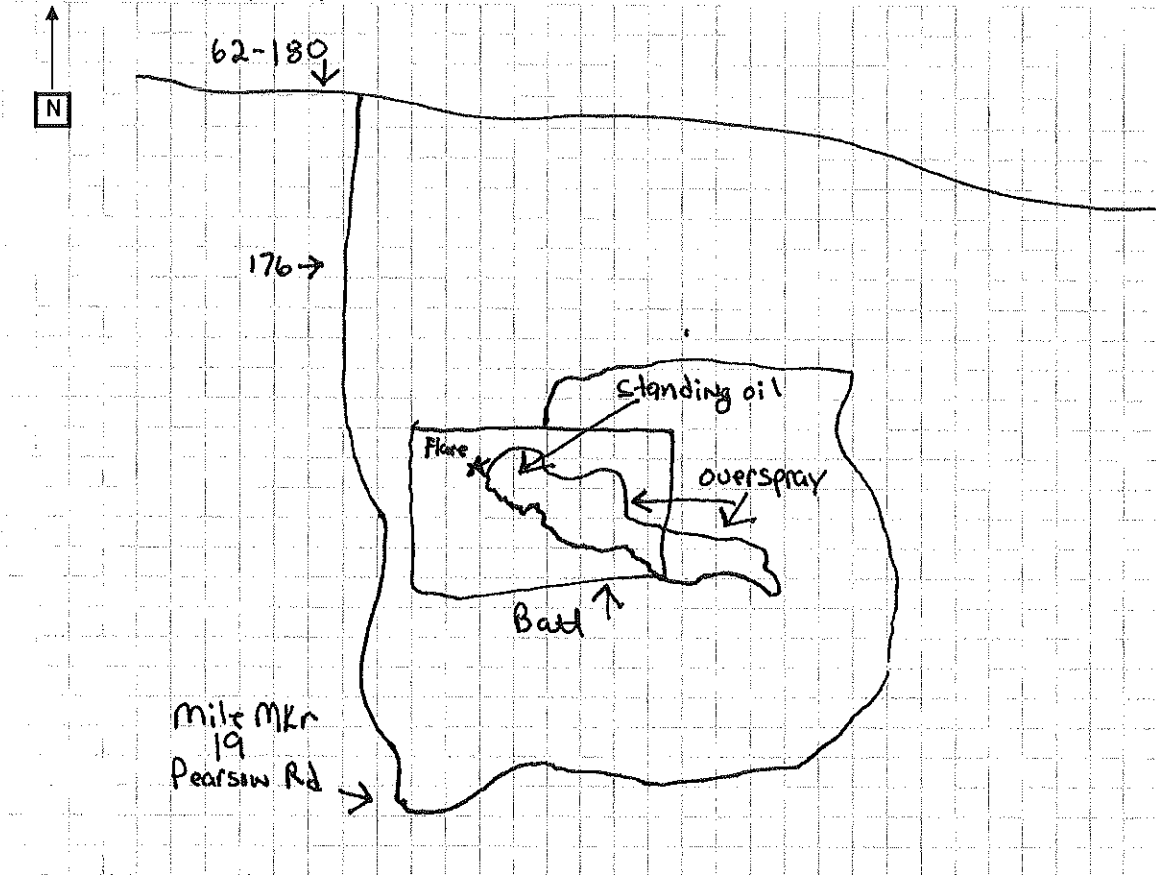

Horizontal Extent: 30yrs X 100yds Estimated Vertical Extent: — feet / inches

Degree of Contamination: ☐ Highly Contaminated/Saturated ☒ Unsaturated

9. REMEDIAL ACTION:

☐ Excavate, and landfarm on location

☒ Excavate, remove and replace remove contaminated soil on location

☒ Treat in place Micro blaze applied on pasture

District I
1625 N. French Dr., Hobbs, NM 88240
Phone:(575) 393-6161 Fax:(575) 393-0720
District II
811 S. First St., Artesia, NM 88210
Phone:(575) 748-1283 Fax:(575) 748-9720
District III
1000 Rio Brazos Rd., Aztec, NM 87410
Phone:(505) 334-6178 Fax:(505) 334-6170
District IV
1220 S. St Francis Dr., Santa Fe, NM 87505
Phone:(505) 476-3470 Fax:(505) 476-3462

State of New Mexico
Energy, Minerals and Natural Resources
Oil Conservation Division
1220 S. St Francis Dr.
Santa Fe, NM 87505

CONDITIONS

Action 201175

CONDITIONS

Operator: Permian Resources Operating, LLC 1001 17th Street, Suite 1800 Denver, CO 80202	OGRID: 372165
	Action Number: 201175
	Action Type: [IM-SD] Incident File Support Doc (ENV) (IM-BNF)

CONDITIONS

Created By	Condition	Condition Date
bhall	Closure approved by Bradford Billings on 8/25/2020. Report not uploaded at that time.	3/27/2023