

Incident ID	nAPP2233957598
District RP	
Facility ID	
Application ID	

## Closure

The responsible party must attach information demonstrating they have complied with all applicable closure requirements and any conditions or directives of the OCD. This demonstration should be in the form of a comprehensive report (electronic submittals in .pdf format are preferred) including a scaled site map, sampling diagrams, relevant field notes, photographs of any excavation prior to backfilling, laboratory data including chain of custody documents of final sampling, and a narrative of the remedial activities. Refer to 19.15.29.12 NMAC.

**Closure Report Attachment Checklist:** *Each of the following items must be included in the closure report.*

- ☒ A scaled site and sampling diagram as described in 19.15.29.11 NMAC
- ☒ Photographs of the remediated site prior to backfill or photos of the liner integrity if applicable (Note: appropriate OCD District office must be notified 2 days prior to liner inspection)
- ☒ Laboratory analyses of final sampling (Note: appropriate ODC District office must be notified 2 days prior to final sampling)
- ☒ Description of remediation activities

I hereby certify that the information given above is true and complete to the best of my knowledge and understand that pursuant to OCD rules and regulations all operators are required to report and/or file certain release notifications and perform corrective actions for releases which may endanger public health or the environment. The acceptance of a C-141 report by the OCD does not relieve the operator of liability should their operations have failed to adequately investigate and remediate contamination that pose a threat to groundwater, surface water, human health or the environment. In addition, OCD acceptance of a C-141 report does not relieve the operator of responsibility for compliance with any other federal, state, or local laws and/or regulations. The responsible party acknowledges they must substantially restore, reclaim, and re-vegetate the impacted surface area to the conditions that existed prior to the release or their final land use in accordance with 19.15.29.13 NMAC including notification to the OCD when reclamation and re-vegetation are complete.

Printed Name: Amber Griffin Title: Rep Safety & Environmental Sr  
Signature: Amber Griffin Date: 12/30/2022  
email: amber\_griffin@eogresources.com Telephone: 575-748-1471

**OCD Only**

Received by: Jocelyn Harimon Date: 12/30/2022

Closure approval by the OCD does not relieve the responsible party of liability should their operations have failed to adequately investigate and remediate contamination that poses a threat to groundwater, surface water, human health, or the environment nor does not relieve the responsible party of compliance with any other federal, state, or local laws and/or regulations.

Closure Approved by: Robert Hamlet Date: 4/10/2023  
Printed Name: Robert Hamlet Title: Environmental Specialist - Advanced

District I  
1625 N. French Dr., Hobbs, NM 88240  
District II  
811 S. First St., Artesia, NM 88210  
District III  
1000 Rio Brazos Road, Aztec, NM 87410  
District IV  
1220 S. St. Francis Dr., Santa Fe, NM 87505

State of New Mexico  
Energy Minerals and Natural  
Resources Department

Oil Conservation Division  
1220 South St. Francis Dr.  
Santa Fe, NM 87505

Form C-141  
Revised August 24, 2018  
Submit to appropriate OCD District office

Incident ID	nAPP2233957598
District RP	
Facility ID	
Application ID	

## Release Notification

### Responsible Party

Responsible Party	EOG Resources, Inc	OGRID	7377
Contact Name	Amber Griffin	Contact Telephone	575-748-1471
Contact email	amber_griffin@eogresources.com	Incident #	nAPP2233957598
Contact mailing address	104 S. 4th Street, Artesia, NM 88210		

### Location of Release Source

Latitude 32.865921 Longitude 103.926899  
(NAD 83 in decimal degrees to 5 decimal places)

Site Name	Jackson B #33 Off Pad	Site Type	Flowline
Date Release Discovered	12/5/2022	API# (if applicable)	30-015-23807

Unit Letter	Section	Township	Range	County
F	1	17S	30E	Eddy

Surface Owner: ☐ State ☒ Federal ☐ Tribal ☐ Private (Name: \_\_\_\_\_)

### Nature and Volume of Release

Material(s) Released (Select all that apply and attach calculations or specific justification for the volumes provided below)

<input checked="" type="checkbox"/> Crude Oil	Volume Released (bbls)	Unknown	Volume Recovered (bbls)
<input checked="" type="checkbox"/> Produced Water	Volume Released (bbls)	Unknown	Volume Recovered (bbls)
	Is the concentration of dissolved chloride in the produced water >10,000 mg/l?	<input checked="" type="checkbox"/> Yes <input type="checkbox"/> No	
<input type="checkbox"/> Condensate	Volume Released (bbls)		Volume Recovered (bbls)
<input type="checkbox"/> Natural Gas	Volume Released (Mcf)		Volume Recovered (Mcf)
<input type="checkbox"/> Other (describe)	Volume/Weight Released (provide units)		Volume/Weight Recovered (provide units)

Cause of Release Historical impacts were discovered during the decommissioning of the location. The environmental consultant contracted to investigate the area determined on 12/5/2022, based on impacted are footprint, that the release more than likely breached the reportable volume threshold.

Incident ID	nAPP2233957598
District RP	
Facility ID	
Application ID	

Was this a major release as defined by 19.15.29.7(A) NMAC?  <input type="checkbox"/> Yes <input checked="" type="checkbox"/> No	If YES, for what reason(s) does the responsible party consider this a major release?
If YES, was immediate notice given to the OCD? By whom? To whom? When and by what means (phone, email, etc)?	

### Initial Response

*The responsible party must undertake the following actions immediately unless they could create a safety hazard that would result in injury*

<input checked="" type="checkbox"/> The source of the release has been stopped. <input checked="" type="checkbox"/> The impacted area has been secured to protect human health and the environment. <input checked="" type="checkbox"/> Released materials have been contained via the use of berms or dikes, absorbent pads, or other containment devices. <input checked="" type="checkbox"/> All free liquids and recoverable materials have been removed and managed appropriately.	
If all the actions described above have <u>not</u> been undertaken, explain why:	
Per 19.15.29.8 B. (4) NMAC the responsible party may commence remediation immediately after discovery of a release. If remediation has begun, please attach a narrative of actions to date. If remedial efforts have been successfully completed or if the release occurred within a lined containment area (see 19.15.29.11(A)(5)(a) NMAC), please attach all information needed for closure evaluation.	
I hereby certify that the information given above is true and complete to the best of my knowledge and understand that pursuant to OCD rules and regulations all operators are required to report and/or file certain release notifications and perform corrective actions for releases which may endanger public health or the environment. The acceptance of a C-141 report by the OCD does not relieve the operator of liability should their operations have failed to adequately investigate and remediate contamination that pose a threat to groundwater, surface water, human health or the environment. In addition, OCD acceptance of a C-141 report does not relieve the operator of responsibility for compliance with any other federal, state, or local laws and/or regulations.	
Printed Name: <u>Amber Griffin</u>	Title: <u>Rep Safety &amp; Environmental Sr</u>
Signature: <u><i>Amber Griffin</i></u>	Date: <u>12/5/2022</u>
email: <u>amber_griffin@eogresources.com</u>	Telephone: <u>575-748-1471</u>
<b><u>OCD Only</u></b>	
Received by: <u>Jocelyn Harimon</u>	Date: <u>12/06/2022</u>

Incident ID	nAPP2233957598
District RP	
Facility ID	
Application ID	

## Site Assessment/Characterization

*This information must be provided to the appropriate district office no later than 90 days after the release discovery date.*

What is the shallowest depth to groundwater beneath the area affected by the release?	<u>Unknown</u> (ft bgs)
Did this release impact groundwater or surface water?	<input type="checkbox"/> Yes <input checked="" type="checkbox"/> No
Are the lateral extents of the release within 300 feet of a continuously flowing watercourse or any other significant watercourse?	<input type="checkbox"/> Yes <input checked="" type="checkbox"/> No
Are the lateral extents of the release within 200 feet of any lakebed, sinkhole, or playa lake (measured from the ordinary high-water mark)?	<input type="checkbox"/> Yes <input checked="" type="checkbox"/> No
Are the lateral extents of the release within 300 feet of an occupied permanent residence, school, hospital, institution, or church?	<input type="checkbox"/> Yes <input checked="" type="checkbox"/> No
Are the lateral extents of the release within 500 horizontal feet of a spring or a private domestic fresh water well used by less than five households for domestic or stock watering purposes?	<input type="checkbox"/> Yes <input checked="" type="checkbox"/> No
Are the lateral extents of the release within 1000 feet of any other fresh water well or spring?	<input type="checkbox"/> Yes <input checked="" type="checkbox"/> No
Are the lateral extents of the release within incorporated municipal boundaries or within a defined municipal fresh water well field?	<input type="checkbox"/> Yes <input checked="" type="checkbox"/> No
Are the lateral extents of the release within 300 feet of a wetland?	<input type="checkbox"/> Yes <input checked="" type="checkbox"/> No
Are the lateral extents of the release overlying a subsurface mine?	<input type="checkbox"/> Yes <input checked="" type="checkbox"/> No
Are the lateral extents of the release overlying an unstable area such as karst geology?	<input type="checkbox"/> Yes <input checked="" type="checkbox"/> No
Are the lateral extents of the release within a 100-year floodplain?	<input type="checkbox"/> Yes <input checked="" type="checkbox"/> No
Did the release impact areas <b>not</b> on an exploration, development, production, or storage site?	<input checked="" type="checkbox"/> Yes <input type="checkbox"/> No

Attach a comprehensive report (electronic submittals in .pdf format are preferred) demonstrating the lateral and vertical extents of soil contamination associated with the release have been determined. Refer to 19.15.29.11 NMAC for specifics.

### **Characterization Report Checklist:** *Each of the following items must be included in the report.*

- ☒ Scaled site map showing impacted area, surface features, subsurface features, delineation points, and monitoring wells.
- ☐ Field data
- ☒ Data table of soil contaminant concentration data
- ☒ Depth to water determination
- ☒ Determination of water sources and significant watercourses within ½-mile of the lateral extents of the release
- ☐ Boring or excavation logs
- ☒ Photographs including date and GIS information
- ☒ Topographic/Aerial maps
- ☒ Laboratory data including chain of custody

If the site characterization report does not include completed efforts at remediation of the release, the report must include a proposed remediation plan. That plan must include the estimated volume of material to be remediated, the proposed remediation technique, proposed sampling plan and methods, anticipated timelines for beginning and completing the remediation. The closure criteria for a release are contained in Table 1 of 19.15.29.12 NMAC, however, use of the table is modified by site- and release-specific parameters.

## Oil Conservation Division

Incident ID	nAPP2233957598
District RP	
Facility ID	
Application ID	

I hereby certify that the information given above is true and complete to the best of my knowledge and understand that pursuant to OCD rules and regulations all operators are required to report and/or file certain release notifications and perform corrective actions for releases which may endanger public health or the environment. The acceptance of a C-141 report by the OCD does not relieve the operator of liability should their operations have failed to adequately investigate and remediate contamination that pose a threat to groundwater, surface water, human health or the environment. In addition, OCD acceptance of a C-141 report does not relieve the operator of responsibility for compliance with any other federal, state, or local laws and/or regulations.

Printed Name: Amber Griffin Title: Rep Safety & Environmental Sr

Signature: Amber Griffin Date: 12/30/2022

email: amber\_griffin@eogresources.com Telephone: 575-748-7471

**OCD Only**

Received by: Jocelyn Harimon Date: 12/30/2022

Incident ID	nAPP2233957598
District RP	
Facility ID	
Application ID	

## Closure

The responsible party must attach information demonstrating they have complied with all applicable closure requirements and any conditions or directives of the OCD. This demonstration should be in the form of a comprehensive report (electronic submittals in .pdf format are preferred) including a scaled site map, sampling diagrams, relevant field notes, photographs of any excavation prior to backfilling, laboratory data including chain of custody documents of final sampling, and a narrative of the remedial activities. Refer to 19.15.29.12 NMAC.

**Closure Report Attachment Checklist:** *Each of the following items must be included in the closure report.*

- ☒ A scaled site and sampling diagram as described in 19.15.29.11 NMAC
- ☒ Photographs of the remediated site prior to backfill or photos of the liner integrity if applicable (Note: appropriate OCD District office must be notified 2 days prior to liner inspection)
- ☒ Laboratory analyses of final sampling (Note: appropriate ODC District office must be notified 2 days prior to final sampling)
- ☒ Description of remediation activities

I hereby certify that the information given above is true and complete to the best of my knowledge and understand that pursuant to OCD rules and regulations all operators are required to report and/or file certain release notifications and perform corrective actions for releases which may endanger public health or the environment. The acceptance of a C-141 report by the OCD does not relieve the operator of liability should their operations have failed to adequately investigate and remediate contamination that pose a threat to groundwater, surface water, human health or the environment. In addition, OCD acceptance of a C-141 report does not relieve the operator of responsibility for compliance with any other federal, state, or local laws and/or regulations. The responsible party acknowledges they must substantially restore, reclaim, and re-vegetate the impacted surface area to the conditions that existed prior to the release or their final land use in accordance with 19.15.29.13 NMAC including notification to the OCD when reclamation and re-vegetation are complete.

Printed Name: Amber Griffin Title: Rep Safety & Environmental Sr  
Signature: Amber Griffin Date: 12/30/2022  
email: amber\_griffin@eogresources.com Telephone: 575-748-1471

**OCD Only**

Received by: Jocelyn Harimon Date: 12/30/2022

Closure approval by the OCD does not relieve the responsible party of liability should their operations have failed to adequately investigate and remediate contamination that poses a threat to groundwater, surface water, human health, or the environment nor does not relieve the responsible party of compliance with any other federal, state, or local laws and/or regulations.

Closure Approved by: \_\_\_\_\_ Date: \_\_\_\_\_

Printed Name: \_\_\_\_\_ Title: \_\_\_\_\_

701 Tradewinds Boulevard, Suite C  
Midland, Texas 79706  
Tel. 432.685.3898  
www.ntglobal.com



December 30, 2022

**New Mexico Oil Conservation Division  
District 2  
811 South First Street  
Artesia, New Mexico 88210**

**Re: Site Characterization and Closure Report  
Jackson B #33 Off Pad  
EOG Resources Inc.  
Incident ID: nAPP2233957598  
F-01-17S-30E, Eddy County, New Mexico**

To Whom it May Concern:

## **1. Introduction**

New Tech Global Environmental, LLC (NTGE), on behalf of EOG Resources (EOG), submits this Site Characterization and Closure Report to the New Mexico Oil Conservation Division (NMOCD) District 2 Office. This report provides documentation of delineation, sampling, remedial activities, and analyses conducted in the affected area at the EOG Jackson B #33 Off Pad Release (Site). The Site is located in Unit Letter F, Section 01, of Township 17 South and Range 30 East in Eddy County, New Mexico. The GPS coordinates for the release site are 32.865921° N latitude and -103.926899° W longitude. The release occurred on land managed by the Bureau of Land Management (BLM). Figure 1 and 2 depict the Site Location. The EOG flowline area and other site details are depicted on Figures 3 and 4.

## **2. Background**

A C-141, Release Notification, for this release was submitted to the NMOCD on December 5, 2022. The C-141 stated that no known volume or date could be assigned to this historical release. The potential release area was discovered during EOG decommissioning and site abandonment activities associated with this location. Soils within the former flowline area appeared to be discolored and after discussions between field personnel and environmental staff, EOG made the decision to file a C-141 for this suspect release location.

The release falls under the jurisdiction of the NMOCD District 2 Office in Artesia, New Mexico. The NMOCD assigned the release with Incident Number nAPP2233957598. The Release Notification and Corrective Action, Site Assessment/Characterization, and Closure portions of Form C-141 are attached to the front of this report.

### 3. Groundwater and Site Characterization

NTGE characterized the Site according to Table I, Closure Criteria for Soils Impacted by a Release, from New Mexico Administrative Code (NMAC) Title 19, Chapter 15, Part 29, Section 13 (NMAC 19.15.29.13).

The area is located in an area of low karst potential. No water wells with depth to groundwater information was located within a half mile. No other receptors (karst potential areas, water wells, playas, wetlands, waterways, lakebeds or ordinance boundaries) were located within each specific boundary or distance from the Site. According to the Site characterization evaluation and 19.15.29.13.C(4)(a)(i), the Site meets the closure criteria for depth to groundwater less than fifty (50) feet in Table I in NMAC 19.15.29.12. The Site characterization documentation (OSE POD Locations Map, Karst Potential, Significant Watercourse Map, Wetlands Map, and FEMA Map) are provided in Attachment A. The soil closure criteria are listed below:

**General Site Characterization and Groundwater:**

Site Characterization	Average Groundwater Depth (ft)
No Receptors Found	Unknown

**Table 3.1 Closure Criteria for Soils Impacted by a Release (NMAC 19.15.29.12 & 19.15.29.13)**

Regulatory Standard	Chloride	TPH (GRO+DRO+MR)	TPH (GRO+MRO)	BTEX	Benzene
19.15.29.13 Restoration, Reclamation and Re-Vegetation (Impacted Area 0-4 Feet)	600 mg/kg	100 mg/kg	---	50 mg/kg	10 mg/kg
19.15.29.12 NMAC Table I Closure Criteria for Soils Impacted by a Release	10,000 mg/kg	2,500 mg/kg	1,000 mg/kg	50 mg/kg	10 mg/kg
Notes: --- = not defined					

### 4. Initial Soil Delineation Assessment Summary and Findings

On November 9, 2022, New Tech Global Environmental, LLC (NTGE), installed one (1) bottom hole hand auger boring (BH-1), and four (4) horizontal hand auger borings (H-1 through H-4) to fully delineate the vertical and horizontal extent of the suspected release area. Four (4) sidewall sample points were also collected within the impacted area already excavated. Soil samples were collected at depths ranging from surface to five (5) feet below ground surface. Additionally, a stockpile sample was collected from the stockpiled soil placed on plastic, STKP-1. All soil samples were analyzed for benzene, toluene, ethylbenzene, and xylenes (BTEX) by EPA method 8021B, total petroleum hydrocarbons (TPH) by method 8015 modified, and chloride by EPA method 300.0 by Envirotech, Inc. in Farmington, New Mexico. One (1) of the two (2) bottom hole hand auger sample points and the stockpile sample exhibited TPH concentrations exceeding 19.15.29.12 Table I Closure Criteria, BH-1 at 4 feet and STKP-1. All four (4) sidewall samples collected exhibited TPH and/or chloride concentrations exceeding 19.15.29.12 Table I Closure Criteria, SW-1, SW-2, SW-3, and SW-4. The four (4) horizontal soil samples (H-1



through HA-4) exhibited benzene, BTEX, TPH, and chloride concentrations below 19.15.29.12 Closure Criteria. Figure 3, Assessment Sample Location Map, depicts the locations of the initial delineation samples. Analytical results are provided on Table 2, Summary of Soil Analytical Data – delineation samples, and in the Laboratory Analytical Reports provided in attachment D.

## 5. Excavation, Waste Management and Confirmation Sampling

Due to the initial soil sampling activities exhibiting TPH and chloride concentrations above 19.15.29.12 Table I Closure Criteria, NTGE and Standard Safety and Supply (SS) mobilized to the site on December 20, 2022, to excavate the affected soils. Soils within the first four (4) feet containing TPH and/or chloride exceedances of 19.15.29.12 Table I Closure Criteria were excavated. On December 21, 2022, two (2) composite confirmation bottom hole samples (BH-1A, and BH-2A), and four (4) sidewall composite confirmation samples (SW-1A through SW-4A) were collected and submitted to Cardinal Laboratories in Hobbs, New Mexico and analyzed for BTEX by EPA Method 8021B, TPH by Method 8015M, and chloride by EPA Method SM4500CL-B. Analytical results indicated one (1) sidewall sample (SW-1A) exceeded TPH concentrations above 19.15.29.13 Table I Closure Criteria.

NTGE and SS returned to the Site on December 27, 2022, to continue excavation activities. The area represented by SW-1A, collected on December 21, 2022, was further excavated and another composite confirmation sample (SW-1B) was collected on December 27, 2022. Analytical results of the final composite confirmation sample indicated no exceedances above 19.15.29.13 Table I Closure Criteria

Figure 4, Confirmation Sample Map, depicts the locations of the confirmation samples. Analytical results are provided on Table 1, Summary of Soil Analytical Data – Confirmation Samples and in the Laboratory Analytical Reports provided in attachment D. A photographic log is included in Attachment B.

Waste Management activities were performed in coordination with EOG directives. EOG obtained regulatory approval via the successful processing of form C-138 Request for Approval to Accept Solid Waste. The waste was approved for acceptance at the OCD-permitted (WM-1-035), Lea Land, LLC facility located at MM 64, Highway 62/180 East, Carlsbad, NM, 88220. Approximately 150 tons of impacted soil were disposed at Lea Land, LLC, the waste manifest from December 29, 2022, are available upon request and aren't included in this report due to the size of the file. Confirmation Sampling Notifications are provided as Attachment C.

## 6. nAPP2233957598 Closure Request

The excavation will be backfilled with non-impacted material on a future date. Site characterization, soil delineation, and remediation activities for this incident number have been performed in accordance with applicable NMOCD guidance and regulations. Based upon supporting documentation provided in this report, NTGE, on behalf of EOG, respectfully requests closure and no further regulatory actions for nAPP2233957598.

If you have any questions or comments concerning this Site Characterization and Closure Report, please do not hesitate to contact our Midland office at (432) 766-1918.

Sincerely,

NTG Environmental



Becky Haskell  
Senior Project Manager

Encl. Figure 1 – Site Location Map  
Figure 2 – Area Map  
Figure 3 – Assessment Sample Location Map  
Figure 4 – Confirmation Sample Map  
Table 1 – Summary of Soil Analytical Data – Confirmation Samples  
Table 2 – Summary of Soil Analytical Data – Delineation Samples  
Attachment A – Site Characterization Documentation  
Attachment B – Photographic Log  
Attachment C – Confirmation Sampling Notifications  
Attachment D – Laboratory Analytical Reports and Chain-of-Custody Documentation

cc: Chase Settle

# FIGURES

---



Document Path: P:\2022 PROJECTS\EOG\RSC\226531 Jackson B#33 Off Pad\7 - Figures\GIS\Geodatabase\Figure\_1\_SLM\Map\_12162022.aprx

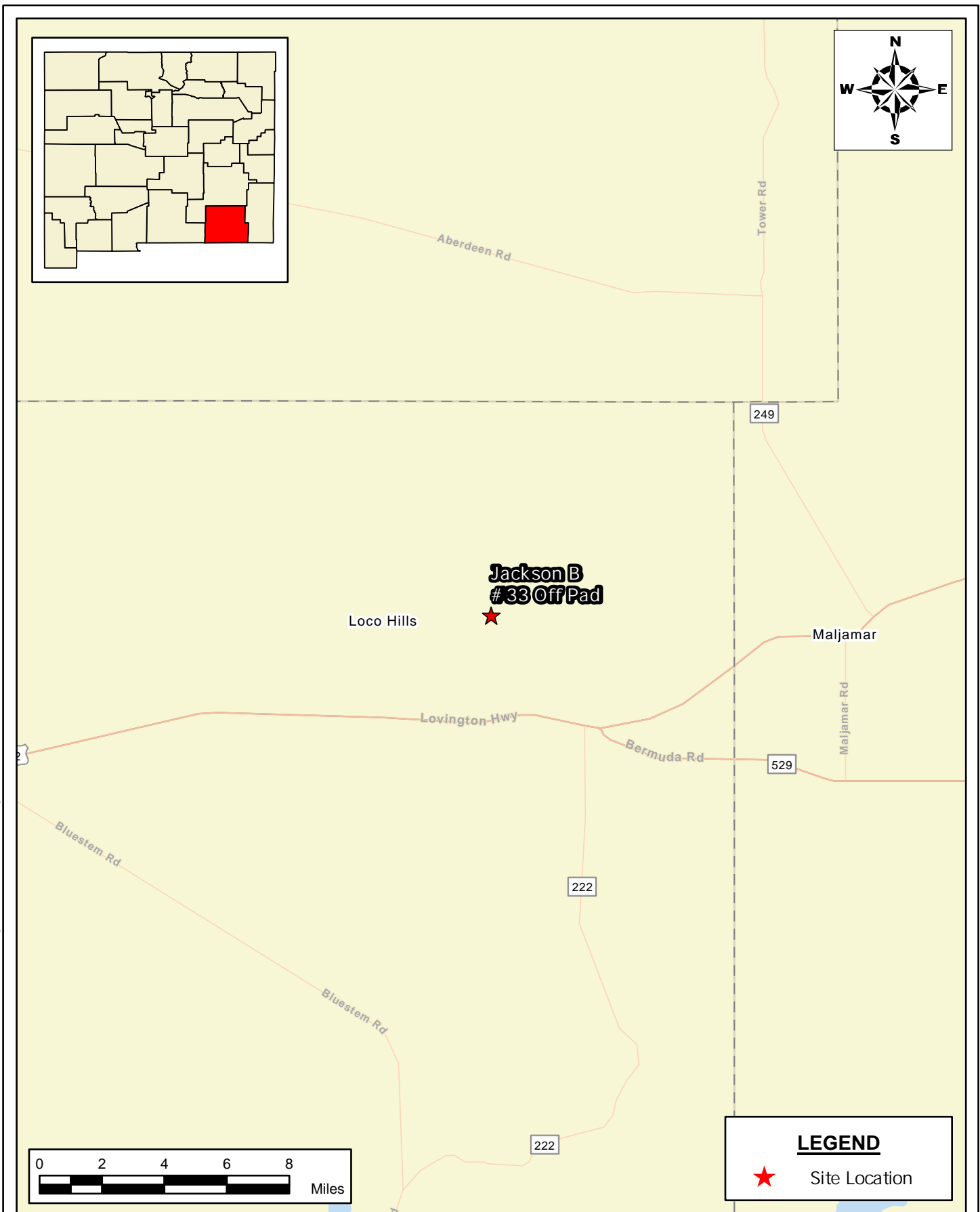

**SITE LOCATION MAP**  
**EOG RESOURCES**  
 JACKSON B #33 OFF PAD  
 EDDY COUNTY, NEW MEXICO  
 32.865921, -103.926899

SCALE: As Shown    Date: 12/30/2022    PROJECT #: 226531



**New Tech Global Environmental, LLC**  
 911 Regional Park Drive  
 Houston, Texas 77060  
 T - 281.872.9300  
 F - 281.872.4521  
 Web: www.ntglobal.com

**NOTES:**

1. Base Image: ESRI Maps & Data 2013
2. Map Projection: NAD 1983 UTM Zone 13N

DRAWING NUMBER:

**FIGURE 1**

SHEET NUMBER:

**1 of 1**



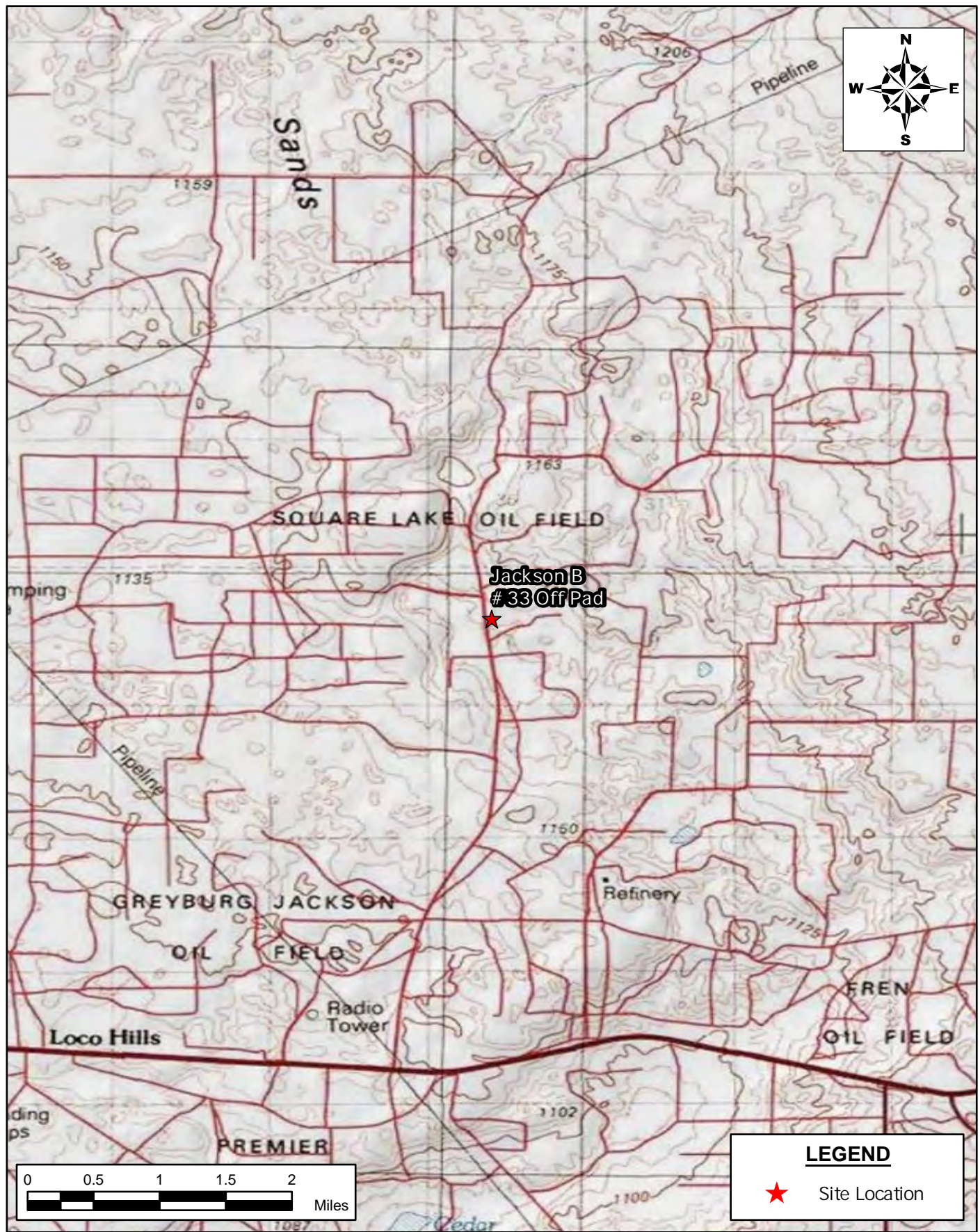

Document Path: P:\2022 PROJECTS\EOG\SC226531 Jackson B#33 Off Pad\7 - Figures\GIS\Geodatabase\Figure\_2\_AreaMap\_12202022.aprx

**AREA MAP**  
**EOG RESOURCES**  
 JACKSON B #33 OFF PAD  
 EDDY COUNTY, NEW MEXICO  
 32.865921, -103.926899

SCALE: As Shown

Date: 12/30/2022

PROJECT #: 226531



**New Tech Global Environmental, LLC**  
 911 Regional Park Drive  
 Houston, Texas 77060  
 T - 281.872.9300  
 F - 281.872.4521  
 Web: www.ntglobal.com

**NOTES:**

1. Base Image: ESRI Maps & Data 2013
2. Map Projection: NAD 1983 UTM Zone 13N

DRAWING NUMBER:

**FIGURE 2**

SHEET NUMBER:

**1 of 1**

Document Path: P:\2022 PROJECTS\EOGRSC\226531 Jackson B\#33 Off Pad\7 - Figures\GIS\Geodatabase\Figure\_3\_SampleLocationMap\_12202022.aprx

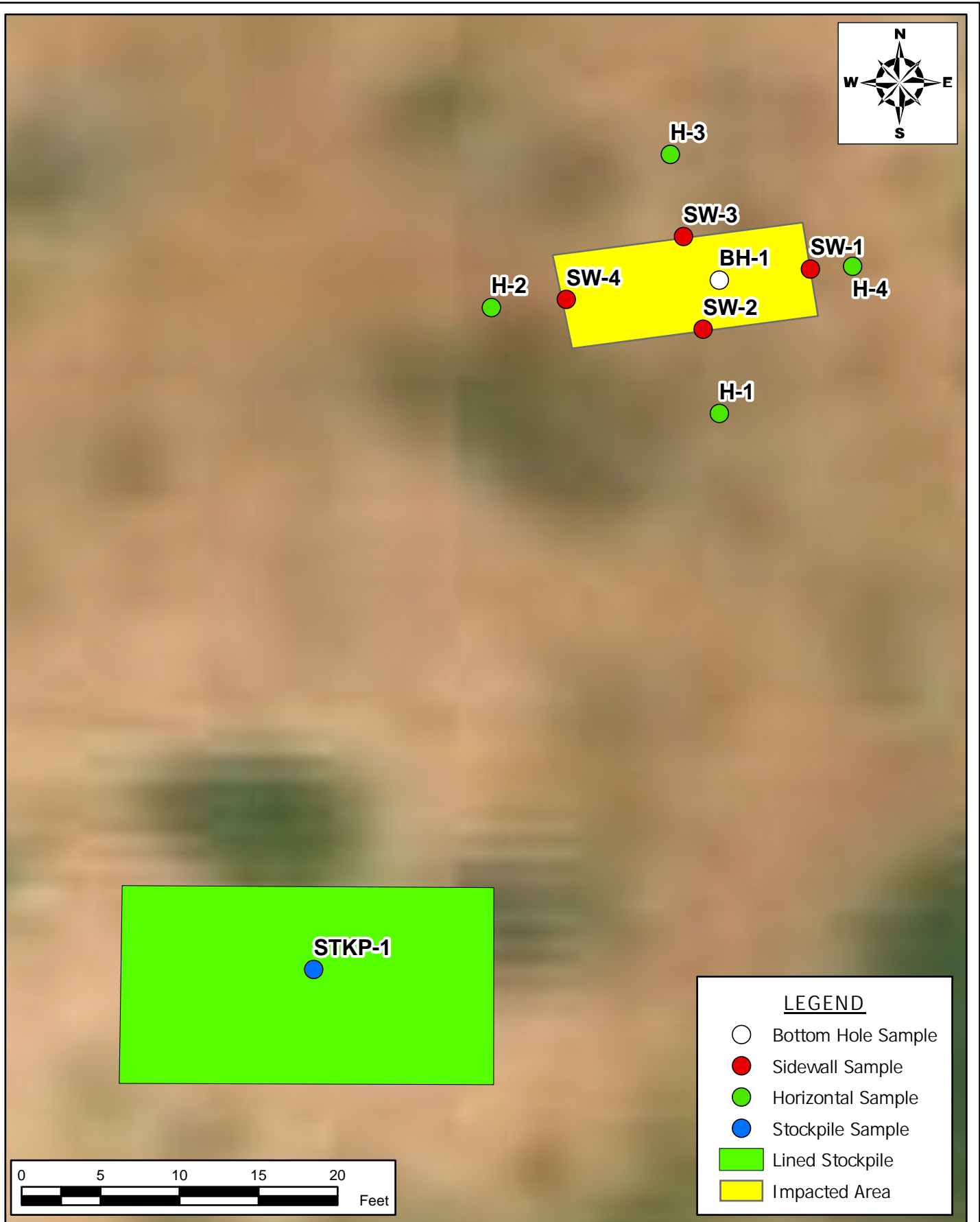

**ASSESSMENT SAMPLE LOCATION MAP**  
**EOG RESOURCES**  
 JACKSON B #33 OFF PAD  
 EDDY COUNTY, NEW MEXICO  
 32.865921, -103.926899

SCALE: As Shown

Date: 12/30/2022

PROJECT #: 226531



**New Tech Global Environmental, LLC**  
 911 Regional Park Drive  
 Houston, Texas 77060  
 T - 281.872.9300  
 F - 281.872.4521  
 Web: www.ntglobal.com

**NOTES:**

1. Base Image: ESRI Maps & Data 2013
2. Map Projection: NAD 1983 UTM Zone 13N
3. Results in Milligrams Per Kilograms (MG/KG)
4. See Table 1 for Full Analytical Results/Details
5. Yellow Cells Indicate Exceedance

DRAWING NUMBER:

**FIGURE 3**

SHEET NUMBER:

**1 of 1**



Document Path: P:\2022 PROJECTS\EOGRSC\226531 Jackson B\33 Off Pad\7 - Figures\GIS\Geodatabase\Figure\_4\_ExcavationMap\_12282022.aprx

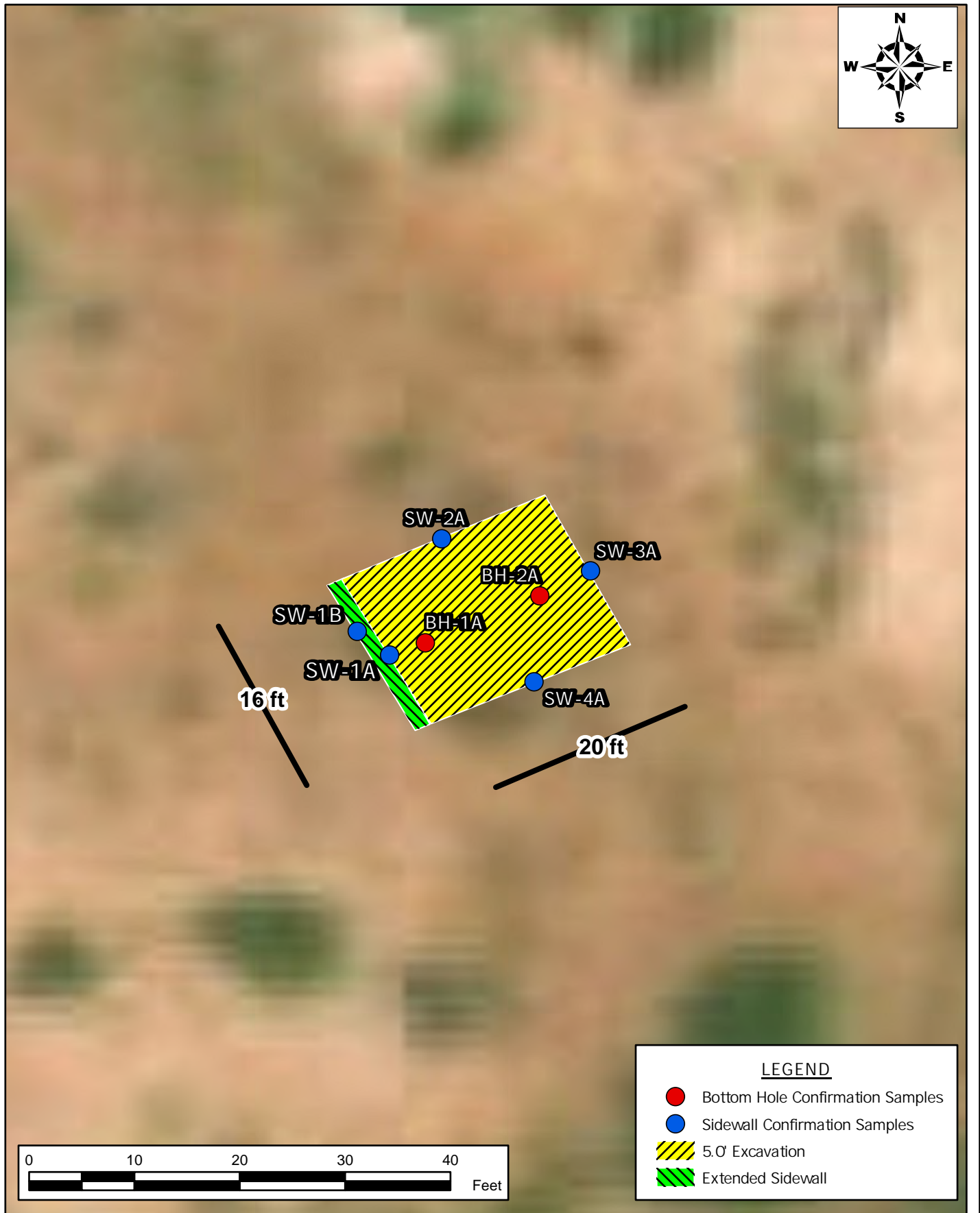

**CONFIRMATION SAMPLE MAP**  
**EOG RESOURCES**  
 JACKSON B #33 OFF PAD  
 EDDY COUNTY, NEW MEXICO  
 32.865921, -103.926899

SCALE: As Shown

Date: 12/30/2022

PROJECT #: 226531



**New Tech Global Environmental, LLC**  
 911 Regional Park Drive  
 Houston, Texas 77060  
 T - 281.872.9300  
 F - 281.872.4521  
 Web: www.ntglobal.com

**NOTES:**

1. Base Image: ESRI Maps & Data 2013
2. Map Projection: NAD 1983 UTM Zone 13N

DRAWING NUMBER:

**FIGURE 4**

SHEET NUMBER:

**1 of 1**

# TABLES

---





**Table 1**  
**Summary of Soil Analytical Data - Confirmation Samples**  
**Jackson B #33 Off Pad**  
**EOG Resources**  
**Eddy County, New Mexico**

Sample ID	Sample Date	Depth (ft bgs)	Benzene	Toluene	Ethylbenzene	Xylenes	BTEX	TPH					Chloride
								GRO (C6-C10)	DRO (C10-C28)	GRO + DRO	MRO (C28-C35)	Total GRO/DRO/MRO	
			(mg/kg)	(mg/kg)	(mg/kg)	(mg/kg)	(mg/kg)	(mg/kg)	(mg/kg)	(mg/kg)	(mg/kg)	(mg/kg)	
			Table I Closure Criteria for Soil <50 feet Depth to Groundwater 19.15.29 NMAC										
			10 mg/kg	---	---	---	50 mg/kg	---	---	---	---	100 mg/kg	600 mg/kg
NTGE Confirmation Samples													
BH-1A	12/21/2022	5'	<0.050	<0.050	<0.050	<0.150	<0.300	<10.0	<10.0	<10.0	<10.0	<10.0	448
BH-2A	12/21/2022	5'	<0.050	<0.050	<0.050	<0.150	<0.300	<10.0	13.3	<10.0	<10.0	<10.0	192
SW-1A	12/21/2022	0-4'	<0.050	<0.050	<0.050	<0.150	<0.300	<10.0	389	389	200	589	32.0
SW-1B	12/27/2022	0-4'	<0.050	<0.050	<0.050	<0.150	<0.300	<10.0	<10.0	<10.0	<10.0	<10.0	16.0
SW-2A	12/21/2022	0-4'	<0.050	<0.050	<0.050	<0.150	<0.300	<10.0	12.3	12.3	15.3	28	64.0
SW-3A	12/21/2022	0-4'	<0.050	<0.050	<0.050	<0.150	<0.300	<10.0	<10.0	<10.0	<10.0	<10.0	80.0
SW-4A	12/21/2022	0-4'	<0.050	<0.050	<0.050	<0.150	<0.300	<10.0	<10.0	<10.0	<10.0	<10.0	16.0

## Notes:

1. Values reported in mg/kg
2. < = Value Less Than Reporting Limit (RL)
3. Bold indicates Analyte Detected
4. BTEX analyses by EPA Method SW 8021B

5. TPH analyses by EPA Method SW 8015 Mod.
6. GRO/DRO/MRO - Gasoline/Diesel/Motor Oil

7. Yellow shaded cells indicate analytical samples that exceed the NMAC 19.15.29.12 Table I Closure Criteria for the site.

8. Peach shaded cells indicate analytical samples that exceed the NMAC 19.15.29.13 Table I Closure Criteria for the site (Surface to 4 Feet Below Grade).

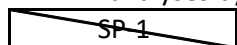
 SP-1 Sample Point Excavated

**Table 2**  
**Summary of Soil Analytical Data - Delineation Samples**  
**Jackson B #33 Off Pad**  
**EOG Resources**  
**Eddy County, New Mexico**

Sample ID	Sample Date	Depth (ft bgs)	Benzene	Toluene	Ethylbenzene	Xylenes	BTEX	TPH					Chloride
								GRO (C6-C10)	DRO (C10-C28)	GRO + DRO	MRO (C28-C35)	Total GRO/DRO/MRO	
			(mg/kg)	(mg/kg)	(mg/kg)	(mg/kg)	(mg/kg)	(mg/kg)	(mg/kg)	(mg/kg)	(mg/kg)	(mg/kg)	
			Table I Closure Criteria for Soil <50 feet Depth to Groundwater 19.15.29 NMAC										
			10 mg/kg	---	---	---	50 mg/kg	---	---	---	---	100 mg/kg	600 mg/kg
NTGE Initial Assessment Samples													
BH-1	11/9/2022	4'	<0.0250	<0.0250	<0.0250	<0.0250	<0.0250	<20	3,500	3,500	<5,000	3,500	227
	11/9/2022	5'	<0.0250	<0.0250	<0.0250	<0.0250	<0.0250	<20	43.8	43.8	<50.0	43.8	275
SW-1	11/9/2022	0-4'	<0.0250	<0.0250	<0.0250	<0.0250	<0.0250	<20	1,120	1,120	502	1,622	51.9
SW-2	11/9/2022	0-4'	<0.0250	<0.0250	<0.0250	<0.0250	<0.0250	<20	1,430	1,430	920	2,350	154
SW-3	11/9/2022	0-4'	<0.0250	<0.0250	<0.0250	<0.0250	<0.0250	<20	7,000	7,000	<5,000	7,000	383
SW-4	11/9/2022	0-4'	<0.0250	<0.0250	<0.0250	<0.0250	<0.0250	<20	9,590	9,590	<5,000	9,590	2,580
H-1 (0-1')	11/9/2022	0-1'	<0.0250	<0.0250	<0.0250	<0.0250	<0.0250	<20	<25.0	<25.0	<50.0	<50.0	165
H-2 (0-1')	11/9/2022	0-1'	<0.0250	<0.0250	<0.0250	<0.0250	<0.0250	<20	<25.0	<25.0	<50.0	<50.0	<20.0
H-3 (0-1')	11/9/2022	0-1'	<0.0250	<0.0250	<0.0250	<0.0250	<0.0250	<20	<25.0	<25.0	<50.0	<50.0	<20.0
H-4 (0-1')	11/9/2022	0-1'	<0.0250	<0.0250	<0.0250	<0.0250	<0.0250	<20	<25.0	<25.0	<50.0	<50.0	<20.0
STKP-1	11/9/2022	NA	<0.0250	<0.0250	<0.0250	<0.0250	<0.0250	<20	5,070	5,070	<5,000	5,070	236

Notes:

1. Values reported in mg/kg
2. < = Value Less Than Reporting Limit (RL)
3. Bold indicates Analyte Detected
4. BTEX analyses by EPA Method SW 8021B

5. TPH analyses by EPA Method SW 8015 Mod.
6. GRO/DRO/MRO - Gasoline/Diesel/Motor Oil

7. Yellow shaded cells indicate analytical samples that exceed the NMAC 19.15.29.12 Table I Closure Criteria for the site.

8. Peach shaded cells indicate analytical samples that exceed the NMAC 19.15.29.13 Table I Closure Criteria for the site (Surface to 4 Feet Below Grade).

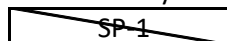
 Sample Point Excavated

**Table 2**  
**Daily Disposal Summary**  
**Jackson B #33**  
**EOG Resources**  
**Eddy, County, New Mexico**

Date of Disposal	Total Pounds Disposed	Total Tons Disposed
12/29/2022	300,100	150
Project Total	300,100	150.05

# **ATTACHMENT A: SITE CHARACTERIZATION DOCUMENTATION**

---



# OSE POD Locations Map

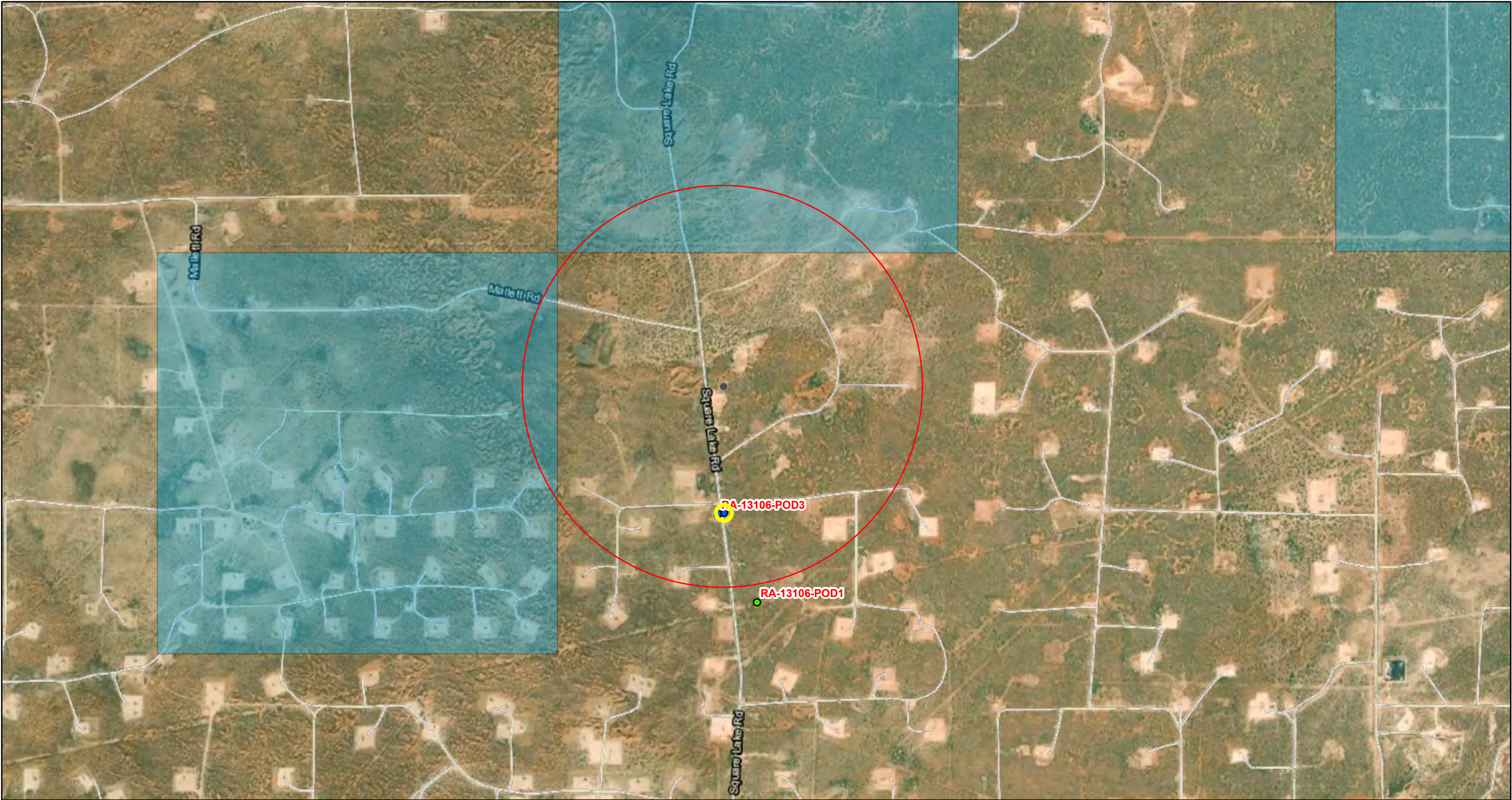

12/19/2022, 10:58:23 AM

GIS WATERS PODs

	OSE District Boundary		SiteBoundaries
	Active		New Mexico State Trust Lands
	Pending		Both Estates

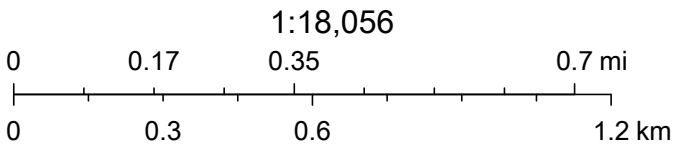





Esri, HERE, iPC, U.S. Department of Energy Office of Legacy Management, Esri, HERE, Garmin, iPC, Maxar



# Jackson B #33 Off Pad

Karst Potential Map

**Legend**

-  High
-  Jackson B #33 Off Pad
-  Low
-  Medium

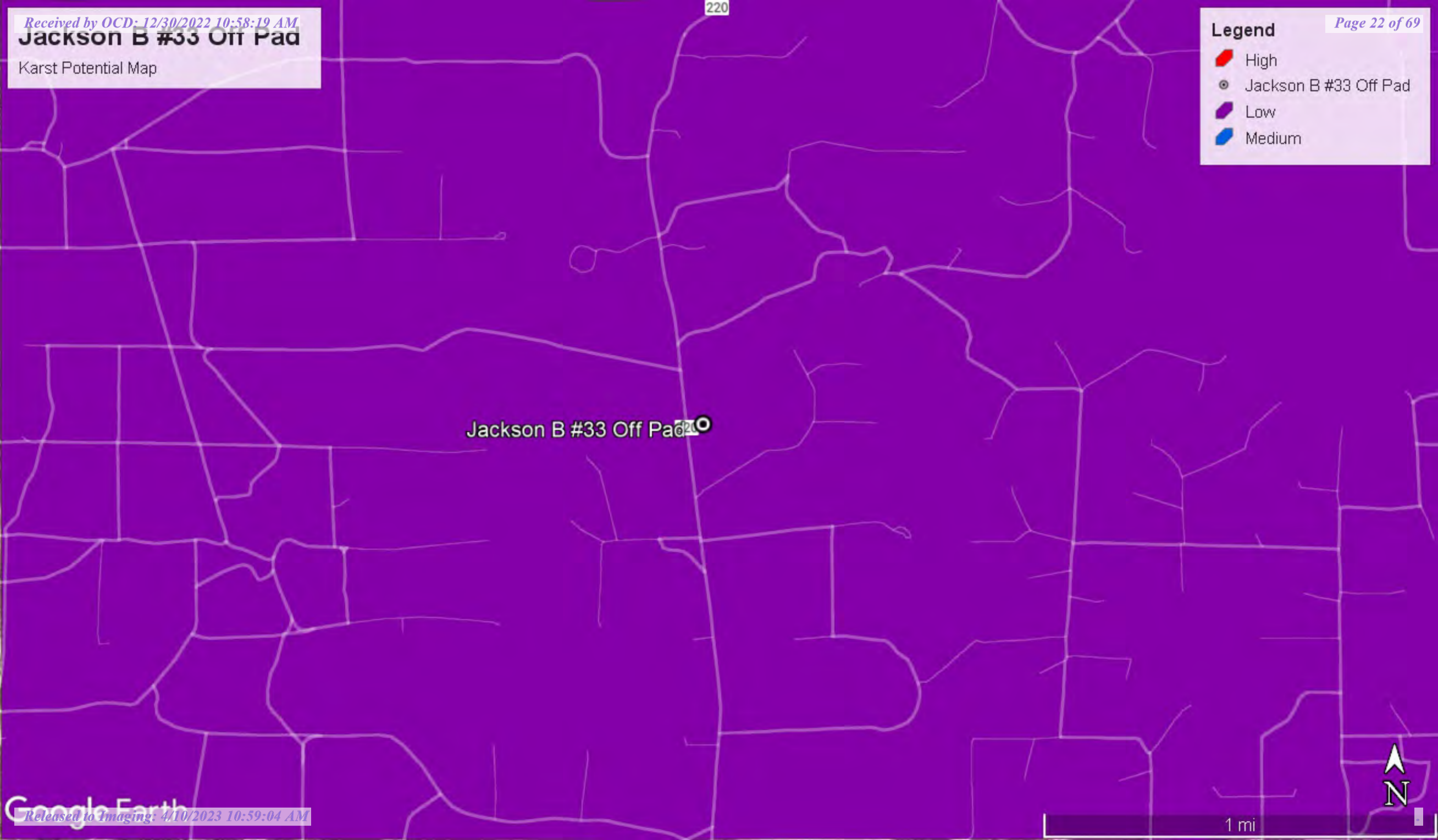

Jackson B #33 Off Pad

# Jackson B #33 Off Pad

Significant Watercourse Map

## Legend

- 1/2 Mile Radius
- 300 Foot Radius
- Jackson B #33 Off Pad

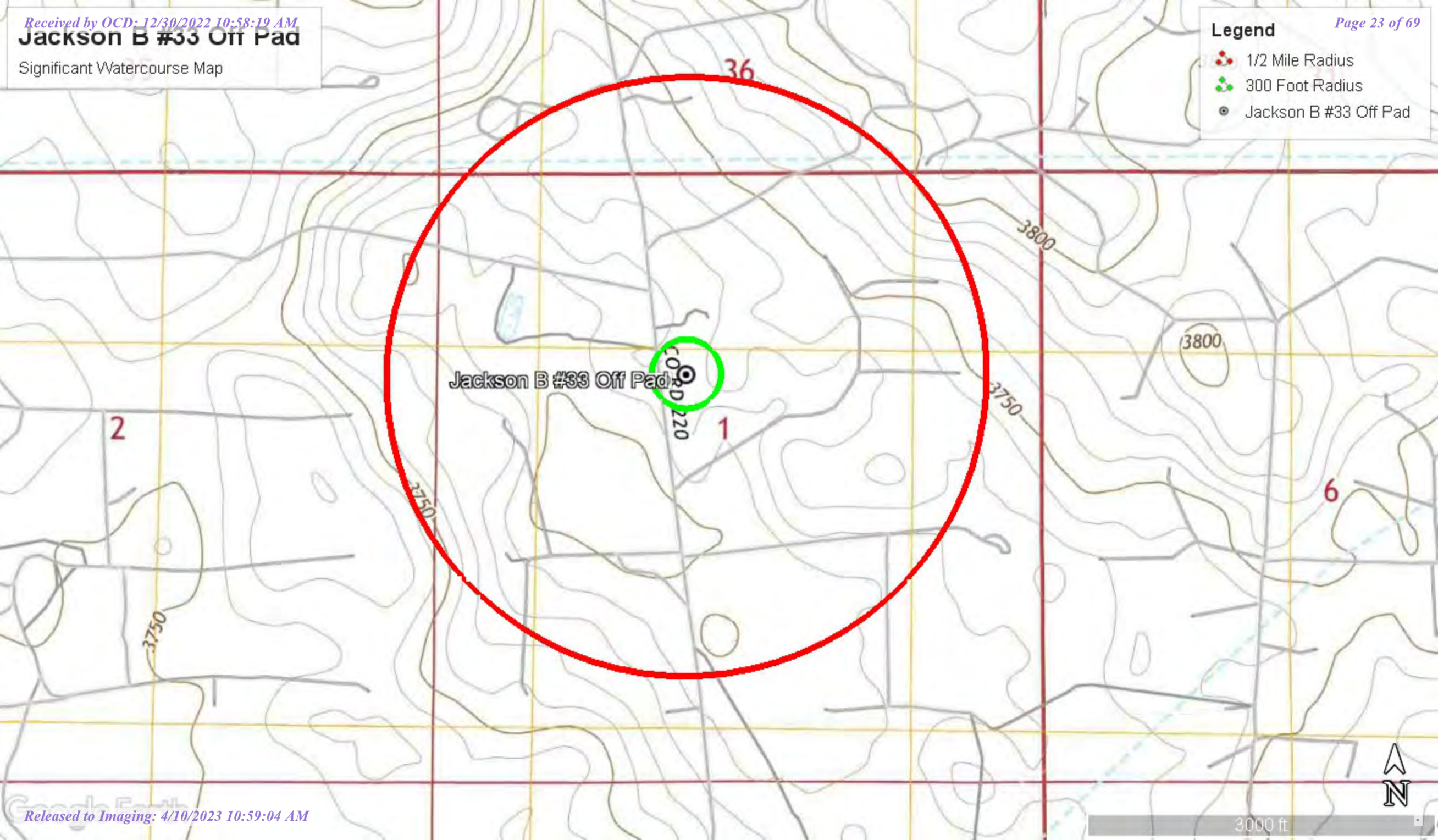





## Jackson B #33 Off Pad



December 19, 2022

**Wetlands**

- Estuarine and Marine Deepwater
- Estuarine and Marine Wetland

- Freshwater Emergent Wetland
- Freshwater Forested/Shrub Wetland
- Freshwater Pond

- Lake
- Other
- Riverine

This map is for general reference only. The US Fish and Wildlife Service is not responsible for the accuracy or currentness of the base data shown on this map. All wetlands related data should be used in accordance with the layer metadata found on the Wetlands Mapper web site.



## National Flood Hazard Layer FIRMette



103°55'55"W 32°52'12"N



## Legend

SEE FIS REPORT FOR DETAILED LEGEND AND INDEX MAP FOR FIRM PANEL LAYOUT

SPECIAL FLOOD HAZARD AREAS		Without Base Flood Elevation (BFE) Zone A, V, A99
		With BFE or Depth Zone AE, AO, AH, VE, AR
		Regulatory Floodway
OTHER AREAS OF FLOOD HAZARD		0.2% Annual Chance Flood Hazard, Areas of 1% annual chance flood with average depth less than one foot or with drainage areas of less than one square mile Zone X
		Future Conditions 1% Annual Chance Flood Hazard Zone X
		Area with Reduced Flood Risk due to Levee. See Notes. Zone X
		Area with Flood Risk due to Levee Zone D
OTHER AREAS		NO SCREEN Area of Minimal Flood Hazard Zone X
		Effective LOMRs
		Area of Undetermined Flood Hazard Zone D
GENERAL STRUCTURES		Channel, Culvert, or Storm Sewer
		Levee, Dike, or Floodwall
OTHER FEATURES		20.2 Cross Sections with 1% Annual Chance Water Surface Elevation
		17.5 Cross Sections with 1% Annual Chance Water Surface Elevation
		Coastal Transect
		Base Flood Elevation Line (BFE)
		Limit of Study
		Jurisdiction Boundary
		Coastal Transect Baseline
MAP PANELS		Digital Data Available
		No Digital Data Available
		Unmapped



The pin displayed on the map is an approximate point selected by the user and does not represent an authoritative property location.

This map complies with FEMA's standards for the use of digital flood maps if it is not void as described below. The basemap shown complies with FEMA's basemap accuracy standards

The flood hazard information is derived directly from the authoritative NFHL web services provided by FEMA. This map was exported on **12/19/2022 at 12:11 PM** and does not reflect changes or amendments subsequent to this date and time. The NFHL and effective information may change or become superseded by new data over time.

This map image is void if the one or more of the following map elements do not appear: basemap imagery, flood zone labels, legend, scale bar, map creation date, community identifiers, FIRM panel number, and FIRM effective date. Map images for unmapped and unmodernized areas cannot be used for regulatory purposes.

0 250 500 1,500 2,000 Feet 1:6,000

103°55'18"W 32°51'42"N

## **ATTACHMENT B: PHOTOGRAPHIC LOG**

---

**PHOTOGRAPHIC LOG****EOG Jackson B #33 Off Pad****Photograph No. 1****Facility:** Jackson B #33 Off Pad**County:** Eddy**Description:**

View of excavation.

**Photograph No. 2****Facility:** Jackson B #33 Off Pad**County:** Eddy**Description:**

View of excavation.





# **ATTACHMENT C: CONFIRMATION SAMPLING NOTIFICATIONS**

---



**Becky Haskell**

---

**From:** Amber Griffin <Amber\_Griffin@eogresources.com>  
**Sent:** Friday, December 16, 2022 10:49 AM  
**To:** Nicholas Hart; Becky Haskell  
**Subject:** FW: [EXTERNAL] Jackson B 33 Off Pad (nAPP2233957598) Sampling Notification

CAUTION: This email originated from outside your organization. Exercise caution when opening attachments or clicking links, especially from unknown senders.

Thank you,  
Amber Griffin

---

**From:** Tina Huerta <Tina\_Huerta@eogresources.com>  
**Sent:** Friday, December 16, 2022 9:45 AM  
**To:** Artesia S&E Spill Remediation <Artesia\_S&E\_Spill\_Remediation@eogresources.com>  
**Cc:** Artesia Regulatory <Artesia\_Regulatory@eogresources.com>  
**Subject:** FW: [EXTERNAL] Jackson B 33 Off Pad (nAPP2233957598) Sampling Notification

FYI

---

**From:** Enviro, OCD, EMNRD <[OCD.Enviro@emnrd.nm.gov](mailto:OCD.Enviro@emnrd.nm.gov)>  
**Sent:** Friday, December 16, 2022 8:27 AM  
**To:** Tina Huerta <[Tina\\_Huerta@eogresources.com](mailto:Tina_Huerta@eogresources.com)>  
**Cc:** Bratcher, Michael, EMNRD <[mike.bratcher@emnrd.nm.gov](mailto:mike.bratcher@emnrd.nm.gov)>; Hamlet, Robert, EMNRD <[Robert.Hamlet@emnrd.nm.gov](mailto:Robert.Hamlet@emnrd.nm.gov)>  
**Subject:** RE: [EXTERNAL] Jackson B 33 Off Pad (nAPP2233957598) Sampling Notification

**CAUTION:** This email originated from outside of the organization. Do not click links or open attachments unless you recognize the sender and know the content is safe.

Tina,  
Thank you for the notification. Please include a copy of this and all notifications in the remedial and/or closure reports to ensure the notifications are documented in the project file.

**Jocelyn Harimon** • Environmental Specialist  
Environmental Bureau  
EMNRD - Oil Conservation Division  
1220 South St. Francis Drive | Santa Fe, NM 87505  
(505)469-2821 | [Jocelyn.Harimon@emnrd.nm.gov](mailto:Jocelyn.Harimon@emnrd.nm.gov)  
[http:// www.emnrd.nm.gov](http://www.emnrd.nm.gov)



**From:** Tina Huerta <[Tina.Huerta@eogresources.com](mailto:Tina.Huerta@eogresources.com)>  
**Sent:** Friday, December 16, 2022 6:55 AM  
**To:** Enviro, OCD, EMNRD <[OCD.Enviro@emnrd.nm.gov](mailto:OCD.Enviro@emnrd.nm.gov)>; [blm\\_nm\\_cfo\\_spill@blm.gov](mailto:blm_nm_cfo_spill@blm.gov)  
**Cc:** Artesia S&E Spill Remediation <[Artesia\\_S&E\\_Spill\\_Remediation@eogresources.com](mailto:Artesia_S&E_Spill_Remediation@eogresources.com)>; Artesia Regulatory <[Artesia\\_Regulatory@eogresources.com](mailto:Artesia_Regulatory@eogresources.com)>  
**Subject:** [EXTERNAL] Jackson B 33 Off Pad (nAPP2233957598) Sampling Notification

CAUTION: This email originated outside of our organization. Exercise caution prior to clicking on links or opening attachments.

Good Morning,

EOG Resources, Inc. respectfully submits notification (2) business days prior to conducting sampling on the following location.

Jackson B 33 Off Pad  
F-1-17S-30E  
Eddy County, NM  
nAPP2233957598

Sampling will begin at 10:00 a.m. on Tuesday, December 20, 2022 and continue through Wednesday, December 21, 2022.

Thank you,

*Tina Huerta*  
*Regulatory Specialist*  
*Direct: 575.748.4168*  
*Cell: 575.703.3121*  
*Email: [tina.huerta@eogresources.com](mailto:tina.huerta@eogresources.com)*



## Becky Haskell

---

**From:** Amber Griffin <Amber\_Griffin@eogresources.com>  
**Sent:** Tuesday, December 27, 2022 10:30 AM  
**To:** Becky Haskell  
**Subject:** FW: [EXTERNAL] Jackson B 33 Off Pad (nAPP2233957598) Sampling Notification

CAUTION: This email originated from outside your organization. Exercise caution when opening attachments or clicking links, especially from unknown senders.

Thank you,  
Amber Griffin

---

**From:** Tina Huerta <Tina\_Huerta@eogresources.com>  
**Sent:** Thursday, December 22, 2022 8:49 AM  
**To:** Artesia S&E Spill Remediation <Artesia\_S&E\_Spill\_Remediation@eogresources.com>  
**Cc:** Artesia Regulatory <Artesia\_Regulatory@eogresources.com>  
**Subject:** FW: [EXTERNAL] Jackson B 33 Off Pad (nAPP2233957598) Sampling Notification

FYI

---

**From:** Enviro, OCD, EMNRD <[OCD.Enviro@emnrd.nm.gov](mailto:OCD.Enviro@emnrd.nm.gov)>  
**Sent:** Thursday, December 22, 2022 8:47 AM  
**To:** Tina Huerta <[Tina\\_Huerta@eogresources.com](mailto:Tina_Huerta@eogresources.com)>  
**Cc:** Bratcher, Michael, EMNRD <[mike.bratcher@emnrd.nm.gov](mailto:mike.bratcher@emnrd.nm.gov)>; Hamlet, Robert, EMNRD <[Robert.Hamlet@emnrd.nm.gov](mailto:Robert.Hamlet@emnrd.nm.gov)>  
**Subject:** RE: [EXTERNAL] Jackson B 33 Off Pad (nAPP2233957598) Sampling Notification

**CAUTION:** This email originated from outside of the organization. Do not click links or open attachments unless you recognize the sender and know the content is safe.

Good morning Tina,

Thank you for the notification. Please include a copy of this and all notifications in the remedial and/or closure reports to ensure the notifications are documented in the project file.

Have a happy holiday,  
Jocelyn Harimon

**Jocelyn Harimon** • Environmental Specialist  
Environmental Bureau  
EMNRD - Oil Conservation Division  
1220 South St. Francis Drive | Santa Fe, NM 87505  
(505)469-2821 | [Jocelyn.Harimon@emnrd.nm.gov](mailto:Jocelyn.Harimon@emnrd.nm.gov)  
[http:// www.emnrd.nm.gov](http://www.emnrd.nm.gov)



**From:** Tina Huerta <[Tina\\_Huerta@eogresources.com](mailto:Tina_Huerta@eogresources.com)>  
**Sent:** Thursday, December 22, 2022 5:20 AM  
**To:** Enviro, OCD, EMNRD <[OCD.Enviro@emnrd.nm.gov](mailto:OCD.Enviro@emnrd.nm.gov)>; [blm\\_nm\\_cfo\\_spill@blm.gov](mailto:blm_nm_cfo_spill@blm.gov)  
**Cc:** Artesia S&E Spill Remediation <[Artesia\\_S&E\\_Spill\\_Remediation@eogresources.com](mailto:Artesia_S&E_Spill_Remediation@eogresources.com)>; Artesia Regulatory <[Artesia\\_Regulatory@eogresources.com](mailto:Artesia_Regulatory@eogresources.com)>  
**Subject:** [EXTERNAL] Jackson B 33 Off Pad (nAPP2233957598) Sampling Notification

CAUTION: This email originated outside of our organization. Exercise caution prior to clicking on links or opening attachments.

Good Morning,

EOG Resources, Inc. respectfully submits notification (2) business days prior to conducting sampling on the following location.

Jackson B 33 Off Pad  
F-1-17S-30E  
Eddy County, NM  
nAPP2233957598

Sampling will begin at 9:00 a.m. on Tuesday, December 27, 2022 and will continue through Wednesday, December 28, 2022.

Thank you,

*Tina Huerta*  
*Regulatory Specialist*  
*Direct: 575.748.4168*  
*Cell: 575.703.3121*  
*Email: [tina\\_huerta@eogresources.com](mailto:tina_huerta@eogresources.com)*





# ATTACHMENT D: LABORATORY ANALYTICAL REPORTS AND CHAIN-OF-CUSTODY DOCUMENTATION

---

Date Reported: 11/17/22

Becky Haskell  
911 Regional Park Dr.  
Houston, TX 77060



Project Name: Jackson B #33 Off Pad  
Workorder: E211072  
Date Received: 11/11/2022 10:45:00AM

Becky Haskell,

Thank you for choosing Envirotech, Inc. as your analytical testing laboratory for the sample(s) received on, 11/11/2022 10:45:00AM, under the Project Name: Jackson B #33 Off Pad.

The analytical test results summarized in this report with the Project Name: Jackson B #33 Off Pad apply to the individual samples collected, identified and submitted bearing the project name on the enclosed chain-of-custody. Subcontracted sample analyses not conducted by Envirotech, Inc., are attached in full as issued by the subcontract laboratory.

Please review the Chain-of-Custody (COC) and Sample Receipt Checklist (SRC) for any issues regarding sample receipt temperature, containers, preservation etc. To best understand your test results, review the entire report summarizing your sample data and the associated quality control batch data.

All reported data in this analytical report were analyzed according to the referenced method(s) and are in compliance with the latest NELAC/TNI standards, unless otherwise noted. Samples or analytical quality control parameters not meeting specific QC criteria are qualified with a data flag. Data flag definitions are located in the Notes and Definitions section of this analytical report.

If you have any questions concerning this report, please feel free to contact Envirotech, Inc.

Respectfully,

**Walter Hinchman**  
Laboratory Director  
Office: 505-632-1881  
Cell: 775-287-1762  
[whinchman@envirotech-inc.com](mailto:whinchman@envirotech-inc.com)

**Raina Schwanz**  
Laboratory Administrator  
Office: 505-632-1881  
[rainaschwanz@envirotech-inc.com](mailto:rainaschwanz@envirotech-inc.com)

**Alexa Michaels**  
Sample Custody Officer  
Office: 505-632-1881  
[labadmin@envirotech-inc.com](mailto:labadmin@envirotech-inc.com)

Field Offices:

**Southern New Mexico Area**  
**Lynn Jarboe**  
Technical Representative/Client Services  
Office: 505-421-LABS(5227)  
Cell: 505-320-4759  
[ljjarboe@envirotech-inc.com](mailto:ljjarboe@envirotech-inc.com)

**West Texas Midland/Odessa Area**  
**Rayny Hagan**  
Technical Representative  
Office: 505-421-LABS(5227)

Envirotech Web Address: [www.envirotech-inc.com](http://www.envirotech-inc.com)

## Table of Contents

Title Page	1
Cover Page	2
Table of Contents	3
Sample Summary	4
Sample Data	5
BH-1 (4')	5
BH-1 (5')	6
SW-1	7
SW-2	8
SW-3	9
SW-4	10
STKP-1	11
H-1 (0 - 1')	12
H-2 (0 - 1')	13
H-3 (0 - 1')	14
H-4 (0 - 1')	15
QC Summary Data	16
QC - Volatile Organic Compounds by EPA 8260B	16
QC - Nonhalogenated Organics by EPA 8015D - GRO	17
QC - Nonhalogenated Organics by EPA 8015D - DRO/ORO	18
QC - Anions by EPA 300.0/9056A	19
Definitions and Notes	20
Chain of Custody etc.	21

## Sample Summary

NTG-New Tech Global Environmental 911 Regional Park Dr. Houston TX, 77060	Project Name: Jackson B #33 Off Pad Project Number: 19034-0001 Project Manager: Becky Haskell	Reported: 11/17/22 16:39
---	---	-----------------------------

Client Sample ID	Lab Sample ID	Matrix	Sampled	Received	Container
BH-1 (4')	E211072-01A	Soil	11/09/22	11/11/22	Glass Jar, 4 oz.
BH-1 (5')	E211072-02A	Soil	11/09/22	11/11/22	Glass Jar, 4 oz.
SW-1	E211072-03A	Soil	11/09/22	11/11/22	Glass Jar, 4 oz.
SW-2	E211072-04A	Soil	11/09/22	11/11/22	Glass Jar, 4 oz.
SW-3	E211072-05A	Soil	11/09/22	11/11/22	Glass Jar, 4 oz.
SW-4	E211072-06A	Soil	11/09/22	11/11/22	Glass Jar, 4 oz.
STKP-1	E211072-07A	Soil	11/09/22	11/11/22	Glass Jar, 4 oz.
H-1 (0 - 1')	E211072-08A	Soil	11/09/22	11/11/22	Glass Jar, 4 oz.
H-2 (0 - 1')	E211072-09A	Soil	11/09/22	11/11/22	Glass Jar, 4 oz.
H-3 (0 - 1')	E211072-10A	Soil	11/09/22	11/11/22	Glass Jar, 4 oz.
H-4 (0 - 1')	E211072-11A	Soil	11/09/22	11/11/22	Glass Jar, 4 oz.



## Sample Data

NTG-New Tech Global Environmental  
911 Regional Park Dr.  
Houston TX, 77060

Project Name: Jackson B #33 Off Pad  
Project Number: 19034-0001  
Project Manager: Becky Haskell

**Reported:**  
11/17/2022 4:39:48PM

## BH-1 (4')

## E211072-01

Analyte	Result	Reporting Limit	Dilution	Prepared	Analyzed	Notes
<b>Volatile Organic Compounds by EPA 8260B</b>						
	mg/kg	mg/kg		Analyst: RKS		Batch: 2247006
Benzene	ND	0.0250	1	11/15/22	11/15/22	
Ethylbenzene	ND	0.0250	1	11/15/22	11/15/22	
Toluene	ND	0.0250	1	11/15/22	11/15/22	
o-Xylene	ND	0.0250	1	11/15/22	11/15/22	
p,m-Xylene	ND	0.0500	1	11/15/22	11/15/22	
Total Xylenes	ND	0.0250	1	11/15/22	11/15/22	
Surrogate: Bromofluorobenzene	99.7 %	70-130		11/15/22	11/15/22	
Surrogate: 1,2-Dichloroethane-d4	95.4 %	70-130		11/15/22	11/15/22	
Surrogate: Toluene-d8	99.5 %	70-130		11/15/22	11/15/22	
<b>Nonhalogenated Organics by EPA 8015D - GRO</b>						
	mg/kg	mg/kg		Analyst: RKS		Batch: 2247006
Gasoline Range Organics (C6-C10)	ND	20.0	1	11/15/22	11/15/22	
Surrogate: Bromofluorobenzene	99.7 %	70-130		11/15/22	11/15/22	
Surrogate: 1,2-Dichloroethane-d4	95.4 %	70-130		11/15/22	11/15/22	
Surrogate: Toluene-d8	99.5 %	70-130		11/15/22	11/15/22	
<b>Nonhalogenated Organics by EPA 8015D - DRO/ORO</b>						
	mg/kg	mg/kg		Analyst: JL		Batch: 2247022
Diesel Range Organics (C10-C28)	3500	2500	100	11/14/22	11/17/22	
Oil Range Organics (C28-C36)	ND	5000	100	11/14/22	11/17/22	
Surrogate: n-Nonane	%	50-200		11/14/22	11/17/22	S6
<b>Anions by EPA 300.0/9056A</b>						
	mg/kg	mg/kg		Analyst: RAS		Batch: 2246094
Chloride	227	20.0	1	11/11/22	11/16/22	



## Sample Data

NTG-New Tech Global Environmental  
911 Regional Park Dr.  
Houston TX, 77060

Project Name: Jackson B #33 Off Pad  
Project Number: 19034-0001  
Project Manager: Becky Haskell

**Reported:**  
11/17/2022 4:39:48PM

## BH-1 (5')

## E211072-02

Analyte	Result	Reporting Limit	Dilution	Prepared	Analyzed	Notes
<b>Volatile Organic Compounds by EPA 8260B</b>						
	mg/kg	mg/kg		Analyst: RKS		Batch: 2247006
Benzene	ND	0.0250	1	11/15/22	11/15/22	
Ethylbenzene	ND	0.0250	1	11/15/22	11/15/22	
Toluene	ND	0.0250	1	11/15/22	11/15/22	
o-Xylene	ND	0.0250	1	11/15/22	11/15/22	
p,m-Xylene	ND	0.0500	1	11/15/22	11/15/22	
Total Xylenes	ND	0.0250	1	11/15/22	11/15/22	
Surrogate: Bromofluorobenzene	97.8 %	70-130		11/15/22	11/15/22	
Surrogate: 1,2-Dichloroethane-d4	96.6 %	70-130		11/15/22	11/15/22	
Surrogate: Toluene-d8	98.1 %	70-130		11/15/22	11/15/22	
<b>Nonhalogenated Organics by EPA 8015D - GRO</b>						
	mg/kg	mg/kg		Analyst: RKS		Batch: 2247006
Gasoline Range Organics (C6-C10)	ND	20.0	1	11/15/22	11/15/22	
Surrogate: Bromofluorobenzene	97.8 %	70-130		11/15/22	11/15/22	
Surrogate: 1,2-Dichloroethane-d4	96.6 %	70-130		11/15/22	11/15/22	
Surrogate: Toluene-d8	98.1 %	70-130		11/15/22	11/15/22	
<b>Nonhalogenated Organics by EPA 8015D - DRO/ORO</b>						
	mg/kg	mg/kg		Analyst: JL		Batch: 2247022
Diesel Range Organics (C10-C28)	43.8	25.0	1	11/14/22	11/17/22	
Oil Range Organics (C28-C36)	ND	50.0	1	11/14/22	11/17/22	
Surrogate: n-Nonane	113 %	50-200		11/14/22	11/17/22	
<b>Anions by EPA 300.0/9056A</b>						
	mg/kg	mg/kg		Analyst: RAS		Batch: 2246094
Chloride	275	20.0	1	11/11/22	11/16/22	



## Sample Data

NTG-New Tech Global Environmental  
911 Regional Park Dr.  
Houston TX, 77060

Project Name: Jackson B #33 Off Pad  
Project Number: 19034-0001  
Project Manager: Becky Haskell

**Reported:**  
11/17/2022 4:39:48PM

## SW-1

## E211072-03

Analyte	Result	Reporting Limit	Dilution	Prepared	Analyzed	Notes
<b>Volatile Organic Compounds by EPA 8260B</b>						
	mg/kg	mg/kg		Analyst: RKS		Batch: 2247006
Benzene	ND	0.0250	1	11/15/22	11/15/22	
Ethylbenzene	ND	0.0250	1	11/15/22	11/15/22	
Toluene	ND	0.0250	1	11/15/22	11/15/22	
o-Xylene	ND	0.0250	1	11/15/22	11/15/22	
p,m-Xylene	ND	0.0500	1	11/15/22	11/15/22	
Total Xylenes	ND	0.0250	1	11/15/22	11/15/22	
Surrogate: Bromofluorobenzene	98.6 %	70-130		11/15/22	11/15/22	
Surrogate: 1,2-Dichloroethane-d4	94.7 %	70-130		11/15/22	11/15/22	
Surrogate: Toluene-d8	99.4 %	70-130		11/15/22	11/15/22	
<b>Nonhalogenated Organics by EPA 8015D - GRO</b>						
	mg/kg	mg/kg		Analyst: RKS		Batch: 2247006
Gasoline Range Organics (C6-C10)	ND	20.0	1	11/15/22	11/15/22	
Surrogate: Bromofluorobenzene	98.6 %	70-130		11/15/22	11/15/22	
Surrogate: 1,2-Dichloroethane-d4	94.7 %	70-130		11/15/22	11/15/22	
Surrogate: Toluene-d8	99.4 %	70-130		11/15/22	11/15/22	
<b>Nonhalogenated Organics by EPA 8015D - DRO/ORO</b>						
	mg/kg	mg/kg		Analyst: JL		Batch: 2247022
Diesel Range Organics (C10-C28)	1120	250	10	11/14/22	11/17/22	
Oil Range Organics (C28-C36)	502	500	10	11/14/22	11/17/22	
Surrogate: n-Nonane	134 %	50-200		11/14/22	11/17/22	
<b>Anions by EPA 300.0/9056A</b>						
	mg/kg	mg/kg		Analyst: RAS		Batch: 2246094
Chloride	51.9	20.0	1	11/11/22	11/16/22	



## Sample Data

NTG-New Tech Global Environmental  
911 Regional Park Dr.  
Houston TX, 77060

Project Name: Jackson B #33 Off Pad  
Project Number: 19034-0001  
Project Manager: Becky Haskell

**Reported:**  
11/17/2022 4:39:48PM

## SW-2

## E211072-04

Analyte	Result	Reporting Limit	Dilution	Prepared	Analyzed	Notes
<b>Volatile Organic Compounds by EPA 8260B</b>						
	mg/kg	mg/kg		Analyst: RKS		Batch: 2247006
Benzene	ND	0.0250	1	11/15/22	11/15/22	
Ethylbenzene	ND	0.0250	1	11/15/22	11/15/22	
Toluene	ND	0.0250	1	11/15/22	11/15/22	
o-Xylene	ND	0.0250	1	11/15/22	11/15/22	
p,m-Xylene	ND	0.0500	1	11/15/22	11/15/22	
Total Xylenes	ND	0.0250	1	11/15/22	11/15/22	
Surrogate: Bromofluorobenzene	97.5 %	70-130		11/15/22	11/15/22	
Surrogate: 1,2-Dichloroethane-d4	100 %	70-130		11/15/22	11/15/22	
Surrogate: Toluene-d8	99.4 %	70-130		11/15/22	11/15/22	
<b>Nonhalogenated Organics by EPA 8015D - GRO</b>						
	mg/kg	mg/kg		Analyst: RKS		Batch: 2247006
Gasoline Range Organics (C6-C10)	ND	20.0	1	11/15/22	11/15/22	
Surrogate: Bromofluorobenzene	97.5 %	70-130		11/15/22	11/15/22	
Surrogate: 1,2-Dichloroethane-d4	100 %	70-130		11/15/22	11/15/22	
Surrogate: Toluene-d8	99.4 %	70-130		11/15/22	11/15/22	
<b>Nonhalogenated Organics by EPA 8015D - DRO/ORO</b>						
	mg/kg	mg/kg		Analyst: JL		Batch: 2247022
Diesel Range Organics (C10-C28)	1430	250	10	11/14/22	11/17/22	
Oil Range Organics (C28-C36)	920	500	10	11/14/22	11/17/22	
Surrogate: n-Nonane	140 %	50-200		11/14/22	11/17/22	
<b>Anions by EPA 300.0/9056A</b>						
	mg/kg	mg/kg		Analyst: RAS		Batch: 2246094
Chloride	154	20.0	1	11/11/22	11/16/22	





## Sample Data

NTG-New Tech Global Environmental  
911 Regional Park Dr.  
Houston TX, 77060

Project Name: Jackson B #33 Off Pad  
Project Number: 19034-0001  
Project Manager: Becky Haskell

**Reported:**  
11/17/2022 4:39:48PM

## SW-3

## E211072-05

Analyte	Result	Reporting Limit	Dilution	Prepared	Analyzed	Notes
<b>Volatile Organic Compounds by EPA 8260B</b>						
	mg/kg	mg/kg		Analyst: RKS		Batch: 2247006
Benzene	ND	0.0250	1	11/15/22	11/15/22	
Ethylbenzene	ND	0.0250	1	11/15/22	11/15/22	
Toluene	ND	0.0250	1	11/15/22	11/15/22	
o-Xylene	ND	0.0250	1	11/15/22	11/15/22	
p,m-Xylene	ND	0.0500	1	11/15/22	11/15/22	
Total Xylenes	ND	0.0250	1	11/15/22	11/15/22	
Surrogate: Bromofluorobenzene	98.0 %	70-130		11/15/22	11/15/22	
Surrogate: 1,2-Dichloroethane-d4	94.0 %	70-130		11/15/22	11/15/22	
Surrogate: Toluene-d8	101 %	70-130		11/15/22	11/15/22	
<b>Nonhalogenated Organics by EPA 8015D - GRO</b>						
	mg/kg	mg/kg		Analyst: RKS		Batch: 2247006
Gasoline Range Organics (C6-C10)	ND	20.0	1	11/15/22	11/15/22	
Surrogate: Bromofluorobenzene	98.0 %	70-130		11/15/22	11/15/22	
Surrogate: 1,2-Dichloroethane-d4	94.0 %	70-130		11/15/22	11/15/22	
Surrogate: Toluene-d8	101 %	70-130		11/15/22	11/15/22	
<b>Nonhalogenated Organics by EPA 8015D - DRO/ORO</b>						
	mg/kg	mg/kg		Analyst: JL		Batch: 2247022
Diesel Range Organics (C10-C28)	7000	2500	100	11/14/22	11/17/22	
Oil Range Organics (C28-C36)	ND	5000	100	11/14/22	11/17/22	
Surrogate: n-Nonane		%	50-200	11/14/22	11/17/22	S6
<b>Anions by EPA 300.0/9056A</b>						
	mg/kg	mg/kg		Analyst: RAS		Batch: 2246094
Chloride	383	20.0	1	11/11/22	11/16/22	



## Sample Data

NTG-New Tech Global Environmental  
911 Regional Park Dr.  
Houston TX, 77060

Project Name: Jackson B #33 Off Pad  
Project Number: 19034-0001  
Project Manager: Becky Haskell

**Reported:**  
11/17/2022 4:39:48PM

## SW-4

## E211072-06

Analyte	Result	Reporting Limit	Dilution	Prepared	Analyzed	Notes
<b>Volatile Organic Compounds by EPA 8260B</b>						
	mg/kg	mg/kg		Analyst: RKS		Batch: 2247006
Benzene	ND	0.0250	1	11/15/22	11/15/22	
Ethylbenzene	ND	0.0250	1	11/15/22	11/15/22	
Toluene	ND	0.0250	1	11/15/22	11/15/22	
o-Xylene	ND	0.0250	1	11/15/22	11/15/22	
p,m-Xylene	ND	0.0500	1	11/15/22	11/15/22	
Total Xylenes	ND	0.0250	1	11/15/22	11/15/22	
Surrogate: Bromofluorobenzene	98.5 %	70-130		11/15/22	11/15/22	
Surrogate: 1,2-Dichloroethane-d4	93.2 %	70-130		11/15/22	11/15/22	
Surrogate: Toluene-d8	99.9 %	70-130		11/15/22	11/15/22	
<b>Nonhalogenated Organics by EPA 8015D - GRO</b>						
	mg/kg	mg/kg		Analyst: RKS		Batch: 2247006
Gasoline Range Organics (C6-C10)	ND	20.0	1	11/15/22	11/15/22	
Surrogate: Bromofluorobenzene	98.5 %	70-130		11/15/22	11/15/22	
Surrogate: 1,2-Dichloroethane-d4	93.2 %	70-130		11/15/22	11/15/22	
Surrogate: Toluene-d8	99.9 %	70-130		11/15/22	11/15/22	
<b>Nonhalogenated Organics by EPA 8015D - DRO/ORO</b>						
	mg/kg	mg/kg		Analyst: JL		Batch: 2247022
Diesel Range Organics (C10-C28)	9590	2500	100	11/14/22	11/17/22	
Oil Range Organics (C28-C36)	ND	5000	100	11/14/22	11/17/22	
Surrogate: n-Nonane		% 50-200		11/14/22	11/17/22	S6
<b>Anions by EPA 300.0/9056A</b>						
	mg/kg	mg/kg		Analyst: RAS		Batch: 2246094
Chloride	2580	20.0	1	11/11/22	11/16/22	



## Sample Data

NTG-New Tech Global Environmental  
911 Regional Park Dr.  
Houston TX, 77060

Project Name: Jackson B #33 Off Pad  
Project Number: 19034-0001  
Project Manager: Becky Haskell

**Reported:**  
11/17/2022 4:39:48PM

## STKP-1

## E211072-07

Analyte	Result	Reporting Limit	Dilution	Prepared	Analyzed	Notes
<b>Volatile Organic Compounds by EPA 8260B</b>						
	mg/kg	mg/kg		Analyst: RKS		Batch: 2247006
Benzene	ND	0.0250	1	11/15/22	11/15/22	
Ethylbenzene	ND	0.0250	1	11/15/22	11/15/22	
Toluene	ND	0.0250	1	11/15/22	11/15/22	
o-Xylene	ND	0.0250	1	11/15/22	11/15/22	
p,m-Xylene	ND	0.0500	1	11/15/22	11/15/22	
Total Xylenes	ND	0.0250	1	11/15/22	11/15/22	
Surrogate: Bromofluorobenzene	99.5 %	70-130		11/15/22	11/15/22	
Surrogate: 1,2-Dichloroethane-d4	95.2 %	70-130		11/15/22	11/15/22	
Surrogate: Toluene-d8	100 %	70-130		11/15/22	11/15/22	
<b>Nonhalogenated Organics by EPA 8015D - GRO</b>						
	mg/kg	mg/kg		Analyst: RKS		Batch: 2247006
Gasoline Range Organics (C6-C10)	ND	20.0	1	11/15/22	11/15/22	
Surrogate: Bromofluorobenzene	99.5 %	70-130		11/15/22	11/15/22	
Surrogate: 1,2-Dichloroethane-d4	95.2 %	70-130		11/15/22	11/15/22	
Surrogate: Toluene-d8	100 %	70-130		11/15/22	11/15/22	
<b>Nonhalogenated Organics by EPA 8015D - DRO/ORO</b>						
	mg/kg	mg/kg		Analyst: JL		Batch: 2247022
Diesel Range Organics (C10-C28)	5070	2500	100	11/14/22	11/17/22	
Oil Range Organics (C28-C36)	ND	5000	100	11/14/22	11/17/22	
Surrogate: n-Nonane		%	50-200	11/14/22	11/17/22	S6
<b>Anions by EPA 300.0/9056A</b>						
	mg/kg	mg/kg		Analyst: RAS		Batch: 2246094
Chloride	236	20.0	1	11/11/22	11/16/22	



## Sample Data

NTG-New Tech Global Environmental  
911 Regional Park Dr.  
Houston TX, 77060

Project Name: Jackson B #33 Off Pad  
Project Number: 19034-0001  
Project Manager: Becky Haskell

**Reported:**  
11/17/2022 4:39:48PM

## H-1 (0 - 1')

## E211072-08

Analyte	Result	Reporting Limit	Dilution	Prepared	Analyzed	Notes
<b>Volatile Organic Compounds by EPA 8260B</b>						
	mg/kg	mg/kg		Analyst: RKS		Batch: 2247006
Benzene	ND	0.0250	1	11/15/22	11/15/22	
Ethylbenzene	ND	0.0250	1	11/15/22	11/15/22	
Toluene	ND	0.0250	1	11/15/22	11/15/22	
o-Xylene	ND	0.0250	1	11/15/22	11/15/22	
p,m-Xylene	ND	0.0500	1	11/15/22	11/15/22	
Total Xylenes	ND	0.0250	1	11/15/22	11/15/22	
Surrogate: Bromofluorobenzene	98.5 %	70-130		11/15/22	11/15/22	
Surrogate: 1,2-Dichloroethane-d4	96.2 %	70-130		11/15/22	11/15/22	
Surrogate: Toluene-d8	100 %	70-130		11/15/22	11/15/22	
<b>Nonhalogenated Organics by EPA 8015D - GRO</b>						
	mg/kg	mg/kg		Analyst: RKS		Batch: 2247006
Gasoline Range Organics (C6-C10)	ND	20.0	1	11/15/22	11/15/22	
Surrogate: Bromofluorobenzene	98.5 %	70-130		11/15/22	11/15/22	
Surrogate: 1,2-Dichloroethane-d4	96.2 %	70-130		11/15/22	11/15/22	
Surrogate: Toluene-d8	100 %	70-130		11/15/22	11/15/22	
<b>Nonhalogenated Organics by EPA 8015D - DRO/ORO</b>						
	mg/kg	mg/kg		Analyst: JL		Batch: 2247022
Diesel Range Organics (C10-C28)	ND	25.0	1	11/14/22	11/17/22	
Oil Range Organics (C28-C36)	ND	50.0	1	11/14/22	11/17/22	
Surrogate: n-Nonane	113 %	50-200		11/14/22	11/17/22	
<b>Anions by EPA 300.0/9056A</b>						
	mg/kg	mg/kg		Analyst: RAS		Batch: 2246094
Chloride	165	20.0	1	11/11/22	11/16/22	



## Sample Data

NTG-New Tech Global Environmental  
911 Regional Park Dr.  
Houston TX, 77060

Project Name: Jackson B #33 Off Pad  
Project Number: 19034-0001  
Project Manager: Becky Haskell

**Reported:**  
11/17/2022 4:39:48PM

## H-2 (0 - 1')

## E211072-09

Analyte	Result	Reporting Limit	Dilution	Prepared	Analyzed	Notes
<b>Volatile Organic Compounds by EPA 8260B</b>						
	mg/kg	mg/kg		Analyst: RKS		Batch: 2247006
Benzene	ND	0.0250	1	11/15/22	11/15/22	
Ethylbenzene	ND	0.0250	1	11/15/22	11/15/22	
Toluene	ND	0.0250	1	11/15/22	11/15/22	
o-Xylene	ND	0.0250	1	11/15/22	11/15/22	
p,m-Xylene	ND	0.0500	1	11/15/22	11/15/22	
Total Xylenes	ND	0.0250	1	11/15/22	11/15/22	
Surrogate: Bromofluorobenzene	96.9 %	70-130		11/15/22	11/15/22	
Surrogate: 1,2-Dichloroethane-d4	93.3 %	70-130		11/15/22	11/15/22	
Surrogate: Toluene-d8	101 %	70-130		11/15/22	11/15/22	
<b>Nonhalogenated Organics by EPA 8015D - GRO</b>						
	mg/kg	mg/kg		Analyst: RKS		Batch: 2247006
Gasoline Range Organics (C6-C10)	ND	20.0	1	11/15/22	11/15/22	
Surrogate: Bromofluorobenzene	96.9 %	70-130		11/15/22	11/15/22	
Surrogate: 1,2-Dichloroethane-d4	93.3 %	70-130		11/15/22	11/15/22	
Surrogate: Toluene-d8	101 %	70-130		11/15/22	11/15/22	
<b>Nonhalogenated Organics by EPA 8015D - DRO/ORO</b>						
	mg/kg	mg/kg		Analyst: JL		Batch: 2247022
Diesel Range Organics (C10-C28)	ND	25.0	1	11/14/22	11/17/22	
Oil Range Organics (C28-C36)	ND	50.0	1	11/14/22	11/17/22	
Surrogate: n-Nonane	116 %	50-200		11/14/22	11/17/22	
<b>Anions by EPA 300.0/9056A</b>						
	mg/kg	mg/kg		Analyst: RAS		Batch: 2246094
Chloride	ND	20.0	1	11/11/22	11/16/22	



## Sample Data

NTG-New Tech Global Environmental  
911 Regional Park Dr.  
Houston TX, 77060

Project Name: Jackson B #33 Off Pad  
Project Number: 19034-0001  
Project Manager: Becky Haskell

**Reported:**  
11/17/2022 4:39:48PM

## H-3 (0 - 1')

## E211072-10

Analyte	Result	Reporting Limit	Dilution	Prepared	Analyzed	Notes
<b>Volatile Organic Compounds by EPA 8260B</b>						
	mg/kg	mg/kg		Analyst: RKS		Batch: 2247006
Benzene	ND	0.0250	1	11/15/22	11/15/22	
Ethylbenzene	ND	0.0250	1	11/15/22	11/15/22	
Toluene	ND	0.0250	1	11/15/22	11/15/22	
o-Xylene	ND	0.0250	1	11/15/22	11/15/22	
p,m-Xylene	ND	0.0500	1	11/15/22	11/15/22	
Total Xylenes	ND	0.0250	1	11/15/22	11/15/22	
Surrogate: Bromofluorobenzene	97.2 %	70-130		11/15/22	11/15/22	
Surrogate: 1,2-Dichloroethane-d4	93.7 %	70-130		11/15/22	11/15/22	
Surrogate: Toluene-d8	99.7 %	70-130		11/15/22	11/15/22	
<b>Nonhalogenated Organics by EPA 8015D - GRO</b>						
	mg/kg	mg/kg		Analyst: RKS		Batch: 2247006
Gasoline Range Organics (C6-C10)	ND	20.0	1	11/15/22	11/15/22	
Surrogate: Bromofluorobenzene	97.2 %	70-130		11/15/22	11/15/22	
Surrogate: 1,2-Dichloroethane-d4	93.7 %	70-130		11/15/22	11/15/22	
Surrogate: Toluene-d8	99.7 %	70-130		11/15/22	11/15/22	
<b>Nonhalogenated Organics by EPA 8015D - DRO/ORO</b>						
	mg/kg	mg/kg		Analyst: JL		Batch: 2247022
Diesel Range Organics (C10-C28)	ND	25.0	1	11/14/22	11/17/22	
Oil Range Organics (C28-C36)	ND	50.0	1	11/14/22	11/17/22	
Surrogate: n-Nonane	111 %	50-200		11/14/22	11/17/22	
<b>Anions by EPA 300.0/9056A</b>						
	mg/kg	mg/kg		Analyst: RAS		Batch: 2246094
Chloride	ND	20.0	1	11/11/22	11/16/22	



## Sample Data

NTG-New Tech Global Environmental  
911 Regional Park Dr.  
Houston TX, 77060

Project Name: Jackson B #33 Off Pad  
Project Number: 19034-0001  
Project Manager: Becky Haskell

**Reported:**  
11/17/2022 4:39:48PM

## H-4 (0 - 1')

## E211072-11

Analyte	Result	Reporting Limit	Dilution	Prepared	Analyzed	Notes
<b>Volatile Organic Compounds by EPA 8260B</b>						
	mg/kg	mg/kg		Analyst: RKS		Batch: 2247006
Benzene	ND	0.0250	1	11/15/22	11/15/22	
Ethylbenzene	ND	0.0250	1	11/15/22	11/15/22	
Toluene	ND	0.0250	1	11/15/22	11/15/22	
o-Xylene	ND	0.0250	1	11/15/22	11/15/22	
p,m-Xylene	ND	0.0500	1	11/15/22	11/15/22	
Total Xylenes	ND	0.0250	1	11/15/22	11/15/22	
Surrogate: Bromofluorobenzene	97.2 %	70-130		11/15/22	11/15/22	
Surrogate: 1,2-Dichloroethane-d4	97.4 %	70-130		11/15/22	11/15/22	
Surrogate: Toluene-d8	100 %	70-130		11/15/22	11/15/22	
<b>Nonhalogenated Organics by EPA 8015D - GRO</b>						
	mg/kg	mg/kg		Analyst: RKS		Batch: 2247006
Gasoline Range Organics (C6-C10)	ND	20.0	1	11/15/22	11/15/22	
Surrogate: Bromofluorobenzene	97.2 %	70-130		11/15/22	11/15/22	
Surrogate: 1,2-Dichloroethane-d4	97.4 %	70-130		11/15/22	11/15/22	
Surrogate: Toluene-d8	100 %	70-130		11/15/22	11/15/22	
<b>Nonhalogenated Organics by EPA 8015D - DRO/ORO</b>						
	mg/kg	mg/kg		Analyst: JL		Batch: 2247022
Diesel Range Organics (C10-C28)	ND	25.0	1	11/14/22	11/17/22	
Oil Range Organics (C28-C36)	ND	50.0	1	11/14/22	11/17/22	
Surrogate: n-Nonane	116 %	50-200		11/14/22	11/17/22	
<b>Anions by EPA 300.0/9056A</b>						
	mg/kg	mg/kg		Analyst: RAS		Batch: 2246094
Chloride	ND	20.0	1	11/11/22	11/16/22	





## QC Summary Data

NTG-New Tech Global Environmental 911 Regional Park Dr. Houston TX, 77060	Project Name: Jackson B #33 Off Pad Project Number: 19034-0001 Project Manager: Becky Haskell	Reported: 11/17/2022 4:39:48PM
---	---	-----------------------------------

## Volatile Organic Compounds by EPA 8260B

Analyst: RKS

Analyte	Result mg/kg	Reporting Limit mg/kg	Spike Level mg/kg	Source Result mg/kg	Rec %	Rec Limits %	RPD %	RPD Limit %	Notes
---------	-----------------	-----------------------------	-------------------------	---------------------------	----------	--------------------	----------	-------------------	-------

## Blank (2247006-BLK1)

Prepared: 11/14/22 Analyzed: 11/15/22

Benzene	ND	0.0250							
Ethylbenzene	ND	0.0250							
Toluene	ND	0.0250							
o-Xylene	ND	0.0250							
p,m-Xylene	ND	0.0500							
Total Xylenes	ND	0.0250							
Surrogate: Bromofluorobenzene	0.503		0.500		101	70-130			
Surrogate: 1,2-Dichloroethane-d4	0.511		0.500		102	70-130			
Surrogate: Toluene-d8	0.489		0.500		97.8	70-130			

## LCS (2247006-BS1)

Prepared: 11/14/22 Analyzed: 11/15/22

Benzene	2.52	0.0250	2.50		101	70-130			
Ethylbenzene	2.55	0.0250	2.50		102	70-130			
Toluene	2.57	0.0250	2.50		103	70-130			
o-Xylene	2.71	0.0250	2.50		108	70-130			
p,m-Xylene	5.17	0.0500	5.00		103	70-130			
Total Xylenes	7.87	0.0250	7.50		105	70-130			
Surrogate: Bromofluorobenzene	0.514		0.500		103	70-130			
Surrogate: 1,2-Dichloroethane-d4	0.473		0.500		94.5	70-130			
Surrogate: Toluene-d8	0.490		0.500		98.0	70-130			

## Matrix Spike (2247006-MS1)

Source: E211072-03

Prepared: 11/14/22 Analyzed: 11/15/22

Benzene	2.31	0.0250	2.50	ND	92.4	48-131			
Ethylbenzene	2.36	0.0250	2.50	ND	94.5	45-135			
Toluene	2.38	0.0250	2.50	ND	95.2	48-130			
o-Xylene	2.50	0.0250	2.50	ND	99.9	43-135			
p,m-Xylene	4.78	0.0500	5.00	ND	95.6	43-135			
Total Xylenes	7.28	0.0250	7.50	ND	97.0	43-135			
Surrogate: Bromofluorobenzene	0.514		0.500		103	70-130			
Surrogate: 1,2-Dichloroethane-d4	0.488		0.500		97.6	70-130			
Surrogate: Toluene-d8	0.495		0.500		98.9	70-130			

## Matrix Spike Dup (2247006-MSD1)

Source: E211072-03

Prepared: 11/14/22 Analyzed: 11/15/22

Benzene	2.43	0.0250	2.50	ND	97.1	48-131	5.00	23	
Ethylbenzene	2.47	0.0250	2.50	ND	98.9	45-135	4.53	27	
Toluene	2.48	0.0250	2.50	ND	99.3	48-130	4.20	24	
o-Xylene	2.61	0.0250	2.50	ND	105	43-135	4.48	27	
p,m-Xylene	5.01	0.0500	5.00	ND	100	43-135	4.71	27	
Total Xylenes	7.62	0.0250	7.50	ND	102	43-135	4.63	27	
Surrogate: Bromofluorobenzene	0.504		0.500		101	70-130			
Surrogate: 1,2-Dichloroethane-d4	0.493		0.500		98.5	70-130			
Surrogate: Toluene-d8	0.497		0.500		99.3	70-130			



## QC Summary Data

NTG-New Tech Global Environmental 911 Regional Park Dr. Houston TX, 77060	Project Name: Jackson B #33 Off Pad Project Number: 19034-0001 Project Manager: Becky Haskell	Reported:  11/17/2022 4:39:48PM
---	---	---------------------------------------

## Nonhalogenated Organics by EPA 8015D - GRO

Analyst: RKS

Analyte	Result mg/kg	Reporting Limit mg/kg	Spike Level mg/kg	Source Result mg/kg	Rec %	Rec Limits %	RPD %	RPD Limit %	Notes
---------	-----------------	-----------------------------	-------------------------	---------------------------	----------	--------------------	----------	-------------------	-------

## Blank (2247006-BLK1)

Prepared: 11/14/22 Analyzed: 11/15/22

Gasoline Range Organics (C6-C10)	ND	20.0							
Surrogate: Bromofluorobenzene	0.503		0.500		101	70-130			
Surrogate: 1,2-Dichloroethane-d4	0.511		0.500		102	70-130			
Surrogate: Toluene-d8	0.489		0.500		97.8	70-130			

## LCS (2247006-BS2)

Prepared: 11/14/22 Analyzed: 11/15/22

Gasoline Range Organics (C6-C10)	52.1	20.0	50.0		104	70-130			
Surrogate: Bromofluorobenzene	0.502		0.500		100	70-130			
Surrogate: 1,2-Dichloroethane-d4	0.487		0.500		97.3	70-130			
Surrogate: Toluene-d8	0.495		0.500		98.9	70-130			

## Matrix Spike (2247006-MS2)

Source: E211072-03

Prepared: 11/14/22 Analyzed: 11/15/22

Gasoline Range Organics (C6-C10)	48.1	20.0	50.0	ND	96.2	70-130			
Surrogate: Bromofluorobenzene	0.496		0.500		99.1	70-130			
Surrogate: 1,2-Dichloroethane-d4	0.481		0.500		96.1	70-130			
Surrogate: Toluene-d8	0.502		0.500		100	70-130			

## Matrix Spike Dup (2247006-MSD2)

Source: E211072-03

Prepared: 11/14/22 Analyzed: 11/15/22

Gasoline Range Organics (C6-C10)	46.8	20.0	50.0	ND	93.6	70-130	2.70	20	
Surrogate: Bromofluorobenzene	0.495		0.500		99.0	70-130			
Surrogate: 1,2-Dichloroethane-d4	0.484		0.500		96.8	70-130			
Surrogate: Toluene-d8	0.491		0.500		98.1	70-130			



## QC Summary Data

NTG-New Tech Global Environmental 911 Regional Park Dr. Houston TX, 77060	Project Name: Jackson B #33 Off Pad Project Number: 19034-0001 Project Manager: Becky Haskell	Reported: 11/17/2022 4:39:48PM
---	---	-----------------------------------

## Nonhalogenated Organics by EPA 8015D - DRO/ORO

Analyst: JL

Analyte	Result mg/kg	Reporting Limit mg/kg	Spike Level mg/kg	Source Result mg/kg	Rec %	Rec Limits %	RPD %	RPD Limit %	Notes
---------	-----------------	-----------------------------	-------------------------	---------------------------	----------	--------------------	----------	-------------------	-------

## Blank (2247022-BLK1)

Prepared: 11/14/22 Analyzed: 11/17/22

Diesel Range Organics (C10-C28)	ND	25.0							
Oil Range Organics (C28-C36)	ND	50.0							
Surrogate: n-Nonane	62.3		50.0		125	50-200			

## LCS (2247022-BS1)

Prepared: 11/14/22 Analyzed: 11/17/22

Diesel Range Organics (C10-C28)	227	25.0	250		90.6	38-132			
Surrogate: n-Nonane	54.1		50.0		108	50-200			

## Matrix Spike (2247022-MS1)

Source: E211072-07

Prepared: 11/14/22 Analyzed: 11/17/22

Diesel Range Organics (C10-C28)	5010	2500	250	5070	NR	38-132			M4
Surrogate: n-Nonane	0.00		50.0			50-200			S6

## Matrix Spike Dup (2247022-MSD1)

Source: E211072-07

Prepared: 11/14/22 Analyzed: 11/17/22

Diesel Range Organics (C10-C28)	6000	2500	250	5070	371	38-132	18.0	20	M4
Surrogate: n-Nonane	0.00		50.0			50-200			S6



## QC Summary Data

NTG-New Tech Global Environmental 911 Regional Park Dr. Houston TX, 77060	Project Name: Jackson B #33 Off Pad Project Number: 19034-0001 Project Manager: Becky Haskell	<b>Reported:</b> 11/17/2022 4:39:48PM
---	---	--

## Anions by EPA 300.0/9056A

Analyst: RAS

Analyte	Result mg/kg	Reporting Limit mg/kg	Spike Level mg/kg	Source Result mg/kg	Rec %	Rec Limits %	RPD %	RPD Limit %	Notes
---------	-----------------	-----------------------------	-------------------------	---------------------------	----------	--------------------	----------	-------------------	-------

## Blank (2246094-BLK1)

Prepared: 11/11/22 Analyzed: 11/16/22

Chloride ND 20.0

## LCS (2246094-BS1)

Prepared: 11/11/22 Analyzed: 11/16/22

Chloride 248 20.0 250 99.4 90-110

## Matrix Spike (2246094-MS1)

Source: E211072-01

Prepared: 11/11/22 Analyzed: 11/16/22

Chloride 478 20.0 250 227 100 80-120

## Matrix Spike Dup (2246094-MSD1)

Source: E211072-01

Prepared: 11/11/22 Analyzed: 11/16/22

Chloride 439 20.0 250 227 84.6 80-120 8.44 20

## QC Summary Report Comment:

Calculations are based off of the raw (non-rounded) data. However, for reporting purposes all QC data is rounded to three significant figures. Therefore, hand calculated values may differ slightly.



## Definitions and Notes

NTG-New Tech Global Environmental 911 Regional Park Dr. Houston TX, 77060	Project Name: Jackson B #33 Off Pad Project Number: 19034-0001 Project Manager: Becky Haskell	<b>Reported:</b> 11/17/22 16:39
---	---	------------------------------------

M4	Matrix spike recovery value is suspect since the analyte concentration in the sample is disproportionate to the spike level. The associated LCS spike recovery was acceptable.
S6	Surrogate was diluted out due to high concentrations of target and/or non-target analytes and does not provide useful information. The associated LCS spike recovery was acceptable.
ND	Analyte NOT DETECTED at or above the reporting limit
NR	Not Reported
RPD	Relative Percent Difference
DNI	Did Not Ignite

Note (1): Methods marked with \*\* are non-accredited methods.

Note (2): Soil data is reported on an "as received" weight basis, unless reported otherwise.







## Chain of Custody

 Work Order No: E211072  
 Job # 19034-0001

 Page 1 of 2

Project Manager:	Becky Haskell	Bill to: (if different)	Chase Settle
Company Name:	NTG Environmental	Company Name:	EOG Resources
Address:	701 Tradewinds BLVD	Address:	104 S. 4th Street
City, State ZIP:	Midland, TX 79706	City, State ZIP:	Artesia, NM 88210
Phone:	432-766-1918	Email:	BHaskell@ntglobal.com

Work Order Comments	
Program: UST/PST	<input type="checkbox"/> PRP <input type="checkbox"/> Brownfields <input type="checkbox"/> RRC <input type="checkbox"/> Superfund <input type="checkbox"/>
State of Project:	
Reporting: Level II	<input type="checkbox"/> Level III <input type="checkbox"/> ST/UST <input type="checkbox"/> RRP <input type="checkbox"/> Level IV <input type="checkbox"/>
Deliverables: EDD	<input type="checkbox"/> ADAPT <input type="checkbox"/> Other:

Project Name:	Jackson B #33 Off Pad		Turn Around		ANALYSIS REQUEST										Preservative Codes			
Project Number:	226531		<input checked="" type="checkbox"/> Routine <input type="checkbox"/> Rush		Pres. Code											None: NO DI Water: H <sub>2</sub> O		
Project Location	Eddy Co, NM		Due Date:	Standard	Parameters	BTEX 8021B TPH 8015M (GRO + DRO + MRO) Chloride 300.0										Cool: Cool MeOH: Me		
Sampler's Name:	NH		TAT starts the day received by the lab, if received by 4:30pm													HCL: HC HNO <sub>3</sub> : HN		
PO #:																H <sub>2</sub> SO <sub>4</sub> : H <sub>2</sub> NaOH: Na		
SAMPLE RECEIPT		Temp Blank:	Yes No	Wet Ice:												Yes No	H <sub>3</sub> PO <sub>4</sub> : HP	
Received Intact:	Yes No	Thermometer ID:	4													NaHSO <sub>4</sub> : NABIS		
Cooler Custody Seals:	Yes No	N/A	Correction Factor:		Na <sub>2</sub> S <sub>2</sub> O <sub>3</sub> : NaSO <sub>3</sub>													
Sample Custody Seals:	Yes No	N/A	Temperature Reading:		Zn Acetate+NaOH: Zn													
Total Containers:		Corrected Temperature:			NaOH+Ascorbic Acid: SAPC													
Sample Identification	Date	Time	Soil	Water	Grab/Comp	# of Cont											Sample Comments	
BH-1 (4')	11/9/2022	-	X	-	G	1	X	X	X								1	
BH-1 (5')	11/9/2022	-	X	-	G	1	X	X	X								2	
SW-1	11/9/2022	-	X	-	G	1	X	X	X								3	
SW-2	11/9/2022	-	X	-	G	1	X	X	X								4	
SW-3	11/9/2022	-	X	-	G	1	X	X	X								5	
SW-4	11/9/2022	-	X	-	G	1	X	X	X								6	
STKP-1	11/9/2022	-	X	-	G	1	X	X	X								7	
H-1 (0-1')	11/9/2022	-	X	-	G	1	X	X	X								8	
H-2 (0-1')	11/9/2022	-	X	-	G	1	X	X	X								9	
H-3 (0-1')	11/9/2022	-	X	-	G	1	X	X	X								10	

Additoinal Comments: Email Results to bhaskell@ntglobal.com, chase\_settle@eogresources.com + Amber\_Griffin@eogresources.com

Notice: Signature of this document and relinquishment of samples constitutes a valid purchase order from client company to Xenco, its affiliates and subcontractors. It assigns standard terms and conditions of service. Xenco will be liable only for the cost of samples and shall not assume any responsibility for any losses or expenses incurred by the client if such losses are due to circumstances beyond the control of Xenco. A minimum charge of \$85.00 will be applied to each project and a charge of \$5 for each sample submitted to Xenco, but not analyzed. These terms will be enforced unless previously negotiated.

Relinquished by: (Signature)	Received by: (Signature)	Date/Time	Relinquished by: (Signature)	Received by: (Signature)	Date/Time
Nick Hart	Becky Haskell	11/10/22 / 10:30	Becky Haskell	Chase Settle	11/10/22
		11/10/22			11/11/22 10:45



Work Order No: E211072  
Job # 19034-0001

Page 2 of 2





Project Manager:	Becky Haskell	Bill to: (if different)	Chase Settle
Company Name:	NTG Environmental	Company Name:	EOG Resources
Address:	701 Tradewinds BLVD	Address:	104 S. 4th Street
City, State ZIP:	Midland, TX 79706	City, State ZIP:	Artesia, NM 88210
Phone:	432-766-1918	Email:	<a href="mailto:BHaskell@ntgglobal.com">BHaskell@ntgglobal.com</a>

Work Order Comments					
<b>Program:</b> UST/PST <input type="checkbox"/> PRP <input type="checkbox"/> Brownfields <input type="checkbox"/> RC <input type="checkbox"/> Superfund <input type="checkbox"/>					
<b>State of Project:</b>					
<b>Reporting:</b> Level II <input type="checkbox"/> Level III <input type="checkbox"/> PST/UST <input type="checkbox"/> RRP <input type="checkbox"/> Level IV <input type="checkbox"/>					
<b>Deliverables:</b> EDD <input type="checkbox"/> ADaPT <input type="checkbox"/> Other:					

[illegible]

Additoinal Comments:
----------------------

Notice: Signature of this document and relinquishment of samples constitutes a valid purchase order from client company to Xenco, its affiliates and subcontractors. It assigns standard terms and conditions of service. Xenco will be liable only for the cost of samples and shall not assume any responsibility for any losses or expenses incurred by the client if such losses are due to circumstances beyond the control of Xenco. A minimum charge of \$85.00 will be applied to each project and a charge of \$5 for each sample submitted to Xenco, but not analyzed. These terms will be enforced unless previously negotiated.

Relinquished by: (Signature)	Received by: (Signature)	Date/Time	Relinquished by: (Signature)	Received by: (Signature)	Date/Time
Nick Hart	Rebecca Haskell	11/10/22 / 10:30	Rebecca Haskell	Rebecca Haskell	11/10/22 /
3 	4 	11-10-22	4 	5 	11/11/22 10:45
5			6		

## Envirotech Analytical Laboratory

Printed: 11/11/2022 3:01:02PM

## Sample Receipt Checklist (SRC)

Instructions: Please take note of any NO checkmarks.

If we receive no response concerning these items within 24 hours of the date of this notice, all the samples will be analyzed as requested.

Client:	NTG-New Tech Global Environmental	Date Received:	11/11/22 10:45	Work Order ID:	E211072
Phone:	(281) 872-9300	Date Logged In:	11/11/22 11:32	Logged In By:	Caitlin Christian
Email:	bhaskell@ntglobal.com	Due Date:	11/17/22 17:00 (4 day TAT)		

Chain of Custody (COC)

1. Does the sample ID match the COC? Yes
  2. Does the number of samples per sampling site location match the COC? Yes
  3. Were samples dropped off by client or carrier? Yes
  4. Was the COC complete, i.e., signatures, dates/times, requested analyses? No
  5. Were all samples received within holding time? Yes
- Note: Analysis, such as pH which should be conducted in the field, i.e., 15 minute hold time, are not included in this discussion.

Carrier: UPSComments/Resolution

Time sampled not provided on COC.

Sample Turn Around Time (TAT)

6. Did the COC indicate standard TAT, or Expedited TAT? Yes

Sample Cooler

7. Was a sample cooler received? Yes
8. If yes, was cooler received in good condition? Yes
9. Was the sample(s) received intact, i.e., not broken? Yes
10. Were custody/security seals present? No
11. If yes, were custody/security seals intact? NA
12. Was the sample received on ice? If yes, the recorded temp is 4°C, i.e., 6°±2°C? Yes

Note: Thermal preservation is not required, if samples are received w/i 15 minutes of sampling

13. If no visible ice, record the temperature. Actual sample temperature: 4°C

Sample Container

14. Are aqueous VOC samples present? No
15. Are VOC samples collected in VOA Vials? NA
16. Is the head space less than 6-8 mm (pea sized or less)? NA
17. Was a trip blank (TB) included for VOC analyses? NA
18. Are non-VOC samples collected in the correct containers? Yes
19. Is the appropriate volume/weight or number of sample containers collected? Yes

Field Label

20. Were field sample labels filled out with the minimum information:
  - Sample ID? Yes
  - Date/Time Collected? Yes
  - Collectors name? No

Sample Preservation

21. Does the COC or field labels indicate the samples were preserved? No
22. Are sample(s) correctly preserved? NA
24. Is lab filtration required and/or requested for dissolved metals? No

Multiphase Sample Matrix

26. Does the sample have more than one phase, i.e., multiphase? No
27. If yes, does the COC specify which phase(s) is to be analyzed? NA

Subcontract Laboratory

28. Are samples required to get sent to a subcontract laboratory? No
29. Was a subcontract laboratory specified by the client and if so who? NA Subcontract Lab: na

Client Instruction

Signature of client authorizing changes to the COC or sample disposition.

Date



envirotech Inc.



PHONE (575) 393-2326 ° 101 E. MARLAND ° HOBBS, NM 88240

---

December 22, 2022

BECKY HASKELL

NTG ENVIRONMENTAL

701 TRADEWINDS BLVD. SUITE C

MIDLAND, TX 79706

RE: JACKSON 33

Enclosed are the results of analyses for samples received by the laboratory on 12/21/22 15:20.

Cardinal Laboratories is accredited through Texas NELAP under certificate number T104704398-22-15. Accreditation applies to drinking water, non-potable water and solid and chemical materials. All accredited analytes are denoted by an asterisk (\*). For a complete list of accredited analytes and matrices visit the TCEQ website at [www.tceq.texas.gov/field/qa/lab\\_accred\\_certif.html](http://www.tceq.texas.gov/field/qa/lab_accred_certif.html).

Cardinal Laboratories is accredited through the State of Colorado Department of Public Health and Environment for:

Method EPA 552.2	Haloacetic Acids (HAA-5)
Method EPA 524.2	Total Trihalomethanes (TTHM)
Method EPA 524.4	Regulated VOCs (V1, V2, V3)

Accreditation applies to public drinking water matrices.

This report meets NELAP requirements and is made up of a cover page, analytical results, and a copy of the original chain-of-custody. If you have any questions concerning this report, please feel free to contact me.

Sincerely,

A handwritten signature in black ink that reads "Celey D. Keene". The signature is written in a cursive, flowing style.

Celey D. Keene

Lab Director/Quality Manager



PHONE (575) 393-2326 ° 101 E. MARLAND ° HOBBS, NM 88240

**Analytical Results For:**

NTG ENVIRONMENTAL  
 BECKY HASKELL  
 701 TRADEWINDS BLVD. SUITE C  
 MIDLAND TX, 79706  
 Fax To:

Received: 12/21/2022  
 Reported: 12/22/2022  
 Project Name: JACKSON 33  
 Project Number: NOT GIVEN  
 Project Location: EOG - EDDY COUNTY

Sampling Date: 12/21/2022  
 Sampling Type: Soil  
 Sampling Condition: \*\* (See Notes)  
 Sample Received By: Tamara Oldaker

**Sample ID: BH - 1 A 5' (H226035-01)**

BTEx 8021B		mg/kg		Analyzed By: JH					
Analyte	Result	Reporting Limit	Analyzed	Method Blank	BS	% Recovery	True Value QC	RPD	Qualifier
Benzene*	<0.050	0.050	12/22/2022	ND	1.96	97.8	2.00	4.62	
Toluene*	<0.050	0.050	12/22/2022	ND	2.09	104	2.00	5.40	
Ethylbenzene*	<0.050	0.050	12/22/2022	ND	2.08	104	2.00	5.44	
Total Xylenes*	<0.150	0.150	12/22/2022	ND	6.42	107	6.00	4.70	
Total BTEx	<0.300	0.300	12/22/2022	ND					

Surrogate: 4-Bromofluorobenzene (PID) 106 % 69.9-140

Chloride, SM4500Cl-B		mg/kg		Analyzed By: GM					
Analyte	Result	Reporting Limit	Analyzed	Method Blank	BS	% Recovery	True Value QC	RPD	Qualifier
Chloride	448	16.0	12/22/2022	ND	432	108	400	3.77	

TPH 8015M		mg/kg		Analyzed By: MS					
Analyte	Result	Reporting Limit	Analyzed	Method Blank	BS	% Recovery	True Value QC	RPD	Qualifier
GRO C6-C10*	<10.0	10.0	12/22/2022	ND	201	100	200	1.82	
DRO >C10-C28*	<10.0	10.0	12/22/2022	ND	198	99.0	200	3.45	
EXT DRO >C28-C36	<10.0	10.0	12/22/2022	ND					

Surrogate: 1-Chlorooctane 78.3 % 45.3-161

Surrogate: 1-Chlorooctadecane 87.8 % 46.3-178

Cardinal Laboratories

\*=Accredited Analyte

PLEASE NOTE: Liability and Damages. Cardinal's liability and client's exclusive remedy for any claim arising, whether based in contract or tort, shall be limited to the amount paid by client for analyses. All claims, including those for negligence and any other cause whatsoever shall be deemed waived unless made in writing and received by Cardinal within thirty (30) days after completion of the applicable service. In no event shall Cardinal be liable for incidental or consequential damages, including, without limitation, business interruptions, loss of use, or loss of profits incurred by client, its subsidiaries, affiliates or successors arising out of or related to the performance of the services hereunder by Cardinal, regardless of whether such claim is based upon any of the above stated reasons or otherwise. Results relate only to the samples identified above. This report shall not be reproduced except in full with written approval of Cardinal Laboratories.

Celey D. Keene, Lab Director/Quality Manager



PHONE (575) 393-2326 ° 101 E. MARLAND ° HOBBS, NM 88240

**Analytical Results For:**

NTG ENVIRONMENTAL  
 BECKY HASKELL  
 701 TRADEWINDS BLVD. SUITE C  
 MIDLAND TX, 79706  
 Fax To:

Received: 12/21/2022  
 Reported: 12/22/2022  
 Project Name: JACKSON 33  
 Project Number: NOT GIVEN  
 Project Location: EOG - EDDY COUNTY

Sampling Date: 12/21/2022  
 Sampling Type: Soil  
 Sampling Condition: \*\* (See Notes)  
 Sample Received By: Tamara Oldaker

**Sample ID: BH - 2 A 5' (H226035-02)**

BTX 8021B		mg/kg		Analyzed By: JH						
Analyte	Result	Reporting Limit	Analyzed	Method Blank	BS	% Recovery	True Value QC	RPD	Qualifier	
Benzene*	<0.050	0.050	12/22/2022	ND	1.96	97.8	2.00	4.62		
Toluene*	<0.050	0.050	12/22/2022	ND	2.09	104	2.00	5.40		
Ethylbenzene*	<0.050	0.050	12/22/2022	ND	2.08	104	2.00	5.44		
Total Xylenes*	<0.150	0.150	12/22/2022	ND	6.42	107	6.00	4.70		
Total BTX	<0.300	0.300	12/22/2022	ND						

Surrogate: 4-Bromofluorobenzene (PID) 107 % 69.9-140

Chloride, SM4500CI-B		mg/kg		Analyzed By: GM						
Analyte	Result	Reporting Limit	Analyzed	Method Blank	BS	% Recovery	True Value QC	RPD	Qualifier	
Chloride	192	16.0	12/22/2022	ND	432	108	400	3.77		

TPH 8015M		mg/kg		Analyzed By: MS					
Analyte	Result	Reporting Limit	Analyzed	Method Blank	BS	% Recovery	True Value QC	RPD	Qualifier
GRO C6-C10*	<10.0	10.0	12/22/2022	ND	201	100	200	1.82	
DRO >C10-C28*	13.3	10.0	12/22/2022	ND	198	99.0	200	3.45	
EXT DRO >C28-C36	<10.0	10.0	12/22/2022	ND					

Surrogate: 1-Chlorooctane 74.3 % 45.3-161

Surrogate: 1-Chlorooctadecane 80.5 % 46.3-178

Cardinal Laboratories

\*=Accredited Analyte

PLEASE NOTE: Liability and Damages. Cardinal's liability and client's exclusive remedy for any claim arising, whether based in contract or tort, shall be limited to the amount paid by client for analyses. All claims, including those for negligence and any other cause whatsoever shall be deemed waived unless made in writing and received by Cardinal within thirty (30) days after completion of the applicable service. In no event shall Cardinal be liable for incidental or consequential damages, including, without limitation, business interruptions, loss of use, or loss of profits incurred by client, its subsidiaries, affiliates or successors arising out of or related to the performance of the services hereunder by Cardinal, regardless of whether such claim is based upon any of the above stated reasons or otherwise. Results relate only to the samples identified above. This report shall not be reproduced except in full with written approval of Cardinal Laboratories.

Celey D. Keene, Lab Director/Quality Manager





PHONE (575) 393-2326 ° 101 E. MARLAND ° HOBBS, NM 88240

**Analytical Results For:**

NTG ENVIRONMENTAL  
BECKY HASKELL  
701 TRADEWINDS BLVD. SUITE C  
MIDLAND TX, 79706  
Fax To:

Received: 12/21/2022  
Reported: 12/22/2022  
Project Name: JACKSON 33  
Project Number: NOT GIVEN  
Project Location: EOG - EDDY COUNTY

Sampling Date: 12/21/2022  
Sampling Type: Soil  
Sampling Condition: \*\* (See Notes)  
Sample Received By: Tamara Oldaker

**Sample ID: SW 1 A (H226035-03)**

BTEx 8021B		mg/kg		Analyzed By: JH						
Analyte	Result	Reporting Limit	Analyzed	Method Blank	BS	% Recovery	True Value QC	RPD	Qualifier	
Benzene*	<0.050	0.050	12/22/2022	ND	1.96	97.8	2.00	4.62		
Toluene*	<0.050	0.050	12/22/2022	ND	2.09	104	2.00	5.40		
Ethylbenzene*	<0.050	0.050	12/22/2022	ND	2.08	104	2.00	5.44		
Total Xylenes*	<0.150	0.150	12/22/2022	ND	6.42	107	6.00	4.70		
Total BTEx	<0.300	0.300	12/22/2022	ND						

Surrogate: 4-Bromofluorobenzene (PID) 108 % 69.9-140

Chloride, SM4500CI-B		mg/kg		Analyzed By: GM						
Analyte	Result	Reporting Limit	Analyzed	Method Blank	BS	% Recovery	True Value QC	RPD	Qualifier	
Chloride	32.0	16.0	12/22/2022	ND	432	108	400	3.77		

TPH 8015M		mg/kg		Analyzed By: MS					
Analyte	Result	Reporting Limit	Analyzed	Method Blank	BS	% Recovery	True Value QC	RPD	Qualifier
GRO C6-C10*	<10.0	10.0	12/22/2022	ND	201	100	200	1.82	
DRO >C10-C28*	389	10.0	12/22/2022	ND	198	99.0	200	3.45	
EXT DRO >C28-C36	200	10.0	12/22/2022	ND					

Surrogate: 1-Chlorooctane 83.8 % 45.3-161

Surrogate: 1-Chlorooctadecane 103 % 46.3-178

Cardinal Laboratories

\*=Accredited Analyte

PLEASE NOTE: Liability and Damages. Cardinal's liability and client's exclusive remedy for any claim arising, whether based in contract or tort, shall be limited to the amount paid by client for analyses. All claims, including those for negligence and any other cause whatsoever shall be deemed waived unless made in writing and received by Cardinal within thirty (30) days after completion of the applicable service. In no event shall Cardinal be liable for incidental or consequential damages, including, without limitation, business interruptions, loss of use, or loss of profits incurred by client, its subsidiaries, affiliates or successors arising out of or related to the performance of the services hereunder by Cardinal, regardless of whether such claim is based upon any of the above stated reasons or otherwise. Results relate only to the samples identified above. This report shall not be reproduced except in full with written approval of Cardinal Laboratories.

Celey D. Keene, Lab Director/Quality Manager





PHONE (575) 393-2326 ° 101 E. MARLAND ° HOBBS, NM 88240

**Analytical Results For:**

NTG ENVIRONMENTAL  
 BECKY HASKELL  
 701 TRADEWINDS BLVD. SUITE C  
 MIDLAND TX, 79706  
 Fax To:

Received: 12/21/2022  
 Reported: 12/22/2022  
 Project Name: JACKSON 33  
 Project Number: NOT GIVEN  
 Project Location: EOG - EDDY COUNTY

Sampling Date: 12/21/2022  
 Sampling Type: Soil  
 Sampling Condition: \*\* (See Notes)  
 Sample Received By: Tamara Oldaker

**Sample ID: SW 2 A (H226035-04)**

BTEx 8021B		mg/kg		Analyzed By: JH						
Analyte	Result	Reporting Limit	Analyzed	Method Blank	BS	% Recovery	True Value QC	RPD	Qualifier	
Benzene*	<0.050	0.050	12/22/2022	ND	1.96	97.8	2.00	4.62		
Toluene*	<0.050	0.050	12/22/2022	ND	2.09	104	2.00	5.40		
Ethylbenzene*	<0.050	0.050	12/22/2022	ND	2.08	104	2.00	5.44		
Total Xylenes*	<0.150	0.150	12/22/2022	ND	6.42	107	6.00	4.70		
Total BTEx	<0.300	0.300	12/22/2022	ND						

Surrogate: 4-Bromofluorobenzene (PID) 107 % 69.9-140

Chloride, SM4500CI-B		mg/kg		Analyzed By: GM						
Analyte	Result	Reporting Limit	Analyzed	Method Blank	BS	% Recovery	True Value QC	RPD	Qualifier	
Chloride	64.0	16.0	12/22/2022	ND	432	108	400	3.77		

TPH 8015M		mg/kg		Analyzed By: MS					
Analyte	Result	Reporting Limit	Analyzed	Method Blank	BS	% Recovery	True Value QC	RPD	Qualifier
GRO C6-C10*	<10.0	10.0	12/22/2022	ND	201	100	200	1.82	
DRO >C10-C28*	12.3	10.0	12/22/2022	ND	198	99.0	200	3.45	
EXT DRO >C28-C36	15.3	10.0	12/22/2022	ND					

Surrogate: 1-Chlorooctane 84.3 % 45.3-161

Surrogate: 1-Chlorooctadecane 91.2 % 46.3-178

Cardinal Laboratories

\*=Accredited Analyte

PLEASE NOTE: Liability and Damages. Cardinal's liability and client's exclusive remedy for any claim arising, whether based in contract or tort, shall be limited to the amount paid by client for analyses. All claims, including those for negligence and any other cause whatsoever shall be deemed waived unless made in writing and received by Cardinal within thirty (30) days after completion of the applicable service. In no event shall Cardinal be liable for incidental or consequential damages, including, without limitation, business interruptions, loss of use, or loss of profits incurred by client, its subsidiaries, affiliates or successors arising out of or related to the performance of the services hereunder by Cardinal, regardless of whether such claim is based upon any of the above stated reasons or otherwise. Results relate only to the samples identified above. This report shall not be reproduced except in full with written approval of Cardinal Laboratories.

Celey D. Keene, Lab Director/Quality Manager



PHONE (575) 393-2326 ° 101 E. MARLAND ° HOBBS, NM 88240

**Analytical Results For:**

NTG ENVIRONMENTAL  
 BECKY HASKELL  
 701 TRADEWINDS BLVD. SUITE C  
 MIDLAND TX, 79706  
 Fax To:

Received: 12/21/2022  
 Reported: 12/22/2022  
 Project Name: JACKSON 33  
 Project Number: NOT GIVEN  
 Project Location: EOG - EDDY COUNTY

Sampling Date: 12/21/2022  
 Sampling Type: Soil  
 Sampling Condition: \*\* (See Notes)  
 Sample Received By: Tamara Oldaker

**Sample ID: SW 3 A (H226035-05)**

BTX 8021B		mg/kg		Analyzed By: JH						
Analyte	Result	Reporting Limit	Analyzed	Method Blank	BS	% Recovery	True Value QC	RPD	Qualifier	
Benzene*	<0.050	0.050	12/22/2022	ND	1.96	97.8	2.00	4.62		
Toluene*	<0.050	0.050	12/22/2022	ND	2.09	104	2.00	5.40		
Ethylbenzene*	<0.050	0.050	12/22/2022	ND	2.08	104	2.00	5.44		
Total Xylenes*	<0.150	0.150	12/22/2022	ND	6.42	107	6.00	4.70		
Total BTX	<0.300	0.300	12/22/2022	ND						

Surrogate: 4-Bromofluorobenzene (PID) 108 % 69.9-140

Chloride, SM4500CI-B		mg/kg		Analyzed By: GM						
Analyte	Result	Reporting Limit	Analyzed	Method Blank	BS	% Recovery	True Value QC	RPD	Qualifier	
Chloride	80.0	16.0	12/22/2022	ND	432	108	400	3.77		

TPH 8015M		mg/kg		Analyzed By: MS					
Analyte	Result	Reporting Limit	Analyzed	Method Blank	BS	% Recovery	True Value QC	RPD	Qualifier
GRO C6-C10*	<10.0	10.0	12/22/2022	ND	201	100	200	1.82	
DRO >C10-C28*	<10.0	10.0	12/22/2022	ND	198	99.0	200	3.45	
EXT DRO >C28-C36	<10.0	10.0	12/22/2022	ND					

Surrogate: 1-Chlorooctane 83.1 % 45.3-161

Surrogate: 1-Chlorooctadecane 88.7 % 46.3-178

Cardinal Laboratories

\*=Accredited Analyte

PLEASE NOTE: Liability and Damages. Cardinal's liability and client's exclusive remedy for any claim arising, whether based in contract or tort, shall be limited to the amount paid by client for analyses. All claims, including those for negligence and any other cause whatsoever shall be deemed waived unless made in writing and received by Cardinal within thirty (30) days after completion of the applicable service. In no event shall Cardinal be liable for incidental or consequential damages, including, without limitation, business interruptions, loss of use, or loss of profits incurred by client, its subsidiaries, affiliates or successors arising out of or related to the performance of the services hereunder by Cardinal, regardless of whether such claim is based upon any of the above stated reasons or otherwise. Results relate only to the samples identified above. This report shall not be reproduced except in full with written approval of Cardinal Laboratories.

Celey D. Keene, Lab Director/Quality Manager



PHONE (575) 393-2326 ° 101 E. MARLAND ° HOBBS, NM 88240

**Analytical Results For:**

NTG ENVIRONMENTAL  
 BECKY HASKELL  
 701 TRADEWINDS BLVD. SUITE C  
 MIDLAND TX, 79706  
 Fax To:

Received: 12/21/2022  
 Reported: 12/22/2022  
 Project Name: JACKSON 33  
 Project Number: NOT GIVEN  
 Project Location: EOG - EDDY COUNTY

Sampling Date: 12/21/2022  
 Sampling Type: Soil  
 Sampling Condition: \*\* (See Notes)  
 Sample Received By: Tamara Oldaker

**Sample ID: SW 4 A (H226035-06)**

BTX 8021B		mg/kg		Analyzed By: JH						
Analyte	Result	Reporting Limit	Analyzed	Method Blank	BS	% Recovery	True Value QC	RPD	Qualifier	
Benzene*	<0.050	0.050	12/22/2022	ND	1.96	97.8	2.00	4.62		
Toluene*	<0.050	0.050	12/22/2022	ND	2.09	104	2.00	5.40		
Ethylbenzene*	<0.050	0.050	12/22/2022	ND	2.08	104	2.00	5.44		
Total Xylenes*	<0.150	0.150	12/22/2022	ND	6.42	107	6.00	4.70		
Total BTX	<0.300	0.300	12/22/2022	ND						

Surrogate: 4-Bromofluorobenzene (PID) 108 % 69.9-140

Chloride, SM4500CI-B		mg/kg		Analyzed By: GM						
Analyte	Result	Reporting Limit	Analyzed	Method Blank	BS	% Recovery	True Value QC	RPD	Qualifier	
Chloride	16.0	16.0	12/22/2022	ND	432	108	400	3.77		

TPH 8015M		mg/kg		Analyzed By: MS					
Analyte	Result	Reporting Limit	Analyzed	Method Blank	BS	% Recovery	True Value QC	RPD	Qualifier
GRO C6-C10*	<10.0	10.0	12/22/2022	ND	201	100	200	1.82	
DRO >C10-C28*	<10.0	10.0	12/22/2022	ND	198	99.0	200	3.45	
EXT DRO >C28-C36	<10.0	10.0	12/22/2022	ND					

Surrogate: 1-Chlorooctane 73.4 % 45.3-161

Surrogate: 1-Chlorooctadecane 78.3 % 46.3-178

Cardinal Laboratories

\*=Accredited Analyte

PLEASE NOTE: Liability and Damages. Cardinal's liability and client's exclusive remedy for any claim arising, whether based in contract or tort, shall be limited to the amount paid by client for analyses. All claims, including those for negligence and any other cause whatsoever shall be deemed waived unless made in writing and received by Cardinal within thirty (30) days after completion of the applicable service. In no event shall Cardinal be liable for incidental or consequential damages, including, without limitation, business interruptions, loss of use, or loss of profits incurred by client, its subsidiaries, affiliates or successors arising out of or related to the performance of the services hereunder by Cardinal, regardless of whether such claim is based upon any of the above stated reasons or otherwise. Results relate only to the samples identified above. This report shall not be reproduced except in full with written approval of Cardinal Laboratories.

Celey D. Keene, Lab Director/Quality Manager



---

PHONE (575) 393-2326 ° 101 E. MARLAND ° HOBBS, NM 88240

---

### Notes and Definitions

ND	Analyte NOT DETECTED at or above the reporting limit
RPD	Relative Percent Difference
**	Samples not received at proper temperature of 6°C or below.
***	Insufficient time to reach temperature.
-	Chloride by SM4500Cl-B does not require samples be received at or below 6°C Samples reported on an as received basis (wet) unless otherwise noted on report

---

Cardinal Laboratories

\*=Accredited Analyte

PLEASE NOTE: Liability and Damages. Cardinal's liability and client's exclusive remedy for any claim arising, whether based in contract or tort, shall be limited to the amount paid by client for analyses. All claims, including those for negligence and any other cause whatsoever shall be deemed waived unless made in writing and received by Cardinal within thirty (30) days after completion of the applicable service. In no event shall Cardinal be liable for incidental or consequential damages, including, without limitation, business interruptions, loss of use, or loss of profits incurred by client, its subsidiaries, affiliates or successors arising out of or related to the performance of the services hereunder by Cardinal, regardless of whether such claim is based upon any of the above stated reasons or otherwise. Results relate only to the samples identified above. This report shall not be reproduced except in full with written approval of Cardinal Laboratories.

A handwritten signature in black ink, appearing to read "Celey D. Keene".

---

Celey D. Keene, Lab Director/Quality Manager



## CHAIN-OF-CUSTODY AND ANALYSIS REQUEST

101 East Marland, Hobbs, NM 88240  
(575) 393-2326 FAX (575) 393-2476

## BILL TO

## ANALYSIS REQUEST

Company Name: <b>NT&amp;E</b>		P.O. #:	
Project Manager: <b>Nick Hunt</b>		Company:	
Address: <b>402 E Wood Ave</b>		Attn:	
City: <b>Catskill</b>		Address:	
Phone #: <b>432-444-3047</b>		City:	
Fax #: <b>432-444-3047</b>		State:	
Project #: <b>33</b>		Zip:	
Project Name: <b>Jackson 33</b>		Phone #:	
Project Location: <b>Eddy County</b>		Fax #:	
Sampler Name: <b>Coley Keene</b>			

Lab I.D.	Sample I.D.	(G)RAB OR (C)OMP.	# CONTAINERS	MATRIX						DATE	TIME	ANALYSIS REQUEST
				GROUNDWATER	WASTEWATER	SOIL	OIL	SLUDGE	OTHER			
H226035	BH-1A S1		6			X				12-21	13:15	TPH
	BH-2A S1		6			X						Chlorides
	SW-1A		6			X						BTIX
	SW-2A		6			X						
	SW-3A		6			X						
	SW-4A		6			X						

PLEASE NOTE: Liability and Damages. Cardinal's liability and client's exclusive remedy for any claim arising whether based in contract or tort, shall be limited to the amount paid by the client for the analyses. All claims including those for negligence and any other causes whatsoever shall be deemed waived unless made in writing and received by Cardinal within 30 days after completion of the applicable service. In no event shall Cardinal be liable for incidental or consequential damages, including without limitation, business interruptions, loss of use, or loss of profits incurred by client, its subsidiaries, affiliates or successors arising out of or related to the performance of services hereunder by Cardinal, regardless of whether such claim is based upon any of the above stated reasons or otherwise.

Relinquished By: <b>[Signature]</b>	Date: <b>12-21-22</b>	Received By: <b>[Signature]</b>	Date: <b>12-21-22</b>
Relinquished By: <b>[Signature]</b>	Date: <b>12-21-22</b>	Received By: <b>[Signature]</b>	Date: <b>12-21-22</b>

Delivered By: (Circle One)	Observed Temp. °C	Corrected Temp. °C	Sample Condition	CHECKED BY: (Initials)	Turnaround Time:	Standard	Bacteria (only)	Sample Condition
Sampler - UPS - Bus - Other:	14.3	13.7	Cool Intact <input checked="" type="checkbox"/> Yes <input type="checkbox"/> No	YO		Rush	<input checked="" type="checkbox"/> Bacteria (only)	Observed Temp. °C
								Corrected Temp. °C

Thermometer ID #113  
Correction Factor -0.6°C

Standard **24 HRS.**

Cardinal cannot accept verbal changes. Please email changes to [coley.keene@cardinallabsnm.com](mailto:coley.keene@cardinallabsnm.com)



PHONE (575) 393-2326 ° 101 E. MARLAND ° HOBBS, NM 88240

---

December 27, 2022

BECKY HASKELL

NTG ENVIRONMENTAL

701 TRADEWINDS BLVD. SUITE C

MIDLAND, TX 79706

RE: JACKSON 33

Enclosed are the results of analyses for samples received by the laboratory on 12/27/22 10:45.

Cardinal Laboratories is accredited through Texas NELAP under certificate number T104704398-22-15. Accreditation applies to drinking water, non-potable water and solid and chemical materials. All accredited analytes are denoted by an asterisk (\*). For a complete list of accredited analytes and matrices visit the TCEQ website at [www.tceq.texas.gov/field/qa/lab\\_accred\\_certif.html](http://www.tceq.texas.gov/field/qa/lab_accred_certif.html).

Cardinal Laboratories is accredited through the State of Colorado Department of Public Health and Environment for:

Method EPA 552.2	Haloacetic Acids (HAA-5)
Method EPA 524.2	Total Trihalomethanes (TTHM)
Method EPA 524.4	Regulated VOCs (V1, V2, V3)

Accreditation applies to public drinking water matrices.

This report meets NELAP requirements and is made up of a cover page, analytical results, and a copy of the original chain-of-custody. If you have any questions concerning this report, please feel free to contact me.

Sincerely,

A handwritten signature in black ink that reads "Celey D. Keene". The signature is written in a cursive, flowing style.

Celey D. Keene

Lab Director/Quality Manager





PHONE (575) 393-2326 • 101 E. MARLAND • HOBBS, NM 88240

**Analytical Results For:**

NTG ENVIRONMENTAL  
 BECKY HASKELL  
 701 TRADEWINDS BLVD. SUITE C  
 MIDLAND TX, 79706  
 Fax To:

Received: 12/27/2022  
 Reported: 12/27/2022  
 Project Name: JACKSON 33  
 Project Number: NOT GIVEN  
 Project Location: EOG - EDDY COUNTY

Sampling Date: 12/27/2022  
 Sampling Type: Soil  
 Sampling Condition: Cool & Intact  
 Sample Received By: Shalyn Rodriguez

**Sample ID: SW - 1B (H226071-01)**

BTEX 8021B			mg/kg		Analyzed By: JH					
Analyte	Result	Reporting Limit	Analyzed	Method Blank	BS	% Recovery	True Value QC	RPD	Qualifier	
Benzene*	<0.050	0.050	12/27/2022	ND	2.09	104	2.00	6.14		
Toluene*	<0.050	0.050	12/27/2022	ND	2.21	111	2.00	5.44		
Ethylbenzene*	<0.050	0.050	12/27/2022	ND	2.20	110	2.00	5.46		
Total Xylenes*	<0.150	0.150	12/27/2022	ND	6.75	113	6.00	5.67		
Total BTEX	<0.300	0.300	12/27/2022	ND						

Surrogate: 4-Bromofluorobenzene (PID) 111 % 69.9-140

Chloride, SM4500Cl-B		mg/kg		Analyzed By: GM					
Analyte	Result	Reporting Limit	Analyzed	Method Blank	BS	% Recovery	True Value QC	RPD	Qualifier
Chloride	16.0	16.0	12/27/2022	ND	432	108	400	0.00	

TPH 8015M		mg/kg		Analyzed By: MS					
Analyte	Result	Reporting Limit	Analyzed	Method Blank	BS	% Recovery	True Value QC	RPD	Qualifier
GRO C6-C10*	<10.0	10.0	12/27/2022	ND	182	91.0	200	0.221	
DRO >C10-C28*	<10.0	10.0	12/27/2022	ND	176	88.1	200	1.07	
EXT DRO >C28-C36	<10.0	10.0	12/27/2022	ND					

Surrogate: 1-Chlorooctane 80.8 % 45.3-161

Surrogate: 1-Chlorooctadecane 87.4 % 46.3-178

Cardinal Laboratories

\*=Accredited Analyte

PLEASE NOTE: Liability and Damages. Cardinal's liability and client's exclusive remedy for any claim arising, whether based in contract or tort, shall be limited to the amount paid by client for analyses. All claims, including those for negligence and any other cause whatsoever shall be deemed waived unless made in writing and received by Cardinal within thirty (30) days after completion of the applicable service. In no event shall Cardinal be liable for incidental or consequential damages, including, without limitation, business interruptions, loss of use, or loss of profits incurred by client, its subsidiaries, affiliates or successors arising out of or related to the performance of the services hereunder by Cardinal, regardless of whether such claim is based upon any of the above stated reasons or otherwise. Results relate only to the samples identified above. This report shall not be reproduced except in full with written approval of Cardinal Laboratories.

Celey D. Keene, Lab Director/Quality Manager





---

PHONE (575) 393-2326 ° 101 E. MARLAND ° HOBBS, NM 88240

---

### Notes and Definitions

ND	Analyte NOT DETECTED at or above the reporting limit
RPD	Relative Percent Difference
**	Samples not received at proper temperature of 6°C or below.
***	Insufficient time to reach temperature.
-	Chloride by SM4500Cl-B does not require samples be received at or below 6°C Samples reported on an as received basis (wet) unless otherwise noted on report

---

Cardinal Laboratories

\*=Accredited Analyte

PLEASE NOTE: Liability and Damages. Cardinal's liability and client's exclusive remedy for any claim arising, whether based in contract or tort, shall be limited to the amount paid by client for analyses. All claims, including those for negligence and any other cause whatsoever shall be deemed waived unless made in writing and received by Cardinal within thirty (30) days after completion of the applicable service. In no event shall Cardinal be liable for incidental or consequential damages, including, without limitation, business interruptions, loss of use, or loss of profits incurred by client, its subsidiaries, affiliates or successors arising out of or related to the performance of the services hereunder by Cardinal, regardless of whether such claim is based upon any of the above stated reasons or otherwise. Results relate only to the samples identified above. This report shall not be reproduced except in full with written approval of Cardinal Laboratories.

A handwritten signature in black ink, appearing to read "Celey D. Keene".

---

Celey D. Keene, Lab Director/Quality Manager



ANALYSIS REQUEST

† Cardinal cannot accept verbal changes. Please email changes to [celey.aveille@calumna.com](mailto:celey.aveille@calumna.com)

**District I**  
1625 N. French Dr., Hobbs, NM 88240  
Phone:(575) 393-6161 Fax:(575) 393-0720  
**District II**  
811 S. First St., Artesia, NM 88210  
Phone:(575) 748-1283 Fax:(575) 748-9720  
**District III**  
1000 Rio Brazos Rd., Aztec, NM 87410  
Phone:(505) 334-6178 Fax:(505) 334-6170  
**District IV**  
1220 S. St Francis Dr., Santa Fe, NM 87505  
Phone:(505) 476-3470 Fax:(505) 476-3462

**State of New Mexico**  
**Energy, Minerals and Natural Resources**  
**Oil Conservation Division**  
**1220 S. St Francis Dr.**  
**Santa Fe, NM 87505**

CONDITIONS  
  
Action 171359

CONDITIONS

Operator: EOG RESOURCES INC P.O. Box 2267 Midland, TX 79702	OGRID: 7377
	Action Number: 171359
	Action Type: [C-141] Release Corrective Action (C-141)

CONDITIONS

Created By	Condition	Condition Date
rhamlet	We have received your closure report and final C-141 for Incident #NAPP2233957598 JACKSON B #33 OFF PAD, thank you. This closure is approved.	4/10/2023