

Incident ID	nAPP2208339578
District RP	
Facility ID	
Application ID	

Closure

The responsible party must attach information demonstrating they have complied with all applicable closure requirements and any conditions or directives of the OCD. This demonstration should be in the form of a comprehensive report (electronic submittals in .pdf format are preferred) including a scaled site map, sampling diagrams, relevant field notes, photographs of any excavation prior to backfilling, laboratory data including chain of custody documents of final sampling, and a narrative of the remedial activities. Refer to 19.15.29.12 NMAC.

Closure Report Attachment Checklist: *Each of the following items must be included in the closure report.*

- ☒ A scaled site and sampling diagram as described in 19.15.29.11 NMAC
- ☒ Photographs of the remediated site prior to backfill or photos of the liner integrity if applicable (Note: appropriate OCD District office must be notified 2 days prior to liner inspection)
- ☒ Laboratory analyses of final sampling (Note: appropriate ODC District office must be notified 2 days prior to final sampling)
- ☒ Description of remediation activities

I hereby certify that the information given above is true and complete to the best of my knowledge and understand that pursuant to OCD rules and regulations all operators are required to report and/or file certain release notifications and perform corrective actions for releases which may endanger public health or the environment. The acceptance of a C-141 report by the OCD does not relieve the operator of liability should their operations have failed to adequately investigate and remediate contamination that pose a threat to groundwater, surface water, human health or the environment. In addition, OCD acceptance of a C-141 report does not relieve the operator of responsibility for compliance with any other federal, state, or local laws and/or regulations. The responsible party acknowledges they must substantially restore, reclaim, and re-vegetate the impacted surface area to the conditions that existed prior to the release or their final land use in accordance with 19.15.29.13 NMAC including notification to the OCD when reclamation and re-vegetation are complete.

Printed Name: Chase Settle Title: Rep Safety & Environmental Sr
Signature: Chase Settle Date: 11/30/2022
email: Chase_Settle@eogresources.com Telephone: 575-748-1471

OCD Only

Received by: Robert Hamlet Date: 4/21/2023

Closure approval by the OCD does not relieve the responsible party of liability should their operations have failed to adequately investigate and remediate contamination that poses a threat to groundwater, surface water, human health, or the environment nor does not relieve the responsible party of compliance with any other federal, state, or local laws and/or regulations.

Closure Approved by: Robert Hamlet Date: 4/21/2023
Printed Name: Robert Hamlet Title: Environmental Specialist - Advanced



SITE REMEDIATION AND CLOSURE REPORT

**FEDERAL CM COM #1 (WELLHEAD AREA)
UNIT M, SECTION 12, TOWNSHIP 19S, RANGE 24E
EDDY COUNTY, NEW MEXICO
32.67054, -104.54807
RANGER REFERENCE NO. 5375**

PREPARED FOR:

**EOG RESOURCES, INC.
ARTESIA DIVISION
105 S 4TH STREET
ARTESIA, NEW MEXICO 88210**

PREPARED BY:

**RANGER ENVIRONMENTAL SERVICES, LLC
P.O. BOX 201179
AUSTIN, TEXAS 78720**

NOVEMBER 30, 2022

A blue ink signature of Patrick K. Finn, consisting of a stylized 'P' followed by a horizontal line and a small flourish.

**Patrick K. Finn, P.G. (TX)
Project Geologist**

A blue ink signature of William Kierdorf, consisting of a stylized 'W' followed by a horizontal line and a small flourish.

**William Kierdorf, REM
Project Manager**

TABLE OF CONTENTS

1.0	SITE LOCATION AND BACKGROUND	1
2.0	SITE REMEDIATION	2
2.1	Closure Criteria.....	2
2.2	Impacted Soil Removal and Confirmation Soil Sampling	2
2.3	Final Confirmation Sample Results	3
2.4	Waste Disposal.....	3
3.0	SITE CLOSURE.....	3
3.1	Site Backfill & Revegetation	3
3.2	Closure Request.....	3

FORM C-141

FIGURES

- Topographic Map
- Area Map
- Final Excavation Area and Confirmation Sample Location Map

TABLES

- Confirmation Soil Sample BTEX (EPA 8260), TPH (EPA 8015) & Chloride (EPA 300) Analytical Data

ATTACHMENTS

- Attachment 1 – Photographic Documentation
- Attachment 2 – Laboratory Analytical Reports
- Attachment 3 – Howell Ranch Seed Mixture
- Attachment 4 – NMOCD Correspondence



**SITE REMEDIATION AND CLOSURE REPORT
FEDERAL CM COM #1 (WELLHEAD AREA)
UNIT M, SECTION 12, TOWNSHIP 19S, RANGE 25E
EDDY COUNTY, NEW MEXICO
32.67054, -104.54807
RANGER REFERENCE NO. 5375**

1.0 SITE LOCATION AND BACKGROUND

The Federal CM #1 (Site) is located on private property, approximately 15 miles southwest of Artesia, within Eddy County, New Mexico. The Site is situated in Unit M, Section 12, T19S-R24E at GPS coordinates 32.67054, -104.54807. On December 9, 2021, Howell Ranch Revocable Trust (Howell Ranch) representatives reported an area of potential impact located in the immediate vicinity of the historic wellhead location. The information provided was limited to a general area and notes of potential elevated chloride concentrations.

EOG Resources, Inc. (EOG) subsequently engaged Ranger Environmental Services, LLC (Ranger) to assist in the assessment, remediation, and reclamation efforts at the Site. On December 17, 2021, Ranger representatives conducted a preliminary inspection of the area in the vicinity of the former wellhead location. During the inspection, an area located to the south-southeast of the former wellhead was noted to be lacking vegetation growth similar to that of the surrounding areas. Based on the observed conditions, Ranger personnel conducted site assessment activities in January 2022, February 2022, and March 2022. Based on the findings of the site assessment activities and the apparent size of the impacted area, the incident was reported to the New Mexico Oil Conservation Division (NMOCD) on March 23, 2022 (NMOCD Incident # nAPP2208339578).

The results of the site assessment activities were summarized in Ranger's June 16, 2022 "*Site Assessment/Characterization Report*." In addition to summarizing the results of the site assessment activities, the report also provided site characterization details and proposed site characterization confirmation activities. On October 28, 2022, the NMOCD approved the *Site Assessment/Characterization Report*."

Due to the lack of recent (<25 years old) depth-to-groundwater data within a one-half mile radius of the Site, the depth-to-groundwater at the Site required confirmation via the installation of a soil boring/temporary monitor well. In September 2022, the temporary monitor well was completed and the depth-to-groundwater was confirmed to be greater than 100 feet below ground surface. A Ranger-prepared "*Site Characterization Update and Proposed Remediation Plan*," dated October 20, 2022, was subsequently submitted to the NMOCD. The report included full details of the depth-to-groundwater confirmation activities and proposed remedial efforts to address the Site.

In November 2022, remedial soil removal efforts were initiated at the Site. The following *Site Remediation and Closure Report* has been prepared to document the remediation and cleanup confirmation soil sampling activities completed at the Site.

A copy of the previously submitted *Release Notification* and *Assessment/Characterization* and *Remediation Plan* sections of Form C-141 are attached. A recent Form C-141 *Closure* section is also attached.

A *Topographic Map* and *Area Map* noting the location of the subject Site and surrounding areas are provided in the Figures section. A *Final Excavation Area and Confirmation Sample Location Map* is also provided in the Figures section which illustrates the excavation boundaries and depths and the locations of the cleanup confirmation soil samples.

2.0 SITE REMEDIATION

2.1 Closure Criteria

Based upon Site characterization details¹ provided in the June 16, 2022, “*Site Assessment/Characterization Report*” and October 20, 2022, “*Site Characterization Update and Proposed Remediation Plan*” the Site was remediated to Table 1 19.15.29.12 NMAC (groundwater >100 feet) criteria. Additionally, the remediation activities were completed to bring the surface to four-foot depth interval into compliance with the Restoration, Reclamation and Re-Vegetation criteria detailed in 19.15.29.13 NMAC. The closure criteria are detailed below:

SITE CLOSURE CRITERIA

REGULATORY STANDARD	CHLORIDE	TPH (GRO+DRO +MRO)	TPH (GRO+DRO)	BTEX	BENZENE
19.15.29.12 NMAC Table 1 Closure Criteria for Soils Impacted by a Release (GW >100')	20,000	2,500	1,000	50	10
19.15.29.13 NMAC Restoration, Reclamation and Re-Vegetation (Soils 0'-4')	600	100 ²	---	50 ²	10 ²

All Values Presented in Parts Per Million (mg/Kg)

1. Full site characterization details are included in the June 16, 2022, “*Site Assessment/Characterization Report*” and October 20, 2022, “*Site Characterization Update and Proposed Remediation Plan*”.
2. Value derived from the State of New Mexico Energy, Minerals and Natural Resources Department document “*Procedures for the Implementation of the Spill Rule*” (19.15.29 NMAC) dated September 6, 2019.

2.2 Impacted Soil Removal and Confirmation Soil Sampling

From November 2, 2022 to November 16, 2022, soil removal operations were conducted at the Site. During the excavation process, Ranger personnel collected field readings from the excavated areas utilizing an organic vapor monitor (OVM) and field chloride titration kit to assist in guiding the excavation to appropriate boundaries. Upon completion, the excavated area was irregular in shape, was noted to have maximum dimensions of approximately 65 feet by 67 feet and was completed to a depth of approximately four feet below ground surface (bgs).

To assess the excavated areas and confirm that the excavation had been completed to appropriate boundaries, cleanup confirmation soil sampling activities were conducted on

November 11 and 16, 2022. The cleanup confirmation soil samples were collected from various locations in the excavation base and along the excavation side walls in accordance with NMAC 19.15.29.12(D), as five-part composite samples representative of no more than 200 square feet. A total of 18 soil samples were collected from the excavation areas.

Upon collection, all cleanup confirmation soil samples were submitted to Hall Environmental in Albuquerque, New Mexico for analysis of total petroleum hydrocarbons (TPH) using EPA Method 8015; benzene, toluene, ethylbenzene and xylenes (BTEX) using EPA Method 8021; and total chloride using EPA Method 300. The samples were collected and managed using standard QA/QC and chain-of-custody procedures.

Prior to the confirmation sampling events, notice was provided to the NMOCD in accordance with NMAC 19.15.29.12(D). Copies of the notifications are attached.

A *Final Excavation Area and Confirmation Sample Location Map* is provided in the Figures section which illustrates the excavation boundaries and depths and the locations of the cleanup confirmation soil samples.

2.3 Final Confirmation Sample Results

The final cleanup confirmation sample results documented that all areas have been brought into attainment of the site closure criteria. A comprehensive sample results table summarizing the laboratory analytical results for all cleanup confirmation soil samples collected during the remediation process is attached. Copies of the laboratory analytical reports including chain-of-custody documentation are also attached.

2.4 Waste Disposal

All soils generated during the remedial excavation activities were transported and disposed of at Lea Land disposal facility in Chaves County, New Mexico.

3.0 SITE CLOSURE

3.1 Site Backfill & Revegetation

Based on the soil sample laboratory results, the excavated area will be backfilled with clean fill material.

Re-vegetation efforts in the area will be completed in conjunction with the outstanding reclamation efforts associated with the former Federal CM Com #1 well pad.

3.2 Closure Request

Based on the results of the cleanup confirmation soil sampling events, the site has been properly addressed pursuant to NMAC 19.15.29 and EOG respectfully requests closure of the incident. A final C-141 form is attached.

FORM C-141

District I
1625 N. French Dr., Hobbs, NM 88240
District II
811 S. First St., Artesia, NM 88210
District III
1000 Rio Brazos Road, Aztec, NM 87410
District IV
1220 S. St. Francis Dr., Santa Fe, NM 87505

State of New Mexico
Energy Minerals and Natural
Resources Department

Oil Conservation Division
1220 South St. Francis Dr.
Santa Fe, NM 87505

Form C-141
Revised August 24, 2018
Submit to appropriate OCD District office

Incident ID	nAPP2208339578
District RP	
Facility ID	
Application ID	

Release Notification

Responsible Party

Responsible Party EOG Resources, Inc.	OGRID 7377
Contact Name Chase Settle	Contact Telephone 575-748-1471
Contact email Chase_Settle@eogresources.com	Incident # (nAPP2208339578)
Contact mailing address 104 S. 4th Street, Artesia, NM 88210	

Location of Release Source

Latitude 32.67054 Longitude -104.54807
(NAD 83 in decimal degrees to 5 decimal places)

Site Name Federal CM Com #1	Site Type Wellpad
Date Release Discovered 03/23/2022	API# 30-015-20800

Unit Letter	Section	Township	Range	County
M	12	19S	24E	Eddy

Surface Owner: ☐ State ☐ Federal ☐ Tribal ☒ Private (Name: Howell Ranch)

Nature and Volume of Release

Material(s) Released (Select all that apply and attach calculations or specific justification for the volumes provided below)

<input type="checkbox"/> Crude Oil	Volume Released (bbls)	Volume Recovered (bbls)
<input checked="" type="checkbox"/> Produced Water	Volume Released (bbls) Unknown	Volume Recovered (bbls) 0
	Is the concentration of dissolved chloride in the produced water >10,000 mg/l?	<input checked="" type="checkbox"/> Yes <input type="checkbox"/> No
<input type="checkbox"/> Condensate	Volume Released (bbls)	Volume Recovered (bbls)
<input type="checkbox"/> Natural Gas	Volume Released (Mcf)	Volume Recovered (Mcf)
<input type="checkbox"/> Other (describe)	Volume/Weight Released (provide units)	Volume/Weight Recovered (provide units)

Cause of Release A notice was submitted by the landowner for an area of the previously reclaimed well pad that appeared to be impacted. The consultant retained to investigate the area provided notice that it most likely meets reportable criteria on 3/23/2022, based on the initial delineation assessment that has been completed to date.

Incident ID	nAPP2208339578
District RP	
Facility ID	
Application ID	

<p>Was this a major release as defined by 19.15.29.7(A) NMAC?</p> <p><input type="checkbox"/> Yes <input checked="" type="checkbox"/> No</p>	<p>If YES, for what reason(s) does the responsible party consider this a major release?</p>
<p>If YES, was immediate notice given to the OCD? By whom? To whom? When and by what means (phone, email, etc)?</p>	

Initial Response

The responsible party must undertake the following actions immediately unless they could create a safety hazard that would result in injury

<input checked="" type="checkbox"/> The source of the release has been stopped.	
<input checked="" type="checkbox"/> The impacted area has been secured to protect human health and the environment.	
<input checked="" type="checkbox"/> Released materials have been contained via the use of berms or dikes, absorbent pads, or other containment devices.	
<input checked="" type="checkbox"/> All free liquids and recoverable materials have been removed and managed appropriately.	
If all the actions described above have <u>not</u> been undertaken, explain why:	
Per 19.15.29.8 B. (4) NMAC the responsible party may commence remediation immediately after discovery of a release. If remediation has begun, please attach a narrative of actions to date. If remedial efforts have been successfully completed or if the release occurred within a lined containment area (see 19.15.29.11(A)(5)(a) NMAC), please attach all information needed for closure evaluation.	
I hereby certify that the information given above is true and complete to the best of my knowledge and understand that pursuant to OCD rules and regulations all operators are required to report and/or file certain release notifications and perform corrective actions for releases which may endanger public health or the environment. The acceptance of a C-141 report by the OCD does not relieve the operator of liability should their operations have failed to adequately investigate and remediate contamination that pose a threat to groundwater, surface water, human health or the environment. In addition, OCD acceptance of a C-141 report does not relieve the operator of responsibility for compliance with any other federal, state, or local laws and/or regulations.	
Printed Name: <u>Chase Settle</u>	Title: <u>Rep Safety & Environmental Sr</u>
Signature: <u><i>Chase Settle</i></u>	Date: <u>03/24/2022</u>
email: <u>Chase_Settle@eogresources.com</u>	Telephone: <u>575-748-1471</u>
<u>OCD Only</u>	
Received by: <u>Jocelyn Harimon</u>	Date: <u>03/24/2022</u>

Incident ID	
District RP	
Facility ID	
Application ID	

Site Assessment/Characterization

This information must be provided to the appropriate district office no later than 90 days after the release discovery date.

What is the shallowest depth to groundwater beneath the area affected by the release?	_____ (ft bgs)
Did this release impact groundwater or surface water?	<input type="checkbox"/> Yes <input type="checkbox"/> No
Are the lateral extents of the release within 300 feet of a continuously flowing watercourse or any other significant watercourse?	<input type="checkbox"/> Yes <input type="checkbox"/> No
Are the lateral extents of the release within 200 feet of any lakebed, sinkhole, or playa lake (measured from the ordinary high-water mark)?	<input type="checkbox"/> Yes <input type="checkbox"/> No
Are the lateral extents of the release within 300 feet of an occupied permanent residence, school, hospital, institution, or church?	<input type="checkbox"/> Yes <input type="checkbox"/> No
Are the lateral extents of the release within 500 horizontal feet of a spring or a private domestic fresh water well used by less than five households for domestic or stock watering purposes?	<input type="checkbox"/> Yes <input type="checkbox"/> No
Are the lateral extents of the release within 1000 feet of any other fresh water well or spring?	<input type="checkbox"/> Yes <input type="checkbox"/> No
Are the lateral extents of the release within incorporated municipal boundaries or within a defined municipal fresh water well field?	<input type="checkbox"/> Yes <input type="checkbox"/> No
Are the lateral extents of the release within 300 feet of a wetland?	<input type="checkbox"/> Yes <input type="checkbox"/> No
Are the lateral extents of the release overlying a subsurface mine?	<input type="checkbox"/> Yes <input type="checkbox"/> No
Are the lateral extents of the release overlying an unstable area such as karst geology?	<input type="checkbox"/> Yes <input type="checkbox"/> No
Are the lateral extents of the release within a 100-year floodplain?	<input type="checkbox"/> Yes <input type="checkbox"/> No
Did the release impact areas not on an exploration, development, production, or storage site?	<input type="checkbox"/> Yes <input type="checkbox"/> No

Attach a comprehensive report (electronic submittals in .pdf format are preferred) demonstrating the lateral and vertical extents of soil contamination associated with the release have been determined. Refer to 19.15.29.11 NMAC for specifics.

Characterization Report Checklist: *Each of the following items must be included in the report.*

- ☐ Scaled site map showing impacted area, surface features, subsurface features, delineation points, and monitoring wells.
- ☐ Field data
- ☐ Data table of soil contaminant concentration data
- ☐ Depth to water determination
- ☐ Determination of water sources and significant watercourses within ½-mile of the lateral extents of the release
- ☐ Boring or excavation logs
- ☐ Photographs including date and GIS information
- ☐ Topographic/Aerial maps
- ☐ Laboratory data including chain of custody

If the site characterization report does not include completed efforts at remediation of the release, the report must include a proposed remediation plan. That plan must include the estimated volume of material to be remediated, the proposed remediation technique, proposed sampling plan and methods, anticipated timelines for beginning and completing the remediation. The closure criteria for a release are contained in Table 1 of 19.15.29.12 NMAC, however, use of the table is modified by site- and release-specific parameters.

State of New Mexico
Oil Conservation Division

Page 4

Incident ID	
District RP	
Facility ID	
Application ID	

I hereby certify that the information given above is true and complete to the best of my knowledge and understand that pursuant to OCD rules and regulations all operators are required to report and/or file certain release notifications and perform corrective actions for releases which may endanger public health or the environment. The acceptance of a C-141 report by the OCD does not relieve the operator of liability should their operations have failed to adequately investigate and remediate contamination that pose a threat to groundwater, surface water, human health or the environment. In addition, OCD acceptance of a C-141 report does not relieve the operator of responsibility for compliance with any other federal, state, or local laws and/or regulations.

Printed Name: _____ Title: _____

Signature: _____ Date: _____

email: _____ Telephone: _____

OCD Only

Received by: _____ Date: _____

Incident ID	
District RP	
Facility ID	
Application ID	

Remediation Plan

Remediation Plan Checklist: *Each of the following items must be included in the plan.*

- ☐ Detailed description of proposed remediation technique
- ☐ Scaled sitemap with GPS coordinates showing delineation points
- ☐ Estimated volume of material to be remediated
- ☐ Closure criteria is to Table 1 specifications subject to 19.15.29.12(C)(4) NMAC
- ☐ Proposed schedule for remediation (note if remediation plan timeline is more than 90 days OCD approval is required)

Deferral Requests Only: *Each of the following items must be confirmed as part of any request for deferral of remediation.*

- ☐ Contamination must be in areas immediately under or around production equipment where remediation could cause a major facility deconstruction.
- ☐ Extents of contamination must be fully delineated.
- ☐ Contamination does not cause an imminent risk to human health, the environment, or groundwater.

I hereby certify that the information given above is true and complete to the best of my knowledge and understand that pursuant to OCD rules and regulations all operators are required to report and/or file certain release notifications and perform corrective actions for releases which may endanger public health or the environment. The acceptance of a C-141 report by the OCD does not relieve the operator of liability should their operations have failed to adequately investigate and remediate contamination that pose a threat to groundwater, surface water, human health or the environment. In addition, OCD acceptance of a C-141 report does not relieve the operator of responsibility for compliance with any other federal, state, or local laws and/or regulations.

Printed Name: _____ Title: _____

Signature: _____ Date: _____

email: _____ Telephone: _____

OCD Only

Received by: _____ Date: _____

☐ Approved ☐ Approved with Attached Conditions of Approval ☐ Denied ☐ Deferral Approved

Signature: _____ Date: _____

Incident ID	
District RP	
Facility ID	
Application ID	

Closure

The responsible party must attach information demonstrating they have complied with all applicable closure requirements and any conditions or directives of the OCD. This demonstration should be in the form of a comprehensive report (electronic submittals in .pdf format are preferred) including a scaled site map, sampling diagrams, relevant field notes, photographs of any excavation prior to backfilling, laboratory data including chain of custody documents of final sampling, and a narrative of the remedial activities. Refer to 19.15.29.12 NMAC.

Closure Report Attachment Checklist: Each of the following items must be included in the closure report.

- ☐ A scaled site and sampling diagram as described in 19.15.29.11 NMAC
- ☐ Photographs of the remediated site prior to backfill or photos of the liner integrity if applicable (Note: appropriate OCD District office must be notified 2 days prior to liner inspection)
- ☐ Laboratory analyses of final sampling (Note: appropriate ODC District office must be notified 2 days prior to final sampling)
- ☐ Description of remediation activities

I hereby certify that the information given above is true and complete to the best of my knowledge and understand that pursuant to OCD rules and regulations all operators are required to report and/or file certain release notifications and perform corrective actions for releases which may endanger public health or the environment. The acceptance of a C-141 report by the OCD does not relieve the operator of liability should their operations have failed to adequately investigate and remediate contamination that pose a threat to groundwater, surface water, human health or the environment. In addition, OCD acceptance of a C-141 report does not relieve the operator of responsibility for compliance with any other federal, state, or local laws and/or regulations. The responsible party acknowledges they must substantially restore, reclaim, and re-vegetate the impacted surface area to the conditions that existed prior to the release or their final land use in accordance with 19.15.29.13 NMAC including notification to the OCD when reclamation and re-vegetation are complete.

Printed Name: _____ Title: _____

Signature: _____ Date: _____

email: _____ Telephone: _____

OCD Only

Received by: _____ Date: _____

Closure approval by the OCD does not relieve the responsible party of liability should their operations have failed to adequately investigate and remediate contamination that poses a threat to groundwater, surface water, human health, or the environment nor does not relieve the responsible party of compliance with any other federal, state, or local laws and/or regulations.

Closure Approved by: _____ Date: _____

Printed Name: _____ Title: _____

District I
1625 N. French Dr., Hobbs, NM 88240
Phone:(575) 393-6161 Fax:(575) 393-0720
District II
811 S. First St., Artesia, NM 88210
Phone:(575) 748-1283 Fax:(575) 748-9720
District III
1000 Rio Brazos Rd., Aztec, NM 87410
Phone:(505) 334-6178 Fax:(505) 334-6170
District IV
1220 S. St Francis Dr., Santa Fe, NM 87505
Phone:(505) 476-3470 Fax:(505) 476-3462

State of New Mexico
Energy, Minerals and Natural Resources
Oil Conservation Division
1220 S. St Francis Dr.
Santa Fe, NM 87505

CONDITIONS

Action 92909

CONDITIONS

Operator: EOG RESOURCES INC P.O. Box 2267 Midland, TX 79702	OGRID: 7377
	Action Number: 92909
	Action Type: [C-141] Release Corrective Action (C-141)

CONDITIONS

Created By	Condition	Condition Date
jharimon	When submitting future reports regarding this release, please submit the calculations used or specific justification for the volumes reported on the initial C-141	3/24/2022

Incident ID	nAPP2208339578
District RP	
Facility ID	
Application ID	

Site Assessment/Characterization

This information must be provided to the appropriate district office no later than 90 days after the release discovery date.

What is the shallowest depth to groundwater beneath the area affected by the release? **The depth to groundwater has been confirmed via the installation of a temporary monitoring well.*

>108' (ft bgs)

Did this release impact groundwater or surface water?

☐ Yes ☒ No

Are the lateral extents of the release within 300 feet of a continuously flowing watercourse or any other significant watercourse?

☐ Yes ☒ No

Are the lateral extents of the release within 200 feet of any lakebed, sinkhole, or playa lake (measured from the ordinary high-water mark)?

☐ Yes ☒ No

Are the lateral extents of the release within 300 feet of an occupied permanent residence, school, hospital, institution, or church?

☐ Yes ☒ No

Are the lateral extents of the release within 500 horizontal feet of a spring or a private domestic fresh water well used by less than five households for domestic or stock watering purposes?

☐ Yes ☒ No

Are the lateral extents of the release within 1000 feet of any other fresh water well or spring?

☐ Yes ☒ No

Are the lateral extents of the release within incorporated municipal boundaries or within a defined municipal fresh water well field?

☐ Yes ☒ No

Are the lateral extents of the release within 300 feet of a wetland?

☐ Yes ☒ No

Are the lateral extents of the release overlying a subsurface mine?

☐ Yes ☒ No

Are the lateral extents of the release overlying an unstable area such as karst geology?

☐ Yes ☒ No

Are the lateral extents of the release within a 100-year floodplain?

☐ Yes ☒ No

Did the release impact areas **not** on an exploration, development, production, or storage site?

☐ Yes ☒ No

Attach a comprehensive report (electronic submittals in .pdf format are preferred) demonstrating the lateral and vertical extents of soil contamination associated with the release have been determined. Refer to 19.15.29.11 NMAC for specifics.

Characterization Report Checklist: *Each of the following items must be included in the report.*

- ☒ Scaled site map showing impacted area, surface features, subsurface features, delineation points, and monitoring wells.
- ☒ Field data
- ☒ Data table of soil contaminant concentration data
- ☒ Depth to water determination
- ☒ Determination of water sources and significant watercourses within ½-mile of the lateral extents of the release
- ☒ Boring or excavation logs
- ☒ Photographs including date and GIS information
- ☒ Topographic/Aerial maps
- ☒ Laboratory data including chain of custody

Oil Conservation Division

Incident ID	nAPP2208339578
District RP	
Facility ID	
Application ID	

If the site characterization report does not include completed efforts at remediation of the release, the report must include a proposed remediation plan. That plan must include the estimated volume of material to be remediated, the proposed remediation technique, proposed sampling plan and methods, anticipated timelines for beginning and completing the remediation. The closure criteria for a release are contained in Table 1 of 19.15.29.12 NMAC, however, use of the table is modified by site- and release-specific parameters.

I hereby certify that the information given above is true and complete to the best of my knowledge and understand that pursuant to OCD rules and regulations all operators are required to report and/or file certain release notifications and perform corrective actions for releases which may endanger public health or the environment. The acceptance of a C-141 report by the OCD does not relieve the operator of liability should their operations have failed to adequately investigate and remediate contamination that pose a threat to groundwater, surface water, human health or the environment. In addition, OCD acceptance of a C-141 report does not relieve the operator of responsibility for compliance with any other federal, state, or local laws and/or regulations.

Printed Name: Chase Settle Title: Rep Safety & Environmental Sr

Signature: Chase Settle Date: 10/27/2022

email: Chase_Settle@eogresources.com Telephone: 575-748-1471

OCD Only

Received by: _____ Date: _____

Incident ID	nAPP2208339578
District RP	
Facility ID	
Application ID	

Remediation Plan

Remediation Plan Checklist: *Each of the following items must be included in the plan.*

- ☒ Detailed description of proposed remediation technique
- ☒ Scaled sitemap with GPS coordinates showing delineation points
- ☒ Estimated volume of material to be remediated
- ☒ Closure criteria is to Table 1 specifications subject to 19.15.29.12(C)(4) NMAC
- ☒ Proposed schedule for remediation (note if remediation plan timeline is more than 90 days OCD approval is required)

Deferral Requests Only: *Each of the following items must be confirmed as part of any request for deferral of remediation.*

- ☐ Contamination must be in areas immediately under or around production equipment where remediation could cause a major facility deconstruction.
- ☐ Extents of contamination must be fully delineated.
- ☐ Contamination does not cause an imminent risk to human health, the environment, or groundwater.

I hereby certify that the information given above is true and complete to the best of my knowledge and understand that pursuant to OCD rules and regulations all operators are required to report and/or file certain release notifications and perform corrective actions for releases which may endanger public health or the environment. The acceptance of a C-141 report by the OCD does not relieve the operator of liability should their operations have failed to adequately investigate and remediate contamination that pose a threat to groundwater, surface water, human health or the environment. In addition, OCD acceptance of a C-141 report does not relieve the operator of responsibility for compliance with any other federal, state, or local laws and/or regulations.

Printed Name: Chase Settle Title: Rep Safety & Environmental Sr

Signature: Chase Settle Date: 10/27/2022

email: Chase_Settle@eogresources.com Telephone: 575-748-1471

OCD Only

Received by: _____ Date: _____

☐ Approved ☐ Approved with Attached Conditions of Approval ☐ Denied ☐ Deferral Approved

Signature: _____ Date: _____

Incident ID	nAPP2208339578
District RP	
Facility ID	
Application ID	

Closure

The responsible party must attach information demonstrating they have complied with all applicable closure requirements and any conditions or directives of the OCD. This demonstration should be in the form of a comprehensive report (electronic submittals in .pdf format are preferred) including a scaled site map, sampling diagrams, relevant field notes, photographs of any excavation prior to backfilling, laboratory data including chain of custody documents of final sampling, and a narrative of the remedial activities. Refer to 19.15.29.12 NMAC.

Closure Report Attachment Checklist: *Each of the following items must be included in the closure report.*

- ☒ A scaled site and sampling diagram as described in 19.15.29.11 NMAC
- ☒ Photographs of the remediated site prior to backfill or photos of the liner integrity if applicable (Note: appropriate OCD District office must be notified 2 days prior to liner inspection)
- ☒ Laboratory analyses of final sampling (Note: appropriate ODC District office must be notified 2 days prior to final sampling)
- ☒ Description of remediation activities

I hereby certify that the information given above is true and complete to the best of my knowledge and understand that pursuant to OCD rules and regulations all operators are required to report and/or file certain release notifications and perform corrective actions for releases which may endanger public health or the environment. The acceptance of a C-141 report by the OCD does not relieve the operator of liability should their operations have failed to adequately investigate and remediate contamination that pose a threat to groundwater, surface water, human health or the environment. In addition, OCD acceptance of a C-141 report does not relieve the operator of responsibility for compliance with any other federal, state, or local laws and/or regulations. The responsible party acknowledges they must substantially restore, reclaim, and re-vegetate the impacted surface area to the conditions that existed prior to the release or their final land use in accordance with 19.15.29.13 NMAC including notification to the OCD when reclamation and re-vegetation are complete.

Printed Name: Chase Settle Title: Rep Safety & Environmental Sr
Signature: Chase Settle Date: 11/30/2022
email: Chase_Settle@eogresources.com Telephone: 575-748-1471

OCD Only

Received by: _____ Date: _____

Closure approval by the OCD does not relieve the responsible party of liability should their operations have failed to adequately investigate and remediate contamination that poses a threat to groundwater, surface water, human health, or the environment nor does not relieve the responsible party of compliance with any other federal, state, or local laws and/or regulations.

Closure Approved by: _____ Date: _____

Printed Name: _____ Title: _____

FIGURES

Topographic Map

Area Map

Final Excavation Area and Confirmation Sample Location Map

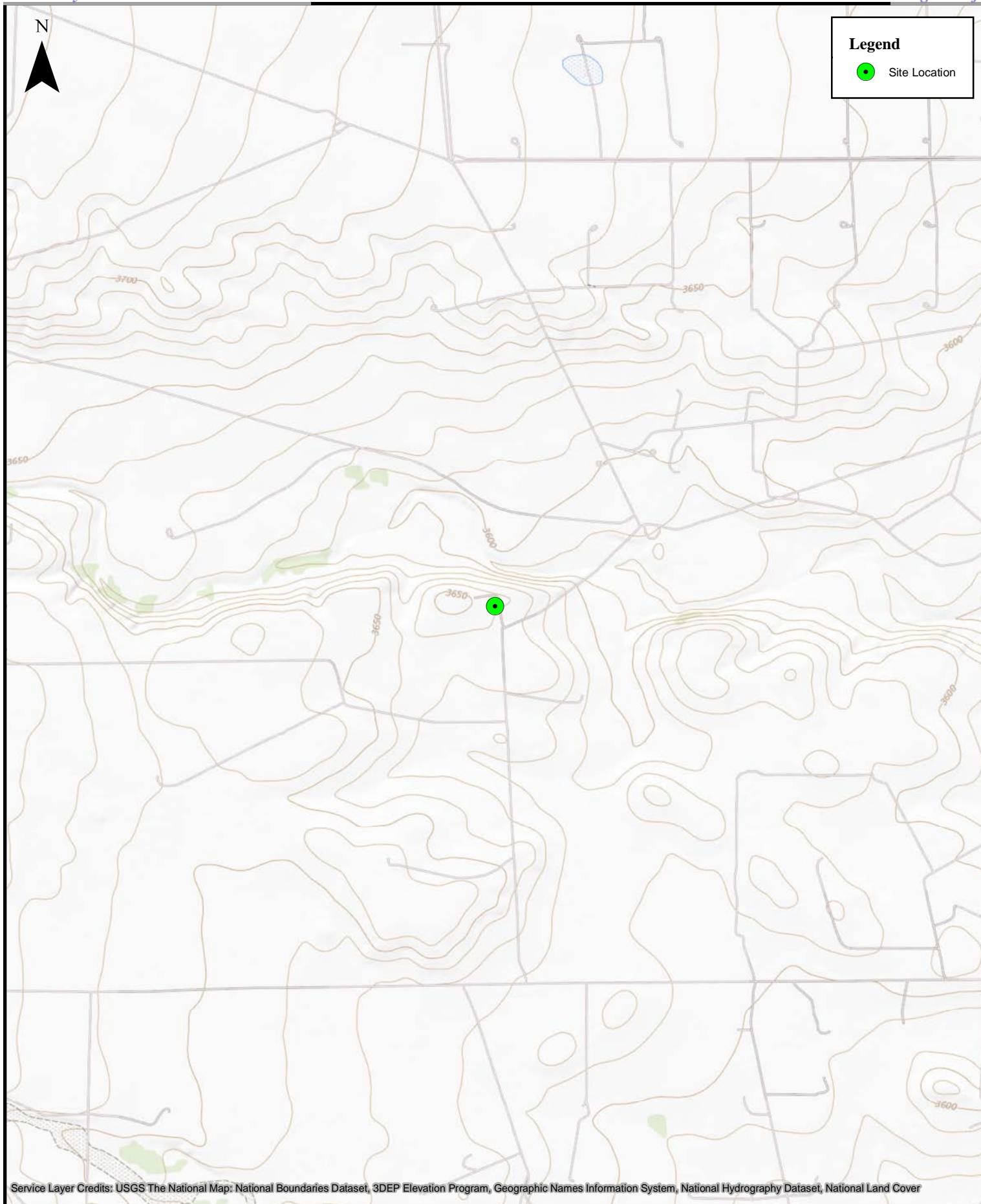

Service Layer Credits: USGS The National Map: National Boundaries Dataset, 3DEP Elevation Program, Geographic Names Information System, National Hydrography Dataset, National Land Cover



0 600 1,200 2,400 3,600 4,800 Feet

1:24,000

Topographic Map
Federal CM #1 (Wellhead Area)
EOG Resources, Inc.

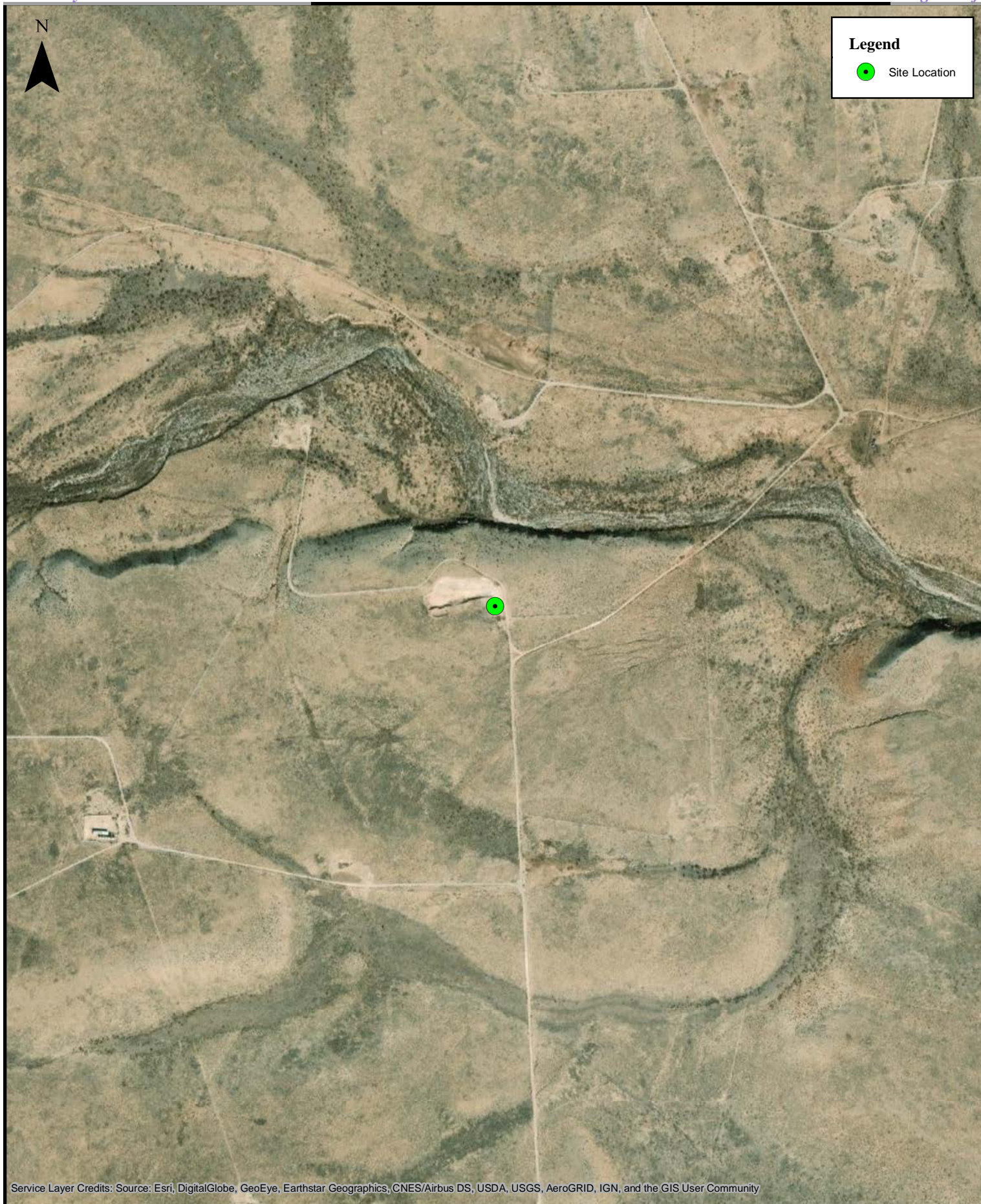

0 250 500 1,000 1,500 2,000 Feet
1:10,000

Area Map
Federal CM #1 (Wellhead Area)
EOG Resources, Inc.

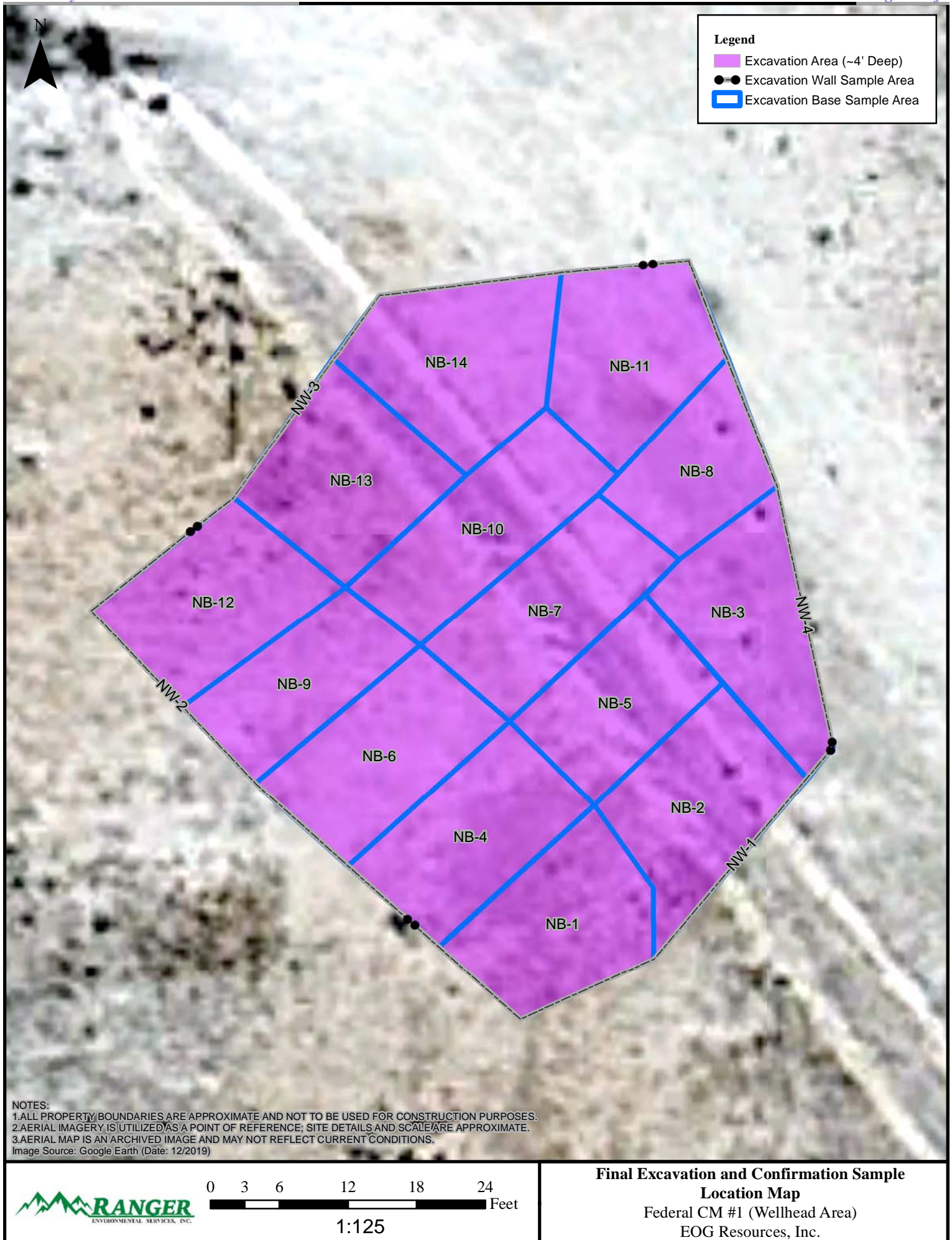

TABLES

Confirmation Soil Sample BTEX (EPA 8260), TPH (EPA 8015) &
Chloride (EPA 300) Analytical Data

CONFIRMATION SOIL SAMPLE SAMPLE BTEX (EPA 8021), TPH (SW 8015) & CHLORIDE (EPA 300) ANALYTICAL DATA EOG RESOURCES, INC. FEDERAL CM COM #1 (WELLHEAD AREA)													
All values presented in parts per million (mg/Kg)													
SAMPLE ID	DATE	DEPTH (FT)	BENZENE	TOLUENE	ETHYL-BENZENE	TOTAL XYLENES	TOTAL BTEX	TPH GRO C6-C10	TPH DRO C10-C28	TPH MRO C28-C36	TPH (GRO+DRO)	TPH (GRO+DRO+MRO)	CHLORIDE
NW-1	11/11/2022	0'-4'	<0.025	<0.050	<0.050	<0.10	<0.10	<5.0	<14	<46	<14	<46	410
NW-2	11/11/2022	0'-4'	<0.024	<0.047	<0.047	<0.094	<0.09	<4.7	<14	<47	<14	<47	230
NW-3	11/11/2022	0'-4'	<0.024	<0.048	<0.048	<0.097	<0.10	<4.8	<14	<48	<14	<48	220
NW-4	11/11/2022	0'-4'	<0.024	<0.048	<0.048	<0.096	<0.10	<4.8	<14	<47	<14	<47	180
NB-1	11/16/2022	4'	<0.035	<0.069	<0.069	<0.14	<0.14	<6.9	<15	<49	<15	<49	900
NB-2	11/16/2022	4'	<0.027	<0.054	<0.054	<0.11	<0.11	<5.4	<14	<45	<14	<45	940
NB-3	11/16/2022	4'	<0.025	<0.050	<0.050	<0.099	<0.10	<5.0	<14	<45	<14	<45	900
NB-4	11/16/2022	4'	<0.022	<0.044	<0.044	<0.087	<0.09	<4.4	<15	<49	<15	<49	460
NB-5	11/16/2022	4'	<0.023	<0.046	<0.046	<0.092	<0.09	<4.6	<14	<47	<14	<47	510
NB-6	11/16/2022	4'	<0.021	<0.041	<0.041	<0.083	<0.08	<4.1	<15	<49	<15	<49	600
NB-7	11/16/2022	4'	<0.020	<0.039	<0.039	<0.078	<0.08	<3.9	<14	<47	<14	<47	780
NB-8	11/16/2022	4'	<0.020	<0.039	<0.039	<0.079	<0.08	<3.9	<15	<51	<15	<51	780
NB-9	11/16/2022	4'	<0.039	<0.078	<0.078	<0.16	<0.16	<7.8	<14	<45	<14	<45	720
NB-10	11/16/2022	4'	<0.021	<0.043	<0.043	<0.086	<0.09	<4.3	<15	<48	<15	<48	830
NB-11	11/16/2022	4'	<0.018	<0.035	<0.035	<0.071	<0.07	<3.5	<15	<49	<15	<49	890
NB-12	11/16/2022	4'	<0.023	<0.047	<0.047	<0.093	<0.09	<4.7	<15	<49	<15	<49	750
NB-13	11/16/2022	4'	<0.027	<0.054	<0.054	<0.11	<0.11	<5.4	<15	<50	<15	<50	860
NB-14	11/16/2022	4'	<0.026	<0.051	<0.051	<0.10	<0.10	<5.1	<14	<47	<14	<47	1,100
19.15.29.12 NMAC Table 1 Closure Criteria for Soils Impacted by a Release (GW >100')			10	---	---	---	50	---	---	---	1,000	2,500	20,000
19.15.29.13 NMAC Reclamation Criteria (0'-4' Soils Only)			10 ³	---	---	---	50 ³	---	---	---	---	100 ³	600
Notes:													
1. Results exceeding the Table 1 Closure Criteria are presented in bold type and are highlighted yellow.													
2. Results exceeding the NMAC Restoration, Reclamation and re-vegetation chloride concentration requirements are presented in bold red type.													
3. Value derived from the State of New Mexico Energy, Minerals and Natural Resources Department document Procedures for the Implementation of the Spill Rule (19.15.29 NMAC) dated September 6, 2019.													

ATTACHMENT 1 – PHOTOGRAPHIC DOCUMENTATION



PHOTOGRAPH NO. 2 – A view of the excavation/remediation area during the soil removal operations. The view is towards the southeast.

(Approximate GPS: 32.670626, -104.548152)



PHOTOGRAPH NO. 1 – A view of the excavation/remediation area at the Site upon completion of the soil removal operations. The view is towards the southwest.

(Approximate GPS: 32.670644, -104.547911)

ATTACHMENT 2 – LABORATORY ANALYTICAL REPORTS

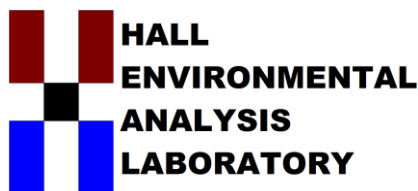

Hall Environmental Analysis Laboratory
4901 Hawkins NE
Albuquerque, NM 87109
TEL: 505-345-3975 FAX: 505-345-4107
Website: www.hallenvironmental.com

November 30, 2022

Will Kierdorf

EOG

105 South Fourth Street

Artesia, NM 88210

TEL:

FAX:

RE: Federal CM 1

OrderNo.: 2211801

Dear Will Kierdorf:

Hall Environmental Analysis Laboratory received 19 sample(s) on 11/15/2022 for the analyses presented in the following report.

These were analyzed according to EPA procedures or equivalent. To access our accredited tests please go to www.hallenvironmental.com or the state specific web sites. In order to properly interpret your results, it is imperative that you review this report in its entirety. See the sample checklist and/or the Chain of Custody for information regarding the sample receipt temperature and preservation. Data qualifiers or a narrative will be provided if the sample analysis or analytical quality control parameters require a flag. When necessary, data qualifiers are provided on both the sample analysis report and the QC summary report, both sections should be reviewed. All samples are reported, as received, unless otherwise indicated. Lab measurement of analytes considered field parameters that require analysis within 15 minutes of sampling such as pH and residual chlorine are qualified as being analyzed outside of the recommended holding time.

Please don't hesitate to contact HEAL for any additional information or clarifications.

ADHS Cert #AZ0682 -- NMED-DWB Cert #NM9425 -- NMED-Micro Cert #NM0901

Sincerely,

A handwritten signature in black ink, appearing to read "Andy Freeman", is written over a white background.

Andy Freeman

Laboratory Manager

4901 Hawkins NE

Albuquerque, NM 87109

Analytical Report

Lab Order 2211801

Date Reported: 11/30/2022

Hall Environmental Analysis Laboratory, Inc.

CLIENT: EOG

Client Sample ID: S-1

Project: Federal CM 1

Collection Date: 11/11/2022 10:00:00 AM

Lab ID: 2211801-001

Matrix: SOIL

Received Date: 11/15/2022 7:30:00 AM

Analyses	Result	RL	Qual	Units	DF	Date Analyzed	Batch
EPA METHOD 300.0: ANIONS							Analyst: JTT
Chloride	73	60		mg/Kg	20	11/21/2022 2:52:01 PM	71616
EPA METHOD 8015M/D: DIESEL RANGE ORGANICS							Analyst: DGH
Diesel Range Organics (DRO)	ND	14		mg/Kg	1	11/17/2022 3:33:52 PM	71554
Motor Oil Range Organics (MRO)	ND	48		mg/Kg	1	11/17/2022 3:33:52 PM	71554
Surr: DNOP	83.2	21-129		%Rec	1	11/17/2022 3:33:52 PM	71554
EPA METHOD 8015D: GASOLINE RANGE							Analyst: CCM
Gasoline Range Organics (GRO)	ND	4.9		mg/Kg	1	11/19/2022 1:57:00 AM	71544
Surr: BFB	107	37.7-212		%Rec	1	11/19/2022 1:57:00 AM	71544
EPA METHOD 8021B: VOLATILES							Analyst: CCM
Benzene	ND	0.024		mg/Kg	1	11/19/2022 1:57:00 AM	71544
Toluene	ND	0.049		mg/Kg	1	11/19/2022 1:57:00 AM	71544
Ethylbenzene	ND	0.049		mg/Kg	1	11/19/2022 1:57:00 AM	71544
Xylenes, Total	ND	0.097		mg/Kg	1	11/19/2022 1:57:00 AM	71544
Surr: 4-Bromofluorobenzene	127	70-130		%Rec	1	11/19/2022 1:57:00 AM	71544

Refer to the QC Summary report and sample login checklist for flagged QC data and preservation information.

Qualifiers:	*	Value exceeds Maximum Contaminant Level.	B	Analyte detected in the associated Method Blank
	D	Sample Diluted Due to Matrix	E	Above Quantitation Range/Estimated Value
	H	Holding times for preparation or analysis exceeded	J	Analyte detected below quantitation limits
	ND	Not Detected at the Reporting Limit	P	Sample pH Not In Range
	PQL	Practical Quantitative Limit	RL	Reporting Limit
	S	% Recovery outside of standard limits. If undiluted results may be estimated.		

Analytical Report

Lab Order 2211801

Date Reported: 11/30/2022

Hall Environmental Analysis Laboratory, Inc.

CLIENT: EOG

Client Sample ID: S-2

Project: Federal CM 1

Collection Date: 11/11/2022 10:02:00 AM

Lab ID: 2211801-002

Matrix: SOIL

Received Date: 11/15/2022 7:30:00 AM

Analyses	Result	RL	Qual	Units	DF	Date Analyzed	Batch
EPA METHOD 300.0: ANIONS							Analyst: JTT
Chloride	ND	60		mg/Kg	20	11/21/2022 3:29:03 PM	71616
EPA METHOD 8015M/D: DIESEL RANGE ORGANICS							Analyst: DGH
Diesel Range Organics (DRO)	ND	14		mg/Kg	1	11/17/2022 3:44:30 PM	71554
Motor Oil Range Organics (MRO)	ND	47		mg/Kg	1	11/17/2022 3:44:30 PM	71554
Surr: DNOP	70.0	21-129		%Rec	1	11/17/2022 3:44:30 PM	71554
EPA METHOD 8015D: GASOLINE RANGE							Analyst: CCM
Gasoline Range Organics (GRO)	ND	4.9		mg/Kg	1	11/19/2022 2:36:00 AM	71544
Surr: BFB	104	37.7-212		%Rec	1	11/19/2022 2:36:00 AM	71544
EPA METHOD 8021B: VOLATILES							Analyst: CCM
Benzene	ND	0.024		mg/Kg	1	11/19/2022 2:36:00 AM	71544
Toluene	ND	0.049		mg/Kg	1	11/19/2022 2:36:00 AM	71544
Ethylbenzene	ND	0.049		mg/Kg	1	11/19/2022 2:36:00 AM	71544
Xylenes, Total	ND	0.098		mg/Kg	1	11/19/2022 2:36:00 AM	71544
Surr: 4-Bromofluorobenzene	126	70-130		%Rec	1	11/19/2022 2:36:00 AM	71544

Refer to the QC Summary report and sample login checklist for flagged QC data and preservation information.

Qualifiers:	*	Value exceeds Maximum Contaminant Level.	B	Analyte detected in the associated Method Blank
	D	Sample Diluted Due to Matrix	E	Above Quantitation Range/Estimated Value
	H	Holding times for preparation or analysis exceeded	J	Analyte detected below quantitation limits
	ND	Not Detected at the Reporting Limit	P	Sample pH Not In Range
	PQL	Practical Quantitative Limit	RL	Reporting Limit
	S	% Recovery outside of standard limits. If undiluted results may be estimated.		

Page 2 of 23

Analytical Report

Lab Order 2211801

Date Reported: 11/30/2022

Hall Environmental Analysis Laboratory, Inc.

CLIENT: EOG

Client Sample ID: S-3

Project: Federal CM 1

Collection Date: 11/11/2022 10:04:00 AM

Lab ID: 2211801-003

Matrix: SOIL

Received Date: 11/15/2022 7:30:00 AM

Analyses	Result	RL	Qual	Units	DF	Date Analyzed	Batch
EPA METHOD 300.0: ANIONS							Analyst: JTT
Chloride	630	59		mg/Kg	20	11/21/2022 3:41:24 PM	71616
EPA METHOD 8015M/D: DIESEL RANGE ORGANICS							Analyst: DGH
Diesel Range Organics (DRO)	ND	15		mg/Kg	1	11/17/2022 3:55:06 PM	71554
Motor Oil Range Organics (MRO)	ND	50		mg/Kg	1	11/17/2022 3:55:06 PM	71554
Surr: DNOP	83.3	21-129		%Rec	1	11/17/2022 3:55:06 PM	71554
EPA METHOD 8015D: GASOLINE RANGE							Analyst: CCM
Gasoline Range Organics (GRO)	ND	5.0		mg/Kg	1	11/19/2022 2:56:00 AM	71544
Surr: BFB	102	37.7-212		%Rec	1	11/19/2022 2:56:00 AM	71544
EPA METHOD 8021B: VOLATILES							Analyst: CCM
Benzene	ND	0.025		mg/Kg	1	11/19/2022 2:56:00 AM	71544
Toluene	ND	0.050		mg/Kg	1	11/19/2022 2:56:00 AM	71544
Ethylbenzene	ND	0.050		mg/Kg	1	11/19/2022 2:56:00 AM	71544
Xylenes, Total	ND	0.099		mg/Kg	1	11/19/2022 2:56:00 AM	71544
Surr: 4-Bromofluorobenzene	125	70-130		%Rec	1	11/19/2022 2:56:00 AM	71544

Refer to the QC Summary report and sample login checklist for flagged QC data and preservation information.

Qualifiers:	*	Value exceeds Maximum Contaminant Level.	B	Analyte detected in the associated Method Blank
	D	Sample Diluted Due to Matrix	E	Above Quantitation Range/Estimated Value
	H	Holding times for preparation or analysis exceeded	J	Analyte detected below quantitation limits
	ND	Not Detected at the Reporting Limit	P	Sample pH Not In Range
	PQL	Practical Quantitative Limit	RL	Reporting Limit
	S	% Recovery outside of standard limits. If undiluted results may be estimated.		

Page 3 of 23

Analytical Report

Lab Order 2211801

Date Reported: 11/30/2022

Hall Environmental Analysis Laboratory, Inc.

CLIENT: EOG

Client Sample ID: S-4

Project: Federal CM 1

Collection Date: 11/11/2022 10:06:00 AM

Lab ID: 2211801-004

Matrix: SOIL

Received Date: 11/15/2022 7:30:00 AM

Analyses	Result	RL	Qual	Units	DF	Date Analyzed	Batch
EPA METHOD 300.0: ANIONS							Analyst: JTT
Chloride	620	60		mg/Kg	20	11/21/2022 3:53:45 PM	71616
EPA METHOD 8015M/D: DIESEL RANGE ORGANICS							Analyst: DGH
Diesel Range Organics (DRO)	ND	14		mg/Kg	1	11/17/2022 4:05:43 PM	71554
Motor Oil Range Organics (MRO)	ND	46		mg/Kg	1	11/17/2022 4:05:43 PM	71554
Surr: DNOP	73.6	21-129		%Rec	1	11/17/2022 4:05:43 PM	71554
EPA METHOD 8015D: GASOLINE RANGE							Analyst: CCM
Gasoline Range Organics (GRO)	ND	4.7		mg/Kg	1	11/19/2022 3:16:00 AM	71544
Surr: BFB	107	37.7-212		%Rec	1	11/19/2022 3:16:00 AM	71544
EPA METHOD 8021B: VOLATILES							Analyst: CCM
Benzene	ND	0.024		mg/Kg	1	11/19/2022 3:16:00 AM	71544
Toluene	ND	0.047		mg/Kg	1	11/19/2022 3:16:00 AM	71544
Ethylbenzene	ND	0.047		mg/Kg	1	11/19/2022 3:16:00 AM	71544
Xylenes, Total	ND	0.095		mg/Kg	1	11/19/2022 3:16:00 AM	71544
Surr: 4-Bromofluorobenzene	126	70-130		%Rec	1	11/19/2022 3:16:00 AM	71544

Refer to the QC Summary report and sample login checklist for flagged QC data and preservation information.

Qualifiers:	*	Value exceeds Maximum Contaminant Level.	B	Analyte detected in the associated Method Blank
	D	Sample Diluted Due to Matrix	E	Above Quantitation Range/Estimated Value
	H	Holding times for preparation or analysis exceeded	J	Analyte detected below quantitation limits
	ND	Not Detected at the Reporting Limit	P	Sample pH Not In Range
	PQL	Practical Quantitative Limit	RL	Reporting Limit
	S	% Recovery outside of standard limits. If undiluted results may be estimated.		

Analytical Report

Lab Order 2211801

Date Reported: 11/30/2022

Hall Environmental Analysis Laboratory, Inc.

CLIENT: EOG

Client Sample ID: S-5

Project: Federal CM 1

Collection Date: 11/11/2022 10:08:00 AM

Lab ID: 2211801-005

Matrix: SOIL

Received Date: 11/15/2022 7:30:00 AM

Analyses	Result	RL	Qual	Units	DF	Date Analyzed	Batch
EPA METHOD 300.0: ANIONS							Analyst: JTT
Chloride	1400	60		mg/Kg	20	11/21/2022 4:06:05 PM	71616
EPA METHOD 8015M/D: DIESEL RANGE ORGANICS							Analyst: DGH
Diesel Range Organics (DRO)	ND	15		mg/Kg	1	11/18/2022 3:02:30 PM	71554
Motor Oil Range Organics (MRO)	ND	48		mg/Kg	1	11/18/2022 3:02:30 PM	71554
Surr: DNOP	84.2	21-129		%Rec	1	11/18/2022 3:02:30 PM	71554
EPA METHOD 8015D: GASOLINE RANGE							Analyst: CCM
Gasoline Range Organics (GRO)	ND	4.9		mg/Kg	1	11/19/2022 3:35:00 AM	71544
Surr: BFB	105	37.7-212		%Rec	1	11/19/2022 3:35:00 AM	71544
EPA METHOD 8021B: VOLATILES							Analyst: CCM
Benzene	ND	0.025		mg/Kg	1	11/19/2022 3:35:00 AM	71544
Toluene	ND	0.049		mg/Kg	1	11/19/2022 3:35:00 AM	71544
Ethylbenzene	ND	0.049		mg/Kg	1	11/19/2022 3:35:00 AM	71544
Xylenes, Total	ND	0.098		mg/Kg	1	11/19/2022 3:35:00 AM	71544
Surr: 4-Bromofluorobenzene	124	70-130		%Rec	1	11/19/2022 3:35:00 AM	71544

Refer to the QC Summary report and sample login checklist for flagged QC data and preservation information.

Qualifiers:	*	Value exceeds Maximum Contaminant Level.	B	Analyte detected in the associated Method Blank
	D	Sample Diluted Due to Matrix	E	Above Quantitation Range/Estimated Value
	H	Holding times for preparation or analysis exceeded	J	Analyte detected below quantitation limits
	ND	Not Detected at the Reporting Limit	P	Sample pH Not In Range
	PQL	Practical Quantitative Limit	RL	Reporting Limit
	S	% Recovery outside of standard limits. If undiluted results may be estimated.		

Page 5 of 23

Analytical Report

Lab Order 2211801

Date Reported: 11/30/2022

Hall Environmental Analysis Laboratory, Inc.

CLIENT: EOG

Client Sample ID: S-6

Project: Federal CM 1

Collection Date: 11/11/2022 10:10:00 AM

Lab ID: 2211801-006

Matrix: SOIL

Received Date: 11/15/2022 7:30:00 AM

Analyses	Result	RL	Qual	Units	DF	Date Analyzed	Batch
EPA METHOD 300.0: ANIONS							Analyst: JTT
Chloride	330	60		mg/Kg	20	11/21/2022 4:18:26 PM	71616
EPA METHOD 8015M/D: DIESEL RANGE ORGANICS							Analyst: DGH
Diesel Range Organics (DRO)	ND	14		mg/Kg	1	11/17/2022 4:26:51 PM	71554
Motor Oil Range Organics (MRO)	ND	47		mg/Kg	1	11/17/2022 4:26:51 PM	71554
Surr: DNOP	68.7	21-129		%Rec	1	11/17/2022 4:26:51 PM	71554
EPA METHOD 8015D: GASOLINE RANGE							Analyst: CCM
Gasoline Range Organics (GRO)	ND	4.8		mg/Kg	1	11/19/2022 3:55:00 AM	71544
Surr: BFB	102	37.7-212		%Rec	1	11/19/2022 3:55:00 AM	71544
EPA METHOD 8021B: VOLATILES							Analyst: CCM
Benzene	ND	0.024		mg/Kg	1	11/19/2022 3:55:00 AM	71544
Toluene	ND	0.048		mg/Kg	1	11/19/2022 3:55:00 AM	71544
Ethylbenzene	ND	0.048		mg/Kg	1	11/19/2022 3:55:00 AM	71544
Xylenes, Total	ND	0.095		mg/Kg	1	11/19/2022 3:55:00 AM	71544
Surr: 4-Bromofluorobenzene	128	70-130		%Rec	1	11/19/2022 3:55:00 AM	71544

Refer to the QC Summary report and sample login checklist for flagged QC data and preservation information.

Qualifiers:	*	Value exceeds Maximum Contaminant Level.	B	Analyte detected in the associated Method Blank
	D	Sample Diluted Due to Matrix	E	Above Quantitation Range/Estimated Value
	H	Holding times for preparation or analysis exceeded	J	Analyte detected below quantitation limits
	ND	Not Detected at the Reporting Limit	P	Sample pH Not In Range
	PQL	Practical Quantitative Limit	RL	Reporting Limit
	S	% Recovery outside of standard limits. If undiluted results may be estimated.		

Page 6 of 23

Analytical Report

Lab Order 2211801

Date Reported: 11/30/2022

Hall Environmental Analysis Laboratory, Inc.

CLIENT: EOG

Client Sample ID: S-7

Project: Federal CM 1

Collection Date: 11/11/2022 10:12:00 AM

Lab ID: 2211801-007

Matrix: SOIL

Received Date: 11/15/2022 7:30:00 AM

Analyses	Result	RL	Qual	Units	DF	Date Analyzed	Batch
EPA METHOD 300.0: ANIONS							Analyst: JTT
Chloride	1800	60		mg/Kg	20	11/21/2022 4:30:47 PM	71616
EPA METHOD 8015M/D: DIESEL RANGE ORGANICS							Analyst: DGH
Diesel Range Organics (DRO)	15	14		mg/Kg	1	11/17/2022 4:37:23 PM	71554
Motor Oil Range Organics (MRO)	ND	47		mg/Kg	1	11/17/2022 4:37:23 PM	71554
Surr: DNOP	78.5	21-129		%Rec	1	11/17/2022 4:37:23 PM	71554
EPA METHOD 8015D: GASOLINE RANGE							Analyst: CCM
Gasoline Range Organics (GRO)	ND	4.6		mg/Kg	1	11/19/2022 4:15:00 AM	71544
Surr: BFB	110	37.7-212		%Rec	1	11/19/2022 4:15:00 AM	71544
EPA METHOD 8021B: VOLATILES							Analyst: CCM
Benzene	ND	0.023		mg/Kg	1	11/19/2022 4:15:00 AM	71544
Toluene	ND	0.046		mg/Kg	1	11/19/2022 4:15:00 AM	71544
Ethylbenzene	ND	0.046		mg/Kg	1	11/19/2022 4:15:00 AM	71544
Xylenes, Total	ND	0.093		mg/Kg	1	11/19/2022 4:15:00 AM	71544
Surr: 4-Bromofluorobenzene	132	70-130	S	%Rec	1	11/19/2022 4:15:00 AM	71544

Refer to the QC Summary report and sample login checklist for flagged QC data and preservation information.

Qualifiers:	*	Value exceeds Maximum Contaminant Level.	B	Analyte detected in the associated Method Blank
	D	Sample Diluted Due to Matrix	E	Above Quantitation Range/Estimated Value
	H	Holding times for preparation or analysis exceeded	J	Analyte detected below quantitation limits
	ND	Not Detected at the Reporting Limit	P	Sample pH Not In Range
	PQL	Practical Quantitative Limit	RL	Reporting Limit
	S	% Recovery outside of standard limits. If undiluted results may be estimated.		

Page 7 of 23

Analytical Report

Lab Order 2211801

Date Reported: 11/30/2022

Hall Environmental Analysis Laboratory, Inc.

CLIENT: EOG

Client Sample ID: S-8

Project: Federal CM 1

Collection Date: 11/11/2022 10:14:00 AM

Lab ID: 2211801-008

Matrix: SOIL

Received Date: 11/15/2022 7:30:00 AM

Analyses	Result	RL	Qual	Units	DF	Date Analyzed	Batch
EPA METHOD 300.0: ANIONS							Analyst: JTT
Chloride	1900	60		mg/Kg	20	11/21/2022 5:20:09 PM	71616
EPA METHOD 8015M/D: DIESEL RANGE ORGANICS							Analyst: DGH
Diesel Range Organics (DRO)	ND	14		mg/Kg	1	11/17/2022 4:47:54 PM	71554
Motor Oil Range Organics (MRO)	ND	45		mg/Kg	1	11/17/2022 4:47:54 PM	71554
Surr: DNOP	71.0	21-129		%Rec	1	11/17/2022 4:47:54 PM	71554
EPA METHOD 8015D: GASOLINE RANGE							Analyst: CCM
Gasoline Range Organics (GRO)	ND	4.9		mg/Kg	1	11/19/2022 4:35:00 AM	71544
Surr: BFB	106	37.7-212		%Rec	1	11/19/2022 4:35:00 AM	71544
EPA METHOD 8021B: VOLATILES							Analyst: CCM
Benzene	ND	0.024		mg/Kg	1	11/19/2022 4:35:00 AM	71544
Toluene	ND	0.049		mg/Kg	1	11/19/2022 4:35:00 AM	71544
Ethylbenzene	ND	0.049		mg/Kg	1	11/19/2022 4:35:00 AM	71544
Xylenes, Total	ND	0.097		mg/Kg	1	11/19/2022 4:35:00 AM	71544
Surr: 4-Bromofluorobenzene	129	70-130		%Rec	1	11/19/2022 4:35:00 AM	71544

Refer to the QC Summary report and sample login checklist for flagged QC data and preservation information.

Qualifiers:	*	Value exceeds Maximum Contaminant Level.	B	Analyte detected in the associated Method Blank
	D	Sample Diluted Due to Matrix	E	Above Quantitation Range/Estimated Value
	H	Holding times for preparation or analysis exceeded	J	Analyte detected below quantitation limits
	ND	Not Detected at the Reporting Limit	P	Sample pH Not In Range
	PQL	Practical Quantitative Limit	RL	Reporting Limit
	S	% Recovery outside of standard limits. If undiluted results may be estimated.		

Page 8 of 23

Analytical Report

Lab Order 2211801

Date Reported: 11/30/2022

Hall Environmental Analysis Laboratory, Inc.

CLIENT: EOG

Client Sample ID: S-9

Project: Federal CM 1

Collection Date: 11/11/2022 10:16:00 AM

Lab ID: 2211801-009

Matrix: SOIL

Received Date: 11/15/2022 7:30:00 AM

Analyses	Result	RL	Qual	Units	DF	Date Analyzed	Batch
EPA METHOD 300.0: ANIONS							Analyst: NAI
Chloride	3800	150		mg/Kg	50	11/22/2022 2:41:35 PM	71616
EPA METHOD 8015M/D: DIESEL RANGE ORGANICS							Analyst: DGH
Diesel Range Organics (DRO)	ND	14		mg/Kg	1	11/17/2022 4:58:25 PM	71554
Motor Oil Range Organics (MRO)	ND	48		mg/Kg	1	11/17/2022 4:58:25 PM	71554
Surr: DNOP	73.9	21-129		%Rec	1	11/17/2022 4:58:25 PM	71554
EPA METHOD 8015D: GASOLINE RANGE							Analyst: CCM
Gasoline Range Organics (GRO)	ND	4.9		mg/Kg	1	11/19/2022 4:55:00 AM	71544
Surr: BFB	107	37.7-212		%Rec	1	11/19/2022 4:55:00 AM	71544
EPA METHOD 8021B: VOLATILES							Analyst: CCM
Benzene	ND	0.024		mg/Kg	1	11/19/2022 4:55:00 AM	71544
Toluene	ND	0.049		mg/Kg	1	11/19/2022 4:55:00 AM	71544
Ethylbenzene	ND	0.049		mg/Kg	1	11/19/2022 4:55:00 AM	71544
Xylenes, Total	ND	0.097		mg/Kg	1	11/19/2022 4:55:00 AM	71544
Surr: 4-Bromofluorobenzene	134	70-130	S	%Rec	1	11/19/2022 4:55:00 AM	71544

Refer to the QC Summary report and sample login checklist for flagged QC data and preservation information.

Qualifiers:	*	Value exceeds Maximum Contaminant Level.	B	Analyte detected in the associated Method Blank
	D	Sample Diluted Due to Matrix	E	Above Quantitation Range/Estimated Value
	H	Holding times for preparation or analysis exceeded	J	Analyte detected below quantitation limits
	ND	Not Detected at the Reporting Limit	P	Sample pH Not In Range
	PQL	Practical Quantitative Limit	RL	Reporting Limit
	S	% Recovery outside of standard limits. If undiluted results may be estimated.		

Analytical Report

Lab Order 2211801

Date Reported: 11/30/2022

Hall Environmental Analysis Laboratory, Inc.

CLIENT: EOG

Client Sample ID: S-10

Project: Federal CM 1

Collection Date: 11/11/2022 10:18:00 AM

Lab ID: 2211801-010

Matrix: SOIL

Received Date: 11/15/2022 7:30:00 AM

Analyses	Result	RL	Qual	Units	DF	Date Analyzed	Batch
EPA METHOD 300.0: ANIONS							Analyst: JTT
Chloride	1500	60		mg/Kg	20	11/21/2022 5:44:52 PM	71616
EPA METHOD 8015M/D: DIESEL RANGE ORGANICS							Analyst: DGH
Diesel Range Organics (DRO)	ND	14		mg/Kg	1	11/17/2022 5:08:54 PM	71554
Motor Oil Range Organics (MRO)	ND	47		mg/Kg	1	11/17/2022 5:08:54 PM	71554
Surr: DNOP	79.5	21-129		%Rec	1	11/17/2022 5:08:54 PM	71554
EPA METHOD 8015D: GASOLINE RANGE							Analyst: CCM
Gasoline Range Organics (GRO)	ND	5.0		mg/Kg	1	11/19/2022 5:14:00 AM	71544
Surr: BFB	110	37.7-212		%Rec	1	11/19/2022 5:14:00 AM	71544
EPA METHOD 8021B: VOLATILES							Analyst: CCM
Benzene	ND	0.025		mg/Kg	1	11/19/2022 5:14:00 AM	71544
Toluene	ND	0.050		mg/Kg	1	11/19/2022 5:14:00 AM	71544
Ethylbenzene	ND	0.050		mg/Kg	1	11/19/2022 5:14:00 AM	71544
Xylenes, Total	ND	0.099		mg/Kg	1	11/19/2022 5:14:00 AM	71544
Surr: 4-Bromofluorobenzene	133	70-130	S	%Rec	1	11/19/2022 5:14:00 AM	71544

Refer to the QC Summary report and sample login checklist for flagged QC data and preservation information.

Qualifiers:	*	Value exceeds Maximum Contaminant Level.	B	Analyte detected in the associated Method Blank
	D	Sample Diluted Due to Matrix	E	Above Quantitation Range/Estimated Value
	H	Holding times for preparation or analysis exceeded	J	Analyte detected below quantitation limits
	ND	Not Detected at the Reporting Limit	P	Sample pH Not In Range
	PQL	Practical Quantitative Limit	RL	Reporting Limit
	S	% Recovery outside of standard limits. If undiluted results may be estimated.		

Page 10 of 23

Analytical Report

Lab Order 2211801

Date Reported: 11/30/2022

Hall Environmental Analysis Laboratory, Inc.

CLIENT: EOG

Client Sample ID: S-11

Project: Federal CM 1

Collection Date: 11/11/2022 10:20:00 AM

Lab ID: 2211801-011

Matrix: SOIL

Received Date: 11/15/2022 7:30:00 AM

Analyses	Result	RL	Qual	Units	DF	Date Analyzed	Batch
EPA METHOD 300.0: ANIONS							Analyst: NAI
Chloride	2200	150		mg/Kg	50	11/22/2022 2:53:59 PM	71616
EPA METHOD 8015M/D: DIESEL RANGE ORGANICS							Analyst: DGH
Diesel Range Organics (DRO)	ND	14		mg/Kg	1	11/17/2022 5:19:28 PM	71554
Motor Oil Range Organics (MRO)	ND	48		mg/Kg	1	11/17/2022 5:19:28 PM	71554
Surr: DNOP	72.1	21-129		%Rec	1	11/17/2022 5:19:28 PM	71554
EPA METHOD 8015D: GASOLINE RANGE							Analyst: CCM
Gasoline Range Organics (GRO)	ND	4.9		mg/Kg	1	11/19/2022 5:34:00 AM	71544
Surr: BFB	106	37.7-212		%Rec	1	11/19/2022 5:34:00 AM	71544
EPA METHOD 8021B: VOLATILES							Analyst: CCM
Benzene	ND	0.024		mg/Kg	1	11/19/2022 5:34:00 AM	71544
Toluene	ND	0.049		mg/Kg	1	11/19/2022 5:34:00 AM	71544
Ethylbenzene	ND	0.049		mg/Kg	1	11/19/2022 5:34:00 AM	71544
Xylenes, Total	ND	0.098		mg/Kg	1	11/19/2022 5:34:00 AM	71544
Surr: 4-Bromofluorobenzene	128	70-130		%Rec	1	11/19/2022 5:34:00 AM	71544

Refer to the QC Summary report and sample login checklist for flagged QC data and preservation information.

Qualifiers:	*	Value exceeds Maximum Contaminant Level.	B	Analyte detected in the associated Method Blank
	D	Sample Diluted Due to Matrix	E	Above Quantitation Range/Estimated Value
	H	Holding times for preparation or analysis exceeded	J	Analyte detected below quantitation limits
	ND	Not Detected at the Reporting Limit	P	Sample pH Not In Range
	PQL	Practical Quantitative Limit	RL	Reporting Limit
	S	% Recovery outside of standard limits. If undiluted results may be estimated.		

Analytical Report

Lab Order 2211801

Date Reported: 11/30/2022

Hall Environmental Analysis Laboratory, Inc.

CLIENT: EOG

Client Sample ID: SW-1

Project: Federal CM 1

Collection Date: 11/11/2022 11:00:00 AM

Lab ID: 2211801-012

Matrix: SOIL

Received Date: 11/15/2022 7:30:00 AM

Analyses	Result	RL	Qual	Units	DF	Date Analyzed	Batch
EPA METHOD 300.0: ANIONS							Analyst: JTT
Chloride	81	60		mg/Kg	20	11/19/2022 3:56:34 PM	71602
EPA METHOD 8015M/D: DIESEL RANGE ORGANICS							Analyst: DGH
Diesel Range Organics (DRO)	ND	14		mg/Kg	1	11/18/2022 10:40:39 PM	71576
Motor Oil Range Organics (MRO)	ND	48		mg/Kg	1	11/18/2022 10:40:39 PM	71576
Surr: DNOP	99.4	21-129		%Rec	1	11/18/2022 10:40:39 PM	71576
EPA METHOD 8015D: GASOLINE RANGE							Analyst: CCM
Gasoline Range Organics (GRO)	ND	5.0		mg/Kg	1	11/19/2022 7:33:00 AM	71547
Surr: BFB	100	37.7-212		%Rec	1	11/19/2022 7:33:00 AM	71547
EPA METHOD 8021B: VOLATILES							Analyst: CCM
Benzene	ND	0.025		mg/Kg	1	11/21/2022 10:20:00 AM	71547
Toluene	ND	0.050		mg/Kg	1	11/21/2022 10:20:00 AM	71547
Ethylbenzene	ND	0.050		mg/Kg	1	11/21/2022 10:20:00 AM	71547
Xylenes, Total	ND	0.10		mg/Kg	1	11/21/2022 10:20:00 AM	71547
Surr: 4-Bromofluorobenzene	140	70-130	S	%Rec	1	11/21/2022 10:20:00 AM	71547

Refer to the QC Summary report and sample login checklist for flagged QC data and preservation information.

Qualifiers:	*	Value exceeds Maximum Contaminant Level.	B	Analyte detected in the associated Method Blank
	D	Sample Diluted Due to Matrix	E	Above Quantitation Range/Estimated Value
	H	Holding times for preparation or analysis exceeded	J	Analyte detected below quantitation limits
	ND	Not Detected at the Reporting Limit	P	Sample pH Not In Range
	PQL	Practical Quantitative Limit	RL	Reporting Limit
	S	% Recovery outside of standard limits. If undiluted results may be estimated.		

Page 12 of 23

Analytical Report

Lab Order 2211801

Date Reported: 11/30/2022

Hall Environmental Analysis Laboratory, Inc.

CLIENT: EOG

Client Sample ID: SW-2

Project: Federal CM 1

Collection Date: 11/11/2022 11:02:00 AM

Lab ID: 2211801-013

Matrix: SOIL

Received Date: 11/15/2022 7:30:00 AM

Analyses	Result	RL	Qual	Units	DF	Date Analyzed	Batch
EPA METHOD 300.0: ANIONS							Analyst: JTT
Chloride	ND	60		mg/Kg	20	11/19/2022 4:33:49 PM	71602
EPA METHOD 8015M/D: DIESEL RANGE ORGANICS							Analyst: DGH
Diesel Range Organics (DRO)	ND	15		mg/Kg	1	11/18/2022 11:12:33 PM	71576
Motor Oil Range Organics (MRO)	ND	49		mg/Kg	1	11/18/2022 11:12:33 PM	71576
Surr: DNOP	82.1	21-129		%Rec	1	11/18/2022 11:12:33 PM	71576
EPA METHOD 8015D: GASOLINE RANGE							Analyst: CCM
Gasoline Range Organics (GRO)	ND	5.0		mg/Kg	1	11/19/2022 8:32:00 AM	71547
Surr: BFB	107	37.7-212		%Rec	1	11/19/2022 8:32:00 AM	71547
EPA METHOD 8021B: VOLATILES							Analyst: CCM
Benzene	ND	0.025		mg/Kg	1	11/21/2022 10:40:00 AM	71547
Toluene	ND	0.050		mg/Kg	1	11/21/2022 10:40:00 AM	71547
Ethylbenzene	ND	0.050		mg/Kg	1	11/21/2022 10:40:00 AM	71547
Xylenes, Total	ND	0.10		mg/Kg	1	11/21/2022 10:40:00 AM	71547
Surr: 4-Bromofluorobenzene	140	70-130	S	%Rec	1	11/21/2022 10:40:00 AM	71547

Refer to the QC Summary report and sample login checklist for flagged QC data and preservation information.

Qualifiers:	*	Value exceeds Maximum Contaminant Level.	B	Analyte detected in the associated Method Blank
	D	Sample Diluted Due to Matrix	E	Above Quantitation Range/Estimated Value
	H	Holding times for preparation or analysis exceeded	J	Analyte detected below quantitation limits
	ND	Not Detected at the Reporting Limit	P	Sample pH Not In Range
	PQL	Practical Quantitative Limit	RL	Reporting Limit
	S	% Recovery outside of standard limits. If undiluted results may be estimated.		

Page 13 of 23

Analytical Report

Lab Order 2211801

Date Reported: 11/30/2022

Hall Environmental Analysis Laboratory, Inc.

CLIENT: EOG

Client Sample ID: SW-3

Project: Federal CM 1

Collection Date: 11/11/2022 11:04:00 AM

Lab ID: 2211801-014

Matrix: SOIL

Received Date: 11/15/2022 7:30:00 AM

Analyses	Result	RL	Qual	Units	DF	Date Analyzed	Batch
EPA METHOD 300.0: ANIONS							Analyst: JTT
Chloride	560	60		mg/Kg	20	11/19/2022 4:46:13 PM	71602
EPA METHOD 8015M/D: DIESEL RANGE ORGANICS							Analyst: DGH
Diesel Range Organics (DRO)	ND	15		mg/Kg	1	11/18/2022 11:23:08 PM	71576
Motor Oil Range Organics (MRO)	ND	50		mg/Kg	1	11/18/2022 11:23:08 PM	71576
Surr: DNOP	87.5	21-129		%Rec	1	11/18/2022 11:23:08 PM	71576
EPA METHOD 8015D: GASOLINE RANGE							Analyst: CCM
Gasoline Range Organics (GRO)	ND	4.9		mg/Kg	1	11/19/2022 9:32:00 AM	71547
Surr: BFB	110	37.7-212		%Rec	1	11/19/2022 9:32:00 AM	71547
EPA METHOD 8021B: VOLATILES							Analyst: CCM
Benzene	ND	0.025		mg/Kg	1	11/21/2022 11:39:00 AM	71547
Toluene	ND	0.049		mg/Kg	1	11/21/2022 11:39:00 AM	71547
Ethylbenzene	ND	0.049		mg/Kg	1	11/21/2022 11:39:00 AM	71547
Xylenes, Total	ND	0.099		mg/Kg	1	11/21/2022 11:39:00 AM	71547
Surr: 4-Bromofluorobenzene	140	70-130	S	%Rec	1	11/21/2022 11:39:00 AM	71547

Refer to the QC Summary report and sample login checklist for flagged QC data and preservation information.

Qualifiers:	*	Value exceeds Maximum Contaminant Level.	B	Analyte detected in the associated Method Blank
	D	Sample Diluted Due to Matrix	E	Above Quantitation Range/Estimated Value
	H	Holding times for preparation or analysis exceeded	J	Analyte detected below quantitation limits
	ND	Not Detected at the Reporting Limit	P	Sample pH Not In Range
	PQL	Practical Quantitative Limit	RL	Reporting Limit
	S	% Recovery outside of standard limits. If undiluted results may be estimated.		

Page 14 of 23

Analytical Report

Lab Order 2211801

Date Reported: 11/30/2022

Hall Environmental Analysis Laboratory, Inc.

CLIENT: EOG

Client Sample ID: SW-4

Project: Federal CM 1

Collection Date: 11/11/2022 11:06:00 AM

Lab ID: 2211801-015

Matrix: SOIL

Received Date: 11/15/2022 7:30:00 AM

Analyses	Result	RL	Qual	Units	DF	Date Analyzed	Batch
EPA METHOD 300.0: ANIONS							Analyst: JMT
Chloride	770	60		mg/Kg	20	11/21/2022 12:26:31 PM	71606
EPA METHOD 8015M/D: DIESEL RANGE ORGANICS							Analyst: DGH
Diesel Range Organics (DRO)	ND	14		mg/Kg	1	11/18/2022 11:33:42 PM	71576
Motor Oil Range Organics (MRO)	ND	48		mg/Kg	1	11/18/2022 11:33:42 PM	71576
Surr: DNOP	79.2	21-129		%Rec	1	11/18/2022 11:33:42 PM	71576
EPA METHOD 8015D: GASOLINE RANGE							Analyst: CCM
Gasoline Range Organics (GRO)	ND	4.9		mg/Kg	1	11/19/2022 9:51:00 AM	71547
Surr: BFB	110	37.7-212		%Rec	1	11/19/2022 9:51:00 AM	71547
EPA METHOD 8021B: VOLATILES							Analyst: CCM
Benzene	ND	0.024		mg/Kg	1	11/21/2022 11:59:00 AM	71547
Toluene	ND	0.049		mg/Kg	1	11/21/2022 11:59:00 AM	71547
Ethylbenzene	ND	0.049		mg/Kg	1	11/21/2022 11:59:00 AM	71547
Xylenes, Total	ND	0.097		mg/Kg	1	11/21/2022 11:59:00 AM	71547
Surr: 4-Bromofluorobenzene	139	70-130	S	%Rec	1	11/21/2022 11:59:00 AM	71547

Refer to the QC Summary report and sample login checklist for flagged QC data and preservation information.

Qualifiers:	*	Value exceeds Maximum Contaminant Level.	B	Analyte detected in the associated Method Blank
	D	Sample Diluted Due to Matrix	E	Above Quantitation Range/Estimated Value
	H	Holding times for preparation or analysis exceeded	J	Analyte detected below quantitation limits
	ND	Not Detected at the Reporting Limit	P	Sample pH Not In Range
	PQL	Practical Quantitative Limit	RL	Reporting Limit
	S	% Recovery outside of standard limits. If undiluted results may be estimated.		

Page 15 of 23

Analytical Report

Lab Order 2211801

Date Reported: 11/30/2022

Hall Environmental Analysis Laboratory, Inc.

CLIENT: EOG

Client Sample ID: NW-1

Project: Federal CM 1

Collection Date: 11/11/2022 1:30:00 PM

Lab ID: 2211801-016

Matrix: SOIL

Received Date: 11/15/2022 7:30:00 AM

Analyses	Result	RL	Qual	Units	DF	Date Analyzed	Batch
EPA METHOD 300.0: ANIONS							Analyst: JMT
Chloride	410	59		mg/Kg	20	11/21/2022 12:38:56 PM	71606
EPA METHOD 8015M/D: DIESEL RANGE ORGANICS							Analyst: DGH
Diesel Range Organics (DRO)	ND	14		mg/Kg	1	11/18/2022 11:44:16 PM	71576
Motor Oil Range Organics (MRO)	ND	46		mg/Kg	1	11/18/2022 11:44:16 PM	71576
Surr: DNOP	75.8	21-129		%Rec	1	11/18/2022 11:44:16 PM	71576
EPA METHOD 8015D: GASOLINE RANGE							Analyst: CCM
Gasoline Range Organics (GRO)	ND	5.0		mg/Kg	1	11/19/2022 10:11:00 AM	71547
Surr: BFB	106	37.7-212		%Rec	1	11/19/2022 10:11:00 AM	71547
EPA METHOD 8021B: VOLATILES							Analyst: CCM
Benzene	ND	0.025		mg/Kg	1	11/21/2022 12:19:00 PM	71547
Toluene	ND	0.050		mg/Kg	1	11/21/2022 12:19:00 PM	71547
Ethylbenzene	ND	0.050		mg/Kg	1	11/21/2022 12:19:00 PM	71547
Xylenes, Total	ND	0.10		mg/Kg	1	11/21/2022 12:19:00 PM	71547
Surr: 4-Bromofluorobenzene	139	70-130	S	%Rec	1	11/21/2022 12:19:00 PM	71547

Refer to the QC Summary report and sample login checklist for flagged QC data and preservation information.

Qualifiers:	*	Value exceeds Maximum Contaminant Level.	B	Analyte detected in the associated Method Blank
	D	Sample Diluted Due to Matrix	E	Above Quantitation Range/Estimated Value
	H	Holding times for preparation or analysis exceeded	J	Analyte detected below quantitation limits
	ND	Not Detected at the Reporting Limit	P	Sample pH Not In Range
	PQL	Practical Quantitative Limit	RL	Reporting Limit
	S	% Recovery outside of standard limits. If undiluted results may be estimated.		

Page 16 of 23

Analytical Report

Lab Order 2211801

Date Reported: 11/30/2022

Hall Environmental Analysis Laboratory, Inc.

CLIENT: EOG

Client Sample ID: NW-2

Project: Federal CM 1

Collection Date: 11/11/2022 1:32:00 PM

Lab ID: 2211801-017

Matrix: SOIL

Received Date: 11/15/2022 7:30:00 AM

Analyses	Result	RL	Qual	Units	DF	Date Analyzed	Batch
EPA METHOD 300.0: ANIONS							Analyst: JMT
Chloride	230	60		mg/Kg	20	11/21/2022 1:16:09 PM	71606
EPA METHOD 8015M/D: DIESEL RANGE ORGANICS							Analyst: DGH
Diesel Range Organics (DRO)	ND	14		mg/Kg	1	11/19/2022 12:05:09 AM	71576
Motor Oil Range Organics (MRO)	ND	47		mg/Kg	1	11/19/2022 12:05:09 AM	71576
Surr: DNOP	75.1	21-129		%Rec	1	11/19/2022 12:05:09 AM	71576
EPA METHOD 8015D: GASOLINE RANGE							Analyst: CCM
Gasoline Range Organics (GRO)	ND	4.7		mg/Kg	1	11/19/2022 10:31:00 AM	71547
Surr: BFB	105	37.7-212		%Rec	1	11/19/2022 10:31:00 AM	71547
EPA METHOD 8021B: VOLATILES							Analyst: CCM
Benzene	ND	0.024		mg/Kg	1	11/21/2022 12:38:00 PM	71547
Toluene	ND	0.047		mg/Kg	1	11/21/2022 12:38:00 PM	71547
Ethylbenzene	ND	0.047		mg/Kg	1	11/21/2022 12:38:00 PM	71547
Xylenes, Total	ND	0.094		mg/Kg	1	11/21/2022 12:38:00 PM	71547
Surr: 4-Bromofluorobenzene	138	70-130	S	%Rec	1	11/21/2022 12:38:00 PM	71547

Refer to the QC Summary report and sample login checklist for flagged QC data and preservation information.

Qualifiers:	*	Value exceeds Maximum Contaminant Level.	B	Analyte detected in the associated Method Blank
	D	Sample Diluted Due to Matrix	E	Above Quantitation Range/Estimated Value
	H	Holding times for preparation or analysis exceeded	J	Analyte detected below quantitation limits
	ND	Not Detected at the Reporting Limit	P	Sample pH Not In Range
	PQL	Practical Quantitative Limit	RL	Reporting Limit
	S	% Recovery outside of standard limits. If undiluted results may be estimated.		

Page 17 of 23

Analytical Report

Lab Order 2211801

Date Reported: 11/30/2022

Hall Environmental Analysis Laboratory, Inc.

CLIENT: EOG

Client Sample ID: NW-3

Project: Federal CM 1

Collection Date: 11/11/2022 1:34:00 PM

Lab ID: 2211801-018

Matrix: SOIL

Received Date: 11/15/2022 7:30:00 AM

Analyses	Result	RL	Qual	Units	DF	Date Analyzed	Batch
EPA METHOD 300.0: ANIONS							Analyst: JMT
Chloride	220	60		mg/Kg	20	11/21/2022 1:28:34 PM	71606
EPA METHOD 8015M/D: DIESEL RANGE ORGANICS							Analyst: DGH
Diesel Range Organics (DRO)	ND	14		mg/Kg	1	11/19/2022 12:15:41 AM	71576
Motor Oil Range Organics (MRO)	ND	48		mg/Kg	1	11/19/2022 12:15:41 AM	71576
Surr: DNOP	73.6	21-129		%Rec	1	11/19/2022 12:15:41 AM	71576
EPA METHOD 8015D: GASOLINE RANGE							Analyst: CCM
Gasoline Range Organics (GRO)	ND	4.8		mg/Kg	1	11/19/2022 10:51:00 AM	71547
Surr: BFB	109	37.7-212		%Rec	1	11/19/2022 10:51:00 AM	71547
EPA METHOD 8021B: VOLATILES							Analyst: CCM
Benzene	ND	0.024		mg/Kg	1	11/21/2022 12:58:00 PM	71547
Toluene	ND	0.048		mg/Kg	1	11/21/2022 12:58:00 PM	71547
Ethylbenzene	ND	0.048		mg/Kg	1	11/21/2022 12:58:00 PM	71547
Xylenes, Total	ND	0.097		mg/Kg	1	11/21/2022 12:58:00 PM	71547
Surr: 4-Bromofluorobenzene	140	70-130	S	%Rec	1	11/21/2022 12:58:00 PM	71547

Refer to the QC Summary report and sample login checklist for flagged QC data and preservation information.

Qualifiers:	*	Value exceeds Maximum Contaminant Level.	B	Analyte detected in the associated Method Blank
	D	Sample Diluted Due to Matrix	E	Above Quantitation Range/Estimated Value
	H	Holding times for preparation or analysis exceeded	J	Analyte detected below quantitation limits
	ND	Not Detected at the Reporting Limit	P	Sample pH Not In Range
	PQL	Practical Quantitative Limit	RL	Reporting Limit
	S	% Recovery outside of standard limits. If undiluted results may be estimated.		

Page 18 of 23

Analytical Report

Lab Order 2211801

Date Reported: 11/30/2022

Hall Environmental Analysis Laboratory, Inc.

CLIENT: EOG

Client Sample ID: NW-4

Project: Federal CM 1

Collection Date: 11/11/2022 1:36:00 PM

Lab ID: 2211801-019

Matrix: SOIL

Received Date: 11/15/2022 7:30:00 AM

Analyses	Result	RL	Qual	Units	DF	Date Analyzed	Batch
EPA METHOD 300.0: ANIONS							Analyst: JMT
Chloride	180	61		mg/Kg	20	11/21/2022 1:40:59 PM	71606
EPA METHOD 8015M/D: DIESEL RANGE ORGANICS							Analyst: DGH
Diesel Range Organics (DRO)	ND	14		mg/Kg	1	11/19/2022 12:26:11 AM	71576
Motor Oil Range Organics (MRO)	ND	47		mg/Kg	1	11/19/2022 12:26:11 AM	71576
Surr: DNOP	66.2	21-129		%Rec	1	11/19/2022 12:26:11 AM	71576
EPA METHOD 8015D: GASOLINE RANGE							Analyst: CCM
Gasoline Range Organics (GRO)	ND	4.8		mg/Kg	1	11/19/2022 11:11:00 AM	71547
Surr: BFB	106	37.7-212		%Rec	1	11/19/2022 11:11:00 AM	71547
EPA METHOD 8021B: VOLATILES							Analyst: CCM
Benzene	ND	0.024		mg/Kg	1	11/21/2022 1:18:00 PM	71547
Toluene	ND	0.048		mg/Kg	1	11/21/2022 1:18:00 PM	71547
Ethylbenzene	ND	0.048		mg/Kg	1	11/21/2022 1:18:00 PM	71547
Xylenes, Total	ND	0.096		mg/Kg	1	11/21/2022 1:18:00 PM	71547
Surr: 4-Bromofluorobenzene	137	70-130	S	%Rec	1	11/21/2022 1:18:00 PM	71547

Refer to the QC Summary report and sample login checklist for flagged QC data and preservation information.

Qualifiers:	*	Value exceeds Maximum Contaminant Level.	B	Analyte detected in the associated Method Blank
	D	Sample Diluted Due to Matrix	E	Above Quantitation Range/Estimated Value
	H	Holding times for preparation or analysis exceeded	J	Analyte detected below quantitation limits
	ND	Not Detected at the Reporting Limit	P	Sample pH Not In Range
	PQL	Practical Quantitative Limit	RL	Reporting Limit
	S	% Recovery outside of standard limits. If undiluted results may be estimated.		

QC SUMMARY REPORT**Hall Environmental Analysis Laboratory, Inc.**

WO#: 2211801

30-Nov-22

Client: EOG
Project: Federal CM 1

Sample ID: MB-71602	SampType: MBLK	TestCode: EPA Method 300.0: Anions								
Client ID: PBS	Batch ID: 71602	RunNo: 92733								
Prep Date: 11/18/2022	Analysis Date: 11/19/2022	SeqNo: 3337377	Units: mg/Kg							
Analyte	Result	PQL	SPK value	SPK Ref Val	%REC	LowLimit	HighLimit	%RPD	RPDLimit	Qual
Chloride	ND	1.5								

Sample ID: LCS-71602	SampType: LCS	TestCode: EPA Method 300.0: Anions								
Client ID: LCSS	Batch ID: 71602	RunNo: 92733								
Prep Date: 11/18/2022	Analysis Date: 11/19/2022	SeqNo: 3337378	Units: mg/Kg							
Analyte	Result	PQL	SPK value	SPK Ref Val	%REC	LowLimit	HighLimit	%RPD	RPDLimit	Qual
Chloride	14	1.5	15.00	0	95.4	90	110			

Sample ID: LCS-71616	SampType: LCS	TestCode: EPA Method 300.0: Anions								
Client ID: LCSS	Batch ID: 71616	RunNo: 92751								
Prep Date: 11/21/2022	Analysis Date: 11/21/2022	SeqNo: 3338145	Units: mg/Kg							
Analyte	Result	PQL	SPK value	SPK Ref Val	%REC	LowLimit	HighLimit	%RPD	RPDLimit	Qual
Chloride	14	1.5	15.00	0	91.2	90	110			

Sample ID: MB-71606	SampType: mblk	TestCode: EPA Method 300.0: Anions								
Client ID: PBS	Batch ID: 71606	RunNo: 92763								
Prep Date: 11/21/2022	Analysis Date: 11/21/2022	SeqNo: 3338670	Units: mg/Kg							
Analyte	Result	PQL	SPK value	SPK Ref Val	%REC	LowLimit	HighLimit	%RPD	RPDLimit	Qual
Chloride	ND	1.5								

Sample ID: LCS-71606	SampType: lcs	TestCode: EPA Method 300.0: Anions								
Client ID: LCSS	Batch ID: 71606	RunNo: 92763								
Prep Date: 11/21/2022	Analysis Date: 11/21/2022	SeqNo: 3338671	Units: mg/Kg							
Analyte	Result	PQL	SPK value	SPK Ref Val	%REC	LowLimit	HighLimit	%RPD	RPDLimit	Qual
Chloride	14	1.5	15.00	0	94.7	90	110			

Qualifiers:

* Value exceeds Maximum Contaminant Level.
D Sample Diluted Due to Matrix
H Holding times for preparation or analysis exceeded
ND Not Detected at the Reporting Limit
PQL Practical Quantitative Limit
S % Recovery outside of standard limits. If undiluted results may be estimated.

B Analyte detected in the associated Method Blank
E Above Quantitation Range/Estimated Value
J Analyte detected below quantitation limits
P Sample pH Not In Range
RL Reporting Limit

QC SUMMARY REPORT**Hall Environmental Analysis Laboratory, Inc.**

WO#: 2211801

30-Nov-22

Client: EOG
Project: Federal CM 1

Sample ID: LCS-71554	SampType: LCS			TestCode: EPA Method 8015M/D: Diesel Range Organics						
Client ID: LCSS	Batch ID: 71554			RunNo: 92653						
Prep Date: 11/16/2022	Analysis Date: 11/17/2022			SeqNo: 3334669			Units: mg/Kg			
Analyte	Result	PQL	SPK value	SPK Ref Val	%REC	LowLimit	HighLimit	%RPD	RPDLimit	Qual
Diesel Range Organics (DRO)	55	15	50.00	0	109	64.4	127			
Surr: DNOP	5.4		5.000		108	21	129			

Sample ID: MB-71554	SampType: MBLK			TestCode: EPA Method 8015M/D: Diesel Range Organics						
Client ID: PBS	Batch ID: 71554			RunNo: 92653						
Prep Date: 11/16/2022	Analysis Date: 11/17/2022			SeqNo: 3334671			Units: mg/Kg			
Analyte	Result	PQL	SPK value	SPK Ref Val	%REC	LowLimit	HighLimit	%RPD	RPDLimit	Qual
Diesel Range Organics (DRO)	ND	15								
Motor Oil Range Organics (MRO)	ND	50								
Surr: DNOP	10		10.00		99.7	21	129			

Sample ID: LCS-71576	SampType: LCS			TestCode: EPA Method 8015M/D: Diesel Range Organics						
Client ID: LCSS	Batch ID: 71576			RunNo: 92689						
Prep Date: 11/17/2022	Analysis Date: 11/18/2022			SeqNo: 3337333			Units: mg/Kg			
Analyte	Result	PQL	SPK value	SPK Ref Val	%REC	LowLimit	HighLimit	%RPD	RPDLimit	Qual
Diesel Range Organics (DRO)	44	15	50.00	0	88.8	64.4	127			
Surr: DNOP	5.4		5.000		108	21	129			

Sample ID: MB-71576	SampType: MBLK			TestCode: EPA Method 8015M/D: Diesel Range Organics						
Client ID: PBS	Batch ID: 71576			RunNo: 92689						
Prep Date: 11/17/2022	Analysis Date: 11/18/2022			SeqNo: 3337336			Units: mg/Kg			
Analyte	Result	PQL	SPK value	SPK Ref Val	%REC	LowLimit	HighLimit	%RPD	RPDLimit	Qual
Diesel Range Organics (DRO)	ND	15								
Motor Oil Range Organics (MRO)	ND	50								
Surr: DNOP	9.9		10.00		99.2	21	129			

Qualifiers:

* Value exceeds Maximum Contaminant Level.
D Sample Diluted Due to Matrix
H Holding times for preparation or analysis exceeded
ND Not Detected at the Reporting Limit
PQL Practical Quantitative Limit
S % Recovery outside of standard limits. If undiluted results may be estimated.

B Analyte detected in the associated Method Blank
E Above Quantitation Range/Estimated Value
J Analyte detected below quantitation limits
P Sample pH Not In Range
RL Reporting Limit

QC SUMMARY REPORT**Hall Environmental Analysis Laboratory, Inc.**

WO#: 2211801

30-Nov-22

Client: EOG
Project: Federal CM 1

Sample ID: lcs-71544	SampType: LCS			TestCode: EPA Method 8015D: Gasoline Range						
Client ID: LCSS	Batch ID: 71544			RunNo: 92710						
Prep Date: 11/16/2022	Analysis Date: 11/18/2022			SeqNo: 3335934		Units: mg/Kg				
Analyte	Result	PQL	SPK value	SPK Ref Val	%REC	LowLimit	HighLimit	%RPD	RPDLimit	Qual
Gasoline Range Organics (GRO)	25	5.0	25.00	0	101	72.3	137			
Surr: BFB	2300		1000		233	37.7	212			S

Sample ID: mb-71544	SampType: MBLK			TestCode: EPA Method 8015D: Gasoline Range						
Client ID: PBS	Batch ID: 71544			RunNo: 92710						
Prep Date: 11/16/2022	Analysis Date: 11/18/2022			SeqNo: 3335935		Units: mg/Kg				
Analyte	Result	PQL	SPK value	SPK Ref Val	%REC	LowLimit	HighLimit	%RPD	RPDLimit	Qual
Gasoline Range Organics (GRO)	ND	5.0								
Surr: BFB	1000		1000		103	37.7	212			

Sample ID: lcs-71547	SampType: LCS			TestCode: EPA Method 8015D: Gasoline Range						
Client ID: LCSS	Batch ID: 71547			RunNo: 92710						
Prep Date: 11/16/2022	Analysis Date: 11/19/2022			SeqNo: 3335981		Units: mg/Kg				
Analyte	Result	PQL	SPK value	SPK Ref Val	%REC	LowLimit	HighLimit	%RPD	RPDLimit	Qual
Gasoline Range Organics (GRO)	25	5.0	25.00	0	101	72.3	137			
Surr: BFB	2200		1000		225	37.7	212			S

Sample ID: mb-71547	SampType: MBLK			TestCode: EPA Method 8015D: Gasoline Range						
Client ID: PBS	Batch ID: 71547			RunNo: 92710						
Prep Date: 11/16/2022	Analysis Date: 11/19/2022			SeqNo: 3335982		Units: mg/Kg				
Analyte	Result	PQL	SPK value	SPK Ref Val	%REC	LowLimit	HighLimit	%RPD	RPDLimit	Qual
Gasoline Range Organics (GRO)	ND	5.0								
Surr: BFB	1000		1000		103	37.7	212			

Qualifiers:

* Value exceeds Maximum Contaminant Level.
D Sample Diluted Due to Matrix
H Holding times for preparation or analysis exceeded
ND Not Detected at the Reporting Limit
PQL Practical Quantitative Limit
S % Recovery outside of standard limits. If undiluted results may be estimated.

B Analyte detected in the associated Method Blank
E Above Quantitation Range/Estimated Value
J Analyte detected below quantitation limits
P Sample pH Not In Range
RL Reporting Limit

Page 22 of 23

QC SUMMARY REPORT**Hall Environmental Analysis Laboratory, Inc.**

WO#: 2211801

30-Nov-22

Client: EOG
Project: Federal CM 1

Sample ID: lcs-71544	SampType: LCS			TestCode: EPA Method 8021B: Volatiles						
Client ID: LCSS	Batch ID: 71544			RunNo: 92710						
Prep Date: 11/16/2022	Analysis Date: 11/18/2022			SeqNo: 3336246		Units: mg/Kg				
Analyte	Result	PQL	SPK value	SPK Ref Val	%REC	LowLimit	HighLimit	%RPD	RPDLimit	Qual
Benzene	1.2	0.025	1.000	0	124	80	120			S
Toluene	1.3	0.050	1.000	0	125	80	120			S
Ethylbenzene	1.3	0.050	1.000	0	127	80	120			S
Xylenes, Total	3.8	0.10	3.000	0	126	80	120			S
Surr: 4-Bromofluorobenzene	1.3		1.000		127	70	130			

Sample ID: mb-71544	SampType: MBLK			TestCode: EPA Method 8021B: Volatiles						
Client ID: PBS	Batch ID: 71544			RunNo: 92710						
Prep Date: 11/16/2022	Analysis Date: 11/18/2022			SeqNo: 3336247		Units: mg/Kg				
Analyte	Result	PQL	SPK value	SPK Ref Val	%REC	LowLimit	HighLimit	%RPD	RPDLimit	Qual
Benzene	ND	0.025								
Toluene	ND	0.050								
Ethylbenzene	ND	0.050								
Xylenes, Total	ND	0.10								
Surr: 4-Bromofluorobenzene	1.2		1.000		123	70	130			

Sample ID: lcs-71547	SampType: LCS			TestCode: EPA Method 8021B: Volatiles						
Client ID: LCSS	Batch ID: 71547			RunNo: 92755						
Prep Date: 11/16/2022	Analysis Date: 11/21/2022			SeqNo: 3338367		Units: mg/Kg				
Analyte	Result	PQL	SPK value	SPK Ref Val	%REC	LowLimit	HighLimit	%RPD	RPDLimit	Qual
Benzene	1.2	0.025	1.000	0	119	80	120			
Toluene	1.2	0.050	1.000	0	122	80	120			S
Ethylbenzene	1.2	0.050	1.000	0	122	80	120			S
Xylenes, Total	3.6	0.10	3.000	0	122	80	120			S
Surr: 4-Bromofluorobenzene	1.4		1.000		136	70	130			S

Sample ID: mb-71547	SampType: MBLK			TestCode: EPA Method 8021B: Volatiles						
Client ID: PBS	Batch ID: 71547			RunNo: 92755						
Prep Date: 11/16/2022	Analysis Date: 11/21/2022			SeqNo: 3338368		Units: mg/Kg				
Analyte	Result	PQL	SPK value	SPK Ref Val	%REC	LowLimit	HighLimit	%RPD	RPDLimit	Qual
Benzene	ND	0.025								
Toluene	ND	0.050								
Ethylbenzene	ND	0.050								
Xylenes, Total	ND	0.10								
Surr: 4-Bromofluorobenzene	1.4		1.000		141	70	130			S

Qualifiers:

* Value exceeds Maximum Contaminant Level.
D Sample Diluted Due to Matrix
H Holding times for preparation or analysis exceeded
ND Not Detected at the Reporting Limit
PQL Practical Quantitative Limit
S % Recovery outside of standard limits. If undiluted results may be estimated.

B Analyte detected in the associated Method Blank
E Above Quantitation Range/Estimated Value
J Analyte detected below quantitation limits
P Sample pH Not In Range
RL Reporting Limit

Page 23 of 23



Hall Environmental Analysis Laboratory
4901 Hawkins NE
Albuquerque, NM 87109
TEL: 505-345-3975 FAX: 505-345-4107
Website: www.hallenvironmental.com

Sample Log-In Check List

Client Name: EOG

Work Order Number: 2211801

RcptNo: 1

Received By: Juan Rojas 11/15/2022 7:30:00 AM

[Signature]

Completed By: Cheyenne Cason 11/15/2022 8:30:13 AM

[Signature]

Reviewed By: *[Signature]* 11-15-22

Chain of Custody

1. Is Chain of Custody complete? Yes ☒ No ☐ Not Present ☐

2. How was the sample delivered? Courier

Log In

3. Was an attempt made to cool the samples? Yes ☒ No ☐ NA ☐

4. Were all samples received at a temperature of >0° C to 6.0°C Yes ☒ No ☐ NA ☐

5. Sample(s) in proper container(s)? Yes ☒ No ☐

6. Sufficient sample volume for indicated test(s)? Yes ☒ No ☐

7. Are samples (except VOA and ONG) properly preserved? Yes ☒ No ☐

8. Was preservative added to bottles? Yes ☐ No ☒ NA ☐

9. Received at least 1 vial with headspace <1/4" for AQ VOA? Yes ☒ No ☐ NA ☐

10. Were any sample containers received broken? Yes ☐ No ☒

11. Does paperwork match bottle labels? Yes ☒ No ☐

(Note discrepancies on chain of custody)

12. Are matrices correctly identified on Chain of Custody? Yes ☒ No ☐

13. Is it clear what analyses were requested? Yes ☒ No ☐

14. Were all holding times able to be met? Yes ☒ No ☐

(If no, notify customer for authorization.)

of preserved
bottles checked
for pH:

(<2 or >12 unless noted)

Adjusted? ☐

Checked by: *[Signature]* 11/15/22

Special Handling (if applicable)

15. Was client notified of all discrepancies with this order? Yes ☐ No ☐ NA ☒

Person Notified:

Date:

By Whom:

Via: ☐ eMail ☐ Phone ☐ Fax ☐ In Person

Regarding:

Client Instructions:

16. Additional remarks:

17. Cooler Information

Cooler No	Temp °C	Condition	Seal Intact	Seal No	Seal Date	Signed By
1	0.3	Good	Not Present			

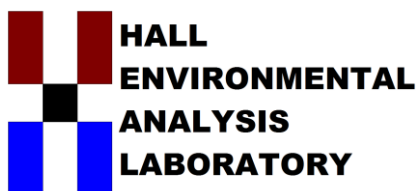

Hall Environmental Analysis Laboratory
4901 Hawkins NE
Albuquerque, NM 87109
TEL: 505-345-3975 FAX: 505-345-4107
Website: www.hallenvironmental.com

November 28, 2022

Will Kierdorf

EOG

105 South Fourth Street

Artesia, NM 88210

TEL:

FAX:

RE: Federal CM 1

OrderNo.: 2211B53

Dear Will Kierdorf:

Hall Environmental Analysis Laboratory received 14 sample(s) on 11/19/2022 for the analyses presented in the following report.

These were analyzed according to EPA procedures or equivalent. To access our accredited tests please go to www.hallenvironmental.com or the state specific web sites. In order to properly interpret your results, it is imperative that you review this report in its entirety. See the sample checklist and/or the Chain of Custody for information regarding the sample receipt temperature and preservation. Data qualifiers or a narrative will be provided if the sample analysis or analytical quality control parameters require a flag. When necessary, data qualifiers are provided on both the sample analysis report and the QC summary report, both sections should be reviewed. All samples are reported, as received, unless otherwise indicated. Lab measurement of analytes considered field parameters that require analysis within 15 minutes of sampling such as pH and residual chlorine are qualified as being analyzed outside of the recommended holding time.

Please don't hesitate to contact HEAL for any additional information or clarifications.

ADHS Cert #AZ0682 -- NMED-DWB Cert #NM9425 -- NMED-Micro Cert #NM0901

Sincerely,

A handwritten signature in black ink, appearing to read "Andy Freeman", is written over a light blue horizontal line.

Andy Freeman

Laboratory Manager

4901 Hawkins NE

Albuquerque, NM 87109

Analytical Report

Lab Order 2211B53

Date Reported: 11/28/2022

Hall Environmental Analysis Laboratory, Inc.

CLIENT: EOG

Client Sample ID: NB-1

Project: Federal CM 1

Collection Date: 11/16/2022 11:23:00 AM

Lab ID: 2211B53-001

Matrix: SOIL

Received Date: 11/19/2022 7:45:00 AM

Analyses	Result	RL	Qual	Units	DF	Date Analyzed	Batch
EPA METHOD 300.0: ANIONS							Analyst: JTT
Chloride	900	60		mg/Kg	20	11/22/2022 12:44:36 AM	71634
EPA METHOD 8015M/D: DIESEL RANGE ORGANICS							Analyst: DGH
Diesel Range Organics (DRO)	ND	15		mg/Kg	1	11/21/2022 5:29:45 PM	71614
Motor Oil Range Organics (MRO)	ND	49		mg/Kg	1	11/21/2022 5:29:45 PM	71614
Surr: DNOP	97.8	21-129		%Rec	1	11/21/2022 5:29:45 PM	71614
EPA METHOD 8015D: GASOLINE RANGE							Analyst: NSB
Gasoline Range Organics (GRO)	ND	6.9		mg/Kg	1	11/21/2022 12:01:10 PM	R92745
Surr: BFB	90.9	37.7-212		%Rec	1	11/21/2022 12:01:10 PM	R92745
EPA METHOD 8021B: VOLATILES							Analyst: NSB
Benzene	ND	0.035		mg/Kg	1	11/21/2022 12:01:10 PM	R92745
Toluene	ND	0.069		mg/Kg	1	11/21/2022 12:01:10 PM	R92745
Ethylbenzene	ND	0.069		mg/Kg	1	11/21/2022 12:01:10 PM	R92745
Xylenes, Total	ND	0.14		mg/Kg	1	11/21/2022 12:01:10 PM	R92745
Surr: 4-Bromofluorobenzene	96.1	70-130		%Rec	1	11/21/2022 12:01:10 PM	R92745

Refer to the QC Summary report and sample login checklist for flagged QC data and preservation information.

Qualifiers:	*	Value exceeds Maximum Contaminant Level.	B	Analyte detected in the associated Method Blank
	D	Sample Diluted Due to Matrix	E	Above Quantitation Range/Estimated Value
	H	Holding times for preparation or analysis exceeded	J	Analyte detected below quantitation limits
	ND	Not Detected at the Reporting Limit	P	Sample pH Not In Range
	PQL	Practical Quantitative Limit	RL	Reporting Limit
	S	% Recovery outside of standard limits. If undiluted results may be estimated.		

Page 1 of 18

Analytical Report

Lab Order 2211B53

Date Reported: 11/28/2022

Hall Environmental Analysis Laboratory, Inc.

CLIENT: EOG

Client Sample ID: NB-2

Project: Federal CM 1

Collection Date: 11/16/2022 11:25:00 AM

Lab ID: 2211B53-002

Matrix: SOIL

Received Date: 11/19/2022 7:45:00 AM

Analyses	Result	RL	Qual	Units	DF	Date Analyzed	Batch
EPA METHOD 300.0: ANIONS							Analyst: JTT
Chloride	940	60		mg/Kg	20	11/22/2022 1:21:39 AM	71634
EPA METHOD 8015M/D: DIESEL RANGE ORGANICS							Analyst: DGH
Diesel Range Organics (DRO)	ND	14		mg/Kg	1	11/21/2022 6:01:37 PM	71614
Motor Oil Range Organics (MRO)	ND	45		mg/Kg	1	11/21/2022 6:01:37 PM	71614
Surr: DNOP	97.4	21-129		%Rec	1	11/21/2022 6:01:37 PM	71614
EPA METHOD 8015D: GASOLINE RANGE							Analyst: NSB
Gasoline Range Organics (GRO)	ND	5.4		mg/Kg	1	11/21/2022 12:24:51 PM	R92745
Surr: BFB	93.0	37.7-212		%Rec	1	11/21/2022 12:24:51 PM	R92745
EPA METHOD 8021B: VOLATILES							Analyst: NSB
Benzene	ND	0.027		mg/Kg	1	11/21/2022 12:24:51 PM	R92745
Toluene	ND	0.054		mg/Kg	1	11/21/2022 12:24:51 PM	R92745
Ethylbenzene	ND	0.054		mg/Kg	1	11/21/2022 12:24:51 PM	R92745
Xylenes, Total	ND	0.11		mg/Kg	1	11/21/2022 12:24:51 PM	R92745
Surr: 4-Bromofluorobenzene	97.6	70-130		%Rec	1	11/21/2022 12:24:51 PM	R92745

Refer to the QC Summary report and sample login checklist for flagged QC data and preservation information.

Qualifiers:	*	Value exceeds Maximum Contaminant Level.	B	Analyte detected in the associated Method Blank
	D	Sample Diluted Due to Matrix	E	Above Quantitation Range/Estimated Value
	H	Holding times for preparation or analysis exceeded	J	Analyte detected below quantitation limits
	ND	Not Detected at the Reporting Limit	P	Sample pH Not In Range
	PQL	Practical Quantitative Limit	RL	Reporting Limit
	S	% Recovery outside of standard limits. If undiluted results may be estimated.		

Page 2 of 18

Analytical Report

Lab Order 2211B53

Date Reported: 11/28/2022

Hall Environmental Analysis Laboratory, Inc.

CLIENT: EOG

Client Sample ID: NB-3

Project: Federal CM 1

Collection Date: 11/16/2022 11:27:00 AM

Lab ID: 2211B53-003

Matrix: SOIL

Received Date: 11/19/2022 7:45:00 AM

Analyses	Result	RL	Qual	Units	DF	Date Analyzed	Batch
EPA METHOD 300.0: ANIONS							Analyst: JTT
Chloride	900	60		mg/Kg	20	11/22/2022 1:33:59 AM	71634
EPA METHOD 8015M/D: DIESEL RANGE ORGANICS							Analyst: DGH
Diesel Range Organics (DRO)	ND	14		mg/Kg	1	11/21/2022 6:22:35 PM	71614
Motor Oil Range Organics (MRO)	ND	45		mg/Kg	1	11/21/2022 6:22:35 PM	71614
Surr: DNOP	97.1	21-129		%Rec	1	11/21/2022 6:22:35 PM	71614
EPA METHOD 8015D: GASOLINE RANGE							Analyst: NSB
Gasoline Range Organics (GRO)	ND	5.0		mg/Kg	1	11/21/2022 12:48:28 PM	R92745
Surr: BFB	89.7	37.7-212		%Rec	1	11/21/2022 12:48:28 PM	R92745
EPA METHOD 8021B: VOLATILES							Analyst: NSB
Benzene	ND	0.025		mg/Kg	1	11/21/2022 12:48:28 PM	R92745
Toluene	ND	0.050		mg/Kg	1	11/21/2022 12:48:28 PM	R92745
Ethylbenzene	ND	0.050		mg/Kg	1	11/21/2022 12:48:28 PM	R92745
Xylenes, Total	ND	0.099		mg/Kg	1	11/21/2022 12:48:28 PM	R92745
Surr: 4-Bromofluorobenzene	92.8	70-130		%Rec	1	11/21/2022 12:48:28 PM	R92745

Refer to the QC Summary report and sample login checklist for flagged QC data and preservation information.

Qualifiers:	*	Value exceeds Maximum Contaminant Level.	B	Analyte detected in the associated Method Blank
	D	Sample Diluted Due to Matrix	E	Above Quantitation Range/Estimated Value
	H	Holding times for preparation or analysis exceeded	J	Analyte detected below quantitation limits
	ND	Not Detected at the Reporting Limit	P	Sample pH Not In Range
	PQL	Practical Quantitative Limit	RL	Reporting Limit
	S	% Recovery outside of standard limits. If undiluted results may be estimated.		

Page 3 of 18

Analytical Report

Lab Order 2211B53

Date Reported: 11/28/2022

Hall Environmental Analysis Laboratory, Inc.

CLIENT: EOG

Client Sample ID: NB-4

Project: Federal CM 1

Collection Date: 11/16/2022 11:29:00 AM

Lab ID: 2211B53-004

Matrix: SOIL

Received Date: 11/19/2022 7:45:00 AM

Analyses	Result	RL	Qual	Units	DF	Date Analyzed	Batch
EPA METHOD 300.0: ANIONS							Analyst: JTT
Chloride	460	60		mg/Kg	20	11/22/2022 1:46:21 AM	71634
EPA METHOD 8015M/D: DIESEL RANGE ORGANICS							Analyst: DGH
Diesel Range Organics (DRO)	ND	15		mg/Kg	1	11/21/2022 6:33:07 PM	71614
Motor Oil Range Organics (MRO)	ND	49		mg/Kg	1	11/21/2022 6:33:07 PM	71614
Surr: DNOP	99.2	21-129		%Rec	1	11/21/2022 6:33:07 PM	71614
EPA METHOD 8015D: GASOLINE RANGE							Analyst: NSB
Gasoline Range Organics (GRO)	ND	4.4		mg/Kg	1	11/21/2022 1:12:11 PM	R92745
Surr: BFB	87.0	37.7-212		%Rec	1	11/21/2022 1:12:11 PM	R92745
EPA METHOD 8021B: VOLATILES							Analyst: NSB
Benzene	ND	0.022		mg/Kg	1	11/21/2022 1:12:11 PM	R92745
Toluene	ND	0.044		mg/Kg	1	11/21/2022 1:12:11 PM	R92745
Ethylbenzene	ND	0.044		mg/Kg	1	11/21/2022 1:12:11 PM	R92745
Xylenes, Total	ND	0.087		mg/Kg	1	11/21/2022 1:12:11 PM	R92745
Surr: 4-Bromofluorobenzene	89.3	70-130		%Rec	1	11/21/2022 1:12:11 PM	R92745

Refer to the QC Summary report and sample login checklist for flagged QC data and preservation information.

Qualifiers:	*	Value exceeds Maximum Contaminant Level.	B	Analyte detected in the associated Method Blank
	D	Sample Diluted Due to Matrix	E	Above Quantitation Range/Estimated Value
	H	Holding times for preparation or analysis exceeded	J	Analyte detected below quantitation limits
	ND	Not Detected at the Reporting Limit	P	Sample pH Not In Range
	PQL	Practical Quantitative Limit	RL	Reporting Limit
	S	% Recovery outside of standard limits. If undiluted results may be estimated.		

Page 4 of 18

Analytical Report

Lab Order 2211B53

Date Reported: 11/28/2022

Hall Environmental Analysis Laboratory, Inc.

CLIENT: EOG

Client Sample ID: NB-5

Project: Federal CM 1

Collection Date: 11/16/2022 11:31:00 AM

Lab ID: 2211B53-005

Matrix: SOIL

Received Date: 11/19/2022 7:45:00 AM

Analyses	Result	RL	Qual	Units	DF	Date Analyzed	Batch
EPA METHOD 300.0: ANIONS							Analyst: JTT
Chloride	510	59		mg/Kg	20	11/22/2022 1:58:42 AM	71634
EPA METHOD 8015M/D: DIESEL RANGE ORGANICS							Analyst: DGH
Diesel Range Organics (DRO)	ND	14		mg/Kg	1	11/21/2022 6:43:38 PM	71614
Motor Oil Range Organics (MRO)	ND	47		mg/Kg	1	11/21/2022 6:43:38 PM	71614
Surr: DNOP	96.2	21-129		%Rec	1	11/21/2022 6:43:38 PM	71614
EPA METHOD 8015D: GASOLINE RANGE							Analyst: NSB
Gasoline Range Organics (GRO)	ND	4.6		mg/Kg	1	11/21/2022 1:35:47 PM	R92745
Surr: BFB	88.6	37.7-212		%Rec	1	11/21/2022 1:35:47 PM	R92745
EPA METHOD 8021B: VOLATILES							Analyst: NSB
Benzene	ND	0.023		mg/Kg	1	11/21/2022 1:35:47 PM	R92745
Toluene	ND	0.046		mg/Kg	1	11/21/2022 1:35:47 PM	R92745
Ethylbenzene	ND	0.046		mg/Kg	1	11/21/2022 1:35:47 PM	R92745
Xylenes, Total	ND	0.092		mg/Kg	1	11/21/2022 1:35:47 PM	R92745
Surr: 4-Bromofluorobenzene	91.6	70-130		%Rec	1	11/21/2022 1:35:47 PM	R92745

Refer to the QC Summary report and sample login checklist for flagged QC data and preservation information.

Qualifiers:	*	Value exceeds Maximum Contaminant Level.	B	Analyte detected in the associated Method Blank
	D	Sample Diluted Due to Matrix	E	Above Quantitation Range/Estimated Value
	H	Holding times for preparation or analysis exceeded	J	Analyte detected below quantitation limits
	ND	Not Detected at the Reporting Limit	P	Sample pH Not In Range
	PQL	Practical Quantitative Limit	RL	Reporting Limit
	S	% Recovery outside of standard limits. If undiluted results may be estimated.		

Page 5 of 18

Analytical Report

Lab Order 2211B53

Date Reported: 11/28/2022

Hall Environmental Analysis Laboratory, Inc.

CLIENT: EOG

Client Sample ID: NB-6

Project: Federal CM 1

Collection Date: 11/16/2022 11:33:00 AM

Lab ID: 2211B53-006

Matrix: SOIL

Received Date: 11/19/2022 7:45:00 AM

Analyses	Result	RL	Qual	Units	DF	Date Analyzed	Batch
EPA METHOD 300.0: ANIONS							Analyst: JTT
Chloride	600	60		mg/Kg	20	11/22/2022 2:11:03 AM	71634
EPA METHOD 8015M/D: DIESEL RANGE ORGANICS							Analyst: DGH
Diesel Range Organics (DRO)	ND	15		mg/Kg	1	11/21/2022 6:54:07 PM	71614
Motor Oil Range Organics (MRO)	ND	49		mg/Kg	1	11/21/2022 6:54:07 PM	71614
Surr: DNOP	100	21-129		%Rec	1	11/21/2022 6:54:07 PM	71614
EPA METHOD 8015D: GASOLINE RANGE							Analyst: NSB
Gasoline Range Organics (GRO)	ND	4.1		mg/Kg	1	11/21/2022 1:59:28 PM	R92745
Surr: BFB	88.3	37.7-212		%Rec	1	11/21/2022 1:59:28 PM	R92745
EPA METHOD 8021B: VOLATILES							Analyst: NSB
Benzene	ND	0.021		mg/Kg	1	11/21/2022 1:59:28 PM	R92745
Toluene	ND	0.041		mg/Kg	1	11/21/2022 1:59:28 PM	R92745
Ethylbenzene	ND	0.041		mg/Kg	1	11/21/2022 1:59:28 PM	R92745
Xylenes, Total	ND	0.083		mg/Kg	1	11/21/2022 1:59:28 PM	R92745
Surr: 4-Bromofluorobenzene	92.1	70-130		%Rec	1	11/21/2022 1:59:28 PM	R92745

Refer to the QC Summary report and sample login checklist for flagged QC data and preservation information.

Qualifiers:	*	Value exceeds Maximum Contaminant Level.	B	Analyte detected in the associated Method Blank
	D	Sample Diluted Due to Matrix	E	Above Quantitation Range/Estimated Value
	H	Holding times for preparation or analysis exceeded	J	Analyte detected below quantitation limits
	ND	Not Detected at the Reporting Limit	P	Sample pH Not In Range
	PQL	Practical Quantitative Limit	RL	Reporting Limit
	S	% Recovery outside of standard limits. If undiluted results may be estimated.		

Page 6 of 18

Analytical Report

Lab Order 2211B53

Date Reported: 11/28/2022

Hall Environmental Analysis Laboratory, Inc.

CLIENT: EOG

Client Sample ID: NB-7

Project: Federal CM 1

Collection Date: 11/16/2022 11:35:00 AM

Lab ID: 2211B53-007

Matrix: SOIL

Received Date: 11/19/2022 7:45:00 AM

Analyses	Result	RL	Qual	Units	DF	Date Analyzed	Batch
EPA METHOD 300.0: ANIONS							Analyst: JTT
Chloride	780	60		mg/Kg	20	11/22/2022 2:23:23 AM	71634
EPA METHOD 8015M/D: DIESEL RANGE ORGANICS							Analyst: DGH
Diesel Range Organics (DRO)	ND	14		mg/Kg	1	11/21/2022 7:04:35 PM	71614
Motor Oil Range Organics (MRO)	ND	47		mg/Kg	1	11/21/2022 7:04:35 PM	71614
Surr: DNOP	102	21-129		%Rec	1	11/21/2022 7:04:35 PM	71614
EPA METHOD 8015D: GASOLINE RANGE							Analyst: NSB
Gasoline Range Organics (GRO)	ND	3.9		mg/Kg	1	11/21/2022 2:23:08 PM	R92745
Surr: BFB	91.3	37.7-212		%Rec	1	11/21/2022 2:23:08 PM	R92745
EPA METHOD 8021B: VOLATILES							Analyst: NSB
Benzene	ND	0.020		mg/Kg	1	11/21/2022 2:23:08 PM	R92745
Toluene	ND	0.039		mg/Kg	1	11/21/2022 2:23:08 PM	R92745
Ethylbenzene	ND	0.039		mg/Kg	1	11/21/2022 2:23:08 PM	R92745
Xylenes, Total	ND	0.078		mg/Kg	1	11/21/2022 2:23:08 PM	R92745
Surr: 4-Bromofluorobenzene	95.6	70-130		%Rec	1	11/21/2022 2:23:08 PM	R92745

Refer to the QC Summary report and sample login checklist for flagged QC data and preservation information.

Qualifiers:	*	Value exceeds Maximum Contaminant Level.	B	Analyte detected in the associated Method Blank
	D	Sample Diluted Due to Matrix	E	Above Quantitation Range/Estimated Value
	H	Holding times for preparation or analysis exceeded	J	Analyte detected below quantitation limits
	ND	Not Detected at the Reporting Limit	P	Sample pH Not In Range
	PQL	Practical Quantitative Limit	RL	Reporting Limit
	S	% Recovery outside of standard limits. If undiluted results may be estimated.		

Page 7 of 18

Analytical Report

Lab Order 2211B53

Date Reported: 11/28/2022

Hall Environmental Analysis Laboratory, Inc.

CLIENT: EOG

Client Sample ID: NB-8

Project: Federal CM 1

Collection Date: 11/16/2022 11:37:00 AM

Lab ID: 2211B53-008

Matrix: SOIL

Received Date: 11/19/2022 7:45:00 AM

Analyses	Result	RL	Qual	Units	DF	Date Analyzed	Batch
EPA METHOD 300.0: ANIONS							Analyst: JTT
Chloride	780	60		mg/Kg	20	11/22/2022 2:35:44 AM	71634
EPA METHOD 8015M/D: DIESEL RANGE ORGANICS							Analyst: DGH
Diesel Range Organics (DRO)	ND	15		mg/Kg	1	11/21/2022 7:15:01 PM	71614
Motor Oil Range Organics (MRO)	ND	51		mg/Kg	1	11/21/2022 7:15:01 PM	71614
Surr: DNOP	105	21-129		%Rec	1	11/21/2022 7:15:01 PM	71614
EPA METHOD 8015D: GASOLINE RANGE							Analyst: NSB
Gasoline Range Organics (GRO)	ND	3.9		mg/Kg	1	11/21/2022 2:46:48 PM	R92745
Surr: BFB	90.1	37.7-212		%Rec	1	11/21/2022 2:46:48 PM	R92745
EPA METHOD 8021B: VOLATILES							Analyst: NSB
Benzene	ND	0.020		mg/Kg	1	11/21/2022 2:46:48 PM	R92745
Toluene	ND	0.039		mg/Kg	1	11/21/2022 2:46:48 PM	R92745
Ethylbenzene	ND	0.039		mg/Kg	1	11/21/2022 2:46:48 PM	R92745
Xylenes, Total	ND	0.079		mg/Kg	1	11/21/2022 2:46:48 PM	R92745
Surr: 4-Bromofluorobenzene	94.5	70-130		%Rec	1	11/21/2022 2:46:48 PM	R92745

Refer to the QC Summary report and sample login checklist for flagged QC data and preservation information.

Qualifiers:	*	Value exceeds Maximum Contaminant Level.	B	Analyte detected in the associated Method Blank
	D	Sample Diluted Due to Matrix	E	Above Quantitation Range/Estimated Value
	H	Holding times for preparation or analysis exceeded	J	Analyte detected below quantitation limits
	ND	Not Detected at the Reporting Limit	P	Sample pH Not In Range
	PQL	Practical Quantitative Limit	RL	Reporting Limit
	S	% Recovery outside of standard limits. If undiluted results may be estimated.		

Page 8 of 18

Analytical Report

Lab Order 2211B53

Date Reported: 11/28/2022

Hall Environmental Analysis Laboratory, Inc.

CLIENT: EOG

Client Sample ID: NB-9

Project: Federal CM 1

Collection Date: 11/16/2022 11:39:00 AM

Lab ID: 2211B53-009

Matrix: SOIL

Received Date: 11/19/2022 7:45:00 AM

Analyses	Result	RL	Qual	Units	DF	Date Analyzed	Batch
EPA METHOD 300.0: ANIONS							Analyst: JTT
Chloride	720	60		mg/Kg	20	11/22/2022 3:12:47 AM	71634
EPA METHOD 8015M/D: DIESEL RANGE ORGANICS							Analyst: DGH
Diesel Range Organics (DRO)	ND	14		mg/Kg	1	11/21/2022 7:25:26 PM	71614
Motor Oil Range Organics (MRO)	ND	45		mg/Kg	1	11/21/2022 7:25:26 PM	71614
Surr: DNOP	90.1	21-129		%Rec	1	11/21/2022 7:25:26 PM	71614
EPA METHOD 8015D: GASOLINE RANGE							Analyst: NSB
Gasoline Range Organics (GRO)	ND	7.8		mg/Kg	1	11/21/2022 5:08:02 PM	R92745
Surr: BFB	89.3	37.7-212		%Rec	1	11/21/2022 5:08:02 PM	R92745
EPA METHOD 8021B: VOLATILES							Analyst: NSB
Benzene	ND	0.039		mg/Kg	1	11/21/2022 5:08:02 PM	R92745
Toluene	ND	0.078		mg/Kg	1	11/21/2022 5:08:02 PM	R92745
Ethylbenzene	ND	0.078		mg/Kg	1	11/21/2022 5:08:02 PM	R92745
Xylenes, Total	ND	0.16		mg/Kg	1	11/21/2022 5:08:02 PM	R92745
Surr: 4-Bromofluorobenzene	94.3	70-130		%Rec	1	11/21/2022 5:08:02 PM	R92745

Refer to the QC Summary report and sample login checklist for flagged QC data and preservation information.

Qualifiers:	*	Value exceeds Maximum Contaminant Level.	B	Analyte detected in the associated Method Blank
	D	Sample Diluted Due to Matrix	E	Above Quantitation Range/Estimated Value
	H	Holding times for preparation or analysis exceeded	J	Analyte detected below quantitation limits
	ND	Not Detected at the Reporting Limit	P	Sample pH Not In Range
	PQL	Practical Quantitative Limit	RL	Reporting Limit
	S	% Recovery outside of standard limits. If undiluted results may be estimated.		

Page 9 of 18

Analytical Report

Lab Order 2211B53

Date Reported: 11/28/2022

Hall Environmental Analysis Laboratory, Inc.

CLIENT: EOG

Client Sample ID: NB-10

Project: Federal CM 1

Collection Date: 11/16/2022 11:41:00 AM

Lab ID: 2211B53-010

Matrix: SOIL

Received Date: 11/19/2022 7:45:00 AM

Analyses	Result	RL	Qual	Units	DF	Date Analyzed	Batch
EPA METHOD 300.0: ANIONS							Analyst: JTT
Chloride	830	59		mg/Kg	20	11/22/2022 3:25:08 AM	71634
EPA METHOD 8015M/D: DIESEL RANGE ORGANICS							Analyst: DGH
Diesel Range Organics (DRO)	ND	15		mg/Kg	1	11/21/2022 7:35:50 PM	71614
Motor Oil Range Organics (MRO)	ND	48		mg/Kg	1	11/21/2022 7:35:50 PM	71614
Surr: DNOP	97.7	21-129		%Rec	1	11/21/2022 7:35:50 PM	71614
EPA METHOD 8015D: GASOLINE RANGE							Analyst: NSB
Gasoline Range Organics (GRO)	ND	4.3		mg/Kg	1	11/21/2022 5:31:38 PM	R92745
Surr: BFB	88.0	37.7-212		%Rec	1	11/21/2022 5:31:38 PM	R92745
EPA METHOD 8021B: VOLATILES							Analyst: NSB
Benzene	ND	0.021		mg/Kg	1	11/21/2022 5:31:38 PM	R92745
Toluene	ND	0.043		mg/Kg	1	11/21/2022 5:31:38 PM	R92745
Ethylbenzene	ND	0.043		mg/Kg	1	11/21/2022 5:31:38 PM	R92745
Xylenes, Total	ND	0.086		mg/Kg	1	11/21/2022 5:31:38 PM	R92745
Surr: 4-Bromofluorobenzene	92.6	70-130		%Rec	1	11/21/2022 5:31:38 PM	R92745

Refer to the QC Summary report and sample login checklist for flagged QC data and preservation information.

Qualifiers:	*	Value exceeds Maximum Contaminant Level.	B	Analyte detected in the associated Method Blank
	D	Sample Diluted Due to Matrix	E	Above Quantitation Range/Estimated Value
	H	Holding times for preparation or analysis exceeded	J	Analyte detected below quantitation limits
	ND	Not Detected at the Reporting Limit	P	Sample pH Not In Range
	PQL	Practical Quantitative Limit	RL	Reporting Limit
	S	% Recovery outside of standard limits. If undiluted results may be estimated.		

Page 10 of 18

Analytical Report

Lab Order 2211B53

Date Reported: 11/28/2022

Hall Environmental Analysis Laboratory, Inc.

CLIENT: EOG

Client Sample ID: NB-11

Project: Federal CM 1

Collection Date: 11/16/2022 11:43:00 AM

Lab ID: 2211B53-011

Matrix: SOIL

Received Date: 11/19/2022 7:45:00 AM

Analyses	Result	RL	Qual	Units	DF	Date Analyzed	Batch
EPA METHOD 300.0: ANIONS							Analyst: JTT
Chloride	890	60		mg/Kg	20	11/22/2022 3:37:29 AM	71634
EPA METHOD 8015M/D: DIESEL RANGE ORGANICS							Analyst: DGH
Diesel Range Organics (DRO)	ND	15		mg/Kg	1	11/21/2022 7:46:12 PM	71614
Motor Oil Range Organics (MRO)	ND	49		mg/Kg	1	11/21/2022 7:46:12 PM	71614
Surr: DNOP	94.3	21-129		%Rec	1	11/21/2022 7:46:12 PM	71614
EPA METHOD 8015D: GASOLINE RANGE							Analyst: NSB
Gasoline Range Organics (GRO)	ND	3.5		mg/Kg	1	11/21/2022 5:55:16 PM	R92745
Surr: BFB	89.3	37.7-212		%Rec	1	11/21/2022 5:55:16 PM	R92745
EPA METHOD 8021B: VOLATILES							Analyst: NSB
Benzene	ND	0.018		mg/Kg	1	11/21/2022 5:55:16 PM	R92745
Toluene	ND	0.035		mg/Kg	1	11/21/2022 5:55:16 PM	R92745
Ethylbenzene	ND	0.035		mg/Kg	1	11/21/2022 5:55:16 PM	R92745
Xylenes, Total	ND	0.071		mg/Kg	1	11/21/2022 5:55:16 PM	R92745
Surr: 4-Bromofluorobenzene	93.2	70-130		%Rec	1	11/21/2022 5:55:16 PM	R92745

Refer to the QC Summary report and sample login checklist for flagged QC data and preservation information.

Qualifiers:	*	Value exceeds Maximum Contaminant Level.	B	Analyte detected in the associated Method Blank
	D	Sample Diluted Due to Matrix	E	Above Quantitation Range/Estimated Value
	H	Holding times for preparation or analysis exceeded	J	Analyte detected below quantitation limits
	ND	Not Detected at the Reporting Limit	P	Sample pH Not In Range
	PQL	Practical Quantitative Limit	RL	Reporting Limit
	S	% Recovery outside of standard limits. If undiluted results may be estimated.		

Page 11 of 18

Analytical Report

Lab Order 2211B53

Date Reported: 11/28/2022

Hall Environmental Analysis Laboratory, Inc.

CLIENT: EOG

Client Sample ID: NB-12

Project: Federal CM 1

Collection Date: 11/16/2022 11:45:00 AM

Lab ID: 2211B53-012

Matrix: SOIL

Received Date: 11/19/2022 7:45:00 AM

Analyses	Result	RL	Qual	Units	DF	Date Analyzed	Batch
EPA METHOD 300.0: ANIONS							Analyst: JTT
Chloride	750	60		mg/Kg	20	11/22/2022 3:49:50 AM	71634
EPA METHOD 8015M/D: DIESEL RANGE ORGANICS							Analyst: DGH
Diesel Range Organics (DRO)	ND	15		mg/Kg	1	11/21/2022 7:56:32 PM	71614
Motor Oil Range Organics (MRO)	ND	49		mg/Kg	1	11/21/2022 7:56:32 PM	71614
Surr: DNOP	101	21-129		%Rec	1	11/21/2022 7:56:32 PM	71614
EPA METHOD 8015D: GASOLINE RANGE							Analyst: NSB
Gasoline Range Organics (GRO)	ND	4.7		mg/Kg	1	11/21/2022 6:18:50 PM	R92745
Surr: BFB	87.0	37.7-212		%Rec	1	11/21/2022 6:18:50 PM	R92745
EPA METHOD 8021B: VOLATILES							Analyst: NSB
Benzene	ND	0.023		mg/Kg	1	11/21/2022 6:18:50 PM	R92745
Toluene	ND	0.047		mg/Kg	1	11/21/2022 6:18:50 PM	R92745
Ethylbenzene	ND	0.047		mg/Kg	1	11/21/2022 6:18:50 PM	R92745
Xylenes, Total	ND	0.093		mg/Kg	1	11/21/2022 6:18:50 PM	R92745
Surr: 4-Bromofluorobenzene	91.0	70-130		%Rec	1	11/21/2022 6:18:50 PM	R92745

Refer to the QC Summary report and sample login checklist for flagged QC data and preservation information.

Qualifiers:	*	Value exceeds Maximum Contaminant Level.	B	Analyte detected in the associated Method Blank
	D	Sample Diluted Due to Matrix	E	Above Quantitation Range/Estimated Value
	H	Holding times for preparation or analysis exceeded	J	Analyte detected below quantitation limits
	ND	Not Detected at the Reporting Limit	P	Sample pH Not In Range
	PQL	Practical Quantitative Limit	RL	Reporting Limit
	S	% Recovery outside of standard limits. If undiluted results may be estimated.		

Page 12 of 18

Analytical Report

Lab Order 2211B53

Date Reported: 11/28/2022

Hall Environmental Analysis Laboratory, Inc.

CLIENT: EOG

Client Sample ID: NB-13

Project: Federal CM 1

Collection Date: 11/16/2022 11:47:00 AM

Lab ID: 2211B53-013

Matrix: SOIL

Received Date: 11/19/2022 7:45:00 AM

Analyses	Result	RL	Qual	Units	DF	Date Analyzed	Batch
EPA METHOD 300.0: ANIONS							Analyst: JTT
Chloride	860	60		mg/Kg	20	11/22/2022 4:02:11 AM	71634
EPA METHOD 8015M/D: DIESEL RANGE ORGANICS							Analyst: DGH
Diesel Range Organics (DRO)	ND	15		mg/Kg	1	11/21/2022 8:06:56 PM	71614
Motor Oil Range Organics (MRO)	ND	50		mg/Kg	1	11/21/2022 8:06:56 PM	71614
Surr: DNOP	92.1	21-129		%Rec	1	11/21/2022 8:06:56 PM	71614
EPA METHOD 8015D: GASOLINE RANGE							Analyst: NSB
Gasoline Range Organics (GRO)	ND	5.4		mg/Kg	1	11/21/2022 6:42:15 PM	R92745
Surr: BFB	93.7	37.7-212		%Rec	1	11/21/2022 6:42:15 PM	R92745
EPA METHOD 8021B: VOLATILES							Analyst: NSB
Benzene	ND	0.027		mg/Kg	1	11/21/2022 6:42:15 PM	R92745
Toluene	ND	0.054		mg/Kg	1	11/21/2022 6:42:15 PM	R92745
Ethylbenzene	ND	0.054		mg/Kg	1	11/21/2022 6:42:15 PM	R92745
Xylenes, Total	ND	0.11		mg/Kg	1	11/21/2022 6:42:15 PM	R92745
Surr: 4-Bromofluorobenzene	98.7	70-130		%Rec	1	11/21/2022 6:42:15 PM	R92745

Refer to the QC Summary report and sample login checklist for flagged QC data and preservation information.

Qualifiers:	*	Value exceeds Maximum Contaminant Level.	B	Analyte detected in the associated Method Blank
	D	Sample Diluted Due to Matrix	E	Above Quantitation Range/Estimated Value
	H	Holding times for preparation or analysis exceeded	J	Analyte detected below quantitation limits
	ND	Not Detected at the Reporting Limit	P	Sample pH Not In Range
	PQL	Practical Quantitative Limit	RL	Reporting Limit
	S	% Recovery outside of standard limits. If undiluted results may be estimated.		

Page 13 of 18

Analytical Report

Lab Order 2211B53

Date Reported: 11/28/2022

Hall Environmental Analysis Laboratory, Inc.

CLIENT: EOG

Client Sample ID: NB-14

Project: Federal CM 1

Collection Date: 11/16/2022 11:49:00 AM

Lab ID: 2211B53-014

Matrix: SOIL

Received Date: 11/19/2022 7:45:00 AM

Analyses	Result	RL	Qual	Units	DF	Date Analyzed	Batch
EPA METHOD 300.0: ANIONS							Analyst: JTT
Chloride	1100	60		mg/Kg	20	11/22/2022 4:14:31 AM	71634
EPA METHOD 8015M/D: DIESEL RANGE ORGANICS							Analyst: DGH
Diesel Range Organics (DRO)	ND	14		mg/Kg	1	11/21/2022 8:17:21 PM	71614
Motor Oil Range Organics (MRO)	ND	47		mg/Kg	1	11/21/2022 8:17:21 PM	71614
Surr: DNOP	100	21-129		%Rec	1	11/21/2022 8:17:21 PM	71614
EPA METHOD 8015D: GASOLINE RANGE							Analyst: NSB
Gasoline Range Organics (GRO)	ND	5.1		mg/Kg	1	11/21/2022 7:05:52 PM	R92745
Surr: BFB	90.2	37.7-212		%Rec	1	11/21/2022 7:05:52 PM	R92745
EPA METHOD 8021B: VOLATILES							Analyst: NSB
Benzene	ND	0.026		mg/Kg	1	11/21/2022 7:05:52 PM	R92745
Toluene	ND	0.051		mg/Kg	1	11/21/2022 7:05:52 PM	R92745
Ethylbenzene	ND	0.051		mg/Kg	1	11/21/2022 7:05:52 PM	R92745
Xylenes, Total	ND	0.10		mg/Kg	1	11/21/2022 7:05:52 PM	R92745
Surr: 4-Bromofluorobenzene	94.7	70-130		%Rec	1	11/21/2022 7:05:52 PM	R92745

Refer to the QC Summary report and sample login checklist for flagged QC data and preservation information.

Qualifiers:	*	Value exceeds Maximum Contaminant Level.	B	Analyte detected in the associated Method Blank
	D	Sample Diluted Due to Matrix	E	Above Quantitation Range/Estimated Value
	H	Holding times for preparation or analysis exceeded	J	Analyte detected below quantitation limits
	ND	Not Detected at the Reporting Limit	P	Sample pH Not In Range
	PQL	Practical Quantitative Limit	RL	Reporting Limit
	S	% Recovery outside of standard limits. If undiluted results may be estimated.		

Page 14 of 18

QC SUMMARY REPORT

Hall Environmental Analysis Laboratory, Inc.

WO#: 2211B53

28-Nov-22

Client: EOG
Project: Federal CM 1

Sample ID: MB-71634	SampType: MBLK	TestCode: EPA Method 300.0: Anions								
Client ID: PBS	Batch ID: 71634	RunNo: 92751								
Prep Date: 11/21/2022	Analysis Date: 11/21/2022	SeqNo: 3338207	Units: mg/Kg							
Analyte	Result	PQL	SPK value	SPK Ref Val	%REC	LowLimit	HighLimit	%RPD	RPDLimit	Qual
Chloride	ND	1.5								

Sample ID: LCS-71634	SampType: LCS	TestCode: EPA Method 300.0: Anions								
Client ID: LCSS	Batch ID: 71634	RunNo: 92751								
Prep Date: 11/21/2022	Analysis Date: 11/22/2022	SeqNo: 3338208	Units: mg/Kg							
Analyte	Result	PQL	SPK value	SPK Ref Val	%REC	LowLimit	HighLimit	%RPD	RPDLimit	Qual
Chloride	14	1.5	15.00	0	95.3	90	110			

Qualifiers:

* Value exceeds Maximum Contaminant Level.
D Sample Diluted Due to Matrix
H Holding times for preparation or analysis exceeded
ND Not Detected at the Reporting Limit
PQL Practical Quantitative Limit
S % Recovery outside of standard limits. If undiluted results may be estimated.

B Analyte detected in the associated Method Blank
E Above Quantitation Range/Estimated Value
J Analyte detected below quantitation limits
P Sample pH Not In Range
RL Reporting Limit

Page 15 of 18

QC SUMMARY REPORT**Hall Environmental Analysis Laboratory, Inc.**

WO#: 2211B53

28-Nov-22

Client: EOG
Project: Federal CM 1

Sample ID: LCS-71614	SampType: LCS			TestCode: EPA Method 8015M/D: Diesel Range Organics						
Client ID: LCSS	Batch ID: 71614			RunNo: 92758						
Prep Date: 11/21/2022	Analysis Date: 11/21/2022			SeqNo: 3338811		Units: mg/Kg				
Analyte	Result	PQL	SPK value	SPK Ref Val	%REC	LowLimit	HighLimit	%RPD	RPDLimit	Qual
Diesel Range Organics (DRO)	45	15	50.00	0	90.7	64.4	127			
Surr: DNOP	5.7		5.000		113	21	129			

Sample ID: MB-71614	SampType: MBLK			TestCode: EPA Method 8015M/D: Diesel Range Organics						
Client ID: PBS	Batch ID: 71614			RunNo: 92758						
Prep Date: 11/21/2022	Analysis Date: 11/21/2022			SeqNo: 3338813		Units: mg/Kg				
Analyte	Result	PQL	SPK value	SPK Ref Val	%REC	LowLimit	HighLimit	%RPD	RPDLimit	Qual
Diesel Range Organics (DRO)	ND	15								
Motor Oil Range Organics (MRO)	ND	50								
Surr: DNOP	11		10.00		106	21	129			

Qualifiers:

* Value exceeds Maximum Contaminant Level.
D Sample Diluted Due to Matrix
H Holding times for preparation or analysis exceeded
ND Not Detected at the Reporting Limit
PQL Practical Quantitative Limit
S % Recovery outside of standard limits. If undiluted results may be estimated.

B Analyte detected in the associated Method Blank
E Above Quantitation Range/Estimated Value
J Analyte detected below quantitation limits
P Sample pH Not In Range
RL Reporting Limit

Page 16 of 18

QC SUMMARY REPORT**Hall Environmental Analysis Laboratory, Inc.**

WO#: 2211B53

28-Nov-22

Client: EOG
Project: Federal CM 1

Sample ID: mb	SampType: MBLK		TestCode: EPA Method 8015D: Gasoline Range							
Client ID: PBS	Batch ID: R92745		RunNo: 92745							
Prep Date:	Analysis Date: 11/21/2022		SeqNo: 3337746		Units: mg/Kg					
Analyte	Result	PQL	SPK value	SPK Ref Val	%REC	LowLimit	HighLimit	%RPD	RPDLimit	Qual
Gasoline Range Organics (GRO)	ND	5.0								
Surr: BFB	920		1000		91.7	37.7	212			

Sample ID: 2.5ug gro lcs	SampType: LCS		TestCode: EPA Method 8015D: Gasoline Range							
Client ID: LCSS	Batch ID: R92745		RunNo: 92745							
Prep Date:	Analysis Date: 11/21/2022		SeqNo: 3337747		Units: mg/Kg					
Analyte	Result	PQL	SPK value	SPK Ref Val	%REC	LowLimit	HighLimit	%RPD	RPDLimit	Qual
Gasoline Range Organics (GRO)	24	5.0	25.00	0	97.1	72.3	137			
Surr: BFB	1800		1000		183	37.7	212			

Qualifiers:

* Value exceeds Maximum Contaminant Level.
D Sample Diluted Due to Matrix
H Holding times for preparation or analysis exceeded
ND Not Detected at the Reporting Limit
PQL Practical Quantitative Limit
S % Recovery outside of standard limits. If undiluted results may be estimated.

B Analyte detected in the associated Method Blank
E Above Quantitation Range/Estimated Value
J Analyte detected below quantitation limits
P Sample pH Not In Range
RL Reporting Limit

QC SUMMARY REPORT**Hall Environmental Analysis Laboratory, Inc.**

WO#: 2211B53

28-Nov-22

Client: EOG
Project: Federal CM 1

Sample ID: mb	SampType: MBLK			TestCode: EPA Method 8021B: Volatiles						
Client ID: PBS	Batch ID: R92745			RunNo: 92745						
Prep Date:	Analysis Date: 11/21/2022			SeqNo: 3337823		Units: mg/Kg				
Analyte	Result	PQL	SPK value	SPK Ref Val	%REC	LowLimit	HighLimit	%RPD	RPDLimit	Qual
Benzene	ND	0.025								
Toluene	ND	0.050								
Ethylbenzene	ND	0.050								
Xylenes, Total	ND	0.10								
Surr: 4-Bromofluorobenzene	0.96		1.000		96.1	70	130			

Sample ID: 100ng btex lcs	SampType: LCS			TestCode: EPA Method 8021B: Volatiles						
Client ID: LCSS	Batch ID: R92745			RunNo: 92745						
Prep Date:	Analysis Date: 11/21/2022			SeqNo: 3337824		Units: mg/Kg				
Analyte	Result	PQL	SPK value	SPK Ref Val	%REC	LowLimit	HighLimit	%RPD	RPDLimit	Qual
Benzene	0.98	0.025	1.000	0	97.5	80	120			
Toluene	1.0	0.050	1.000	0	101	80	120			
Ethylbenzene	1.0	0.050	1.000	0	100	80	120			
Xylenes, Total	3.0	0.10	3.000	0	101	80	120			
Surr: 4-Bromofluorobenzene	0.95		1.000		95.3	70	130			

Qualifiers:

* Value exceeds Maximum Contaminant Level.
D Sample Diluted Due to Matrix
H Holding times for preparation or analysis exceeded
ND Not Detected at the Reporting Limit
PQL Practical Quantitative Limit
S % Recovery outside of standard limits. If undiluted results may be estimated.

B Analyte detected in the associated Method Blank
E Above Quantitation Range/Estimated Value
J Analyte detected below quantitation limits
P Sample pH Not In Range
RL Reporting Limit



Hall Environmental Analysis Laboratory
4901 Hawkins NE
Albuquerque, NM 87109
TEL: 505-345-3975 FAX: 505-345-4107
Website: www.hallenvironmental.com

Sample Log-In Check List

Client Name: **EOG** Work Order Number: **2211B53** RptNo: **1**

Received By: **Kasandra Jimena Garcia** 11/19/2022 7:45:00 AM

Completed By: **Kasandra Jimena Garcia** 11/19/2022 8:09:19 AM

Reviewed By: *KAG 11-19-22*

KAG

KAG

Chain of Custody

1. Is Chain of Custody complete? Yes ☒ No ☐ Not Present ☐
2. How was the sample delivered? Courier

Log In

3. Was an attempt made to cool the samples? Yes ☒ No ☐ NA ☐
4. Were all samples received at a temperature of >0° C to 6.0°C Yes ☒ No ☐ NA ☐
5. Sample(s) in proper container(s)? Yes ☒ No ☐
6. Sufficient sample volume for indicated test(s)? Yes ☒ No ☐
7. Are samples (except VOA and ONG) properly preserved? Yes ☒ No ☐
8. Was preservative added to bottles? Yes ☐ No ☒ NA ☐
9. Received at least 1 vial with headspace <1/4" for AQ VOA? Yes ☐ No ☐ NA ☒
10. Were any sample containers received broken? Yes ☐ No ☒
11. Does paperwork match bottle labels? Yes ☒ No ☐
(Note discrepancies on chain of custody)
12. Are matrices correctly identified on Chain of Custody? Yes ☒ No ☐
13. Is it clear what analyses were requested? Yes ☒ No ☐
14. Were all holding times able to be met? Yes ☒ No ☐
(If no, notify customer for authorization.)

of preserved bottles checked for pH:

(<2 or >12 unless noted)

Adjusted? _____

Checked by: *initials*

Special Handling (if applicable)

15. Was client notified of all discrepancies with this order? Yes ☐ No ☐ NA ☒

Person Notified: _____

Date: _____

By Whom: _____

Via: ☐ eMail ☐ Phone ☐ Fax ☐ In Person

Regarding: _____

Client Instructions: _____

16. Additional remarks:

17. Cooler Information

Cooler No	Temp °C	Condition	Seal Intact	Seal No	Seal Date	Signed By
1	2.0	Good	Yes			
2	3.4	Good	Yes			
3	1.8	Good	Yes			



HALL ENVIRONMENTAL ANALYSIS LABORATORY
www.hallenvironmental.com
4901 Hawkins NE - Albuquerque, NM 87109
Tel. 505-345-3975 Fax 505-345-4107

Client: EOG-Artesia / Ranger Env.
Mailing Address: EOG - 105 S 4th St, Artesia NM, 88210
Ranger: PO Box 201179, Austin TX 78720
Phone #: 521-335-1785
email or Fax#: Will@RangerEnv.com
QA/QC Package:
☒ Standard ☐ Level 4 (Full Validation)
Accreditation: ☐ Az Compliance
☒ NELAC ☐ Other
☒ EDD (Type) Excel

☐ Standard ☒ Rush 24 hr
Project Name: Federal On #1
Project #: 5375
Project Manager: W. Kierdorf
Sampler: W. Kennedy
On Ice: ☒ Yes ☐ No
of Coolers: 3
Cooler Temp (including C-3):
Container Type and # Preservative Type HEAL No.
1 p402 Ice 013
1 014

Date Time Matrix Sample Name
11/16/20 1147 Soil NB-13
1149 I NB-14

Date Time Relinquished by: W. Kennedy
11/16/20 0815
Date Time Relinquished by: W. Kennedy
11/16/20 1900

Date Time Received by: W. Kennedy
11/16/20 1822 845
Date Time Received by: W. Kennedy
11/16/20 1922 745

Remarks: Bill to EOG Artesia

TPH: 8015D(GRO / DRO / MRO)
Chloride (EPA 300)
BTX (8021)

Analysis Request

Released to Imaging: 4/21/2023 3:19:05 PM

ATTACHMENT 3 – HOWELL RANCH SEED MIXTURE

James H & Betty R Howell Revocable Trust Seed Mix

1lb per acre of Plains Bristlegrass

2lbs per acre of Green Sprangletop

3lbs per acre of Side Oats Gramma

2lbs per acre of Blue Gramma

Increase to 16lbs per acre if broadcast.

Add Reclamation Mix

40% Ryegrass (Annual)

10% Millet

7.5% Kleingrass

5.7% Sideoats

5% Green Sprangletop

7.5% Bristlegrass

10% Western Wheatgrass

10% Buffalograss

2.5% Blue Grama

PLANTING RATE 20 lbs. per acre

Updated 5/23/2021

ATTACHMENT 4 – NMOCD CORRESPONDENCE

From: OCDOnline@state.nm.us <OCDOnline@state.nm.us>
Sent: Thursday, March 24, 2022 12:00 PM
To: Tina Huerta <Tina.Huerta@eogresources.com>
Subject: The Oil Conservation Division (OCD) has approved the application, Application ID: 92909

CAUTION: This email originated from outside of the organization. Do not click links or open attachments unless you recognize the sender and know the content is safe.

To whom it may concern (c/o Tina Huerta for EOG RESOURCES INC),

The OCD has approved the submitted *Application for administrative approval of a release notification and corrective action* (C-141), for incident ID (n#) nAPP2208339578, with the following conditions:

- When submitting future reports regarding this release, please submit the calculations used or specific justification for the volumes reported on the initial C-141

The signed C-141 can be found in the OCD Online: Imaging under the incident ID (n#).

If you have any questions regarding this application, please contact me.

Thank you,
Jocelyn Harimon
Environmental Specialist
575-748-1283
Jocelyn.Harimon@state.nm.us

New Mexico Energy, Minerals and Natural Resources Department
1220 South St. Francis Drive
Santa Fe, NM 87505

2 Attachments • Scanned by Gmail ⓘ



From: OCDOnline@state.nm.us <OCDOnline@state.nm.us>
Sent: Friday, October 28, 2022 11:35 AM
To: Tina Huerta <Tina_Huerta@eogresources.com>
Subject: The Oil Conservation Division (OCD) has approved the application, Application ID: 119150

CAUTION: This email originated from outside of the organization. Do not click links or open attachments unless you recognize the sender and know the content is safe.

To whom it may concern (p/o Tina Huerta for EOG RESOURCES INC),

The OCD has approved the submitted *Application for administrative approval of a release notification and corrective action* (C-141), for incident ID (n#) nAPP2208339578, with the following conditions:

- Thank you for the site assessment. Please make sure all sample locations are fully delineated. Floor confirmation samples should be delineated/excavated to meet closure criteria standards for site assessment/characterization/proven depth to water determination. All off pad areas must contain a minimum of 4 feet non-waste containing uncontaminated, earthen material with chloride concentrations less than 600 mg/kg and less than 100 mg/kg for TPH. Sidewall samples should be delineated/excavated to 600 mg/kg for chlorides and 100 mg/kg for TPH to define the edge of the release. Samples must be analyzed for all constituents listed in Table I of 19.15.29.12 NMAC. Confirmation samples should be collected every 200 ft². A remediation plan should be submitted within 90 days of the date of discovery.

The signed C-141 can be found in the OCD Online: Imaging under the incident ID (n#).

If you have any questions regarding this application, please contact me.

Thank you,
Robert Hamlet
575-748-1283
Robert.Hamlet@emnrd.nm.gov

New Mexico Energy, Minerals and Natural Resources Department
1220 South St. Francis Drive
Santa Fe, NM 87505

One attachment • Scanned by Gmail ⓘ



From: Tina Huerta <Tina_Huerta@eogresources.com>

Sent: Tuesday, November 8, 2022 3:00 PM

To: ocd.enviro@emnrd.nm.gov; blm_nm_cfo_spill@blm.gov; Alan & Cheryl <ahowell@pvt.net>; Austin Weyant <austin@atkinseng.com>

Cc: Andrea Felix <Andrea_Felix@eogresources.com>; Katie Jamison <Katie_Jamison@eogresources.com>; Michael Yemm <Michael_Yemm@eogresources.com>; Terrence Gant <Terry_Gant@eogresources.com>

Subject: Federal CM 1 (nAPP2208339578 & nAPP2208340165) Sampling Notification

Good Afternoon,

EOG Resources, Inc. respectfully submits notification of sampling activities to be conducted at the below location.

Federal CM 1

nAPP2208339578 & nAPP2208340165

Sampling will begin at 8:00 a.m. on Friday, November 11, 2022.

Thank you,

Tina Huerta

Regulatory Specialist

Direct: 575.748.4168

Cell: 575.703.3121

Email: tina_huerta@eogresources.com



Artesia Division

From: Tina Huerta <Tina_Huerta@eogresources.com>
Sent: Monday, November 14, 2022 11:52 AM
To: ood.enviro@emnrd.nm.gov; blm_nm_cfo_spill@blm.gov; Alan & Cheryl <ahowell@pvt.net>; Austin Weyant <austin@atkinseng.com>
Co: Andrea Felix <Andrea_Felix@eogresources.com>; Katie Jamison <Katie_Jamison@eogresources.com>; Michael Yemm <Michael_Yemm@eogresources.com>; Terrence Gant <Terry_Gant@eogresources.com>
Subject: Federal CM 1 (nAPP2208339578 & nAPP2208340165) Sampling Notification

Good Morning,

EOG Resources, Inc. respectfully submits notification of sampling activities to be conducted at the below location.

Federal CM 1
M-12-19S-24E
Eddy County, NM
nAPP2208339578 & nAPP2208340165

Sampling will begin at 12:00 p.m. on Wednesday, November 16, 2022.

Thank you,

Tina Huerta
Regulatory Specialist
Direct: 575.748.4168
Cell: 575.703.3121
Email: tina_huerta@eogresources.com



Artesia Division

District I
1625 N. French Dr., Hobbs, NM 88240
Phone:(575) 393-6161 Fax:(575) 393-0720
District II
811 S. First St., Artesia, NM 88210
Phone:(575) 748-1283 Fax:(575) 748-9720
District III
1000 Rio Brazos Rd., Aztec, NM 87410
Phone:(505) 334-6178 Fax:(505) 334-6170
District IV
1220 S. St Francis Dr., Santa Fe, NM 87505
Phone:(505) 476-3470 Fax:(505) 476-3462

State of New Mexico
Energy, Minerals and Natural Resources
Oil Conservation Division
1220 S. St Francis Dr.
Santa Fe, NM 87505

CONDITIONS

Action 160799

CONDITIONS

Operator: EOG RESOURCES INC P.O. Box 2267 Midland, TX 79702	OGRID: 7377
	Action Number: 160799
	Action Type: [C-141] Release Corrective Action (C-141)

CONDITIONS

Created By	Condition	Condition Date
rhamlet	We have received your closure report and final C-141 for Incident #NAPP2208339578 FEDERAL CM COM #1, thank you. This closure is approved.	4/21/2023