

talonlpe.com • 866.742.0742



## Closure Report

Antelope Ridge 24 SWD #001  
Lea County, New Mexico  
API ID # 30-025-26547  
**Incident #** NOY1816657191

## Prepared For:

Matador Resources  
5347 N. 26<sup>th</sup> Street 2<sup>nd</sup> Floor.  
Artesia, NM 88210

## Prepared By:

Talon/LPE  
408 W. Texas Avenue  
Artesia, New Mexico 88210

**June 16, 2023**

**NMOCD**

506 W. Texas Ave  
Artesia, NM 88210

Subject: **Closure Report**  
Antelope Ridge 24 SWD #001  
Lea County, New Mexico  
API ID # 30-025-26547  
Incident # NOY1816657191

To Whom It May Concern,

Matador Resources contracted Talon/LPE (Talon) to perform soil assessment and remediation services at the above referenced location. The incident description, soil sampling results, remedial actions, and closure request are presented herein.

**Site Information**

The Antelope Ridge 24 SWD #001 is located approximately 32 miles southwest of Hobbs, New Mexico. The legal location for this release is Unit Letter K, Section 24, Township 23 South, and Range 34 East in Lea County, New Mexico. More specifically the latitude and longitude for the release are 32.2883301 and -103.4258575. A Site Location Map is presented in [Appendix I](#).

According to the soil survey provided by the United States Department of Agriculture National Resources Conservation Services, the soil in this area is comprised of Ratliff-Wink fine sandy loams with, 0 to 3 percent slopes. The referenced soil data is presented in [Appendix II](#). Per the New Mexico Bureau of Geology and Mineral Resources, the local geology consists of eolian and piedmont deposits. Interlayered eolian sands and piedmont-slope deposits along the eastern flank of the Pecos River valley, primarily between Roswell and Carlsbad. Typically capped by thin eolian deposits.

**Groundwater and Site Characterization**

The New Mexico Office of the State Engineer Database indicates the nearest reported depth to groundwater is 1 mile from the site and is recorded at 270 feet below ground surface (bgs). Further research of the Bureau of Land Management Karst data indicates that this site is situated outside a potential Karst area. The FEMA data base locates the site in a minimal flood hazard zone.

<b>Approximate Depth to Groundwater</b>	<b>270 feet bgs</b>
---	---------------------

- ☐ Yes ☒ No Within 300 feet of any continuously flowing watercourse or any other significant watercourse
- ☐ Yes ☒ No Within 200 feet of any lakebed, sinkhole or a playa lake
- ☐ Yes ☒ No Within 300 feet from an occupied permanent residence, school, hospital, institution or church
- ☐ Yes ☒ No Within 500 feet of a spring or a private, domestic fresh water well used by less than five households for domestic or stock watering purposes
- ☐ Yes ☒ No Within 1000 feet of any freshwater well or spring
- ☐ Yes ☒ No Within incorporated municipal boundaries or within a defined municipal freshwater well field covered under a municipal ordinance adopted pursuant to Section 3-2703 NMSA 1978
- ☐ Yes ☒ No Within 300 feet of a wetland
- ☐ Yes ☒ No Within the area overlying a subsurface mine
- ☐ Yes ☒ No Within an unstable area
- ☐ Yes ☒ No Within a 100-year floodplain

With no depth to water source available that meets New Mexico Oil Conservation Division's (NMOCD) criteria within ½ mile of the site, the responsible party must therefore adhere to the cleanup criteria for this site of groundwater less than 50 feet bgs, Table I, NMOCD Rule 19.15.29 NMAC.

Closure Criteria for Soils Impacted by a Release			
Depth below horizontal extents of release to ground water less than 10,000 mg/l TDS	Constituent	Method	Limit
≤ 50 feet	Total Chlorides	EPA 300.0 or SM4500 Cl B	600 mg/kg
	TPH (GRO+DRO+MRO)	EPA SW-846 Method 8015M	100 mg/kg
	BTEX	EPA SW-846 Method 8021B or 8260B	50 mg/kg
	Benzene	EPA SW-846 Method 8021B or 8260B	10 mg/kg

---

### **Incident Description**

On June 15, 2018, piping on gun barrel failed and loss of power causing the secondary containment to fill until the fluids spilled over the front of the battery, running East and pooled in roadway and pasture. Approximately 1119 barrels (bbls) of produced water were released on the pad location and pasture with 937 (bbls) of fluids recovered. The initial C-141 was submitted to the NMOCD, can be reviewed under incident number NOY1816657191. The site location map is presented in [Appendix I](#).

### **Regulatory Response**

On March 3, 2023, NMOCD rejected the closure report submitted by Matador for the following reasons: "Closure denied. In an email dated 9/11/2018, conditions of approval for closure are listed. Dated and geo-referenced photo documentation of site/release characterization and remedial activities are required in the subsequent report. The submitted report did not contain photo documentation."

On May 18, 2023, on the conclusion of meeting with NMOCD, 6 locations were listed to be sampled from the previous reclamation assessment map. BG-3, BHC3, and BHC1 were requested to be sample no less than 2' bgs.. Samples points SWC5, SWC6, and BHC4 were to be sampled no less than 3' bgs.

### **Site Assessment Activities**

On May 22, 2023, upon client authorization, Talon mobilized personnel to the site to conduct an initial site assessment. The impacted area was photographed, soil samples were collected utilizing a hand auger, and the area was mapped. All soil samples were properly packaged in laboratory provided glassware, preserved on ice in the custody of Talon personnel, and transported to Cardinal Analytical Laboratory for analysis of Total Chlorides (SM4500Cl-B), Total Petroleum Hydrocarbons (TPH, EPA Method 8015M) and Volatile Organics (BTEX, EPA Method 8021B). Sample locations are shown on the attached Figure 1 in [Appendix I](#), and the results of the sampling event are presented below in Table 1.

**Table 1**  
*Site Assessment Analytical Data*

Sample ID	Sample Date	Depth (BGS)	Benzene mg/kg	BTEX mg/kg	GRO mg/kg	DRO mg/kg	MRO mg/kg	Total TPH mg/kg	Chlorides mg/kg
<b>NMOCD Table 1 Closure Criteria 19.15.29 NMAC</b>			<b>10 mg/kg</b>	<b>50 mg/kg</b>	<b>DRO + GRO + MRO combined = 100 mg/kg</b>			<b>100 mg/kg</b>	<b>600 mg/kg</b>
BG-3	5/22/2023	2'	ND	ND	ND	ND	ND	0	176
BHC3	5/22/2023	2'	ND	ND	ND	ND	ND	0	192
BHC1	5/22/2023	2'	ND	ND	ND	ND	ND	0	944
SWC5	5/22/2023	3'	ND	ND	ND	ND	ND	0	160
SWC6	5/22/2023	3'	ND	ND	ND	ND	ND	0	80
BHC4	5/22/2023	3'	ND	ND	ND	ND	ND	66	256

**NOTES:**

**BGS** Below ground surface  
**mg/kg** milligrams per kilogram  
**ND** Analyte Not Detected

**Highlighted cells indicate exceedance of NMOCD Table 1 Closure Criteria**

### Remediation Activities

On June 14, 2023, Talon Returned to location and removed impacted soils located at C1 (BHC-1). The samples were transported with the chain of custody to Cardinal Laboratories, for analysis of Total Chlorides (SM4500CI-B), Total Petroleum Hydrocarbons (TPH, EPA Method 8015M) and Volatile Organics (BTEX, EPA Method 8021B).

The soil sample results from the laboratory analytical are summarized below. Sample locations are illustrated on Figure 2 in [Appendix I](#) and complete laboratory analytical reports are presented in [Appendix V](#).

**Table 2**  
*Site Closure Analytical Data*

Sample ID	Sample Date	Depth (BGS)	Benzene mg/kg	BTEX mg/kg	GRO mg/kg	DRO mg/kg	MRO mg/kg	Total TPH mg/kg	Chlorides mg/kg
<b>NMOCD Table 1 Closure Criteria 19.15.29 NMAC</b>			<b>10 mg/kg</b>	<b>50 mg/kg</b>	<b>DRO + GRO + MRO combined = 100 mg/kg</b>			<b>100 mg/kg</b>	<b>600 mg/kg</b>
<b>C-1 (BHC-1)</b>	6/14/2023	4'	ND	ND	ND	ND	ND	ND	96
<b>SW-1</b>	6/14/2023	0-4'	ND	ND	ND	ND	ND	ND	496
<b>SW-2</b>	6/14/2023	0-4'	ND	ND	ND	ND	ND	ND	576
<b>SW-3</b>	6/14/2023	0-4'	ND	ND	ND	ND	ND	ND	240
<b>SW-4</b>	6/14/2023	0-4'	ND	ND	ND	ND	ND	ND	128

**NOTES:**

**BGS** Below ground surface  
**mg/kg** Milligrams per kilogram  
**C** Confirmation Sample  
**SW** Sidewall Sample  
**ND** Analyte Not Detected

**Highlighted cells indicate exceedance of NMOCD Table 1 Closure Criteria**

### Remedial Action Summary

- The impacted areas on location were excavated to depths of 4 feet bgs. Talon field titrated soil samples for total chlorides to guide the vertical and horizontal extents of the excavation process.
- Pursuant to NMOCD guidance, confirmation soil samples were collected at 200 square foot intervals and analyzed for TPH, BTEX and Total Chlorides to insure all areas had reached NMOCD closure criteria.
- The excavated areas on the well pad were backfilled with new caliche, machine compacted, and contoured to match the surrounding location.
- Photographic documentation is provided in [Appendix IV](#).
- Copies of the Final C-141s are presented in [Appendix III](#).

---

### **Closure**

Based upon the completed remedial actions and confirmation sampling results, on behalf of Matador Resources, we respectfully request that no further actions be required and the incident closed.

Should you have any questions or if further information is required, please do not hesitate to contact our office at 575-746-8768.

Respectfully submitted,

Talon/LPE

Chad Hensley  
Project Manager

David J. Adkins  
Regional Manager

#### **Attachments:**

Appendix I Site Maps  
Appendix II Groundwater Data, Soil Survey, FEMA Flood Map  
Appendix III C-141 Forms, NMOCD Correspondence  
Appendix IV Photographic Documentation  
Appendix V Laboratory Analytical Reports



## Appendix I

### Site Maps





Site and Sample Location Map  
ANTELOPE RIDGE 24 SWD #001 - Matador Resources  
S: 24 T23S R34E, Lea County New Mexico

Figure 1

Date Saved: 10/15/2018	By: _____	Date: _____	Revisions	Descr: _____
	By: _____	Date: _____		Descr: _____
	Copyright 2015 Souder, Miller & Associates - All Rights Reserved			

Drawn	Lucas Middleton
Checked	_____
Approved	_____



201 South Halaguena Street  
Carlsbad, New Mexico 88221  
(575) 689-7040  
www.soudermiller.com  
Serving the Southwest & Rocky Mountains



Maxar, Microsoft



Drafted: 6/20/2023

1 in = 20 ft

Drafted By: JAI

Matador Resources  
Antelope Ridge 24 SWS #001  
Lea County, New Mexico  
Figure 2





Drafted: 6/20/2023

1 in = 1,000 ft

Drafted By: JAI

Matador Resources  
Antelope Ridge 24 SWS #001  
Lea County, New Mexico  
Karst Map



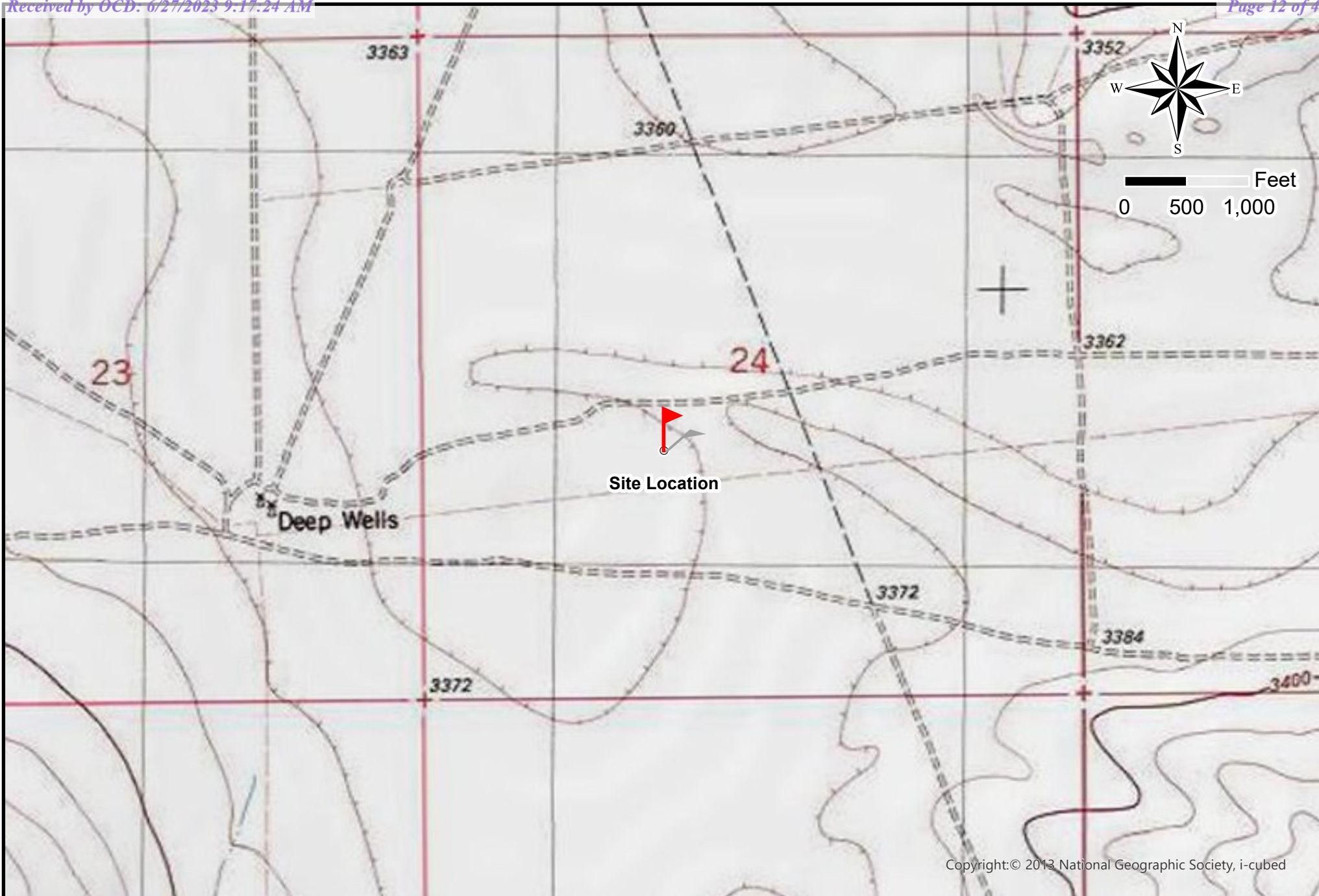

Copyright:© 2013 National Geographic Society, i-cubed



Drafted: 6/20/2023

1 in = 1,000 ft

Drafted By: JAI

Matador Resources  
Antelope Ridge 24 SWS #001  
Lea County, New Mexico  
Topographic Map



## **Appendix II**

Groundwater Data

Soil Survey

FEMA Flood Map



# New Mexico Office of the State Engineer

## Water Column/Average Depth to Water

(A CLW##### in the POD suffix indicates the POD has been replaced & no longer serves a water right file.)

(R=POD has been replaced,  
O=orphaned,  
C=the file is closed)

(quarters are 1=NW 2=NE 3=SW 4=SE)

(quarters are smallest to largest)

(NAD83 UTM in meters)

(In feet)

POD Number	Code	POD Sub-basin	County	Q 64	Q 16	Q 4	Sec	Tws	Rng	X	Y	DepthWell	DepthWater	Water Column
<a href="#">CP 01830 POD1</a>		CP	LE	3	3	3	18	23S	35E	649289	3574568	460	270	190

Average Depth to Water: 270 feet

Minimum Depth: 270 feet

Maximum Depth: 270 feet

**Record Count:** 1

### PLSS Search:

**Section(s):** 18

**Township:** 23S

**Range:** 35E

The data is furnished by the NMOSE/ISC and is accepted by the recipient with the expressed understanding that the OSE/ISC make no warranties, expressed or implied, concerning the accuracy, completeness, reliability, usability, or suitability for any particular purpose of the data.

6/19/23 11:41 AM

WATER COLUMN/ AVERAGE DEPTH TO WATER



United States  
Department of  
Agriculture

**NRCS**

Natural  
Resources  
Conservation  
Service

A product of the National  
Cooperative Soil Survey,  
a joint effort of the United  
States Department of  
Agriculture and other  
Federal agencies, State  
agencies including the  
Agricultural Experiment  
Stations, and local  
participants

# Custom Soil Resource Report for **Lea County, New Mexico**



June 16, 2023

## Soil Map

---

The soil map section includes the soil map for the defined area of interest, a list of soil map units on the map and extent of each map unit, and cartographic symbols displayed on the map. Also presented are various metadata about data used to produce the map, and a description of each soil map unit.

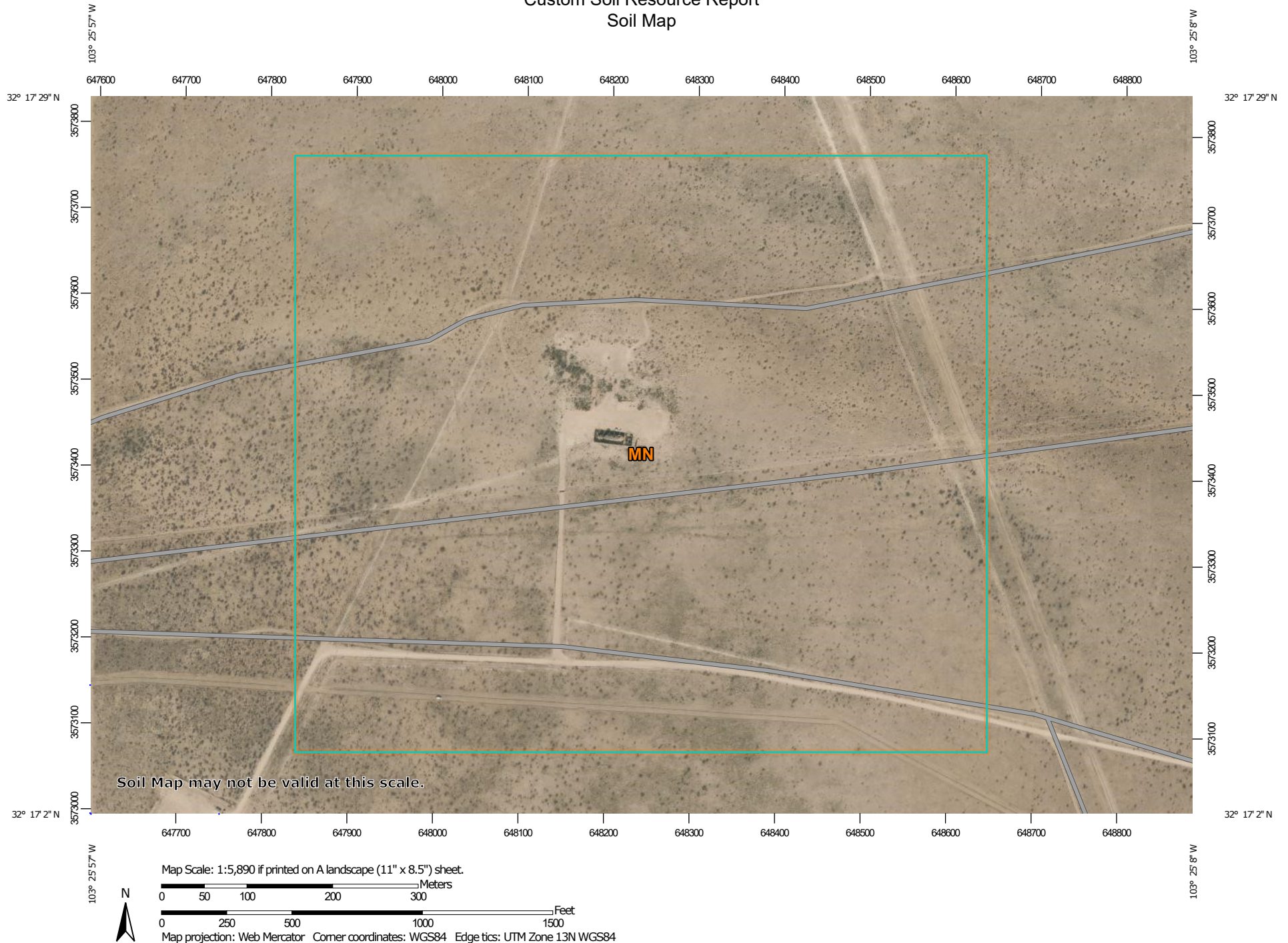

Custom Soil Resource Report  
Soil Map

## Custom Soil Resource Report

## MAP LEGEND

## Area of Interest (AOI)

 Area of Interest (AOI)

## Soils

 Soil Map Unit Polygons

 Soil Map Unit Lines

 Soil Map Unit Points

## Special Point Features

 Blowout

 Borrow Pit

 Clay Spot

 Closed Depression

 Gravel Pit

 Gravelly Spot

 Landfill

 Lava Flow

 Marsh or swamp

 Mine or Quarry

 Miscellaneous Water

 Perennial Water

 Rock Outcrop

 Saline Spot

 Sandy Spot

 Severely Eroded Spot

 Sinkhole

 Slide or Slip

 Sodic Spot

 Spoil Area

 Stony Spot

 Very Stony Spot

 Wet Spot

 Other

 Special Line Features

## Water Features

 Streams and Canals

## Transportation

 Rails

 Interstate Highways

 US Routes

 Major Roads

 Local Roads

## Background

 Aerial Photography

## MAP INFORMATION

The soil surveys that comprise your AOI were mapped at 1:20,000.

Warning: Soil Map may not be valid at this scale.

Enlargement of maps beyond the scale of mapping can cause misunderstanding of the detail of mapping and accuracy of soil line placement. The maps do not show the small areas of contrasting soils that could have been shown at a more detailed scale.

Please rely on the bar scale on each map sheet for map measurements.

Source of Map: Natural Resources Conservation Service  
Web Soil Survey URL:  
Coordinate System: Web Mercator (EPSG:3857)

Maps from the Web Soil Survey are based on the Web Mercator projection, which preserves direction and shape but distorts distance and area. A projection that preserves area, such as the Albers equal-area conic projection, should be used if more accurate calculations of distance or area are required.

This product is generated from the USDA-NRCS certified data as of the version date(s) listed below.

Soil Survey Area: Lea County, New Mexico  
Survey Area Data: Version 19, Sep 8, 2022

Soil map units are labeled (as space allows) for map scales 1:50,000 or larger.

Date(s) aerial images were photographed: Feb 7, 2020—May 12, 2020

The orthophoto or other base map on which the soil lines were compiled and digitized probably differs from the background imagery displayed on these maps. As a result, some minor shifting of map unit boundaries may be evident.

## Custom Soil Resource Report

## Lea County, New Mexico

## MN—Ratliff-Wink fine sandy loams

## Map Unit Setting

*National map unit symbol:* dmqf

*Elevation:* 3,000 to 3,900 feet

*Mean annual precipitation:* 10 to 15 inches

*Mean annual air temperature:* 60 to 62 degrees F

*Frost-free period:* 190 to 205 days

*Farmland classification:* Farmland of statewide importance

## Map Unit Composition

*Ratliff and similar soils:* 45 percent

*Wink and similar soils:* 40 percent

*Minor components:* 15 percent

*Estimates are based on observations, descriptions, and transects of the mapunit.*

## Description of Ratliff

## Setting

*Landform:* Plains

*Landform position (three-dimensional):* Dip

*Down-slope shape:* Convex

*Across-slope shape:* Convex

*Parent material:* Calcareous alluvium and/or calcareous eolian deposits derived from sedimentary rock

## Typical profile

*A - 0 to 4 inches:* fine sandy loam

*Bw - 4 to 22 inches:* clay loam

*Bk - 22 to 60 inches:* clay loam

## Properties and qualities

*Slope:* 0 to 3 percent

*Depth to restrictive feature:* More than 80 inches

*Drainage class:* Well drained

*Runoff class:* Low

*Capacity of the most limiting layer to transmit water (Ksat):* Moderately high to high (0.60 to 2.00 in/hr)

*Depth to water table:* More than 80 inches

*Frequency of flooding:* None

*Frequency of ponding:* None

*Calcium carbonate, maximum content:* 50 percent

*Gypsum, maximum content:* 1 percent

*Maximum salinity:* Nonsaline to very slightly saline (0.0 to 2.0 mmhos/cm)

*Sodium adsorption ratio, maximum:* 2.0

*Available water supply, 0 to 60 inches:* Moderate (about 8.1 inches)

## Interpretive groups

*Land capability classification (irrigated):* 4e

*Land capability classification (nonirrigated):* 6c

*Hydrologic Soil Group:* B

*Ecological site:* R070BC007NM - Loamy

*Hydric soil rating:* No

## Custom Soil Resource Report

**Description of Wink****Setting**

*Landform:* Plains

*Landform position (three-dimensional):* Dip

*Down-slope shape:* Convex

*Across-slope shape:* Convex

*Parent material:* Calcareous sandy alluvium and/or calcareous sandy eolian deposits derived from sedimentary rock

**Typical profile**

*A - 0 to 12 inches:* fine sandy loam

*Bk - 12 to 23 inches:* sandy loam

*BCK - 23 to 60 inches:* sandy loam

**Properties and qualities**

*Slope:* 0 to 3 percent

*Depth to restrictive feature:* More than 80 inches

*Drainage class:* Well drained

*Runoff class:* Very low

*Capacity of the most limiting layer to transmit water (Ksat):* High (2.00 to 6.00 in/hr)

*Depth to water table:* More than 80 inches

*Frequency of flooding:* None

*Frequency of ponding:* None

*Calcium carbonate, maximum content:* 30 percent

*Gypsum, maximum content:* 1 percent

*Maximum salinity:* Nonsaline to very slightly saline (0.0 to 2.0 mmhos/cm)

*Sodium adsorption ratio, maximum:* 2.0

*Available water supply, 0 to 60 inches:* Low (about 4.7 inches)

**Interpretive groups**

*Land capability classification (irrigated):* None specified

*Land capability classification (nonirrigated):* 7e

*Hydrologic Soil Group:* A

*Ecological site:* R070BD004NM - Sandy

*Hydric soil rating:* No

**Minor Components****Kermit**

*Percent of map unit:* 6 percent

*Ecological site:* R070BC022NM - Sandhills

*Hydric soil rating:* No

**Maljamar**

*Percent of map unit:* 5 percent

*Ecological site:* R070BD003NM - Loamy Sand

*Hydric soil rating:* No

**Palomas**

*Percent of map unit:* 4 percent

*Ecological site:* R070BD003NM - Loamy Sand

*Hydric soil rating:* No



# National Flood Hazard Layer FIRMette



103°25'52"W 32°17'33"N



0 250 500 1,000 1,500 2,000 Feet

1:6,000

103°25'14"W 32°17'3"N

Released to Imaging: 6/29/2023 10:37:51 AM

Basemap Imagery Source: USGS National Map 2023

## Legend

SEE FIS REPORT FOR DETAILED LEGEND AND INDEX MAP FOR FIRM PANEL LAYOUT

SPECIAL FLOOD HAZARD AREAS		Without Base Flood Elevation (BFE) Zone A, V, A99
		With BFE or Depth Zone AE, AO, AH, VE, AR
		Regulatory Floodway
OTHER AREAS OF FLOOD HAZARD		0.2% Annual Chance Flood Hazard, Areas of 1% annual chance flood with average depth less than one foot or with drainage areas of less than one square mile Zone X
		Future Conditions 1% Annual Chance Flood Hazard Zone X
		Area with Reduced Flood Risk due to Levee. See Notes. Zone X
		Area with Flood Risk due to Levee Zone D
		NO SCREEN Area of Minimal Flood Hazard Zone X
OTHER AREAS		Effective LOMRs
		Area of Undetermined Flood Hazard Zone D
GENERAL STRUCTURES		Channel, Culvert, or Storm Sewer
		Levee, Dike, or Floodwall
OTHER FEATURES		20.2 Cross Sections with 1% Annual Chance Water Surface Elevation
		17.5 Cross Sections with 1% Annual Chance Water Surface Elevation
		Coastal Transect
		Base Flood Elevation Line (BFE)
		Limit of Study
		Jurisdiction Boundary
		Coastal Transect Baseline
		Profile Baseline
MAP PANELS		Digital Data Available
		No Digital Data Available
		Unmapped



The pin displayed on the map is an approximate point selected by the user and does not represent an authoritative property location.

This map complies with FEMA's standards for the use of digital flood maps if it is not void as described below. The basemap shown complies with FEMA's basemap accuracy standards

The flood hazard information is derived directly from the authoritative NFHL web services provided by FEMA. This map was exported on 6/16/2023 at 2:18 PM and does not reflect changes or amendments subsequent to this date and time. The NFHL and effective information may change or become superseded by new data over time.

This map image is void if the one or more of the following map elements do not appear: basemap imagery, flood zone labels, legend, scale bar, map creation date, community identifiers, FIRM panel number, and FIRM effective date. Map images for unmapped and unmodernized areas cannot be used for regulatory purposes.



## **Appendix III**

C-141 Forms

NMOCD Correspondence

District I  
1625 N. French Dr., Hobbs, NM 88240  
District II  
811 S. First St., Artesia, NM 88210  
District III  
1000 Rio Brazos Road, Aztec, NM 87410  
District IV  
1220 S. St. Francis Dr., Santa Fe, NM 87505

State of New Mexico  
Energy Minerals and Natural Resources

Oil Conservation Division  
1220 South St. Francis Dr.  
Santa Fe, NM 87505

Form C-141  
Revised April 3, 2017

Submit 1 Copy to appropriate District Office in  
accordance with 19.15.29 NMAC.

## Release Notification and Corrective Action

1RP-5099

## OPERATOR

☐ Initial Report ☒ Final Report

Name of Company Matador Resources Company	Contact John Hurt
Address 5400 LBJ Freeway, Suite 1500 Dallas, TX 75240	Telephone No. 972-371-5200
Facility Name ANTELOPE RIDGE 24 SWD #001	Facility Type Salt Water Disposal

Surface Owner State of New Mexico	Mineral Owner State of New Mexico	API No. 30-025-26547
-----------------------------------	-----------------------------------	----------------------

## LOCATION OF RELEASE

Unit Letter K	Section 24	Township 23S	Range 34E	Feet from the 1980	North/South Line South	Feet from the 1980	East/West Line West	County Lea
------------------	---------------	-----------------	--------------	-----------------------	---------------------------	-----------------------	------------------------	---------------

Latitude 32.288089° Longitude -103.426398° NAD83

## NATURE OF RELEASE

Type of Release Produced Water	Volume of Release 1,119 bbl	Volume Recovered 937 bbl
Source of Release Equipment Failure	Date and Hour of Occurrence 6/7/18 ~6:00 p.m.	Date and Hour of Discovery 6/7/18 ~8:00p.m..
Was Immediate Notice Given? <input checked="" type="checkbox"/> Yes <input type="checkbox"/> No <input type="checkbox"/> Not Required	If YES, To Whom? Olivia Yu	
By Whom? Lucas Middleton( SMA)	Date and Hour 6/8/18 3:08 pm	
Was a Watercourse Reached? <input type="checkbox"/> Yes <input checked="" type="checkbox"/> No	If YES, Volume Impacting the Watercourse.	

If a Watercourse was Impacted, Describe Fully.\*

N/A

Describe Cause of Problem and Remedial Action Taken.\*

Piping on Gun barrel failed and lost of power causing the secondary containment to fill until the fluids spilled over the front of the battery running east and pooled in roadway and pasture. The location was shut down and a vacuum truck was on site vacuuming all standing fluids

Describe Area Affected and Cleanup Action Taken.\*

The release occurred within the secondary containment and on the pad, road and pasture (~544 square yards). SMA will delineate and submit a work plan for approval of remediation actions.

I hereby certify that the information given above is true and complete to the best of my knowledge and understand that pursuant to NMOC rules and regulations all operators are required to report and/or file certain release notifications and perform corrective actions for releases which may endanger public health or the environment. The acceptance of a C-141 report by the NMOC marked as "Final Report" does not relieve the operator of liability should their operations have failed to adequately investigate and remediate contamination that pose a threat to ground water, surface water, human health or the environment. In addition, NMOC acceptance of a C-141 report does not relieve the operator of responsibility for compliance with any other federal, state, or local laws and/or regulations.

## OIL CONSERVATION DIVISION

Signature: 	Approved by Environmental Specialist:		
Printed Name: John Hurt			
Title: RES Specialist	Approval Date:	Expiration Date:	
E-mail Address: <a href="mailto:Jhurt@matadorresources.com">Jhurt@matadorresources.com</a>	Conditions of Approval:		Attached <input type="checkbox"/>
Date: Phone: 972-371-5200			

\* Attach Additional Sheets If Necessary

Incident ID	NOY1816657191
District RP	
Facility ID	
Application ID	

## Closure

The responsible party must attach information demonstrating they have complied with all applicable closure requirements and any conditions or directives of the OCD. This demonstration should be in the form of a comprehensive report (electronic submittals in .pdf format are preferred) including a scaled site map, sampling diagrams, relevant field notes, photographs of any excavation prior to backfilling, laboratory data including chain of custody documents of final sampling, and a narrative of the remedial activities. Refer to 19.15.29.12 NMAC.

**Closure Report Attachment Checklist:** *Each of the following items must be included in the closure report.*

- ☒ A scaled site and sampling diagram as described in 19.15.29.11 NMAC
- ☒ Photographs of the remediated site prior to backfill or photos of the liner integrity if applicable (Note: appropriate OCD District office must be notified 2 days prior to liner inspection)
- ☒ Laboratory analyses of final sampling (Note: appropriate ODC District office must be notified 2 days prior to final sampling)
- ☒ Description of remediation activities

I hereby certify that the information given above is true and complete to the best of my knowledge and understand that pursuant to OCD rules and regulations all operators are required to report and/or file certain release notifications and perform corrective actions for releases which may endanger public health or the environment. The acceptance of a C-141 report by the OCD does not relieve the operator of liability should their operations have failed to adequately investigate and remediate contamination that pose a threat to groundwater, surface water, human health or the environment. In addition, OCD acceptance of a C-141 report does not relieve the operator of responsibility for compliance with any other federal, state, or local laws and/or regulations. The responsible party acknowledges they must substantially restore, reclaim, and re-vegetate the impacted surface area to the conditions that existed prior to the release or their final land use in accordance with 19.15.29.13 NMAC including notification to the OCD when reclamation and re-vegetation are complete.

Printed Name: Clinton Talley Title: Environmental, Health & Safety Supervisor

Signature: *Clinton Talley* Date: 6/27/2023

email: clinton.talley@matadorresources.com Telephone: 337-319-8398

**OCD Only**

Received by: OCD Date: 06/27/2023

Closure approval by the OCD does not relieve the responsible party of liability should their operations have failed to adequately investigate and remediate contamination that poses a threat to groundwater, surface water, human health, or the environment nor does not relieve the responsible party of compliance with any other federal, state, or local laws and/or regulations.

Closure Approved by: *Ashley Maxwell* Date: 06/29/2023

Printed Name: Ashley Maxwell Title: Environmental Specialist





## **Appendix IV**

### Photographic Documentation



Antelope Ridge 24 SWD #001 / Sample Event  
Lea County, NM



**Photograph No.1 Description:**

BHC4 Sample Point @ 3'



**Photograph No.2 Description:**

SWC5 Sample Point @ 3'



**Photograph No.3 Description:**

SWC6 Sample Point @ 3'



**Photograph No.4 Description:**

BHC3 Sample Point @ 2'



**Photograph No.5 Description:**

BHC1 Sample Point @ 2'

**Photograph No.6 Description:**

BHC1 Excavation to remove contaminated soils.



## **Appendix V**

### Laboratory Reports



PHONE (575) 393-2326 ° 101 E. MARLAND ° HOBBS, NM 88240

---

May 30, 2023

DAVID ADKINS

TALON LPE

408 W. TEXAS AVE.

ARTESIA, NM 88210

RE: ANTELOPE RIDGE 24 SWD #001

Enclosed are the results of analyses for samples received by the laboratory on 05/24/23 13:25.

Cardinal Laboratories is accredited through Texas NELAP under certificate number T104704398-22-15. Accreditation applies to drinking water, non-potable water and solid and chemical materials. All accredited analytes are denoted by an asterisk (\*). For a complete list of accredited analytes and matrices visit the TCEQ website at [www.tceq.texas.gov/field/qa/lab\\_accred\\_certif.html](http://www.tceq.texas.gov/field/qa/lab_accred_certif.html).

Cardinal Laboratories is accredited through the State of Colorado Department of Public Health and Environment for:

Method EPA 552.2	Haloacetic Acids (HAA-5)
Method EPA 524.2	Total Trihalomethanes (TTHM)
Method EPA 524.4	Regulated VOCs (V1, V2, V3)

Accreditation applies to public drinking water matrices.

This report meets NELAP requirements and is made up of a cover page, analytical results, and a copy of the original chain-of-custody. If you have any questions concerning this report, please feel free to contact me.

Sincerely,

A handwritten signature in black ink that reads "Celey D. Keene".

Celey D. Keene

Lab Director/Quality Manager



PHONE (575) 393-2326 ° 101 E. MARLAND ° HOBBS, NM 88240

**Analytical Results For:**

TALON LPE  
DAVID ADKINS  
408 W. TEXAS AVE.  
ARTESIA NM, 88210  
Fax To: (575) 745-8905

Received:	05/24/2023	Sampling Date:	05/22/2023
Reported:	05/30/2023	Sampling Type:	Soil
Project Name:	ANTELOPE RIDGE 24 SWD #001	Sampling Condition:	Cool & Intact
Project Number:	702520.057.01	Sample Received By:	Shalyn Rodriguez
Project Location:	MATADOR - LEA CO NM		

**Sample ID: BG 3 2' (H232646-01)**

BTX 8021B		mg/kg		Analyzed By: JH					
Analyte	Result	Reporting Limit	Analyzed	Method Blank	BS	% Recovery	True Value QC	RPD	Qualifier
Benzene*	<0.050	0.050	05/25/2023	ND	2.14	107	2.00	1.00	
Toluene*	<0.050	0.050	05/25/2023	ND	2.15	108	2.00	0.529	
Ethylbenzene*	<0.050	0.050	05/25/2023	ND	2.23	112	2.00	0.448	
Total Xylenes*	<0.150	0.150	05/25/2023	ND	6.56	109	6.00	0.342	
Total BTX	<0.300	0.300	05/25/2023	ND					

Surrogate: 4-Bromofluorobenzene (PID) 101 % 71.5-134

Chloride, SM4500Cl-B		mg/kg		Analyzed By: AC						
Analyte	Result	Reporting Limit	Analyzed	Method Blank	BS	% Recovery	True Value QC	RPD	Qualifier	
Chloride	176	16.0	05/25/2023	ND	416	104	400	3.77		

TPH 8015M		mg/kg		Analyzed By: MS					
Analyte	Result	Reporting Limit	Analyzed	Method Blank	BS	% Recovery	True Value QC	RPD	Qualifier
GRO C6-C10*	<10.0	10.0	05/25/2023	ND	190	95.2	200	4.36	
DRO >C10-C28*	<10.0	10.0	05/25/2023	ND	199	99.4	200	4.39	
EXT DRO >C28-C36	<10.0	10.0	05/25/2023	ND					

Surrogate: 1-Chlorooctane 71.7 % 48.2-134

Surrogate: 1-Chlorooctadecane 78.8 % 49.1-148

Cardinal Laboratories

\*=Accredited Analyte

PLEASE NOTE: Liability and Damages. Cardinal's liability and client's exclusive remedy for any claim arising, whether based in contract or tort, shall be limited to the amount paid by client for analyses. All claims, including those for negligence and any other cause whatsoever shall be deemed waived unless made in writing and received by Cardinal within thirty (30) days after completion of the applicable service. In no event shall Cardinal be liable for incidental or consequential damages, including, without limitation, business interruptions, loss of use, or loss of profits incurred by client, its subsidiaries, affiliates or successors arising out of or related to the performance of the services hereunder by Cardinal, regardless of whether such claim is based upon any of the above stated reasons or otherwise. Results relate only to the samples identified above. This report shall not be reproduced except in full with written approval of Cardinal Laboratories.

Celey D. Keene, Lab Director/Quality Manager



PHONE (575) 393-2326 ° 101 E. MARLAND ° HOBBS, NM 88240

**Analytical Results For:**

TALON LPE  
DAVID ADKINS  
408 W. TEXAS AVE.  
ARTESIA NM, 88210  
Fax To: (575) 745-8905

Received:	05/24/2023	Sampling Date:	05/22/2023
Reported:	05/30/2023	Sampling Type:	Soil
Project Name:	ANTELOPE RIDGE 24 SWD #001	Sampling Condition:	Cool & Intact
Project Number:	702520.057.01	Sample Received By:	Shalyn Rodriguez
Project Location:	MATADOR - LEA CO NM		

**Sample ID: BHC 3 2' (H232646-02)**

BTX 8021B		mg/kg		Analyzed By: JH						
Analyte	Result	Reporting Limit	Analyzed	Method Blank	BS	% Recovery	True Value QC	RPD	Qualifier	
Benzene*	<0.050	0.050	05/25/2023	ND	2.14	107	2.00	1.00		
Toluene*	<0.050	0.050	05/25/2023	ND	2.15	108	2.00	0.529		
Ethylbenzene*	<0.050	0.050	05/25/2023	ND	2.23	112	2.00	0.448		
Total Xylenes*	<0.150	0.150	05/25/2023	ND	6.56	109	6.00	0.342		
Total BTX	<0.300	0.300	05/25/2023	ND						

Surrogate: 4-Bromofluorobenzene (PID) 100 % 71.5-134

Chloride, SM4500CI-B		mg/kg		Analyzed By: AC						
Analyte	Result	Reporting Limit	Analyzed	Method Blank	BS	% Recovery	True Value QC	RPD	Qualifier	
Chloride	192	16.0	05/25/2023	ND	416	104	400	3.77		

TPH 8015M		mg/kg		Analyzed By: MS					
Analyte	Result	Reporting Limit	Analyzed	Method Blank	BS	% Recovery	True Value QC	RPD	Qualifier
GRO C6-C10*	<10.0	10.0	05/25/2023	ND	190	95.2	200	4.36	
DRO >C10-C28*	<10.0	10.0	05/25/2023	ND	199	99.4	200	4.39	
EXT DRO >C28-C36	<10.0	10.0	05/25/2023	ND					

Surrogate: 1-Chlorooctane 92.8 % 48.2-134

Surrogate: 1-Chlorooctadecane 104 % 49.1-148

Cardinal Laboratories

\*=Accredited Analyte

PLEASE NOTE: Liability and Damages. Cardinal's liability and client's exclusive remedy for any claim arising, whether based in contract or tort, shall be limited to the amount paid by client for analyses. All claims, including those for negligence and any other cause whatsoever shall be deemed waived unless made in writing and received by Cardinal within thirty (30) days after completion of the applicable service. In no event shall Cardinal be liable for incidental or consequential damages, including, without limitation, business interruptions, loss of use, or loss of profits incurred by client, its subsidiaries, affiliates or successors arising out of or related to the performance of the services hereunder by Cardinal, regardless of whether such claim is based upon any of the above stated reasons or otherwise. Results relate only to the samples identified above. This report shall not be reproduced except in full with written approval of Cardinal Laboratories.

Celey D. Keene, Lab Director/Quality Manager



PHONE (575) 393-2326 ° 101 E. MARLAND ° HOBBS, NM 88240

**Analytical Results For:**

TALON LPE  
 DAVID ADKINS  
 408 W. TEXAS AVE.  
 ARTESIA NM, 88210  
 Fax To: (575) 745-8905

Received: 05/24/2023  
 Reported: 05/30/2023  
 Project Name: ANTELOPE RIDGE 24 SWD #001  
 Project Number: 702520.057.01  
 Project Location: MATADOR - LEA CO NM

Sampling Date: 05/22/2023  
 Sampling Type: Soil  
 Sampling Condition: Cool & Intact  
 Sample Received By: Shalyn Rodriguez

**Sample ID: BHC 1 2' (H232646-03)**

BTX 8021B		mg/kg		Analyzed By: JH						
Analyte	Result	Reporting Limit	Analyzed	Method Blank	BS	% Recovery	True Value QC	RPD	Qualifier	
Benzene*	<0.050	0.050	05/25/2023	ND	2.14	107	2.00	1.00		
Toluene*	<0.050	0.050	05/25/2023	ND	2.15	108	2.00	0.529		
Ethylbenzene*	<0.050	0.050	05/25/2023	ND	2.23	112	2.00	0.448		
Total Xylenes*	<0.150	0.150	05/25/2023	ND	6.56	109	6.00	0.342		
Total BTX	<0.300	0.300	05/25/2023	ND						

Surrogate: 4-Bromofluorobenzene (PID) 99.6 % 71.5-134

Chloride, SM4500CI-B		mg/kg		Analyzed By: AC						
Analyte	Result	Reporting Limit	Analyzed	Method Blank	BS	% Recovery	True Value QC	RPD	Qualifier	
Chloride	944	16.0	05/25/2023	ND	416	104	400	3.77		

TPH 8015M		mg/kg		Analyzed By: MS					
Analyte	Result	Reporting Limit	Analyzed	Method Blank	BS	% Recovery	True Value QC	RPD	Qualifier
GRO C6-C10*	<10.0	10.0	05/25/2023	ND	190	95.2	200	4.36	
DRO >C10-C28*	<10.0	10.0	05/25/2023	ND	199	99.4	200	4.39	
EXT DRO >C28-C36	<10.0	10.0	05/25/2023	ND					

Surrogate: 1-Chlorooctane 77.9 % 48.2-134

Surrogate: 1-Chlorooctadecane 86.9 % 49.1-148

Cardinal Laboratories

\*=Accredited Analyte

PLEASE NOTE: Liability and Damages. Cardinal's liability and client's exclusive remedy for any claim arising, whether based in contract or tort, shall be limited to the amount paid by client for analyses. All claims, including those for negligence and any other cause whatsoever shall be deemed waived unless made in writing and received by Cardinal within thirty (30) days after completion of the applicable service. In no event shall Cardinal be liable for incidental or consequential damages, including, without limitation, business interruptions, loss of use, or loss of profits incurred by client, its subsidiaries, affiliates or successors arising out of or related to the performance of the services hereunder by Cardinal, regardless of whether such claim is based upon any of the above stated reasons or otherwise. Results relate only to the samples identified above. This report shall not be reproduced except in full with written approval of Cardinal Laboratories.

Celey D. Keene, Lab Director/Quality Manager





PHONE (575) 393-2326 ° 101 E. MARLAND ° HOBBS, NM 88240

**Analytical Results For:**

TALON LPE  
DAVID ADKINS  
408 W. TEXAS AVE.  
ARTESIA NM, 88210  
Fax To: (575) 745-8905

Received: 05/24/2023  
Reported: 05/30/2023  
Project Name: ANTELOPE RIDGE 24 SWD #001  
Project Number: 702520.057.01  
Project Location: MATADOR - LEA CO NM

Sampling Date: 05/22/2023  
Sampling Type: Soil  
Sampling Condition: Cool & Intact  
Sample Received By: Shalyn Rodriguez

**Sample ID: SWC 5 3' (H232646-04)**

BTX 8021B		mg/kg		Analyzed By: JH						
Analyte	Result	Reporting Limit	Analyzed	Method Blank	BS	% Recovery	True Value QC	RPD	Qualifier	
Benzene*	<0.050	0.050	05/25/2023	ND	2.14	107	2.00	1.00		
Toluene*	<0.050	0.050	05/25/2023	ND	2.15	108	2.00	0.529		
Ethylbenzene*	<0.050	0.050	05/25/2023	ND	2.23	112	2.00	0.448		
Total Xylenes*	<0.150	0.150	05/25/2023	ND	6.56	109	6.00	0.342		
Total BTX	<0.300	0.300	05/25/2023	ND						

Surrogate: 4-Bromofluorobenzene (PID) 99.0 % 71.5-134

Chloride, SM4500CI-B		mg/kg		Analyzed By: AC						
Analyte	Result	Reporting Limit	Analyzed	Method Blank	BS	% Recovery	True Value QC	RPD	Qualifier	
Chloride	160	16.0	05/25/2023	ND	416	104	400	3.77		

TPH 8015M		mg/kg		Analyzed By: MS					
Analyte	Result	Reporting Limit	Analyzed	Method Blank	BS	% Recovery	True Value QC	RPD	Qualifier
GRO C6-C10*	<10.0	10.0	05/25/2023	ND	190	95.2	200	4.36	
DRO >C10-C28*	<10.0	10.0	05/25/2023	ND	199	99.4	200	4.39	
EXT DRO >C28-C36	<10.0	10.0	05/25/2023	ND					

Surrogate: 1-Chlorooctane 72.6 % 48.2-134

Surrogate: 1-Chlorooctadecane 79.8 % 49.1-148

Cardinal Laboratories

\*=Accredited Analyte

PLEASE NOTE: Liability and Damages. Cardinal's liability and client's exclusive remedy for any claim arising, whether based in contract or tort, shall be limited to the amount paid by client for analyses. All claims, including those for negligence and any other cause whatsoever shall be deemed waived unless made in writing and received by Cardinal within thirty (30) days after completion of the applicable service. In no event shall Cardinal be liable for incidental or consequential damages, including, without limitation, business interruptions, loss of use, or loss of profits incurred by client, its subsidiaries, affiliates or successors arising out of or related to the performance of the services hereunder by Cardinal, regardless of whether such claim is based upon any of the above stated reasons or otherwise. Results relate only to the samples identified above. This report shall not be reproduced except in full with written approval of Cardinal Laboratories.

Celey D. Keene, Lab Director/Quality Manager



PHONE (575) 393-2326 ° 101 E. MARLAND ° HOBBS, NM 88240

**Analytical Results For:**

TALON LPE  
DAVID ADKINS  
408 W. TEXAS AVE.  
ARTESIA NM, 88210  
Fax To: (575) 745-8905

Received: 05/24/2023  
Reported: 05/30/2023  
Project Name: ANTELOPE RIDGE 24 SWD #001  
Project Number: 702520.057.01  
Project Location: MATADOR - LEA CO NM

Sampling Date: 05/22/2023  
Sampling Type: Soil  
Sampling Condition: Cool & Intact  
Sample Received By: Shalyn Rodriguez

**Sample ID: SWC 6 3' (H232646-05)**

BTX 8021B		mg/kg		Analyzed By: JH						
Analyte	Result	Reporting Limit	Analyzed	Method Blank	BS	% Recovery	True Value QC	RPD	Qualifier	
Benzene*	<0.050	0.050	05/25/2023	ND	2.14	107	2.00	1.00		
Toluene*	<0.050	0.050	05/25/2023	ND	2.15	108	2.00	0.529		
Ethylbenzene*	<0.050	0.050	05/25/2023	ND	2.23	112	2.00	0.448		
Total Xylenes*	<0.150	0.150	05/25/2023	ND	6.56	109	6.00	0.342		
Total BTX	<0.300	0.300	05/25/2023	ND						

Surrogate: 4-Bromofluorobenzene (PID) 98.8 % 71.5-134

Chloride, SM4500CI-B		mg/kg		Analyzed By: AC						
Analyte	Result	Reporting Limit	Analyzed	Method Blank	BS	% Recovery	True Value QC	RPD	Qualifier	
Chloride	80.0	16.0	05/25/2023	ND	416	104	400	3.77		

TPH 8015M		mg/kg		Analyzed By: MS					
Analyte	Result	Reporting Limit	Analyzed	Method Blank	BS	% Recovery	True Value QC	RPD	Qualifier
GRO C6-C10*	<10.0	10.0	05/25/2023	ND	190	95.2	200	4.36	
DRO >C10-C28*	<10.0	10.0	05/25/2023	ND	199	99.4	200	4.39	
EXT DRO >C28-C36	<10.0	10.0	05/25/2023	ND					

Surrogate: 1-Chlorooctane 87.6 % 48.2-134

Surrogate: 1-Chlorooctadecane 96.2 % 49.1-148

Cardinal Laboratories

\*=Accredited Analyte

PLEASE NOTE: Liability and Damages. Cardinal's liability and client's exclusive remedy for any claim arising, whether based in contract or tort, shall be limited to the amount paid by client for analyses. All claims, including those for negligence and any other cause whatsoever shall be deemed waived unless made in writing and received by Cardinal within thirty (30) days after completion of the applicable service. In no event shall Cardinal be liable for incidental or consequential damages, including, without limitation, business interruptions, loss of use, or loss of profits incurred by client, its subsidiaries, affiliates or successors arising out of or related to the performance of the services hereunder by Cardinal, regardless of whether such claim is based upon any of the above stated reasons or otherwise. Results relate only to the samples identified above. This report shall not be reproduced except in full with written approval of Cardinal Laboratories.

Celey D. Keene, Lab Director/Quality Manager



PHONE (575) 393-2326 ° 101 E. MARLAND ° HOBBS, NM 88240

**Analytical Results For:**

TALON LPE  
DAVID ADKINS  
408 W. TEXAS AVE.  
ARTESIA NM, 88210  
Fax To: (575) 745-8905

Received: 05/24/2023  
Reported: 05/30/2023  
Project Name: ANTELOPE RIDGE 24 SWD #001  
Project Number: 702520.057.01  
Project Location: MATADOR - LEA CO NM

Sampling Date: 05/22/2023  
Sampling Type: Soil  
Sampling Condition: Cool & Intact  
Sample Received By: Shalyn Rodriguez

**Sample ID: BHC 4 3' (H232646-06)**

BTX 8021B		mg/kg		Analyzed By: JH						
Analyte	Result	Reporting Limit	Analyzed	Method Blank	BS	% Recovery	True Value QC	RPD	Qualifier	
Benzene*	<0.050	0.050	05/25/2023	ND	2.14	107	2.00	1.00		
Toluene*	<0.050	0.050	05/25/2023	ND	2.15	108	2.00	0.529		
Ethylbenzene*	<0.050	0.050	05/25/2023	ND	2.23	112	2.00	0.448		
Total Xylenes*	<0.150	0.150	05/25/2023	ND	6.56	109	6.00	0.342		
Total BTX	<0.300	0.300	05/25/2023	ND						

Surrogate: 4-Bromofluorobenzene (PID) 102 % 71.5-134

Chloride, SM4500CI-B		mg/kg		Analyzed By: AC						
Analyte	Result	Reporting Limit	Analyzed	Method Blank	BS	% Recovery	True Value QC	RPD	Qualifier	
Chloride	256	16.0	05/25/2023	ND	416	104	400	3.77		

TPH 8015M		mg/kg		Analyzed By: MS					
Analyte	Result	Reporting Limit	Analyzed	Method Blank	BS	% Recovery	True Value QC	RPD	Qualifier
GRO C6-C10*	<10.0	10.0	05/25/2023	ND	190	95.2	200	4.36	
DRO >C10-C28*	<10.0	10.0	05/25/2023	ND	199	99.4	200	4.39	
EXT DRO >C28-C36	<10.0	10.0	05/25/2023	ND					

Surrogate: 1-Chlorooctane 94.2 % 48.2-134

Surrogate: 1-Chlorooctadecane 101 % 49.1-148

Cardinal Laboratories

\*=Accredited Analyte

PLEASE NOTE: Liability and Damages. Cardinal's liability and client's exclusive remedy for any claim arising, whether based in contract or tort, shall be limited to the amount paid by client for analyses. All claims, including those for negligence and any other cause whatsoever shall be deemed waived unless made in writing and received by Cardinal within thirty (30) days after completion of the applicable service. In no event shall Cardinal be liable for incidental or consequential damages, including, without limitation, business interruptions, loss of use, or loss of profits incurred by client, its subsidiaries, affiliates or successors arising out of or related to the performance of the services hereunder by Cardinal, regardless of whether such claim is based upon any of the above stated reasons or otherwise. Results relate only to the samples identified above. This report shall not be reproduced except in full with written approval of Cardinal Laboratories.

Celey D. Keene, Lab Director/Quality Manager

PHONE (575) 393-2326 ° 101 E. MARLAND ° HOBBS, NM 88240

---

### Notes and Definitions

QM-07	The spike recovery was outside acceptance limits for the MS and/or MSD. The batch was accepted based on acceptable LCS recovery.
ND	Analyte NOT DETECTED at or above the reporting limit
RPD	Relative Percent Difference
**	Samples not received at proper temperature of 6°C or below.
***	Insufficient time to reach temperature.
-	Chloride by SM4500Cl-B does not require samples be received at or below 6°C Samples reported on an as received basis (wet) unless otherwise noted on report

---

Cardinal Laboratories

\*=Accredited Analyte

PLEASE NOTE: Liability and Damages. Cardinal's liability and client's exclusive remedy for any claim arising, whether based in contract or tort, shall be limited to the amount paid by client for analyses. All claims, including those for negligence and any other cause whatsoever shall be deemed waived unless made in writing and received by Cardinal within thirty (30) days after completion of the applicable service. In no event shall Cardinal be liable for incidental or consequential damages, including, without limitation, business interruptions, loss of use, or loss of profits incurred by client, its subsidiaries, affiliates or successors arising out of or related to the performance of the services hereunder by Cardinal, regardless of whether such claim is based upon any of the above stated reasons or otherwise. Results relate only to the samples identified above. This report shall not be reproduced except in full with written approval of Cardinal Laboratories.

A handwritten signature in black ink, appearing to read "Celey D. Keene".

---

Celey D. Keene, Lab Director/Quality Manager

101 East Marland, Hobbs, NM 88240  
(575) 393-2326 FAX (575) 393-2476

Received by OCD: 6/27/2023 9:17:24 AM



PHONE (575) 393-2326 ° 101 E. MARLAND ° HOBBS, NM 88240

---

June 15, 2023

CHAD HENSLEY

TALON LPE

408 W. TEXAS AVE.

ARTESIA, NM 88210

RE: ANTELOPE RIDGE 24 SWD #001

Enclosed are the results of analyses for samples received by the laboratory on 06/14/23 13:45.

Cardinal Laboratories is accredited through Texas NELAP under certificate number T104704398-22-15. Accreditation applies to drinking water, non-potable water and solid and chemical materials. All accredited analytes are denoted by an asterisk (\*). For a complete list of accredited analytes and matrices visit the TCEQ website at [www.tceq.texas.gov/field/qa/lab\\_accred\\_certif.html](http://www.tceq.texas.gov/field/qa/lab_accred_certif.html).

Cardinal Laboratories is accredited through the State of Colorado Department of Public Health and Environment for:

Method EPA 552.2	Haloacetic Acids (HAA-5)
Method EPA 524.2	Total Trihalomethanes (TTHM)
Method EPA 524.4	Regulated VOCs (V1, V2, V3)

Accreditation applies to public drinking water matrices.

This report meets NELAP requirements and is made up of a cover page, analytical results, and a copy of the original chain-of-custody. If you have any questions concerning this report, please feel free to contact me.

Sincerely,

A handwritten signature in black ink that reads "Celey D. Keene". The signature is written in a cursive, flowing style.

Celey D. Keene

Lab Director/Quality Manager



PHONE (575) 393-2326 ° 101 E. MARLAND ° HOBBS, NM 88240

**Analytical Results For:**

TALON LPE  
CHAD HENSLEY  
408 W. TEXAS AVE.  
ARTESIA NM, 88210  
Fax To: (575) 745-8905

Received:	06/14/2023	Sampling Date:	06/13/2023
Reported:	06/15/2023	Sampling Type:	Soil
Project Name:	ANTELOPE RIDGE 24 SWD #001	Sampling Condition:	Cool & Intact
Project Number:	702520.057.01	Sample Received By:	Shalyn Rodriguez
Project Location:	MATADOR - LEA CO NM		

**Sample ID: SW - 1 2.5' (H233054-01)**

BTEX 8021B		mg/kg		Analyzed By: MS					
Analyte	Result	Reporting Limit	Analyzed	Method Blank	BS	% Recovery	True Value QC	RPD	Qualifier
Benzene*	<0.050	0.050	06/15/2023	ND	1.55	77.7	2.00	23.8	
Toluene*	<0.050	0.050	06/15/2023	ND	1.83	91.6	2.00	5.54	
Ethylbenzene*	<0.050	0.050	06/15/2023	ND	1.95	97.4	2.00	1.48	
Total Xylenes*	<0.150	0.150	06/15/2023	ND	5.87	97.8	6.00	3.26	
Total BTEX	<0.300	0.300	06/15/2023	ND					

Surrogate: 4-Bromofluorobenzene (PID) 107 % 71.5-134

Chloride, SM4500Cl-B		mg/kg		Analyzed By: AC						
Analyte	Result	Reporting Limit	Analyzed	Method Blank	BS	% Recovery	True Value QC	RPD	Qualifier	
Chloride	496	16.0	06/14/2023	ND	416	104	400	7.41		

TPH 8015M		mg/kg		Analyzed By: MS					
Analyte	Result	Reporting Limit	Analyzed	Method Blank	BS	% Recovery	True Value QC	RPD	Qualifier
GRO C6-C10*	<10.0	10.0	06/15/2023	ND	200	100	200	5.53	
DRO >C10-C28*	<10.0	10.0	06/15/2023	ND	206	103	200	5.33	
EXT DRO >C28-C36	<10.0	10.0	06/15/2023	ND					

Surrogate: 1-Chlorooctane 96.6 % 48.2-134

Surrogate: 1-Chlorooctadecane 101 % 49.1-148

Cardinal Laboratories

\*=Accredited Analyte

PLEASE NOTE: Liability and Damages. Cardinal's liability and client's exclusive remedy for any claim arising, whether based in contract or tort, shall be limited to the amount paid by client for analyses. All claims, including those for negligence and any other cause whatsoever shall be deemed waived unless made in writing and received by Cardinal within thirty (30) days after completion of the applicable service. In no event shall Cardinal be liable for incidental or consequential damages, including, without limitation, business interruptions, loss of use, or loss of profits incurred by client, its subsidiaries, affiliates or successors arising out of or related to the performance of the services hereunder by Cardinal, regardless of whether such claim is based upon any of the above stated reasons or otherwise. Results relate only to the samples identified above. This report shall not be reproduced except in full with written approval of Cardinal Laboratories.

Celey D. Keene, Lab Director/Quality Manager





PHONE (575) 393-2326 ° 101 E. MARLAND ° HOBBS, NM 88240

**Analytical Results For:**

TALON LPE  
CHAD HENSLEY  
408 W. TEXAS AVE.  
ARTESIA NM, 88210  
Fax To: (575) 745-8905

Received: 06/14/2023  
Reported: 06/15/2023  
Project Name: ANTELOPE RIDGE 24 SWD #001  
Project Number: 702520.057.01  
Project Location: MATADOR - LEA CO NM

Sampling Date: 06/13/2023  
Sampling Type: Soil  
Sampling Condition: Cool & Intact  
Sample Received By: Shalyn Rodriguez

**Sample ID: SW - 2 2.5' (H233054-02)**

BTX 8021B			mg/kg							
			Analyzed By: MS							
Analyte	Result	Reporting Limit	Analyzed	Method Blank	BS	% Recovery	True Value QC	RPD	Qualifier	
Benzene*	<0.050	0.050	06/15/2023	ND	1.55	77.7	2.00	23.8		
Toluene*	<0.050	0.050	06/15/2023	ND	1.83	91.6	2.00	5.54		
Ethylbenzene*	<0.050	0.050	06/15/2023	ND	1.95	97.4	2.00	1.48		
Total Xylenes*	<0.150	0.150	06/15/2023	ND	5.87	97.8	6.00	3.26		
Total BTX	<0.300	0.300	06/15/2023	ND						

Surrogate: 4-Bromofluorobenzene (PID) 107 % 71.5-134

Chloride, SM4500CI-B			mg/kg							
			Analyzed By: AC							
Analyte	Result	Reporting Limit	Analyzed	Method Blank	BS	% Recovery	True Value QC	RPD	Qualifier	
Chloride	576	16.0	06/14/2023	ND	416	104	400	7.41		

TPH 8015M			mg/kg							
			Analyzed By: MS							
Analyte	Result	Reporting Limit	Analyzed	Method Blank	BS	% Recovery	True Value QC	RPD	Qualifier	
GRO C6-C10*	<10.0	10.0	06/15/2023	ND	200	100	200	5.53		
DRO >C10-C28*	<10.0	10.0	06/15/2023	ND	206	103	200	5.33		
EXT DRO >C28-C36	<10.0	10.0	06/15/2023	ND						

Surrogate: 1-Chlorooctane 95.7 % 48.2-134

Surrogate: 1-Chlorooctadecane 102 % 49.1-148

Cardinal Laboratories

\*=Accredited Analyte

PLEASE NOTE: Liability and Damages. Cardinal's liability and client's exclusive remedy for any claim arising, whether based in contract or tort, shall be limited to the amount paid by client for analyses. All claims, including those for negligence and any other cause whatsoever shall be deemed waived unless made in writing and received by Cardinal within thirty (30) days after completion of the applicable service. In no event shall Cardinal be liable for incidental or consequential damages, including, without limitation, business interruptions, loss of use, or loss of profits incurred by client, its subsidiaries, affiliates or successors arising out of or related to the performance of the services hereunder by Cardinal, regardless of whether such claim is based upon any of the above stated reasons or otherwise. Results relate only to the samples identified above. This report shall not be reproduced except in full with written approval of Cardinal Laboratories.

Celey D. Keene, Lab Director/Quality Manager





PHONE (575) 393-2326 ° 101 E. MARLAND ° HOBBS, NM 88240

**Analytical Results For:**

TALON LPE  
CHAD HENSLEY  
408 W. TEXAS AVE.  
ARTESIA NM, 88210  
Fax To: (575) 745-8905

Received: 06/14/2023  
Reported: 06/15/2023  
Project Name: ANTELOPE RIDGE 24 SWD #001  
Project Number: 702520.057.01  
Project Location: MATADOR - LEA CO NM

Sampling Date: 06/13/2023  
Sampling Type: Soil  
Sampling Condition: Cool & Intact  
Sample Received By: Shalyn Rodriguez

**Sample ID: SW - 3 2.5' (H233054-03)**

BTEx 8021B		mg/kg		Analyzed By: MS					
Analyte	Result	Reporting Limit	Analyzed	Method Blank	BS	% Recovery	True Value QC	RPD	Qualifier
Benzene*	<0.050	0.050	06/15/2023	ND	1.55	77.7	2.00	23.8	
Toluene*	<0.050	0.050	06/15/2023	ND	1.83	91.6	2.00	5.54	
Ethylbenzene*	<0.050	0.050	06/15/2023	ND	1.95	97.4	2.00	1.48	
Total Xylenes*	<0.150	0.150	06/15/2023	ND	5.87	97.8	6.00	3.26	
Total BTEX	<0.300	0.300	06/15/2023	ND					

Surrogate: 4-Bromofluorobenzene (PID) 107 % 71.5-134

Chloride, SM4500Cl-B		mg/kg		Analyzed By: AC					
Analyte	Result	Reporting Limit	Analyzed	Method Blank	BS	% Recovery	True Value QC	RPD	Qualifier
Chloride	240	16.0	06/14/2023	ND	416	104	400	7.41	

TPH 8015M		mg/kg		Analyzed By: MS					
Analyte	Result	Reporting Limit	Analyzed	Method Blank	BS	% Recovery	True Value QC	RPD	Qualifier
GRO C6-C10*	<10.0	10.0	06/15/2023	ND	200	100	200	5.53	
DRO >C10-C28*	<10.0	10.0	06/15/2023	ND	206	103	200	5.33	
EXT DRO >C28-C36	<10.0	10.0	06/15/2023	ND					

Surrogate: 1-Chlorooctane 90.4 % 48.2-134

Surrogate: 1-Chlorooctadecane 96.0 % 49.1-148

Cardinal Laboratories

\*=Accredited Analyte

PLEASE NOTE: Liability and Damages. Cardinal's liability and client's exclusive remedy for any claim arising, whether based in contract or tort, shall be limited to the amount paid by client for analyses. All claims, including those for negligence and any other cause whatsoever shall be deemed waived unless made in writing and received by Cardinal within thirty (30) days after completion of the applicable service. In no event shall Cardinal be liable for incidental or consequential damages, including, without limitation, business interruptions, loss of use, or loss of profits incurred by client, its subsidiaries, affiliates or successors arising out of or related to the performance of the services hereunder by Cardinal, regardless of whether such claim is based upon any of the above stated reasons or otherwise. Results relate only to the samples identified above. This report shall not be reproduced except in full with written approval of Cardinal Laboratories.

Celey D. Keene, Lab Director/Quality Manager



PHONE (575) 393-2326 ° 101 E. MARLAND ° HOBBS, NM 88240

**Analytical Results For:**

TALON LPE  
CHAD HENSLEY  
408 W. TEXAS AVE.  
ARTESIA NM, 88210  
Fax To: (575) 745-8905

Received: 06/14/2023  
Reported: 06/15/2023  
Project Name: ANTELOPE RIDGE 24 SWD #001  
Project Number: 702520.057.01  
Project Location: MATADOR - LEA CO NM

Sampling Date: 06/13/2023  
Sampling Type: Soil  
Sampling Condition: Cool & Intact  
Sample Received By: Shalyn Rodriguez

**Sample ID: SW - 4 2.5' (H233054-04)**

BTEX 8021B		mg/kg		Analyzed By: MS						
Analyte	Result	Reporting Limit	Analyzed	Method Blank	BS	% Recovery	True Value QC	RPD	Qualifier	
Benzene*	<0.050	0.050	06/15/2023	ND	1.55	77.7	2.00	23.8		
Toluene*	<0.050	0.050	06/15/2023	ND	1.83	91.6	2.00	5.54		
Ethylbenzene*	<0.050	0.050	06/15/2023	ND	1.95	97.4	2.00	1.48		
Total Xylenes*	<0.150	0.150	06/15/2023	ND	5.87	97.8	6.00	3.26		
Total BTEX	<0.300	0.300	06/15/2023	ND						

Surrogate: 4-Bromofluorobenzene (PID) 102 % 71.5-134

Chloride, SM4500Cl-B		mg/kg		Analyzed By: AC						
Analyte	Result	Reporting Limit	Analyzed	Method Blank	BS	% Recovery	True Value QC	RPD	Qualifier	
Chloride	128	16.0	06/14/2023	ND	416	104	400	7.41		

TPH 8015M		mg/kg		Analyzed By: MS					
Analyte	Result	Reporting Limit	Analyzed	Method Blank	BS	% Recovery	True Value QC	RPD	Qualifier
GRO C6-C10*	<10.0	10.0	06/15/2023	ND	200	100	200	5.53	
DRO >C10-C28*	<10.0	10.0	06/15/2023	ND	206	103	200	5.33	
EXT DRO >C28-C36	<10.0	10.0	06/15/2023	ND					

Surrogate: 1-Chlorooctane 96.0 % 48.2-134

Surrogate: 1-Chlorooctadecane 101 % 49.1-148

Cardinal Laboratories

\*=Accredited Analyte

PLEASE NOTE: Liability and Damages. Cardinal's liability and client's exclusive remedy for any claim arising, whether based in contract or tort, shall be limited to the amount paid by client for analyses. All claims, including those for negligence and any other cause whatsoever shall be deemed waived unless made in writing and received by Cardinal within thirty (30) days after completion of the applicable service. In no event shall Cardinal be liable for incidental or consequential damages, including, without limitation, business interruptions, loss of use, or loss of profits incurred by client, its subsidiaries, affiliates or successors arising out of or related to the performance of the services hereunder by Cardinal, regardless of whether such claim is based upon any of the above stated reasons or otherwise. Results relate only to the samples identified above. This report shall not be reproduced except in full with written approval of Cardinal Laboratories.

Celey D. Keene, Lab Director/Quality Manager



PHONE (575) 393-2326 ° 101 E. MARLAND ° HOBBS, NM 88240

**Analytical Results For:**

TALON LPE  
CHAD HENSLEY  
408 W. TEXAS AVE.  
ARTESIA NM, 88210  
Fax To: (575) 745-8905

Received: 06/14/2023  
Reported: 06/15/2023  
Project Name: ANTELOPE RIDGE 24 SWD #001  
Project Number: 702520.057.01  
Project Location: MATADOR - LEA CO NM

Sampling Date: 06/13/2023  
Sampling Type: Soil  
Sampling Condition: Cool & Intact  
Sample Received By: Shalyn Rodriguez

**Sample ID: C - 1 4' (H233054-05)**

BTEX 8021B		mg/kg		Analyzed By: MS						
Analyte	Result	Reporting Limit	Analyzed	Method Blank	BS	% Recovery	True Value QC	RPD	Qualifier	
Benzene*	<0.050	0.050	06/15/2023	ND	1.55	77.7	2.00	23.8		
Toluene*	<0.050	0.050	06/15/2023	ND	1.83	91.6	2.00	5.54		
Ethylbenzene*	<0.050	0.050	06/15/2023	ND	1.95	97.4	2.00	1.48		
Total Xylenes*	<0.150	0.150	06/15/2023	ND	5.87	97.8	6.00	3.26		
Total BTEX	<0.300	0.300	06/15/2023	ND						

Surrogate: 4-Bromofluorobenzene (PID) 109 % 71.5-134

Chloride, SM4500Cl-B		mg/kg		Analyzed By: AC					
Analyte	Result	Reporting Limit	Analyzed	Method Blank	BS	% Recovery	True Value QC	RPD	Qualifier
Chloride	96.0	16.0	06/14/2023	ND	416	104	400	7.41	

TPH 8015M		mg/kg		Analyzed By: MS					
Analyte	Result	Reporting Limit	Analyzed	Method Blank	BS	% Recovery	True Value QC	RPD	Qualifier
GRO C6-C10*	<10.0	10.0	06/15/2023	ND	200	100	200	5.53	
DRO >C10-C28*	<10.0	10.0	06/15/2023	ND	206	103	200	5.33	
EXT DRO >C28-C36	<10.0	10.0	06/15/2023	ND					

Surrogate: 1-Chlorooctane 96.4 % 48.2-134

Surrogate: 1-Chlorooctadecane 101 % 49.1-148

Cardinal Laboratories

\*=Accredited Analyte

PLEASE NOTE: Liability and Damages. Cardinal's liability and client's exclusive remedy for any claim arising, whether based in contract or tort, shall be limited to the amount paid by client for analyses. All claims, including those for negligence and any other cause whatsoever shall be deemed waived unless made in writing and received by Cardinal within thirty (30) days after completion of the applicable service. In no event shall Cardinal be liable for incidental or consequential damages, including, without limitation, business interruptions, loss of use, or loss of profits incurred by client, its subsidiaries, affiliates or successors arising out of or related to the performance of the services hereunder by Cardinal, regardless of whether such claim is based upon any of the above stated reasons or otherwise. Results relate only to the samples identified above. This report shall not be reproduced except in full with written approval of Cardinal Laboratories.

Celey D. Keene, Lab Director/Quality Manager

PHONE (575) 393-2326 ° 101 E. MARLAND ° HOBBS, NM 88240

---

### Notes and Definitions

QR-04	The RPD for the BS/BSD was outside of historical limits.
BS-3	Blank spike recovery outside of lab established statistical limits, but still within method limits. Data is not adversely affected.
ND	Analyte NOT DETECTED at or above the reporting limit
RPD	Relative Percent Difference
**	Samples not received at proper temperature of 6°C or below.
***	Insufficient time to reach temperature.
-	Chloride by SM4500Cl-B does not require samples be received at or below 6°C Samples reported on an as received basis (wet) unless otherwise noted on report

---

Cardinal Laboratories

\*=Accredited Analyte

PLEASE NOTE: Liability and Damages. Cardinal's liability and client's exclusive remedy for any claim arising, whether based in contract or tort, shall be limited to the amount paid by client for analyses. All claims, including those for negligence and any other cause whatsoever shall be deemed waived unless made in writing and received by Cardinal within thirty (30) days after completion of the applicable service. In no event shall Cardinal be liable for incidental or consequential damages, including, without limitation, business interruptions, loss of use, or loss of profits incurred by client, its subsidiaries, affiliates or successors arising out of or related to the performance of the services hereunder by Cardinal, regardless of whether such claim is based upon any of the above stated reasons or otherwise. Results relate only to the samples identified above. This report shall not be reproduced except in full with written approval of Cardinal Laboratories.

A handwritten signature in black ink, appearing to read "Celey D. Keene".

---

Celey D. Keene, Lab Director/Quality Manager



101 East Marland, Hobbs, NM 88240  
(575) 393-2326 FAX (575) 393-2476

**CHAIN-OF-CUSTODY AND ANALYSIS REQUEST**

Company Name: Talon LPE

Project Manager: C. Hensley

Address: 408 W. Texas Ave

City: Artesia

State: NM zip: 88210

Phone #: 575.746.8768

Fax #:

Project #: 702520.057.01

Project Owner: Matador

Project Name: Antelope Ridge

Project Location: Eddy county

Sample Name: N. Rose

**BILL TO**

P.O. #:

Company: Matador

Attn:

Address:

City:

State: Zip:

Phone #:

Fax #:

**ANALYSIS REQUEST**

FOR LAB USE ONLY

Lab I.D.

Sample I.D.

H233054

1 SW-1 2.5'  
2 SW-2  
3 SW-3  
4 SW-4  
5 C-1 4'

(G)RAB OR (C)OMP.  
# CONTAINERS  
GROUNDWATER  
WASTEWATER  
SOIL  
OIL  
SLUDGE  
OTHER :  
ACID/BASE:  
ICE / COOL  
OTHER :

DATE TIME

CL  
BTEX  
TPH

6/13/2013 1301  
1336  
1355  
1752  
1717

PLEASE NOTE: Liability and Damages. Cardinal's liability and client's exclusive remedy for any claim arising whether based in contract or tort, shall be limited to the amount paid by the client for the analyses. All claims, including those for negligence and any other cause whatsoever shall be deemed waived unless made in writing and received by Cardinal within 30 days after completion of the applicable service. In no event shall Cardinal be liable for incidental or consequential damages, including without limitation, business interruptions, loss of use, or loss of profits incurred by client, its subsidiaries, affiliates or successors arising out of or related to the performance of services hereunder by Cardinal, regardless of whether such claim is based upon any of the above stated reasons or otherwise.

Relinquished By:

Date: 6-14-23 Received By: [Signature]

Relinquished By:

Date: 6-14-23 Received By: [Signature]

Delivered By: (Circle One)

Sampler - UPS - Bus - Other:

-0.8°C / -1.4°C

Sample Condition  
Cool Intact  
Yes Yes  
No No

CHECKED BY: [Signature]

Phone Result: ☐ Yes ☐ No Add'l Phone #:  
Fax Result: ☐ Yes ☐ No Add'l Fax #:

REMARKS:

24 hour Rush

**District I**  
1625 N. French Dr., Hobbs, NM 88240  
Phone:(575) 393-6161 Fax:(575) 393-0720  
**District II**  
811 S. First St., Artesia, NM 88210  
Phone:(575) 748-1283 Fax:(575) 748-9720  
**District III**  
1000 Rio Brazos Rd., Aztec, NM 87410  
Phone:(505) 334-6178 Fax:(505) 334-6170  
**District IV**  
1220 S. St Francis Dr., Santa Fe, NM 87505  
Phone:(505) 476-3470 Fax:(505) 476-3462

State of New Mexico  
Energy, Minerals and Natural Resources  
Oil Conservation Division  
1220 S. St Francis Dr.  
Santa Fe, NM 87505

CONDITIONS  
  
Action 233206

CONDITIONS

Operator: MATADOR PRODUCTION COMPANY One Lincoln Centre Dallas, TX 75240	OGRID: 228937
	Action Number: 233206
	Action Type: [C-141] Release Corrective Action (C-141)

CONDITIONS

Created By	Condition	Condition Date
amaxwell	None	6/29/2023