

**REVIEWED****By Mike Buchanan at 3:31 pm, Jun 18, 2024**

HESS CORPORATION

1501 McKinney

Houston, TX 77010

Brian Epperson

Director, EHS

Phone: (713) 496-7296

E-Mail: bepperson@hess.com

April 1, 2024

Mr. Bradford Billings
New Mexico Oil Conservation District
1220 South St. Francis Drive
Santa Fe, NM 87505
VIA: Electronic Submittal Only

**Re: 2023 Annual Site Update
Former State G 4 Tank Battery, 1R-4863
Sec 18, T-19S, R-37E, Lea County**

Dear Mr. Billings:

Enclosed please find the Annual Site Update for 1R-4863, Former State G 4 Tank Battery, located in Monument, New Mexico. The report summarizes the environmental efforts and sampling results for 2023.

If you should have any further questions or require additional information, please feel free to contact the undersigned at 713-496-7296.

Sincerely,

Brian Epperson
Director, EHS

cc: Brad Freeman, Axis Environmental Management

Review of the 2023
Annual Site Update for
the Former State G 4
Tank Battery, 1R-4863:
Content is satisfactory

1. Continue utilizing
absorbent sock in
MW-3 unless it is not
showing effective
results in completely
eliminating TPH.

2. Continue to conduct
semi-annual
groundwater monitoring
in wells as prescribed.

3. Continue to operate
solar sippers in MW-1,
MW-2 and MW-5;

continue vacuum
events in MW-1, MW-2
and MW-5.

4. Submit the 2024
Groundwater update
report by April 1, 2025.

1R-4863, Former State G 4 Tank Battery, located in
Monument, New Mexico. The report summarizes the environmental efforts and sampling results for 2023.

If you should have any further questions or require additional information, please feel free to contact the
undersigned at 713-496-7296.

FORMER STATE G 4 TANK BATTERY 1R-4863

SECTION 18, TOWNSHIP 19 SOUTH, RANGE 37 EAST
MONUMENT, LEA COUNTY, NEW MEXICO

SITE UPDATE

Prepared for:



Hess Corporation

1501 McKinney
Houston, TX 77010

Prepared by:



TABLE OF CONTENTS

1.0 INTRODUCTION.....	2
2.0 GROUNDWATER ACTIVITIES.....	4
3.0 LPH RECOVERY ACTIVITIES.....	5
4.0 RECOMMENDATIONS.....	6

LIST OF TABLES

TABLE 1	SUMMARY OF GROUNDWATER GAUGING DATA
TABLE 2A	SUMMARY OF GROUNDWATER MONITORING RESULTS: BTEX, TPH, CHLORIDE, AND TDS
TABLE 2B	SUMMARY OF GROUNDWATER MONITORING RESULTS: PAHs
TABLE 3	SOLAR SIPPER RECOVERY SUMMARY
TABLE 4	SUMMARY OF SOLAR SIPPER RECOVERY

LIST OF FIGURES

FIGURE 1	SITE LOCATION MAP
FIGURE 2	GROUNDWATER POTENTIOMETRIC MAP (JULY 20, 2023)
FIGURE 3	GROUNDWATER POTENTIOMETRIC MAP (DECEMBER 5, 2023)
FIGURE 4	GROUNDWATER ANALYTICAL MAP

ATTACHMENTS

ATTACHMENT 1	LABORATORY REPORTS
ATTACHMENT 2	LPH THICKNESS GRAPH

1.0 INTRODUCTION

The Former State G 4 Tank Battery (State G 4 or the Site) is located northwest of Monument, New Mexico in southern Lea County. The legal description of the site is Section 18, Township 19 South, and Range 37 East. The Site latitude is 32° 39' 24.1" and longitude is 103° 17' 47.4". The Site was formerly a tank battery that was dismantled at an unknown date. A regional location map showing the site location is included as **Figure 1**. No known environmental incidents have occurred at the Site; however, the Site is under investigation due to its historical use as a former tank battery. On December 5, 2005, the New Mexico Oil Conservation Division (NMOCD) approved a general work plan submitted by Hess Corporation (Hess) to investigate and remediate locations within the North Monument Grayburg San Andres Unit (NMGSAU) that have historical contamination. A C-141 form was submitted and approved by NMOCD on November 29, 2017, and remediation case number 1R-4863 was assigned.

BBC International (BBC) initiated the investigation of the former tank battery on June 30 and July 1, 2015 by advancing nine soil borings to depths as great as 55 feet below ground surface (bgs). The locations of these borings are shown on the Site Map in **Figure 2**. Soils were analyzed for Benzene, Toluene, Ethylbenzene, Total Xylenes (BTEX), Chloride, Total Petroleum Hydrocarbons Gasoline Range Organics (TPH-GRO), and Total Petroleum Hydrocarbons Diesel Range Organics (TPH-DRO). Chloride concentrations were above the NMOCD Standard in soil boring SP1 to a depth of 25 feet, SP2 at depths of 15 feet and 45 feet, and SP6 to a depth of 20 feet. Total TPH concentrations were above the NMOCD Standard in soil borings SP1, SP2, and SP7 to a depth of 55 feet in each location, as well as SP6 to a depth of 20 feet. Concentrations for Benzene or Total BTEX were not above the NMOCD Standard in any of the soil borings.

A monitoring well, MW-1, was installed by BBC during the initial investigation in July 2015. The presence of Liquid Phase Hydrocarbon (LPH) was observed in the monitoring well, and no groundwater sample was collected at that time. GeoMonitoring Services (GMS) gauged MW-1 three times in 2016 in August, October, and December. No measurable LPH was

observed during these three events, and groundwater samples were collected and analyzed for BTEX, TPH-GRO, TPH-DRO, and Chlorides. Polynuclear Aromatic Hydrocarbons (PAHs) were also analyzed during the December 2016 sampling event. Only Chloride concentrations exceeded the New Mexico Water Quality Control Commission (NM WQCC) Standard of 250 milligrams per liter (mg/L) in October 2016 with a concentration of 850 mg/L and December 2016 with a concentration of 640 mg/L.

GMS utilized the information gathered during the initial investigation conducted by BBC International to further delineate the soil and groundwater impacts. GMS installed four additional monitoring wells and three soil borings in November 2016. An additional five soil borings were advanced and temporary wells were installed in November 2017. Analysis of soil samples demonstrated Total TPH concentrations in excess of the NMOCD Standards of 1,000 mg/kg to depths up to 60 feet in MW-2, 60 feet in MW-5, 50 feet in SB-10, 50 feet in SB-11, and 50 feet in SB-12. Soil borings SB-13 through SB-17 and MW-3 and MW-4 did not have any detections for Total TPH in excess of the NMOCD Standards. Chloride concentrations did not exceed the NMOCD Standard in any of the sample points. Groundwater samples did not have concentrations of BTEX or TPH above the NM WQCC Standards, with the exception of a Benzene detection in monitoring well MW-5 with a concentration of 32 µg/L. Chloride concentrations exceeded the NM WQCC standard in monitoring wells MW-1, MW-3, MW-4, and soil boring SB-14. The total dissolved solids (TDS) concentration in soil boring SB-14 exceeded the NM WQCC Standard. A Site Assessment Report further detailing the above investigation was submitted on July 25, 2018. In that report, Hess proposed excavating the areas with elevated TPH to a depth of four feet, installing a polyethylene liner, and backfilling with clean soil.

During a meeting at the NMOCD office on October 2, 2018, NMOCD expressed interest in Hess evaluating the viability of an air sparge and vapor extraction (AS/VE) system instead of the proposed excavation. On March 3, 2019, Hess submitted a Sparge Test Work Plan, which proposed installing one test point and one observation point. On June 19, 2019, Hess performed gamma and conductivity logs in the five monitoring wells to begin evaluating AS/VE viability. During this event, LPH was observed in the most upgradient monitoring well, MW-5, with a

thickness of 3.5 feet. LPH thicknesses in monitoring wells MW-1 and MW-2 had also increased to greater than 6 feet. A Site Update dated November 12, 2020, noted that LPH samples were subsequently collected from MW-1, MW-2, and MW-5, and the analysis concluded the LPH in all three wells came from the same source and/or release. The update also discussed baildown tests conducted on MW-1 and MW-5, and noted that after 8 hours, MW-1 returned to 57% of its pretest thickness, and MW-5 returned to 70% of its pretest thickness. The update concluded that Hess planned to install three additional monitoring wells immediately south of the road, upgradient of MW-5. Monitoring wells, MW-6, MW-7, and MW-8 were installed on March 23, 2021.

On November 16, 2021, Hess submitted a Site Update and Remedial Work Plan that summarized the additional monitoring wells installed in March 2021 as well as liquid phase hydrocarbon (LPH) recovery efforts. It also included a proposal from Hess to excavate soil in the areas with elevated Total Petroleum Hydrocarbons (TPH) to a depth of four feet below ground surface, line the excavation with a polyethylene liner, and backfill with clean soil. The proposed scope of work was approved by the New Mexico Oil Conservation Division (NMOCD) on November 29, 2021, and implementation of the approved scope of work began on December 2, 2021. A Site Update summarizing the excavation and liner installation was submitted on January 28, 2022. In that update, Hess committed to continued LPH removal with solar sippers, conducting monthly vacuum events on the three monitor wells with LPH, sampling the monitoring wells without measurable LPH on a semiannual basis, and to provide annual site status updates. Below is a summary of the activities that occurred during 2023.

2.0 Groundwater Activities

Monitoring wells MW-3, MW-4, MW-6, MW-7, and MW-8 were sampled on July 20, 2023. Monitoring wells MW-1, MW-2, and MW-5 were not sampled in July 2023 due to the presence of LPH. All monitoring wells, including MW-1, MW-2, and MW-5, were sampled on December 5, 2023. All monitoring wells were gauged prior to sampling on July 20, 2023 and December 5, 2023. Monitoring wells MW-1, MW-2, and MW-5 have historically had measurable LPH. During the December 2023 gauging event, monitoring well MW-3 was found to have a measurable LPH thickness of 0.02 feet. The groundwater potentiometric maps for July

2023 and December 2023 are provided in **Figure 2** and **Figure 3**, respectively. The groundwater gradient was to the north during both sampling events, which is consistent with historical measurements.

Groundwater samples were collected and analyzed for benzene, toluene, ethylbenzene, total xylenes (BTEX), total petroleum hydrocarbons gasoline range organics (TPH-GRO), total petroleum hydrocarbons diesel range organics (TPH-DRO), total petroleum hydrocarbons extended diesel range organics (TPH EXT-DRO), chloride, and PAHs. Purging was completed by bailing three well volumes, and three field measurements were recorded for pH, conductivity, temperature, dissolved oxygen, and oxygen redox potential (ORP). The samples were transferred from the bailers into dedicated laboratory-supplied Teflon™-capped glassware. The groundwater samples were preserved with hydrochloric acid, placed into a cooler, and maintained at a temperature of less than 4°C for transportation to Cardinal.

None of the groundwater samples collected in July or December 2023 had detected concentrations for BTEX, TPH-GRO, TPH-DRO, TPH Ext-DRO or PAHs above the NM WQCC Standards, with the exception of monitoring well MW-5 in December 2023. Monitoring well MW-5, which had measurable LPH, had a detected concentration for benzene of 15 µg/L in December 2023. Monitoring wells MW-2, MW-3, MW-7, and MW-8 had Chloride concentrations above the NM WQCC Standard of 250 mg/L. These concentrations in July 2023 ranged from 305 mg/L in MW-3 to 372 mg/L in MW-8. Chloride concentrations exceeding the NM WQCC Standard in December 2023 ranged from 328 mg/L in MW-7 to 460 mg/L in MW-2. A summary of groundwater monitoring results is found in **Tables 2A and 2B** and is shown in **Figure 4**. The laboratory report is found in **Attachment 1**.

3.0 LPH Recovery Activities

In an effort to remove LPH from the monitoring wells, solar sippers operated in monitoring wells MW-1 and MW-2 throughout 2023. An additional solar sipper was installed in monitoring well MW-5 in July 2023. The solar sippers in MW-1 and MW-5 are plumbed to discharge into an adjacent drum, which is stored in an overpack. The solar sipper installed in MW-2 is plumbed to discharge into a 300-gallon double wall tank. The recovery containers

were gauged weekly in order to monitor the recovery progress. During 2023, approximately 30.76 gallons of LPH and 254.38 gallons of water were recovered from MW-1. MW-2 recovered approximately 196.68 gallons of LPH and 219.12 gallons of water during 2023. MW-5 recovered approximately 30.35 gallons of LPH and 63.76 gallons of water during 2023. A summary of the solar sipper recovery is shown in **Table 3**.

In addition, monthly vacuum events were conducted for MW-1, MW-2, and MW-5 throughout 2023. The LPH thickness was measured in each well before and after the vacuum event. **Table 4** shows the pre and post LPH thicknesses for each monthly vacuum event. Between the January 28, 2023 vacuum event and the December 30, 2023 vacuum event, the LPH thickness in MW-1 decreased from 3.56 feet to 0.86 feet, the LPH thickness in MW-2 decreased from 3.30 feet to 2.73 feet, and the LPH thickness in MW-5 decreased from 5.17 feet to 2.46 feet. The LPH Thickness Graph found in **Attachment 2** illustrates the overall LPH thicknesses in MW-1, MW-2, and MW-5 since March 2022. LPH was first measured in monitoring well MW-3 during the December 2023 gauging event, and an absorbent sock was subsequently installed.

4.0 Recommendations

The groundwater samples collected from monitoring wells MW-1, MW-2, and MW-5 below the LPH resulted in only benzene exceeding the NM WQCC Standard of 10 µg/L in monitoring well MW-5 (15 µg/L) and chlorides exceeding the NM WQCC Standard of 250 mg/L in monitoring well MW-2 (460 mg/L). As such, the LPH present in the wells is having a minimum impact on contacted groundwater. The monitoring wells without LPH will continue to be sampled semiannually. Hess will continue to operate solar sippers in MW-1, MW-2, and MW-5. Monthly vacuum events will also continue to be conducted in MW-1, MW-2, and MW-5. An absorbent sock will continue to be installed in monitoring well MW-3 until no measurable LPH is present. If LPH thicknesses continue to decrease in all monitoring wells, Hess will request No Further Action/Closure for 1R-4863, Former G State Battery.

Tables

Table 1
Summary of Groundwater Gauging Data
Texaco NM State G 4 Battery

Well No.	Casing Diameter (inches)	Top of Casing Elevation (feet)	Date	Top of Casing to LPH (feet)	Top of Casing to Water (feet)	LPH Thickness (feet)	Groundwater Elevation (feet)
MW-1	2	3707.36	7/20/2023	63.33	65.67	2.34	3643.562
			12/5/2023	63.49	65.10	1.61	3643.548
MW-2	2	3706.78	7/20/2023	62.81	64.81	2.00	3643.57
			12/5/2023	62.76	65.21	2.45	3643.53
MW-3	2	3709.31	7/20/2023	NE	64.46	0.0	3644.85
			12/5/2023	64.66	64.68	0.02	3644.646
MW-4	2	3707.01	7/20/2023	NE	63.11	0.0	3643.9
			12/5/2023	NE	63.35	0.0	3643.66
MW-5	2	3706.57	7/20/2023	61.94	69.24	7.30	3643.17
			12/5/2023	61.92	69.89	7.97	3643.056
MW-6	2	3708.91	7/20/2023	NE	64.52	0.00	3644.39
			12/5/2023	NE	64.51	0.00	3644.4
MW-7	2	3708.83	7/20/2023	NE	64.46	0.0	3644.37
			12/5/2023	NE	64.48	0.0	3644.35
MW-8	2	3707.36	7/20/2023	NE	63.03	0.0	3644.33
			12/5/2023	NE	63.16	0.00	3644.20

Note:

LPH - Liquid Phase Hydrocarbon

NM - Not Measured

NE - Not Encountered

GeoMonitoring Services

Table 2A
Summary of Groundwater Monitoring Results
BTEX, TPH, Chloride
Texaco NM State G 4 Battery

Sample Identification	Date Sampled	Benzene (µg/L)	Toluene (µg/L)	Ethylbenzene (µg/L)	Xylenes (µg/L)	TPH-GRO (C6-C10) (mg/L)	TPH-DRO (C10-C28) (mg/L)	TPH EXT-DRO (C28-C36) (mg/L)	Chloride (mg/L)	TDS (mg/L)
NM WQCC Standards:		10	750	750	620	NONE	NONE	NONE	250	1000
MW-1	8/9/2016	<1	<1	<1	<3	NA	NA	NA	NA	NA
	3/30/2021	NOT SAMPLED								
	6/30/2022	NOT SAMPLED								
	12/8/2022	NOT SAMPLED								
	7/20/2023	NOT SAMPLED								
	12/5/2023	3.0	2.0	8.0	10.0	1.18	15.9	3.2	188.0	NA
MW-2	12/21/2016	NOT SAMPLED								
	3/30/2021	NOT SAMPLED								
	6/30/2022	NOT SAMPLED								
	12/8/2022	NOT SAMPLED								
	7/20/2023	NOT SAMPLED								
	12/5/2023	9.0	3.0	7.0	27.0	1.93	7.70	<1	460.0	NA
MW-3	12/21/2016	0.7	<0.5	<0.5	<2	<1	<1	NA	264	NA
	3/30/2021	<0.5	<0.5	<0.5	<0.5	<1	<1	<1	252	1084
	6/30/2022	<1	<1	<1	<3	<1	<1	<1	272	NA
	12/9/2022	<1	<1	<1	<2	<1	<1	<1	280	NA
	7/20/2023	<1	<1	<1	<3	<1	<1	<1	304	NA
	12/5/2023	5.0	<1	<1	5	4.46	44.9	9.28	332	NA
MW-4	12/21/2016	4.0	<0.5	<0.5	12	<1	1.58	NA	268	NA
	3/30/2021	2.0	<0.5	<0.5	2	<1	1.20	<1	340	1552
	6/30/2022	<1	<1	<1	<3	<1	<1	<1	600	NA
	12/9/2022	6.0	<1	<1	2	<1	<1	<1	348	NA
	7/20/2023	4.0	<1	<1	<3	<1	<1	<1	180	NA
	12/5/2023	8.0	2	2	6	<1	<1	<1	132	NA
MW-5	12/21/2016	32	<0.5	16	110	4.68	13.2	NA	104	NA
	3/30/2021	NOT SAMPLED								
	6/30/2022	NOT SAMPLED								
	12/9/2022	NOT SAMPLED								
	7/20/2023	NOT SAMPLED								
	12/5/2023	15.0	4.0	17.0	53.0	5.55	22.4	3.14	108.0	
MW-6	3/30/2021	<0.5	<0.5	<0.5	<0.5	<1	<1	<1	48	826
	6/30/2022	<1	<1	<1	<3	<1	<1	<1	124	NA
	12/8/2022	<1	<1	<1	<2	<1	<1	<1	140	
	7/20/2023	<1	<1	<1	<3	<1	<1	<1	72	NA
	12/5/2023	<1	<1	<1	<3	<1	<1	<1	96	NA
	3/30/2021	<0.5	<0.5	<0.5	<0.5	<1	<1	<1	380	1464
MW-7	6/30/2022	<1	<1	<1	<3	<1	<1	<1	472	NA
	12/8/2022	<1	<1	<1	<2	<1	<1	<1	480	NA
	7/20/2023	<1	<1	<1	<3	<1	<1	<1	340	NA
	12/5/2023	<1	<1	<1	<3	<1	<1	<1	328	NA
	3/30/2021	<0.5	<0.5	<0.5	<0.5	<1	<1	<1	368	1526
	6/30/2022	<1	<1	<1	<3	<1	<1	<1	408	NA
MW-8	12/8/2022	<1	<1	<1	<2	<1	<1	<1	408	NA
	7/20/2023	<1	<1	<1	<3	<1	<1	<1	372	NA
	12/5/2023	<1	<1	<1	<3	<1	<1	<1	348	NA
	3/30/2021	<0.5	<0.5	<0.5	<0.5	<1	<1	<1	368	1526
SB-13	11/30/2017	<0.5	<0.5	<1	<2	<1	<1	NA	224	974
SB-14	11/30/2017	<0.5	<0.5	<1	<2	<1	2.44	NA	320	1220
SB-15	11/30/2017	<0.5	<0.5	1	20	4.19	19.6	NA	72	730
SB-16	11/30/2017	<0.5	<0.5	<1	<2	1.66	2.45	NA	72	664
SB-17	11/30/2017	<0.5	<0.5	<1	<2	<1	<1	NA	80	600

NOTE:

BTEX = Benzene, Toluene, Ethylbenzene, Total Xylenes

TPH = Total Petroleum Hydrocarbons

TPH-GRO = Total Petroleum Hydrocarbons Gasoline Range Organics

TPH-DRO = Total Petroleum Hydrocarbons Diesel Range Organics

TPH EXT-DRO = Total Petroleum Hydrocarbons Extended Diesel Range Organics

NM WQCC = New Mexico Water Quality Control Commission

NA=not analyzed

µg/L = micrograms per Liter

mg/L = milligrams per Liter

NONE = no NM WQCC Standard for this constituent

BOLD values exceed NM WQCC standards

GeoMonitoring Services

Table 2B
Summary of Groundwater Monitoring Results
Polynuclear Aromatic Hydrocarbons
Texaco NM State G 4 Battery

Sample Identification	Date Sampled	Naphthalene (mg/L)	2-Methylnaphthalene (mg/L)	1-Methylnaphthalene (mg/L)	Acenaphthylene (mg/L)	Acenaphthene (mg/L)	Fluorene (mg/L)	Phenanthrene (mg/L)	Anthracene (mg/L)	Carbazole (mg/L)	Fluoranthene (mg/L)	Pyrene (mg/L)	Benzo[a]anthracene (mg/L)	Chrysene (mg/L)	Benzo[b]fluoranthene (mg/L)	Benzo[k]fluoranthene (mg/L)	Benzo[a]pyrene (mg/L)	Indeno[1,2,3-cd]pyrene (mg/L)	Dibenz[a,h]anthracene (mg/L)	Benzo[ghi]perylene (mg/L)
MW-1	12/21/2016	<0.002	0.0	0.0	<0.002	0.003	0.002	0.008	0.008	<0.003	<0.002	<0.002	0.003	0.003	<0.004	<0.006	0.0	<0.002	0.002	<0.004
	3/30/2021																			
	6/30/2022																			
	12/9/2022																			
	7/20/2023																			
MW-2	12/5/2023	0.002	0.006	0.009	<0.001	<0.001	0.002	0.003	<0.001	<0.001	<0.001	<0.001	<0.001	<0.001	<0.001	<0.01	<0.0002	<0.001	<0.001	<0.001
	12/21/2016																			
	3/30/2021																			
	6/30/2022																			
	12/9/2022																			
MW-3	7/20/2023																			
	12/5/2023	0.009	0.018	0.021	<0.001	<0.001	0.003	0.004	<0.001	0.001	<0.001	<0.001	<0.001	<0.001	<0.001	<0.001	<0.0002	<0.001	<0.001	<0.001
	12/21/2016	<0.0002	<0.0002	<0.0009	<0.0002	<0.0002	<0.0002	<0.0002	<0.0002	<0.0002	<0.0002	<0.0002	<0.0002	<0.0002	<0.0005	<0.0007	<0.0002	<0.0002	<0.0002	<0.0005
	3/30/2021	<0.001	<0.001	<0.0005	<0.001	<0.001	<0.001	<0.001	<0.001	<0.001	<0.001	<0.001	<0.001	<0.001	<0.001	<0.001	<0.0002	<0.001	<0.001	<0.001
	6/30/2022	<0.001	<0.001	<0.0005	<0.001	<0.001	<0.001	<0.001	<0.001	<0.001	<0.001	<0.001	<0.001	<0.001	<0.001	<0.001	<0.0002	<0.001	<0.001	<0.001
MW-4	12/9/2022	<0.001	<0.001	<0.0005	<0.001	<0.001	<0.001	<0.001	<0.001	<0.001	<0.001	<0.001	<0.001	<0.001	<0.001	<0.001	<0.0002	<0.001	<0.001	<0.001
	7/20/2023	<0.001	<0.001	<0.0005	<0.001	<0.001	<0.001	<0.001	<0.001	<0.001	<0.001	<0.001	<0.001	<0.001	<0.001	<0.001	<0.0002	<0.001	<0.001	<0.001
	12/5/2023	0.0	0.012	0.015	<0.001	<0.001	0.007	0.0	<0.001	<0.001	<0.001	<0.001	<0.001	0.0	<0.001	<0.001	<0.0002	<0.001	<0.001	<0.001
	12/21/2016	<0.0002	<0.0002	<0.0009	<0.0002	<0.0002	<0.0002	<0.0002	<0.0002	<0.0003	<0.0002	<0.0002	<0.0002	<0.0002	<0.0005	<0.0007	<0.0002	<0.0002	<0.0002	<0.0005
	3/30/2021	<0.001	<0.001	<0.0005	<0.001	<0.001	<0.001	<0.001	<0.001	<0.001	<0.001	<0.001	<0.001	<0.001	<0.001	<0.001	<0.0002	<0.001	<0.001	<0.001
MW-5	6/30/2022	<0.001	<0.001	0.0006	<0.001	<0.001	<0.001	1.002	<0.001	<0.001	<0.001	<0.001	<0.001	<0.001	<0.001	<0.001	<0.0002	<0.001	<0.001	<0.001
	7/20/2023	<0.001	<0.001	0.001	<0.001	<0.001	<0.001	<0.001	<0.001	<0.001	<0.001	<0.001	<0.001	<0.001	<0.001	<0.001	<0.0002	<0.001	<0.001	<0.001
	12/5/2023	<0.001	<0.001	0.002	<0.001	<0.001	<0.001	<0.001	<0.001	<0.001	<0.001	<0.001	<0.001	<0.001	<0.001	<0.001	<0.0002	<0.001	<0.001	<0.001
	12/21/2016	0.002	0.004	0.006	<0.0002	<0.0002	0.001	0.001	0.001	<0.0003	<0.0002	<0.0002	<0.0001	<0.0002	<0.0004	<0.0006	<0.00002	<0.0002	<0.0002	<0.0004
	3/30/2021																			
MW-6	6/30/2022																			
	12/9/2022																			
	7/20/2023																			
	12/5/2023	0.009	0.021	0.027	<0.001	<0.001	0.004	0.007	<0.001	0.002	<0.001	<0.001	<0.001	<0.001	<0.001	<0.001	<0.0002	<0.001	<0.001	<0.001
	3/30/2021	<0.001	<0.001	<0.0005	<0.001	<0.001	<0.001	<0.001	<0.001	<0.001	<0.001	<0.001	<0.001	<0.001	<0.001	<0.001	<0.0002	<0.001	<0.001	<0.001
MW-7	6/30/2022	<0.001	<0.001	<0.0005	<0.001	<0.001	<0.001	0.001	<0.001	<0.001	<0.001	<0.001	<0.001	<0.001	<0.001	<0.001	<0.0002	<0.001	<0.001	<0.001
	12/9/2022	<0.001	<0.001	<0.0005	<0.001	<0.001	<0.001	<0.001	<0.001	<0.001	<0.001	<0.001	<0.001	<0.001	<0.001	<0.001	<0.0002	<0.001	<0.001	<0.001
	7/20/2023	<0.001	<0.001	<0.0005	<0.001	<0.001	<0.001	<0.001	<0.001	<0.001	<0.001	<0.001	<0.001	<0.001	<0.001	<0.001	<0.0002	<0.001	<0.001	<0.001
	12/5/2023	<0.001	<0.001	<0.0005	<0.001	<0.001	<0.001	<0.001	<0.001	<0.001	<0.001	<0.001	<0.001	<0.001	<0.001	<0.001	<0.0002	<0.001	<0.001	<0.001
	3/30/2021	<0.001	<0.001	<0.0005	<0.001	<0.001	<0.001	<0.001	<0.001	<0.001	<0.001	<0.001	<0.001	<0.001	<0.001	<0.001	<0.0002	<0.001	<0.001	<0.001
MW-8	6/30/2022	<0.001	<0.001	<0.0006	<0.001	<0.001	<0.001	<0.001	<0.001	<0.001	<0.001	<0.001	<0.001	<0.001	<0.001	<0.001	<0.0002	<0.001	<0.001	<0.001
	12/9/2022	<0.001	<0.001	<0.0005	<0.001	<0.001	<0.001	<0.001	<0.001	<0.001	<0.001	<0.001	<0.001	<0.001	<0.001	<0.001	<0.0002	<0.001	<0.001	<0.001
	7/20/2023	<0.001	<0.001	<0.0005	<0.001	<0.001	<0.001	<0.001	<0.001	<0.001	<0.001	<0.001	<0.001	<0.001	<0.001	<0.001	<0.0002	<0.001	<0.001	<0.001
	12/5/2023	<0.001	<0.001	<0.0005	<0.001	<0.001	<0.001	<0.001	<0.001	<0.001	<0.001	<0.001	<0.001	<0.001	<0.001	<0.001	<0.0002	<0.001	<0.001	<0.001
	3/30/2021	<0.001	<0.001	<0.0005	<0.001	<0.001	<0.001	<0.001	<0.001	<0.001	<0.001	<0.001	<0.001	<0.001	<0.001	<0.001	<0.0002	<0.001	<0.001	<0.001
SB-13	11/30/2017	<0.001	<0.001	<0.0005	<0.001	<0.001	<0.001	<0.001	<0.001	<0.001	<0.001	<0.001	<0.001	<0.001	<0.001	<0.001	<0.0002	<0.001	<0.001	<0.001
SB-14	11/30/2017	<0.001	<0.001	<0.0005	<0.001	<0.001	0.001	0.001	<0.001	<0.001	<0.001	<0.001	<0.001	<0.001	<0.001	<0.001	<0.0002	<0.001	<0.001	<0.001
SB-15	11/30/2017	0.01	0.021	0.022	<0.001	<0.001	0.002	0.002	<0.001	<0.001	<0.001	<0.001	<0.001	<0.001	<0.001	<0.001	<0.0002	<0.001	<0.001	<0.001
SB-16	11/30/2017	<0.001	<0.001	<0.0005	<0.001	<0.001	<0.001	<0.001	<0.001	<0.001	<0.001	<0.001	<0.001	<0.001	<0.001	<0.001	<0.0002	<0.001	<0.001	<0.001
SB-17	11/30/2017	<0.001	<0.001	<0.0005	<0.001	<0.001	<0.001	<0.001	<0.001	<0.001	<0.001	<0.001	<0.001	<0.001	<0.001	<0.001	<0.0002	<0.001	<0.001	<0.001

NOTE:
 NM WQCC = New Mexico Water Quality Control Commission
 mg/L - milligrams per Liter
 NONE = no NM WQCC Standard for this constituent

Table 3
Solar Sipper Recovery Summary
Texaco NM State G 4 Battery

Well ID	Date	Amount of LPH (gallons)	Amount of Water (gallons)	Total Fluid (gallons)
MW-1	1/28/2023	4.07	14.26	18.33
	2/11/2023	8.15	16.30	24.45
	4/1/2023	5.50	19.35	24.85
	4/29/2023	3.06	21.39	24.45
	5/27/2023	1.83	22.41	24.24
	7/1/2023	1.22	29.33	30.55
	7/29/2023	0.41	23.02	23.43
	8/26/2023	0.20	15.07	15.27
	9/30/2023	0.81	29.54	30.35
	10/28/2023	1.02	25.26	26.28
	12/3/2023	1.43	26.23	27.66
	12/30/2023	3.06	12.22	15.28
	Year Total	30.76	254.38	285.14
MW-2	1/23/2023	13.20	7.92	21.12
	3/4/2023	15.84	15.84	31.68
	4/1/2023	15.84	7.92	23.76
	4/29/2023	17.16	10.56	27.72
	5/27/2023	17.16	18.48	35.64
	7/1/2023	21.12	22.44	43.56
	7/29/2023	18.48	21.12	39.60
	8/26/2023	15.84	25.08	40.92
	9/30/2023	15.84	35.64	51.48
	10/28/2023	13.20	29.04	42.24
	12/3/2023	19.80	25.08	44.88
	12/30/2023	13.20	0.00	13.20
	Year Total	196.68	219.12	415.80

Table 4
Monthly Well Vacuuming Summary
Texaco NM State G 4 Battery

Well	Date	Initial Depth to Product (feet)	Initial Depth to Water (feet)	LPH Thickness (feet)	Depth to Product After Vacuuming (feet)	Depth to Water After Vacuuming (feet)	LPH Thickness (feet)
MW-1	1/28/2023	62.14	65.70	3.56	61.5	61.5	0
	3/4/2023	62.50	65.10	2.60	62.78	62.78	0
	4/1/2023	62.70	65.15	2.45	62.98	62.98	0
	4/29/2023	63.08	65.10	2.02	63.35	63.35	0
	5/27/2023	63.24	65.12	1.88	63.45	63.45	0
	7/1/2023	63.22	65.48	2.26	63.55	63.55	0
	7/29/2023	63.35	65.78	2.43	63.6	63.63	0.03
	8/26/2023	63.17	65.56	2.39	63.49	63.49	0
	9/30/2023	63.14	65.79	2.65	63.35	63.35	0
	10/28/2023	63.31	65.48	2.17	63.54	63.54	0
	12/3/2023	63.49	65.10	1.61	-	-	-
	12/30/2023	63.74	64.6	0.86	63.85	63.85	0
MW-2	1/28/2023	61.5	64.80	3.30	-	-	-
	3/4/2023	61.84	64.74	2.90	62.85	62.85	0
	4/1/2023	62.12	64.82	2.70	63.45	63.45	0
	4/29/2023	62.6	64.82	2.22	63.3	63.3	0
	5/27/2023	62.66	64.42	1.76	64	64	0
	7/1/2023	62.72	64.83	2.11	63.5	63.5	0
	7/29/2023	62.83	65.10	2.27	63.3	63.3	0
	8/26/2023	62.7	65.05	2.35	63.3	63.3	0
	9/30/2023	62.53	65.21	2.68	63.13	63.13	0
	10/28/2023	62.7	65.12	2.42	63.4	63.4	0
	12/3/2023	62.76	65.21	2.45	-	-	-
	12/30/2023	63.00	65.73	2.73	63.4	63.4	0
MW-5	1/28/2023	61.03	66.20	5.17	61.74	61.79	0.05
	3/4/2023	61.18	66.86	5.68	61.95	61.95	0.00
	4/1/2023	61.38	67.28	5.90	62.5	62.5	0.00
	4/29/2023	61.64	68.62	6.98	62.65	62.65	0.00
	5/27/2023	61.78	68.73	6.95	62.73	62.73	0.00
	7/1/2023	61.82	68.80	6.98	62.84	62.84	0.00
	7/29/2023	61.88	69.05	7.17	62.8	62.8	0.00
	8/26/2023	62.10	67.00	4.90	62.8	62.8	0.00
	9/30/2023	61.91	67.73	5.82	62.7	62.7	0.00
	10/28/2023	62.05	66.90	4.85	62.73	62.73	0.00
	12/3/2023	61.92	69.89	7.97	-	-	-
	12/30/2023	62.63	65.09	2.46	63.2	63.2	0

Figures

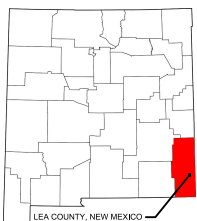
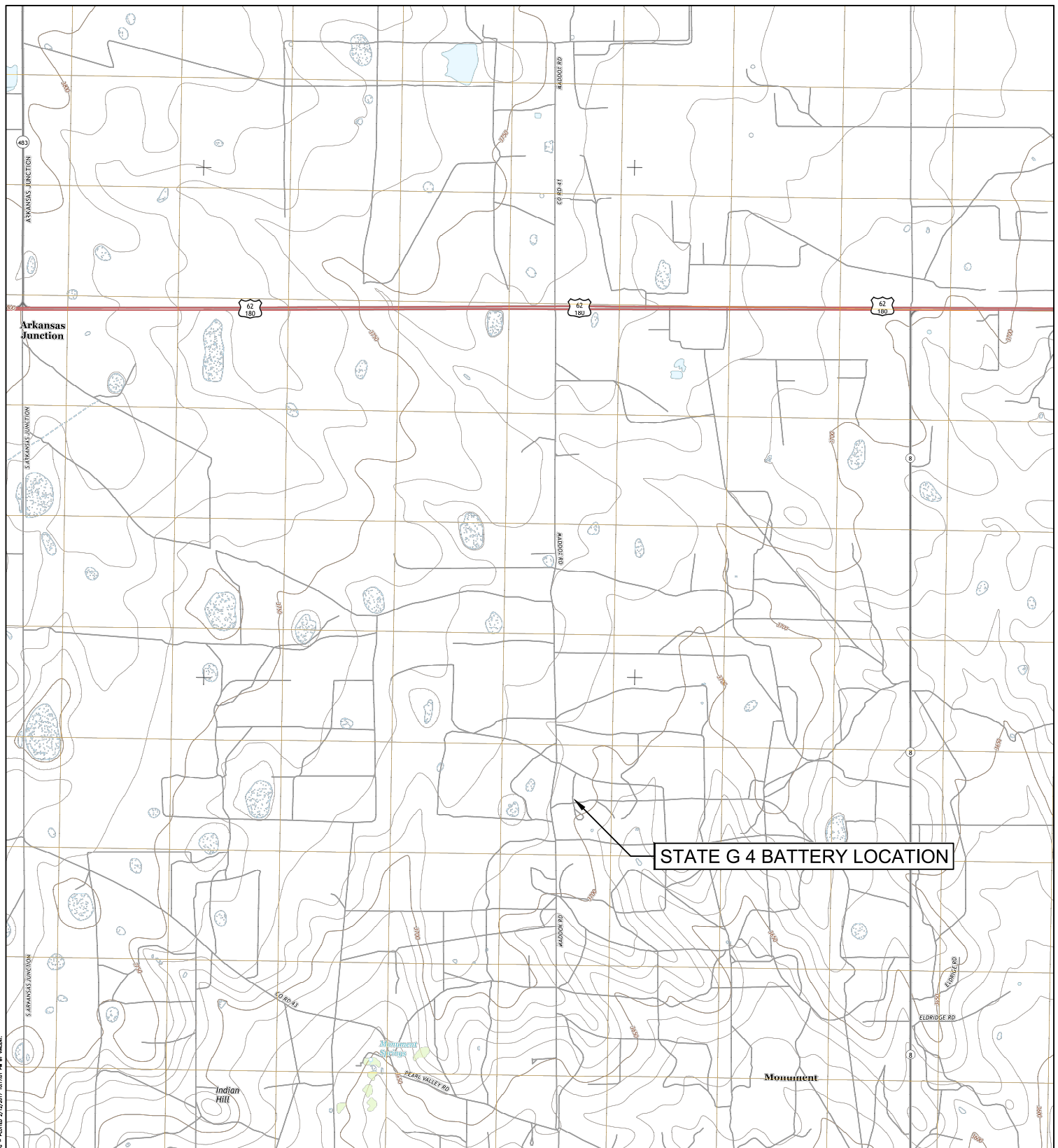

0 2000 4000 8000
APPROXIMATE SCALE IN FEET



FIGURE 1
SITE LOCATION MAP
TEXACO NM STATE G 4 BATTERY
LEA COUNTY, NEW MEXICO

MAP SOURCE: USGS 7.5 MINUTE SERIES TOPOGRAPHIC MAP -- NONUM NORTH QUADRANGLE (2017)

DRAWN BY: VMW

DATE: 02/12/17

PROJECT NO: HESS E&P



Image courtesy of ImagePatch.com © 2017 Microsoft Corporation © 2010 NAV



LEGEND	
	MONITORING WELL LOCATION
	SOIL BORING LOCATION
	INITIAL SOIL BORING LOCATION
	GROUNDWATER ELEVATION (IN FEET)
	GROUNDWATER ELEVATION CONTOUR LINE (IN FEET)
	INFERRED GROUNDWATER ELEVATION CONTOUR LINE (IN FEET)

N

0 10 20 40

APPROXIMATE SCALE IN FEET

FIGURE 2		
GROUNDWATER POTENTIOMETRIC MAP		
JULY 20, 2023		
TEXACO NM STATE G 4 BATTERY		
LEA COUNTY, NEW MEXICO		
DRAWN BY: JFLAKE	DATE: 2/7/2024	PROJECT NO: HESS E&P



Image courtesy of ImagePatch.com © 2017 Microsoft Corporation © 2010 NAV



GMS
GeoMonitoring Services
Environmental Remediation & Consulting



MONITORING WELL LOCATION



SOIL BORING LOCATION



INITIAL SOIL BORING LOCATION

3,644.40

GROUNDWATER ELEVATION (IN FEET)



GROUNDWATER ELEVATION CONTOUR LINE (IN FEET)



INFERRED GROUNDWATER ELEVATION CONTOUR LINE (IN FEET)

N



0102040

APPROXIMATE SCALE IN FEET

FIGURE 3

GROUNDWATER POTENTIOMETRIC MAP

DECEMBER 5, 2023

TEXACO NM STATE G 4 BATTERY

LEA COUNTY, NEW MEXICO

DRAWN BY: JFLAKE

DATE: 2/7/2024

PROJECT NO: HESS E&P



Image courtesy of ImagePatch.com © 2017 Microsoft Corporation © 2010 NAI



NOTE: AERIAL SOURCE - USGS IMAGEPATCH.COM © MICROSOFT CORPORATION. FOR EACH SAMPLE COLLECTED, BTEX, TPH, CHLORIDE, AND TDS DATA IS SHOWN. FOR PAH'S, ONLY CONSTITUENTS WHICH WERE DETECTED ARE SHOWN. ANALYTICAL DATA DISPLAYED IN RED EXCEEDS THE NEW MEXICO WATER QUALITY CONTROL COMMISSION STANDARDS.

LEGEND

- MONITORING WELL LOCATION
- SOIL BORING LOCATION
- INITIAL SOIL BORING LOCATION
- NA - NOT ANALYZED

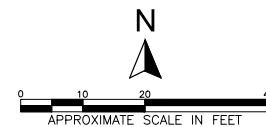

FIGURE 4
GROUNDWATER ANALYTICAL MAP
JULY/DECEMBER 2023
TEXACO NM STATE G 4 BATTERY
LEA COUNTY, NEW MEXICO

DRAWN BY: JFLAKE DATE: 2/8/2024 PROJECT NO: HESS EA2

Attachment 1

Laboratory Analytical Report



PHONE (575) 393-2326 ° 101 E. MARLAND ° HOBBS, NM 88240

July 31, 2023

BRAD FREEMAN

AXIS ENVIROMENTAL

121 INDIAN RIDGE RD

BELTON, TX 76513

RE: G STATE 4

Enclosed are the results of analyses for samples received by the laboratory on 07/20/23 15:30.

Cardinal Laboratories is accredited through Texas NELAP under certificate number T104704398-22-15. Accreditation applies to drinking water, non-potable water and solid and chemical materials. All accredited analytes are denoted by an asterisk (*). For a complete list of accredited analytes and matrices visit the TCEQ website at www.tceq.texas.gov/field/ga/lab_accred_certif.html.

Cardinal Laboratories is accredited through the State of Colorado Department of Public Health and Environment for:

Method EPA 552.2	Total Haloacetic Acids (HAA-5)
Method EPA 524.2	Total Trihalomethanes (TTHM)
Method EPA 524.4	Regulated VOCs (V1, V2, V3)

Cardinal Laboratories is accredited through the State of New Mexico Environment Department for:

Method SM 9223-B	Total Coliform and E. coli (Colilert MMO-MUG)
Method EPA 524.2	Regulated VOCs and Total Trihalomethanes (TTHM)
Method EPA 552.2	Total Haloacetic Acids (HAA-5)

Accreditation applies to public drinking water matrices for State of Colorado and New Mexico.

This report meets NELAP requirements and is made up of a cover page, analytical results, and a copy of the original chain-of-custody. If you have any questions concerning this report, please feel free to contact me.

Sincerely,

A handwritten signature in black ink that reads "Celey D. Keene".

Celey D. Keene

Lab Director/Quality Manager



PHONE (575) 393-2326 ° 101 E. MARLAND ° HOBBS, NM 88240

Analytical Results For:AXIS ENVIROMENTAL
121 INDIAN RIDGE RD
BELTON TX, 76513Project: G STATE 4
Project Number: NONE GIVEN
Project Manager: BRAD FREEMAN
Fax To:Reported:
31-Jul-23 12:26

Sample ID	Laboratory ID	Matrix	Date Sampled	Date Received
MW 3	H233797-01	Water	20-Jul-23 12:50	20-Jul-23 15:30
MW 4	H233797-02	Water	20-Jul-23 11:40	20-Jul-23 15:30
MW 6	H233797-03	Water	20-Jul-23 09:00	20-Jul-23 15:30
MW 7	H233797-04	Water	20-Jul-23 09:55	20-Jul-23 15:30
MW 8	H233797-05	Water	20-Jul-23 10:40	20-Jul-23 15:30

Cardinal Laboratories

*=Accredited Analyte

PLEASE NOTE: Liability and Damages. Cardinal's liability and client's exclusive remedy for any claim arising, whether based in contract or tort, shall be limited to the amount paid by client for analyses. All claims, including those for negligence or any other cause whatsoever shall be deemed waived unless made in writing and received by Cardinal within thirty (30) days after completion of the applicable service. In no event shall Cardinal be liable for incidental or consequential damage including, without limitation, business interruptions, loss of use, or loss of profits incurred by client, its subsidiaries, affiliates or successors arising out of or related to the performance of the services hereunder by Cardinal, regardless of whether such claim is based upon any of the above stated reasons or otherwise. Results relate only to the samples identified above. This report shall not be reproduced except in full with written approval of Cardinal Laboratories.

Celey D. Keene, Lab Director/Quality Manager



PHONE (575) 393-2326 ° 101 E. MARLAND ° HOBBS, NM 88240

Analytical Results For:

AXIS ENVIROMENTAL
121 INDIAN RIDGE RD
BELTON TX, 76513

Project: G STATE 4
Project Number: NONE GIVEN
Project Manager: BRAD FREEMAN
Fax To:

Reported:
31-Jul-23 12:26

MW 3**H233797-01 (Water)**

Analyte	Result	MDL	Reporting Limit	Units	Dilution	Batch	Analyst	Analyzed	Method	Notes
---------	--------	-----	-----------------	-------	----------	-------	---------	----------	--------	-------

Cardinal Laboratories**Inorganic Compounds**

Chloride*	304		4.00	mg/L	1	3071022	AC	24-Jul-23	4500-Cl-B	
-----------	-----	--	------	------	---	---------	----	-----------	-----------	--

Volatile Organic Compounds by EPA Method 8021

Benzene*	<0.001		0.001	mg/L	1	3072429	MS	26-Jul-23	8021B	
Toluene*	<0.001		0.001	mg/L	1	3072429	MS	26-Jul-23	8021B	
Ethylbenzene*	<0.001		0.001	mg/L	1	3072429	MS	26-Jul-23	8021B	
Total Xylenes*	<0.003		0.003	mg/L	1	3072429	MS	26-Jul-23	8021B	
Total BTEX	<0.006		0.006	mg/L	1	3072429	MS	26-Jul-23	8021B	

Surrogate: 4-Bromofluorobenzene (PID)	107 %		77.5-125			3072429	MS	26-Jul-23	8021B	
---------------------------------------	-------	--	----------	--	--	---------	----	-----------	-------	--

Petroleum Hydrocarbons by GC FID

GRO C6-C10*	<1.00		1.00	mg/L	0.1	3072032	MS	22-Jul-23	8015B	
DRO >C10-C28*	<1.00		1.00	mg/L	0.1	3072032	MS	22-Jul-23	8015B	
EXT DRO >C28-C36	<1.00		1.00	mg/L	0.1	3072032	MS	22-Jul-23	8015B	

Surrogate: 1-Chlorooctane	92.3 %		48.8-131			3072032	MS	22-Jul-23	8015B	
---------------------------	--------	--	----------	--	--	---------	----	-----------	-------	--

Surrogate: 1-Chlorooctadecane	99.2 %		60.1-141			3072032	MS	22-Jul-23	8015B	
-------------------------------	--------	--	----------	--	--	---------	----	-----------	-------	--

Polynuclear Aromatic Compounds by GC/MS

Naphthalene*	<0.001		0.001	mg/L	0.97	3071835	MS	26-Jul-23	8270C	
2-Methylnaphthalene*	<0.001		0.001	mg/L	0.97	3071835	MS	26-Jul-23	8270C	
1-Methylnaphthalene	<0.0005		0.0005	mg/L	0.97	3071835	MS	26-Jul-23	8270C	
Acenaphthylene*	<0.001		0.001	mg/L	0.97	3071835	MS	26-Jul-23	8270C	
Acenaphthene*	<0.001		0.001	mg/L	0.97	3071835	MS	26-Jul-23	8270C	
Fluorene*	<0.001		0.001	mg/L	0.97	3071835	MS	26-Jul-23	8270C	
Phenanthrene*	<0.001		0.001	mg/L	0.97	3071835	MS	26-Jul-23	8270C	
Anthracene*	<0.001		0.001	mg/L	0.97	3071835	MS	26-Jul-23	8270C	
Carbazole*	<0.001		0.001	mg/L	0.97	3071835	MS	26-Jul-23	8270C	
Fluoranthene*	<0.001		0.001	mg/L	0.97	3071835	MS	26-Jul-23	8270C	
Pyrene*	<0.001		0.001	mg/L	0.97	3071835	MS	26-Jul-23	8270C	

Cardinal Laboratories

*=Accredited Analyte

PLEASE NOTE: Liability and Damages. Cardinal's liability and client's exclusive remedy for any claim arising, whether based in contract or tort, shall be limited to the amount paid by client for analyses. All claims, including those for negligence or any other cause whatsoever shall be deemed waived unless made in writing and received by Cardinal within thirty (30) days after completion of the applicable service. In no event shall Cardinal be liable for incidental or consequential damage including, without limitation, business interruptions, loss of use, or loss of profits incurred by client, its subsidiaries, affiliates or successors arising out of or related to the performance of the services hereunder by Cardinal, regardless of whether such claim is based upon any of the above stated reasons or otherwise. Results relate only to the samples identified above. This report shall not be reproduced except in full with written approval of Cardinal Laboratories.

Celey D. Keene, Lab Director/Quality Manager



PHONE (575) 393-2326 ° 101 E. MARLAND ° HOBBS, NM 88240

Analytical Results For:

AXIS ENVIROMENTAL
121 INDIAN RIDGE RD
BELTON TX, 76513

Project: G STATE 4
Project Number: NONE GIVEN
Project Manager: BRAD FREEMAN
Fax To:

Reported:
31-Jul-23 12:26

MW 3**H233797-01 (Water)**

Analyte	Result	MDL	Reporting Limit	Units	Dilution	Batch	Analyst	Analyzed	Method	Notes
---------	--------	-----	-----------------	-------	----------	-------	---------	----------	--------	-------

Cardinal Laboratories**Polynuclear Aromatic Compounds by GC/MS**

Benzo[a]anthracene*	<0.001		0.001	mg/L	0.97	3071835	MS	26-Jul-23	8270C	
Chrysene*	<0.001		0.001	mg/L	0.97	3071835	MS	26-Jul-23	8270C	
Benzo[b]flouranthene*	<0.001		0.001	mg/L	0.97	3071835	MS	26-Jul-23	8270C	
Benzo[k]flouranthene*	<0.001		0.001	mg/L	0.97	3071835	MS	26-Jul-23	8270C	
Benzo[a]pyrene*	<0.0002		0.0002	mg/L	0.97	3071835	MS	26-Jul-23	8270C	
Indeno[1,2,3-cd]pyrene*	<0.001		0.001	mg/L	0.97	3071835	MS	26-Jul-23	8270C	
Dibenz[a,h]anthracene*	<0.001		0.001	mg/L	0.97	3071835	MS	26-Jul-23	8270C	
Benzo[g,h,i]perylene*	<0.001		0.001	mg/L	0.97	3071835	MS	26-Jul-23	8270C	
Surrogate: Nitrobenzene-d5			62.7 %	20.3-96.6		3071835	MS	26-Jul-23	8270C	
Surrogate: 2-Fluorobiphenyl			66.9 %	18.9-97.9		3071835	MS	26-Jul-23	8270C	
Surrogate: Terphenyl-d14			74.1 %	14.7-112		3071835	MS	26-Jul-23	8270C	

Cardinal Laboratories

*=Accredited Analyte

PLEASE NOTE: Liability and Damages. Cardinal's liability and client's exclusive remedy for any claim arising, whether based in contract or tort, shall be limited to the amount paid by client for analyses. All claims, including those for negligence or any other cause whatsoever shall be deemed waived unless made in writing and received by Cardinal within thirty (30) days after completion of the applicable service. In no event shall Cardinal be liable for incidental or consequential damage including, without limitation, business interruptions, loss of use, or loss of profits incurred by client, its subsidiaries, affiliates or successors arising out of or related to the performance of the services hereunder by Cardinal, regardless of whether such claim is based upon any of the above stated reasons or otherwise. Results relate only to the samples identified above. This report shall not be reproduced except in full with written approval of Cardinal Laboratories.

Celey D. Keene, Lab Director/Quality Manager



PHONE (575) 393-2326 • 101 E. MARLAND • HOBBS, NM 88240

Analytical Results For:

AXIS ENVIROMENTAL
121 INDIAN RIDGE RD
BELTON TX, 76513

Project: G STATE 4
Project Number: NONE GIVEN
Project Manager: BRAD FREEMAN
Fax To:

Reported:
31-Jul-23 12:26

MW 4**H233797-02 (Water)**

Analyte	Result	MDL	Reporting Limit	Units	Dilution	Batch	Analyst	Analyzed	Method	Notes
---------	--------	-----	-----------------	-------	----------	-------	---------	----------	--------	-------

Cardinal Laboratories**Inorganic Compounds**

Chloride*	180		4.00	mg/L	1	3071022	AC	24-Jul-23	4500-Cl-B	
-----------	-----	--	------	------	---	---------	----	-----------	-----------	--

Volatile Organic Compounds by EPA Method 8021

Benzene*	0.004		0.001	mg/L	1	3072429	MS	26-Jul-23	8021B	
Toluene*	<0.001		0.001	mg/L	1	3072429	MS	26-Jul-23	8021B	
Ethylbenzene*	<0.001		0.001	mg/L	1	3072429	MS	26-Jul-23	8021B	
Total Xylenes*	<0.003		0.003	mg/L	1	3072429	MS	26-Jul-23	8021B	
Total BTEX	<0.006		0.006	mg/L	1	3072429	MS	26-Jul-23	8021B	

Surrogate: 4-Bromofluorobenzene (PID)	110 %		77.5-125			3072429	MS	26-Jul-23	8021B	
---------------------------------------	-------	--	----------	--	--	---------	----	-----------	-------	--

Petroleum Hydrocarbons by GC FID

GRO C6-C10*	<1.00		1.00	mg/L	0.1	3072032	MS	22-Jul-23	8015B	
DRO >C10-C28*	<1.00		1.00	mg/L	0.1	3072032	MS	22-Jul-23	8015B	
EXT DRO >C28-C36	<1.00		1.00	mg/L	0.1	3072032	MS	22-Jul-23	8015B	

Surrogate: 1-Chlorooctane	93.9 %		48.8-131			3072032	MS	22-Jul-23	8015B	
---------------------------	--------	--	----------	--	--	---------	----	-----------	-------	--

Surrogate: 1-Chlorooctadecane	101 %		60.1-141			3072032	MS	22-Jul-23	8015B	
-------------------------------	-------	--	----------	--	--	---------	----	-----------	-------	--

Polynuclear Aromatic Compounds by GC/MS

Naphthalene*	<0.001		0.001	mg/L	1	3071835	MS	26-Jul-23	8270C	
2-Methylnaphthalene*	<0.001		0.001	mg/L	1	3071835	MS	26-Jul-23	8270C	
1-Methylnaphthalene	0.001		0.0005	mg/L	1	3071835	MS	26-Jul-23	8270C	
Acenaphthylene*	<0.001		0.001	mg/L	1	3071835	MS	26-Jul-23	8270C	
Acenaphthene*	<0.001		0.001	mg/L	1	3071835	MS	26-Jul-23	8270C	
Fluorene*	<0.001		0.001	mg/L	1	3071835	MS	26-Jul-23	8270C	
Phenanthrene*	<0.001		0.001	mg/L	1	3071835	MS	26-Jul-23	8270C	
Anthracene*	<0.001		0.001	mg/L	1	3071835	MS	26-Jul-23	8270C	
Carbazole*	<0.001		0.001	mg/L	1	3071835	MS	26-Jul-23	8270C	
Fluoranthene*	<0.001		0.001	mg/L	1	3071835	MS	26-Jul-23	8270C	
Pyrene*	<0.001		0.001	mg/L	1	3071835	MS	26-Jul-23	8270C	
Benzo[a]anthracene*	<0.001		0.001	mg/L	1	3071835	MS	26-Jul-23	8270C	

Cardinal Laboratories

*=Accredited Analyte

PLEASE NOTE: Liability and Damages. Cardinal's liability and client's exclusive remedy for any claim arising, whether based in contract or tort, shall be limited to the amount paid by client for analyses. All claims, including those for negligence or any other cause whatsoever shall be deemed waived unless made in writing and received by Cardinal within thirty (30) days after completion of the applicable service. In no event shall Cardinal be liable for incidental or consequential damage including, without limitation, business interruptions, loss of use, or loss of profits incurred by client, its subsidiaries, affiliates or successors arising out of or related to the performance of the services hereunder by Cardinal, regardless of whether such claim is based upon any of the above stated reasons or otherwise. Results relate only to the samples identified above. This report shall not be reproduced except in full with written approval of Cardinal Laboratories.

Celey D. Keene, Lab Director/Quality Manager



PHONE (575) 393-2326 ° 101 E. MARLAND ° HOBBS, NM 88240

Analytical Results For:

AXIS ENVIROMENTAL
121 INDIAN RIDGE RD
BELTON TX, 76513

Project: G STATE 4
Project Number: NONE GIVEN
Project Manager: BRAD FREEMAN
Fax To:

Reported:
31-Jul-23 12:26

MW 4**H233797-02 (Water)**

Analyte	Result	MDL	Reporting Limit	Units	Dilution	Batch	Analyst	Analyzed	Method	Notes
---------	--------	-----	-----------------	-------	----------	-------	---------	----------	--------	-------

Cardinal Laboratories**Polynuclear Aromatic Compounds by GC/MS**

Chrysene*	<0.001		0.001	mg/L	1	3071835	MS	26-Jul-23	8270C	
Benzo[b]flouranthene*	<0.001		0.001	mg/L	1	3071835	MS	26-Jul-23	8270C	
Benzo[k]flouranthene*	<0.001		0.001	mg/L	1	3071835	MS	26-Jul-23	8270C	
Benzo[a]pyrene*	<0.0002		0.0002	mg/L	1	3071835	MS	26-Jul-23	8270C	
Indeno[1,2,3-cd]pyrene*	<0.001		0.001	mg/L	1	3071835	MS	26-Jul-23	8270C	
Dibenz[a,h]anthracene*	<0.001		0.001	mg/L	1	3071835	MS	26-Jul-23	8270C	
Benzo[g,h,i]perylene*	<0.001		0.001	mg/L	1	3071835	MS	26-Jul-23	8270C	
Surrogate: Nitrobenzene-d5			68.5 %	20.3-96.6		3071835	MS	26-Jul-23	8270C	
Surrogate: 2-Fluorobiphenyl			64.5 %	18.9-97.9		3071835	MS	26-Jul-23	8270C	
Surrogate: Terphenyl-d14			65.3 %	14.7-112		3071835	MS	26-Jul-23	8270C	

Cardinal Laboratories

*=Accredited Analyte

PLEASE NOTE: Liability and Damages. Cardinal's liability and client's exclusive remedy for any claim arising, whether based in contract or tort, shall be limited to the amount paid by client for analyses. All claims, including those for negligence or any other cause whatsoever shall be deemed waived unless made in writing and received by Cardinal within thirty (30) days after completion of the applicable service. In no event shall Cardinal be liable for incidental or consequential damage including, without limitation, business interruptions, loss of use, or loss of profits incurred by client, its subsidiaries, affiliates or successors arising out of or related to the performance of the services hereunder by Cardinal, regardless of whether such claim is based upon any of the above stated reasons or otherwise. Results relate only to the samples identified above. This report shall not be reproduced except in full with written approval of Cardinal Laboratories.

Celey D. Keene, Lab Director/Quality Manager



PHONE (575) 393-2326 ° 101 E. MARLAND ° HOBBS, NM 88240

Analytical Results For:

AXIS ENVIROMENTAL
121 INDIAN RIDGE RD
BELTON TX, 76513

Project: G STATE 4
Project Number: NONE GIVEN
Project Manager: BRAD FREEMAN
Fax To:

Reported:
31-Jul-23 12:26

MW 6**H233797-03 (Water)**

Analyte	Result	MDL	Reporting Limit	Units	Dilution	Batch	Analyst	Analyzed	Method	Notes
---------	--------	-----	-----------------	-------	----------	-------	---------	----------	--------	-------

Cardinal Laboratories**Inorganic Compounds**

Chloride*	72.0		4.00	mg/L	1	3071022	AC	24-Jul-23	4500-Cl-B	
-----------	------	--	------	------	---	---------	----	-----------	-----------	--

Volatile Organic Compounds by EPA Method 8021

Benzene*	<0.001		0.001	mg/L	1	3072429	MS	26-Jul-23	8021B	
Toluene*	<0.001		0.001	mg/L	1	3072429	MS	26-Jul-23	8021B	
Ethylbenzene*	<0.001		0.001	mg/L	1	3072429	MS	26-Jul-23	8021B	
Total Xylenes*	<0.003		0.003	mg/L	1	3072429	MS	26-Jul-23	8021B	
Total BTEX	<0.006		0.006	mg/L	1	3072429	MS	26-Jul-23	8021B	

Surrogate: 4-Bromofluorobenzene (PID) 102 % 77.5-125 3072429 MS 26-Jul-23 8021B

Petroleum Hydrocarbons by GC FID

GRO C6-C10*	<1.00		1.00	mg/L	0.1	3072032	MS	22-Jul-23	8015B	
DRO >C10-C28*	<1.00		1.00	mg/L	0.1	3072032	MS	22-Jul-23	8015B	
EXT DRO >C28-C36	<1.00		1.00	mg/L	0.1	3072032	MS	22-Jul-23	8015B	

Surrogate: 1-Chlorooctane 89.1 % 48.8-131 3072032 MS 22-Jul-23 8015B

Surrogate: 1-Chlorooctadecane 97.2 % 60.1-141 3072032 MS 22-Jul-23 8015B

Polynuclear Aromatic Compounds by GC/MS

Naphthalene*	<0.001		0.001	mg/L	0.96	3071835	MS	26-Jul-23	8270C	
2-Methylnaphthalene*	<0.001		0.001	mg/L	0.96	3071835	MS	26-Jul-23	8270C	
1-Methylnaphthalene	<0.0005		0.0005	mg/L	0.96	3071835	MS	26-Jul-23	8270C	
Acenaphthylene*	<0.001		0.001	mg/L	0.96	3071835	MS	26-Jul-23	8270C	
Acenaphthene*	<0.001		0.001	mg/L	0.96	3071835	MS	26-Jul-23	8270C	
Fluorene*	<0.001		0.001	mg/L	0.96	3071835	MS	26-Jul-23	8270C	
Phenanthrene*	<0.001		0.001	mg/L	0.96	3071835	MS	26-Jul-23	8270C	
Anthracene*	<0.001		0.001	mg/L	0.96	3071835	MS	26-Jul-23	8270C	
Carbazole*	<0.001		0.001	mg/L	0.96	3071835	MS	26-Jul-23	8270C	
Fluoranthene*	<0.001		0.001	mg/L	0.96	3071835	MS	26-Jul-23	8270C	
Pyrene*	<0.001		0.001	mg/L	0.96	3071835	MS	26-Jul-23	8270C	
Benzo[a]anthracene*	<0.001		0.001	mg/L	0.96	3071835	MS	26-Jul-23	8270C	

Cardinal Laboratories

*=Accredited Analyte

PLEASE NOTE: Liability and Damages. Cardinal's liability and client's exclusive remedy for any claim arising, whether based in contract or tort, shall be limited to the amount paid by client for analyses. All claims, including those for negligence or any other cause whatsoever shall be deemed waived unless made in writing and received by Cardinal within thirty (30) days after completion of the applicable service. In no event shall Cardinal be liable for incidental or consequential damage including, without limitation, business interruptions, loss of use, or loss of profits incurred by client, its subsidiaries, affiliates or successors arising out of or related to the performance of the services hereunder by Cardinal, regardless of whether such claim is based upon any of the above stated reasons or otherwise. Results relate only to the samples identified above. This report shall not be reproduced except in full with written approval of Cardinal Laboratories.

Celey D. Keene, Lab Director/Quality Manager



PHONE (575) 393-2326 ° 101 E. MARLAND ° HOBBS, NM 88240

Analytical Results For:

AXIS ENVIROMENTAL
121 INDIAN RIDGE RD
BELTON TX, 76513

Project: G STATE 4
Project Number: NONE GIVEN
Project Manager: BRAD FREEMAN
Fax To:

Reported:
31-Jul-23 12:26

MW 6**H233797-03 (Water)**

Analyte	Result	MDL	Reporting Limit	Units	Dilution	Batch	Analyst	Analyzed	Method	Notes
---------	--------	-----	-----------------	-------	----------	-------	---------	----------	--------	-------

Cardinal Laboratories**Polynuclear Aromatic Compounds by GC/MS**

Chrysene*	<0.001		0.001	mg/L	0.96	3071835	MS	26-Jul-23	8270C	
Benzo[b]flouranthene*	<0.001		0.001	mg/L	0.96	3071835	MS	26-Jul-23	8270C	
Benzo[k]flouranthene*	<0.001		0.001	mg/L	0.96	3071835	MS	26-Jul-23	8270C	
Benzo[a]pyrene*	<0.0002		0.0002	mg/L	0.96	3071835	MS	26-Jul-23	8270C	
Indeno[1,2,3-cd]pyrene*	<0.001		0.001	mg/L	0.96	3071835	MS	26-Jul-23	8270C	
Dibenz[a,h]anthracene*	<0.001		0.001	mg/L	0.96	3071835	MS	26-Jul-23	8270C	
Benzo[g,h,i]perylene*	<0.001		0.001	mg/L	0.96	3071835	MS	26-Jul-23	8270C	
Surrogate: Nitrobenzene-d5			64.1 %	20.3-96.6		3071835	MS	26-Jul-23	8270C	
Surrogate: 2-Fluorobiphenyl			67.4 %	18.9-97.9		3071835	MS	26-Jul-23	8270C	
Surrogate: Terphenyl-d14			80.2 %	14.7-112		3071835	MS	26-Jul-23	8270C	

Cardinal Laboratories

*=Accredited Analyte

PLEASE NOTE: Liability and Damages. Cardinal's liability and client's exclusive remedy for any claim arising, whether based in contract or tort, shall be limited to the amount paid by client for analyses. All claims, including those for negligence or any other cause whatsoever shall be deemed waived unless made in writing and received by Cardinal within thirty (30) days after completion of the applicable service. In no event shall Cardinal be liable for incidental or consequential damage including, without limitation, business interruptions, loss of use, or loss of profits incurred by client, its subsidiaries, affiliates or successors arising out of or related to the performance of the services hereunder by Cardinal, regardless of whether such claim is based upon any of the above stated reasons or otherwise. Results relate only to the samples identified above. This report shall not be reproduced except in full with written approval of Cardinal Laboratories.

Celey D. Keene, Lab Director/Quality Manager



PHONE (575) 393-2326 • 101 E. MARLAND • HOBBS, NM 88240

Analytical Results For:

AXIS ENVIROMENTAL
121 INDIAN RIDGE RD
BELTON TX, 76513

Project: G STATE 4
Project Number: NONE GIVEN
Project Manager: BRAD FREEMAN
Fax To:

Reported:
31-Jul-23 12:26

MW 7**H233797-04 (Water)**

Analyte	Result	MDL	Reporting Limit	Units	Dilution	Batch	Analyst	Analyzed	Method	Notes
---------	--------	-----	-----------------	-------	----------	-------	---------	----------	--------	-------

Cardinal Laboratories**Inorganic Compounds**

Chloride*	340		4.00	mg/L	1	3071022	AC	24-Jul-23	4500-Cl-B	
------------------	------------	--	------	------	---	---------	----	-----------	-----------	--

Volatile Organic Compounds by EPA Method 8021

Benzene*	<0.001		0.001	mg/L	1	3072429	MS	26-Jul-23	8021B	
Toluene*	<0.001		0.001	mg/L	1	3072429	MS	26-Jul-23	8021B	
Ethylbenzene*	<0.001		0.001	mg/L	1	3072429	MS	26-Jul-23	8021B	
Total Xylenes*	<0.003		0.003	mg/L	1	3072429	MS	26-Jul-23	8021B	
Total BTEX	<0.006		0.006	mg/L	1	3072429	MS	26-Jul-23	8021B	

Surrogate: 4-Bromofluorobenzene (PID)			104 %	77.5-125		3072429	MS	26-Jul-23	8021B	
---------------------------------------	--	--	-------	----------	--	---------	----	-----------	-------	--

Petroleum Hydrocarbons by GC FID

GRO C6-C10*	<1.00		1.00	mg/L	0.1	3072032	MS	22-Jul-23	8015B	
DRO >C10-C28*	<1.00		1.00	mg/L	0.1	3072032	MS	22-Jul-23	8015B	
EXT DRO >C28-C36	<1.00		1.00	mg/L	0.1	3072032	MS	22-Jul-23	8015B	

Surrogate: 1-Chlorooctane			93.6 %	48.8-131		3072032	MS	22-Jul-23	8015B	
---------------------------	--	--	--------	----------	--	---------	----	-----------	-------	--

Surrogate: 1-Chlorooctadecane			101 %	60.1-141		3072032	MS	22-Jul-23	8015B	
-------------------------------	--	--	-------	----------	--	---------	----	-----------	-------	--

Polynuclear Aromatic Compounds by GC/MS

Naphthalene*	<0.001		0.001	mg/L	0.96	3071835	MS	26-Jul-23	8270C	
2-Methylnaphthalene*	<0.001		0.001	mg/L	0.96	3071835	MS	26-Jul-23	8270C	
1-Methylnaphthalene	<0.0005		0.0005	mg/L	0.96	3071835	MS	26-Jul-23	8270C	
Acenaphthylene*	<0.001		0.001	mg/L	0.96	3071835	MS	26-Jul-23	8270C	
Acenaphthene*	<0.001		0.001	mg/L	0.96	3071835	MS	26-Jul-23	8270C	
Fluorene*	<0.001		0.001	mg/L	0.96	3071835	MS	26-Jul-23	8270C	
Phenanthrene*	<0.001		0.001	mg/L	0.96	3071835	MS	26-Jul-23	8270C	
Anthracene*	<0.001		0.001	mg/L	0.96	3071835	MS	26-Jul-23	8270C	
Carbazole*	<0.001		0.001	mg/L	0.96	3071835	MS	26-Jul-23	8270C	
Fluoranthene*	<0.001		0.001	mg/L	0.96	3071835	MS	26-Jul-23	8270C	
Pyrene*	<0.001		0.001	mg/L	0.96	3071835	MS	26-Jul-23	8270C	
Benzo[a]anthracene*	<0.001		0.001	mg/L	0.96	3071835	MS	26-Jul-23	8270C	

Cardinal Laboratories

*=Accredited Analyte

PLEASE NOTE: Liability and Damages. Cardinal's liability and client's exclusive remedy for any claim arising, whether based in contract or tort, shall be limited to the amount paid by client for analyses. All claims, including those for negligence or any other cause whatsoever shall be deemed waived unless made in writing and received by Cardinal within thirty (30) days after completion of the applicable service. In no event shall Cardinal be liable for incidental or consequential damage including, without limitation, business interruptions, loss of use, or loss of profits incurred by client, its subsidiaries, affiliates or successors arising out of or related to the performance of the services hereunder by Cardinal, regardless of whether such claim is based upon any of the above stated reasons or otherwise. Results relate only to the samples identified above. This report shall not be reproduced except in full with written approval of Cardinal Laboratories.

Celey D. Keene, Lab Director/Quality Manager



PHONE (575) 393-2326 ° 101 E. MARLAND ° HOBBS, NM 88240

Analytical Results For:AXIS ENVIROMENTAL
121 INDIAN RIDGE RD
BELTON TX, 76513Project: G STATE 4
Project Number: NONE GIVEN
Project Manager: BRAD FREEMAN
Fax To:Reported:
31-Jul-23 12:26**MW 7****H233797-04 (Water)**

Analyte	Result	MDL	Reporting Limit	Units	Dilution	Batch	Analyst	Analyzed	Method	Notes
---------	--------	-----	-----------------	-------	----------	-------	---------	----------	--------	-------

Cardinal Laboratories**Polynuclear Aromatic Compounds by GC/MS**

Chrysene*	<0.001		0.001	mg/L	0.96	3071835	MS	26-Jul-23	8270C	
Benzo[b]flouranthene*	<0.001		0.001	mg/L	0.96	3071835	MS	26-Jul-23	8270C	
Benzo[k]flouranthene*	<0.001		0.001	mg/L	0.96	3071835	MS	26-Jul-23	8270C	
Benzo[a]pyrene*	<0.0002		0.0002	mg/L	0.96	3071835	MS	26-Jul-23	8270C	
Indeno[1,2,3-cd]pyrene*	<0.001		0.001	mg/L	0.96	3071835	MS	26-Jul-23	8270C	
Dibenz[a,h]anthracene*	<0.001		0.001	mg/L	0.96	3071835	MS	26-Jul-23	8270C	
Benzo[g,h,i]perylene*	<0.001		0.001	mg/L	0.96	3071835	MS	26-Jul-23	8270C	
Surrogate: Nitrobenzene-d5			49.6 %	20.3-96.6		3071835	MS	26-Jul-23	8270C	
Surrogate: 2-Fluorobiphenyl			52.5 %	18.9-97.9		3071835	MS	26-Jul-23	8270C	
Surrogate: Terphenyl-d14			62.7 %	14.7-112		3071835	MS	26-Jul-23	8270C	

Cardinal Laboratories

*=Accredited Analyte

PLEASE NOTE: Liability and Damages. Cardinal's liability and client's exclusive remedy for any claim arising, whether based in contract or tort, shall be limited to the amount paid by client for analyses. All claims, including those for negligence or any other cause whatsoever shall be deemed waived unless made in writing and received by Cardinal within thirty (30) days after completion of the applicable service. In no event shall Cardinal be liable for incidental or consequential damage including, without limitation, business interruptions, loss of use, or loss of profits incurred by client, its subsidiaries, affiliates or successors arising out of or related to the performance of the services hereunder by Cardinal, regardless of whether such claim is based upon any of the above stated reasons or otherwise. Results relate only to the samples identified above. This report shall not be reproduced except in full with written approval of Cardinal Laboratories.

Celey D. Keene, Lab Director/Quality Manager



PHONE (575) 393-2326 ° 101 E. MARLAND ° HOBBS, NM 88240

Analytical Results For:

AXIS ENVIROMENTAL
121 INDIAN RIDGE RD
BELTON TX, 76513

Project: G STATE 4
Project Number: NONE GIVEN
Project Manager: BRAD FREEMAN
Fax To:

Reported:
31-Jul-23 12:26

MW 8**H233797-05 (Water)**

Analyte	Result	MDL	Reporting Limit	Units	Dilution	Batch	Analyst	Analyzed	Method	Notes
---------	--------	-----	-----------------	-------	----------	-------	---------	----------	--------	-------

Cardinal Laboratories**Inorganic Compounds**

Chloride*	372		4.00	mg/L	1	3072101	AC	24-Jul-23	4500-Cl-B	
-----------	-----	--	------	------	---	---------	----	-----------	-----------	--

Volatile Organic Compounds by EPA Method 8021

Benzene*	<0.001		0.001	mg/L	1	3072429	MS	26-Jul-23	8021B	
Toluene*	<0.001		0.001	mg/L	1	3072429	MS	26-Jul-23	8021B	
Ethylbenzene*	<0.001		0.001	mg/L	1	3072429	MS	26-Jul-23	8021B	
Total Xylenes*	<0.003		0.003	mg/L	1	3072429	MS	26-Jul-23	8021B	
Total BTEX	<0.006		0.006	mg/L	1	3072429	MS	26-Jul-23	8021B	

Surrogate: 4-Bromofluorobenzene (PID)	98.7 %		77.5-125			3072429	MS	26-Jul-23	8021B	
---------------------------------------	--------	--	----------	--	--	---------	----	-----------	-------	--

Petroleum Hydrocarbons by GC FID

GRO C6-C10*	<1.00		1.00	mg/L	0.1	3072032	MS	22-Jul-23	8015B	
DRO >C10-C28*	<1.00		1.00	mg/L	0.1	3072032	MS	22-Jul-23	8015B	
EXT DRO >C28-C36	<1.00		1.00	mg/L	0.1	3072032	MS	22-Jul-23	8015B	

Surrogate: 1-Chlorooctane	90.9 %		48.8-131			3072032	MS	22-Jul-23	8015B	
---------------------------	--------	--	----------	--	--	---------	----	-----------	-------	--

Surrogate: 1-Chlorooctadecane	101 %		60.1-141			3072032	MS	22-Jul-23	8015B	
-------------------------------	-------	--	----------	--	--	---------	----	-----------	-------	--

Polynuclear Aromatic Compounds by GC/MS

Naphthalene*	<0.001		0.001	mg/L	1	3071835	MS	26-Jul-23	8270C	
2-Methylnaphthalene*	<0.001		0.001	mg/L	1	3071835	MS	26-Jul-23	8270C	
1-Methylnaphthalene	<0.0005		0.0005	mg/L	1	3071835	MS	26-Jul-23	8270C	
Acenaphthylene*	<0.001		0.001	mg/L	1	3071835	MS	26-Jul-23	8270C	
Acenaphthene*	<0.001		0.001	mg/L	1	3071835	MS	26-Jul-23	8270C	
Fluorene*	<0.001		0.001	mg/L	1	3071835	MS	26-Jul-23	8270C	
Phenanthrene*	<0.001		0.001	mg/L	1	3071835	MS	26-Jul-23	8270C	
Anthracene*	<0.001		0.001	mg/L	1	3071835	MS	26-Jul-23	8270C	
Carbazole*	<0.001		0.001	mg/L	1	3071835	MS	26-Jul-23	8270C	
Fluoranthene*	<0.001		0.001	mg/L	1	3071835	MS	26-Jul-23	8270C	
Pyrene*	<0.001		0.001	mg/L	1	3071835	MS	26-Jul-23	8270C	
Benzo[a]anthracene*	<0.001		0.001	mg/L	1	3071835	MS	26-Jul-23	8270C	

Cardinal Laboratories

*=Accredited Analyte

PLEASE NOTE: Liability and Damages. Cardinal's liability and client's exclusive remedy for any claim arising, whether based in contract or tort, shall be limited to the amount paid by client for analyses. All claims, including those for negligence or any other cause whatsoever shall be deemed waived unless made in writing and received by Cardinal within thirty (30) days after completion of the applicable service. In no event shall Cardinal be liable for incidental or consequential damage including, without limitation, business interruptions, loss of use, or loss of profits incurred by client, its subsidiaries, affiliates or successors arising out of or related to the performance of the services hereunder by Cardinal, regardless of whether such claim is based upon any of the above stated reasons or otherwise. Results relate only to the samples identified above. This report shall not be reproduced except in full with written approval of Cardinal Laboratories.

Celey D. Keene, Lab Director/Quality Manager



PHONE (575) 393-2326 ° 101 E. MARLAND ° HOBBS, NM 88240

Analytical Results For:

AXIS ENVIROMENTAL
121 INDIAN RIDGE RD
BELTON TX, 76513

Project: G STATE 4
Project Number: NONE GIVEN
Project Manager: BRAD FREEMAN
Fax To:

Reported:
31-Jul-23 12:26

MW 8**H233797-05 (Water)**

Analyte	Result	MDL	Reporting Limit	Units	Dilution	Batch	Analyst	Analyzed	Method	Notes
---------	--------	-----	-----------------	-------	----------	-------	---------	----------	--------	-------

Cardinal Laboratories**Polynuclear Aromatic Compounds by GC/MS**

Chrysene*	<0.001		0.001	mg/L	1	3071835	MS	26-Jul-23	8270C	
Benzo[b]flouranthene*	<0.001		0.001	mg/L	1	3071835	MS	26-Jul-23	8270C	
Benzo[k]flouranthene*	<0.001		0.001	mg/L	1	3071835	MS	26-Jul-23	8270C	
Benzo[a]pyrene*	<0.0002		0.0002	mg/L	1	3071835	MS	26-Jul-23	8270C	
Indeno[1,2,3-cd]pyrene*	<0.001		0.001	mg/L	1	3071835	MS	26-Jul-23	8270C	
Dibenz[a,h]anthracene*	<0.001		0.001	mg/L	1	3071835	MS	26-Jul-23	8270C	
Benzo[g,h,i]perylene*	<0.001		0.001	mg/L	1	3071835	MS	26-Jul-23	8270C	
Surrogate: Nitrobenzene-d5			62.6 %	20.3-96.6		3071835	MS	26-Jul-23	8270C	
Surrogate: 2-Fluorobiphenyl			57.6 %	18.9-97.9		3071835	MS	26-Jul-23	8270C	
Surrogate: Terphenyl-d14			50.5 %	14.7-112		3071835	MS	26-Jul-23	8270C	

Cardinal Laboratories

*=Accredited Analyte

PLEASE NOTE: Liability and Damages. Cardinal's liability and client's exclusive remedy for any claim arising, whether based in contract or tort, shall be limited to the amount paid by client for analyses. All claims, including those for negligence or any other cause whatsoever shall be deemed waived unless made in writing and received by Cardinal within thirty (30) days after completion of the applicable service. In no event shall Cardinal be liable for incidental or consequential damage including, without limitation, business interruptions, loss of use, or loss of profits incurred by client, its subsidiaries, affiliates or successors arising out of or related to the performance of the services hereunder by Cardinal, regardless of whether such claim is based upon any of the above stated reasons or otherwise. Results relate only to the samples identified above. This report shall not be reproduced except in full with written approval of Cardinal Laboratories.

Celey D. Keene, Lab Director/Quality Manager



PHONE (575) 393-2326 ° 101 E. MARLAND ° HOBBS, NM 88240

Analytical Results For:

AXIS ENVIROMENTAL
121 INDIAN RIDGE RD
BELTON TX, 76513

Project: G STATE 4
Project Number: NONE GIVEN
Project Manager: BRAD FREEMAN
Fax To:

Reported:
31-Jul-23 12:26

Inorganic Compounds - Quality Control**Cardinal Laboratories**

Analyte	Result	Reporting Limit	Units	Spike Level	Source Result	%REC Limits	RPD	RPD Limit	Notes
---------	--------	--------------------	-------	----------------	------------------	----------------	-----	--------------	-------

Batch 3071022 - General Prep - Wet Chem**Blank (3071022-BLK1)**

Prepared & Analyzed: 10-Jul-23

Chloride	ND	4.00	mg/L						
----------	----	------	------	--	--	--	--	--	--

LCS (3071022-BS1)

Prepared & Analyzed: 10-Jul-23

Chloride	104	4.00	mg/L	100	104	80-120			
----------	-----	------	------	-----	-----	--------	--	--	--

LCS Dup (3071022-BSD1)

Prepared & Analyzed: 10-Jul-23

Chloride	100	4.00	mg/L	100	100	80-120	3.92	20	
----------	-----	------	------	-----	-----	--------	------	----	--

Batch 3072101 - General Prep - Wet Chem**Blank (3072101-BLK1)**

Prepared: 21-Jul-23 Analyzed: 24-Jul-23

Chloride	ND	4.00	mg/L						
----------	----	------	------	--	--	--	--	--	--

LCS (3072101-BS1)

Prepared: 21-Jul-23 Analyzed: 24-Jul-23

Chloride	104	4.00	mg/L	100	104	80-120			
----------	-----	------	------	-----	-----	--------	--	--	--

LCS Dup (3072101-BSD1)

Prepared: 21-Jul-23 Analyzed: 24-Jul-23

Chloride	100	4.00	mg/L	100	100	80-120	3.92	20	
----------	-----	------	------	-----	-----	--------	------	----	--

Cardinal Laboratories

*=Accredited Analyte

PLEASE NOTE: Liability and Damages. Cardinal's liability and client's exclusive remedy for any claim arising, whether based in contract or tort, shall be limited to the amount paid by client for analyses. All claims, including those for negligence or any other cause whatsoever shall be deemed waived unless made in writing and received by Cardinal within thirty (30) days after completion of the applicable service. In no event shall Cardinal be liable for incidental or consequential damage including, without limitation, business interruptions, loss of use, or loss of profits incurred by client, its subsidiaries, affiliates or successors arising out of or related to the performance of the services hereunder by Cardinal, regardless of whether such claim is based upon any of the above stated reasons or otherwise. Results relate only to the samples identified above. This report shall not be reproduced except in full with written approval of Cardinal Laboratories.

Celey D. Keene, Lab Director/Quality Manager



PHONE (575) 393-2326 ° 101 E. MARLAND ° HOBBS, NM 88240

Analytical Results For:

AXIS ENVIROMENTAL
121 INDIAN RIDGE RD
BELTON TX, 76513

Project: G STATE 4
Project Number: NONE GIVEN
Project Manager: BRAD FREEMAN
Fax To:

Reported:
31-Jul-23 12:26

Volatile Organic Compounds by EPA Method 8021 - Quality Control**Cardinal Laboratories**

Analyte	Result	Reporting Limit	Units	Spike Level	Source Result	%REC	%REC Limits	RPD	RPD Limit	Notes
---------	--------	-----------------	-------	-------------	---------------	------	-------------	-----	-----------	-------

Batch 3072429 - Volatiles**Blank (3072429-BLK1)**

Prepared: 24-Jul-23 Analyzed: 26-Jul-23

Benzene	ND	0.001	mg/L							
Toluene	ND	0.001	mg/L							
Ethylbenzene	ND	0.001	mg/L							
Total Xylenes	ND	0.003	mg/L							
Total BTEX	ND	0.006	mg/L							
Surrogate: 4-Bromofluorobenzene (PID)	0.0495		mg/L	0.0500		99.0	77.5-125			

LCS (3072429-BS1)

Prepared: 24-Jul-23 Analyzed: 26-Jul-23

Benzene	0.018	0.001	mg/L	0.0200		91.4	80.8-112			
Toluene	0.018	0.001	mg/L	0.0200		88.0	78.7-114			
Ethylbenzene	0.018	0.001	mg/L	0.0200		90.2	70.9-120			
m,p-Xylene	0.036	0.002	mg/L	0.0400		89.8	76.9-119			
o-Xylene	0.018	0.001	mg/L	0.0200		91.7	71.7-120			
Total Xylenes	0.054	0.003	mg/L	0.0600		90.4	75.6-119			
Surrogate: 4-Bromofluorobenzene (PID)	0.0501		mg/L	0.0500		100	77.5-125			

LCS Dup (3072429-BSD1)

Prepared: 24-Jul-23 Analyzed: 26-Jul-23

Benzene	0.020	0.001	mg/L	0.0200		97.9	80.8-112	6.89	8.26	
Toluene	0.019	0.001	mg/L	0.0200		95.7	78.7-114	8.46	9.03	
Ethylbenzene	0.019	0.001	mg/L	0.0200		95.7	70.9-120	5.94	11.9	
m,p-Xylene	0.039	0.002	mg/L	0.0400		96.4	76.9-119	7.08	11	
o-Xylene	0.020	0.001	mg/L	0.0200		98.0	71.7-120	6.64	15	
Total Xylenes	0.058	0.003	mg/L	0.0600		96.9	75.6-119	6.93	12.2	
Surrogate: 4-Bromofluorobenzene (PID)	0.0501		mg/L	0.0500		100	77.5-125			

Cardinal Laboratories

*=Accredited Analyte

PLEASE NOTE: Liability and Damages. Cardinal's liability and client's exclusive remedy for any claim arising, whether based in contract or tort, shall be limited to the amount paid by client for analyses. All claims, including those for negligence or any other cause whatsoever shall be deemed waived unless made in writing and received by Cardinal within thirty (30) days after completion of the applicable service. In no event shall Cardinal be liable for incidental or consequential damage including, without limitation, business interruptions, loss of use, or loss of profits incurred by client, its subsidiaries, affiliates or successors arising out of or related to the performance of the services hereunder by Cardinal, regardless of whether such claim is based upon any of the above stated reasons or otherwise. Results relate only to the samples identified above. This report shall not be reproduced except in full with written approval of Cardinal Laboratories.

Celey D. Keene, Lab Director/Quality Manager



PHONE (575) 393-2326 ° 101 E. MARLAND ° HOBBS, NM 88240

Analytical Results For:

AXIS ENVIROMENTAL
121 INDIAN RIDGE RD
BELTON TX, 76513

Project: G STATE 4
Project Number: NONE GIVEN
Project Manager: BRAD FREEMAN
Fax To:

Reported:
31-Jul-23 12:26

Petroleum Hydrocarbons by GC FID - Quality Control**Cardinal Laboratories**

Analyte	Result	Reporting Limit	Units	Spike Level	Source Result	%REC Limits	RPD	RPD Limit	Notes
---------	--------	--------------------	-------	----------------	------------------	----------------	-----	--------------	-------

Batch 3072032 - General Prep - Organics**Blank (3072032-BLK1)**

Prepared: 20-Jul-23 Analyzed: 22-Jul-23

GRO C6-C10	ND	1.00	mg/L						
DRO >C10-C28	ND	1.00	mg/L						
EXT DRO >C28-C36	ND	1.00	mg/L						
Surrogate: 1-Chlorooctane	4.37		mg/L	4.96		88.1	48.8-131		
Surrogate: 1-Chlorooctadecane	5.09		mg/L	5.00		102	60.1-141		

LCS (3072032-BS1)

Prepared: 20-Jul-23 Analyzed: 22-Jul-23

GRO C6-C10	45.1	1.00	mg/L	50.0		90.2	69.6-126		
DRO >C10-C28	46.0	1.00	mg/L	50.0		92.0	68.8-126		
Surrogate: 1-Chlorooctane	5.18		mg/L	4.96		105	48.8-131		
Surrogate: 1-Chlorooctadecane	5.16		mg/L	5.00		103	60.1-141		

LCS Dup (3072032-BS1)

Prepared: 20-Jul-23 Analyzed: 22-Jul-23

GRO C6-C10	45.7	1.00	mg/L	50.0		91.3	69.6-126	1.20	16.8
DRO >C10-C28	45.1	1.00	mg/L	50.0		90.2	68.8-126	2.01	20.4
Surrogate: 1-Chlorooctane	5.34		mg/L	4.96		108	48.8-131		
Surrogate: 1-Chlorooctadecane	5.07		mg/L	5.00		101	60.1-141		

Cardinal Laboratories

*=Accredited Analyte

PLEASE NOTE: Liability and Damages. Cardinal's liability and client's exclusive remedy for any claim arising, whether based in contract or tort, shall be limited to the amount paid by client for analyses. All claims, including those for negligence or any other cause whatsoever shall be deemed waived unless made in writing and received by Cardinal within thirty (30) days after completion of the applicable service. In no event shall Cardinal be liable for incidental or consequential damage including, without limitation, business interruptions, loss of use, or loss of profits incurred by client, its subsidiaries, affiliates or successors arising out of or related to the performance of the services hereunder by Cardinal, regardless of whether such claim is based upon any of the above stated reasons or otherwise. Results relate only to the samples identified above. This report shall not be reproduced except in full with written approval of Cardinal Laboratories.

Celey D. Keene, Lab Director/Quality Manager



PHONE (575) 393-2326 ° 101 E. MARLAND ° HOBBS, NM 88240

Analytical Results For:

AXIS ENVIROMENTAL
121 INDIAN RIDGE RD
BELTON TX, 76513

Project: G STATE 4
Project Number: NONE GIVEN
Project Manager: BRAD FREEMAN
Fax To:

Reported:
31-Jul-23 12:26

Polynuclear Aromatic Compounds by GC/MS - Quality Control**Cardinal Laboratories**

Analyte	Result	Reporting Limit	Units	Spike Level	Source Result	%REC	%REC Limits	RPD	RPD Limit	Notes
---------	--------	--------------------	-------	----------------	------------------	------	----------------	-----	--------------	-------

Batch 3071835 - SW846-3510**Blank (3071835-BLK1)**

Prepared: 18-Jul-23 Analyzed: 26-Jul-23

Naphthalene	ND	0.001	mg/L							
2-Methylnaphthalene	ND	0.001	mg/L							
1-Methylnaphthalene	ND	0.0005	mg/L							
Acenaphthylene	ND	0.001	mg/L							
Acenaphthene	ND	0.001	mg/L							
Fluorene	ND	0.001	mg/L							
Phenanthrene	ND	0.001	mg/L							
Anthracene	ND	0.001	mg/L							
Carbazole	ND	0.001	mg/L							
Fluoranthene	ND	0.001	mg/L							
Pyrene	ND	0.001	mg/L							
Benzo[a]anthracene	ND	0.001	mg/L							
Chrysene	ND	0.001	mg/L							
Benzo[b]fluoranthene	ND	0.001	mg/L							
Benzo[k]fluoranthene	ND	0.001	mg/L							
Benzo[a]pyrene	ND	0.0002	mg/L							
Indeno[1,2,3-cd]pyrene	ND	0.001	mg/L							
Dibenz[a,h]anthracene	ND	0.001	mg/L							
Benzo[g,h,i]perylene	ND	0.001	mg/L							
Surrogate: Nitrobenzene-d5	0.0578		mg/L	0.0500		116	20.3-96.6			S-05
Surrogate: 2-Fluorobiphenyl	0.0618		mg/L	0.0500		124	18.9-97.9			S-05
Surrogate: Terphenyl-d14	0.0364		mg/L	0.0500		72.8	14.7-112			

LCS (3071835-BS1)

Prepared: 18-Jul-23 Analyzed: 26-Jul-23

Naphthalene	0.007	0.001	mg/L	0.0100		65.8	18.1-117			
2-Methylnaphthalene	0.007	0.001	mg/L	0.0100		68.4	21-115			
1-Methylnaphthalene	0.007	0.0005	mg/L	0.0100		68.2	21.2-116			
Acenaphthylene	0.007	0.001	mg/L	0.0100		69.7	24.2-119			
Acenaphthene	0.006	0.001	mg/L	0.0100		64.9	21.5-122			
Fluorene	0.007	0.001	mg/L	0.0100		70.5	22.9-124			
Phenanthrene	0.007	0.001	mg/L	0.0100		70.3	25.6-128			
Anthracene	0.007	0.001	mg/L	0.0100		69.7	27-127			

Cardinal Laboratories

*=Accredited Analyte

PLEASE NOTE: Liability and Damages. Cardinal's liability and client's exclusive remedy for any claim arising, whether based in contract or tort, shall be limited to the amount paid by client for analyses. All claims, including those for negligence or any other cause whatsoever shall be deemed waived unless made in writing and received by Cardinal within thirty (30) days after completion of the applicable service. In no event shall Cardinal be liable for incidental or consequential damage including, without limitation, business interruptions, loss of use, or loss of profits incurred by client, its subsidiaries, affiliates or successors arising out of or related to the performance of the services hereunder by Cardinal, regardless of whether such claim is based upon any of the above stated reasons or otherwise. Results relate only to the samples identified above. This report shall not be reproduced except in full with written approval of Cardinal Laboratories.

Celey D. Keene, Lab Director/Quality Manager



PHONE (575) 393-2326 • 101 E. MARLAND • HOBBS, NM 88240

Analytical Results For:

AXIS ENVIROMENTAL
121 INDIAN RIDGE RD
BELTON TX, 76513

Project: G STATE 4
Project Number: NONE GIVEN
Project Manager: BRAD FREEMAN
Fax To:

Reported:
31-Jul-23 12:26

Polynuclear Aromatic Compounds by GC/MS - Quality Control**Cardinal Laboratories**

Analyte	Result	Reporting Limit	Units	Spike Level	Source Result	%REC	%REC Limits	RPD	RPD Limit	Notes
---------	--------	-----------------	-------	-------------	---------------	------	-------------	-----	-----------	-------

Batch 3071835 - SW846-3510**LCS (3071835-BS1)**

Prepared: 18-Jul-23 Analyzed: 26-Jul-23

Carbazole	0.007	0.001	mg/L	0.0100		74.0	26.4-128			
Fluoranthene	0.008	0.001	mg/L	0.0100		77.2	27.2-128			
Pyrene	0.007	0.001	mg/L	0.0100		67.4	19.1-137			
Benzo[a]anthracene	0.007	0.001	mg/L	0.0100		67.4	21.9-134			
Chrysene	0.007	0.001	mg/L	0.0100		66.4	22.2-133			
Benzo[b]fluoranthene	0.008	0.001	mg/L	0.0100		76.2	20.4-144			
Benzo[k]fluoranthene	0.007	0.001	mg/L	0.0100		72.0	21.8-139			
Benzo[a]pyrene	0.008	0.0002	mg/L	0.0100		75.9	23.6-140			
Indeno[1,2,3-cd]pyrene	0.008	0.001	mg/L	0.0100		78.5	21.8-132			
Dibenz[a,h]anthracene	0.008	0.001	mg/L	0.0100		80.3	20.3-133			
Benzo[g,h,i]perylene	0.008	0.001	mg/L	0.0100		75.5	24.8-126			
Surrogate: Nitrobenzene-d5	0.0502		mg/L	0.0500		100	20.3-96.6			S-05
Surrogate: 2-Fluorobiphenyl	0.0522		mg/L	0.0500		104	18.9-97.9			S-05
Surrogate: Terphenyl-d14	0.0440		mg/L	0.0500		88.1	14.7-112			

LCS Dup (3071835-BSD1)

Prepared: 18-Jul-23 Analyzed: 26-Jul-23

Naphthalene	0.006	0.001	mg/L	0.0100		64.9	18.1-117	1.38	3.46	
2-Methylnaphthalene	0.007	0.001	mg/L	0.0100		67.0	21-115	2.07	4.47	
1-Methylnaphthalene	0.007	0.0005	mg/L	0.0100		66.0	21.2-116	3.28	4.3	
Acenaphthylene	0.007	0.001	mg/L	0.0100		69.3	24.2-119	0.576	3.88	
Acenaphthene	0.007	0.001	mg/L	0.0100		66.1	21.5-122	1.83	3.77	
Fluorene	0.007	0.001	mg/L	0.0100		71.6	22.9-124	1.55	4.31	
Phenanthrene	0.007	0.001	mg/L	0.0100		69.0	25.6-128	1.87	5.04	
Anthracene	0.007	0.001	mg/L	0.0100		69.7	27-127	0.00	4.49	
Carbazole	0.007	0.001	mg/L	0.0100		72.2	26.4-128	2.46	4.78	
Fluoranthene	0.008	0.001	mg/L	0.0100		75.1	27.2-128	2.76	6.19	
Pyrene	0.007	0.001	mg/L	0.0100		71.1	19.1-137	5.34	7.75	
Benzo[a]anthracene	0.007	0.001	mg/L	0.0100		67.7	21.9-134	0.444	3.03	
Chrysene	0.007	0.001	mg/L	0.0100		68.3	22.2-133	2.82	3.42	
Benzo[b]fluoranthene	0.007	0.001	mg/L	0.0100		74.3	20.4-144	2.52	6.95	
Benzo[k]fluoranthene	0.008	0.001	mg/L	0.0100		76.3	21.8-139	5.80	8.16	
Benzo[a]pyrene	0.008	0.0002	mg/L	0.0100		76.4	23.6-140	0.657	3.27	

Cardinal Laboratories

*=Accredited Analyte

PLEASE NOTE: Liability and Damages. Cardinal's liability and client's exclusive remedy for any claim arising, whether based in contract or tort, shall be limited to the amount paid by client for analyses. All claims, including those for negligence or any other cause whatsoever shall be deemed waived unless made in writing and received by Cardinal within thirty (30) days after completion of the applicable service. In no event shall Cardinal be liable for incidental or consequential damage including, without limitation, business interruptions, loss of use, or loss of profits incurred by client, its subsidiaries, affiliates or successors arising out of or related to the performance of the services hereunder by Cardinal, regardless of whether such claim is based upon any of the above stated reasons or otherwise. Results relate only to the samples identified above. This report shall not be reproduced except in full with written approval of Cardinal Laboratories.

Celey D. Keene, Lab Director/Quality Manager



PHONE (575) 393-2326 ° 101 E. MARLAND ° HOBBS, NM 88240

Analytical Results For:

AXIS ENVIROMENTAL
121 INDIAN RIDGE RD
BELTON TX, 76513

Project: G STATE 4
Project Number: NONE GIVEN
Project Manager: BRAD FREEMAN
Fax To:

Reported:
31-Jul-23 12:26

Polynuclear Aromatic Compounds by GC/MS - Quality Control**Cardinal Laboratories**

Analyte	Result	Reporting Limit	Units	Spike Level	Source Result	%REC Limits	RPD	RPD Limit	Notes
---------	--------	--------------------	-------	----------------	------------------	----------------	-----	--------------	-------

Batch 3071835 - SW846-3510**LCS Dup (3071835-BSD1)**

Prepared: 18-Jul-23 Analyzed: 26-Jul-23

Indeno[1,2,3-cd]pyrene	0.007	0.001	mg/L	0.0100		70.5	21.8-132	10.7	4.11	QR-04
Dibenz[a,h]anthracene	0.007	0.001	mg/L	0.0100		74.3	20.3-133	7.76	4.77	QR-04
Benzo[g,h,i]perylene	0.007	0.001	mg/L	0.0100		69.8	24.8-126	7.85	6.35	QR-04
Surrogate: Nitrobenzene-d5	0.0507		mg/L	0.0500		101	20.3-96.6			S-05
Surrogate: 2-Fluorobiphenyl	0.0547		mg/L	0.0500		109	18.9-97.9			S-05
Surrogate: Terphenyl-d14	0.0448		mg/L	0.0500		89.6	14.7-112			

Cardinal Laboratories

*=Accredited Analyte

PLEASE NOTE: Liability and Damages. Cardinal's liability and client's exclusive remedy for any claim arising, whether based in contract or tort, shall be limited to the amount paid by client for analyses. All claims, including those for negligence or any other cause whatsoever shall be deemed waived unless made in writing and received by Cardinal within thirty (30) days after completion of the applicable service. In no event shall Cardinal be liable for incidental or consequential damage including, without limitation, business interruptions, loss of use, or loss of profits incurred by client, its subsidiaries, affiliates or successors arising out of or related to the performance of the services hereunder by Cardinal, regardless of whether such claim is based upon any of the above stated reasons or otherwise. Results relate only to the samples identified above. This report shall not be reproduced except in full with written approval of Cardinal Laboratories.

Celey D. Keene, Lab Director/Quality Manager

PHONE (575) 393-2326 • 101 E. MARLAND • HOBBS, NM 88240

Notes and Definitions

S-05	The surrogate recovery is outside of lab established statistical control limits but still within method limits. Data is not adversely affected.
QR-04	The RPD for the BS/BSD was outside of historical limits.
ND	Analyte NOT DETECTED at or above the reporting limit
RPD	Relative Percent Difference
**	Samples not received at proper temperature of 6°C or below.
***	Insufficient time to reach temperature.
-	Chloride by SM4500Cl-B does not require samples be received at or below 6°C Samples reported on an as received basis (wet) unless otherwise noted on report

Cardinal Laboratories

*=Accredited Analyte

PLEASE NOTE: Liability and Damages. Cardinal's liability and client's exclusive remedy for any claim arising, whether based in contract or tort, shall be limited to the amount paid by client for analyses. All claims, including those for negligence or any other cause whatsoever shall be deemed waived unless made in writing and received by Cardinal within thirty (30) days after completion of the applicable service. In no event shall Cardinal be liable for incidental or consequential damage including, without limitation, business interruptions, loss of use, or loss of profits incurred by client, its subsidiaries, affiliates or successors arising out of or related to the performance of the services hereunder by Cardinal, regardless of whether such claim is based upon any of the above stated reasons or otherwise. Results relate only to the samples identified above. This report shall not be reproduced except in full with written approval of Cardinal Laboratories.

A handwritten signature in black ink, appearing to read "Celey D. Keene", is written over a horizontal line.

Celey D. Keene, Lab Director/Quality Manager



101 East Marland, Hobbs, NM 88240
(575) 393-2326 FAX (575) 393-2476

CHAIN-OF-CUSTODY AND ANALYSIS REQUEST

[illegible]

PHONE (575) 393-2326 ° 101 E. MARLAND ° HOBBS, NM 88240

December 12, 2023

BRAD FREEMAN

AXIS ENVIROMENTAL

121 INDIAN RIDGE RD

BELTON, TX 76513

RE: G STATE 4

Enclosed are the results of analyses for samples received by the laboratory on 12/05/23 14:10.

Cardinal Laboratories is accredited through Texas NELAP under certificate number T104704398-22-15. Accreditation applies to drinking water, non-potable water and solid and chemical materials. All accredited analytes are denoted by an asterisk (*). For a complete list of accredited analytes and matrices visit the TCEQ website at www.tceq.texas.gov/field/ga/lab_accred_certif.html.

Cardinal Laboratories is accredited through the State of Colorado Department of Public Health and Environment for:

Method EPA 552.2	Total Haloacetic Acids (HAA-5)
Method EPA 524.2	Total Trihalomethanes (TTHM)
Method EPA 524.4	Regulated VOCs (V1, V2, V3)

Cardinal Laboratories is accredited through the State of New Mexico Environment Department for:

Method SM 9223-B	Total Coliform and E. coli (Colilert MMO-MUG)
Method EPA 524.2	Regulated VOCs and Total Trihalomethanes (TTHM)
Method EPA 552.2	Total Haloacetic Acids (HAA-5)

Accreditation applies to public drinking water matrices for State of Colorado and New Mexico.

This report meets NELAP requirements and is made up of a cover page, analytical results, and a copy of the original chain-of-custody. If you have any questions concerning this report, please feel free to contact me.

Sincerely,

A handwritten signature in black ink that reads "Celey D. Keene". The signature is fluid and cursive, with the first letters of the first and last names being capitalized and prominent.

Celey D. Keene

Lab Director/Quality Manager



PHONE (575) 393-2326 ° 101 E. MARLAND ° HOBBS, NM 88240

Analytical Results For:AXIS ENVIROMENTAL
121 INDIAN RIDGE RD
BELTON TX, 76513Project: G STATE 4
Project Number: NONE GIVEN
Project Manager: BRAD FREEMAN
Fax To:Reported:
12-Dec-23 09:56

Sample ID	Laboratory ID	Matrix	Date Sampled	Date Received
MW 5	H236530-01	Water	05-Dec-23 08:00	05-Dec-23 14:10
MW 1	H236530-02	Water	05-Dec-23 08:45	05-Dec-23 14:10
MW 2	H236530-03	Water	05-Dec-23 09:30	05-Dec-23 14:10
MW 3	H236530-04	Water	05-Dec-23 10:15	05-Dec-23 14:10
MW 4	H236530-05	Water	05-Dec-23 11:00	05-Dec-23 14:10
MW 6	H236530-06	Water	05-Dec-23 11:50	05-Dec-23 14:10
MW 7	H236530-07	Water	05-Dec-23 12:45	05-Dec-23 14:10
MW 8	H236530-08	Water	05-Dec-23 13:25	05-Dec-23 14:10

Cardinal Laboratories

*=Accredited Analyte

PLEASE NOTE: Liability and Damages. Cardinal's liability and client's exclusive remedy for any claim arising, whether based in contract or tort, shall be limited to the amount paid by client for analyses. All claims, including those for negligence or any other cause whatsoever shall be deemed waived unless made in writing and received by Cardinal within thirty (30) days after completion of the applicable service. In no event shall Cardinal be liable for incidental or consequential damage including, without limitation, business interruptions, loss of use, or loss of profits incurred by client, its subsidiaries, affiliates or successors arising out of or related to the performance of the services hereunder by Cardinal, regardless of whether such claim is based upon any of the above stated reasons or otherwise. Results relate only to the samples identified above. This report shall not be reproduced except in full with written approval of Cardinal Laboratories.

Celey D. Keene, Lab Director/Quality Manager



PHONE (575) 393-2326 ° 101 E. MARLAND ° HOBBS, NM 88240

Analytical Results For:

AXIS ENVIROMENTAL
121 INDIAN RIDGE RD
BELTON TX, 76513

Project: G STATE 4
Project Number: NONE GIVEN
Project Manager: BRAD FREEMAN
Fax To:

Reported:
12-Dec-23 09:56

MW 5
H236530-01 (Water)

Analyte	Result	MDL	Reporting Limit	Units	Dilution	Batch	Analyst	Analyzed	Method	Notes
---------	--------	-----	-----------------	-------	----------	-------	---------	----------	--------	-------

Cardinal Laboratories**Inorganic Compounds**

Chloride*	108		4.00	mg/L	1	3120109	AC	06-Dec-23	4500-Cl-B	
------------------	------------	--	------	------	---	---------	----	-----------	-----------	--

Volatile Organic Compounds by EPA Method 8021

Benzene*	0.015		0.001	mg/L	1	3120504	JH	05-Dec-23	8021B	
Toluene*	0.004		0.001	mg/L	1	3120504	JH	05-Dec-23	8021B	GC-NC1
Ethylbenzene*	0.017		0.001	mg/L	1	3120504	JH	05-Dec-23	8021B	
Total Xylenes*	0.053		0.003	mg/L	1	3120504	JH	05-Dec-23	8021B	
Total BTEX	0.089		0.006	mg/L	1	3120504	JH	05-Dec-23	8021B	GC-NC1

Surrogate: 4-Bromofluorobenzene (PID) 117 % 77.5-125 3120504 JH 05-Dec-23 8021B

Petroleum Hydrocarbons by GC FID**S-04**

GRO C6-C10*	5.55		1.00	mg/L	0.1	3120602	MS	08-Dec-23	8015B	
DRO >C10-C28*	22.4		1.00	mg/L	0.1	3120602	MS	08-Dec-23	8015B	
EXT DRO >C28-C36	3.14		1.00	mg/L	0.1	3120602	MS	08-Dec-23	8015B	

Surrogate: 1-Chlorooctane 117 % 48.8-131 3120602 MS 08-Dec-23 8015B

Surrogate: 1-Chlorooctadecane 143 % 60.1-141 3120602 MS 08-Dec-23 8015B

Polynuclear Aromatic Compounds by GC/MS

Naphthalene*	0.009		0.001	mg/L	0.95	3120433	MS	08-Dec-23	8270C	
2-Methylnaphthalene*	0.021		0.001	mg/L	0.95	3120433	MS	08-Dec-23	8270C	
1-Methylnaphthalene	0.027		0.0005	mg/L	0.95	3120433	MS	08-Dec-23	8270C	
Acenaphthylene*	<0.001		0.001	mg/L	0.95	3120433	MS	08-Dec-23	8270C	
Acenaphthene*	<0.001		0.001	mg/L	0.95	3120433	MS	08-Dec-23	8270C	
Fluorene*	0.004		0.001	mg/L	0.95	3120433	MS	08-Dec-23	8270C	
Phenanthrene*	0.007		0.001	mg/L	0.95	3120433	MS	08-Dec-23	8270C	
Anthracene*	<0.001		0.001	mg/L	0.95	3120433	MS	08-Dec-23	8270C	
Carbazole*	0.002		0.001	mg/L	0.95	3120433	MS	08-Dec-23	8270C	
Fluoranthene*	<0.001		0.001	mg/L	0.95	3120433	MS	08-Dec-23	8270C	
Pyrene*	<0.001		0.001	mg/L	0.95	3120433	MS	08-Dec-23	8270C	

Cardinal Laboratories

*=Accredited Analyte

PLEASE NOTE: Liability and Damages. Cardinal's liability and client's exclusive remedy for any claim arising, whether based in contract or tort, shall be limited to the amount paid by client for analyses. All claims, including those for negligence or any other cause whatsoever shall be deemed waived unless made in writing and received by Cardinal within thirty (30) days after completion of the applicable service. In no event shall Cardinal be liable for incidental or consequential damage including, without limitation, business interruptions, loss of use, or loss of profits incurred by client, its subsidiaries, affiliates or successors arising out of or related to the performance of the services hereunder by Cardinal, regardless of whether such claim is based upon any of the above stated reasons or otherwise. Results relate only to the samples identified above. This report shall not be reproduced except in full with written approval of Cardinal Laboratories.

Celey D. Keene, Lab Director/Quality Manager



PHONE (575) 393-2326 ° 101 E. MARLAND ° HOBBS, NM 88240

Analytical Results For:

AXIS ENVIROMENTAL
121 INDIAN RIDGE RD
BELTON TX, 76513

Project: G STATE 4
Project Number: NONE GIVEN
Project Manager: BRAD FREEMAN
Fax To:

Reported:
12-Dec-23 09:56

MW 5**H236530-01 (Water)**

Analyte	Result	MDL	Reporting Limit	Units	Dilution	Batch	Analyst	Analyzed	Method	Notes
---------	--------	-----	-----------------	-------	----------	-------	---------	----------	--------	-------

Cardinal Laboratories**Polynuclear Aromatic Compounds by GC/MS**

Benzo[a]anthracene*	<0.001		0.001	mg/L	0.95	3120433	MS	08-Dec-23	8270C	
Chrysene*	<0.001		0.001	mg/L	0.95	3120433	MS	08-Dec-23	8270C	
Benzo[b]flouranthene*	<0.001		0.001	mg/L	0.95	3120433	MS	08-Dec-23	8270C	
Benzo[k]flouranthene*	<0.001		0.001	mg/L	0.95	3120433	MS	08-Dec-23	8270C	
Benzo[a]pyrene*	<0.0002		0.0002	mg/L	0.95	3120433	MS	08-Dec-23	8270C	
Indeno[1,2,3-cd]pyrene*	<0.001		0.001	mg/L	0.95	3120433	MS	08-Dec-23	8270C	
Dibenz[a,h]anthracene*	<0.001		0.001	mg/L	0.95	3120433	MS	08-Dec-23	8270C	
Benzo[g,h,i]perylene*	<0.001		0.001	mg/L	0.95	3120433	MS	08-Dec-23	8270C	
Surrogate: Nitrobenzene-d5			61.2 %	5.17-184		3120433	MS	08-Dec-23	8270C	
Surrogate: 2-Fluorobiphenyl			57.5 %	7.39-192		3120433	MS	08-Dec-23	8270C	
Surrogate: Terphenyl-d14			58.4 %	27.5-139		3120433	MS	08-Dec-23	8270C	

Cardinal Laboratories

*=Accredited Analyte

PLEASE NOTE: Liability and Damages. Cardinal's liability and client's exclusive remedy for any claim arising, whether based in contract or tort, shall be limited to the amount paid by client for analyses. All claims, including those for negligence or any other cause whatsoever shall be deemed waived unless made in writing and received by Cardinal within thirty (30) days after completion of the applicable service. In no event shall Cardinal be liable for incidental or consequential damage including, without limitation, business interruptions, loss of use, or loss of profits incurred by client, its subsidiaries, affiliates or successors arising out of or related to the performance of the services hereunder by Cardinal, regardless of whether such claim is based upon any of the above stated reasons or otherwise. Results relate only to the samples identified above. This report shall not be reproduced except in full with written approval of Cardinal Laboratories.

Celey D. Keene, Lab Director/Quality Manager



PHONE (575) 393-2326 ° 101 E. MARLAND ° HOBBS, NM 88240

Analytical Results For:

AXIS ENVIROMENTAL
121 INDIAN RIDGE RD
BELTON TX, 76513

Project: G STATE 4
Project Number: NONE GIVEN
Project Manager: BRAD FREEMAN
Fax To:

Reported:
12-Dec-23 09:56

MW 1**H236530-02 (Water)**

Analyte	Result	MDL	Reporting Limit	Units	Dilution	Batch	Analyst	Analyzed	Method	Notes
---------	--------	-----	-----------------	-------	----------	-------	---------	----------	--------	-------

Cardinal Laboratories**Inorganic Compounds**

Chloride*	188		4.00	mg/L	1	3120109	AC	06-Dec-23	4500-Cl-B	
------------------	------------	--	------	------	---	---------	----	-----------	-----------	--

Volatile Organic Compounds by EPA Method 8021

Benzene*	0.003		0.001	mg/L	1	3120504	JH	05-Dec-23	8021B	
Toluene*	0.002		0.001	mg/L	1	3120504	JH	05-Dec-23	8021B	GC-NC1
Ethylbenzene*	0.008		0.001	mg/L	1	3120504	JH	05-Dec-23	8021B	
Total Xylenes*	0.010		0.003	mg/L	1	3120504	JH	05-Dec-23	8021B	
Total BTEX	0.023		0.006	mg/L	1	3120504	JH	05-Dec-23	8021B	GC-NC1

Surrogate: 4-Bromofluorobenzene (PID) 99.3 % 77.5-125 3120504 JH 05-Dec-23 8021B

Petroleum Hydrocarbons by GC FID

GRO C6-C10*	1.18		1.00	mg/L	0.1	3120602	MS	08-Dec-23	8015B	
DRO >C10-C28*	15.9		1.00	mg/L	0.1	3120602	MS	08-Dec-23	8015B	
EXT DRO >C28-C36	3.18		1.00	mg/L	0.1	3120602	MS	08-Dec-23	8015B	

Surrogate: 1-Chlorooctane 110 % 48.8-131 3120602 MS 08-Dec-23 8015B

Surrogate: 1-Chlorooctadecane 131 % 60.1-141 3120602 MS 08-Dec-23 8015B

Polynuclear Aromatic Compounds by GC/MS

Naphthalene*	0.002		0.001	mg/L	0.96	3120433	MS	08-Dec-23	8270C	
2-Methylnaphthalene*	0.006		0.001	mg/L	0.96	3120433	MS	08-Dec-23	8270C	
1-Methylnaphthalene	0.009		0.0005	mg/L	0.96	3120433	MS	08-Dec-23	8270C	
Acenaphthylene*	<0.001		0.001	mg/L	0.96	3120433	MS	08-Dec-23	8270C	
Acenaphthene*	<0.001		0.001	mg/L	0.96	3120433	MS	08-Dec-23	8270C	
Fluorene*	0.002		0.001	mg/L	0.96	3120433	MS	08-Dec-23	8270C	
Phenanthrene*	0.003		0.001	mg/L	0.96	3120433	MS	08-Dec-23	8270C	
Anthracene*	<0.001		0.001	mg/L	0.96	3120433	MS	08-Dec-23	8270C	
Carbazole*	<0.001		0.001	mg/L	0.96	3120433	MS	08-Dec-23	8270C	
Fluoranthene*	<0.001		0.001	mg/L	0.96	3120433	MS	08-Dec-23	8270C	
Pyrene*	<0.001		0.001	mg/L	0.96	3120433	MS	08-Dec-23	8270C	
Benzo[a]anthracene*	<0.001		0.001	mg/L	0.96	3120433	MS	08-Dec-23	8270C	

Cardinal Laboratories

*=Accredited Analyte

PLEASE NOTE: Liability and Damages. Cardinal's liability and client's exclusive remedy for any claim arising, whether based in contract or tort, shall be limited to the amount paid by client for analyses. All claims, including those for negligence or any other cause whatsoever shall be deemed waived unless made in writing and received by Cardinal within thirty (30) days after completion of the applicable service. In no event shall Cardinal be liable for incidental or consequential damage including, without limitation, business interruptions, loss of use, or loss of profits incurred by client, its subsidiaries, affiliates or successors arising out of or related to the performance of the services hereunder by Cardinal, regardless of whether such claim is based upon any of the above stated reasons or otherwise. Results relate only to the samples identified above. This report shall not be reproduced except in full with written approval of Cardinal Laboratories.

Celey D. Keene, Lab Director/Quality Manager



PHONE (575) 393-2326 ° 101 E. MARLAND ° HOBBS, NM 88240

Analytical Results For:

AXIS ENVIROMENTAL
121 INDIAN RIDGE RD
BELTON TX, 76513

Project: G STATE 4
Project Number: NONE GIVEN
Project Manager: BRAD FREEMAN
Fax To:

Reported:
12-Dec-23 09:56

MW 1**H236530-02 (Water)**

Analyte	Result	MDL	Reporting Limit	Units	Dilution	Batch	Analyst	Analyzed	Method	Notes
---------	--------	-----	-----------------	-------	----------	-------	---------	----------	--------	-------

Cardinal Laboratories**Polynuclear Aromatic Compounds by GC/MS**

Chrysene*	<0.001		0.001	mg/L	0.96	3120433	MS	08-Dec-23	8270C	
Benzo[b]flouranthene*	<0.001		0.001	mg/L	0.96	3120433	MS	08-Dec-23	8270C	
Benzo[k]flouranthene*	<0.001		0.001	mg/L	0.96	3120433	MS	08-Dec-23	8270C	
Benzo[a]pyrene*	<0.0002		0.0002	mg/L	0.96	3120433	MS	08-Dec-23	8270C	
Indeno[1,2,3-cd]pyrene*	<0.001		0.001	mg/L	0.96	3120433	MS	08-Dec-23	8270C	
Dibenz[a,h]anthracene*	<0.001		0.001	mg/L	0.96	3120433	MS	08-Dec-23	8270C	
Benzo[g,h,i]perylene*	<0.001		0.001	mg/L	0.96	3120433	MS	08-Dec-23	8270C	
Surrogate: Nitrobenzene-d5			32.3 %	5.17-184		3120433	MS	08-Dec-23	8270C	
Surrogate: 2-Fluorobiphenyl			34.2 %	7.39-192		3120433	MS	08-Dec-23	8270C	
Surrogate: Terphenyl-d14			37.7 %	27.5-139		3120433	MS	08-Dec-23	8270C	

Cardinal Laboratories

*=Accredited Analyte

PLEASE NOTE: Liability and Damages. Cardinal's liability and client's exclusive remedy for any claim arising, whether based in contract or tort, shall be limited to the amount paid by client for analyses. All claims, including those for negligence or any other cause whatsoever shall be deemed waived unless made in writing and received by Cardinal within thirty (30) days after completion of the applicable service. In no event shall Cardinal be liable for incidental or consequential damage including, without limitation, business interruptions, loss of use, or loss of profits incurred by client, its subsidiaries, affiliates or successors arising out of or related to the performance of the services hereunder by Cardinal, regardless of whether such claim is based upon any of the above stated reasons or otherwise. Results relate only to the samples identified above. This report shall not be reproduced except in full with written approval of Cardinal Laboratories.

Celey D. Keene, Lab Director/Quality Manager



PHONE (575) 393-2326 ° 101 E. MARLAND ° HOBBS, NM 88240

Analytical Results For:

AXIS ENVIROMENTAL
121 INDIAN RIDGE RD
BELTON TX, 76513

Project: G STATE 4
Project Number: NONE GIVEN
Project Manager: BRAD FREEMAN
Fax To:

Reported:
12-Dec-23 09:56

MW 2**H236530-03 (Water)**

Analyte	Result	MDL	Reporting Limit	Units	Dilution	Batch	Analyst	Analyzed	Method	Notes
---------	--------	-----	-----------------	-------	----------	-------	---------	----------	--------	-------

Cardinal Laboratories**Inorganic Compounds**

Chloride*	460		4.00	mg/L	1	3120109	AC	06-Dec-23	4500-Cl-B	
-----------	-----	--	------	------	---	---------	----	-----------	-----------	--

Volatile Organic Compounds by EPA Method 8021

Benzene*	0.009		0.001	mg/L	1	3120504	JH	05-Dec-23	8021B	
Toluene*	0.003		0.001	mg/L	1	3120504	JH	05-Dec-23	8021B	GC-NC1
Ethylbenzene*	0.007		0.001	mg/L	1	3120504	JH	05-Dec-23	8021B	
Total Xylenes*	0.027		0.003	mg/L	1	3120504	JH	05-Dec-23	8021B	
Total BTEX	0.046		0.006	mg/L	1	3120504	JH	05-Dec-23	8021B	GC-NC1

Surrogate: 4-Bromofluorobenzene (PID) 92.2 % 77.5-125 3120504 JH 05-Dec-23 8021B

Petroleum Hydrocarbons by GC FID

GRO C6-C10*	1.93		1.00	mg/L	0.1	3120602	MS	08-Dec-23	8015B	
DRO >C10-C28*	7.70		1.00	mg/L	0.1	3120602	MS	08-Dec-23	8015B	
EXT DRO >C28-C36	<1.00		1.00	mg/L	0.1	3120602	MS	08-Dec-23	8015B	

Surrogate: 1-Chlorooctane 111 % 48.8-131 3120602 MS 08-Dec-23 8015B

Surrogate: 1-Chlorooctadecane 136 % 60.1-141 3120602 MS 08-Dec-23 8015B

Polynuclear Aromatic Compounds by GC/MS

Naphthalene*	0.009		0.001	mg/L	0.96	3120433	MS	08-Dec-23	8270C	
2-Methylnaphthalene*	0.018		0.001	mg/L	0.96	3120433	MS	08-Dec-23	8270C	
1-Methylnaphthalene	0.021		0.0005	mg/L	0.96	3120433	MS	08-Dec-23	8270C	
Acenaphthylene*	<0.001		0.001	mg/L	0.96	3120433	MS	08-Dec-23	8270C	
Acenaphthene*	<0.001		0.001	mg/L	0.96	3120433	MS	08-Dec-23	8270C	
Fluorene*	0.003		0.001	mg/L	0.96	3120433	MS	08-Dec-23	8270C	
Phenanthrene*	0.004		0.001	mg/L	0.96	3120433	MS	08-Dec-23	8270C	
Anthracene*	<0.001		0.001	mg/L	0.96	3120433	MS	08-Dec-23	8270C	
Carbazole*	0.001		0.001	mg/L	0.96	3120433	MS	08-Dec-23	8270C	
Fluoranthene*	<0.001		0.001	mg/L	0.96	3120433	MS	08-Dec-23	8270C	
Pyrene*	<0.001		0.001	mg/L	0.96	3120433	MS	08-Dec-23	8270C	
Benzo[a]anthracene*	<0.001		0.001	mg/L	0.96	3120433	MS	08-Dec-23	8270C	

Cardinal Laboratories

*=Accredited Analyte

PLEASE NOTE: Liability and Damages. Cardinal's liability and client's exclusive remedy for any claim arising, whether based in contract or tort, shall be limited to the amount paid by client for analyses. All claims, including those for negligence or any other cause whatsoever shall be deemed waived unless made in writing and received by Cardinal within thirty (30) days after completion of the applicable service. In no event shall Cardinal be liable for incidental or consequential damage including, without limitation, business interruptions, loss of use, or loss of profits incurred by client, its subsidiaries, affiliates or successors arising out of or related to the performance of the services hereunder by Cardinal, regardless of whether such claim is based upon any of the above stated reasons or otherwise. Results relate only to the samples identified above. This report shall not be reproduced except in full with written approval of Cardinal Laboratories.

Celey D. Keene, Lab Director/Quality Manager



PHONE (575) 393-2326 ° 101 E. MARLAND ° HOBBS, NM 88240

Analytical Results For:

AXIS ENVIROMENTAL
121 INDIAN RIDGE RD
BELTON TX, 76513

Project: G STATE 4
Project Number: NONE GIVEN
Project Manager: BRAD FREEMAN
Fax To:

Reported:
12-Dec-23 09:56

MW 2**H236530-03 (Water)**

Analyte	Result	MDL	Reporting Limit	Units	Dilution	Batch	Analyst	Analyzed	Method	Notes
---------	--------	-----	-----------------	-------	----------	-------	---------	----------	--------	-------

Cardinal Laboratories**Polynuclear Aromatic Compounds by GC/MS**

Chrysene*	<0.001		0.001	mg/L	0.96	3120433	MS	08-Dec-23	8270C	
Benzo[b]flouranthene*	<0.001		0.001	mg/L	0.96	3120433	MS	08-Dec-23	8270C	
Benzo[k]flouranthene*	<0.001		0.001	mg/L	0.96	3120433	MS	08-Dec-23	8270C	
Benzo[a]pyrene*	<0.0002		0.0002	mg/L	0.96	3120433	MS	08-Dec-23	8270C	
Indeno[1,2,3-cd]pyrene*	<0.001		0.001	mg/L	0.96	3120433	MS	08-Dec-23	8270C	
Dibenz[a,h]anthracene*	<0.001		0.001	mg/L	0.96	3120433	MS	08-Dec-23	8270C	
Benzo[g,h,i]perylene*	<0.001		0.001	mg/L	0.96	3120433	MS	08-Dec-23	8270C	
Surrogate: Nitrobenzene-d5			52.6 %	5.17-184		3120433	MS	08-Dec-23	8270C	
Surrogate: 2-Fluorobiphenyl			48.4 %	7.39-192		3120433	MS	08-Dec-23	8270C	
Surrogate: Terphenyl-d14			48.6 %	27.5-139		3120433	MS	08-Dec-23	8270C	

Cardinal Laboratories

*=Accredited Analyte

PLEASE NOTE: Liability and Damages. Cardinal's liability and client's exclusive remedy for any claim arising, whether based in contract or tort, shall be limited to the amount paid by client for analyses. All claims, including those for negligence or any other cause whatsoever shall be deemed waived unless made in writing and received by Cardinal within thirty (30) days after completion of the applicable service. In no event shall Cardinal be liable for incidental or consequential damage including, without limitation, business interruptions, loss of use, or loss of profits incurred by client, its subsidiaries, affiliates or successors arising out of or related to the performance of the services hereunder by Cardinal, regardless of whether such claim is based upon any of the above stated reasons or otherwise. Results relate only to the samples identified above. This report shall not be reproduced except in full with written approval of Cardinal Laboratories.

Celey D. Keene, Lab Director/Quality Manager



PHONE (575) 393-2326 ° 101 E. MARLAND ° HOBBS, NM 88240

Analytical Results For:

AXIS ENVIROMENTAL
121 INDIAN RIDGE RD
BELTON TX, 76513

Project: G STATE 4
Project Number: NONE GIVEN
Project Manager: BRAD FREEMAN
Fax To:

Reported:
12-Dec-23 09:56

MW 3**H236530-04 (Water)**

Analyte	Result	MDL	Reporting Limit	Units	Dilution	Batch	Analyst	Analyzed	Method	Notes
---------	--------	-----	-----------------	-------	----------	-------	---------	----------	--------	-------

Cardinal Laboratories**Inorganic Compounds**

Chloride*	332		4.00	mg/L	1	3120109	AC	06-Dec-23	4500-Cl-B	
------------------	------------	--	------	------	---	---------	----	-----------	-----------	--

Volatile Organic Compounds by EPA Method 8021

Benzene*	0.005		0.001	mg/L	1	3120504	JH	05-Dec-23	8021B	
Toluene*	<0.001		0.001	mg/L	1	3120504	JH	05-Dec-23	8021B	
Ethylbenzene*	<0.001		0.001	mg/L	1	3120504	JH	05-Dec-23	8021B	
Total Xylenes*	0.005		0.003	mg/L	1	3120504	JH	05-Dec-23	8021B	
Total BTEX	0.010		0.006	mg/L	1	3120504	JH	05-Dec-23	8021B	

Surrogate: 4-Bromofluorobenzene (PID) 102 % 77.5-125 3120504 JH 05-Dec-23 8021B

Petroleum Hydrocarbons by GC FID**S-04**

GRO C6-C10*	4.46		1.00	mg/L	0.1	3120602	MS	08-Dec-23	8015B	
DRO >C10-C28*	44.9		1.00	mg/L	0.1	3120602	MS	08-Dec-23	8015B	
EXT DRO >C28-C36	9.28		1.00	mg/L	0.1	3120602	MS	08-Dec-23	8015B	

Surrogate: 1-Chlorooctane 120 % 48.8-131 3120602 MS 08-Dec-23 8015B

Surrogate: 1-Chlorooctadecane 158 % 60.1-141 3120602 MS 08-Dec-23 8015B

Polynuclear Aromatic Compounds by GC/MS

Naphthalene*	0.003		0.001	mg/L	0.96	3120433	MS	08-Dec-23	8270C	
2-Methylnaphthalene*	0.012		0.001	mg/L	0.96	3120433	MS	08-Dec-23	8270C	
1-Methylnaphthalene	0.015		0.0005	mg/L	0.96	3120433	MS	08-Dec-23	8270C	
Acenaphthylene*	<0.001		0.001	mg/L	0.96	3120433	MS	08-Dec-23	8270C	
Acenaphthene*	<0.001		0.001	mg/L	0.96	3120433	MS	08-Dec-23	8270C	
Fluorene*	0.007		0.001	mg/L	0.96	3120433	MS	08-Dec-23	8270C	
Phenanthrene*	0.016		0.001	mg/L	0.96	3120433	MS	08-Dec-23	8270C	
Anthracene*	<0.001		0.001	mg/L	0.96	3120433	MS	08-Dec-23	8270C	
Carbazole*	<0.001		0.001	mg/L	0.96	3120433	MS	08-Dec-23	8270C	
Fluoranthene*	<0.001		0.001	mg/L	0.96	3120433	MS	08-Dec-23	8270C	
Pyrene*	<0.001		0.001	mg/L	0.96	3120433	MS	08-Dec-23	8270C	
Benzo[a]anthracene*	<0.001		0.001	mg/L	0.96	3120433	MS	08-Dec-23	8270C	

Cardinal Laboratories

*=Accredited Analyte

PLEASE NOTE: Liability and Damages. Cardinal's liability and client's exclusive remedy for any claim arising, whether based in contract or tort, shall be limited to the amount paid by client for analyses. All claims, including those for negligence or any other cause whatsoever shall be deemed waived unless made in writing and received by Cardinal within thirty (30) days after completion of the applicable service. In no event shall Cardinal be liable for incidental or consequential damage including, without limitation, business interruptions, loss of use, or loss of profits incurred by client, its subsidiaries, affiliates or successors arising out of or related to the performance of the services hereunder by Cardinal, regardless of whether such claim is based upon any of the above stated reasons or otherwise. Results relate only to the samples identified above. This report shall not be reproduced except in full with written approval of Cardinal Laboratories.

Celey D. Keene, Lab Director/Quality Manager



PHONE (575) 393-2326 ° 101 E. MARLAND ° HOBBS, NM 88240

Analytical Results For:

AXIS ENVIROMENTAL
121 INDIAN RIDGE RD
BELTON TX, 76513

Project: G STATE 4
Project Number: NONE GIVEN
Project Manager: BRAD FREEMAN
Fax To:

Reported:
12-Dec-23 09:56

MW 3**H236530-04 (Water)**

Analyte	Result	MDL	Reporting Limit	Units	Dilution	Batch	Analyst	Analyzed	Method	Notes
---------	--------	-----	-----------------	-------	----------	-------	---------	----------	--------	-------

Cardinal Laboratories**Polynuclear Aromatic Compounds by GC/MS**

Chrysene*	0.002		0.001	mg/L	0.96	3120433	MS	08-Dec-23	8270C	
Benzo[b]flouranthene*	<0.001		0.001	mg/L	0.96	3120433	MS	08-Dec-23	8270C	
Benzo[k]flouranthene*	<0.001		0.001	mg/L	0.96	3120433	MS	08-Dec-23	8270C	
Benzo[a]pyrene*	<0.0002		0.0002	mg/L	0.96	3120433	MS	08-Dec-23	8270C	
Indeno[1,2,3-cd]pyrene*	<0.001		0.001	mg/L	0.96	3120433	MS	08-Dec-23	8270C	
Dibenz[a,h]anthracene*	<0.001		0.001	mg/L	0.96	3120433	MS	08-Dec-23	8270C	
Benzo[g,h,i]perylene*	<0.001		0.001	mg/L	0.96	3120433	MS	08-Dec-23	8270C	
Surrogate: Nitrobenzene-d5			73.1 %	5.17-184		3120433	MS	08-Dec-23	8270C	
Surrogate: 2-Fluorobiphenyl			56.0 %	7.39-192		3120433	MS	08-Dec-23	8270C	
Surrogate: Terphenyl-d14			71.4 %	27.5-139		3120433	MS	08-Dec-23	8270C	

Cardinal Laboratories

*=Accredited Analyte

PLEASE NOTE: Liability and Damages. Cardinal's liability and client's exclusive remedy for any claim arising, whether based in contract or tort, shall be limited to the amount paid by client for analyses. All claims, including those for negligence or any other cause whatsoever shall be deemed waived unless made in writing and received by Cardinal within thirty (30) days after completion of the applicable service. In no event shall Cardinal be liable for incidental or consequential damage including, without limitation, business interruptions, loss of use, or loss of profits incurred by client, its subsidiaries, affiliates or successors arising out of or related to the performance of the services hereunder by Cardinal, regardless of whether such claim is based upon any of the above stated reasons or otherwise. Results relate only to the samples identified above. This report shall not be reproduced except in full with written approval of Cardinal Laboratories.

Celey D. Keene, Lab Director/Quality Manager



PHONE (575) 393-2326 ° 101 E. MARLAND ° HOBBS, NM 88240

Analytical Results For:

AXIS ENVIROMENTAL
121 INDIAN RIDGE RD
BELTON TX, 76513

Project: G STATE 4
Project Number: NONE GIVEN
Project Manager: BRAD FREEMAN
Fax To:

Reported:
12-Dec-23 09:56

MW 4**H236530-05 (Water)**

Analyte	Result	MDL	Reporting Limit	Units	Dilution	Batch	Analyst	Analyzed	Method	Notes
---------	--------	-----	-----------------	-------	----------	-------	---------	----------	--------	-------

Cardinal Laboratories**Inorganic Compounds**

Chloride*	132		4.00	mg/L	1	3120109	AC	06-Dec-23	4500-Cl-B	
-----------	-----	--	------	------	---	---------	----	-----------	-----------	--

Volatile Organic Compounds by EPA Method 8021

Benzene*	0.008		0.001	mg/L	1	3120504	JH	05-Dec-23	8021B	
Toluene*	0.002		0.001	mg/L	1	3120504	JH	05-Dec-23	8021B	GC-NC1
Ethylbenzene*	0.002		0.001	mg/L	1	3120504	JH	05-Dec-23	8021B	
Total Xylenes*	0.006		0.003	mg/L	1	3120504	JH	05-Dec-23	8021B	
Total BTEX	0.018		0.006	mg/L	1	3120504	JH	05-Dec-23	8021B	GC-NC1

Surrogate: 4-Bromofluorobenzene (PID) 99.7 % 77.5-125 3120504 JH 05-Dec-23 8021B

Petroleum Hydrocarbons by GC FID

GRO C6-C10*	<1.00		1.00	mg/L	0.1	3120602	MS	08-Dec-23	8015B	
DRO >C10-C28*	<1.00		1.00	mg/L	0.1	3120602	MS	08-Dec-23	8015B	
EXT DRO >C28-C36	<1.00		1.00	mg/L	0.1	3120602	MS	08-Dec-23	8015B	

Surrogate: 1-Chlorooctane 112 % 48.8-131 3120602 MS 08-Dec-23 8015B

Surrogate: 1-Chlorooctadecane 133 % 60.1-141 3120602 MS 08-Dec-23 8015B

Polynuclear Aromatic Compounds by GC/MS

Naphthalene*	<0.001		0.001	mg/L	0.96	3120433	MS	08-Dec-23	8270C	
2-Methylnaphthalene*	<0.001		0.001	mg/L	0.96	3120433	MS	08-Dec-23	8270C	
1-Methylnaphthalene	0.002		0.0005	mg/L	0.96	3120433	MS	08-Dec-23	8270C	
Acenaphthylene*	<0.001		0.001	mg/L	0.96	3120433	MS	08-Dec-23	8270C	
Acenaphthene*	<0.001		0.001	mg/L	0.96	3120433	MS	08-Dec-23	8270C	
Fluorene*	<0.001		0.001	mg/L	0.96	3120433	MS	08-Dec-23	8270C	
Phenanthrene*	<0.001		0.001	mg/L	0.96	3120433	MS	08-Dec-23	8270C	
Anthracene*	<0.001		0.001	mg/L	0.96	3120433	MS	08-Dec-23	8270C	
Carbazole*	<0.001		0.001	mg/L	0.96	3120433	MS	08-Dec-23	8270C	
Fluoranthene*	<0.001		0.001	mg/L	0.96	3120433	MS	08-Dec-23	8270C	
Pyrene*	<0.001		0.001	mg/L	0.96	3120433	MS	08-Dec-23	8270C	
Benzo[a]anthracene*	<0.001		0.001	mg/L	0.96	3120433	MS	08-Dec-23	8270C	

Cardinal Laboratories

*=Accredited Analyte

PLEASE NOTE: Liability and Damages. Cardinal's liability and client's exclusive remedy for any claim arising, whether based in contract or tort, shall be limited to the amount paid by client for analyses. All claims, including those for negligence or any other cause whatsoever shall be deemed waived unless made in writing and received by Cardinal within thirty (30) days after completion of the applicable service. In no event shall Cardinal be liable for incidental or consequential damage including, without limitation, business interruptions, loss of use, or loss of profits incurred by client, its subsidiaries, affiliates or successors arising out of or related to the performance of the services hereunder by Cardinal, regardless of whether such claim is based upon any of the above stated reasons or otherwise. Results relate only to the samples identified above. This report shall not be reproduced except in full with written approval of Cardinal Laboratories.

Celey D. Keene, Lab Director/Quality Manager



PHONE (575) 393-2326 ° 101 E. MARLAND ° HOBBS, NM 88240

Analytical Results For:

AXIS ENVIROMENTAL
121 INDIAN RIDGE RD
BELTON TX, 76513

Project: G STATE 4
Project Number: NONE GIVEN
Project Manager: BRAD FREEMAN
Fax To:

Reported:
12-Dec-23 09:56

MW 4**H236530-05 (Water)**

Analyte	Result	MDL	Reporting Limit	Units	Dilution	Batch	Analyst	Analyzed	Method	Notes
---------	--------	-----	-----------------	-------	----------	-------	---------	----------	--------	-------

Cardinal Laboratories**Polynuclear Aromatic Compounds by GC/MS**

Chrysene*	<0.001		0.001	mg/L	0.96	3120433	MS	08-Dec-23	8270C	
Benzo[b]flouranthene*	<0.001		0.001	mg/L	0.96	3120433	MS	08-Dec-23	8270C	
Benzo[k]flouranthene*	<0.001		0.001	mg/L	0.96	3120433	MS	08-Dec-23	8270C	
Benzo[a]pyrene*	<0.0002		0.0002	mg/L	0.96	3120433	MS	08-Dec-23	8270C	
Indeno[1,2,3-cd]pyrene*	<0.001		0.001	mg/L	0.96	3120433	MS	08-Dec-23	8270C	
Dibenz[a,h]anthracene*	<0.001		0.001	mg/L	0.96	3120433	MS	08-Dec-23	8270C	
Benzo[g,h,i]perylene*	<0.001		0.001	mg/L	0.96	3120433	MS	08-Dec-23	8270C	
Surrogate: Nitrobenzene-d5			55.3 %	5.17-184		3120433	MS	08-Dec-23	8270C	
Surrogate: 2-Fluorobiphenyl			53.8 %	7.39-192		3120433	MS	08-Dec-23	8270C	
Surrogate: Terphenyl-d14			52.9 %	27.5-139		3120433	MS	08-Dec-23	8270C	

Cardinal Laboratories

*=Accredited Analyte

PLEASE NOTE: Liability and Damages. Cardinal's liability and client's exclusive remedy for any claim arising, whether based in contract or tort, shall be limited to the amount paid by client for analyses. All claims, including those for negligence or any other cause whatsoever shall be deemed waived unless made in writing and received by Cardinal within thirty (30) days after completion of the applicable service. In no event shall Cardinal be liable for incidental or consequential damage including, without limitation, business interruptions, loss of use, or loss of profits incurred by client, its subsidiaries, affiliates or successors arising out of or related to the performance of the services hereunder by Cardinal, regardless of whether such claim is based upon any of the above stated reasons or otherwise. Results relate only to the samples identified above. This report shall not be reproduced except in full with written approval of Cardinal Laboratories.

Celey D. Keene, Lab Director/Quality Manager



PHONE (575) 393-2326 ° 101 E. MARLAND ° HOBBS, NM 88240

Analytical Results For:

AXIS ENVIROMENTAL
121 INDIAN RIDGE RD
BELTON TX, 76513

Project: G STATE 4
Project Number: NONE GIVEN
Project Manager: BRAD FREEMAN
Fax To:

Reported:
12-Dec-23 09:56

MW 6
H236530-06 (Water)

Analyte	Result	MDL	Reporting Limit	Units	Dilution	Batch	Analyst	Analyzed	Method	Notes
---------	--------	-----	-----------------	-------	----------	-------	---------	----------	--------	-------

Cardinal Laboratories**Inorganic Compounds**

Chloride*	96.0		4.00	mg/L	1	3120109	AC	06-Dec-23	4500-Cl-B	
-----------	------	--	------	------	---	---------	----	-----------	-----------	--

Volatile Organic Compounds by EPA Method 8021

Benzene*	<0.001		0.001	mg/L	1	3120504	JH	05-Dec-23	8021B	
Toluene*	<0.001		0.001	mg/L	1	3120504	JH	05-Dec-23	8021B	
Ethylbenzene*	<0.001		0.001	mg/L	1	3120504	JH	05-Dec-23	8021B	
Total Xylenes*	<0.003		0.003	mg/L	1	3120504	JH	05-Dec-23	8021B	
Total BTEX	<0.006		0.006	mg/L	1	3120504	JH	05-Dec-23	8021B	

Surrogate: 4-Bromofluorobenzene (PID)	94.9 %		77.5-125			3120504	JH	05-Dec-23	8021B	
---------------------------------------	--------	--	----------	--	--	---------	----	-----------	-------	--

Petroleum Hydrocarbons by GC FID

GRO C6-C10*	<1.00		1.00	mg/L	0.1	3120602	MS	08-Dec-23	8015B	
DRO >C10-C28*	<1.00		1.00	mg/L	0.1	3120602	MS	08-Dec-23	8015B	
EXT DRO >C28-C36	<1.00		1.00	mg/L	0.1	3120602	MS	08-Dec-23	8015B	

Surrogate: 1-Chlorooctane	111 %		48.8-131			3120602	MS	08-Dec-23	8015B	
---------------------------	-------	--	----------	--	--	---------	----	-----------	-------	--

Surrogate: 1-Chlorooctadecane	130 %		60.1-141			3120602	MS	08-Dec-23	8015B	
-------------------------------	-------	--	----------	--	--	---------	----	-----------	-------	--

Polynuclear Aromatic Compounds by GC/MS

Naphthalene*	<0.001		0.001	mg/L	0.98	3120433	MS	09-Dec-23	8270C	
2-Methylnaphthalene*	<0.001		0.001	mg/L	0.98	3120433	MS	09-Dec-23	8270C	
1-Methylnaphthalene	<0.0005		0.0005	mg/L	0.98	3120433	MS	09-Dec-23	8270C	
Acenaphthylene*	<0.001		0.001	mg/L	0.98	3120433	MS	09-Dec-23	8270C	
Acenaphthene*	<0.001		0.001	mg/L	0.98	3120433	MS	09-Dec-23	8270C	
Fluorene*	<0.001		0.001	mg/L	0.98	3120433	MS	09-Dec-23	8270C	
Phenanthrene*	<0.001		0.001	mg/L	0.98	3120433	MS	09-Dec-23	8270C	
Anthracene*	<0.001		0.001	mg/L	0.98	3120433	MS	09-Dec-23	8270C	
Carbazole*	<0.001		0.001	mg/L	0.98	3120433	MS	09-Dec-23	8270C	
Fluoranthene*	<0.001		0.001	mg/L	0.98	3120433	MS	09-Dec-23	8270C	
Pyrene*	<0.001		0.001	mg/L	0.98	3120433	MS	09-Dec-23	8270C	
Benzo[a]anthracene*	<0.001		0.001	mg/L	0.98	3120433	MS	09-Dec-23	8270C	

Cardinal Laboratories

*=Accredited Analyte

PLEASE NOTE: Liability and Damages. Cardinal's liability and client's exclusive remedy for any claim arising, whether based in contract or tort, shall be limited to the amount paid by client for analyses. All claims, including those for negligence or any other cause whatsoever shall be deemed waived unless made in writing and received by Cardinal within thirty (30) days after completion of the applicable service. In no event shall Cardinal be liable for incidental or consequential damage including, without limitation, business interruptions, loss of use, or loss of profits incurred by client, its subsidiaries, affiliates or successors arising out of or related to the performance of the services hereunder by Cardinal, regardless of whether such claim is based upon any of the above stated reasons or otherwise. Results relate only to the samples identified above. This report shall not be reproduced except in full with written approval of Cardinal Laboratories.

Celey D. Keene, Lab Director/Quality Manager



PHONE (575) 393-2326 ° 101 E. MARLAND ° HOBBS, NM 88240

Analytical Results For:

AXIS ENVIROMENTAL
121 INDIAN RIDGE RD
BELTON TX, 76513

Project: G STATE 4
Project Number: NONE GIVEN
Project Manager: BRAD FREEMAN
Fax To:

Reported:
12-Dec-23 09:56

MW 6**H236530-06 (Water)**

Analyte	Result	MDL	Reporting Limit	Units	Dilution	Batch	Analyst	Analyzed	Method	Notes
---------	--------	-----	-----------------	-------	----------	-------	---------	----------	--------	-------

Cardinal Laboratories**Polynuclear Aromatic Compounds by GC/MS**

Chrysene*	<0.001		0.001	mg/L	0.98	3120433	MS	09-Dec-23	8270C	
Benzo[b]flouranthene*	<0.001		0.001	mg/L	0.98	3120433	MS	09-Dec-23	8270C	
Benzo[k]flouranthene*	<0.001		0.001	mg/L	0.98	3120433	MS	09-Dec-23	8270C	
Benzo[a]pyrene*	<0.0002		0.0002	mg/L	0.98	3120433	MS	09-Dec-23	8270C	
Indeno[1,2,3-cd]pyrene*	<0.001		0.001	mg/L	0.98	3120433	MS	09-Dec-23	8270C	
Dibenz[a,h]anthracene*	<0.001		0.001	mg/L	0.98	3120433	MS	09-Dec-23	8270C	
Benzo[g,h,i]perylene*	<0.001		0.001	mg/L	0.98	3120433	MS	09-Dec-23	8270C	
Surrogate: Nitrobenzene-d5			66.7 %	5.17-184		3120433	MS	09-Dec-23	8270C	
Surrogate: 2-Fluorobiphenyl			63.0 %	7.39-192		3120433	MS	09-Dec-23	8270C	
Surrogate: Terphenyl-d14			64.1 %	27.5-139		3120433	MS	09-Dec-23	8270C	

Cardinal Laboratories

*=Accredited Analyte

PLEASE NOTE: Liability and Damages. Cardinal's liability and client's exclusive remedy for any claim arising, whether based in contract or tort, shall be limited to the amount paid by client for analyses. All claims, including those for negligence or any other cause whatsoever shall be deemed waived unless made in writing and received by Cardinal within thirty (30) days after completion of the applicable service. In no event shall Cardinal be liable for incidental or consequential damage including, without limitation, business interruptions, loss of use, or loss of profits incurred by client, its subsidiaries, affiliates or successors arising out of or related to the performance of the services hereunder by Cardinal, regardless of whether such claim is based upon any of the above stated reasons or otherwise. Results relate only to the samples identified above. This report shall not be reproduced except in full with written approval of Cardinal Laboratories.

Celey D. Keene, Lab Director/Quality Manager



PHONE (575) 393-2326 ° 101 E. MARLAND ° HOBBS, NM 88240

Analytical Results For:

AXIS ENVIROMENTAL
121 INDIAN RIDGE RD
BELTON TX, 76513

Project: G STATE 4
Project Number: NONE GIVEN
Project Manager: BRAD FREEMAN
Fax To:

Reported:
12-Dec-23 09:56

MW 7**H236530-07 (Water)**

Analyte	Result	MDL	Reporting Limit	Units	Dilution	Batch	Analyst	Analyzed	Method	Notes
---------	--------	-----	-----------------	-------	----------	-------	---------	----------	--------	-------

Cardinal Laboratories**Inorganic Compounds**

Chloride*	328		4.00	mg/L	1	3120109	AC	06-Dec-23	4500-Cl-B	
------------------	------------	--	------	------	---	---------	----	-----------	-----------	--

Volatile Organic Compounds by EPA Method 8021

Benzene*	<0.001		0.001	mg/L	1	3120504	JH	05-Dec-23	8021B	
Toluene*	<0.001		0.001	mg/L	1	3120504	JH	05-Dec-23	8021B	
Ethylbenzene*	<0.001		0.001	mg/L	1	3120504	JH	05-Dec-23	8021B	
Total Xylenes*	<0.003		0.003	mg/L	1	3120504	JH	05-Dec-23	8021B	
Total BTEX	<0.006		0.006	mg/L	1	3120504	JH	05-Dec-23	8021B	

Surrogate: 4-Bromofluorobenzene (PID)	94.4 %		77.5-125			3120504	JH	05-Dec-23	8021B	
---------------------------------------	--------	--	----------	--	--	---------	----	-----------	-------	--

Petroleum Hydrocarbons by GC FID

GRO C6-C10*	<1.00		1.00	mg/L	0.1	3120602	MS	08-Dec-23	8015B	
DRO >C10-C28*	<1.00		1.00	mg/L	0.1	3120602	MS	08-Dec-23	8015B	
EXT DRO >C28-C36	<1.00		1.00	mg/L	0.1	3120602	MS	08-Dec-23	8015B	

Surrogate: 1-Chlorooctane	109 %		48.8-131			3120602	MS	08-Dec-23	8015B	
---------------------------	-------	--	----------	--	--	---------	----	-----------	-------	--

Surrogate: 1-Chlorooctadecane	129 %		60.1-141			3120602	MS	08-Dec-23	8015B	
-------------------------------	-------	--	----------	--	--	---------	----	-----------	-------	--

Polynuclear Aromatic Compounds by GC/MS

Naphthalene*	<0.001		0.001	mg/L	0.98	3120433	MS	09-Dec-23	8270C	
2-Methylnaphthalene*	<0.001		0.001	mg/L	0.98	3120433	MS	09-Dec-23	8270C	
1-Methylnaphthalene	<0.0005		0.0005	mg/L	0.98	3120433	MS	09-Dec-23	8270C	
Acenaphthylene*	<0.001		0.001	mg/L	0.98	3120433	MS	09-Dec-23	8270C	
Acenaphthene*	<0.001		0.001	mg/L	0.98	3120433	MS	09-Dec-23	8270C	
Fluorene*	<0.001		0.001	mg/L	0.98	3120433	MS	09-Dec-23	8270C	
Phenanthrene*	<0.001		0.001	mg/L	0.98	3120433	MS	09-Dec-23	8270C	
Anthracene*	<0.001		0.001	mg/L	0.98	3120433	MS	09-Dec-23	8270C	
Carbazole*	<0.001		0.001	mg/L	0.98	3120433	MS	09-Dec-23	8270C	
Fluoranthene*	<0.001		0.001	mg/L	0.98	3120433	MS	09-Dec-23	8270C	
Pyrene*	<0.001		0.001	mg/L	0.98	3120433	MS	09-Dec-23	8270C	
Benzo[a]anthracene*	<0.001		0.001	mg/L	0.98	3120433	MS	09-Dec-23	8270C	

Cardinal Laboratories

*=Accredited Analyte

PLEASE NOTE: Liability and Damages. Cardinal's liability and client's exclusive remedy for any claim arising, whether based in contract or tort, shall be limited to the amount paid by client for analyses. All claims, including those for negligence or any other cause whatsoever shall be deemed waived unless made in writing and received by Cardinal within thirty (30) days after completion of the applicable service. In no event shall Cardinal be liable for incidental or consequential damage including, without limitation, business interruptions, loss of use, or loss of profits incurred by client, its subsidiaries, affiliates or successors arising out of or related to the performance of the services hereunder by Cardinal, regardless of whether such claim is based upon any of the above stated reasons or otherwise. Results relate only to the samples identified above. This report shall not be reproduced except in full with written approval of Cardinal Laboratories.

Celey D. Keene, Lab Director/Quality Manager



PHONE (575) 393-2326 ° 101 E. MARLAND ° HOBBS, NM 88240

Analytical Results For:

AXIS ENVIROMENTAL
121 INDIAN RIDGE RD
BELTON TX, 76513

Project: G STATE 4
Project Number: NONE GIVEN
Project Manager: BRAD FREEMAN
Fax To:

Reported:
12-Dec-23 09:56

MW 7**H236530-07 (Water)**

Analyte	Result	MDL	Reporting Limit	Units	Dilution	Batch	Analyst	Analyzed	Method	Notes
---------	--------	-----	-----------------	-------	----------	-------	---------	----------	--------	-------

Cardinal Laboratories**Polynuclear Aromatic Compounds by GC/MS**

Chrysene*	<0.001		0.001	mg/L	0.98	3120433	MS	09-Dec-23	8270C	
Benzo[b]flouranthene*	<0.001		0.001	mg/L	0.98	3120433	MS	09-Dec-23	8270C	
Benzo[k]flouranthene*	<0.001		0.001	mg/L	0.98	3120433	MS	09-Dec-23	8270C	
Benzo[a]pyrene*	<0.0002		0.0002	mg/L	0.98	3120433	MS	09-Dec-23	8270C	
Indeno[1,2,3-cd]pyrene*	<0.001		0.001	mg/L	0.98	3120433	MS	09-Dec-23	8270C	
Dibenz[a,h]anthracene*	<0.001		0.001	mg/L	0.98	3120433	MS	09-Dec-23	8270C	
Benzo[g,h,i]perylene*	<0.001		0.001	mg/L	0.98	3120433	MS	09-Dec-23	8270C	
Surrogate: Nitrobenzene-d5			37.1 %	5.17-184		3120433	MS	09-Dec-23	8270C	
Surrogate: 2-Fluorobiphenyl			35.2 %	7.39-192		3120433	MS	09-Dec-23	8270C	
Surrogate: Terphenyl-d14			37.0 %	27.5-139		3120433	MS	09-Dec-23	8270C	

Cardinal Laboratories

*=Accredited Analyte

PLEASE NOTE: Liability and Damages. Cardinal's liability and client's exclusive remedy for any claim arising, whether based in contract or tort, shall be limited to the amount paid by client for analyses. All claims, including those for negligence or any other cause whatsoever shall be deemed waived unless made in writing and received by Cardinal within thirty (30) days after completion of the applicable service. In no event shall Cardinal be liable for incidental or consequential damage including, without limitation, business interruptions, loss of use, or loss of profits incurred by client, its subsidiaries, affiliates or successors arising out of or related to the performance of the services hereunder by Cardinal, regardless of whether such claim is based upon any of the above stated reasons or otherwise. Results relate only to the samples identified above. This report shall not be reproduced except in full with written approval of Cardinal Laboratories.

Celey D. Keene, Lab Director/Quality Manager



PHONE (575) 393-2326 ° 101 E. MARLAND ° HOBBS, NM 88240

Analytical Results For:

AXIS ENVIROMENTAL
121 INDIAN RIDGE RD
BELTON TX, 76513

Project: G STATE 4
Project Number: NONE GIVEN
Project Manager: BRAD FREEMAN
Fax To:

Reported:
12-Dec-23 09:56

MW 8**H236530-08 (Water)**

Analyte	Result	MDL	Reporting Limit	Units	Dilution	Batch	Analyst	Analyzed	Method	Notes
---------	--------	-----	-----------------	-------	----------	-------	---------	----------	--------	-------

Cardinal Laboratories**Inorganic Compounds**

Chloride*	348		4.00	mg/L	1	3120109	AC	06-Dec-23	4500-Cl-B	
------------------	------------	--	------	------	---	---------	----	-----------	-----------	--

Volatile Organic Compounds by EPA Method 8021

Benzene*	<0.001	0.001	mg/L	1	3120504	JH	05-Dec-23	8021B	
Toluene*	<0.001	0.001	mg/L	1	3120504	JH	05-Dec-23	8021B	
Ethylbenzene*	<0.001	0.001	mg/L	1	3120504	JH	05-Dec-23	8021B	
Total Xylenes*	<0.003	0.003	mg/L	1	3120504	JH	05-Dec-23	8021B	
Total BTEX	<0.006	0.006	mg/L	1	3120504	JH	05-Dec-23	8021B	

Surrogate: 4-Bromofluorobenzene (PID)	94.1 %	77.5-125	3120504	JH	05-Dec-23	8021B	
---------------------------------------	--------	----------	---------	----	-----------	-------	--

Petroleum Hydrocarbons by GC FID

GRO C6-C10*	<1.00	1.00	mg/L	0.1	3120602	MS	08-Dec-23	8015B	
DRO >C10-C28*	<1.00	1.00	mg/L	0.1	3120602	MS	08-Dec-23	8015B	
EXT DRO >C28-C36	<1.00	1.00	mg/L	0.1	3120602	MS	08-Dec-23	8015B	

Surrogate: 1-Chlorooctane	109 %	48.8-131	3120602	MS	08-Dec-23	8015B	
---------------------------	-------	----------	---------	----	-----------	-------	--

Surrogate: 1-Chlorooctadecane	129 %	60.1-141	3120602	MS	08-Dec-23	8015B	
-------------------------------	-------	----------	---------	----	-----------	-------	--

Polynuclear Aromatic Compounds by GC/MS

Naphthalene*	<0.001	0.001	mg/L	0.98	3120433	MS	09-Dec-23	8270C	
2-Methylnaphthalene*	<0.001	0.001	mg/L	0.98	3120433	MS	09-Dec-23	8270C	
1-Methylnaphthalene	<0.0005	0.0005	mg/L	0.98	3120433	MS	09-Dec-23	8270C	
Acenaphthylene*	<0.001	0.001	mg/L	0.98	3120433	MS	09-Dec-23	8270C	
Acenaphthene*	<0.001	0.001	mg/L	0.98	3120433	MS	09-Dec-23	8270C	
Fluorene*	<0.001	0.001	mg/L	0.98	3120433	MS	09-Dec-23	8270C	
Phenanthrene*	<0.001	0.001	mg/L	0.98	3120433	MS	09-Dec-23	8270C	
Anthracene*	<0.001	0.001	mg/L	0.98	3120433	MS	09-Dec-23	8270C	
Carbazole*	<0.001	0.001	mg/L	0.98	3120433	MS	09-Dec-23	8270C	
Fluoranthene*	<0.001	0.001	mg/L	0.98	3120433	MS	09-Dec-23	8270C	
Pyrene*	<0.001	0.001	mg/L	0.98	3120433	MS	09-Dec-23	8270C	
Benzo[a]anthracene*	<0.001	0.001	mg/L	0.98	3120433	MS	09-Dec-23	8270C	

Cardinal Laboratories

*=Accredited Analyte

PLEASE NOTE: Liability and Damages. Cardinal's liability and client's exclusive remedy for any claim arising, whether based in contract or tort, shall be limited to the amount paid by client for analyses. All claims, including those for negligence or any other cause whatsoever shall be deemed waived unless made in writing and received by Cardinal within thirty (30) days after completion of the applicable service. In no event shall Cardinal be liable for incidental or consequential damage including, without limitation, business interruptions, loss of use, or loss of profits incurred by client, its subsidiaries, affiliates or successors arising out of or related to the performance of the services hereunder by Cardinal, regardless of whether such claim is based upon any of the above stated reasons or otherwise. Results relate only to the samples identified above. This report shall not be reproduced except in full with written approval of Cardinal Laboratories.

Celey D. Keene, Lab Director/Quality Manager



PHONE (575) 393-2326 ° 101 E. MARLAND ° HOBBS, NM 88240

Analytical Results For:

AXIS ENVIROMENTAL
121 INDIAN RIDGE RD
BELTON TX, 76513

Project: G STATE 4
Project Number: NONE GIVEN
Project Manager: BRAD FREEMAN
Fax To:

Reported:
12-Dec-23 09:56

MW 8**H236530-08 (Water)**

Analyte	Result	MDL	Reporting Limit	Units	Dilution	Batch	Analyst	Analyzed	Method	Notes
---------	--------	-----	-----------------	-------	----------	-------	---------	----------	--------	-------

Cardinal Laboratories**Polynuclear Aromatic Compounds by GC/MS**

Chrysene*	<0.001	0.001	mg/L	0.98	3120433	MS	09-Dec-23	8270C
Benzo[b]flouranthene*	<0.001	0.001	mg/L	0.98	3120433	MS	09-Dec-23	8270C
Benzo[k]flouranthene*	<0.001	0.001	mg/L	0.98	3120433	MS	09-Dec-23	8270C
Benzo[a]pyrene*	<0.0002	0.0002	mg/L	0.98	3120433	MS	09-Dec-23	8270C
Indeno[1,2,3-cd]pyrene*	<0.001	0.001	mg/L	0.98	3120433	MS	09-Dec-23	8270C
Dibenz[a,h]anthracene*	<0.001	0.001	mg/L	0.98	3120433	MS	09-Dec-23	8270C
Benzo[g,h,i]perylene*	<0.001	0.001	mg/L	0.98	3120433	MS	09-Dec-23	8270C
Surrogate: Nitrobenzene-d5		56.1 %	5.17-184		3120433	MS	09-Dec-23	8270C
Surrogate: 2-Fluorobiphenyl		57.4 %	7.39-192		3120433	MS	09-Dec-23	8270C
Surrogate: Terphenyl-d14		57.4 %	27.5-139		3120433	MS	09-Dec-23	8270C

Cardinal Laboratories

*=Accredited Analyte

PLEASE NOTE: Liability and Damages. Cardinal's liability and client's exclusive remedy for any claim arising, whether based in contract or tort, shall be limited to the amount paid by client for analyses. All claims, including those for negligence or any other cause whatsoever shall be deemed waived unless made in writing and received by Cardinal within thirty (30) days after completion of the applicable service. In no event shall Cardinal be liable for incidental or consequential damage including, without limitation, business interruptions, loss of use, or loss of profits incurred by client, its subsidiaries, affiliates or successors arising out of or related to the performance of the services hereunder by Cardinal, regardless of whether such claim is based upon any of the above stated reasons or otherwise. Results relate only to the samples identified above. This report shall not be reproduced except in full with written approval of Cardinal Laboratories.

Celey D. Keene, Lab Director/Quality Manager



PHONE (575) 393-2326 ° 101 E. MARLAND ° HOBBS, NM 88240

Analytical Results For:

AXIS ENVIROMENTAL
121 INDIAN RIDGE RD
BELTON TX, 76513

Project: G STATE 4
Project Number: NONE GIVEN
Project Manager: BRAD FREEMAN
Fax To:

Reported:
12-Dec-23 09:56

Inorganic Compounds - Quality Control**Cardinal Laboratories**

Analyte	Result	Reporting Limit	Units	Spike Level	Source Result	%REC Limits	RPD Limit	Notes
Batch 3120109 - General Prep - Wet Chem								
Blank (3120109-BLK1)				Prepared: 01-Dec-23 Analyzed: 05-Dec-23				
Chloride	ND	4.00	mg/L					
LCS (3120109-BS1)				Prepared: 01-Dec-23 Analyzed: 05-Dec-23				
Chloride	100	4.00	mg/L	100	100	80-120		
LCS Dup (3120109-BSD1)				Prepared: 01-Dec-23 Analyzed: 05-Dec-23				
Chloride	104	4.00	mg/L	100	104	80-120	3.92	20

Cardinal Laboratories

*=Accredited Analyte

PLEASE NOTE: Liability and Damages. Cardinal's liability and client's exclusive remedy for any claim arising, whether based in contract or tort, shall be limited to the amount paid by client for analyses. All claims, including those for negligence or any other cause whatsoever shall be deemed waived unless made in writing and received by Cardinal within thirty (30) days after completion of the applicable service. In no event shall Cardinal be liable for incidental or consequential damage including, without limitation, business interruptions, loss of use, or loss of profits incurred by client, its subsidiaries, affiliates or successors arising out of or related to the performance of the services hereunder by Cardinal, regardless of whether such claim is based upon any of the above stated reasons or otherwise. Results relate only to the samples identified above. This report shall not be reproduced except in full with written approval of Cardinal Laboratories.

Celey D. Keene, Lab Director/Quality Manager



PHONE (575) 393-2326 • 101 E. MARLAND • HOBBS, NM 88240

Analytical Results For:

AXIS ENVIROMENTAL
121 INDIAN RIDGE RD
BELTON TX, 76513

Project: G STATE 4
Project Number: NONE GIVEN
Project Manager: BRAD FREEMAN
Fax To:

Reported:
12-Dec-23 09:56

Volatile Organic Compounds by EPA Method 8021 - Quality Control**Cardinal Laboratories**

Analyte	Result	Reporting Limit	Units	Spike Level	Source Result	%REC	%REC Limits	RPD	RPD Limit	Notes
---------	--------	-----------------	-------	-------------	---------------	------	-------------	-----	-----------	-------

Batch 3120504 - Volatiles**Blank (3120504-BLK1)**

Prepared & Analyzed: 05-Dec-23

Benzene	ND	0.001	mg/L							
Toluene	ND	0.001	mg/L							
Ethylbenzene	ND	0.001	mg/L							
Total Xylenes	ND	0.003	mg/L							
Total BTEX	ND	0.006	mg/L							
Surrogate: 4-Bromofluorobenzene (PID)	0.0457		mg/L	0.0500		91.4	77.5-125			

LCS (3120504-BS1)

Prepared & Analyzed: 05-Dec-23

Benzene	0.020	0.001	mg/L	0.0200		101	80.8-112			
Toluene	0.020	0.001	mg/L	0.0200		102	78.7-114			
Ethylbenzene	0.020	0.001	mg/L	0.0200		102	70.9-120			
m,p-Xylene	0.040	0.002	mg/L	0.0400		99.2	76.9-119			
o-Xylene	0.020	0.001	mg/L	0.0200		98.8	71.7-120			
Total Xylenes	0.059	0.003	mg/L	0.0600		99.1	75.6-119			
Surrogate: 4-Bromofluorobenzene (PID)	0.0477		mg/L	0.0500		95.3	77.5-125			

LCS Dup (3120504-BSD1)

Prepared & Analyzed: 05-Dec-23

Benzene	0.018	0.001	mg/L	0.0200		91.9	80.8-112	9.36	8.26	QR-04
Toluene	0.019	0.001	mg/L	0.0200		96.3	78.7-114	6.01	9.03	
Ethylbenzene	0.019	0.001	mg/L	0.0200		97.5	70.9-120	4.18	11.9	
m,p-Xylene	0.038	0.002	mg/L	0.0400		95.8	76.9-119	3.48	11	
o-Xylene	0.019	0.001	mg/L	0.0200		95.9	71.7-120	3.02	15	
Total Xylenes	0.057	0.003	mg/L	0.0600		95.8	75.6-119	3.33	12.2	
Surrogate: 4-Bromofluorobenzene (PID)	0.0503		mg/L	0.0500		101	77.5-125			

Cardinal Laboratories

*=Accredited Analyte

PLEASE NOTE: Liability and Damages. Cardinal's liability and client's exclusive remedy for any claim arising, whether based in contract or tort, shall be limited to the amount paid by client for analyses. All claims, including those for negligence or any other cause whatsoever shall be deemed waived unless made in writing and received by Cardinal within thirty (30) days after completion of the applicable service. In no event shall Cardinal be liable for incidental or consequential damage including, without limitation, business interruptions, loss of use, or loss of profits incurred by client, its subsidiaries, affiliates or successors arising out of or related to the performance of the services hereunder by Cardinal, regardless of whether such claim is based upon any of the above stated reasons or otherwise. Results relate only to the samples identified above. This report shall not be reproduced except in full with written approval of Cardinal Laboratories.

Celey D. Keene, Lab Director/Quality Manager



PHONE (575) 393-2326 ° 101 E. MARLAND ° HOBBS, NM 88240

Analytical Results For:

AXIS ENVIROMENTAL
121 INDIAN RIDGE RD
BELTON TX, 76513

Project: G STATE 4
Project Number: NONE GIVEN
Project Manager: BRAD FREEMAN
Fax To:

Reported:
12-Dec-23 09:56

Petroleum Hydrocarbons by GC FID - Quality Control**Cardinal Laboratories**

Analyte	Result	Reporting Limit	Units	Spike Level	Source Result	%REC	%REC Limits	RPD	RPD Limit	Notes
---------	--------	--------------------	-------	----------------	------------------	------	----------------	-----	--------------	-------

Batch 3120602 - General Prep - Organics**Blank (3120602-BLK1)**

Prepared: 06-Dec-23 Analyzed: 08-Dec-23

GRO C6-C10	ND	1.00	mg/L							
DRO >C10-C28	ND	1.00	mg/L							
EXT DRO >C28-C36	ND	1.00	mg/L							
Surrogate: 1-Chlorooctane	5.27		mg/L	5.00		105	48.8-131			
Surrogate: 1-Chlorooctadecane	6.29		mg/L	5.00		126	60.1-141			

LCS (3120602-BS1)

Prepared: 06-Dec-23 Analyzed: 08-Dec-23

GRO C6-C10	51.4	1.00	mg/L	50.0		103	69.6-126			
DRO >C10-C28	48.8	1.00	mg/L	50.0		97.6	68.8-126			
Surrogate: 1-Chlorooctane	6.73		mg/L	5.00		135	48.8-131			S-05
Surrogate: 1-Chlorooctadecane	6.88		mg/L	5.00		138	60.1-141			

LCS Dup (3120602-BSD1)

Prepared: 06-Dec-23 Analyzed: 08-Dec-23

GRO C6-C10	50.7	1.00	mg/L	50.0		101	69.6-126	1.33	16.8	
DRO >C10-C28	49.0	1.00	mg/L	50.0		98.0	68.8-126	0.354	20.4	
Surrogate: 1-Chlorooctane	6.71		mg/L	5.00		134	48.8-131			S-05
Surrogate: 1-Chlorooctadecane	6.86		mg/L	5.00		137	60.1-141			

Cardinal Laboratories

*=Accredited Analyte

PLEASE NOTE: Liability and Damages. Cardinal's liability and client's exclusive remedy for any claim arising, whether based in contract or tort, shall be limited to the amount paid by client for analyses. All claims, including those for negligence or any other cause whatsoever shall be deemed waived unless made in writing and received by Cardinal within thirty (30) days after completion of the applicable service. In no event shall Cardinal be liable for incidental or consequential damage including, without limitation, business interruptions, loss of use, or loss of profits incurred by client, its subsidiaries, affiliates or successors arising out of or related to the performance of the services hereunder by Cardinal, regardless of whether such claim is based upon any of the above stated reasons or otherwise. Results relate only to the samples identified above. This report shall not be reproduced except in full with written approval of Cardinal Laboratories.

Celey D. Keene, Lab Director/Quality Manager



PHONE (575) 393-2326 ° 101 E. MARLAND ° HOBBS, NM 88240

Analytical Results For:

AXIS ENVIROMENTAL
121 INDIAN RIDGE RD
BELTON TX, 76513

Project: G STATE 4
Project Number: NONE GIVEN
Project Manager: BRAD FREEMAN
Fax To:

Reported:
12-Dec-23 09:56

Polynuclear Aromatic Compounds by GC/MS - Quality Control**Cardinal Laboratories**

Analyte	Result	Reporting Limit	Units	Spike Level	Source Result	%REC	%REC Limits	RPD	RPD Limit	Notes
---------	--------	-----------------	-------	-------------	---------------	------	-------------	-----	-----------	-------

Batch 3120433 - SW846-3510**Blank (3120433-BLK1)**

Prepared: 04-Dec-23 Analyzed: 08-Dec-23

Naphthalene	ND	0.001	mg/L							
2-Methylnaphthalene	ND	0.001	mg/L							
1-Methylnaphthalene	ND	0.0005	mg/L							
Acenaphthylene	ND	0.001	mg/L							
Acenaphthene	ND	0.001	mg/L							
Fluorene	ND	0.001	mg/L							
Phenanthrene	ND	0.001	mg/L							
Anthracene	ND	0.001	mg/L							
Carbazole	ND	0.001	mg/L							
Fluoranthene	ND	0.001	mg/L							
Pyrene	ND	0.001	mg/L							
Benzo[a]anthracene	ND	0.001	mg/L							
Chrysene	ND	0.001	mg/L							
Benzo[b]fluoranthene	ND	0.001	mg/L							
Benzo[k]fluoranthene	ND	0.001	mg/L							
Benzo[a]pyrene	ND	0.0002	mg/L							
Indeno[1,2,3-cd]pyrene	ND	0.001	mg/L							
Dibenz[a,h]anthracene	ND	0.001	mg/L							
Benzo[g,h,i]perylene	ND	0.001	mg/L							
Surrogate: Nitrobenzene-d5	0.0270		mg/L	0.0500		54.0	5.17-184			
Surrogate: 2-Fluorobiphenyl	0.0302		mg/L	0.0500		60.4	7.39-192			
Surrogate: Terphenyl-d14	0.0316		mg/L	0.0500		63.1	27.5-139			

LCS (3120433-BS1)

Prepared: 04-Dec-23 Analyzed: 08-Dec-23

Naphthalene	0.005	0.001	mg/L	0.0100		54.0	46.9-122			
2-Methylnaphthalene	0.006	0.001	mg/L	0.0100		57.4	48.1-126			
1-Methylnaphthalene	0.006	0.0005	mg/L	0.0100		56.6	47.6-126			
Acenaphthylene	0.006	0.001	mg/L	0.0100		64.4	50.2-124			
Acenaphthene	0.006	0.001	mg/L	0.0100		61.9	49.4-119			
Fluorene	0.006	0.001	mg/L	0.0100		62.6	50.1-126			
Phenanthrene	0.007	0.001	mg/L	0.0100		65.4	53.6-120			
Anthracene	0.007	0.001	mg/L	0.0100		65.5	51.9-120			

Cardinal Laboratories

*=Accredited Analyte

PLEASE NOTE: Liability and Damages. Cardinal's liability and client's exclusive remedy for any claim arising, whether based in contract or tort, shall be limited to the amount paid by client for analyses. All claims, including those for negligence or any other cause whatsoever shall be deemed waived unless made in writing and received by Cardinal within thirty (30) days after completion of the applicable service. In no event shall Cardinal be liable for incidental or consequential damage including, without limitation, business interruptions, loss of use, or loss of profits incurred by client, its subsidiaries, affiliates or successors arising out of or related to the performance of the services hereunder by Cardinal, regardless of whether such claim is based upon any of the above stated reasons or otherwise. Results relate only to the samples identified above. This report shall not be reproduced except in full with written approval of Cardinal Laboratories.

Celey D. Keene, Lab Director/Quality Manager



PHONE (575) 393-2326 • 101 E. MARLAND • HOBBS, NM 88240

Analytical Results For:

AXIS ENVIROMENTAL
121 INDIAN RIDGE RD
BELTON TX, 76513

Project: G STATE 4
Project Number: NONE GIVEN
Project Manager: BRAD FREEMAN
Fax To:

Reported:
12-Dec-23 09:56

Polynuclear Aromatic Compounds by GC/MS - Quality Control**Cardinal Laboratories**

Analyte	Result	Reporting Limit	Units	Spike Level	Source Result	%REC	%REC Limits	RPD	RPD Limit	Notes
---------	--------	-----------------	-------	-------------	---------------	------	-------------	-----	-----------	-------

Batch 3120433 - SW846-3510**LCS (3120433-BS1)**

Prepared: 04-Dec-23 Analyzed: 08-Dec-23

Carbazole	0.007	0.001	mg/L	0.0100		70.9	54-123			
Fluoranthene	0.007	0.001	mg/L	0.0100		68.4	54.9-126			
Pyrene	0.007	0.001	mg/L	0.0100		66.0	50.2-124			
Benzo[a]anthracene	0.006	0.001	mg/L	0.0100		64.1	49.9-123			
Chrysene	0.007	0.001	mg/L	0.0100		69.6	50.1-125			
Benzo[b]fluoranthene	0.007	0.001	mg/L	0.0100		68.3	52.1-125			
Benzo[k]fluoranthene	0.007	0.001	mg/L	0.0100		70.3	49.3-131			
Benzo[a]pyrene	0.008	0.0002	mg/L	0.0100		75.4	52.9-126			
Indeno[1,2,3-cd]pyrene	0.007	0.001	mg/L	0.0100		72.5	50-132			
Dibenz[a,h]anthracene	0.007	0.001	mg/L	0.0100		74.6	51.7-129			
Benzo[g,h,i]perylene	0.007	0.001	mg/L	0.0100		69.8	50.7-130			
Surrogate: Nitrobenzene-d5	0.0324		mg/L	0.0500		64.8	5.17-184			
Surrogate: 2-Fluorobiphenyl	0.0354		mg/L	0.0500		70.8	7.39-192			
Surrogate: Terphenyl-d14	0.0381		mg/L	0.0500		76.1	27.5-139			

LCS Dup (3120433-BSD1)

Prepared: 04-Dec-23 Analyzed: 08-Dec-23

Naphthalene	0.006	0.001	mg/L	0.0100		57.3	46.9-122	5.93	3.46	QR-04
2-Methylnaphthalene	0.006	0.001	mg/L	0.0100		59.8	48.1-126	4.10	4.47	
1-Methylnaphthalene	0.006	0.0005	mg/L	0.0100		57.6	47.6-126	1.75	4.3	
Acenaphthylene	0.006	0.001	mg/L	0.0100		63.9	50.2-124	0.779	3.88	
Acenaphthene	0.006	0.001	mg/L	0.0100		62.4	49.4-119	0.805	3.77	
Fluorene	0.006	0.001	mg/L	0.0100		61.7	50.1-126	1.45	4.31	
Phenanthrene	0.007	0.001	mg/L	0.0100		66.4	53.6-120	1.52	5.04	
Anthracene	0.006	0.001	mg/L	0.0100		64.6	51.9-120	1.38	4.49	
Carbazole	0.007	0.001	mg/L	0.0100		69.2	54-123	2.43	4.78	
Fluoranthene	0.007	0.001	mg/L	0.0100		66.5	54.9-126	2.82	6.19	
Pyrene	0.007	0.001	mg/L	0.0100		67.4	50.2-124	2.10	7.75	
Benzo[a]anthracene	0.007	0.001	mg/L	0.0100		67.5	49.9-123	5.17	3.03	QR-04
Chrysene	0.007	0.001	mg/L	0.0100		70.6	50.1-125	1.43	3.42	
Benzo[b]fluoranthene	0.007	0.001	mg/L	0.0100		68.1	52.1-125	0.293	6.95	
Benzo[k]fluoranthene	0.007	0.001	mg/L	0.0100		72.4	49.3-131	2.94	8.16	
Benzo[a]pyrene	0.007	0.0002	mg/L	0.0100		73.8	52.9-126	2.14	3.27	

Cardinal Laboratories

*=Accredited Analyte

PLEASE NOTE: Liability and Damages. Cardinal's liability and client's exclusive remedy for any claim arising, whether based in contract or tort, shall be limited to the amount paid by client for analyses. All claims, including those for negligence or any other cause whatsoever shall be deemed waived unless made in writing and received by Cardinal within thirty (30) days after completion of the applicable service. In no event shall Cardinal be liable for incidental or consequential damage including, without limitation, business interruptions, loss of use, or loss of profits incurred by client, its subsidiaries, affiliates or successors arising out of or related to the performance of the services hereunder by Cardinal, regardless of whether such claim is based upon any of the above stated reasons or otherwise. Results relate only to the samples identified above. This report shall not be reproduced except in full with written approval of Cardinal Laboratories.

Celey D. Keene, Lab Director/Quality Manager



PHONE (575) 393-2326 ° 101 E. MARLAND ° HOBBS, NM 88240

Analytical Results For:

AXIS ENVIROMENTAL
121 INDIAN RIDGE RD
BELTON TX, 76513

Project: G STATE 4
Project Number: NONE GIVEN
Project Manager: BRAD FREEMAN
Fax To:

Reported:
12-Dec-23 09:56

Polynuclear Aromatic Compounds by GC/MS - Quality Control**Cardinal Laboratories**

Analyte	Result	Reporting Limit	Units	Spike Level	Source Result	%REC	%REC Limits	RPD	RPD Limit	Notes
---------	--------	--------------------	-------	----------------	------------------	------	----------------	-----	--------------	-------

Batch 3120433 - SW846-3510**LCS Dup (3120433-BSD1)**

Prepared: 04-Dec-23 Analyzed: 08-Dec-23

Indeno[1,2,3-cd]pyrene	0.006	0.001	mg/L	0.0100		59.5	50-132	19.7	4.11	QR-04
Dibenz[a,h]anthracene	0.006	0.001	mg/L	0.0100		58.6	51.7-129	24.0	4.77	QR-04
Benzo[g,h,i]perylene	0.006	0.001	mg/L	0.0100		62.2	50.7-130	11.5	6.35	QR-04
Surrogate: Nitrobenzene-d5	0.0324		mg/L	0.0500		64.7	5.17-184			
Surrogate: 2-Fluorobiphenyl	0.0353		mg/L	0.0500		70.5	7.39-192			
Surrogate: Terphenyl-d14	0.0393		mg/L	0.0500		78.6	27.5-139			

Cardinal Laboratories

*=Accredited Analyte

PLEASE NOTE: Liability and Damages. Cardinal's liability and client's exclusive remedy for any claim arising, whether based in contract or tort, shall be limited to the amount paid by client for analyses. All claims, including those for negligence or any other cause whatsoever shall be deemed waived unless made in writing and received by Cardinal within thirty (30) days after completion of the applicable service. In no event shall Cardinal be liable for incidental or consequential damage including, without limitation, business interruptions, loss of use, or loss of profits incurred by client, its subsidiaries, affiliates or successors arising out of or related to the performance of the services hereunder by Cardinal, regardless of whether such claim is based upon any of the above stated reasons or otherwise. Results relate only to the samples identified above. This report shall not be reproduced except in full with written approval of Cardinal Laboratories.

Celey D. Keene, Lab Director/Quality Manager

PHONE (575) 393-2326 ° 101 E. MARLAND ° HOBBS, NM 88240

Notes and Definitions

S-05	The surrogate recovery is outside of lab established statistical control limits but still within method limits. Data is not adversely affected.
S-04	The surrogate recovery for this sample is outside of established control limits due to a sample matrix effect.
QR-04	The RPD for the BS/BSD was outside of historical limits.
GC-NC1	8260 confirmation analysis was performed; initial GC results were not supported by GC/MS analysis and are biased high with interfering compounds.
ND	Analyte NOT DETECTED at or above the reporting limit
RPD	Relative Percent Difference
**	Samples not received at proper temperature of 6°C or below.
***	Insufficient time to reach temperature.
-	Chloride by SM4500Cl-B does not require samples be received at or below 6°C Samples reported on an as received basis (wet) unless otherwise noted on report

Cardinal Laboratories

*=Accredited Analyte

PLEASE NOTE: Liability and Damages. Cardinal's liability and client's exclusive remedy for any claim arising, whether based in contract or tort, shall be limited to the amount paid by client for analyses. All claims, including those for negligence or any other cause whatsoever shall be deemed waived unless made in writing and received by Cardinal within thirty (30) days after completion of the applicable service. In no event shall Cardinal be liable for incidental or consequential damage including, without limitation, business interruptions, loss of use, or loss of profits incurred by client, its subsidiaries, affiliates or successors arising out of or related to the performance of the services hereunder by Cardinal, regardless of whether such claim is based upon any of the above stated reasons or otherwise. Results relate only to the samples identified above. This report shall not be reproduced except in full with written approval of Cardinal Laboratories.

A handwritten signature in black ink, appearing to read "C. Keene".

Celey D. Keene, Lab Director/Quality Manager

101 East Marland, Hobbs, NM 88240
(575) 393-2326 FAX (575) 393-2476

[illegible]

Attachment 2

LPH Thickness Graph

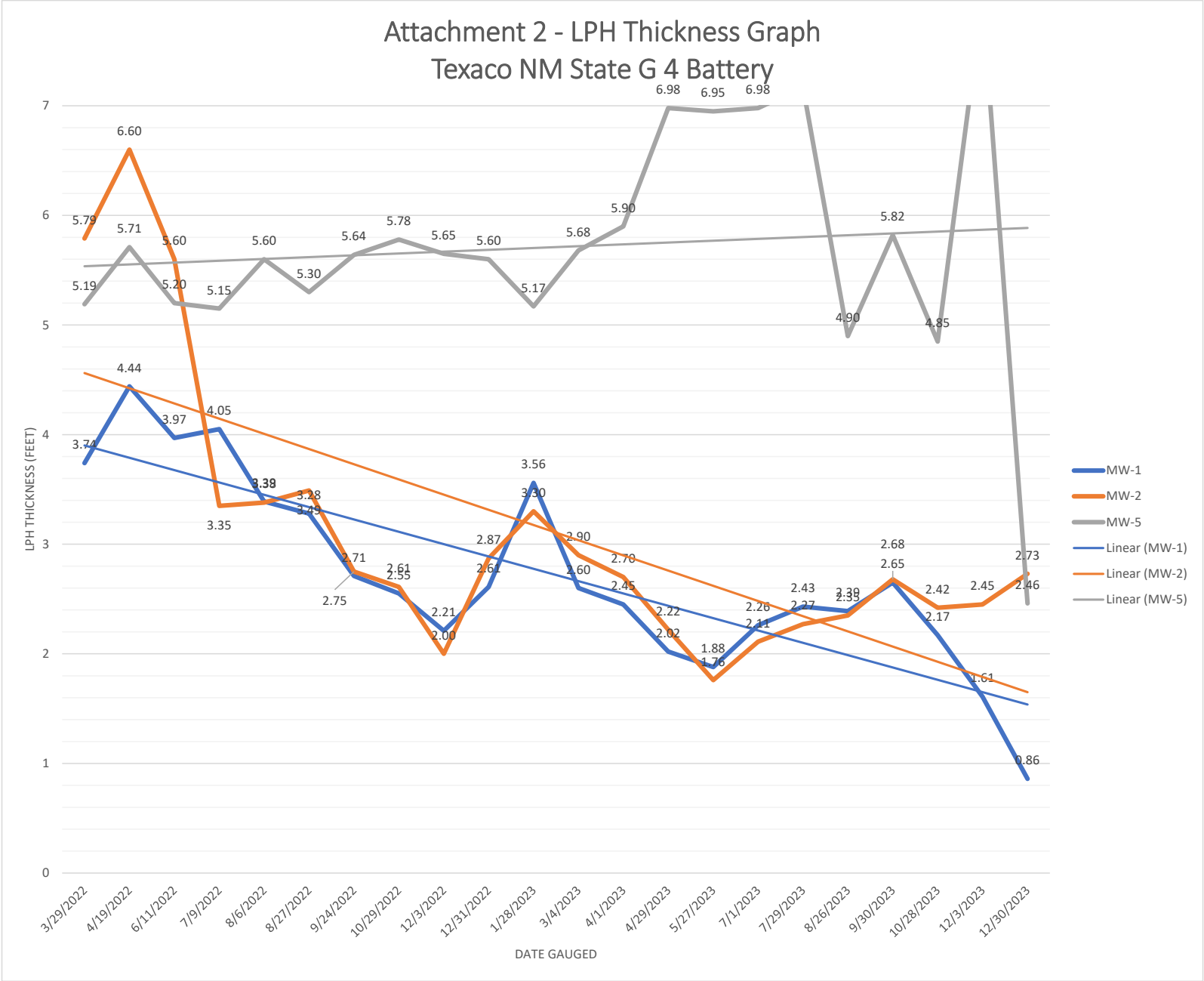

District I
1625 N. French Dr., Hobbs, NM 88240
Phone:(575) 393-6161 Fax:(575) 393-0720
District II
811 S. First St., Artesia, NM 88210
Phone:(575) 748-1283 Fax:(575) 748-9720
District III
1000 Rio Brazos Rd., Aztec, NM 87410
Phone:(505) 334-6178 Fax:(505) 334-6170
District IV
1220 S. St Francis Dr., Santa Fe, NM 87505
Phone:(505) 476-3470 Fax:(505) 476-3462

State of New Mexico
Energy, Minerals and Natural Resources
Oil Conservation Division
1220 S. St Francis Dr.
Santa Fe, NM 87505

CONDITIONS

Action 332113

CONDITIONS

Operator: HESS CORPORATION 1501 McKinney Street Houston, TX 77010	OGRID:
	495
	Action Number:
	332113
Action Type:	
[UF-GWA] Ground Water Abatement (GROUND WATER ABATEMENT)	

CONDITIONS

Created By	Condition	Condition Date
michael.buchanan	Review of the 2023 Annual Site Update for the Former State G 4 Tank Battery, 1R-4863: Content is satisfactory 1. Continue utilizing absorbent sock in MW-3 unless it is not showing effective results in completely eliminating TPH. 2. Continue to conduct semi-annual groundwater monitoring in wells as prescribed. 3. Continue to operate solar sippers in MW-1, MW-2 and MW-5; continue vacuum events in MW-1 MW-2 and MW-5 4. Submit the 2024 Groundwater update report by April 1, 2025.	6/18/2024