

DEVON ENERGY
Cotton Draw 14 Fed Com 2H

Workplan

UL D, Section 14, T25S, R31E
Eddy County, New Mexico

NAPP2520942604

August 15, 2025



Prepared for:

Devon Energy
6488 Seven Rivers Hwy
Artesia, NM 88210

By:

Safety & Environmental Solutions, Inc.
1501 W. Bender Boulevard
Hobbs, New Mexico 88240
(575) 397-0510

Company Contacts

Representative	Company	Telephone	E-mail
Jim Raley	Devon Energy	575-689-7597	jim.raley@devon.com
Leslie Mendenhall	SESI	575-397-0510	lmendenhall@sesi-nm.com

Location

The Cotton Draw 14 Fed Com 2H is located approximately 50 miles southeast of Carlsbad, NM. The legal location for this facility is Unit Letter D, Section 14, Township 25 South and Range 31 East in Eddy County, New Mexico. More specifically the latitude and longitude are 32.1367073,-103.7508469 NAD83.

Background

Incident C-141 received on 07/30/2025 for release discovered on 07/28/2025. The cause of the release was reported as equipment failure: "Spill pot on wellhead failed allowing release of produced water to pad surface." Cause: Equipment Failure | Well | Produced Water | Released: 5 BBL | Recovered: 3 BBL | Lost: 2 BBL.

Surface and Groundwater

According to the soil survey provided by the United States Department of Agriculture National Resources Conservation Services, the soils located within the Site consists of Simona-Bippous Complex and Tonuco loamy fine sand. Per the New Mexico Bureau of Geology and Mineral Resources, the shallow geology consists of interlayered eolian sands and mixed alluvium, Holocene to middle Pleistocene in age. The Site is located within an area of low karst potential.

Depth to groundwater at the Site is estimated to be greater than 55 feet below ground surface (ft bgs) based on the nearest groundwater well data. Groundwater was determined utilizing the New Mexico Office of the State Engineers (NMOSE) database for registered water wells. The nearest permitted groundwater well with depth to groundwater data is NMOSE well is C-4912-POD1 located approximately 227 ft away on the northeastern corner of the pad location. The well was completed to a depth of 55 ft bgs on December 3, 2024. No groundwater was encountered during drilling activities or recorded during a 72-hour observation period.

The well was plugged on December 9, 2024. The nearest fresh water well for livestock watering purposes is located approximately 1.3 miles northeast of the Site. The Site is greater than 1.5 miles from a lakebed, sinkhole, or playa lake and greater than 4 miles from unoccupied residence, school, hospital, institution, church. A freshwater emergent wetland is located approximately 0.64 miles northwest of the Site. The Site is greater than 1,000 feet to a freshwater well or spring. A 100-year flood zone is documented approximately 1.51 miles northwest of the Site. The nearest subsurface mine is greater than 5 miles away from the Site. The Site is not underlain by unstable geology (low potential karst designation area).

Characterization

Table 1
Closure Criteria for Soils Impacted by a Release

Minimum depth below any point within the horizontal boundary of the release to ground water less than 10,000 mg/l TDS	Constituent	Method*	Limit**
≤ 50 feet	Chloride***	EPA 300.0 or SM4500 Cl B	600 mg/kg
	TPH	EPA SW-846	100 mg/kg
	(GRO+DRO+MRO)	Method 8015M	
	BTEX	EPA SW-846 Method 8021B or 8260B	50 mg/kg
	Benzene	EPA SW-846 Method 8021B or 8260B	10 mg/kg

Table I Closure Criteria for Soils Impacted by a Release			
Minimum depth below any point within the horizontal boundary of the release to ground water less than 10,000 mg/l TDS	Constituent	Method*	Limit**
51 feet-100 feet	Chloride***	EPA 300.0 or SM4500 Cl B	10,000 mg/kg
	TPH	EPA SW-846 Method 8015M	2,500 mg/kg
	(GRO+DRO+MRO)		
	GRO+DRO	EPA SW-846 Method 8015M	1,000 mg/kg
	BTEX	EPA SW-846 Method 8021B or 8260B	50 mg/kg
>100 feet	Benzene	EPA SW-846 Method 8021B or 8260B	10 mg/kg
	Chloride***	EPA 300.0 or SM4500 Cl B	20,000 mg/kg
	TPH	EPA SW-846 Method 8015M	2,500 mg/kg
	(GRO+DRO+MRO)		
	GRO+DRO	EPA SW-846 Method 8015M	1,000 mg/kg
	BTEX	EPA SW-846 Method 8021B or 8260B	50 mg/kg
	Benzene	EPA SW-846 Method 8021B or 8260B	10 mg/kg
*Or other test methods approved by the division. **Numerical limits or natural background level, whichever is greater. ***This applies to releases of produced water or other fluids, which may contain chloride. [19.15.29.12 NMAC - N, 8/14/2018]			

WORK PERFORMED

On August 1, 2025, SESI mobilized the site to conduct a delineation investigation. A total of eighteen (18) soil samples were collected at the surface and at six inches bgs. Samples were field-tested for chloride and submitted to Envirotech Analytical Laboratory (Lab ID: E508033) under proper chain-of-custody protocols for full analysis of:

Devon Energy Cotton Draw 14 Fed Com 2H Sample Date Collected: 08/01/2025 Envirotech Analytical Laboratory (Lab ID: E508033)									
Sample ID	Chloride (mg/Kg)	Benzene (mg/Kg)	Toluene (mg/Kg)	Ethyl benzene (mg/Kg)	Total Xylenes (mg/Kg)	Total BTEX (mg/Kg)	GRO (C-6-C10) (mg/Kg)	DRO (C-10-C28) (mg/Kg)	ORO (C-C28-C36) (mg/Kg)
SP-1 @ 1'	580	ND	ND	ND	ND	ND	1330	920	ND
SP-2 @ 1'	16600	ND	ND	ND	ND	ND	1160	474	ND
SP-3 @ 1'	11500	ND	1.19	1.62	16.3	19.11	8300	2460	138
SP-4 @ 1'	2970	0.372	4.94	1.81	14.6	21.722	25000	10800	114
SP-5 @ 6"	13000	ND	0.065	0.177	2.25	2.492	3330	1390	29.8
SP-6 @ 1'	13400	ND	0.0315	0.0402	0.214	0.2857	3570	1420	ND
SP-7 @ 6"	1840	ND	ND	ND	ND	ND	2740	1100	ND
SP-8 @ 6"	15200	ND	ND	ND	ND	ND	69.8	115	ND
SP-9 @ 1'	2350	ND	ND	ND	ND	ND	208	297	ND
SP-10 @ 1'	4400	ND	ND	ND	ND	ND	1220	572	ND
SP-11 @ 1'	4250	ND	ND	ND	ND	ND	67.6	131	ND
HP-1	9390	ND	ND	ND	ND	ND	7670	3930	ND
HP-2	594	ND	ND	ND	ND	ND	ND	ND	ND
HP-3	181	ND	ND	ND	ND	ND	ND	ND	ND
HP-4	4010	ND	ND	ND	ND	ND	ND	ND	ND
HP-5	1560	ND	ND	ND	ND	ND	ND	ND	ND
HP-6	104	ND	ND	ND	ND	ND	ND	ND	ND
HP-7	76.5	ND	ND	ND	ND	ND	ND	ND	ND

Proposed Remediation Action Plan

Following the initial site assessment, SESI determined that the impacted area encompasses approximately 1,191 square feet. The site is situated in a low karst potential area, with groundwater encountered at a depth greater than 55 feet below ground surface (bgs). Based on these site-specific conditions, the applicable remediation standards in accordance with NMOCD Table 1 are 10,000 mg/kg for Chloride and 2,500 mg/kg for Total Petroleum Hydrocarbons (TPH).

Based on the sampling conducted on August 1, 2025, analytical results identified chloride concentrations exceeding 10,000 mg/kg in samples SP-2 (16,600), SP-3 (11,500), SP-5 (13,000), SP-6 (13,400), and SP-8 (15,200). TPH (GRO+DRO+ORO) concentrations exceeding 2,500 mg/kg were detected in samples SP-3 (10,898), SP-4 (35,914), SP-5 (4,749.8), SP-6 (4,990), SP-7 (3,840), and HP-1 (11,600). These exceedances require active remediation.

SESI recommends the use of backhoe equipment and hand augers will be utilized to excavate impacted soils to a depth of approximately 2–4 feet bgs, or until analytical data confirms that vertical delineation meets the target concentrations. Lateral excavation will extend at least 2 feet beyond the horizontal extent of impacts to ensure complete removal. All excavated material will be transported under manifest to an NMOCD-approved disposal facility.

Following excavation, confirmation soil samples will be collected from the base of the excavated area and submitted to Envirotech Analytical Laboratory for analysis of chloride, TPH (GRO+DRO+ORO), and BTEX in accordance with NMOCD Table 1 parameters. Once laboratory results verify that both regulatory closure criteria and SESI's internal remediation targets have been met, the excavated area will be backfilled with clean, compatible material and restored to existing grade in accordance with site specifications.

A final remediation closure report will be prepared and submitted to the NMOCD. This report will include analytical results, waste disposal documentation, and details of site restoration activities for regulatory review and approval.

Supplemental Documentation

Document 1: Vicinity Map
Document 2: OSE information
Document 3: NMOCD Oil and Gas Map
Document 4: BLM Cave Karst Map
Document 5: FEMA Floodplain Map
Document 6: Photographs
Document 7: C-141 initial



Cotton Draw 14 Fed Com 2H

UL D, Section 14, T25S, R31E
Eddy County, New Mexico

nAPP2520942604

Site Map
Initial Site Assessment and sampling locations

Legend



-  Cotton Draw 14 Fed 2H
-  Horizontal Point
-  Sample Point



OSE POD Location Map



8/9/2025, 9:41:32 PM

-  Override 1
-  OSE District Boundary

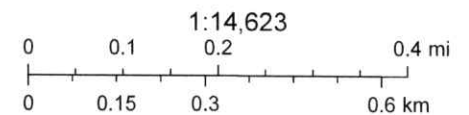

Sources: Esri, TomTom, Garmin, FAO, NOAA, USGS, (c) OpenStreetMap contributors, and the GIS User Community, Maxar

Online web user

This is an unofficial map from the OSE's online application.



WELL RECORD & LOG

OFFICE OF THE STATE ENGINEER

www.ose.state.nm.us

OSE DTI ROSWELL NM
17 DEC '24 PM 2:46

1. GENERAL AND WELL LOCATION	OSE POD NO. (WELL NO.) C-4912-POD1		WELL TAG ID NO.		OSE FILE NO(S) C-4912-POD1			
	WELL OWNER NAME(S) Devon Energy Resources				PHONE (OPTIONAL)			
	WELL OWNER MAILING ADDRESS 205 E. Bender Road #150				CITY Hobbs	STATE NM	ZIP 88240	
	WELL LOCATION (FROM GPS)	DEGREES LATITUDE 32	MINUTES 8	SECONDS 13.8	N	* ACCURACY REQUIRED: ONE TENTH OF A SECOND		
	LONGITUDE -103	45	11.8	W	* DATUM REQUIRED: WGS 84			
DESCRIPTION RELATING WELL LOCATION TO STREET ADDRESS AND COMMON LANDMARKS - PLSS (SECTION, TOWNSHIP, RANGE) WHERE AVAILABLE								
2. DRILLING & CASING INFORMATION	LICENSE NO. 1833		NAME OF LICENSED DRILLER Jason Maley			NAME OF WELL DRILLING COMPANY Vision Resources		
	DRILLING STARTED 12-3-24	DRILLING ENDED 12-3-24	DEPTH OF COMPLETED WELL (FT) 55'	BORE HOLE DEPTH (FT) 55'	DEPTH WATER FIRST ENCOUNTERED (FT) N/A			
	COMPLETED WELL IS: <input type="checkbox"/> ARTESIAN *add Centralizer info below <input checked="" type="checkbox"/> DRY HOLE <input type="checkbox"/> SHALLOW (UNCONFINED)				STATIC WATER LEVEL IN COMPLETED WELL (FT) 0'	DATE STATIC MEASURED 12-3-24		
	DRILLING FLUID: <input checked="" type="checkbox"/> AIR <input type="checkbox"/> MUD ADDITIVES - SPECIFY:							
	DRILLING METHOD: <input checked="" type="checkbox"/> ROTARY <input type="checkbox"/> HAMMER <input type="checkbox"/> CABLE TOOL <input type="checkbox"/> OTHER - SPECIFY:				CHECK HERE IF PITLESS ADAPTER IS INSTALLED <input type="checkbox"/>			
	DEPTH (feet bgl) FROM TO		BORE HOLE DIAM. (inches)	CASING MATERIAL AND/OR GRADE (include each casing string, and note sections of screen)	CASING CONNECTION TYPE (add coupling diameter)	CASING INSIDE DIAM. (inches)	CASING WALL THICKNESS (inches)	SLOT SIZE (inches)
	0	45	6"	PVC 2" SCH40	Thread	2"	SCH40	N/A
	45	55	6"	PVC 2" SCH40	Thread	2"	SCH40	.02
3. ANNULAR MATERIAL	DEPTH (feet bgl) FROM TO		BORE HOLE DIAM. (inches)	LIST ANNULAR SEAL MATERIAL AND GRAVEL PACK SIZE - RANGE BY INTERVAL <i>*(if using Centralizers for Artesian wells- indicate the spacing below)</i>		AMOUNT (cubic feet)	METHOD OF PLACEMENT	
				None pulled and plugged				

FOR OSE INTERNAL USE

WR-20 WELL RECORD & LOG (Version 09/22/2022)

FILE NO. <u>C-4912</u>	POD NO. <u>1</u>	TRN NO. <u>771667</u>
LOCATION <u>255.31E.14 211</u>	WELL TAG ID NO. <u>—</u>	PAGE 1 OF 2

[illegible]

FOR OSE INTERNAL USE		WR-20 WELL RECORD & LOG (Version 09/22/2022)	
FILE NO. C-49112	POD NO. 1	TRN NO. 771667	
LOCATION 25S.31E.14 211	WELL TAG ID NO. —	PAGE 2 OF 2	

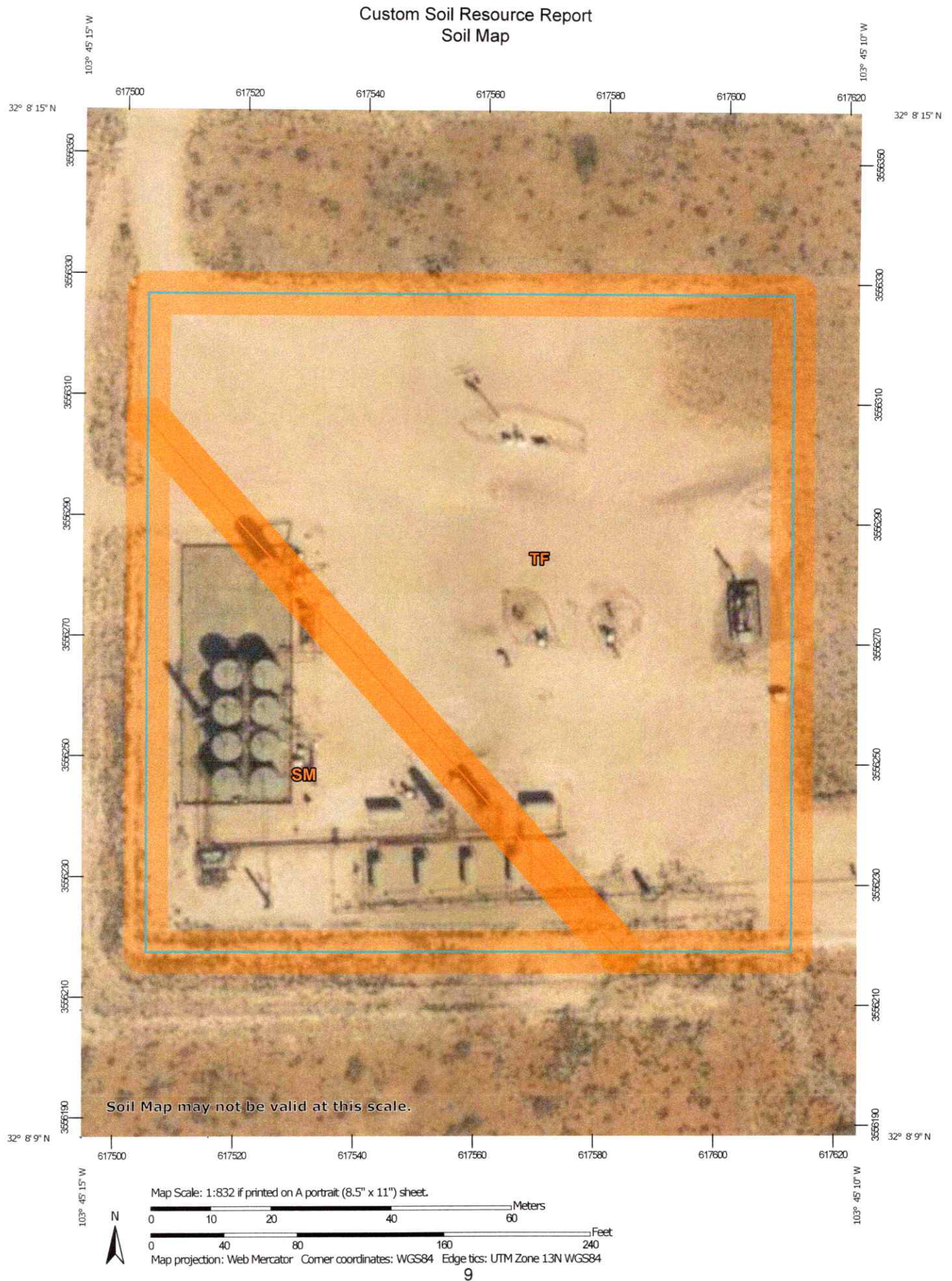

Custom Soil Resource Report

MAP LEGEND

Area of Interest (AOI)

 Area of Interest (AOI)

Soils

 Soil Map Unit Polygons

 Soil Map Unit Lines

 Soil Map Unit Points

Special Point Features



Blowout



Borrow Pit



Clay Spot



Closed Depression



Gravel Pit



Gravelly Spot



Landfill



Lava Flow



Marsh or swamp



Mine or Quarry



Miscellaneous Water



Perennial Water



Rock Outcrop



Saline Spot



Sandy Spot



Severely Eroded Spot



Sinkhole



Slide or Slip



Sodic Spot



Spoil Area



Stony Spot



Very Stony Spot



Wet Spot



Other



Special Line Features

Water Features



Streams and Canals

Transportation



Rails



Interstate Highways



US Routes



Major Roads



Local Roads

Background



Aerial Photography

MAP INFORMATION

The soil surveys that comprise your AOI were mapped at 1:20,000.

Warning: Soil Map may not be valid at this scale.

Enlargement of maps beyond the scale of mapping can cause misunderstanding of the detail of mapping and accuracy of soil line placement. The maps do not show the small areas of contrasting soils that could have been shown at a more detailed scale.

Please rely on the bar scale on each map sheet for map measurements.

Source of Map: Natural Resources Conservation Service
Web Soil Survey URL:
Coordinate System: Web Mercator (EPSG:3857)

Maps from the Web Soil Survey are based on the Web Mercator projection, which preserves direction and shape but distorts distance and area. A projection that preserves area, such as the Albers equal-area conic projection, should be used if more accurate calculations of distance or area are required.

This product is generated from the USDA-NRCS certified data as of the version date(s) listed below.

Soil Survey Area: Eddy Area, New Mexico
Survey Area Data: Version 20, Sep 3, 2024

Soil map units are labeled (as space allows) for map scales 1:50,000 or larger.

Date(s) aerial images were photographed: Feb 7, 2020—May 12, 2020

The orthophoto or other base map on which the soil lines were compiled and digitized probably differs from the background imagery displayed on these maps. As a result, some minor shifting of map unit boundaries may be evident.

Custom Soil Resource Report

Eddy Area, New Mexico**SM—Simona-Bippus complex, 0 to 5 percent slopes****Map Unit Setting**

National map unit symbol: 1w5x
Elevation: 1,800 to 5,000 feet
Mean annual precipitation: 8 to 24 inches
Mean annual air temperature: 57 to 70 degrees F
Frost-free period: 180 to 230 days
Farmland classification: Not prime farmland

Map Unit Composition

Simona and similar soils: 55 percent
Bippus and similar soils: 30 percent
Minor components: 15 percent
Estimates are based on observations, descriptions, and transects of the mapunit.

Description of Simona**Setting**

Landform: Plains, alluvial fans
Landform position (three-dimensional): Rise
Down-slope shape: Convex, linear
Across-slope shape: Linear
Parent material: Mixed alluvium and/or eolian sands

Typical profile

H1 - 0 to 19 inches: gravelly fine sandy loam
H2 - 19 to 23 inches: indurated

Properties and qualities

Slope: 0 to 3 percent
Depth to restrictive feature: 7 to 20 inches to petrocalcic
Drainage class: Well drained
Runoff class: Very high
Capacity of the most limiting layer to transmit water (Ksat): Very low to moderately low (0.00 to 0.06 in/hr)
Depth to water table: More than 80 inches
Frequency of flooding: None
Frequency of ponding: None
Calcium carbonate, maximum content: 15 percent
Maximum salinity: Nonsaline to very slightly saline (0.0 to 2.0 mmhos/cm)
Sodium adsorption ratio, maximum: 1.0
Available water supply, 0 to 60 inches: Very low (about 2.1 inches)

Interpretive groups

Land capability classification (irrigated): None specified
Land capability classification (nonirrigated): 7e
Hydrologic Soil Group: D
Ecological site: R070BD002NM - Shallow Sandy
Hydric soil rating: No

Custom Soil Resource Report

Description of Bippus**Setting**

Landform: Flood plains, alluvial fans
Landform position (three-dimensional): Talf, rise
Down-slope shape: Convex, linear
Across-slope shape: Linear
Parent material: Mixed alluvium

Typical profile

H1 - 0 to 37 inches: silty clay loam
H2 - 37 to 60 inches: clay loam

Properties and qualities

Slope: 0 to 5 percent
Depth to restrictive feature: More than 80 inches
Drainage class: Well drained
Runoff class: Very low
Capacity of the most limiting layer to transmit water (Ksat): Moderately high to high
(0.60 to 2.00 in/hr)
Depth to water table: More than 80 inches
Frequency of flooding: Occasional
Frequency of ponding: None
Calcium carbonate, maximum content: 40 percent
Maximum salinity: Nonsaline to very slightly saline (0.0 to 2.0 mmhos/cm)
Sodium adsorption ratio, maximum: 1.0
Available water supply, 0 to 60 inches: Moderate (about 8.7 inches)

Interpretive groups

Land capability classification (irrigated): 2e
Land capability classification (nonirrigated): 3e
Hydrologic Soil Group: B
Ecological site: R070BC017NM - Bottomland
Hydric soil rating: No

Minor Components**Simona**

Percent of map unit: 8 percent
Ecological site: R070BD002NM - Shallow Sandy
Hydric soil rating: No

Bippus

Percent of map unit: 7 percent
Ecological site: R070BC017NM - Bottomland
Hydric soil rating: No

Custom Soil Resource Report

TF—Tonuco loamy fine sand, 0 to 3 percent slopes**Map Unit Setting**

National map unit symbol: 1w61
Elevation: 3,000 to 4,100 feet
Mean annual precipitation: 10 to 14 inches
Mean annual air temperature: 60 to 64 degrees F
Frost-free period: 200 to 217 days
Farmland classification: Not prime farmland

Map Unit Composition

Tonuco and similar soils: 98 percent
Minor components: 2 percent
Estimates are based on observations, descriptions, and transects of the mapunit.

Description of Tonuco**Setting**

Landform: Plains, alluvial fans
Landform position (three-dimensional): Rise
Down-slope shape: Convex, linear
Across-slope shape: Linear
Parent material: Mixed alluvium and/or eolian sands

Typical profile

H1 - 0 to 5 inches: loamy fine sand
H2 - 5 to 15 inches: loamy fine sand
H3 - 15 to 19 inches: indurated

Properties and qualities

Slope: 0 to 3 percent
Depth to restrictive feature: 6 to 20 inches to petrocalcic
Drainage class: Excessively drained
Runoff class: Very high
Capacity of the most limiting layer to transmit water (Ksat): Very low to moderately low (0.00 to 0.06 in/hr)
Depth to water table: More than 80 inches
Frequency of flooding: None
Frequency of ponding: None
Maximum salinity: Nonsaline (0.0 to 1.0 mmhos/cm)
Sodium adsorption ratio, maximum: 1.0
Available water supply, 0 to 60 inches: Very low (about 1.3 inches)

Interpretive groups

Land capability classification (irrigated): None specified
Land capability classification (nonirrigated): 7e
Hydrologic Soil Group: D
Ecological site: R070BD004NM - Sandy
Hydric soil rating: No

Custom Soil Resource Report

Minor Components

Tonuco

Percent of map unit: 1 percent

Ecological site: R070BD004NM - Sandy

Hydric soil rating: No

Dune land

Percent of map unit: 1 percent

Hydric soil rating: No

OCD Well Locations | Karst Map

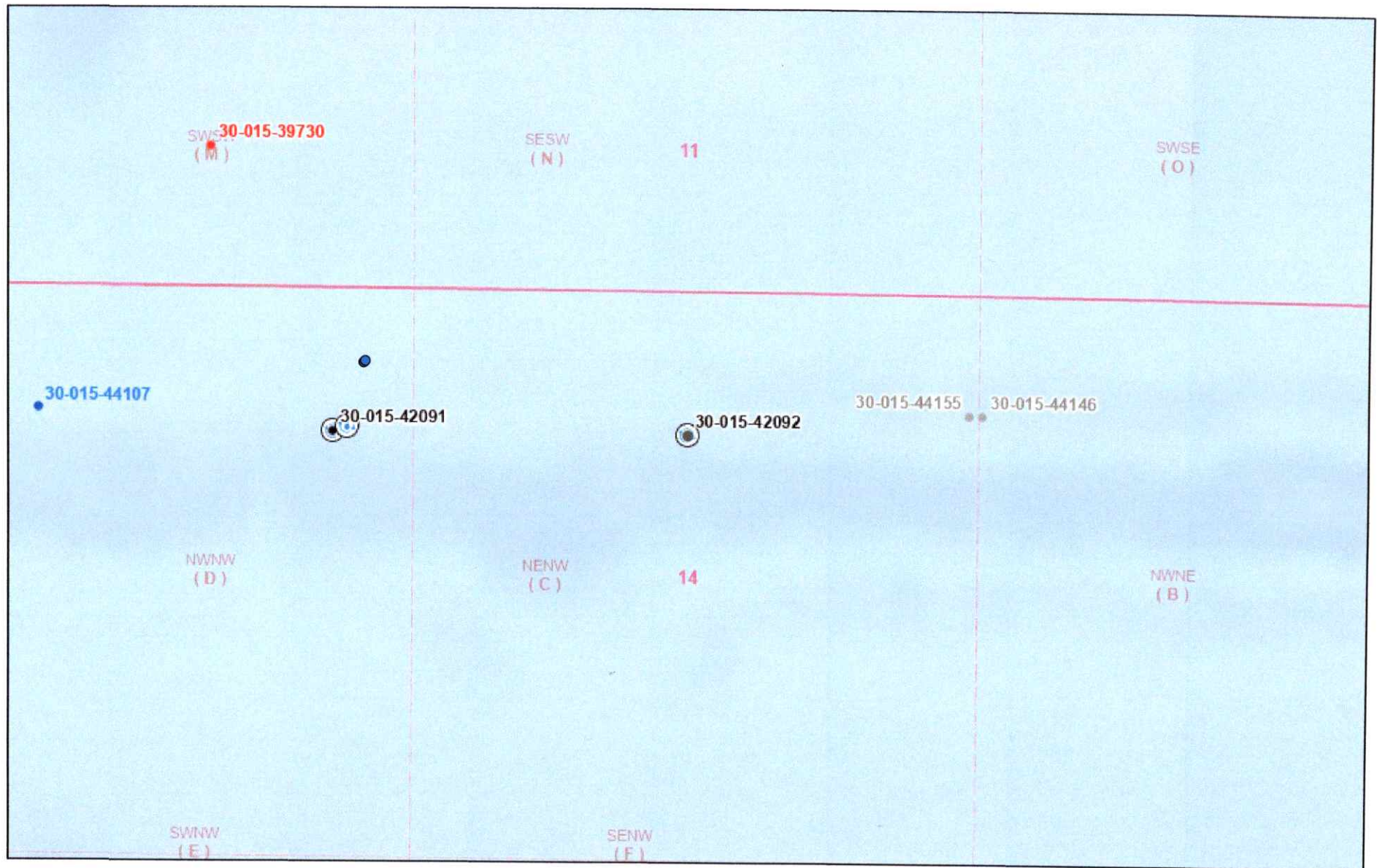

8/5/2025, 10:09:46 PM

- | | | |
|---------------------|--------------------------|------------------------------------|
| ● OSE Water PODs | ● Oil, Plugged | Facility |
| Wells - Large Scale | Incident Release | ● Other |
| • Oil, Active | ● Produced Water Release | ■ Karst Occurrence Potential |
| • Oil, Cancelled | ● Oil Release | ■ Low |
| • Oil, New | | ■ Oil and Gas Leasing Restrictions |

- | |
|------------------------|
| ■ Oil and Gas Leases |
| ■ PLSS Second Division |
| ■ PLSS First Division |

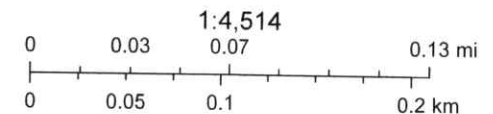

BLM, OCD, New Mexico Tech, Oil Conservation Division of the New Mexico Energy, Minerals and Natural Resources Department., USGS, OCD, NM

NM OCD Oil and Gas Map. <http://nm-emnrd.maps.arcgis.com/apps/webappviewer/index.html?id=4d017f2306164de29fd2fb9f8f35ca75>. New Mexico Oil Conservation Division



Cotton Draw 14



March 3, 2025

Wetlands

- Estuarine and Marine Deepwater
- Estuarine and Marine Wetland

- Freshwater Emergent Wetland
- Freshwater Forested/Shrub Wetland
- Freshwater Pond

- Lake
- Other
- Riverine

This map is for general reference only. The US Fish and Wildlife Service is not responsible for the accuracy or currentness of the base data shown on this map. All wetlands related data should be used in accordance with the layer metadata found on the Wetlands Mapper web site.

National Flood Hazard Layer FIRMette



103°45'31"W 32°8'28"N



0 250 500 1,000 1,500 2,000 Feet

1:6,000

103°44'54"W 32°7'58"N

Legend

SEE FIS REPORT FOR DETAILED LEGEND AND INDEX MAP FOR FIRM PANEL LAYOUT

SPECIAL FLOOD HAZARD AREAS		Without Base Flood Elevation (BFE) Zone A, V, A99
		With BFE or Depth Zone AE, AO, AH, VE, AR
		Regulatory Floodway
OTHER AREAS OF FLOOD HAZARD		0.2% Annual Chance Flood Hazard, Areas of 1% annual chance flood with average depth less than one foot or with drainage areas of less than one square mile Zone X
		Future Conditions 1% Annual Chance Flood Hazard Zone X
		Area with Reduced Flood Risk due to Levee. See Notes, Zone X
		Area with Flood Risk due to Levee Zone D
OTHER AREAS		NO SCREEN Area of Minimal Flood Hazard Zone X
		Effective LOMRs
		Area of Undetermined Flood Hazard Zone D
GENERAL STRUCTURES		Channel, Culvert, or Storm Sewer
		Levee, Dike, or Floodwall
OTHER FEATURES		20.2 Cross Sections with 1% Annual Chance Water Surface Elevation
		17.5 Cross Sections with 1% Annual Chance Water Surface Elevation
		Coastal Transect
		Base Flood Elevation Line (BFE)
		Limit of Study
		Jurisdiction Boundary
		Coastal Transect Baseline
OTHER FEATURES		Profile Baseline
		Hydrographic Feature
MAP PANELS		Digital Data Available
		No Digital Data Available
		Unmapped



The pin displayed on the map is an approximate point selected by the user and does not represent an authoritative property location.

This map complies with FEMA's standards for the use of digital flood maps if it is not void as described below. The basemap shown complies with FEMA's basemap accuracy standards.

The flood hazard information is derived directly from the authoritative NFHL web services provided by FEMA. This map was exported on 8/10/2025 at 3:37 AM and does not reflect changes or amendments subsequent to this date and time. The NFHL and effective information may change or become superseded by new data over time.

This map image is void if the one or more of the following map elements do not appear: basemap imagery, flood zone labels, legend, scale bar, map creation date, community identifiers, FIRM panel number, and FIRM effective date. Map images for unmapped and unmodernized areas cannot be used for regulatory purposes.

Cotton Draw 14 Fed Com 2H

July 28, 2025



Cotton Draw 14 Fed Com 2H

August 1, 2025

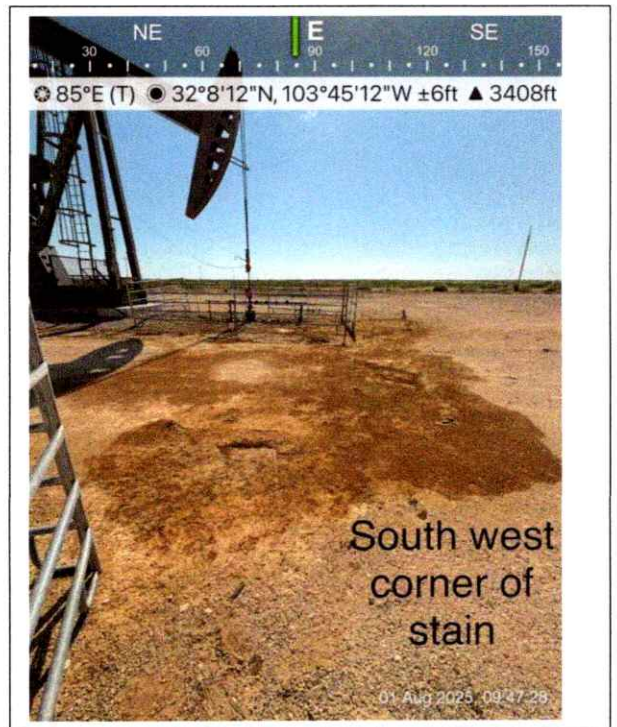
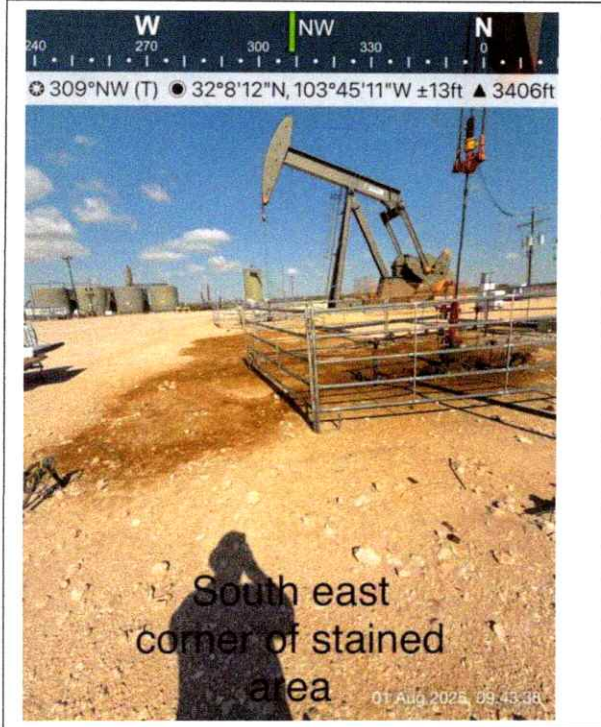

Cotton Draw 14 Fed Com 2H

August 1, 2025

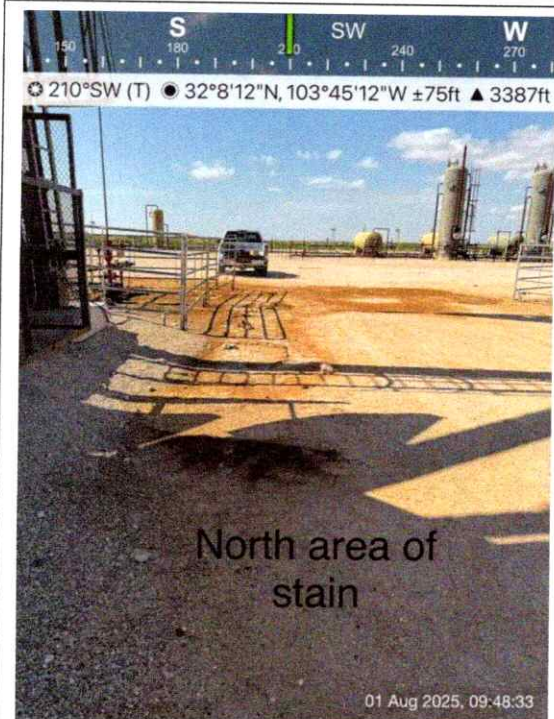

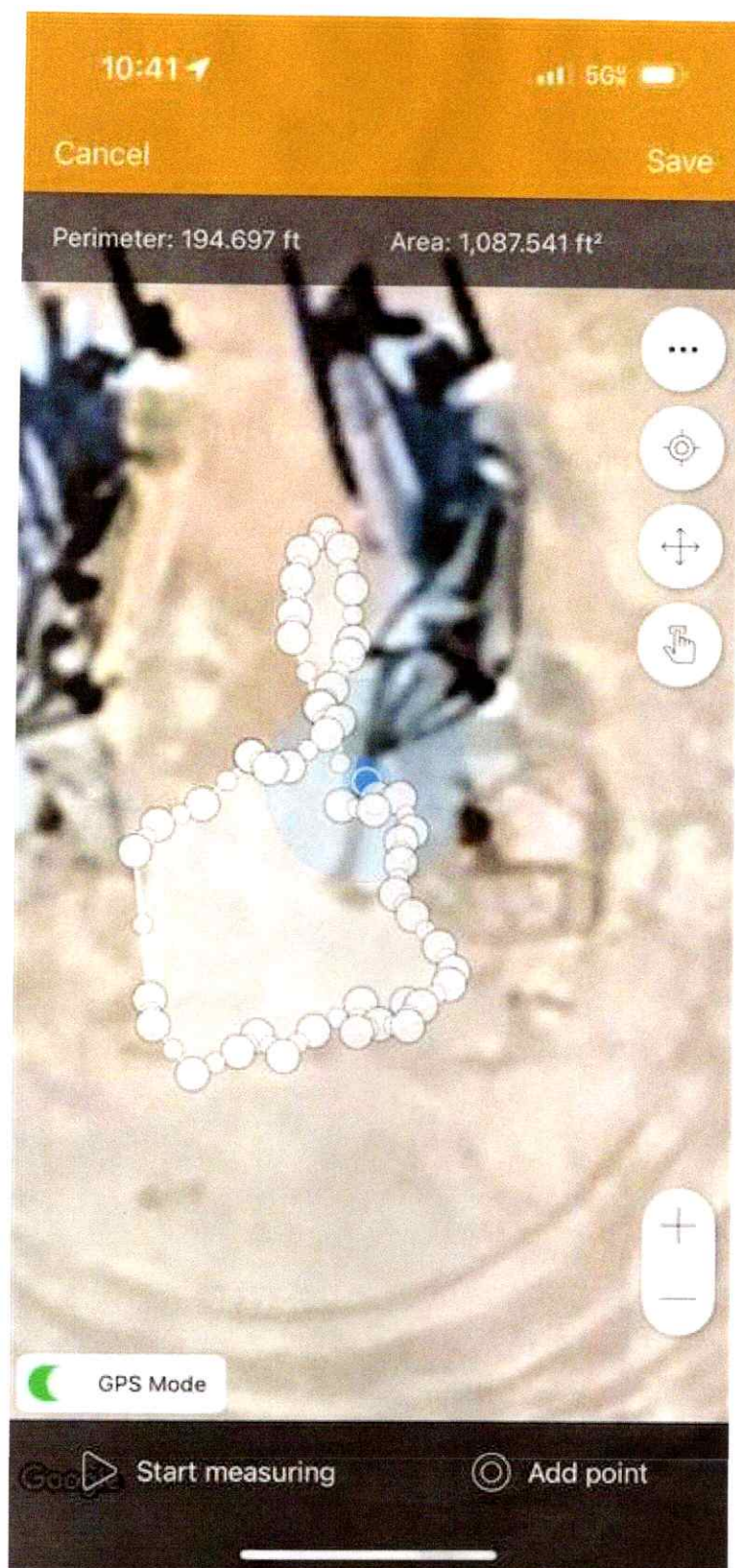

Person Reporting	Joey Melancon	
Foreman Name	Lionel Sandate	
Facility or Well Name	Cotton Draw 14 FED 2H	
API (If applicable)		
Lat/Long	N32 08 12.313 W103 45 102.012	
M3#	13128745	
Please Include the following with report:	Picture of Lease Sign - Pictures of Spill - Screen Shot of Volume Calculations	
Date and Time of Incident	7/25/2025 11:00 A.M.	
Description of Incident	Pumping unit spill pot plugged off allowing fluid to leak out of stuffing box	
Immediate Actions	LO shut well in and isolated leak. Called vac truck for recovery of standing fluid	
	Released (Bbls)	Recovered (Bbls)
Fluid Type		
Oil		
Produced Water	5.73	3
Gas		
Other		

Spill Volume Calculations

Free Standing Fluid Volume

How do you want to enter area? **Total area from app**

Area from app (ft ²)	650.00	
Depth of fluid		0.50 in
Number of Tanks in Fluid Affected Area (if any):		0
Tank Diameter (if needed):		15.5 ft
Volume of Standing Fluid		4.82 bbl

Contaminated Soil Calculations

How do you want to enter area? **Total area from app**

Area from app (ft ²)	1087.00	
Depth of impacted soil		0.25 in
Soil Type		Caliche
Spilled Material		Oil / Produced Water
Soil Saturation	Moist - some color change; little to no moisture left on hands	
Volume of Spill In Soil	0.90	bbls
Total Spill Volume	5.73	bbls

7/28/25, 4:27 PM

OCD Permitting - Incidents

SIGN-IN HELP

Searches

Operator Data

Hearing Fee Application

OCD Permitting

Home Searches Incidents Incident Details

NAPP2520942604 COTTON DRAW 14 FED COM #002H @ 30-015-42092

General Incident Information

Site Name:	COTTON DRAW 14 FED COM #002H		
Well:	30-015-42092 COTTON DRAW 14 FED COM #002H		
Facility:			
Operator:	6137 DEVON ENERGY PRODUCTION COMPANY LP		
Status:	Notification Accepted. Pending submission of Initial C-141 from the operator.		
Type:	Produced Water Release	Severity:	Minor
		Surface Owner:	Federal
District:	Artesia	County:	Eddy (15)
Incident Location:	D-14-255-31E 330 FNL 1880 FWL		
Lat/Long:	32.1367073 -103.7508469 NAD83		
Directions:			

Quick

- [Gene](#)
- [Mate](#)
- [Evan](#)
- [Order](#)
- [Actu](#)

Assoc

- [Incide](#)
- [Well I](#)

New

- [New I](#)
- [New I](#)
- [New I](#)
- [New I](#)
- [New I](#)
- [New I](#)
- [New I](#)

Notes

Source of Referral: Industry Rep

Action / Escalation:

Resulted In Fire:

Resulted In Injury:

Endangered Public Health:

Will or Has Reached Watercourse:

Fresh Water Contamination:

Property Or Environmental Damage:

Contact Details

Contact Name:

Contact Title:

Event Dates

Date of Discovery: 07/25/2025

Initial C-141 Report Due: 8/11/2025

Remediation Closure Report Due: 10/23/2025

Incident Dates

Type: Action: Reviewed: Reported: Set: Set:

Notification: [489014](#) 07/26/2025 07/28/2025

Compositional Analysis of Vented and/or Flared Natural Gas

No Compositional Analysis Found

Incident Materials

7/28/25, 4:27 PM

OCD Permitting - Incidents

View By: [dropdown]

Searches

Operator Data

Hearing Fee Application

Is the applicant a US citizen? (Indicate in the previous section if foreign)
Yes No

Is the applicant a US citizen? (Indicate in the previous section if foreign)
Yes No

Is the applicant a US citizen? (Indicate in the previous section if foreign)
Yes No

Incident Events

Is the incident a result of a vehicle accident?
Yes No

Is the incident a result of a vehicle accident?
Yes No

Is the incident a result of a vehicle accident?
Yes No

Incident Severity

Is the incident a result of a vehicle accident?
Yes No

Incident Corrective Actions

Initial Response

Is the incident a result of a vehicle accident?
Yes No

Is the incident a result of a vehicle accident?
Yes No

Is the incident a result of a vehicle accident?
Yes No

Is the incident a result of a vehicle accident?
Yes No

Is the incident a result of a vehicle accident?
Yes No

Is the incident a result of a vehicle accident?
Yes No

Is the incident a result of a vehicle accident?
Yes No

Is the incident a result of a vehicle accident?
Yes No

Is the incident a result of a vehicle accident?
Yes No

Is the incident a result of a vehicle accident?
Yes No

Is the incident a result of a vehicle accident?
Yes No

Is the incident a result of a vehicle accident?
Yes No

Orders

Is the incident a result of a vehicle accident?
Yes No

Sante Fe Main Office
Phone: (505) 476-3441

General Information
Phone: (505) 629-6116

Online Phone Directory
<https://www.emnrd.nm.gov/ocd/contact-us>

State of New Mexico
Energy, Minerals and Natural Resources
Oil Conservation Division
1220 S. St Francis Dr.
Santa Fe, NM 87505

QUESTIONS

Action 497404

QUESTIONS

Operator: DEVON ENERGY PRODUCTION COMPANY, LP 333 West Sheridan Ave. Oklahoma City, OK 73102	OGRID: 6137
	Action Number: 497404
	Action Type: [C-141] Site Char./Remediation Plan C-141 (C-141-v-Plan)

QUESTIONS

Prerequisites	
Incident ID (n#)	nAPP2520942604
Incident Name	NAPP2520942604 COTTON DRAW 14 FED COM #002H @ 30-015-42092
Incident Type	Produced Water Release
Incident Status	Remediation Plan Received
Incident Well	[30-015-42092] COTTON DRAW 14 FED COM #002H

Location of Release Source*Please answer all the questions in this group.*

Site Name	COTTON DRAW 14 FED COM #002H
Date Release Discovered	07/25/2025
Surface Owner	Federal

Incident Details*Please answer all the questions in this group.*

Incident Type	Produced Water Release
Did this release result in a fire or is the result of a fire	No
Did this release result in any injuries	No
Has this release reached or does it have a reasonable probability of reaching a watercourse	No
Has this release endangered or does it have a reasonable probability of endangering public health	No
Has this release substantially damaged or will it substantially damage property or the environment	No
Is this release of a volume that is or may with reasonable probability be detrimental to fresh water	No

Nature and Volume of Release*Material(s) released, please answer all that apply below. Any calculations or specific justifications for the volumes provided should be attached to the follow-up C-141 submission.*

Crude Oil Released (bbls) Details	Not answered.
Produced Water Released (bbls) Details	Cause: Equipment Failure Well Produced Water Released: 5 BBL Recovered: 3 BBL Lost: 2 BBL.
Is the concentration of chloride in the produced water >10,000 mg/l	Yes
Condensate Released (bbls) Details	Not answered.
Natural Gas Vented (Mcf) Details	Not answered.
Natural Gas Flared (Mcf) Details	Not answered.
Other Released Details	Not answered.
Are there additional details for the questions above (i.e. any answer containing Other, Specify, Unknown, and/or Fire, or any negative lost amounts)	Spill pot on wellhead failed allowing release of produced water to pad surface.

Sante Fe Main Office
Phone: (505) 476-3441

General Information
Phone: (505) 629-6116

Online Phone Directory
<https://www.emnrd.nm.gov/ocd/contact-us>

State of New Mexico
Energy, Minerals and Natural Resources
Oil Conservation Division
1220 S. St Francis Dr.
Santa Fe, NM 87505

QUESTIONS, Page 2

Action 497404

QUESTIONS (continued)

Operator: DEVON ENERGY PRODUCTION COMPANY, LP 333 West Sheridan Ave. Oklahoma City, OK 73102	OGRID: 6137
	Action Number: 497404
	Action Type: [C-141] Site Char./Remediation Plan C-141 (C-141-v-Plan)

QUESTIONS

Nature and Volume of Release (continued)	
Is this a gas only submission (i.e. only significant Mcf values reported)	More info needed to determine if this will be treated as a "gas only" report.
Was this a major release as defined by Subsection A of 19.15.29.7 NMAC	No
Reasons why this would be considered a submission for a notification of a major release	<i>Unavailable.</i>
<i>With the implementation of the 19.15.27 NMAC (05/25/2021), venting and/or flaring of natural gas (i.e. gas only) are to be submitted on the C-129 form.</i>	

Initial Response

The responsible party must undertake the following actions immediately unless they could create a safety hazard that would result in injury.

The source of the release has been stopped	True
The impacted area has been secured to protect human health and the environment	True
Released materials have been contained via the use of berms or dikes, absorbent pads, or other containment devices	True
All free liquids and recoverable materials have been removed and managed appropriately	True
If all the actions described above have not been undertaken, explain why	<i>Not answered.</i>

Per Paragraph (4) of Subsection B of 19.15.29.8 NMAC the responsible party may commence remediation immediately after discovery of a release. If remediation has begun, please prepare and attach a narrative of actions to date in the follow-up C-141 submission. If remedial efforts have been successfully completed or if the release occurred within a lined containment area (see Subparagraph (a) of Paragraph (5) of Subsection A of 19.15.29.11 NMAC), please prepare and attach all information needed for closure evaluation in the follow-up C-141 submission.

I hereby certify that the information given above is true and complete to the best of my knowledge and understand that pursuant to OCD rules and regulations all operators are required to report and/or file certain release notifications and perform corrective actions for releases which may endanger public health or the environment. The acceptance of a C-141 report by the OCD does not relieve the operator of liability should their operations have failed to adequately investigate and remediate contamination that pose a threat to groundwater, surface water, human health or the environment. In addition, OCD acceptance of a C-141 report does not relieve the operator of responsibility for compliance with any other federal, state, or local laws and/or regulations.

I hereby agree and sign off to the above statement	Name: James Raley Title: EHS Professional Email: jim.raley@dvni.com Date: 08/20/2025
--	---

Sante Fe Main Office
Phone: (505) 476-3441

General Information
Phone: (505) 629-6116

Online Phone Directory
<https://www.emnrd.nm.gov/ocd/contact-us>

State of New Mexico
Energy, Minerals and Natural Resources
Oil Conservation Division
1220 S. St Francis Dr.
Santa Fe, NM 87505

QUESTIONS, Page 3

Action 497404

QUESTIONS (continued)

Operator: DEVON ENERGY PRODUCTION COMPANY, LP 333 West Sheridan Ave. Oklahoma City, OK 73102	OGRID: 6137
	Action Number: 497404
	Action Type: [C-141] Site Char./Remediation Plan C-141 (C-141-v-Plan)

QUESTIONS

Site Characterization	
<i>Please answer all the questions in this group (only required when seeking remediation plan approval and beyond). This information must be provided to the appropriate district office no later than 90 days after the release discovery date.</i>	
What is the shallowest depth to groundwater beneath the area affected by the release in feet below ground surface (ft bgs)	Between 51 and 75 (ft.)
What method was used to determine the depth to ground water	NM OSE iWaters Database Search
Did this release impact groundwater or surface water	No
What is the minimum distance, between the closest lateral extents of the release and the following surface areas:	
A continuously flowing watercourse or any other significant watercourse	Between 1 and 5 (mi.)
Any lakebed, sinkhole, or playa lake (measured from the ordinary high-water mark)	Between 1 and 5 (mi.)
An occupied permanent residence, school, hospital, institution, or church	Between 1 and 5 (mi.)
A spring or a private domestic fresh water well used by less than five households for domestic or stock watering purposes	Between 1000 (ft.) and ½ (mi.)
Any other fresh water well or spring	Between ½ and 1 (mi.)
Incorporated municipal boundaries or a defined municipal fresh water well field	Between 1 and 5 (mi.)
A wetland	Between ½ and 1 (mi.)
A subsurface mine	Greater than 5 (mi.)
An (non-karst) unstable area	Between 1 and 5 (mi.)
Categorize the risk of this well / site being in a karst geology	Low
A 100-year floodplain	Between 1 and 5 (mi.)
Did the release impact areas not on an exploration, development, production, or storage site	No

Remediation Plan	
<i>Please answer all the questions that apply or are indicated. This information must be provided to the appropriate district office no later than 90 days after the release discovery date.</i>	
Requesting a remediation plan approval with this submission	Yes
<i>Attach a comprehensive report demonstrating the lateral and vertical extents of soil contamination associated with the release have been determined, pursuant to 19.15.29.11 NMAC and 19.15.29.13 NMAC.</i>	
Have the lateral and vertical extents of contamination been fully delineated	Yes
Was this release entirely contained within a lined containment area	No
Soil Contamination Sampling: (Provide the highest observable value for each, in milligrams per kilograms.)	
Chloride (EPA 300.0 or SM4500 Cl B)	16600
TPH (GRO+DRO+MRO) (EPA SW-846 Method 8015M)	35914
GRO+DRO (EPA SW-846 Method 8015M)	35800
BTEX (EPA SW-846 Method 8021B or 8260B)	21
Benzene (EPA SW-846 Method 8021B or 8260B)	0
<i>Per Subsection B of 19.15.29.11 NMAC unless the site characterization report includes completed efforts at remediation, the report must include a proposed remediation plan in accordance with 19.15.29.12 NMAC, which includes the anticipated timelines for beginning and completing the remediation.</i>	
On what estimated date will the remediation commence	08/30/2025
On what date will (or did) the final sampling or liner inspection occur	09/30/2025
On what date will (or was) the remediation complete(d)	10/15/2025
What is the estimated surface area (in square feet) that will be reclaimed	1191
What is the estimated volume (in cubic yards) that will be reclaimed	176
What is the estimated surface area (in square feet) that will be remediated	1191
What is the estimated volume (in cubic yards) that will be remediated	176
<i>These estimated dates and measurements are recognized to be the best guess or calculation at the time of submission and may (be) change(d) over time as more remediation efforts are completed.</i>	
<i>The OCD recognizes that proposed remediation measures may have to be minimally adjusted in accordance with the physical realities encountered during remediation. If the responsible party has any need to significantly deviate from the remediation plan proposed, then it should consult with the division to determine if another remediation plan submission is required.</i>	

Sante Fe Main Office
Phone: (505) 476-3441

General Information
Phone: (505) 629-6116

Online Phone Directory
<https://www.emnrd.nm.gov/ocd/contact-us>

State of New Mexico
Energy, Minerals and Natural Resources
Oil Conservation Division
1220 S. St Francis Dr.
Santa Fe, NM 87505

QUESTIONS, Page 4

Action 497404

QUESTIONS (continued)

Operator: DEVON ENERGY PRODUCTION COMPANY, LP 333 West Sheridan Ave. Oklahoma City, OK 73102	OGRID: 6137
	Action Number: 497404
	Action Type: [C-141] Site Char./Remediation Plan C-141 (C-141-v-Plan)

QUESTIONS

Remediation Plan (continued)	
<i>Please answer all the questions that apply or are indicated. This information must be provided to the appropriate district office no later than 90 days after the release discovery date.</i>	
This remediation will (or is expected to) utilize the following processes to remediate / reduce contaminants:	
<i>(Select all answers below that apply.)</i>	
(Ex Situ) Excavation and off-site disposal (i.e. dig and haul, hydrovac, etc.)	Yes
Which OCD approved facility will be used for off-site disposal	HALFWAY DISPOSAL AND LANDFILL [FEEM0112334510]
OR which OCD approved well (API) will be used for off-site disposal	Not answered.
OR is the off-site disposal site, to be used, out-of-state	Not answered.
OR is the off-site disposal site, to be used, an NMED facility	Not answered.
(Ex Situ) Excavation and on-site remediation (i.e. On-Site Land Farms)	Not answered.
(In Situ) Soil Vapor Extraction	Not answered.
(In Situ) Chemical processing (i.e. Soil Shredding, Potassium Permanganate, etc.)	Not answered.
(In Situ) Biological processing (i.e. Microbes / Fertilizer, etc.)	Not answered.
(In Situ) Physical processing (i.e. Soil Washing, Gypsum, Disking, etc.)	Not answered.
Ground Water Abatement pursuant to 19.15.30 NMAC	Not answered.
OTHER (Non-listed remedial process)	Not answered.
<i>Per Subsection B of 19.15.29.11 NMAC unless the site characterization report includes completed efforts at remediation, the report must include a proposed remediation plan in accordance with 19.15.29.12 NMAC, which includes the anticipated timelines for beginning and completing the remediation.</i>	
I hereby certify that the information given above is true and complete to the best of my knowledge and understand that pursuant to OCD rules and regulations all operators are required to report and/or file certain release notifications and perform corrective actions for releases which may endanger public health or the environment. The acceptance of a C-141 report by the OCD does not relieve the operator of liability should their operations have failed to adequately investigate and remediate contamination that pose a threat to groundwater, surface water, human health or the environment. In addition, OCD acceptance of a C-141 report does not relieve the operator of responsibility for compliance with any other federal, state, or local laws and/or regulations.	
I hereby agree and sign off to the above statement	Name: James Raley Title: EHS Professional Email: jim.raley@dv.com Date: 08/20/2025
<i>The OCD recognizes that proposed remediation measures may have to be minimally adjusted in accordance with the physical realities encountered during remediation. If the responsible party has any need to significantly deviate from the remediation plan proposed, then it should consult with the division to determine if another remediation plan submission is required.</i>	

Sante Fe Main Office
Phone: (505) 476-3441

General Information
Phone: (505) 629-6116

Online Phone Directory
<https://www.emnrd.nm.gov/ocd/contact-us>

State of New Mexico
Energy, Minerals and Natural Resources
Oil Conservation Division
1220 S. St Francis Dr.
Santa Fe, NM 87505

QUESTIONS, Page 5

Action 497404

QUESTIONS (continued)

Operator: DEVON ENERGY PRODUCTION COMPANY, LP 333 West Sheridan Ave. Oklahoma City, OK 73102	OGRID: 6137
	Action Number: 497404
	Action Type: [C-141] Site Char./Remediation Plan C-141 (C-141-v-Plan)

QUESTIONS

Deferral Requests Only	
Only answer the questions in this group if seeking a deferral upon approval this submission. Each of the following items must be confirmed as part of any request for deferral of remediation.	
Requesting a deferral of the remediation closure due date with the approval of this submission	No

Sante Fe Main Office
Phone: (505) 476-3441

General Information
Phone: (505) 629-6116

Online Phone Directory
<https://www.emnrd.nm.gov/ocd/contact-us>

State of New Mexico
Energy, Minerals and Natural Resources
Oil Conservation Division
1220 S. St Francis Dr.
Santa Fe, NM 87505

QUESTIONS, Page 6

Action 497404

QUESTIONS (continued)

Operator: DEVON ENERGY PRODUCTION COMPANY, LP 333 West Sheridan Ave. Oklahoma City, OK 73102	OGRID: 6137
	Action Number: 497404
	Action Type: [C-141] Site Char./Remediation Plan C-141 (C-141-v-Plan)

QUESTIONS

Sampling Event Information	
Last sampling notification (C-141N) recorded	{Unavailable.}

Remediation Closure Request	
Only answer the questions in this group if seeking remediation closure for this release because all remediation steps have been completed.	
Requesting a remediation closure approval with this submission	No

Sante Fe Main Office
Phone: (505) 476-3441

General Information
Phone: (505) 629-6116

Online Phone Directory
<https://www.emnrd.nm.gov/ocd/contact-us>

State of New Mexico
Energy, Minerals and Natural Resources
Oil Conservation Division
1220 S. St Francis Dr.
Santa Fe, NM 87505

CONDITIONS

Action 497404

CONDITIONS

Operator: DEVON ENERGY PRODUCTION COMPANY, LP 333 West Sheridan Ave. Oklahoma City, OK 73102	OGRID: 6137
	Action Number: 497404
	Action Type: [C-141] Site Char./Remediation Plan C-141 (C-141-v-Plan)

CONDITIONS

Created By	Condition	Condition Date
michael.buchanan	Remediation work plan is approved with the following conditions: 1. Continue to address HP-1 horizontally by stepping out to ensure contamination is fully delineated. 2. Excavate as planned to address full contamination vertically to meet the 51-100' Table 1. criteria.	8/26/2025