



June 15, 2026

New Mexico Oil Conservation Division

New Mexico Energy, Minerals, and Natural Resources Department
1220 South St. Francis Drive
Santa Fe, New Mexico 87505

**Re: Closure Request
Boone 16 State 2H
Incident Number NAPP2612526852
Lea County, New Mexico**

To Whom It May Concern:

COG Production, LLC, (COG), has prepared this *Closure Request* to document the findings of a liner integrity inspection conducted at the Boone 16 State 2H (Site) following the release of produced water within a lined containment. Based on the liner integrity inspection activities, COG is submitting this Closure Request, describing assessment activities that have occurred and requesting no further action and closure for Incident Number NAPP2612526852.

SITE DESCRIPTION AND RELEASE SUMMARY

The site is located in Unit O, Section 16, Township 21 South, Range 33 East, in Lea County, New Mexico (32.472211, -103.575047) and is associated with oil and gas exploration and production operations on private surface lands managed by Merchant Livestock.

On May 4, 2026, field personnel discovered a leak on a water tank causing forty-seven point three three (47.33) barrels of produced water to be released into a lined containment. A vacuum truck was dispatched to the site to recover free-standing fluids and approximately forty-five (45) barrels of fluid were recovered. The water tank was isolated to prevent fluid being further released. COG reported the release to the New Mexico Oil Conservation Division (NMOCD) on a *Release Notification Form C-141* (Form C-141) on May 5, 2026. The release was assigned Incident Number NAPP2612526852.

SITE CHARACTERIZATION AND CLOSURE CRITERIA

The site is located within a low karst area. Based on a review of the New Mexico Office of State Engineers databases, there is no known water source within a 0.50-mile radius of the location. The closest well is located approximately 1.28 miles Southwest of the Site in Unit Letter P, S20, T21S, R33E and was drilled in 2021. The well has a reported depth of 105' feet below ground surface and no groundwater was encountered. Per the NMOCD regulatory criteria established in 19.15.29.12 NMAC, the following criteria were utilized in assessing the site.

- Benzene: 10 milligrams per kilogram (mg/kg).
- Benzene, toluene, ethylbenzene, and total xylenes (BTEX): 50 mg/kg.
- TPH: 100 mg/kg (GRO + DRO + MRO).
- Chloride: 600 mg/kg.

LINER INTEGRITY INSPECTION ACTIVITIES

A 48-hour advance notice of the liner inspection was submitted to the NMOCD on June 9, 2026. Prior to conducting the liner integrity inspection, COG operations power washed the liner to remove dirt and debris and recover any residual produced water. A liner integrity inspection was conducted by Jacob Laird on June 12, 2026. Upon inspection, no rips, tears, holes, or damage was observed. The liner was determined to be sufficient, and all released fluids have been removed. Refer to photolog for details.

CLOSURE REQUEST

Based on the liner inspection throughout the facility, the liner was determined to be sufficient. The release was contained laterally by the lined containment and the liner was performing as designed. No further actions are required at the site. COG, LLC respectfully requests that the New Mexico Oil Conservation Division grant closure approval for Incident Number NAPP2612526852.

Should you have any questions or concerns please do not hesitate to contact me.

Sincerely,

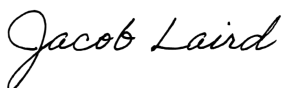

Jacob Laird
Environmental Engineer
jacob.laird@conocophillips.com

Appendices:

Figures- Site Map Overview, Topography Map, Secondary Containment Map

Appendix A: NMOCD Correspondence

Appendix B: Photolog

Appendix C: Site Characterization and Ground Water

Figures: Site Maps



Overview Map

COG Operating, LLC
Boone 16 State 2H
Lea County, New Mexico
32.472211, -103.575047

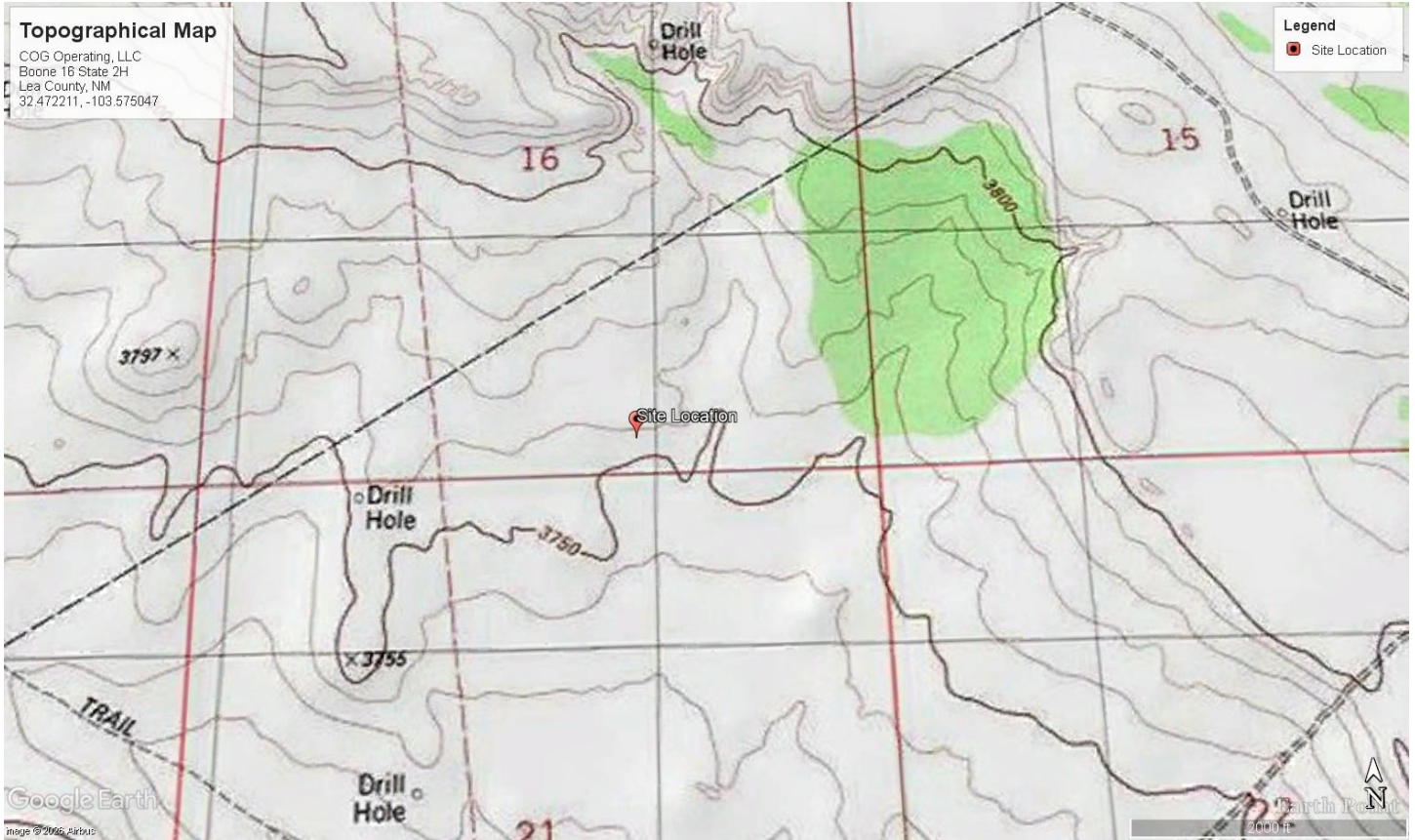

Topographical Map

COG Operating, LLC
Boone 16 State 2H
Lea County, New Mexico
32.472211, -103.575047



Secondary Containment Map

COG Operating, LLC
Boone 16 State 2H
Lea County, New Mexico
32.472211, -103.575047

Appendix A: NMOCD Correspondence

Sante Fe Main Office
Phone: (505) 476-3441

General Information
Phone: (505) 629-6116

Online Phone Directory
<https://www.emnrd.nm.gov/ocd/contact-us>

**State of New Mexico
Energy, Minerals and Natural Resources
Oil Conservation Division
1220 S. St Francis Dr.
Santa Fe, NM 87505**

QUESTIONS

Action 581906

QUESTIONS

Operator: COG OPERATING LLC 600 W Illinois Ave Midland, TX 79701	OGRID: 229137
	Action Number: 581906
	Action Type: [NOTIFY] Notification Of Release (NOR)

QUESTIONS

Location of Release Source	
<i>Please answer all the questions in this group.</i>	
Site Name	Boone 16 State 2H
Date Release Discovered	05/04/2026
Surface Owner	Private

Incident Details	
<i>Please answer all the questions in this group.</i>	
Incident Type	Other
Did this release result in a fire or is the result of a fire	No
Did this release result in any injuries	No
Has this release reached or does it have a reasonable probability of reaching a watercourse	No
Has this release endangered or does it have a reasonable probability of endangering public health	No
Has this release substantially damaged or will it substantially damage property or the environment	No
Is this release of a volume that is or may with reasonable probability be detrimental to fresh water	No

Nature and Volume of Release	
<i>Material(s) released, please answer all that apply below. Any calculations or specific justifications for the volumes provided should be attached to the follow-up C-141 submission.</i>	
Crude Oil Released (bbls) Details	Cause: Overflow - Tank, Pit, Etc. Tank (Any) Crude Oil Released: 0 BBL Recovered: 0 BBL Lost: 0 BBL.
Produced Water Released (bbls) Details	Cause: Overflow - Tank, Pit, Etc. Tank (Any) Produced Water Released: 47 BBL Recovered: 45 BBL Lost: 2 BBL.
Is the concentration of chloride in the produced water >10,000 mg/l	Yes
Condensate Released (bbls) Details	Not answered.
Natural Gas Vented (Mcf) Details	Not answered.
Natural Gas Flared (Mcf) Details	Not answered.
Other Released Details	Not answered.
Are there additional details for the questions above (i.e. any answer containing Other, Specify, Unknown, and/or Fire, or any negative lost amounts)	Not answered.

Sante Fe Main Office
Phone: (505) 476-3441

General Information
Phone: (505) 629-6116

Online Phone Directory
<https://www.emnrd.nm.gov/ocd/contact-us>

**State of New Mexico
Energy, Minerals and Natural Resources
Oil Conservation Division
1220 S. St Francis Dr.
Santa Fe, NM 87505**

QUESTIONS, Page 2

Action 581906

QUESTIONS (continued)

Operator: COG OPERATING LLC 600 W Illinois Ave Midland, TX 79701	OGRID: 229137
	Action Number: 581906
	Action Type: [NOTIFY] Notification Of Release (NOR)

QUESTIONS

Nature and Volume of Release (continued)	
Is this a gas only submission (i.e. only significant Mcf values reported)	No, according to supplied volumes this does not appear to be a "gas only" report.
Was this a major release as defined by Subsection A of 19.15.29.7 NMAC	Yes
Reasons why this would be considered a submission for a notification of a major release	From paragraph A. "Major release" determine using: (1) an unauthorized release of a volume, excluding gases, of 25 barrels or more.

With the implementation of the 19.15.27 NMAC (05/25/2021), venting and/or flaring of natural gas (i.e. gas only) are to be submitted on the C-129 form.

Initial Response

The responsible party must undertake the following actions immediately unless they could create a safety hazard that would result in injury.

The source of the release has been stopped	True
The impacted area has been secured to protect human health and the environment	True
Released materials have been contained via the use of berms or dikes, absorbent pads, or other containment devices	True
All free liquids and recoverable materials have been removed and managed appropriately	True
If all the actions described above have not been undertaken, explain why	Full release was within a lined facility

Per Paragraph 4 of Subsection B of 19.15.29.8 NMAC the responsible party may commence remediation immediately after discovery of a release. If remediation has begun, please prepare and attach a narrative of actions to date in the follow-up C-141 submission. If remedial efforts have been successfully completed or if the release occurred within a lined containment area (see 19.15.29.11(A)(5)(a) NMAC), please prepare and attach all information needed for closure evaluation in the follow-up C-141 submission.

Sante Fe Main Office
Phone: (505) 476-3441

General Information
Phone: (505) 629-6116

Online Phone Directory
<https://www.emnrd.nm.gov/ocd/contact-us>

State of New Mexico
Energy, Minerals and Natural Resources
Oil Conservation Division
1220 S. St Francis Dr.
Santa Fe, NM 87505

ACKNOWLEDGMENTS

Action 581906

ACKNOWLEDGMENTS

Operator: COG OPERATING LLC 600 W Illinois Ave Midland, TX 79701	OGRID: 229137
	Action Number: 581906
	Action Type: [NOTIFY] Notification Of Release (NOR)

ACKNOWLEDGMENTS

<input checked="" type="checkbox"/>	I acknowledge that I am authorized to submit notification of a release on behalf of my operator.
<input checked="" type="checkbox"/>	I acknowledge that upon submitting this application, I will be creating a new incident file (assigned to my operator) to track the notification(s) and corrective action(s) for a release, pursuant to NMAC 19.15.29.
<input checked="" type="checkbox"/>	I acknowledge that creating a new incident file will require my operator to file subsequent submission(s) of form "C-141, Application for administrative approval of a release notification and corrective action", pursuant to NMAC 19.15.29.
<input checked="" type="checkbox"/>	I hereby certify that the information given above is true and complete to the best of my knowledge and understand that pursuant to OCD rules and regulations all operators are required to report and/or file certain release notifications and perform corrective actions for releases which may endanger public health or the environment.
<input checked="" type="checkbox"/>	I acknowledge the fact that the acceptance of a C-141 report by the OCD does not relieve the operator of liability should their operations have failed to adequately investigate and remediate contamination that pose a threat to groundwater, surface water, human health or the environment.
<input checked="" type="checkbox"/>	I acknowledge the fact that, in addition, OCD acceptance of a C-141 report does not relieve the operator of responsibility for compliance with any other federal, state, or local laws and/or regulations.

Sante Fe Main Office
Phone: (505) 476-3441

General Information
Phone: (505) 629-6116

Online Phone Directory
<https://www.emnrd.nm.gov/ocd/contact-us>

State of New Mexico
Energy, Minerals and Natural Resources
Oil Conservation Division
1220 S. St Francis Dr.
Santa Fe, NM 87505

CONDITIONS

Action 581906

CONDITIONS

Operator: COG OPERATING LLC 600 W Illinois Ave Midland, TX 79701	OGRID: 229137
	Action Number: 581906
	Action Type: [NOTIFY] Notification Of Release (NOR)

CONDITIONS

Created By	Condition	Condition Date
jlaire	When submitting future reports regarding this release, please submit the calculations used or specific justification for the volumes reported on the initial C-141.	5/5/2026

Sante Fe Main Office
Phone: (505) 476-3441

General Information
Phone: (505) 629-6116

Online Phone Directory
<https://www.emnrd.nm.gov/ocd/contact-us>

**State of New Mexico
Energy, Minerals and Natural Resources
Oil Conservation Division
1220 S. St Francis Dr.
Santa Fe, NM 87505**

QUESTIONS

Action 593474

QUESTIONS

Operator: COG OPERATING LLC 600 W Illinois Ave Midland, TX 79701	OGRID: 229137
	Action Number: 593474
	Action Type: [NOTIFY] Notification Of Liner Inspection (C-141L)

QUESTIONS

Prerequisites	
Incident ID (n#)	nAPP2612526852
Incident Name	NAPP2612526852 BOONE 16 STATE 2H @ O-16-21S-33E
Incident Type	Other
Incident Status	Initial C-141 Approved

Location of Release Source	
Site Name	Boone 16 State 2H
Date Release Discovered	05/04/2026
Surface Owner	Private

Liner Inspection Event Information	
<i>Please answer all the questions in this group.</i>	
What is the liner inspection surface area in square feet	4,591
Have all the impacted materials been removed from the liner	Yes
Liner inspection date pursuant to Subparagraph (a) of Paragraph (5) of Subsection A of 19.15.29.11 NMAC	06/12/2026
Time liner inspection will commence	07:00 AM
Please provide any information necessary for observers to liner inspection	Jacob Laird 575-703-5428
Please provide any information necessary for navigation to liner inspection site	32.472211, -103.575047

Sante Fe Main Office
Phone: (505) 476-3441

General Information
Phone: (505) 629-6116

Online Phone Directory
<https://www.emnrd.nm.gov/ocd/contact-us>

State of New Mexico
Energy, Minerals and Natural Resources
Oil Conservation Division
1220 S. St Francis Dr.
Santa Fe, NM 87505

CONDITIONS

Action 593474

CONDITIONS

Operator: COG OPERATING LLC 600 W Illinois Ave Midland, TX 79701	OGRID: 229137
	Action Number: 593474
	Action Type: [NOTIFY] Notification Of Liner Inspection (C-141L)

CONDITIONS

Created By	Condition	Condition Date
jlaird	Failure to notify the OCD of liner inspections including any changes in date/time per the requirements of 19.15.29.11.A(5)(a)(ii) NMAC, may result in the inspection not being accepted.	6/9/2026

Appendix B: Photolog

Photographic Log

<p>Facility: Boone 16 State 2H</p> <p>County: Lea County, New Mexico</p> <p>Description: Facility Sign</p>	
<p>Facility: Boone 16 State 2H</p> <p>County: Lea County, New Mexico</p> <p>Description: Original release photo from 5/4/2026</p>	
<p>Facility: Boone 16 State 2H</p> <p>County: Lea County, New Mexico</p> <p>Description: Original release photo from 5/4/2026</p>	

Facility: Boone 16 State 2H

County: Lea County, New Mexico

Description: View facing North. Lined area South of production tanks



Facility: Boone 16 State 2H

County: Lea County, New Mexico

Description: View facing North. Lined area South of production tanks



Facility: Boone 16 State 2H

County: Lea County, New Mexico

Description: View facing North. Lined area South of production tanks



Facility: Boone 16 State 2H

County: Lea County, New Mexico

Description: View facing North. Lined area South of production tanks



Facility: Boone 16 State 2H

County: Lea County, New Mexico

Description: View facing North. Lined area South of production tanks



Facility: Boone 16 State 2H

County: Lea County, New Mexico

Description: View facing North. Lined area South of production tanks



<p>Facility: Boone 16 State 2H</p> <p>County: Lea County, New Mexico</p> <p>Description: View facing North. Lined area West of production tanks</p>	<p>Date & Time: Fri, Jun 12, 2026 at 07:04:23 MDT Position: +032.472232° E -103.570034° W (+12.5ft) Altitude: 3763ft (+9.8ft) Datum: WGS-84 Azimuth/Bearing: 358° N02W 534mils True (+10°) Elevation Angle: -22.9° Horizon Angle: -00.5° Zoom: 0.5X Boone 16 State 2H</p> 
<p>Facility: Boone 16 State 2H</p> <p>County: Lea County, New Mexico</p> <p>Description: View facing North. Lined area East of production tanks</p>	<p>Date & Time: Fri, Jun 12, 2026 at 07:04:47 MDT Position: +032.472242° E -103.57009° W (+15.6ft) Altitude: 3763ft (+9.8ft) Datum: WGS-84 Azimuth/Bearing: 009° N09E 0160mils True (+10°) Elevation Angle: -16.7° Horizon Angle: -00.9° Zoom: 0.5X Boone 16 State 2H</p> 
<p>Facility: Boone 16 State 2H</p> <p>County: Lea County, New Mexico</p> <p>Description: View facing West. Lined area between production tanks.</p>	<p>Date & Time: Fri, Jun 12, 2026 at 07:04:54 MDT Position: +032.472265° E -103.570011° W (+16.5ft) Altitude: 3763ft (+9.8ft) Datum: WGS-84 Azimuth/Bearing: 282° N78W 5013mils True (+10°) Elevation Angle: -27.8° Horizon Angle: -00.7° Zoom: 0.5X Boone 16 State 2H</p> 

Facility: Boone 16 State 2H

County: Lea County, New Mexico

Description: View facing North. Lined area West of production tanks.



Facility: Boone 16 State 2H

County: Lea County, New Mexico

Description: View facing North. Lined area East of production tanks



Facility: Boone 16 State 2H

County: Lea County, New Mexico

Description: View facing West. Lined area between production tanks.



Facility: Boone 16 State 2H

County: Lea County, New Mexico

Description: View facing North. Lined area West of production tanks



Facility: Boone 16 State 2H

County: Lea County, New Mexico

Description: View facing North. Lined area East of production tanks



Facility: Boone 16 State 2H

County: Lea County, New Mexico

Description: View facing West. Lined area between production tanks.



Facility: Boone 16 State 2H

County: Lea County, New Mexico

Description: View facing North. Lined area West of production tanks



Facility: Boone 16 State 2H

County: Lea County, New Mexico

Description: View facing North. Lined area East of production tanks



Facility: Boone 16 State 2H

County: Lea County, New Mexico

Description: View facing West. Lined area between production tanks.



<p>Facility: Boone 16 State 2H</p> <p>County: Lea County, New Mexico</p> <p>Description: View facing North. Lined area West of production tanks</p>	<p>Date & Time: Fri, Jun 12, 2026 at 07:07:51 MDT Position: +032.6724582°E -103.5730445°W (+21.7ft) Altitude: 3762ft (+9.8ft) Datum: WGS-84 Azimuth/Bearing: 026° N24E 0429mils True (+10°) Elevation Angle: -25.5° Horizon Angle: -00.2° Zoom: 0.5X Boone 16 State 2H</p> 
<p>Facility: Boone 16 State 2H</p> <p>County: Lea County, New Mexico</p> <p>Description: View facing North. Lined area East of production tanks</p>	<p>Date & Time: Fri, Jun 12, 2026 at 07:08:23 MDT Position: +032.6724581°E -103.5729860°W (+8.9ft) Altitude: 3762ft (+9.8ft) Datum: WGS-84 Azimuth/Bearing: 003° N03E 0053mils True (+12°) Elevation Angle: -21.4° Horizon Angle: -00.1° Zoom: 0.5X Boone 16 State 2H</p> 
<p>Facility: Boone 16 State 2H</p> <p>County: Lea County, New Mexico</p> <p>Description: View facing West. Lined area North of production tanks</p>	<p>Date & Time: Fri, Jun 12, 2026 at 07:08:35 MDT Position: +032.6724802°E -103.5729880°W (+18.5ft) Altitude: 3765ft (+10.5ft) Datum: WGS-84 Azimuth/Bearing: 205° N85W 4889mils True (+10°) Elevation Angle: -20.8° Horizon Angle: -00.0° Zoom: 0.5X Boone 16 State 2H</p> 

Appendix C: Site Characterization and Ground Water



New Mexico Office of the State Engineer

Water Column/Average Depth to Water

(A CLW##### in the POD suffix indicates the POD has been replaced & no longer serves a water right file.)

(R=POD has been replaced, O=orphaned, C=the file is closed)

(quarters are smallest to largest)

(meters)

(In feet)

POD Number	Code	Sub basin	County	Q64	Q16	Q4	Sec	Tws	Range	X	Y	Map	Distance	Well Depth	Depth Water	Water Column
CP 00601 POD1	R	CP	LE		NE	NW	28	21S	33E	633502.0	3591791.0 *		1936	223		
CP 01880 POD1		CP	LE	SW	SE	SE	20	21S	33E	632561.5	3592129.3		2055			

Average Depth to Water: **0 feet**

Minimum Depth: **0 feet**

Maximum Depth: **0 feet**

Record Count: 2

Basin/County Search:

County: LE

UTM Filters (in meters):

Easting: 633905.78

Northing: 3593684.75

Radius: 2100

* UTM location was derived from PLSS - see Help

The data is furnished by the NMOSE/ISC and is accepted by the recipient with the expressed understanding that the OSE/ISC make no warranties, expressed or implied, concerning the accuracy, completeness, reliability, usability, or suitability for any particular purpose of the data.



WELL RECORD & LOG

OFFICE OF THE STATE ENGINEER

www.ose.state.nm.us

1. GENERAL AND WELL LOCATION	OSE POD NO. (WELL NO.) POD1 (TW-1)		WELL TAG ID NO. n/a		OSE FILE NO(S). CP-1880			
	WELL OWNER NAME(S) Advanced Energy Partners				PHONE (OPTIONAL) 832.672.4700			
	WELL OWNER MAILING ADDRESS 11490 Westheimer Rd. Stuit 950				CITY Houston	STATE TX	ZIP 77077	
	WELL LOCATION (FROM GPS)	LATITUDE	DEGREES 32	MINUTES 27	SECONDS 30.43	N	* ACCURACY REQUIRED: ONE TENTH OF A SECOND * DATUM REQUIRED: WGS 84	
	LONGITUDE	103	35	22.44	W			
DESCRIPTION RELATING WELL LOCATION TO STREET ADDRESS AND COMMON LANDMARKS - PLSS (SECTION, TOWNSHIP, RANGE) WHERE AVAILABLE SE SE NE Sec. 30 T21S R33E								
2. DRILLING & CASING INFORMATION	LICENSE NO. 1249		NAME OF LICENSED DRILLER Jackie D. Atkins			NAME OF WELL DRILLING COMPANY Atkins Engineering Associates, Inc.		
	DRILLING STARTED 10/08/2021	DRILLING ENDED 10/08/2021	DEPTH OF COMPLETED WELL (FT) temporary well material	BORE HOLE DEPTH (FT) 105	DEPTH WATER FIRST ENCOUNTERED (FT) n/a			
	COMPLETED WELL IS: <input type="checkbox"/> ARTESIAN <input checked="" type="checkbox"/> DRY HOLE <input type="checkbox"/> SHALLOW (UNCONFINED)					STATIC WATER LEVEL IN COMPLETED WELL (FT) n/a		
	DRILLING FLUID: <input type="checkbox"/> AIR <input type="checkbox"/> MUD ADDITIVES - SPECIFY:							
	DRILLING METHOD: <input type="checkbox"/> ROTARY <input type="checkbox"/> HAMMER <input type="checkbox"/> CABLE TOOL <input checked="" type="checkbox"/> OTHER - SPECIFY: Hollow Stem Auger							
	DEPTH (feet bgl)		BORE HOLE DIAM (inches)	CASING MATERIAL AND/OR GRADE (include each casing string, and note sections of screen)	CASING CONNECTION TYPE (add coupling diameter)	CASING INSIDE DIAM. (inches)	CASING WALL THICKNESS (inches)	SLOT SIZE (inches)
	FROM	TO						
	0	105	±6.5	Boring- HSA	-	-	-	-
3. ANNULAR MATERIAL	DEPTH (feet bgl)		BORE HOLE DIAM. (inches)	LIST ANNULAR SEAL MATERIAL AND GRAVEL PACK SIZE-RANGE BY INTERVAL	AMOUNT (cubic feet)	METHOD OF PLACEMENT		
	FROM	TO						

FOR OSE INTERNAL USE				WR-20 WELL RECORD & LOG (Version 06/30/17)			
FILE NO.	CP-1880	POD NO.	1	TRN NO.	609464		
LOCATION	21S. 33E. 20. 443			WELL TAG ID NO.	PAGE 1 OF 2		



Neatest Water Well Map

COG Operating, LLC
Boone 16 State 2H
Lea County, New Mexico
32.472211, -103.575047



Karst Map

COG Operating, LLC
Boone 16 State 2H
Lea County, New Mexico
32.472211, -103.575047



Hydrology Map

COG Operating, LLC
Boone 16 State 2H
Lea County, New Mexico
32.472211, -103.575047

Sante Fe Main Office
Phone: (505) 476-3441

General Information
Phone: (505) 629-6116

Online Phone Directory
<https://www.emnrd.nm.gov/ocd/contact-us>

State of New Mexico
Energy, Minerals and Natural Resources
Oil Conservation Division
1220 S. St Francis Dr.
Santa Fe, NM 87505

QUESTIONS

Action 595464

QUESTIONS

Operator: COG OPERATING LLC 600 W Illinois Ave Midland, TX 79701	OGRID: 229137
	Action Number: 595464
	Action Type: [C-141] Remediation Closure Request C-141 (C-141-v-Closure)

QUESTIONS

Prerequisites	
Incident ID (n#)	nAPP2612526852
Incident Name	NAPP2612526852 BOONE 16 STATE 2H @ O-16-21S-33E
Incident Type	Other
Incident Status	Remediation Closure Report Received

Location of Release Source	
<i>Please answer all the questions in this group.</i>	
Site Name	Boone 16 State 2H
Date Release Discovered	05/04/2026
Surface Owner	Private

Incident Details	
<i>Please answer all the questions in this group.</i>	
Incident Type	Other
Did this release result in a fire or is the result of a fire	No
Did this release result in any injuries	No
Has this release reached or does it have a reasonable probability of reaching a watercourse	No
Has this release endangered or does it have a reasonable probability of endangering public health	No
Has this release substantially damaged or will it substantially damage property or the environment	No
Is this release of a volume that is or may with reasonable probability be detrimental to fresh water	No

Nature and Volume of Release	
<i>Material(s) released, please answer all that apply below. Any calculations or specific justifications for the volumes provided should be attached to the follow-up C-141 submission.</i>	
Crude Oil Released (bbls) Details	Cause: Overflow - Tank, Pit, Etc. Tank (Any) Crude Oil Released: 0 BBL Recovered: 0 BBL Lost: 0 BBL.
Produced Water Released (bbls) Details	Cause: Overflow - Tank, Pit, Etc. Tank (Any) Produced Water Released: 47 BBL Recovered: 45 BBL Lost: 2 BBL.
Is the concentration of chloride in the produced water >10,000 mg/l	Yes
Condensate Released (bbls) Details	Not answered.
Natural Gas Vented (Mcf) Details	Not answered.
Natural Gas Flared (Mcf) Details	Not answered.
Other Released Details	Not answered.
Are there additional details for the questions above (i.e. any answer containing Other, Specify, Unknown, and/or Fire, or any negative lost amounts)	Not answered.

Sante Fe Main Office
Phone: (505) 476-3441

General Information
Phone: (505) 629-6116

Online Phone Directory
<https://www.emnrd.nm.gov/ocd/contact-us>

State of New Mexico
Energy, Minerals and Natural Resources
Oil Conservation Division
1220 S. St Francis Dr.
Santa Fe, NM 87505

QUESTIONS, Page 2

Action 595464

QUESTIONS (continued)

Operator: COG OPERATING LLC 600 W Illinois Ave Midland, TX 79701	OGRID: 229137
	Action Number: 595464
	Action Type: [C-141] Remediation Closure Request C-141 (C-141-v-Closure)

QUESTIONS

Nature and Volume of Release (continued)	
Is this a gas only submission (i.e. only significant Mcf values reported)	No, according to supplied volumes this does not appear to be a "gas only" report.
Was this a major release as defined by Subsection A of 19.15.29.7 NMAC	Yes
Reasons why this would be considered a submission for a notification of a major release	From paragraph A. "Major release" determine using: (1) an unauthorized release of a volume, excluding gases, of 25 barrels or more.
<i>With the implementation of the 19.15.27 NMAC (05/25/2021), venting and/or flaring of natural gas (i.e. gas only) are to be submitted on the C-129 form.</i>	

Initial Response

The responsible party must undertake the following actions immediately unless they could create a safety hazard that would result in injury.

The source of the release has been stopped	True
The impacted area has been secured to protect human health and the environment	True
Released materials have been contained via the use of berms or dikes, absorbent pads, or other containment devices	True
All free liquids and recoverable materials have been removed and managed appropriately	True
If all the actions described above have not been undertaken, explain why	Full release was within a lined facility

Per Paragraph (4) of Subsection B of 19.15.29.8 NMAC the responsible party may commence remediation immediately after discovery of a release. If remediation has begun, please prepare and attach a narrative of actions to date in the follow-up C-141 submission. If remedial efforts have been successfully completed or if the release occurred within a lined containment area (see Subparagraph (a) of Paragraph (5) of Subsection A of 19.15.29.11 NMAC), please prepare and attach all information needed for closure evaluation in the follow-up C-141 submission.

I hereby certify that the information given above is true and complete to the best of my knowledge and understand that pursuant to OCD rules and regulations all operators are required to report and/or file certain release notifications and perform corrective actions for releases which may endanger public health or the environment. The acceptance of a C-141 report by the OCD does not relieve the operator of liability should their operations have failed to adequately investigate and remediate contamination that pose a threat to groundwater, surface water, human health or the environment. In addition, OCD acceptance of a C-141 report does not relieve the operator of responsibility for compliance with any other federal, state, or local laws and/or regulations.

I hereby agree and sign off to the above statement	Name: Jacob Laird Title: Environmental Engineer Email: jacob.laird@conocophillips.com Date: 06/15/2026
--	---

Sante Fe Main Office
Phone: (505) 476-3441

General Information
Phone: (505) 629-6116

Online Phone Directory
<https://www.emnrd.nm.gov/ocd/contact-us>

State of New Mexico
Energy, Minerals and Natural Resources
Oil Conservation Division
1220 S. St Francis Dr.
Santa Fe, NM 87505

QUESTIONS, Page 3

Action 595464

QUESTIONS (continued)

Operator: COG OPERATING LLC 600 W Illinois Ave Midland, TX 79701	OGRID: 229137
	Action Number: 595464
	Action Type: [C-141] Remediation Closure Request C-141 (C-141-v-Closure)

QUESTIONS

Site Characterization	
<i>Please answer all the questions in this group (only required when seeking remediation plan approval and beyond). This information must be provided to the appropriate district office no later than 90 days after the release discovery date.</i>	
What is the shallowest depth to groundwater beneath the area affected by the release in feet below ground surface (ft bgs)	Between 100 and 500 (ft.)
What method was used to determine the depth to ground water	NM OSE iWaters Database Search
Did this release impact groundwater or surface water	No
What is the minimum distance, between the closest lateral extents of the release and the following surface areas:	
A continuously flowing watercourse or any other significant watercourse	Between 500 and 1000 (ft.)
Any lakebed, sinkhole, or playa lake (measured from the ordinary high-water mark)	Between 1 and 5 (mi.)
An occupied permanent residence, school, hospital, institution, or church	Greater than 5 (mi.)
A spring or a private domestic fresh water well used by less than five households for domestic or stock watering purposes	Between 1 and 5 (mi.)
Any other fresh water well or spring	Between 1 and 5 (mi.)
Incorporated municipal boundaries or a defined municipal fresh water well field	Greater than 5 (mi.)
A wetland	Between 500 and 1000 (ft.)
A subsurface mine	Greater than 5 (mi.)
An (non-karst) unstable area	Greater than 5 (mi.)
Categorize the risk of this well / site being in a karst geology	Low
A 100-year floodplain	Between 500 and 1000 (ft.)
Did the release impact areas not on an exploration, development, production, or storage site	No

Remediation Plan	
<i>Please answer all the questions that apply or are indicated. This information must be provided to the appropriate district office no later than 90 days after the release discovery date.</i>	
Requesting a remediation plan approval with this submission	Yes
<i>Attach a comprehensive report demonstrating the lateral and vertical extents of soil contamination associated with the release have been determined, pursuant to 19.15.29.11 NMAC and 19.15.29.13 NMAC.</i>	
Have the lateral and vertical extents of contamination been fully delineated	Yes
Was this release entirely contained within a lined containment area	Yes
<i>Per Subsection B of 19.15.29.11 NMAC unless the site characterization report includes completed efforts at remediation, the report must include a proposed remediation plan in accordance with 19.15.29.12 NMAC, which includes the anticipated timelines for beginning and completing the remediation.</i>	
On what estimated date will the remediation commence	06/09/2026
On what date will (or did) the final sampling or liner inspection occur	06/12/2026
On what date will (or was) the remediation complete(d)	06/12/2026
What is the estimated surface area (in square feet) that will be remediated	4591
What is the estimated volume (in cubic yards) that will be remediated	0
<i>These estimated dates and measurements are recognized to be the best guess or calculation at the time of submission and may (be) change(d) over time as more remediation efforts are completed.</i>	
<i>The OCD recognizes that proposed remediation measures may have to be minimally adjusted in accordance with the physical realities encountered during remediation. If the responsible party has any need to significantly deviate from the remediation plan proposed, then it should consult with the division to determine if another remediation plan submission is required.</i>	

Sante Fe Main Office
Phone: (505) 476-3441

General Information
Phone: (505) 629-6116

Online Phone Directory
<https://www.emnrd.nm.gov/ocd/contact-us>

State of New Mexico
Energy, Minerals and Natural Resources
Oil Conservation Division
1220 S. St Francis Dr.
Santa Fe, NM 87505

QUESTIONS, Page 4

Action 595464

QUESTIONS (continued)

Operator: COG OPERATING LLC 600 W Illinois Ave Midland, TX 79701	OGRID: 229137
	Action Number: 595464
	Action Type: [C-141] Remediation Closure Request C-141 (C-141-v-Closure)

QUESTIONS

Remediation Plan (continued)	
<i>Please answer all the questions that apply or are indicated. This information must be provided to the appropriate district office no later than 90 days after the release discovery date.</i>	
This remediation will (or is expected to) utilize the following processes to remediate / reduce contaminants:	
<i>(Select all answers below that apply.)</i>	
Is (or was) there affected material present needing to be removed	Yes
Is (or was) there a power wash of the lined containment area (to be) performed	Yes
OTHER (Non-listed remedial process)	No
<i>Per Subsection B of 19.15.29.11 NMAC unless the site characterization report includes completed efforts at remediation, the report must include a proposed remediation plan in accordance with 19.15.29.12 NMAC, which includes the anticipated timelines for beginning and completing the remediation.</i>	
I hereby certify that the information given above is true and complete to the best of my knowledge and understand that pursuant to OCD rules and regulations all operators are required to report and/or file certain release notifications and perform corrective actions for releases which may endanger public health or the environment. The acceptance of a C-141 report by the OCD does not relieve the operator of liability should their operations have failed to adequately investigate and remediate contamination that pose a threat to groundwater, surface water, human health or the environment. In addition, OCD acceptance of a C-141 report does not relieve the operator of responsibility for compliance with any other federal, state, or local laws and/or regulations.	
I hereby agree and sign off to the above statement	Name: Jacob Laird Title: Environmental Engineer Email: jacob.laird@conocophillips.com Date: 06/15/2026
<i>The OCD recognizes that proposed remediation measures may have to be minimally adjusted in accordance with the physical realities encountered during remediation. If the responsible party has any need to significantly deviate from the remediation plan proposed, then it should consult with the division to determine if another remediation plan submission is required.</i>	

Sante Fe Main Office
Phone: (505) 476-3441

General Information
Phone: (505) 629-6116

Online Phone Directory
<https://www.emnrd.nm.gov/ocd/contact-us>

State of New Mexico
Energy, Minerals and Natural Resources
Oil Conservation Division
1220 S. St Francis Dr.
Santa Fe, NM 87505

QUESTIONS, Page 6

Action 595464

QUESTIONS (continued)

Operator: COG OPERATING LLC 600 W Illinois Ave Midland, TX 79701	OGRID: 229137
	Action Number: 595464
	Action Type: [C-141] Remediation Closure Request C-141 (C-141-v-Closure)

QUESTIONS

Liner Inspection Information	
Last liner inspection notification (C-141L) recorded	593474
Liner inspection date pursuant to Subparagraph (a) of Paragraph (5) of Subsection A of 19.15.29.11 NMAC	06/12/2026
Was all the impacted materials removed from the liner	Yes
What was the liner inspection surface area in square feet	4591

Remediation Closure Request	
<i>Only answer the questions in this group if seeking remediation closure for this release because all remediation steps have been completed.</i>	
Requesting a remediation closure approval with this submission	Yes
Have the lateral and vertical extents of contamination been fully delineated	Yes
Was this release entirely contained within a lined containment area	Yes
What was the total surface area (in square feet) remediated	4591
What was the total volume (cubic yards) remediated	0
Summarize any additional remediation activities not included by answers (above)	NA

The responsible party must attach information demonstrating they have complied with all applicable closure requirements and any conditions or directives of the OCD. This demonstration should be in the form of a comprehensive report (in .pdf format) including a scaled site map, sampling diagrams, relevant field notes, photographs of any excavation prior to backfilling, laboratory data including chain of custody documents of final sampling, and a narrative of the remedial activities. Refer to 19.15.29.12 NMAC.

I hereby certify that the information given above is true and complete to the best of my knowledge and understand that pursuant to OCD rules and regulations all operators are required to report and/or file certain release notifications and perform corrective actions for releases which may endanger public health or the environment. The acceptance of a C-141 report by the OCD does not relieve the operator of liability should their operations have failed to adequately investigate and remediate contamination that pose a threat to groundwater, surface water, human health or the environment. In addition, OCD acceptance of a C-141 report does not relieve the operator of responsibility for compliance with any other federal, state, or local laws and/or regulations. The responsible party acknowledges they must substantially restore, reclaim, and re-vegetate the impacted surface area to the conditions that existed prior to the release or their final land use in accordance with 19.15.29.13 NMAC including notification to the OCD when reclamation and re-vegetation are complete.

I hereby agree and sign off to the above statement	Name: Jacob Laird Title: Environmental Engineer Email: jacob.laird@conocophillips.com Date: 06/15/2026
--	---

Sante Fe Main Office
Phone: (505) 476-3441

General Information
Phone: (505) 629-6116

Online Phone Directory
<https://www.emnrd.nm.gov/ocd/contact-us>

State of New Mexico
Energy, Minerals and Natural Resources
Oil Conservation Division
1220 S. St Francis Dr.
Santa Fe, NM 87505

CONDITIONS

Action 595464

CONDITIONS

Operator: COG OPERATING LLC 600 W Illinois Ave Midland, TX 79701	OGRID: 229137
	Action Number: 595464
	Action Type: [C-141] Remediation Closure Request C-141 (C-141-v-Closure)

CONDITIONS

Created By	Condition	Condition Date
rhamlet	We have received your Remediation Closure Report for Incident #nAPP2612526852 Boone 16 State 2H, thank you. This Remediation Closure Report is approved.	6/15/2026