

**District I**  
1625 N. French Dr., Hobbs, NM 88240  
Phone:(575) 393-8161 Fax:(575) 393-0720  
**District II**  
811 S. First St., Artesia, NM 88210  
Phone:(575) 748-1283 Fax:(575) 748-9720  
**District III**  
1000 Rio Brazos Rd., Aztec, NM 87410  
Phone:(505) 334-8178 Fax:(505) 334-8170  
**District IV**  
1220 S. St Francis Dr., Santa Fe, NM 87505  
Phone:(505) 476-3470 Fax:(505) 476-3482

**State of New Mexico**  
**Energy, Minerals and Natural Resources**  
**Oil Conservation Division**  
**1220 S. St Francis Dr.**  
**Santa Fe, NM 87505**

Form C-101  
August 1, 2011  
Permit 195079

**APPLICATION FOR PERMIT TO DRILL, RE-ENTER, DEEPEN, PLUGBACK, OR ADD A ZONE**

1. Operator Name and Address APACHE CORP 303 Veterans Airpark Lane Midland, TX 79705		2. OGRID Number 873
4. Property Code 22503		3. API Number 30-025-42238
5. Property Name NORTHEAST DRINKARD UNIT		6. Well No. 556

**7. Surface Location**

UL - Lot	A	Section	15	Township	21S	Range	37E	Lot Idn	Feet From	570	N/S Line	N	Feet From	1300	E/W Line	E	County	Lea
----------	---	---------	----	----------	-----	-------	-----	---------	-----------	-----	----------	---	-----------	------	----------	---	--------	-----

**8. Proposed Bottom Hole Location**

UL - Lot	A	Section	15	Township	21S	Range	37E	Lot Idn	A	Feet From	570	N/S Line	N	Feet From	1300	E/W Line	E	County	Lea
----------	---	---------	----	----------	-----	-------	-----	---------	---	-----------	-----	----------	---	-----------	------	----------	---	--------	-----

**9. Pool Information**

EUNICE,BLI-TU-DR, NORTH	22900
-------------------------	-------

**Additional Well Information**

11. Work Type New Well	12. Well Type OIL	13. Cable/Rotary	14. Lease Type State	15. Ground Level Elevation 3441
16. Multiple N	17. Proposed Depth 7450	18. Formation Drinkard	19. Contractor	20. Spud Date
Depth to Ground water		Distance from nearest fresh water well		Distance to nearest surface water

☒ We will be using a closed-loop system in lieu of lined pits

**21. Proposed Casing and Cement Program**

Type	Hole Size	Casing Size	Casing Weight/ft	Setting Depth	Sacks of Cement	Estimated TOC
Surf	11	8.625	24	1297	475	
Prod	7.875	5.5	17	7450	1250	

**Casing/Cement Program: Additional Comments**

--

**22. Proposed Blowout Prevention Program**

Type	Working Pressure	Test Pressure	Manufacturer
Hydril	3000	2000	

23. I hereby certify that the information given above is true and complete to the best of my knowledge and belief. I further certify I have complied with 19.15.14.9 (A) NMAC <input checked="" type="checkbox"/> and/or 19.15.14.9 (B) NMAC <input checked="" type="checkbox"/> , if applicable.  Signature: _____ Printed Name: Electronically filed by Bobby Smith Title: _____ Email Address: bobby.smith@apachecorp.com Date: 11/4/2014	<div style="text-align: center;"><b>OIL CONSERVATION DIVISION</b></div> Approved By: Paul Kautz Title: Geologist Approved Date: 11/5/2014 Expiration Date: 11/5/2016 Conditions of Approval Attached
---	--

District I  
1625 N. French Dr., Hobbs, NM 88240  
Phone: (575) 393-6161 Fax: (575) 393-0720  
District II  
811 S. First St., Artesia, NM 88210  
Phone: (575) 748-1283 Fax: (575) 748-9720  
District III  
1000 Rio Brazos Road, Aztec, NM 87410  
Phone: (505) 334-6178 Fax: (505) 334-6170  
District IV  
1220 S. St. Francis Dr., Santa Fe, NM 87505  
Phone: (505) 476-3460 Fax: (505) 476-3462

State of New Mexico  
Energy, Minerals & Natural Resources Department  
OIL CONSERVATION DIVISION  
1220 South St. Francis Dr.  
Santa Fe, NM 87505

Form C-102  
Revised August 1, 2011  
Submit one copy to  
appropriate  
District Office

☐ AMENDED REPORT

WELL LOCATION AND ACREAGE DEDICATION PLAT

1 API Number <b>30-025-</b>	2 Pool Code <b>22900</b>	3 Pool Name <b>Eunice; BLI - TU - DR North</b>
4 Property Code <b>22503</b>	5 Property Name <b>NORTH EAST DRINKARD UNIT</b>	
6 Well Number <b>#556</b>	7 OGRID No. <b>873</b>	
8 Operator Name <b>APACHE CORPORATION</b>		9 Elevation <b>3441.59</b>

10 Surface Location

UL or lot no.	Section	Township	Range	Lot Idn	Feet from the	North/South line	Feet from the	East/West line	County
1	15	21 S	37 E		570	NORTH	1,300	EAST	LEA

11 Bottom Hole Location If Different From Surface

UL or lot no.	Section	Township	Range	Lot Idn	Feet from the	North/South line	Feet from the	East/West line	County

No allowable will be assigned to this completion until all interests have been consolidated or a non-standard unit has been approved by the division.

SECTION 15, TOWNSHIP 21 SOUTH, RANGE 37 EAST P.M.

<p>FOUND 1/2 INCH IRON ROD, CAPPED</p> <p>LAT: 32.455889 N LONG: -103.158798 W NAD83 E: 542471.386 NAD83 E: 862177.373 (N.A.D. 27)</p> <p>LAT: 32.456010 N LONG: -103.158269 W NAD83 E: 542533.491 NAD83 E: 862361.479 (N.A.D. 83)</p>		<p>SURFACE LOCATION</p> <p>DD LAT: 32.454346 N DD LONG: -103.145907 W DMS LAT: 32°27'15.645" N DMS LONG: 103°08'45.264" W NAD83 E: 541955.583 NAD83 E: 868159.016 (N.A.D. 27)</p> <p>DD LAT: 32.454486 N DD LONG: -103.146377 W DMS LAT: 32°27'04.678" N DMS LONG: 103°08'46.957" W NAD83 E: 542015.833 NAD83 E: 867343.139 (N.A.D. 83)</p>		<p>FOUND SPIKE NAIL IN STONE MOUND</p> <p>LAT: 32.455889 N LONG: -103.141692 W NAD83 E: 542543.162 NAD83 E: 867450.319 (N.A.D. 27)</p> <p>LAT: 32.456040 N LONG: -103.142103 W NAD83 E: 542602.915 NAD83 E: 868536.387 (N.A.D. 83)</p>		<p>17 OPERATOR CERTIFICATION</p> <p>I hereby certify that the information contained herein is true and complete to the best of my knowledge and belief, and that this organization either owns a working interest or unleased mineral interest in the land including the proposed bottom hole location or has a right to drill this well at this location pursuant to a contract with an owner of such a mineral or working interest, or to a voluntary pooling agreement or a compulsory pooling order heretofore entered by the division.</p> <p>Signature: <u>Michelle Cooper</u> Date: <u>11-4-14</u></p> <p>Printed Name: <u>Michelle Cooper</u></p> <p>E-mail Address: <u>michelle.cooper@apachecorp.com</u></p>	
<p>FOUND 3/8 INCH IRON ROD, CAPPED</p> <p>LAT: 32.471381 N LONG: -103.158661 W NAD83 E: 537195.739 NAD83 E: 862577.682 (N.A.D. 27)</p> <p>LAT: 32.471580 N LONG: -103.160131 W NAD83 E: 537252.732 NAD83 E: 863461.939 (N.A.D. 83)</p>		<p>FOUND 2" IRON PIPE, DISTURBED</p> <p>LAT: 32.471405 N LONG: -103.141684 W NAD83 E: 537262.309 NAD83 E: 867513.885 (N.A.D. 27)</p> <p>LAT: 32.471525 N LONG: -103.142154 W NAD83 E: 537321.985 NAD83 E: 868656.104 (N.A.D. 83)</p>		<p>18 SURVEYOR CERTIFICATION</p> <p>I hereby certify that the well location shown on this plat was plotted from field notes of actual surveys made by me or under my supervision, and that the same is true and correct to the best of my belief.</p> <p>10-02-2014</p> <p>Date of Survey</p> <p>Signature and Seal of Professional Surveyor</p> <p><u>Jeffery E. Hudson</u></p> <p>Certificate Number: <u>20559</u></p>			

# LEA COUNTY, NEW MEXICO

SECTION FIFTEEN (15), TOWNSHIP TWENTY-ONE (21) SOUTH,  
RANGE THIRTY-SEVEN (37) EAST OF THE PRINCIPAL MERIDIAN

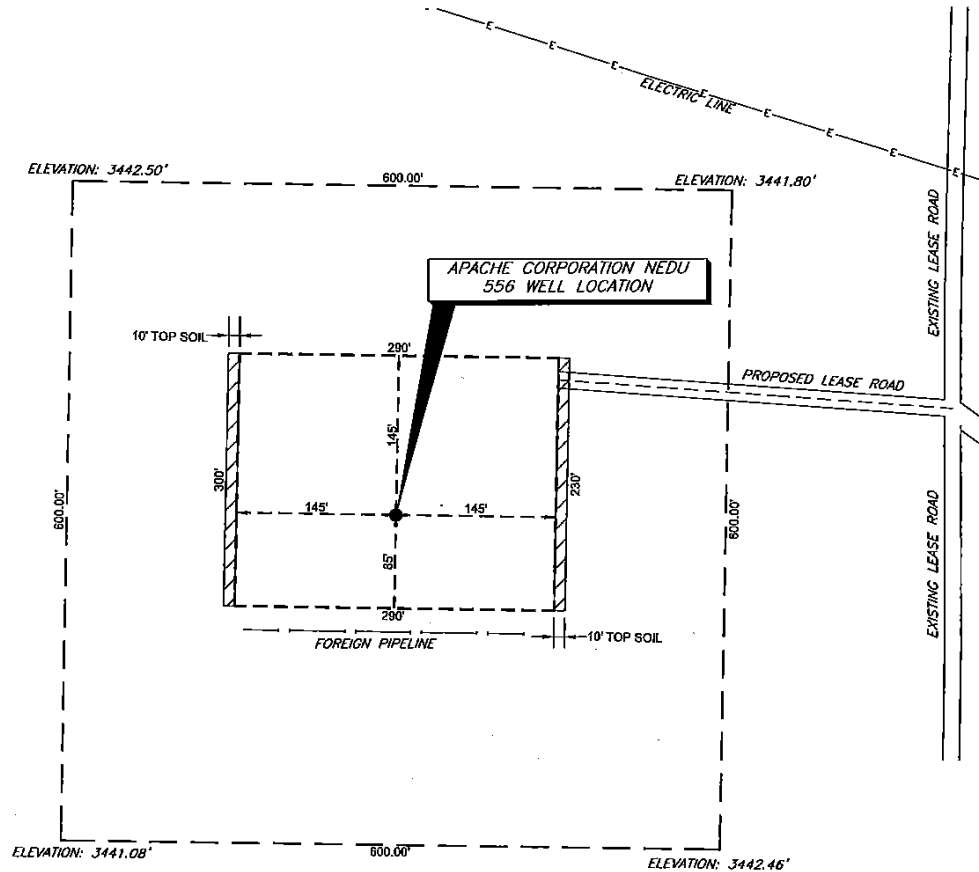

COORDINATE TABLE				
WELL NAME	NORTHING (N.A.D. 27)	EASTING (N.A.D. 27)	NORTHING (N.A.D. 83)	EASTING (N.A.D. 83)
NEDU 556 SURFACE LOCATION & PENETRATION POINT	541955.983	866159.046	542015.833	907343.139
ELEVATION	LATITUDE (N.A.D. 27)	LONGITUDE (N.A.D. 27)	LATITUDE (N.A.D. 83)	LONGITUDE (N.A.D. 83)
3441.59'	32.484346 N	-103.145907 W	32.484466 N	-103.146377 W

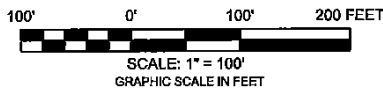

PREPARED FROM SURVEY  
DATED: OCTOBER 2, 2014

## NOTES:

1.) BEARINGS & COORDINATES SHOWN HEREON ARE REFERENCED TO THE NEW MEXICO STATE PLANE COORDINATE SYSTEM, N.A.D. 27 & 83 DATUM (NEW MEXICO EAST ZONE) DERIVED FROM GPS OBSERVATIONS AND ARE BASED REFERENCE STATIONS - "E 148" - MALJAMAR NE (1088)

2.) LATITUDE & LONGITUDE ARE NAD 83 & 27 GEOGRAPHIC.

3.) THIS IS AN WELL PLAT AND DOES NOT REPRESENT A TRUE BOUNDARY SURVEY. THIS SURVEY IS BASED ON OWNERSHIP AND EASEMENT INFORMATION PROVIDED BY APACHE CORPORATION. SURVEYOR DID NOT ABSTRACT SUBJECT TRACT AND THERE MAY BE EASEMENTS OR OTHER ENCUMBRANCES THAT AFFECT THE SUBJECT TRACT THAT ARE NOT SHOWN HEREON.



8205 Camp Bowls West, Suite 204  
Fort Worth, Texas 76116  
(817) 369-0362 ~ Fax (817) 224-3377

THE NEDU 556 WELL LOCATION IS LOCATED  
APPROXIMATELY 3.32 MILES SOUTH-SOUTHWEST OF  
EUNICE, NEW MEXICO

# Apache

Location of

NORTH EAST DRINKARD UNIT #556

Surface Location & Penetration Point: 670' FNL & 1300' FEL

Section 15, Township 21 South, Range 37 East of P.M.

Lea County, New Mexico

DRAWN BY: K.C.N.	DATE: 10-8-14	DWG. NO.	REV.
CHECKED BY:	DATE:	NEDU 556-140827 WELL LOCATION	0
SCALE: 1" = 100'	APP:	PAGE 1 OF 1	

**District I**  
1625 N. French Dr., Hobbs, NM 88240  
Phone:(575) 393-6161 Fax:(575) 393-0720  
**District II**  
811 S. First St., Artesia, NM 88210  
Phone:(575) 748-1283 Fax:(575) 748-9720  
**District III**  
1000 Rio Brazos Rd., Aztec, NM 87410  
Phone:(505) 334-6178 Fax:(505) 334-6170  
**District IV**  
1220 S. St Francis Dr., Santa Fe, NM 87505  
Phone:(505) 476-3470 Fax:(505) 476-3482

**State of New Mexico**  
**Energy, Minerals and Natural Resources**  
**Oil Conservation Division**  
**1220 S. St Francis Dr.**  
**Santa Fe, NM 87505**

Form APD Comments

Permit 195079

**PERMIT COMMENTS**

Operator Name and Address: APACHE CORP [873] 303 Veterans Airpark Lane Midland, TX 79705	API Number: 30-025-42238
	Well: NORTHEAST DRINKARD UNIT #556

Created By	Comment	Comment Date
------------	---------	--------------

**District I**  
 1625 N. French Dr., Hobbs, NM 88240  
 Phone:(575) 393-8161 Fax:(575) 393-0720  
**District II**  
 811 S. First St., Artesia, NM 88210  
 Phone:(575) 748-1283 Fax:(575) 748-9720  
**District III**  
 1000 Rio Brazos Rd., Aztec, NM 87410  
 Phone:(505) 334-6178 Fax:(505) 334-6170  
**District IV**  
 1220 S. St Francis Dr., Santa Fe, NM 87505  
 Phone:(505) 476-3470 Fax:(505) 476-3462

**State of New Mexico**  
**Energy, Minerals and Natural Resources**  
**Oil Conservation Division**  
**1220 S. St Francis Dr.**  
**Santa Fe, NM 87505**

Form APD Conditions

Permit 195079

**PERMIT CONDITIONS OF APPROVAL**

Operator Name and Address: APACHE CORP [873] 303 Veterans Airpark Lane Midland, TX 79705	API Number: 30-025-42238
	Well: NORTHEAST DRINKARD UNIT #556

OCD Reviewer	Condition
pkautz	Once the well is spud, to prevent ground water contamination through whole or partial conduits from the surface, the operator shall drill without interruption through the fresh water zone or zones and shall immediately set in cement the water protection string
pkautz	If using a pit for drilling and completion operations, must have an approved pit from prior to spudding the well.
pkautz	SURFACE & PRODUCTION CASING - Cement must circulate to surface
pkautz	If cement does not circulate to surface, must run temperature survey or other log to determine top of cement
pkautz	Surface casing must be set 25' below top of Rustler Anhydrite in order to seal off protectable water