

District I  
1625 N. French Dr., Hobbs, NM 88240  
District II  
811 S. First St., Artesia, NM 88210  
District III  
1000 Rio Brazos Rd., Aztec, NM 87410  
District IV  
1220 S. St. Francis Dr., Santa Fe, NM 87505

State of New Mexico  
Energy, Minerals & Natural Resources

Form C-104  
Revised August 1, 2011

Oil Conservation Division  
1220 South St. Francis Dr.  
Santa Fe, NM 87505

Submit one copy to appropriate District Office

AMENDED REPORT

**I. REQUEST FOR ALLOWABLE AND AUTHORIZATION TO TRANSPORT**

<sup>1</sup> Operator name and Address Avant Operating, LLC 1515 Wynoop Street, Ste. 700 Denver CO 80202		<sup>2</sup> OGRID Number 330396
		<sup>3</sup> Reason for Filing Code/ Effective Date RT 2/18/22
<sup>4</sup> API Number 30 - 0 25-49365	<sup>5</sup> Pool Name Antelope Ridge; Bone Spring, North	<sup>6</sup> Pool Code 2205
<sup>7</sup> Property Code 331355	<sup>8</sup> Property Name Golden Tee 31 Federal Com	<sup>9</sup> Well Number 501H

**II. <sup>10</sup> Surface Location**

UL or lot no.	Section	Township	Range	Lot Idn	Feet from the	North/South Line	Feet from the	East/West line	County
D	31	22S	35E	1	210	North	1200	West	Lea

**<sup>11</sup> Bottom Hole Location**

UL or lot no.	Section	Township	Range	Lot Idn	Feet from the	North/South line	Feet from the	East/West line	County
E	6	23S	35E	5	2578	North	484	West	Lea
<sup>12</sup> Lse Code F	<sup>13</sup> Producing Method Code F	<sup>14</sup> Gas Connection Date 2/18/22	<sup>15</sup> C-129 Permit Number	<sup>16</sup> C-129 Effective Date	<sup>17</sup> C-129 Expiration Date				

**III. Oil and Gas Transporters**

<sup>18</sup> Transporter OGRID	<sup>19</sup> Transporter Name and Address	<sup>20</sup> O/G/W
214984	Plains Marketing, L.P. 333 Clay St., Ste. 1900 Houston TX 77002	O
372422	Lucid Energy Delaware, LLC 3100 McKinnon, Ste. 800 Dallas TX 75201	G

**IV. Well Completion Data**

<sup>21</sup> Spud Date 9/14/21	<sup>22</sup> Ready Date 2/18/22	<sup>23</sup> TD MD: 18,423 TVD: 10,619	<sup>24</sup> PBTD 18,360	<sup>25</sup> Perforations 10,854-18,346	<sup>26</sup> DHC, MC
<sup>27</sup> Hole Size	<sup>28</sup> Casing & Tubing Size	<sup>29</sup> Depth Set	<sup>30</sup> Sacks Cement		
17-1/2	13-3/8	1,891	1,085		
12-1/4	9-5/8	5,629	2,990		
8-3/4	5-1/2	18,408	3,120		

**V. Well Test Data**

<sup>31</sup> Date New Oil	<sup>32</sup> Gas Delivery Date	<sup>33</sup> Test Date	<sup>34</sup> Test Length	<sup>35</sup> Tbg. Pressure	<sup>36</sup> Csg. Pressure
<sup>37</sup> Choke Size	<sup>38</sup> Oil	<sup>39</sup> Water	<sup>40</sup> Gas		<sup>41</sup> Test Method

<sup>42</sup> I hereby certify that the rules of the Oil Conservation Division have been complied with and that the information given above is true and complete to the best of my knowledge and belief.

Signature: *Sandra Belt*

Printed name:  
Sandra Belt

Title:  
Regulatory Analyst

E-mail Address:  
sandra@permanregulatory.com

Date: 2/18/22 Phone: 432-413-9797

OIL CONSERVATION DIVISION

Approved by:



Title: **Engineer**

Approval Date: **04/07/22**

**RT expires on 07/06/22**



Released to Imaging: 4/7/2022 9:04:52 AM

Received by OCD: 2/21/2022 6:30:46 PM

SECTION DETAILS

Sec	MD	Inc	Azi	TVD	+N/-S	+E/-W	Dleg	TFace	VSect	Target	Annotation
1	18371.00	90.86	178.40	10620.06	-7603.29	-664.16	0.000	0.00	7598.47		Last Aim Svy
2	18423.00	90.86	178.40	10619.28	-7655.27	-662.71	0.000	0.00	7650.45		Proj to BHL

Drawn By: KRN  
 Date Created: 9/3/2021  
 Date Revised: 10/03/2021  
 File: Avant - Golden Tee 31  
 Fed Com 501H - Plan 2.0

DESIGN TARGET DETAILS

Name	TVD	+N/-S	+E/-W	Northing	Easting	Latitude	Longitude
FTP GT 31 Fed Com 501H	10500.00	102.70	-720.68	494152.40	825337.14	32° 21' 18.511 N	103° 24' 49.048 W
LTP GT 31 Fed Com 501H	10500.00	-7616.60	-666.87	486433.10	825390.95	32° 20' 2.127 N	103° 24' 49.194 W
PBHL GT 31 Fed Com 501H	10500.00	-7616.60	-666.87	486433.10	825390.95	32° 20' 2.127 N	103° 24' 49.194 W

SITE DETAILS: Golden Tee 31 Fed Com 501H

Site Centre Northing: 494049.70  
 Easting: 826057.82

Positional Uncertainty: 0.00  
 Convergence: 0.49  
 Local North: Grid

PROJECT DETAILS: Lea Co., NM (NAD 83)

Geodetic System: US State Plane 1983  
 Datum: North American Datum 1983  
 Ellipsoid: GRS 1980  
 Zone: New Mexico Eastern Zone

System Datum: Mean Sea Level

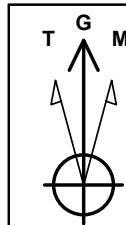

Azimuths to Grid North  
 True North: -0.49°  
 Magnetic North: 5.96°

Magnetic Field  
 Strength: 47775.1nT  
 Dip Angle: 59.98°  
 Date: 9/1/2021  
 Model: MVHD

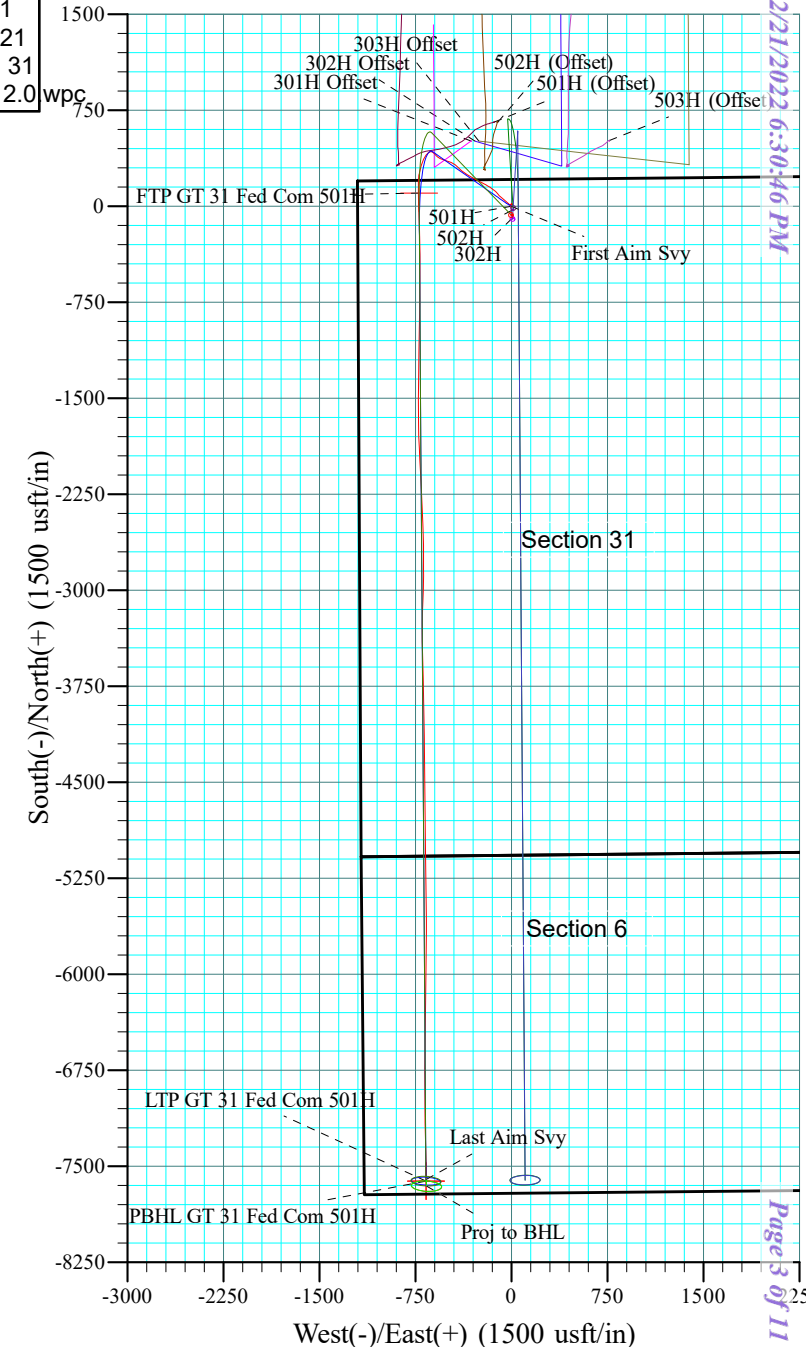
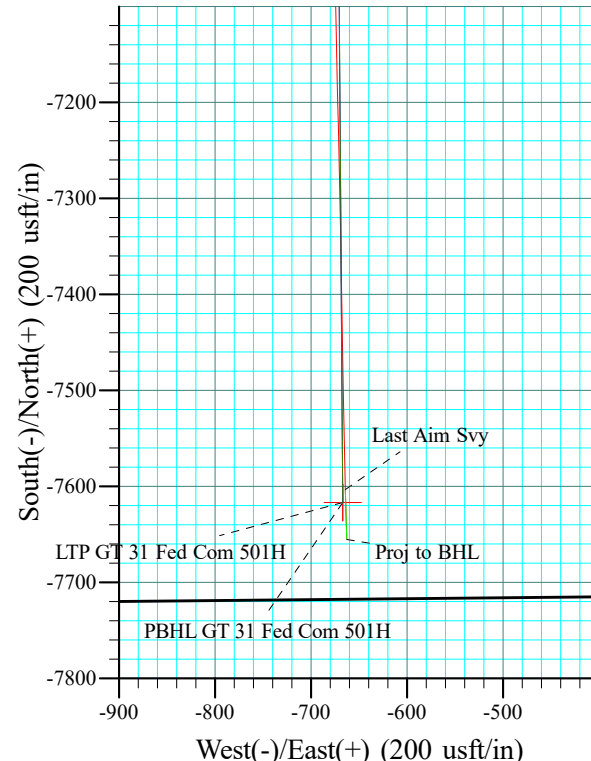
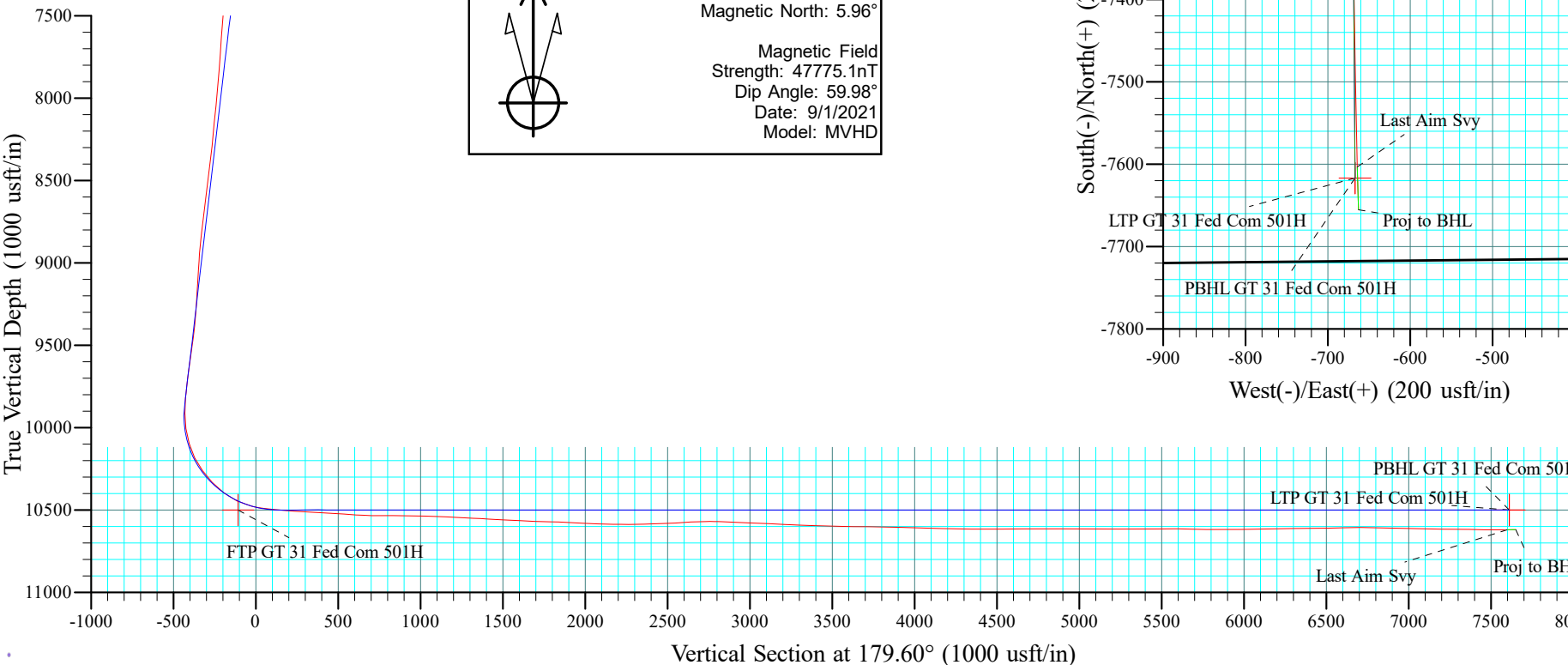





**Aim Directional Services, LLC**  
Survey Report



<b>Company:</b>	Avant Operating, LLC	<b>Local Co-ordinate Reference:</b>	Well 501H
<b>Project:</b>	Lea Co., NM (NAD 83)	<b>TVD Reference:</b>	Well @ 3482.00usft (H&P 642)
<b>Site:</b>	Golden Tee 31 Fed Com 501H	<b>MD Reference:</b>	Well @ 3482.00usft (H&P 642)
<b>Well:</b>	501H	<b>North Reference:</b>	Grid
<b>Wellbore:</b>	Drilling	<b>Survey Calculation Method:</b>	Minimum Curvature
<b>Design:</b>	Surveys	<b>Database:</b>	RTOC- EDM 5000.1 Single User Db

<b>Project</b>	Lea Co., NM (NAD 83)		
<b>Map System:</b>	US State Plane 1983	<b>System Datum:</b>	Mean Sea Level
<b>Geo Datum:</b>	North American Datum 1983		
<b>Map Zone:</b>	New Mexico Eastern Zone		

<b>Site</b>	Golden Tee 31 Fed Com 501H				
<b>Site Position:</b>		<b>Northing:</b>	494,049.70 usft	<b>Latitude:</b>	32° 21' 17.434 N
<b>From:</b>	Map	<b>Easting:</b>	826,057.82 usft	<b>Longitude:</b>	103° 24' 40.657 W
<b>Position Uncertainty:</b>	0.00 usft	<b>Slot Radius:</b>	13-3/16 "	<b>Grid Convergence:</b>	0.49 °

<b>Well</b>	501H					
<b>Well Position</b>	<b>+N/-S</b>	0.00 usft	<b>Northing:</b>	494,049.70 usft	<b>Latitude:</b>	32° 21' 17.434 N
	<b>+E/-W</b>	0.00 usft	<b>Easting:</b>	826,057.82 usft	<b>Longitude:</b>	103° 24' 40.657 W
<b>Position Uncertainty</b>		1.00 usft	<b>Wellhead Elevation:</b>	usft	<b>Ground Level:</b>	3,455.00 usft

<b>Wellbore</b>	Drilling				
<b>Magnetics</b>	<b>Model Name</b>	<b>Sample Date</b>	<b>Declination (°)</b>	<b>Dip Angle (°)</b>	<b>Field Strength (nT)</b>
	MVHD	9/1/2021	6.45	59.98	47,775.140

<b>Design</b>	Surveys				
<b>Audit Notes:</b>					
<b>Version:</b>	1.0	<b>Phase:</b>	ACTUAL	<b>Tie On Depth:</b>	0.00
<b>Vertical Section:</b>	<b>Depth From (TVD) (usft)</b>	<b>+N/-S (usft)</b>	<b>+E/-W (usft)</b>	<b>Direction (°)</b>	
	0.00	0.00	0.00	179.60	

<b>Survey Program</b>	<b>Date</b>	10/3/2021			
<b>From (usft)</b>	<b>To (usft)</b>	<b>Survey (Wellbore)</b>	<b>Tool Name</b>	<b>Description</b>	
227.00	18,423.00	MWD Svy (Drilling)	B001Mb_MWD+HRGM	OWSG MWD + HRGM	

<b>Survey</b>										
<b>Measured Depth (usft)</b>	<b>Inclination (°)</b>	<b>Azimuth (°)</b>	<b>Vertical Depth (usft)</b>	<b>+N/-S (usft)</b>	<b>+E/-W (usft)</b>	<b>Vertical Section (usft)</b>	<b>Dogleg Rate (°/100ft)</b>	<b>Build Rate (°/100ft)</b>	<b>Turn Rate (°/100ft)</b>	
0.00	0.00	0.00	0.00	0.00	0.00	0.00	0.000	0.000	0.000	
227.00	0.35	158.27	227.00	-0.64	0.26	0.65	0.154	0.154	0.000	
<b>First Aim Svy</b>										
317.00	0.18	213.73	317.00	-1.02	0.28	1.02	0.321	-0.189	61.622	
407.00	0.18	235.53	407.00	-1.21	0.08	1.22	0.076	0.000	24.222	
497.00	0.09	261.81	497.00	-1.30	-0.10	1.30	0.119	-0.100	29.200	
589.00	0.04	257.77	589.00	-1.32	-0.20	1.32	0.055	-0.054	-4.391	
678.00	0.35	55.09	678.00	-1.17	-0.01	1.17	0.435	0.348	176.764	
770.00	0.22	45.69	770.00	-0.89	0.34	0.89	0.150	-0.141	-10.217	
860.00	0.40	337.31	859.99	-0.48	0.35	0.48	0.421	0.200	-75.978	
950.00	0.26	227.18	949.99	-0.33	0.08	0.33	0.608	-0.156	-122.366	



### Aim Directional Services, LLC

#### Survey Report



<b>Company:</b>	Avant Operating, LLC	<b>Local Co-ordinate Reference:</b>	Well 501H
<b>Project:</b>	Lea Co., NM (NAD 83)	<b>TVD Reference:</b>	Well @ 3482.00usft (H&P 642)
<b>Site:</b>	Golden Tee 31 Fed Com 501H	<b>MD Reference:</b>	Well @ 3482.00usft (H&P 642)
<b>Well:</b>	501H	<b>North Reference:</b>	Grid
<b>Wellbore:</b>	Drilling	<b>Survey Calculation Method:</b>	Minimum Curvature
<b>Design:</b>	Surveys	<b>Database:</b>	RTOC- EDM 5000.1 Single User Db

Survey										
Measured Depth (usft)	Inclination (°)	Azimuth (°)	Vertical Depth (usft)	+N/-S (usft)	+E/-W (usft)	Vertical Section (usft)	Dogleg Rate (°/100ft)	Build Rate (°/100ft)	Turn Rate (°/100ft)	
1,045.00	0.48	172.16	1,044.99	-0.87	-0.03	0.87	0.414	0.232	-57.916	
1,140.00	0.35	171.81	1,139.99	-1.55	0.07	1.55	0.137	-0.137	-0.368	
1,235.00	0.40	176.03	1,234.99	-2.17	0.13	2.17	0.060	0.053	4.442	
1,329.00	0.53	196.86	1,328.98	-2.91	0.03	2.91	0.225	0.138	22.160	
1,424.00	0.57	210.22	1,423.98	-3.74	-0.34	3.74	0.141	0.042	14.063	
1,518.00	0.70	179.46	1,517.97	-4.72	-0.57	4.71	0.382	0.138	-32.723	
1,613.00	0.53	195.89	1,612.97	-5.72	-0.68	5.72	0.256	-0.179	17.295	
1,708.00	0.79	226.57	1,707.96	-6.59	-1.28	6.58	0.453	0.274	32.295	
1,838.00	0.57	245.64	1,837.95	-7.48	-2.52	7.46	0.241	-0.169	14.669	
1,993.00	0.92	296.00	1,992.94	-7.25	-4.34	7.22	0.457	0.226	32.490	
2,088.00	0.70	335.81	2,087.93	-6.38	-5.26	6.35	0.620	-0.232	41.905	
2,183.00	1.05	350.14	2,182.92	-5.00	-5.65	4.96	0.432	0.368	15.084	
2,277.00	0.97	353.66	2,276.91	-3.36	-5.88	3.32	0.108	-0.085	3.745	
2,467.00	1.05	356.38	2,466.88	-0.02	-6.17	-0.02	0.049	0.042	1.432	
2,561.00	1.19	1.74	2,560.86	1.81	-6.20	-1.86	0.186	0.149	5.702	
2,751.00	1.32	11.76	2,750.81	5.93	-5.69	-5.97	0.134	0.068	5.274	
2,845.00	1.41	14.57	2,844.79	8.11	-5.18	-8.14	0.119	0.096	2.989	
3,034.00	1.54	33.03	3,033.73	12.49	-3.21	-12.51	0.259	0.069	9.767	
3,129.00	0.75	4.91	3,128.71	14.18	-2.46	-14.19	0.997	-0.832	-29.600	
3,224.00	0.35	350.93	3,223.70	15.08	-2.45	-15.10	0.441	-0.421	-14.716	
3,318.00	0.57	337.40	3,317.70	15.80	-2.68	-15.82	0.259	0.234	-14.394	
3,413.00	0.66	7.28	3,412.69	16.78	-2.79	-16.80	0.346	0.095	31.453	
3,508.00	1.19	44.81	3,507.68	18.02	-2.02	-18.03	0.819	0.558	39.505	
3,603.00	1.76	66.69	3,602.65	19.30	0.01	-19.30	0.833	0.600	23.032	
3,698.00	2.20	60.72	3,697.59	20.76	2.94	-20.74	0.511	0.463	-6.284	
3,793.00	0.84	124.17	3,792.56	21.27	5.11	-21.23	2.077	-1.432	66.789	
3,888.00	1.01	183.24	3,887.55	20.04	5.64	-20.00	0.972	0.179	62.179	
3,982.00	1.14	162.23	3,981.54	18.32	5.87	-18.28	0.439	0.138	-22.351	
4,077.00	1.32	138.24	4,076.52	16.60	6.89	-16.56	0.569	0.189	-25.253	
4,172.00	0.97	130.41	4,171.50	15.27	8.23	-15.21	0.403	-0.368	-8.242	
4,266.00	0.75	127.51	4,265.49	14.38	9.33	-14.31	0.239	-0.234	-3.085	
4,361.00	1.01	262.95	4,360.48	13.90	8.99	-13.83	1.717	0.274	142.568	
4,456.00	1.58	270.07	4,455.46	13.79	6.85	-13.75	0.622	0.600	7.495	
4,550.00	1.41	265.76	4,549.42	13.71	4.40	-13.68	0.217	-0.181	-4.585	
4,645.00	1.14	277.10	4,644.40	13.74	2.30	-13.72	0.388	-0.284	11.937	
4,739.00	0.97	279.48	4,738.38	13.99	0.58	-13.98	0.187	-0.181	2.532	
4,929.00	0.57	241.86	4,928.37	13.81	-1.84	-13.82	0.329	-0.211	-19.800	
5,118.00	1.05	171.55	5,117.35	11.65	-2.41	-11.67	0.535	0.254	-37.201	
5,213.00	1.36	170.32	5,212.33	9.68	-2.09	-9.69	0.327	0.326	-1.295	
5,403.00	0.75	272.09	5,402.31	7.50	-2.96	-7.52	0.885	-0.321	53.563	
5,577.00	1.14	277.63	5,576.29	7.77	-5.81	-7.81	0.230	0.224	3.184	
5,680.00	1.14	268.67	5,679.27	7.88	-7.85	-7.94	0.173	0.000	-8.699	
5,774.00	3.78	312.35	5,773.18	9.95	-11.08	-10.03	3.254	2.809	46.468	



**Aim Directional Services, LLC**

Survey Report



<b>Company:</b>	Avant Operating, LLC	<b>Local Co-ordinate Reference:</b>	Well 501H
<b>Project:</b>	Lea Co., NM (NAD 83)	<b>TVD Reference:</b>	Well @ 3482.00usft (H&P 642)
<b>Site:</b>	Golden Tee 31 Fed Com 501H	<b>MD Reference:</b>	Well @ 3482.00usft (H&P 642)
<b>Well:</b>	501H	<b>North Reference:</b>	Grid
<b>Wellbore:</b>	Drilling	<b>Survey Calculation Method:</b>	Minimum Curvature
<b>Design:</b>	Surveys	<b>Database:</b>	RTOC- EDM 5000.1 Single User Db

Survey										
Measured Depth (usft)	Inclination (°)	Azimuth (°)	Vertical Depth (usft)	+N/-S (usft)	+E/-W (usft)	Vertical Section (usft)	Dogleg Rate (°/100ft)	Build Rate (°/100ft)	Turn Rate (°/100ft)	
5,869.00	7.78	313.49	5,867.67	16.49	-18.06	-16.61	4.212	4.211	1.200	
5,964.00	10.02	311.73	5,961.53	26.42	-28.89	-26.62	2.375	2.358	-1.853	
6,059.00	10.55	310.76	6,055.00	37.59	-41.65	-37.88	0.587	0.558	-1.021	
6,153.00	10.42	310.76	6,147.43	48.76	-54.60	-49.14	0.138	-0.138	0.000	
6,248.00	10.33	310.41	6,240.88	59.89	-67.60	-60.36	0.116	-0.095	-0.368	
6,343.00	10.90	309.45	6,334.25	71.12	-81.02	-71.69	0.628	0.600	-1.011	
6,437.00	12.26	316.21	6,426.34	83.98	-94.79	-84.64	2.042	1.447	7.191	
6,532.00	12.92	317.80	6,519.05	99.12	-108.90	-99.88	0.785	0.695	1.674	
6,626.00	12.70	317.09	6,610.71	114.48	-123.00	-115.33	0.288	-0.234	-0.755	
6,721.00	11.12	305.32	6,703.68	127.43	-137.59	-128.38	3.042	-1.663	-12.389	
6,815.00	11.38	304.79	6,795.87	137.96	-152.60	-139.02	0.298	0.277	-0.564	
6,910.00	11.47	306.19	6,888.99	148.88	-167.92	-150.05	0.307	0.095	1.474	
7,005.00	10.51	299.16	6,982.25	158.68	-183.11	-159.96	1.734	-1.011	-7.400	
7,099.00	10.46	297.32	7,074.68	166.78	-198.18	-168.15	0.360	-0.053	-1.957	
7,194.00	10.02	298.11	7,168.17	174.63	-213.13	-176.11	0.486	-0.463	0.832	
7,289.00	9.41	297.41	7,261.81	182.10	-227.31	-183.68	0.654	-0.642	-0.737	
7,384.00	8.44	294.33	7,355.66	188.54	-240.56	-190.22	1.138	-1.021	-3.242	
7,478.00	7.74	294.24	7,448.72	193.99	-252.62	-195.74	0.745	-0.745	-0.096	
7,573.00	8.66	299.08	7,542.75	200.09	-264.70	-201.93	1.210	0.968	5.095	
7,668.00	8.48	300.83	7,636.69	207.15	-276.97	-209.08	0.334	-0.189	1.842	
7,763.00	7.56	298.99	7,730.76	213.77	-288.45	-215.78	1.005	-0.968	-1.937	
7,857.00	8.62	300.92	7,823.82	220.39	-299.90	-222.48	1.164	1.128	2.053	
7,952.00	9.05	299.43	7,917.69	227.72	-312.52	-229.90	0.513	0.453	-1.568	
8,047.00	10.24	301.10	8,011.35	235.75	-326.25	-238.02	1.287	1.253	1.758	
8,142.00	11.47	300.48	8,104.65	244.91	-341.62	-247.28	1.301	1.295	-0.653	
8,237.00	10.20	301.10	8,197.95	254.04	-356.97	-256.53	1.342	-1.337	0.653	
8,331.00	10.46	305.14	8,290.43	263.25	-371.07	-265.84	0.819	0.277	4.298	
8,426.00	10.59	309.09	8,383.83	273.72	-384.90	-276.40	0.772	0.137	4.158	
8,521.00	9.67	313.23	8,477.35	284.69	-397.49	-287.46	1.234	-0.968	4.358	
8,616.00	10.24	318.76	8,570.92	296.50	-408.87	-299.35	1.171	0.600	5.821	
8,711.00	9.58	310.76	8,664.51	308.02	-420.43	-310.94	1.605	-0.695	-8.421	
8,805.00	11.82	307.07	8,756.87	318.93	-434.03	-321.95	2.491	2.383	-3.926	
8,900.00	9.71	309.09	8,850.19	329.85	-448.02	-332.97	2.256	-2.221	2.126	
8,995.00	8.75	295.91	8,943.97	338.06	-460.74	-341.26	2.437	-1.011	-13.874	
9,089.00	10.11	291.69	9,036.70	344.23	-474.83	-347.54	1.622	1.447	-4.489	
9,184.00	10.33	287.30	9,130.20	349.84	-490.71	-353.26	0.852	0.232	-4.621	
9,279.00	12.40	285.28	9,223.33	355.07	-508.69	-358.61	2.219	2.179	-2.126	
9,374.00	13.80	290.99	9,315.86	361.81	-529.11	-365.50	2.005	1.474	6.011	
9,469.00	14.73	292.57	9,407.93	370.51	-550.84	-374.34	1.061	0.979	1.663	
9,563.00	13.10	307.60	9,499.20	381.60	-570.32	-385.57	4.203	-1.734	15.989	
9,699.00	11.21	315.16	9,632.15	400.38	-591.86	-404.50	1.814	-1.390	5.559	
9,794.00	8.70	315.77	9,725.71	412.08	-603.38	-416.28	2.644	-2.642	0.642	
9,889.00	9.85	304.88	9,819.48	421.87	-615.06	-426.16	2.204	1.211	-11.463	



**Aim Directional Services, LLC**  
Survey Report



<b>Company:</b>	Avant Operating, LLC	<b>Local Co-ordinate Reference:</b>	Well 501H
<b>Project:</b>	Lea Co., NM (NAD 83)	<b>TVD Reference:</b>	Well @ 3482.00usft (H&P 642)
<b>Site:</b>	Golden Tee 31 Fed Com 501H	<b>MD Reference:</b>	Well @ 3482.00usft (H&P 642)
<b>Well:</b>	501H	<b>North Reference:</b>	Grid
<b>Wellbore:</b>	Drilling	<b>Survey Calculation Method:</b>	Minimum Curvature
<b>Design:</b>	Surveys	<b>Database:</b>	RTOC- EDM 5000.1 Single User Db

**Survey**

Measured Depth (usft)	Inclination (°)	Azimuth (°)	Vertical Depth (usft)	+N/-S (usft)	+E/-W (usft)	Vertical Section (usft)	Dogleg Rate (°/100ft)	Build Rate (°/100ft)	Turn Rate (°/100ft)	
9,984.00	10.07	268.14	9,913.14	426.25	-630.04	-430.64	6.582	0.232	-38.674	
10,078.00	13.23	233.25	10,005.30	419.54	-646.90	-424.05	8.052	3.362	-37.117	
10,173.00	20.66	219.18	10,096.15	400.01	-666.23	-404.65	8.880	7.821	-14.810	
10,268.00	28.09	203.19	10,182.71	366.38	-685.68	-371.16	10.398	7.821	-16.832	
10,362.00	37.10	198.79	10,261.84	319.09	-703.56	-324.00	9.906	9.585	-4.681	
10,457.00	44.79	191.41	10,333.58	259.04	-719.44	-264.05	9.551	8.095	-7.768	
10,551.00	52.35	181.92	10,395.82	189.20	-727.26	-194.27	11.029	8.043	-10.096	
10,645.00	64.40	178.58	10,445.03	109.32	-727.46	-114.40	13.169	12.819	-3.553	
10,670.02	67.49	178.46	10,455.22	86.49	-726.87	-91.56	12.355	12.347	-0.490	
<b>FTP GT 31 Fed Com 501H</b>										
10,740.00	76.13	178.14	10,477.05	20.10	-724.89	-25.16	12.355	12.348	-0.454	
10,856.00	84.70	177.79	10,496.35	-94.11	-720.83	89.07	7.394	7.388	-0.302	
10,951.00	86.42	178.67	10,503.70	-188.77	-717.91	183.75	2.032	1.811	0.926	
11,046.00	86.11	179.10	10,509.89	-283.55	-716.06	278.55	0.557	-0.326	0.453	
11,140.00	86.73	179.10	10,515.76	-377.36	-714.59	372.36	0.660	0.660	0.000	
11,235.00	86.07	179.81	10,521.73	-472.16	-713.69	467.17	1.019	-0.695	0.747	
11,329.00	86.33	180.07	10,527.96	-565.96	-713.59	560.96	0.391	0.277	0.277	
11,424.00	87.74	180.34	10,532.87	-660.83	-713.93	655.83	1.511	1.484	0.284	
11,519.00	89.23	180.86	10,535.38	-755.78	-714.92	750.77	1.661	1.568	0.547	
11,614.00	91.16	181.48	10,535.06	-850.76	-716.86	845.73	2.134	2.032	0.653	
11,708.00	89.32	181.57	10,534.66	-944.72	-719.36	939.68	1.960	-1.957	0.096	
11,803.00	86.95	180.42	10,537.76	-1,039.65	-721.01	1,034.59	2.773	-2.495	-1.211	
11,898.00	88.26	180.77	10,541.73	-1,134.56	-722.00	1,129.49	1.427	1.379	0.368	
11,992.00	86.81	180.25	10,545.77	-1,228.46	-722.83	1,223.39	1.639	-1.543	-0.553	
12,086.00	87.69	181.13	10,550.28	-1,322.35	-723.97	1,317.26	1.323	0.936	0.936	
12,181.00	86.51	180.42	10,555.08	-1,417.21	-725.25	1,412.12	1.449	-1.242	-0.747	
12,276.00	87.16	180.77	10,560.33	-1,512.06	-726.23	1,506.96	0.777	0.684	0.368	
12,370.00	87.25	179.63	10,564.91	-1,605.95	-726.56	1,600.84	1.215	0.096	-1.213	
12,465.00	87.74	179.10	10,569.07	-1,700.85	-725.51	1,695.75	0.759	0.516	-0.558	
12,560.00	88.48	178.23	10,572.20	-1,795.77	-723.30	1,790.68	1.202	0.779	-0.916	
12,655.00	87.25	177.61	10,575.74	-1,890.64	-719.85	1,885.57	1.450	-1.295	-0.653	
12,750.00	87.30	176.64	10,580.25	-1,985.41	-715.09	1,980.37	1.021	0.053	-1.021	
12,844.00	87.87	176.91	10,584.22	-2,079.18	-709.81	2,074.18	0.671	0.606	0.287	
12,939.00	88.66	177.26	10,587.09	-2,174.01	-704.98	2,169.04	0.909	0.832	0.368	
13,034.00	90.20	177.70	10,588.04	-2,268.92	-700.80	2,263.97	1.686	1.621	0.463	
13,129.00	91.91	176.91	10,586.29	-2,363.79	-696.34	2,358.87	1.983	1.800	-0.832	
13,223.00	91.69	178.23	10,583.33	-2,457.66	-692.35	2,452.76	1.423	-0.234	1.404	
13,317.00	93.49	178.23	10,579.09	-2,551.51	-689.45	2,546.64	1.915	1.915	0.000	
13,411.00	93.41	178.75	10,573.43	-2,645.31	-686.98	2,640.45	0.559	-0.085	0.553	
13,506.00	90.64	179.72	10,570.07	-2,740.23	-685.72	2,735.38	3.089	-2.916	1.021	
13,600.00	87.34	180.34	10,571.73	-2,834.20	-685.76	2,829.35	3.572	-3.511	0.660	
13,694.00	87.65	180.60	10,575.84	-2,928.11	-686.53	2,923.25	0.430	0.330	0.277	
13,789.00	87.60	181.65	10,579.78	-3,023.01	-688.40	3,018.13	1.106	-0.053	1.105	
13,883.00	87.56	182.97	10,583.74	-3,116.85	-692.18	3,111.94	1.404	-0.043	1.404	



**Aim Directional Services, LLC**

Survey Report



<b>Company:</b>	Avant Operating, LLC	<b>Local Co-ordinate Reference:</b>	Well 501H
<b>Project:</b>	Lea Co., NM (NAD 83)	<b>TVD Reference:</b>	Well @ 3482.00usft (H&P 642)
<b>Site:</b>	Golden Tee 31 Fed Com 501H	<b>MD Reference:</b>	Well @ 3482.00usft (H&P 642)
<b>Well:</b>	501H	<b>North Reference:</b>	Grid
<b>Wellbore:</b>	Drilling	<b>Survey Calculation Method:</b>	Minimum Curvature
<b>Design:</b>	Surveys	<b>Database:</b>	RTOC- EDM 5000.1 Single User Db

Survey										
Measured Depth (usft)	Inclination (°)	Azimuth (°)	Vertical Depth (usft)	+N/-S (usft)	+E/-W (usft)	Vertical Section (usft)	Dogleg Rate (°/100ft)	Build Rate (°/100ft)	Turn Rate (°/100ft)	
13,978.00	87.03	181.30	10,588.23	-3,211.67	-695.72	3,206.74	1.842	-0.558	-1.758	
14,072.00	87.65	180.25	10,592.59	-3,305.56	-696.99	3,300.61	1.296	0.660	-1.117	
14,167.00	88.26	179.10	10,595.98	-3,400.49	-696.45	3,395.55	1.370	0.642	-1.211	
14,261.00	89.14	177.61	10,598.11	-3,494.43	-693.75	3,489.50	1.841	0.936	-1.585	
14,356.00	88.48	178.84	10,600.09	-3,589.36	-690.81	3,584.45	1.469	-0.695	1.295	
14,450.00	90.07	179.90	10,601.28	-3,683.34	-689.78	3,678.44	2.033	1.691	1.128	
14,545.00	88.62	179.10	10,602.36	-3,778.33	-688.95	3,773.43	1.743	-1.526	-0.842	
14,640.00	88.66	178.49	10,604.62	-3,873.28	-686.95	3,868.39	0.643	0.042	-0.642	
14,735.00	87.82	178.67	10,607.53	-3,968.21	-684.60	3,963.33	0.904	-0.884	0.189	
14,829.00	88.79	178.23	10,610.32	-4,062.13	-682.06	4,057.27	1.133	1.032	-0.468	
14,924.00	88.26	179.46	10,612.76	-4,157.08	-680.14	4,152.23	1.409	-0.558	1.295	
15,019.00	89.54	179.37	10,614.58	-4,252.05	-679.17	4,247.21	1.351	1.347	-0.095	
15,114.00	88.75	179.10	10,616.00	-4,347.03	-677.90	4,342.19	0.879	-0.832	-0.284	
15,208.00	90.46	178.84	10,616.65	-4,441.01	-676.21	4,436.18	1.840	1.819	-0.277	
15,303.00	89.67	179.72	10,616.54	-4,536.00	-675.02	4,531.18	1.245	-0.832	0.926	
15,397.00	91.03	179.98	10,615.97	-4,630.00	-674.77	4,625.17	1.473	1.447	0.277	
15,492.00	89.71	179.63	10,615.35	-4,724.99	-674.45	4,720.17	1.437	-1.389	-0.368	
15,587.00	90.73	179.02	10,614.99	-4,819.98	-673.33	4,815.17	1.251	1.074	-0.642	
15,681.00	89.45	179.54	10,614.84	-4,913.97	-672.15	4,909.16	1.470	-1.362	0.553	
15,775.00	90.33	178.93	10,615.02	-5,007.96	-670.90	5,003.16	1.139	0.936	-0.649	
15,869.00	89.93	180.07	10,614.81	-5,101.96	-670.08	5,097.16	1.285	-0.426	1.213	
15,964.00	89.49	178.93	10,615.29	-5,196.95	-669.25	5,192.15	1.286	-0.463	-1.200	
16,059.00	89.19	179.37	10,616.38	-5,291.93	-667.84	5,287.14	0.561	-0.316	0.463	
16,153.00	89.54	179.63	10,617.43	-5,385.92	-667.02	5,381.14	0.464	0.372	0.277	
16,248.00	92.31	178.58	10,615.89	-5,480.89	-665.53	5,476.11	3.118	2.916	-1.105	
16,343.00	89.67	178.84	10,614.25	-5,575.84	-663.40	5,571.08	2.792	-2.779	0.274	
16,438.00	88.09	180.86	10,616.11	-5,670.82	-663.15	5,666.05	2.699	-1.663	2.126	
16,532.00	89.01	180.77	10,618.49	-5,764.78	-664.48	5,760.00	0.983	0.979	-0.096	
16,627.00	90.33	179.81	10,619.03	-5,859.77	-664.96	5,854.99	1.718	1.389	-1.011	
16,722.00	90.24	181.30	10,618.56	-5,954.76	-665.88	5,949.97	1.571	-0.095	1.568	
16,816.00	91.82	181.13	10,616.87	-6,048.72	-667.88	6,043.91	1.691	1.681	-0.181	
16,911.00	90.02	180.77	10,615.35	-6,143.69	-669.45	6,138.87	1.932	-1.895	-0.379	
17,006.00	91.30	181.30	10,614.25	-6,238.67	-671.17	6,233.83	1.458	1.347	0.558	
17,100.00	90.07	180.77	10,613.13	-6,332.65	-672.86	6,327.79	1.425	-1.309	-0.564	
17,195.00	91.30	180.34	10,611.99	-6,427.63	-673.79	6,422.77	1.372	1.295	-0.453	
17,289.00	90.37	181.04	10,610.62	-6,521.61	-674.92	6,516.74	1.238	-0.989	0.745	
17,384.00	92.31	180.69	10,608.40	-6,616.57	-676.35	6,611.69	2.075	2.042	-0.368	
17,478.00	89.63	179.28	10,606.81	-6,710.55	-676.33	6,705.66	3.221	-2.851	-1.500	
17,572.00	88.26	180.07	10,608.54	-6,804.53	-675.79	6,799.64	1.682	-1.457	0.840	
17,667.00	89.10	180.07	10,610.73	-6,899.50	-675.91	6,894.61	0.884	0.884	0.000	
17,761.00	88.48	179.28	10,612.71	-6,993.48	-675.38	6,988.59	1.068	-0.660	-0.840	
17,856.00	89.45	179.19	10,614.43	-7,088.45	-674.11	7,083.57	1.025	1.021	-0.095	
17,951.00	88.57	178.75	10,616.07	-7,183.42	-672.40	7,178.55	1.036	-0.926	-0.463	





**Aim Directional Services, LLC**  
Survey Report



<b>Company:</b>	Avant Operating, LLC	<b>Local Co-ordinate Reference:</b>	Well 501H
<b>Project:</b>	Lea Co., NM (NAD 83)	<b>TVD Reference:</b>	Well @ 3482.00usft (H&P 642)
<b>Site:</b>	Golden Tee 31 Fed Com 501H	<b>MD Reference:</b>	Well @ 3482.00usft (H&P 642)
<b>Well:</b>	501H	<b>North Reference:</b>	Grid
<b>Wellbore:</b>	Drilling	<b>Survey Calculation Method:</b>	Minimum Curvature
<b>Design:</b>	Surveys	<b>Database:</b>	RTOC- EDM 5000.1 Single User Db

Measured Depth (usft)	Inclination (°)	Azimuth (°)	Vertical Depth (usft)	+N/-S (usft)	+E/-W (usft)	Vertical Section (usft)	Dogleg Rate (°/100ft)	Build Rate (°/100ft)	Turn Rate (°/100ft)
18,045.00	89.76	178.58	10,617.44	-7,277.38	-670.21	7,272.53	1.279	1.266	-0.181
18,140.00	88.57	179.02	10,618.83	-7,372.35	-668.22	7,367.51	1.335	-1.253	0.463
18,235.00	89.36	179.28	10,620.54	-7,467.32	-666.81	7,462.49	0.875	0.832	0.274
18,330.00	90.59	178.75	10,620.58	-7,562.31	-665.18	7,557.48	1.410	1.295	-0.558
18,371.00	90.86	178.40	10,620.06	-7,603.29	-664.16	7,598.47	1.078	0.659	-0.854
<b>Last Aim Svy - LTP GT 31 Fed Com 501H - PBHL GT 31 Fed Com 501H</b>									
18,423.00	90.86	178.40	10,619.28	-7,655.27	-662.71	7,650.45	0.000	0.000	0.000
<b>Proj to BHL</b>									

Measured Depth (usft)	Vertical Depth (usft)	Local Coordinates		Comment
		+N/-S (usft)	+E/-W (usft)	
227.00	227.00	-0.64	0.26	First Aim Svy
18,371.00	10,620.06	-7,603.29	-664.16	Last Aim Svy
18,423.00	10,619.28	-7,655.27	-662.71	Proj to BHL

**District I**  
 1625 N. French Dr., Hobbs, NM 88240  
 Phone:(575) 393-6161 Fax:(575) 393-0720

**District II**  
 811 S. First St., Artesia, NM 88210  
 Phone:(575) 748-1283 Fax:(575) 748-9720

**District III**  
 1000 Rio Brazos Rd., Aztec, NM 87410  
 Phone:(505) 334-6178 Fax:(505) 334-6170

**District IV**  
 1220 S. St Francis Dr., Santa Fe, NM 87505  
 Phone:(505) 476-3470 Fax:(505) 476-3462

**State of New Mexico**  
**Energy, Minerals and Natural Resources**  
**Oil Conservation Division**  
**1220 S. St Francis Dr.**  
**Santa Fe, NM 87505**

ACKNOWLEDGMENTS

Action 83057

**ACKNOWLEDGMENTS**

Operator: Avant Operating, LLC 1515 Wynkoop Street Denver, CO 80202	OGRID: 330396
	Action Number: 83057
	Action Type: [C-104] Completion Packet (C-104C)

**ACKNOWLEDGMENTS**

<input checked="" type="checkbox"/>	I hereby certify that the required Water Use Report has been, or will be, submitted for this wells completion.
<input checked="" type="checkbox"/>	I hereby certify that the required FracFocus disclosure has been, or will be, submitted for this wells completion.

**District I**  
 1625 N. French Dr., Hobbs, NM 88240  
 Phone:(575) 393-6161 Fax:(575) 393-0720

**District II**  
 811 S. First St., Artesia, NM 88210  
 Phone:(575) 748-1283 Fax:(575) 748-9720

**District III**  
 1000 Rio Brazos Rd., Aztec, NM 87410  
 Phone:(505) 334-6178 Fax:(505) 334-6170

**District IV**  
 1220 S. St Francis Dr., Santa Fe, NM 87505  
 Phone:(505) 476-3470 Fax:(505) 476-3462

**State of New Mexico**  
**Energy, Minerals and Natural Resources**  
**Oil Conservation Division**  
**1220 S. St Francis Dr.**  
**Santa Fe, NM 87505**

CONDITIONS  
 Action 83057

**CONDITIONS**

Operator: Avant Operating, LLC 1515 Wynkoop Street Denver, CO 80202	OGRID: 330396
	Action Number: 83057
	Action Type: [C-104] Completion Packet (C-104C)

**CONDITIONS**

Created By	Condition	Condition Date
llowe	RT expires on 07/06/22	4/7/2022