

Well Name: HEADS CC 9-4 FEDERAL COM	Well Location: T24S / R29E / SEC 9 / SWSE / 32.227378 / -103.985348	County or Parish/State: EDDY / NM
Well Number: 24H	Type of Well: OIL WELL	Allottee or Tribe Name:
Lease Number: NMNM99034	Unit or CA Name:	Unit or CA Number:
US Well Number: 300154733700X1	Well Status: Approved Application for Permit to Drill	Operator: OXY USA INCORPORATED

Notice of Intent

Sundry ID: 2756231

Type of Submission: Notice of Intent	Type of Action: APD Change
Date Sundry Submitted: 10/12/2023	Time Sundry Submitted: 10:40
Date proposed operation will begin: 04/02/2024	

Procedure Description: THE SHL IS CHANGING SLIGHTLY. THE BHL, HSU SIZE, SURFACE CASING, INTERMEDIATE CASING, AND PRODUCTION CASING ARE UPDATED. A CONTINGENCY TIE BACK IS ATTACHED. UPDATED VARIANCE REQUESTS FOR BOP BREAK TESTING, BRADENHEAD CBL, AND OFFLINE CEMENT ARE ATTACHED.

NOI Attachments

Procedure Description

- I10204WEL00NM_HEADS_CC_9_4_FED_COM_24H_C_102_20231012103906.pdf
- HeadsCC9_4FederalCom24H_TNSWedge463_7.827in_39.30ppf_P110S_20231012103905.pdf
- HeadsCC9_4FederalCom21H_GENERAL_DOCUMENTS_20231012103900.pdf
- HeadsCC9_4FederalCom24H_TNSWedge461_5.500in_20.00ppf_P110CY_20231012103904.pdf
- HeadsCC9_4FederalCom24H_FalconSL1AnnClearanceVariance_20231012103858.pdf
- HeadsCC9_4FederalCom24H_DrillPlan_20231012103858.pdf
- HeadsCC9_4FederalCom24H_3SFalconSL1ContingencyTiebackDetails_20231012103858.pdf
- HeadsCC9_4FederalCom24H_NAD83DirectionalPlot_20231012103858.pdf
- HeadsCC9_4FederalCom24H_NAD83DirectionalPlan_20231012103858.pdf

Received by OCD: 1/26/2024 2:04:11 PM

Page 2 of 86

Well Name: HEADS CC 9-4 FEDERAL COM	Well Location: T24S / R29E / SEC 9 / SWSE / 32.227378 / -103.985348	County or Parish/State: EDDY / NM
Well Number: 24H	Type of Well: OIL WELL	Allottee or Tribe Name:
Lease Number: NMNM99034	Unit or CA Name:	Unit or CA Number:
US Well Number: 300154733700X1	Well Status: Approved Application for Permit to Drill	Operator: OXY USA INCORPORATED

OXY_APD_CHANGE_SUNDRY_LIST_10.12.23_20231012103845.pdf

Conditions of Approval

Additional

FALCON_DESIGN__HEADS_CC_9_4_FEDERAL_COM_24H__SUNDRY_COA_20240125154843.pdf

Operator

I certify that the foregoing is true and correct. Title 18 U.S.C. Section 1001 and Title 43 U.S.C. Section 1212, make it a crime for any person knowingly and willfully to make to any department or agency of the United States any false, fictitious or fraudulent statements or representations as to any matter within its jurisdiction. Electronic submission of Sundry Notices through this system satisfies regulations requiring a

Operator Electronic Signature: STEPHEN JANACEK

Signed on: OCT 12, 2023 10:38 AM

Name: OXY USA INCORPORATED

Title: Regulatory Engineer

Street Address: 5 Greenway Plaza, Suite 110

City: HoustonState: TX

Phone: (713) 497-2417

Email address: stephen_janacek@oxy.com

Field

Representative Name:

Street Address:

City:State:Zip:

Phone:

Email address:

BLM Point of Contact

BLM POC Name: CHRISTOPHER WALLS

BLM POC Title: Petroleum Engineer

BLM POC Phone: 5752342234

BLM POC Email Address: cwalls@blm.gov

Disposition: Approved

Disposition Date: 01/26/2024

Signature: Chris Walls

Form 3160-5
(June 2019)

UNITED STATES
DEPARTMENT OF THE INTERIOR
BUREAU OF LAND MANAGEMENT

FORM APPROVED
OMB No. 1004-0137
Expires: October 31, 2021

SUNDRY NOTICES AND REPORTS ON WELLS
Do not use this form for proposals to drill or to re-enter an abandoned well. Use Form 3160-3 (APD) for such proposals.

5. Lease Serial No.	
6. If Indian, Allottee or Tribe Name	
7. If Unit of CA/Agreement, Name and/or No.	
8. Well Name and No.	
9. API Well No.	
10. Field and Pool or Exploratory Area	11. Country or Parish, State

SUBMIT IN TRIPLICATE - Other instructions on page 2	
1. Type of Well	
<input type="checkbox"/> Oil Well <input type="checkbox"/> Gas Well <input type="checkbox"/> Other	
2. Name of Operator	
3a. Address	3b. Phone No. (include area code)
4. Location of Well (Footage, Sec., T.,R.,M., or Survey Description)	

12. CHECK THE APPROPRIATE BOX(ES) TO INDICATE NATURE OF NOTICE, REPORT OR OTHER DATA				
TYPE OF SUBMISSION	TYPE OF ACTION			
<input type="checkbox"/> Notice of Intent	<input type="checkbox"/> Acidize	<input type="checkbox"/> Deepen	<input type="checkbox"/> Production (Start/Resume)	<input type="checkbox"/> Water Shut-Off
<input type="checkbox"/> Subsequent Report	<input type="checkbox"/> Alter Casing	<input type="checkbox"/> Hydraulic Fracturing	<input type="checkbox"/> Reclamation	<input type="checkbox"/> Well Integrity
<input type="checkbox"/> Final Abandonment Notice	<input type="checkbox"/> Casing Repair	<input type="checkbox"/> New Construction	<input type="checkbox"/> Recomplete	<input type="checkbox"/> Other
	<input type="checkbox"/> Change Plans	<input type="checkbox"/> Plug and Abandon	<input type="checkbox"/> Temporarily Abandon	
	<input type="checkbox"/> Convert to Injection	<input type="checkbox"/> Plug Back	<input type="checkbox"/> Water Disposal	

13. Describe Proposed or Completed Operation: Clearly state all pertinent details, including estimated starting date of any proposed work and approximate duration thereof. If the proposal is to deepen directionally or recompleate horizontally, give subsurface locations and measured and true vertical depths of all pertinent markers and zones. Attach the Bond under which the work will be perfonned or provide the Bond No. on file with BLM/BIA. Required subsequent reports must be filed within 30 days following completion of the involved operations. If the operation results in a multiple completion or recompleation in a new interval, a Form 3160-4 must be filed once testing has been completed. Final Abandonment Notices must be filed only after all requirements, including reclamation, have been completed and the operator has detennined that the site is ready for final inspection.)

14. I hereby certify that the foregoing is true and correct. Name (Printed/Typed)	Title
Signature	Date

THE SPACE FOR FEDERAL OR STATE OFFICE USE		
Approved by	Title	Date
Conditions of approval, if any, are attached. Approval of this notice does not warrant or certify that the applicant holds legal or equitable title to those rights in the subject lease which would entitle the applicant to conduct operations thereon.	Office	

Title 18 U.S.C Section 1001 and Title 43 U.S.C Section 1212, make it a crime for any person knowingly and willfully to make to any department or agency of the United States any false, fictitious or fraudulent statements or representations as to any matter within its jurisdiction.

(Instructions on page 2)

GENERAL INSTRUCTIONS

This form is designed for submitting proposals to perform certain well operations and reports of such operations when completed as indicated on Federal and Indian lands pursuant to applicable Federal law and regulations. Any necessary special instructions concerning the use of this form and the number of copies to be submitted, particularly with regard to local area or regional procedures and practices, are either shown below, will be issued by or may be obtained from the local Federal office.

SPECIFIC INSTRUCTIONS

Item 4 - Locations on Federal or Indian land should be described in accordance with Federal requirements. Consult the local Federal office for specific instructions.

Item 13: Proposals to abandon a well and subsequent reports of abandonment should include such special information as is required by the local Federal office. In addition, such proposals and reports should include reasons for the abandonment; data on any former or present productive zones or other zones with present significant fluid contents not sealed off by cement or otherwise; depths (top and bottom) and method of placement of cement plugs; mud or other material placed below, between and above plugs; amount, size, method of parting of any casing, liner or tubing pulled and the depth to the top of any tubing left in the hole; method of closing top of well and date well site conditioned for final inspection looking for approval of the abandonment. If the proposal will involve **hydraulic fracturing operations**, you must comply with 43 CFR 3162.3-3, including providing information about the protection of usable water. Operators should provide the best available information about all formations containing water and their depths. This information could include data and interpretation of resistivity logs run on nearby wells. Information may also be obtained from state or tribal regulatory agencies and from local BLM offices.

NOTICES

The privacy Act of 1974 and the regulation in 43 CFR 2.48(d) provide that you be furnished the following information in connection with information required by this application.

AUTHORITY: 30 U.S.C. 181 et seq., 351 et seq., 25 U.S.C. 396; 43 CFR 3160.

PRINCIPAL PURPOSE: The information is used to: (1) Evaluate, when appropriate, approve applications, and report completion of subsequent well operations, on a Federal or Indian lease; and (2) document for administrative use, information for the management, disposal and use of National Resource lands and resources, such as: (a) evaluating the equipment and procedures to be used during a proposed subsequent well operation and reviewing the completed well operations for compliance with the approved plan; (b) requesting and granting approval to perform those actions covered by 43 CFR 3162.3-2, 3162.3-3, and 3162.3-4; (c) reporting the beginning or resumption of production, as required by 43 CFR 3162.4-1(c) and (d) analyzing future applications to drill or modify operations in light of data obtained and methods used.

ROUTINE USES: Information from the record and/or the record will be transferred to appropriate Federal, State, local or foreign agencies, when relevant to civil, criminal or regulatory investigations or prosecutions in connection with congressional inquiries or to consumer reporting agencies to facilitate collection of debts owed the Government.

EFFECT OF NOT PROVIDING THE INFORMATION: Filing of this notice and report and disclosure of the information is mandatory for those subsequent well operations specified in 43 CFR 3162.3-2, 3162.3-3, 3162.3-4.

The Paperwork Reduction Act of 1995 requires us to inform you that:

The BLM collects this information to evaluate proposed and/or completed subsequent well operations on Federal or Indian oil and gas leases.

Response to this request is mandatory.

The BLM would like you to know that you do not have to respond to this or any other Federal agency-sponsored information collection unless it displays a currently valid OMB control number.

BURDEN HOURS STATEMENT: Public reporting burden for this form is estimated to average 8 hours per response, including the time for reviewing instructions, gathering and maintaining data, and completing and reviewing the form. Direct comments regarding the burden estimate or any other aspect of this form to U.S. Department of the Interior, Bureau of Land Management (1004-0137), Bureau Information Collection Clearance Officer (WO-630), 1849 C St., N.W., Mail Stop 401 LS, Washington, D.C. 20240

Additional Information

Location of Well

0. SHL: SWSE / 910 FSL / 1365 FEL / TWSP: 24S / RANGE: 29E / SECTION: 9 / LAT: 32.227378 / LONG: -103.985348 (TVD: 0 feet, MD: 0 feet)

PPP: NWNE / 1321 FNL / 2239 FEL / TWSP: 24S / RANGE: 29E / SECTION: 4 / LAT: 32.250403 / LONG: -103.988214 (TVD: 8506 feet, MD: 18393 feet)

PPP: SWNE / 2647 FNL / 2239 FEL / TWSP: 24S / RANGE: 29E / SECTION: 4 / LAT: 32.246757 / LONG: -103.988208 (TVD: 8509 feet, MD: 17067 feet)

PPP: NWSE / 1328 FSL / 2239 FEL / TWSP: 24S / RANGE: 29E / SECTION: 9 / LAT: 32.22852 / LONG: -103.988177 (TVD: 8525 feet, MD: 10433 feet)

PPP: SWSE / 100 FSL / 2110 FEL / TWSP: 24S / RANGE: 29E / SECTION: 9 / LAT: 32.225146 / LONG: -103.987751 (TVD: 8529 feet, MD: 9060 feet)

BHL: LOT 2 / 20 FNL / 2110 FEL / TWSP: 24S / RANGE: 29E / SECTION: 4 / LAT: 32.253979 / LONG: -103.9878 (TVD: 8504 feet, MD: 19271 feet)

PECOS DISTRICT DRILLING CONDITIONS OF APPROVAL

OPERATOR'S NAME:	OXY USA INCORPORATED
WELL NAME & NO.:	HEADS CC 9-4 FEDERAL COM / 24H
SURFACE HOLE FOOTAGE:	910'S & 1366'E
BOTTOM HOLE FOOTAGE:	20'N & 1970'E
LOCATION:	Section 9, T.24 S., R.29 E.
COUNTY:	Eddy County, New Mexico

ALL PREVIOUS COAs STILL APPLY

H2S	<input checked="" type="radio"/> Yes	<input type="radio"/> No	
Potash	<input checked="" type="radio"/> None	<input type="radio"/> Secretary	<input type="radio"/> R-111-P
Cave/Karst Potential	<input type="radio"/> Low	<input checked="" type="radio"/> Medium	<input type="radio"/> High
Cave/Karst Potential	<input type="radio"/> Critical		
Variance	<input type="radio"/> None	<input checked="" type="radio"/> Flex Hose	<input type="radio"/> Other
Wellhead	<input type="radio"/> Conventional	<input checked="" type="radio"/> Multibowl	<input type="radio"/> Both
Wellhead Variance	<input type="radio"/> Diverter		
Other	<input type="checkbox"/> 4 String	<input type="checkbox"/> Capitan Reef	<input type="checkbox"/> WIPP
Other	<input type="checkbox"/> Fluid Filled	<input type="checkbox"/> Pilot Hole	<input type="checkbox"/> Open Annulus
Cementing	<input type="checkbox"/> Contingency Cement Squeeze	<input type="checkbox"/> EchoMeter	<input checked="" type="checkbox"/> Primary Cement Squeeze
Special Requirements	<input type="checkbox"/> Water Disposal	<input checked="" type="checkbox"/> COM	<input type="checkbox"/> Unit
Special Requirements	<input type="checkbox"/> Batch Sundry		
Special Requirements Variance	<input checked="" type="checkbox"/> Break Testing	<input checked="" type="checkbox"/> Offline Cementing	<input checked="" type="checkbox"/> Casing Clearance

COA

A. CASING

COA for the proposed Falcon Design (2-string + production liner):

- Tie Back of the liner should be a minimum of 200' into the previous casing
- Surface and Intermediate cement to surface should be verified visually. If cement fallback is suspected, an Echo-meter can be run to verify cement top in the intermediate and a temp log may be run in the surface interval. CBL should be run if confidence is lacking in the surface or intermediate cement job. The proposed falcon design (2-string + production liner) is only approved when surface and intermediate sections are cemented to surface. Operator to revert to 3-string design when surface or intermediate cementing is of poor quality or not verified to surface
- Region 2 NACE certified intermediate casing must be used

- A third-party verification (such as thread rep or torque turn) must be conducted to ensure the connection makeups are to spec for the intermediate casing string exposed to frac pressures
- Corrosion inhibitors must be used in areas with corrosive production fluids
- Operator should actively monitor annulus during the completion phase. Wells should be monitored in a manner capable of identifying a casing leak or liner top packer leak, within an acceptable time frame while on production. Remedial work may be required to restore intermediate casing integrity or liner top packer integrity in a failure event
- BLM should be notified if cement is not verified to the liner top
- Surface location must NOT be located within SOPA, KPLA, Capitan Reef or High Cave Karst

Alternate Casing Design:

1. The **10-3/4** inch surface casing shall be set at approximately **612** feet (a minimum of 25 feet (Lea County) into the Rustler Anhydrite and above the salt) and cemented to the surface.
 - a. If cement does not circulate to the surface, the appropriate BLM office shall be notified and a temperature survey utilizing an electronic type temperature survey with surface log readout will be used or a cement bond log shall be run to verify the top of the cement. Temperature survey will be run a minimum of six hours after pumping cement and ideally between 8-10 hours after completing the cement job.
 - b. Wait on cement (WOC) time for a primary cement job will be a minimum of **8 hours** or 500 pounds compressive strength, whichever is greater. (This is to include the lead cement)
 - c. Wait on cement (WOC) time for a remedial job will be a minimum of 4 hours after bringing cement to surface or 500 pounds compressive strength, whichever is greater.
 - d. If cement falls back, remedial cementing will be done prior to drilling out that string.
2. The **7.827** inch intermediate casing shall be set at approximately **7913** feet The minimum required fill of cement behind the **7.827** inch intermediate casing is:

Option 1 (Single Stage):

- Cement to surface. If cement does not circulate see B.1.a, c-d above.
Wait on cement (WOC) time for a primary cement job is to include the lead cement slurry due to cave/karst or potash.

Option 2:

Operator has proposed a DV tool, the depth may be adjusted as long as the cement is changed proportionally. The DV tool may be cancelled if cement circulates to surface on the first stage.

- a. First stage to DV tool: Cement to circulate. If cement does not circulate off the DV tool, contact the appropriate BLM office before proceeding with second stage cement job.
- b. Second stage above DV tool:
 - Cement to surface. If cement does not circulate, contact the appropriate BLM office.
Wait on cement (WOC) time for a primary cement job is to include the lead cement slurry due to cave/karst or potash.

Operator has proposed to pump down 7.827" X 5-1/2" annulus. Operator must top out cement after the bradenhead squeeze and verify cement to surface. Operator can also check TOC with Echo-meter. CBL must be run from TD of the 7.827" casing to surface if confidence is lacking on the quality of the bradenhead squeeze cement job. Submit results to BLM.

3. The 5-1/2 inch production liner shall be set at approximately **19,571 feet. A minimum 200' tie back of production liner into the intermediate casing is required. Successful liner top pressure test critical for zonal isolation check. If ICP in Bone Spring Pool and lateral landed in Wolfcamp Pool, a CBL will be ran.** The minimum required fill of cement behind the 5-1/2 inch production liner is:
 - Cement should tie-back **200 feet** into the previous casing. Operator shall provide method of verification.
 - Operator has proposed 10% excess instead of 25% excess recommendation for the liner design and this is acceptable. Losses may need to be cured and pump rates may need to be modified to achieve cement tieback when losses occur or are anticipated in the production interval

GENERAL REQUIREMENTS

The BLM is to be notified in advance for a representative to witness:

- a. Spudding well (minimum of 24 hours)
- b. Setting and/or Cementing of all casing strings (minimum of 4 hours)
- c. BOPE tests (minimum of 4 hours)

☒ Eddy County
Call the Carlsbad Field Office, 620 East Greene St., Carlsbad, NM 88220,

(575) 361-2822

☒ Lea County

Call the Hobbs Field Station, 414 West Taylor, Hobbs NM 88240, (575)
689-5981

1. Unless the production casing has been run and cemented or the well has been properly plugged, the drilling rig shall not be removed from over the hole without prior approval.
 - a. In the event the operator has proposed to drill multiple wells utilizing a skid/walking rig. Operator shall secure the wellbore on the current well, after installing and testing the wellhead, by installing a blind flange of like pressure rating to the wellhead and a pressure gauge that can be monitored while drilling is performed on the other well(s).
 - b. When the operator proposes to set surface casing with Spudder Rig
 - Notify the BLM when moving in and removing the Spudder Rig.
 - Notify the BLM when moving in the 2nd Rig. Rig to be moved in within 90 days of notification that Spudder Rig has left the location.
 - BOP/BOPE test to be conducted per Onshore Oil and Gas Order No. 2 as soon as 2nd Rig is rigged up on well.
2. Floor controls are required for 3M or Greater systems. These controls will be on the rig floor, unobstructed, readily accessible to the driller and will be operational at all times during drilling and/or completion activities. Rig floor is defined as the area immediately around the rotary table; the area immediately above the substructure on which the draw works are located, this does not include the dog house or stairway area.
3. The record of the drilling rate along with the GR/N well log run from TD to surface (horizontal well – vertical portion of hole) shall be submitted to the BLM office as well as all other logs run on the borehole 30 days from completion. If available, a digital copy of the logs is to be submitted in addition to the paper copies. The Rustler top and top and bottom of Salt are to be recorded on the Completion Report.

A. CASING

1. Changes to the approved APD casing program need prior approval if the items substituted are of lesser grade or different casing size or are Non-API. The Operator can exchange the components of the proposal with that of superior strength (i.e. changing from J-55 to N-80, or from 36# to 40#). Changes to the approved cement program need prior approval if the altered cement plan has less volume or strength or if the changes are substantial (i.e. Multistage tool, ECP, etc.). The initial wellhead installed on the well will remain on the well with spools used as needed.

2. Wait on cement (WOC) for Potash Areas: After cementing but before commencing any tests, the casing string shall stand cemented under pressure until both of the following conditions have been met: 1) cement reaches a minimum compressive strength of 500 psi for all cement blends, 2) until cement has been in place at least 24 hours. WOC time will be recorded in the driller's log. The casing integrity test can be done (prior to the cement setting up) immediately after bumping the plug.
3. Wait on cement (WOC) for Water Basin: After cementing but before commencing any tests, the casing string shall stand cemented under pressure until both of the following conditions have been met: 1) cement reaches a minimum compressive strength of 500 psi at the shoe, 2) until cement has been in place at least 8 hours. WOC time will be recorded in the driller's log. See individual casing strings for details regarding lead cement slurry requirements. The casing integrity test can be done (prior to the cement setting up) immediately after bumping the plug.
4. Provide compressive strengths including hours to reach required 500 pounds compressive strength prior to cementing each casing string. Have well specific cement details onsite prior to pumping the cement for each casing string.
5. No pea gravel permitted for remedial or fall back remedial without prior authorization from the BLM engineer.
6. On that portion of any well approved for a 5M BOPE system or greater, a pressure integrity test of each casing shoe shall be performed. Formation at the shoe shall be tested to a minimum of the mud weight equivalent anticipated to control the formation pressure to the next casing depth or at total depth of the well. This test shall be performed before drilling more than 20 feet of new hole.
7. If hardband drill pipe is rotated inside casing, returns will be monitored for metal. If metal is found in samples, drill pipe will be pulled and rubber protectors which have a larger diameter than the tool joints of the drill pipe will be installed prior to continuing drilling operations.
8. Whenever a casing string is cemented in the R-111-P potash area, the NMOCD requirements shall be followed.

B. PRESSURE CONTROL

1. All blowout preventer (BOP) and related equipment (BOPE) shall comply with well control requirements as described in Onshore Oil and Gas Order No. 2 and API RP 53 Sec. 17.
2. If a variance is approved for a flexible hose to be installed from the BOP to the choke manifold, the following requirements apply: The flex line must meet the requirements of API 16C. Check condition of flexible line from BOP to choke

manifold, replace if exterior is damaged or if line fails test. Line to be as straight as possible with no hard bends and is to be anchored according to Manufacturer's requirements. The flexible hose can be exchanged with a hose of equal size and equal or greater pressure rating. Anchor requirements, specification sheet and hydrostatic pressure test certification matching the hose in service, to be onsite for review. These documents shall be posted in the company man's trailer and on the rig floor.

3. 5M or higher system requires an HCR valve, remote kill line and annular to match. The remote kill line is to be installed prior to testing the system and tested to stack pressure.
4. If the operator has proposed a multi-bowl wellhead assembly in the APD. The following requirements must be met:
 - a. Wellhead shall be installed by manufacturer's representatives, submit documentation with subsequent sundry.
 - b. If the welding is performed by a third party, the manufacturer's representative shall monitor the temperature to verify that it does not exceed the maximum temperature of the seal.
 - c. Manufacturer representative shall install the test plug for the initial BOP test.
 - d. Whenever any seal subject to test pressure is broken, all the tests in OOGO2.III.A.2.i must be followed.
 - e. If the cement does not circulate and one inch operations would have been possible with a standard wellhead, the well head shall be cut off, cementing operations performed and another wellhead installed.
5. The appropriate BLM office shall be notified a minimum of 4 hours in advance for a representative to witness the tests.
 - a. In a water basin, for all casing strings utilizing slips, these are to be set as soon as the crew and rig are ready and any fallback cement remediation has been done. The casing cut-off and BOP installation can be initiated four hours after installing the slips, which will be approximately six hours after bumping the plug. For those casing strings not using slips, the minimum wait time before cut-off is eight hours after bumping the plug. BOP/BOPE testing can begin after cut-off or once cement reaches 500 psi compressive strength (including lead cement), whichever is greater. However, if the float does not hold, cut-off cannot be initiated until cement reaches 500 psi compressive strength (including lead when specified).
 - b. In potash areas, for all casing strings utilizing slips, these are to be set as soon as the crew and rig are ready and any fallback cement remediation has been done. For all casing strings, casing cut-off and BOP installation can be initiated at twelve hours after bumping the cement plug. The BOPE test can be

initiated after bumping the cement plug with the casing valve open. (only applies to single stage cement jobs, prior to the cement setting up.)

- c. The tests shall be done by an independent service company utilizing a test plug not a cup or J-packer and can be initiated immediately with the casing valve open. The operator also has the option of utilizing an independent tester to test without a plug (i.e. against the casing) pursuant to Onshore Order 2 with the pressure not to exceed 70% of the burst rating for the casing. Any test against the casing must meet the WOC time for water basin (8 hours) or potash (24 hours) or 500 pounds compressive strength, whichever is greater, prior to initiating the test (see casing segment as lead cement may be critical item).
- d. The test shall be run on a 5000 psi chart for a 2-3M BOP/BOP, on a 10000 psi chart for a 5M BOP/BOPE and on a 15000 psi chart for a 10M BOP/BOPE. If a linear chart is used, it shall be a one hour chart. A circular chart shall have a maximum 2 hour clock. If a twelve hour or twenty-four hour chart is used, tester shall make a notation that it is run with a two hour clock.
- e. The results of the test shall be reported to the appropriate BLM office.
- f. All tests are required to be recorded on a calibrated test chart. A copy of the BOP/BOPE test chart and a copy of independent service company test will be submitted to the appropriate BLM office.
- g. The BOP/BOPE test shall include a low pressure test from 250 to 300 psi. The test will be held for a minimum of 10 minutes if test is done with a test plug and 30 minutes without a test plug. This test shall be performed prior to the test at full stack pressure.
- h. BOP/BOPE must be tested by an independent service company within 500 feet of the top of the Wolfcamp formation if the time between the setting of the intermediate casing and reaching this depth exceeds 20 days. This test does not exclude the test prior to drilling out the casing shoe as per Onshore Order No. 2.

C. DRILLING MUD

Mud system monitoring equipment, with derrick floor indicators and visual and audio alarms, shall be operating before drilling into the Wolfcamp formation, and shall be used until production casing is run and cemented.

D. WASTE MATERIAL AND FLUIDS

All waste (i.e. drilling fluids, trash, salts, chemicals, sewage, gray water, etc.) created as a result of drilling operations and completion operations shall be safely contained and

disposed of properly at a waste disposal facility. No waste material or fluid shall be disposed of on the well location or surrounding area.

Porto-johns and trash containers will be on-location during fracturing operations or any other crew-intensive operations.

KPI – 01/25/2024

District I
1625 N. French Dr., Hobbs, NM 88240
Phone: (575) 393-6161 Fax: (575) 393-0720
District II
811 S. First St., Artesia, NM 88210
Phone: (575) 748-1283 Fax: (575) 748-9720
District III
1000 Rio Brazos Road, Aztec, NM 87410
Phone: (505) 334-6178 Fax: (505) 334-6170
District IV
1220 S. St. Francis Dr., Santa Fe, NM 87505
Phone: (505) 476-3460 Fax: (505) 476-3462

State of New Mexico
Energy, Minerals & Natural Resources Department
OIL CONSERVATION DIVISION
1220 South St. Francis Dr.
Santa Fe, NM 87505

Form C-102
Revised August 1, 2011
Submit one copy to appropriate
District Office

☒ AMENDED REPORT

WELL LOCATION AND ACREAGE DEDICATION PLAT

¹ API Number 30-015-47337	² Pool Code 96473	³ Pool Name PIERCE CROSSING; BONE SPRING EAST
⁴ Property Code 328290	⁵ Property Name HEADS CC 9 4 FED COM	
⁷ OGRID No. 16696	⁸ Operator Name OXY USA INC.	⁶ Well Number 24H
		⁹ Elevation 2935.7'

¹⁰ Surface Location

UL or lot no. O	Section 9	Township 24S	Range 29E	Lot Idn	Feet from the 910	North/South line SOUTH	Feet from the 1366	East/West line EAST	County EDDY
--------------------	--------------	-----------------	--------------	---------	----------------------	---------------------------	-----------------------	------------------------	----------------

¹¹ Bottom Hole Location If Different From Surface

UL or lot no. 2	Section 4	Township 24S	Range 29E	Lot Idn	Feet from the 20	North/South line NORTH	Feet from the 1970	East/West line EAST	County EDDY
¹² Dedicated Acres 1280	¹³ Joint or Infill Y	¹⁴ Consolidation Code		¹⁵ Order No.					

No allowable will be assigned to this completion until all interests have been consolidated or a non-standard unit has been approved by the division.

¹⁶ NAD 83 (SURFACE HOLE LOCATION) LATITUDE = 32°13'38.56" (32.227378°) LONGITUDE = -103°59'07.25" (-103.985349°) NAD 27 (SURFACE HOLE LOCATION) LATITUDE = 32°13'38.12" (32.227255°) LONGITUDE = -103°59'05.49" (-103.984860°) STATE PLANE NAD 83 (N.M. EAST) N: 446628.05' E: 648941.87' STATE PLANE NAD 27 (N.M. EAST) N: 446569.08' E: 607758.04'	NAD 83 (KICK OFF POINT) LATITUDE = 32°13'26.58" (32.224049°) LONGITUDE = -103°59'14.26" (-103.987293°) NAD 27 (KICK OFF POINT) LATITUDE = 32°13'26.14" (32.223927°) LONGITUDE = -103°59'12.50" (-103.986804°) STATE PLANE NAD 83 (N.M. EAST) N: 445415.26' E: 648344.42' STATE PLANE NAD 27 (N.M. EAST) N: 445356.31' E: 607160.56'	NAD 83 (FIRST TAKE POINT) LATITUDE = 32°13'30.53" (32.225149°) LONGITUDE = -103°59'14.27" (-103.987297°) NAD 27 (FIRST TAKE POINT) LATITUDE = 32°13'30.09" (32.225026°) LONGITUDE = -103°59'12.51" (-103.986808°) STATE PLANE NAD 83 (N.M. EAST) N: 445815.17' E: 648341.88' STATE PLANE NAD 27 (N.M. EAST) N: 445756.21' E: 607158.03'
NAD 83 (LEASE CROSSING 1) LATITUDE = 32°13'42.69" (32.228524°) LONGITUDE = -103°59'14.29" (-103.987303°) NAD 27 (LEASE CROSSING 1) LATITUDE = 32°13'42.24" (32.228401°) LONGITUDE = -103°59'12.53" (-103.986814°) STATE PLANE NAD 83 (N.M. EAST) N: 447042.95' E: 648336.18' STATE PLANE NAD 27 (N.M. EAST) N: 446983.97' E: 607152.36'	NAD 83 (LEASE CROSSING 2) LATITUDE = 32°14'48.35" (32.246763°) LONGITUDE = -103°59'14.40" (-103.987333°) NAD 27 (LEASE CROSSING 2) LATITUDE = 32°14'47.90" (32.246640°) LONGITUDE = -103°59'12.64" (-103.986844°) STATE PLANE NAD 83 (N.M. EAST) N: 453677.97' E: 648305.39' STATE PLANE NAD 27 (N.M. EAST) N: 453618.85' E: 607121.73'	NAD 83 (LEASE CROSSING 3) LATITUDE = 32°15'01.48" (32.250412°) LONGITUDE = -103°59'14.42" (-103.987339°) NAD 27 (LEASE CROSSING 3) LATITUDE = 32°15'01.04" (32.250290°) LONGITUDE = -103°59'12.66" (-103.986850°) STATE PLANE NAD 83 (N.M. EAST) N: 455005.54' E: 648299.22' STATE PLANE NAD 27 (N.M. EAST) N: 454946.40' E: 607115.60'
NAD 83 (LAST TAKE POINT) LATITUDE = 32°15'13.53" (32.253759°) LONGITUDE = -103°59'14.44" (-103.987345°) NAD 27 (LAST TAKE POINT) LATITUDE = 32°15'13.09" (32.253637°) LONGITUDE = -103°59'12.68" (-103.986855°) STATE PLANE NAD 83 (N.M. EAST) N: 456223.33' E: 648293.57' STATE PLANE NAD 27 (N.M. EAST) N: 456164.15' E: 607109.98'		
NAD 83 (BOTTOM HOLE LOCATION) LATITUDE = 32°15'14.33" (32.253979°) LONGITUDE = -103°59'14.44" (-103.987345°) NAD 27 (BOTTOM HOLE LOCATION) LATITUDE = 32°15'13.89" (32.253857°) LONGITUDE = -103°59'12.68" (-103.986855°) STATE PLANE NAD 83 (N.M. EAST) N: 456303.31' E: 648293.24' STATE PLANE NAD 27 (N.M. EAST) N: 456244.13' E: 607109.66'		

**¹⁷ OPERATOR
CERTIFICATION**

I hereby certify that the information contained herein is true and complete to the best of my knowledge and belief, and that this organization either owns a working interest or unleased mineral interest in the land including the proposed bottom hole location or has a right to drill this well at this location pursuant to a contract with an owner of such a mineral or working interest, or to a voluntary pooling agreement or a compulsory pooling order heretofore entered by the division.

Signature

10/12/2023

Date

STEPHEN JANACEK

Printed Name

STEPHEN_JANACEK@OXY.COM

E-mail Address

**¹⁸ SURVEYOR
CERTIFICATION**

I hereby certify that the well location shown on this plat was plotted from field notes of actual surveys made by me or under my supervision, and that the same is true and correct to the best of my belief.

Date of Survey
June 2, 2023

Signature and Seal of Professional Surveyor:

23782

06-20-23

PAUL BUCHELE

NEW MEXICO

PROFESSIONAL SURVEYOR

Certificate Number:

HSU COORDINATES				
		NAD 27 N.M. STATE PLANE, EAST ZONE		NAD 83 N.M. STATE PLANE, EAST ZONE
POINT	NORTHING	EASTING	NORTHING	EASTING
A	456251.93'	603786.25'	456311.10'	644969.83'
B	456261.68'	606432.26'	456320.85'	647615.84'
C	456271.26'	609079.15'	456330.43'	650262.74'
D	453629.22'	609089.75'	453688.34'	650273.41'
E	450974.81'	609100.88'	451033.87'	650284.61'
F	448322.87'	609114.24'	448381.88'	650298.04'
G	445667.28'	609128.10'	445726.23'	650311.96'
H	445637.62'	603837.40'	445696.58'	645021.24'
I	448292.86'	603824.90'	448351.88'	645008.68'
J	450947.86'	603813.62'	451006.92'	644997.33'
K	453601.34'	603799.71'	453660.46'	644983.36'

See Detail "B"

NOTE:
• Distances referenced on plat to section lines are perpendicular.
• Basis of Bearings is a Transverse Mercator Projection with a Central Meridian of W103°53'00" (NAD 83)

See Detail "A"

SCALE
DRAWN BY: N.R. 06-20-23

SW Cor. Sec. 16

Detail "A" No Scale

Detail "B" No Scale

LINE TABLE			LINE TABLE		
LINE	DIRECTION	LENGTH	LINE	DIRECTION	LENGTH
L1	N89°58'16"W	2646.59'	L12	N00°01'52"W	2655.89'
L2	N89°58'02"W	2647.47'	L13	N00°00'17"W	2655.63'
L3	N00°00'31"E	2642.67'	L14	N00°08'44"W	2654.77'
L4	N00°00'06"W	2655.05'	L15	N00°09'55"E	5303.34'
L5	S89°57'15"W	2644.28'	L16	S26°27'58"W	1352.25'
L6	S89°56'31"W	2644.18'	L17	N00°07'26"W	400.00'
L7	N00°03'42"W	2654.14'	L18	N00°01'33"W	1228.06'
L8	N00°03'08"W	2651.24'	L19	N00°01'33"W	6636.49'
L9	N00°03'00"W	2652.59'	L20	N00°01'33"W	1327.87'
L10	N00°03'37"W	2656.24'	L21	N00°01'33"W	1218.05'
L11	S89°55'08"W	5291.92'	L22	N00°00'31"E	80.00'

Received by OCD: 1/26/2024 2:04:11 PM

Released to Imaging: 1/26/2024 4:19:58 PM



TenarisHydril Wedge 463®



Coupling	Pipe Body
Grade: P110-S	Grade: P110-S
Body: White	1st Band: White
1st Band: Orange	2nd Band: Orange
2nd Band: -	3rd Band: -
3rd Band: -	4th Band: -
	5th Band: -
	6th Band: -

Outside Diameter	7.827 in.	Wall Thickness	0.500 in.	Grade	P110-S
Min. Wall Thickness	87.50 %	Pipe Body Drift	Special Drift	Type	Casing
Connection OD Option	REGULAR				

Pipe Body Data

Geometry				Performance	
Nominal OD	7.827 in.	Wall Thickness	0.500 in.	Body Yield Strength	1266 x1000 lb
Nominal Weight	39.30 lb/ft	Plain End Weight	39.16 lb/ft	Min. Internal Yield Pressure	12,300 psi
Drift	6.750 in.	OD Tolerance	API	SMYS	110,000 psi
Nominal ID	6.827 in.			Collapse Pressure	10,490 psi

Connection Data

Geometry		Performance		Make-Up Torques	
Connection OD	8.500 in.	Tension Efficiency	100 %	Minimum	22,000 ft-lb
Coupling Length	10.950 in.	Joint Yield Strength	1266 x1000 lb	Optimum	23,000 ft-lb
Connection ID	6.814 in.	Internal Pressure Capacity	12,300 psi	Maximum	27,000 ft-lb
Make-up Loss	4.520 in.	Compression Efficiency	100 %	Operation Limit Torques	
Threads per inch	3.25	Compression Strength	1266 x1000 lb	Operating Torque	61,000 ft-lb
Connection OD Option	Regular	Max. Allowable Bending	64.42 °/100 ft	Yield Torque	70,000 ft-lb
		External Pressure Capacity	10,490 psi	Buck-On	
		Coupling Face Load	414,177 lb	Minimum	26,000 ft-lb
				Maximum	29,000 ft-lb

Notes

For the latest performance data, always visit our website: www.tenaris.com
For further information on concepts indicated in this datasheet, download the Datasheet Manual from www.tenaris.com

Tenaris has issued this document for general information only, and the information in this document, including, without limitation, any pictures, drawings or designs ("Information") is not intended to constitute professional or any other type of advice or recommendation and is provided on an "as is" basis. No warranty is given. Tenaris has not independently verified any information –if any- provided by the user in connection with, or for the purpose of, the Information contained hereunder. The use of the Information is at user's own risk and Tenaris does not assume any responsibility or liability of any kind for any loss, damage or injury resulting from, or in connection with any Information contained hereunder or any use thereof. The Information in this document is subject to change or modification without notice. Tenaris's products and services are subject to Tenaris's standard terms and conditions or otherwise to the terms resulting from the respective contracts of sale or services, as the case may be, between petitioner and Tenaris. For more complete information please contact a Tenaris's representative or visit our website at www.tenaris.com . ©Tenaris 2023. All rights reserved.

P11/C11

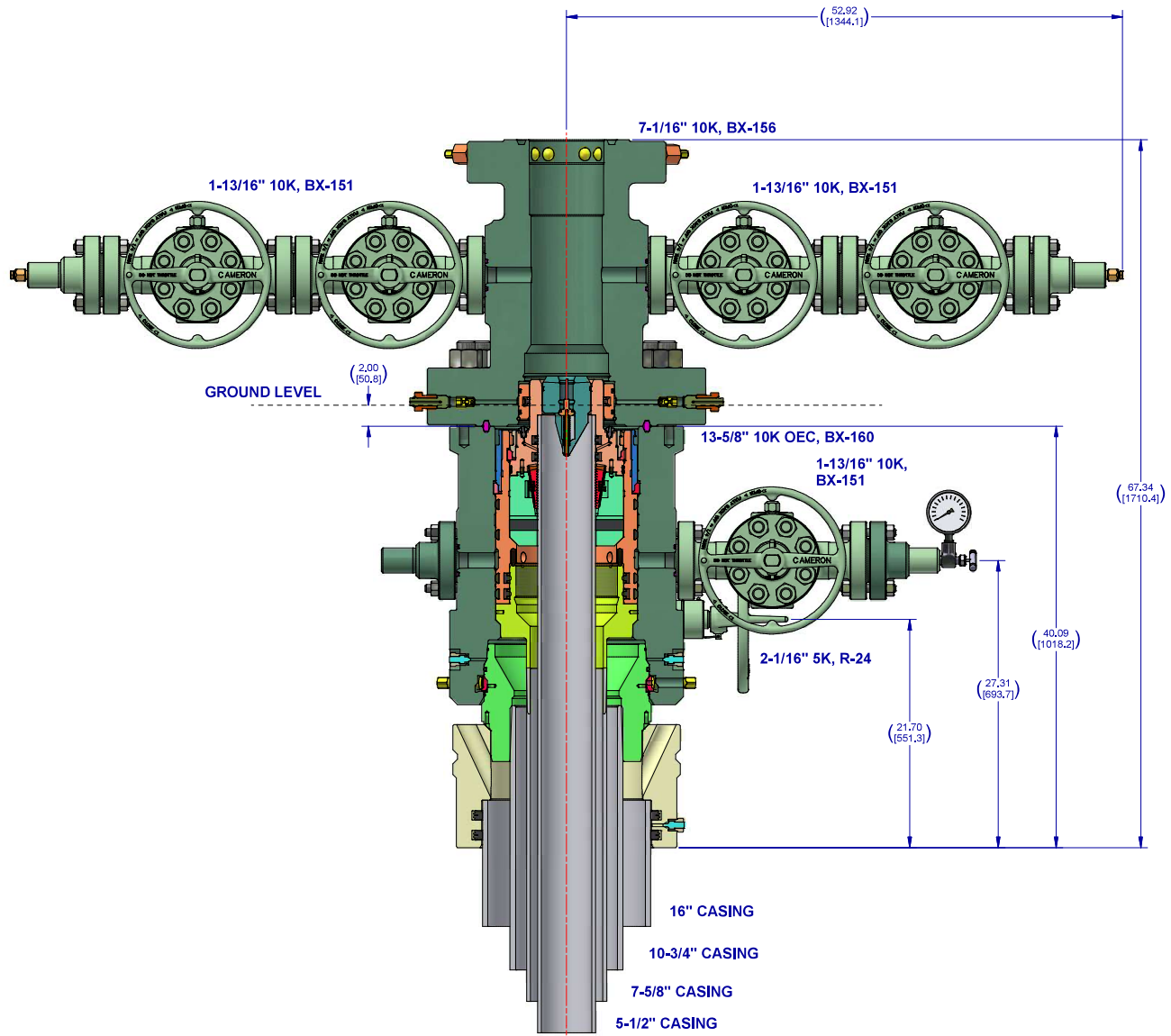

Notes:

1. THIS IS A PROPOSAL DRAWING AND DIMENSIONS SHOWN ARE SUBJECT TO CHANGE DURING THE FINAL DESIGN PROCESS.

2. DIGITALLY ENABLED SOLUTIONS, CHOKES AND ESD'S AVAILABLE ON REQUEST

CONFIDENTIAL					
SURFACE TREATMENT		DO NOT SCALE		CAMERON A Schlumberger Company	
DRAWN BY		DATE		SURFACE SYSTEMS	
D. GOTTUNG		2 Dec 21			
CHECKED BY		DATE			
D. GOTTUNG		2 Dec 21			
APPROVED BY		DATE			
D. GOTTUNG		2 Dec 21			
ESTIMATED WEIGHT		6515.617 LBS (2955.434 KG)		SHEET 4 of 4	
		INTERNAL USE BOM		SD-053434-94-05	
				REV 01	

5/10M BOP Stack

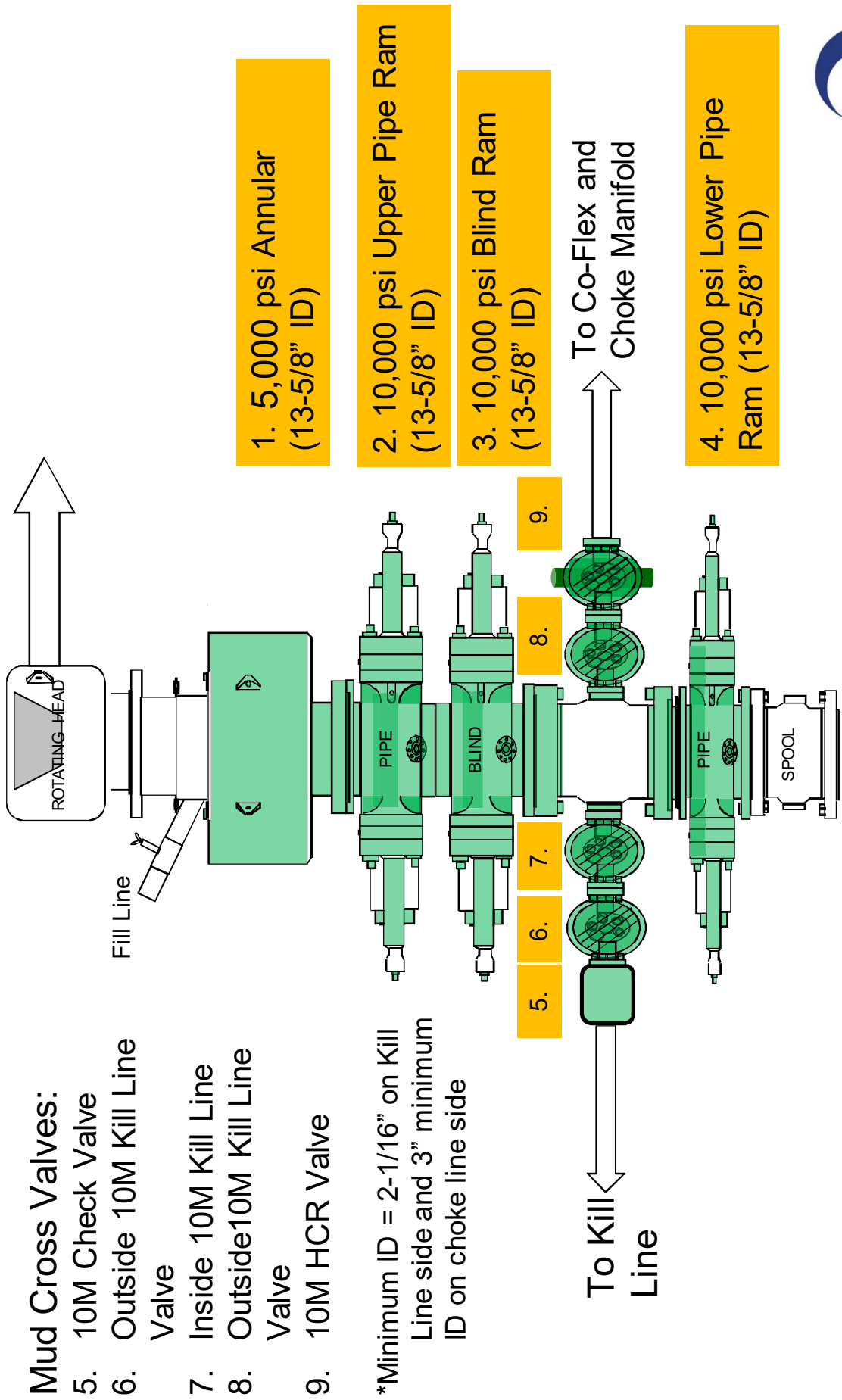

BOP Break Testing Request

Oxy requests permission to adjust the BOP break testing requirements as per the agreement reached in the OXY/BLM meeting on September 5, 2019.

BOP break test under the following conditions:

- After a full BOP test is conducted
- When skidding to drill an intermediate section where ICP is set into the third Bone Spring or shallower.
- When skidding to drill a production section that does not penetrate into the third Bone Spring or deeper.

If the kill line is broken prior to skid, two tests will be performed.

- 1) Wellhead flange, co-flex hose, kill line connections and upper pipe rams
- 2) Wellhead flange, HCR valve, check valve, upper pipe rams

If the kill line is not broken prior to skid, only one test will be performed.

- 1) Wellhead flange, co-flex hose, check valve, upper pipe rams

See supporting information below:

Subject: Request for a Variance Allowing Break Testing of a Blowout Preventer Stack

OXY USA Inc. (OXY) requests a variance to allow break testing of the Blowout Preventer (BOP) stack when skidding a drilling rig between wells on multi-well pads. This practice entails retesting only the connections of the **BOP** stack that have been disconnected during this operation and not a complete **BOP** test.

Background

43 CFR part 3170 Subpart 3172 states that a **BOP** test must be performed whenever any seal subject to test pressure is broken. The current interpretation of the Bureau of Land Management (BLM) is this requires a complete **BOP** test and not just a test of the affected component. 43 CFR part 3170 Subpart 3172, Section I.D.2. states, "Some situations may exist either on a well-by-well basis or field-wide basis whereby it is commonly accepted practice to vary a particular minimum standard(s) established in this Order. This situation can be resolved by requesting a variance...". OXY feels the practice of break testing the **BOP** stack is such a situation. Therefore, as per 43 CFR part 3170 Subpart 3172, Section IV., OXY submits this request for the variance.

Supporting Rationale

43 CFR part 3170 Subpart 3172 became effective on December 19, 1988, and has remained the standard for regulating BLM onshore drilling operations for almost 30 years. During this time there have been significant changes in drilling technology. **BLM** continues to use the variance request process to allow for the use of modern technology and acceptable engineering practices that have arisen since 43 CFR part 3170 Subpart 3172 was originally released. The drilling rig fleet OXY utilizes in New Mexico was built with many modern upgrades. One of which allows the rigs to skid between wells on multi-well pads. A part of this rig package is a hydraulic winch system which safely installs and removes the BOP from the wellhead and carries it during skidding operations. This technology has made break testing a safe and reliable procedure.

American Petroleum Institute (API) standards, specifications and recommended practices are considered industry standards and are consistently utilized and referenced by the industry. 43 CFR part 3170 Subpart 3172 recognized API Recommended Practices (RP) 53 in its original development. API Standard 53,

Blowout Prevention Equipment Systems for Drilling Wells (Fourth Edition, November 2012, Addendum 1, July 2016) recognizes break testing as an acceptable practice. Specifically, API Standard 53, Section 6.5.3.4.1.b states "Pressure tests on the well control equipment shall be conducted after the disconnection or repair of any pressure containment seal in the **BOP** stack, choke line, kill line, choke manifold, or wellhead assembly but limited to the affected component."

The Bureau of Safety and Environmental Enforcement (BSEE), Department of Interior, has also utilized the API standards, specifications and best practices in the development of its offshore oil and gas regulations and incorporates them by reference within its regulations. BSEE issued new offshore regulations under 30 CFR Part 250, *Oil and Gas and Sulphur Operations in the Outer Continental Shelf - Blowout Preventer Systems and Well Control*, which became effective on July 28, 2016. Section 250.737(d.1) states "Follow the testing requirements of API Standard 53". In addition, Section 250.737(d.8) has adopted language from **API** Standard 53 as it states "Pressure test affected **BOP** components following the disconnection or repair of any well-pressure containment seal in the wellhead or **BOP** stack assembly".

Break testing has been approved by the BLM in the past. See the Appendix for a Sundry Notice that was approved in 2015 by the Farmington Field Office. This approval granted permission for the operator to break test when skidding its Aztec 1000 rig on multi-well pads.

Oxy feels break testing and our current procedures meet the intent of 43 CFR part 3170 Subpart 3172 and often exceed it. We have not seen any evidence that break testing results in more components failing tests than seen on full BOP tests. As skidding operations take place within the 30-day full BOPE test window, the BOP shell and components such as the pipe rams and check valve get tested to the full rated working pressure more often. Therefore, there are more opportunities to ensure components are in good working order. Also, Oxy's standard requires complete BOP tests more often than that of 43 CFR part 3170 Subpart 3172. In addition to function testing the annular at least weekly and the pipe and blind rams on each trip, Oxy also performs a choke drill prior to drilling out every casing shoe. As a crew's training is a vital part of well control, this procedure to simulate step one of the Driller's Method exceeds the requirements of 43 CFR part 3170 Subpart 3172.

Procedures

- 1) OXY to submit the break testing plan in the APD or Sundry Notice (SN) and receive approval prior to implementing (See Appendix for examples)
- 2) OXY would perform BOP break testing on multi-well pads where multiple intermediate sections can be drilled and cased within the 30-day BOP test window
- 3) After performing a complete BOP test on the first well and drilling and casing the hole section, three breaks would be made on the BOP.
 - Between the check valve and the kill line
 - Between the HCR valve and the co-flex hose or the co-flex hose and the manifold
 - Between the BOP flange and the wellhead
- 4) The BOP is then lifted and removed from the wellhead by the hydraulic winch system
- 5) After skidding to the next well, the BOP is moved to the wellhead by the hydraulic winch system and installed
- 6) The choke line and kill line are reconnected
- 7) A test plug is installed in the wellhead with a joint of drill pipe and the internal parts of the check valve are removed
- 8) A shell test is performed against the upper pipe rams testing all three breaks
- 9) The internal parts of the check valve are reinstalled and the HCR valve is closed. A second test is performed on them
- 10) These tests consist of a 250 psi low test and a high test to the value submitted in the APD or SN (e.g., 5000 psi)
- 11) Perform a function test of components not pressure tested to include the lower pipe rams, the blind rams and the annular
- 12) If this were a three well pad, the same three breaks on the BOP would be made and steps 4 through 11 would be repeated
- 13) A second break test would only be done if the third hole section could be completed within the 30-day BOP test window
- 14) If a second break test is performed, additional components that were not tested on the initial break test will be tested on this break test

Notes:

- a. If any parts of the BOP are changed out or any additional breaks are made during the skidding operation, these affected components would also be tested as in step 10.
- b. As the choke manifold remains stationary during the skidding operation and the only break to the manifold is tested in step 8 above, no further testing of the manifold is done until the next full BOP test.

Summary

OXY requests a variance to allow break testing of the BOP stack when skidding drilling rigs between wells on multi-well pads. API standards, specifications and recommended practices are considered industry standards and are consistently utilized and referenced by the industry and the BLM. API Standard 53 recognizes break testing as an acceptable practice and BSEE adopted language from this standard into its newly created 30 CFR Part 250 which also supports break testing. Due to this, OXY feels this request meets the intent of 43 CFR part 3170

REQUEST FOR A VARIANCE TO BREAK TEST THE BOP

Permian Resources New Mexico

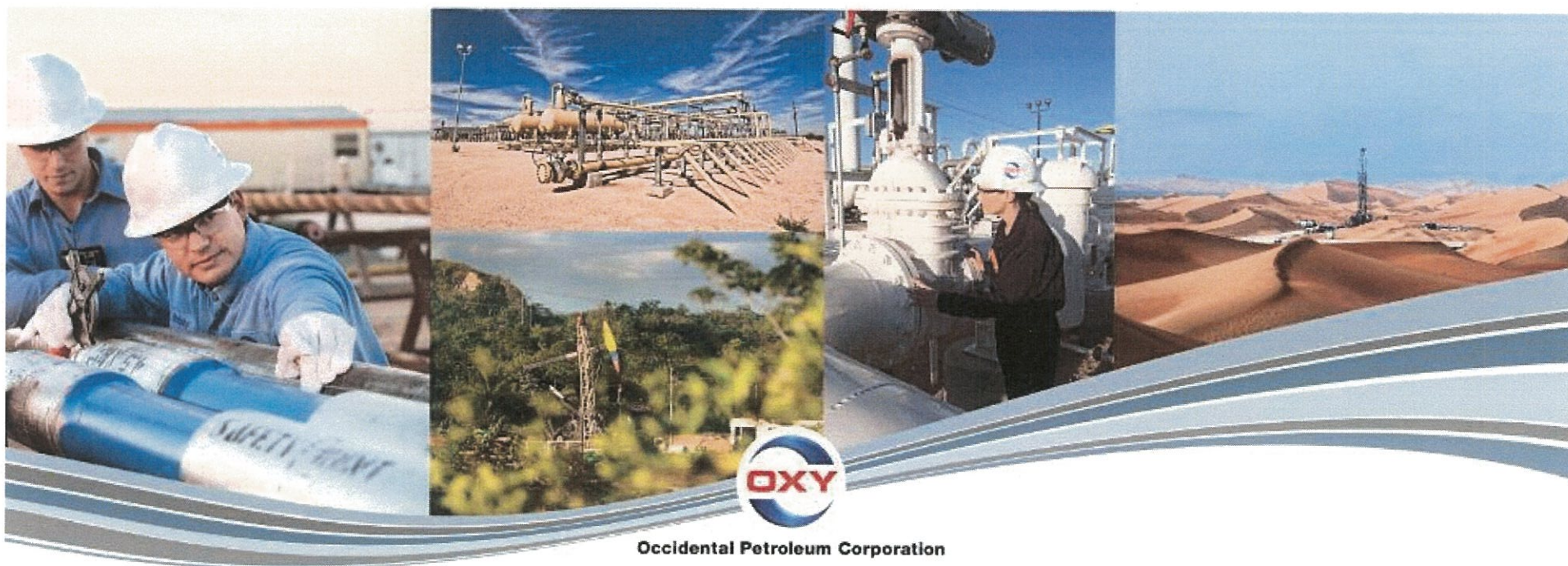

Occidental Petroleum Corporation

Request for Variance

OXY USA Inc. (OXY) requests a variance to allow break testing of the Blowout Preventer (BOP) stack when skidding a drilling rig between wells on multi-well pads

- This practice entails retesting only the connections of the BOP stack that have been disconnected during this operation and not a complete BOP test.
- As the choke manifold remains stationary during the skidding operation and the only break to the manifold is tested, no further testing of the manifold is done until the next full BOP test.
- This request is being made as per Section IV of the *Onshore Oil and Gas Order (OOGO) No. 2*

Rationale for Allowing BOP Break Testing

American Petroleum Institute (API) standards, specifications and recommended practices are considered industry standards and are consistently utilized and referenced by the industry

- API Standard 53, *Blowout Prevention Equipment Systems for Drilling Wells* (Fourth Edition, November 2012, Addendum 1, July 2016) recognizes break testing as an acceptable practice.
- Specifically, API Standard 53, Section 6.5.3.4.1.b states “Pressure tests on the well control equipment shall be conducted after the disconnection or repair of any pressure containment seal in the BOP stack, choke line, kill line, choke manifold, or wellhead assembly but limited to the affected component.”



Rationale for Allowing BOP Break Testing

The Bureau of Safety and Environmental Enforcement (BSEE), Department of Interior, has also utilized the API standards, specifications and best practices in the development of its offshore oil and gas regulations and incorporates them by reference within its regulations.

- BSEE issued new offshore regulations in July 2016 under 30 CFR Part 250, *Oil and Gas and Sulphur Operations in the Outer Continental Shelf - Blowout Preventer Systems and Well Control*. Within these regulations is language adopted from API Standard 53 which also supports break testing.
- Specifically, Section 250.737(d.8) states “Pressure test affected BOP components following the disconnection or repair of any well-pressure containment seal in the wellhead or BOP stack assembly.”

Rationale for Allowing BOP Break Testing

Break testing has been approved by the BLM in the past

- The Farmington Field Office approved a Sundry Notice (SN) to allow break testing in 2015
- This SN granted permission for the operator to break test when skidding its Aztec 1000 rig on multi-well pads

Oxy feels break testing and our current procedures meet or exceed the intent of OOGO No. 2

- As skidding operations take place within the 30-day full BOPE test window, the BOP shell and components such as the pipe rams and check valve get tested to the full rated working pressure more often
- Oxy's standard requires complete BOP tests more often than that of OOGO No. 2
- Oxy performs a choke drill prior to drilling out every casing shoe. As a crew's training is a vital part of well control, this procedure to simulate step one of the Driller's Method exceeds the requirements of OOGO No. 2



Break Testing Procedures

- 1) OXY to submit the break testing plan in the APD or Sundry Notice (SN) and receive approval prior to implementing
- 2) OXY would perform BOP break testing on multi-well pads where multiple intermediate sections can be drilled and cased within the full BOP test window
- 3) After performing a complete BOP test on the first well and drilling and casing the hole section, three breaks would be made on the BOP.
 - Between the check valve and the kill line
 - Between the HCR valve and the co-flex hose or the co-flex hose and the manifold
 - Between the BOP flange and the wellhead
- 4) The BOP is then lifted and removed from the wellhead by the hydraulic winch system
- 5) After skidding to the next well, the BOP is moved to the wellhead by the hydraulic winch system and installed
- 6) The choke line and kill line are reconnected
- 7) A test plug is installed in the wellhead with a joint of drill pipe and the internal parts of the check valve are removed



Break Testing Procedures

- 8) A shell test is performed against the upper pipe rams testing all three breaks
- 9) The internal parts of the check valve are reinstalled and the HCR valve is closed.
A second test is performed on them
- 10) These tests consist of a 250 psi low test and a high test to the value submitted in the APD or SN (e.g., 5000 psi)
- 11) Perform a function test of components not pressure tested to include the lower pipe rams, the blind rams and the annular
- 12) If this were a three well pad, the same three breaks on the BOP would be made and steps 4 through 11 would be repeated
- 13) A second break test would only be done if the third hole section could be completed within the 30-day BOP test window
- 14) If a second break test is performed, additional components that were not tested on the first break test will be tested



Break Testing Procedures and Tests

1. After performing a complete BOP test on the first well, the BOP is removed, the rig is skidded and the BOP is installed on the second well

2. A test plug is installed in the wellhead on drill pipe and the inner components of the check valve are removed

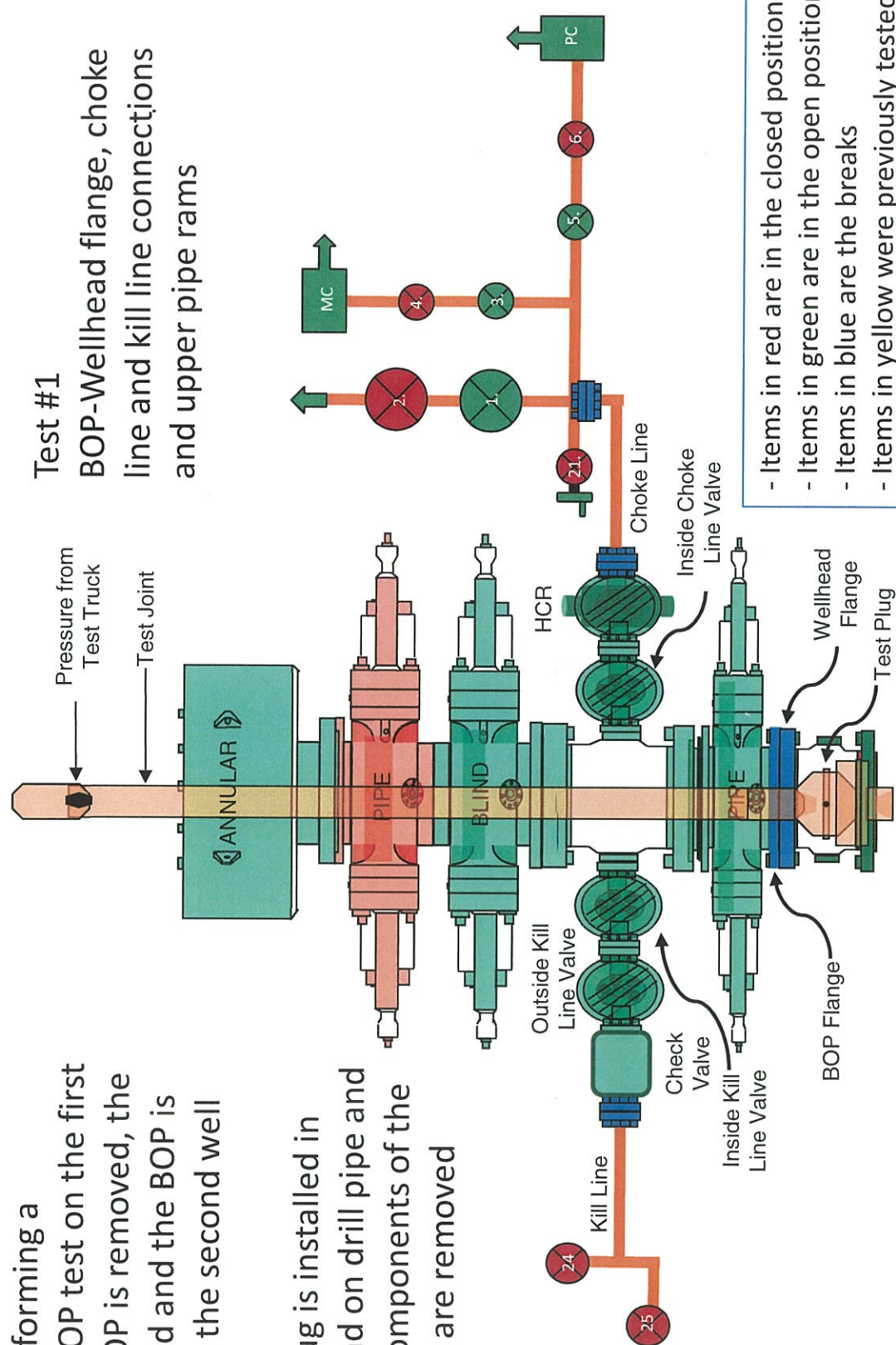

Break Testing Procedures and Tests

3. After Test #1, the inner components of the check valve are reinstalled and the HCR valve is closed



- Items in red are in the closed position
- Items in green are in the open position
- Items in blue are the breaks
- Items in yellow were previously tested



3. After Test #1, the inner components of the check valve are reinstalled and the inside choke line valve is closed

BOP-Wellhead flange, inside
choke line valve, check valve
and upper pipe rams

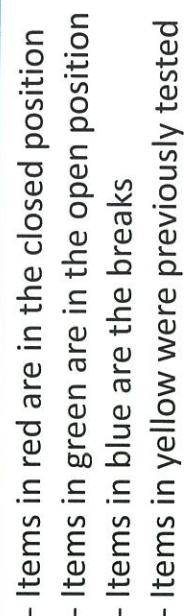

BOP Handling System



Hydraulic winch system which moves the BOP from its carrier to the wellhead

BOP standing in its carrier





12

BOP Handling System



Hydraulic winch
system moving
the BOP over to
the wellhead

Wellhead

Summary for Variance Request for Break Testing

- API standards, specifications and recommended practices are considered industry standards
 - OOGO No. 2 recognized API Recommended Practices (RP) 53 in its original development
 - API Standard 53 recognizes break testing as an acceptable practice
 - The Bureau of Safety and Environmental Enforcement has utilized API standards, specifications and best practices in the development of its offshore oil and gas regulations
 - API Standard 53 recognizes break testing as an acceptable practice
- OXY feels break testing meets the intent of OOGO No. 2 to protect public health and safety and the environment

Bradenhead Cement CBL Variance Request

Oxy requests permission to adjust the CBL requirement after bradenhead cement jobs, on 7-5/8" intermediate casings, as per the agreement reached in the OXY/BLM meeting on September 5, 2019.

Three string wells:

- CBL will be required on one well per pad
- If the pumped volume of cement is less than permitted in the APD, BLM will be notified and a CBL may be run
- Echometer will be used after bradenhead cement job to determine TOC before pumping top-out cement

Four string wells:

- CBL is not required
- If the pumped volume of cement is less than permitted in the APD, BLM will be notified and a CBL may be run
- Echometer will be used after bradenhead cement job to determine TOC before pumping top-out cement

10M Choke Panel

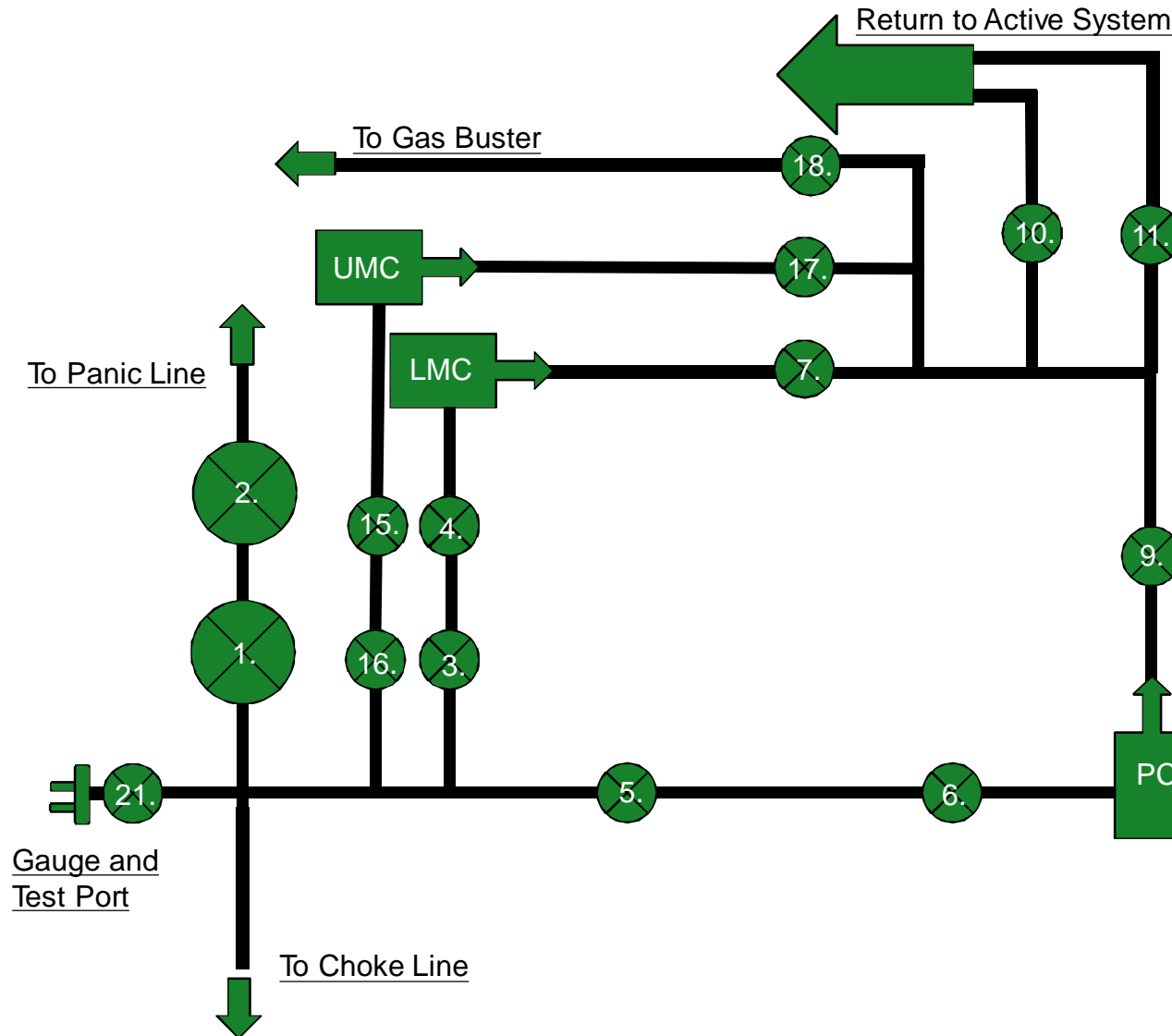

1. Choke Manifold Valve
2. Choke Manifold Valve
3. Choke Manifold Valve
4. Choke Manifold Valve
5. Choke Manifold Valve
6. Choke Manifold Valve
7. Choke Manifold Valve
8. PC – Power Choke
9. Choke Manifold Valve
10. Choke Manifold Valve
11. Choke Manifold Valve
12. LMC – Lower Manual Choke
13. UMC – Upper manual choke

15. Choke Manifold Valve
16. Choke Manifold Valve
17. Choke Manifold Valve
18. Choke Manifold Valve

21. Vertical Choke Manifold Valve

***All Valves 3" minimum**

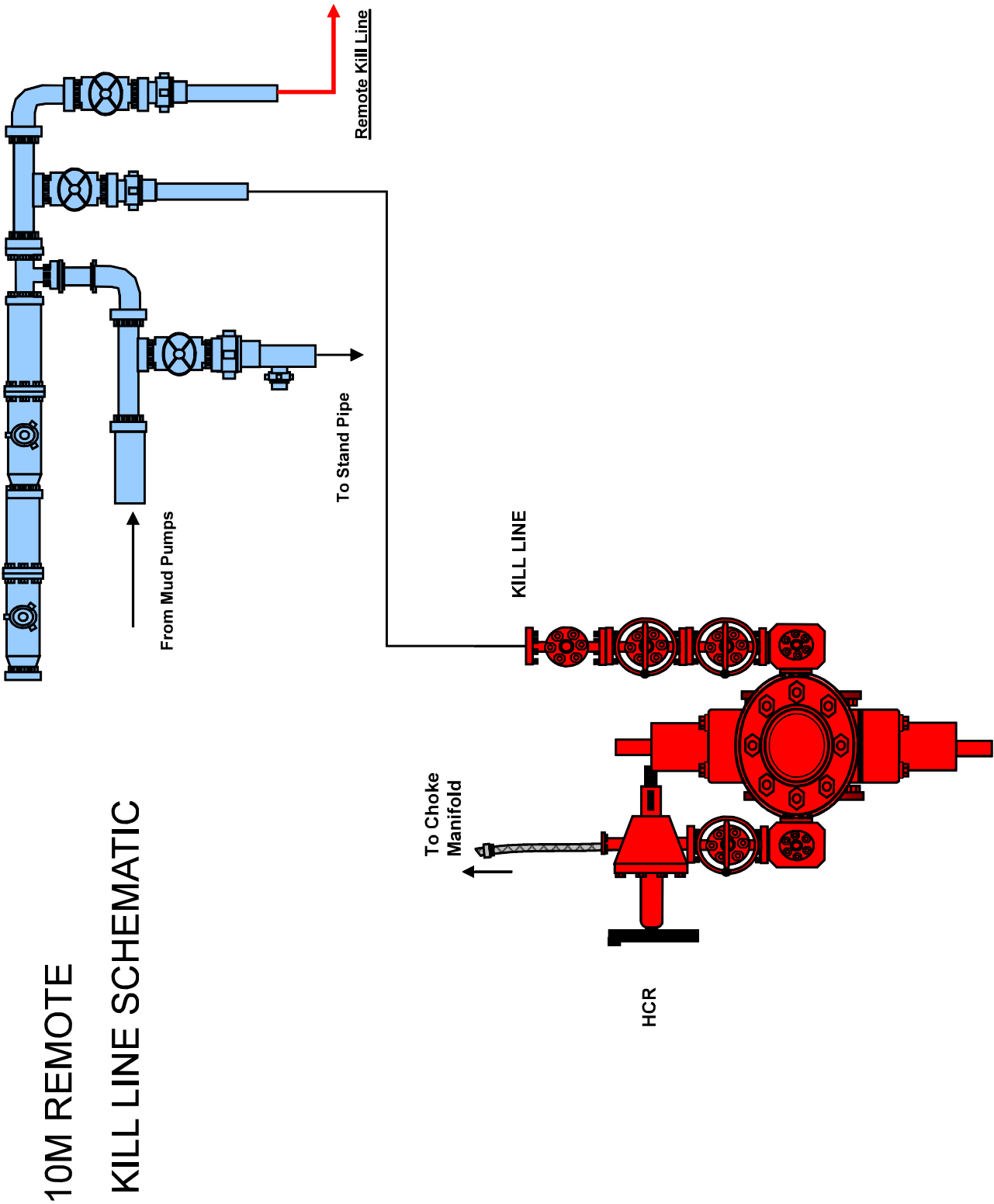

Gas Separator Routing Flex III Rigs

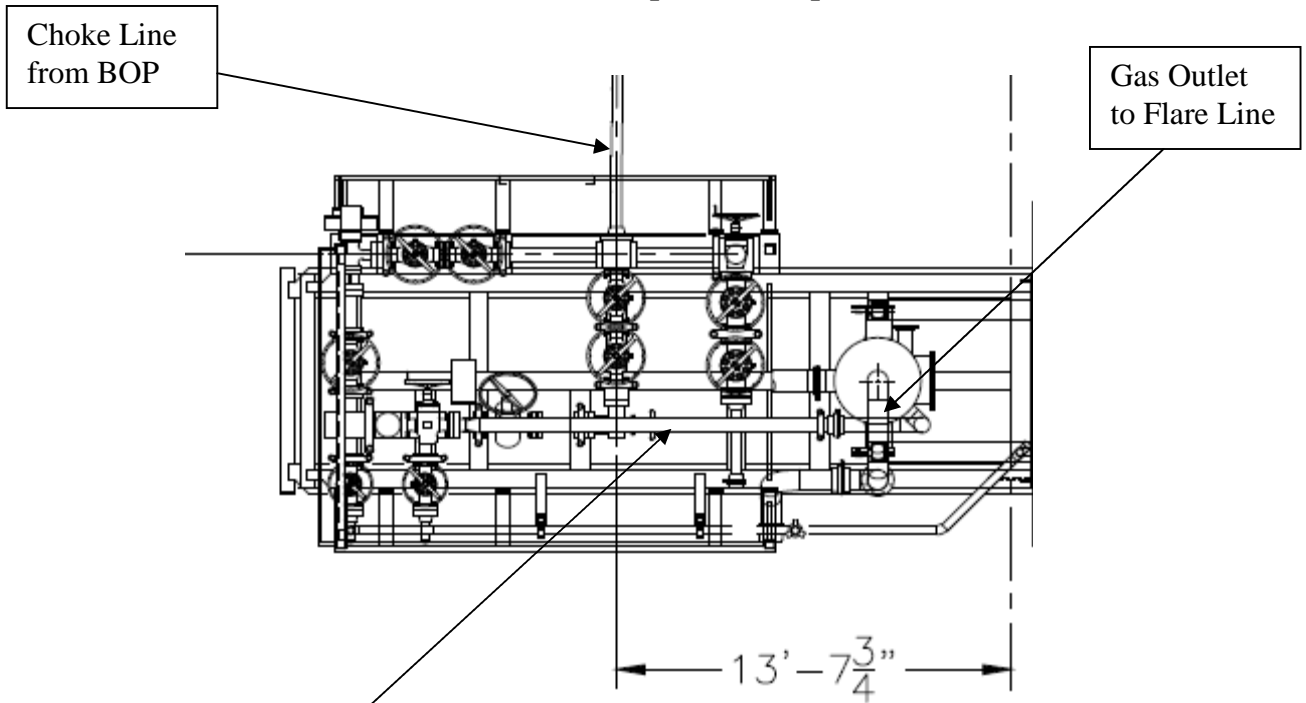
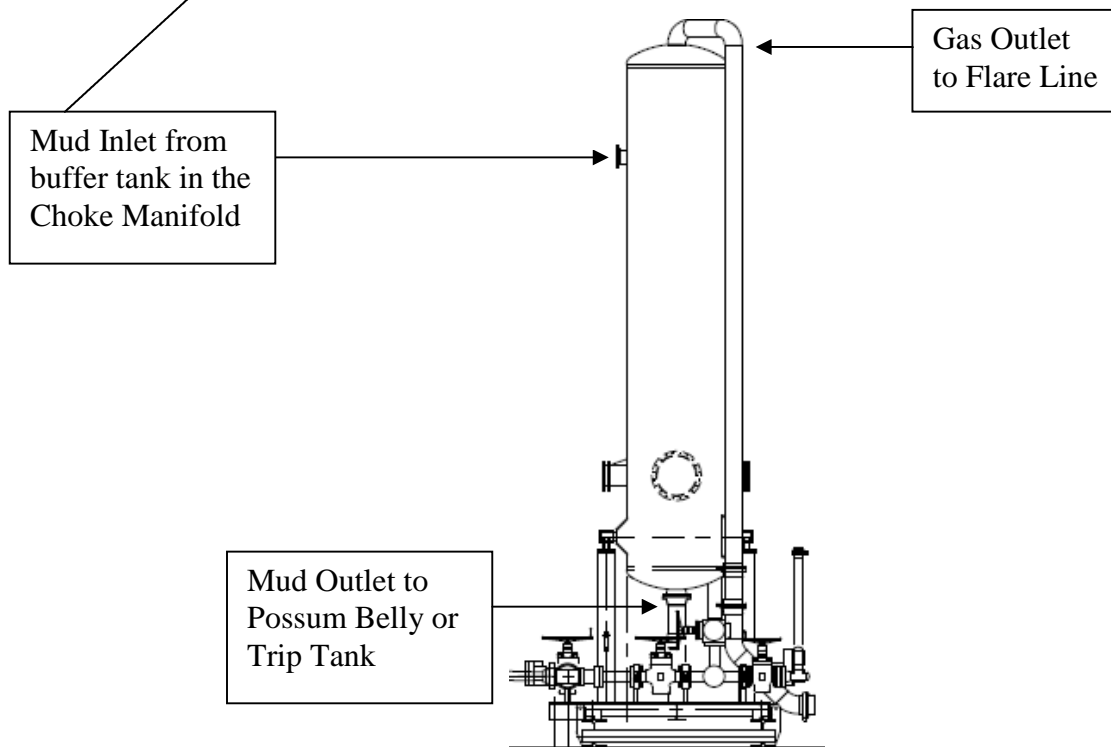

Choke Manifold – Gas Separator (Top View)**Choke Manifold – Gas Separator (Side View)**

OXY's Minimum Design Criteria

Burst, Collapse, and Tensile SF are calculated using Landmark's Stress Check (Casing Design) software. A sundry will be requested if any lesser grade or different size casing is substituted.

1) Casing Design Assumptions

a) Burst Loads

CSG Test (Surface)

- Internal: Displacement fluid + pressure required to comply with regulatory casing test pressures. This will comply with both 43 CFR part 3170 Subpart 3172 and 19.15.16 of the OCD Rules.
- External: Pore pressure in open hole.

CSG Test (Intermediate)

- Internal: Displacement fluid + pressure required to comply with regulatory casing test pressures. This will comply with both 43 CFR part 3170 Subpart 3172 and 19.15.16 of the OCD Rules.
- External: Mud Weight to TOC, cement mix water gradient (8.4 ppg) below TOC, and pore pressure in open hole.

CSG Test (Production)

- Internal:
 - For Drilling: Displacement fluid + pressure required to comply with regulatory casing test pressures. This will comply with both 43 CFR part 3170 Subpart 3172 and 19.15.16 of the OCD Rules.
 - For Production: The design pressure test should be the greater of (1) the planned test pressure prior to stimulation down the casing. (2) the regulatory test pressure, and (3) the expected gas lift system pressure. The design test fluid should be the fluid associated with pressure test having the greatest pressure.
- External:
 - For Drilling: Mud Weight to TOC, cement mix water gradient (8.4 ppg) below TOC, and pore pressure in open hole.
 - For Production: Mud base-fluid density to TOC, cement mix water gradient (8.4 ppg) below TOC, and pore pressure in open hole.

Gas Column (Surface)

- Internal: Assumes a full column of gas in the casing with a Gas/Oil Gradient of 0.1 psi/ft in the absence of better information. It is limited to the controlling pressure based on the fracture pressure at the shoe or the maximum expected pore pressure within the next drilling interval, whichever results in a lower surface pressure.
- External: Fluid gradient below TOC, pore pressure from the TOC to the Intermediate CSG shoe (if applicable), and MW of the drilling mud that was in the hole when the CSG was run from Intermediate CSG shoe to surface.

Bullheading (Surface / Intermediate)

- Internal: The string must be designed to withstand a pressure profile based on the fracture pressure at the casing shoe with a column of water above the shoe plus an additional surface pressure (in psi) of $0.02 \times \text{MD of the shoe}$ to account for pumping friction pressure.
- External: Mud weight to TOC, cement mix water gradient (8.4 ppg) below TOC, and pore pressure in open hole.

Gas Kick (Intermediate)

- The string must be designed to at least a gas kick load case unless the rig is unable to detect a kick. For the gas kick load case, the internal pressure profile must be based on a minimum volume of 50 bbl or the minimum kick detection capability of the rig, whichever is greater, and a kick intensity of 2.0 ppg for Class 1, 1.0 ppg of Class 2, and 0.5 ppg for Class 3 and 4 wells.
- Internal: Influx depth of the maximum pore pressure of 0.55 “gas kick gravity” of gas to surface while drilling the next hole section.
- External: Mud weight to the TOC, cement mix water gradient below TOC, and pore pressure in open hole.

Tubing Leak Near Surface While Producing (Production)

- Internal: SITP plus a packer fluid gradient to the shoe or top of packer.
- External: Mud base-fluid density to TOC, cement mix water gradient (8.4 ppg) below TOC, and pore pressure in open hole.

Tubing Leak Near Surface While Stimulating (Production)

- Internal: Surface pressure or pressure-relief system pressure, whichever is lower plus packer fluid gradient.
- External: Mud base-fluid density to TOC, cement mix water gradient (8.4 ppg) below TOC, and pore pressure in open hole.

Injection / Stimulation Down Casing (Production)

- Internal: Surface pressure plus injection fluid gradient.
- External: Mud base-fluid density to TOC, cement mix water gradient (8.4 ppg) below TOC, and pore pressure in open hole.

b) Collapse Loads**Lost Circulation (Surface / Intermediate)**

- Internal: Lost circulation at the TD of the next hole section, and the fluid level falls to a depth where the hydrostatic of the mud equals pore pressure at the depth of the lost circulation zone.
- External: MW of the drilling mud that was in the hole when the casing was run. Cementing (Surface / Intermediate / Production)

- Internal: Displacement fluid density.
- External: Mud weight from TOC to surface and cement slurry weight from TOC to casing shoe.

Full Evacuation (Production)

- Internal: Full void pipe.
- External: MW of drilling mud in the hole when the casing was run.

c) Tension Loads**Running Casing (Surface / Intermediate / Production)**

- Axial: Buoyant weight of the string plus the lesser of 100,000 lb or the string weight in air.

Green Cement (Surface / Intermediate / Production)

- Axial: Buoyant weight of the string plus cement plug bump pressure load.

Falcon SL1 Production Casing Annular Clearance Variance Request

If Production Casing Connection OD does not meet 0.422" annular clearance inside casing:

- Cement excess will be circulated from Top of Liner to surface (Cement Confirmation)
- Liner Top will be tested to confirm seal.
- If ICP in Bone Spring Pool and lateral landed in Wolfcamp Pool, a CBL will be ran.



Permian Drilling Hydrogen Sulfide Drilling Operations Plan

Open drill site. No homes or buildings are near the proposed location.

1. Escape

Personnel shall escape upwind of wellbore in the event of an emergency gas release. Escape can take place through the lease road on the Southeast side of the location. Personnel need to move to a safe distance and block the entrance to location. If the primary route is not an option due to the wind direction, then a secondary egress route should be taken.

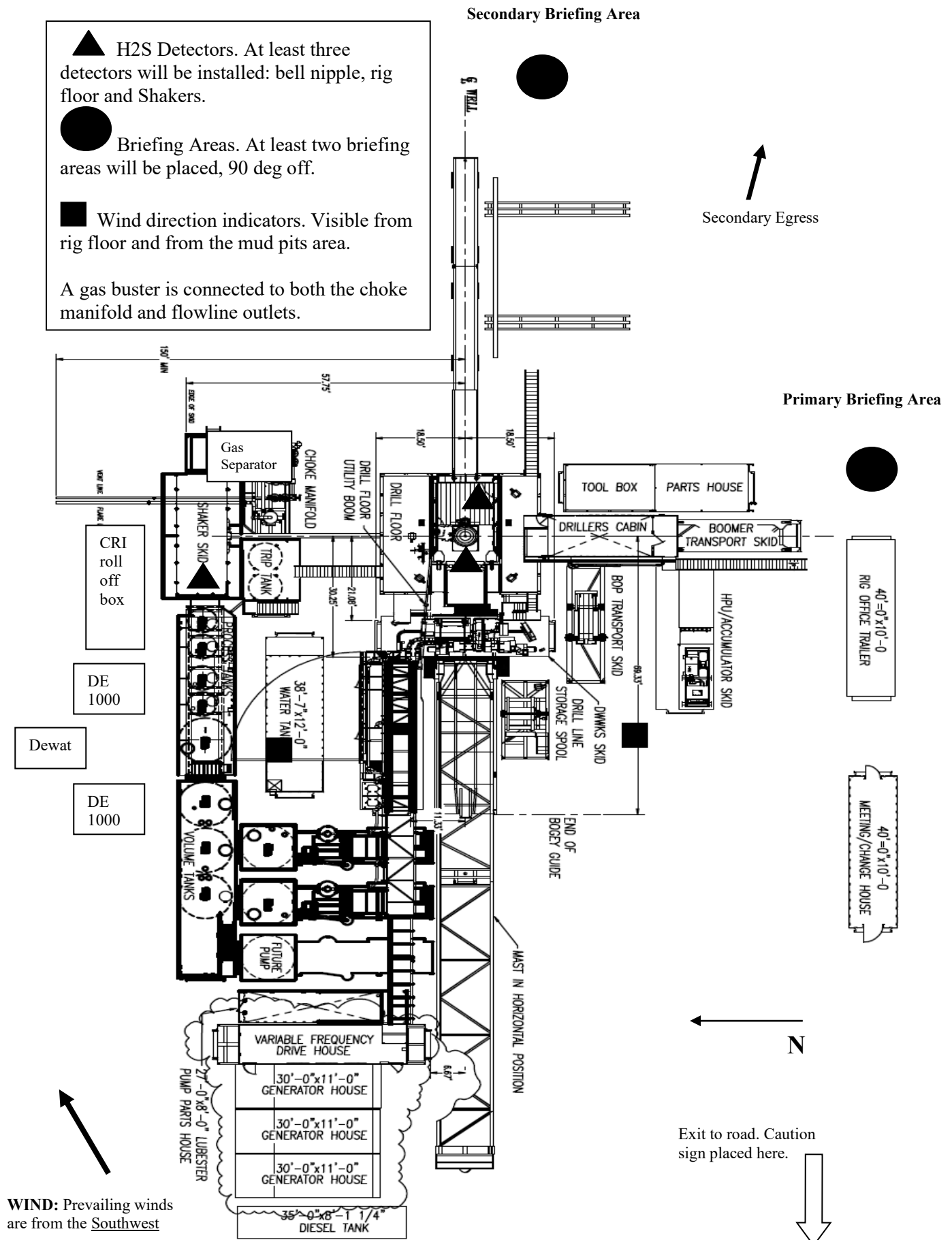



Permian Drilling Hydrogen Sulfide Drilling Operations Plan New Mexico

Scope

This contingency plan establishes guidelines for the public, all company employees, and contract employees who's work activities may involve exposure to hydrogen sulfide (H₂S) gas.

While drilling this well, it is possible to encounter H₂S bearing formations. At all times, the first barrier to control H₂S emissions will be the drilling fluid, which will have a density high enough to control influx.

Objective

1. Provide an immediate and predetermined response plan to any condition when H₂S is detected. All H₂S detections in excess of 10 parts per million (ppm) concentration are considered an Emergency.
2. Prevent any and all accidents, and prevent the uncontrolled release of hydrogen sulfide into the atmosphere.
3. Provide proper evacuation procedures to cope with emergencies.
4. Provide immediate and adequate medical attention should an injury occur.

Discussion

Implementation:	This plan with all details is to be fully implemented before drilling to <u>commence</u> .
Emergency response Procedure:	This section outlines the conditions and denotes steps to be taken in the event of an emergency.
Emergency equipment Procedure:	This section outlines the safety and emergency equipment that will be required for the drilling of this well.
Training provisions:	This section outlines the training provisions that must be adhered to prior to drilling.
Drilling emergency call lists:	Included are the telephone numbers of all persons to be contacted should an emergency exist.
Briefing:	This section deals with the briefing of all people involved in the drilling operation.
Public safety:	Public safety personnel will be made aware of any potential evacuation and any additional support needed.
Check lists:	Status check lists and procedural check lists have been included to insure adherence to the plan.
General information:	A general information section has been included to supply support information.

Hydrogen Sulfide Training

All personnel, whether regularly assigned, contracted, or employed on an unscheduled basis, will receive training from a qualified instructor in the following areas prior to commencing drilling operations on the well:

1. The hazards and characteristics of H₂S.
2. Proper use and maintenance of personal protective equipment and life support systems.
3. H₂S detection.
4. Proper use of H₂S detectors, alarms, warning systems, briefing areas, evacuation procedures and prevailing winds.
5. Proper techniques for first aid and rescue procedures.
6. Physical effects of hydrogen sulfide on the human body.
7. Toxicity of hydrogen sulfide and sulfur dioxide.
8. Use of SCBA and supplied air equipment.
9. First aid and artificial respiration.
10. Emergency rescue.

In addition, supervisory personnel will be trained in the following areas:

1. The effects of H₂S on metal components. If high tensile strength tubular is to be used, personnel will be trained in their special maintenance requirements.
2. Corrective action and shut-in procedures when drilling a well, blowout prevention and well control procedures.
3. The contents and requirements of the H₂S Drilling Operations Plan.

H₂S training refresher must have been taken within one year prior to drilling the well. Specifics on the well to be drilled will be discussed during the pre-spud meeting. H₂S and well control (choke) drills will be performed while drilling the well, at least on a weekly basis. This plan shall be available in the well site. All personnel will be required to carry the documentation proving that the H₂S training has been taken.

Service company and visiting personnel

- A. Each service company that will be on this well will be notified if the zone contains H₂S.
- B. Each service company must provide for the training and equipment of their employees before they arrive at the well site.
- C. Each service company will be expected to attend a well site

Emergency Equipment Requirements

1. Well control equipment

The well shall have hydraulic BOP equipment for the anticipated pressures. Equipment is to be tested on installation and follow Oxy Well Control standard, as well as 43 CFR part 3170 Subpart 3172.

Special control equipment:

- A. Hydraulic BOP equipment with remote control on ground.
Remotely operated choke.
- B. Rotating head
- C. Gas buster equipment shall be installed before drilling out of surface pipe.

2. Protective equipment for personnel

- A. Four (4) 30-minute positive pressure air packs (2 at each briefing area) on location.
- B. Adequate fire extinguishers shall be located at strategic locations.
- C. Radio / cell telephone communication will be available at the rig.
 - Rig floor and trailers.
 - Vehicle.

3. Hydrogen sulfide sensors and alarms

- A. H₂S sensor with alarms will be located on the rig floor, at the bell nipple, and at the flow line. These monitors will be set to alarm at 10 ppm with strobe light, and audible alarm.
- B. Hand operated detectors with tubes.
- C. H₂S monitor tester (to be provided by contract Safety Company.)
- D. There shall be one combustible gas detector on location at all times.

4. Visual Warning Systems

- A. One sign located at each location entrance with the following language:

**Caution – potential poison gas
Hydrogen sulfide
No admittance without authorization**

Wind sock – wind streamers:

- A. One 36” (in length) wind sock located at protection center, at height visible from rig floor.
- B. One 36” (in length) wind sock located at height visible from pit areas.

Condition flags

- A. One each condition flag to be displayed to denote conditions.

green – normal conditions
yellow – potential danger
red – danger, H2S present

- B. Condition flag shall be posted at each location sign entrance.

5. Mud Program

The mud program is designed to minimize the risk of having H2S and other formation fluids at surface. Proper mud weight and safe drilling practices will be applied. H2S scavengers will be used to minimize the hazards while drilling. Below is a summary of the drilling program.

Mud inspection devices:

Garrett gas train or hatch tester for inspection of sulfide concentration in mud system.

6. Metallurgy

- A. Drill string, casing, tubing, wellhead, blowout preventers, drilling spools or adapters, kill lines, choke manifold, lines and valves shall be suitable for the H2S service.
- B. All the elastomers, packing, seals and ring gaskets shall be suitable for H2S service.

7. Well Testing

No drill stem test will be performed on this well.

8. Evacuation plan

Evacuation routes should be established prior to well spud for each well and discussed with all rig personnel.

9. Designated area

- A. Parking and visitor area: all vehicles are to be parked at a predetermined safe distance from the wellhead.
- B. There will be a designated smoking area.
- C. Two briefing areas on either side of the location at the maximum allowable distance from the well bore so they offset prevailing winds perpendicularly, or at a 45-degree angle if wind direction tends to shift in the area.

Emergency procedures

- A. In the event of any evidence of H₂S level above 10 ppm, take the following steps:
 - 1. The Driller will pick up off bottom, shut down the pumps, slow down the pipe rotation.
 - 2. Secure and don escape breathing equipment, report to the upwind designated safe briefing / muster area.
 - 3. All personnel on location will be accounted for and emergency search should begin for any missing, the Buddy System will be implemented.
 - 4. Order non-essential personnel to leave the well site, order all essential personnel out of the danger zone and upwind to the nearest designated safe briefing / muster area.
 - 5. Entrance to the location will be secured to a higher level than our usual "Meet and Greet" requirement, and the proper condition flag will be displayed at the entrance to the location.
 - 6. Take steps to determine if the H₂S level can be corrected or suppressed and, if so, proceed as required.
- B. If uncontrollable conditions occur:
 - 1. Take steps to protect and/or remove any public in the down-wind area from the rig – partial evacuation and isolation. Notify necessary public safety personnel and appropriate regulatory entities (i.e. BLM) of the situation.

2. Remove all personnel to the nearest upwind designated safe briefing / muster area or off location.
3. Notify public safety personnel of safe briefing / muster area.
4. An assigned crew member will blockade the entrance to the location. No unauthorized personnel will be allowed entry to the location.
5. Proceed with best plan (at the time) to regain control of the well. Maintain tight security and safety procedures.

C. Responsibility:

1. Designated personnel.
 - a. Shall be responsible for the total implementation of this plan.
 - b. Shall be in complete command during any emergency.
 - c. Shall designate a back-up.

- | | |
|---------------------|--|
| All personnel: | <ol style="list-style-type: none"> 1. On alarm, don escape unit and report to the nearest upwind designated safe briefing / muster area upw 2. Check status of personnel (buddy system). 3. Secure breathing equipment. 4. Await orders from supervisor. |
| Drill site manager: | <ol style="list-style-type: none"> 1. Don escape unit if necessary and report to nearest upwind designated safe briefing / muster area. 2. Coordinate preparations of individuals to return to point of release with tool pusher and driller (using the buddy system). 3. Determine H2S concentrations. 4. Assess situation and take control measures. |
| Tool pusher: | <ol style="list-style-type: none"> 1. Don escape unit Report to up nearest upwind designated safe briefing / muster area. 2. Coordinate preparation of individuals to return to point of release with tool pusher drill site manager (using the buddy system). 3. Determine H2S concentration. 4. Assess situation and take control measures. |
| Driller: | <ol style="list-style-type: none"> 1. Don escape unit, shut down pumps, continue |

- rotating DP.
 - 2. Check monitor for point of release.
 - 3. Report to nearest upwind designated safe briefing / muster area.
 - 4. Check status of personnel (in an attempt to rescue, use the buddy system).
 - 5. Assigns least essential person to notify Drill Site Manager and tool pusher by quickest means in case of their absence.
 - 6. Assumes the responsibilities of the Drill Site Manager and tool pusher until they arrive should they be absent.
- Derrick man
- Floor man #1
- Floor man #2
- Mud engineer:
- 1. Will remain in briefing / muster area until instructed by supervisor.
- 1. Report to nearest upwind designated safe briefing / muster area.
 - 2. When instructed, begin check of mud for ph and H2S level. (Garett gas train.)
- Safety personnel:
- 1. Mask up and check status of all personnel and secure operations as instructed by drill site manager.

Taking a kick

When taking a kick during an H2S emergency, all personnel will follow standard Well control procedures after reporting to briefing area and masking up.

Open-hole logging

All unnecessary personnel off floor. Drill Site Manager and safety personnel should monitor condition, advise status and determine need for use of air equipment.

Running casing or plugging

Following the same “tripping” procedure as above. Drill Site Manager and safety personnel should determine if all personnel have access to protective equipment.

Ignition procedures

The decision to ignite the well is the responsibility of the operator (Oxy Drilling Management). The decision should be made only as a last resort and in a situation where it is clear that:

1. Human life and property are endangered.
2. There is no hope controlling the blowout under the prevailing conditions at the well.

Instructions for igniting the well

1. Two people are required for the actual igniting operation. They must wear self-contained breathing units and have a safety rope attached. One man (tool pusher or safety engineer) will check the atmosphere for explosive gases with the gas monitor. The other man is responsible for igniting the well.
2. Primary method to ignite: 25 mm flare gun with range of approximately 500 feet.
3. Ignite upwind and do not approach any closer than is warranted.
4. Select the ignition site best for protection, and which offers an easy escape route.
5. Before firing, check for presence of combustible gas.
6. After lighting, continue emergency action and procedure as before.
7. All unassigned personnel will remain in briefing area until instructed by supervisor or directed by the Drill Site Manager.

Remember: After well is ignited, burning hydrogen sulfide will convert to sulfur dioxide, which is also highly toxic. **Do not assume the area is safe after the well is ignited.**

Status check list

Note: All items on this list must be completed before drilling to production casing point.

1. H2S sign at location entrance.
2. Two (2) wind socks located as required.
3. Four (4) 30-minute positive pressure air packs (2 at each Briefing area) on location for all rig personnel and mud loggers.
4. Air packs inspected and ready for use.
5. Cascade system and hose line hook-up as needed.
6. Cascade system for refilling air bottles as needed.
7. Condition flag on location and ready for use.
8. H2S detection system hooked up and tested.
9. H2S alarm system hooked up and tested.
10. Hand operated H2S detector with tubes on location.
11. 1 – 100' length of nylon rope on location.
12. All rig crew and supervisors trained as required.
13. All outside service contractors advised of potential H2S hazard on well.
14. No smoking sign posted and a designated smoking area identified.
15. Calibration of all H2S equipment shall be noted on the IADC report.

Checked by: _____ Date: _____

Procedural check list during H2S events

Perform each tour:

1. Check fire extinguishers to see that they have the proper charge.
2. Check breathing equipment to ensure that it is in proper working order.
3. Make sure all the H2S detection system is operative.

Perform each week:

1. Check each piece of breathing equipment to make sure that demand or forced air regulator is working. This requires that the bottle be opened and the mask assembly be put on tight enough so that when you inhale, you receive air or feel air flow.
2. BOP skills (well control drills).
3. Check supply pressure on BOP accumulator stand by source.
4. Check breathing equipment mask assembly to see that straps are loosened and turned back, ready to put on.
5. Check pressure on breathing equipment air bottles to make sure they are charged to full volume. (Air quality checked for proper air grade "D" before bringing to location)
6. Confirm pressure on all supply air bottles.
7. Perform breathing equipment drills with on-site personnel.
8. Check the following supplies for availability.
 - A. Emergency telephone list.
 - B. Hand operated H2S detectors and tubes.

General evacuation plan

1. When the company approved supervisor (Drill Site Manager, consultant, rig pusher, or driller) determines the H2S gas cannot be limited to the well location and the public will be involved, he will activate the evacuation plan.
2. Drill Site Manager or designee will notify local government agency that a hazardous condition exists and evacuation needs to be implemented.
3. Company or contractor safety personnel that have been trained in the use of H2S detection equipment and self-contained breathing equipment will monitor H2S concentrations, wind directions, and area of exposure. They will delineate the outer perimeter of the hazardous gas area. Extension to the evacuation area will be determined from information gathered.
4. Law enforcement personnel (state police, police dept., fire dept., and sheriff's dept.) Will be called to aid in setting up and maintaining road blocks. Also, they will aid in evacuation of the public if necessary.
5. After the discharge of gas has been controlled, company safety personnel will determine when the area is safe for re-entry.

Important: Law enforcement personnel will not be asked to come into a contaminated area. Their assistance will be limited to uncontaminated areas. Constant radio contact will be maintained with them.

Emergency actions

Well blowout – if emergency

1. Evacuate all personnel to “Safe Briefing / Muster Areas” or off location if needed.
2. If sour gas – evacuate rig personnel.
3. If sour gas – evacuate public within 3000 ft radius of exposure.
4. Don SCBA and shut well in if possible using the buddy system.
5. Notify Drilling Superintendent and call 911 for emergency help (fire dept and ambulance) if needed.
6. Implement the Blowout Contingency Plan, and Drilling Emergency Action Plan.
6. Give first aid as needed.

Person down location/facility

1. If immediately possible, contact 911. Give location and wait for confirmation.
2. Don SCBA and perform rescue operation using buddy system.

Toxic effects of hydrogen sulfide

Hydrogen sulfide is extremely toxic. The acceptable ceiling concentration for eight-hour exposure is 10 ppm, which is .001% by volume. Hydrogen sulfide is heavier than air (specific gravity – 1.192) and colorless. It forms an explosive mixture with air between 4.3 and 46.0 percent by volume. Hydrogen sulfide is almost as toxic as hydrogen cyanide and is between five and six times more toxic than carbon monoxide. Toxicity data for hydrogen sulfide and various other gases are compared in table i. Physical effects at various hydrogen sulfide exposure levels are shown in table ii.

Table i
Toxicity of various gases

Common name	Chemical formula	Specific gravity (sc=1)	Threshold limit (1)	Hazardous limit (2)	Lethal concentration (3)
Hydrogen Cyanide	Hcn	0.94	10 ppm	150 ppm/hr	300 ppm
Hydrogen Sulfide	H2S	1.18	10 ppm	250 ppm/hr	600 ppm
Sulfur Dioxide	So2	2.21	5 ppm	-	1000 ppm
Chlorine	Cl2	2.45	1 ppm	4 ppm/hr	1000 ppm
Carbon Monoxide	Co	0.97	50 ppm	400 ppm/hr	1000 ppm
Carbon Dioxide	Co2	1.52	5000 ppm	5%	10%
Methane	Ch4	0.55	90,000 ppm	Combustible above 5% in air	

- 1) threshold limit – concentration at which it is believed that all workers may be repeatedly exposed day after day without adverse effects.
- 2) hazardous limit – concentration that will cause death with short-term exposure.
- 3) lethal concentration – concentration that will cause death with short-term exposure.

Toxic effects of hydrogen sulfide

Table ii
Physical effects of hydrogen sulfide

Percent (%)	Ppm	Concentration Grains 100 std. Ft3*	Physical effects
0.001	<10	00.65	Obvious and unpleasant odor.

0.002	10	01.30	Safe for 8 hours of exposure.
0.010	100	06.48	Kill smell in 3 – 15 minutes. May sting eyes and throat.
0.020	200	12.96	Kills smell shortly; stings eyes and throat.
0.050	500	32.96	Dizziness; breathing ceases in a few minutes; needs prompt artificial respiration.
0.070	700	45.36	Unconscious quickly; death will result if not rescued promptly.
0.100	1000	64.30	Unconscious at once; followed by death within minutes.

*at 15.00 psia and 60'f.

Use of self-contained breathing equipment (SCBA)

1. Written procedures shall be prepared covering safe use of SCBA's in dangerous atmosphere, which might be encountered in normal operations or in emergencies. Personnel shall be familiar with these procedures and the available SCBA.
2. SCBA's shall be inspected frequently at random to insure that they are properly used, cleaned, and maintained.
3. Anyone who may use the SCBA's shall be trained in how to insure proper face-piece to face seal. They shall wear SCBA's in normal air and then wear them in a test atmosphere. (note: such items as facial hair {beard or sideburns} and eyeglasses will not allow proper seal.) Anyone that may be reasonably expected to wear SCBA's should have these items removed before entering a toxic atmosphere. A special mask must be obtained for anyone who must wear eyeglasses or contact lenses.
4. Maintenance and care of SCBA's:
 - a. A program for maintenance and care of SCBA's shall include the following:
 1. Inspection for defects, including leak checks.
 2. Cleaning and disinfecting.
 3. Repair.
 4. Storage.
 - b. Inspection, self-contained breathing apparatus for emergency use shall be inspected monthly.
 1. Fully charged cylinders.
 2. Regulator and warning device operation.
 3. Condition of face piece and connections.
 4. Rubber parts shall be maintained to keep them pliable and prevent deterioration.
 - c. Routinely used SCBA's shall be collected, cleaned and disinfected as frequently as necessary to insure proper protection is provided.
5. Persons assigned tasks that requires use of self-contained breathing equipment shall be certified physically fit (medically cleared) for breathing equipment usage at least annually.
6. SCBA's should be worn when:
 - A. Any employee works near the top or on top of any tank unless test reveals less than 10 ppm of H₂S.

- B. When breaking out any line where H₂S can reasonably be expected.
- C. When sampling air in areas to determine if toxic concentrations of H₂S exists.
- D. When working in areas where over 10 ppm H₂S has been detected.
- E. At any time there is a doubt as to the H₂S level in the area to be entered.

Rescue
First aid for H₂S poisoning

Do not panic!

Remain calm – think!

1. Don SCBA breathing equipment.
2. Remove victim(s) utilizing buddy system to fresh air as quickly as possible. (go up-wind from source or at right angle to the wind. Not down wind.)
3. Briefly apply chest pressure – arm lift method of artificial respiration to clean the victim's lungs and to avoid inhaling any toxic gas directly from the victim's lungs.
4. Provide for prompt transportation to the hospital, and continue giving artificial respiration if needed.
5. Hospital(s) or medical facilities need to be informed, before-hand, of the possibility of H₂S gas poisoning – no matter how remote the possibility is.
6. Notify emergency room personnel that the victim(s) has been exposed to H₂S gas.

Besides basic first aid, everyone on location should have a good working knowledge of artificial respiration.

Revised CM 6/27/2012

Offline Cementing Variance Request

Oxy requests a variance to cement the 9.625" and/or 7.625" intermediate casing strings offline in accordance to the approved variance, EC Tran 461365.

1. Cement Program

No changes to the cement program will take place for offline cementing.

2. Offline Cementing Procedure

The operational sequence will be as follows:

1. Run casing as per normal operations. While running casing, conduct negative pressure test and confirm integrity of the float equipment (float collar and shoe)
2. Land casing with mandrel
3. Fill pipe with kill weight fluid, do not circulate through floats and confirm well is static
4. Set annular packoff shown below and pressure test to confirm integrity of the seal.
Pressure ratings of wellhead components and valves is 5,000 psi

Annular packoff with both external and internal seals

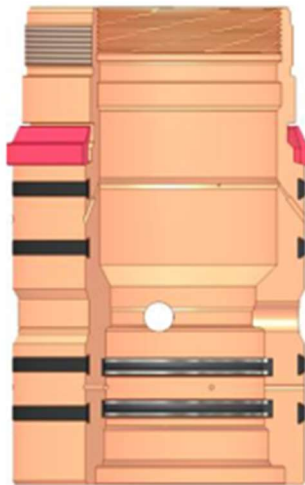

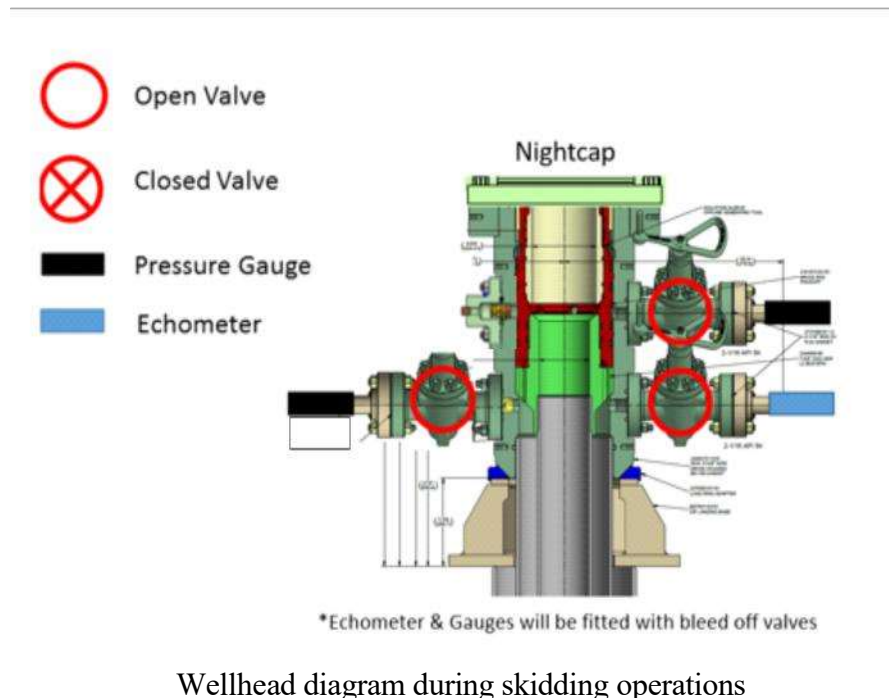

5. After confirmation of both annular barriers and internal barriers, nipple down BOP and install cap flange.
 - a. If any barrier fails to test, the BOP stack will not be nipped down until after the cement job is completed with cement 500ft above the highest formation capable of flow with kill weight mud above or after it has achieved 50 psi compressive strength if cannot be verified.
6. Skid rig to next well on pad.
7. Confirm well is static before removing cap flange, flange will not be removed and offline cementing operations will not commence until well is under control. If well is not static, casing outlet valves will provide access to both the casing ID and annulus. Rig or third party pump truck will kill well prior to cementing or nipping up for further remediation.
 - a. Well Control Plan
 - i. The Drillers Method will be the primary well control method to regain control of the wellbore prior to cementing, if wellbore conditions do not permit the drillers method other methods of well control may be used
 - ii. Rig pumps or a 3rd party pump will be tied into the upper casing valve to pump down the casing ID
 - iii. A high pressure return line will be rigged up to lower casing valve and run to choke manifold to control annular pressure
 - iv. Once influx is circulated out of the hole, kill weight mud will be circulated
 - v. Well will be confirmed static
 - vi. Once confirmed static, cap flange will be removed to allow for offline cementing operations to commence
8. Install offline cement tool
9. Rig up cement equipment

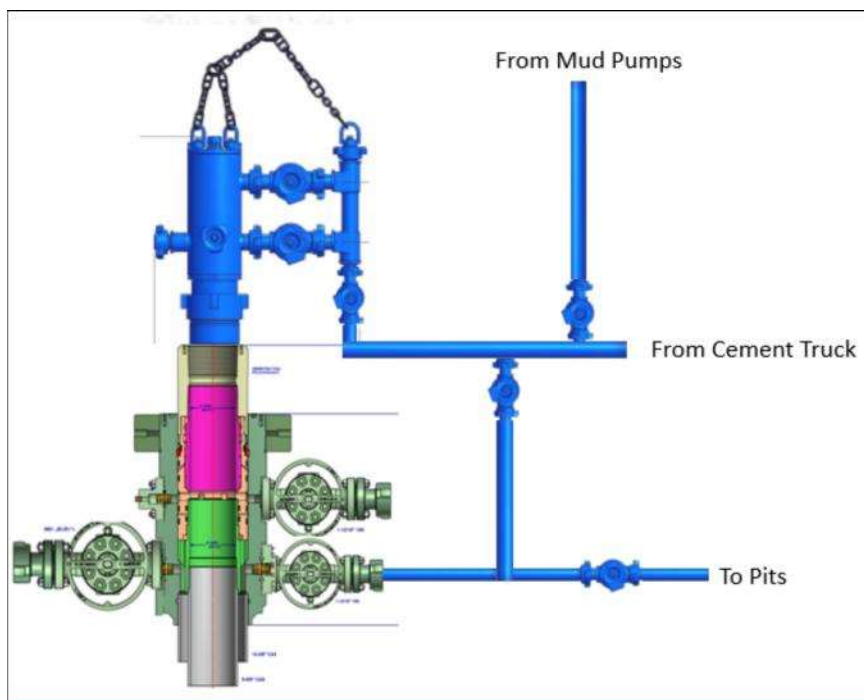

Wellhead diagram during offline cementing operations

10. Circulate bottoms up with cement truck
 - a. If gas is present on bottoms up, well will be shut in and returns rerouted through gas buster to handle entrained gas
 - b. Max anticipated time before circulating with cement truck is 6 hrs
11. Perform cement job taking returns from the annulus wellhead valve
12. Confirm well is static and floats are holding after cement job
13. Remove cement equipment, offline cement tools and install night cap with pressure gauge for monitoring.

OXY USA Inc
APD ATTACHMENT: SPUDDER RIG DATA

OPERATOR NAME / NUMBER: OXY USA Inc

1. SUMMARY OF REQUEST:

Oxy USA respectfully requests approval for the following operations for the surface hole in the drill plan:

1. Utilize a spudder rig to pre-set surface casing for time and cost savings.

2. Description of Operations

1. Spudder rig will move in to drill the surface hole and pre-set surface casing on the well.
 - a. After drilling the surface hole section, the spudder rig will run casing and cement following all of the applicable rules and regulations (43 CFR part 3170 Subpart 3172, all COAs and NMOCD regulations).
 - b. The spudder rig will utilize fresh water-based mud to drill the surface hole to TD. Solids control will be handled entirely on a closed loop basis. No earth pits will be used.
2. The wellhead will be installed and tested as soon as the surface casing is cut off and the WOC time has been reached.
3. A blind flange at the same pressure rating as the wellhead will be installed to seal the wellbore. Pressure will be monitored with needle valves installed on two wingvalves.
 - a. A means for intervention will be maintained while the drilling rig is not over the well.
4. Spudder rig operations are expected to take 2-3 days per well on the pad.
5. The BLM will be contacted and notified 24 hours prior to commencing spudder rig operations.
6. Drilling operations will begin with a larger rig and a BOP stack equal to or greater than the pressure rating that was permitted will be nipped up and tested on the wellhead before drilling operations resume on each well.
 - a. The larger rig will move back onto the location within 90 days from the point at which the wells are secured and the spudder rig is moved off location.
 - b. The BLM will be contacted / notified 24 hours before the larger rig moves back on the pre-set locations.
7. Oxy will have supervision on the rig to ensure compliance with all BLM and NMOCD regulations and to oversee operations.
8. Once the rig is removed, Oxy will secure the wellhead area by placing a guard rail around the cellar area.

Spudder Rig Layout

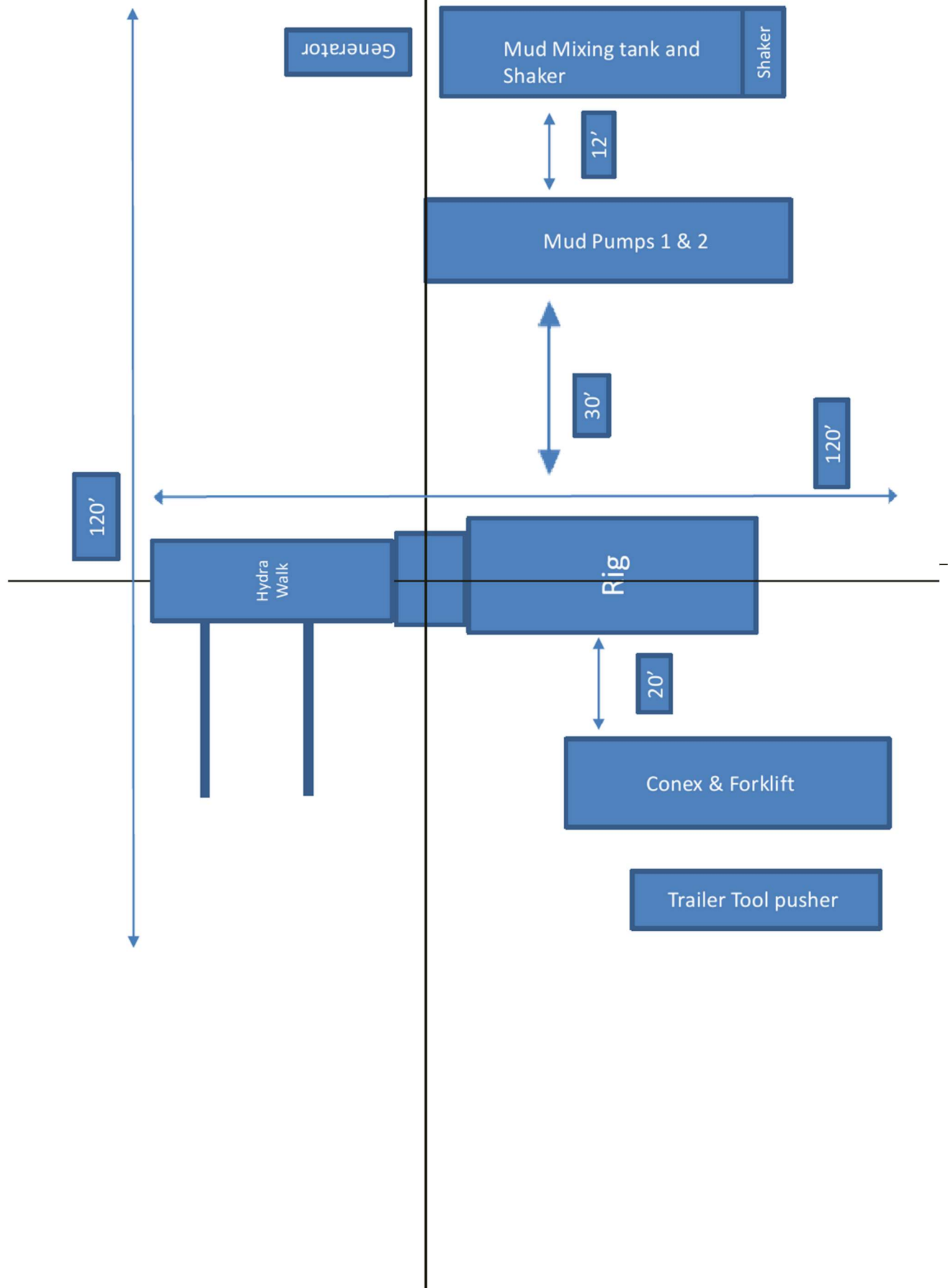



5.500" 20.00 lb/ft P110-CY

TenarisHydril Wedge 461™ Matched Strength



Special Data Sheet

TH DS-20.0359

12 August 2020

Rev 00

Nominal OD	5.500 in.	Wall Thickness	0.361 in.	Grade	P110-CY
Min Wall Thickness	87.5%	Type	CASING	Connection OD Option	MATCHED STRENGTH

Pipe Body Data

Geometry			Performance		
Nominal OD	5.500 in.	Nominal ID	4.778 in.	Body Yield Strength	641 x 1000 lbs
Nominal Weight	20.00 lbs/ft	Wall Thickness	0.361 in.	Internal Yield	12640 psi
Standard Drift Diameter	4.653 in.	Plain End Weight	19.83 lbs/ft	SMYS	110000 psi
Special Drift Diameter	N/A	OD Tolerance	API	Collapse Pressure	11110 psi

Connection Data

Geometry		Performance		Make-up Torques	
Matched Strength OD	6.050 in.	Tension Efficiency	100%	Minimum	17000 ft-lbs
Make-up Loss	3.775 in.	Joint Yield Strength	641 x 1000 lbs	Optimum	18000 ft-lbs
Threads per in.	3.40	Internal Yield	12640 psi	Maximum	21600 ft-lbs
Connection OD Option	MATCHED STRENGTH	Compression Efficiency	100%	Operational Limit Torques	
Coupling Length	7.714 in.	Compression Strength	641 x 1000 lbs	Operating Torque	32000 ft-lbs
		Bending	92 °/100 ft	Yield Torque	38000 ft-lbs
		Collapse	11110 psi	Buck-On Torques	
				Minimum	21600 ft-lbs
				Maximum	23100 ft-lbs

Notes

*If you need to use torque values that are higher than the maximum indicated, please contact a local Tenaris technical sales representative

Falcon SL1 Production Casing Annular Clearance Variance Request

If Production Casing Connection OD does not meet 0.422" annular clearance inside casing:

- Cement excess will be circulated from Top of Liner to surface (Cement Confirmation)
- Liner Top will be tested to confirm seal.
- If ICP in Bone Spring Pool and lateral landed in Wolfcamp Pool, a CBL will be ran.

Oxy USA Inc. - Heads CC 9_4 Federal Com 24H Drill Plan

1. Geologic Formations

TVD of Target (ft):	8531	Pilot Hole Depth (ft):	
Total Measured Depth (ft):	19571	Deepest Expected Fresh Water (ft):	148

Delaware Basin

Formation	MD-RKB (ft)	TVD-RKB (ft)	Expected Fluids
Rustler	148	148	
Salado	672	672	Salt
Castile	1347	1347	Salt
Delaware	2914	2913	Oil/Gas/Brine
Bell Canyon	2965	2964	Oil/Gas/Brine
Cherry Canyon	3818	3804	Oil/Gas/Brine
Brushy Canyon	5126	5052	Losses
Bone Spring	6808	6651	Oil/Gas
Bone Spring 1st	7855	7647	Oil/Gas
Bone Spring 2nd	8793	8461	Oil/Gas
Bone Spring 3rd			Oil/Gas
Wolfcamp			Oil/Gas
Penn			Oil/Gas
Strawn			Oil/Gas

*H2S, water flows, loss of circulation, abnormal pressures, etc.

2. Casing Program

Section	Hole Size (in)	MD		TVD		Csg. OD (in)	Csg Wt. (ppf)	Grade	Conn.
		From (ft)	To (ft)	From (ft)	To (ft)				
Surface	14.75	0	612	0	612	10.75	45.5	J-55	BTC
Intermediate	9.875	0	7913	0	7698	7.827	39.3	P110S	Wedge 463
Production	6.75	7713	19571	7498	8531	5.5	20	P-110	Wedge 461

All casing strings will be tested in accordance with 43 CFR part 3170 Subpart 3172

All Casing SF Values will meet or exceed those below			
SF Collapse	SF Burst	Body SF Tension	Joint SF Tension
1.00	1.100	1.4	1.4

- *If Production Casing Connection OD does not meet 0.422" annular clearance inside casing:
- Cement excess will be circulated from Top of Liner to surface (Cement Confirmation)
 - Liner Top will be tested to confirm seal
 - If ICP in Bone Spring Pool and lateral landed in Wolfcamp Pool, a CBL will be ran.

	Y or N
Is casing new? If used, attach certification as required in 43 CFR 3160	Y
Does casing meet API specifications? If no, attach casing specification sheet.	Y
Is premium or uncommon casing planned? If yes attach casing specification sheet.	Y
Does the above casing design meet or exceed BLM's minimum standards? If not provide justification (loading assumptions, casing design criteria).	Y
Will the intermediate pipe be kept at a minimum 1/3 fluid filled to avoid approaching the collapse pressure rating of the casing?	Y
Is well located within Capitan Reef?	N
If yes, does production casing cement tie back a minimum of 50' above the Reef?	
Is well within the designated 4 string boundary.	
Is well located in SOPA but not in R-111-P?	N
If yes, are the first 2 strings cemented to surface and 3 rd string cement tied back 500' into previous casing?	
Is well located in R-111-P and SOPA?	N
If yes, are the first three strings cemented to surface?	
Is 2 nd string set 100' to 600' below the base of salt?	
Is well located in high Cave/Karst?	N
If yes, are there two strings cemented to surface?	
(For 2 string wells) If yes, is there a contingency casing if lost circulation occurs?	
Is well located in critical Cave/Karst?	N
If yes, are there three strings cemented to surface?	

3. Cementing Program

Section	Stage	Slurry:	Sacks	Yield (ft ³ /ft)	Density (lb/gal)	Excess:	TOC	Placement	Description
Surface	1	Surface - Tail	512	1.33	14.8	100%	-	Circulate	Class C+Accel.
Int.	1	Intermediate 1S - Tail	319	1.65	13.2	5%	5,376	Circulate	Class H+Accel., Disper., Salt
Int.	2	Intermediate 2S - Tail BH	766	1.71	13.3	25%	-	Bradenhead	Class C+Accel.
Prod.	1	Production - Tail	895	1.38	13.2	25%	7,713	Circulate	Class H+Ret., Disper., Salt

Offline Cementing Request

Oxy requests a variance to cement the 9.625" and/or 7.625" intermediate casing strings offline in accordance to the approved variance, EC Tran 461365. Please see Offline Cementing Variance attachment for further details.

Bradenhead CBL Request

Oxy requests permission to adjust the CBL requirement after bradenhead cement jobs, on 7-5/8" intermediate casings, as per the agreement reached in the OXY/BLM meeting on September 5, 2019. Please see Bradenhead CBL Variance attachment for further details.

Cement Top and Liner Overlap

- Oxy is requesting permission to have minimum fill of cement behind the 5-1/2" production liner to be 200 ft into previous casing string
The reason for this is so that we can come back and develop shallower benches from the same 7.625"/7.827" mainbore in the future
- Cement will be brought to the top of this liner hanger

4. Pressure Control Equipment

BOP installed and tested before drilling which hole?	Size?	Min. Required WP	Type		✓	Tested to:	Deepest TVD Depth (ft) per Section:
9.875" Hole	13-5/8"	5M	Annular		✓	70% of working pressure	7698
		5M	Blind Ram		✓	250 psi / 5000 psi	
			Pipe Ram				
			Double Ram		✓		
			Other*				
6.75" Hole	13-5/8"	5M	Annular		✓	70% of working pressure	8531
		5M	Blind Ram		✓	250 psi / 5000 psi	
			Pipe Ram				
			Double Ram		✓		
			Other*				

*Specify if additional ram is utilized

BOP/BOPE will be tested by an independent service company to 250 psi low and the high pressure indicated above per 43 CFR part 3170 Subpart 3172 requirements. The System may be upgraded to a higher pressure but still tested to the working pressure listed in the table above. If the system is upgraded all the components installed will be functional and tested.

Pipe rams will be operationally checked each 24 hour period. Blind rams will be operationally checked on each trip out of the hole. These checks will be noted on the daily tour sheets. Other accessories to the BOP equipment will include a Kelly cock and floor safety valve (inside BOP) and choke lines and choke manifold.

	Formation integrity test will be performed per 43 CFR part 3170 Subpart 3172. On Exploratory wells or on that portion of any well approved for a 5M BOPE system or greater, a pressure integrity test of each casing shoe shall be performed. Will be tested in accordance with 43 CFR part 3170 Subpart 3172.
	A variance is requested for the use of a flexible choke line from the BOP to Choke Manifold. See attached for specs and hydrostatic test chart.
Y	Are anchors required by manufacturer?
	A multibowl or a unionized multibowl wellhead system will be employed. The wellhead and connection to the BOPE will meet all API 6A requirements. The BOP will be tested per 43 CFR part 3170 Subpart 3172 after installation on the surface casing which will cover testing requirements for a maximum of 30 days. If any seal subject to test pressure is broken the system must be tested. We will test the flange connection of the wellhead with a test port that is directly in the flange. We are proposing that we will run the wellhead through the rotary prior to cementing surface casing as discussed with the BLM on October 8, 2015. See attached schematics.

BOP Break Testing Request

Oxy requests permission to adjust the BOP break testing requirements as per the agreement reached in the OXY/BLM meeting on September 5, 2019. Please see BOP Break Testing Variance attachment for further details.

Oxy will use Cameron ADAPT wellhead system that uses an OEC top flange connection. This connection has been fully vetted and verified by API to Spec 6A and carries an API monogram.

5. Mud Program

Section	Depth - MD		Depth - TVD		Type	Weight (ppg)	Viscosity	Water Loss
	From (ft)	To (ft)	From (ft)	To (ft)				
Surface	0	612	0	612	Water-Based Mud	8.6 - 8.8	40-60	N/C
Intermediate	612	7913	612	7698	Saturated Brine-Based or Oil-Based Mud	8.0 - 10.0	35-45	N/C
Production	7913	19571	7698	8531	Water-Based or Oil-Based Mud	8.0 - 9.6	38-50	N/C

Sufficient mud materials to maintain mud properties and meet minimum lost circulation and weight increase requirements will be kept on location at all times. The following is a general list of products: Barite, Bentonite, Gypsum, Lime, Soda Ash, Caustic Soda, Nut Plug, Cedar Fiber, Cotton Seed Hulls, Drilling Paper, Salt Water Clay, CACL2. Oxy will use a closed mud system.

What will be used to monitor the loss or gain of fluid?	PVT/MD Totco/Visual Monitoring
---	--------------------------------

6. Logging and Testing Procedures

Logging, Coring and Testing.		
Yes	Will run GR from TD to surface (horizontal well – vertical portion of hole).	
	Stated logs run will be in the Completion Report and submitted to the BLM.	
No	Logs are planned based on well control or offset log information.	
No	Drill stem test? If yes, explain	
No	Coring? If yes, explain	
Additional logs planned		
No	Resistivity	Interval
No	Density	
Yes	CBL	Production string
Yes	Mud log	Bone Spring – TD
No	PEX	

7. Drilling Conditions

Condition	Specify what type and where?
BH Pressure at deepest TVD	4259 psi
Abnormal Temperature	No
BH Temperature at deepest TVD	149°F

Pump high viscosity sweeps as needed for hole cleaning. The mud system will be monitored visually/manually as well as with an electronic PVT. The necessary mud products for additional weight and fluid loss control will be on location at all times. Appropriately weighted mud will be used to isolate potential gas, oil, and water zones until such time as casing can be cemented into place for zonal

Hydrogen Sulfide (H₂S) monitors will be installed prior to drilling out the surface shoe. If H₂S is detected in concentrations greater than 100 ppm, the operator will comply with the provisions of 43 CFR part 3170 Subpart 3172. If Hydrogen Sulfide is encountered, measured values and formations will be provided to the BLM.

N	H ₂ S is present
Y	H ₂ S Plan attached

8. Other facets of operation

	Yes/No
Will the well be drilled with a walking/skidding operation? If yes, describe. We plan to drill the 2 well pad in batch by section: all surface sections, intermediate sections and production sections. The wellhead will be secured with a night cap whenever the rig is not over the well.	Yes
Will more than one drilling rig be used for drilling operations? If yes, describe. Oxy requests the option to contract a Surface Rig to drill, set surface casing, and cement for this well. If the timing between rigs is such that Oxy would not be able to preset surface, the Primary Rig will MIRU and drill the well in its entirety per the APD. Please see the attached document for information on the spudder rig.	Yes
Total Estimated Cuttings Volume: 1337 bbls	

OXY USA WTP LP

Falcon SL1 Contingency Tieback Details

Below is a summary that describes the general operational steps to drill and complete the well.

- Drill 14-3/4" hole x 10-3/4" casing for surface section. Cement to surface.
- Drill 9-7/8" hole x 7.827" casing for intermediate section. Cement to surface.
- Drill 6-3/4" hole x 5-1/2" liner for production section. Cement to top of liner, 100' inside 7.827" shoe.
- Release drilling rig from location.
- If contingency tieback required pre-frac:
 - Move in workover rig and run a 5-1/2" 20# P110 Wedge 461 tie-back frac string and seal assembly. Tie into liner hanger Polished Bore Receptacle (PBR) with seal assembly.
 - Pump hydraulic fracture job.
 - Flowback and produce well.
- If contingency tieback required post-frac:
 - Move in workover rig and run a 5-1/2" L80 BTC or lesser rated tie-back string and seal assembly. Tie into liner hanger Polished Bore Receptacle (PBR) with seal assembly.
 - Return well to production.

General well schematic:

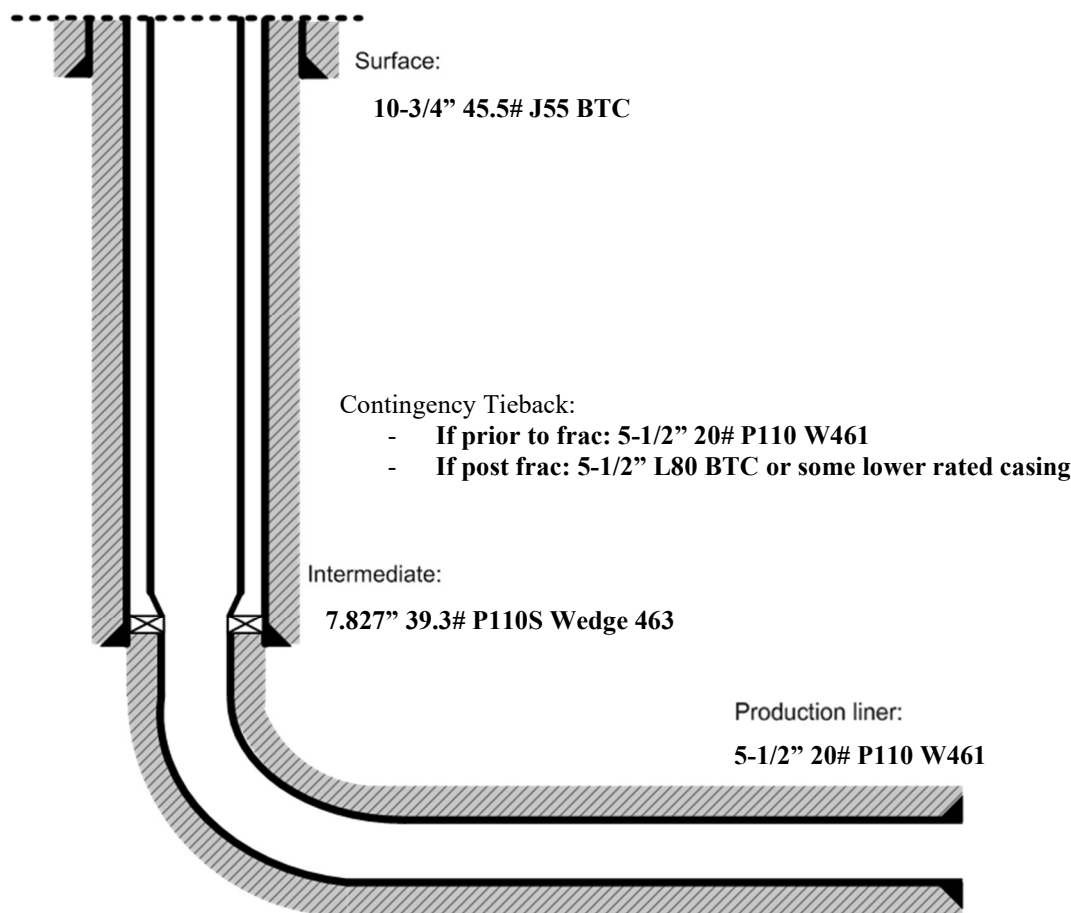



Project: PRD NM DIRECTIONAL PLANS (NAD 1983)
 Site: Heads CC 9_4
 Well: Heads CC 9_4 Federal Com 24H
 Wellbore: Wellbore #1
 Design: Permitting Plan

PROJECT DETAILS: NM DIRECTIONAL PLANS (NAD 1983)

Geodetic System: US State Plane 1983
 Datum: North American Datum 1983
 Ellipsoid: GRS 1980
 Zone: New Mexico Eastern Zone

System Datum: Mean Sea Level

WELL DETAILS: Heads CC 9_4 Federal Com 24H

+N/-S	+E/-W	Northing	Ground Level: Easting	2935.70	Latitude	Longitude
0.00	0.00	446628.05	648941.87		32.227378	-103.985349

SECTION DETAILS

MD	Inc	Azi	TVD	+N/-S	+E/-W	Dleg	TFace	Vsect	Annotation
0.00	0.00	0.00	0.00	0.00	0.00	0.00	0.00	0.00	
2410.00	0.00	0.00	2410.00	0.00	0.00	0.00	0.00	0.00	Build 1°/100'
4209.86	18.00	200.61	4180.40	-262.44	-98.70	1.00	200.61	-255.25	Hold 18° Tangent
8013.12	18.00	200.61	7797.55	-1362.41	-512.37	0.00	0.00	-1325.08	KOP, Build & Turn 10°/100'
9082.23	90.13	359.73	8531.00	-812.94	-600.04	10.00	158.13	-770.99	Landing Point
19571.35	90.13	359.73	8507.00	9676.03	-648.68	0.00	0.00	9697.75	TD at 19571.35' MD

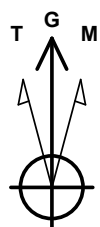

Azimuths to Grid North
 True North: -0.19°
 Magnetic North: 6.71°

Magnetic Field
 Strength: 47854.8nT
 Dip Angle: 59.93°
 Date: 12/31/2019
 Model: HDGM_FILE

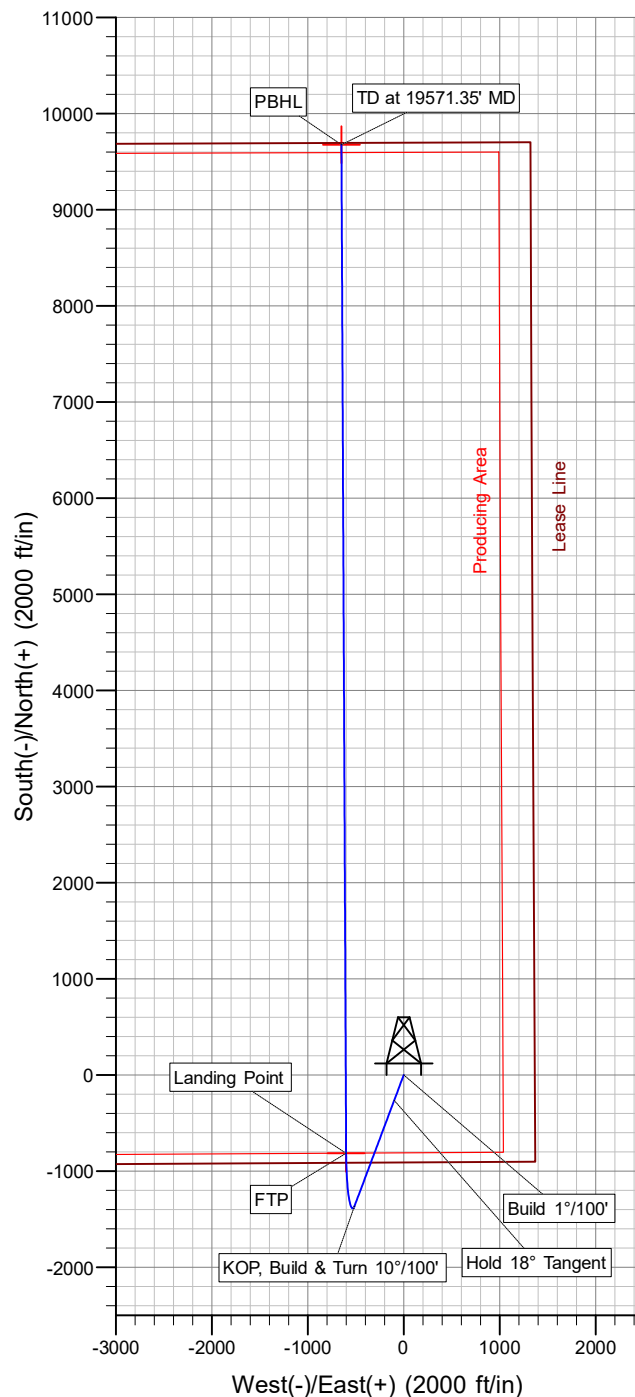
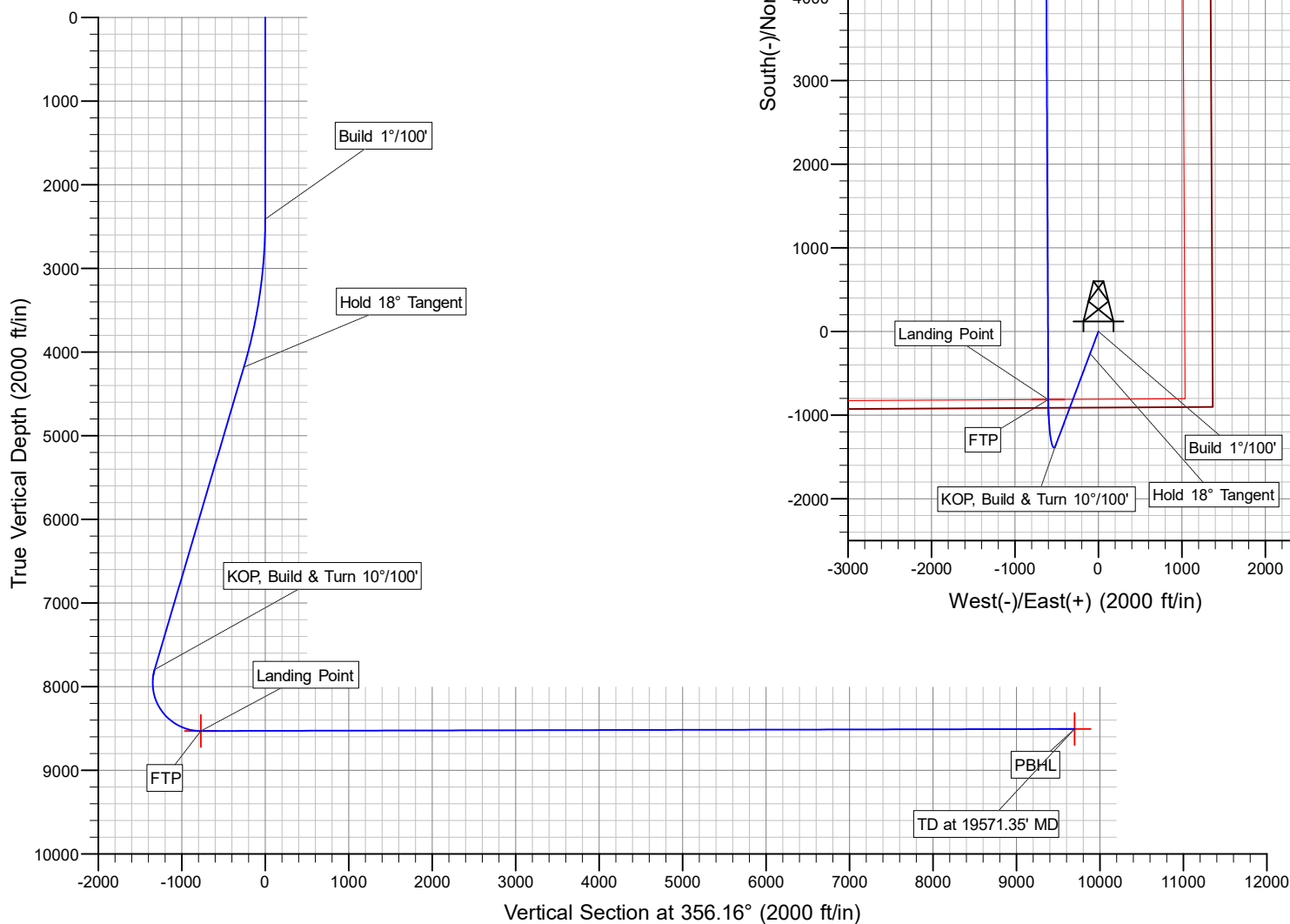

OXY

PRD NM DIRECTIONAL PLANS (NAD 1983)

Heads CC 9_4

Heads CC 9_4 Federal Com 24H

Wellbore #1

Plan: Permitting Plan

Standard Planning Report

27 September, 2023

OXY
Planning Report

Database:	HOPSPP	Local Co-ordinate Reference:	Well Heads CC 9_4 Federal Com 24H
Company:	ENGINEERING DESIGNS	TVD Reference:	25' RKB @ 2960.70ft
Project:	PRD NM DIRECTIONAL PLANS (NAD 1983)	MD Reference:	25' RKB @ 2960.70ft
Site:	Heads CC 9_4	North Reference:	Grid
Well:	Heads CC 9_4 Federal Com 24H	Survey Calculation Method:	Minimum Curvature
Wellbore:	Wellbore #1		
Design:	Permitting Plan		

Project	PRD NM DIRECTIONAL PLANS (NAD 1983)		
Map System:	US State Plane 1983	System Datum:	Mean Sea Level
Geo Datum:	North American Datum 1983		
Map Zone:	New Mexico Eastern Zone		Using geodetic scale factor

Site	Heads CC 9_4		
Site Position:		Northing:	446,198.60 usft
From:	Map	Easting:	648,677.50 usft
Position Uncertainty:	2.00 ft	Slot Radius:	13.200 in
		Latitude:	32.226200
		Longitude:	-103.986208

Well	Heads CC 9_4 Federal Com 24H		
Well Position	+N/-S	0.00 ft	Northing:
	+E/-W	0.00 ft	Easting:
Position Uncertainty	2.00 ft	Wellhead Elevation:	0.00 ft
Grid Convergence:	0.19 °		
		Latitude:	32.227378
		Longitude:	-103.985349
		Ground Level:	2,935.70 ft

Wellbore	Wellbore #1				
Magnetics	Model Name	Sample Date	Declination (°)	Dip Angle (°)	Field Strength (nT)
	HDGM_FILE	12/31/2019	6.90	59.93	47,854.80000000

Design	Permitting Plan			
Audit Notes:				
Version:	Phase:	PROTOTYPE	Tie On Depth:	0.00
Vertical Section:	Depth From (TVD) (ft)	+N/-S (ft)	+E/-W (ft)	Direction (°)
	0.00	0.00	0.00	356.16

Plan Survey Tool Program	Date	9/27/2023		
Depth From (ft)	Depth To (ft)	Survey (Wellbore)	Tool Name	Remarks
1	0.00	19,571.35	Permitting Plan (Wellbore #1)	B001Mb_MWD+HRGM
				OWSG MWD + HRGM

Plan Sections										
Measured Depth (ft)	Inclination (°)	Azimuth (°)	Vertical Depth (ft)	+N/-S (ft)	+E/-W (ft)	Dogleg Rate (°/100ft)	Build Rate (°/100ft)	Turn Rate (°/100ft)	TFO (°)	Target
0.00	0.00	0.00	0.00	0.00	0.00	0.00	0.00	0.00	0.00	
2,410.00	0.00	0.00	2,410.00	0.00	0.00	0.00	0.00	0.00	0.00	
4,209.86	18.00	200.61	4,180.40	-262.44	-98.70	1.00	1.00	0.00	200.61	
8,013.12	18.00	200.61	7,797.55	-1,362.41	-512.37	0.00	0.00	0.00	0.00	
9,082.23	90.13	359.73	8,531.00	-812.94	-600.04	10.00	6.75	14.88	158.13	FTP (Heads CC 9_4
19,571.35	90.13	359.73	8,507.00	9,676.03	-648.68	0.00	0.00	0.00	0.00	PBHL (Heads CC

OXY

Planning Report

Database:	HOPSPP	Local Co-ordinate Reference:	Well Heads CC 9_4 Federal Com 24H
Company:	ENGINEERING DESIGNS	TVD Reference:	25' RKB @ 2960.70ft
Project:	PRD NM DIRECTIONAL PLANS (NAD 1983)	MD Reference:	25' RKB @ 2960.70ft
Site:	Heads CC 9_4	North Reference:	Grid
Well:	Heads CC 9_4 Federal Com 24H	Survey Calculation Method:	Minimum Curvature
Wellbore:	Wellbore #1		
Design:	Permitting Plan		

Planned Survey									
Measured Depth (ft)	Inclination (°)	Azimuth (°)	Vertical Depth (ft)	+N/-S (ft)	+E/-W (ft)	Vertical Section (ft)	Dogleg Rate (°/100ft)	Build Rate (°/100ft)	Turn Rate (°/100ft)
0.00	0.00	0.00	0.00	0.00	0.00	0.00	0.00	0.00	0.00
100.00	0.00	0.00	100.00	0.00	0.00	0.00	0.00	0.00	0.00
200.00	0.00	0.00	200.00	0.00	0.00	0.00	0.00	0.00	0.00
300.00	0.00	0.00	300.00	0.00	0.00	0.00	0.00	0.00	0.00
400.00	0.00	0.00	400.00	0.00	0.00	0.00	0.00	0.00	0.00
500.00	0.00	0.00	500.00	0.00	0.00	0.00	0.00	0.00	0.00
600.00	0.00	0.00	600.00	0.00	0.00	0.00	0.00	0.00	0.00
700.00	0.00	0.00	700.00	0.00	0.00	0.00	0.00	0.00	0.00
800.00	0.00	0.00	800.00	0.00	0.00	0.00	0.00	0.00	0.00
900.00	0.00	0.00	900.00	0.00	0.00	0.00	0.00	0.00	0.00
1,000.00	0.00	0.00	1,000.00	0.00	0.00	0.00	0.00	0.00	0.00
1,100.00	0.00	0.00	1,100.00	0.00	0.00	0.00	0.00	0.00	0.00
1,200.00	0.00	0.00	1,200.00	0.00	0.00	0.00	0.00	0.00	0.00
1,300.00	0.00	0.00	1,300.00	0.00	0.00	0.00	0.00	0.00	0.00
1,400.00	0.00	0.00	1,400.00	0.00	0.00	0.00	0.00	0.00	0.00
1,500.00	0.00	0.00	1,500.00	0.00	0.00	0.00	0.00	0.00	0.00
1,600.00	0.00	0.00	1,600.00	0.00	0.00	0.00	0.00	0.00	0.00
1,700.00	0.00	0.00	1,700.00	0.00	0.00	0.00	0.00	0.00	0.00
1,800.00	0.00	0.00	1,800.00	0.00	0.00	0.00	0.00	0.00	0.00
1,900.00	0.00	0.00	1,900.00	0.00	0.00	0.00	0.00	0.00	0.00
2,000.00	0.00	0.00	2,000.00	0.00	0.00	0.00	0.00	0.00	0.00
2,100.00	0.00	0.00	2,100.00	0.00	0.00	0.00	0.00	0.00	0.00
2,200.00	0.00	0.00	2,200.00	0.00	0.00	0.00	0.00	0.00	0.00
2,300.00	0.00	0.00	2,300.00	0.00	0.00	0.00	0.00	0.00	0.00
2,400.00	0.00	0.00	2,400.00	0.00	0.00	0.00	0.00	0.00	0.00
2,410.00	0.00	0.00	2,410.00	0.00	0.00	0.00	0.00	0.00	0.00
2,500.00	0.90	200.61	2,500.00	-0.66	-0.25	-0.64	1.00	1.00	0.00
2,600.00	1.90	200.61	2,599.97	-2.95	-1.11	-2.87	1.00	1.00	0.00
2,700.00	2.90	200.61	2,699.88	-6.87	-2.58	-6.68	1.00	1.00	0.00
2,800.00	3.90	200.61	2,799.70	-12.42	-4.67	-12.08	1.00	1.00	0.00
2,900.00	4.90	200.61	2,899.40	-19.60	-7.37	-19.06	1.00	1.00	0.00
3,000.00	5.90	200.61	2,998.96	-28.41	-10.68	-27.63	1.00	1.00	0.00
3,100.00	6.90	200.61	3,098.33	-38.84	-14.61	-37.78	1.00	1.00	0.00
3,200.00	7.90	200.61	3,197.50	-50.90	-19.14	-49.50	1.00	1.00	0.00
3,300.00	8.90	200.61	3,296.43	-64.57	-24.28	-62.80	1.00	1.00	0.00
3,400.00	9.90	200.61	3,395.08	-79.86	-30.03	-77.67	1.00	1.00	0.00
3,500.00	10.90	200.61	3,493.44	-96.75	-36.39	-94.10	1.00	1.00	0.00
3,600.00	11.90	200.61	3,591.46	-115.25	-43.34	-112.10	1.00	1.00	0.00
3,700.00	12.90	200.61	3,689.13	-135.35	-50.90	-131.64	1.00	1.00	0.00
3,800.00	13.90	200.61	3,786.41	-157.04	-59.06	-152.74	1.00	1.00	0.00
3,900.00	14.90	200.61	3,883.26	-180.32	-67.81	-175.38	1.00	1.00	0.00
4,000.00	15.90	200.61	3,979.67	-205.18	-77.16	-199.56	1.00	1.00	0.00
4,100.00	16.90	200.61	4,075.60	-231.60	-87.10	-225.26	1.00	1.00	0.00
4,209.86	18.00	200.61	4,180.40	-262.44	-98.70	-255.25	1.00	1.00	0.00
4,300.00	18.00	200.61	4,266.13	-288.51	-108.50	-280.60	0.00	0.00	0.00
4,400.00	18.00	200.61	4,361.24	-317.43	-119.38	-308.73	0.00	0.00	0.00
4,500.00	18.00	200.61	4,456.35	-346.35	-130.25	-336.86	0.00	0.00	0.00
4,600.00	18.00	200.61	4,551.45	-375.27	-141.13	-364.99	0.00	0.00	0.00
4,700.00	18.00	200.61	4,646.56	-404.19	-152.01	-393.12	0.00	0.00	0.00
4,800.00	18.00	200.61	4,741.66	-433.12	-162.88	-421.25	0.00	0.00	0.00
4,900.00	18.00	200.61	4,836.77	-462.04	-173.76	-449.38	0.00	0.00	0.00
5,000.00	18.00	200.61	4,931.88	-490.96	-184.64	-477.51	0.00	0.00	0.00
5,100.00	18.00	200.61	5,026.98	-519.88	-195.52	-505.64	0.00	0.00	0.00
5,200.00	18.00	200.61	5,122.09	-548.80	-206.39	-533.77	0.00	0.00	0.00
5,300.00	18.00	200.61	5,217.20	-577.72	-217.27	-561.90	0.00	0.00	0.00

OXY

Planning Report

Database:	HOPSPP	Local Co-ordinate Reference:	Well Heads CC 9_4 Federal Com 24H
Company:	ENGINEERING DESIGNS	TVD Reference:	25' RKB @ 2960.70ft
Project:	PRD NM DIRECTIONAL PLANS (NAD 1983)	MD Reference:	25' RKB @ 2960.70ft
Site:	Heads CC 9_4	North Reference:	Grid
Well:	Heads CC 9_4 Federal Com 24H	Survey Calculation Method:	Minimum Curvature
Wellbore:	Wellbore #1		
Design:	Permitting Plan		

Planned Survey									
Measured Depth (ft)	Inclination (°)	Azimuth (°)	Vertical Depth (ft)	+N/-S (ft)	+E/-W (ft)	Vertical Section (ft)	Dogleg Rate (°/100ft)	Build Rate (°/100ft)	Turn Rate (°/100ft)
5,400.00	18.00	200.61	5,312.30	-606.65	-228.15	-590.03	0.00	0.00	0.00
5,500.00	18.00	200.61	5,407.41	-635.57	-239.02	-618.16	0.00	0.00	0.00
5,600.00	18.00	200.61	5,502.52	-664.49	-249.90	-646.29	0.00	0.00	0.00
5,700.00	18.00	200.61	5,597.62	-693.41	-260.78	-674.42	0.00	0.00	0.00
5,800.00	18.00	200.61	5,692.73	-722.33	-271.65	-702.54	0.00	0.00	0.00
5,900.00	18.00	200.61	5,787.84	-751.25	-282.53	-730.67	0.00	0.00	0.00
6,000.00	18.00	200.61	5,882.94	-780.18	-293.41	-758.80	0.00	0.00	0.00
6,100.00	18.00	200.61	5,978.05	-809.10	-304.28	-786.93	0.00	0.00	0.00
6,200.00	18.00	200.61	6,073.15	-838.02	-315.16	-815.06	0.00	0.00	0.00
6,300.00	18.00	200.61	6,168.26	-866.94	-326.04	-843.19	0.00	0.00	0.00
6,400.00	18.00	200.61	6,263.37	-895.86	-336.91	-871.32	0.00	0.00	0.00
6,500.00	18.00	200.61	6,358.47	-924.79	-347.79	-899.45	0.00	0.00	0.00
6,600.00	18.00	200.61	6,453.58	-953.71	-358.67	-927.58	0.00	0.00	0.00
6,700.00	18.00	200.61	6,548.69	-982.63	-369.54	-955.71	0.00	0.00	0.00
6,800.00	18.00	200.61	6,643.79	-1,011.55	-380.42	-983.84	0.00	0.00	0.00
6,900.00	18.00	200.61	6,738.90	-1,040.47	-391.30	-1,011.97	0.00	0.00	0.00
7,000.00	18.00	200.61	6,834.01	-1,069.39	-402.17	-1,040.10	0.00	0.00	0.00
7,100.00	18.00	200.61	6,929.11	-1,098.32	-413.05	-1,068.23	0.00	0.00	0.00
7,200.00	18.00	200.61	7,024.22	-1,127.24	-423.93	-1,096.36	0.00	0.00	0.00
7,300.00	18.00	200.61	7,119.33	-1,156.16	-434.80	-1,124.49	0.00	0.00	0.00
7,400.00	18.00	200.61	7,214.43	-1,185.08	-445.68	-1,152.62	0.00	0.00	0.00
7,500.00	18.00	200.61	7,309.54	-1,214.00	-456.56	-1,180.74	0.00	0.00	0.00
7,600.00	18.00	200.61	7,404.64	-1,242.92	-467.44	-1,208.87	0.00	0.00	0.00
7,700.00	18.00	200.61	7,499.75	-1,271.85	-478.31	-1,237.00	0.00	0.00	0.00
7,800.00	18.00	200.61	7,594.86	-1,300.77	-489.19	-1,265.13	0.00	0.00	0.00
7,900.00	18.00	200.61	7,689.96	-1,329.69	-500.07	-1,293.26	0.00	0.00	0.00
8,000.00	18.00	200.61	7,785.07	-1,358.61	-510.94	-1,321.39	0.00	0.00	0.00
8,013.12	18.00	200.61	7,797.55	-1,362.41	-512.37	-1,325.08	0.00	0.00	0.00
8,050.00	14.64	206.05	7,832.94	-1,371.93	-516.42	-1,334.31	10.00	-9.11	14.75
8,100.00	10.43	218.71	7,881.75	-1,381.14	-522.03	-1,343.13	10.00	-8.41	25.32
8,150.00	7.29	244.58	7,931.16	-1,386.04	-527.73	-1,347.64	10.00	-6.28	51.74
8,200.00	6.88	285.87	7,980.81	-1,386.58	-533.48	-1,347.79	10.00	-0.83	82.58
8,250.00	9.55	316.20	8,030.32	-1,382.77	-539.24	-1,343.60	10.00	5.34	60.65
8,300.00	13.60	331.10	8,079.30	-1,374.63	-544.95	-1,335.10	10.00	8.09	29.81
8,350.00	18.12	338.98	8,127.39	-1,362.22	-550.58	-1,322.34	10.00	9.05	15.77
8,400.00	22.84	343.75	8,174.22	-1,345.63	-556.09	-1,305.42	10.00	9.44	9.53
8,450.00	27.65	346.94	8,219.43	-1,325.00	-561.43	-1,284.48	10.00	9.63	6.38
8,500.00	32.52	349.25	8,262.69	-1,300.48	-566.56	-1,259.67	10.00	9.73	4.61
8,550.00	37.41	351.01	8,303.65	-1,272.26	-571.45	-1,231.19	10.00	9.80	3.52
8,600.00	42.33	352.41	8,342.01	-1,240.55	-576.05	-1,199.24	10.00	9.84	2.81
8,650.00	47.26	353.57	8,377.48	-1,205.59	-580.33	-1,164.08	10.00	9.87	2.32
8,700.00	52.21	354.56	8,409.79	-1,167.66	-584.26	-1,125.96	10.00	9.89	1.98
8,750.00	57.16	355.43	8,438.69	-1,127.03	-587.80	-1,085.18	10.00	9.90	1.73
8,800.00	62.11	356.20	8,463.96	-1,084.01	-590.94	-1,042.06	10.00	9.91	1.55
8,850.00	67.07	356.91	8,485.40	-1,038.95	-593.65	-996.91	10.00	9.92	1.41
8,900.00	72.03	357.57	8,502.87	-992.17	-595.90	-950.08	10.00	9.92	1.31
8,950.00	77.00	358.19	8,516.21	-944.03	-597.68	-901.94	10.00	9.93	1.24
9,000.00	81.96	358.78	8,525.34	-894.90	-598.98	-852.83	10.00	9.93	1.19
9,050.00	86.93	359.36	8,530.17	-845.16	-599.78	-803.15	10.00	9.93	1.16
9,082.23	90.13	359.73	8,531.00	-812.94	-600.04	-770.99	10.00	9.93	1.15
9,100.00	90.13	359.73	8,530.96	-795.17	-600.12	-753.25	0.00	0.00	0.00
9,200.00	90.13	359.73	8,530.73	-695.18	-600.58	-653.45	0.00	0.00	0.00
9,300.00	90.13	359.73	8,530.50	-595.18	-601.05	-553.64	0.00	0.00	0.00
9,400.00	90.13	359.73	8,530.27	-495.18	-601.51	-453.83	0.00	0.00	0.00
9,500.00	90.13	359.73	8,530.04	-395.18	-601.98	-354.03	0.00	0.00	0.00

OXY

Planning Report

Database:	HOPSPP	Local Co-ordinate Reference:	Well Heads CC 9_4 Federal Com 24H
Company:	ENGINEERING DESIGNS	TVD Reference:	25' RKB @ 2960.70ft
Project:	PRD NM DIRECTIONAL PLANS (NAD 1983)	MD Reference:	25' RKB @ 2960.70ft
Site:	Heads CC 9_4	North Reference:	Grid
Well:	Heads CC 9_4 Federal Com 24H	Survey Calculation Method:	Minimum Curvature
Wellbore:	Wellbore #1		
Design:	Permitting Plan		

Planned Survey									
Measured Depth (ft)	Inclination (°)	Azimuth (°)	Vertical Depth (ft)	+N/-S (ft)	+E/-W (ft)	Vertical Section (ft)	Dogleg Rate (°/100ft)	Build Rate (°/100ft)	Turn Rate (°/100ft)
9,600.00	90.13	359.73	8,529.82	-295.18	-602.44	-254.22	0.00	0.00	0.00
9,700.00	90.13	359.73	8,529.59	-195.18	-602.90	-154.42	0.00	0.00	0.00
9,800.00	90.13	359.73	8,529.36	-95.18	-603.37	-54.61	0.00	0.00	0.00
9,900.00	90.13	359.73	8,529.13	4.81	-603.83	45.19	0.00	0.00	0.00
10,000.00	90.13	359.73	8,528.90	104.81	-604.29	145.00	0.00	0.00	0.00
10,100.00	90.13	359.73	8,528.67	204.81	-604.76	244.81	0.00	0.00	0.00
10,200.00	90.13	359.73	8,528.44	304.81	-605.22	344.61	0.00	0.00	0.00
10,300.00	90.13	359.73	8,528.21	404.81	-605.69	444.42	0.00	0.00	0.00
10,400.00	90.13	359.73	8,527.99	504.81	-606.15	544.22	0.00	0.00	0.00
10,500.00	90.13	359.73	8,527.76	604.81	-606.61	644.03	0.00	0.00	0.00
10,600.00	90.13	359.73	8,527.53	704.81	-607.08	743.83	0.00	0.00	0.00
10,700.00	90.13	359.73	8,527.30	804.80	-607.54	843.64	0.00	0.00	0.00
10,800.00	90.13	359.73	8,527.07	904.80	-608.00	943.45	0.00	0.00	0.00
10,900.00	90.13	359.73	8,526.84	1,004.80	-608.47	1,043.25	0.00	0.00	0.00
11,000.00	90.13	359.73	8,526.61	1,104.80	-608.93	1,143.06	0.00	0.00	0.00
11,100.00	90.13	359.73	8,526.38	1,204.80	-609.40	1,242.86	0.00	0.00	0.00
11,200.00	90.13	359.73	8,526.15	1,304.80	-609.86	1,342.67	0.00	0.00	0.00
11,300.00	90.13	359.73	8,525.93	1,404.80	-610.32	1,442.47	0.00	0.00	0.00
11,400.00	90.13	359.73	8,525.70	1,504.79	-610.79	1,542.28	0.00	0.00	0.00
11,500.00	90.13	359.73	8,525.47	1,604.79	-611.25	1,642.09	0.00	0.00	0.00
11,600.00	90.13	359.73	8,525.24	1,704.79	-611.71	1,741.89	0.00	0.00	0.00
11,700.00	90.13	359.73	8,525.01	1,804.79	-612.18	1,841.70	0.00	0.00	0.00
11,800.00	90.13	359.73	8,524.78	1,904.79	-612.64	1,941.50	0.00	0.00	0.00
11,900.00	90.13	359.73	8,524.55	2,004.79	-613.11	2,041.31	0.00	0.00	0.00
12,000.00	90.13	359.73	8,524.32	2,104.79	-613.57	2,141.11	0.00	0.00	0.00
12,100.00	90.13	359.73	8,524.10	2,204.79	-614.03	2,240.92	0.00	0.00	0.00
12,200.00	90.13	359.73	8,523.87	2,304.78	-614.50	2,340.73	0.00	0.00	0.00
12,300.00	90.13	359.73	8,523.64	2,404.78	-614.96	2,440.53	0.00	0.00	0.00
12,400.00	90.13	359.73	8,523.41	2,504.78	-615.42	2,540.34	0.00	0.00	0.00
12,500.00	90.13	359.73	8,523.18	2,604.78	-615.89	2,640.14	0.00	0.00	0.00
12,600.00	90.13	359.73	8,522.95	2,704.78	-616.35	2,739.95	0.00	0.00	0.00
12,700.00	90.13	359.73	8,522.72	2,804.78	-616.82	2,839.75	0.00	0.00	0.00
12,800.00	90.13	359.73	8,522.49	2,904.78	-617.28	2,939.56	0.00	0.00	0.00
12,900.00	90.13	359.73	8,522.26	3,004.77	-617.74	3,039.37	0.00	0.00	0.00
13,000.00	90.13	359.73	8,522.04	3,104.77	-618.21	3,139.17	0.00	0.00	0.00
13,100.00	90.13	359.73	8,521.81	3,204.77	-618.67	3,238.98	0.00	0.00	0.00
13,200.00	90.13	359.73	8,521.58	3,304.77	-619.13	3,338.78	0.00	0.00	0.00
13,300.00	90.13	359.73	8,521.35	3,404.77	-619.60	3,438.59	0.00	0.00	0.00
13,400.00	90.13	359.73	8,521.12	3,504.77	-620.06	3,538.39	0.00	0.00	0.00
13,500.00	90.13	359.73	8,520.89	3,604.77	-620.53	3,638.20	0.00	0.00	0.00
13,600.00	90.13	359.73	8,520.66	3,704.77	-620.99	3,738.01	0.00	0.00	0.00
13,700.00	90.13	359.73	8,520.43	3,804.76	-621.45	3,837.81	0.00	0.00	0.00
13,800.00	90.13	359.73	8,520.21	3,904.76	-621.92	3,937.62	0.00	0.00	0.00
13,900.00	90.13	359.73	8,519.98	4,004.76	-622.38	4,037.42	0.00	0.00	0.00
14,000.00	90.13	359.73	8,519.75	4,104.76	-622.84	4,137.23	0.00	0.00	0.00
14,100.00	90.13	359.73	8,519.52	4,204.76	-623.31	4,237.03	0.00	0.00	0.00
14,200.00	90.13	359.73	8,519.29	4,304.76	-623.77	4,336.84	0.00	0.00	0.00
14,300.00	90.13	359.73	8,519.06	4,404.76	-624.24	4,436.65	0.00	0.00	0.00
14,400.00	90.13	359.73	8,518.83	4,504.75	-624.70	4,536.45	0.00	0.00	0.00
14,500.00	90.13	359.73	8,518.60	4,604.75	-625.16	4,636.26	0.00	0.00	0.00
14,600.00	90.13	359.73	8,518.38	4,704.75	-625.63	4,736.06	0.00	0.00	0.00
14,700.00	90.13	359.73	8,518.15	4,804.75	-626.09	4,835.87	0.00	0.00	0.00
14,800.00	90.13	359.73	8,517.92	4,904.75	-626.55	4,935.67	0.00	0.00	0.00
14,900.00	90.13	359.73	8,517.69	5,004.75	-627.02	5,035.48	0.00	0.00	0.00
15,000.00	90.13	359.73	8,517.46	5,104.75	-627.48	5,135.29	0.00	0.00	0.00

OXY

Planning Report

Database:	HOPSPP	Local Co-ordinate Reference:	Well Heads CC 9_4 Federal Com 24H
Company:	ENGINEERING DESIGNS	TVD Reference:	25' RKB @ 2960.70ft
Project:	PRD NM DIRECTIONAL PLANS (NAD 1983)	MD Reference:	25' RKB @ 2960.70ft
Site:	Heads CC 9_4	North Reference:	Grid
Well:	Heads CC 9_4 Federal Com 24H	Survey Calculation Method:	Minimum Curvature
Wellbore:	Wellbore #1		
Design:	Permitting Plan		

Planned Survey									
Measured Depth (ft)	Inclination (°)	Azimuth (°)	Vertical Depth (ft)	+N/-S (ft)	+E/-W (ft)	Vertical Section (ft)	Dogleg Rate (°/100ft)	Build Rate (°/100ft)	Turn Rate (°/100ft)
15,100.00	90.13	359.73	8,517.23	5,204.75	-627.95	5,235.09	0.00	0.00	0.00
15,200.00	90.13	359.73	8,517.00	5,304.74	-628.41	5,334.90	0.00	0.00	0.00
15,300.00	90.13	359.73	8,516.77	5,404.74	-628.87	5,434.70	0.00	0.00	0.00
15,400.00	90.13	359.73	8,516.54	5,504.74	-629.34	5,534.51	0.00	0.00	0.00
15,500.00	90.13	359.73	8,516.32	5,604.74	-629.80	5,634.31	0.00	0.00	0.00
15,600.00	90.13	359.73	8,516.09	5,704.74	-630.26	5,734.12	0.00	0.00	0.00
15,700.00	90.13	359.73	8,515.86	5,804.74	-630.73	5,833.93	0.00	0.00	0.00
15,800.00	90.13	359.73	8,515.63	5,904.74	-631.19	5,933.73	0.00	0.00	0.00
15,900.00	90.13	359.73	8,515.40	6,004.73	-631.66	6,033.54	0.00	0.00	0.00
16,000.00	90.13	359.73	8,515.17	6,104.73	-632.12	6,133.34	0.00	0.00	0.00
16,100.00	90.13	359.73	8,514.94	6,204.73	-632.58	6,233.15	0.00	0.00	0.00
16,200.00	90.13	359.73	8,514.71	6,304.73	-633.05	6,332.95	0.00	0.00	0.00
16,300.00	90.13	359.73	8,514.49	6,404.73	-633.51	6,432.76	0.00	0.00	0.00
16,400.00	90.13	359.73	8,514.26	6,504.73	-633.97	6,532.57	0.00	0.00	0.00
16,500.00	90.13	359.73	8,514.03	6,604.73	-634.44	6,632.37	0.00	0.00	0.00
16,600.00	90.13	359.73	8,513.80	6,704.73	-634.90	6,732.18	0.00	0.00	0.00
16,700.00	90.13	359.73	8,513.57	6,804.72	-635.37	6,831.98	0.00	0.00	0.00
16,800.00	90.13	359.73	8,513.34	6,904.72	-635.83	6,931.79	0.00	0.00	0.00
16,900.00	90.13	359.73	8,513.11	7,004.72	-636.29	7,031.59	0.00	0.00	0.00
17,000.00	90.13	359.73	8,512.88	7,104.72	-636.76	7,131.40	0.00	0.00	0.00
17,100.00	90.13	359.73	8,512.65	7,204.72	-637.22	7,231.21	0.00	0.00	0.00
17,200.00	90.13	359.73	8,512.43	7,304.72	-637.68	7,331.01	0.00	0.00	0.00
17,300.00	90.13	359.73	8,512.20	7,404.72	-638.15	7,430.82	0.00	0.00	0.00
17,400.00	90.13	359.73	8,511.97	7,504.71	-638.61	7,530.62	0.00	0.00	0.00
17,500.00	90.13	359.73	8,511.74	7,604.71	-639.08	7,630.43	0.00	0.00	0.00
17,600.00	90.13	359.73	8,511.51	7,704.71	-639.54	7,730.23	0.00	0.00	0.00
17,700.00	90.13	359.73	8,511.28	7,804.71	-640.00	7,830.04	0.00	0.00	0.00
17,800.00	90.13	359.73	8,511.05	7,904.71	-640.47	7,929.85	0.00	0.00	0.00
17,900.00	90.13	359.73	8,510.82	8,004.71	-640.93	8,029.65	0.00	0.00	0.00
18,000.00	90.13	359.73	8,510.60	8,104.71	-641.39	8,129.46	0.00	0.00	0.00
18,100.00	90.13	359.73	8,510.37	8,204.71	-641.86	8,229.26	0.00	0.00	0.00
18,200.00	90.13	359.73	8,510.14	8,304.70	-642.32	8,329.07	0.00	0.00	0.00
18,300.00	90.13	359.73	8,509.91	8,404.70	-642.79	8,428.87	0.00	0.00	0.00
18,400.00	90.13	359.73	8,509.68	8,504.70	-643.25	8,528.68	0.00	0.00	0.00
18,500.00	90.13	359.73	8,509.45	8,604.70	-643.71	8,628.49	0.00	0.00	0.00
18,600.00	90.13	359.73	8,509.22	8,704.70	-644.18	8,728.29	0.00	0.00	0.00
18,700.00	90.13	359.73	8,508.99	8,804.70	-644.64	8,828.10	0.00	0.00	0.00
18,800.00	90.13	359.73	8,508.77	8,904.70	-645.10	8,927.90	0.00	0.00	0.00
18,900.00	90.13	359.73	8,508.54	9,004.69	-645.57	9,027.71	0.00	0.00	0.00
19,000.00	90.13	359.73	8,508.31	9,104.69	-646.03	9,127.52	0.00	0.00	0.00
19,100.00	90.13	359.73	8,508.08	9,204.69	-646.50	9,227.32	0.00	0.00	0.00
19,200.00	90.13	359.73	8,507.85	9,304.69	-646.96	9,327.13	0.00	0.00	0.00
19,300.00	90.13	359.73	8,507.62	9,404.69	-647.42	9,426.93	0.00	0.00	0.00
19,400.00	90.13	359.73	8,507.39	9,504.69	-647.89	9,526.74	0.00	0.00	0.00
19,500.00	90.13	359.73	8,507.16	9,604.69	-648.35	9,626.54	0.00	0.00	0.00
19,571.35	90.13	359.73	8,507.00	9,676.03	-648.68	9,697.75	0.00	0.00	0.00

OXY

Planning Report

Database:	HOPSPP	Local Co-ordinate Reference:	Well Heads CC 9_4 Federal Com 24H
Company:	ENGINEERING DESIGNS	TVD Reference:	25' RKB @ 2960.70ft
Project:	PRD NM DIRECTIONAL PLANS (NAD 1983)	MD Reference:	25' RKB @ 2960.70ft
Site:	Heads CC 9_4	North Reference:	Grid
Well:	Heads CC 9_4 Federal Com 24H	Survey Calculation Method:	Minimum Curvature
Wellbore:	Wellbore #1		
Design:	Permitting Plan		

Design Targets									
Target Name	Dip Angle	Dip Dir.	TVD	+N/-S	+E/-W	Northing	Easting	Latitude	Longitude
- hit/miss target	(°)	(°)	(ft)	(ft)	(ft)	(usft)	(usft)		
- Shape									
PBHL (Heads CC 9_4	0.00	0.00	8,507.00	9,676.03	-648.68	456,303.31	648,293.24	32.253979	-103.987346
- plan hits target center									
- Point									
FTP (Heads CC 9_4	0.00	0.01	8,531.00	-812.94	-600.04	445,815.17	648,341.88	32.225149	-103.987298
- plan hits target center									
- Point									

Formations						
Measured Depth	Vertical Depth	Name	Lithology	Dip	Dip Direction	
(ft)	(ft)			(°)	(°)	
147.70	147.70	RUSTLER				
671.70	671.70	SALADO				
1,346.70	1,346.70	CASTILE				
2,912.34	2,911.70	DELAWARE				
2,964.57	2,963.70	BELL CANYON				
3,817.82	3,803.70	CHERRY CANYON				
5,125.99	5,051.70	BRUSHY CANYON				
6,806.21	6,649.70	BONE SPRING				
7,854.51	7,646.70	BONE SPRING 1ST				
8,793.12	8,460.70	BONE SPRING 2ND				

Plan Annotations					
Measured Depth	Vertical Depth	Local Coordinates			
(ft)	(ft)	+N/-S	+E/-W	Comment	
		(ft)	(ft)		
2,410.00	2,410.00	0.00	0.00	Build 1°/100'	
4,209.86	4,180.40	-262.44	-98.70	Hold 18° Tangent	
8,013.12	7,797.55	-1,362.41	-512.37	KOP, Build & Turn 10°/100'	
9,082.23	8,531.00	-812.94	-600.04	Landing Point	
19,571.34	8,507.00	9,676.03	-648.68	TD at 19571.35' MD	

OXY APD CHANGE SUNDRY LIST

DATE	10/12/2023
WELL NAME	HEADS CC 9_4 FED COM 24H
API NUMBER	30-015-47337

ITEM	PREVIOUS	UPDATE
NAME	NA	
NSL	NA	
SHL	910 FSL, 1365 FEL	910 FSL, 1366 FEL
PAD	NA	
BHL	20 FNL, 1030 FWL	20 FNL, 1970 FEL
HSU SIZE, ACRES	640	1280
POOL	NA	
TARGET FORMATION	NA	
TVD	NA	
SURFACE CASING	40.5 LBS	45.5 LBS
INTERMEDIATE CASING	L-80 HC, BTC	P110S, WEDGE 463
INTERMEDIATE 2 CASING	NA	
PRODUCTION CASING	TAPER 5.5 TO 4.5, DQX	5.5 PROD LINER, WEDGE 461
LINER OR TIE BACK	NONE	CONTINGENCY TIE BACK
CEMENT		
FACILITIES		
OTHER		

OTHER COMMENTS
THE SHL IS CHANGING SLIGHTLY. THE BHL, HSU SIZE, SURFACE CASING, INTERMEDIATE CASING, AND PRODUCTION CASING ARE UPDATED.
A CONTINGENCY TIE BACK IS ATTACHED. UPDATED VARIANCE REQUESTS FOR BOP BREAK TESTING, BRADENHEAD CBL, AND OFFLINE CEMENT ARE ATTACHED.

Note- Only fill out what item is changing. The other cells can be left blank.

VERSION DATE 10/12/2023

District I
1625 N. French Dr., Hobbs, NM 88240
Phone:(575) 393-6161 Fax:(575) 393-0720
District II
811 S. First St., Artesia, NM 88210
Phone:(575) 748-1283 Fax:(575) 748-9720
District III
1000 Rio Brazos Rd., Aztec, NM 87410
Phone:(505) 334-6178 Fax:(505) 334-6170
District IV
1220 S. St Francis Dr., Santa Fe, NM 87505
Phone:(505) 476-3470 Fax:(505) 476-3462

State of New Mexico
Energy, Minerals and Natural Resources
Oil Conservation Division
1220 S. St Francis Dr.
Santa Fe, NM 87505

CONDITIONS

Action 308470

CONDITIONS

Operator: OXY USA INC P.O. Box 4294 Houston, TX 772104294	OGRID: 16696
	Action Number: 308470
	Action Type: [C-103] NOI Change of Plans (C-103A)

CONDITIONS

Created By	Condition	Condition Date
dmcclure	If cement does not circulate on any string, a CBL is required for that string of casing.	1/26/2024
dmcclure	All prior COAs are still applicable.	1/26/2024