

| | | |
|--|--|---|
| Santa Fe Main Office Phone: (505) 476-3441 Fax: (55) 476-3462 General Information Phone: (505) 629-6116 Online Phone Directory Visit: https://www.emnrd.nm.gov/ocd/contact-us/ | State of New Mexico Energy, Minerals & Natural Resources Department OIL CONSERVATION DIVISION | C-104 Revised July 9, 2024 Submit Electronically Via OCD Permitting |
|--|--|---|

REQUEST FOR ALLOWABLE AND AUTHORIZATION TO TRANSPORT

Section 1 - Operator and Well Information

| | |
|--|--------------------------|
| Submittal Type: <input type="checkbox"/> Test Allowable (C-104RT) <input checked="" type="checkbox"/> New Well (C-104NW) <input type="checkbox"/> Recomplete (C-104RC) <input type="checkbox"/> Pay Add (C-104RC) <input type="checkbox"/> Amended | |
| Operator Name: Hilcorp Energy Company | OGRID: 372171 |
| Property Name and Well Number: CALLOWAY 2M | Property Code: 318877 |
| Mineral Owner: <input type="checkbox"/> State <input checked="" type="checkbox"/> Fee <input type="checkbox"/> Tribal <input type="checkbox"/> Federal | API Number: 30-045-38406 |
| Pool Name: BASIN DAKOTA | Pool Code: 71599 |

Section 2 – Surface Location

| UL H | Section 34 | Township 031N | Range 011W | Lot | Ft. from N/S 2470' North | Ft. from E/W 948' East | Latitude 36.855748 | Longitude -107.972688 | County SAN JUAN |
|---------|---------------|------------------|---------------|-----|-----------------------------|---------------------------|-----------------------|--------------------------|--------------------|
|---------|---------------|------------------|---------------|-----|-----------------------------|---------------------------|-----------------------|--------------------------|--------------------|

Section 3 – Completion Information

| | | | |
|-----------------------------|------------------------|------------------------------------|-------------------------------------|
| Producing Method Flowing | Ready Date 4/9/2024 | Perforations MD 6,871' – 7,080' | Perforations TVD 6,625' – 6,843' |
|-----------------------------|------------------------|------------------------------------|-------------------------------------|

Section 4 – Action IDs for Submissions and Order Numbers

| | |
|---|---|
| List Action IDs for Drilling Sundries | Was an Order required / needed (Y/N), if yes list Order number: |
| C-104 RT Action ID (if C-104NW): 448221 | Communitization Agreement <input type="checkbox"/> Yes <input checked="" type="checkbox"/> No, Order No. |
| Surface Casing Action ID: 385353 | Unit: <input type="checkbox"/> Yes <input checked="" type="checkbox"/> No, Order No. |
| Intermediate 1 Casing Action ID: 385353 | Compulsory Pooling: <input type="checkbox"/> Yes <input checked="" type="checkbox"/> No, Order No. |
| Intermediate 2 Casing Action ID: N/A | Down Hole Commingling: <input checked="" type="checkbox"/> Yes <input type="checkbox"/> No, Order No. DHC-5467 |
| Production Casing Action ID: 386634 | Surface Commingling: <input type="checkbox"/> Yes <input checked="" type="checkbox"/> No, Order No. |
| All casing was pressure tested in accordance with NMAC <input checked="" type="checkbox"/> Yes <input type="checkbox"/> No | Non-standard Location: <input type="checkbox"/> Yes <input checked="" type="checkbox"/> No <input type="checkbox"/> Common ownership Order No. |
| Liner 1 Action ID: N/A | Non-standard Proration: <input type="checkbox"/> Yes <input checked="" type="checkbox"/> No, Order No. |
| Casing was installed prior to OCD's Action ID system (Y/N): N | Simultaneous Dedication: <input type="checkbox"/> Yes <input checked="" type="checkbox"/> No, Order No. |

Section 5 - Operator Signature and Certification

| | |
|--|-----------------|
| <input checked="" type="checkbox"/> I hereby certify that the required Water Use Report has been, or will be, submitted for this well's completion. | |
| <input checked="" type="checkbox"/> I hereby certify that the required Fracfocus disclosure has been, or will be, submitted for this well's completion. | |
| <input checked="" type="checkbox"/> I hereby certify that the rules of the Oil Conservation Division have been complied with and that the information given above is true and complete to the best of my knowledge and belief. | |
| Name Cherylene Weston | |
| Title: Operations Regulatory Tech Sr. | Date: 4/29/2025 |

| | | |
|--|--|---|
| Santa Fe Main Office Phone: (505) 476-3441 Fax: (55) 476-3462 General Information Phone: (505) 629-6116 Online Phone Directory Visit: https://www.emnrd.nm.gov/ocd/contact-us/ | State of New Mexico Energy, Minerals & Natural Resources Department OIL CONSERVATION DIVISION | C-104 Revised July 9, 2024 Submit Electronically Via OCD Permitting |
|--|--|---|

REQUEST FOR ALLOWABLE AND AUTHORIZATION TO TRANSPORT

Section 1 - Operator and Well Information

| | |
|--|--------------------------|
| Submittal Type: <input type="checkbox"/> Test Allowable (C-104RT) <input checked="" type="checkbox"/> New Well (C-104NW) <input type="checkbox"/> Recomplete (C-104RC) <input type="checkbox"/> Pay Add (C-104RC) <input type="checkbox"/> Amended | |
| Operator Name: Hilcorp Energy Company | OGRID: 372171 |
| Property Name and Well Number: CALLOWAY 2M | Property Code: 318877 |
| Mineral Owner: <input type="checkbox"/> State <input checked="" type="checkbox"/> Fee <input type="checkbox"/> Tribal <input type="checkbox"/> Federal | API Number: 30-045-38406 |
| Pool Name: BLANCO MESAVERDE | Pool Code: 72319 |

Section 2 – Surface Location

| UL H | Section 34 | Township 031N | Range 011W | Lot | Ft. from N/S 2470' North | Ft. from E/W 948' East | Latitude 36.855748 | Longitude -107.972688 | County SAN JUAN |
|---------|---------------|------------------|---------------|-----|-----------------------------|---------------------------|-----------------------|--------------------------|--------------------|
|---------|---------------|------------------|---------------|-----|-----------------------------|---------------------------|-----------------------|--------------------------|--------------------|

Section 3 – Completion Information

| | | | |
|-----------------------------|------------------------|------------------------------------|-------------------------------------|
| Producing Method Flowing | Ready Date 4/3/2024 | Perforations MD 4,436' - 5,079' | Perforations TVD 4,192' - 4,834' |
|-----------------------------|------------------------|------------------------------------|-------------------------------------|

Section 4 – Action IDs for Submissions and Order Numbers

| | |
|---|---|
| List Action IDs for Drilling Sundries | Was an Order required / needed (Y/N), if yes list Order number: |
| C-104 RT Action ID (if C-104NW): 448220 | Communitization Agreement <input type="checkbox"/> Yes <input checked="" type="checkbox"/> No, Order No. |
| Surface Casing Action ID: 385353 | Unit: <input type="checkbox"/> Yes <input checked="" type="checkbox"/> No, Order No. |
| Intermediate 1 Casing Action ID: 385353 | Compulsory Pooling: <input type="checkbox"/> Yes <input checked="" type="checkbox"/> No, Order No. |
| Intermediate 2 Casing Action ID: N/A | Down Hole Commingling: <input checked="" type="checkbox"/> Yes <input type="checkbox"/> No, Order No. DHC-5467 |
| Production Casing Action ID: 386634 | Surface Commingling: <input type="checkbox"/> Yes <input checked="" type="checkbox"/> No, Order No. |
| All casing was pressure tested in accordance with NMAC <input checked="" type="checkbox"/> Yes <input type="checkbox"/> No | Non-standard Location: <input type="checkbox"/> Yes <input checked="" type="checkbox"/> No <input type="checkbox"/> Common ownership Order No. |
| Liner 1 Action ID: N/A | Non-standard Proration: <input type="checkbox"/> Yes <input checked="" type="checkbox"/> No, Order No. |
| Casing was installed prior to OCD's Action ID system (Y/N): N | Simultaneous Dedication: <input type="checkbox"/> Yes <input checked="" type="checkbox"/> No, Order No. |

Section 5 - Operator Signature and Certification

| | |
|--|-----------------|
| <input checked="" type="checkbox"/> I hereby certify that the required Water Use Report has been, or will be, submitted for this well's completion. | |
| <input checked="" type="checkbox"/> I hereby certify that the required Fracfocus disclosure has been, or will be, submitted for this well's completion. | |
| <input checked="" type="checkbox"/> I hereby certify that the rules of the Oil Conservation Division have been complied with and that the information given above is true and complete to the best of my knowledge and belief. | |
| Name Cherylene Weston | |
| Title: Operations Regulatory Tech Sr. | Date: 4/29/2025 |

WELL COMPLETION OR RECOMPLETION REPORT AND LOG

Section 1 - Operator and Well Information

| | |
|---|--------------------------|
| Submittal Type: <input checked="" type="checkbox"/> New Well <input type="checkbox"/> Workover <input type="checkbox"/> Deepening <input type="checkbox"/> Plugback <input type="checkbox"/> Different Reservoir <input type="checkbox"/> C-144 Closure Attachment <input type="checkbox"/> Other | |
| Operator Name: Hilcorp Energy Company | OGRID: 372171 |
| Property Name and Well Number: CALLOWAY 2M | Property Code: 318877 |
| Mineral Owner: <input type="checkbox"/> State <input checked="" type="checkbox"/> Fee <input type="checkbox"/> Tribal <input type="checkbox"/> Federal | API Number: 30-045-38406 |
| Pool Name: BASIN DAKOTA | Pool Code: 71599 |

Section 2 – Well Location

| | Ul or lot no. | Section | Township | Range | Lot Id | Feet from | N/S Line | Feet from | E/W Line | County |
|------|---------------|---------|----------|-------|--------|-----------|----------|-----------|----------|----------|
| SHL: | H | 34 | 031N | 011W | | 2470 | North | 948 | East | San Juan |
| BHL | J | 34 | 031N | 011W | | 2110 | South | 1938 | East | San Juan |

Section 3 – Completion Information

| | | | |
|--------------------------------|--|--|---|
| Date T.D. Reached 3/22/2025 | Total Measured Depth of Well 7146’ | Acid Volume (bbls) 24 | <input checked="" type="checkbox"/> Directional Survey Submitted <input type="checkbox"/> Deviation Survey Submitted |
| Date Rig Released 4/9/2025 | Plug-Back Measured Depth 7129’ | Completion Fluid Used (bbls) 1,204 | Were Logs Ran (Y/N) Y |
| Completion Date 4/9/2025 | Perforations (MD and TVD) 6,871’ – 7,080’ MD; 6,625’ – 6,843’ TVD | Completion Proppant Used (lbs) 65,620 | List Type of Logs Ran if applicable: CBL |

Section 4 – Action IDs for Submissions and Order Numbers

| | |
|---|--|
| Surface Casing Action ID: 386634 | UIC Permit/Order (UIC wells only) <input type="checkbox"/> Yes <input checked="" type="checkbox"/> No, Order No. |
| Intermediate 1 Casing Action ID: 386634 | NOI Recomplete Action ID (if applicable): N/A |
| Intermediate 2 Casing Action ID: 386634 | NOI Plugback Action ID (if applicable): N/A |
| Production Casing Action ID: 386634 | Cement Squeeze Action ID (if applicable): |
| Tubing Action ID: N/A | All casing was pressure tested in accordance with NMAC <input checked="" type="checkbox"/> Yes <input type="checkbox"/> No |
| Liner 1 Action ID: N/A | Casing was installed prior to Action ID system (Y/N): N |

Section 5 – Test Data

| | | | |
|-----------------------------------|------------------------------|------------------------------------|----------------------------|
| Date First Production 4/9/2025 | Production Method Flowing | Well Status Producing | Gas – Oil Ratio |
| Date of Test 4/9/2025 | Choke Size 16/64” | Flowing Tubing Pressure 840 psi | Casing Pressure 780 psi |
| 24 hr Oil (bbls) 0 bbl | 24 hr Gas (MCF) 2,058 MCF | 24 hr Water (bbls) 0 bbl | Oil Gravity – API |
| Disposition of Gas: Sold | | | |

Section 6 – Pits

☐ A temporary pit was used at the well. If so, attach a plat with the location of the temporary pit.
☒ A Closed Loop System was used.
☐ If an on-site burial was used at the well, report the exact location of the on-site burial:
LAT: _____ LONG: _____

Section 7 - Operator Signature and Certification

| | |
|--|----------------|
| <input checked="" type="checkbox"/> I hereby certify that the required Water Use Report has been, or will be, submitted for this well’s completion. | |
| <input checked="" type="checkbox"/> I hereby certify that the required Fracfocus disclosure has been, or will be, submitted for this well’s completion. | |
| <input checked="" type="checkbox"/> I hereby certify that the rules of the Oil Conservation Division have been complied with and that the information given above is true and complete to the best of my knowledge and belief. | |
| Name Cherylene Weston | |
| Title Operations Regulatory Tech Sr. | Date 4/29/2025 |

| South Formations | | | | North Formations | | | |
|---------------------|----|-----|-------|--------------------|------|------|-------|
| Formation/Zone | MD | TVD | W/O/G | Formation/Zone | MD | TVD | W/O/G |
| T. Anhy | | | | T. San Jose | | | |
| T. Salt | | | | T. Nacimiento | | | |
| B. Salt | | | | T. Ojo Alamo | 756 | 756 | WATER |
| T. Yates | | | | T. Kirtland | 862 | 862 | NA |
| T. 7 Rivers | | | | T. Fruitland | 1838 | 1802 | GAS |
| T. Queen | | | | T. Pictured Cliffs | 2332 | 2238 | GAS |
| T. Grayburg | | | | T. Lewis Shale | 2454 | 2343 | NA |
| T. San Andres | | | | T. Chacra | 3550 | 3327 | NA |
| T. Glorieta | | | | T. Cliff House | 4085 | 3843 | W/G |
| T. Yeso | | | | T. Menefee | 4246 | 4002 | GAS |
| T. Paddock | | | | T. Point Lookout | 4743 | 4498 | GAS |
| T. Blinebry | | | | T. Mancos | 5101 | 4855 | GAS |
| T.Tubb | | | | T. Gallup | 6020 | 5775 | GAS |
| T. Drinkard | | | | T. Greenhorn | 6753 | 6507 | NA |
| T. Abo | | | | T. Graneros | 6813 | 6567 | NA |
| T. Wolfcamp | | | | T. Dakota | 6868 | 6622 | GAS |
| T. Penn | | | | T. Morrison | | | |
| T. Cisco | | | | T. Bluff | | | |
| T. Canyon | | | | T.Todilto | | | |
| T. Strawn | | | | T. Entrada | | | |
| T. Atoka | | | | T. Wingate | | | |
| T. Morrow | | | | T. Chinle | | | |
| T. Barnett Shale | | | | T. Permian | | | |
| T. Miss | | | | T. Penn A" | | | |
| T. Woodford Shale | | | | T. Penn. "B" | | | |
| T. Devonian | | | | T. Penn. "C" | | | |
| T. Silurian | | | | T. Penn. "D" | | | |
| T. Fusselman | | | | T. Leadville | | | |
| T. Montoya | | | | T. Madison | | | |
| T. Simpson | | | | T. Elbert | | | |
| T. McKee | | | | T. McCracken | | | |
| T. Waddell | | | | T. Ignacio Oztte | | | |
| T. Connel | | | | T. Granite | | | |
| T. Ellenburger | | | | T. Hermosa | | | |
| T. Gr. Wash | | | | T. De Chelly | | | |
| T. Delaware Sand | | | | T. Pinkerton | | | |
| T. Lamar Lime | | | | | | | |
| T. Bell Canyon | | | | | | | |
| T. Cherry Canyon | | | | | | | |
| T. Brushy Canyon | | | | | | | |
| T. Bone Springs | | | | | | | |
| T. 1st BS Sand | | | | | | | |
| T. 2nd BS Carbonate | | | | | | | |
| T. 2nd BS Sand | | | | | | | |
| T. 3rd BS Carbonate | | | | | | | |
| T. 3rd BS Sand | | | | | | | |

WELL COMPLETION OR RECOMPLETION REPORT AND LOG

Section 1 - Operator and Well Information

| | |
|---|--------------------------|
| Submittal Type: <input checked="" type="checkbox"/> New Well <input type="checkbox"/> Workover <input type="checkbox"/> Deepening <input type="checkbox"/> Plugback <input type="checkbox"/> Different Reservoir <input type="checkbox"/> C-144 Closure Attachment <input type="checkbox"/> Other | |
| Operator Name: Hilcorp Energy Company | OGRID: 372171 |
| Property Name and Well Number: CALLOWAY 2M | Property Code: 318877 |
| Mineral Owner: <input type="checkbox"/> State <input checked="" type="checkbox"/> Fee <input type="checkbox"/> Tribal <input type="checkbox"/> Federal | API Number: 30-045-38406 |
| Pool Name: BLANCO MESAVERDE | Pool Code: 72319 |

Section 2 – Well Location

| | Ul or lot no. | Section | Township | Range | Lot Id | Feet from | N/S Line | Feet from | E/W Line | County |
|------|---------------|---------|----------|-------|--------|-----------|----------|-----------|----------|----------|
| SHL: | H | 34 | 031N | 011W | | 2470 | North | 948 | East | San Juan |
| BHL | J | 34 | 031N | 011W | | 2110 | South | 1938 | East | San Juan |

Section 3 – Completion Information

| | | | |
|--------------------------------|--|---|---|
| Date T.D. Reached 3/22/2025 | Total Measured Depth of Well 7146’ | Acid Volume (bbls) 24 | <input checked="" type="checkbox"/> Directional Survey Submitted <input type="checkbox"/> Deviation Survey Submitted |
| Date Rig Released 4/9/2025 | Plug-Back Measured Depth 7129’ | Completion Fluid Used (bbls) 2,327 | Were Logs Ran (Y/N) Y |
| Completion Date 4/9/2025 | Perforations (MD and TVD) 4,436’ – 5,079’ MD; 4,192’ – 4,834’ TVD | Completion Proppant Used (lbs) 316,317 | List Type of Logs Ran if applicable: CBL |

Section 4 – Action IDs for Submissions and Order Numbers

| | |
|---|--|
| Surface Casing Action ID: 386634 | UIC Permit/Order (UIC wells only) <input type="checkbox"/> Yes <input checked="" type="checkbox"/> No, Order No. |
| Intermediate 1 Casing Action ID: 386634 | NOI Recomplete Action ID (if applicable): N/A |
| Intermediate 2 Casing Action ID: 386634 | NOI Plugback Action ID (if applicable): N/A |
| Production Casing Action ID: 386634 | Cement Squeeze Action ID (if applicable): |
| Tubing Action ID: N/A | All casing was pressure tested in accordance with NMAC <input checked="" type="checkbox"/> Yes <input type="checkbox"/> No |
| Liner 1 Action ID: N/A | Casing was installed prior to Action ID system (Y/N): N |

Section 5 – Test Data

| | | | |
|-----------------------------------|------------------------------|----------------------------------|----------------------------|
| Date First Production 4/3/2025 | Production Method Flowing | Well Status Producing | Gas – Oil Ratio |
| Date of Test 4/3/2025 | Choke Size 16/64” | Flowing Tubing Pressure 0 psi | Casing Pressure 660 psi |
| 24 hr Oil (bbls) 0 bbl | 24 hr Gas (MCF) 7 MCF | 24 hr Water (bbls) 0 bbl | Oil Gravity – API |
| Disposition of Gas: Sold | | | |

Section 6 – Pits

☐ A temporary pit was used at the well. If so, attach a plat with the location of the temporary pit.
☒ A Closed Loop System was used.
☐ If an on-site burial was used at the well, report the exact location of the on-site burial:
LAT: _____ LONG: _____

Section 7 - Operator Signature and Certification

| | |
|--|----------------|
| <input checked="" type="checkbox"/> I hereby certify that the required Water Use Report has been, or will be, submitted for this well’s completion. | |
| <input checked="" type="checkbox"/> I hereby certify that the required Fracfocus disclosure has been, or will be, submitted for this well’s completion. | |
| <input checked="" type="checkbox"/> I hereby certify that the rules of the Oil Conservation Division have been complied with and that the information given above is true and complete to the best of my knowledge and belief. | |
| Name Cherylene Weston | |
| Title Operations Regulatory Tech Sr. | Date 4/29/2025 |

| South Formations | | | | North Formations | | | |
|---------------------|----|-----|-------|--------------------|------|------|-------|
| Formation/Zone | MD | TVD | W/O/G | Formation/Zone | MD | TVD | W/O/G |
| T. Anhy | | | | T. San Jose | | | |
| T. Salt | | | | T. Nacimiento | | | |
| B. Salt | | | | T. Ojo Alamo | 756 | 756 | WATER |
| T. Yates | | | | T. Kirtland | 862 | 862 | NA |
| T. 7 Rivers | | | | T. Fruitland | 1838 | 1802 | GAS |
| T. Queen | | | | T. Pictured Cliffs | 2332 | 2238 | GAS |
| T. Grayburg | | | | T. Lewis Shale | 2454 | 2343 | NA |
| T. San Andres | | | | T. Chacra | 3550 | 3327 | NA |
| T. Glorieta | | | | T. Cliff House | 4085 | 3843 | W/G |
| T. Yeso | | | | T. Menefee | 4246 | 4002 | GAS |
| T. Paddock | | | | T. Point Lookout | 4743 | 4498 | GAS |
| T. Blinebry | | | | T. Mancos | 5101 | 4855 | GAS |
| T.Tubb | | | | T. Gallup | 6020 | 5775 | GAS |
| T. Drinkard | | | | T. Greenhorn | 6753 | 6507 | NA |
| T. Abo | | | | T. Graneros | 6813 | 6567 | NA |
| T. Wolfcamp | | | | T. Dakota | 6868 | 6622 | GAS |
| T. Penn | | | | T. Morrison | | | |
| T. Cisco | | | | T. Bluff | | | |
| T. Canyon | | | | T.Todilto | | | |
| T. Strawn | | | | T. Entrada | | | |
| T. Atoka | | | | T. Wingate | | | |
| T. Morrow | | | | T. Chinle | | | |
| T. Barnett Shale | | | | T. Permian | | | |
| T. Miss | | | | T. Penn A" | | | |
| T. Woodford Shale | | | | T. Penn. "B" | | | |
| T. Devonian | | | | T. Penn. "C" | | | |
| T. Silurian | | | | T. Penn. "D" | | | |
| T. Fusselman | | | | T. Leadville | | | |
| T. Montoya | | | | T. Madison | | | |
| T. Simpson | | | | T. Elbert | | | |
| T. McKee | | | | T. McCracken | | | |
| T. Waddell | | | | T. Ignacio Otzte | | | |
| T. Connel | | | | T. Granite | | | |
| T. Ellenburger | | | | T. Hermosa | | | |
| T. Gr. Wash | | | | T. De Chelly | | | |
| T. Delaware Sand | | | | T. Pinkerton | | | |
| T. Lamar Lime | | | | | | | |
| T. Bell Canyon | | | | | | | |
| T. Cherry Canyon | | | | | | | |
| T. Brushy Canyon | | | | | | | |
| T. Bone Springs | | | | | | | |
| T. 1st BS Sand | | | | | | | |
| T. 2nd BS Carbonate | | | | | | | |
| T. 2nd BS Sand | | | | | | | |
| T. 3rd BS Carbonate | | | | | | | |
| T. 3rd BS Sand | | | | | | | |

Submit 1 Copy To Appropriate District

Office

District I – (575) 393-6161

1625 N. French Dr., Hobbs, NM 88240

District II – (575) 748-1283

811 S. First St., Artesia, NM 88210

District III – (505) 334-6178

1000 Rio Brazos Rd., Aztec, NM 87410

District IV – (505) 476-3460

1220 S. St. Francis Dr., Santa Fe, NM

87505

State of New Mexico
Energy, Minerals and Natural ResourcesForm C-103
Revised July 18, 2013OIL CONSERVATION DIVISION
1220 South St. Francis Dr.
Santa Fe, NM 87505

| |
|---|
| WELL API NO. 30-045-38406 |
| 5. Indicate Type of Lease STATE <input type="checkbox"/> FEE <input checked="" type="checkbox"/> |
| 6. State Oil & Gas Lease No. |
| 7. Lease Name or Unit Agreement Name Calloway |
| 8. Well Number 2M |
| 9. OGRID Number 372171 |
| 10. Pool name or Wildcat Blanco Mesaverde / Basin Dakota |

SUNDRY NOTICES AND REPORTS ON WELLS
(DO NOT USE THIS FORM FOR PROPOSALS TO DRILL OR TO DEEPEN OR PLUG BACK TO A DIFFERENT RESERVOIR. USE "APPLICATION FOR PERMIT" (FORM C-101) FOR SUCH PROPOSALS.)

1. Type of Well: Oil Well ☐ Gas Well ☒ Other2. Name of Operator
Hilcorp Energy Company3. Address of Operator
382 Road 3100, Aztec, NM 87410

4. Well Location

Unit Letter H: 2470 feet from the North line and 948 feet from the East lineSection 34 Township 031N Range 011W NMPM County SAN JUAN11. Elevation (Show whether DR, RKB, RT, GR, etc.)
5659' GL

12. Check Appropriate Box to Indicate Nature of Notice, Report or Other Data

NOTICE OF INTENTION TO:

PERFORM REMEDIAL WORK ☐ PLUG AND ABANDON ☐
 TEMPORARILY ABANDON ☐ CHANGE PLANS ☐
 PULL OR ALTER CASING ☐ MULTIPLE COMPL ☐
 DOWNHOLE COMMINGLE ☐
 CLOSED-LOOP SYSTEM ☐
 OTHER: ☐

SUBSEQUENT REPORT OF:

REMEDIAL WORK ☐ ALTERING CASING ☐
 COMMENCE DRILLING OPNS. ☐ P AND A ☐
 CASING/CEMENT JOB ☒
 OTHER: SIDETRACK ☒

13. Describe proposed or completed operations. (Clearly state all pertinent details, and give pertinent dates, including estimated date of starting any proposed work). SEE RULE 19.15.7.14 NMAC. For Multiple Completions: Attach wellbore diagram of proposed completion or recompletion.

Please see attached completion operations reports.

Spud Date:

Rig Release Date:

I hereby certify that the information above is true and complete to the best of my knowledge and belief.

SIGNATURE Cherylene Weston TITLE Operations/Regulatory Tech-Sr. DATE 4/29/2025Type or print name Cherylene Weston E-mail address: cweston@hilcorp.com PHONE: 713-289-2615
For State Use OnlyAPPROVED BY: _____ TITLE _____ DATE _____
Conditions of Approval (if any)

| | | |
|--|-------------------------------|-----------------------------|
| <div>Hilcorp Energy Company</div> <div>Well Operations Summary L48</div> | | |
| Well Name: CALLOWAY 2M | | |
| API: 3004538406 | Field: Blanco Mesaverde | State: NEW MEXICO |
| Permit to Drill (PTD) #: | Sundry #: | Rig/Service: 105 |
| Jobs | | |
| Actual Start Date: 3/25/2025 | | End Date: |
| Report Number 4 | Report Start Date 4/1/2025 | Report End Date 4/1/2025 |
| Operation | | |
| RIH AND PERF STAGE #1 (DAKOTA) INTERVAL IN 2 RUNS WITH 31 SHOTS, 0.33" DIA, 3-1/8" WELLMATICS GUNS, 1 SPF 0 DEGREE PHASING AT 6871', 6875', 6880', 6883', 6906', 6910', 6917', 6922', 6933', 6947', 6951', 6956', 6961', 6966', 6971', 6975', 6980', 6991', 6995', 7003', 7006', 7013', 7015', 7022', 7035', 7039', 7046', 7067', 7071', 7075', 7080'. | | |
| ALL SHOTS FIRED. | | |
| TIED INTO CNL RAN 3/27/2025 | | |
| POH. R/D WRLN LUBRICATOR. | | |
| COOL DOWN AND PRIME EQUIPMENT. PRESSURE TEST FLUID LINES TO 5000 PSI. GOOD TEST. PRESSURE TEST N2 LINES TO 5000 PSI. GOOD TEST. | | |
| HELD PRE JOB SAFETY MEETING WITH ALL PERSONAL ON LOCATION. | | |
| DAKOTA STIMULATION: (6871' TO 7080') | | |
| FRAC AT 50 BPM W/ 70Q N2 FOAM TOTAL LOAD: 1216 BBLS SLICKWATER: 1204 BBLS (50,568 GALS) TOTAL ACID: 12 BBLS TOTAL 20/40 SAND: 65,620 LBS TOTAL N2: 2,148,000 SCF AVERAGE RATE: 50.1 BPM MAX RATE: 51.3 BPM AVERAGE PRESSURE: 3,656 PSI MAX PRESSURE: 4,022 PSI MAX SAND CONC: 1.5 PPG DOWNHOLE | | |
| BREAKDOWN: ISIP: 820 PSI 5 MIN: 392 PSI 10 MIN: 293 PSI 15 MIN: 234 PSI | | |
| FINAL: ISIP: 1956 PSI 5 MIN: 1499 PSI 10 MIN: 1405 PSI 15 MIN: 1341 PSI | | |
| DROPPED (15) 7/8" RCN BALLS BETWEEN SAND RAMPS. | | |
| RIH W/ WRLN AND SET CBP AT 5150'. | | |
| PERF STAGE #2 POINT LOOKOUT INTERVAL IN 1 RUN WITH 30 SHOTS, 0.33" DIA, 3-1/8" WELLMATICS GUNS, 1 SPF 0 DEGREE PHASING AT 4752', 4758', 4763', 4768', 4773', 4778', 4792', 4797', 4803', 4812', 4816', 4820', 4825', 4831', 4838', 4846', 4859', 4881', 4890', 4910', 4926', 4934', 4953', 4956', 4971', 4983', 4988', 5018', 5045', 5079'. | | |
| ALL SHOTS FIRED. | | |
| POH. R/D WRLN LUBRICATOR. | | |
| | | |
| WellViewAdmin@hilcorp.com | | |
| Page 1/3 | | |
| Report Printed: 4/7/2025 | | |



Well Operations Summary L48

Well Name: CALLOWAY 2M

| | | |
|-----------------|-------------------------|-------------------|
| API: 3004538406 | Field: Blanco Mesaverde | State: NEW MEXICO |
| | Sundry #: | Rig/Service: 105 |

Operation

POINT LOOKOUT STIMULATION: (4752' TO 5079')

FRAC AT 70 BPM W/ 70Q N2 FOAM
TOTAL LOAD: 1,245 BBLS
SLICKWATER: 1,233 BBLS (51,786 GALS)
TOTAL ACID: 12 BBLS
TOTAL 20/40 SAND: 133,917 LBS
TOTAL N2: 1,433,000 SCF
AVERAGE RATE: 70 BPM
MAX RATE: 71.9 BPM
AVERAGE PRESSURE: 2,510 PSI
MAX PRESSURE: 3,372 PSI
MAX SAND CONC: 3.0 PPG DOWNHOLE

BREAKDOWN:
ISIP: 29 PSI
5 MIN: N/A
10 MIN: N/A
15 MIN: N/A

FINAL:
ISIP: 229 PSI
5 MIN: 47 PSI
10 MIN: 35 PSI
15 MIN: 29 PSI

DROPPED (15) 7/8" RCN BALLS BETWEEN SAND RAMPS.

RIH W/ WRLN AND SET CBP AT 4748'.

PERF STAGE #3 MENELEE INTERVAL WITH 25 SHOTS IN 1 RUN, 0.33" DIA, 3-1/8" WELLMATICS GUNS, 1 SPF 0 DEGREE PHASING AT 4436', 4442', 4465', 4475', 4483', 4536', 4571', 4575', 4580', 4610', 4616', 4629', 4632', 4641', 4646', 4656', 4665', 4671', 4675', 4680', 4684', 4698', 4703', 4727', 4741'.

ALL SHOTS FIRED.

TIED INTO CNL RAN 3/27/2025

POH. R/D WRLN LUBRICATOR.

MENELEE STIMULATION: (4436' TO 4741')

FRAC AT 70 BPM W/ 70Q N2 FOAM
TOTAL LOAD: 1,106 BBLS
SLICKWATER: 1,094 BBLS (45,948 GALS)
TOTAL ACID: 12 BBLS
TOTAL 20/40 SAND: 116,780 LBS
TOTAL N2: 1,525,000 SCF
AVERAGE RATE: 68.2 BPM
MAX RATE: 70.6 BPM
AVERAGE PRESSURE: 4,286 PSI
MAX PRESSURE: 4,566 PSI
MAX SAND CONC: 2.25 PPG DOWNHOLE

BREAKDOWN:
ISIP: 585 PSI
5 MIN: N/A
10 MIN: N/A
15 MIN: N/A

FINAL:
ISIP: 1,475 PSI
5 MIN: 1,241 PSI
10 MIN: 1,206 PSI
15 MIN: 1,182 PSI

DROP RATE TO 65 BPM DURING SECOND SAND RAMP DUE TO PRESSURE.
DROPPED (12) 7/8" RCN BALLS BETWEEN SAND RAMPS.

RIH W/ WRLN AND SET CBP AT 4300'. POH. BLEED OFF PRESSURE IN 4-1/2" CASING.

SHUT IN WELL. SECURED LOCATION.

| | | |
|--------------------|-------------------------------|-----------------------------|
| Report Number 5 | Report Start Date 4/2/2025 | Report End Date 4/2/2025 |
|--------------------|-------------------------------|-----------------------------|



Well Operations Summary L48

Well Name: **CALLOWAY 2M**

API: 3004538406

Field: Blanco Mesaverde

State: NEW MEXICO

Sundry #:

Rig/Service: 105

Operation

ACCEPT HEC #105 AT 06:00 ON 4/2/2025. CREW TRAVEL TO LOCATION.

MOB FROM THE NYE SRC #8 TO THE CALLOWAY #2M (6 MILE MOVE). EXTRA TIME TAKEN DUE TO FRAC CREW ON LOCATION.

SPOT RIG AND EQUIPMENT. RIG UP RIG EQUIPMENT. SITP: N/A SICP: 0 PSI SIICP: 0 PSI SIBHP: 0 PSI BDW: 0 MIN

LUBRICATE IN TWC. N/D FRAC STACK. N/U BOP. R/U RIG FLOOR. CHANGE OVER TO 2-3/8" HANDLING TOOLS. FUNCTION TEST BOP (GOOD).

R/U WELLCHECK. PRESSURE TEST PIPE RAMS AND BLIND RAMS. 250 PSI LOW FOR 5 MINUTES AND 2500 PSI HIGH FOR 10 MINUTES. TEST CHARTED. R/D WELLCHECK.

P/U 3-7/8" JUNK MILL. TALLY AND P/U 2-3/8" N-80 TUBING TO 2680'.

R/U HEC AIR UNIT. PT LINES (GOOD).

CONTINUE TO TALLY AND P/U 2-3/8" N-80 TUBING. TAG PLUG #1 AT 4300' (NO FILL).

P/U SWIVEL. R/U SWIVEL.

EST CIRC W/ AIR/FOAM UNIT. 1350 CFM & 13 BBL/HR WATER. 1 GAL/HR SOAP & 1 GAL/HR INHIBITOR. **DRILL PLUG #1 (CBP) AT 4300'**. EXTRA TIME TAKEN DUE TO PRESSURES.

CIRC WELL CLEAN. PUMP SWEEPS. KILL TUBING. RACK BACK SWIVEL. LEAVE EOT @ 4300'. TOP PERF @ 4436'.

SHUT IN WELL. SECURED LOCATION. DEBRIEFED CREW. SDFN.

CREW TRAVEL HOME.

Report Number
6Report Start Date
4/3/2025Report End Date
4/3/2025

Operation

CREW TRAVEL TO LOCATION.

HELD PRE JOB SAFETY MEETING. BDW. WAIT FOR WIND DIRECTION TO CHANGE SITP: 0 PSI SICP: 1300 PSI SIICP: 0 PSI SIBHP: 0 PSI BDW: 30 MIN

TIH W/ TUBING. TAG FILL ON TOP OF PLUG #2 AT 4742' (6' FILL, 1'). R/U POWER SWIVEL.

KI AIR. EST CIRC W/ AIR/FOAM UNIT. WITH 1350 CFM & 13 BBL/HR WATER. 1 GAL/HR SOAP & 1.5 GAL/HR INHIBITOR. C/O PLUG PARTS AND SAND FROM 4742' TO 4748'. **MILL PLUG #2 (CBP) AT 4748'**.

CIRCULATE WELL CLEAN. PUMP SWEEPS. KILL TBG RACK BACK POWER SWIVEL.

TALLY AND P/U TUBING. TAG FILL AT 4985' (165' FILL). P/U POWER SWIVEL. KI AIR. EST CIRC W/ AIR/FOAM UNIT. WITH 1350 CFM & 13 BBL/HR WATER. 1 GAL/HR SOAP & 1.5 GAL/HR INHIBITOR. C/O PLUG PARTS AND SAND FROM 54985' TO 5139' (11' FILL). BOTTOM MV PERFS AT 5079'. WELL MAKING HEAVY SAND.

CIRCULATE WELL CLEAN. PUMP SWEEPS. SAND DOWN TO TRACE. BLOW WELL DRY. RACK BACK POWER SWIVEL.

TOOH W/ TUBING TO ABOVE TOP PERF. EOT AT 4174'.

SHUT IN WELL. SECURED LOCATION. DEBRIEFED CREW. SDFN. CREW TRAVELED HOME.



Well Operations Summary L48

Well Name: CALLOWAY 2M

| | | |
|--------------------------|-------------------------|------------------------------|
| API: 3004538406 | Field: Blanco Mesaverde | State: NEW MEXICO |
| Permit to Drill (PTD) #: | Sundry #: | Rig/Service: MESA PRODUCTION |

Jobs

Actual Start Date: 3/25/2025 End Date: 4/9/2025

| | | |
|--------------------|-------------------------------|-----------------------------|
| Report Number 8 | Report Start Date 4/7/2025 | Report End Date 4/7/2025 |
|--------------------|-------------------------------|-----------------------------|

Operation

CREW TRAVELED TO LOCATION.
HELD PRE JOB SAFETY MEETING.
TIH WITH TUBING FROM DERRICK.
P/U TUBING. TAGGED FILL AT 5115' (35' OF FILL). P/U POWER SWIVEL.
KI AIR/MIST AND ESTABLISH CIRCULATION W/ 1200 CFM, 14 BBLS/HR WATER, 1 GAL/10 BBL SOAP,1 GAL/10 BBLS CI.
C/O FILL FROM 5115' TO PLUG AT 5150'. **DO CBP AT 5150'**. L/D POWER SWIVEL.
P/U TUBING. TAGGED FILL AT 7027' (102' OF FILL).
TOH WITH 42 STANDS TO ABOVE PERFS. EOT AT 4366'.
SHUT IN WELL. SECURED LOCATION. DEBRIEFED CREW. SDFN.
CREW TRAVELED HOME.

| | | |
|--------------------|-------------------------------|-----------------------------|
| Report Number 9 | Report Start Date 4/8/2025 | Report End Date 4/8/2025 |
|--------------------|-------------------------------|-----------------------------|

Operation

CREW TRAVELED TO LOCATION.
HELD PRE JOB SAFETY MEETING. CHECK WELL PRESSURES. BDW IN 30 MIN.
SITP: 0 PSI
SICP: 1000 PSI
SIICP: 0 PSI
SIBHP: 0 PSI
TAGGED FILL AT 7002' (127' OF FILL, 25' OF ADDITIONAL FILL). FILL WAS STICKY AND HAD TO PULL OUT OF IT. L/D TAG JOINT.
P/U POWER SWIVEL. KI AIR MIST. EST CIRC. C/O FILL FROM 7002' TO PBTD OF 7,129'. WELL WAS MAKING HEAVY SAND AND HAD CIRCULATE CLEAR SEVERAL TIMES. CIRC PRESSURE STAYED AROUND 1,400 PSI. CIRCULATE ON BOTTOM.
CUT AIR, PUMP TBG KILL, HANG BACL PWR SWVL, AND TOO. PUMPED CASING KILL WITH 10 STANDS OUT. L/D JUNK MILL.
M/U MULE SHOE WITH EXPENDABLE CHECK BHA AND TIH WITH 139 JOINTS OF PRODUCTION TUBING. EOT AT 4402'.
SHUT IN WELL. SECURED LOCATION. DEBRIEFED CREW. SDFN.
CREW TRAVELED HOME.

| | | |
|---------------------|-------------------------------|-----------------------------|
| Report Number 10 | Report Start Date 4/9/2025 | Report End Date 4/9/2025 |
|---------------------|-------------------------------|-----------------------------|

Operation

CREW TRAVEL TO LOCATION.
HELD PJSM WITH RIG CREW ON TODAY'S OPERATIONS. BDW.
SITP: 0 PSI
SICP: 950 PSI
SIICP: 0 PSI
SIBHP: 0 PSI
BDW: 30 MIN
TIH WITH REMAINING TUBING IN DERRICK (DRIFTING).
P/U TUBING HANGER. LAND TUBING AS FOLLOWS:

TUBING HANGER
213 - 2 3/8 EUE 4.7# 8RD L-80 YELLOW BAND (6744.03')
1 - 2-3/8" L-80 PUP JOINT (2.10')
1 - 2 3/8 EUE 4.7# 8RD L-80 YELLOW BAND (32.10')
1 - EXPENDABLE CHECK

PBTD - 7129'
EOT - 6797.03'
KB - 17'

L/D POWER SWIVEL. R/D FLOOR. NIPPLE DOWN BOP. NIPPLE UP WELLHEAD.
PUMP 5 GAL INHIBITOR AND 8 BBLS DOWN TUBING. DROP BALL. PRESSURE TEST TUBING WITH AIR TO 500 PSI (GOOD). PUMP OFF CHECK AT 1000 PSI. UNLOAD WELL.
RIG DOWN RIG AND EQUIPMENT. R/D AIR UNIT. PREP FOR RIG MOVE. MOVE OFF RIG. **RIG RELEASED TO THE KESSLER COM #3 AT 12:00 ON 4/9/2025.**
JOB COMPLETE.

| | | |
|---------------|--|--|
| Report Number | | |
|---------------|--|--|



Current Schematic - Version 3

Well Name: CALLOWAY 2M

| | | | | | |
|-----------------------------------|---|-------------------------------------|------------------------------------|--------------------------------|--|
| API / UWI 3004538406 | Surface Legal Location SENE-34-31N-11W | Field Name Blanco Mesaverde | Route | State/Province NEW MEXICO | Well Configuration Type Directional |
| Ground Elevation (ft) 5,659.00 | Original KB/RT Elevation (ft) | Tubing Hanger Elevation (ft) | RKB to GL (ft) | KB-Casing Flange Distance (ft) | KB-Tubing Hanger Distance (ft) |
| Tubing Strings | | | | | |
| Run Date 4/9/2025 00:00 | Set Depth (ftKB) 6,797.03 | String Max Nominal OD (in) 2 3/8 | String Min Nominal ID (in) 2.00 | Weight/Length (lb/ft) 4.70 | Original Spud Date 3/5/2025 23:30 |

Sidetrack 1 [Directional]

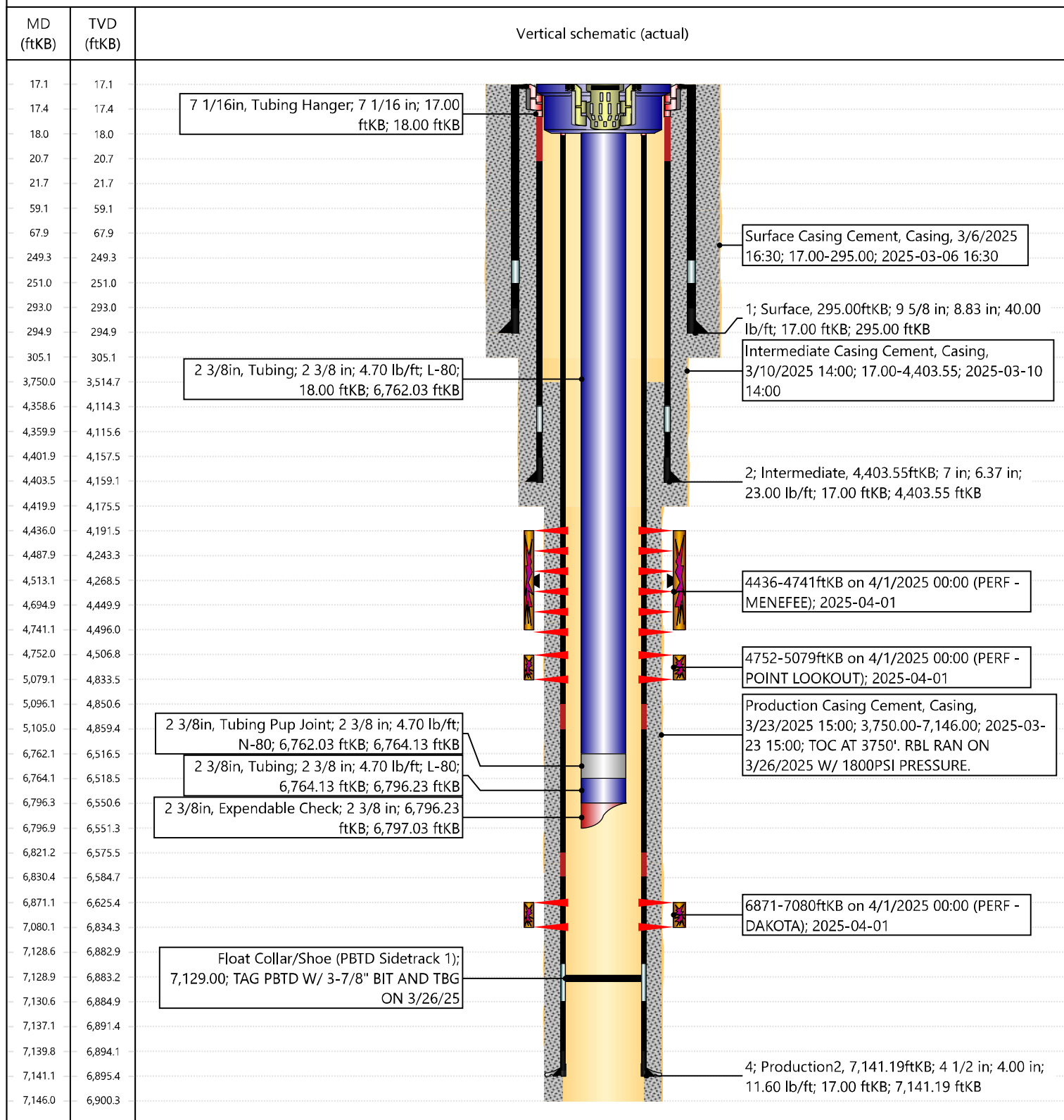

Sante Fe Main Office
Phone: (505) 476-3441

General Information
Phone: (505) 629-6116

Online Phone Directory
<https://www.emnrd.nm.gov/ocd/contact-us>

State of New Mexico
Energy, Minerals and Natural Resources
Oil Conservation Division
1220 S. St Francis Dr.
Santa Fe, NM 87505

ACKNOWLEDGMENTS

Action 456889

ACKNOWLEDGMENTS

| | |
|--|--|
| Operator: HILCORP ENERGY COMPANY 1111 Travis Street Houston, TX 77002 | OGRID: 372171 |
| | Action Number: 456889 |
| | Action Type: [C-104] Completion Packet - New Well (C-104NW) |

ACKNOWLEDGMENTS

| | |
|-------------------------------------|--|
| <input checked="" type="checkbox"/> | I hereby certify that the required Water Use Report has been, or will be, submitted for this wells completion. |
| <input checked="" type="checkbox"/> | I hereby certify that the required FracFocus disclosure has been, or will be, submitted for this wells completion. |
| <input checked="" type="checkbox"/> | I hereby certify that the rules of the Oil Conservation Division have been complied with and that the information given above is true and complete to the best of my knowledge and belief. |

Sante Fe Main Office
Phone: (505) 476-3441

General Information
Phone: (505) 629-6116

Online Phone Directory
<https://www.emnrd.nm.gov/oed/contact-us>

State of New Mexico
Energy, Minerals and Natural Resources
Oil Conservation Division
1220 S. St Francis Dr.
Santa Fe, NM 87505

CONDITIONS

Action 456889

CONDITIONS

| | |
|--|--|
| Operator: HILCORP ENERGY COMPANY 1111 Travis Street Houston, TX 77002 | OGRID: 372171 |
| | Action Number: 456889 |
| | Action Type: [C-104] Completion Packet - New Well (C-104NW) |

CONDITIONS

| Created By | Condition | Condition Date |
|------------|-----------|----------------|
| plmartinez | None | 5/19/2025 |