



Well Name: KR	Well Location: T27N / R13W / SEC 20 / SWSW / 36.55554 / -108.24814	County or Parish/State: SAN JUAN / NM
Well Number: 4	Type of Well: CONVENTIONAL GAS WELL	Allottee or Tribe Name:
Lease Number: NMNM11580	Unit or CA Name:	Unit or CA Number:
US Well Number: 300452269400C1	Operator: DUGAN PRODUCTION CORPORATION	

Operator

I certify that the foregoing is true and correct. Title 18 U.S.C. Section 1001 and Title 43 U.S.C. Section 1212, make it a crime for any person knowingly and willfully to make to any department or agency of the United States any false, fictitious or fraudulent statements or representations as to any matter within its jurisdiction. Electronic submission of Sundry Notices through this system satisfies regulations requiring a

Operator Electronic Signature: TYRA FEIL	Signed on: JAN 02, 2026 03:50 PM
Name: DUGAN PRODUCTION CORPORATION	
Title: Authorized Representative	
Street Address: PO BOX 420	
City: FARMINGTON	State: NM
Phone: (505) 325-1821	
Email address: TYRAFEIL@DUGANPRODUCTION.COM	

Field

Representative Name: Aliph Reena		
Street Address: PO Box 420		
City: Farmington	State: NM	Zip: 87499-0420
Phone: (505)360-9192		
Email address: Aliph.Reena@duganproduction.com		

BLM Point of Contact

BLM POC Name: KENNETH G RENNICK	BLM POC Title: Petroleum Engineer
BLM POC Phone: 5055647742	BLM POC Email Address: krennick@blm.gov
Disposition: Accepted	Disposition Date: 01/12/2026
Signature: Kenneth Rennick	

Dugan Production plugged and abandoned the **KR 4** from **12-19-2025 to 12-21-2025** per the following procedure.

- MI&RU Aztec Well Service Rig 450. Spot in and RU cement equipment.
- Check pressures: Tubing 50 psi, Casing 68 psi, BH N/A psi.
- Pull and LD production tubing.
- PU & tally work string run 2-7/8" string mill to scrape csg to 1323'.
- Attempt to establish injection rate, pressured up to 650 psi. No injection rate.
- MI&RU WL. RIH w/wireline, set 2-7/8" CIBP at 1285'. **Pictured Cliffs perforations @ 1324'-1334'.**
- Load and circulate hole clean with 8 bbls of water.
- **Pressure test casing to 650 psi for 30 minutes. Good test.**
- Run CBL from 1285' to surface. Sent copy of CBL to NMOCD. Copy of communications attached.
- **Plug I, Pictured Cliffs-Fruitland-Kirtland-Surface Casing-Surface:** Spot Plug I inside 2-7/8" casing above CIBP @ 1285' to surface w/46 sks (52.9 cu ft) Class G neat cement to cover the Pictured Cliffs, Fruitland- Kirtland tops, surface casing shoe & surface casing. No displacement. WOC 4 hrs. MI&RU welder, cut wellhead off. Tagged TOC at 0' inside, 0' annulus. **Plug I, Spot Inside 2-7/8" casing, CIBP at 1285', 46 sks, 52.9 cu ft, Pictured Cliffs-Fruitland- Kirtland-Surface Casing shoe to Surface, 0'-1285'.**
- Install dry hole marker (below grade plate) (cement at surface on both ends) No cement needed.
- RD Aztec Well Service Rig 450. Clean location, move.
- Jimmy Dobson with BLM witnessed the job.
- Photos of P&A marker and GPS coordinates attached per NMOCD COA.
- **Well P&A'd on 12/21/2025.**

**Completed P & A Wellbore Schematic**

K R #4

30-045-22694

Basin Fruitland Coal/Waw FR Sand PC

790' FSL & 790' FWL

M-S20-T27N-R13W

San Juan County, NM

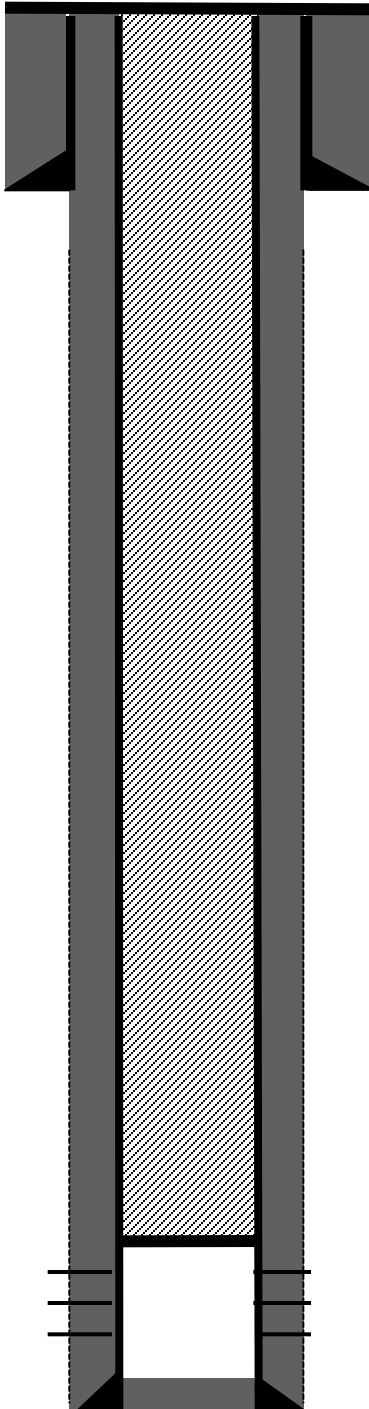

**5-1/2" 14#, 8r casing @ 44': Hole size - 7-7/8"**  
Cemented with 6 sks.

**Plug I, Spot Inside 2-7/8" casing, CIBP at 1285', 46 sks, 52.9 cu ft, Pictured Cliffs-Fruitland- Kirtland-Surface Casing shoe to Surface, 0'-1285'.**

**2-7/8" 6.4#, NEUE casing @ 1445'. Hole size: 4-3/4"**  
Cement w/ 90 sx 2% Lodense w/1/4# cello flake/sk. Followed by 50 sx class B w/1/4# celloflake /sx. Cement circulated.

Pictured Cliffs Perforated @ 1324' – 1334'

PBTD @ 1402', TD 1450'

**K R #4**

30-045-22694

Basin Fruitland Coal/Waw FR Sand PC

790' FSL & 790' FWL

M-S20-T27N-R13W

San Juan County, NM

**Formation Tops (Referenced for the P &A)**

- Surface Casing - 44'
- Kirtland - 65'
- Fruitland - 1170'
- Perforations - 1324'-1334'
- Pictured Cliffs - 1340'

## Tyra Feil

---

**From:** Diede, Loren, EMNRD <Loren.Diede@emnrd.nm.gov>  
**Sent:** Monday, December 22, 2025 1:40 PM  
**To:** Rennick, Kenneth G; Alex Robles; Aliph Reena  
**Cc:** Smith, Clarence, EMNRD; Lucero, Virgil S; Garcia, John, EMNRD; Vermersch, Thomas, EMNRD; Durham, John, EMNRD; Indalecio Roldan; Tyra Feil; Omar Ramirez; Dobson, Jimmie P  
**Subject:** Re: [EXTERNAL] dugan\_kr\_4\_cbl.pdf

NMOCD agrees with BLM.

Thank you,  
Loren Diede  
Senior Petroleum Specialist  
Engineering Special Projects  
Oil Conservation Division  
1220 South St. Francis Drive  
Santa Fe, New Mexico 87505  
505-394-3582 OCD cell



---

**From:** Rennick, Kenneth G <krennick@blm.gov>  
**Sent:** Monday, December 22, 2025 11:53 AM  
**To:** Alex Robles <aarobles@aztecwell.com>; Aliph Reena <aliph.reena@duganproduction.com>  
**Cc:** Diede, Loren, EMNRD <Loren.Diede@emnrd.nm.gov>; Smith, Clarence, EMNRD <Clarence.Smith@emnrd.nm.gov>; Lucero, Virgil S <vlucero@blm.gov>; Garcia, John, EMNRD <JohnA.Garcia@emnrd.nm.gov>; Vermersch, Thomas, EMNRD <Thomas.Vermersch@emnrd.nm.gov>; Durham, John, EMNRD <john.durham@emnrd.nm.gov>; Indalecio Roldan <indalecio.rolدان@duganproduction.com>; Tyra Feil <tyra.feil@duganproduction.com>; Omar Ramirez <oramirez@aztecwell.com>; Dobson, Jimmie P <jdobson@blm.gov>  
**Subject:** Re: [EXTERNAL] dugan\_kr\_4\_cbl.pdf

The BLM finds that appropriate.

Kenneth (Kenny) Rennick

Petroleum Engineer

Bureau of Land Management  
Farmington Field Office  
6251 College Blvd  
Farmington, NM 87402

Email: [krennick@blm.gov](mailto:krennick@blm.gov)  
Mobile & Text: 505.497.0019

---

**From:** Alex Robles <arobles@aztecwell.com>  
**Sent:** Monday, December 22, 2025 10:50 AM  
**To:** Aliph Reena <aliph.reena@duganproduction.com>  
**Cc:** Diede Loren EMNRD <loren.diede@emnrd.nm.gov>; Smith, Clarence, EMNRD <clarence.smith@emnrd.nm.gov>; Lucero, Virgil S <vlucero@blm.gov>; Rennick, Kenneth G <krennick@blm.gov>; Garcia John EMNRD <johna.garcia@emnrd.nm.gov>; Vermersch, Thomas, EMNRD <thomas.vermersch@emnrd.nm.gov>; Durham, John, EMNRD <john.durham@emnrd.nm.gov>; Indalecio Roldan <indalecio.rolan@duganproduction.com>; Tyra Feil <tyra.feil@duganproduction.com>; Omar Ramirez <oramirez@aztecwell.com>; Dobson, Jimmie P <jdobson@blm.gov>  
**Subject:** [EXTERNAL] dugan\_kr\_4\_cbl.pdf

**This email has been received from outside of DOI - Use caution before clicking on links, opening attachments, or responding.**

Good morning all.

TOC on KR#4 appears to be all the way to surface will continue to fill up as proposed on the original approved NOI.

Alex Prieto  
Rig Manager – San Juan Basin  
Aztec Well Servicing Co.  
P.O. Box 100  
Aztec, New Mexico 87410  
Cell: 505-419-9882  
Office: 505-334-6191  
[Arobles@aztecwell.com](mailto:Arobles@aztecwell.com)



CAUTION: This email originated from outside your organization. Exercise caution.











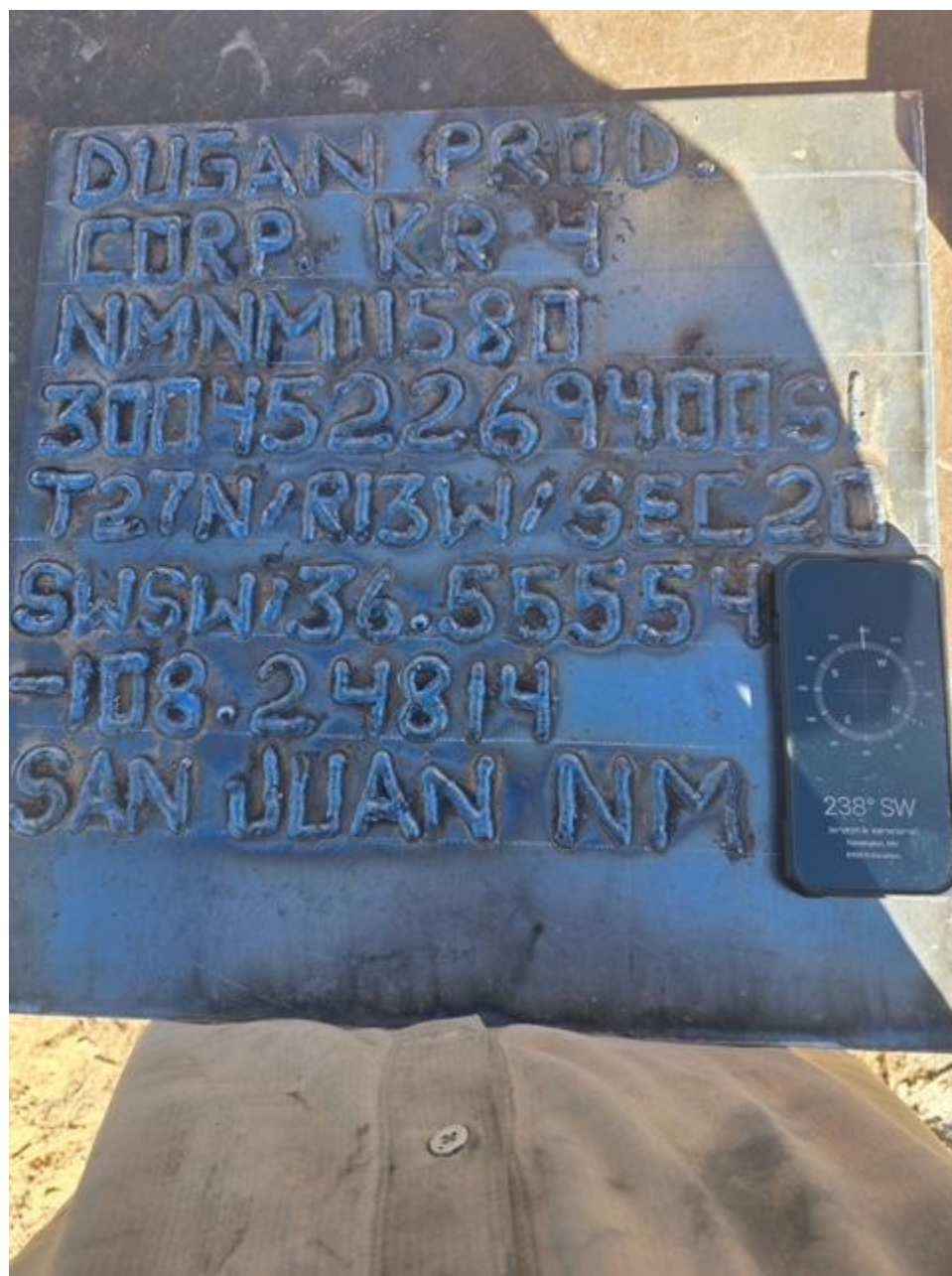





Sante Fe Main Office  
Phone: (505) 476-3441

General Information  
Phone: (505) 629-6116

Online Phone Directory  
<https://www.emnrd.nm.gov/ocd/contact-us>

State of New Mexico  
Energy, Minerals and Natural Resources  
Oil Conservation Division  
1220 S. St Francis Dr.  
Santa Fe, NM 87505

CONDITIONS

Action 542133

CONDITIONS

Operator: DUGAN PRODUCTION CORP PO Box 420 Farmington, NM 87499	OGRID: 6515
	Action Number: 542133
	Action Type: [C-103] Sub. Plugging (C-103P)

CONDITIONS

Created By	Condition	Condition Date
loren.diede	None	1/13/2026