

Well Name: FEDERAL I	Well Location: T29N / R14W / SEC 1 / LOT 2 / 36.760101 / -108.258256	County or Parish/State: SAN JUAN / NM
Well Number: 100	Type of Well: OTHER	Allottee or Tribe Name:
Lease Number: NMSF078110	Unit or CA Name:	Unit or CA Number:
US Well Number: 300452999100S1	Operator: DUGAN PRODUCTION CORPORATION	

Subsequent Report

Sundry ID: 2888907

Type of Submission: Subsequent Report	Type of Action: Plug and Abandonment
Date Sundry Submitted: 12/31/2025	Time Sundry Submitted: 08:43
Date Operation Actually Began: 10/22/2025	

Actual Procedure: Dugan Production plugged and abandoned the well from 10/22/2025 to 10/23/2025 per the attached procedure.

SR Attachments

Actual Procedure

- Federal\_I\_100\_gps\_marker\_20251231084138.pdf
- Federal\_I\_100\_BLM\_OCD\_plug\_comms\_20251231084124.pdf
- Federal\_I\_100\_SR\_PA\_formation\_tops\_20251231083840.pdf
- Federal\_I\_100\_SR\_PA\_completed\_wellbore\_schematic\_20251231083833.pdf
- Federal\_I\_100\_SR\_PA\_completed\_work\_20251231083823.pdf

Well Name: FEDERAL I	Well Location: T29N / R14W / SEC 1 / LOT 2 / 36.760101 / -108.258256	County or Parish/State: SAN JUAN / NM
Well Number: 100	Type of Well: OTHER	Allottee or Tribe Name:
Lease Number: NMSF078110	Unit or CA Name:	Unit or CA Number:
US Well Number: 300452999100S1	Operator: DUGAN PRODUCTION CORPORATION	

Operator

I certify that the foregoing is true and correct. Title 18 U.S.C. Section 1001 and Title 43 U.S.C. Section 1212, make it a crime for any person knowingly and willfully to make to any department or agency of the United States any false, fictitious or fraudulent statements or representations as to any matter within its jurisdiction. Electronic submission of Sundry Notices through this system satisfies regulations requiring a

Operator Electronic Signature: TYRA FEIL	Signed on: DEC 31, 2025 08:38 AM
Name: DUGAN PRODUCTION CORPORATION	
Title: Authorized Representative	
Street Address: PO BOX 420	
City: FARMINGTON	State: NM
Phone: (505) 325-1821	
Email address: TYRAFEIL@DUGANPRODUCTION.COM	

Field

Representative Name: Aliph Reena		
Street Address: PO Box 420		
City: Farmington	State: NM	Zip: 87499-0420
Phone: (505)360-9192		
Email address: Aliph.Reena@duganproduction.com		

BLM Point of Contact

BLM POC Name: KENNETH G RENNICK	BLM POC Title: Petroleum Engineer
BLM POC Phone: 5055647742	BLM POC Email Address: krennick@blm.gov
Disposition: Accepted	Disposition Date: 01/12/2026
Signature: Kenneth Rennick	

Dugan Production plugged and abandoned the Federal I 100 from **10/22/2025 to 10/23/2025** per the following procedure.

- MI & RU Aztec Well Service Rig 450. Spot in and RU cement equipment.
- Check pressures: Tubing 0 psi, Casing 30 psi, BH 0 psi.
- Pull and LD rods, and production tubing.
- PU & Tally 2-3/8" work string. Run 4½" string mill to scrape casing to 1128'.
- RIH & set 4½" cement retainer to 1067'. Fruitland perforations @ 1117'-1233'.
- Load and circulate hole clean with 20 bbls of water.
- Establish injection rate: 1.5 bbls/min at 200 psi.
- **Pressure test casing to 650 psi for 30 minutes, Good test.**
- Check pressures: Tubing 0 psi, Casing 0 psi, BH 0 psi.
- Run CBL from 1067' to surface. Sent copy of CBL to NMOCD. Copy of communications attached.
- **Plug I, Pictured Cliffs-Fruitland-Kirtland-Surface:** Sting in the cement retainer. Squeeze 20 sks, 23 cu ft Class G neat cement to cover the Pictured Cliffs below the retainer till top perforation. Displaced with 4.1 bbls of water. Sting out. Spot Inside 4½" casing above cement retainer @ 1067' w/95 sks (109.25 cu ft) Class G neat cement to cover the Pictured Cliffs, Fruitland, Kirtland tops & Surface casing shoe to surface (5 gal/sk, 15.8 #/gal, 1.15 cu ft/sk). No displacement. WOC 4 hrs. RU welder. Cut wellhead off. Tagged TOC at 40' inside, 40' annulus. Good tag. **Plug I, Inside 4½" casing, cement retainer at 1067', 115 sks, 132.25 cu ft, Pictured Cliffs-Fruitland-Kirtland-surface casing shoe, 0'-1117'.**
- Fill cellar and install DHM with 42 sks, 48.3 cu ft, Class G neat cement.
- RD Aztec Well Service Rig 450. Clean location, move.
- Monty Gomez with BLM witnessed the job.
- Photos of P & A marker and GPS coordinates attached per NMOCD COA.
- **Well P&A'd on 10/23/2025.**

**Completed P & A Wellbore Schematic**

Federal I # 100

30-045-29991

Basin Fruitland Coal

950' FNL & 1835' FEL

B-S1-T29N-R14W

San Juan County, NM

Lat: 36.7600975, Long: -108.2581863

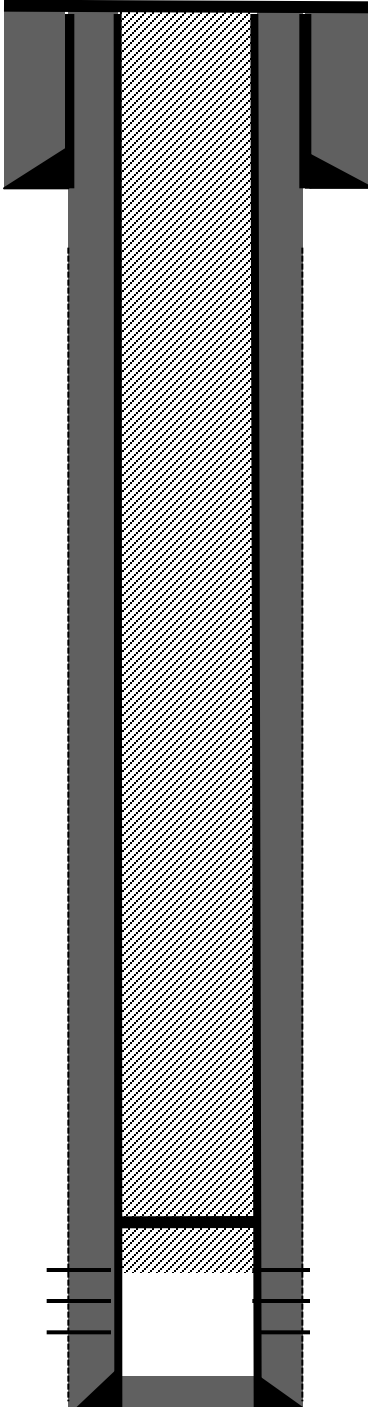

7" 20# J-55 casing @ 123' Hole size 9"

Cemented w/ 70.8 Cu.ft Class B. Circ 3 bbls cement to surface

4 ½" 10.5# J-55 casing @ 1340', Hole size 6-1/4"

Cemented w/ 75 sks Lodense, tailed w/ 75 sks Class B  
(Total 242 Cu.ft) Circ 7 bbls cement

Set 4 ½" CR @ 1067'. Squeeze 20 sks, 23 Cu.ft cement to  
cover the Pictured cliffs top below the retainer till top perf.

Plug I, Inside 4 ½" casing, Cement Retainer at 1067', 115 sks,  
132.25 Cu.ft, Pictured Cliffs-Fruitland-Kirtland-Surface Casing  
shoe, 0'-1117'.

Fruitland Perforated @ 1117' – 1233'

PBTD at 1312', TD at 1350'

**Federal I # 100**  
30-045-29991  
Basin Fruitland Coal  
950' FNL & 1835' FEL  
B-S1-T29N-R14W  
San Juan County, NM  
Lat: 36.7600975, Long: -108.2581863

**Formation Tops (Referenced for the P & A)**

- **Kirtland – Surface**
- **Surface Casing – 123'**
- **Fruitland – 910'**
- **Perforations – 1117'-1233'**
- **Pictured Cliffs – 1235'**

## Tyra Feil

---

**From:** Omar Ramirez <oramirez@aztecwell.com>  
**Sent:** Thursday, October 23, 2025 11:33 AM  
**To:** Diede, Loren, EMNRD; Vermersch, Thomas, EMNRD; Durham, John, EMNRD; Smith, Clarence, EMNRD; Aliph Reena; vlucero@blm.gov; Gomez, Monty J  
**Cc:** Tyra Feil; Indalecio Roldan; Alex Robles  
**Subject:** Dugan Federal I #100 CBL  
**Attachments:** dugan\_federal\_I\_#100\_cbl.pdf; Federal I #100 BLM-OCD apvd NOI P&A.pdf

Revised proposal post CBL  
Dugan Production Corp.  
Federal I #100  
API: 30-045-29991

Please see CBL attached

It appears from looking at the CBL TOC is at around 70'... We request to follow original procedure and fill up with 1" poly line after cutoff.

Omar Ramirez  
Rig Manager – San Juan Basin  
Aztec Well Servicing Co.  
P.O. Box 100  
Aztec, New Mexico 87410  
Cell: 505-486-1828  
505-402-6753  
Office: 505-334-6191  
[Oramirez@aztecwell.com](mailto:Oramirez@aztecwell.com)



CAUTION: This email originated from outside your organization. Exercise caution.



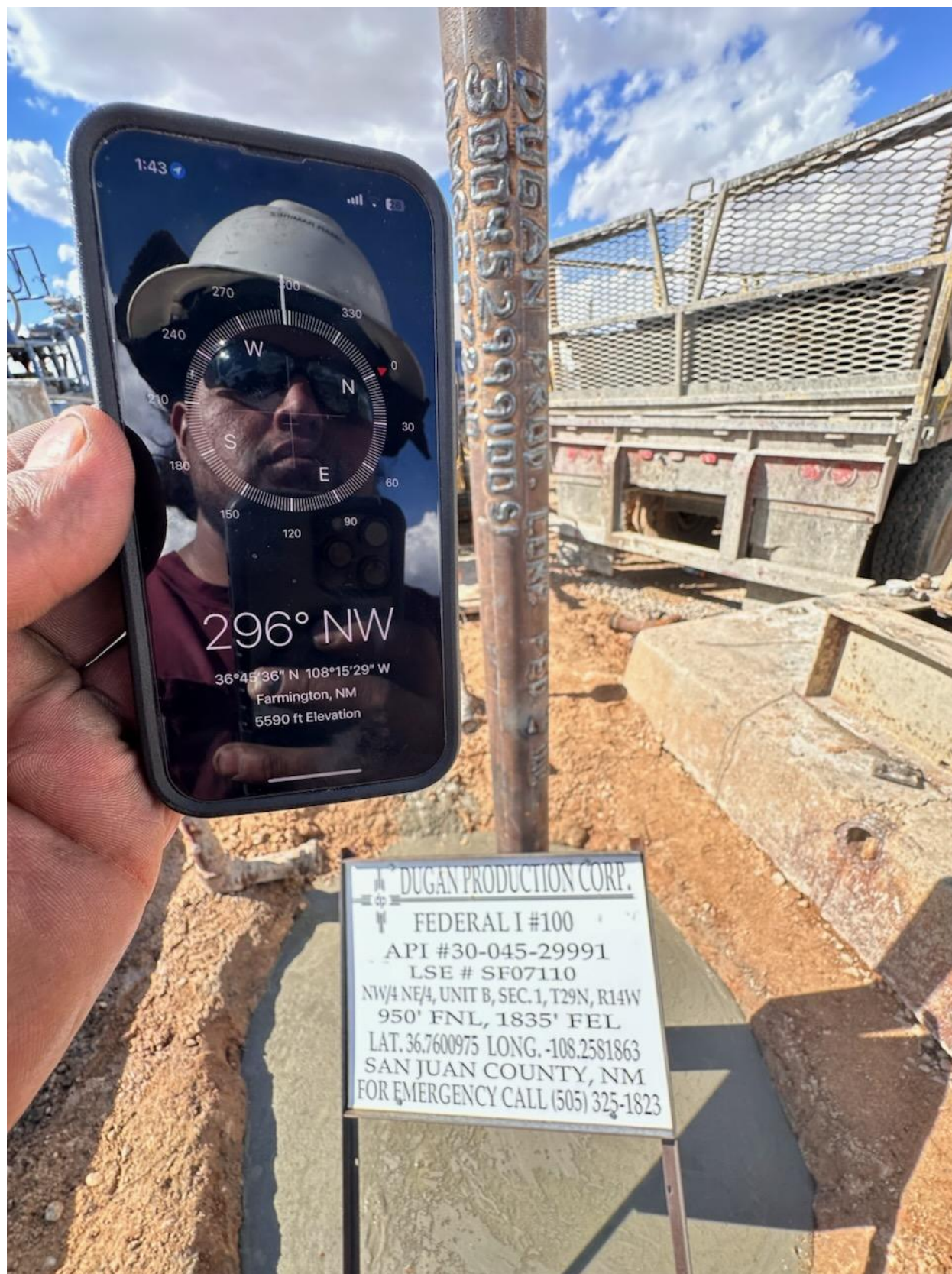









Sante Fe Main Office  
Phone: (505) 476-3441

General Information  
Phone: (505) 629-6116

Online Phone Directory  
<https://www.emnrd.nm.gov/ocd/contact-us>

State of New Mexico  
Energy, Minerals and Natural Resources  
Oil Conservation Division  
1220 S. St Francis Dr.  
Santa Fe, NM 87505

CONDITIONS

Action 542016

CONDITIONS

Operator: DUGAN PRODUCTION CORP PO Box 420 Farmington, NM 87499	OGRID: 6515
	Action Number: 542016
	Action Type: [C-103] Sub. Plugging (C-103P)

CONDITIONS

Created By	Condition	Condition Date
loren.diede	None	1/13/2026