

Well Name: EL PASO 14 FEDERAL	Well Location: T26S / R30E / SEC 14 / NESW / 32.0405558 / -103.8544985	County or Parish/State: EDDY / NM
Well Number: 1H	Type of Well: CONVENTIONAL GAS WELL	Allottee or Tribe Name:
Lease Number: NMNM93207	Unit or CA Name: 1 EL PASO 14 FED	Unit or CA Number: NMNM101359
US Well Number: 3001530278	Operator: EOG RESOURCES INCORPORATED	

Notice of Intent

Sundry ID: 2881790

Type of Submission: Notice of Intent

Type of Action: Plug and Abandonment

Date Sundry Submitted: 11/06/2025

Time Sundry Submitted: 03:44

Date proposed operation will begin: 11/20/2025

Procedure Description: EOG PROPOSES TO P&A THIS WELLBORE USING THE ATTACHED PROCEDURE.CURRENT AND PROPOSED WELLBORE SCHEMATICS ATTACHED.

Surface Disturbance

Is any additional surface disturbance proposed?: No

NOI Attachments

Procedure Description

El_Paso_14_Fed_1_Proposed_PA_Prog___WBD_20251106154447.pdf

Well Name: EL PASO 14 FEDERAL

Well Location: T26S / R30E / SEC 14 /
NESW / 32.0405558 / -103.8544985

County or Parish/State: EDDY /
NM

Well Number: 1H

Type of Well: CONVENTIONAL GAS
WELL

Allottee or Tribe Name:

Lease Number: NMNM93207

Unit or CA Name: 1 EL PASO 14 FED

Unit or CA Number:
NMNM101359

US Well Number: 3001530278

Operator: EOG RESOURCES
INCORPORATED

Conditions of Approval

Specialist Review

El_Paso_14_Federal_Com_1_Sundry_ID_2881790_P_A_20260208091038.pdf

Operator

I certify that the foregoing is true and correct. Title 18 U.S.C. Section 1001 and Title 43 U.S.C. Section 1212, make it a crime for any person knowingly and willfully to make to any department or agency of the United States any false, fictitious or fraudulent statements or representations as to any matter within its jurisdiction. Electronic submission of Sundry Notices through this system satisfies regulations requiring a

Operator Electronic Signature: KRISTINA AGEE

Signed on: NOV 06, 2025 03:44 PM

Name: EOG RESOURCES INCORPORATED

Title: Senior Regulatory Administrator

Street Address: 5509 Champions Dr.

City: Midland

State: TX

Phone: (432) 686-6996

Email address: KRISTINA_AGEE@EOGRESOURCES.COM

Field

Representative Name:

Street Address:

City:

State:

Zip:

Phone:

Email address:

BLM Point of Contact

BLM POC Name: LONG VO

BLM POC Title: Petroleum Engineer

BLM POC Phone: 5759885402

BLM POC Email Address: LVO@BLM.GOV

Disposition: Approved

Disposition Date: 02/08/2026

Signature: Long Vo

Form 3160-5
(October 2024)

UNITED STATES
DEPARTMENT OF THE INTERIOR
BUREAU OF LAND MANAGEMENT

FORM APPROVED
OMB No. 1004-0220
Expires: October 31, 2027

SUNDRY NOTICES AND REPORTS ON WELLS
Do not use this form for proposals to drill or to re-enter an abandoned well. Use Form 3160-3 (APD) for such proposals.

5. Lease Serial No.

6. If Indian, Allottee or Tribe Name

SUBMIT IN TRIPLICATE - Other instructions on page 2

7. If Unit of CA/Agreement, Name and/or No.

1. Type of Well

Oil Well Gas Well Other

8. Well Name and No.

2. Name of Operator

9. API Well No.

3a. Address

3b. Phone No. (include area code)

10. Field and Pool or Exploratory Area

4. Location of Well (Footage, Sec., T.,R.,M., or Survey Description)

11. Country or Parish, State

12. CHECK THE APPROPRIATE BOX(ES) TO INDICATE NATURE OF NOTICE, REPORT OR OTHER DATA

TYPE OF SUBMISSION	TYPE OF ACTION			
<input type="checkbox"/> Notice of Intent	<input type="checkbox"/> Acidize	<input type="checkbox"/> Deepen	<input type="checkbox"/> Production (Start/Resume)	<input type="checkbox"/> Water Shut-Off
<input type="checkbox"/> Subsequent Report	<input type="checkbox"/> Alter Casing	<input type="checkbox"/> Hydraulic Fracturing	<input type="checkbox"/> Reclamation	<input type="checkbox"/> Well Integrity
<input type="checkbox"/> Final Abandonment Notice	<input type="checkbox"/> Casing Repair	<input type="checkbox"/> New Construction	<input type="checkbox"/> Recomplete	<input type="checkbox"/> Other
	<input type="checkbox"/> Change Plans	<input type="checkbox"/> Plug and Abandon	<input type="checkbox"/> Temporarily Abandon	
	<input type="checkbox"/> Convert to Injection	<input type="checkbox"/> Plug Back	<input type="checkbox"/> Water Disposal	

13. Describe Proposed or Completed Operation: Clearly state all pertinent details, including estimated starting date of any proposed work and approximate duration thereof. If the proposal is to deepen directionally or recomplete horizontally, give subsurface locations and measured and true vertical depths of all pertinent markers and zones. Attach the Bond under which the work will be performed or provide the Bond No. on file with BLM/BIA. Required subsequent reports must be filed within 30 days following completion of the involved operations. If the operation results in a multiple completion or recompletion in a new interval, a Form 3160-4 must be filed once testing has been completed. Final Abandonment Notices must be filed only after all requirements, including reclamation, have been completed and the operator has determined that the site is ready for final inspection.)

14. I hereby certify that the foregoing is true and correct. Name (Printed/Typed)

Title

Signature

Date

THE SPACE FOR FEDERAL OR STATE OFFICE USE

Approved by

Title

Date

Conditions of approval, if any, are attached. Approval of this notice does not warrant or certify that the applicant holds legal or equitable title to those rights in the subject lease which would entitle the applicant to conduct operations thereon.

Office

Title 18 U.S.C Section 1001 and Title 43 U.S.C Section 1212, make it a crime for any person knowingly and willfully to make to any department or agency of the United States any false, fictitious or fraudulent statements or representations as to any matter within its jurisdiction.

(Instructions on page 2)

GENERAL INSTRUCTIONS

This form is designed for submitting proposals to perform certain well operations and reports of such operations when completed as indicated on Federal and Indian lands pursuant to applicable Federal law and regulations. Any necessary special instructions concerning the use of this form and the number of copies to be submitted, particularly with regard to local area or regional procedures and practices, are either shown below, will be issued by or may be obtained from the local Federal office.

SPECIFIC INSTRUCTIONS

Item 4 - Locations on Federal or Indian land should be described in accordance with Federal requirements. Consult the local Federal office for specific instructions.

Item 13: Proposals to abandon a well and subsequent reports of abandonment should include such special information as is required by the local Federal office. In addition, such proposals and reports should include reasons for the abandonment; data on any former or present productive zones or other zones with present significant fluid contents not sealed off by cement or otherwise; depths (top and bottom) and method of placement of cement plugs; mud or other material placed below, between and above plugs; amount, size, method of parting of any casing, liner or tubing pulled and the depth to the top of any tubing left in the hole; method of closing top of well and date well site conditioned for final inspection looking for approval of the abandonment. If the proposal will involve **hydraulic fracturing operations**, you must comply with 43 CFR 3162.3-3, including providing information about the protection of usable water. Operators should provide the best available information about all formations containing water and their depths. This information could include data and interpretation of resistivity logs run on nearby wells. Information may also be obtained from state or tribal regulatory agencies and from local BLM offices.

NOTICES

The privacy Act of 1974 and the regulation in 43 CFR 2.48(d) provide that you be furnished the following information in connection with information required by this application.

AUTHORITY: 30 U.S.C. 181 et seq., 351 et seq., 25 U.S.C. 396; 43 CFR 3160.

PRINCIPAL PURPOSE: The information is used to: (1) Evaluate, when appropriate, approve applications, and report completion of subsequent well operations, on a Federal or Indian lease; and (2) document for administrative use, information for the management, disposal and use of National Resource lands and resources, such as: (a) evaluating the equipment and procedures to be used during a proposed subsequent well operation and reviewing the completed well operations for compliance with the approved plan; (b) requesting and granting approval to perform those actions covered by 43 CFR 3162.3-2, 3162.3-3, and 3162.3-4; (c) reporting the beginning or resumption of production, as required by 43 CFR 3162.4-1(c) and (d) analyzing future applications to drill or modify operations in light of data obtained and methods used.

ROUTINE USES: Information from the record and/or the record will be transferred to appropriate Federal, State, local or foreign agencies, when relevant to civil, criminal or regulatory investigations or prosecutions in connection with congressional inquiries or to consumer reporting agencies to facilitate collection of debts owed the Government.

EFFECT OF NOT PROVIDING THE INFORMATION: Filing of this notice and report and disclosure of the information is mandatory for those subsequent well operations specified in 43 CFR 3162.3-2, 3162.3-3, 3162.3-4.

The Paperwork Reduction Act of 1995 requires us to inform you that:

The BLM collects this information to evaluate proposed and/or completed subsequent well operations on Federal or Indian oil and gas leases.

Response to this request is mandatory.

The BLM would like you to know that you do not have to respond to this or any other Federal agency-sponsored information collection unless it displays a currently valid OMB control number.

BURDEN HOURS STATEMENT: Public reporting burden for this form is estimated to average 8 hours per response, including the time for reviewing instructions, gathering and maintaining data, and completing and reviewing the form. Direct comments regarding the burden estimate or any other aspect of this form to U.S. Department of the Interior, Bureau of Land Management (1004-0137), Bureau Information Collection Clearance Officer (WO-630), 1849 C St., N.W., Mail Stop 401 LS, Washington, D.C. 20240

Additional Information

Location of Well

0. SHL: NESW / 1900 FSL / 1850 FWL / TWSP: 26S / RANGE: 30E / SECTION: 14 / LAT: 32.0405558 / LONG: -103.8544985 (TVD: 0 feet, MD: 0 feet)

BHL: SWSE / 930 FSL / 1759 FEL / TWSP: 26S / RANGE: 30E / SECTION: 14 / LAT: 0.0 / LONG: 0.0 (TVD: 0 feet, MD: 0 feet)

El Paso 14 Fed #1 P&A Procedure**AFE 187082**

Location: Sec. 14-26S-30E 1900 FSL & 1850 FWL
County: Eddy, NM
Lat/Long: 32.0405579,-103.8545685 NAD83
API #: 30-015-30278

Surface Casing: 13-3/8" 48# H-40 STC @ 400' Cmt w/ 365 sx "C" (circ)
Inter. Casing: 9-5/8" 36# K-55 LTC @ 3,680' Cmt Stage 1 w/ 875 sx "C", Cmt Stage 2 w/ 945 sxs "C" (circ)
Production Casing: 7" 26# P-110 LTC @ 11,800' Cmt Stage 1 w/ 725 sx "H", Cmt Stage 2 w/ 725 sx "H" (TOC @ 6,284)
Liner String: 4-1/2" 15.1# P-110 HDL Liner from 11,455' to 13,910' Cmt Stage 1 w/ 575 sx "C" (TOC @ 6,284)
Producing Interval: Wolfcamp perms - 12,610'-13,906'

Procedure

1. Notify Regulatory Agency 24 hours prior to commencing work.
2. MIRU Workover rig and any necessary safety equipment.
3. RU WL and free point the tubing and TIH with jet cutter and cut 2 7/8 tubing @ 11,430 ft .(The well has a permanent packer @11,440, which is set right next to a liner top (11,455'))
4. RU WL to make GR/JB run to 11,410'. RIH w/ CIBP and set CIBP at 11,400'.
5. Dump 25 sx of Class H cement on top of CIBP. WOC and TAG.
6. Spot 25 sx class H cement 8,223' – 8,174' (spacer plug to make less than 3000 ft between plug)
7. Spot 33 sx class H cement 7,624' – 7,447' (Bone Spring)
8. Spot 52 sx class C cement 7,050' – 6,730' (DV Tool)
9. Pick up, perf @3,730' and sqz 40 sx class C cement plug to 3,592'. WOC and TAG. (Shoe and Delaware)
10. Pick up, perf @2,030' and sqz 35 sx class C cement plug to 1,909'. WOC and TAG. (DV tool)
11. Pick up, perf @450' and sqz 31 sx class C cement plug to 345'. WOC and TAG. (shoe)
12. Pick up, perf @100' and sqz class C cement plug to surface. WOC Bubble Test.
13. Cut off WH 3' below surface; verify cement to surface & weld on P&A marker.
14. Cut off anchors 3' below surface and clean location.



El Paso 14 Federal #001

Current Wellbore Diagram

API: 30-015-30278
 LOCATION: Sec. 14-26S-30E 1900 FSL & 1850 FWL
 COUNTY: Eddy County, New Mexico
 LAT/LONG: 32.0405579,-103.8545685 NAD83

SPUD DATE: 7/31/1998
 KB: 3,161 GR

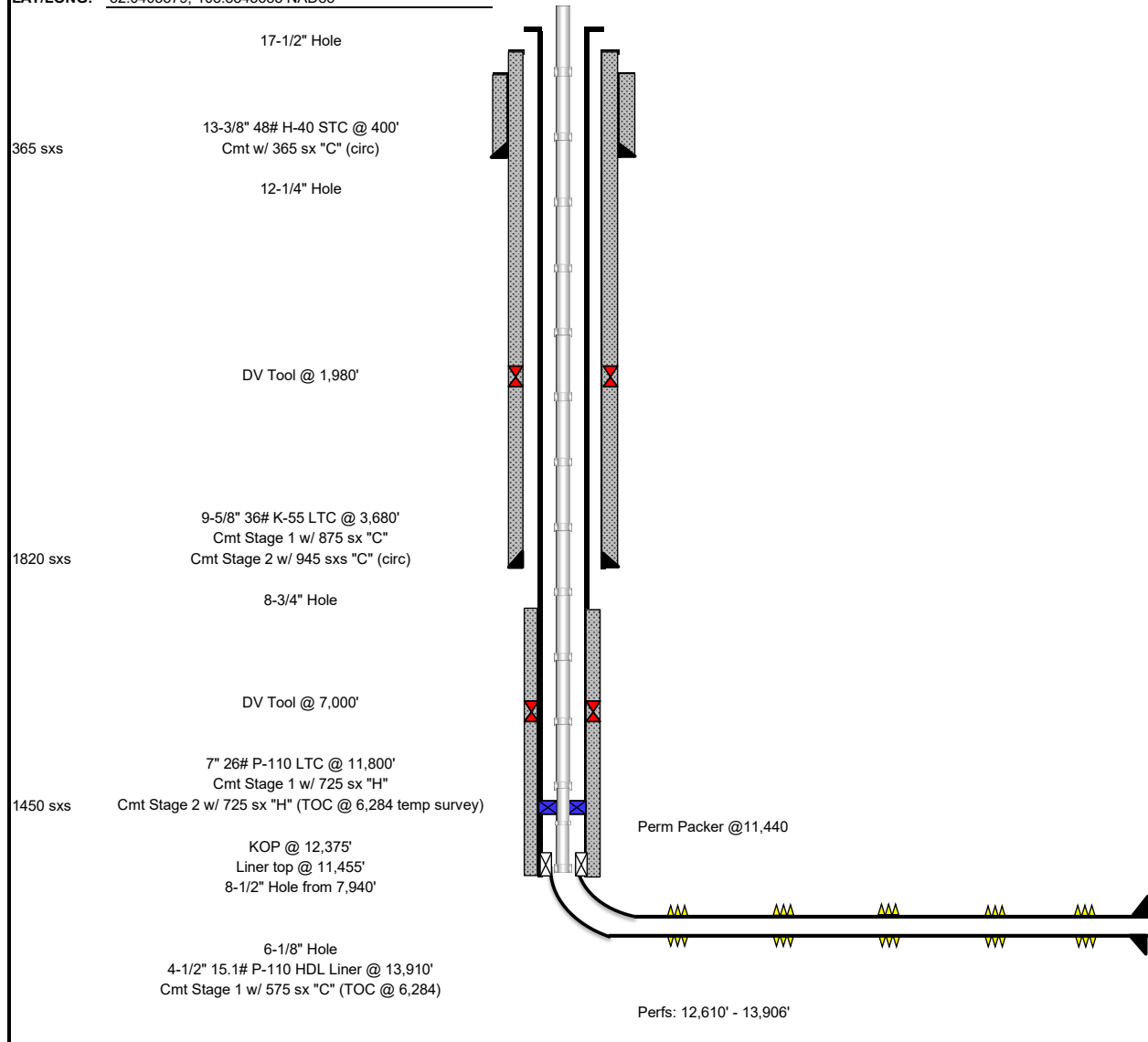

Formation Tops	
Delaware	3,710
Bone Spring	7,574
Wolfcamp "A"	12,210

Tubing Detail	
2-7/8" 6.5# L-80 Hydril CS tubing	
Baker Model D Perm Packer at 11,440'	
6' 2-3/8" tubing sub	
1.875" Baker BX Nipple at 11,450.52'	
6' 2-3/8" tubing sub	
1.875" Baker BXN Nipple at 11,457.47' w/ 1.791" no-go	
10' 2-3/8" tubing sub	
15,000 psi Glass disk	
Wireline Re-entry	
End of assembly at 11,470.33'	

PBTD @ 12,258'
 TMD @ 13,910'



El Paso 14 Federal #001 Current Wellbore Diagram

SPUD DATE: 7/31/1998
GL: 3.161 GR

API: 30-015-30278
LOCATION: Sec. 14-26S-30E 1900 FSL & 1850 FWL
COUNTY: Eddy County, New Mexico
LAT/LONG: 32.0405579,-103.8545685 NAD83

Formation Tops	
Delaware	3,710
Bone Spring	7,574
Wolfcamp "A"	12,210

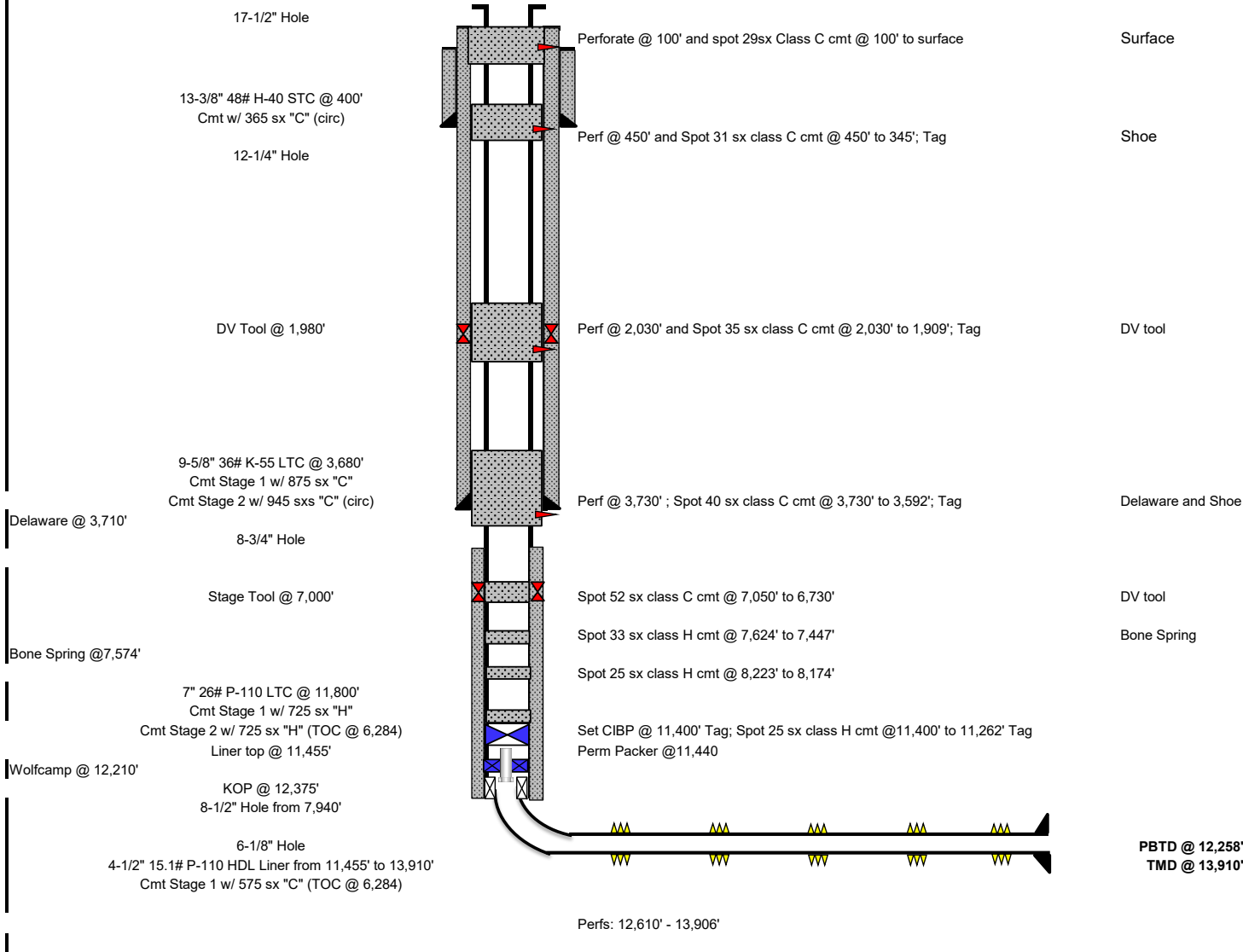

U.S. Department of the Interior
BUREAU OF LAND MANAGEMENT

Well Name: EL PASO 14 FEDERAL	Well Location: T26S / R30E / SEC 14 / NESW / 32.0405558 / -103.8544985	County or Parish/State: EDDY / NM
Well Number: 1H	Type of Well: CONVENTIONAL GAS WELL	Allottee or Tribe Name:
Lease Number: NMNM93207	Unit or CA Name: 1 EL PASO 14 FED	Unit or CA Number: NMNM101359
US Well Number: 3001530278	Operator: EOG RESOURCES INCORPORATED	

Notice of Intent

Sundry ID: 2881790

Type of Submission: Notice of Intent

Type of Action: Plug and Abandonment

Date Sundry Submitted: 11/06/2025

Time Sundry Submitted: 03:44

Date proposed operation will begin: 11/20/2025

Procedure Description: EOG PROPOSES TO P&A THIS WELLBORE USING THE ATTACHED PROCEDURE.CURRENT AND PROPOSED WELLBORE SCHEMATICS ATTACHED.

Surface Disturbance

Is any additional surface disturbance proposed?: No

NOI Attachments

Procedure Description

El_Paso_14_Fed_1_Proposed_PA_Prog___WBD_20251106154447.pdf

**APPROVAL SUBJECT TO
GENERAL REQUIREMENTS AND
SPECIAL STIPULATIONS
ATTACHED**

Well Name: EL PASO 14 FEDERAL

Well Location: T26S / R30E / SEC 14 /
NESW / 32.0405558 / -103.8544985

County or Parish/State: EDDY /
NM

Well Number: 1H

Type of Well: CONVENTIONAL GAS
WELL

Allottee or Tribe Name:

Lease Number: NMNM93207

Unit or CA Name: 1 EL PASO 14 FED

Unit or CA Number:
NMNM101359

US Well Number: 3001530278

Operator: EOG RESOURCES
INCORPORATED

Operator

I certify that the foregoing is true and correct. Title 18 U.S.C. Section 1001 and Title 43 U.S.C. Section 1212, make it a crime for any person knowingly and willfully to make to any department or agency of the United States any false, fictitious or fraudulent statements or representations as to any matter within its jurisdiction. Electronic submission of Sundry Notices through this system satisfies regulations requiring a

Operator Electronic Signature: KRISTINA AGEE

Signed on: NOV 06, 2025 03:44 PM

Name: EOG RESOURCES INCORPORATED

Title: Senior Regulatory Administrator

Street Address: 5509 Champions Dr.

City: Midland

State: TX

Phone: (432) 686-6996

Email address: KRISTINA_AGEE@EOGRESOURCES.COM

Field

Representative Name:

Street Address:

City:

State:

Zip:

Phone:

Email address:

APPROVED by Long Vo
Petroleum Engineer
Carlsbad Field Office
575-988-50402
LVO@BLM.GOV

Lea County Notification: 575-689-5981

Eddy County Notification: BLM_NM_CFO_PluggingNotifications@BLM.GOV

Secondary Contact: 575-361-2822

Form 3160-5
(October 2024)

UNITED STATES
DEPARTMENT OF THE INTERIOR
BUREAU OF LAND MANAGEMENT

FORM APPROVED
OMB No. 1004-0220
Expires: October 31, 2027

SUNDRY NOTICES AND REPORTS ON WELLS
Do not use this form for proposals to drill or to re-enter an abandoned well. Use Form 3160-3 (APD) for such proposals.

SUBMIT IN TRIPLICATE - Other instructions on page 2		5. Lease Serial No.
1. Type of Well <input type="checkbox"/> Oil Well <input type="checkbox"/> Gas Well <input type="checkbox"/> Other		6. If Indian, Allottee or Tribe Name
2. Name of Operator		7. If Unit of CA/Agreement, Name and/or No.
3a. Address	3b. Phone No. (include area code)	8. Well Name and No.
4. Location of Well (Footage, Sec., T.,R.,M., or Survey Description)		9. API Well No.
		10. Field and Pool or Exploratory Area
		11. Country or Parish, State

12. CHECK THE APPROPRIATE BOX(ES) TO INDICATE NATURE OF NOTICE, REPORT OR OTHER DATA

TYPE OF SUBMISSION	TYPE OF ACTION			
<input type="checkbox"/> Notice of Intent	<input type="checkbox"/> Acidize	<input type="checkbox"/> Deepen	<input type="checkbox"/> Production (Start/Resume)	<input type="checkbox"/> Water Shut-Off
<input type="checkbox"/> Subsequent Report	<input type="checkbox"/> Alter Casing	<input type="checkbox"/> Hydraulic Fracturing	<input type="checkbox"/> Reclamation	<input type="checkbox"/> Well Integrity
<input type="checkbox"/> Final Abandonment Notice	<input type="checkbox"/> Casing Repair	<input type="checkbox"/> New Construction	<input type="checkbox"/> Recomplete	<input type="checkbox"/> Other
	<input type="checkbox"/> Change Plans	<input type="checkbox"/> Plug and Abandon	<input type="checkbox"/> Temporarily Abandon	
	<input type="checkbox"/> Convert to Injection	<input type="checkbox"/> Plug Back	<input type="checkbox"/> Water Disposal	

13. Describe Proposed or Completed Operation: Clearly state all pertinent details, including estimated starting date of any proposed work and approximate duration thereof. If the proposal is to deepen directionally or recomplete horizontally, give subsurface locations and measured and true vertical depths of all pertinent markers and zones. Attach the Bond under which the work will be performed or provide the Bond No. on file with BLM/BIA. Required subsequent reports must be filed within 30 days following completion of the involved operations. If the operation results in a multiple completion or recompletion in a new interval, a Form 3160-4 must be filed once testing has been completed. Final Abandonment Notices must be filed only after all requirements, including reclamation, have been completed and the operator has determined that the site is ready for final inspection.)

14. I hereby certify that the foregoing is true and correct. Name (Printed/Typed)	Title
Signature	Date

THE SPACE FOR FEDERAL OR STATE OFFICE USE

Approved by Long Vo 	Title Petroleum Engineer	Date 2-8-2026
Conditions of approval, if any, are attached. Approval of this notice does not warrant or certify that the applicant holds legal or equitable title to those rights in the subject lease which would entitle the applicant to conduct operations thereon.		Office Carlsbad Field Office

Title 18 U.S.C Section 1001 and Title 43 U.S.C Section 1212, make it a crime for any person knowingly and willfully to make to any department or agency of the United States any false, fictitious or fraudulent statements or representations as to any matter within its jurisdiction.

(Instructions on page 2)

GENERAL INSTRUCTIONS

This form is designed for submitting proposals to perform certain well operations and reports of such operations when completed as indicated on Federal and Indian lands pursuant to applicable Federal law and regulations. Any necessary special instructions concerning the use of this form and the number of copies to be submitted, particularly with regard to local area or regional procedures and practices, are either shown below, will be issued by or may be obtained from the local Federal office.

SPECIFIC INSTRUCTIONS

Item 4 - Locations on Federal or Indian land should be described in accordance with Federal requirements. Consult the local Federal office for specific instructions.

Item 13: Proposals to abandon a well and subsequent reports of abandonment should include such special information as is required by the local Federal office. In addition, such proposals and reports should include reasons for the abandonment; data on any former or present productive zones or other zones with present significant fluid contents not sealed off by cement or otherwise; depths (top and bottom) and method of placement of cement plugs; mud or other material placed below, between and above plugs; amount, size, method of parting of any casing, liner or tubing pulled and the depth to the top of any tubing left in the hole; method of closing top of well and date well site conditioned for final inspection looking for approval of the abandonment. If the proposal will involve **hydraulic fracturing operations**, you must comply with 43 CFR 3162.3-3, including providing information about the protection of usable water. Operators should provide the best available information about all formations containing water and their depths. This information could include data and interpretation of resistivity logs run on nearby wells. Information may also be obtained from state or tribal regulatory agencies and from local BLM offices.

NOTICES

The privacy Act of 1974 and the regulation in 43 CFR 2.48(d) provide that you be furnished the following information in connection with information required by this application.

AUTHORITY: 30 U.S.C. 181 et seq., 351 et seq., 25 U.S.C. 396; 43 CFR 3160.

PRINCIPAL PURPOSE: The information is used to: (1) Evaluate, when appropriate, approve applications, and report completion of subsequent well operations, on a Federal or Indian lease; and (2) document for administrative use, information for the management, disposal and use of National Resource lands and resources, such as: (a) evaluating the equipment and procedures to be used during a proposed subsequent well operation and reviewing the completed well operations for compliance with the approved plan; (b) requesting and granting approval to perform those actions covered by 43 CFR 3162.3-2, 3162.3-3, and 3162.3-4; (c) reporting the beginning or resumption of production, as required by 43 CFR 3162.4-1(c) and (d) analyzing future applications to drill or modify operations in light of data obtained and methods used.

ROUTINE USES: Information from the record and/or the record will be transferred to appropriate Federal, State, local or foreign agencies, when relevant to civil, criminal or regulatory investigations or prosecutions in connection with congressional inquiries or to consumer reporting agencies to facilitate collection of debts owed the Government.

EFFECT OF NOT PROVIDING THE INFORMATION: Filing of this notice and report and disclosure of the information is mandatory for those subsequent well operations specified in 43 CFR 3162.3-2, 3162.3-3, 3162.3-4.

The Paperwork Reduction Act of 1995 requires us to inform you that:

The BLM collects this information to evaluate proposed and/or completed subsequent well operations on Federal or Indian oil and gas leases.

Response to this request is mandatory.

The BLM would like you to know that you do not have to respond to this or any other Federal agency-sponsored information collection unless it displays a currently valid OMB control number.

BURDEN HOURS STATEMENT: Public reporting burden for this form is estimated to average 8 hours per response, including the time for reviewing instructions, gathering and maintaining data, and completing and reviewing the form. Direct comments regarding the burden estimate or any other aspect of this form to U.S. Department of the Interior, Bureau of Land Management (1004-0137), Bureau Information Collection Clearance Officer (WO-630), 1849 C St., N.W., Mail Stop 401 LS, Washington, D.C. 20240

Additional Information

Location of Well

0. SHL: NESW / 1900 FSL / 1850 FWL / TWSP: 26S / RANGE: 30E / SECTION: 14 / LAT: 32.0405558 / LONG: -103.8544985 (TVD: 0 feet, MD: 0 feet)

BHL: SWSE / 930 FSL / 1759 FEL / TWSP: 26S / RANGE: 30E / SECTION: 14 / LAT: 0.0 / LONG: 0.0 (TVD: 0 feet, MD: 0 feet)

Medium Karst 350'

El Paso 14 Fed #1 P&A Procedure**AFE 187082**

Location: Sec. 14-26S-30E 1900 FSL & 1850 FWL
County: Eddy, NM
Lat/Long: 32.0405579,-103.8545685 NAD83
API #: 30-015-30278

Surface Casing: 13-3/8" 48# H-40 STC @ 400' Cmt w/ 365 sx "C" (circ)
Inter. Casing: 9-5/8" 36# K-55 LTC @ 3,680' Cmt Stage 1 w/ 875 sx "C", Cmt Stage 2 w/ 945 sxs "C" (circ)
Production Casing: 7" 26# P-110 LTC @ 11,800' Cmt Stage 1 w/ 725 sx "H", Cmt Stage 2 w/ 725 sx "H" (TOC @ 6,284)
Liner String: 4-1/2" 15.1# P-110 HDL Liner from 11,455' to 13,910' Cmt Stage 1 w/ 575 sx "C" (TOC @ 6,284)
Producing Interval: Wolfcamp perms - 12,610'-13,906'

Procedure

1. Notify Regulatory Agency 24 hours prior to commencing work.
2. MIRU Workover rig and any necessary safety equipment.
3. RU WL and free point the tubing and TIH with jet cutter and cut 2 7/8 tubing @ 11,430 ft. (The well has a permanent packer @11,440, which is set right next to a liner top (11,455'))
4. RU WL to make GR/JB run to 11,410'. RIH w/ CIBP and set CIBP at 11,400'. **Leak test CIBP for 30 minutes at 500 psi.**
5. **Run CBL from CIBP to surface.**
6. **Spot 147 sx** of Class H cement on top of CIBP. WOC and TAG **at 10676'.**
7. Spot **37 sx** class H cement 8,223' – 8,174' (spacer plug to make less than 3000 ft between plug) **WOC and Tag**
8. Spot **36 sx** class H cement **7585-7409** (Bone Spring) **WOC and Tag**
9. Spot 52 sx class C cement 7,050' – 6,730' (DV Tool) **WOC and Tag**
10. Pick up, perf @**3,760'** and sqz **49 sx** class C cement plug to 3,592'. WOC and TAG. (Shoe and Delaware) **(In 28 sxs/Out 21 sxs)**
11. Pick up, perf @**2,416'** and sqz **148 sx** class C cement plug to 1,909'. WOC and TAG. (DV tool) **(In 83 sxs/Out 65 sxs)**
12. Pick up, perf @**1497'** and circulate class C cement plug to surface. WOC Bubble Test. **434 sxs.**
13. Cut off WH 3' below surface; verify cement to surface & weld on P&A marker.
14. Cut off anchors 3' below surface and clean location.

REVISED**9:57 am, Feb 08, 2026**



El Paso 14 Federal #001

Current Wellbore Diagram

API: 30-015-30278
 LOCATION: Sec. 14-26S-30E 1900 FSL & 1850 FWL
 COUNTY: Eddy County, New Mexico
 LAT/LONG: 32.0405579,-103.8545685 NAD83

SPUD DATE: 7/31/1998
 KB: 3,161 GR

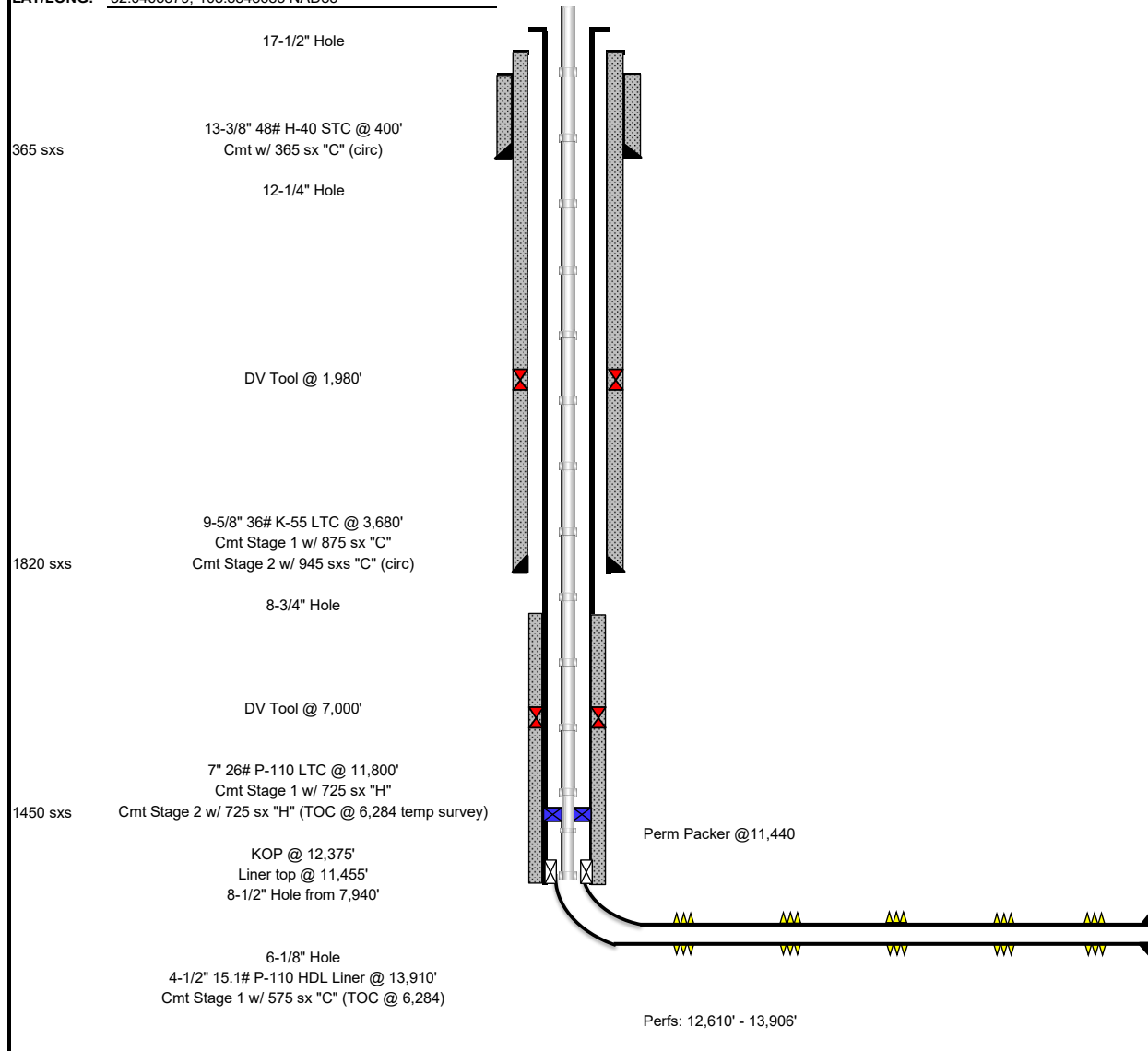

Formation Tops	
Delaware	3,710
Bone Spring	7,574
Wolfcamp "A"	12,210

Tubing Detail
 2-7/8" 6.5# L-80 Hydril CS tubing
 Baker Model D Perm Packer at 11,440'
 6' 2-3/8" tubing sub
 1.875" Baker BX Nipple at 11,450.52'
 6' 2-3/8" tubing sub
 1.875" Baker BXN Nipple at 11,457.47' w/ 1.791" no-go
 10' 2-3/8" tubing sub
 15,000 psi Glass disk
 Wireline Re-entry
 End of assembly at 11,470.33'

PBTD @ 12,258'
 TMD @ 13,910'

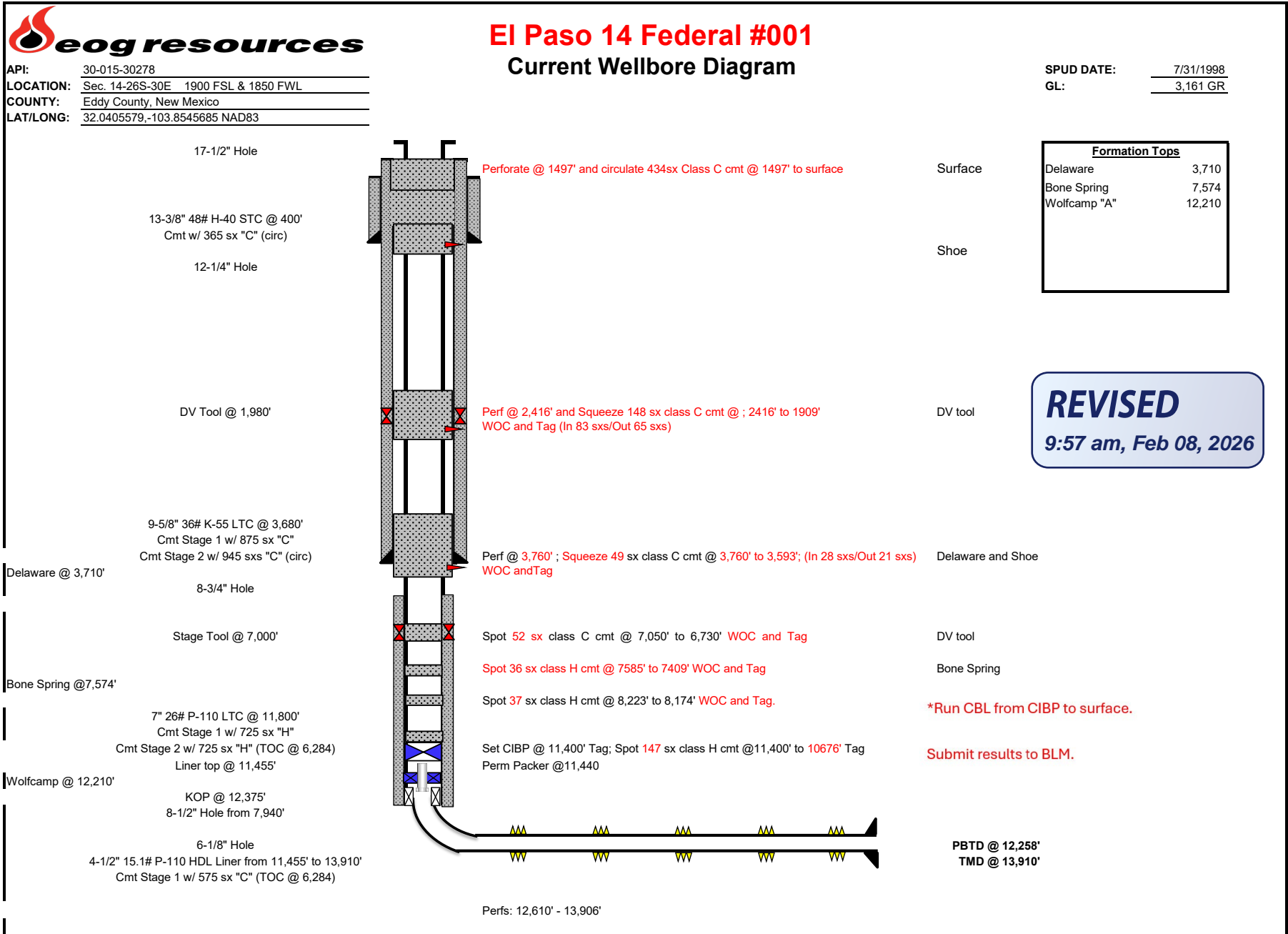

Outside of Lesser Prairie Chicken Area

**BUREAU OF LAND MANAGEMENT
Carlsbad Field Office
620 East Greene Street
Carlsbad, New Mexico 88220
575-234-5972**

**Permanent Abandonment of Federal Wells
Conditions of Approval**

Failure to comply with the following Conditions of Approval may result in a Notice of Incidents of Noncompliance (INC) in accordance with 43 CFR 3163.1.

Plugging operations shall commence within **ninety (90)** days from the approval date of this Notice of Intent to Abandon.

If you are unable to plug the well by the 90th day provide this office, prior to the 90th day, with the reason for not meeting the deadline and a date when we can expect the well to be plugged. Failure to do so will result in enforcement action.

The rig used for the plugging procedure cannot be released and moved off without the prior approval of the authorized officer. Failure to do so may result in enforcement action.

Notification: Contact the appropriate BLM office at least 24 hours prior to the commencing of any plugging operations. For wells in Chaves and Roosevelt County, call 575-627-0272; Lea County, call 575-689-5981. Eddy County, please email notifications to: [BLM NM CFO PluggingNotifications@BLM.GOV](mailto:BLM_NM_CFO_PluggingNotifications@BLM.GOV). The Eddy County inspector on call phone, 575-361-2822, will remain active as a secondary contact.

Blowout Preventers: A blowout preventer (BOP), as appropriate, shall be installed before commencing any plugging operation. The BOP must be installed and maintained as per API and manufacturer recommendations. The minimum BOP requirement is a 2M system for a well not deeper than 9,090 feet; a 3M system for a well not deeper than 13,636 feet; and a 5M system for a well not deeper than 22,727 feet.

Mud Requirement: Mud shall be placed between all plugs. Minimum consistency of plugging mud shall be obtained by mixing at the rate of 25 sacks (50 pounds each) of gel per 100 barrels of water. Minimum nine (9) pounds per gallon.

Cement Requirement: Sufficient cement shall be used to bring any required plug to the specified depth and length. Any given cement volumes on the proposed plugging procedure are merely estimates and are not final. Unless specific approval is received, no plug except the surface plug shall be less than 25 sacks of cement. Any plug that requires a tag will have a minimum WOC time of 4 hours for Class C or accelerated cement (calcium chloride) and 6 hours for Class H. Tagging the plug means running in the hole with a string of tubing or drill pipe and placing sufficient weight on the plug to ensure its integrity. Other methods of tagging the plug may be approved by the BLM authorized officer or BLM field representative.

In lieu of a cement plug across perforations in a cased hole (not for any other plugs), a bridge plug set within 50 feet to 100 feet above the perforations shall be capped with 25 sacks of cement. If a bailer is used to cap this plug, 35 feet of cement shall be sufficient. **Before pumping or bailing cement on top of CIBP, tag will be required to verify depth. Based on depth, a tag of the cement may be deemed necessary.**

Unless otherwise specified in the approved procedure, the cement plug shall consist of either Neat Class "C", for up to 7,500 feet of depth or Neat Class "H", for deeper than 7,500 feet plugs.

Fluid used to mix the cement in R111Q shall be saturated with the salts common to the section penetrated, and in suitable proportions but not less than 1% and not more than 3% calcium chloride by weight of cement will be considered the desired mixture whenever possible.

Above Ground Level Marker: If outside of Lesser Prairie-Chicken Habitat an above ground level marker shall be utilized. All casing shall be cut-off at the base of the cellar or 3 feet below final restored ground level (whichever is deeper). **The BLM is to be notified *BY PHONE* (numbers listed in 2. Notifications) a minimum of 4 hours prior to the wellhead being cut off to verify that cement is to surface in the casing and all annuluses. Wellhead cut off shall commence within fourteen (14) calendar days of the well being plugged. If the cut off cannot be done by the 14th day, the BLM is to be contacted with justification to receive an extension for completing the cut off.**

The well bore shall then be capped with a 4-inch pipe, 10-feet in length, 4 feet above ground and embedded in cement, unless otherwise noted in COA (requirements will be attached). The following information shall be permanently inscribed on the dry hole marker: well name and number, name of the operator, lease serial number, surveyed location (quarter-quarter section, section, township and range or other authorized survey designation acceptable to the authorized officer such as metes and bounds). A weep hole shall be left if a metal plate is welded in place.

Below Ground Level Marker: If within Lesser Prairie-Chicken Habitat a below ground level marker shall be utilized. All casing shall be cut-off at the base of the cellar or 3 feet below final restored ground level (whichever is deeper). **The BLM is to be notified *BY PHONE* (numbers listed in 2. Notifications) a minimum of 4 hours prior to the wellhead being cut off to verify that cement is to surface in the casing and all annuluses. Wellhead cut off shall commence within fourteen (14) calendar days of the well being plugged. If the cut off cannot be done by the 14th day, the BLM is to be contacted with justification to receive an extension for completing the cut off.**

Upon the plugging and subsequent abandonment of wells that are located in lesser prairie-chicken habitat, the casings shall be cut-off at the base of the cellar or 3 feet below final restored ground level (whichever is deeper). The well bore shall then be covered with a metal plate at least ¼ inch thick and welded in place. A weep hole shall be left in the plate and/or casing. The following information shall be permanently inscribed on the plate: well name and number, name of operator, lease serial number, surveyed location (quarter-quarter section, section, township and range or other authorized survey designation acceptable to the authorized officer such as metes and bounds).

NMOCD also requires the operator to notify NMOCD when this type of dry hole marker is used. This can be done on the subsequent report of abandonment which is submitted to the BLM after the well is plugged. State that a below ground cap was installed as required in the COA's from the BLM.

Operator to verify the ground marker type with the BLM before setting dry hole Marker.

Subsequent Plugging Reporting: Within 30 days after plugging work is completed, file via the AFMSS 2 WISx Module a Subsequent Report of Plugging and Abandonment to BLM. Please include the following information:

- The report should give in detail the manner in which the plugging work was carried out, the Extent (by depths) of cement plugs placed, and the size and location (by depths) of casing left In the well.
- The final copy of CBL.
- Any email correspondence regarding changes to originally approved procedure.
- Show date well was plugged.

Trash: All trash, junk and other waste material shall be contained in trash cages or bins to prevent scattering and will be removed and deposited in an approved sanitary landfill. Burial on site is not permitted.

Following the submission and approval of the Subsequent Report of Abandonment, surface restoration will be required. See attached reclamation objectives.

Timing Limitation Stipulation/ Condition of Approval for Lesser Prairie-Chicken:

From March 1st through June 15th annually, abandonment activities will be allowed except between the hours from 3:00 am and 9:00 am. Normal vehicle use on existing roads will not be restricted.



United States Department of the Interior

BUREAU OF LAND MANAGEMENT

Carlsbad Field Office
620 E. Greene St.
Carlsbad, New Mexico 88220-6292
www.blm.gov/nm



In Reply Refer To: 1310

Reclamation Objectives and Procedures

Reclamation Objective: Oil and gas development is one of many uses of the public lands and resources. While development may have a short- or long-term effect on the land, successful reclamation can ensure the effect is not permanent. During the life of the development, all disturbed areas not needed for active support of production operations should undergo “interim” reclamation in order to minimize the environmental impacts of development on other resources and uses. At final abandonment, well locations, production facilities, and access roads must undergo “final” reclamation so that the character and productivity of the land and water are restored.

The long-term objective of final reclamation is to set the course for eventual ecosystem restoration, including the restoration of the natural vegetation community, hydrology, and wildlife habitats. In most cases this means returning the land to a condition approximating or equal to that which existed prior to the disturbance. The final goal of reclamation is to restore the character of the land and water to its pre-disturbance condition. The operator is generally not responsible for achieving full ecological restoration of the site. Instead, the operator must achieve the short-term stability, visual, hydrological, and productivity objectives of the surface management agency and take steps necessary to ensure that long-term objectives will be reached through natural processes.

To achieve these objectives, remove any/all contaminants, scrap/trash, equipment, pipelines and powerlines **(Contact service companies, allowing plenty of time to have the risers and power lines and poles removed prior to reclamation, don't wait till the last day and try to get them to remove infrastructure)**. Strip and remove caliche, contour the location to blend with the surrounding landscape, re-distribute the native soils, provide erosion control as needed, rip (across the slope and seed as specified in the original APD COA. **This will apply to well pads, facilities, and access roads.** Barricade access road at the starting point. If reserve pits have not reclaimed due to salts or other contaminants, submit a plan for approval, as to how you propose to provide adequate restoration of the pit area.

The Application for Permit to Drill or Reenter (APD, Form 3160-3), Surface Use Plan of Operations must include adequate measures for stabilization and reclamation of disturbed lands. Oil and Gas operators must plan for reclamation, both interim and final, up front in the APD process as per Onshore Oil and Gas Order No. 1.

For wells and/or access roads not having an approved plan, or an inadequate plan for surface reclamation (either interim or final reclamation), the operator must submit a proposal describing the procedures for reclamation. For interim reclamation, the appropriate time for submittal would be when filing the Well Completion or Recompletion Report and Log (Form 3160-4). For final reclamation, the appropriate time for submittal would be when filing the Notice of Intent, or the Subsequent Report of Abandonment, Sundry Notices and Reports on Wells (Form 3160-5). Interim reclamation is to be completed within 6 months of well completion, and final reclamation is to be completed within 6 months of well abandonment.

The operator must file a Subsequent Report Plug and Abandonment (Form 3160-5) following the plugging of a well.

Previous instruction had you waiting for a BLM specialist to inspect the location and provide you with reclamation requirements. If you have an approved Surface Use Plan of Operation and/or an approved Sundry Notice, you are free to proceed with reclamation as per approved APD. If you have issues or concerns, contact a BLM specialist to assist you. It would be in your interest to have a BLM specialist look at the location and

access road prior to the removal of reclamation equipment to ensure that it meets BLM objectives. Upon conclusion submit a Form 3160-5, Subsequent Report of Reclamation. This will prompt a specialist to inspect the location to verify work was completed as per approved plans.

The approved Subsequent Report of Reclamation will be your notice that the native soils, contour and seedbed have been reestablished. If the BLM objectives have not been met the operator will be notified and corrective actions may be required.

It is the responsibility of the operator to monitor these locations and/or access roads until such time as the operator feels that the BLM objective has been met. If after two growing seasons the location and/or access roads are not showing the potential for successful revegetation, additional actions may be needed. When you feel the BLM objectives have been met submit a Final Abandonment Notice (FAN), Form 3160-5, stating that all reclamation requirements have been achieved and the location and/or access road is ready for a final abandonment inspection.

At this time the BLM specialist will inspect the location and/or access road. If the native soils and contour have been restored, and the revegetation is successful, the FAN will be approved, releasing the operator of any further liability of the location and/or access road. If the location and/or access road have not achieved the objective, you will be notified as to additional work needed or additional time being needed to achieve the objective.

If there are any questions, please feel free to contact any of the following specialists:

Jim Amos
Supervisory Petroleum Engineering Tech/Environmental Protection Specialist
575-234-5909 (Office), 575-361-2648 (Cell)

Arthur Arias
Environmental Protection Specialist
575-234-6230

Crisha Morgan
Environmental Protection Specialist
575-234-5987

Jose Martinez-Colon
Environmental Protection Specialist
575-234-5951

Angela Mohle
Environmental Protection Specialist
575-234-9226

Robert Duenas
Environmental Protection Specialist
575-234-2229

Terry Gregston
Environmental Protection/HAZMAT Specialist
575-234-5958

Sundry ID		2881790					
Plug Type	Top	Bottom	Length	Tag	Sacks	Cement Class	Notes
Surface Plug	0.00	100.00	100.00	Tag/Verify			
Fresh Water @ 325	271.75	375.00	103.25	base no			
13.375 inch- Shoe Plug	346.00	450.00	104.00	Tag/Verify			
Top of Salt @ 1447	1382.53	1497.00	114.47	Tag/Verify	434.00	C	Perf and circulate from 1497' to surface. Verify at surface.
DV tool plug	1910.20	2030.00	119.80	Tag/Verify			
Base of Salt @ 2366	2292.34	2416.00	123.66	Tag/Verify	148.00	C	Perf and squeeze from 2416' to 1909'. WOC and Tag. (In 83 sxs/Out 65 sxs)
9.625 inch- Shoe Plug	3593.20	3730.00	136.80	Tag/Verify			
Delaware @ 3710	3622.90	3760.00	137.10	If solid base no need to Tag (CIBP present and/or Mechanical Integrity Test), If Perf & Sqz then Tag, Leak Test all CIBP if no Open Perforations	49.00	C	Perf and squeeze from 3760' to 3593'. WOC and Tag. (In 28 sxs/Out 21 sxs)
DV tool plug	6730.00	7050.00	320.00	Tag/Verify	52.00	C	Spot cement from 7050' to 6730'. WOC and Tag.
Bonesprings @ 7535	7409.65	7585.00	175.35	If solid base no need to Tag (CIBP	36.00	H	Spot cement from 7585' to 7409'. WOC and Tag.
Spacer Plug @ 8173	8041.27	8223.00	181.73	If solid base no need to Tag (CIBP present and/or Mechanical Integrity Test), If Perf & Sqz then Tag, Leak Test all CIBP if no Open Perforations	37.00	H	Spot cement from 8223' to 8041'. WOC and Tag.
Wolfcamp @ 10835	10676.65	10885.00	208.35	If solid			
Liner Top @ 11455	11290.45	11505.00	214.55	If solid			

				If solid base no need to Tag (CIBP present and/or Mechanical Integrity Test), If Perf & Sqz then Tag, Leak Test all CIBP if no Open Perforations			
CIBP Plug	11365.00	11400.00	35.00		147.00	H	Set CIBP at 11400'. Leak test CIBP. Spot cement from 11400' to 10676'. WOC and Tag.
7 inch- Shoe Plug	11632.00	11850.00	218.00	Tag/Verify			
4.5 inch- Shoe Plug	13720.90	13960.00	239.10	Tag/Verify			

No more than 2000' is to be allowed between plugs in open hole, and no more than 3000' between plugs in cased hole.
 Class H >7500'
 Class C <7500'

Fluid used to mix the cement in R111P shall be saturated with the salts common to the section penetrated, and in suitable proportions, but not more than 3% calcium chloride by weight of cement will be considered the desired mixture whenever possible.

Medium, Secretary: Top of salt to surface If no salt take the deepest fresh water or Karst Depth

High, Critical: Bottom of Karst to surface or Deepest fresh water, whichever is greater
 R111P: 50 Feet from Base of Salt to surface.

Class C: 1.32 ft³/sx
 Class H: 1.06 ft³/sx

Onshore Order 2.III.G Drilling Abandonment Requirements: "All formations bearing usable-quality water, oil, gas, or geothermal resources, and/or a prospectively valuable deposit of minerals shall be protected.

		<u>Top of Salt to surface</u>	
<u>Cave Karst/Potash Cement Requirement:</u>	<u>Medium</u>		
<u>Wild Life</u>	<u>Outside of Lesser Prairie Chicken Area</u>		
13.375 inch- Shoe Plug @	400.00		
9.625 inch- Shoe Plug @	3680.00		
7 inch- Shoe Plug @	11800.00	TOC @	6284.00
4.5 inch- Shoe Plug @	13910.00	TOC @	11455.00

DV Tool @	7000.00	CIBP @	11400.00
DV Tool @	1980.00		

Sante Fe Main Office
Phone: (505) 476-3441

General Information
Phone: (505) 629-6116

Online Phone Directory
<https://www.emnrd.nm.gov/oecd/contact-us>

State of New Mexico
Energy, Minerals and Natural Resources
Oil Conservation Division
1220 S. St Francis Dr.
Santa Fe, NM 87505

CONDITIONS

Action 552651

CONDITIONS

Operator: EOG RESOURCES INC 5509 Champions Drive Midland, TX 79706	OGRID: 7377
	Action Number: 552651
	Action Type: [C-103] NOI Plug & Abandon (C-103F)

CONDITIONS

Created By	Condition	Condition Date
gcordero	Adhere to current Plug & Abandon (P&A) Conditions Of Approvals (COA).	2/12/2026
gcordero	A Cement Bond Log (CBL) is required to be submitted to electronic permitting.	2/12/2026
gcordero	Submit Cement Bond Logs (CBL) prior to submittal of C-103P.	2/12/2026