

District I
1625 N. French Dr., Hobbs, NM 88240
District II
1301 W. Grand Avenue, Artesia, NM 88210
District III
1000 Rio Brazos Rd., Aztec, NM 87410
District IV
1220 S. St. Francis Dr., Santa Fe, NM 87505

State of New Mexico
Energy, Minerals & Natural Resources

Form C-101
May 27, 2004

Oil Conservation Division
1220 S. St. Francis Dr.

Santa Fe, NM 87505

RECEIVED

Submit to appropriate District Office

2008 MAR 19 PM 3 59

AMENDED REPORT

APPLICATION FOR PERMIT TO DRILL, RE-ENTER, DEEPEN, PLUGBACK, OR ADD A ZONE

¹ Operator Name and Address OXY USA Inc. P.O. Box 50250 Midland, TX 79710-0250		² OGRID Number 16696
⁴ Property Code 27111	⁵ Property Name Bravo Dome Carbon Dioxide Gas Unit 1831	³ API Number 30- 021- 20455
⁹ Proposed Pool 1 Bravo Dome Carbon Dioxide Gas 160 96010		⁶ Well No. 071
¹⁰ Proposed Pool 2		

⁷ Surface Location

UL or lot no.	Section	Township	Range	Lot. Idn	Feet from the	North/South Line	Feet from the	East/West line	County
F	7	18 N	31 E		1900	North	1650	West	Harding

⁸ Proposed Bottom Hole Location If Different From Surface

UL or lot no.	Section	Township	Range	Lot. Idn	Feet from the	North/South Line	Feet from the	East/West line	County

Additional Well Location

¹¹ Work Type Code N	¹² Well Type Code C	¹³ Cable/Rotary R	¹⁴ Lease Type Code S-105862	¹⁵ Ground Level Elevation 4499.9'
¹⁶ Multiple No	¹⁷ Proposed Depth 2600'	¹⁸ Formation Tubb	¹⁹ Contractor N/A	²⁰ Spud Date 4/20/08
Depth to ground water >100'		Distance from nearest fresh water well >1000'		Distance from nearest surface water >1000'
Pit: Liner: Synthetic <input checked="" type="checkbox"/> 12 mils thick Clay <input type="checkbox"/> Pit Volume 4000 bbls Drilling Method:				
Closed-Loop System <input type="checkbox"/> Fresh Water <input checked="" type="checkbox"/> Brine <input type="checkbox"/> Diesel/Oil-based <input type="checkbox"/> Gas/Air <input type="checkbox"/>				

²¹ Proposed Casing and Cement Program

Hole Size	Casing Size	Casing weight/foot	Setting Depth	Sacks of Cement	Estimated TOC
12-1/4"	8-5/8"	24#	+/- 750'	400sx	Surface
7-7/8"	5-1/2"	5.9#FG/15.5#	+/- 2600'	550sx	Surface

²² Describe the proposed program. If this application is to DEEPEN or PLUG BACK, give the data on the present productive zone and proposed new productive zone. Describe the blowout prevention program, if any. Use additional sheets if necessary.

See Attachment

²³ I hereby certify that the information given above is true and complete to the best of my knowledge and belief. I further certify that the drilling pit will be constructed according to NMOCD guidelines ☒ a general permit ☐, or an (attached) alternative OCD-approved plan ☐.
Signature: *David Stewart*

Printed name: David Stewart

Title: Sr. Regulatory Analyst

E-mail Address: david_stewart@oxy.com

Date: 3/17/08

Phone: 432-685-5717

OIL CONSERVATION DIVISION

Approved by:

Ed Martin
DISTRICT SUPERVISOR

Title:

Approval Date: 3/27/08 Expiration Date: 3/27/10

Conditions of Approval:

Attached ☐

District I
1625 N. French Dr., Hobbs, NM 88240

District II
811 South First, Artesia, NM 88210

District III
1000 Rio Brazos Rd., Aztec, NM 87410

District IV
2040 South Pacheco, Santa Fe, NM 87505

State of New Mexico
Energy, Minerals & Natural Resources Department

OIL CONSERVATION DIVISION
2040 South Pacheco
Santa Fe, NM 87505

Form C-102
Revised October 18, 1994
Instructions on back
Submit to Appropriate District Office
State Lease - 4 Copies
Fee Lease - 3 Copies

☐ AMENDED REPORT

WELL LOCATION AND ACREAGE DEDICATION PLAT

API Number 30-021- 20455	Pool Code 96010	Pool Name BRAVO DOME CARBON DIOXIDE GAS 160
Property Code 27111	Property Name BRAVO DOME CARBON DIOXIDE GAS UNIT 1831	Well Number 071
OGRID No. 16696	Operator Name OXY USA INC.	Elevation 4499.9



Surface Location

UL or lot no. F	Section 7	Township 18 N	Range 31 E	Lot Idn.	Feet from the 1900'	North/South line NORTH	Feet from the 1650'	East/West line WEST	County HARDING
--------------------	--------------	------------------	---------------	----------	------------------------	---------------------------	------------------------	------------------------	-------------------

Bottom Hole Location If Different From Surface

UL or lot no.	Section	Township	Range	Lot Idn.	Feet from the	North/South line	Feet from the	East/West line	County
Dedicated Acres 160	Joint or Infill N	Consolidation Code	Order No.						

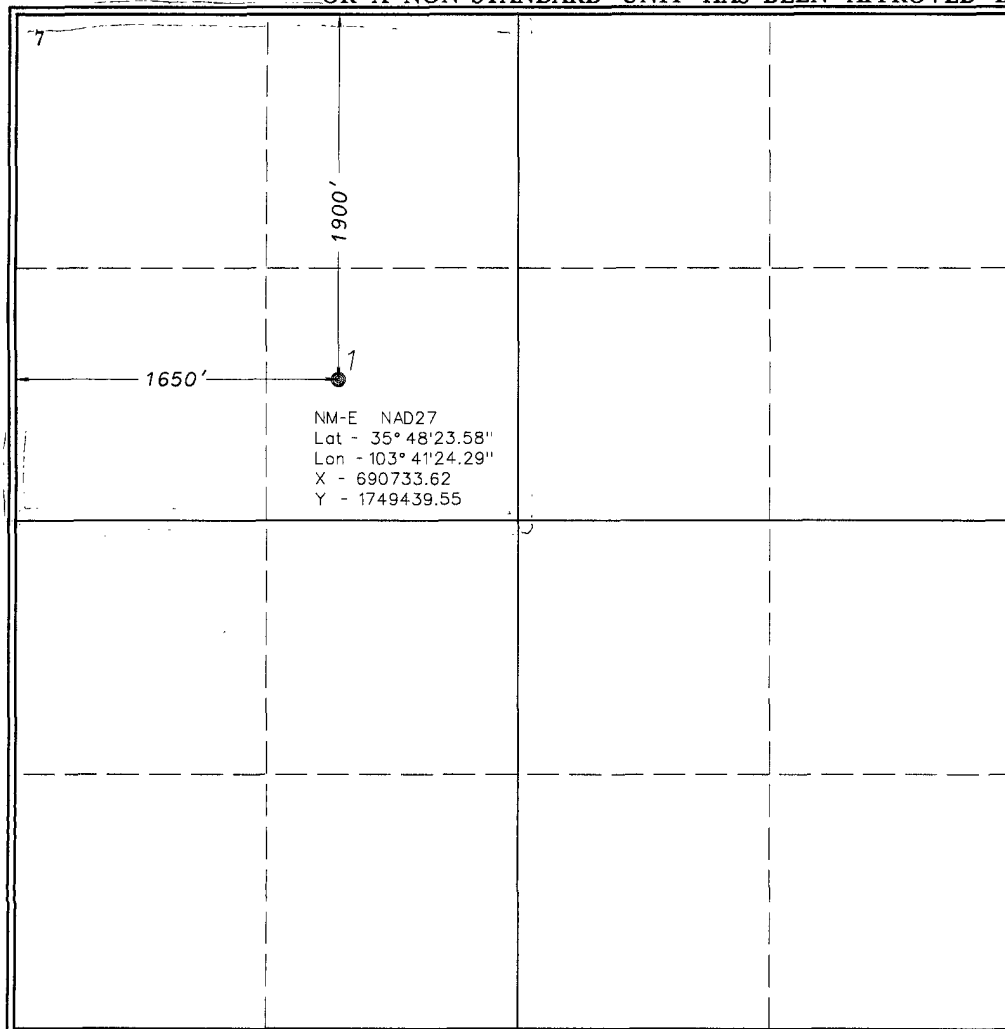
NO ALLOWABLE WILL BE ASSIGNED TO THIS COMPLETION UNTIL ALL INTERESTS HAVE BEEN CONSOLIDATED
OR A NON-STANDARD UNIT HAS BEEN APPROVED BY THE DIVISION

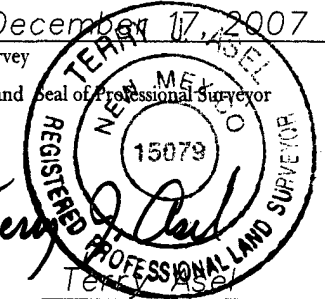
	<p>OPERATOR CERTIFICATION</p> <p>I hereby certify that the information contained herein is true and complete to the best of my knowledge and belief.</p> <p>Signature </p> <p>Printed Name David Stewart</p> <p>Title Sr. Regulatory Analyst</p> <p>Date 3/17/08</p>
	<p>SURVEYOR CERTIFICATION</p> <p>I hereby certify that the well location shown on this plat was plotted from field notes of actual surveys made by me or under my supervision, and that the same is true and correct to the best of my belief.</p> <p>Date of Survey December 17, 2007</p> <p>Signature and Seal of Professional Surveyor </p> <p>Certificate Number 15079</p>

Bravo Dome CO2 wells - 2008

CASING:

MD (ft)	Hole Size (in)	Csg Size (in)	Wt (lb/ft)	Grd	Cplg
0 - ±750	12-1/4	8-5/8	24	J55	STC
0 - ± 2440	7-7/8	5-1/2 FG	5.9	FG	10 Rd
2440 - ± 2600	7-7/8	5-1/2 Steel	15.5	J55	LTC

CEMENT:

Surface:

Cement Design							
Slurry	Weight (ppg)	TOC (feet)	BOC (feet)		Slurry Volume (Bbls)	Cement Required (sx.)	Comment
Lead	14.8	Surface	750		96	400	TOC ±surface
Lead Slurry							
Premium Plus CaCl Poly E Flake Slurry Yield Mix Water Mix Water Source				400 sx 2% 0.125 lb/sx 1.35 cfs 6.3 gal/sx Freshwater			

Production:

Cement Design							
Slurry	Weight (ppg)	TOC (feet)	BOC (feet)		Slurry Volume (Bbls)	Cement Required (sx.)	Comment
Lead	11.1	0	±1830		233	400	TOC to Surface
Tail	13.2	±1830	2600		50	150	TOC ±600' above Cimarron
Lead Slurry				Tail Slurry			
Premium Plus CaCl Poly E Flake Slurry Yield Mix Water Mix Water Source		400 sx 3% 0.125 lb/sx 3.28 cfs 20.56 gal/sk Freshwater		Premium Plus CaCl Poly E Flake Slurry Yield Mix Water Mix Water Source		150 sx 3% 0.125 lb/sx 1.86 cfs 9.99 gal/sk Freshwater	

9" BOP - 3000psi

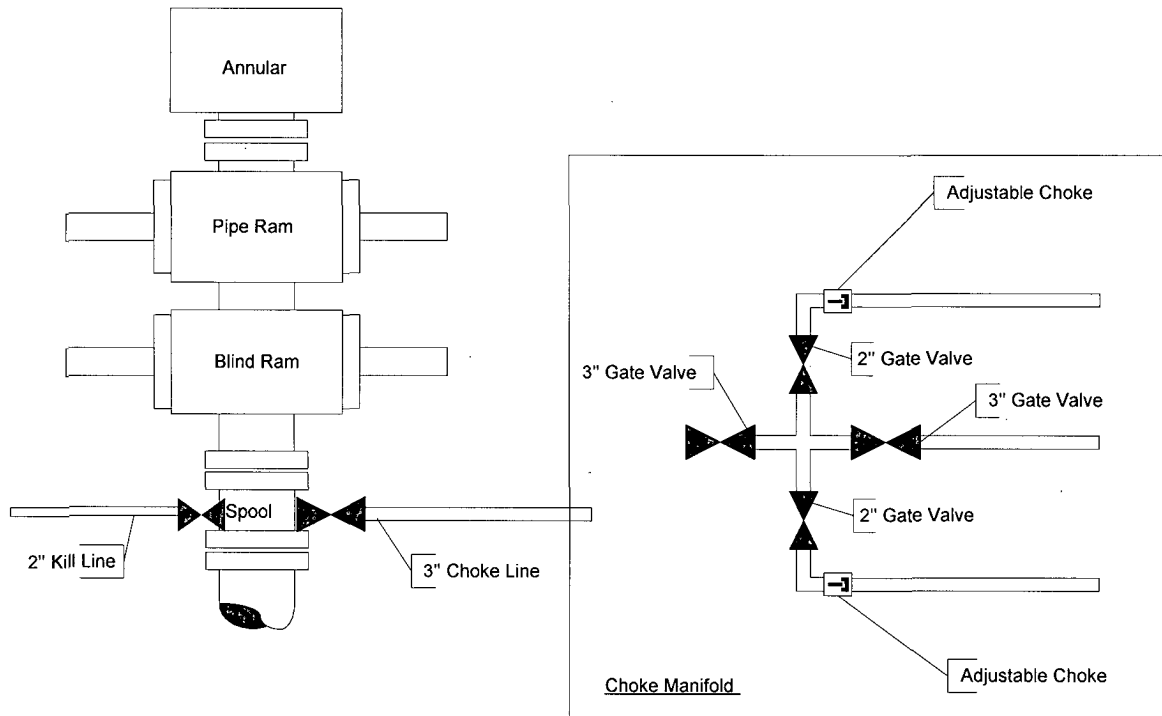

Bravo Dome Unit
Location and Pit Design
Cheyenne Rig 8

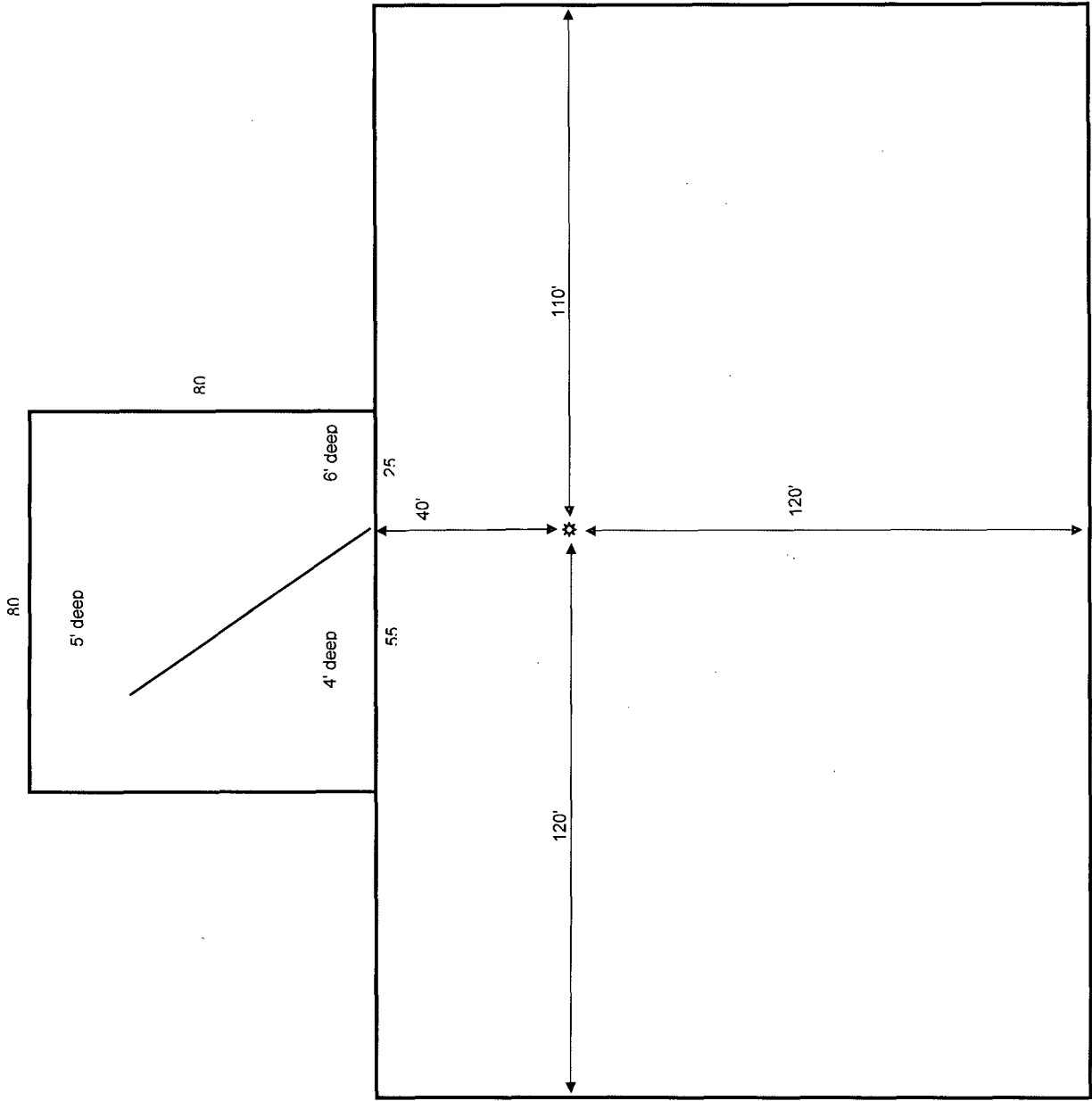

Bravo Dome Unit
Cellar and Sump Pit
Cheyenne Rig 8

