

5-19-04 DATE IN	6-8-04 SUSPENSE	<i>Morgan</i> ENGINEER	5-20-04 LOGGED IN	NSL TYPE	PSN 16414129424 APP NO
--------------------	--------------------	---------------------------	----------------------	-------------	---------------------------

BP
RECEIVED

ABOVE THIS LINE FOR DIVISION USE ONLY

NEW MEXICO OIL CONSERVATION DIVISION
- Engineering Bureau -
1220 South St. Francis Drive, Santa Fe, NM 87505



MAY 19 2004

**OIL CONSERVATION
DIVISION**

ADMINISTRATIVE APPLICATION CHECKLIST

THIS CHECKLIST IS MANDATORY FOR ALL ADMINISTRATIVE APPLICATIONS FOR EXCEPTIONS TO DIVISION RULES AND REGULATIONS WHICH REQUIRE PROCESSING AT THE DIVISION LEVEL IN SANTA FE

Application Acronyms:

[NSL-Non-Standard Location] [NSP-Non-Standard Proration Unit] [SD-Simultaneous Dedication]
[DHC-Downhole Commingling] [CTB-Lease Commingling] [PLC-Pool/Lease Commingling]
[PC-Pool Commingling] [OLS - Off-Lease Storage] [OLM-Off-Lease Measurement]
[WFX-Waterflood Expansion] [PMX-Pressure Maintenance Expansion]
[SWD-Salt Water Disposal] [IPI-Injection Pressure Increase]
[EOR-Qualified Enhanced Oil Recovery Certification] [PPR-Positive Production Response]

- [1] **TYPE OF APPLICATION** - Check Those Which Apply for [A]
- [A] Location - Spacing Unit - Simultaneous Dedication
☒ NSL ☐ NSP ☐ SD
- Check One Only for [B] or [C]
- [B] Commingling - Storage - Measurement
☐ DHC ☐ CTB ☐ PLC ☐ PC ☐ OLS ☐ OLM
- [C] Injection - Disposal - Pressure Increase - Enhanced Oil Recovery
☐ WFX ☐ PMX ☐ SWD ☐ IPI ☐ EOR ☐ PPR
- [D] Other: Specify _____
- [2] **NOTIFICATION REQUIRED TO:** - Check Those Which Apply, or ☒ Does Not Apply
- [A] ☐ Working, Royalty or Overriding Royalty Interest Owners
- [B] ☐ Offset Operators, Leaseholders or Surface Owner
- [C] ☐ Application is One Which Requires Published Legal Notice
- [D] ☐ Notification and/or Concurrent Approval by BLM or SLO
U.S. Bureau of Land Management - Commissioner of Public Lands, State Land Office
- [E] ☐ For all of the above, Proof of Notification or Publication is Attached, and/or,
- [F] ☐ Waivers are Attached

- [3] **SUBMIT ACCURATE AND COMPLETE INFORMATION REQUIRED TO PROCESS THE TYPE OF APPLICATION INDICATED ABOVE.**

[4] **CERTIFICATION:** I hereby certify that the information submitted with this application for administrative approval is **accurate** and **complete** to the best of my knowledge. I also understand that **no action** will be taken on this application until the required information and notifications are submitted to the Division.

Note: Statement must be completed by an individual with managerial and/or supervisory capacity.

Mary Corley
Print or Type Name

Mary Corley
Signature

Sr. Regulatory Analyst 05/12/2004
Title Date
corleym1@bp.com
e-mail Address

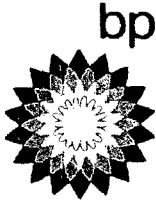

San Juan South Asset

Mary Corley
WL1-19.171
281-366-4491 (direct)
281-366-0700 (FAX)
corleym1@bp.com

P. O. Box 3092
Houston, Texas 77253-3092
501 Westlake Park Boulevard
Houston, Texas 77079

May 12, 2004

Mr. Michael Stogner
New Mexico Oil Conservation Division
1220 South St Francis Drive
P.O. Box 6429
Santa Fe, NM 87505

Application for Non-Standard Well Location
Elliott Gas Com D Well No. 1C
S/2 Section 09-T30N-R09W
Blanco Mesaverde Pool
San Juan County, New Mexico

BP America Production Company respectfully requests an administrative approval for a non-standard well location for the Elliott Gas Com D Well No. 1C to be drilled at a location of 2035' FSL and 745' FWL of Section 09, T30N-R09W. The non-standard location is necessitated by topographical conditions – steep terrain and existing pipelines - and would insure the conservation of surface and subsurface resources in the area.

To aid in your review attached is a C-102, Well Location Plat, indicating the proposed well location and the existing Mesaverde wells in the BP operated 320 acre unit in the S/2. Burlington is a working interest partner in the S/2 Mesaverde development and BP has a 100% working interest in the offsetting 320 acre unit in the N/2 of section 09. Also attached are a topographical map and a 9-section plat showing the offset wells.

Your attention to this matter is greatly appreciated. Should you have any questions concerning this application please do not hesitate to call me at 281-366-4491.

Sincerely,

Mary Corley

cc: Frank Chavez, Supervisor
NMOCD District III
1000 Rio Brazos Road
Aztec, NM 87410

District I
PO Box 1980, Hobbs NM 88241-1980
District II
PO Drawer KK, Artesia, NM 87211-0719
District III
1000 Rio Brazos Rd., Aztec, NM 87410
District IV
PO Box 2088, Santa Fe, NM 87504-2088

State of New Mexico
Energy, Minerals & Natural Resources Department

OIL CONSERVATION DIVISION
PO Box 2088
Santa Fe, NM 87504-2088

Form C-102
Revised February 21, 1994
Instructions on back
Submit to Appropriate District Office
State Lease - 4 Copies
Fee Lease - 3 Copies

☐ AMENDED REPORT

WELL LOCATION AND ACREAGE DEDICATION PLAT

1 API Number		2 Pool Code 72319		3 Pool Name BLANCO MESAVERDE		
4 Property Code 000 444		5 Property Name Elliott Gas Com D			6 Well Number # 1C	
7 OGRID No. 000 778		8 Operator Name BP AMERICA PRODUCTION COMPANY			9 Elevation 6158	

10 Surface Location

UL or Lot No. L	Section 9	Township 30 N	Range 9 W	Lot Idn	Feet from the 2035	North/South line SOUTH	Feet from the 745	East/West line WEST	County SAN JUAN
--------------------	--------------	------------------	--------------	---------	-----------------------	---------------------------	----------------------	------------------------	--------------------

11 Bottom Hole Location If Different From Surface

7 UL or lot no.	Section	Township	Range	Lot Idn	Feet from the	North/South line	Feet from the	East/West line	County
-----------------	---------	----------	-------	---------	---------------	------------------	---------------	----------------	--------

12 Dedicated Acres 3.20	13 Joint or Infill	14 Consolidation Code	15 Order No.
----------------------------	--------------------	-----------------------	--------------

NO ALLOWABLE WILL BE ASSIGNED TO THIS COMPLETION UNTIL ALL INTERESTS HAVE BEEN CONSOLIDATED
OR A NON-STANDARD UNIT HAS BEEN APPROVED BY THE DIVISION

16		3248(R)		17 OPERATOR CERTIFICATION	
3004530984 MV 1030 FNL & 2210 FWL ELLIOTT GAS COM C BP No. 001B				I hereby certify that the information contained herein is true and complete to the best of my knowledge and belief.	
3004522056 MV 1640 FNL & 1050 FWL ELLIOTT GAS COM C BP No. 001A		3004509712 MV 1650 FNL & 1750 FEL ELLIOTT GAS COM C BP No. 001		Signature Mary Corley	
3004509706 PC 1755 FNL & 1455 FWL E E ELLIOTT C No. 002 BP		3004522931 FC 1570 FNL & 1055 FEL ELLIOTT GAS COM Y BP No. 001		Printed Name MARY CORLEY	
3004509607 MV 990 FSL & 1650 FWL ELLIOTT GAS COM D BP No. 001		3004509653 FS 1650 FSL & 1455 FEL E E ELLIOTT C No. 001 BP		Title SR. REGULATORY ANALYST	
3004527134 FC 790 FSL & 1785 FWL DUFF COM No. 260 BURLINGTON		3004530988 MV 1390 FSL & 2250 FEL ELLIOTT GAS COM D BP No. 001B		Date 05.13.2004	
3004520139 PC 1090 FSL & 850 FWL DUFF No. 003 ENERGEN		3004522138 MV 960 FSL & 830 FEL ELLIOTT GAS COM D BP No. 001A		18 SURVEYOR CERTIFICATION	
745'		2035'		I hereby certify that the well location shown on this plat was plotted from field notes of actual surveys made by me or under my supervision, and that the same is true and correct to the best of my belief.	
				Restaked: April 27, 2004 February 21, 2004	
				Date of Survey	
				Signature and Seal of Professional Surveyor	
				GARY D. VANN NEW MEXICO REGISTERED PROFESSIONAL LAND SURVEYOR 7016	
				7016 Certificate Number	

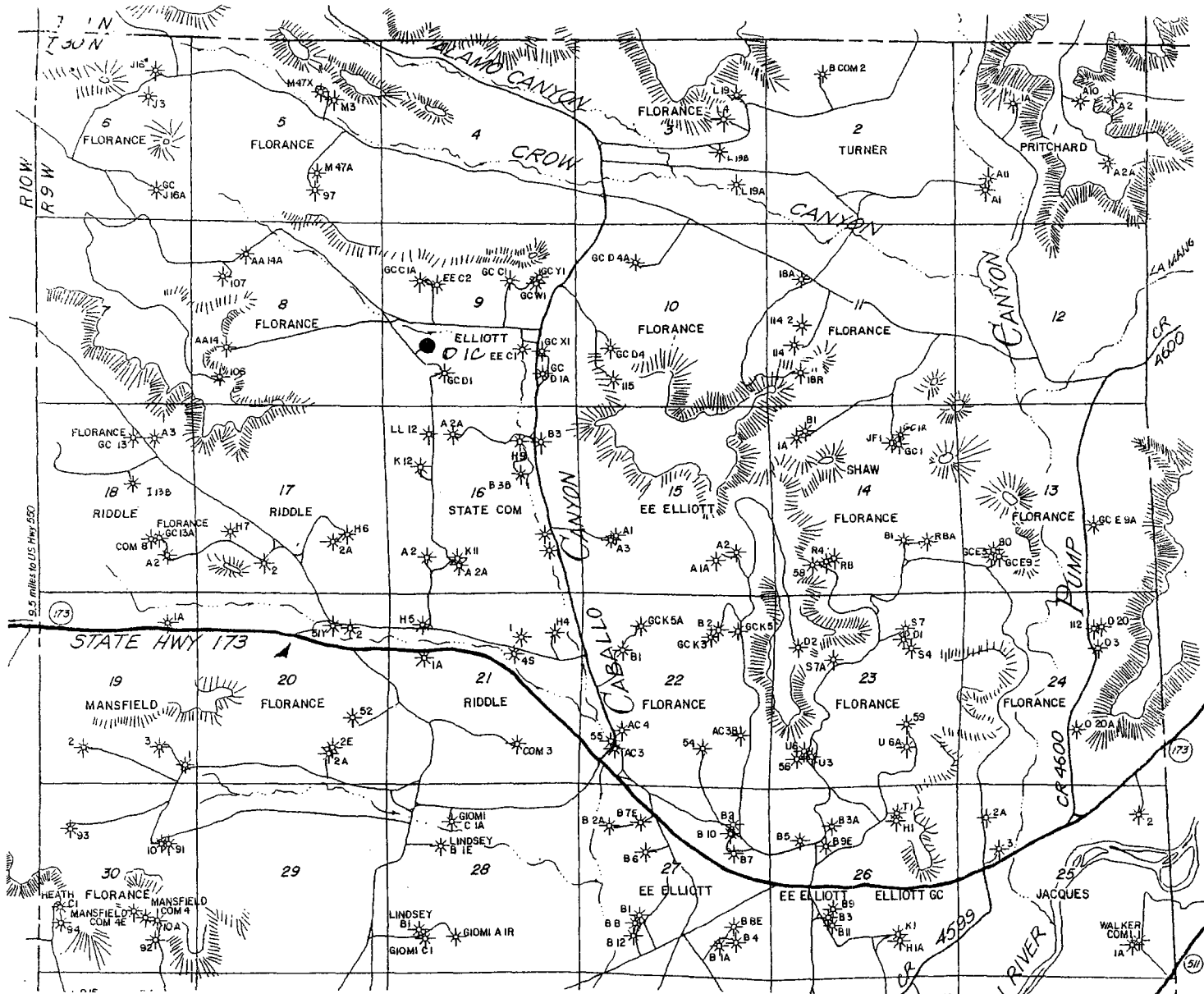

LAT: 36°49.4'

LONG: 107°47.5'

BP AMERICA PRODUCTION COMPANY

Elliott Gas Com D # 1C

SW¼ Sec. 9, T30N, R9W, NMPM

RAIL POINT:

MUD POINT:

CEMENT POINT:

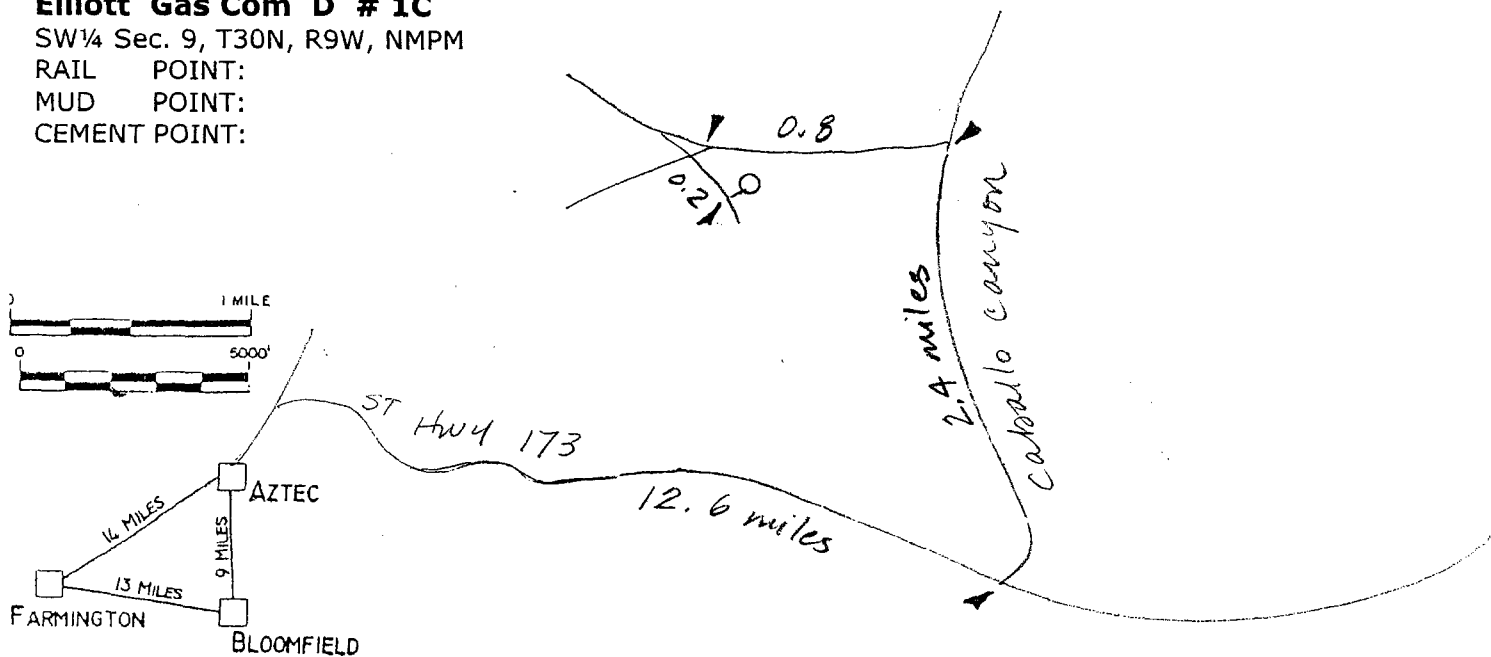

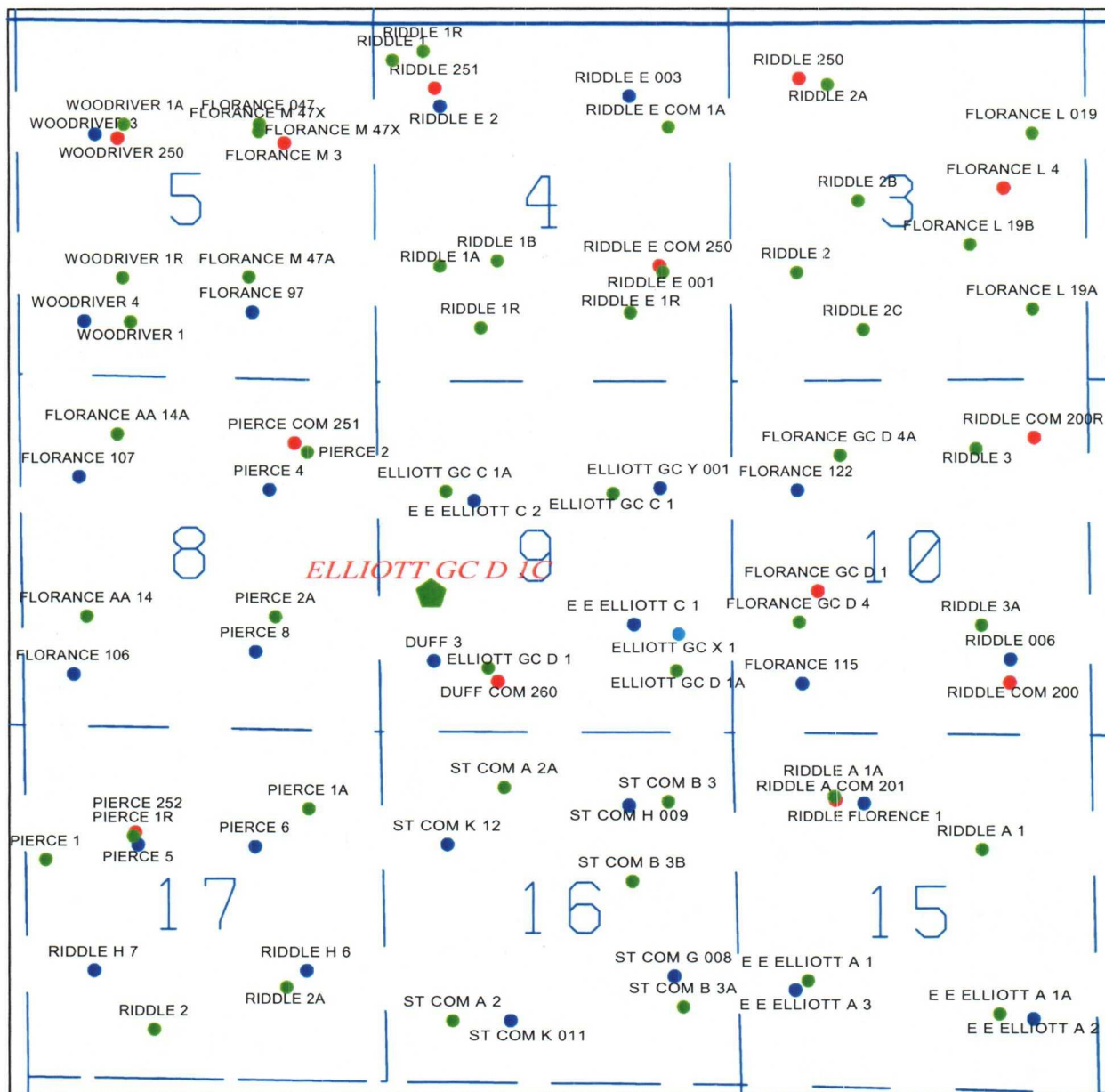

- Fruitland Coal
- Pictured Cliffs
- Mesaverde
- Dakota

BP America Production Co.
Houston, TX

San Juan Basin
T30N R09W Sec. 9
Elliott GC D 1C

SCALE: _____ DRAWN BY: M. J. RITZ DATE: 13-MAY-2004

CHECKED BY: _____