

DATE IN 4/17/03	5/2/03	ENGINEER DRC	LOGGED IN KV	TYPE SWD	PKR/V0311234114
--------------------	--------	-----------------	-----------------	-------------	-----------------

ABOVE THIS LINE FOR DIVISION USE ONLY

## NEW MEXICO OIL CONSERVATION DIVISION

- Engineering Bureau -

1220 South St. Francis Drive, Santa Fe, NM 87505



880

### ADMINISTRATIVE APPLICATION CHECKLIST

THIS CHECKLIST IS MANDATORY FOR ALL ADMINISTRATIVE APPLICATIONS FOR EXCEPTIONS TO DIVISION RULES AND REGULATIONS WHICH REQUIRE PROCESSING AT THE DIVISION LEVEL IN SANTA FE

#### Application Acronyms:

[NSL-Non-Standard Location] [NSP-Non-Standard Proration Unit] [SD-Simultaneous Dedication]  
 [DHC-Downhole Commingling] [CTB-Lease Commingling] [PLC-Pool/Lease Commingling]  
 [PC-Pool Commingling] [OLS - Off-Lease Storage] [OLM-Off-Lease Measurement]  
 [WFX-Waterflood Expansion] [PMX-Pressure Maintenance Expansion]  
 [SWD-Salt Water Disposal] [IPI-Injection Pressure Increase]  
 [EOR-Qualified Enhanced Oil Recovery Certification] [PPR-Positive Production Response]

#### [1] TYPE OF APPLICATION - Check Those Which Apply for [A]

[A] Location - Spacing Unit - Simultaneous Dedication  
☐ NSL ☐ NSP ☐ SD

Check One Only for [B] or [C]

[B] Commingling - Storage - Measurement  
☐ DHC ☐ CTB ☐ PLC ☐ PC ☐ OLS ☐ OLM

[C] Injection - Disposal - Pressure Increase - Enhanced Oil Recovery  
☐ WFX ☐ PMX ☒ SWD ☐ IPI ☐ EOR ☐ PPR

[D] Other: Specify \_\_\_\_\_

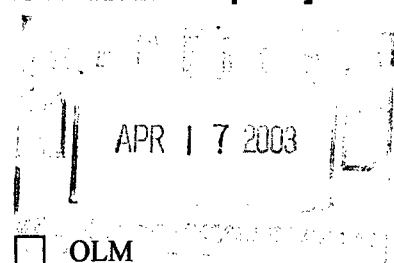

#### [2] NOTIFICATION REQUIRED TO: - Check Those Which Apply, or ☐ Does Not Apply

- [A] ☐ Working, Royalty or Overriding Royalty Interest Owners
- [B] ☒ Offset Operators, Leaseholders or Surface Owner
- [C] ☒ Application is One Which Requires Published Legal Notice
- [D] ☒ Notification and/or Concurrent Approval by BLM or SLO  
 U.S. Bureau of Land Management - Commissioner of Public Lands, State Land Office
- [E] ☒ For all of the above, Proof of Notification or Publication is Attached, and/or,
- [F] ☐ Waivers are Attached

#### [3] SUBMIT ACCURATE AND COMPLETE INFORMATION REQUIRED TO PROCESS THE TYPE OF APPLICATION INDICATED ABOVE.

[4] **CERTIFICATION:** I hereby certify that the information submitted with this application for administrative approval is **accurate** and **complete** to the best of my knowledge. I also understand that **no action** will be taken on this application until the required information and notifications are submitted to the Division.

Note: Statement must be completed by an individual with managerial and/or supervisory capacity.

Michael Prichard  
 Print or Type Name

Signature

Title

Agent

4/1/03  
 Date

e-mail Address

RECEIVED

APR 17 2003

OIL CONSERVATION  
DIVISION

Hal J. Rasmussen Operating  
Greg Rasmussen  
550 W. Texas  
Suite 200  
Midland, Tx 79701  
915-687-1664

April 1, 2003

David Catanach  
State of New Mexico  
Oil Conservation Division  
1220 So. St. Francis Drive  
Santa Fe, New Mexico 87505

Dear Mr. Catanach,

(30-025-33021)

Please find enclosed a copy of form C108(Application for Authority Inject) for the Gecko 27 State # 1 located in Unit "A" of Section 27, T15S, R38E, Lea County, New Mexico.

Should have any questions, please feel free to contact Greg Rasmussen at 915-687-1664.

Sincerely,



Michael Prichard  
Agent

**APPLICATION FOR AUTHORIZATION TO INJECT**

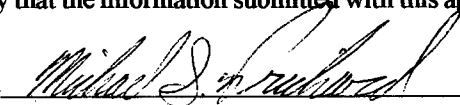
- I. PURPOSE: \_\_\_\_\_ Secondary Recovery \_\_\_\_\_ Pressure Maintenance ☒ Disposal \_\_\_\_\_ Storage  
Application qualifies for administrative approval? ☒ Yes \_\_\_\_\_ No
- II. OPERATOR: Hal J. Rasmussen Operating Ogrid 9809  
ADDRESS: 550 W. Texas Suite 200 Midland, TX 79701  
CONTACT PARTY: Greg Rasmussen PHONE: 915-687-1664
- III. WELL DATA: Complete the data required on the reverse side of this form for each well proposed for injection.  
Additional sheets may be attached if necessary.
- IV. Is this an expansion of an existing project? \_\_\_\_\_ Yes ☒ No  
If yes, give the Division order number authorizing the project: \_\_\_\_\_
- V. Attach a map that identifies all wells and leases within two miles of any proposed injection well with a one-half mile radius circle drawn around each proposed injection well. This circle identifies the well's area of review.
- VI. Attach a tabulation of data on all wells of public record within the area of review which penetrate the proposed injection zone. Such data shall include a description of each well's type, construction, date drilled, location, depth, record of completion, and a schematic of any plugged well illustrating all plugging detail.
- VII. Attach data on the proposed operation, including:
1. Proposed average and maximum daily rate and volume of fluids to be injected;
  2. Whether the system is open or closed;
  3. Proposed average and maximum injection pressure;
  4. Sources and an appropriate analysis of injection fluid and compatibility with the receiving formation if other than reinjected produced water; and,
  5. If injection is for disposal purposes into a zone not productive of oil or gas at or within one mile of the proposed well, attach a chemical analysis of the disposal zone formation water (may be measured or inferred from existing literature, studies, nearby wells, etc.).
- \*VIII. Attach appropriate geologic data on the injection zone including appropriate lithologic detail, geologic name, thickness, and depth. Give the geologic name, and depth to bottom of all underground sources of drinking water (aquifers containing waters with total dissolved solids concentrations of 10,000 mg/l or less) overlying the proposed injection zone as well as any such sources known to be immediately underlying the injection interval.
- IX. Describe the proposed stimulation program, if any.
- \*X. Attach appropriate logging and test data on the well. (If well logs have been filed with the Division, they need not be resubmitted).
- \*XI. Attach a chemical analysis of fresh water from two or more fresh water wells (if available and producing) within one mile of any injection or disposal well showing location of wells and dates samples were taken.
- XII. Applicants for disposal wells must make an affirmative statement that they have examined available geologic and engineering data and find no evidence of open faults or any other hydrologic connection between the disposal zone and any underground sources of drinking water.
- XIII. Applicants must complete the "Proof of Notice" section on the reverse side of this form.
- XIV. Certification: I hereby certify that the information submitted with this application is true and correct to the best of my knowledge and belief.  
NAME: Michael Prichard  TITLE: Agent  
SIGNATURE: \_\_\_\_\_ DATE: 04/01/2003
- \* If the information required under Sections VI, VIII, X, and XI above has been previously submitted, it need not be resubmitted. Please show the date and circumstances of the earlier submittal: \_\_\_\_\_

**C-108 Application for Authorization to Inject  
Hal J. Rasmussen  
Gecko 27 State # 1  
660' FNL X 660' FEL  
UL A, Section 27, T15S, R38E  
Lea County, New Mexico**

- 1. The purpose of this application is to re-enter the Gecko 27 State # 1 plugged by Gecko Inc in 1995. Drill out cement plugs to the TD of 11183 feet, Run 5 ½" 17# & 20# casing and land at 9850ft, Top of 5 ½" casing at 4700ft, Cement casing with 760 sx Class H cement. Drill out plugs. Run 5 ½" packer and plastic lined 3 ½" tubing. Displace annulus with packer fluid. Set packer at 9800ft. Run MIT and dispose of produced water from the Devonian to the open hole from 9850-11183 in the Pennsylvanian..**
- 2. Hal J. Rasmussen Operating  
550 W. Texas Suite 200  
Midland , Texas 79701  
Greg Rasmussen (915) 687-1664**
- 3 Well Data: See Attachment A**
- 4. This is not an expansion of existing project**
- 5. See attached map, Attachment B.**
- 6. There are "NO" active wells in the area of review that penetrate the proposed injection interval. There is 1 plugged and abandoned well that penetrate the interval in the area of review. See attached list and wellbore schematics. Attachment C**
- 7. Proposed average daily injection volumes approximately 6000 BWPD  
Maximum daily injection volume approximately 6500 BWPD**
- 8. This will be a closed system.**
- 9. Proposed average injection pressure 750 psig  
Proposed maximum injection pressure 2000 psig**
- 10. Sources of disposed water would be produced water from the Devonian**
- 11. Disposal interval is Pennsylvanian 9816-11183 ft**
- 12. Underground water sources of drinking water are the alluvial fill from surface to 350ft.**

- A. There are several water wells in the area of review.**
- B. No fresh water samples were caught.**

**13. The disposal interval may be acidized in the future with 15% HCL acid**

AFFIDAVIT OF PUBLICATION

State of New Mexico,  
County of Lea.

I, KATHI BEARDEN

Publisher

of the Hobbs News-Sun, a  
newspaper published at  
Hobbs, New Mexico, do solemnly  
swear that the clipping attached  
hereto was published once a  
week in the regular and entire  
issue of said paper, and not a  
supplement thereof for a period.

of 1  
\_\_\_\_\_ weeks.

Beginning with the issue dated

April 3 2003  
and ending with the issue dated

April 3 2003

Kathi Bearden

Publisher

Sworn and subscribed to before

me this 3rd day of

April 2003

Jodi Benson

Notary Public.

My Commission expires  
October 18, 2004  
(Seal)

Legal Notice  
April 3, 2003

Hal J. Rasmussen Operating, 550 W. Texas, Suite 200, Midland, Texas, 79701 has filed form C-108 (Application for Authorization to Inject) with the New Mexico Oil Conservation Division seeking administrative approval for a salt water disposal well. The proposed well is the Gecko 27 State #1 located 660' FNL & 660' FEL of Section 27, Township 15 South, Range 38 East of Lea County, New Mexico, will be used for salt water disposal. Produced waters from the Devonian will be disposed into the Pennsylvanian at a depth of 9850 feet to 11183 feet with a maximum pressure of 2000 psi and a maximum rate of 6000 BWPD.

All interested parties opposing the aforementioned must file objections or requests for a hearing with the Oil Conservation Division, 1220 South Francis Drive, Santa Fe, New Mexico 87505-5472, within 15 days. Additional information can be obtained by contacting Greg Rasmussen at (915)687-1664.

#19704

This newspaper is duly qualified to publish legal notices or advertisements within the meaning of Section 3, Chapter 167, Laws of 1937, and payment of fees for said publication has been made.

67100757000

67512632

Pueblo West LLC  
1218 W. Pueblo  
Hobbs, NM 88240

GL 3712'

Gecko Inc

Gecko 27 State #1

API 30-025-33021

UL A, Sec 27, T15S, R38E

660' FNL X 660' FEL

Plugged in 1995

13 3/8" 54.5" ± 68"

csg set @ 420

cmt w/ 4255x

Cmt Circ

Well is currently  
Plugged

Cmt Plug 1000'-1100' w/ 35sx

9 5/8" 36" ± 40"

csg set @ 4918'

cmt w/ 1440sx

Toe 650 by TS

Cmt Plug 4855'-4955' w/ 35sx

Attachment A

Cmt plug 7395'-7495' w/ 30sx

Cmt plug 9110'-9280' w/ 30sx

Cmt Plug 11182'-11282' w/ 30sx

TD 11283

**Proposed SWD Well****GECKO 27 STATE No. 1 SWD**

GL: 3712' KB:

660' FNL & 660' FEL  
 Sec 27, T-15S R-38E  
 Lea County, NM

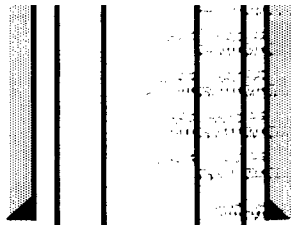

13 3/8" 54.5/68# @ 420' w/ 425 sx

Injection Interval: Penn 9850' - 11,182'

Injection String: 3 1/2" O' - 9860'  
 Pkr @ 9860'

Max Inj Pressure: 2000 psi

Max Inj Rate: 6,000 BPD

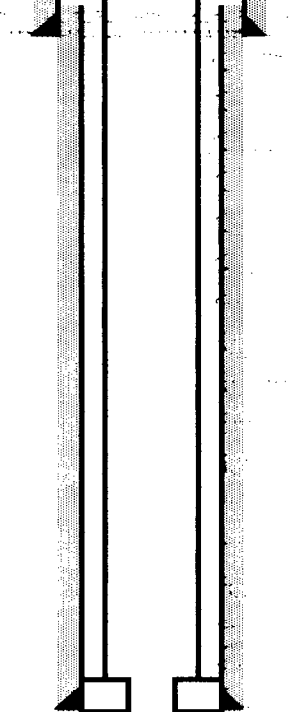

9 5/8" 36/40# @ 4918' w/ 1440 sx  
 TOC: 650 by TS

Surface Owner: State of New Mexico

## Formation Tops

Rustler	2200
Yates	3280
Seven Rivers	3450
San Andres	4830
Glorietta	6363
Upper Clearfork	6920
Tubb	7517
Lower Clearfork	7676
Abo	8217
Wolfcamp	9290
Pennsylvanian	9816
Lower Miss	11938
Woodford Shale	12670
Devonian	12780

5 1/2" 17# 4700' - 9850' w/ 756 sx "H"

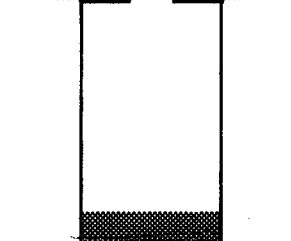

Cmt Plug 11,182' - 11,282' w/ 30' sx

TD: 11,283'





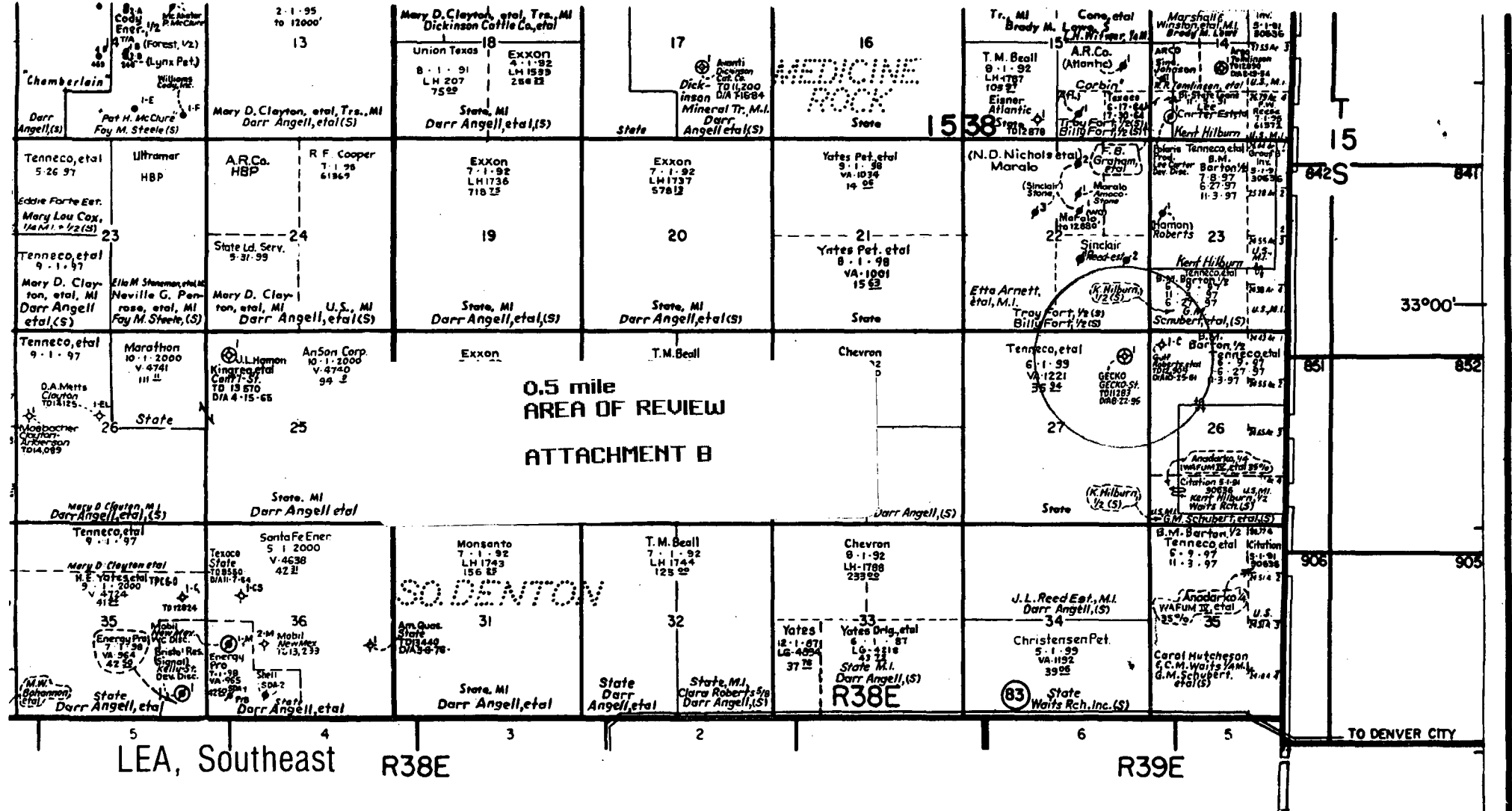

se and Fee Information

ted to: 7-20-96

on Commission Well Information

ted to JUL 31 1996

e Sold JUL 31 1996

103°10'

103°05'

U.S. Postal Service  
**CERTIFIED MAIL RECEIPT**  
(Domestic Mail Only; No Insurance Coverage Provided)

Article Sent To:

Darr Angel  
LOVINGTON NM 88260

UNIT ID: 0640

Postage	\$ 1.85
Certified Fee	2.30
Return Receipt Fee (Endorsement Required)	1.75
Restricted Delivery Fee (Endorsement Required)	
Total Postage & Fees	\$ 4.88

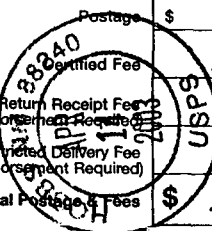

Postmark  
Here  
Clerk: BJF140

04/14/03

DARR ANGEL  
PO BOX 190  
LOVINGTON NM 88260

U.S. Postal Service  
**CERTIFIED MAIL RECEIPT**  
(Domestic Mail Only; No Insurance Coverage Provided)

Article Sent To:

State Land Office  
SANTA FE NM 87504

UNIT ID: 0640

Postage	\$ 1.85
Certified Fee	2.30
Return Receipt Fee (Endorsement Required)	1.75
Restricted Delivery Fee (Endorsement Required)	
Total Postage & Fees	\$ 4.88

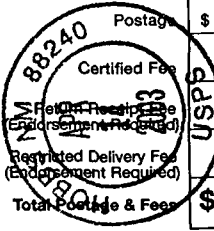

Postmark  
Here  
Clerk: BJF140

04/14/03

STATE LAND OFFICE  
POB 1148  
SANTA FE NM 87504-1148

*Attachment C*

**No Active wells in AOR**

**Plugged wells in AOR**

**Gulf Oil Corporation  
Clara M Roberts etal "C" # 1  
API # 30-025-07265  
330 FNL X 330 FWL  
Unit Letter D, Section 26, T15S, R38E  
Lea County, New Mexico  
Drilled and abandoned in 1961  
See attached Well bore schematic**

**Surface owner  
State of New Mexico  
New Mexico State Land Office  
PO Box 1148  
Santa Fe, New Mexico 87504-1148**

**Leasee  
Darr Angel  
PO Box 190  
Lovington, New Mexico 88260**

Gulf Oil Corp  
Clara M Roberts ETAL C #1  
API 30-025-07265  
ULD, Sec 26, T15S, R38E  
330 FNL X 330 FWL

Plugged in 1961

13 3/8" 48# csq set @ 320'  
Cmt w/ 350sx  
Cmt Circ

Cmt Plug 300'-400'  
100SX

Cut + Pull 1218' of 9 5/8 csq  
Cmt Plug 1150-1250' w/ 100SX

9 5/8" 36#+40# csq set @  
4890' Cmt w/ 525sx cmt

Cmt Plug 4800'-4950' w/ 60SX

Attachment C

7 Cmt Plug 6350'-6450' w/ 40SX

6 Cmt Plug 7450'-7550' w/ 40SX

5 Cmt Plug 8150'-8250' w/ 40SX

4 Cmt Plug 9150-9250 w/ 40SX

3 Cmt Plug 11150-11250 w/ 40SX

2 Cmt Plug 11950-12050 w/ 40SX

1 Cmt Plug 12800-12904 w/ 40SX

TD 12904

**Attachment**

**C-108 application for Authorization to Inject  
Hal J. Rasmussen Operating  
Gecko 27 State # 1  
660 FNL X 660 FEL  
UL A, Section 27, T15S,R38E  
Lea County, New Mexico**

**Available engineering and geologic data have been examined and no evidence of open faults of hydrologic connection between the disposal zone and any underground sources of drinking water have been found.**

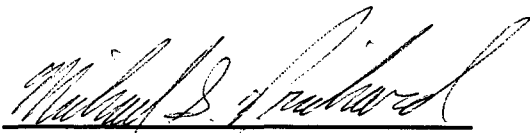
A handwritten signature in dark ink, appearing to read "Michael Prichard", written over a horizontal line.

**Michael Prichard  
Agent  
Hal J. Rasmussen Operating**

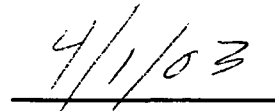
A handwritten date "4/1/03" in dark ink, written over a horizontal line.

**Date**