

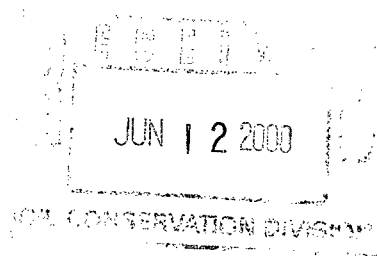

Cross Timbers Oil Company

NSL 01/02/00
7-3-00

June 9, 2000



CERTIFIED MAIL:

Mr. Michael E. Stogner
New Mexico Oil Conservation Division
2040 South Pacheco
Santa Fe, New Mexico 87505

RE: Application for Administrative Approval of Unorthodox Location
Cross Timbers Operating Company's Aztec Com 4 #1 Well
2,045' FWL and 2,370' FNL (SE/4 NW/4)
Unit F, Section 16, T30N-R11W
San Juan County, New Mexico
Basin Dakota Formation

Dear Mr. Stogner:

Cross Timbers Operating Company hereby requests administrative approval for an unorthodox location for the above referenced well. Attached for your reference are the following exhibits:

1. Well location plat (NMOCD Form C-102)
2. Ownership map
3. List of Offset Owners

The above captioned well will be proposed to test the Basin Dakota Formation. The well spacing would be a W/2 Unit consisting of approximately 320 acres. The rules state that the well should not be closer than 790' to any quarter section line, nor closer than 130' to any quarter-quarter section line. The well is unorthodox because it will not conform to the current footage requirements at the proposed location. It is necessary to drill the well in an unorthodox location due to the surface topography.

By certified mail, a copy of this application and request for administrative approval has been sent to all of the Basin Dakota formation working interest owners and offset operators listed on the attached list.

Cross Timbers would like to request your Administration Approval for the unorthodox location based on the above information. Should you need any additional information please feel free to contact me at (817) 885-2454.

Sincerely,
CROSS TIMBERS OPERATING COMPANY

A handwritten signature in black ink, appearing to read "George A. Cox".

George A. Cox, CPL
Landman

Enclosures

cc: Gary Markestad
Darrin Steed
Jeff Patton

District I
PO Box 1980, Hobbs, NM 88241-1980

District II
PO Drawer DD, Artesia, NM 88211-0719

District III
1000 Rio Brazos Rd., Aztec, NM 87410

District IV
PO Box 2088, Santa Fe, NM 87504-2088

State of New Mexico
Energy, Minerals & Natural Resources Department

OIL CONSERVATION DIVISION
PO Box 2088
Santa Fe, NM 87504-2088

Form C-102
Revised February 21, 1994
Instructions on back
Submit to Appropriate District Office
State Lease - 4 Copies
Fee Lease - 3 Copies

☐ AMENDED REPORT

WELL LOCATION AND ACREAGE DEDICATION PLAT

*API Number	*Pool Code 71599	*Pool Name BASIN DAKOTA
*Property Code	*Property Name AZTEC COM 4	*Well Number 1
*GRID No. 167067	*Operator Name CROSS TIMBERS OPERATING COMPANY	*Elevation 5691'

¹⁰ Surface Location

UL or lot no. F	Section 16	Township 30N	Range 11W	Lot Idn	Feet from the 2370	North/South line NORTH	Feet from the 2045	East/West line WEST	County SAN JUAN
--------------------	---------------	-----------------	--------------	---------	-----------------------	---------------------------	-----------------------	------------------------	--------------------

¹¹ Bottom Hole Location If Different From Surface

UL or lot no.	Section	Township	Range	Lot Idn	Feet from the	North/South line	Feet from the	East/West line	County
¹² Dedicated Acres		¹³ Joint or Infill		¹⁴ Consolidation Code		¹⁵ Order No.			

NO ALLOWABLE WILL BE ASSIGNED TO THIS COMPLETION UNTIL ALL INTERESTS HAVE BEEN CONSOLIDATED
OR A NON-STANDARD UNIT HAS BEEN APPROVED BY THE DIVISION

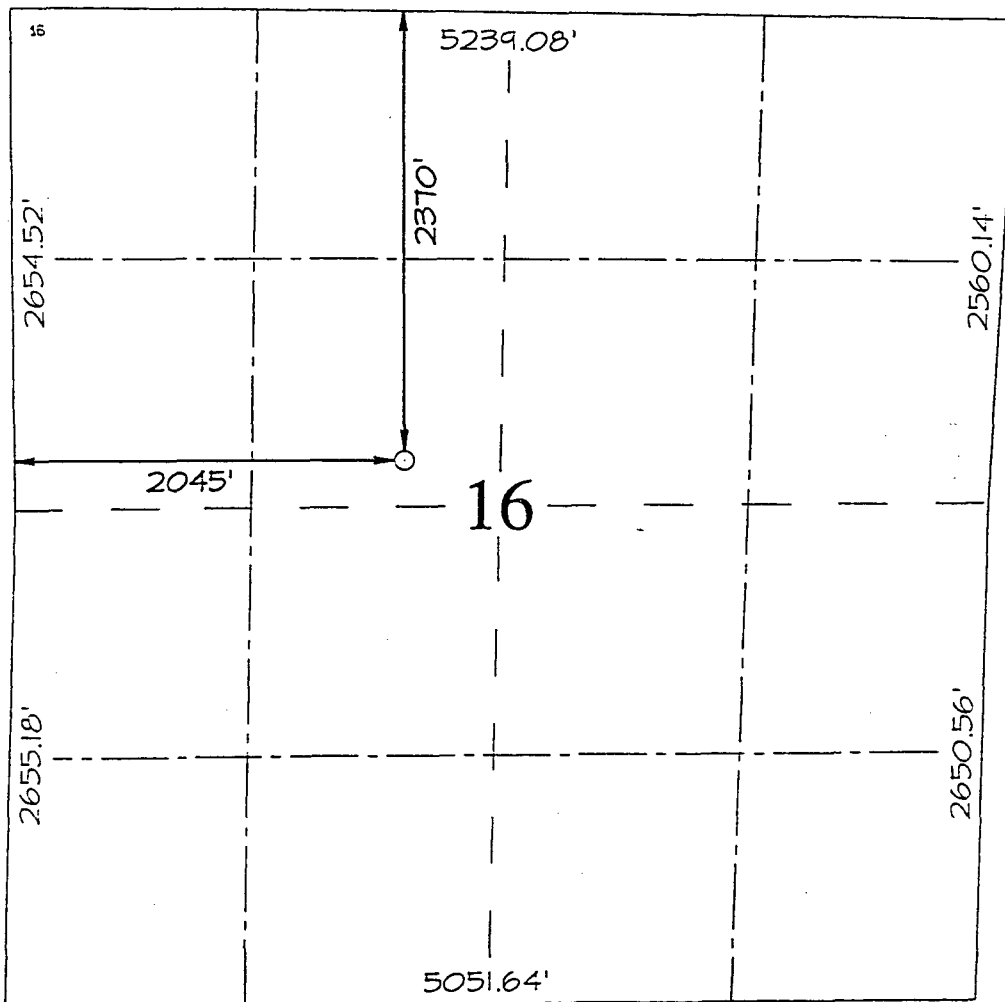

¹⁷ OPERATOR CERTIFICATION

I hereby certify that the information contained herein is true and complete to the best of my knowledge and belief

Jeff Patton
Signature

Jeff Patton
Printed Name

Production Engineer
Title

Date

¹⁸ SURVEYOR CERTIFICATION

I hereby certify that the well location shown on this plat was plotted from field notes of actual surveys made by me or under my supervision, and that the same is true and correct to the best of my belief.

MAY 24, 2000

Date of Survey

Signature and Seal of

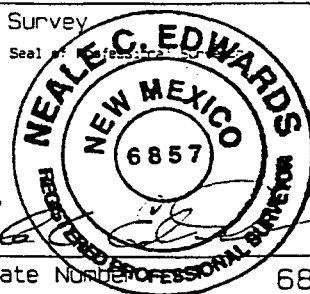

Certificate Number 6857

LATITUDE: 36°48'47"
LONGITUDE: 107°59'53"

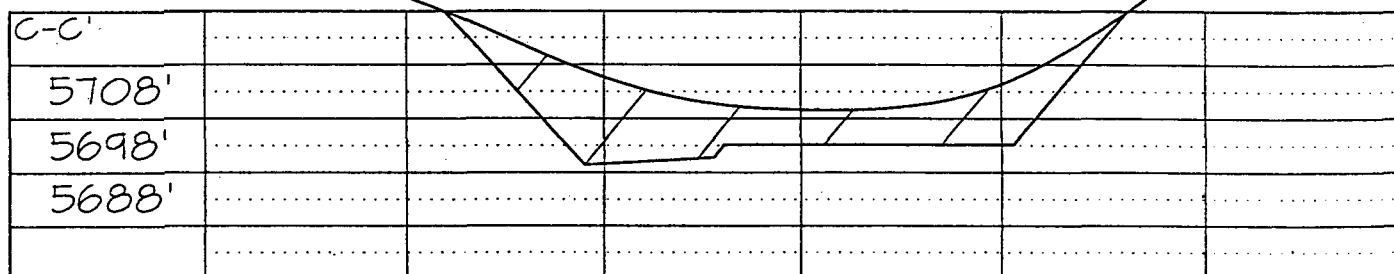
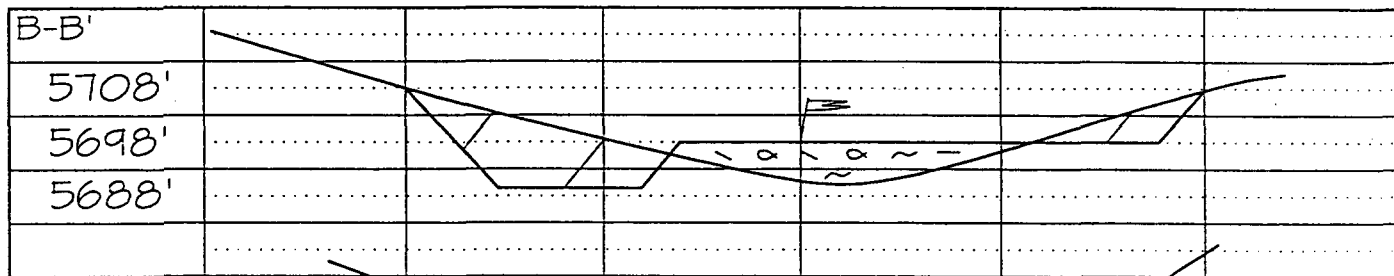
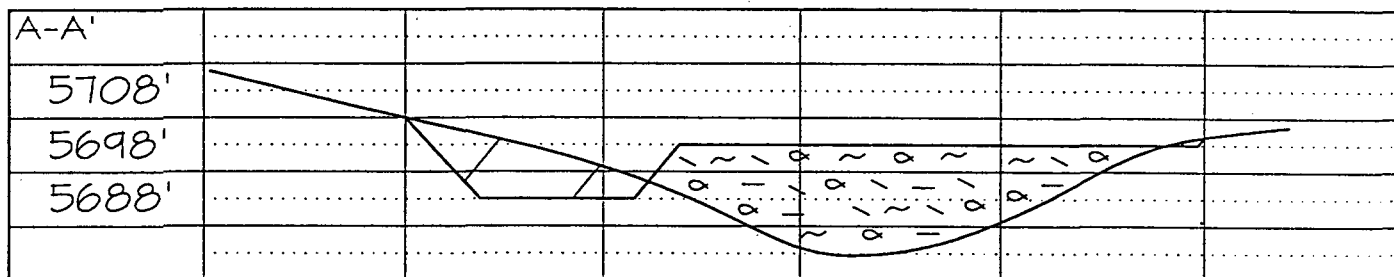
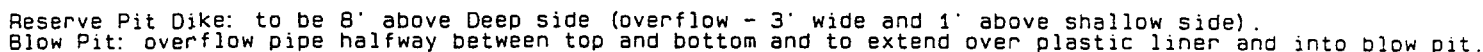

Note: Contractor should call One-Call for location of any marked or unmarked buried pipelines or cables on well pad and/or access road at least two (2) working days prior to construction

CROSS TIMBERS OPERATING COMPANY AZTEC COM 4 #1

2370' FNL & 2045' FWL, SECTION 16, T30N, R11W, N.M.P.M.
SAN JUAN COUNTY, NEW MEXICO

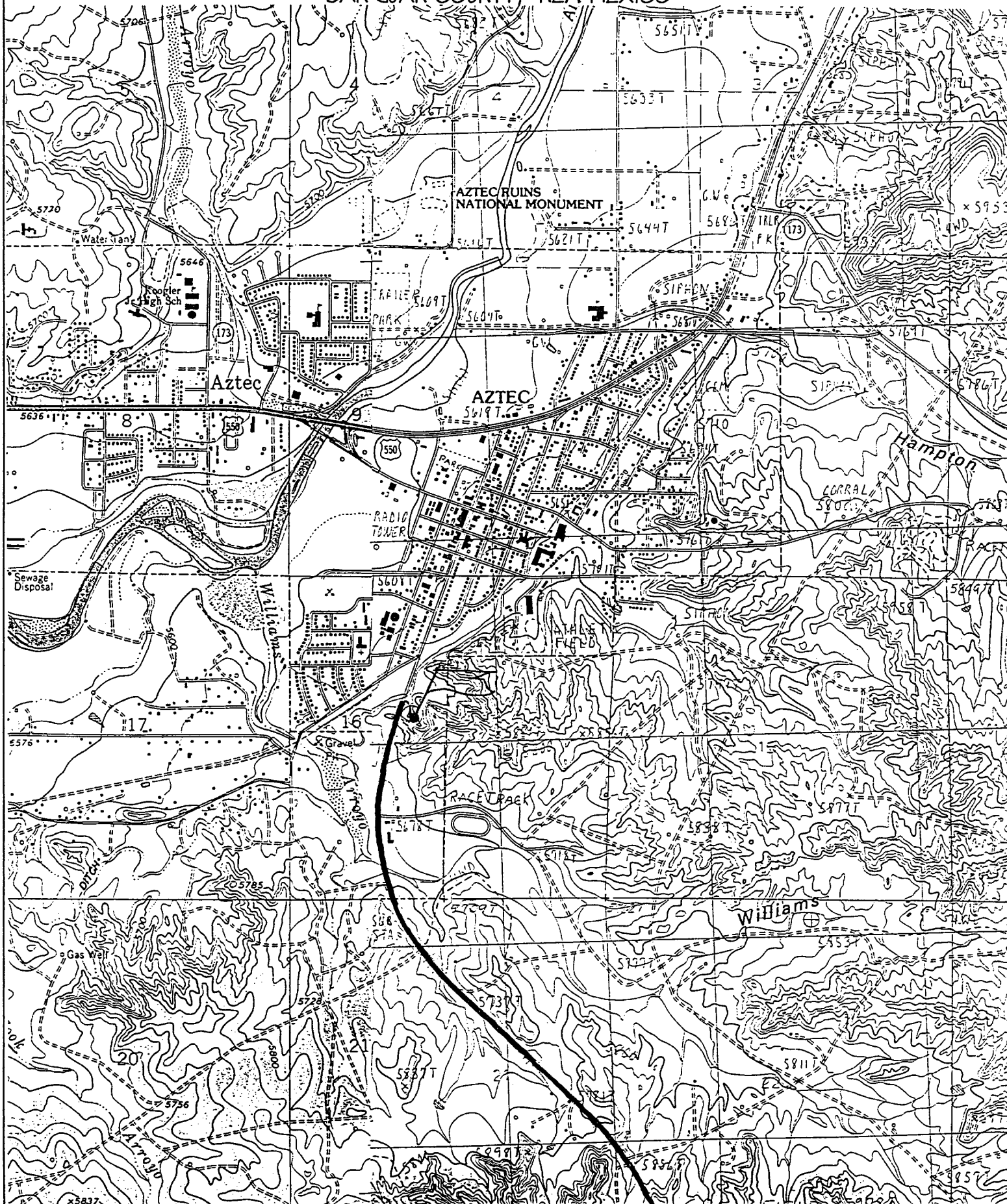

OFFSET OPERATORS AND OWNERS NOTIFICATION LIST
AZTEC COM 4 #1 WELL

Burlington Resources Oil & Gas
P.O. Box 4289
Farmington, NM 87499-4289
Attention: Alan Alexander

Glacier Park Company
c/o Burlington Resources Oil & Gas
P.O. Box 4289
Farmington, NM 87499-4289
Attention: Alan Alexander

Conoco, Inc.
DUBAI Building
600 N. Dairy Ashford
Houston, TX 77079-1175
Attn: William Franklin

Phillips Petroleum Company
5525 Hwy 64, NBU 3004
Farmington, NM 87401
Attention: Scott Prather

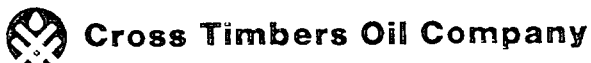

STATE: New Mexico COUNTY: San Juan
PROSPECT: Ownership for Dakota Formation DATE: 6/8/2000
SECTIONS: 16 BLOCK: _____ SURVEY: _____
ACRES: _____ TOWNSHIP: 30N RANGE: 11W

Aztec Com 4#1

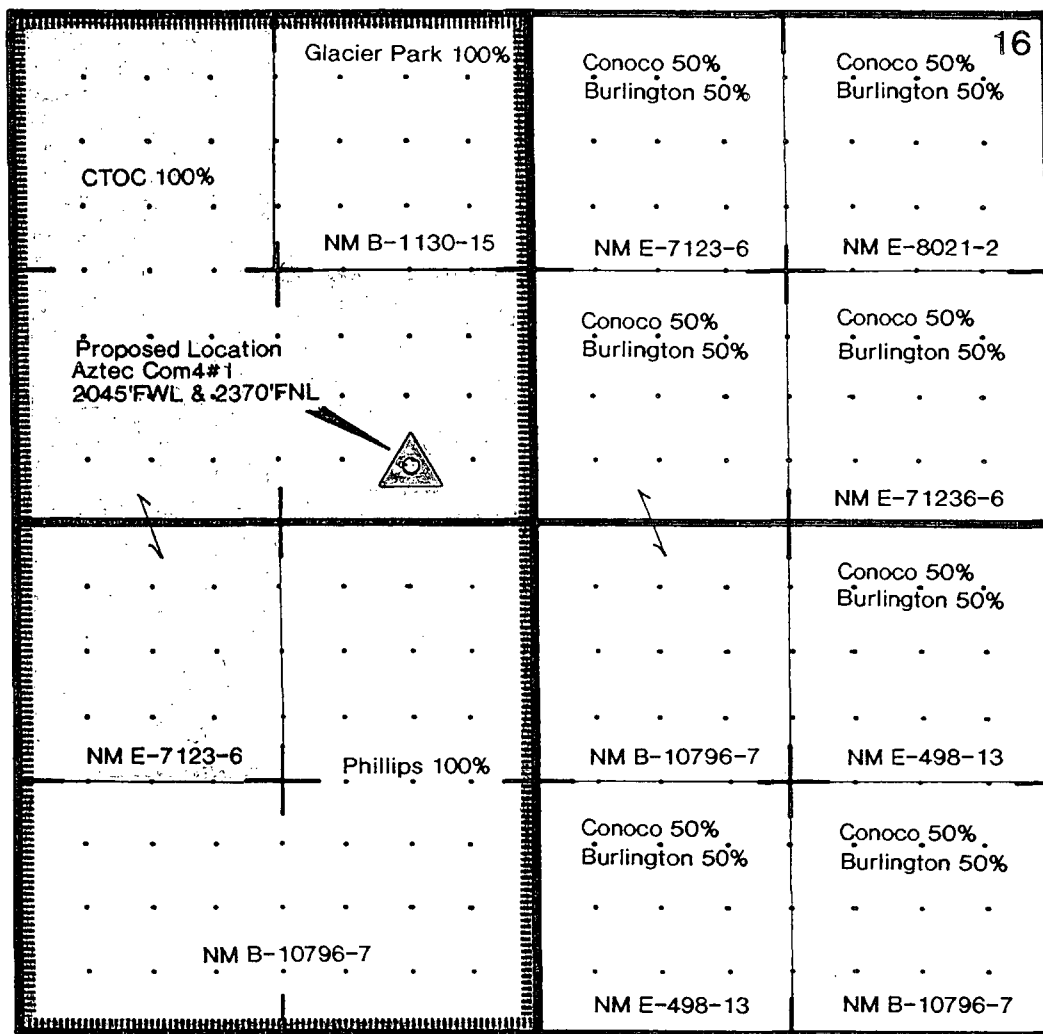

SENDER: COMPLETE THIS SECTION

- Complete items 1, 2, and 3. Also complete item 4 if Restricted Delivery is desired.
- Print your name and address on the reverse so that we can return the card to you.
- Attach this card to the back of the mailpiece, or on the front if space permits.

1. Article Addressed to:

Glacier Park Company
c/o Burlington Resources Oil & Gas Co.
P.O. Box 4289
Farmington, NM 87499-4289
GC - 6/9/00 - Aztec Com 4#1

2. Article Number (Copy from service label)

COMPLETE THIS SECTION ON DELIVERY

A. Received by (Please Print Clearly) B. Date of Delivery

C. Signature

X

☐ Agent☐ AddresseeD. Is delivery address different from item 1? ☐ YesIf YES, enter delivery address below: ☐ No

3. Service Type

☒ Certified Mail☐ Express Mail☐ Registered☐ Return Receipt for Merchandise☐ Insured Mail☐ C.O.D.

4. Restricted Delivery? (Extra Fee)

☐ Yes

PS Form 3811, July 1999

Domestic Return Receipt

102595-99-M-1789

Z 225 600 182

SENDER: COMPLETE THIS SECTION

- Complete items 1, 2, and 3. Also complete item 4 if Restricted Delivery is desired.
- Print your name and address on the reverse so that we can return the card to you.
- Attach this card to the back of the mailpiece, or on the front if space permits.

1. Article Addressed to:

Burlington Resources Oil & Gas Co.
Attn: Alan Alexander
P.O. Box 4289
Farmington, NM 87499-4289
GC - 6/9/00 - Aztec Com 4#1

2. Article Number (Copy from service label)

COMPLETE THIS SECTION ON DELIVERY

A. Received by (Please Print Clearly) B. Date of Delivery

C. Signature

X

☐ Agent☐ AddresseeD. Is delivery address different from item 1? ☐ YesIf YES, enter delivery address below: ☐ No

3. Service Type

☒ Certified Mail☐ Express Mail☐ Registered☐ Return Receipt for Merchandise☐ Insured Mail☐ C.O.D.

4. Restricted Delivery? (Extra Fee)

☐ Yes

PS Form 3811, July 1999

Domestic Return Receipt

102595-99-M-1789

Z 225 600 181

SENDER: COMPLETE THIS SECTION

- Complete items 1, 2, and 3. Also complete item 4 if Restricted Delivery is desired.
- Print your name and address on the reverse so that we can return the card to you.
- Attach this card to the back of the mailpiece, or on the front if space permits.

1. Article Addressed to:

Phillips Petroleum Company
5525 Hwy 64, NBU 3004
Farmington, NM 87401
Attn: Scott Prather
GC - 6/9/00 - Aztec Com 4#1

COMPLETE THIS SECTION ON DELIVERY

A. Received by (Please Print Clearly) B. Date of Delivery

C. Signature

X

☐ Agent
☐ AddresseeD. Is delivery address different from item 1? ☐ YesIf YES, enter delivery address below: ☐ No

3. Service Type

- ☒ Certified Mail ☐ Express Mail
☐ Registered ☐ Return Receipt for Merchandise
☐ Insured Mail ☐ C.O.D.

4. Restricted Delivery? (Extra Fee) ☐ Yes

2. Article Number (Copy from service label)

2 225 600 184

PS Form 3811, July 1999

Domestic Return Receipt

102595-99-M-1789

SENDER: COMPLETE THIS SECTION

- Complete items 1, 2, and 3. Also complete item 4 if Restricted Delivery is desired.
- Print your name and address on the reverse so that we can return the card to you.
- Attach this card to the back of the mailpiece, or on the front if space permits.

1. Article Addressed to:

Conoco, Inc. -Houston
600 N. Dairy Ashford, Dubai 3092
Houston, Texas 77079
ATTN: William Franklin
GC - 6/9/00 - Aztec Com 4#1

COMPLETE THIS SECTION ON DELIVERY

A. Received by (Please Print Clearly) B. Date of Delivery

C. Signature

X

☐ Agent
☐ AddresseeD. Is delivery address different from item 1? ☐ YesIf YES, enter delivery address below: ☐ No

3. Service Type

- ☒ Certified Mail ☐ Express Mail
☐ Registered ☐ Return Receipt for Merchandise
☐ Insured Mail ☐ C.O.D.

4. Restricted Delivery? (Extra Fee) ☐ Yes

2. Article Number (Copy from service label)

2 225 600 183

PS Form 3811, July 1999

Domestic Return Receipt

102595-99-M-1789



Cross Timbers Oil Company

June 9, 2000

CERTIFIED MAIL:

Burlington Resources Oil & Gas
P.O. Box 4289
Farmington, NM 87499-4289
Attention: Alan Alexander

RE: Application for Administrative Approval of Unorthodox Location
Cross Timbers Operating Company's Aztec Com 4 #1 Well
2,045' FWL and 2,370' FNL (SE/4 NW/4)
Unit F, Section 16, T30N-R11W
San Juan County, New Mexico
Basin Dakota Formation

Gentlemen:

Enclosed please find a copy of the above captioned application that has been sent to the NMOCD for administrative approval. Should you not agree with the request, please notify the NMOCD within 20 days of the date of this application. Should you have any questions, concerning the operations, please feel free to contact me at (817) 885-2454.

Sincerely,
CROSS TIMBERS OIL COMPANY



George A. Cox, CPL

Landman

Enclosures



Cross Timbers Oil Company

June 9, 2000

CERTIFIED MAIL:

Conoco, Inc.
DUBAI Building
600 N. Dairy Ashford
Houston, TX 77079-1175
Attn: William Franklin

RE: Application for Administrative Approval of Unorthodox Location
Cross Timbers Operating Company's Aztec Com 4 #1 Well
2,045' FWL and 2,370' FNL (SE/4 NW/4)
Unit F, Section 16, T30N-R11W
San Juan County, New Mexico
Basin Dakota Formation

Gentlemen:

Enclosed please find a copy of the above captioned application that has been sent to the NMOCD for administrative approval. Should you not agree with the request, please notify the NMOCD within 20 days of the date of this application. Should you have any questions, concerning the operations, please feel free to contact me at (817) 885-2454.

Sincerely,
CROSS TIMBERS OIL COMPANY

George A. Cox, CPL
Landman

Enclosures



Cross Timbers Oil Company

June 9, 2000

CERTIFIED MAIL:

Glacier Park Company
c/o Burlington Resources Oil & Gas
P.O. Box 4289
Farmington, NM 87499-4289
Attention: Alan Alexander

RE: Application for Administrative Approval of Unorthodox Location
Cross Timbers Operating Company's Aztec Com 4 #1 Well
2,045' FWL and 2,370' FNL (SE/4 NW/4)
Unit F, Section 16, T30N-R11W
San Juan County, New Mexico
Basin Dakota Formation

Gentlemen:

Enclosed please find a copy of the above captioned application that has been sent to the NMOCD for administrative approval. Should you not agree with the request, please notify the NMOCD within 20 days of the date of this application. Should you have any questions, concerning the operations, please feel free to contact me at (817) 885-2454.

Sincerely,
CROSS TIMBERS OIL COMPANY

George A. Cox, CPL
Landman

Enclosures



Cross Timbers Oil Company

June 9, 2000

CERTIFIED MAIL:

Phillips Petroleum Company
5525 Hwy 64, NBU 3004
Farmington, NM 87401
Attention: Scott Prather

RE: Application for Administrative Approval of Unorthodox Location
Cross Timbers Operating Company's Aztec Com 4 #1 Well
2,045' FWL and 2,370' FNL (SE/4 NW/4)
Unit F, Section 16, T30N-R11W
San Juan County, New Mexico
Basin Dakota Formation

Gentlemen:

Enclosed please find a copy of the above captioned application that has been sent to the NMOCD for administrative approval. Should you not agree with the request, please notify the NMOCD within 20 days of the date of this application. Should you have any questions, concerning the operations, please feel free to contact me at (817) 885-2454.

Sincerely,
CROSS TIMBERS OIL COMPANY

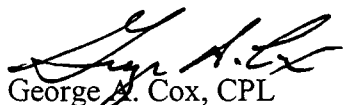

George A. Cox, CPL
Landman

Enclosures