

NEW MEXICO OIL CONSERVATION COMMISSION  
SANTA FE, NEW MEXICO  
APPLICATION FOR MULTIPLE COMPLETION

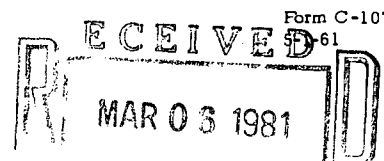

Operator <b>Getty Oil Company</b>		County <b>Rio Arriba</b>		Date <b>SANTA FE</b>
Address <b>P.O. Box 3360, Casper, WY 82602</b>		Lease <b>Jicarilla B</b>		Well No. <b>20E</b>
Location of Well <b>L</b>	Unit <b>31</b>	Section <b>25N</b>	Township <b>5W</b>	Range

1. Has the New Mexico Oil Conservation Commission heretofore authorized the multiple completion of a well in these same pools or in the same zones within one mile of the subject well? YES X NO \_\_\_\_\_
2. If answer is yes, identify one such instance: Order No. \_\_\_\_\_; Operator Lease, and Well No.: Jicarilla B #20E

Getty Oil Company

3. The following facts are submitted:	Upper Zone	Intermediate Zone	Lower Zone
a. Name of Pool and Formation	<u>Gallup</u>		<u>Dakota</u>
b. Top and Bottom of Pay Section (Perforations)	<u>5994'-6310'</u>		<u>7029'-7096'</u>
c. Type of production (Oil or Gas)	<u>Oil</u>		<u>Gas</u>
d. Method of Production (Flowing or Artificial Lift)	<u>Flowing</u>		<u>Flowing</u>

4. The following are attached. (Please check YES or NO)

Yes	No	
<input checked="" type="checkbox"/>	<input type="checkbox"/>	a. Diagrammatic Sketch of the Multiple Completion, showing all casing strings, including diameters and setting depths, centralizers and/or turbolizers and location thereof, quantities used and top of cement, perforated intervals, tubing strings, including diameters and setting depth, location and type of packers and side door chokes, and such other information as may be pertinent.
<input checked="" type="checkbox"/>	<input type="checkbox"/>	b. Plat showing the location of all wells on applicant's lease, all offset wells on offset leases, and the names and addresses of operators of all leases offsetting applicant's lease.
<input checked="" type="checkbox"/>	<input type="checkbox"/>	c. Waivers consenting to such multiple completion from each offset operator, or in lieu thereof, evidence that said offset operators have been furnished copies of the application.*
<input checked="" type="checkbox"/>	<input type="checkbox"/>	d. Electrical log of the well or other acceptable log with tops and bottoms of producing zones and intervals of perforation indicated thereon. (If such log is not available at the time application is filed it shall be submitted as provided by Rule 112-A.)

5. List all offset operators to the lease on which this well is located together with their correct mailing address.

Amerada Hess Corp., Production Dept., P.O. Box 2040, Tulsa, Oklahoma 74102

El Paso Natural Gas Co., Production Dept., P.O. Box 990, Farmington, New Mexico 87401

6. Were all operators listed in Item 5 above notified and furnished a copy of this application? YES X NO \_\_\_\_\_. If answer is yes, give date of such notification 2-20-81.

CERTIFICATE: I, the undersigned, state that I am the Area Engineer of the Getty Oil Company (company), and that I am authorized by said company to make this report; and that this report was prepared under my supervision and direction and that the facts stated therein are true, correct and complete to the best of my knowledge.

Charles E. Mowry  
Signature

\*Should waivers from all offset operators not accompany an application for administrative approval, the New Mexico Oil Conservation Commission will hold the application for a period of twenty (20) days from date of receipt by the Commission's Santa Fe office. If, after said twenty-day period, no protest nor request for hearing is received by the Santa Fe office, the application will then be processed.

NOTE: If the proposed multiple completion will result in an unorthodox well location and/or a non-standard proration unit in one or more of the producing zones, then separate application for approval of the same should be filed simultaneously with this application.

Jicarilla B #20E  
NW SW Section 31-T25N-R5W  
San Juan County, New Mexico

2/19/81

WELLBORE DIAGRAM

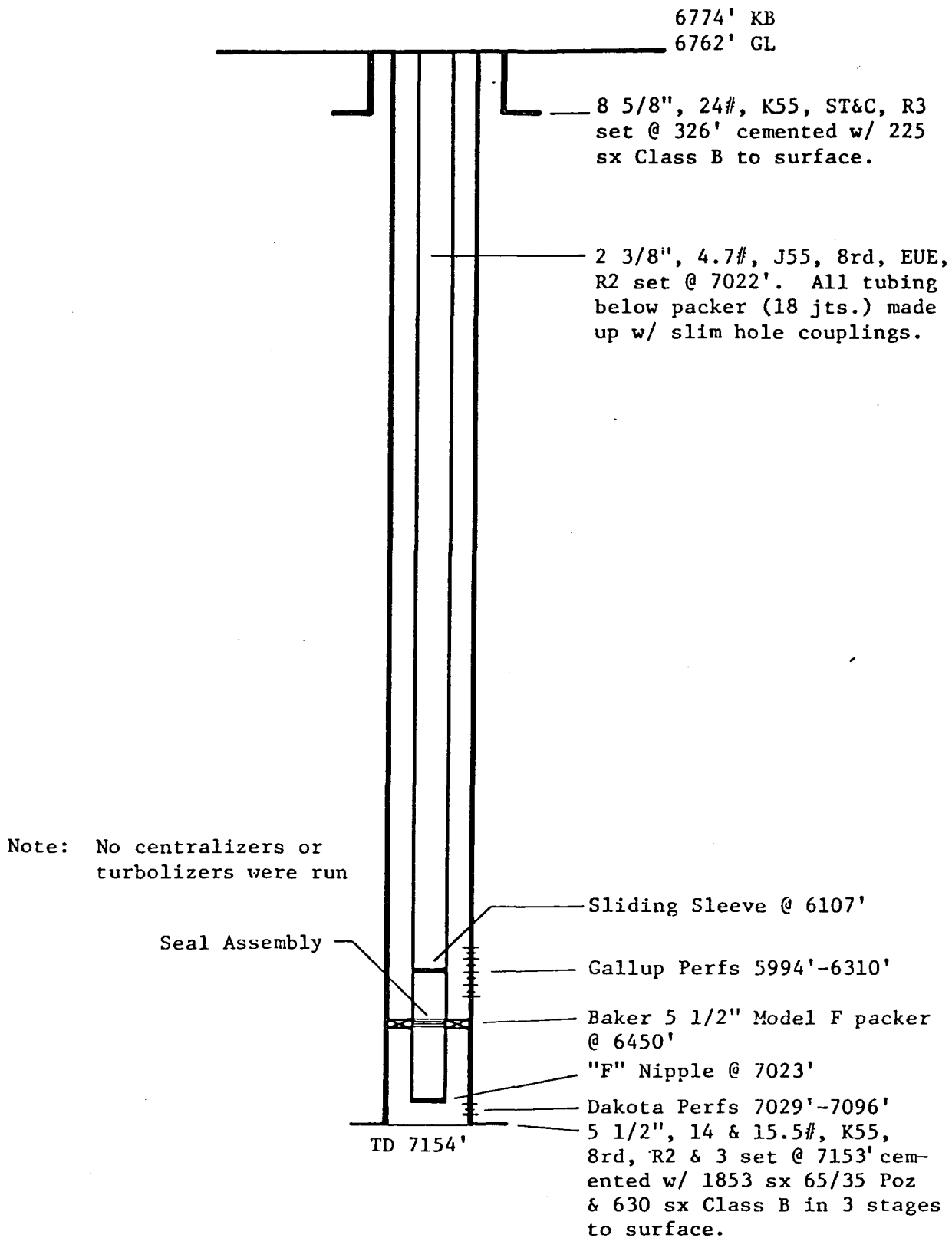

R 6 W

R 5 W

T  
25  
N

T  
24  
N

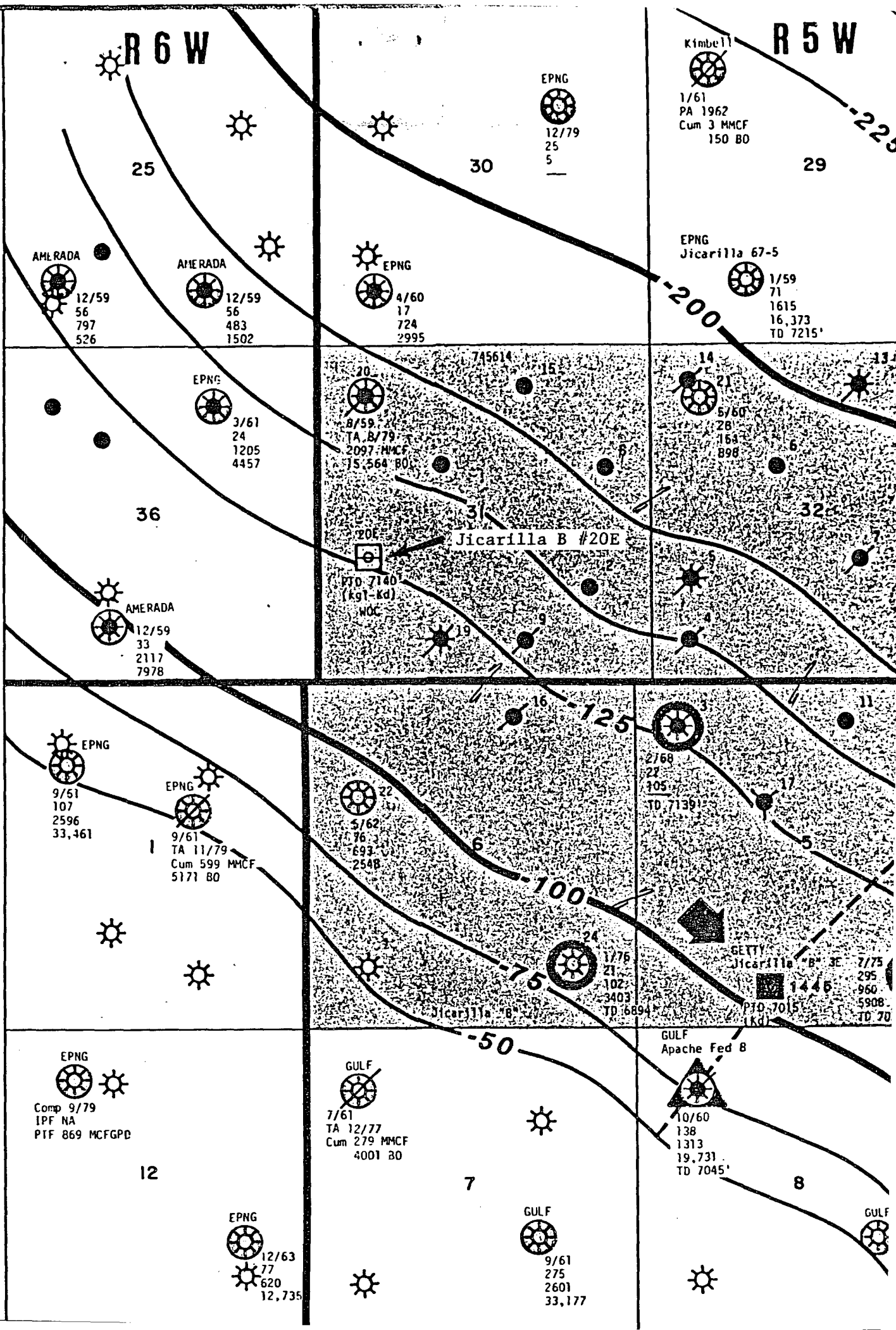

50-216



DENY

Getty Oil Company, P.O. Box 3360, Casper, Wyoming 82602

Central Exploration and Production Division  
El Paso Natural Gas Company  
Production Department  
P.O. Box 990  
Farmington, New Mexico

February 20, 1981



RE: Jicarilla B #20-E  
L Sec. 31-T25N-R5W  
Rio Arriba County, New Mexico

Gentlemen:

Please find attached copies of our Application for Multiple Completion which we are submitting to the New Mexico Oil Conservation Division.

If you as an offset operator, have no objections to the multiple completion of the Gallup and Dakota formations of this well, please sign the waiver at the bottom of this page and send to:

New Mexico Oil Conservation Division  
1000 Rio Brazos Road  
Aztec, New Mexico 87401

We would appreciate your returning one executed copy to the undersigned.

Very truly yours,

GETTY OIL COMPANY

H. E. Aab  
Area Superintendent

JLF/  
Attachments

W A I V E R

We hereby waive any objections to Getty Oil Company's Application for Multiple Completion as set forth above.

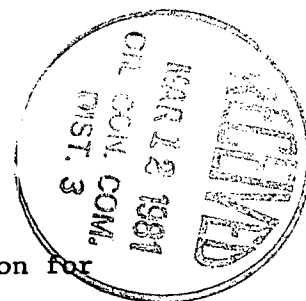

-Regional Land Manager

Name of Person (for Company)

EL PASO NATURAL GAS COMPANY  
March 11, 1981

Date



DENY

To: Dick  
Getty Oil Company, P.O. Box 3360, Casper, Wyoming 82602

Central Exploration and Production Division

February 20, 1981

Amerada Hess Corporation  
Production Department  
P.O. Box 2040  
Tulsa, Oklahoma 74102

RECEIVED

MAR 17 1981

OIL CONSERVATION DIVISION  
SANTA FE

RE: Jicarilla B #20-E  
L Sec. 31-T25N-R5W  
Rio Arriba County, New Mexico

Gentlemen:

Please find attached copies of our Application for Multiple Completion which we are submitting to the New Mexico Oil Conservation Division.

If you as an offset operator, have no objections to the multiple completion of the Gallup and Dakota formations of this well, please sign the waiver at the bottom of this page and send to:

New Mexico Oil Conservation Division  
1000 Rio Brazos Road  
Aztec, New Mexico 87401

We would appreciate your returning one executed copy to the undersigned.

Very truly yours,

GETTY OIL COMPANY

H. E. Aab  
Area Superintendent

JLF/  
Attachments

W A I V E R



We hereby waive any objections to Getty Oil Company's Application for Multiple Completion as set forth above.

Name of Person (for Company)

3-3-81  
Date



Getty Oil Company, P.O. Box 3360, Casper, Wyoming 82602

Central Exploration and Production Division

October 7, 1980

Energy and Minerals Department  
Oil Conservation Division  
P.O. Box 2088  
Santa Fe, New Mexico 87501

Attention: Mr. Joe D. Ramey  
Division Director

Re: Administrative Approval for  
Commingling as per Order No. R-5854

Gentlemen,

We request administrative approval for a commingled Gallup and Dakota completion of the proposed Jicarilla "B" Well No. 20E to be located in Unit L of Section 31 - T25N-R5W, Rio Arriba County, New Mexico.

We expect an initial production rate of approximately 12 BOPD and 80 MCFGPD from the Gallup and 2 BCPD and 100 MCFGPD from the Dakota. Static reservoir pressures are expected to be of about equal magnitude at approximately 1000 psig. Allocation of production will be determined after completion of the well when productivity of the two zones can be gauged.

Enclosed is a schematic of the proposed completion and a map showing the proposed location and offset producing wells with their current production rates and cumulatives.

H. E. Aab  
Area Superintendent

TIM/cs

Enclosures

cc: Mr. Frank Chavez, Supervisor  
New Mexico Oil Conservation Commission  
1000 Rio Brazos Road  
Aztec, New Mexico 87401

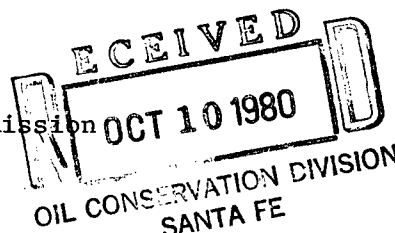

Joe

7/10/81.

Getty called on this again. They have well all set up to produce as ~~the~~ Downhole Commingled. El Paso has hooked up.

---

I called Frank. It turns out Aztec office was confused and now has decided that DHC is O.K. They are waiting for order. Can you give verbal approval today (Monday) while we get order written?

Roy can whip it out. I'm stuck at NMSU's Columbus re-drill & plug operation.

Carl

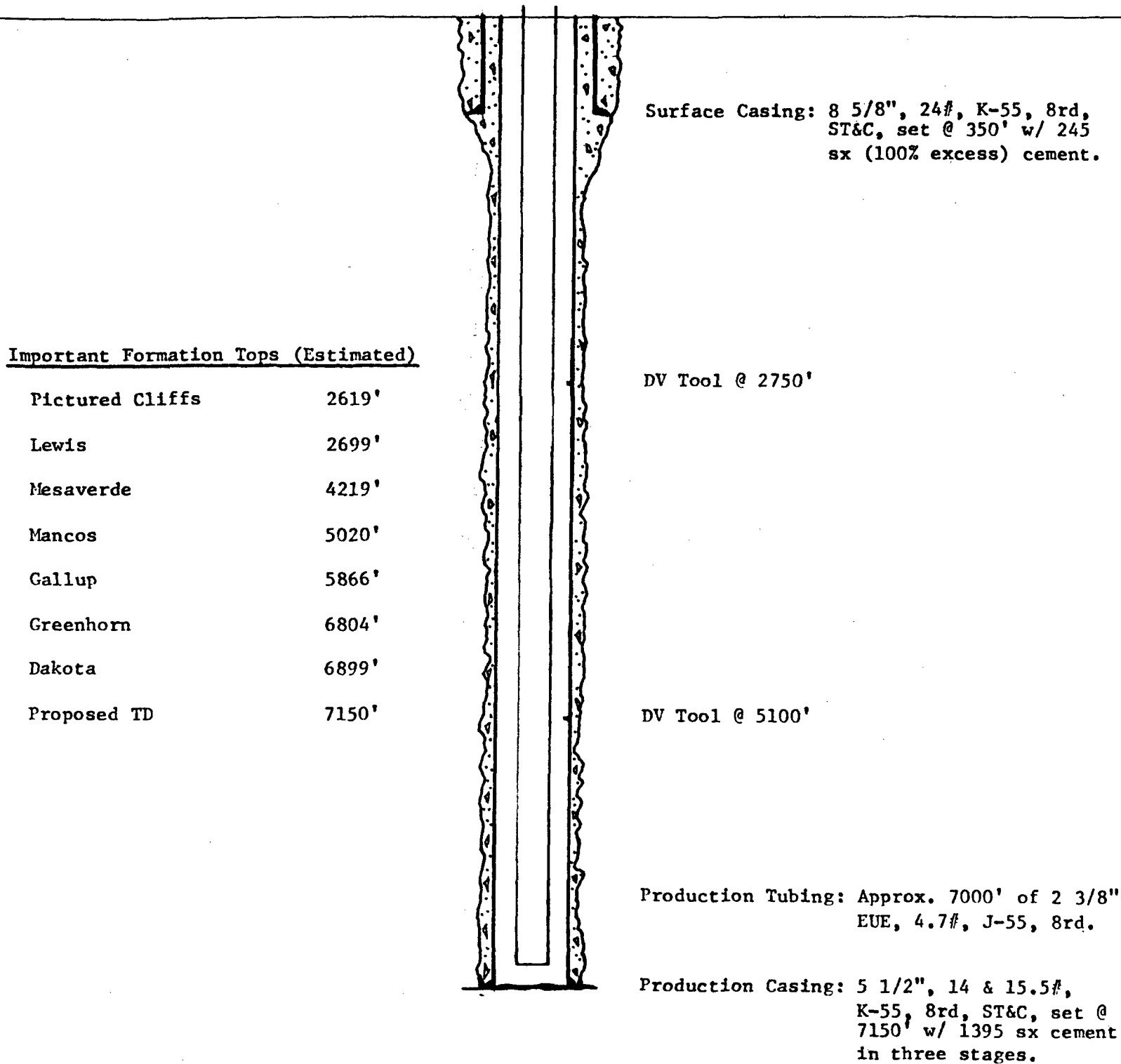



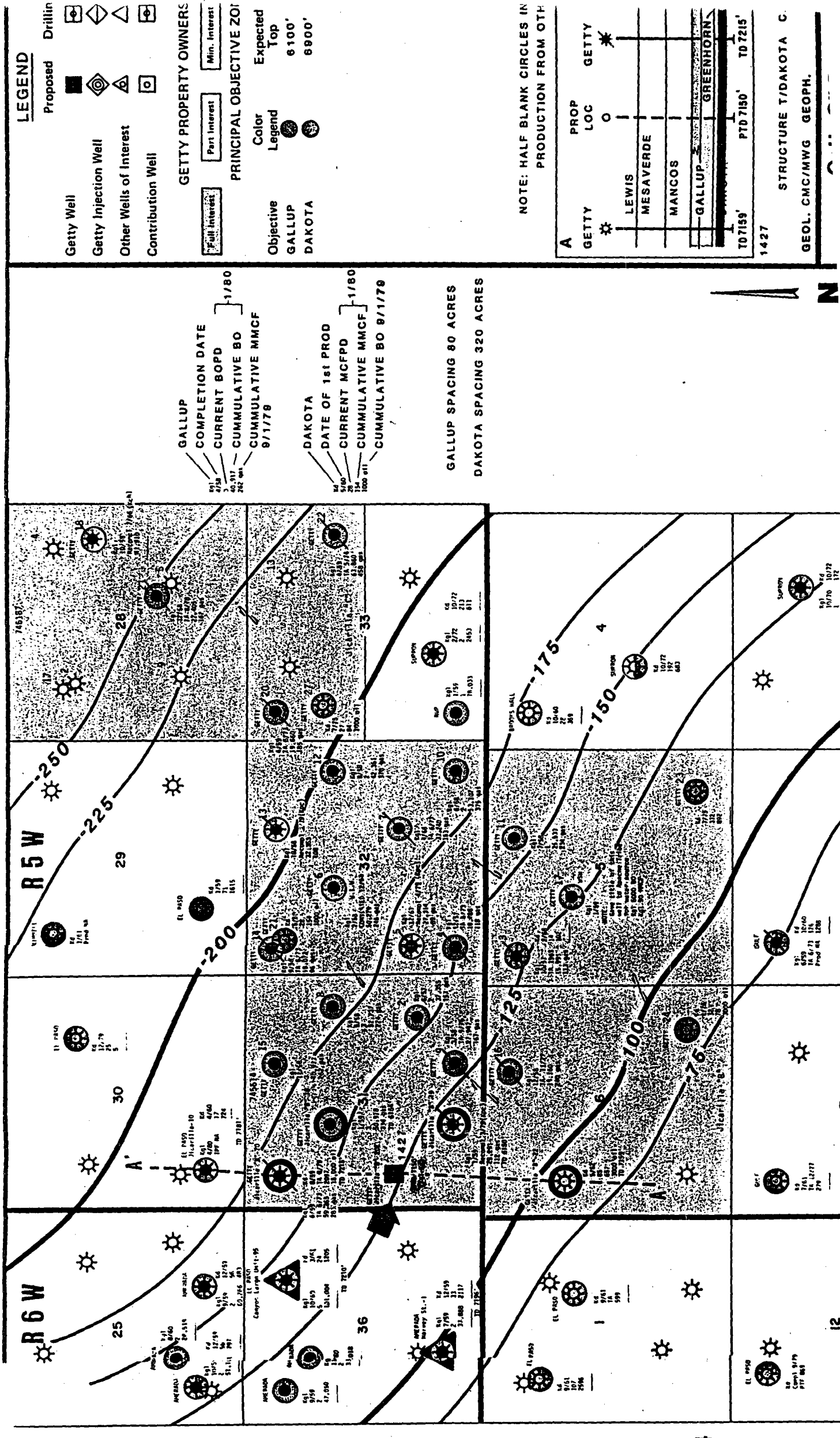

Propo

Getty Well

Getty Injection Well

Other Wells of Interest

Contribution Well

GETTY PROPER

Full Interest

Part Interest

PRINCIPAL OBJ

GALLUP

COMPLETION DATE

CURRENT BOPD

CUMULATIVE BO

CUMULATIVE MMCF

8/1/79

Objective

GALLUP

DAKOTA

Legend

DAKOTA

DATE OF 1st PROD

CURRENT MCFPD

CUMULATIVE MMCF

1/80

CUMULATIVE BO 8/1/79

GALLUP SPACING 80 ACRES

DAKOTA SPACING 320 ACRES

NOTE: HALF BLANK

PRODUCTION

A	GETTY	PROP
	LOC	
	LEWIS	
	MESAVERDE	
	MANCOS	
	GALLUP	
	GR	
	PTD 7150'	

1427

STRUCTURE T/D

GEOL. CMC/MWG GEOP

Getty Oil

OTERO G

BASIN DAK

(JICARIL)

RIO ARriba COUI

DENVER

SCALE 1"/2000'

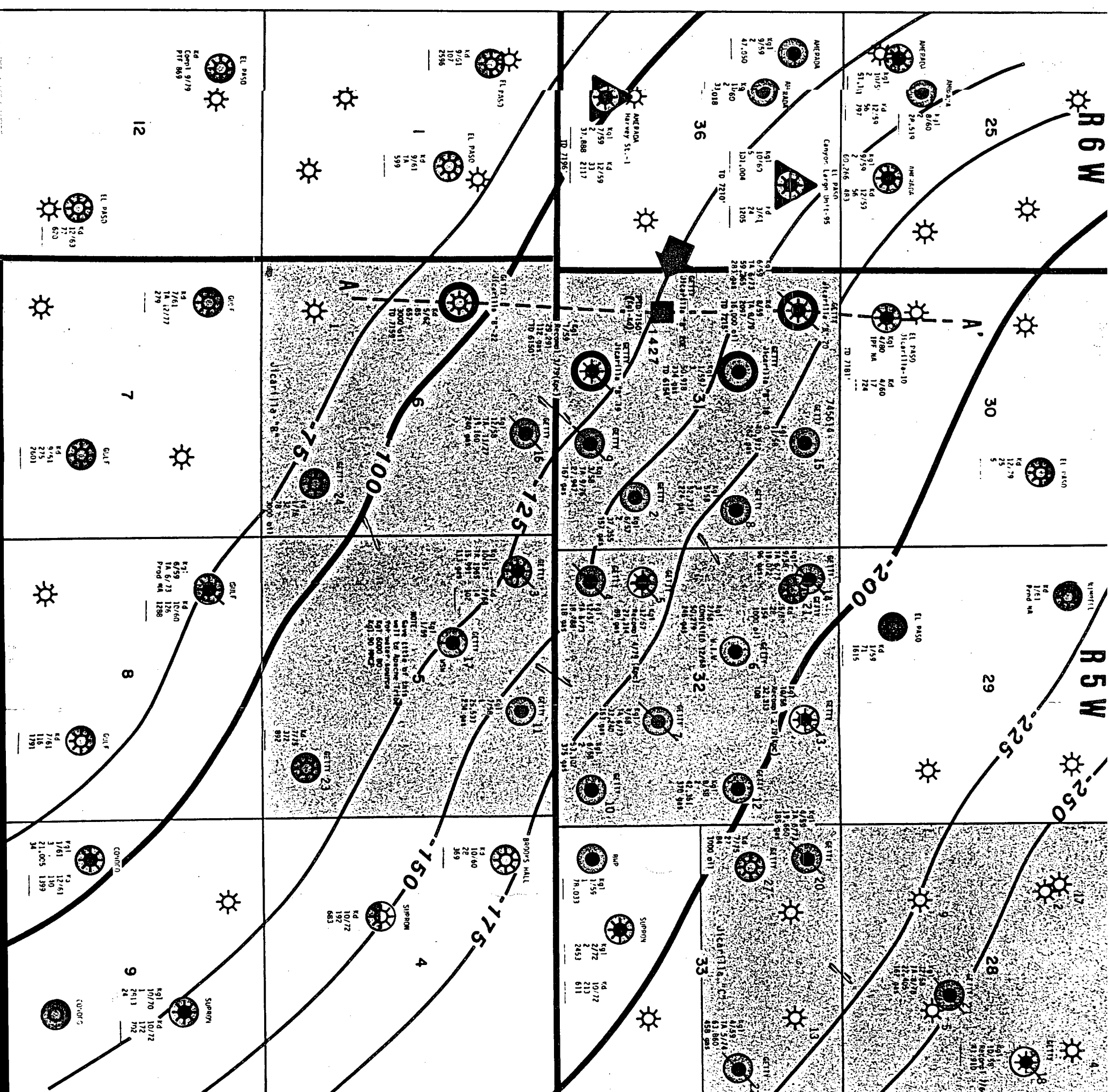



STATE OF NEW MEXICO  
ENERGY AND MINERALS DEPARTMENT RECEIVED  
OIL CONSERVATION DIVISION  
AZTEC DISTRICT OFFICE

MAR 03 1981

OIL CONSERVATION DIVISION  
1000 RIO BRAZOS ROAD  
AZTEC, NEW MEXICO 87410  
SANTA FE (505) 334-6178

OIL CONSERVATION DIVISION  
BOX 2088  
SANTA FE, NEW MEXICO 87501

DATE 3-3-81

RE: Proposed MC ^  
Proposed DHC         
Proposed NSL         
Proposed SWD         
Proposed WFX         
Proposed PMX       

R-5854

Gentlemen:

I have examined the application dated 2-25-81  
for the Gatty Leavitt B#20E L-31-25N-5W  
Operator Lease and Well No. Unit, S-T-R

and my recommendations are as follows:

Deny - Gallup formation is in Otero-Gallup oil  
pool and produces paraffin.

Yours truly,

Frank J. Chang

DENY



STATE OF NEW MEXICO  
ENERGY AND MINERALS DEPARTMENT  
OIL CONSERVATION DIVISION  
AZTEC DISTRICT OFFICE

1000 RIO BRAZOS ROAD  
AZTEC, NEW MEXICO 87410  
(505) 334-5178

OIL CONSERVATION DIVISION  
BOX 2088  
SANTA FE, NEW MEXICO 87501

DATE 5-15-81

RE: Proposed MC \_\_\_\_\_  
Proposed DHC a \_\_\_\_\_  
Proposed NSL \_\_\_\_\_  
Proposed SWD \_\_\_\_\_  
Proposed WFX \_\_\_\_\_  
Proposed PMX \_\_\_\_\_

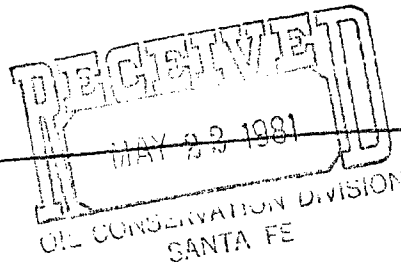

work o/o  
on three  
Frank & Getty  
on DHC

Gentlemen:

I have examined the application dated 5-13-81  
for the J. Getty Jimilla B #20E L-31-25N-5W  
Operator Lease and Well No. Unit, S-T-R

and my recommendations are as follows:

Approve - Dakota only

Yours truly,

Frank J. Chang

→ 6/29 - Talked to Frank - - - Gallup not to be produced  
until after hearing, but he has approved C-104 for  
Dakota. Prob no action needed until after hearing.  
CU

7/10 R-5854 (DHC)

~~in~~ in area of  
approval (5,6 24 N 5W  
21, 22, 27, 28, 31-34  
25