

DATE <u>5/5/03</u>	SUSPENSE <u>5/20/03</u>	ENGINEER <u>LRC</u>	LOGGED IN <u>KV</u>	TYPE <u>WFX</u>	FILE NO. <u>PKRV0312634338</u>
--------------------	-------------------------	---------------------	---------------------	-----------------	--------------------------------

ABOVE THIS LINE FOR DIVISION USE ONLY

NEW MEXICO OIL CONSERVATION DIVISION

- Engineering Bureau -

1220 South St. Francis Drive, Santa Fe, NM 87505



790

ADMINISTRATIVE APPLICATION CHECKLIST

THIS CHECKLIST IS MANDATORY FOR ALL ADMINISTRATIVE APPLICATIONS FOR EXCEPTIONS TO DIVISION RULES AND REGULATIONS WHICH REQUIRE PROCESSING AT THE DIVISION LEVEL IN SANTA FE

Application Acronyms:

[NSL-Non-Standard Location] [NSP-Non-Standard Proration Unit] [SD-Simultaneous Dedication]
[DHC-Downhole Commingling] [CTB-Lease Commingling] [PLC-Pool/Lease Commingling]
[PC-Pool Commingling] [OLS - Off-Lease Storage] [OLM-Off-Lease Measurement]
[WFX-Waterflood Expansion] [PMX-Pressure Maintenance Expansion]
[SWD-Salt Water Disposal] [IPI-Injection Pressure Increase]
[EOR-Qualified Enhanced Oil Recovery Certification] [PPR-Positive Production Response]

[1] TYPE OF APPLICATION - Check Those Which Apply for [A]

[A] Location - Spacing Unit - Simultaneous Dedication

☐ NSL ☐ NSP ☐ SD

Check One Only for [B] or [C]

[B] Commingling - Storage - Measurement

☐ DHC ☐ CTB ☐ PLC ☐ PC ☐ OLS ☐ OLM

[C] Injection - Disposal - Pressure Increase - Enhanced Oil Recovery

☒ WFX ☐ PMX ☐ SWD ☐ IPI ☐ EOR ☐ PPR

[D] Other: Specify _____

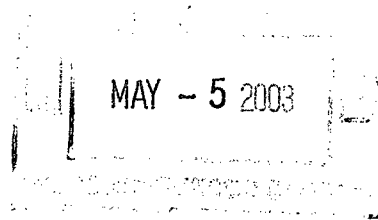

[2] NOTIFICATION REQUIRED TO: - Check Those Which Apply, or Does Not Apply

[A] ☐ Working, Royalty or Overriding Royalty Interest Owners

[B] ☒ Offset Operators, Leaseholders or Surface Owner

[C] ☒ Application is One Which Requires Published Legal Notice

[D] ☐ Notification and/or Concurrent Approval by BLM or SLO
U.S. Bureau of Land Management - Commissioner of Public Lands, State Land Office

[E] ☒ For all of the above, Proof of Notification or Publication is Attached, and/or,

[F] ☐ Waivers are Attached

[3] SUBMIT ACCURATE AND COMPLETE INFORMATION REQUIRED TO PROCESS THE TYPE OF APPLICATION INDICATED ABOVE.

[4] **CERTIFICATION:** I hereby certify that the information submitted with this application for administrative approval is **accurate** and **complete** to the best of my knowledge. I also understand that **no action** will be taken on this application until the required information and notifications are submitted to the Division.

Note: Statement must be completed by an individual with managerial and/or supervisory capacity.

Roy L. Wheeler, Jr.
Print or Type Name

Roy L. Wheeler, Jr.
Signature

Specialist - Field Admin.
Title

April 30, 2003
Date

Amerada Hess Corporation (OGRID No. 000495)
FORM C-108 - North Monument G/SA Unit 1420, No. 298
API No. 30-025-35197

rwheeler@hess.com
e-mail Address

APPLICATION FOR AUTHORIZATION TO INJECT

- I. PURPOSE: X Secondary Recovery Pressure Maintenance Disposal Storage
Application qualifies for administrative approval? X Yes No
- II. OPERATOR: Amerada Hess Corporation
ADDRESS: P. O. Box 840, Seminole, Texas 79360
CONTACT PARTY: Chad McGehee PHONE: 915 758-6707
- III. WELL DATA: Complete the data required on the reverse side of this form for each well proposed for injection.
Additional sheets may be attached if necessary.
- IV. Is this an expansion of an existing project? X Yes No
If yes, give the Division order number authorizing the project: R-9596
- V. Attach a map that identifies all wells and leases within two miles of any proposed injection well with a one-half mile radius circle drawn around each proposed injection well. This circle identifies the well's area of review.
- VI. Attach a tabulation of data on all wells of public record within the area of review which penetrate the proposed injection zone. Such data shall include a description of each well's type, construction, date drilled, location, depth, record of completion, and a schematic of any plugged well illustrating all plugging detail.
- VII. Attach data on the proposed operation, including:
1. Proposed average and maximum daily rate and volume of fluids to be injected;
 2. Whether the system is open or closed;
 3. Proposed average and maximum injection pressure;
 4. Sources and an appropriate analysis of injection fluid and compatibility with the receiving formation if other than reinjected produced water; and,
 5. If injection is for disposal purposes into a zone not productive of oil or gas at or within one mile of the proposed well, attach a chemical analysis of the disposal zone formation water (may be measured or inferred from existing literature, studies, nearby wells, etc.).
- *VIII. Attach appropriate geologic data on the injection zone including appropriate lithologic detail, geologic name, thickness, and depth. Give the geologic name, and depth to bottom of all underground sources of drinking water (aquifers containing waters with total dissolved solids concentrations of 10,000 mg/l or less) overlying the proposed injection zone as well as any such sources known to be immediately underlying the injection interval.
- IX. Describe the proposed stimulation program, if any.
- *X. Attach appropriate logging and test data on the well. (If well logs have been filed with the Division, they need not be resubmitted).
- *XI. Attach a chemical analysis of fresh water from two or more fresh water wells (if available and producing) within one mile of any injection or disposal well showing location of wells and dates samples were taken.
- XII. Applicants for disposal wells must make an affirmative statement that they have examined available geologic and engineering data and find no evidence of open faults or any other hydrologic connection between the disposal zone and any underground sources of drinking water.
- XIII. Applicants must complete the "Proof of Notice" section on the reverse side of this form.
- XIV. Certification: I hereby certify that the information submitted with this application is true and correct to the best of my knowledge and belief.
- NAME: Chad McGehee TITLE: Petroleum Engineer
SIGNATURE: Chad McGehee DATE: April 30, 2003
- * If the information required under Sections VI, VIII, X, and XI above has been previously submitted, it need not be resubmitted. Please show the date and circumstances of the earlier submittal: August 2, 1991, original C-108 submitted and subsequent amendments filed by Amerada Hess Corporation on North Monument Grayburg San Andres Unit.

III. WELL DATA

A. The following well data must be submitted for each injection well covered by this application. The data must be both in tabular and schematic form and shall include:

- (1) Lease name; Well No.; Location by Section, Township and Range; and footage location within the section.
- (2) Each casing string used with its size, setting depth, sacks of cement used, hole size, top of cement, and how such top was determined.
- (3) A description of the tubing to be used including its size, lining material, and setting depth.
- (4) The name, model, and setting depth of the packer used or a description of any other seal system or assembly used.

Division District Offices have supplies of Well Data Sheets which may be used or which may be used as models for this purpose. Applicants for several identical wells may submit a "typical data sheet" rather than submitting the data for each well.

B. The following must be submitted for each injection well covered by this application. All items must be addressed for the initial well. Responses for additional wells need be shown only when different. Information shown on schematics need not be repeated.

- (1) The name of the injection formation and, if applicable, the field or pool name.
- (2) The injection interval and whether it is perforated or open-hole.
- (3) State if the well was drilled for injection or, if not, the original purpose of the well.
- (4) Give the depths of any other perforated intervals and detail on the sacks of cement or bridge plugs used to seal off such perforations.
- (5) Give the depth to and the name of the next higher and next lower oil or gas zone in the area of the well, if any.

XIV. PROOF OF NOTICE

All applicants must furnish proof that a copy of the application has been furnished, by certified or registered mail, to the owner of the surface of the land on which the well is to be located and to each leasehold operator within one-half mile of the well location.

Where an application is subject to administrative approval, a proof of publication must be submitted. Such proof shall consist of a copy of the legal advertisement which was published in the county in which the well is located. The contents of such advertisement must include:

- (1) The name, address, phone number, and contact party for the applicant;
- (2) The intended purpose of the injection well; with the exact location of single wells or the Section, Township, and Range location of multiple wells;
- (3) The formation name and depth with expected maximum injection rates and pressures; and,
- (4) A notation that interested parties must file objections or requests for hearing with the Oil Conservation Division, 1220 South St. Francis Dr., Santa Fe, New Mexico 87505, within 15 days.

NO ACTION WILL BE TAKEN ON THE APPLICATION UNTIL PROPER PROOF OF NOTICE HAS BEEN SUBMITTED.

NOTICE: Surface owners or offset operators must file any objections or requests for hearing of administrative applications within 15 days from the date this application was mailed to them.

INDEX

C-108 ATTACHMENTS

Section III - Well Data, Wellbore Schematic	PAGE
North Monument Grayburg San Andres Unit Well No. 1420	1 - 3
 Section V - Maps	
North Monument Grayburg San Andres Unit Map	4
North Monument Grayburg San Andres Unit Well No. 1420 Area of Review Map.	5
 Section VI - Tabulation of Wells Penetrating Proposed Injection Zone - Casing, cement & cement top calculations. (Wells not included in original C-108)	6
 Section VII - Data on Proposed Operation & Section IX - Stimulation	7
 Section XIII & XIV - Proof of Notice	
Surface Owner Listing & Leasehold Operator Listing	8
Publication	9

Note: Item Nos. VI, VII, & XI were submitted with original C-108 filed August 2, 1991

Item No. X - Logs & test data have previously been submitted.

WELL LOCATION:	<u>1310' FNL & 1250' FWL</u>	<u>D</u>	<u>36</u>	<u>19S</u>	<u>36E</u>
	FOOTAGE LOCATION	UNIT LETTER	SECTION	TOWNSHIP	RANGE

(Perforated or Open Hole; indicate which)

INJECTION WELL DATA SHEETTubing Size: 2-3/8" Lining Material: IPC or PE LinedType of Packer: Plastic Coated AD-1Packer Setting Depth: +/- 3650'

Other Type of Tubing/Casing Seal (if applicable): _____

Additional Data1. Is this a new well drilled for injection? _____ Yes X NoIf no, for what purpose was the well originally drilled? Grayburg San Andres Producer2. Name of the Injection Formation: Grayburg San Andres3. Name of Field or Pool (if applicable): Eunice Monument Grayburg San Andres4. Has the well ever been perforated in any other zone(s)? List all such perforated intervals and give plugging detail, i.e. sacks of cement or plug(s) used. No

5. Give the name and depths of any oil or gas zones underlying or overlying the proposed injection zone in this area: _____

Higher Gas Zone: Eumont at +/- 3642'Lower Oil Zone: Paddock at +/- 5050'(Depths are from markers at Monument Abo No. 1 Well, per Unit Agreement.)

NMGSAU UNIT # 1420
WELL # 298
1310' FNL, 1250' FWL UNIT D
SEC. 36, TWN.19S, RN,36E

Surface
8 5/8"
24# @ 411'
200 sx. surface
11' hole

circulated

Production
5 1/2"
15.5# @4009'
1260 sx. Surface
7 7/8" hole

circulated

Perforations
3678' to 3978'

4009' TD

Prepared By:

Joe Severino

04/22/03

NMGSAU - North Monument Grayburg/San Andres Unit

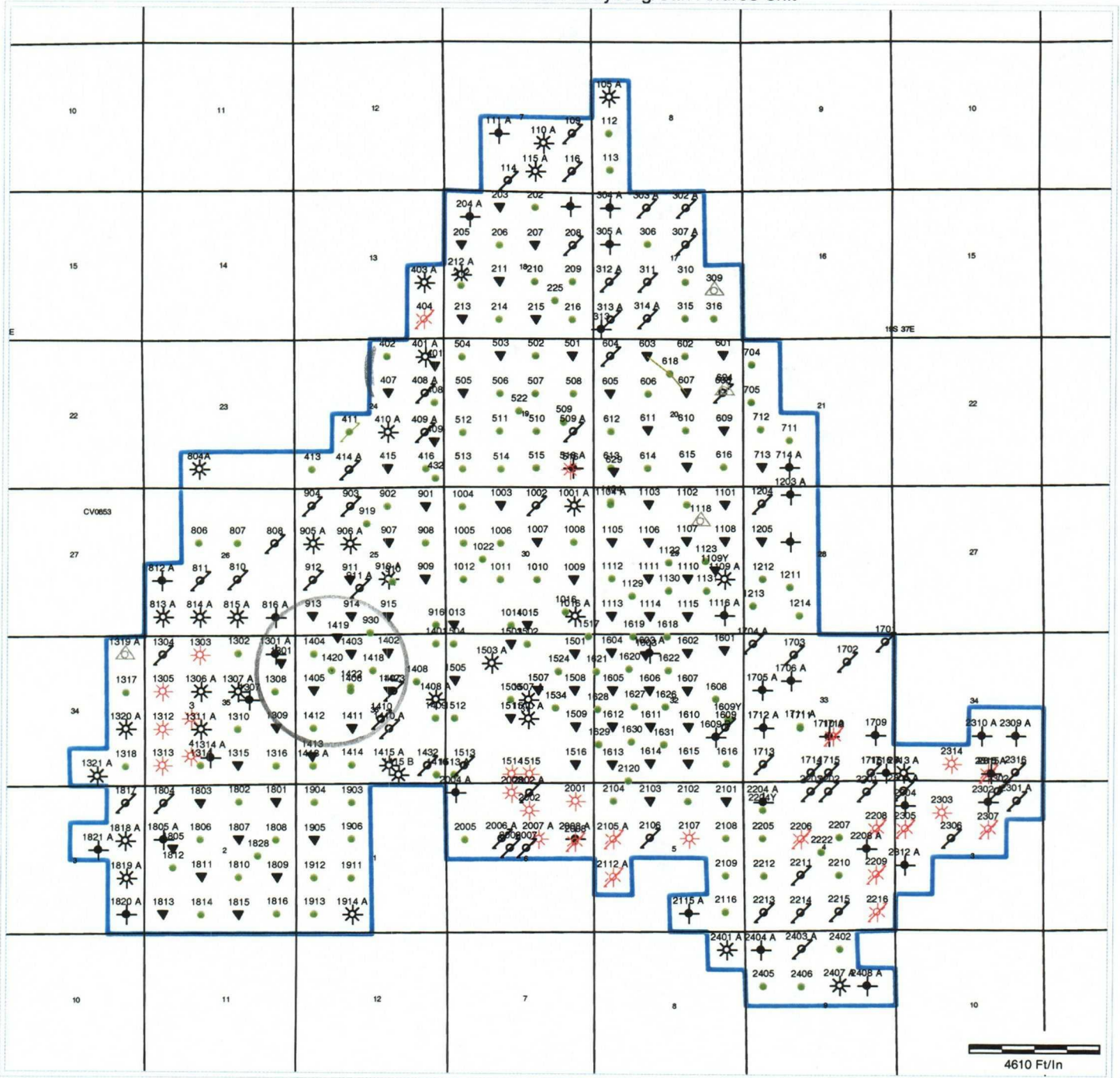

VI. TABULATION OF WELLS PENETRATING PROPOSED INJECTION ZONE

Wells not included in original C-108, within area of review

LEASE	WELL	OPERATOR	API	UNIT	LOCATION			TYPE	FIELD	DATE DRILLED	TD	COMPLETION INTERVAL	
					SEC	T	R					TOP	BOTTOM
NMGSAU	930	AMERADA HESS CORP	3002535181	N	25	19	36	OIL	MONUMENT	11/06/2000	4055	3772	4010
NMGSAU	297	AMERADA HESS CORP	3002535177	B	36	19	36	OIL	MONUMENT	12/21/2000	3986	3680	3962

C-108 ATTACHMENT

A. Section VII - Data on Proposed Operation

1. Proposed Average & Maximum Daily Rate and Volume of Fluids to be Injected:

Average Daily Rate: 400 B.W./D.
Maximum Daily Rate: 2500 B.W./D.

2. Open or Close System:

Injection system is a closed system.

3. Proposed Average & Maximum* Injection Pressures:

Average injection pressure: 710 PSI

WELL NAME	TOP PERF	MAX P
1420	3695'	739

*Until a fracture gradient is determined, maximum injection pressure will be based on a .2 PSI/foot gradient to depth of top of completion.

4. Sources of Appropriate Analysis of Injection Fluid:

The source of injection water will be from San Andres water supply wells and produced water from existing North Monument Grayburg San Andres Unit producers. The San Andres formation is compatible with the produced water from the unit wells.

B. Section IX. Proposed Stimulation Program:

1. NMGSAU Well No. 1420

Acidize well w/2000 - 4000 gal. 15% NEFE acid.

C-108 ATTACHMENT

A. Sections VIII & XIV – Proof of Notice.

1. Surface Owners – Application mailed by Certified Mail to following:
 - New Mexico State Land Office
Commissioner of Public Lands
Ray Powell, M.S., D.V.M.
310 Old Santa Fe Trail
P. O. Box 1148
Santa Fe, New Mexico 87504-1148
 - Jimmie T. Cooper
P. O. Box 55
Monument, New Mexico 88265

2. Leasehold Operators within ½ mile of proposed injection wells – application mailed by Certified Mail to following:
 - Altura Energy LTD
P. O. Box 4294
Houston, Texas 77210
 - ChevronTexaco PBBU
15 Smith Road
Midland, Texas 79705
 - Jack Huff
P. O. Box 50190
Midland, Texas 79710-0190
 - Kerr McGee Corporation
P. O. Box 1050
Midland, Texas 79702
 - Oryx Energy Company
P. O. Box 2880
Dallas, Texas 75221-2880
 - Owens Petroleum Inc.
P. O. Box 2911
Midland, Texas 79702

3. Publication – (Attached)

AFFIDAVIT OF PUBLICATION

State of New Mexico,
County of Lea.

I, KATHI BEARDEN

Publisher

of the Hobbs News-Sun, a
newspaper published at
Hobbs, New Mexico, do solemnly
swear that the clipping attached
hereto was published once a
week in the regular and entire
issue of said paper, and not a
supplement thereof for a period.

of 1

 weeks.

Beginning with the issue dated

April 27 2003

and ending with the issue dated

April 27 2003

Kathi Bearden

Publisher

Sworn and subscribed to before

me this 28th day of

April 2003

Jodi Benson

Notary Public.

My Commission expires
October 18, 2004
(Seal)

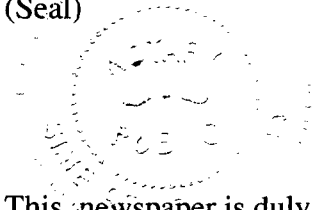

This newspaper is duly qualified
to publish legal notices or adver-
tisements within the meaning of
Section 3, Chapter 167, Laws of
1937, and payment of fees for
said publication has been made.

LEGAL NOTICE
April 27, 2003

Amerada Hess Corporation, operator of record for the North Monument Grayburg San Andres Unit, (NMGSAU), hereby notifies of their desire to inject water into NMGSAU Well No. 1420, NMOCD No. 298, located in Unit D, Sec. 36, T19S, R36E, Lea County, N.M. The NMGSAU "Authorization to Inject" is covered under State of New Mexico, Energy, Minerals and Natural Resources Department, Oil Conservation Division Case No. 10252, Division Order No. R-9596. Amerada Hess Corporation hereby gives notice that application has been made for administrative regulatory amendment of Exhibit "A" of said division order to include the aforementioned well to inject water into Grayburg San Andres formation, Eunice Monument Grayburg San Andres pool through the gross perforated and/or open hole interval from approximately 3700 feet to 4000 feet with an initial maximum injection pressure of 0.2 PSI/FT. to top of completion.

Contact Mr. Chad McGehee, Amerada Hess Corporation, P.O. Box 840, Seminole, Texas 79360, Phone 432-758-6707 concerning questions regarding application. Objections or requests for hearing concerning this application should be filed with the State of New Mexico, Energy, Minerals and Natural Resources Department, Oil Conservation Division, 1220 S. St. Francis Dr., Santa Fe, New Mexico 87504 within 15 days of this publication.

#19750

01100986000 67513269

Amerada Hess Corporation
PO Box 840
SEMINOLE, TX 79360

AMERADA HESS CORPORATION

P. O. BOX 840
SEMINOLE, TEXAS 79360
915-758-6700

April 30, 2003

Re: Application for Amended Injection Permit
North Monument Grayburg San Andres Unit
Lea County, New Mexico

Dear Sir,

Enclosed, for your information is a copy of Form C-108 and supporting documents filed with State of New Mexico Oil Conservation Division requesting administrative approval to add North Monument Grayburg San Andres Unit Well No. 1420 as a water injection well to unit.

If additional information is needed, please let us know at your earliest convenience at above address or phone (915) 758-6707.

Sincerely,

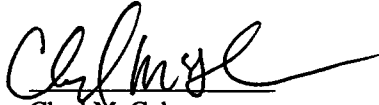

Chad McGehee
Petroleum Engineer

Submit 3 Copies To Appropriate District
Office
District I
1625 N. French Dr., Hobbs, NM 87240
District II
811 South First, Artesia, NM 87210
District III
1000 Rio Brazos Rd., Aztec, NM 87410
District IV
2040 South Pacheco, Santa Fe, NM 87505

State of New Mexico
Energy, Minerals and Natural Resources

OIL CONSERVATION DIVISION
2040 South Pacheco
Santa Fe, NM 87505

Form C-103
Revised March 25, 1999

SUNDRY NOTICES AND REPORTS ON WELLS (DO NOT USE THIS FORM FOR PROPOSALS TO DRILL OR TO DEEPEN OR PLUG BACK TO A DIFFERENT RESERVOIR. USE "APPLICATION FOR PERMIT" (FORM C-101) FOR SUCH PROPOSALS.)		WELL API NO. 30-025-35177
1. Type of Well: Oil Well <input checked="" type="checkbox"/> Gas Well <input type="checkbox"/> Other <input type="checkbox"/>		5. Indicate Type of Lease STATE <input checked="" type="checkbox"/> FEE <input type="checkbox"/>
2. Name of Operator Amerada Hess Corporation		6. State Oil & Gas Lease No. N/A
3. Address of Operator P.O. Box 2040 Houston, TX 77252-2040		7. Lease Name or Unit Agreement Name: NORTH MONUMENT / GRAYBURG SAN ANDRES UNIT
4. Well Location Unit Letter B : 1310 feet from the NORTH line and 2525 feet from the EAST line Section 36 Township 19 S Range 36 E NMPM County LEA		8. Well No. 297
10. Elevation (Show whether DR, RKB, RT, GR, etc.) 3599' GR.		9. Pool name or Wildcat EUNICE-MONUMENT G/S ANDRES

11. Check Appropriate Box to Indicate Nature of Notice, Report, or Other Data

NOTICE OF INTENTION TO:

PERFORM REMEDIAL WORK ☐ PLUG AND ABANDON ☐
TEMPORARILY ABANDON ☐ CHANGE PLANS ☐
PULL OR ALTER CASING ☐ MULTIPLE COMPLETION ☐
OTHER: ☐

SUBSEQUENT REPORT OF:

REMEDIAL WORK ☐ ALTERING CASING ☐
COMMENCE DRILLING OPNS. ☐ PLUG AND ABANDONMENT ☐
CASING TEST AND CEMENT JOB ☒
OTHER: **RUNNING PRODUCTION CASING** ☒

12. Describe Proposed or Completed Operations (Clearly state all pertinent details, and give pertinent dates, including estimated date of starting any proposed work). SEE RULE 1103. For Multiple Completions: Attach wellbore diagram of proposed completion or recompilation.

10-26-00

RU Bull Rogers Csg crew & run 90 Jts of 5-1/2" 15.5# J-55 L/T&C csg set @ 3986', shoe @ 3985', FC @ 3895', ran 13 centralizers. Cmt w/ BJ 850 sx 35:65 POZ + 6% Gel + 5#/sx salt + 1/4#/sx CF (12.6#-1.98). Tail w/ 550 sx class "C" + 1/4#/sx CF + 0.2% CD-32 + 0.6% FL-62 (14.8#-1.33). Displace w/ 95 bbls fresh water @ 6 bbl/min. Final circ w/ 1500 psi. Bump plug w/ 1950 psi @ 10:30 AM MST 10-26-00. Floats held ok, good returns. Circ 180 sx to pit. Reciprocate csg. NU Kvaerner Nat 7-1/6" x 11" 3M Tbg. Hd.
TURNED OVER TO PRODUCTION

I hereby certify that the information above is true and complete to the best of my knowledge and belief.

SIGNATURE Betsy David TITLE Prof. Drilling Engineer DATE 10/31/00

Type or print name Betsy David Telephone No. (713) 609-4803

(This space for State use)

APPROVED BY Chris Williams DISTRICT 1 SUPERVISOR DATE NOV 03 2000
Conditions of approval, if any:

Submit 3 Copies To Appropriate District
Office
District I
1625 N. French Dr., Hobbs, NM 87240
District II
811 South First, Artesia, NM 87210
District III
1000 Rio Brazos Rd., Aztec, NM 87410
District IV
2040 South Pacheco, Santa Fe, NM 87505

State of New Mexico
Energy, Minerals and Natural Resources

Form C-103
Revised March 25, 1999

OIL CONSERVATION DIVISION
2040 South Pacheco
Santa Fe, NM 87505

WELL API NO. 30-025-35177
5. Indicate Type of Lease STATE <input checked="" type="checkbox"/> FEE <input type="checkbox"/>
6. State Oil & Gas Lease No. N/A
7. Lease Name or Unit Agreement Name: NORTH MONUMENT / GRAYBURG SAN ANDRES UNIT
8. Well No. 297
9. Pool name or Wildcat EUNICE-MONUMENT G/S ANDRES

SUNDRY NOTICES AND REPORTS ON WELLS
(DO NOT USE THIS FORM FOR PROPOSALS TO DRILL OR TO DEEPEN OR PLUG BACK TO A DIFFERENT RESERVOIR. USE "APPLICATION FOR PERMIT" (FORM C-101) FOR SUCH PROPOSALS.)

1. Type of Well: Oil Well <input checked="" type="checkbox"/> Gas Well <input type="checkbox"/> Other	2. Name of Operator Amerada Hess Corporation
3. Address of Operator P.O. Box 2040 Houston, TX 77252-2040	4. Well Location Unit Letter B : 1310 feet from the NORTH line and 2525 feet from the EAST line Section 36 Township 19 S Range 36 E NMPM County Lea
10. Elevation (Show whether DR, RKB, RT, GR, etc.) 3599' GR.	

11. Check Appropriate Box to Indicate Nature of Notice, Report, or Other Data

NOTICE OF INTENTION TO:

PERFORM REMEDIAL WORK ☐ PLUG AND ABANDON ☐
TEMPORARILY ABANDON ☐ CHANGE PLANS ☐
PULL OR ALTER CASING ☐ MULTIPLE COMPLETION ☐

OTHER: ☐

SUBSEQUENT REPORT OF:

REMEDIAL WORK ☐ ALTERING CASING ☐
COMMENCE DRILLING OPNS. ☒ PLUG AND ABANDONMENT ☐
CASING TEST AND CEMENT JOB ☒

OTHER: ☒ Running Surface Casing

12. Describe Proposed or Completed Operations (Clearly state all pertinent details, and give pertinent dates, including estimated date of starting any proposed work). SEE RULE 1103. For Multiple Completions: Attach wellbore diagram of proposed completion or recompilation.

10-21-00 thru 10-22-00

MI & RU Key Energy Rig #41. Spud well @ 12:00 AM 10-21-00. (40' of 14" Conductor + 13' To KB = 53'). Drill from 53' to 406'. Survey @ 406' = 3/4 (Deg.). Circ and cond. RU Bull Rogers Csg Crew & run 10 jts of 8-5/8", 24#, J55, 8RS, 'A' csg set @ 406', Shoe @ 405', FC @ 367' & ran 4 centralizers. Circ Csg. Cmt w/ BJ: Pump 200 sx of class 'C' + 2%CaCl2 + 1/4#/sx CF (14.8#-1.35). Displace w/ 23.5 bbl fresh water @ 1.5 bbl/min. Final circ w/ 160 psi. Bump plug w/ 165 psi @ 10:00 am w/ good returns. Circ 66 sx cmt to pit. WOC. Test pipe rams & annular w/ 1000 psi, OK. Drill cmt from 350' - 387' w/ FC @ 367'. Test csg w/ 1000 psi, OK.

I hereby certify that the information above is true and complete to the best of my knowledge and belief.

SIGNATURE Betsy David TITLE Prof. Drilling Engineer DATE 10-31-00

Type or print name Betsy David Telephone No. 713-609-4803

(This space for State use)

APPROVED BY Chris Williams TITLE DISTRICT 1 SUPERVISOR DATE Nov 03 2000

Conditions of approval, if any:

Submit 3 Copies To Appropriate District
Office
District I
1625 N. French Dr., Hobbs, NM 87240
District II
811 South First, Artesia, NM 87210
District III
1000 Rio Brazos Rd., Aztec, NM 87410
District IV
2040 South Pacheco, Santa Fe, NM 87505

State of New Mexico
Energy, Minerals and Natural Resources

OIL CONSERVATION DIVISION
2040 South Pacheco
Santa Fe, NM 87505

Form C-103
Revised March 25, 1999

SUNDRY NOTICES AND REPORTS ON WELLS (DO NOT USE THIS FORM FOR PROPOSALS TO DRILL OR TO DEEPEN OR PLUG BACK TO A DIFFERENT RESERVOIR. USE "APPLICATION FOR PERMIT" (FORM C-101) FOR SUCH PROPOSALS.)		WELL API NO. 30-025-35187
1. Type of Well: Oil Well <input checked="" type="checkbox"/> Gas Well <input type="checkbox"/> Other <input type="checkbox"/>		5. Indicate Type of Lease STATE <input checked="" type="checkbox"/> FEE <input type="checkbox"/>
2. Name of Operator Amerada Hess Corporation		6. State Oil & Gas Lease No. N/A
3. Address of Operator P.O. Box 2040 Houston, TX 77252-2040		7. Lease Name or Unit Agreement Name: NORTH MONUMENT / GRAYBURG SAN ANDRES UNIT
4. Well Location Unit Letter n : 224 feet from the SOUTH line and 2443 feet from the WEST line Section 25 Township 19 S Range 36 E NMPM County LEA		8. Well No. 930
10. Elevation (Show whether DR, RKB, RT, GR, etc.) 3616' GR.		9. Pool name or Wildcat EUNICE-MONUMENT G/S ANDRES

11. Check Appropriate Box to Indicate Nature of Notice, Report, or Other Data

NOTICE OF INTENTION TO:

PERFORM REMEDIAL WORK ☐ PLUG AND ABANDON ☐
TEMPORARILY ABANDON ☐ CHANGE PLANS ☐
PULL OR ALTER CASING ☐ MULTIPLE COMPLETION ☐

OTHER: ☐

SUBSEQUENT REPORT OF:

REMEDIAL WORK ☐ ALTERING CASING ☐
COMMENCE DRILLING OPNS. ☐ PLUG AND ABANDONMENT ☐
CASING TEST AND CEMENT JOB ☒

OTHER: **RUNNING PRODUCTION CASING** ☒

12. Describe Proposed or Completed Operations (Clearly state all pertinent details, and give pertinent dates, including estimated date of starting any proposed work). SEE RULE 1103. For Multiple Completions: Attach wellbore diagram of proposed completion or recompilation.

11-14/00 thru 11-15-00

RU Bull Rogers Csg crew & run 94 Jts of 7" 23# & 20# J-55 I/T&C csg set @ 4055', shoe @ 4054', FC @ 3968', ran 13 centralizers. Cmt w/ BJ 850 sx 35:65 POZ + 6% Gel + 5#/sx salt + 1/4#/sx CF (12.6#-1.98). Tail w/ 350 sx class "C" + 1/4#/sx CF + 0.2% CD-32 + 0.6% FL-62 (14.8#-1.33). Displace w/ 155 bbls fresh water @ 6 bbl/min. Final circ w/ 1700 psi. Bump plug w/ 2100 psi @ 02:00 AM MST 11-15-00. Floats held ok, good returns. Circ 160 sx to pit. Reciprocate csg. NU Kvaerner Nat 7-1/6" x 11" 3M Tbg. Hd.
TURNED OVER TO PRODUCTION

I hereby certify that the information above is true and complete to the best of my knowledge and belief.

SIGNATURE Ann Williams TITLE Sr. Staff Associate DATE 11/15/00

Type or print name Ann Williams Telephone No. (713) 609-4838

(This space for State use)

APPROVED BY Paul J. Kuntz TITLE Geologist DATE NOV 29 2000

Conditions of approval, if any:

Submit 3 Copies To Appropriate District
Office
District I
1625 N. French Dr., Hobbs, NM 87240
District II
811 South First, Artesia, NM 87210
District III
1000 Rio Brazos Rd., Aztec, NM 87410
District IV
2040 South Pacheco, Santa Fe, NM 87505

State of New Mexico
Energy, Minerals and Natural Resources

Form C-103
Revised March 25, 1999

OIL CONSERVATION DIVISION
2040 South Pacheco
Santa Fe, NM 87505

WELL API NO. 30-025-35181
5. Indicate Type of Lease STATE <input checked="" type="checkbox"/> FEE <input type="checkbox"/>
6. State Oil & Gas Lease No. N/A
7. Lease Name or Unit Agreement Name: NORTH MONUMENT / GRAYBURG SAN ANDRES UNIT
8. Well No. 930
9. Pool name or Wildcat EUNICE-MONUMENT G/S ANDRES

SUNDRY NOTICES AND REPORTS ON WELLS
(DO NOT USE THIS FORM FOR PROPOSALS TO DRILL OR TO DEEPEN OR PLUG BACK TO A DIFFERENT RESERVOIR. USE "APPLICATION FOR PERMIT" (FORM C-101) FOR SUCH PROPOSALS.)

1. Type of Well: Oil Well <input checked="" type="checkbox"/> Gas Well <input type="checkbox"/> Other	2. Name of Operator Amerada Hess Corporation
3. Address of Operator P.O. Box 2040 Houston, TX 77252-2040	4. Well Location Unit Letter N : 224 feet from the SOUTH line and 2443 feet from the WEST line Section 25 Township 19 S Range 36 E NMPM County Lea
10. Elevation (Show whether DR, RKB, RT, GR, etc.) 3616' GR.	

11. Check Appropriate Box to Indicate Nature of Notice, Report, or Other Data

NOTICE OF INTENTION TO:

PERFORM REMEDIAL WORK ☐ PLUG AND ABANDON ☐
TEMPORARILY ABANDON ☐ CHANGE PLANS ☐
PULL OR ALTER CASING ☐ MULTIPLE COMPLETION ☐

OTHER: ☐

SUBSEQUENT REPORT OF:

REMEDIAL WORK ☐ ALTERING CASING ☐
COMMENCE DRILLING OPNS. ☒ PLUG AND ABANDONMENT ☐
CASING TEST AND CEMENT JOB ☒

OTHER: Running Surface Casing ☒

12. Describe Proposed or Completed Operations (Clearly state all pertinent details, and give pertinent dates, including estimated date of starting any proposed work). SEE RULE 1103. For Multiple Completions: Attach wellbore diagram of proposed completion or recompilation.

11-6-00 thru 11-8-00

MI & RU Key Energy Rig #41. Spud well @ 20:30 HR 11-6-00. (40' of 14" Conductor + 13' To KB = 53'). Drill from 53' to 402'. Survey @ 402' = 1/4 (Deg.). Circ and cond. RU Bull Rogers Csg Crew & run 9 jts of 9-5/8", 36#, J55, 8RS, 'A' csg set @ 402', Shoe @ 401', FC @ 356' & ran 4 centralizers. Circ Csg. Cmt w/ BJ: Pump 250 sx of class 'C' + 2%CaCl2 + 1/4#/sx CF (14.8#-1.35). Displace w/ 38.0 bbl fresh water @ 3.5 bbl/min. Final circ w/ 200 psi. Bump plug w/ 700 psi @ 04:30 am w/ good returns. Circ 100 sx cmt to pit. WOC. Test pipe rams & annular w/ 1000 psi, OK. Drill cmt from 350' - 407' w/ FC @ 356'. Test csg w/ 1000 psi, OK.

I hereby certify that the information above is true and complete to the best of my knowledge and belief.

SIGNATURE Ann Williams TITLE Sr. Staff Associate DATE 11/10/00

Type or print name Ann Williams Telephone No. 713-609-4838

(This space for State use)

APPROVED BY Paul J. Hart TITLE Geologist DATE NOV 16 2000

Conditions of approval, if any:

U.S. Postal Service
CERTIFIED MAIL RECEIPT
(Domestic Mail Only; No Insurance Coverage Provided)

OFFICIAL USE

Postage	\$.83
Certified Fee	2.30
Return Receipt Fee (Endorsement Required)	
Restricted Delivery Fee (Endorsement Required)	
Total Postage & Fees	\$ 3.13

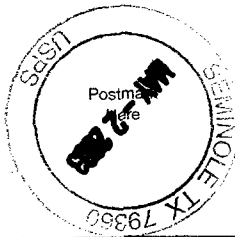

Sent To
Jimmie T. Cooper
Street, Apt. No.,
or PO Box No. **P.O. Box 55**
City, State, ZIP+4
Monument, N.M. 88265
PS Form 3800, January 2001 See Reverse for Instructions

U.S. Postal Service
CERTIFIED MAIL RECEIPT
(Domestic Mail Only; No Insurance Coverage Provided)

OFFICIAL USE

Postage	\$.83
Certified Fee	2.30
Return Receipt Fee (Endorsement Required)	
Restricted Delivery Fee (Endorsement Required)	
Total Postage & Fees	\$ 3.13



Sent To
New Mexico State Land Office
Street, Apt. No.,
or PO Box No. **P.O. Box 1148**
City, State, ZIP+4
Santa Fe, N.M. 87504-1148
PS Form 3800, January 2001 See Reverse for Instructions

U.S. Postal Service
CERTIFIED MAIL RECEIPT
(Domestic Mail Only; No Insurance Coverage Provided)

OFFICIAL USE

Postage	\$.83
Certified Fee	2.30
Return Receipt Fee (Endorsement Required)	
Restricted Delivery Fee (Endorsement Required)	
Total Postage & Fees	\$ 3.13

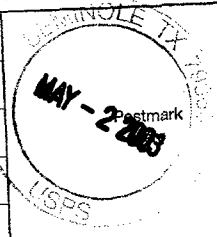

Sent To
Chevron Texaco PBBU
Street, Apt. No.,
or PO Box No. **15 Smith Road**
City, State, ZIP+4
Midland, TX- 79705
PS Form 3800, January 2001 See Reverse for Instructions

U.S. Postal Service
CERTIFIED MAIL RECEIPT
(Domestic Mail Only; No Insurance Coverage Provided)

OFFICIAL USE

Postage	\$.83
Certified Fee	2.30
Return Receipt Fee (Endorsement Required)	
Restricted Delivery Fee (Endorsement Required)	
Total Postage & Fees	\$ 3.13



Sent To
Altura Energy LTD
Street, Apt. No.,
or PO Box No. **P.O. Box 4294**
City, State, ZIP+4
Newton, TX- 77210
PS Form 3800, January 2001 See Reverse for Instructions

U.S. Postal Service
CERTIFIED MAIL RECEIPT
(Domestic Mail Only; No Insurance Coverage Provided)

OFFICIAL USE

Postage	\$.83
Certified Fee	2.30
Return Receipt Fee (Endorsement Required)	
Restricted Delivery Fee (Endorsement Required)	
Total Postage & Fees	\$ 3.13



Sent To
Kerr McGee Corporation
Street, Apt. No.,
or PO Box No. **P.O. Box 1050**
City, State, ZIP+4
Midland, TX- 79702
PS Form 3800, January 2001 See Reverse for Instructions

U.S. Postal Service
CERTIFIED MAIL RECEIPT
(Domestic Mail Only; No Insurance Coverage Provided)

OFFICIAL USE

Postage	\$.83
Certified Fee	2.30
Return Receipt Fee (Endorsement Required)	
Restricted Delivery Fee (Endorsement Required)	
Total Postage & Fees	\$ 3.13

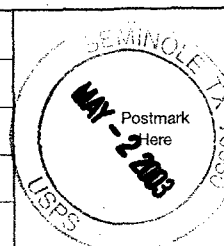

Sent To
Jack Huff
Street, Apt. No.,
or PO Box No. **P.O. Box 50190**
City, State, ZIP+4
Midland, TX- 79710-0190
PS Form 3800, January 2001 See Reverse for Instructions

U.S. Postal Service
CERTIFIED MAIL RECEIPT
 (Domestic Mail Only; No Insurance Coverage Provided)

OFFICIAL USE

Postage	\$.83
Certified Fee	2.30
Return Receipt Fee (Endorsement Required)	
Restricted Delivery Fee (Endorsement Required)	
Total Postage & Fees	\$ 3.13

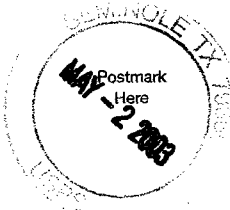

Sent To Owens Petroleum Inc.
 Street, Apt. No.;
 or PO Box No. P.O. Box 2911
 City, State, ZIP+4 Midland, TX - 79702
 PS Form 3800, January 2001 See Reverse for Instructions

U.S. Postal Service
CERTIFIED MAIL RECEIPT
 (Domestic Mail Only; No Insurance Coverage Provided)

OFFICIAL USE

Postage	\$.83
Certified Fee	2.30
Return Receipt Fee (Endorsement Required)	
Restricted Delivery Fee (Endorsement Required)	
Total Postage & Fees	\$ 3.13

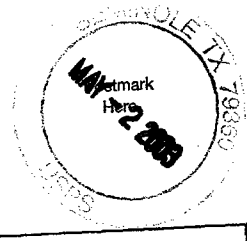

Sent To Drax Energy Company
 Street, Apt. No.;
 or PO Box No. P.O. Box 2880
 City, State, ZIP+4 Dallas, TX - 75221-2880
 PS Form 3800, January 2001 See Reverse for Instructions