

ABOVE THIS LINE FOR DIVISION USE ONLY

**NEW MEXICO OIL CONSERVATION DIVISION**  
 - Engineering Bureau -  
 1220 South St. Francis Drive, Santa Fe, NM 87505



**ADMINISTRATIVE APPLICATION CHECKLIST**

THIS CHECKLIST IS MANDATORY FOR ALL ADMINISTRATIVE APPLICATIONS FOR EXCEPTIONS TO DIVISION RULES AND REGULATIONS WHICH REQUIRE PROCESSING AT THE DIVISION LEVEL IN SANTA FE

**Application Acronyms:**

- [NSL-Non-Standard Location] [NSP-Non-Standard Proration Unit] [SD-Simultaneous Dedication]
- [DHC-Downhole Commingling] [CTB-Lease Commingling] [PLC-Pool/Lease Commingling]
- [PC-Pool Commingling] [OLS - Off-Lease Storage] [OLM-Off-Lease Measurement]
- [WFX-Waterflood Expansion] [PMX-Pressure Maintenance Expansion]
- [SWD-Salt Water Disposal] [IPI-Injection Pressure Increase]
- [EOR-Qualified Enhanced Oil Recovery Certification] [PPR-Positive Production Response]

- [1] **TYPE OF APPLICATION** - Check Those Which Apply for [A]
- [A] Location - Spacing Unit - Simultaneous Dedication  
 NSL  NSP  SD
- Check One Only for [B] or [C]
- [B] Commingling - Storage - Measurement  
 DHC  CTB  PLC  PC  OLS  OLM
- [C] Injection - Disposal - Pressure Increase - Enhanced Oil Recovery  
 WFX  PMX  SWD  IPI  EOR  PPR
- [D] Other: Specify \_\_\_\_\_

- [2] **NOTIFICATION REQUIRED TO:** - Check Those Which Apply, or  Does Not Apply
- [A]  Working, Royalty or Overriding Royalty Interest Owners
- [B]  Offset Operators, Leaseholders or Surface Owner
- [C]  Application is One Which Requires Published Legal Notice
- [D]  Notification and/or Concurrent Approval by BLM or SLO  
 U.S. Bureau of Land Management - Commissioner of Public Lands, State Land Office
- [E]  For all of the above, Proof of Notification or Publication is Attached, and/or,
- [F]  Waivers are Attached

- [3] **SUBMIT ACCURATE AND COMPLETE INFORMATION REQUIRED TO PROCESS THE TYPE OF APPLICATION INDICATED ABOVE.** - S.F. #133  
 30-025-3233  
 - S.F. #135  
 30-025-3238
- [4] **CERTIFICATION:** I hereby certify that the information submitted with this application for administrative approval is **accurate** and **complete** to the best of my knowledge. I also understand that **no action** will be taken on this application until the required information and notifications are submitted to the Division.

Note: Statement must be completed by an individual with managerial and/or supervisory capacity.

Rhonda Rogers  
 Print or Type Name

*Rhonda Rogers*  
 Signature

Staff Regulatory Technician  
 Title

02/06/2014  
 Date

rogerrs@conocophillips.com  
 e-mail Address

PLC  
 RECEIVED  
 2/12/2014  
 - CONOCOPhillips  
 217817  
 POOLS  
 - Vachum Yates  
 62400  
 - Vachum Dainkumb  
 62100  
 - Vachum Blinbory  
 6#850  
 wells  
 - Sutter #97  
 30-025-20791  
 - S.F. #133  
 30-025-3233  
 - S.F. #135  
 30-025-3238  
 - S.F. #134  
 30-025-3244  
 - S.F. #136  
 30-025-33928



Thomas Scarbrough, CPL  
Mid-America – Permian  
P. O. Box 2197 PK10 - 5030  
Houston, TX 77252-2197  
Tel: 281-206-5352  
Fax: 918-662-1956

February 25, 2014

RE: Surface Commingling Application  
Santa Fe Wells  
Lea County, New Mexico

The following ConocoPhillips Operated Santa Fe Wells are located as follows:

Well Name	Well Number	Legal Description	State of NM Lease #
Santa Fe	97	Sec. 33N-T17S-R35E	B-2073
Santa Fe	133	Sec. 31O-T17S-R35E	B-1861
Santa Fe	134	Sec. 5D-T18S-R35E	B-1502
Santa Fe	135	Sec. 31L-T17S-R35E	B-1606
Santa Fe	136	Sec. 33E-T17S-R35E	B-2517

The ownership for the working interest, overriding royalty interest and royalty interest owners is reflected below:

<u>Interest Owner</u>	<u>Working Interest</u>	<u>Net Revenue Interest</u>	<u>ORR Interest</u>	<u>Royalty Interest</u>
ConocoPhillips Company State of New Mexico	100%	87.5%		12.5%

I certify that the above information is true and correct.

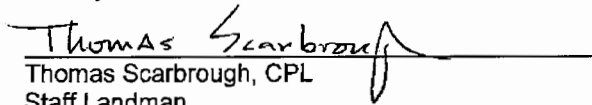
  
Thomas Scarbrough, CPL  
Staff Landman  
ConocoPhillips Company



**CONOCOPHILLIPS COMPANY**  
**APPLICATION FOR SURFACE COMMINGLING Interest Owners**  
**SANTA FE LEASE, (VACUUM-YATES)/(VACUUM-DRINKARD)/(PROPOSED VACUUM-BLINEBRY) POOLS**

Wells	API#	State Lse.#	COP W.I. %	COP N.R.I.%	State of NM RI %	ORRI %
Santa Fe #97 SE/4 SW/4 Section 33, T-17-S, R-35-E, Lea Co., NM	30-025-20791	NM-2073	100%	87.50%	12.50%	0%
Santa Fe #133 SW/4 SE/4 Section 31, T-17-S, R-35-E, Lea Co., NM	30-025-32333	NM-B-1861	100%	87.50%	12.50%	0%
Santa Fe #134 NW/4 Section 5, T-18-S, R-35-E, Lea Co., NM	30-025-32414	NM-B-1502	100%	87.50%	12.50%	0%
Santa Fe #135 Lot 2 & 3 Section 31, T-17-S, R-35-E, Lea Co., NM	30-025-32438	NM-1606	100%	87.50%	12.50%	0%
Santa Fe #136 SW/4 NW/4 Sec. 33 T-17-S, R-35-E, Lea Co., NM	30-025-33928	NM-B-2517	100%	87.50%	12.50%	0%
<b>Santa Fe 133 Battery</b> <b>SW/4 SE/4 Section 31, T-17-S, R-35-E, Lea Co., NM</b>						

**CONOCOPHILLIPS COMPANY  
APPLICATION FOR SURFACE COMMINGLING**

**SANTA FE LEASE, (VACUUM-YATES)/(VACUUM-DRINKARD)/(PROPOSED VACUUM-BLINEBRY) POOLS**

Wells	Current Pool	Proposed Pool to Commingle	Current Prod (Last Well Test)			Anticipated Additional Prod		
			Oil, BOPD	Water, BWPD	Gas, MCFD	Oil, BOPD	Water, BWPD	Gas, MCFD
Santa Fe #97 SE/4 SW/4 Section 33, T-17-S, R-35-E, Lea Co., NM	Vacuum: Yates (#62400)		3	1	25			
Santa Fe #133 SW/4 SE/4 Section 31, T-17-S, R-35-E, Lea Co., NM	Vacuum: Drinkard (#62100)	Vacuum; Blinebry (#61850)	18	12	101	20	200	20
Santa Fe #134 NW/4 Section 5, T-18-S, R-35-E, Lea Co., NM	Vacuum: Drinkard (#62100)	Vacuum; Blinebry (#61850)	3	3	7			
Santa Fe #135 Lot 2 & 3 Section 31, T-17-S, R-35-E, Lea Co., NM	Vacuum: Drinkard (#62100)	Vacuum; Blinebry (#61850)	5	3	5			
Santa Fe #136 SW/4 NW/4 Sec. 33 T-17-S, R-35-E, Lea Co., NM	Vacuum: Drinkard (#62100)	Vacuum; Blinebry (#61850)	6	1	1	20	200	20
Santa Fe 133 Battery SW/4 SE/4 Section 31, T-17-S, R-35-E, Lea Co., NM	Vacuum: Drinkard (#62100) Vacuum: Yates (#62400)	Vacuum; Blinebry (#61850)	35	20	139	40	400	40



---

Rhonda Rogers  
Staff Regulatory Technician  
Phone: (432) 688-9174

ConocoPhillips Company  
P.O. Box 51810  
Midland, TX 79710-1810

February 6, 2014

State of New Mexico  
Oil Conservation Division  
1220 South Saint Francis Drive  
Santa Fe, New Mexico 87505

SUBJECT: REQUEST FOR A SURFACE COMMINGLE FOR THE SANTA FE LEASE

Dear Sirs,

ConocoPhillips Company would like to report that we have 100% Working Interest ownership for all the wells attached.

Enclosed are the following documents in support of this request.

- Administrative Application Checklist
- C-107-B
- Plat with Lease boundaries
- Schematic diagram of facility
- List of wells with production
- Interest Owner
- Well testing procedure

If you have questions regarding this request, I can be reached at 432-688-9174 or via email at [rogers@conocophillips.com](mailto:rogers@conocophillips.com).

Sincerely,

A handwritten signature in black ink that reads "Rhonda Rogers".

Rhonda Rogers  
Staff Regulatory Technician  
ConocoPhillips Company

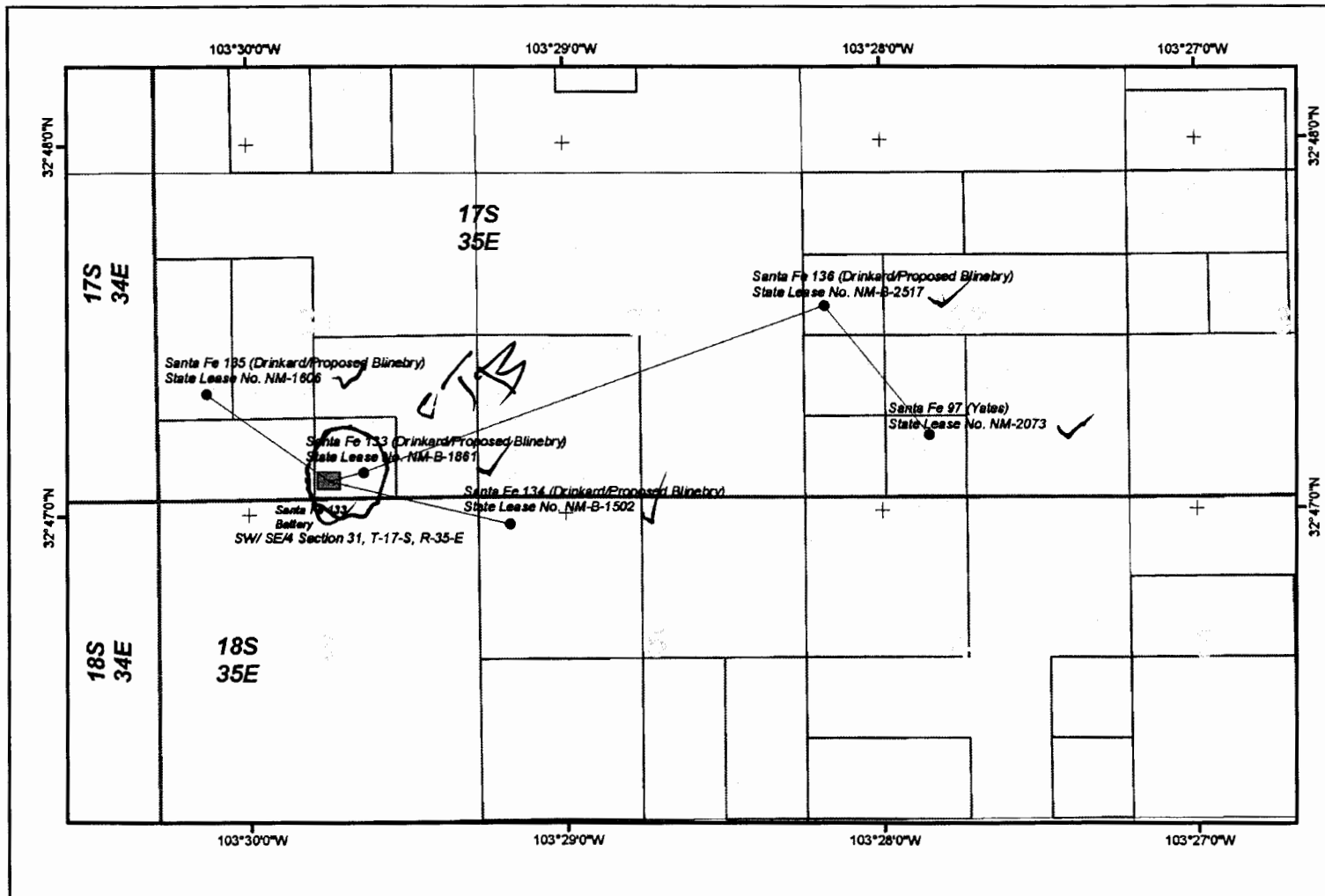

● Santa Fe Wells  
 COPC Lease Tracts



NAD27 - StatePlane - New Mexico East

ConocoPhillips  
 Mid-Continent

**Southeast New Mexico**  
**Santa Fe Wells & Battery**  
**Lea County, New Mexico**

Author: Don Rouse Date: 09/02/2017  
 Compiler: J. Hernandez Date: 11/23/2017  
 Project: Santa Fe Wells & Battery, Lea County, New Mexico

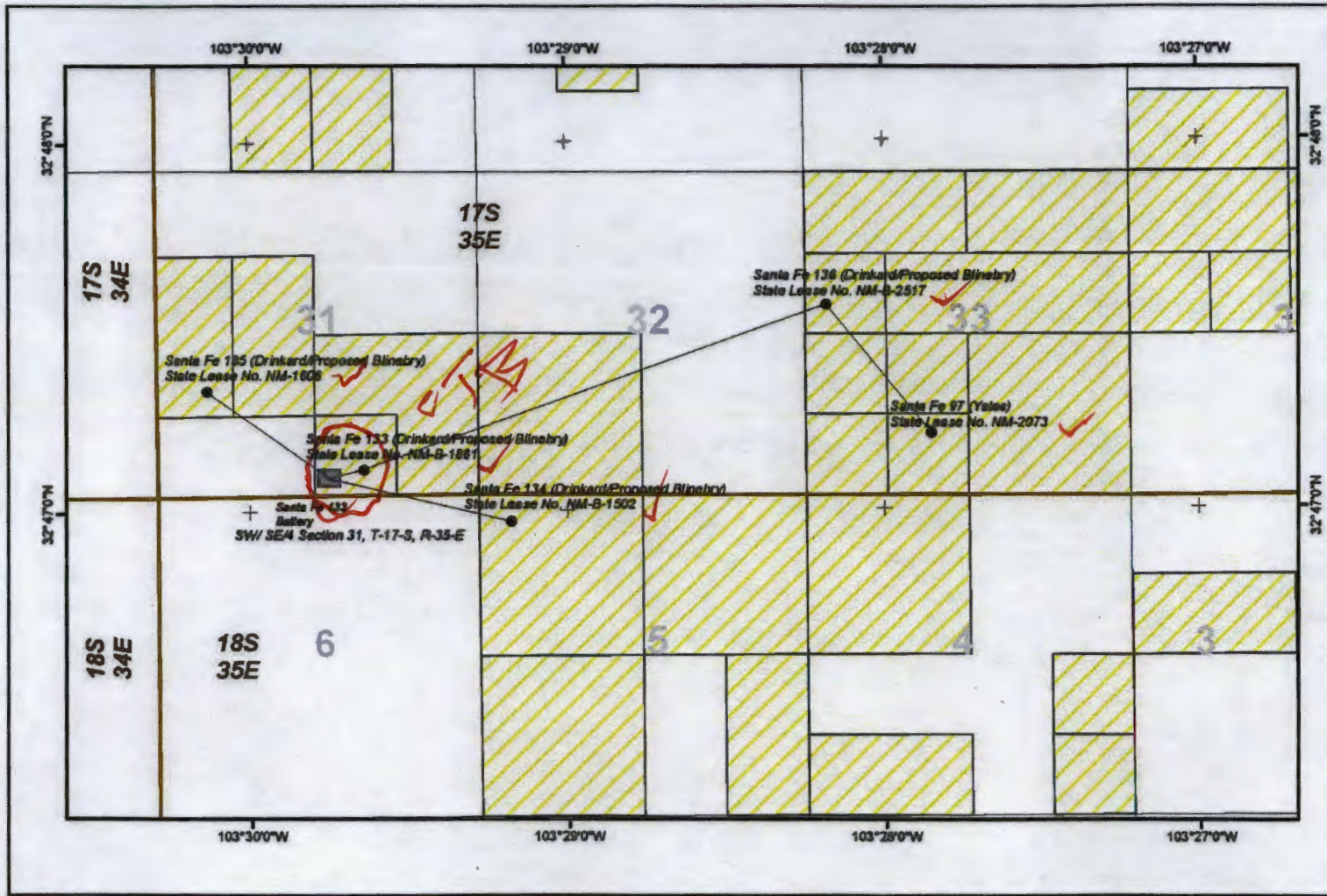

● Santa Fe Wells
   

 COPC Lease Tracts



NAD27 - StatePlane - New Mexico East

ConocoPhillips

**Mid-Continent**
  
**Southeast New Mexico**
  
**Santa Fe Wells & Battery**
  
**Los County, New Mexico**

Author: Dan Perea	Date: 02/09/2017
Checked by: [illegible]	Scale: 1" = 100'
<small>           Printed on: 02/09/2017 10:00 AM                       Project: Santa Fe Wells &amp; Battery - Section 31 of T-17-S, R-35-E         </small>	

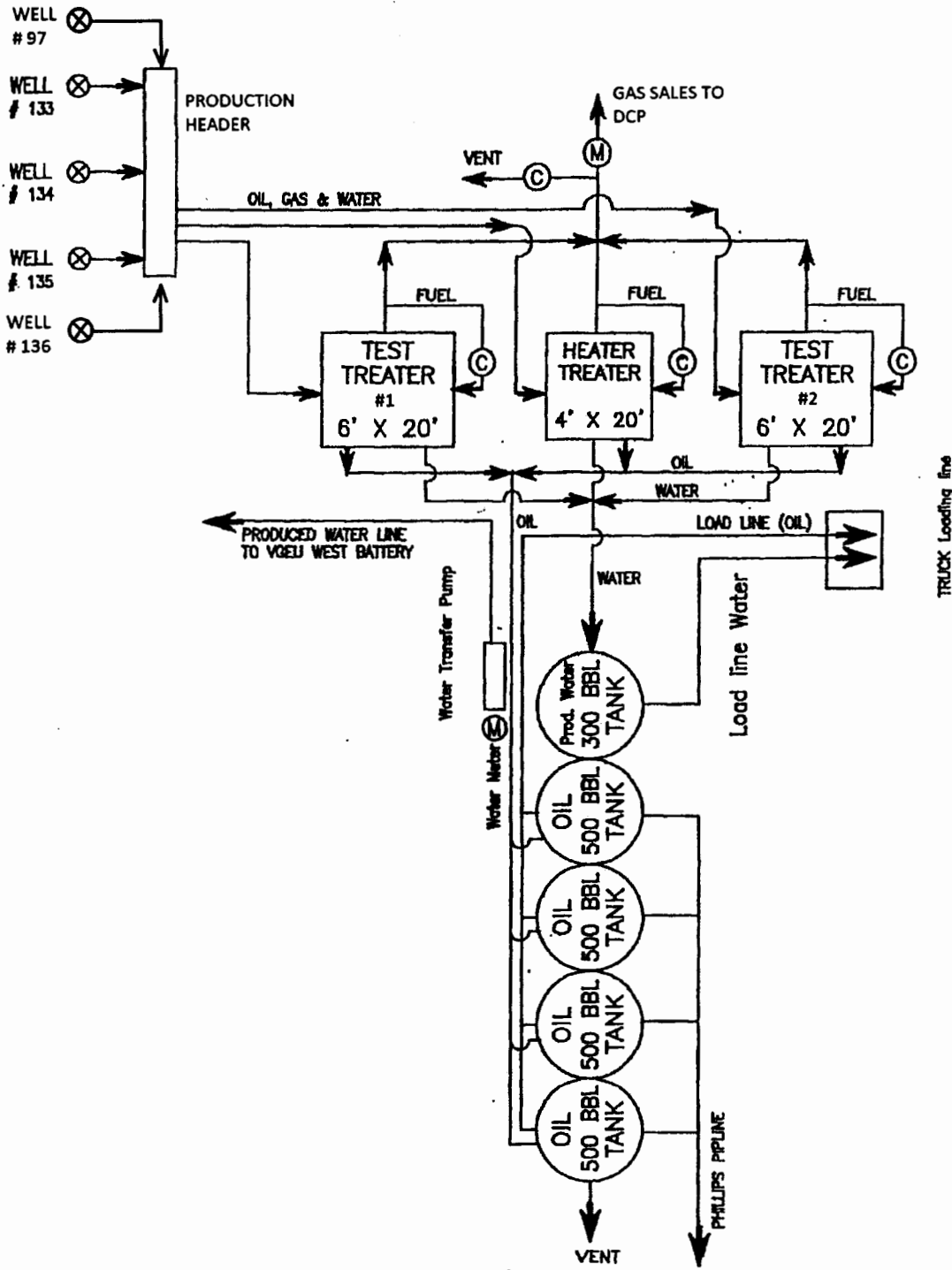

H:\ACAD\FILE\PARS\SANTAFE.DWG		UPDATED			
NO.	REVISION	BY	DATE	CHKD	APP'D
FOR BIDS	<b>PHILLIPS PETROLEUM COMPANY</b> BARTLESVILLE, OKLAHOMA			JA NO.	FILE CODE
FOR APPR				AFE NO.	SCALE
FOR CONST	LEASE NAME: SANTA FE 133 LEASE CODE: 600015 NETWORK: 503			NO	
DRAWN 2/4/2014	DGH			FILE NAME: HOBBS	
CHECKED				DWG NO. 1.0	
APP'D					

RC-ORIGINAL

FORM 1779-S



CONOCOPHILLIPS COMPANY

APPLICATION FOR SURFACE COMMINGLING

SANTA FE LEASE, (VACUUM-YATES)/(VACUUM-DRINKARD)/(PROPOSED VACUUM-BLINEBRY) POOLS

Wells	Current Pool	Proposed Pool to Commingle	Current Prod (Last Well Test)			Anticipated Additional Prod		
			Oil, BOPD	Water, BWPD	Gas, MCFD	Oil, BOPD	Water, BWPD	Gas, MCFD
Santa Fe #97 SE/4 SW/4 Section 33, T-17-S, R-35-E, Lea Co., NM	Vacuum: Yates (#62400) <i>C</i>		3	1	25			
Santa Fe #133 SW/4 SE/4 Section 31, T-17-S, R-35-E, Lea Co., NM	Vacuum: Drinkard (#62100)	Vacuum; Blinebry (#61850)	18	12	101	20	200	20
Santa Fe #134 NW/4 Section 5, T-18-S, R-35-E, Lea Co., NM	Vacuum: Drinkard (#62100)	Vacuum; Blinebry (#61850)	3	3	7			
Santa Fe #135 Lot 2 & 3 Section 31, T-17-S, R-35-E, Lea Co., NM	Vacuum: Drinkard (#62100)	Vacuum; Blinebry (#61850)	5	3	5			
Santa Fe #136 SW/4 NW/4 Sec. 33 T-17-S, R-35-E, Lea Co., NM	Vacuum: Drinkard (#62100) <sup>1</sup>	Vacuum; Blinebry (#61850)	6	1	1	20	200	20
Santa Fe 133 Battery SW/4 SE/4 Section 31, T-17-S, R-35-E, Lea Co., NM	Vacuum: Drinkard (#62100) Vacuum: Yates (#62400)	Vacuum; Blinebry (#61850)	35	20	139	40	400	40

*OK*

**CONOCOPHILLIPS COMPANY**  
**APPLICATION FOR SURFACE COMMINGLING Interest Owners**  
**SANTA FE LEASE, (VACUUM-YATES)/(VACUUM-DRINKARD)/(PROPOSED VACUUM-BLINEBRY) POOLS**

<b>Wells</b>	<b>API#</b>	<b>State Lse.#</b>	<b>COP W.I. %</b>	<b>COP N.R.I.%</b>	<b>State of NM RI %</b>	<b>ORRI %</b>
Santa Fe #97 SE/4 SW/4 Section 33, T-17-S, R-35-E, Lea Co., NM	30-025-20791	NM-2073	100%	87.50%	12.50%	0%
Santa Fe #133 SW/4 SE/4 Section 31, T-17-S, R-35-E, Lea Co., NM	30-025-32333	NM-B-1861	100%	87.50%	12.50%	0%
Santa Fe #134 NW/4 Section 5, T-18-S, R-35-E, Lea Co., NM	30-025-32414	NM-B-1502	100%	87.50%	12.50%	0%
Santa Fe #135 Lot 2 & 3 Section 31, T-17-S, R-35-E, Lea Co., NM	30-025-32438	NM-1606	100%	87.50%	12.50%	0%
Santa Fe #136 SW/4 NW/4 Sec. 33 T-17-S, R-35-E, Lea Co., NM	30-025-33928	NM-B-2517	100%	87.50%	12.50%	0%
<b>Santa Fe 133 Battery</b> <b>SW/4 SE/4 Section 31, T-17-S, R-35-E, Lea Co., NM</b>						



### **Well Testing**

All production from the Santa Fe Leases listed on this application will go through the same production header located at the Santa Fe 133 Battery. When there is not a well in test, all of the production is gathered at this header and sent through a trunk line to the heater treater/ separator where the oil, gas and water are separated and sent to their respective tanks or sales meter. When a well is put in test, it is sent through a separate testing line to a separate test treater/separator that measures the amount of oil, water, and gas produced for that particular well. These volumes will be added to the well test volumes of the other producing wells in this battery for the allocation process. The individual well tests will ultimately allocate the total battery production to each well.