

DATE IN 3/31/2014	SUSPENSE	ENGINEER MAM	LOGGED IN 2/03/2014	TYPE NSL	APP NO. PMAM1403429701
----------------------	----------	-----------------	------------------------	-------------	---------------------------

ABOVE THIS LINE FOR DIVISION USE ONLY

NEW MEXICO OIL CONSERVATION DIVISION
 - Engineering Bureau -
 1220 South St. Francis Drive, Santa Fe, NM 87505



ADMINISTRATIVE APPLICATION CHECKLIST

THIS CHECKLIST IS MANDATORY FOR ALL ADMINISTRATIVE APPLICATIONS FOR EXCEPTIONS TO DIVISION RULES AND REGULATIONS WHICH REQUIRE PROCESSING AT THE DIVISION LEVEL IN SANTA FE

Application Acronyms:

[NSL-Non-Standard Location] [NSP-Non-Standard Proration Unit] [SD-Simultaneous Dedication]
[DHC-Downhole Commingling] [CTB-Lease Commingling] [PLC-Pool/Lease Commingling]
[PC-Pool Commingling] [OLS - Off-Lease Storage] [OLM-Off-Lease Measurement]
[WFX-Waterflood Expansion] [PMX-Pressure Maintenance Expansion]
[SWD-Salt Water Disposal] [IPI-Injection Pressure Increase]
[EOR-Qualified Enhanced Oil Recovery Certification] [PPR-Positive Production Response]

[1] **TYPE OF APPLICATION** - Check Those Which Apply for [A]

[A] Location - Spacing Unit - Simultaneous Dedication
☒ NSL ☐ NSP ☐ SD

Check One Only for [B] or [C]

[B] Commingling - Storage - Measurement
☐ DHC ☐ CTB ☐ PLC ☐ PC ☐ OLS ☐ OLM

[C] Injection - Disposal - Pressure Increase - Enhanced Oil Recovery
☐ WFX ☐ PMX ☐ SWD ☐ IPI ☐ EOR ☐ PPR

[D] Other: Specify _____

[2] **NOTIFICATION REQUIRED TO:** - Check Those Which Apply, or Does Not Apply

[A] ☐ Working, Royalty or Overriding Royalty Interest Owners
 [B] ☐ Offset Operators, Leaseholders or Surface Owner
 [C] ☐ Application is One Which Requires Published Legal Notice
 [D] ☐ Notification and/or Concurrent Approval by BLM or SLO
U.S. Bureau of Land Management - Commissioner of Public Lands, State Land Office
 [E] ☐ For all of the above, Proof of Notification or Publication is Attached, and/or,
 [F] ☐ Waivers are Attached

[3] **SUBMIT ACCURATE AND COMPLETE INFORMATION REQUIRED TO PROCESS THE TYPE OF APPLICATION INDICATED ABOVE.**

[4] **CERTIFICATION:** I hereby certify that the information submitted with this application for administrative approval is **accurate** and **complete** to the best of my knowledge. I also understand that **no action** will be taken on this application until the required information and notifications are submitted to the Division.

Note: Statement must be completed by an individual with managerial and/or supervisory capacity.

MICHAEL H. FELDEWERT

Print or Type Name

Signature

ATTORNEY

Title

01/31/14

Date

mfeldewert@hollandhart.com
 e-mail Address

- NSL 7006
 - EOG Resources
 7377
 2014 01 31 09 35
 2014 01 31 09 35
 - Hawk 35 #7H
 30-025 pending
 Pool
 Red Hills upper
 Bowe Spring
 Shale
 97900

January 31, 2014

VIA HAND DELIVERY

Jami Bailey
Oil Conservation Division
New Mexico Department of Energy,
Minerals and Natural Resources
1220 South Saint Francis Drive
Santa Fe, New Mexico 87505

Re: Application of EOG Resources, Inc. for administrative approval of an unorthodox well location for its Hawk 35 Fed 7H Well to be located in Section 26, Township 24 South, Range 33 East, N.M.P.M., Lea County, New Mexico.

Dear Ms. Bailey:

EOG Resources, Inc. (OGRID No. 7377) seeks administrative approval of an unorthodox well location for its **Hawk 35 Fed 7H Well** to be completed within the Red Hills; Upper Bone Spring Shale Pool (Pool Code 97900) underlying Section 26, Township 24 South, Range 33 East, N.M.P.M., Lea County, New Mexico. This well will be drilled from a surface location 500 feet from the North line and 2007 feet from the East line of Section 35, Township 24 South, Range 33 East but completed wholly within Section 26. The upper most perforation will be 50 feet from the South line and 1889 feet from the East line of Section 26 (Unit O) and the lower most perforation will be 330 feet from the North line and 1882 feet from the East line of Section 26 (Unit B). Since this acreage is governed by the Division's statewide rules which provides for wells to be located no closer than 330 feet to the outer boundary of the spacing unit, the upper most perforation for this well will be unorthodox, but the remaining portion of the completed interval will comply with the Division's setback requirements. Approval of the unorthodox completed interval will prevent waste of a productive reservoir and improve well performance.

Exhibit A is the Well Location and Acreage Dedication Plat (Form C-102), which shows that the completed interval of the proposed **Hawk 35 Fed 7H Well** encroaches on the spacing and proration unit to the South.

Exhibit B is a land plat for Section 26 and the surrounding sections that shows the proposed **Hawk 35 Fed 7H Well** in relation to adjoining units and existing wells. There are no affected parties for this application since EOG is the sole operator and mineral lessee of the federal lease

HOLLAND & HART LLP



covering Sections 26 and 35. Nonetheless, a copy of this application has been provided to the Bureau of Land Management.

Your attention to this matter is appreciated.

Sincerely,

Michael H. Feldewert

ATTORNEY FOR EOG RESOURCES, INC.

cc: Bureau of Land Management
620 E. Green Street
Carlsbad, NM 88220

Enclosures

District I
1625 N. French Dr., Hobbs, NM 88240
Phone: (575) 393-6161 Fax: (575) 393-0720
District II
811 S First St., Artesia, NM 88210
Phone: (575) 748-1283 Fax: (575) 748-9720
District III
1000 Rio Brazos Road, Aztec, NM 87410
Phone: (505) 334-6178 Fax: (505) 334-6170
District IV
1220 S. St. Francis Dr., Santa Fe, NM 87505
Phone: (505) 476-3460 Fax: (505) 476-3462

State of New Mexico
Energy, Minerals & Natural Resources
Department
OIL CONSERVATION DIVISION
1220 South St. Francis Dr.
Sante Fe, NM 87505

FORM C-102
Revised August 1, 2011
Submit one copy to appropriate
District Office
☐ AMENDED REPORT

WELL LOCATION AND ACREAGE DEDICATION PLAT

¹ API Number		² Pool Code	³ Pool Name
⁴ Property Code	⁵ Property Name HAWK 35 FED		⁶ Well Number #7H
⁷ OGRID No.	⁸ Operator Name EOG RESOURCES, INC.		⁹ Elevation 3519'

¹⁰Surface Location

UL or lot no.	Section	Township	Range	Lot Idn	Feet from the	North/South line	Feet from the	East/West line	County
B	35	24-S	33-E	-	500'	NORTH	2007'	EAST	LEA

UL or lot no.	Section	Township	Range	Lot Idn	Feet from the	North/South line	Feet from the	East/West line	County
B	26	24-S	33-E	-	230'	NORTH	1882'	EAST	LEA

¹² Dedicated Acres	¹³ Joint or Infill	¹⁴ Consolidation Code	¹⁵ Order No.
-------------------------------	-------------------------------	----------------------------------	-------------------------

No allowable will be assigned to this completion until all interests have been consolidated or a non-standard unit has been approved by the division.

		<p>¹⁷OPERATOR CERTIFICATION</p> <p>I hereby certify that the information contained herein is true and complete to the best of my knowledge and belief, and that this organization either owns a working interest or undivided mineral interest in the land including the proposed bottom hole location or has a right to drill this well at this location pursuant to a contract with an owner of such a mineral or working interest, or to a voluntary pooling agreement or a compulsory pooling order heretofore entered by the division.</p> <p>Signature _____ Date _____</p> <p>Printed Name _____</p> <p>E-mail Address _____</p>
<p>¹⁸SURVEYOR CERTIFICATION</p> <p>I hereby certify that the well location shown on this plat was plotted from field notes of actual surveys made by me or under my supervision, and that the same is true to the best of my belief.</p> <p>Date of Survey _____ Signature _____</p>		<p>10/29/2013</p> <p>NEW MEXICO</p> <p>18329</p> <p>PROFESSIONAL SURVEYOR</p>
<p>EXHIBIT</p> <p>A</p>		<p>Certificate Number</p>

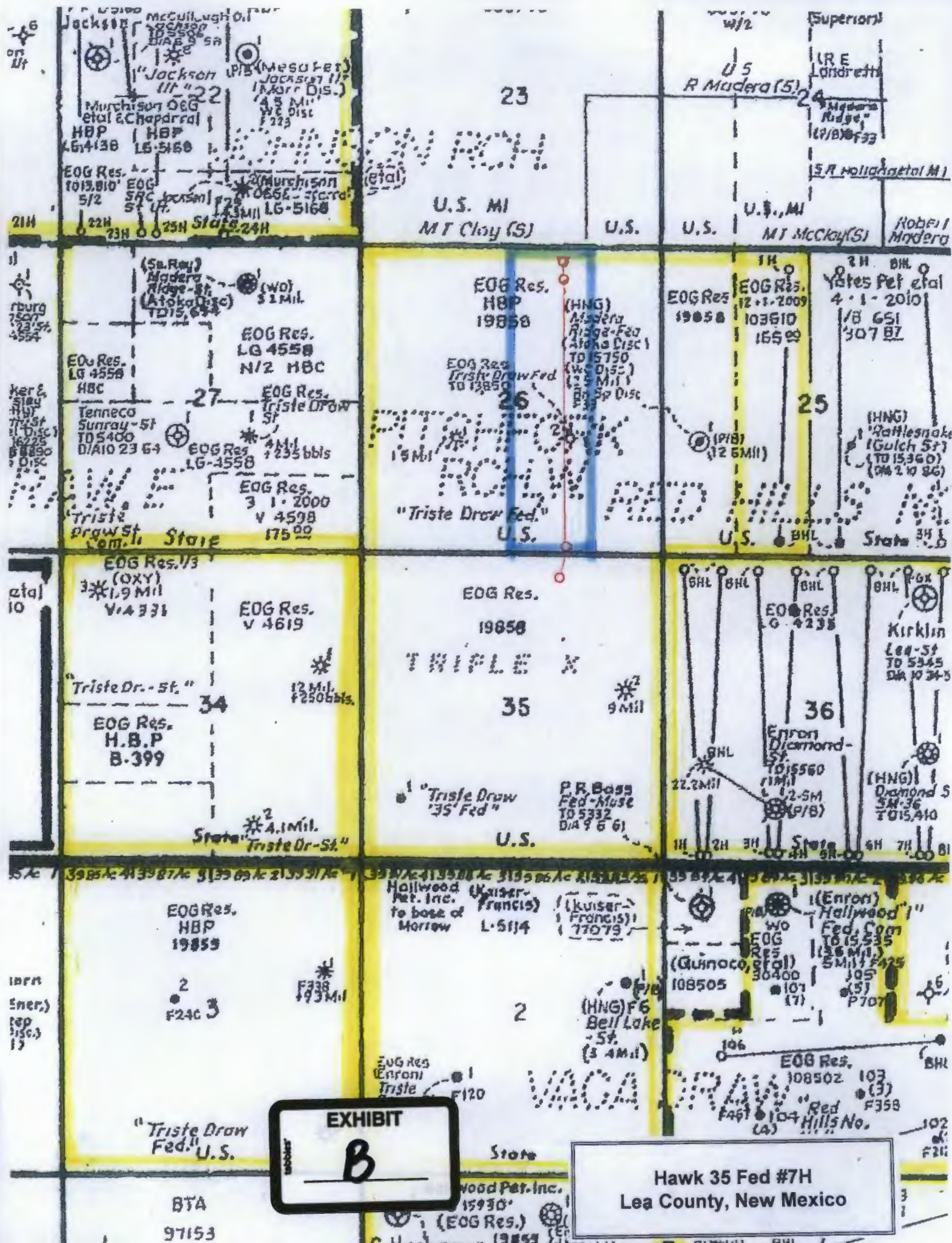

McMillan, Michael, EMNRD

From: Michael Feldewert <MFeldewert@hollandhart.com>
Sent: Tuesday, February 04, 2014 12:31 PM
To: McMillan, Michael, EMNRD
Cc: Ezeanyim, Richard, EMNRD; Goetze, Phillip, EMNRD
Subject: EOG Hawk 35 wells 1H through 10H

Michael: You are correct that the bottom hole location for each of these ten wells will be 230 FNL. However, as I understand the Division's Rules, it is the "completed interval" that controls whether the well is unorthodox, not the surfaced location or the bottomhole location. Accordingly, each of the ten applications identify the location of the upper and lower most perforations for the purpose determining the areas of encroachment.

I trust that this addresses the inquiries in the two emails you sent yesterday. If you need any more information, please feel free to contact me.

Michael H. Feldewert

Partner

Holland & Hart, LLP

Post Office Box 2208

Santa Fe, New Mexico 87504-2208

Phone (505) 988-4421

E-mail: mfeldewert@hollandhart.com

[Download vCard](#)

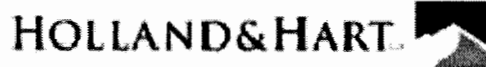

CONFIDENTIALITY NOTICE: This message is confidential and may be privileged. If you believe that this email has been sent to you in error, please reply to the sender that you received the message in error; then please delete this e-mail. Thank you.

From: McMillan, Michael, EMNRD [<mailto:Michael.McMillan@state.nm.us>]
Sent: Monday, February 03, 2014 12:53 PM
To: Michael Feldewert
Cc: Ezeanyim, Richard, EMNRD; Goetze, Phillip, EMNRD
Subject: EOG Hawk 35 1H,3H,5H,6H,8H

Mr. Feldewert:

Can you clarify the bottom hole locations for the EOG Hawk 35 1H, 3H, 5H, 6H, and 8H. Sec. 35 T24S33E.

The bottom hole location according to the C-102 for all of these wells is 230 FNL. Your letter states the bottom hole location is 330 FNL.

These wells do require notification of offset owners.

Thank You

Michael A. McMillan

Engineering and Geological Services Bureau, Oil Conservation Division

1220 South St. Francis Dr., Santa Fe NM 87505

O: 505.476.3448 F. 505.476.3462