

ABOVE THIS LINE FOR DIVISION USE ONLY

NEW MEXICO OIL CONSERVATION DIVISION
 - Engineering Bureau -
 1220 South St. Francis Drive, Santa Fe, NM 87505



ADMINISTRATIVE APPLICATION CHECKLIST

THIS CHECKLIST IS MANDATORY FOR ALL ADMINISTRATIVE APPLICATIONS FOR EXCEPTIONS TO DIVISION RULES AND REGULATIONS WHICH REQUIRE PROCESSING AT THE DIVISION LEVEL IN SANTA FE

Application Acronyms:

- [NSL-Non-Standard Location] [NSP-Non-Standard Proration Unit] [SD-Simultaneous Dedication]**
[DHC-Downhole Commingling] [CTB-Lease Commingling] [PLC-Pool/Lease Commingling]
[PC-Pool Commingling] [OLS - Off-Lease Storage] [OLM-Off-Lease Measurement]
[WFX-Waterflood Expansion] [PMX-Pressure Maintenance Expansion]
[SWD-Salt Water Disposal] [IPI-Injection Pressure Increase]
[EOR-Qualified Enhanced Oil Recovery Certification] [PPR-Positive Production Response]

- [1] **TYPE OF APPLICATION** - Check Those Which Apply for [A]
- [A] Location - Spacing Unit - Simultaneous Dedication
 NSL NSP SD
- Check One Only for [B] or [C]
- [B] Commingling - Storage - Measurement
 DHC CTB PLC PC OLS OLM
- [C] Injection - Disposal - Pressure Increase - Enhanced Oil Recovery
 WFX PMX SWD IPI EOR PPR
- [D] Other: Specify _____

-SWD
 -COG OPERATING
 229137
 well
 -Cottonwood 2 State
 SWD#1
 30-015-Pending

- [2] **NOTIFICATION REQUIRED TO:** - Check Those Which Apply, or Does Not Apply
- [A] Working, Royalty or Overriding Royalty Interest Owners
- [B] Offset Operators, Leaseholders or Surface Owner
- [C] Application is One Which Requires Published Legal Notice
- [D] Notification and/or Concurrent Approval by BLM or SLO
U.S. Bureau of Land Management - Commissioner of Public Lands, State Land Office
- [E] For all of the above, Proof of Notification or Publication is Attached, and/or,
- [F] Waivers are Attached

Pool
 -SWD, Devonian -
 Silurian
 97869

[3] **SUBMIT ACCURATE AND COMPLETE INFORMATION REQUIRED TO PROCESS THE TYPE OF APPLICATION INDICATED ABOVE.**

[4] **CERTIFICATION:** I hereby certify that the information submitted with this application for administrative approval is **accurate** and **complete** to the best of my knowledge. I also understand that **no action** will be taken on this application until the required information and notifications are submitted to the Division.

Note: Statement must be completed by an individual with managerial and/or supervisory capacity.

BRIAN COLLINS _____
 Print or Type Name

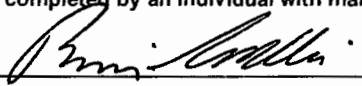

 Signature

SENIOR OPERATIONS ENGINEER _____
 Title

13 Feb 2014
 Date

bcollins@concho.com
 e-mail Address

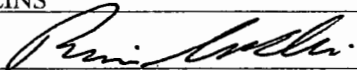
APPLICATION FOR AUTHORIZATION TO INJECT

- I. PURPOSE: _____ Secondary Recovery _____ Pressure Maintenance Disposal _____ Storage
Application qualifies for administrative approval? Yes _____ No
- II. OPERATOR: _____ COG OPERATING LLC _____
ADDRESS: _____ 2208 W. Main Street, ARTESIA, NM 88210 _____
CONTACT PARTY: _____ BRIAN COLLINS _____ PHONE: _____ 575-748-6940 _____
- III. WELL DATA: Complete the data required on the reverse side of this form for each well proposed for injection.
Additional sheets may be attached if necessary.
- IV. Is this an expansion of an existing project? _____ Yes No
If yes, give the Division order number authorizing the project: _____
- V. Attach a map that identifies all wells and leases within two miles of any proposed injection well with a one-half mile radius circle drawn around each proposed injection well. This circle identifies the well's area of review.
- VI. Attach a tabulation of data on all wells of public record within the area of review which penetrate the proposed injection zone. Such data shall include a description of each well's type, construction, date drilled, location, depth, record of completion, and a schematic of any plugged well illustrating all plugging detail.
- VII. Attach data on the proposed operation, including:
1. Proposed average and maximum daily rate and volume of fluids to be injected;
 2. Whether the system is open or closed;
 3. Proposed average and maximum injection pressure;
 4. Sources and an appropriate analysis of injection fluid and compatibility with the receiving formation if other than reinjected produced water; and,
 5. If injection is for disposal purposes into a zone not productive of oil or gas at or within one mile of the proposed well, attach a chemical analysis of the disposal zone formation water (may be measured or inferred from existing literature, studies, nearby wells, etc.).
- *VIII. Attach appropriate geologic data on the injection zone including appropriate lithologic detail, geologic name, thickness, and depth. Give the geologic name, and depth to bottom of all underground sources of drinking water (aquifers containing waters with total dissolved solids concentrations of 10,000 mg/l or less) overlying the proposed injection zone as well as any such sources known to be immediately underlying the injection interval.
- IX. Describe the proposed stimulation program, if any.
- *X. Attach appropriate logging and test data on the well. (If well logs have been filed with the Division, they need not be resubmitted).
- *XI. Attach a chemical analysis of fresh water from two or more fresh water wells (if available and producing) within one mile of any injection or disposal well showing location of wells and dates samples were taken.
- XII. Applicants for disposal wells must make an affirmative statement that they have examined available geologic and engineering data and find no evidence of open faults or any other hydrologic connection between the disposal zone and any underground sources of drinking water.
- XIII. Applicants must complete the "Proof of Notice" section on the reverse side of this form.
- XIV. Certification: I hereby certify that the information submitted with this application is true and correct to the best of my knowledge and belief.
- NAME: _____ BRIAN COLLINS _____ TITLE: _____ Senior Operations Engineer _____
SIGNATURE: _____  _____ DATE: _____ 13 Feb 2014 _____
- E-MAIL ADDRESS: _____ bcollins@concho.com _____
- * If the information required under Sections VI, VIII, X, and XI above has been previously submitted, it need not be resubmitted.
Please show the date and circumstances of the earlier submittal: _____

C-108 Application for Authorization to Inject
COTTONWOOD 2 STATE SWD 1
400' FSL, 1400' FEL
Unit O, Sec 2, T26S, R26E
Eddy County, NM

COG Operating, LLC, proposes to drill the captioned well and make it into an open hole Devonian-Silurian-Ordovician SWD well from approximately 13100' to 14600'.

- V. Map is attached.
- VI. No wells within the ½ mile radius area of review penetrate the proposed injection zone.
- VII.
 1. Proposed average daily injection rate = 7000 BWPD
Proposed maximum daily injection rate = 20,000 BWPD
 2. Closed system
 3. Proposed maximum injection pressure = 2620 psi
(0.2 psi/ft. x 13100' ft.)
 4. Source of injected water will be Delaware Sand, Bone Spring and Wolfcamp produced water. No compatibility problems are expected (we've seen no compatibility issues in a Devonian SWD located in Sec.16-26s-28e that takes the same produced water as the proposed SWD well). Analyses of Delaware, Bone Spring and Wolfcamp waters are attached. There are no Devonian-Silurian-Ordovician receiving formation water analyses available in this area. —
- VIII. The injection zone is the Devonian-Silurian-Ordovician from 13100' to 14600' which is composed of porous limestone and dolomite. Any underground water sources will be shallower than 300' based on surface casing setting depth.
- IX. The Devonian-Silurian-Ordovician injection interval will be acidized with approximately 40,000 gals of 20% HCl acid.
- X. Well logs if run will be filed with the Division. There are no nearby well logs available for the Devonian-Silurian-Ordovician section. *-CBL/Logs for salinity/pick/mudlog for HC potential*
- XI. There are no fresh water wells within a mile of the proposed SWD well.
- XII. After examining the available geologic and engineering data, no evidence was found of open faults or any other hydrologic connection between the disposal zone and any underground sources of drinking water. ✓
- XIII. Proof of Notice is attached.

III.

WELL DATA

INJECTION WELL DATA SHEET

OPERATOR: COG Operating, LLC

WELL NAME & NUMBER: Cottonwood 2 State SWD No. 1

WELL LOCATION: 400' FSL 1400' FEL 0 2 26s 26e
FOOTAGE LOCATION UNIT LETTER SECTION TOWNSHIP RANGE

WELLBORE SCHEMATIC

WELL CONSTRUCTION DATA

Surface Casing

Hole Size: 26" Casing Size: 20" @ ± 300'
Cemented with: - sx. or ± 900 ft³
Top of Cement: Surface Method Determined: Design

See Proposed Wellbore Schematic

Intermediate Casings

Hole Size: 17 1/2" Casing Size: 13 3/8" @ ± 1950'
12 1/4" or ± 8700'
Cemented with: - sx. or ± 2700 ft³
± 3400
Top of Cement: Surface Method Determined: Design
1500' Design

Production Casing (Liner)

Hole Size: 8 3/4" Casing Size: 7" liner ± 8400 - 13100'
Cemented with: - sx. or ± 1050 ft³
Top of Cement: Top of liner Method Determined: Design
Total Depth: ± 14600'

Injection Interval

6 1/8" Open Hole ± 13,100' feet to ± 14600'

(Perforated or Open Hole) indicate which)

INJECTION WELL DATA SHEET

Tubing Size: 4 1/2" Lining Material: Glassbore or Duoline 20
Type of Packer: Nickel plated 10K double grip retrievable
Packer Setting Depth: ± 13050'
Other Type of Tubing/Casing Seal (if applicable): NIA

Additional Data

1. Is this a new well drilled for injection? X Yes No
If no, for what purpose was the well originally drilled? NIA

2. Name of the Injection Formation: Devonian-Silurian-Ordovician

3. Name of Field or Pool (if applicable): Cottonwood Draw

4. Has the well ever been perforated in any other zone(s)? List all such perforated intervals and give plugging detail, i.e. sacks of cement or plug(s) used. No

5. Give the name and depths of any oil or gas zones underlying or overlying the proposed injection zone in this area:

Underlying : None
Overlying : Delaware 1855-5180'± , Bone Spring 6050-7800'±
Wolfcamp 9500'± , Strawn 10259-10412'±
Atoka 11342-11354'± , Morrow 11592-12263'±

30-015-

Cottonwood 2 State SWD 1
400' FSL, 1400' FEL
O-2-26s-26e
Eddy, NM

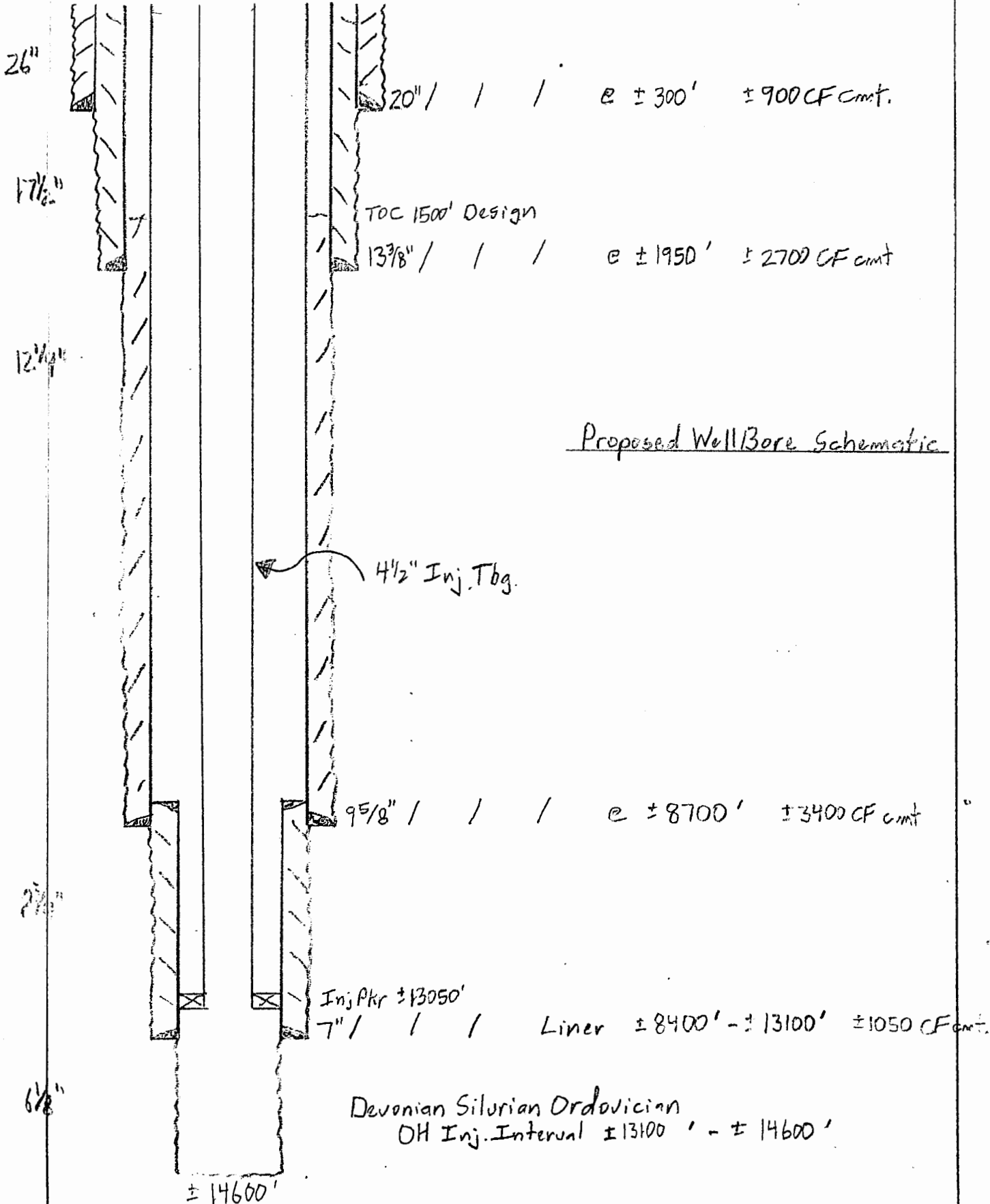

Proposed Well Bore Schematic

Devonian Silurian Ordovician
OH Inj. Interval ± 13100' - ± 14600'

V.

MAP

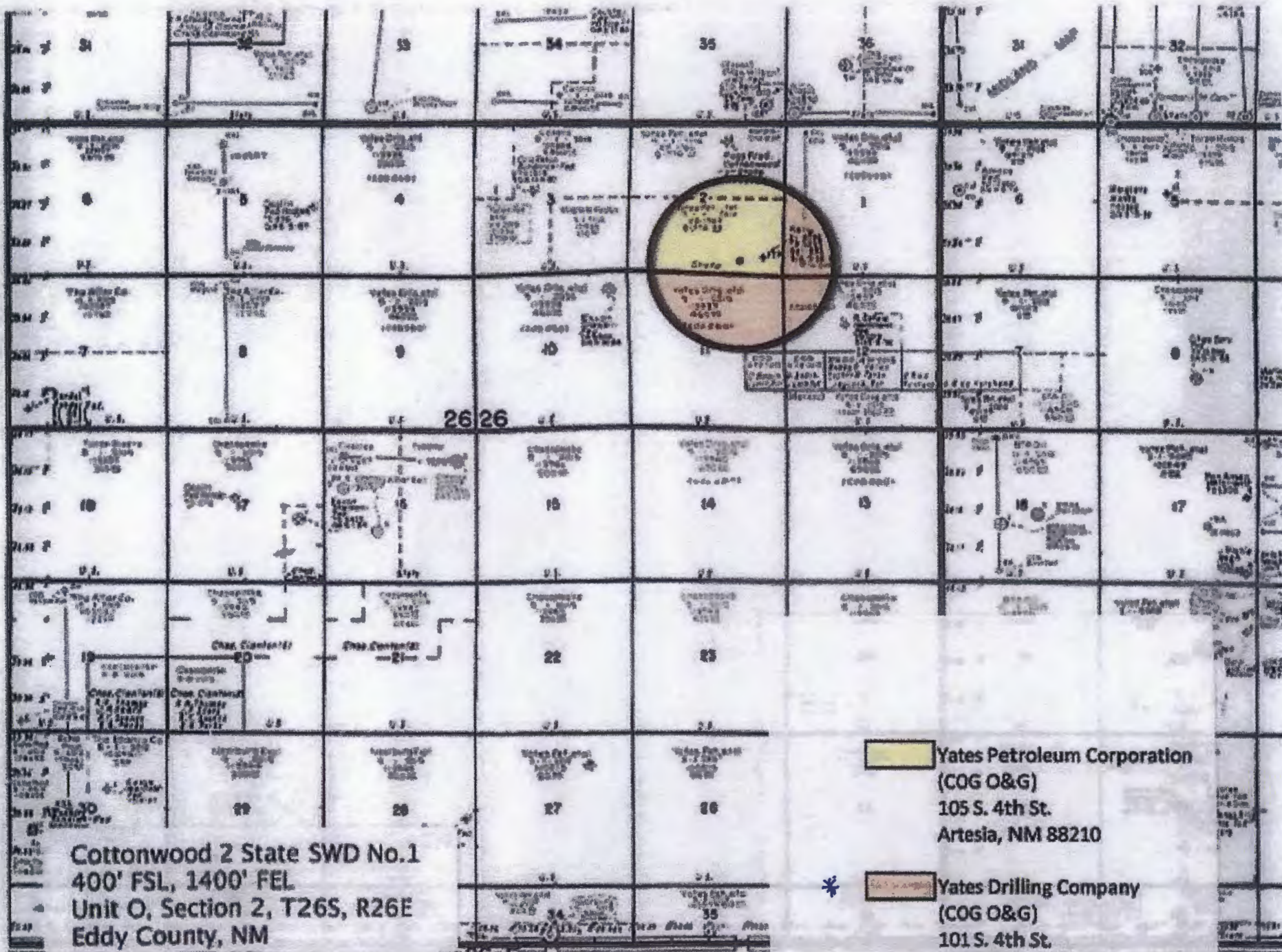

Cottonwood 2 State SWD No.1
 400' FSL, 1400' FEL
 Unit O, Section 2, T26S, R26E
 Eddy County, NM

 Yates Petroleum Corporation
 (COG O&G)
 105 S. 4th St.
 Artesia, NM 88210

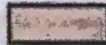
*  Yates Drilling Company
 (COG O&G)
 101 S. 4th St.
 Artesia, NM 88210

* Yates Drilling assets purchased by OXY.

n-26-E
 ON ALL NON LIBRARY MAP PRODUCTS

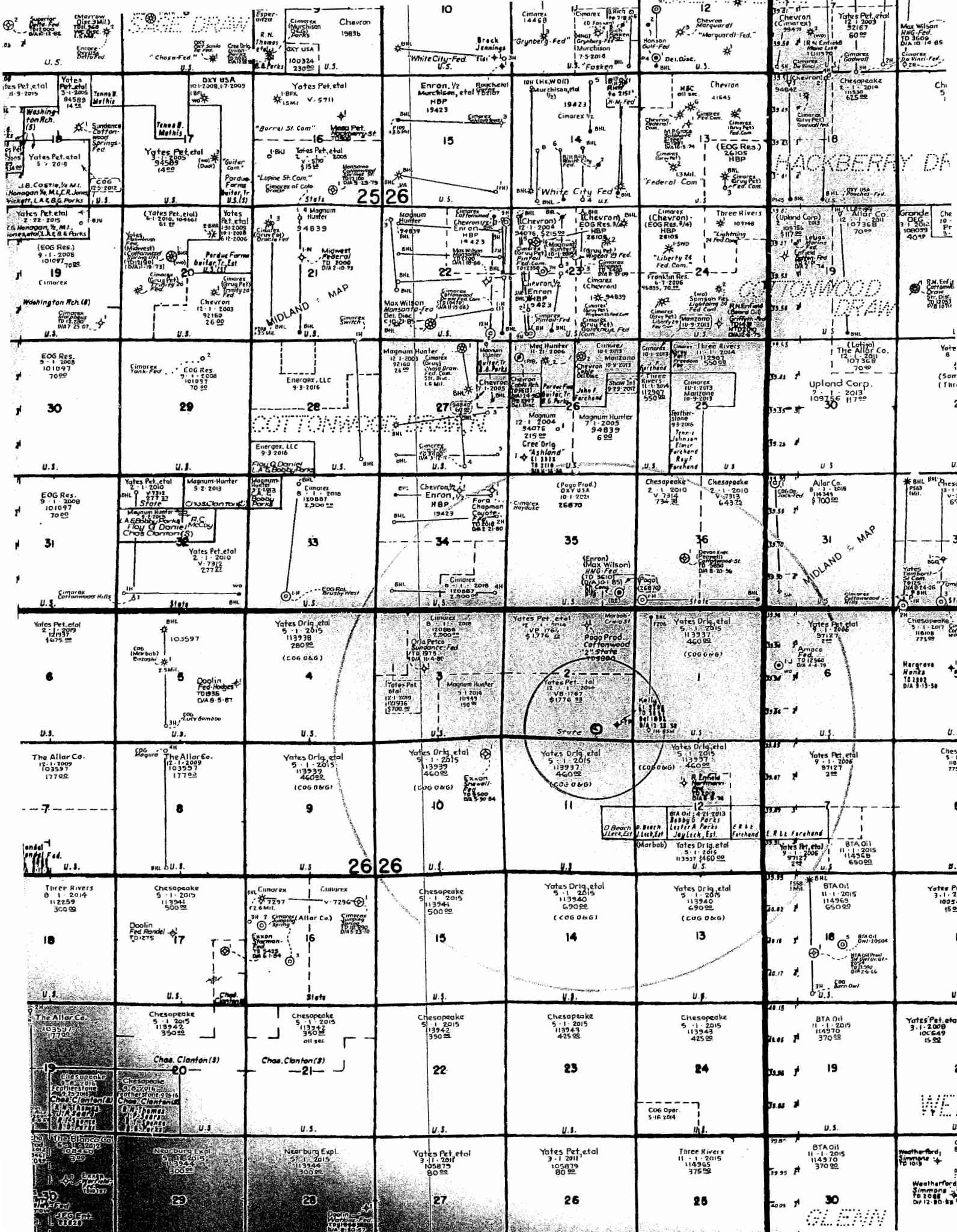

MACKBERRY DA

COTTONWOOD DRAW

MIDLAND MAP

WELLS

GLENN

2526

2626

2726

2826

2926

3026

3126

3226

3326

3426

3526

3626

3726

3826

3926

4026

4126

4226

4326

4426

4526

4626

4726

4826

4926

5026

5126

5226

5326

5426

5526

5626

5726

5826

5926

6026

6126

6226

6326

6426

6526

6626

6726

6826

6926

7026

7126

7226

7326

7426

7526

7626

7726

7826

7926

8026

8126

8226

8326

8426

8526

8626

8726

8826

8926

9026

9126

9226

9326

9426

9526

9626

9726

9826

9926

10026

10126

10226

10326

10426

10526

10626

10726

10826

10926

11026

11126

11226

11326

11426

VII.

Water Analysis Produced and Receiving Formation Water

WATER SAMPLES REPRESENTATIVE OF WATER BEING INJECTED INTO THE PROPOSED SWD WELL

Delaware												
Lab Test #	Lease	Location	Salesman	Date Out	Sample Date	Specific Gravity	Ionic Strength	TDS	pH	conductivity	Ca (mg/L)	Mg (mg/L)
011128362	Sly Hawk State	1	William D Polk	9/28/2011	9/13/2011	1.17	4.06	256802.26	6.50		26180.00	4101.14
Stone Spring												
Lab Test #	Lease	Location	Salesman	Date Out	Sample Date	Specific Gravity	Ionic Strength	TDS	pH	conductivity	Ca (mg/L)	Mg (mg/L)
012108003	Boyles	24 1H	William D Polk	4/16/2012	4/3/2012	1.13	3.41	206441.81	6.69		3700.86	841.87
Wolfcamp												
Lab Test #	Lease	Location	Salesman	Date Out	Sample Date	Specific Gravity	Ionic Strength	TDS	pH	conductivity	Ca (mg/L)	Mg (mg/L)
012105892	Augustus 10	1H		3/15/2012	3/8/2012	1.06	1.46	89771.55	6.60		3963.30	639.83

H (CaCO3)	Na (mg/L)	K (mg/L)	Zn (mg/L)	Fe (mg/L)	Ba (mg/L)	Sr (mg/L)	Mn (mg/L)	Resistivity	HCO3 (mg/L)	CO3 (mg/L)	OH (mg/L)	SO4 (mg/L)	Cl (mg/L)	CO2 (mg/L)	H2S (mg/L)
83379.63	62970.16	1133.12	38.78	20.06	1.64	905.03	9.33		73.00	0.00		70.00	161300.00	360.00	0.00
H (CaCO3)	Na (mg/L)	K (mg/L)	Zn (mg/L)	Fe (mg/L)	Ba (mg/L)	Sr (mg/L)	Mn (mg/L)	Resistivity	HCO3 (mg/L)	CO3 (mg/L)	OH (mg/L)	SO4 (mg/L)	Cl (mg/L)	CO2 (mg/L)	H2S (mg/L)
13271.35	69386.15	1109.30	0.00	17.57	0.00	483.07	0.00		1403.00	0.00		700.00	128800.00	400.00	0.00
H (CaCO3)	Na (mg/L)	K (mg/L)	Zn (mg/L)	Fe (mg/L)	Ba (mg/L)	Sr (mg/L)	Mn (mg/L)	Resistivity	HCO3 (mg/L)	CO3 (mg/L)	OH (mg/L)	SO4 (mg/L)	Cl (mg/L)	CO2 (mg/L)	H2S (mg/L)
13352.51	28320.32	350.70	0.00	17.85	1.77	707.79	0.00		220.00	0.00		950.00	54600.00	60.00	0.00

XI.

Fresh Water Sample Analyses



New Mexico Office of the State Engineer

Active & Inactive Points of Diversion

(with Ownership Information)

WR File Nbr	Sub basin	Use	Diversion	Owner	County	POD Number	Code Grant	Source			X	Y		
								q	q	q				
C 00974	C	DOM	3	CARLSBAD CITY SCHOOLS	ED	C 00974		6416	4	3	25S	26E	569074	3549831*
							<i>Location not correct. Actually in 3-sec 35-25s-26e.</i>							

(R=POD has been replaced and no longer serves this file, (quarters are 1=NW 2=NE 3=SW 4=SE)
 C=the file is closed) (quarters are smallest to largest) (NAD83 UTM in meters)

Record Count: 1

PLSS Search:

Section(s): 34, 35, 36 **Township:** 25S **Range:** 26E

Sorted by: File Number

*UTM location was derived from PLSS - see Help

The data is furnished by the NMOSE/ISC and is accepted by the recipient with the expressed understanding that the OSE/ISC make no warranties, expressed or implied, concerning the accuracy, completeness, reliability, usability, or suitability for any particular purpose of the data.

SK

146596
1

REVISED FEBRUARY 1969

(EXECUTE IN TRIPPLICATE ACCOMPANIED BY \$1.00 FILING FEE)

~~193674~~
462188

APPLICATION FOR PERMIT TO REPAIR OR DEEPEN WELL

Date Received July 28, 1986 File No. C-974

JUL 29 8 22 AM '86
STATE ENGINEER
SANTA FE COUNTY, NM

1. Name of Water Right Owner Carlsbad Municipal Schools
Mailing address 408 No. Canyon St.
City and State Carlsbad, NM 88220

2. Describe well location under one of the following subheadings:
a. SW $\frac{1}{4}$ of Sec. 35 Twp. 21 Rge. 26 E N. M. P. M. in
Eddy County.

b. Tract No. _____ of Map No. _____ of the _____ District.

c. Lot No. _____ of Block No. _____ of the _____ Subdivision, of record in
_____ County.

3. Source of supply non-artesian
(State whether artesian or non-artesian)

4. Right was acquired for air conditioning cooling purposes.

5. Type of repair contemplated: a. Clean out well to original depth b. Deepen well
from _____ to _____ feet c. Other see explanation in #7 below

6. Name of driller, if known: Woody's Welding & Winch Service

7. Additional statements or explanations: There were two wells drilled at the same time in 1961. One was a supply well and the other was a discharge well. We were having pump problems and when pulled found the supply well has either a casing problem or some other obstruction. In consulting with our engineer we feel that the best solution may be to switch the use of the two wells. We wish to run a test pump on the discharge well and possibly use it for supply water. We do not think we will need to clean the well and it is 500' deep.

STATE ENGINEER
SANTA FE COUNTY, NM
JUL 29 1986
AUG 19 10:23

I, DON G. FISHER affirm that the foregoing statements are true to the best of my knowledge and belief and that development shall not commence until approval of the permit has been obtained.

Carlsbad Municipal Schools, Applicant

By: [Signature]

Date: July 25, 1986

ACTION OF STATE ENGINEER

This application is approved for the work indicated, subject to all general conditions and to the specific conditions numbered 1 on the reverse side hereof. This permit will automatically expire unless work specified is completed and the well record filed on or before August 31, 1987.

S. E. Reynolds, State Engineer:

By: [Signature]
Delbert W. Nelson
Assistant District II Supervisor

Date: August 18, 1986

FILE NO.: C-974

LOG FILED: _____



New Mexico Office of the State Engineer
Water Column/Average Depth to Water

No records found.

PLSS Search:

Section(s): 34, 35, 36

Township: 25S

Range: 26E

The data is furnished by the NMOSE/ISC and is accepted by the recipient with the expressed understanding that the OSE/ISC make no warranties, expressed or implied, concerning the accuracy, completeness, reliability, usability, or suitability for any particular purpose of the data.



New Mexico Office of the State Engineer
Active & Inactive Points of Diversion
(with Ownership Information)

No PODs found.

PLSS Search:

Section(s): 1, 2, 3

Township: 26S

Range: 26E



New Mexico Office of the State Engineer
Water Column/Average Depth to Water

No records found.

PLSS Search:

Section(s): 1, 2, 3

Township: 26S

Range: 26E

The data is furnished by the NMOSE/ISC and is accepted by the recipient with the expressed understanding that the OSE/ISC make no warranties, expressed or implied, concerning the accuracy, completeness, reliability, usability, or suitability for any particular purpose of the data.

2/12/14 9:30 AM

Page 1 of 1

WATER COLUMN/ AVERAGE
DEPTH TO WATER



New Mexico Office of the State Engineer

Active & Inactive Points of Diversion

(with Ownership Information)

WR File Nbr	Sub basin	Use	Diversion	Owner	County	POD Number	Code Grant	Source			X	Y		
								q	q	q				
C 02438	STK	3	DORIS & OWEN CARLETON	ED	C 02438			6416	4	12	26S	26E	571015	3546705*

(R=POD has been replaced and no longer serves this file, (quarters are 1=NW 2=NE 3=SW 4=SE)
 C=the file is closed) (quarters are smallest to largest) (NAD83 UTM in meters)

(acre ft per annum)

Slightly greater than 1 mile away.

Record Count: 1

(Too many cattle present to allow water sampling at windmill...)

PLSS Search:

Section(s): 10, 11, 12 **Township:** 26S **Range:** 26E

Sorted by: File Number

*UTM location was derived from PLSS - see Help

The data is furnished by the NMOSE/ISC and is accepted by the recipient with the expressed understanding that the OSE/ISC make no warranties, expressed or implied, concerning the accuracy, completeness, reliability, usability, or suitability for any particular purpose of the data.



New Mexico Office of the State Engineer

Point of Diversion Summary

(quarters are 1=NW 2=NE 3=SW 4=SE)
(quarters are smallest to largest) (NAD83 UTM in meters)

POD Number	Q64	Q16	Q4	Sec	Tws	Rng	X	Y
C 02438	4	2	3	12	26S	26E	571015	3546705*

Driller License:

Driller Name:

Drill Start Date:

Drill Finish Date: 12/31/1945

Plug Date:

Log File Date:

PCW Rcv Date:

Source:

Pump Type:

Pipe Discharge Size:

Estimated Yield:

Casing Size: 3.00

Depth Well: 30 feet

Depth Water:

*UTM location was derived from PLSS - see Help

The data is furnished by the NMOSE/ISC and is accepted by the recipient with the expressed understanding that the OSE/ISC make no warranties, expressed or implied, concerning the accuracy, completeness, reliability, usability, or suitability for any particular purpose of the data.



New Mexico Office of the State Engineer

Water Column/Average Depth to Water

(A CLW##### in the POD suffix indicates the POD has been replaced & no longer serves a water right file.)

(R=POD has been replaced,
O=orphaned,

C=the file is (quarters are 1=NW 2=NE 3=SW 4=SE)
closed) (quarters are smallest to largest)

(NAD83 UTM in meters) (In feet)

POD Number	POD Sub-Code	basin	County	Q	Q	Q	Sec	Tws	Rng	X	Y	Depth Well	Depth Water	Water Column
C 02438			ED	4	2	3	12	26S	26E	571015	3546705*	30		

Average Depth to Water: --

Minimum Depth: --

Maximum Depth: --

Record Count: 1

PLSS Search:

Section(s): 10, 11, 12

Township: 26S

Range: 26E

*UTM location was derived from PLSS - see Help

The data is furnished by the NMOSE/ISC and is accepted by the recipient with the expressed understanding that the OSE/ISC make no warranties, expressed or implied, concerning the accuracy, completeness, reliability, usability, or suitability for any particular purpose of the data.



February 13, 2014

New Mexico Oil Conservation Division
Attn: Phillip Goetze
1220 South St. Francis Drive
Santa Fe, NM 87505

RE: Application For Authorization To Inject
Cottonwood 2 State SWD #1
Township 26 South, Range 26 East, N.M.P.M.
Section 2: 400' FSL & 1400' FEL
Eddy County, New Mexico

Dear Mr. Goetze:

COG Operating LLC respectfully requests administrative approval for authorization to inject for the referenced well. Attached, for your review, is a copy of the C-108 application. Once we receive the newspaper publication and all certified return receipts, I will send you a copy.

Please do not hesitate to contact me at (575) 748-6940 should you have any questions.

Sincerely,

A handwritten signature in black ink, appearing to read "Brian Collins".

Brian Collins
Senior Operations Engineer

BC/sw
Enclosures

CORPORATE ADDRESS

One Concho Center | 600 West Illinois Avenue | Midland, Texas 79701
PHONE 432.683.7443 | FAX 432.683.7441

LOCAL ADDRESS

Concho West | 2208 West Main Street | Artesia, New Mexico 88210
PHONE 575.748.6940 | FAX 575.748.6968



February 13, 2014

Oil Conservation Division
Attn: Richard Inge
811 South 1st St.
Artesia, NM 88210

RE: Application For Authorization To Inject
Cottonwood 2 State SWD #1
Township 26 South, Range 26 East, N.M.P.M.
Section 2: 400' FSL & 1400' FEL
Eddy County, New Mexico

Dear Mr. Inge:

COG Operating LLC respectfully requests administrative approval for authorization to inject for the referenced well. Attached, for your review, is a copy of the C-108 application. Once we receive the newspaper publication and all certified return receipts, I will send you a copy.

Please do not hesitate to contact me at (575) 748-6940 should you have any questions.

Sincerely,

A handwritten signature in black ink that reads "Brian Collins".

Brian Collins
Senior Operations Engineer

BC/sw
Enclosures



February 13, 2014

New Mexico State Land Office
310 Old Santa Fe Trail,
Santa Fe, NM 87501

**RE: Application For Authorization To Inject
Cottonwood 2 State SWD #1
Township 26 South, Range 26 East, N.M.P.M.
Section 2: 400' FSL & 1400' FEL
Eddy County, New Mexico**

To Whom It May Concern:

Enclosed for your review is a copy of COG Operating LLC's C-108 Application to Inject for the above referenced well. We plan to drill this well for SWD service if our C-108 is approved. As a requirement of the New Mexico Oil Conservation Division, we are notifying you because you have been identified as an operator or surface owner. Any objections must be submitted in writing to NMOCD, 1220 S. St. Francis Drive, Santa Fe, New Mexico 87505. Objections must be received within fifteen (15) days of receipt of this letter.

This well will not be a commercial SWD well. Please do not hesitate to contact us at 575-748-6940 should you have any questions.

Sincerely,

A handwritten signature in black ink, appearing to read "Brian Collins".

Brian Collins
Senior Operations Engineer

BC/bg
Enclosures



February 13, 2014

Yates Petroleum Corporation
105 S. 4th St.
Artesia, NM 88210

RE: Application For Authorization To Inject
Cottonwood 2 State SWD #1
Township 26 South, Range 26 East, N.M.P.M.
Section 2: 400' FSL & 1400' FEL
Eddy County, New Mexico

To Whom It May Concern:

Enclosed for your review is a copy of COG Operating LLC's C-108 Application to Inject for the above referenced well. We plan to drill this well for SWD service if our C-108 is approved. As a requirement of the New Mexico Oil Conservation Division, we are notifying you because you have been identified as the surface owner or an operator within a half mile radius area of review. Any objections must be submitted in writing to NMOCD, 1220 S. St. Francis Drive, Santa Fe, New Mexico 87505. Objections must be received within fifteen (15) days of receipt of this letter.

Please do not hesitate to contact us at 575-748-6940 should you have any questions.

Sincerely,

A handwritten signature in black ink, appearing to read "Brian Collins".

Brian Collins
Senior Operations Engineer

BC/sw
Enclosures



February 13, 2014

OXY-Y-1 Co.
P.O. Box 27570
Houston TX, 77227-7570

RE: Application For Authorization To Inject
Cottonwood 2 State SWD #1
Township 26 South, Range 26 East, N.M.P.M.
Section 2: 400' FSL & 1400' FEL
Eddy County, New Mexico

To Whom It May Concern:

Enclosed for your review is a copy of COG Operating LLC's C-108 Application to Inject for the above referenced well. We plan to drill this well for SWD service if our C-108 is approved. As a requirement of the New Mexico Oil Conservation Division, we are notifying you because you have been identified as the surface owner or an operator within a half mile radius area of review. Any objections must be submitted in writing to NMOCD, 1220 S. St. Francis Drive, Santa Fe, New Mexico 87505. Objections must be received within fifteen (15) days of receipt of this letter.

Please do not hesitate to contact us at 575-748-6940 should you have any questions.

Sincerely,

A handwritten signature in black ink, appearing to read "Brian Collins".

Brian Collins
Senior Operations Engineer

BC/sw
Enclosures



February 13, 2014

OXY, USA, Inc.
P.O. Box 4294
Houston TX, 77210-4294

RE: Application For Authorization To Inject
Cottonwood 2 State SWD #1
Township 26 South, Range 26 East, N.M.P.M.
Section 2: 400' FSL & 1400' FEL
Eddy County, New Mexico

To Whom It May Concern:

Enclosed for your review is a copy of COG Operating LLC's C-108 Application to Inject for the above referenced well. We plan to drill this well for SWD service if our C-108 is approved. As a requirement of the New Mexico Oil Conservation Division, we are notifying you because you have been identified as the surface owner or an operator within a half mile radius area of review. Any objections must be submitted in writing to NMOCD, 1220 S. St. Francis Drive, Santa Fe, New Mexico 87505. Objections must be received within fifteen (15) days of receipt of this letter.

Please do not hesitate to contact us at 575-748-6940 should you have any questions.

Sincerely,

A handwritten signature in black ink, appearing to read "Brian Collins".

Brian Collins
Senior Operations Engineer

BC/sw
Enclosures



February 13, 2014

Artesia Daily Press
P. O. Box 190
Artesia, NM 88211-0190

Re: **Legal Notice**
Salt Water Disposal Well
Cottonwood 2 State SWD #1

To Whom It May Concern:

Enclosed is a legal notice regarding New Mexico Oil Conservation Division C-108 Application for Authorization to Inject for a salt water disposal well.

Please run this notice and return the proof of notice to the undersigned at:

COG Operating LLC, 2208 W. Main St., Artesia, NM 88210

Sincerely,

A handwritten signature in black ink, appearing to read "Brian Collins".

Brian Collins
Senior Operations Engineer

BC/sw
Enclosures

ARTESIA DAILY PRESS
LEGAL NOTICES

COG Operating LLC, 2208 W. Main Street, Artesia, NM 88210 has filed Form C-108 (Application for Authorization to Inject) with the New Mexico Oil Conservation Division seeking administrative approval for a salt water disposal well. The proposed well, the Cottonwood 2 State SWD No. 1 is located 400' FSL & 1400' FEL, Section 2, Township 26 South, Range 26 East, Eddy County, New Mexico. Disposal water will be sourced from area wells producing from the Delaware, Bone Spring and Wolfcamp formations. The disposal water will be injected into the Devonian-Silurian-Ordovician formation at a depth of 13100' to 14600' at a maximum surface pressure of 2620 psi and a maximum rate of 20,000 BWPD. The proposed SWD well is located approximately 9 miles southeast of White's City. Any interested party who has an objection to this must give notice in writing to the Oil Conservation Division, 1220 S. St. Francis Drive, Santa Fe, New Mexico 87505, within fifteen (15) days of this notice. Any interested party with questions or comments may contact Brian Collins at COG Operating LLC, 2208 W. Main Street, Artesia, NM 88210, or call 575-748-6940.

Published in the Artesia Daily Press, Artesia, New Mexico
_____, 2014.



RECEIVED
FEB 13 2014
10:15 AM

February 13, 2014

New Mexico Oil Conservation Division
Attn: Phillip Goetze
1220 South St. Francis Drive
Santa Fe, NM 87505

RE: Application For Authorization To Inject
Cottonwood 2 State SWD #1
Township 26 South, Range 26 East, N.M.P.M.
Section 2: 400' FSL & 1400' FEL
Eddy County, New Mexico

Dear Mr. Goetze:

COG Operating LLC respectfully requests administrative approval for authorization to inject for the referenced well. Attached, for your review, is a copy of the C-108 application. Once we receive the newspaper publication and all certified return receipts, I will send you a copy.

Please do not hesitate to contact me at (575) 748-6940 should you have any questions.

Sincerely,

A handwritten signature in black ink that reads "Brian Collins".

Brian Collins
Senior Operations Engineer

BC/sw
Enclosures

Affidavit of Publication

No. 22866

State of New Mexico

County of Eddy:

Danny Scott

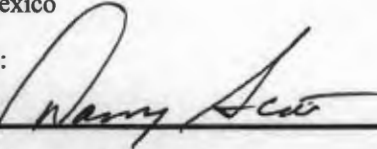

being duly sworn, says that he is the **Publisher**

of the Artesia Daily Press, a daily newspaper of General circulation, published in English at Artesia, said county and state, and that the hereto attached

Legal Notice

was published in a regular and entire issue of the said Artesia Daily Press, a daily newspaper duly qualified for that purpose within the meaning of Chapter 167 of the 1937 Session Laws of the state of New Mexico for 1 Consecutive weeks/day on the same day as follows:

First Publication February 19, 2014

Second Publication _____

Third Publication _____

Fourth Publication _____

Fifth Publication _____

Subscribed and sworn before me this

19th day of February 2014



OFFICIAL SEAL
Latisha Romine
NOTARY PUBLIC-STATE OF NEW MEXICO

My commission expires: 5/2/2015

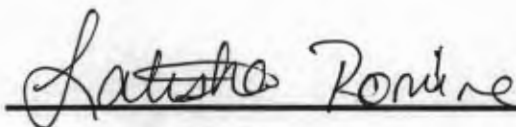

Latisha Romine

Notary Public, Eddy County, New Mexico

Copy of Publication:

LEGAL NOTICE

COG Operating LLC, 2208 W. Main Street, Artesia, NM 88210 has filed Form C-108 (Application for Authorization to Inject) with the New Mexico Oil Conservation Division seeking administrative approval for a salt water disposal well. The proposed well, the Cottonwood 2 State SWD No. 1 is located 400' FSL & 1400' FEL, Section 2, Township 26 South, Range 26 East, Eddy County, New Mexico. Disposal water will be sourced from area wells producing from the Delaware, Bone Spring and Wolfcamp formations. The disposal water will be injected into the Devonian-Silurian-Ordovician formation at a depth of 13100' to 14600' at a maximum surface pressure of 2620 psi and a maximum rate of 20,000 BWPD. The proposed SWD well is located approximately 9 miles southeast of White's City. Any interested party who has an objection to this must give notice in writing to the Oil Conservation Division, 1220 S. St. Francis Drive, Santa Fe, New Mexico 87505, within fifteen (15) days of this notice. Any interested party with questions or comments may contact Brian Collins at COG Operating LLC, 2208 W. Main Street, Artesia, NM 88210, or call 575-748-6940. Published in the Artesia Daily Press, Artesia, N.M., Feb. 19, 2014 Legal No 22866.

SENDER: COMPLETE THIS SECTION	COMPLETE THIS SECTION ON DELIVERY
<ul style="list-style-type: none"> Complete items 1, 2, and 3. Also complete item 4 if Restricted Delivery is desired. Print your name and address on the reverse so that we can return the card to you. Attach this card to the back of the mailpiece, or on the front if space permits. 	<p>A. Signature <input checked="" type="checkbox"/> <i>A. Arce</i> <input type="checkbox"/> Agent <input type="checkbox"/> Addressee</p> <p>B. Received by (Printed Name) <i>H. Arce</i></p> <p>C. Date of Delivery <i>2/18/14</i></p> <p>D. Is delivery address different from item 1? <input type="checkbox"/> Yes If YES, enter delivery address below: <input type="checkbox"/> No</p>
<p>1. Article Addressed to:</p> <p>Yates Petroleum Corporation 105 South 4th Street Artesia, NM 88210 Cottonwood 2 State SWD #1 C108</p>	<p>3. Service Type <input checked="" type="checkbox"/> Certified Mail® <input type="checkbox"/> Priority Mail Express™ <input type="checkbox"/> Registered <input type="checkbox"/> Return Receipt for Merchandise <input type="checkbox"/> Insured Mail <input type="checkbox"/> Collect on Delivery</p> <p>4. Restricted Delivery? (Extra Fee) <input type="checkbox"/> Yes</p>
<p>2. Article Number (Transfer from service label) 7013 3020 0000 8750 3935</p>	
PS Form 3811, July 2013 Domestic Return Receipt	

SENDER: COMPLETE THIS SECTION	COMPLETE THIS SECTION ON DELIVERY
<ul style="list-style-type: none"> Complete items 1, 2, and 3. Also complete item 4 if Restricted Delivery is desired. Print your name and address on the reverse so that we can return the card to you. Attach this card to the back of the mailpiece, or on the front if space permits. 	<p>A. Signature <input checked="" type="checkbox"/> <i>[Signature]</i> <input type="checkbox"/> Agent <input type="checkbox"/> Addressee</p> <p>B. Received by (Printed Name)</p> <p>C. Date of Delivery</p> <p>D. Is delivery address different from item 1? <input type="checkbox"/> Yes If YES, enter delivery address below: <input type="checkbox"/> No</p>
<p>1. Article Addressed to:</p> <p>New Mexico Oil Conservation Division Attn: Phillips Goetze 1220 South St. Francis Drive Santa Fe, NM 87505 Cottonwood 2 State SWD #1 C108</p>	<p>3. Service Type <input checked="" type="checkbox"/> Certified Mail® <input type="checkbox"/> Priority Mail Express™ <input type="checkbox"/> Registered <input type="checkbox"/> Return Receipt for Merchandise <input type="checkbox"/> Insured Mail <input type="checkbox"/> Collect on Delivery</p> <p>4. Restricted Delivery? (Extra Fee) <input type="checkbox"/> Yes</p>
<p>2. Article Number (Transfer from service label) 7013 3020 0000 8750 5007</p>	
PS Form 3811, July 2013 Domestic Return Receipt	

SENDER: COMPLETE THIS SECTION	COMPLETE THIS SECTION ON DELIVERY
<ul style="list-style-type: none"> Complete items 1, 2, and 3. Also complete item 4 if Restricted Delivery is desired. Print your name and address on the reverse so that we can return the card to you. Attach this card to the back of the mailpiece, or on the front if space permits. 	<p>A. Signature <input checked="" type="checkbox"/> <i>[Signature]</i> <input type="checkbox"/> Agent <input type="checkbox"/> Addressee</p> <p>B. Received by (Printed Name) <i>S. B. Arce</i></p> <p>C. Date of Delivery</p> <p>D. Is delivery address different from item 1? <input type="checkbox"/> Yes If YES, enter delivery address below: <input type="checkbox"/> No</p>
<p>1. Article Addressed to:</p> <p>OXY USA, Inc. PO Box 4294 Houston, TX 77210-4294 Cottonwood 2 State SWD #1 C108</p>	<p>3. Service Type <input checked="" type="checkbox"/> Certified Mail® <input type="checkbox"/> Priority Mail Express™ <input type="checkbox"/> Registered <input type="checkbox"/> Return Receipt for Merchandise <input type="checkbox"/> Insured Mail <input type="checkbox"/> Collect on Delivery</p> <p>4. Restricted Delivery? (Extra Fee) <input type="checkbox"/> Yes</p>
<p>2. Article Number (Transfer from service label) 7013 3020 0000 8750 3959</p>	
PS Form 3811, July 2013 Domestic Return Receipt	

SENDER: COMPLETE THIS SECTION	COMPLETE THIS SECTION ON DELIVERY
<ul style="list-style-type: none"> Complete items 1, 2, and 3. Also complete item 4 if Restricted Delivery is desired. Print your name and address on the reverse so that we can return the card to you. Attach this card to the back of the mailpiece, or on the front if space permits. 	<p>A. Signature <input checked="" type="checkbox"/> <i>[Signature]</i> <input type="checkbox"/> Agent <input type="checkbox"/> Addressee</p> <p>B. Received by (Printed Name)</p> <p>C. Date of Delivery</p> <p>D. Is delivery address different from item 1? <input type="checkbox"/> Yes If YES, enter delivery address below: <input type="checkbox"/> No</p>
<p>1. Article Addressed to:</p> <p>Oil Conservation Division Attn: Richard Inge 811 South 1st Street Artesia, NM 88210 Cottonwood 2 State SWD #1 C108</p>	<p>3. Service Type <input checked="" type="checkbox"/> Certified Mail® <input type="checkbox"/> Priority Mail Express™ <input type="checkbox"/> Registered <input type="checkbox"/> Return Receipt for Merchandise <input type="checkbox"/> Insured Mail <input type="checkbox"/> Collect on Delivery</p> <p>4. Restricted Delivery? (Extra Fee) <input type="checkbox"/> Yes</p>
<p>2. Article Number (Transfer from service label) 7013 3020 0000 8750 3911</p>	
PS Form 3811, July 2013 Domestic Return Receipt	

SENDER: COMPLETE THIS SECTION	COMPLETE THIS SECTION ON DELIVERY
<ul style="list-style-type: none"> Complete items 1, 2, and 3. Also complete item 4 if Restricted Delivery is desired. Print your name and address on the reverse so that we can return the card to you. Attach this card to the back of the mailpiece, or on the front if space permits. 	<p>A. Signature <input checked="" type="checkbox"/> <i>[Signature]</i> <input type="checkbox"/> Agent <input type="checkbox"/> Addressee</p> <p>B. Received by (Printed Name) <i>S. B. Arce</i></p> <p>C. Date of Delivery</p> <p>D. Is delivery address different from item 1? <input type="checkbox"/> Yes If YES, enter delivery address below: <input type="checkbox"/> No</p>
<p>1. Article Addressed to:</p> <p>OXY Y-1 Co. PO Box 27570 Houston, TX 77227-7570 Cottonwood 2 State SWD #1 C108</p>	<p>3. Service Type <input checked="" type="checkbox"/> Certified Mail® <input type="checkbox"/> Priority Mail Express™ <input type="checkbox"/> Registered <input type="checkbox"/> Return Receipt for Merchandise <input type="checkbox"/> Insured Mail <input type="checkbox"/> Collect on Delivery</p> <p>4. Restricted Delivery? (Extra Fee) <input type="checkbox"/> Yes</p>
<p>2. Article Number (Transfer from service label) 7013 3020 0000 8750 3942</p>	
PS Form 3811, July 2013 Domestic Return Receipt	

SENDER: COMPLETE THIS SECTION	COMPLETE THIS SECTION ON DELIVERY
<ul style="list-style-type: none"> Complete items 1, 2, and 3. Also complete item 4 if Restricted Delivery is desired. Print your name and address on the reverse so that we can return the card to you. Attach this card to the back of the mailpiece, or on the front if space permits. 	<p>A. Signature <input checked="" type="checkbox"/> <i>[Signature]</i> <input type="checkbox"/> Agent <input type="checkbox"/> Addressee</p> <p>B. Received by (Printed Name)</p> <p>C. Date of Delivery</p> <p>D. Is delivery address different from item 1? <input type="checkbox"/> Yes If YES, enter delivery address below: <input type="checkbox"/> No</p>
<p>1. Article Addressed to:</p> <p>New Mexico State Land Office 310 Old Santa Fe Trail Santa Fe, NM 87501 Cottonwood 2 State SWD #1 C108</p>	<p>3. Service Type <input checked="" type="checkbox"/> Certified Mail® <input type="checkbox"/> Priority Mail Express™ <input type="checkbox"/> Registered <input type="checkbox"/> Return Receipt for Merchandise <input type="checkbox"/> Insured Mail <input type="checkbox"/> Collect on Delivery</p> <p>4. Restricted Delivery? (Extra Fee) <input type="checkbox"/> Yes</p>
<p>2. Article Number (Transfer from service label) 7013 3020 0000 8750 3928</p>	
PS Form 3811, July 2013 Domestic Return Receipt	



C-108 Review Checklist:

Received 02/18/14

Add. Request: _____

Reply Date: _____

Suspended: _____

[Ver 13]

PERMIT TYPE: WFX / PMX / SWD Number: 1473

Permit Date: 4/10/14

Legacy Permits/Orders: NA

Well No. 1

Well Name(s): Cottonwood 2 State SWD

API: 30-0 15-Pending Spud Date: TBD New or Old: New (UIC Class II Primacy 03/07/1982)

Footages 400 FSL / 1400 FEL Lot - or Unit 0 Sec 2 Tsp 26 S Rge 26 E County Eddy

General Location: 6m N of TX border / Near Cottonwood Hills / Hay Hollow Pool: SWD: Devonian/Sil / ord Pool No.: 97869

BLM 100K Map: Carlsbad Operator: COG Operating LLC OGRID: 229137 Contact: Brian Collins

COMPLIANCE RULE 5.9: Total Wells: 3677 Inactive: 6 Fincl Assur: [Yes] - old on GARD well shows up - not violator
Compl. Order? No IS 5.9 OK? Yes Date: 4/10/2014

WELL FILE REVIEWED Current Status: New well - pending API number / no C-103 filed

WELL DIAGRAMS: NEW: Proposed or RE-ENTER: Before Conv. After Conv. Logs in Imaging: None - proposal doesn't provide a log suite

Planned Rehab Work to Well: NA - new well; deep formations for injection interval

Well Construction Details:	Sizes (in) Borehole / Pipe	Setting Depths (ft)	Cement Sx of Cf	Cement Top and Determination Method
Planned <input checked="" type="checkbox"/> or Existing <u>Surface</u>	<u>26/26</u>	<u>0 to 300</u>	<u>900</u>	<u>Cir to Surface</u>
Planned <input type="checkbox"/> or Existing <u>Intern/Prod</u>	<u>17 1/2 / 13 1/8</u>	<u>0 to 1950</u>	<u>None</u>	<u>Cir to Surface</u>
Planned <input type="checkbox"/> or Existing <u>Intern/Prod</u>	<u>12 1/4 /</u>	<u>0 to 8700</u>	<u>None</u>	<u>1300 (Calc)</u>
Planned <input type="checkbox"/> or Existing <u>Prod/Liner</u>	<u>8 3/4 / 7</u>	<u>8400 to 13100</u>	<u>None</u>	<u>Top of Liner (Calc)</u>
Planned <input type="checkbox"/> or Existing <u>Liner</u>	<u>—</u>	<u>—</u>	<u>—</u>	<u>—</u>
Planned <input checked="" type="checkbox"/> or Existing <u>OH / PERF</u>	<u>6/8</u>	<u>13100 to 14600</u>	<u>1500</u>	

Injection Stratigraphic Units:	Depths (ft)	Injection or Confining Units	Topsof	Completion/Operation Details:
Adjacent Unit: Litho. Struc. Por.		<u>Mississippian</u>	<u>*</u>	Drilled TD <u>—</u> PBSD <u>—</u>
Confining Unit: Litho. Struc. Por.	<u>*</u>	<u>Woodford sh</u>	<u>*</u>	NEW TD <u>14600</u> NEW PBSD <u>NA</u>
Proposed Inj Interval TOP:	<u>13100</u>	<u>Devonian</u>	<u>13352</u>	NEW Open Hole <input checked="" type="checkbox"/> or NEW Perfs <input type="checkbox"/>
Proposed Inj Interval BOTTOM:	<u>14600</u>	<u>Sil / ord</u>	<u>TBD</u>	Tubing Size <u>4 1/2</u> in. Inter Coated? <u>Yes</u>
Confining Unit: Litho. Struc. Por.	<u>Limit to top</u>	<u>Ellensburg</u>	<u>*</u>	Proposed Packer Depth <u>13050</u> ft
Adjacent Unit: Litho. Struc. Por.	<u>100' of</u>	<u>re wash pe</u>	<u>—</u>	Min. Packer Depth <u>13000</u> (100-ft limit)
AOR: Hydrologic and Geologic Information				Proposed Max. Surface Press. <u>2620</u> psi
POTASH: R-111-P <u>No</u> Noticed? <u>NA</u> BLM Sec Ord <u>No</u> WIPP <u>No</u> Noticed? <u>NA</u> SALT/SALADO T: <u>—</u> B: <u>—</u> CLIFF HOUSE <u>NA</u>				Admin. Inj. Press. <u>2620</u> (0.2 psi per ft)

FRESH WATER: Aquifer Alluvial - unconsolidated Max Depth <200 ft HYDRO AFFIRM STATEMENT By Qualified Person

NMOSE Basin: Carlsbad CAPITAN REEF: thru adj NA No. Wells within 1-Mile Radius? 0 FW Analysis NA

Disposal Fluid: Formation Source(s) Delaware / WC / Bone Spring analysis? Yes On Lease Operator Only or Commercial

Disposal Int: Inject Rate (Avg/Max BWPD): 7000/20000 Protectable Waters? Low Source: Need Info System: Closed or Open

HC Potential: Producing Interval? No Formerly Producing? No Method: Logs/DST/P&A/Other Need Info 2-Mile Radius Pool Map NA

AOR Wells: 1/2-M Radius Map? Yes Well List? NA Total No. Wells Penetrating Interval: 0 Horizontals? 0

Penetrating Wells: No. Active Wells 0 Num Repairs? — on which well(s)? _____ Diagrams? NA

Penetrating Wells: No. P&A Wells 0 Num Repairs? — on which well(s)? _____ Diagrams? NA

NOTICE: Newspaper Date 02/19/14 Mineral Owner SLO Surface Owner SLO N. Date 02/18/14

RULE 26.7(A): Identified Tracts? Yes Affected Persons: Echo Production N. Date 02/18/14

Permit Conditions: Issues: Unknown WQ for injection zone; new well / no log suite proposed

Add Permit Cond: Logs for estimated tops & salinity; CBL for TOCs; tops picked

Goetze, Phillip, EMNRD

From: Brian Collins <BCollins@concho.com>
Sent: Wednesday, April 09, 2014 5:36 PM
To: Goetze, Phillip, EMNRD
Cc: Ward Whiteman
Subject: RE: COG C108 and Request for Higher Injection Pressure Letter Questions

Phillip:

I'm curious why the Ellenburger is excluded as a permissible disposal interval? Answers to your questions follow below.

There's very little deep well control in this area, but here's our geologist's projected picks for the two deep wells:

Pine Springs 2 State SWD 1 Devonian/Silurian/Ordovician (12450-14000') Sec 2-26s25e:

Devonian-12630'

Fusselman (Silurian)-13060'

Ellenburger (Ordovician)-14180'

I applied for an injection interval a little higher than the estimated top of Devonian and into the Silurian to account for geologic uncertainty and to ensure we cut plenty of dolomite for better permeability. Calling this formation the Devonian/Silurian/Ordovician was what Will Jones recommended a few years ago on these deep applications since we were likely penetrating the Silurian on "Devonian" SWDs.

Cottonwood 2 State SWD 1 Devonian/Silurian/Ordovician (13100-14600') Sec 2-26s-26e:

Devonian-13332'

Fusselman (Silurian)- not picked

Ellenburger (Ordovician)-not picked

I applied for an injection interval a little higher than the estimated top of Devonian and into the Silurian to account for geologic uncertainty and to ensure we cut plenty of dolomite for better permeability. I applied for a 1500' thick open hole disposal interval the same as the Pine Springs well shown above with the top reference depth 200'+ shallower than the projected top of the Devonian. This should put us into the Silurian at TD.

Our proposed total depths should keep us well above the Ellenburger. Our 7" casings will be set into the actual top of the Devonian on each well. Applying for the shallower top of the injection interval will keep us from having to re-permit in case the Devonian comes in a little shallower than projected. I've no problems if you want to issue the permit as Devonian/Silurian instead of Devonian/Silurian/Ordovician. Hope this answers your questions. Please call or email if you have any more questions. Thank you.

Brian Collins

Senior Operations Engineer
NM Basin Team

COG OPERATING LLC
2208 W. Main Street
Artesia, New Mexico 88210-3720
Phone # 575.748.6924
Email: bcollins@concho.com