

ABOVE THIS LINE FOR DIVISION USE ONLY

15 day clock starts 11-06-2017

NEW MEXICO OIL CONSERVATION DIVISION
 - Engineering Bureau -
 1220 South St. Francis Drive, Santa Fe, NM 87505



ADMINISTRATIVE APPLICATION CHECKLIST

THIS CHECKLIST IS MANDATORY FOR ALL ADMINISTRATIVE APPLICATIONS FOR EXCEPTIONS TO DIVISION RULES AND REGULATIONS WHICH REQUIRE PROCESSING AT THE DIVISION LEVEL IN SANTA FE

Application Acronyms:

- [NSL-Non-Standard Location] [NSP-Non-Standard Proration Unit] [SD-Simultaneous Dedication]
- [DHC-Downhole Commingling] [CTB-Lease Commingling] [PLC-Pool/Lease Commingling]
- [PC-Pool Commingling] [OLS - Off-Lease Storage] [OLM-Off-Lease Measurement]
- [WFX-Waterflood Expansion] [PMX-Pressure Maintenance Expansion]
- [SWD-Salt Water Disposal] [IPI-Injection Pressure Increase]
- [EOR-Qualified Enhanced Oil Recovery Certification] [PPR-Positive Production Response]

[1] **TYPE OF APPLICATION** - Check Those Which Apply for [A]

- [A] Location - Spacing Unit - Simultaneous Dedication
 NSL NSP SD

Check One Only for [B] or [C]

- [B] Commingling - Storage - Measurement
 DHC CTB PLC PC OLS OLM

- [C] Injection - Disposal - Pressure Increase - Enhanced Oil Recovery
 WFX PMX SWD IPI EOR PPR

- [D] Other: Specify _____

- SWD 1707
 - Solaris Water Midstream, LLC
 371643

RECEIVED ON 11/03/2017 - 3 P 4:22

[2] **NOTIFICATION REQUIRED TO:** - Check Those Which Apply, or Does Not Apply

- [A] Working, Royalty or Overriding Royalty Interest Owners

- [B] Offset Operators, Leaseholders or Surface Owner

- [C] Application is One Which Requires Published Legal Notice

- [D] Notification and/or Concurrent Approval by BLM or SLO
U.S. Bureau of Land Management - Commissioner of Public Lands, State Land Office

- [E] For all of the above, Proof of Notification or Publication is Attached, and/or,

- [F] Waivers are Attached

well
 - Attached
 SWD #1
 30-025 pending pool
 - SWD
 Devonian-Silurian
 47869

[3] **SUBMIT ACCURATE AND COMPLETE INFORMATION REQUIRED TO PROCESS THE TYPE OF APPLICATION INDICATED ABOVE.**

[4] **CERTIFICATION:** I hereby certify that the information submitted with this application for administrative approval is **accurate** and **complete** to the best of my knowledge. I also understand that **no action** will be taken on this application until the required information and notifications are submitted to the Division.

Note: Statement must be completed by an individual with managerial and/or supervisory capacity.

Ben Stone
 Print or Type Name

Ben Stone
 Signature

Agent for Solaris Water Midstream, LLC 10/31/17

ben@sosconsulting.us
 e-mail Address



October 31, 2017

New Mexico Oil Conservation Division
1220 South St. Francis Drive
Santa Fe, New Mexico 87505

Attn: Mr. David Catanach, Director

Re: Application of Solaris Water Midstream, LLC to permit for salt water disposal the proposed Athena 28 SWD Well No.1, to be located in Section 28, Township 20 South, Range 34 East, NMMP, Lea County, New Mexico.

Dear Mr. Catanach,

Please find enclosed form C-108 Application for Authority to Inject, supporting the above-referenced request to permit for disposal, the Athena 28 SWD No.1.

Solaris Water Midstream seeks to optimize efficiency, both economically and operationally, of its operations and to offer additional disposal options for operators in southeast New Mexico. Approval of this application is consistent with that goal as well as the NMOCD's mission of preventing waste and protection of correlative rights.

Published legal notice will run on or about November 2, 2017 in the Hobbs News-Sun and all offset operators and other interested parties have been notified individually. The legal notice affidavit will be forwarded when received. This application also includes a wellbore schematic, area of review maps, leaseholder plats and other required information for a complete Form C-108. The well is located on private land and minerals with federal minerals offset; a copy of this application has been submitted to the BLM, Carlsbad Field Office, Oil and Gas Division.

I respectfully request that the approval of this salt water disposal well proceed swiftly and if you or your staff requires additional information or has any questions, please do not hesitate to call or email me.

Best regards,

A handwritten signature in black ink, appearing to read 'Ben Stone', is written in a cursive style.

Ben Stone, Partner
SOS Consulting, LLC
Agent for Solaris Water Midstream, LLC

Cc: Application attachment and file

APPLICATION FOR AUTHORIZATION TO INJECT

- I. PURPOSE: **Salt Water Disposal** and the application **QUALIFIES** for administrative approval.
- II. OPERATOR: **Solaris Water Midstream, LLC**
ADDRESS: **701 Tradewinds Blvd., Suite C, Midland, TX 79706**

CONTACT PARTY: **Agent: SOS Consulting, LLC – Ben Stone (903) 488-9850**
- III. WELL DATA: **All well data and applicable wellbore diagrams are ATTACHED.**
- IV. **This is not an expansion of an existing project.**
- V. **A map is attached** that identifies all wells and leases within two miles of any proposed injection well with a one-half mile radius circle drawn around each proposed injection well. This circle identifies the well's area of review.
- *VI. A tabulation is attached of data on all wells of public record within the area of review which penetrate the proposed injection zone. **There are NO (0) Wells in the subject AOR.** The data includes a description of each well's type, construction, date drilled, location, depth, and a schematic of any plugged well illustrating all plugging detail.
- VII. **The following data is ATTACHED** on the proposed operation, including:
1. Proposed average and maximum daily rate and volume of fluids to be injected;
 2. Whether the system is open or closed;
 3. Proposed average and maximum injection pressure;
 4. Sources and an appropriate analysis of injection fluid and compatibility with the receiving formation if other than reinjected produced water; and,
 5. If injection is for disposal purposes into a zone not productive of oil or gas at or within one mile of the proposed well, attach a chemical analysis of the disposal zone formation water (may be measured or inferred from existing literature, studies, nearby wells, etc.).
- *VIII. **Appropriate geologic data on the injection zone is ATTACHED** including appropriate lithologic detail, geologic name, thickness, and depth. Give the geologic name, and depth to bottom of all underground sources of drinking water (aquifers containing waters with total dissolved solids concentrations of 10,000 mg/l or less) overlying the proposed injection zone as well as any such sources known to be immediately underlying the injection interval.
- IX. **Stimulation program – a conventional acid job may be performed to clean and open the formation.**
- *X. Attach appropriate logging and test data on the well. (If well logs have been filed with the Division, they need not be resubmitted). **Well Logs will be filed with OCD.**
- *XI. **There are 2 water wells (1 is monitor) within one mile of the proposed SWD well. Analysis on 1 is INCLUDED.**
- XII. **An affirmative statement is ATTACHED that available geologic and engineering data has been examined and no evidence was found** of open faults or any other hydrologic connection between the disposal zone and any underground sources of drinking water.
- XIII. **"Proof of Notice" section on the next page of this form has been completed and ATTACHED. There are 9 offset lessees and/or operators within 1/2 mile and federal minerals – BLM and all have been noticed. Well location is PRIVATE.**
- XIV. Certification: I hereby certify that the information submitted with this application is true and correct to the best of my knowledge and belief.

NAME: **Ben Stone** TITLE: **SOS Consulting, LLC agent for Solaris Water Midstream, LLC**

SIGNATURE:  DATE: 10/31/2017

E-MAIL ADDRESS: **ben@sosconsulting.us**

* If the information required under Sections VI, VIII, X, and XI above has been previously submitted, it need not be resubmitted. Please show the date and circumstances of the earlier submittal:

DISTRIBUTION: Original and one copy to Santa Fe with one copy to the appropriate District Office

FORM C-108 – APPLICATION FOR AUTHORIZATION TO INJECT (cont.)

III. WELL DATA – *The following information and data is included (See ATTACHED Wellbore Schematic):*

A. The following well data must be submitted for each injection well covered by this application. The data must be both in tabular and schematic form and shall include:

- (1) Lease name; Well No., Location by Section, Township and Range; and footage location within the section.
- (2) Each casing string used with its size, setting depth, sacks of cement used, hole size, top of cement, and how such top was determined.
- (3) A description of the tubing to be used including its size, lining material, and setting depth.
- (4) The name, model, and setting depth of the packer used or a description of any other seal system or assembly used.

Division District Offices have supplies of Well Data Sheets which may be used or which may be used as models for this purpose. Applicants for several identical wells may submit a "typical data sheet" rather than submitting the data for each well.

B. The following must be submitted for each injection well covered by this application. All items must be addressed for the initial well. Responses for additional wells need be shown only when different. Information shown on schematics need not be repeated.

- (1) The name of the injection formation and, if applicable, the field or pool name.
- (2) The injection interval and whether it is perforated or open-hole.
- (3) State if the well was drilled for injection or, if not, the original purpose of the well.
- (4) Give the depths of any other perforated intervals and detail on the sacks of cement or bridge plugs used to seal off such perforations.
- (5) Give the depth to and the name of the next higher and next lower oil or gas zone in the area of the well, if any.

XIV. PROOF OF NOTICE *pursuant to the following criteria is ATTACHED.*

All applicants must furnish proof that a copy of the application has been furnished, by certified or registered mail, to the owner of the surface of the land on which the well is to be located and to each leasehold operator within one-half mile of the well location.

Where an application is subject to administrative approval, a proof of publication must be submitted. Such proof shall consist of a copy of the legal advertisement which was published in the county in which the well is located. The contents of such advertisement must include:

- (1) The name, address, phone number, and contact party for the applicant;
- (2) The intended purpose of the injection well; with the exact location of single wells or the Section, Township, and Range location of multiple wells;
- (3) The formation name and depth with expected maximum injection rates and pressures; and,
- (4) A notation that interested parties must file objections or requests for hearing with the Oil Conservation Division, 1220 South St. Francis Dr., Santa Fe, New Mexico 87505, within 15 days.

NO ACTION WILL BE TAKEN ON THE APPLICATION UNTIL PROPER PROOF OF NOTICE HAS BEEN SUBMITTED.

NOTICE: Surface owners or offset operators must file any objections or requests for hearing of administrative applications within 15 days from the date this application was mailed to them.



WELL SCHEMATIC - PROPOSED
Athena 28 SWD Well No.1

API 30-025-xxxxx
 2198' FNL & 350' FWL, SEC. 28-T20S-R34E
 LEA COUNTY, NEW MEXICO

SWD; Devonian-Silurian (97869)

Spud Date: 12/15/2017
 SWD Config Dt: 1/15/2018

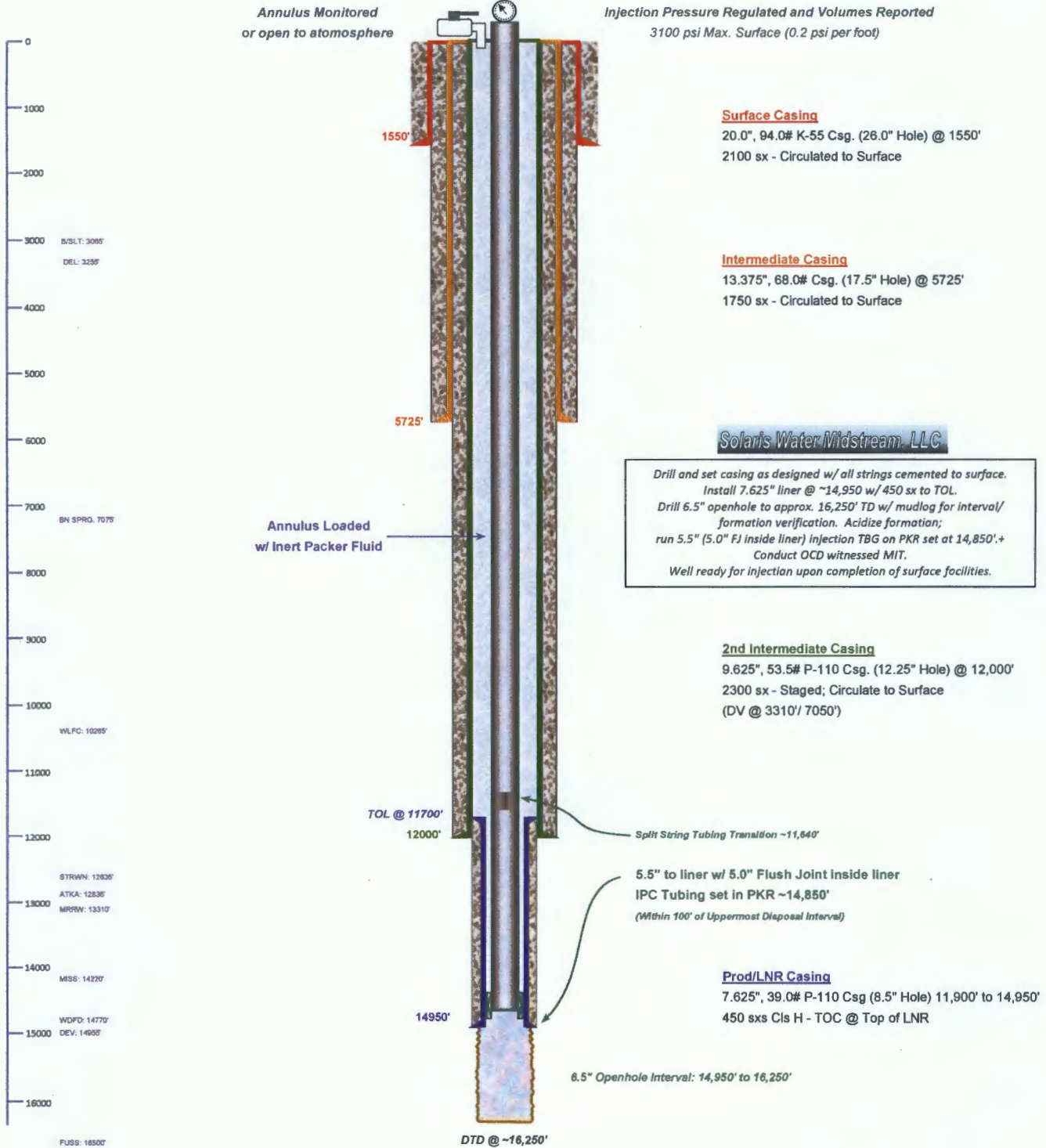

Solaris Water Midstream, LLC

Drill and set casing as designed w/ all strings cemented to surface.
 Install 7.625" liner @ ~14,950 w/ 450 sx to TOL.
 Drill 6.5" openhole to approx. 16,250' TD w/ mudlog for interval/
 formation verification. Acidize formation;
 run 5.5" (5.0" FJ inside liner) injection TBG on PKR set at 14,850'+
 Conduct OCD witnessed MIT.
 Well ready for injection upon completion of surface facilities.

2nd Intermediate Casing
 9.625", 53.5# P-110 Csg. (12.25" Hole) @ 12,000'
 2300 sx - Staged; Circulate to Surface
 (DV @ 3310/ 7050')

Prod/LNR Casing
 7.625", 39.0# P-110 Csg (8.5" Hole) 11,900' to 14,950'
 450 sxs Cls H - TOC @ Top of LNR

Corrected Version



Drawn by: Ben Stone, Rvs'd 11/27/2017

Athena 28 SWD Well No.1 - Area of Review / Overview Map

(Attachment to NMOCD Form C-108, Application for Authority to Inject.)

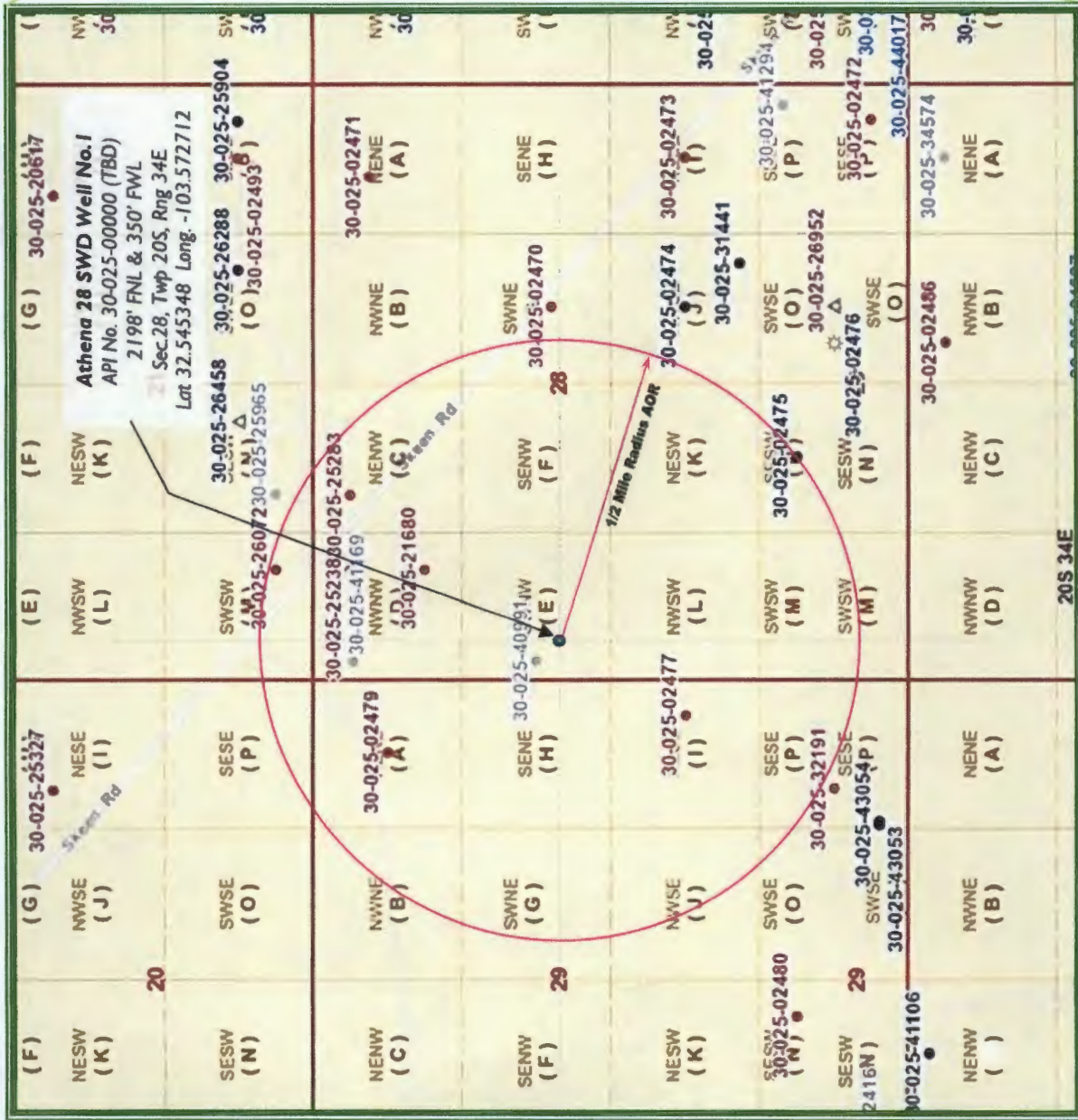

~18.8 miles W/SW of Monument, NM



Lea County, New Mexico



C-108 - Item VI

Area of Review Well Data

**THERE ARE NO WELLS WHICH PENETRATE THE
PROPOSED DEVONIAN FORMATION IN THE
ONE-HALF MILE AREA of REVIEW**

C-108 ITEM X – LOGS and AVAILABLE TEST DATA

**A Standard Suite of Logs will be run after
drilling the well and submitted to the Division.**

C-108 ITEM VII – PROPOSED OPERATION

Athena 28 SWD No.1

Commercial SWD Facility

Upon approval of all permits for SWD, operations would begin within 30 days. Completion of the well operations will take approximately 6-8 weeks. Facility construction including installation of the tank battery, berms, plumbing and other and associated equipment would be occurring during the same interval but at a different location from the well. In any event, it is not expected for the construction phase of the project to last more than 60 days, depending on availability of contractors and equipment. The operator has negotiated a Surface Owner Agreement for the facility and well site.

Configure for Salt Water Disposal

Prior to commencing any work, an NOI sundry(ies) will be submitted to configure the well for SWD and will detail the completion workover including all work otherwise described above, any change to the procedure noted herein and to perform mechanical integrity pressure test per OCD test procedures. (Notify NMOCD 24 hours prior.) The casing/tubing annulus will be monitored for communication with injection fluid or loss of casing integrity.

Operational Summary

The SWD facility will not be fenced so that trucks may access for load disposal 24/7.

The well and injection equipment will be a closed system and equipped with pressure limiting devices and volume meters. The annulus, loaded with an inert, anti-corrosion packer fluid, will be monitored for pressure.

The tanks will be equipped with telemetry devices and visual alarms to alert the operator and customers of full tanks or an overflow situation.

Anticipated daily maximum volume is 25,000 bpd and an average of 20,000 bpd at a maximum surface injection pressure of 2900 psi (.2 psi/ft gradient – maximum pressure will be adjusted if the top of interval is modified after well logs are run).

Potential releases will be contained and cleaned up immediately. The operator shall repair or otherwise correct the situation within 48 hours before resuming operations. OCD will be notified within 24 hours of any release greater than 5 bbls. If required, remediation will start as soon as practicable. Operator shall comply with 19.15.29 NMAC and 19.15.30 NMAC, as necessary and appropriate.

C-108 ITEM VII – PRODUCED WATER ANALYSES

Item VII.4 – Water Analysis of Source Zone Water

Delaware
Bone Spring
Wolfcamp
Morrow

Item VII.5 – Water Analysis of Disposal Zone Water

Devonian

Water Analyses follow this page.

C-108 Item VII.5 - Produced Water Data
Solaris Water Midstream, LLC - Athena 28 SWD Well No.1

SOURCE ZONE

DELAWARE

API No	3002508367	Lab ID	
Well Name	BELL LAKE UNIT	Sample ID	4347
	007	Sample No	
Location	ULSTR 01 24 S 33 E	Lat / Long	32.25143 -103.51924
	660 N 660 E	County	Lea
Operator (when sampled)			
	Field SWD	Unit	1
Sample Date		Analysis Date	
	Sample Source UNKNOWN	Depth (if known)	
	Water Typ		
ph		alkalinity_as_caco3_mgL	
ph_temp_F		hardness_as_caco3_mgL	
specificgravity		hardness_mgL	
specificgravity_temp_F		resistivity_ohm_cm	
tds_mgL	87686	resistivity_ohm_cm_temp_	
tds_mgL_180C		conductivity	
chloride_mgL	53920	conductivity_temp_F	
sodium_mgL		carbonate_mgL	
calcium_mgL		bicarbonate_mgL	391
iron_mgL		sulfate_mgL	749
barium_mgL		hydroxide_mgL	
magnesium_mgL		h2s_mgL	
potassium_mgL		co2_mgL	
strontium_mgL		o2_mgL	
manganese_mgL		anionremarks	

Remarks

(Produced water data courtesy of NMT Octane NM WAIDS database.)



**C-108 Item VII.5 - Produced Water Data
Solaris Water Midstream, LLC - Athena 28 SWD Well No.1**

SOURCE ZONE

BONE SPRING

API No	3002502429	Lab ID	
Well Name	LEA UNIT	Sample ID	4916
		Sample No	
	005		
Location	ULSTR 12 20 S 34 E	Lat / Long	32.58504 -103.51106
	1980 S 1980 E	County	Lea
Operator (when sampled)			
	Field LEA		Unit J
Sample Date		Analysis Date	
	Sample Sourc DST	Depth (if known)	
	Water Typ		
ph		alkalinity_as_caco3_mgL	
ph_temp_F		hardness_as_caco3_mgL	
specificgravity		hardness_mgL	
specificgravity_temp_F		resistivity_ohm_cm	
tds_mgL	202606	resistivity_ohm_cm_temp_	
tds_mgL_180C		conductivity	
chloride_mgL	118100	conductivity_temp_F	
sodium_mgL		carbonate_mgL	
calcium_mgL		bicarbonate_mgL	5196
iron_mgL		sulfate_mgL	992
barium_mgL		hydroxide_mgL	
magnesium_mgL		h2s_mgL	
potassium_mgL		co2_mgL	
strontium_mgL		o2_mgL	
manganese_mgL		anionremarks	
Remarks			

(Produced water data courtesy of NMT Octane NM WAIDS database.)



**C-108 Item VII.5 - Produced Water Data
Solaris Water Midstream, LLC - Athena 28 SWD Well No.1**

SOURCE ZONE

WOLFCAMP

API No	3001520138	Lab ID	
Well Name	MAHUN STATE 001	Sample ID	5688
		Sample No	
Location	ULSTR 16 22 S 22 E 1800 N 1980 W	Lat / Long	32.39340 -104.70979
		County	Eddy
Operator (when sampled)			
	Field	ROCKY ARROYO	Unit F
Sample Date	5/17/1968	Analysis Date	
	Sample Source	DST	Depth (if known)
	Water Typ		
ph	8.6	alkalinity_as_caco3_mgL	
ph_temp_F		hardness_as_caco3_mgL	
specificgravity		hardness_mgL	
specificgravity_temp_F		resistivity_ohm_cm	
tds_mgL	35495	resistivity_ohm_cm_temp_	
tds_mgL_180C		conductivity	
chloride_mgL	19000	conductivity_temp_F	
sodium_mgL		carbonate_mgL	
calcium_mgL		bicarbonate_mgL	830
iron_mgL		sulfate_mgL	2500
barium_mgL		hydroxide_mgL	
magnesium_mgL		h2s_mgL	
potassium_mgL		co2_mgL	
strontium_mgL		o2_mgL	
manganese_mgL		anionremarks	
Remarks			

(Produced water data courtesy of NMT Octane NM WAIDS database.)



C-108 Item VII.5 - Produced Water Data
Solaris Water Midstream, LLC - Athena 28 SWD Well No.1

SOURCE ZONE

MORROW

API No	3002520756	Lab ID	
Well Name	CUSTER MOUNTAIN UNIT 001	Sample ID	2434
		Sample No	
Location	ULSTR 09 24 S 35 E	Lat / Long	32.22999 -103.37431
	1980 S 1980 W	County	Lea
Operator (when sampled)			
	Field CINTA ROJA		Unit K
Sample Date		Analysis Date	
	Sample Sourc DST		Depth (if known)
	Water Typ		
ph		alkalinity_as_caco3_mgL	
ph_temp_F		hardness_as_caco3_mgL	
specificgravity		hardness_mgL	
specificgravity_temp_F		resistivity_ohm_cm	
tds_mgL	282741	resistivity_ohm_cm_temp_	
tds_mgL_180C		conductivity	
chloride_mgL	176800	conductivity_temp_F	
sodium_mgL		carbonate_mgL	
calcium_mgL		bicarbonate_mgL	161
iron_mgL		sulfate_mgL	650
barium_mgL		hydroxide_mgL	
magnesium_mgL		h2s_mgL	
potassium_mgL		co2_mgL	
strontium_mgL		o2_mgL	
manganese_mgL		anionremarks	

Remarks

(Produced water data courtesy of NMT Octane NM WAIDS database.)



**C-108 Item VII.5 - Produced Water Data
Solaris Water Midstream, LLC - Athena 28 SWD Well No.1**

DISPOSAL ZONE

DEVONIAN

API No.	3002508483	Lab ID	
Well Name	BELL LAKE UNIT	Sample ID	5733
	006	Sample No	
Location	ULSTR 06 23 S 34 E	Lat / Long	32.32821 -103.50663
	660 S 1980 E	County	Lea
Operator (when sampled)			
	Field BELL LAKE NORTH	Unit	O
Sample Date		Analysis Date	
	Sample Source HEATER/TREATER	Depth (if known)	
	Water Type		
ph	7	alkalinity_as_caco3_mgL	
ph_temp_F		hardness_as_caco3_mgL	
specificgravity		hardness_mgL	
specificgravity_temp_F		resistivity_ohm_cm	
tds_mgL	71078	resistivity_ohm_cm_temp_	
tds_mgL_180C		conductivity	
chloride_mgL	42200	conductivity_temp_F	
sodium_mgL		carbonate_mgL	
calcium_mgL		bicarbonate_mgL	500
iron_mgL		sulfate_mgL	1000
barium_mgL		hydroxide_mgL	
magnesium_mgL		h2s_mgL	
potassium_mgL		co2_mgL	
strontium_mgL		o2_mgL	
manganese_mgL		anionremarks	

Remarks

(Produced water data courtesy of NMT Octane NM WAIDS database.)



**C-108 Item VII.5 - Produced Water Data
Solaris Water Midstream, LLC - Athena 28 SWD No.1**

DISPOSAL ZONE

DEVONIAN

API No.	3002521082	Lab ID	
Well Name	ANTELOPE RIDGE UNIT 003	Sample ID	5720
		Sample No	
Location	ULSTR 34 23 S 34 E 1980 S 1650 W	Lat / Long	32.25922 -103.46068
		County	Lea
Operator (when sampled)			
	Field ANTELOPE RIDGE	Unit	K
Sample Date	11/14/1967	Analysis Date	
	Sample Source UNKNOWN	Depth (if known)	
	Water Type		
ph	6.9	alkalinity_as_caco3_mgL	
ph_temp_F		hardness_as_caco3_mgL	
specificgravity		hardness_mgL	
specificgravity_temp_F		resistivity_ohm_cm	
tds_mgL	80187	resistivity_ohm_cm_temp_	
tds_mgL_180C		conductivity	
chloride_mgL	47900	conductivity_temp_F	
sodium_mgL		carbonate_mgL	
calcium_mgL		bicarbonate_mgL	476
iron_mgL		sulfate_mgL	900
barium_mgL		hydroxide_mgL	
magnesium_mgL		h2s_mgL	
potassium_mgL		co2_mgL	
strontium_mgL		o2_mgL	
manganese_mgL		anionremarks	
Remarks			

(Produced water data courtesy of NMT Octane NM WAIDS database.)



C-108 – Item VIII

Geologic Information

The Devonian and Silurian (including Fusselman) consist of carbonates including light colored dolomite and chert intervals interspersed with some tight limestone intervals. Several thick sections of porous dolomite capable of taking water are present within the subject formations in the area. Depth control data was inferred from deep wells in the vicinity. If the base of Devonian and top of Silurian and/or Ordovician rocks come in as expected the well will only be drilled deep enough for adequate logging rathole.

At a proposed depth of 16,250' BGL (Below Ground Level) the well will TD approximately 1,750 feet below the estimated top of the Devonian. Mud logging through the interval will ensure the target interval remains in Devonian and Silurian. Once Devonian is determined, the casing shoe depth will be set at an approximate maximum upper depth of 14,500' BGL. Injection will occur through the resulting openhole interval. If the base of Silurian and top of Ordovician rocks come in as expected the well will only be drilled deep enough for adequate logging rathole; estimated total depth approximately 16,250'.

The Devonian is overlain by the Woodford Shale and lower Silurian (Fusselman) rock is underlain by the Ordovician; Simpson, McKee and Ellenburger.

Fresh water in the area is generally available from the Santa Rosa formation. State Engineer's records show water wells in the area with a depth to groundwater of 90 to 150 feet.

There are two water wells located within one mile of the proposed SWD. One is a monitor well and water analyses from the other is included with this application.

C-108 ITEM XI – WATER WELLS IN AOR

Athena 28 Water Well Locator Map



Well shown was sampled – analysis follows on next page.



Oilfield Labs of America
 3302 Pilot Ave
 Midland, Texas 79706
 1-855-OIL-LAB1

Report Date: 10/20/2017

Complete Water Analysis

Customer:	Solaris Water Midstream	Account Rep:	Katy Welch
Operator:	Solaris	Sample ID:	1171018001
Lease:	Jeff Water Well	Sample Date:	
Sample Point:	Section 34 T205 R34E	Received Date:	10/18/2017
Region:	New Mexico	Log Out Date:	10/20/2017

Solaris Water Midstream, Solaris, Jeff Water Well, Section 34 T205 R34E

Field Data		Analysis of Sample											
		Anions:		mg/L		meq/L		Cations:		mg/L		meq/L	
Initial Temperature (°F):	190	Chloride (Cl ⁻):	120	3.4	Sodium (Na ⁺):	234	10.2						
Final Temperature (°F):	80	Sulfate (SO ₄ ²⁻):	210	4.4	Potassium (K ⁺):	3	0.1						
Initial Pressure (psi):	1250	Borate (H ₃ BO ₃):	1	0.0	Magnesium (Mg ²⁺):	7	0.6						
Final Pressure (psi):	15				Calcium (Ca ²⁺):	5	0.3						
					Strontium (Sr ²⁺):	0	0.0						
pH:					Barium (Ba ²⁺):	ND							
pH:	8.6	Phosphate (PO ₄ ³⁻):	ND		Iron (Fe ²⁺):	4.4	0.2						
					Manganese (Mn ²⁺):	ND							
					Total Hardness:	44							
Alkalinity by Titration:	mg/L meq/L												
Bicarbonate (HCO ₃ ⁻):	272 4.5												
aqueous CO ₂ (ppm):	ND												
aqueous H ₂ S (ppm):	1												
Calculated TDS (mg/L):	857												
Density/Specific Gravity (g/cm ³):	0.9978												
Measured Density/Specific Gravity													
		Anion EPM Total:	12		Cation EPM Total:	11							
		% RPD of Cations/Anions:	8.0%			ND = Not Determined							

Conditions		Barite (BaSO ₄)		Calcite (CaCO ₃)		Gypsum (CaSO ₄ ·2H ₂ O)		Anhydrite (CaSO ₄)	
Temp	Press.	Index	Amt (ptb)	Index	Amt (ptb)	Index	Amt (ptb)	Index	Amt (ptb)
80°F	15 psi	0.000	0.18	1.055	-2.39	0.000	-2.64	0.000	
92°F	152 psi	0.000	0.16	0.906	-2.39	0.000	-2.59	0.000	
104°F	289 psi	0.000	0.21	1.179	-2.39	0.000	-2.54	0.000	
117°F	427 psi	0.000	0.26	1.458	-2.39	0.000	-2.48	0.000	
129°F	564 psi	0.000	0.31	1.737	-2.38	0.000	-2.42	0.000	
141°F	701 psi	0.000	0.36	2.010	-2.36	0.000	-2.34	0.000	
153°F	838 psi	0.000	0.41	2.270	-2.34	0.000	-2.27	0.000	
166°F	976 psi	0.000	0.46	2.512	-2.32	0.000	-2.18	0.000	
178°F	1113 psi	0.000	0.51	2.734	-2.30	0.000	-2.10	0.000	
190°F	1250 psi	0.000	0.56	2.935	-2.27	0.000	-2.01	0.000	

Conditions		Celestite (SrSO ₄)		Halite (NaCl)		Iron Sulfide (FeS)		Iron Carbonate (FeCO ₃)	
Temp	Press.	Index	Amt (ptb)	Index	Amt (ptb)	Index	Amt (ptb)	Index	Amt (ptb)
80°F	15 psi	-2.39	0.000	-6.16	0.000	3.01	0.636	1.88	3.134
92°F	152 psi	-2.39	0.000	-6.18	0.000	2.88	0.636	1.90	3.135
104°F	289 psi	-2.38	0.000	-6.19	0.000	2.83	0.636	1.99	3.148
117°F	427 psi	-2.37	0.000	-6.20	0.000	2.80	0.636	2.08	3.158
129°F	564 psi	-2.36	0.000	-6.20	0.000	2.77	0.636	2.16	3.166
141°F	701 psi	-2.33	0.000	-6.21	0.000	2.76	0.636	2.24	3.172
153°F	838 psi	-2.30	0.000	-6.21	0.000	2.76	0.636	2.32	3.177
166°F	976 psi	-2.26	0.000	-6.21	0.000	2.76	0.636	2.39	3.180
178°F	1113 psi	-2.22	0.000	-6.20	0.000	2.77	0.636	2.45	3.183
190°F	1250 psi	-2.18	0.000	-6.20	0.000	2.78	0.636	2.51	3.185

Note 1: When assessing the severity of the scale problem, both the saturation index (SI) and amount of scale must be considered
 Note 2: Precipitation of each scale is considered separately. Total scale will be less than the sum of the amounts of the eight (8) scales.
 Note 3: Saturation index predictions on this sheet use pH and alkalinity; %CO₂ is not included in the calculations.



Comments:

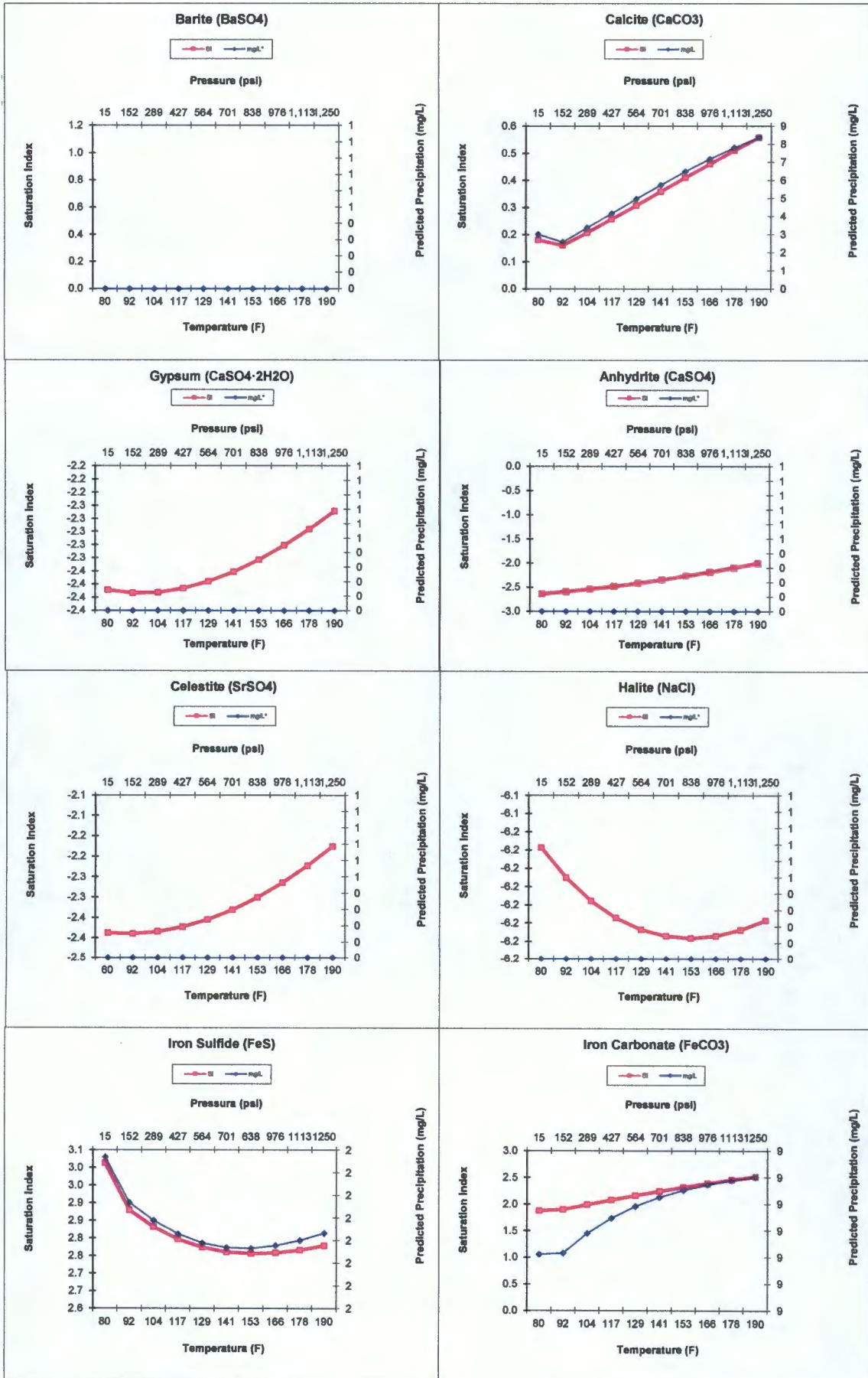

C-108 ITEM XII – GEOLOGIC AFFIRMATION

We have examined available geologic and engineering data and have found no evidence of open faults or other hydrologic connection between the disposal interval and any underground sources of drinking water.

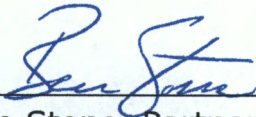

Ben Stone, Partner
SOS Consulting, LLC

Project: Solaris Water Midstream, LLC
Athena 28 SWD No.1
Reviewed 10/19/2017

Athena 28 SWD Well No.1 - Leasehold Plat
 (Attachment to NMOCD Form C-108, Application for Authority to Inject.)

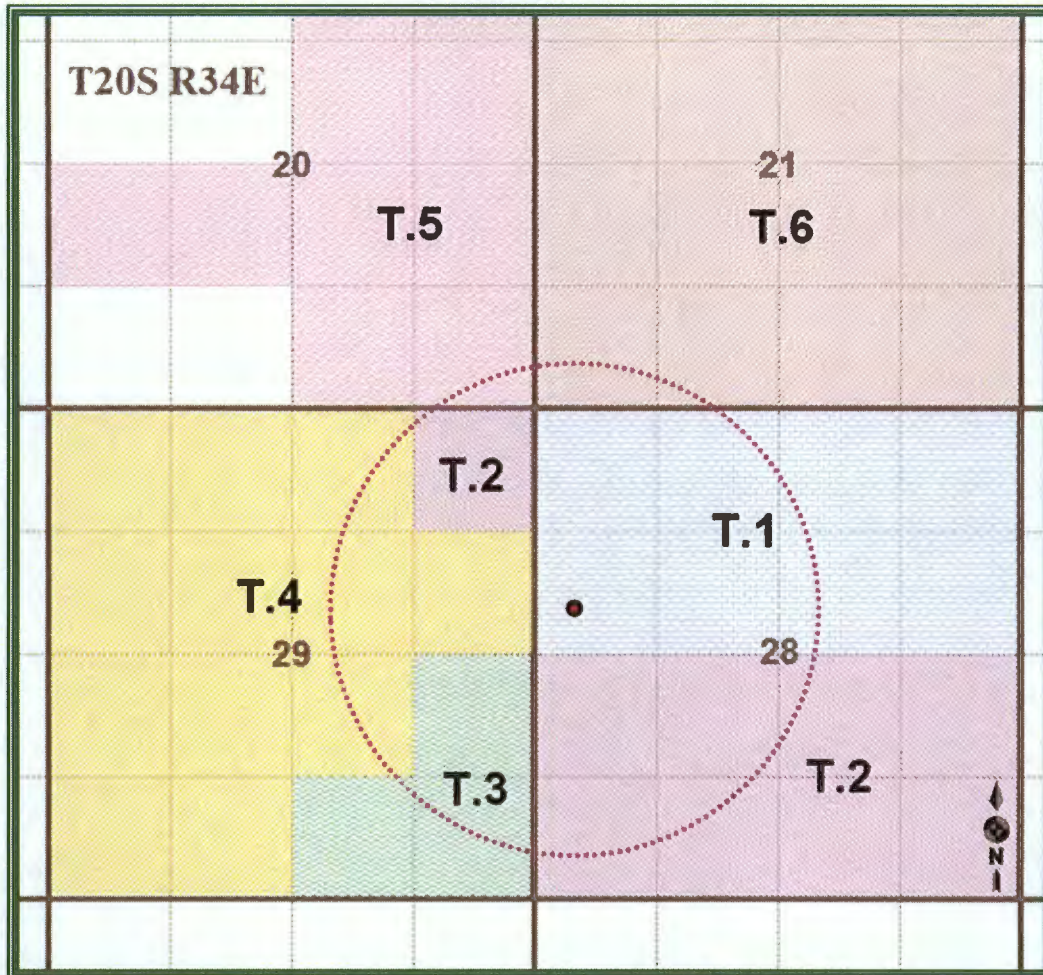

LEGEND

- T.1 – Berry Ranch; BC Operating, Inc.
- T.2 – NMNM-0039256; Mobil Producing TX & NM
- T.3 – NMNM-108977; EOG Resources, Inc.
- T.4 – NMNM-128367; EOG Resources, Inc.
- T.5 – NMNM-013276; Oxy USA WTP, LP
- T.6 – NMLC-0070315; Keystone OG NM, LLC, others

**C-108 ITEM XIII – PROOF OF NOTIFICATION
INTERESTED PARTIES LIST**

SURFACE OWNER

- 1 BERRY RANCH
P.O. Box 160
Eunice, New Mexico 88231
Certified: 7015 0640 0007 9482 9781

MINERALS LESSEES and/or OPERATORS (All Notified via USPS Certified Mail)

Fee Lease – Berry Ranch.; (T.1 on plat.)

- Operator***
2 BC OPERATING, INC.
P.O. Box 50820
Midland, TX 79710
Certified: 7015 0640 0007 9482 9774

BLM Lease NMNM-0039256; (T.2 on plat.)

- Lessee***
3 MOBIL PRODUCING TEXAS & NM, INC.
P.O. Box 2305
Houston, TX 77252-2305
Certified: 7015 0640 0007 9482 9767

BLM Lease NMNM-108977 & NMNM-128367; (T.3 & T.4 on plat.)

- Lessee & Operator***
2 EOG RESOURCES, INC.
5509 Champions Drive
Midland, TX 79706
Certified: 7015 0640 0007 9482 9750

- Operator***
5 DIAMONDBACK RESOURCES, LLC
303 Veterans Airpark Ln., Ste.1100
Midland, TX 79705
Certified: 7015 0640 0007 9482 9743

BLM Lease NMNM-013276; (T.5 on plat.)

- Lessee***
6 OXY USA, INC.
6001 Deauville Blvd.
Midland, TX 79706
Certified: 7015 0640 0007 9482 9736

BLM Lease NMLC-0070315; (T.6 on plat.)

- 7 KEYSTONE OG NM, LLC (ET AL)
P.O. Box 916107
Fort Worth, TX 76191-6107
Certified: 7015 0640 0007 9482 9729

**C-108 ITEM XIII – PROOF OF NOTIFICATION
INTERESTED PARTIES LIST (cont.)**

BLM Lease NMLC-0070315; (T.6 on plat - cont.)

Operators

8 FASKEN OIL & RANCH, LTD
6101 Holiday Hill Road
Midland, TX 79707
Certified: 7015 0640 0007 9482 9712

9 RHCJ ENTERPRISES, LLC
P.O. Box 6055
Hobbs, NM 88241
Certified: 7015 0640 0007 9482 9705

OFFSET MINERALS OWNER (Notified via USPS Certified Mail)

10 U.S. DEPARTMENT OF INTERIOR
Bureau of Land Management
Oil & Gas Division
620 E. Greene St.
Carlsbad, NM 88220
Certified: 7015 0640 0007 9482 9699

REGULATORY

NEW MEXICO OIL CONSERVATION DIVISION (FedEx'ed original and copy)
1220 S. St. Francis Dr.
Santa Fe, NM 87505

NEW MEXICO OIL CONSERVATION DIVISION (FedEx'ed copy)
1625 S. French Drive
Hobbs, NM 88240



October 31, 2017

NOTIFICATION TO INTERESTED PARTIES
via U.S. Certified Mail – Return Receipt Requested

To Whom It May Concern:

Solaris Water Midstream, LLC, Midland, Texas, has made application to the New Mexico Oil Conservation Division to drill and complete for salt water disposal the Athena 28 SWD Well No.1. The proposed commercial operation will be for produced water disposal from area operators. As indicated in the notice below, the well is located in Section 28, Township 20 South, Range 34 East in Lea County, New Mexico.

The published notice states that the interval will be from 14,500 feet to 16,250 feet into the Devonian, Silurian and Fusselman formations.

Following is the notice published in the Hobbs News Sun, Hobbs, New Mexico on or about November 2, 2017.

LEGAL NOTICE

Solaris Water Midstream, LLC, 701 Tradewinds Blvd., Suite C, Midland, TX 79706, is filing Form C-108 (Application for Authority to Inject) with the New Mexico Oil Conservation Division seeking administrative approval for a salt water disposal well. The proposed well, the Athena 28 SWD No.1, is located 2198' FNL and 350' FWL, Section 28, Township 20 South, Range 34 East, Lea County, New Mexico. Produced water from area production will be commercially disposed into the Devonian, Silurian and Fusselman formations at a depth of 14,500' to 16,250' at a maximum surface pressure of 2900 psi and a rate limited only by such pressure. The proposed SWD well is located approximately 18.8 miles west/ southwest of Monument, NM.

Interested parties wishing to object to the proposed application must file with the New Mexico Oil Conservation Division, 1220 St. Francis Dr., Santa Fe, NM 87505, (505)476-3460 within 15 days of the date of this notice. Additional information may be obtained from the applicant's agent, SOS Consulting, LLC, (903)488-9850 or, email info@sosconsulting.us.

You have been identified as a party who may be interested as an offset lessee or operator.

You are entitled to a full copy of the application. A full copy in PDF format is posted on the SOS Consulting **ShareFile** site and is available for immediate download.

Use the URL link <https://sosconsulting.sharefile.com/d-s21ca56e57814352a>

(Please Note: The ShareFile service is powered by Citrix Systems and is completely secure.)*

The link to this file will be active for 30 days from the date of this letter. Your company can access and download the file a maximum of five (5) times. (One copy may be downloaded and shared as needed among your company.)

Alternatively, you may call SOS Consulting, LLC at 903-488-9850, or email info@sosconsulting.us, and the same PDF file copy will be expedited to you via email.

Please use the subject "**Athena SWD Nov2017 PDF Copy Request**".

Thank you for your attention in this matter.

Best regards,



Ben Stone, SOS Consulting, LLC
Agent for Solaris Water Midstream, LLC

Cc: Application File

SOS Consulting is committed to providing superior quality work using technology to assist clients and interested parties in obtaining the documentation required. SOS will continue to utilize methods for reducing papers copies and are less energy and resource intensive.

We hope you'll partner with us and appreciate these efforts.

* You will be asked for your email, name and company.
This will not be used by anyone except keeping track of the file downloads.
You will not be solicited by SOS or anyone else. Data is stored on Citrix Systems servers only.

C-108 - Item XIV

Proof of Notice (Certified Mail Receipts)

7015 0640 0007 9482 9781
7015 0640 0007 9482 9767

U.S. Postal Service™
CERTIFIED MAIL® RECEIPT
Domestic Mail Only

For delivery information, visit our website at www.usps.com®.

OFFICIAL USE

Certified Mail Fee	\$		Postmark Here
Extra Services & Fees (check box, add fee as appropriate)	\$		
<input type="checkbox"/> Return Receipt (hardcopy)	\$		
<input type="checkbox"/> Return Receipt (electronic)	\$		
<input type="checkbox"/> Certified Mail Restricted Delivery	\$		
<input type="checkbox"/> Adult Signature Required	\$		
<input type="checkbox"/> Adult Signature Restricted Delivery	\$		
Postage	\$		
Total Postage and Fees	\$		

Sent To
Street and
City, State
BERRY RANCH
P.O. Box 160
Eunice, New Mexico 88231

CERTIFIED MAIL® RECEIPT
Domestic Mail Only

For delivery information, visit our website at www.usps.com®.

OFFICIAL USE

Certified Mail Fee	\$		Postmark Here
Extra Services & Fees (check box, add fee as appropriate)	\$		
<input type="checkbox"/> Return Receipt (hardcopy)	\$		
<input type="checkbox"/> Return Receipt (electronic)	\$		
<input type="checkbox"/> Certified Mail Restricted Delivery	\$		
<input type="checkbox"/> Adult Signature Required	\$		
<input type="checkbox"/> Adult Signature Restricted Delivery	\$		
Postage	\$		
Total Postage and Fees	\$		

Sent To
Street and
City, State
MOBIL PROD. TEXAS & NM, INC.
P.O. Box 2305
Houston, TX 77252-2305

CERTIFIED MAIL® RECEIPT
Domestic Mail Only

For delivery information, visit our website at www.usps.com®.

OFFICIAL USE

Certified Mail Fee	\$		Postmark Here
Extra Services & Fees (check box, add fee as appropriate)	\$		
<input type="checkbox"/> Return Receipt (hardcopy)	\$		
<input type="checkbox"/> Return Receipt (electronic)	\$		
<input type="checkbox"/> Certified Mail Restricted Delivery	\$		
<input type="checkbox"/> Adult Signature Required	\$		
<input type="checkbox"/> Adult Signature Restricted Delivery	\$		
Postage	\$		
Total Postage and Fees	\$		

Sent To
Street and
City, State
DIAMONDBACK RESOURCES, LLC
303 Veterans Airpark Ln., Ste.1100
Midland, TX 79705

7015 0640 0007 9482 9774
7015 0640 0007 9482 9750

U.S. Postal Service™
CERTIFIED MAIL® RECEIPT
Domestic Mail Only

For delivery information, visit our website at www.usps.com®.

OFFICIAL USE

Certified Mail Fee	\$		Postmark Here
Extra Services & Fees (check box, add fee as appropriate)	\$		
<input type="checkbox"/> Return Receipt (hardcopy)	\$		
<input type="checkbox"/> Return Receipt (electronic)	\$		
<input type="checkbox"/> Certified Mail Restricted Delivery	\$		
<input type="checkbox"/> Adult Signature Required	\$		
<input type="checkbox"/> Adult Signature Restricted Delivery	\$		
Postage	\$		
Total Postage and Fees	\$		

Sent To
Street and
City, State
BC OPERATING, INC.
P.O. Box 50820
Midland, TX 79710

CERTIFIED MAIL® RECEIPT
Domestic Mail Only

For delivery information, visit our website at www.usps.com®.

OFFICIAL USE

Certified Mail Fee	\$		Postmark Here
Extra Services & Fees (check box, add fee as appropriate)	\$		
<input type="checkbox"/> Return Receipt (hardcopy)	\$		
<input type="checkbox"/> Return Receipt (electronic)	\$		
<input type="checkbox"/> Certified Mail Restricted Delivery	\$		
<input type="checkbox"/> Adult Signature Required	\$		
<input type="checkbox"/> Adult Signature Restricted Delivery	\$		
Postage	\$		
Total Postage and Fees	\$		

Sent To
Street and
City, State
EOG RESOURCES, INC.
5509 Champions Drive
Midland, TX 79706

CERTIFIED MAIL® RECEIPT
Domestic Mail Only

For delivery information, visit our website at www.usps.com®.

OFFICIAL USE

Certified Mail Fee	\$		Postmark Here
Extra Services & Fees (check box, add fee as appropriate)	\$		
<input type="checkbox"/> Return Receipt (hardcopy)	\$		
<input type="checkbox"/> Return Receipt (electronic)	\$		
<input type="checkbox"/> Certified Mail Restricted Delivery	\$		
<input type="checkbox"/> Adult Signature Required	\$		
<input type="checkbox"/> Adult Signature Restricted Delivery	\$		
Postage	\$		
Total Postage and Fees	\$		

Sent To
Street and
City, State
DIAMONDBACK RESOURCES, LLC
303 Veterans Airpark Ln., Ste.1100
Midland, TX 79705

C-108 - Item XIV

Proof of Notice (Certified Mail Receipts – cont.)

7015 0640 0007 9482 9736
7015 0640 0007 9482 9712

U.S. Postal Service™
CERTIFIED MAIL® RECEIPT
Domestic Mail Only

For delivery information, visit our website at www.usps.com®.

OFFICIAL USE

Certified Mail Fee
\$ _____

Extra Services & Fees (check box, add fee as appropriate)

Return Receipt (hardcopy) \$ _____

Return Receipt (electronic) \$ _____

Certified Mail Restricted Delivery \$ _____

Adult Signature Required \$ _____

Adult Signature Restricted Delivery \$ _____

Postage
\$ _____

Total Postage and Fees
\$ _____

Postmark
Here

Sent To
Street and _____
City, State _____

OXY USA, INC.
6001 Deauville Blvd.
Midland, TX 79706

CERTIFIED MAIL RECEIPT
Domestic Mail Only

For delivery information, visit our website at www.usps.com®.

OFFICIAL USE

Certified Mail Fee
\$ _____

Extra Services & Fees (check box, add fee as appropriate)

Return Receipt (hardcopy) \$ _____

Return Receipt (electronic) \$ _____

Certified Mail Restricted Delivery \$ _____

Adult Signature Required \$ _____

Adult Signature Restricted Delivery \$ _____

Postage
\$ _____

Total Postage and Fees
\$ _____

Postmark
Here

Sent To
Street and _____
City, State _____

FASKEN OIL & RANCH, LTD
6101 Holiday Hill Road
Midland, TX 79707

CERTIFIED MAIL RECEIPT
Domestic Mail Only

For delivery information, visit our website at www.usps.com®.

OFFICIAL USE

Certified Mail Fee
\$ _____

Extra Services & Fees (check box, add fee as appropriate)

Return Receipt (hardcopy) \$ _____

Return Receipt (electronic) \$ _____

Certified Mail Restricted Delivery \$ _____

Adult Signature Required \$ _____

Adult Signature Restricted Delivery \$ _____

Postage
\$ _____

Total Postage and Fees
\$ _____

Postmark
Here

Sent To
Street _____
City, State _____

Bureau of Land Management
Oil & Gas Division
620 E. Greene St.
Carlsbad, NM 88220

CERTIFIED MAIL RECEIPT
Domestic Mail Only

For delivery information, visit our website at www.usps.com®.

OFFICIAL USE

U.S. Postal Service™
CERTIFIED MAIL® RECEIPT
Domestic Mail Only

For delivery information, visit our website at www.usps.com®.

OFFICIAL USE

Certified Mail Fee
\$ _____

Extra Services & Fees (check box, add fee as appropriate)

Return Receipt (hardcopy) \$ _____

Return Receipt (electronic) \$ _____

Certified Mail Restricted Delivery \$ _____

Adult Signature Required \$ _____

Adult Signature Restricted Delivery \$ _____

Postage
\$ _____

Total Postage and Fees
\$ _____

Postmark
Here

Sent To
Street and _____
City, State, Z _____

KEYSTONE OG NM, LLC (ET AL)
P.O. Box 916107
Fort Worth, TX 76191-6107

CERTIFIED MAIL RECEIPT
Domestic Mail Only

For delivery information, visit our website at www.usps.com®.

OFFICIAL USE

Certified Mail Fee
\$ _____

Extra Services & Fees (check box, add fee as appropriate)

Return Receipt (hardcopy) \$ _____

Return Receipt (electronic) \$ _____

Certified Mail Restricted Delivery \$ _____

Adult Signature Required \$ _____

Adult Signature Restricted Delivery \$ _____

Postage
\$ _____

Total Postage and Fees
\$ _____

Postmark
Here

Sent To
Street _____
City, State _____

RHCJ ENTERPRISES, LLC
P.O. Box 6055
Hobbs, NM 88241

CERTIFIED MAIL RECEIPT
Domestic Mail Only

For delivery information, visit our website at www.usps.com®.

OFFICIAL USE

Certified Mail Fee
\$ _____

Extra Services & Fees (check box, add fee as appropriate)

Return Receipt (hardcopy) \$ _____

Return Receipt (electronic) \$ _____

Certified Mail Restricted Delivery \$ _____

Adult Signature Required \$ _____

Adult Signature Restricted Delivery \$ _____

Postage
\$ _____

Total Postage and Fees
\$ _____

Instructions

Sent To
Street _____
City, State _____

CERTIFIED MAIL RECEIPT
Domestic Mail Only

For delivery information, visit our website at www.usps.com®.

OFFICIAL USE

C-108 - Item XIV

Proof of Notice – Legal Notice Newspaper of General Circulation

LEGAL NOTICE November 2, 2017

Solaris Water Midstream, LLC, 701 Tradewinds Blvd., Suite C, Midland, TX 79706, is filing Form C-108 (Application for Authority to Inject) with the New Mexico Oil Conservation Division seeking administrative approval for a salt water disposal well. The proposed well, the Athena 28 SWD No.1, is located 2198' FNL and 350' FWL, Section 28, Township 20 South, Range 34 East, Lea County, New Mexico. Produced water from area production will be commercially disposed into the Devonian, Silurian and Fusselman formations at a depth of 14,500' to 16,250' at a maximum surface pressure of 2900 psi and a rate limited only by such pressure. The proposed SWD well is located approximately 18.8 miles west/ southwest of Monument, NM.

Interested parties wishing to object to the proposed application must file with the New Mexico Oil Conservation Division, 1220 St. Francis Dr., Santa Fe, NM 87505, (505)476-3460 within 15 days of the date of this notice. Additional information may be obtained from the applicant's agent, SOS Consulting, LLC, (903)488-9850 or, email info@sosconsulting.us.
#32205

RECEIVED OGD
2017 NOV -6 A 8:55

The above is the "Proof Copy" sent from the Hobbs News-Sun.
The affidavit of publication will be forwarded as soon as it is received.

McMillan, Michael, EMNRD

From: ben@sosconsulting.us
Sent: Sunday, November 5, 2017 12:27 PM
To: McMillan, Michael, EMNRD
Subject: Affidavit - Solaris Athena SWD...
Attachments: Affidavit_Athena_Solaris_20171105001.pdf

Mike,

Athena SWD No.1 affidavit attached. Hard copy via U.S. mail

thanks,
Ben



Visit us on the web at www.sosconsulting.us!

This electronic message and all attachments are confidential, and are intended only for the use of the individual to whom it is addressed. Information may also be legally privileged. This transmission is sent in trust for the sole purpose of delivery to the intended recipient. If you have received this transmission in error, you are hereby notified that any use, dissemination, distribution or reproduction of this transmission is strictly prohibited and may be unlawful. If you are not the intended recipient, you must delete this message and any copy of it (in any form) without disclosing it. If this message has been sent to you in error, please notify the sender by replying to this transmission, or by calling SOS Consulting, LLC, 903-488-9850. Unless expressly stated in this e-mail, nothing in this message should be construed as a digital or electronic signature. Thank you for your cooperation.

Affidavit of Publication

STATE OF NEW MEXICO
COUNTY OF LEA

I, Daniel Russell, Publisher of the Hobbs News-Sun, a newspaper published at Hobbs, New Mexico, solemnly swear that the clipping attached hereto was published in the regular and entire issue of said newspaper, and not a supplement thereof for a period of 1 issue(s).

Beginning with the issue dated
November 02, 2017
and ending with the issue dated
November 02, 2017.

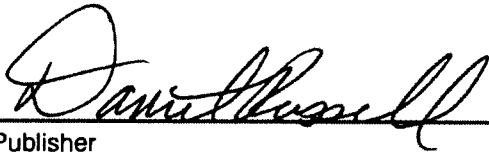

Publisher

Sworn and subscribed to before me this
2nd day of November 2017.



Business Manager

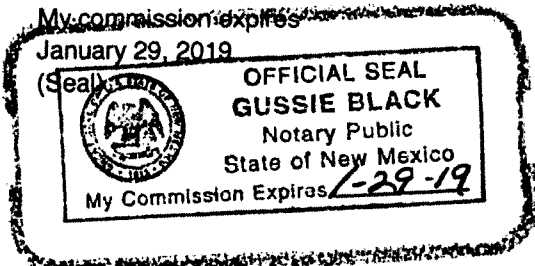

This newspaper is duly qualified to publish legal notices or advertisements within the meaning of Section 3, Chapter 167, Laws of 1937 and payment of fees for said



LEGAL NOTICE November 2, 2017

Solaris Water Midstream, LLC, 701 Tradewinds Blvd., Suite C, Midland, TX 79706, is filing Form C-108 (Application for Authority to Inject) with the New Mexico Oil Conservation Division seeking administrative approval for a salt water disposal well. The proposed well, the Athena 88 SWD No. 1, is located 2195' FNL and 380' FNL, Section 26, Township 20 South, Range 34 East, Lea County, New Mexico. Produced water from area production will be commercially disposed into the Devonian, Blurian and Fusselman formations at a depth of 14,500' to 16,250' at a maximum surface pressure of 2000 psi and a rate limited only by such pressure. The proposed SWD well is located approximately 18.8 miles west/southwest of Monument, NM.

Interested parties wishing to object to the proposed application must file with the New Mexico Oil Conservation Division, 1220 St. Francis Dr., Santa Fe, NM 87505, (505) 475-3480 within 15 days of the date of this notice. Additional information may be obtained from the applicant's agent, SOS Consulting, LLC, (903) 488-8860 or, email info@sosconsulting.us #32205

67104420

00202076

BEN STONE
SOS CONSULTING, LLC.
P.O. BOX 300
COMO, TX 75431

Affidavit of Publication

STATE OF NEW MEXICO
COUNTY OF LEA

I, Daniel Russell, Publisher of the Hobbs News-Sun, a newspaper published at Hobbs, New Mexico, solemnly swear that the clipping attached hereto was published in the regular and entire issue of said newspaper, and not a supplement thereof for a period of 1 issue(s).

Beginning with the issue dated
November 02, 2017
and ending with the issue dated
November 02, 2017.

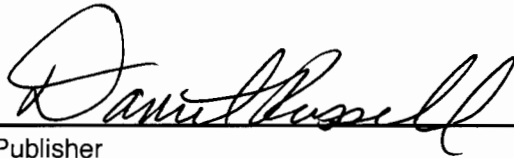

Publisher

Sworn and subscribed to before me this
2nd day of November 2017.

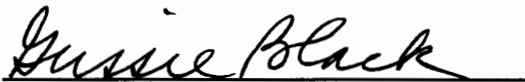

Business Manager

My commission expires
January 29, 2019

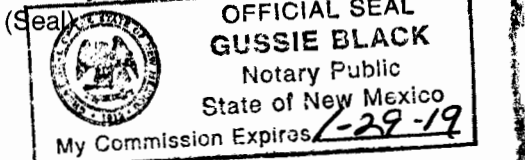

This newspaper is duly qualified to publish legal notices or advertisements within the meaning of Section 3, Chapter 167, Laws of 1937 and payment of fees for said

LEGALS

LEGAL NOTICE November 2, 2017

Solaris Water Midstream, LLC, 701 Tradewinds Blvd., Suite C, Midland, TX 79706, is filing Form C-108 (Application for Authority to Inject) with the New Mexico Oil Conservation Division seeking administrative approval for a salt water disposal well. The proposed well, the Athena 28 SWD No.1, is located 2198' FNL and 350' FWL, Section 28, Township 20 South, Range 34 East, Lea County, New Mexico. Produced water from area production will be commercially disposed into the Devonian, Silurian and Fusselman formations at a depth of 14,500' to 16,250' at a maximum surface pressure of 2900 psi and a rate limited only by such pressure. The proposed SWD well is located approximately 18.8 miles west/ southwest of Monument, NM.

Interested parties wishing to object to the proposed application must file with the New Mexico Oil Conservation Division, 1220 St. Francis Dr., Santa Fe, NM 87505, (505)476-3460 within 15 days of the date of this notice. Additional information may be obtained from the applicant's agent, SOS Consulting, LLC, (903)488-9850 or, email info@sosconsulting.us. #32205

RECEIVED OCD
2017 NOV -9 P 3: 16

67104420

00202076

BEN STONE
SOS CONSULTING, LLC.
P.O. BOX 300
COMO, TX 75431



C-108 Review Checklist: Received 11/03/2017 Add. Request: 11/06/2017 Reply Date: _____ Suspended: _____ [Ver 15]

ORDER TYPE: WFX / PMX / SWD Number: _____ Order Date: _____ Legacy Permits/Orders: _____

Well No. 1 Well Name(s): Athena 2 & 5

API: 30-0 25-Pending Spud Date: YOD New or Old: NEW (UIC Class II Primacy 03/07/1982)

Footages 2198 FNL 357 FNL Lot _____ or Unit E Sec 28 Tsp 205 Rge 34E County Lee

General Location: 2 20 mile SW Hubbs Pool: SWD, DEVONIAN Pool No.: 97869

BLM 100K Map: Hobbs Operator: midstream, LLC OGRID: 371643 Contact: Agent

COMPLIANCE RULE 5.9: Total Wells: 5 Inactive: 0 Fincl Assur OK Compl. Order? N/A IS 5.9 OK? y Date: 11-27-2017

WELL FILE REVIEWED Current Status: Proposed

WELL DIAGRAMS: NEW: Proposed or RE-ENTER: Before Conv. After Conv. Logs in Imaging: N/A

Planned Rehab Work to Well: _____

Well Construction Details	Sizes (in) Borehole / Pipe	Setting Depths (ft)	Cement Syor Cf	Cement Top and Determination Method
Planned ___ or Existing ___ Surface	<u>26 1/2"</u>	<u>1550</u>	<u>2100</u>	<u>Surface/Visual</u>
Planned ___ or Existing ___ Interm/Prod	<u>17 1/2"</u>	<u>5725</u>	<u>1750</u>	<u>Surface/Visual</u>
Planned ___ or Existing ___ Interm/Prod	<u>12 1/4"</u>	<u>12000</u>	<u>2300</u>	<u>Surface/Visual</u>
Planned ___ or Existing ___ Prod/Liner	<u>8 1/2"</u>	<u>11700</u>	<u>450</u>	<u>1700 / C-13-L</u>
Planned ___ or Existing ___ Liner				
Planned ___ or Existing ___ (OH) PERF	<u>14500 - 16250</u>		<u>Inj Length 1750</u>	

Injection Lithostratigraphic Units	Depths (ft)	Injection or Confining Units	Tops	Completion/Operation Details:
Adjacent Unit: Litho. Struc. Por.		<u>*wd</u>	<u>14770</u>	Drilled TD <u>16250</u> PBDT _____
Confining Unit: Litho. Struc. Por.		<u>*DV</u>	<u>114658</u>	NEW TD _____ NEW PBDT _____
Proposed Inj Interval TOP:		<u>*Projected depths</u>		NEW Open Hole <input checked="" type="radio"/> or NEW Perfs <input type="radio"/>
Proposed Inj Interval BOTTOM:				Tubing Size <u>6"</u> in. Inter Coated? _____
Confining Unit: Litho. Struc. Por.				Proposed Packer Depth <u>14400</u> ft
Adjacent Unit: Litho. Struc. Por.				Min. Packer Depth <u>14400</u> (100-ft limit)
				Proposed Max. Surface Press. <u>2900</u> psi
				Admin. Inj. Press. <u>2900</u> (0.2 psi per ft)

AOR: Hydrologic and Geologic Information

POTASH: R-111-P y Noticed? y BLM Sec Ord WIPP Noticed? N/A Salt/Salado T: 1760 B: 330 NW: Cliff House fm

FRESH WATER: Aquifer Traces Max Depth 1005 HYDRO AFFIRM STATEMENT By Qualified Person

NMOSE Basin: Capitan CAPITAN REEF: thru adj NA No. Wells within 1-Mile Radius? 2 FW Analysis y

Disposal Fluid: Formation Source(s) Spring, well, Amp, morra Analysis? y On Lease Operator Only or Commercial

Disposal Int: Inject Rate (Avg/Max BWPD): 200/25K Protectable Waters? _____ Source: _____ System: Closed or Open

HC Potential: Producing Interval? N/A Formerly Producing? _____ Method: Logs/DST/P&A/Other regional 2-Mile Radius Pool Map

AOR Wells: 1/2-M Radius Map? y Well List? _____ Total No. Wells Penetrating Interval: 0 Horizontals? _____

Penetrating Wells: No. Active Wells 0 Num Repairs? _____ on which well(s)? _____ Diagrams? _____

Penetrating Wells: No. P&A Wells _____ Num Repairs? _____ on which well(s)? _____ Diagrams? _____

NOTICE: Newspaper Date November 2017 Mineral Owner BERRY Surface Owner BC BERRY N. Date 10-31-2017

RULE 26.7(A): Identified Tracts? y Affected Persons: BC OPERATING, MOBILE, OKC, KEYSTONE N. Date 10-31-2017

Order Conditions: Issues: _____

Add Order Cond: _____