

DATE IN 11/03/2017	SUSPENSE	ENGINEER PPS	LOGGED IN 11/03/2017	TYPE SWD	APP NO. PMAM1731050949
-----------------------	----------	-----------------	-------------------------	-------------	---------------------------

ABOVE THIS LINE FOR DIVISION USE ONLY

NEW MEXICO OIL CONSERVATION DIVISION
 - Engineering Bureau -
 1220 South St. Francis Drive, Santa Fe, NM 87505



ADMINISTRATIVE APPLICATION CHECKLIST

THIS CHECKLIST IS MANDATORY FOR ALL ADMINISTRATIVE APPLICATIONS FOR EXCEPTIONS TO DIVISION RULES AND REGULATIONS WHICH REQUIRE PROCESSING AT THE DIVISION LEVEL IN SANTA FE

Application Acronyms:

[NSL-Non-Standard Location] [NSP-Non-Standard Proration Unit] [SD-Simultaneous Dedication]
 [DHC-Downhole Commingling] [CTB-Lease Commingling] [PLC-Pool/Lease Commingling]
 [PC-Pool Commingling] [OLS - Off-Lease Storage] [OLM-Off-Lease Measurement]
 [WFX-Waterflood Expansion] [PMX-Pressure Maintenance Expansion]
 [SWD-Salt Water Disposal] [IPI-Injection Pressure Increase]
 [EOR-Qualified Enhanced Oil Recovery Certification] [PPR-Positive Production Response]

- [1] **TYPE OF APPLICATION** - Check Those Which Apply for [A]
 [A] Location - Spacing Unit - Simultaneous Dedication
☐ NSL ☐ NSP ☐ SD

Check One Only for [B] or [C]

- [B] Commingling - Storage - Measurement
☐ DHC ☐ CTB ☐ PLC ☐ PC ☐ OLS ☐ OLM

- [C] Injection - Disposal - Pressure Increase - Enhanced Oil Recovery
☐ WFX ☐ PMX ☒ SWD ☐ IPI ☐ EOR ☐ PPR

- [D] Other: Specify _____

- [2] **NOTIFICATION REQUIRED TO:** - Check Those Which Apply, or ☐ Does Not Apply

- [A] ☐ Working, Royalty or Overriding Royalty Interest Owners
 [B] ☒ Offset Operators, Leaseholders or Surface Owner
 [C] ☒ Application is One Which Requires Published Legal Notice
 [D] ☒ Notification and/or Concurrent Approval by BLM or SLO
 U.S. Bureau of Land Management - Commissioner of Public Lands, State Land Office
 [E] ☒ For all of the above, Proof of Notification or Publication is Attached, and/or,
 [F] ☐ Waivers are Attached

- [3] **SUBMIT ACCURATE AND COMPLETE INFORMATION REQUIRED TO PROCESS THE TYPE OF APPLICATION INDICATED ABOVE.**

- [4] **CERTIFICATION:** I hereby certify that the information submitted with this application for administrative approval is **accurate** and **complete** to the best of my knowledge. I also understand that **no action** will be taken on this application until the required information and notifications are submitted to the Division.

Note: Statement must be completed by an individual with managerial and/or supervisory capacity.

Ben Stone
 Print or Type Name

Signature

Agent for Solaris Water Midstream, LLC 10/31/17

Title

ben@sosconsulting.us

e-mail Address

Date

97869

RECEIVED
 2017 NOV - 3 PM 4:22

Handwritten notes and signatures in the bottom right corner, including "30-025-Pending" and "SWD, per union".



October 31, 2017

New Mexico Oil Conservation Division
1220 South St. Francis Drive
Santa Fe, New Mexico 87505

Attn: Mr. David Catanach, Director

Re: Application of Solaris Water Midstream, LLC to permit for salt water disposal the proposed Zeus SWD Well No.1, to be located in Section 35, Township 21 South, Range 32 East, NMPM, Lea County, New Mexico.

Dear Mr. Catanach,

Please find enclosed form C-108 Application for Authority to Inject, supporting the above-referenced request to permit for disposal, the Zeus SWD No.1.

Please note that this proposed location was originally permitted and authorized for SWD by a different operator. Those permits were cancelled by the operator or otherwise allowed to expire by the NMOCD. This application will essentially redo the previously authorized permits at a location approximately 100 feet away.

Solaris Water Midstream seeks to optimize efficiency, both economically and operationally, of its operations and to offer additional disposal options for operators in southeast New Mexico. Approval of this application is consistent with that goal as well as the NMOCD's mission of preventing waste and protection of correlative rights.

Published legal notice will run on or about November 2, 2017 in the Hobbs News-Sun and all offset operators and other interested parties have been notified individually. The legal notice affidavit will be forwarded when received. This application also includes a wellbore schematic, area of review maps, leaseholder plats and other required information for a complete Form C-108. The well is located on private land and minerals with federal minerals offsetting; the BLM CFO was notified.

I respectfully request that the approval of this salt water disposal well proceed swiftly and if you or your staff requires additional information or has any questions, please do not hesitate to call or email me.

Best regards,

Ben Stone, Partner
SOS Consulting, LLC
Agent for Solaris Water Midstream, LLC

Cc: Application attachment and file

APPLICATION FOR AUTHORIZATION TO INJECT

- I. PURPOSE: **Salt Water Disposal** and the application **QUALIFIES** for administrative approval.
- II. OPERATOR: **Solaris Water Midstream, LLC**
ADDRESS: **701 Tradewinds Blvd., Suite C, Midland, TX 79706**

CONTACT PARTY: **Agent: SOS Consulting, LLC – Ben Stone (903) 488-9850**
- III. WELL DATA: **All well data and applicable wellbore diagrams are ATTACHED.**
- IV. **This is not an expansion of an existing project.**
- V. **A map is attached** that identifies all wells and leases within two miles of any proposed injection well with a one-half mile radius circle drawn around each proposed injection well. This circle identifies the well's area of review.
- *VI. A tabulation is attached of data on all wells of public record within the area of review which penetrate the proposed injection zone. **There are NO (0) Wells in the subject AOR.** The data includes a description of each well's type, construction, date drilled, location, depth, and a schematic of any plugged well illustrating all plugging detail.
- VII. **The following data is ATTACHED** on the proposed operation, including:
1. Proposed average and maximum daily rate and volume of fluids to be injected;
 2. Whether the system is open or closed;
 3. Proposed average and maximum injection pressure;
 4. Sources and an appropriate analysis of injection fluid and compatibility with the receiving formation if other than reinjected produced water; and,
 5. If injection is for disposal purposes into a zone not productive of oil or gas at or within one mile of the proposed well, attach a chemical analysis of the disposal zone formation water (may be measured or inferred from existing literature, studies, nearby wells, etc.).
- *VIII. **Appropriate geologic data on the injection zone is ATTACHED** including appropriate lithologic detail, geologic name, thickness, and depth. Give the geologic name, and depth to bottom of all underground sources of drinking water (aquifers containing waters with total dissolved solids concentrations of 10,000 mg/l or less) overlying the proposed injection zone as well as any such sources known to be immediately underlying the injection interval.
- IX. **Stimulation program – a conventional acid job may be performed to clean and open the formation.**
- *X. Attach appropriate logging and test data on the well. (If well logs have been filed with the Division, they need not be resubmitted). **Well Logs will be filed with OCD.**
- *XI. **There are NO water wells within one mile of the proposed SWD well.**
- XII. **An affirmative statement is ATTACHED that available geologic and engineering data has been examined and no evidence was found** of open faults or any other hydrologic connection between the disposal zone and any underground sources of drinking water.
- XIII. **"Proof of Notice" section on the next page of this form has been completed and ATTACHED. There are 8 offset lessees and/or operators within ½ mile and federal minerals – BLM and all have been noticed. Well location is PRIVATE.**
- XIV. Certification: I hereby certify that the information submitted with this application is true and correct to the best of my knowledge and belief.

NAME: **Ben Stone** TITLE: **SOS Consulting, LLC agent for Solaris Water Midstream, LLC**

SIGNATURE:  DATE: **10/31/2017**

E-MAIL ADDRESS: **ben@sosconsulting.us**

- * If the information required under Sections VI, VIII, X, and XI above has been previously submitted, it need not be resubmitted. Please show the date and circumstances of the earlier submittal:

DISTRIBUTION: Original and one copy to Santa Fe with one copy to the appropriate District Office

FORM C-108 – APPLICATION FOR AUTHORIZATION TO INJECT (cont.)

III. WELL DATA – *The following information and data is included (See ATTACHED Wellbore Schematic):*

A. The following well data must be submitted for each injection well covered by this application. The data must be both in tabular and schematic form and shall include:

- (1) Lease name; Well No., Location by Section, Township and Range; and footage location within the section.
- (2) Each casing string used with its size, setting depth, sacks of cement used, hole size, top of cement, and how such top was determined.
- (3) A description of the tubing to be used including its size, lining material, and setting depth.
- (4) The name, model, and setting depth of the packer used or a description of any other seal system or assembly used.

Division District Offices have supplies of Well Data Sheets which may be used or which may be used as models for this purpose. Applicants for several identical wells may submit a "typical data sheet" rather than submitting the data for each well.

B. The following must be submitted for each injection well covered by this application. All items must be addressed for the initial well. Responses for additional wells need be shown only when different. Information shown on schematics need not be repeated.

- (1) The name of the injection formation and, if applicable, the field or pool name.
- (2) The injection interval and whether it is perforated or open-hole.
- (3) State if the well was drilled for injection or, if not, the original purpose of the well.
- (4) Give the depths of any other perforated intervals and detail on the sacks of cement or bridge plugs used to seal off such perforations.
- (5) Give the depth to and the name of the next higher and next lower oil or gas zone in the area of the well, if any.

XIV. PROOF OF NOTICE *pursuant to the following criteria is ATTACHED.*

All applicants must furnish proof that a copy of the application has been furnished, by certified or registered mail, to the owner of the surface of the land on which the well is to be located and to each leasehold operator within one-half mile of the well location.

Where an application is subject to administrative approval, a proof of publication must be submitted. Such proof shall consist of a copy of the legal advertisement which was published in the county in which the well is located. The contents of such advertisement must include:

- (1) The name, address, phone number, and contact party for the applicant;
- (2) The intended purpose of the injection well; with the exact location of single wells or the Section, Township, and Range location of multiple wells;
- (3) The formation name and depth with expected maximum injection rates and pressures; and,
- (4) A notation that interested parties must file objections or requests for hearing with the Oil Conservation Division, 1220 South St. Francis Dr., Santa Fe, New Mexico 87505, within 15 days.

NO ACTION WILL BE TAKEN ON THE APPLICATION UNTIL PROPER PROOF OF NOTICE HAS BEEN SUBMITTED.

NOTICE: Surface owners or offset operators must file any objections or requests for hearing of administrative applications within 15 days from the date this application was mailed to them.



WELL SCHEMATIC - PROPOSED Zeus SWD Well No.1

API 30-025-xxxxx
199' FSL & 335' FEL, SEC. 35-T21S-R32E
LEA COUNTY, NEW MEXICO

SWD; Devonian-Silurian (97869)

Spud Date: 2/15/2018
SWD Config Dt: 3/15/2018

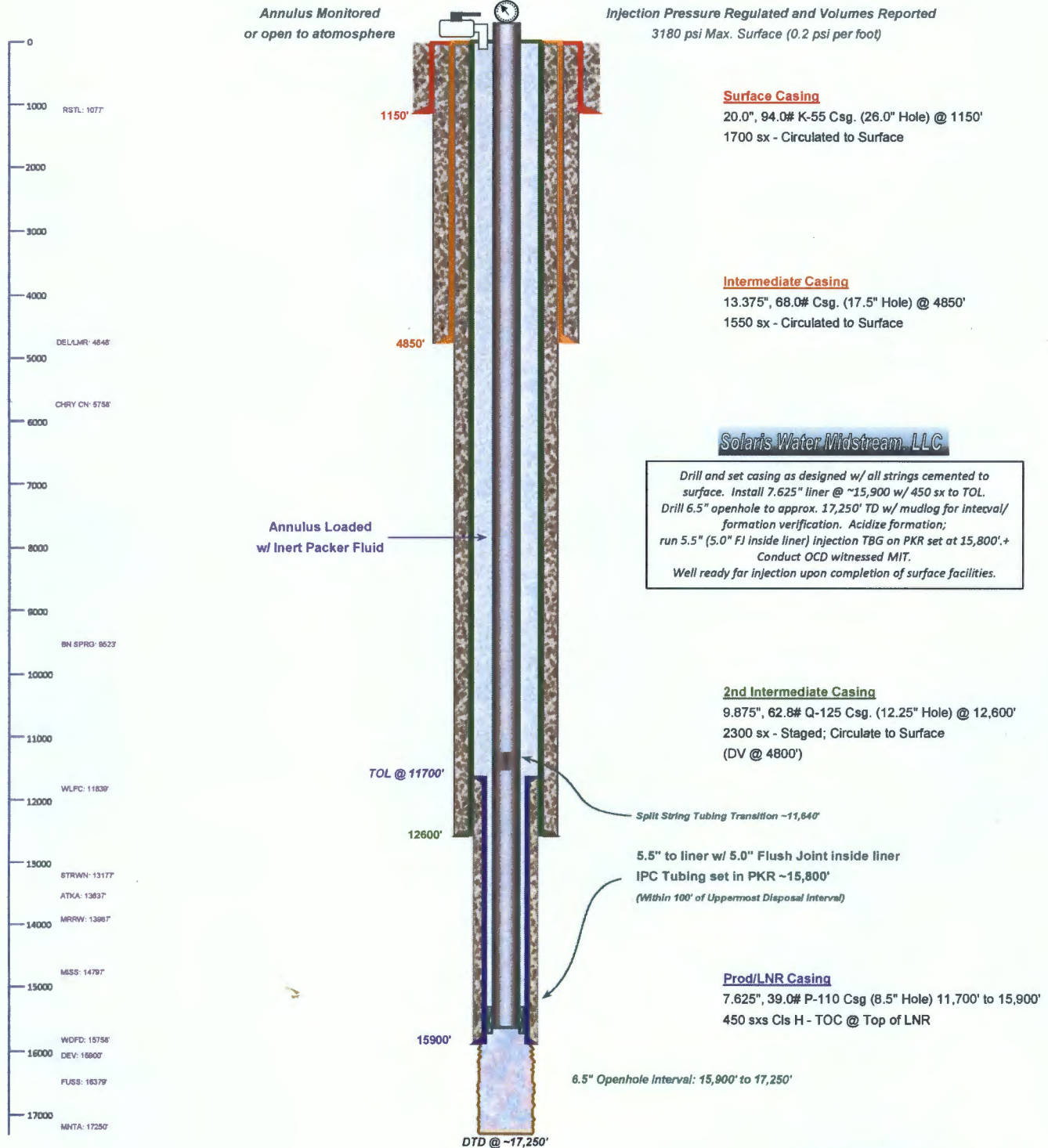

Drill and set casing as designed w/ all strings cemented to surface. Install 7.625" liner @ ~15,900 w/ 450 sx to TOL. Drill 6.5" openhole to approx. 17,250' TD w/ mudlog for interval/formation verification. Acidize formation; run 5.5" (5.0" FI inside liner) injection TBG on PKR set at 15,800'; + Conduct OCD witnessed MIT. Well ready for injection upon completion of surface facilities.

Drawn by: Ben Stone, Rvsd 11/14/2017



Zeus SWD No.1 - Area of Review / 2 Miles

(Attachment to NMOCD Form C-108 - Item V)

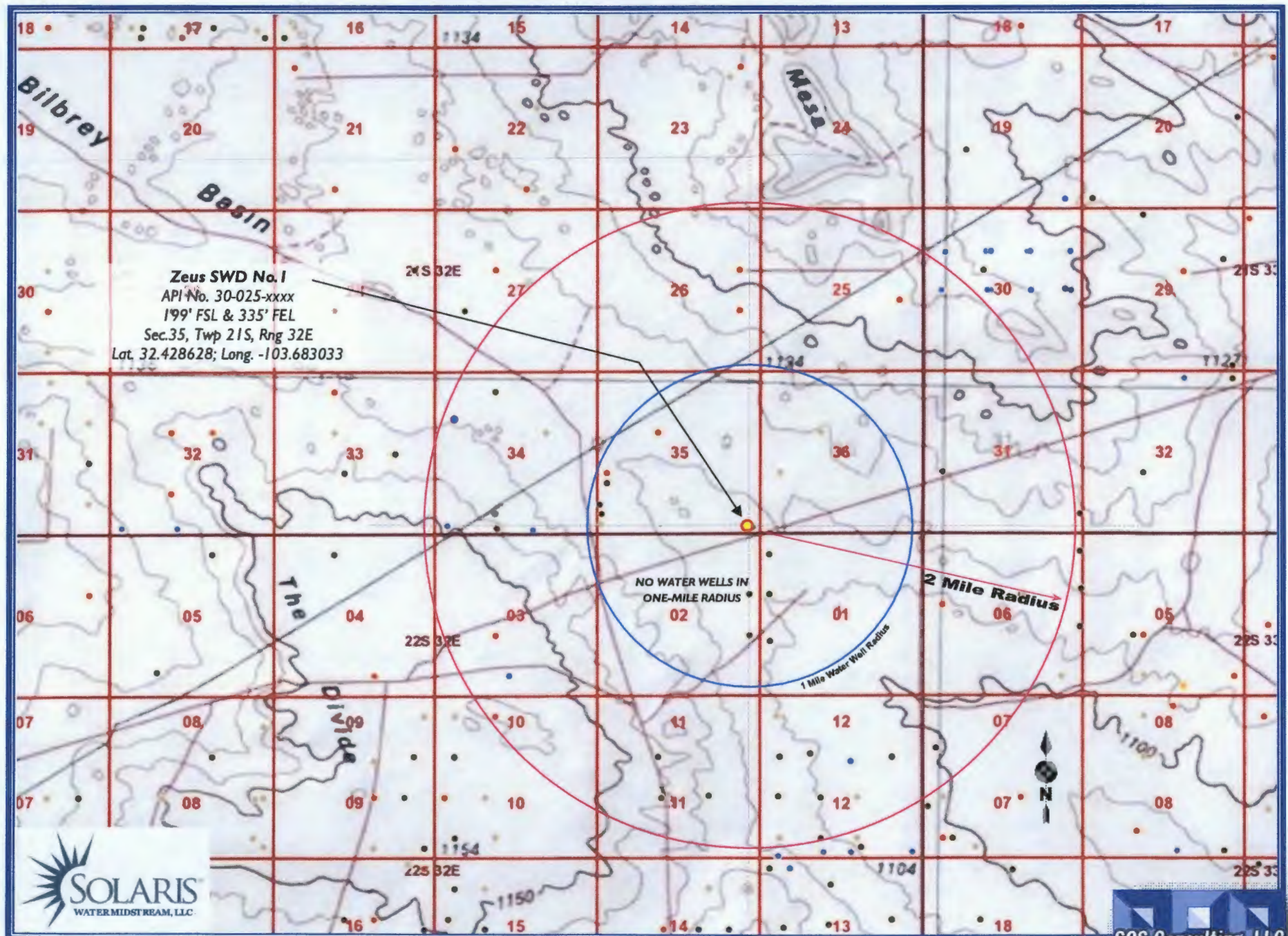

Zeus SWD Well No.1 - Area of Review / Overview Map

(Attachment to NMOCD Form C-108, Application for Authority to Inject.)



25.9 miles SW of Monument, NM

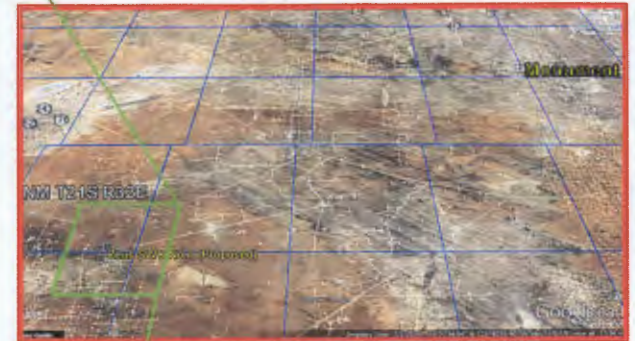

Lea County, New Mexico



Zeus SWD No.1 - Area of Review – Potash Area

(Attachment to NMOCD Form C-108 - Item V)

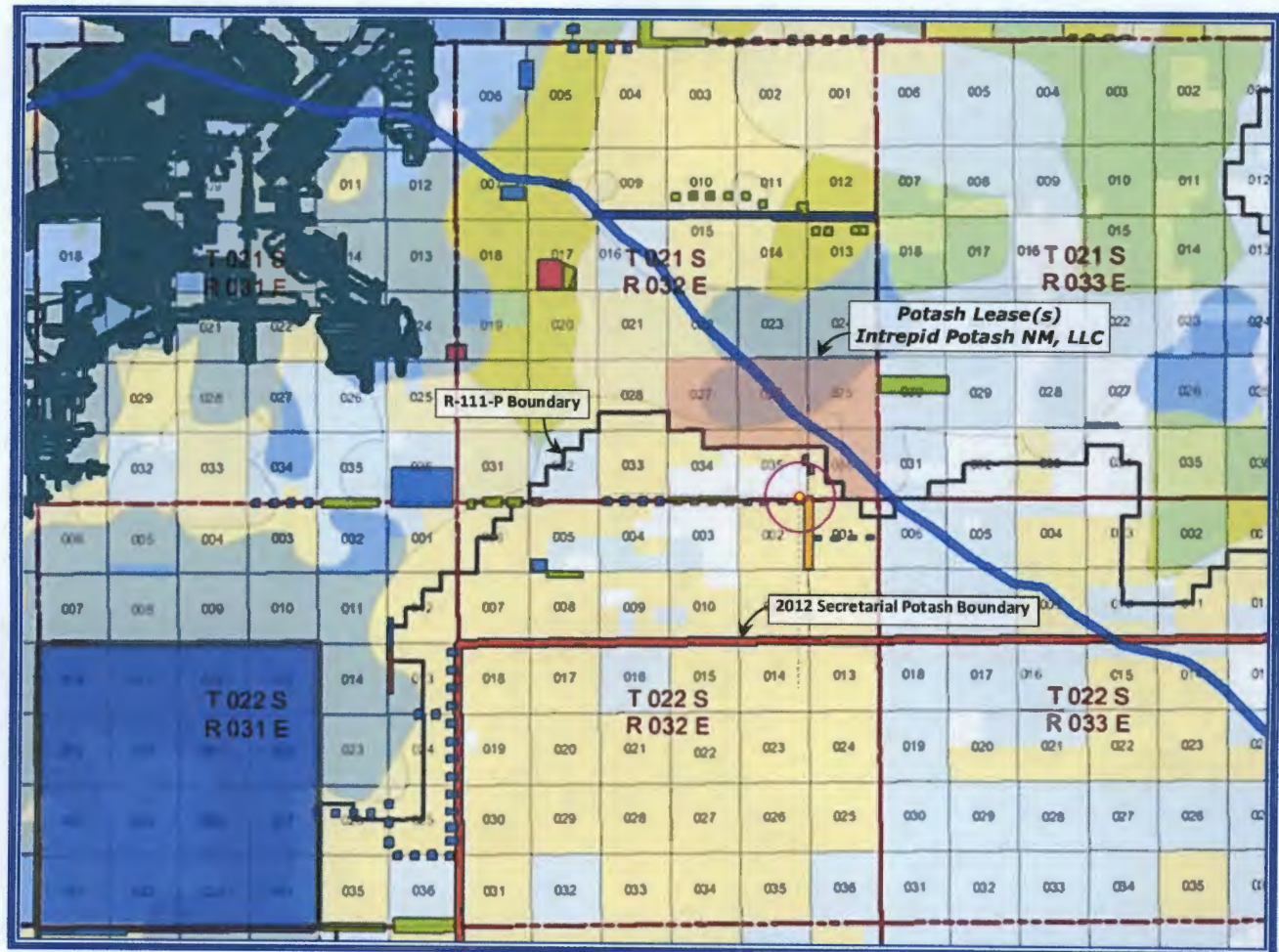

(July 27, 2017 Drill Island Map courtesy of BLM – Carlsbad Field Office)

*Intrepid Potash NM, LLC was included in the notification of affected parties.

C-108 - Item VI

Area of Review Well Data

**THERE ARE NO WELLS WHICH PENETRATE THE
PROPOSED DEVONIAN FORMATION IN THE
ONE-HALF MILE AREA of REVIEW**

C-108 ITEM X – LOGS and AVAILABLE TEST DATA

**A Standard Suite of Logs will be run after
drilling the well and submitted to the Division.**

C-108 ITEM VII – PROPOSED OPERATION

Zeus SWD No.1

Commercial SWD Facility

Upon approval of all permits for SWD, operations would begin within 30 days. Completion of the well operations will take approximately 6-8 weeks. Facility construction including installation of the tank battery, berms, plumbing and other and associated equipment would be occurring during the same interval but at a different location from the well. In any event, it is not expected for the construction phase of the project to last more than 60 days, depending on availability of contractors and equipment. The operator has negotiated a Surface Owner Agreement for the facility and well site.

Configure for Salt Water Disposal

Prior to commencing any work, an NOI sundry(ies) will be submitted to configure the well for SWD and will detail the completion workover including all work otherwise described above, any change to the procedure noted herein and to perform mechanical integrity pressure test per OCD test procedures. (Notify NMOCD 24 hours prior.) The casing/tubing annulus will be monitored for communication with injection fluid or loss of casing integrity.

Operational Summary

The SWD facility will not be fenced so that trucks may access for load disposal 24/7.

The well and injection equipment will be a closed system and equipped with pressure limiting devices and volume meters. The annulus, loaded with an inert, anti-corrosion packer fluid, will be monitored for pressure.

The tanks will be equipped with telemetry devices and visual alarms to alert the operator and customers of full tanks or an overflow situation.

Anticipated daily maximum volume is 30,000 bpd and an average of 20,000 bpd at a maximum surface injection pressure of 3180 psi (.2 psi/ft gradient – maximum pressure will be adjusted If the top of interval is modified after well logs are run).

Potential releases will be contained and cleaned up immediately. The operator shall repair or otherwise correct the situation within 48 hours before resuming operations. OCD will be notified within 24 hours of any release greater than 5 bbls. If required, remediation will start as soon as practicable. Operator shall comply with 19.15.29 NMAC and 19.15.30 NMAC, as necessary and appropriate.

C-108 ITEM VII – PRODUCED WATER ANALYSES

Item VII.4 – Water Analysis of Source Zone Water

Delaware
Bone Spring
Wolfcamp
Morrow

Item VII.5 – Water Analysis of Disposal Zone Water

Devonian

Water Analyses follow this page.

C-108 Item VII.5 - Produced Water Data
Solaris Water Midstream, LLC - Zeus SWD Well No.1

SOURCE ZONE

DELAWARE

API No	3002508367	Lab ID	
Well Name	BELL LAKE UNIT	Sample ID	4347
	007	Sample No	
Location	ULSTR 01 24 S 33 E	Lat / Long	32.25143 -103.51924
	660 N 660 E	County	Lea
Operator (when sampled)			
	Field SWD	Unit	1
Sample Date		Analysis Date	
	Sample Source UNKNOWN	Depth (if known)	
	Water Typ		
ph		alkalinity_as_caco3_mgL	
ph_temp_F		hardness_as_caco3_mgL	
specificgravity		hardness_mgL	
specificgravity_temp_F		resistivity_ohm_cm	
tds_mgL	87686	resistivity_ohm_cm_temp_	
tds_mgL_180C		conductivity	
chloride_mgL	53920	conductivity_temp_F	
sodium_mgL		carbonate_mgL	
calcium_mgL		bicarbonate_mgL	391
iron_mgL		sulfate_mgL	749
barium_mgL		hydroxide_mgL	
magnesium_mgL		h2s_mgL	
potassium_mgL		co2_mgL	
strontium_mgL		o2_mgL	
manganese_mgL		anionremarks	
Remarks			

(Produced water data courtesy of NMT Octane NM WAIDS database.)



C-108 Item VII.5 - Produced Water Data
Solaris Water Midstream, LLC - Zeus SWD Well No.1

SOURCE ZONE

BONE SPRING

API No	3002502429	Lab ID	
Well Name	LEA UNIT	Sample ID	4916
	005	Sample No	
Location	ULSTR 12 20 S 34 E	Lat / Long	32.58504 -103.51106
	1980 S 1980 E	County	Lea
Operator (when sampled)			
	Field LEA	Unit	J
Sample Date		Analysis Date	
	Sample Source DST	Depth (if known)	
	Water Type		
ph		alkalinity_as_caco3_mgL	
ph_temp_F		hardness_as_caco3_mgL	
specificgravity		hardness_mgL	
specificgravity_temp_F		resistivity_ohm_cm	
tds_mgL	202606	resistivity_ohm_cm_temp_	
tds_mgL_180C		conductivity	
chloride_mgL	118100	conductivity_temp_F	
sodium_mgL		carbonate_mgL	
calcium_mgL		bicarbonate_mgL	5196
iron_mgL		sulfate_mgL	992
barium_mgL		hydroxide_mgL	
magnesium_mgL		h2s_mgL	
potassium_mgL		co2_mgL	
strontium_mgL		o2_mgL	
manganese_mgL		anionremarks	
Remarks			

(Produced water data courtesy of NMT Octane NM WAIDS database.)



C-108 Item VII.5 - Produced Water Data
Solaris Water Midstream, LLC - Zeus SWD Well No.1

SOURCE ZONE

WOLFCAMP

API No 3001520138		Lab ID	
Well Name MAHUN STATE 001		Sample ID 5688	
		Sample No	
Location ULSTR 16 22 S 22 E	Lat / Long 32.39340	-104.70979	
1800 N 1980 W	County Eddy		
Operator (when sampled)			
Field	ROCKY ARROYO	Unit F	
Sample Date	5/17/1968	Analysis Date	
Sample Source	DST	Depth (if known)	
Water Typ			
ph	8.6	alkalinity_as_caco3_mgL	
ph_temp_F		hardness_as_caco3_mgL	
specificgravity		hardness_mgL	
specificgravity_temp_F		resistivity_ohm_cm	
tds_mgL	35495	resistivity_ohm_cm_temp_	
tds_mgL_180C		conductivity	
chloride_mgL	19000	conductivity_temp_F	
sodium_mgL		carbonate_mgL	
calcium_mgL		bicarbonate_mgL	830
iron_mgL		sulfate_mgL	2500
barium_mgL		hydroxide_mgL	
magnesium_mgL		h2s_mgL	
potassium_mgL		co2_mgL	
strontium_mgL		o2_mgL	
manganese_mgL		anionremarks	
Remarks			

(Produced water data courtesy of NMT Octane NM WAIDS database.)



C-108 Item VII.5 - Produced Water Data
Solaris Water Midstream, LLC - Zeus SWD Well No.1

SOURCE ZONE

MORROW

API No	3002520756	Lab ID	
Well Name	CUSTER MOUNTAIN UNIT 001	Sample ID	2434
		Sample No	
Location	ULSTR 09 24 S 35 E	Lat / Long	32.22999 -103.37431
	1980 S 1980 W	County	Lea
Operator (when sampled)			
	Field CINTA ROJA	Unit	K
Sample Date		Analysis Date	
	Sample Source DST	Depth (if known)	
	Water Type		
ph		alkalinity_as_caco3_mgL	
ph_temp_F		hardness_as_caco3_mgL	
specificgravity		hardness_mgL	
specificgravity_temp_F		resistivity_ohm_cm	
tds_mgL	282741	resistivity_ohm_cm_temp_	
tds_mgL_180C		conductivity	
chloride_mgL	176800	conductivity_temp_F	
sodium_mgL		carbonate_mgL	
calcium_mgL		bicarbonate_mgL	161
iron_mgL		sulfate_mgL	650
barium_mgL		hydroxide_mgL	
magnesium_mgL		h2s_mgL	
potassium_mgL		co2_mgL	
strontium_mgL		o2_mgL	
manganese_mgL		anionremarks	
Remarks			

(Produced water data courtesy of NMT Octane NM WAIDS database.)



C-108 Item VII.5 - Produced Water Data
Solaris Water Midstream, LLC - Zeus SWD Well No.1

DISPOSAL ZONE

DEVONIAN

API No.	3002508483	Lab ID	
Well Name	BELL LAKE UNIT	Sample ID	5733
	006	Sample No	
Location	ULSTR 06 23 S 34 E	Lat / Long	32.32821 -103.50663
	660 S 1980 E	County	Lea
Operator (when sampled)			
	Field BELL LAKE NORTH	Unit	O
Sample Date		Analysis Date	
	Sample Source HEATER/TREATER	Depth (if known)	
	Water Type		
ph	7	alkalinity_as_caco3_mgL	
ph_temp_F		hardness_as_caco3_mgL	
specificgravity		hardness_mgL	
specificgravity_temp_F		resistivity_ohm_cm	
tds_mgL	71078	resistivity_ohm_cm_temp_	
tds_mgL_180C		conductivity	
chloride_mgL	42200	conductivity_temp_F	
sodium_mgL		carbonate_mgL	
calcium_mgL		bicarbonate_mgL	500
iron_mgL		sulfate_mgL	1000
barium_mgL		hydroxide_mgL	
magnesium_mgL		h2s_mgL	
potassium_mgL		co2_mgL	
strontium_mgL		o2_mgL	
manganese_mgL		anionremarks	
Remarks			

(Produced water data courtesy of NMT Octane NM WAIDS database.)



C-108 Item VII.5 - Produced Water Data
Solaris Water Midstream, LLC - Zeus SWD No.1

DISPOSAL ZONE

DEVONIAN

		Lab ID	
API No.	3002521082	Sample ID	5720
Well Name	ANTELOPE RIDGE UNIT 003	Sample No	
Location	ULSTR 34 23 S 34 E	Lat / Long	32.25922 -103.46068
	1980 S 1650 W	County	Lea
Operator (when sampled)			
	Field ANTELOPE RIDGE	Unit	K
Sample Date	11/14/1967	Analysis Date	
	Sample Source UNKNOWN	Depth (if known)	
	Water Type		
ph	6.9	alkalinity_as_caco3_mgL	
ph_temp_F		hardness_as_caco3_mgL	
specificgravity		hardness_mgL	
specificgravity_temp_F		resistivity_ohm_cm	
tds_mgL	80187	resistivity_ohm_cm_temp_	
tds_mgL_180C		conductivity	
chloride_mgL	47900	conductivity_temp_F	
sodium_mgL		carbonate_mgL	
calcium_mgL		bicarbonate_mgL	476
iron_mgL		sulfate_mgL	900
barium_mgL		hydroxide_mgL	
magnesium_mgL		h2s_mgL	
potassium_mgL		co2_mgL	
strontium_mgL		o2_mgL	
manganese_mgL		anionremarks	
Remarks			

(Produced water data courtesy of NMT Octane NM WAIDS database.)



C-108 – Item VIII

Geologic Information

The Devonian and Silurian (including Fusselman) consist of carbonates including light colored dolomite and chert intervals interspersed with some tight limestone intervals. Several thick sections of porous dolomite capable of taking water are present within the subject formations in the area. Depth control data was inferred from deep wells in the vicinity. If the base of Devonian and top of Silurian and/or Ordovician rocks come in as expected the well will only be drilled deep enough for adequate logging rathole.

At a proposed depth of 17,250' BGL (Below Ground Level) the well will TD approximately 1,350 feet below the estimated top of the Devonian. Mud logging through the interval will ensure the target interval remains in Devonian and Silurian. Once Devonian is determined, the casing shoe depth will be set at an approximate maximum upper depth of 15,900' BGL. Injection will occur through the resulting openhole interval. If the base of Silurian and top of Ordovician rocks come in as expected the well will only be drilled deep enough for adequate logging rathole; estimated total depth approximately 17,250'.

The Devonian is overlain by the Woodford Shale and lower Silurian (Fusselman) rock is underlain by the Ordovician; Simpson, McKee and Ellenburger.

Fresh water in the area is limited but may be generally available from the Santa Rosa or Dewey Lake formations. State Engineer's records show water wells in the area with an average depth to groundwater of 350 feet south of this location and even deeper to the north. There are no water wells located within one mile of the proposed SWD.

C-108 ITEM XI – WATER WELLS IN AOR

NO WATER WELLS WITHIN ONE MILE OF PROPOSED SWD WELL.



New Mexico Office of the State Engineer **Active & Inactive Points of Diversion** (with Ownership Information)

No PODs found.

PLSS Search:

Section(s): 35, 36 Township: 21S Range: 32E

No PODs found.

PLSS Search:

Section(s): 1, 2 Township: 22S Range: 32E

The data is furnished by the NMOSE/ISC and is accepted by the recipient with the expressed understanding that the OSE/ISC make no warranties, expressed or implied, concerning the accuracy, completeness, reliability, usability, or suitability for any particular purpose of the data.

11/1/17 7:53 AM

Page 1 of 1

ACTIVE & INACTIVE POINTS OF DIVERSION

C-108 ITEM XI – WATER WELLS IN AOR

Depth to Ground Water



New Mexico Office of the State Engineer Water Column/Average Depth to Water

(A CLW##### in the
POD suffix indicates the
POD has been replaced
& no longer serves a
water right file.)

(R=POD has
been replaced.
O=orphaned.

C=the file is (quarters are 1=NW 2=NE 3=SW 4=SE)
closed) (quarters are smallest to largest)

(NAD83 UTM in meters)

(In feet)

POD Number	POD Sub-Code	basin	County	64	16	4	Sec	Tws	Rng	X	Y	Depth Well	Depth Water	Water Column
C 02096		ED		2	3	14	22S	32E		627204	3584464*	435	360	75
C 02821	C	LE		2	2	3	14	22S	32E	627303	3584563*	540	340	200
C 02939	C	LE		3	3	1	19	22S	32E	620234	3583042*	280		
C 03717 POD1	C	LE		4	4	1	09	22S	32E	624094	3586365	650		
C 04144 POD1	CUB	LE		3	1	3	07	22S	32E	620128	3585772			
C 04144 POD2	CUB	LE		1	3	3	07	22S	32E	620136	3585733			
C 04144 POD3	CUB	LE		3	1	3	07	22S	32E	620240	3585842			
C 04144 POD4	CUB	LE		3	1	3	07	22S	32E	620200	3585808			

Average Depth to Water: **350 feet**

Minimum Depth: **340 feet**

Maximum Depth: **360 feet**

Record Count: 8

PLSS Search:

Township: 22S Range: 32E

*UTM location was derived from PLSS - see Help

The data is furnished by the NMOSE/ISC and is accepted by the recipient with the expressed understanding that the OSE/ISC make no warranties, expressed or implied, concerning the accuracy, completeness, reliability, usability, or suitability for any particular purpose of the data.

C-108 ITEM XII – GEOLOGIC AFFIRMATION

We have examined available geologic and engineering data and have found no evidence of open faults or other hydrologic connection between the disposal interval and any underground sources of drinking water.

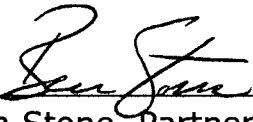
A handwritten signature in black ink, appearing to read "Ben Stone", is positioned above a horizontal line.

Ben Stone, Partner
SOS Consulting, LLC

Project: Solaris Water Midstream, LLC
Zeus SWD No.1
Reviewed 10/30/2017

C-108 ITEM XIII – PROOF OF NOTIFICATION

IDENTIFICATION AND NOTIFICATION OF INTERESTED PARTIES

Exhibits for Section

Leasehold Plat

List of Interested Parties

Notification Letter to Interested Parties

Proof of Certified Mailing

Published Legal Notice

Zeus SWD Well No.1 - Leasehold Plat

(Attachment to NMOCD Form C-108, Application for Authority to Inject.)

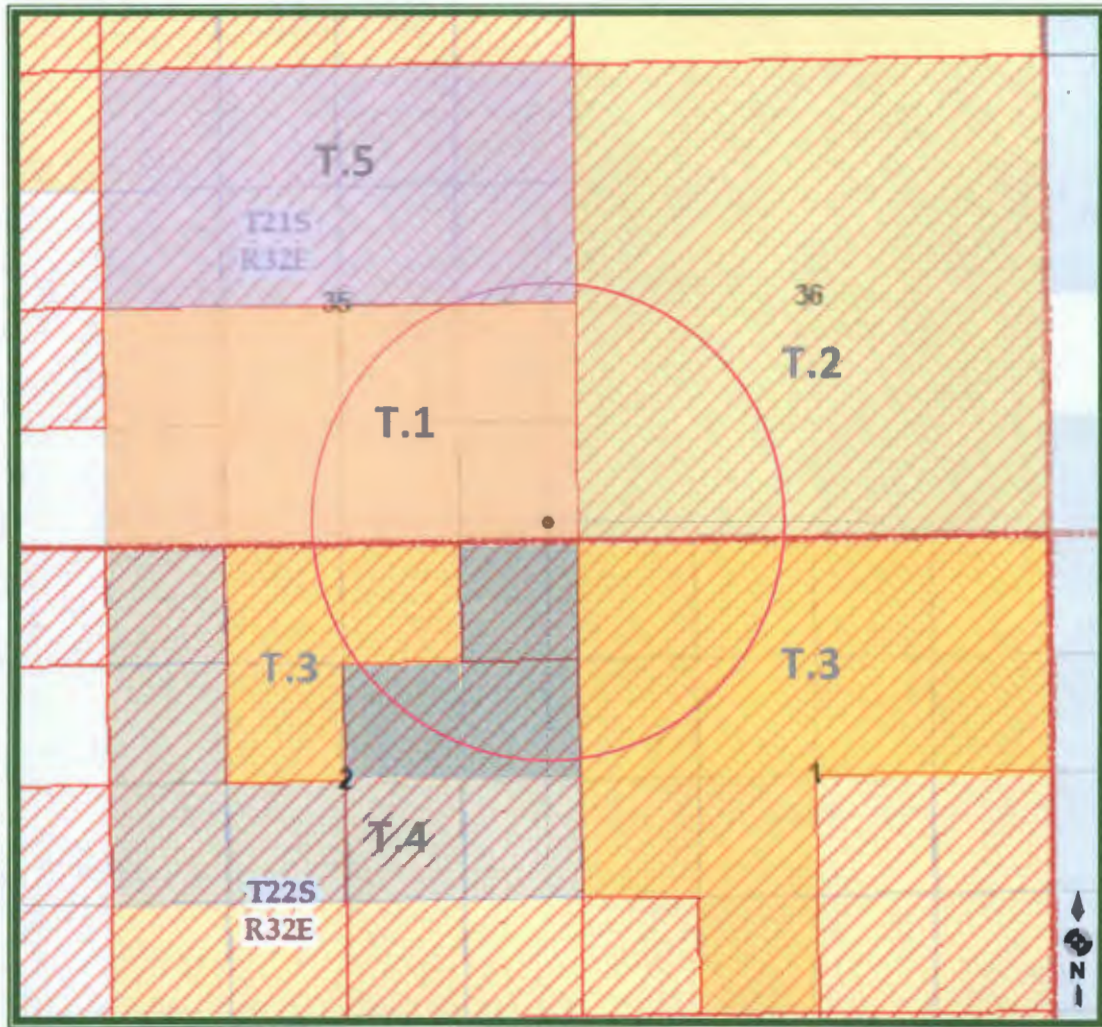

LEGEND

- T.1 – Mills Ranch; Oxy USA, Inc.
- T.2 – NMNM-108967; The Allar Company
- T.3 – NMNM-109758; Khody Land & Minerals Co.
- T.4 – NMNM-106696 & 105891; Echo Production Co.
- T.5 – NMNM-120905; R & R Royalty Company

C-108 ITEM XIII – PROOF OF NOTIFICATION INTERESTED PARTIES LIST

SURFACE OWNER

- 1 MILLS RANCH (Notified via USPS Certified Mail)
c/o Francis Mills, Registered Agent
P.O. Box 1358
Loving, NM 88256
Certified: 7015 0640 0007 9482 9873

OFFSET MINERALS LESSEES and OPERATORS (All Notified via USPS Certified Mail)

Fee Lease - Mills Ranch (T.1 on Leasehold Plat)

Lessee

- 2 OXY USA, INC.
6001 Deauville Blvd.
Midland, TX 79706
Certified: 7015 0640 0007 9482 9866

Operator

- 3 OXY USA WTP, LIMITED PARTNERSHIP
6001 Deauville Blvd.
Midland, TX 79706
Certified: 7015 0640 0007 9482 9859

BLM Lease NMNM-108967 (T.2 on Leasehold Plat)

Lessee

- 4 THE ALLAR COMPANY
P.O. Box 1567
Graham, TX 76450
Certified: 7015 0640 0007 9482 9842

BLM Lease NMNM-109758 (T.3 on Leasehold Plat)

Lessee

- 5 KHODY LAND & MINERALS CO.
210 Park Avenue, Ste.900
Oklahoma City, OK 73102
Certified: 7015 0640 0007 9482 9835

Operator

OXY USA, INC.
6001 Deauville Blvd.
Midland, TX 79706

BLM Leases NMNM-106696 & 105891 (T.4 on Leasehold Plat)

Lessee

- 6 ECHO PRODUCTION COMPANY
P.O. Box 1210
Graham, TX 76450
Certified: 7015 0640 0007 9482 9828

C-108 ITEM XIII – PROOF OF NOTIFICATION INTERESTED PARTIES LIST (cont.)

BLM Leases NMNM-106696 & 105891 (T.4 on Leasehold Plat – cont.)

Operator

OXY USA, INC.
6001 Deauville Blvd.
Midland, TX 79706

BLM Lease NMNM-120905 (T.5 on Leasehold Plat)

Lessee

- 7 R & R ROYALTY, LTD
500 North Shoreline Blvd., Ste.322
Corpus Christi, TX 78401
Certified: 7015 0640 0007 9482 9811

OFFSET MINERALS OWNERS (All Notified via USPS Certified Mail)

- 8 U.S. DEPARTMENT OF INTERIOR
Bureau of Land Management
Oil & Gas Division
620 E. Greene St.
Carlsbad, NM 88220
Certified: 7015 0640 0007 9482 9804
- 9 INTREPID POTASH NM, LLC (*Potash lease >1 mile from proposed well.*)
707 17TH St., Ste.4200
Denver, CO 80202
Certified: 7015 0640 0007 9482 9798

REGULATORY

NEW MEXICO OIL CONSERVATION DIVISION (FedEx'ed original and copy)
1220 S. St. Francis Dr.
Santa Fe, NM 87505

NEW MEXICO OIL CONSERVATION DIVISION (FedEx'ed copy)
811 S. First St.
Artesia, NM 88210

November 6, 2017

NOTIFICATION TO INTERESTED PARTIES

(CORRECTED LOCATION SECTION - Section 19-35)

via U.S. Certified Mail – Return Receipt Requested

To Whom It May Concern:

Solaris Water Midstream, LLC, Midland, Texas, has made application to the New Mexico Oil Conservation Division to drill and complete for salt water disposal the Zeus SWD Well No.1. The proposed commercial operation will be for produced water disposal from area operators. As indicated in the notice below, the well is located in Section 35, Township 21 South, Range 32 East in Lea County, New Mexico.

The published notice states that the interval will be from 15,900 feet to 17,250 feet into the Devonian, Silurian and Fusselman formations.

Following is the *corrected* notice published in the Hobbs News-Sun, New Mexico on or about November 7, 2017. (*Republish date; original publication in error, November 1, 2017.*)

LEGAL NOTICE

Solaris Water Midstream, LLC, 701 Tradewinds Blvd., Suite C, Midland, TX 79706, is filing Form C-108 (Application for Authority to Inject) with the New Mexico Oil Conservation Division seeking administrative approval for a salt water disposal well. The proposed well, the Zeus SWD No.1, will be located 199' FSL and 335' FEL, Section 35, Township 21 South, Range 32 East, Lea County, New Mexico. Produced water from area production will be commercially disposed into the Devonian, Silurian and Fusselman formations at a depth of 15,900' to 17,250' at a maximum surface pressure of 3180 psi and a rate limited only by such pressure. The proposed SWD well is located approximately 26.0 miles southwest of Monument, NM.

This proposed well was originally permitted and authorized for SWD by a different operator. Those permits were cancelled by the operator or otherwise allowed to expire by the NMOCD. This application will essentially redo the previously authorized permits approximately 100 feet offset from the originally proposed location.

Interested parties wishing to object to the proposed application must file with the New Mexico Oil Conservation Division, 1220 St. Francis Dr., Santa Fe, NM 87505, (505)476-3460 within 15 days of the date of this notice. Additional information may be obtained from the applicant's agent, SOS Consulting, LLC, (903)488-9850 or, email info@sosconsulting.us.

You have been identified as a party who may be interested as an offset lessee or operator.

You are entitled to a full copy of the application. A full copy in PDF format is posted on the SOS Consulting **ShareFile** site and is available for immediate download.

Use the URL link: <https://sosconsulting.sharefile.com/d-se344cb3097441098>

(Please Note: The ShareFile service is powered by Citrix Systems and is completely secure.*)

The link to this file will be active for 30 days from the date of this letter. Your company can access and download the file a maximum of five (5) times. (One copy may be downloaded and shared as needed amongst your company.)

Alternatively, you may call SOS Consulting, LLC at 903-488-9850, or email info@sosconsulting.us, and the same PDF file copy will be expedited to you via email.

Please use the subject "**Zeus SWD Nov 2017 PDF Copy Request**".

Thank you for your attention in this matter.

Best regards,



Ben Stone, SOS Consulting, LLC
Agent for Solaris Water Midstream, LLC

Cc: Application File

SOS Consulting is committed to providing superior quality work using technology to assist clients and interested parties in obtaining the documentation required. SOS will continue to utilize methods for reducing papers copies and are less energy and resource intensive.

We hope you'll partner with us and appreciate these efforts.

* You will be asked for your email, name and company.

This will not be used by anyone except keeping track of the file downloads.

You will not be solicited by SOS or anyone else. Data is stored on Citrix Systems servers only.

C-108 - Item XIV

Proof of Notice (Certified Mail Receipts)

7015 0640 0007 9482 9972

U.S. Postal Service™ CERTIFIED MAIL® RECEIPT Domestic Mail Only

For delivery information, visit our website at www.usps.com®.

Certified Mail Fee
\$
Extra Services & Fees (check box, add fee as appropriate)
☐ Return Receipt (hardcopy) \$
☐ Return Receipt (electronic) \$
☐ Certified Mail Restricted Delivery \$
☐ Adult Signature Required \$
☐ Adult Signature Restricted Delivery \$

Postmark
Here

Postage
\$
Total Postage and Fees
\$6.59

Sent To
Street
City, St
PS For
MILLS RANCH
c/o Francis Mills, Registered Agent
P.O. Box 1358
Loving, NM 88256

Instructions

7015 0640 0007 9482 9965

U.S. Postal Service™ CERTIFIED MAIL® RECEIPT Domestic Mail Only

For delivery information, visit our website at www.usps.com®.

Certified Mail Fee
\$
Extra Services & Fees (check box, add fee as appropriate)
☐ Return Receipt (hardcopy) \$
☐ Return Receipt (electronic) \$
☐ Certified Mail Restricted Delivery \$
☐ Adult Signature Required \$
☐ Adult Signature Restricted Delivery \$

Postmark
Here

Postage
\$
Total Postage and Fees
\$6.59

Sent To
Street
City, St
PS For
OXY USA, INC.
6001 Deauville Blvd.
Midland, TX 79706

Instructions

7015 0640 0007 9482 9958

U.S. Postal Service™ CERTIFIED MAIL® RECEIPT Domestic Mail Only

For delivery information, visit our website at www.usps.com®.

Certified Mail Fee
\$
Extra Services & Fees (check box, add fee as appropriate)
☐ Return Receipt (hardcopy) \$
☐ Return Receipt (electronic) \$
☐ Certified Mail Restricted Delivery \$
☐ Adult Signature Required \$
☐ Adult Signature Restricted Delivery \$

Postmark
Here

Postage
\$
Total Postage and Fees
\$6.59

Sent To
Street
City, St
PS For
OXY USA WTP, LP
6001 Deauville Blvd.
Midland, TX 79706

Instructions

7015 0640 0007 9482 9941

U.S. Postal Service™ CERTIFIED MAIL® RECEIPT Domestic Mail Only

For delivery information, visit our website at www.usps.com®.

Certified Mail Fee
\$
Extra Services & Fees (check box, add fee as appropriate)
☐ Return Receipt (hardcopy) \$
☐ Return Receipt (electronic) \$
☐ Certified Mail Restricted Delivery \$
☐ Adult Signature Required \$
☐ Adult Signature Restricted Delivery \$

Postmark
Here

Postage
\$
Total Postage and Fees
\$6.59

Sent To
Street
City, St
PS For
THE ALLAR COMPANY
P.O. Box 1567
Graham, TX 76450

Instructions

C-108 - Item XIV

Proof of Notice (Certified Mail Receipts – cont.)

7015 0640 0007 9482 9934

U.S. Postal Service™
CERTIFIED MAIL® RECEIPT
 Domestic Mail Only

For delivery information, visit our website at www.usps.com®.

OFFICIAL USE

Certified Mail Fee
 \$

Extra Services & Fees (check box, add fee as appropriate)
☐ Return Receipt (hardcopy) \$
☐ Return Receipt (electronic) \$
☐ Certified Mail Restricted Delivery \$
☐ Adult Signature Required \$
☐ Adult Signature Restricted Delivery \$

Postage
 \$

Total Postage and Fees **6.59**

Sent To
 Street and
 City, State, ZIP+4®
KHODY LAND & MINERALS CO.
3500 One Williams Center
Tulsa, OK 74172

PS Form 3800, April 2007
 Domestic Mail Only

7015 0640 0007 9482 9927

U.S. Postal Service™
CERTIFIED MAIL® RECEIPT
 Domestic Mail Only

For delivery information, visit our website at www.usps.com®.

OFFICIAL USE

Certified Mail Fee
 \$

Extra Services & Fees (check box, add fee as appropriate)
☐ Return Receipt (hardcopy) \$
☐ Return Receipt (electronic) \$
☐ Certified Mail Restricted Delivery \$
☐ Adult Signature Required \$
☐ Adult Signature Restricted Delivery \$

Postage
 \$

Total Postage and Fees **6.59**

Sent To
 Street and
 City, State, ZIP+4®
ECHO PRODUCTION COMPANY
P.O. Box 1210
Graham, TX 76450

PS Form 3800, April 2007
 Domestic Mail Only

7015 0640 0007 9482 9910

U.S. Postal Service™
CERTIFIED MAIL® RECEIPT
 Domestic Mail Only

For delivery information, visit our website at www.usps.com®.

OFFICIAL USE

Certified Mail Fee
 \$

Extra Services & Fees (check box, add fee as appropriate)
☐ Return Receipt (hardcopy) \$
☐ Return Receipt (electronic) \$
☐ Certified Mail Restricted Delivery \$
☐ Adult Signature Required \$
☐ Adult Signature Restricted Delivery \$

Postage
 \$

Total Postage and Fees **6.59**

Sent To
 Street and
 City, State, ZIP+4®
R & R ROYALTY, LTD
500 North Shoreline Blvd., Ste.322
Corpus Christi, TX 78401

PS Form 3800, April 2007
 Domestic Mail Only

7015 0640 0007 9482 9903

U.S. Postal Service™
CERTIFIED MAIL® RECEIPT
 Domestic Mail Only

For delivery information, visit our website at www.usps.com®.

OFFICIAL USE

Certified Mail Fee
 \$

Extra Services & Fees (check box, add fee as appropriate)
☐ Return Receipt (hardcopy) \$
☐ Return Receipt (electronic) \$
☐ Certified Mail Restricted Delivery \$
☐ Adult Signature Required \$
☐ Adult Signature Restricted Delivery \$

Postage
 \$

Total Postage and Fees **6.59**

Sent To
 Street and
 City, State, ZIP+4®
Bureau of Land Management
Oil & Gas Division
620 E. Greene St.
Carlsbad, NM 88220

PS Form 3800, April 2007
 Domestic Mail Only

7015 0640 0007 9482 9897

U.S. Postal Service™
CERTIFIED MAIL® RECEIPT
 Domestic Mail Only

For delivery information, visit our website at www.usps.com®.

OFFICIAL USE

Certified Mail Fee
 \$

Extra Services & Fees (check box, add fee as appropriate)
☐ Return Receipt (hardcopy) \$
☐ Return Receipt (electronic) \$
☐ Certified Mail Restricted Delivery \$
☐ Adult Signature Required \$
☐ Adult Signature Restricted Delivery \$

Postage
 \$

Total Postage and Fees **6.59**

Sent To
 Street and
 City, State, ZIP+4®
INTREPID POTASH NM, LLC
707 17TH St., Ste.4200
Denver, CO 80202

PS Form 3800, April 2007
 Domestic Mail Only

C-108 - Item XIV

Proof of Notice – Legal Notice Newspaper of General Circulation

LEGAL NOTICE November 7, 2017

Solaris Water Midstream, LLC, 701 Tradewinds Blvd., Suite C, Midland, TX 79706, is filing Form C-108 (Application for Authority to Inject) with the New Mexico Oil Conservation Division seeking administrative approval for a salt water disposal well. The proposed well, the Zeus SWD No.1, will be located 199' FSL and 335' FEL, Section 35, Township 21 South, Range 32 East, Lea County, New Mexico. Produced water from area production will be commercially disposed into the Devonian, Silurian and Fusselman formations at a depth of 15,900' to 17,250' at a maximum surface pressure of 3180 psi and a rate limited only by such pressure. The proposed SWD well is located approximately 26.0 miles southwest of Monument, NM.

This proposed well was originally permitted and authorized for SWD by a different operator. Those permits were cancelled by the operator or otherwise allowed to expire by the NMOCD. This application will essentially redo the previously authorized permits approximately 100 feet offset from the originally proposed location.

Interested parties wishing to object to the proposed application must file with the New Mexico Oil Conservation Division, 1220 St. Francis Dr., Santa Fe, NM 87505, (505)476-3460 within 15 days of the date of this notice. Additional information may be obtained from the applicant's agent, SOS Consulting, LLC, (903)488-9850 or, email info@sosconsulting.us.

The above is the "Proof Copy" sent to the Hobbs News-Sun.
The affidavit of publication will be forwarded as soon as it is received.

McMillan, Michael, EMNRD

From: ben@sosconsulting.us
Sent: Saturday, November 11, 2017 2:08 PM
To: McMillan, Michael, EMNRD
Subject: Affidavit - CORRECTED LOCATION - Solaris Zeus SWD...
Attachments: Affidavit_Corrected_Zeus_Solaris_20171110001.pdf

Mike,

Here's the corrected location Affidavit for the Zeus SWD.

Hard copy via U.S. Mail.

Thanks,
Ben



Visit us on the web at www.sosconsulting.us!

This electronic message and all attachments are confidential, and are intended only for the use of the individual to whom it is addressed; information may also be legally privileged. This transmission is sent in trust for the sole purpose of delivery to the intended recipient. If you have received this transmission in error, you are hereby notified that any use, dissemination, distribution or reproduction of this transmission is strictly prohibited and may be unlawful. If you are not the intended recipient, you must delete this message and any copy of it (in any form) without disclosing it. If this message has been sent to you in error, please notify the sender by replying to this transmission, or by calling SOS Consulting, LLC. 903-488-9850. Unless expressly stated in this e-mail, nothing in this message should be construed as a digital or electronic signature. Thank you for your cooperation.

Affidavit of Publication

STATE OF NEW MEXICO
COUNTY OF LEA

I, Daniel Russell, Publisher of the Hobbs News-Sun, a newspaper published at Hobbs, New Mexico, solemnly swear that the clipping attached hereto was published in the regular and entire issue of said newspaper, and not a supplement thereof for a period of 1 issue(s).

Beginning with the issue dated
November 08, 2017
and ending with the issue dated
November 08, 2017.

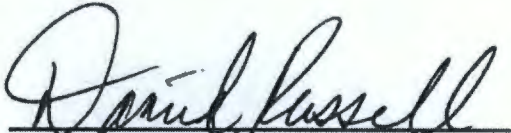
Publisher

Sworn and subscribed to before me this
8th day of November 2017.

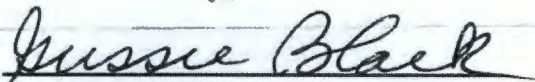
Business Manager

My commission expires
January 29, 2019

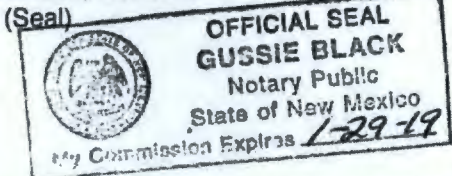

This newspaper is duly qualified to publish legal notices or advertisements within the meaning of Section 3, Chapter 167, Laws of 1937 and payment of fees for said

LEGALS

LEGAL NOTICE November 8, 2017

Solaris Water Midstream, LLC, 701 Tradewinds Blvd., Suite C, Midland, TX 79706, is filing Form C-108 (Application for Authority to Inject) with the New Mexico Oil Conservation Division seeking administrative approval for a salt water disposal well. The proposed well, the Zeus SWD No. 1, will be located 199' FSL and 335' FEL, Section 35, Township 21 South, Range 32 East, Lea County, New Mexico. Produced water from area production will be commercially disposed into the Devonian, Silurian and Fusselman formations at a depth of 15,900' to 17,250' at a maximum surface pressure of 3180 psi and a rate limited only by such pressure. The proposed SWD well is located approximately 26.0 miles southwest of Monument, NM.

This proposed well was originally permitted and authorized for SWD by a different operator. Those permits were cancelled by the operator or otherwise allowed to expire by the NMOCD. This application will essentially redo the previously authorized permits approximately 100 feet offset from the originally proposed location.

Interested parties wishing to object to the proposed application must file with the New Mexico Oil Conservation Division, 1220 St. Francis Dr., Santa Fe, NM 87505, (505) 476-3480 within 15 days of the date of this notice. Additional information may be obtained from the applicant's agent, SOS Consulting, LLC, (903) 488-9850 or, email info@sosconsulting.us. #32228

67104420

00202427

BEN STONE
SOS CONSULTING, LLC.
P.O. BOX 300
COMO, TX 75431

Affidavit of Publication

STATE OF NEW MEXICO
COUNTY OF LEA

I, Daniel Russell, Publisher of the Hobbs News-Sun, a newspaper published at Hobbs, New Mexico, solemnly swear that the clipping attached hereto was published in the regular and entire issue of said newspaper, and not a supplement thereof for a period of 1 issue(s).

Beginning with the issue dated
November 08, 2017
and ending with the issue dated
November 08, 2017.

Publisher

Sworn and subscribed to before me this
8th day of November 2017.

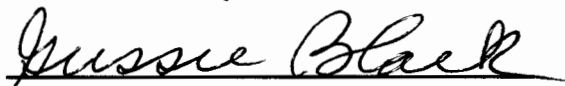
Business Manager

My commission expires

January 29, 2019

(Seal)

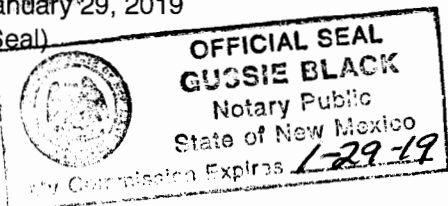

This newspaper is duly qualified to publish legal notices or advertisements within the meaning of Section 3, Chapter 167, Laws of 1937 and payment of fees for said

LEGAL S

LEGAL NOTICE November 8, 2017

Solaris Water Midstream, LLC, 701 Tradewinds Blvd., Suite C, Midland, TX 79706, is filing Form C-108 (Application for Authority to Inject) with the New Mexico Oil Conservation Division seeking administrative approval for a salt water disposal well. The proposed well, the Zeus SWD No.1, will be located 199' FSL and 335' FEL, Section 35, Township 21 South, Range 32 East, Lea County, New Mexico. Produced water from area production will be commercially disposed into the Devonian, Silurian and Fusselman formations at a depth of 15,900' to 17,250' at a maximum surface pressure of 3180 psi and a rate limited only by such pressure. The proposed SWD well is located approximately 28.0 miles southwest of Monument, NM.

This proposed well was originally permitted and authorized for SWD by a different operator. Those permits were cancelled by the operator or otherwise allowed to expire by the NMOCD. This application will essentially redo the previously authorized permits approximately 100 feet offset from the originally proposed location.

Interested parties wishing to object to the proposed application must file with the New Mexico Oil Conservation Division, 1220 St. Francis Dr., Santa Fe, NM 87505, (505)476-3460 within 15 days of the date of this notice. Additional information may be obtained from the applicant's agent, SOS Consulting, LLC, (903)488-9850 or, email info@sosconsulting.us. #32226

67104420

00202427

BEN STONE
SOS CONSULTING, LLC.
P.O. BOX 300
COMO, TX 75431

RECEIVED OCD
2017 NOV 16 P 3:38



FORM C-108 Technical Review Summary [Prepared by reviewer and included with application; V16.2]

DATE RECORD: First Rec: 11/13/2017 Admin Complete: 11/13/2017 or Suspended: _____ Add. Request/Reply: _____

ORDER TYPE: WFX / PMX / SWD Number: _____ Order Date: _____ Legacy Permits/Orders: _____

Well No. 1 Well Name(s): ZEAS SWD

API : 30-0 25-Pending Spud Date: TBP New or Old (EPA): N (UIC Class II Primacy 03/07/1982)

Footages 195 FSL
335 FEL Lot _____ or Unit _____ Sec 3B Tsp 24 Rge 32E County Lea

General Location: 3.28 miles W/Elyria Pool: SWD, Devonian Silurian Pool No.: 97869

BLM 100K Map: JA1 Operator: Golanis Water Midstream, LLC OGRID: 371643 Contact: Bew Store, Agart

COMPLIANCE RULE 5.9: Total Wells: 5 Inactive: 0 Fincl Assur: OK Compl. Order? MA IS 5.9 OK? Y Date: 11-30-2017

WELL FILE REVIEWED ☐ Current Status: Proposed

WELL DIAGRAMS: NEW: Proposed ☒ or RE-ENTER: Before Conv. ☐ After Conv. ☐ Logs in Imaging: N/A

Planned Rehab Work to Well: _____

Well Construction Details		Sizes (in)	Setting		Cement	Cement Top and
		Borehole / Pipe	Depths (ft)	Stage Tool	Sx or Cf	Determination Method
Planned ___ or Existing ___	Surface	<u>26" / 20"</u>	<u>1150</u>		<u>1700</u>	<u>Surface / Visual</u>
Planned ___ or Existing ___	Interm/Prod	<u>17 1/2" / 13 7/8"</u>	<u>4850</u>		<u>1550</u>	<u>Surface / Visual</u>
Planned ___ or Existing ___	Interm/Prod	<u>12 1/4" / 9 5/8"</u>	<u>12600</u>	<u>4800</u>	<u>2300</u>	<u>Surface / Visual</u>
Planned ___ or Existing ___	Prod/Liner	<u>7 1/2" / 8 1/2" / 21 1/4"</u>	<u>15900</u>		<u>450</u>	<u>1700 / Visual</u>
Planned ___ or Existing ___	Liner					
Planned ___ or Existing ___	OH/PERF	<u>15900 / 17250</u>		Inj Length <u>1350'</u>		

Injection Lithostratigraphic Units:		Depths (ft)	Injection or Confining Units	Tops	Completion/Operation Details:	
Adjacent Unit: Litho. Struc. Por.			<u>Wd</u>	<u>15758</u>	Drilled TD <u>17250</u>	PBTD _____
Confining Unit: Litho. Struc. Por.			<u>DV</u>	<u>15900</u>	NEW TD _____	NEW PBTD _____
Proposed Inj Interval TOP:					NEW Open Hole <input checked="" type="radio"/> or NEW Perfs <input type="radio"/>	
Proposed Inj Interval BOTTOM:					Tubing Size <u>8</u> in. Inter Coated? <u>S</u>	
Confining Unit: Litho. Struc. Por.					Proposed Packer Depth <u>15800</u> ft	
Adjacent Unit: Litho. Struc. Por.					Min. Packer Depth <u>1580</u> (100-ft limit)	
					Proposed Max. Surface Press. <u>3180</u> psi	
					Admin. Inj. Press. <u>3180</u> (0.2 psi per ft)	

AOR: Hydrologic and Geologic Information

POTASH: R-111-P MA Noticed? _____ BLM Sec Ord ☒ WIPP ☐ Noticed? _____ Salt/Salado T: 1310 B: 3570 NW: Cliff House fm _____

FRESH WATER: Aquifer Triassic Max Depth 350' HYDRO AFFIRM STATEMENT By Qualified Person ☒

NMOSE Basin: Capitan CAPITAN REEF: thru _____ adj _____ (NA) No. GW Wells in 1-Mile Radius? 0 FW Analysis? MA

Disposal Fluid: Formation Source(s) Spring Water Camp Analysis? Y On Lease ☐ Operator Only ☐ or Commercial ☒

Disposal Interval: Inject Rate (Avg/Max BWPD): 20K/30K Protectable Waters? _____ Source: _____ System: Closed or Open

HC Potential: Producing Interval? _____ Formerly Producing? _____ Method: Logs/DST/P&A/Other _____ 2-Mile Radius Pool Map ☐

AOR Wells: 1/2-M Radius Map and Well List? _____ No. Penetrating Wells: 0 [AOR Horizontals: _____ AOR SWDs: 1]

Penetrating Wells: No. Active Wells 0 Num Repairs? _____ on which well(s)? _____ Diagrams? _____

Penetrating Wells: No. P&A Wells _____ Num Repairs? _____ on which well(s)? _____ Diagrams? _____

NOTICE: Newspaper Date 11-18-2017 Mineral Owner BLM Surface Owner Mills Ranch N. Date 11-18-2017

RULE 26.7(A): Identified Tracts? Y Affected Persons: Fertigoid Oxy, Allan, RKT N. Date 11-18

Order Conditions: Issues: C-3-2 - 7500' top down to base line

Additional COAs: _____