

RECEIVED: 1/17/20	REVIEWER: DM	TYPE: PLC	APP NO: pDM2006638989
-------------------	--------------	-----------	-----------------------

ABOVE THIS TABLE FOR OCD DIVISION USE ONLY

NEW MEXICO OIL CONSERVATION DIVISION
 - Geological & Engineering Bureau -
 1220 South St. Francis Drive, Santa Fe, NM 87505



ADMINISTRATIVE APPLICATION CHECKLIST

THIS CHECKLIST IS MANDATORY FOR ALL ADMINISTRATIVE APPLICATIONS FOR EXCEPTIONS TO DIVISION RULES AND REGULATIONS WHICH REQUIRE PROCESSING AT THE DIVISION LEVEL IN SANTA FE

Applicant: _____ OGRID Number: _____
 Well Name: _____ API: _____
 Pool: _____ Pool Code: _____

SUBMIT ACCURATE AND COMPLETE INFORMATION REQUIRED TO PROCESS THE TYPE OF APPLICATION INDICATED BELOW

1) **TYPE OF APPLICATION:** Check those which apply for [A]

A. Location – Spacing Unit – Simultaneous Dedication

☐ NSL ☐ NSP (PROJECT AREA) ☐ NSP (PRORATION UNIT) ☐ SD

B. Check one only for [I] or [II]

[I] Commingling – Storage – Measurement

☐ DHC ☐ CTB ☐ PLC ☐ PC ☐ OLS ☐ OLM

[II] Injection – Disposal – Pressure Increase – Enhanced Oil Recovery

☐ WFX ☐ PMX ☐ SWD ☐ IPI ☐ EOR ☐ PPR

2) **NOTIFICATION REQUIRED TO:** Check those which apply.

- A. ☐ Offset operators or lease holders
 B. ☐ Royalty, overriding royalty owners, revenue owners
 C. ☐ Application requires published notice
 D. ☐ Notification and/or concurrent approval by SLO
 E. ☐ Notification and/or concurrent approval by BLM
 F. ☐ Surface owner
 G. ☐ For all of the above, proof of notification or publication is attached, and/or,
 H. ☐ No notice required

FOR OCD ONLY

- ☐ Notice Complete
☐ Application Content Complete

- 3) **CERTIFICATION:** I hereby certify that the information submitted with this application for administrative approval is **accurate** and **complete** to the best of my knowledge. I also understand that **no action** will be taken on this application until the required information and notifications are submitted to the Division.

Note: Statement must be completed by an individual with managerial and/or supervisory capacity.

 Print or Type Name

 Date

 Phone Number

 Signature

 e-mail Address

Submit 1 Copy To Appropriate District Office
District I – (575) 393-6161
1625 N. French Dr., Hobbs, NM 88240
District II – (575) 748-1283
811 S. First St., Artesia, NM 88210
District III – (505) 334-6178
1000 Rio Brazos Rd., Aztec, NM 87410
District IV – (505) 476-3460
1220 S. St. Francis Dr., Santa Fe, NM 87505

State of New Mexico
Energy, Minerals and Natural Resources

Form C-103
Revised July 18, 2013

OIL CONSERVATION DIVISION
1220 South St. Francis Dr.
Santa Fe, NM 87505

WELL API NO. 30-015-44249
5. Indicate Type of Lease STATE <input checked="" type="checkbox"/> FEE <input type="checkbox"/>
6. State Oil & Gas Lease No.
7. Lease Name or Unit Agreement Name Remuda South 25 State
8. Well Number 105H
9. OGRID Number 005380
10. Pool name or Wildcat Purple Sage; Wolfcamp

4. Well Location Unit Letter <u>G</u> : <u>2279</u> feet from the <u>North</u> line and <u>2055</u> feet from the <u>East</u> line Section <u>25</u> Township <u>23S</u> Range <u>29E</u> NMPM County <u>Eddy, NM</u>	
11. Elevation (Show whether DR, RKB, RT, GR, etc.) 3061'	

SUNDRY NOTICES AND REPORTS ON WELLS
(DO NOT USE THIS FORM FOR PROPOSALS TO DRILL OR TO DEEPEN OR PLUG BACK TO A DIFFERENT RESERVOIR. USE "APPLICATION FOR PERMIT" (FORM C-101) FOR SUCH PROPOSALS.)

1. Type of Well: Oil Well ☒ Gas Well ☐ Other

2. Name of Operator

XTO Energy, Inc

3. Address of Operator

6401 Holiday Hill Rd. Bldg 5, Midland, TX 79707

12. Check Appropriate Box to Indicate Nature of Notice, Report or Other Data

NOTICE OF INTENTION TO:

PERFORM REMEDIAL WORK ☐ PLUG AND ABANDON ☐
TEMPORARILY ABANDON ☐ CHANGE PLANS ☐
PULL OR ALTER CASING ☐ MULTIPLE COMPL ☐
DOWNHOLE COMMINGLE ☐
CLOSED-LOOP SYSTEM ☐
OTHER: Surface Commingle ☒

SUBSEQUENT REPORT OF:

REMEDIAL WORK ☐ ALTERING CASING ☐
COMMENCE DRILLING OPNS. ☐ P AND A ☐
CASING/CEMENT JOB ☐
OTHER: ☐

13. Describe proposed or completed operations. (Clearly state all pertinent details, and give pertinent dates, including estimated date of starting any proposed work). SEE RULE 19.15.7.14 NMAC. For Multiple Completions: Attach wellbore diagram of proposed completion or recompletion.

XTO Operating, Inc. submits this sundry notice to add the following wells to commingle order PLC-572 for the Remuda 100 tank battery.

Remuda South 25 State 105H / 30-015-44249
Remuda South 25 State 125H / 30-015-44356
Remudua South 25 State 126H / 30-015-44392
Remuda South 25 State 166H / 30-015-44391

Interest owners of wells to be added are being furnished a copy of this request concurrent with this filing per 19.15.12.10C(4) (g) and the requirements of the order. Attached are C-102s of wells to be added, lease map of all wells and notice list.

Spud Date:

Rig Release Date:

I hereby certify that the information above is true and complete to the best of my knowledge and belief.

SIGNATURE



TITLE Regulatory Coordinator

DATE

01/17/19

Type or print name Tracie J. Cherry

E-mail address: tracie_cherry@xtoenergy.cor

PHONE: 432-221-7379

For State Use Only

APPROVED BY:

TITLE

DATE

Conditions of Approval (if any):

RECEIVED

District I
1625 N. French Dr., Hobbs, NM 88240
Phone: (575) 393-6161 Fax: (575) 393-0720

District II
811 S. First St., Artesia, NM 88210
Phone: (575) 748-1283 Fax: (575) 748-9720

District III
1000 Rio Brazos Road, Aztec, NM 87410
Phone: (505) 334-6178 Fax: (505) 334-6170

District IV
1220 S. St. Francis Dr., Santa Fe, NM 87505
Phone: (505) 476-3460 Fax: (505) 476-3462

State of New Mexico
Energy, Minerals & Natural Resources Department

JUN 18 2019

Form C-102

Revised August 1, 2011

OIL CONSERVATION DIVISION

Submit one copy to appropriate

DISTRICT II-ARTESIA O.C.D.

District Office

1220 South St. Francis Dr.

Santa Fe, NM 87505

☒ AMENDED REPORT

WELL LOCATION AND ACREAGE DEDICATION PLAT

¹ API Number 30-015-44249	² Pool Code 98220	³ Pool Name PURPLE SAGE; WOLFCAMP
⁴ Property Code 317788	⁵ Property Name REMUDA SOUTH 25 STATE	⁶ Well Number 105H
⁷ OGRID No. 005380	⁸ Operator Name XTO ENERGY, INC.	⁹ Elevation 3,061'

¹⁰ Surface Location

UL or lot no.	Section	Township	Range	Lot Idn	Feet from the	North/South line	Feet from the	East/West line	County
G	25	23 S	29 E		2,279	NORTH	2,055	EAST	EDDY

¹¹ Bottom Hole Location If Different From Surface

UL or lot no.	Section	Township	Range	Lot Idn	Feet from the	North/South line	Feet from the	East/West line	County
O	36	23 S	29 E		200	SOUTH	2,145	EAST	EDDY

¹² Dedicated Acres	¹³ Joint or Infill	¹⁴ Consolidation Code	¹⁵ Order No.
480			

No allowable will be assigned to this completion until all interests have been consolidated or a non-standard unit has been approved by the division.

	GEODETIC COORDINATES NAD 27 NME SURFACE LOCATION Y= 464,640.4 X= 622,880.4 LAT.= 32.276787°N LONG.= 103.935741°W FIRST TAKE POINT NAD 27 NME Y= 463,929.4 X= 622,782.7 LAT.= 32.274834°N LONG.= 103.936033°W	GEODETIC COORDINATES NAD 83 NME SURFACE LOCATION Y= 464,699.8 X= 664,063.3 LAT.= 32.276910°N LONG.= 103.936232°W FIRST TAKE POINT NAD 83 NME Y= 463,988.8 X= 663,975.7 LAT.= 32.274956°N LONG.= 103.936524°W	¹⁷ OPERATOR CERTIFICATION I hereby certify that the information contained herein is true and complete to the best of my knowledge and belief, and that this organization either owns a working interest or unleased mineral interest in the land including the proposed bottom hole location or has a right to drill this well at this location pursuant to a contract with an owner of such a mineral or working interest, or to a voluntary pooling agreement or a compulsory pooling order heretofore entered by the division. Kelly Kardos 6.17.19 Signature Date Kelly Kardos Printed Name kelly_kardos@xtoenergy.com E-mail Address
	CORNER COORDINATES TABLE NAD 27 NME A - Y= 464,259.7 N, X= 622,286.2 E B - Y= 464,258.9 N, X= 623,667.2 E C - Y= 461,808.0 N, X= 622,291.1 E D - Y= 461,809.3 N, X= 623,619.4 E E - Y= 459,948.6 N, X= 622,304.5 E F - Y= 459,948.5 N, X= 623,632.7 E G - Y= 456,287.9 N, X= 622,317.8 E H - Y= 456,290.8 N, X= 623,644.7 E	CORNER COORDINATES TABLE NAD 83 NME A - Y= 464,319.1 N, X= 663,469.2 E B - Y= 464,318.3 N, X= 664,850.2 E C - Y= 461,867.3 N, X= 663,474.1 E D - Y= 461,868.6 N, X= 664,802.5 E E - Y= 459,005.9 N, X= 663,487.6 E F - Y= 459,007.8 N, X= 664,815.8 E G - Y= 456,347.1 N, X= 663,501.0 E H - Y= 456,350.0 N, X= 664,827.9 E	¹⁸ SURVEYOR CERTIFICATION I hereby certify that the well location shown on this plat was plotted from field notes of actual surveys made by me or under my supervision, and that the same is true and correct to the best of my belief. 05-17-2019 Date of Survey Signature and Seal of Professional Surveyor:
	LAST TAKE POINT NAD 27 NME Y= 456,619.0 X= 622,825.2 LAT.= 32.254738°N LONG.= 103.936015°W BOTTOM HOLE LOCATION NAD 27 NME Y= 456,489.0 X= 622,825.8 LAT.= 32.254380°N LONG.= 103.936015°W	LAST TAKE POINT NAD 83 NME Y= 456,678.2 X= 664,008.4 LAT.= 32.254861°N LONG.= 103.936505°W BOTTOM HOLE LOCATION NAD 83 NME Y= 456,548.2 X= 664,009.0 LAT.= 32.254503°N LONG.= 103.936505°W	MARK DILLON HARP NEW MEXICO 23786 PROFESSIONAL SURVEYOR MARK DILLON HARP 23786 Certificate Number AW 2019010050
	SEC. 25 GRID AZ.=187°01'17" HORIZ. DIST.=716.33' SEC. 30 SEC. 31 T23S R30E SEC. 36 T23S R29E GRID AZ.=179°44'38" HORIZ. DIST.=7,440.64' SEC. 6 T24S R30E		

District I
1625 N. French Dr., Hobbs, NM 88240
Phone: (575) 393-6161 Fax: (575) 393-0720

District II
811 S. First St., Artesia, NM 88210
Phone: (505) 748-1283 Fax: (505) 748-9720

District III
1000 Rio Brazos Road, Aztec, NM 87410
Phone: (505) 334-6178 Fax: (505) 334-6170

District IV
1220 S. St. Francis Dr., Santa Fe, NM 87505
Phone: (505) 476-3460 Fax: (505) 476-3462

State of New Mexico
Energy, Minerals & Natural Resources Department
OIL CONSERVATION DIVISION
1220 South St. Francis Dr. DISTRICT II-ARTESIA O.C.D.
Santa Fe, NM 87505

Form C-102
Revised August 1, 2011
Submit one copy to appropriate District Office
☐ AMENDED REPORT

WELL LOCATION AND ACREAGE DEDICATION PLAT

¹ API Number 30-015-44356	² Pool Code 98220	³ Pool Name PURPLE SAGE; WOLFCAMP
⁴ Property Code	⁵ Property Name REMUDA SOUTH 25 STATE	⁶ Well Number 125H
⁷ OGRID No. 005380	⁸ Operator Name XTO ENERGY, INC.	⁹ Elevation 3,061'

¹⁰ Surface Location

UL or lot no.	Section	Township	Range	Lot Idn	Feet from the	North/South line	Feet from the	East/West line	County
G	25	23 S	29 E		2,279	NORTH	2,025	EAST	EDDY

¹¹ Bottom Hole Location If Different From Surface

UL or lot no.	Section	Township	Range	Lot Idn	Feet from the	North/South line	Feet from the	East/West line	County
O	36	23 S	29 E		200	SOUTH	1,980	EAST	EDDY

¹² Dedicated Acres 480	¹³ Joint or Infill	¹⁴ Consolidation Code	¹⁵ Order No.
--------------------------------------	-------------------------------	----------------------------------	-------------------------

No allowable will be assigned to this completion until all interests have been consolidated or a non-standard unit has been approved by the division.

	<p>GEODETIC COORDINATES NAD 27 NME SURFACE LOCATION Y= 464,640.4 X= 622,910.2 LAT.= 32.276787°N LONG.= 103.935644°W</p> <p>FIRST TAKE POINT NAD 27 NME Y= 463,929.3 X= 622,957.7 LAT.= 32.274832°N LONG.= 103.935450°W</p> <p>CORNER COORDINATES TABLE NAD 27 NME A - Y= 464,259.7 N, X= 622,286.2 E B - Y= 464,258.9 N, X= 623,667.2 E C - Y= 461,608.0 N, X= 622,291.1 E D - Y= 461,609.3 N, X= 623,619.4 E E - Y= 458,946.6 N, X= 622,304.5 E F - Y= 458,948.5 N, X= 623,632.7 E G - Y= 456,287.9 N, X= 622,317.8 E H - Y= 456,290.8 N, X= 623,644.7 E</p> <p>CORNER COORDINATES TABLE NAD 83 NME A - Y= 464,319.1 N, X= 663,469.2 E B - Y= 464,318.3 N, X= 664,850.2 E C - Y= 461,667.3 N, X= 663,474.1 E D - Y= 461,668.6 N, X= 664,802.5 E E - Y= 459,005.9 N, X= 663,487.6 E F - Y= 459,007.8 N, X= 664,815.8 E G - Y= 456,347.1 N, X= 663,501.0 E H - Y= 456,350.0 N, X= 664,827.9 E</p> <p>LAST TAKE POINT NAD 27 NME Y= 456,619.4 X= 622,990.2 LAT.= 32.254737°N LONG.= 103.935482°W</p> <p>BOTTOM HOLE LOCATION NAD 27 NME Y= 456,489.4 X= 622,990.8 LAT.= 32.254380°N LONG.= 103.935481°W</p>	<p>GEODETIC COORDINATES NAD 83 NME SURFACE LOCATION Y= 464,699.8 X= 664,093.1 LAT.= 32.276909°N LONG.= 103.936135°W</p> <p>FIRST TAKE POINT NAD 83 NME Y= 463,988.7 X= 664,140.7 LAT.= 32.274954°N LONG.= 103.935990°W</p> <p>CORNER COORDINATES TABLE NAD 83 NME A - Y= 464,319.1 N, X= 663,469.2 E B - Y= 464,318.3 N, X= 664,850.2 E C - Y= 461,667.3 N, X= 663,474.1 E D - Y= 461,668.6 N, X= 664,802.5 E E - Y= 459,005.9 N, X= 663,487.6 E F - Y= 459,007.8 N, X= 664,815.8 E G - Y= 456,347.1 N, X= 663,501.0 E H - Y= 456,350.0 N, X= 664,827.9 E</p> <p>LAST TAKE POINT NAD 83 NME Y= 456,678.6 X= 664,173.4 LAT.= 32.254860°N LONG.= 103.935971°W</p> <p>BOTTOM HOLE LOCATION NAD 83 NME Y= 456,548.6 X= 664,174.0 LAT.= 32.254502°N LONG.= 103.935971°W</p>	<p>¹⁷ OPERATOR CERTIFICATION I hereby certify that the information contained herein is true and complete to the best of my knowledge and belief, and that this organization either owns a working interest or unleased mineral interest in the land including the proposed bottom hole location or has a right to drill this well at this location pursuant to a contract with an owner of such a mineral or working interest, or to a voluntary pooling agreement or a compulsory pooling order heretofore entered by the division.</p> <p>Kelly Kardos 6-15-19 Signature Date Kelly Kardos Printed Name kelly_kardos@xtoenergy.com E-mail Address</p>
	<p>¹⁸ SURVEYOR CERTIFICATION I hereby certify that the well location shown on this plat was plotted from field notes of actual surveys made by me or under my supervision, and that the same is true and correct to the best of my belief.</p> <p>05-17-2019 Date of Survey Signature and Seal of Professional Surveyor: MARK DILLON HARP 23786 Certificate Number AW 2019010051</p>		

RECEIVED

District I
1625 N. French Dr., Hobbs, NM 88240
Phone: (575) 393-6161 Fax: (575) 393-0720

District II
811 S. First St., Artesia, NM 88210
Phone: (575) 748-1283 Fax: (575) 748-9720

District III
1000 Rio Brazos Road, Aztec, NM 87410
Phone: (505) 334-6178 Fax: (505) 334-6170

District IV
1220 S. St. Francis Dr., Santa Fe, NM 87505
Phone: (505) 476-3460 Fax: (505) 476-3462

State of New Mexico
Energy, Minerals & Natural Resources Department
OIL CONSERVATION DIVISION
1220 South St. Francis Dr.
Santa Fe, NM 87505

Form C-102
Revised August 1, 2011
Submit one copy to appropriate
District Office
☒ AMENDED REPORT

WELL LOCATION AND ACREAGE DEDICATION PLAT

¹ API Number 30-015- 44392	² Pool Code 98220	³ Pool Name PURPLE SAGE; WOLFCAMP
⁴ Property Code	⁵ Property Name REMUDA SOUTH 25 STATE	⁶ Well Number 126H
⁷ OGRID No. 005380	⁸ Operator Name XTO ENERGY, INC.	⁹ Elevation 3,061'

¹⁰ Surface Location

UL or lot no.	Section	Township	Range	Lot Idn	Feet from the	North/South line	Feet from the	East/West line	County
G	25	23 S	29 E		2,280	NORTH	1,965	EAST	EDDY

¹¹ Bottom Hole Location If Different From Surface

UL or lot no.	Section	Township	Range	Lot Idn	Feet from the	North/South line	Feet from the	East/West line	County
P	36	23 S	29 E		200	SOUTH	1,290	EAST	EDDY

¹² Dedicated Acres	¹³ Joint or Infill	¹⁴ Consolidation Code	¹⁵ Order No.
480			

No allowable will be assigned to this completion until all interests have been consolidated or a non-standard unit has been approved by the division.

	GEODETIC COORDINATES NAD 27 NME SURFACE LOCATION Y= 464,640.3 X= 622,970.2 LAT.= 32.276786°N LONG.= 103.935450°W FIRST TAKE POINT NAD 27 NME Y= 463,929.0 X= 623,647.7 LAT.= 32.274824°N LONG.= 103.933266°W	GEODETIC COORDINATES NAD 83 NME SURFACE LOCATION Y= 464,699.7 X= 664,153.2 LAT.= 32.276909°N LONG.= 103.935841°W FIRST TAKE POINT NAD 83 NME Y= 463,988.4 X= 664,830.7 LAT.= 32.274946°N LONG.= 103.933757°W	¹⁷ OPERATOR CERTIFICATION I hereby certify that the information contained herein is true and complete to the best of my knowledge and belief, and that this organization either owns a working interest or unleased mineral interest in the land including the proposed bottom hole location or has a right to drill this well as this location pursuant to a contract with an owner of such a mineral or working interest, or to a voluntary pooling agreement or a compulsory pooling order heretofore entered by the division. Kelly Kardos Signature Date 6.17.19 Kelly Kardos Printed Name kelly_kardos@xtoenergy.com E-mail Address
	CORNER COORDINATES TABLE NAD 27 NME A - Y= 464,258.3 N, X= 624,936.3 E B - Y= 464,258.9 N, X= 623,667.2 E C - Y= 461,610.6 N, X= 624,947.7 E D - Y= 461,609.3 N, X= 623,619.4 E E - Y= 458,950.4 N, X= 624,961.0 E F - Y= 458,948.5 N, X= 623,632.7 E G - Y= 456,293.7 N, X= 624,971.6 E H - Y= 456,290.8 N, X= 623,644.7 E	CORNER COORDINATES TABLE NAD 83 NME A - Y= 464,317.7 N, X= 666,119.3 E B - Y= 464,318.3 N, X= 664,850.2 E C - Y= 461,669.9 N, X= 666,130.8 E D - Y= 461,668.6 N, X= 664,802.5 E E - Y= 459,009.7 N, X= 666,144.1 E F - Y= 459,007.8 N, X= 664,815.8 E G - Y= 456,352.9 N, X= 666,154.8 E H - Y= 456,350.0 N, X= 664,827.9 E	¹⁸ SURVEYOR CERTIFICATION I hereby certify that the well location shown on this plat was plotted from field notes of actual surveys made by me or under my supervision, and that the same is true and correct to the best of my belief. 05-17-2019 Date of Survey Signature and Seal of Professional Surveyor: MARK DILLON HARP 23786 Certificate Number AW 2019010053
	LAST TAKE POINT NAD 27 NME Y= 456,620.9 X= 623,680.2 LAT.= 32.254734°N LONG.= 103.933250°W	LAST TAKE POINT NAD 83 NME Y= 456,680.1 X= 664,863.4 LAT.= 32.254857°N LONG.= 103.933739°W	
	BOTTOM HOLE LOCATION NAD 27 NME Y= 456,490.9 X= 623,680.8 LAT.= 32.254377°N LONG.= 103.933249°W	BOTTOM HOLE LOCATION NAD 83 NME Y= 456,550.7 X= 664,864.0 LAT.= 32.254500°N LONG.= 103.933739°W	

District I
1625 N. French Dr., Hobbs, NM 88240
Phone: (575) 393-6161 Fax: (575) 393-0720
District II
811 S. First St., Artesia, NM 88210
Phone: (575) 748-1283 Fax: (575) 748-9720
District III
1000 Rio Brazos Road, Aztec, NM 87410
Phone: (505) 334-6178 Fax: (505) 334-6170
District IV
1220 S. St. Francis Dr., Santa Fe, NM 87505
Phone: (505) 476-3460 Fax: (505) 476-3462

State of New Mexico
Energy, Minerals & Natural Resources Department

RECEIVED

Form C-102

Revised August 1, 2011

OIL CONSERVATION DIVISION

Submit one copy to appropriate

1220 South St. Francis Dr.

District Office

Santa Fe, NM 87505

DISTRICT II-ARTESIA O.C.D. AMENDED REPORT

WELL LOCATION AND ACREAGE DEDICATION PLAT

¹ API Number 30-015-44391		² Pool Code 98220		³ Pool Name PURPLE SAGE; WOLFCAMP	
⁴ Property Code		⁵ Property Name REMUDA SOUTH 36 STATE			⁶ Well Number 166H
⁷ OGRID No. 005380		⁸ Operator Name XTO ENERGY, INC.			⁹ Elevation 3,061'
¹⁰ Surface Location					
UL or lot no. G	Section 25	Township 23 S	Range 29 E	Lot Idn	Feet from the 2,279
				North/South line NORTH	Feet from the 1,995
				East/West line EAST	County EDDY
¹¹ Bottom Hole Location If Different From Surface					
UL or lot no. O	Section 36	Township 23 S	Range 29 E	Lot Idn	Feet from the 200
				North/South line SOUTH	Feet from the 1,650
				East/West line EAST	County EDDY
¹² Dedicated Acres 480		¹³ Joint or Infill		¹⁴ Consolidation Code	
¹⁵ Order No.					

No allowable will be assigned to this completion until all interests have been consolidated or a non-standard unit has been approved by the division.

	GEODETIC COORDINATES NAD 27 NME SURFACE LOCATION Y= 464,640.4 X= 622,940.2 LAT.= 32.276787°N LONG.= 103.935547°W FIRST TAKE POINT NAD 27 NME Y= 463,929.1 X= 623,287.7 LAT.= 32.274828°N LONG.= 103.934431°W	GEODETIC COORDINATES NAD 83 NME SURFACE LOCATION Y= 464,699.8 X= 664,123.2 LAT.= 32.276909°N LONG.= 103.936038°W FIRST TAKE POINT NAD 83 NME Y= 463,988.5 X= 664,470.7 LAT.= 32.274951°N LONG.= 103.934922°W	¹⁷ OPERATOR CERTIFICATION I hereby certify that the information contained herein is true and complete to the best of my knowledge and belief, and that this organization either owns a working interest or unleased mineral interest in the land including the proposed bottom hole location or has a right to drill this well as this location pursuant to a contract with an owner of such a mineral or working interest, or to a voluntary pooling agreement or a compulsory pooling order heretofore entered by the division. Kelly Kardos 5-30-19 Signature Date Kelly Kardos Printed Name kelly_kardos@xtoenergy.com E-mail Address
	CORNER COORDINATES TABLE NAD 27 NME A - Y= 464,259.7 N, X= 622,286.2 E B - Y= 464,258.9 N, X= 623,667.2 E C - Y= 461,608.0 N, X= 622,291.1 E D - Y= 461,609.3 N, X= 623,619.4 E E - Y= 458,946.6 N, X= 622,304.5 E F - Y= 458,948.5 N, X= 623,632.7 E G - Y= 458,287.9 N, X= 622,317.8 E H - Y= 458,290.8 N, X= 623,644.7 E		¹⁸ SURVEYOR CERTIFICATION I hereby certify that the well location shown on this plat was plotted from field notes of actual surveys made by me or under my supervision, and that the same is true and correct to the best of my belief. 05-17-2019 Date of Survey Signature and Seal of Professional Surveyor: MARK DILLON HARP 23786 Certificate Number AW 2019010052
	CORNER COORDINATES TABLE NAD 83 NME A - Y= 464,319.1 N, X= 663,469.2 E B - Y= 464,318.3 N, X= 664,850.2 E C - Y= 461,667.3 N, X= 663,474.1 E D - Y= 461,668.6 N, X= 664,802.5 E E - Y= 459,005.9 N, X= 663,487.6 E F - Y= 459,007.8 N, X= 664,815.8 E G - Y= 458,347.1 N, X= 663,501.0 E H - Y= 458,350.0 N, X= 664,827.9 E		
	LAST TAKE POINT NAD 27 NME Y= 456,620.1 X= 623,320.2 LAT.= 32.254736°N LONG.= 103.934414°W BOTTOM HOLE LOCATION NAD 27 NME Y= 456,490.1 X= 623,320.8 LAT.= 32.254378°N LONG.= 103.934414°W		

Date: 1/17/2020

REMUDA 100 TANK BATTERY

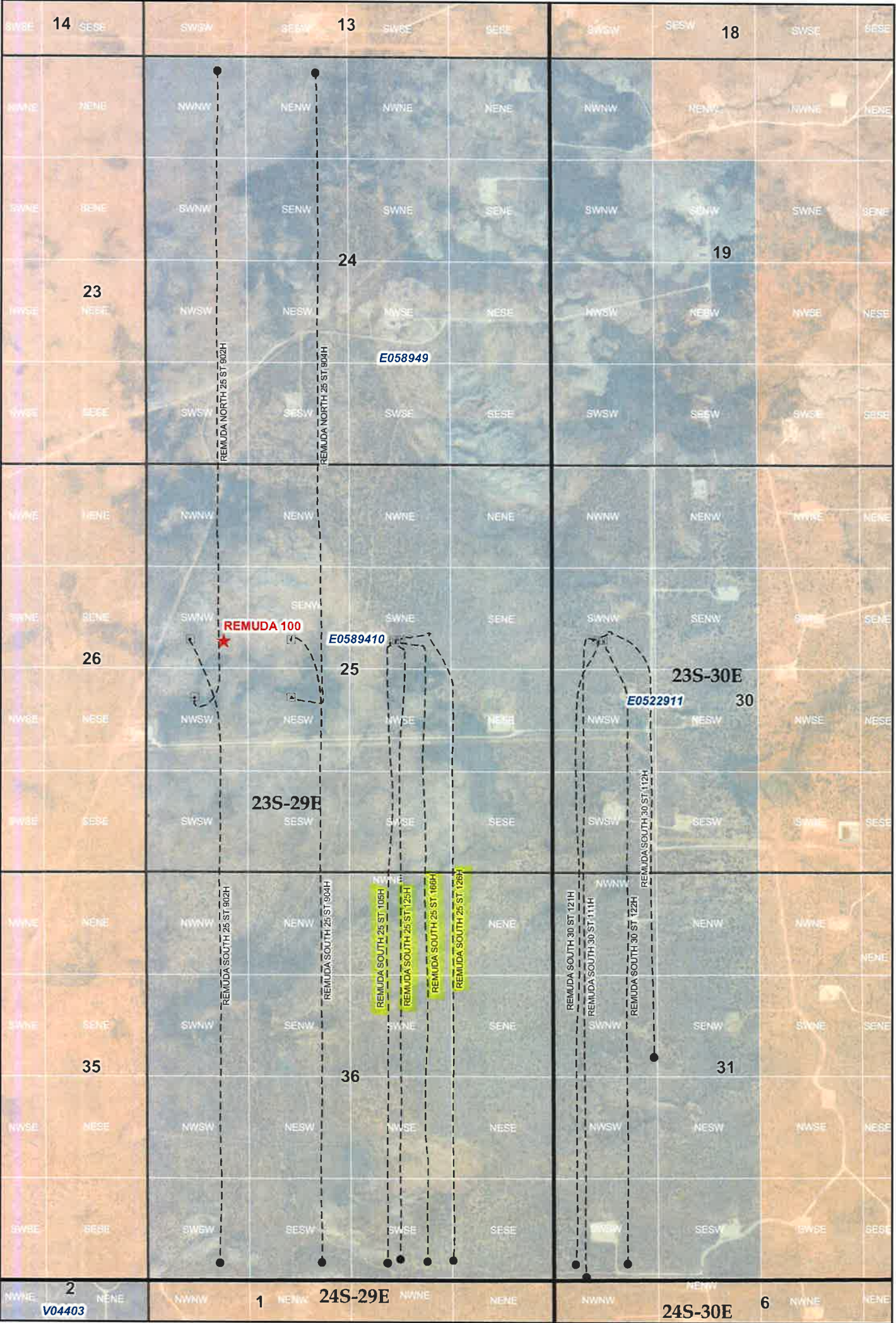

CERTIFIED MAILING LIST
XTO Energy
Remuda Basin 100 Battery

Certified #7016 2070 0000 9005 6683

Smith Exploration, LLP
1416 J Avenue
Plano, TX 75074

Certified #7016 2070 0000 2967 8269

New Mexico State Land Office
310 Old Santa Fe Trail
Santa Fe, NM 87501

Certified #7016 2070 0000 9005 6676

Chevron USA
6301 Deauville Blvd
Midland, TX 79706

Certified #7016 2070 0000 2967 8252

BK Royalties, LLC
PO Box 52098
Tulsa, OK 74152-0098

Certified #7016 2070 0000 9005 6669

Devon Energy Production Co
333 West Sheridan Ave
Oklahoma City, OK 73102-5015

Certified #7016 2070 0000 9005 6652

Penroc Oil Corporation
PO Box 2769
Hobbs, NM 88241

Certified #7016 2070 0000 9005 6645

BEPCO, LP
Hugh C. Montgomery
201 Main St, Suite Suite 3100
Ft. Worth, TX 76102

I, Tracie J Cherry, do hereby certify the interest owners for the wells in the Remuda 100 Battery were furnished, by certified mail, on the date signed below, a copy of the attached letter.

Signed:

Tracie J. Cherry

Title: Regulatory Coordinator

Date:

01/17/19



Tracie J Cherry
Regulatory Coordinator
XTO Energy Inc.
6401 Holiday Hill Road, Bldg 5
Midland, TX 79707
(432) 221-7379

Received by OCD: 1/17/2020 10:58:11 AM

January 17, 2020

Via certified mail # 7016 2070 0000 9005 6683

Smith Exploration, LLP
1416 J Avenue
Plano, TX 75074

RE: Application to Amend Lease/Pool Commingle
PLC-572
Remuda 100 Battery
Eddy County, New Mexico

Dear Interest Owner:

XTO Energy, Inc (XTO) was granted approval to commingle production at a central tank battery and allocate production using well tests for the Remuda 100 facility. A copy of the application was sent to you when application was made as you have an interest in the well(s) being commingled. A copy of the original application and approval is attached for referenced.

XTO was also granted approval to add additional wells to the facility without submitting a new application however, owners in the new wells are to be given notice. This letter and the information attached are considered notice of these additions.

If you have any questions or would like additional information, please feel free to contact me at 432-221-7379 or by email at tracie_cherry@xtoenergy.com.

Any objections or requests for a hearing must be filed with the Oil Conservation Division, 1220 South St Frances Dr., Santa Fe, New Mexico 87505 within 20 days of this letter's date.

Sincerely,
 **COPY**

Tracie J Cherry
Regulatory Coordinator

Attachments

ATTACHMENT TO CERTIFIED MAILING LIST
REMUDA 100 Battery

Ann Hyatt Bass Management Trust
Samantha Sims Bass Management Trust
BMT I BPEOR NM LLC
BMT II BPEOR NM LLC
Keystone (CTAM) BPEOR NM LLC
Keystone (RMB) BPEOR NM LLC
LMBI I BPEOR NM LLC
LMBI II BPEOR NM LLC
SRBI I BPEOR NM LLC
SRBI II BPEOR NM LLC
Thru Line O&G NN LLC

Per the letter attached, interest owners associated with the Bass family of companies, have agreed to a single notice of application sent to Mr. Hugh C. Montgomery, Director of Land rather than be notified individually

BEPCO, L.P.
201 MAIN ST
FORT WORTH, TEXAS 76102-3131
817/390-8400

October 23, 2017

EMAIL/OVERNIGHT MAIL

XTO Energy Inc.
500 West Illinois, Suite 100
Midland, Texas 79701

Attn: Tracie J. Cherry

Re: New Mexico Regulatory Notifications

Dear Tracie,

Pursuant to our recent discussions concerning notifications required under the rules and regulations of the New Mexico Oil Conservation Division, or any other regulatory body as such situations occur, this letter is to advise you that all notifications can be sent to the following address:

BEPCO, L.P.
201 Main Street, Suite 3100
Fort Worth, Texas 76102
Attn: Hugh C. Montgomery III
Director of Land

This will be the designated representative for each of the entities listed below:

32 MINERAL I BPEOR NM, LLC;
32 MINERAL II BPEOR NM, LLC;
820MT I BPEOR NM, LLC;
820MT II BPEOR NM, LLC;
ACB BPEOR NM, LLC;
ARBGT (SRB) I BPEOR NM, LLC;
ARBGT (SRB) II BPEOR NM, LLC;
ARB-LMB PC I BPEOR NM, LLC;
ARB-LMB PC II BPEOR NM, LLC;
ARB-RMB PC BPEOR NM, LLC;
ARB-SRB PC I BPEOR NM, LLC;
ARB-SRB PC II BPEOR NM, LLC;
BMT I BPEOR NM, LLC;
BMT II BPEOR NM, LLC;
CAPITAL PARTNERSHIP (RMB) BPEOR, LLC;
CAPITAL PARTNERSHIP (CTAM) BPEOR, LLC;

SRBI I BPEOR NM, LLC;
SRBI II BPEOR NM, LLC;
SRBMT I BPEOR NM, LLC;
SRBMT II BPEOR NM, LLC;
SSB 1993C I BPEOR NM, LLC;
SSB 1993C II BPEOR NM, LLC;
THRU LINE BPEOR NM, LLC;
TRB BPEOR NM, LLC;
WD I BPEOR NM, LLC;
WD II BPEOR NM, LLC;
BOPCO-LMBI I BPEOR NM, LLC;
BOPCO-LMBI II BPEOR NM, LLC;
BOPCO-SRBI I BPEOR NM, LLC;
BOPCO-SRBI II BPEOR NM, LLC;
BOPCO-KEYSTONE (RMB) BPEOR NM, LLC;
BOPCO-KEYSTONE (CTAM) BPEOR NM, LLC;

CAPITAL PARTNERSHIP II (CTAM) BPEOR NM, LLC;	BOPCO-THRU LINE BPEOR NM, LLC;
CMB BPEOR NM, LLC;	DELBASIN-SRB I BPEOR NM, LLC;
CTV-LMB I BPEOR NM, LLC;	DELBASIN-SRB II BPEOR NM, LLC;
CTV-LMB II BPEOR NM, LLC;	DELBASIN-LMB I BPEOR NM, LLC;
CTV-CTAM BPEOR NM, LLC;	DELBASIN-LMB II BPEOR NM, LLC;
CTV-SRB I BPEOR NM, LLC;	DELBASIN-RMB BPEOR NM, LLC;
CTV-SRB II BPEOR NM, LLC;	DELBASIN-EPB BPEOR NM, LLC;
EPB-PC BPEOR NM, LLC;	PRB II 1993A I BPEOR, LLC;
FINE LINE BPEOR NM, LLC;	PRB II 1993A II BPEOR, LLC;
GOLIAD- LMB I BPEOR NM, LLC;	RFB 1993A I BPEOR, LLC;
GOLIAD-LMB II BPEOR NM, LLC;	RFB 1993A II BPEOR, LLC;
GOLIAD-SRB I BPEOR NM, LLC;	SSB 1993A I BPEOR, LLC; and
GOLIAD-SRB II BPEOR NM, LLC;	SSB 1993A II BPEOR, LLC,
KEYSTONE (RMB) BPEOR NM, LLC;	all Texas limited liability companies
KEYSTONE (CTAM) BPEOR NM, LLC;	
LMBI I BPEOR NM, LLC;	
LMBI II BPEOR NM, LLC;	
MLB BPEOR NM, LLC;	
PRB II 1993C I BPEOR NM, LLC;	
PRB II 1993C II BPEOR NM, LLC;	
RFB 1993C I BPEOR NM, LLC;	
RFB 1993C II BPEOR NM, LLC;	
RMB BPEOR NM, LLC;	

In an effort to cut down on unnecessary paper, whenever there is more than one of the entities listed above involved, please send one notification which can be addressed to the affected entities as a group.

Should you have any questions concerning the above, please feel free to contact me at (817)390-8584.

Very truly yours,

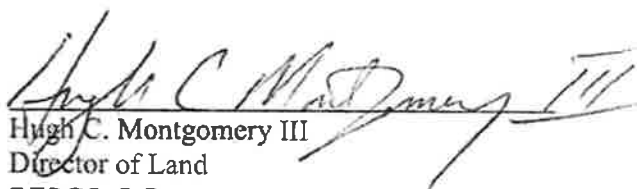
 Hugh C. Montgomery III
 Director of Land
 BEPCO, L.P.