

RECEIVED: 1/17/20	REVIEWER: DM	TYPE: PLC	APP NO: pMAM1912140977
-------------------	--------------	-----------	------------------------

ABOVE THIS TABLE FOR OCD DIVISION USE ONLY

**NEW MEXICO OIL CONSERVATION DIVISION**  
 - Geological & Engineering Bureau -  
 1220 South St. Francis Drive, Santa Fe, NM 87505



### ADMINISTRATIVE APPLICATION CHECKLIST

THIS CHECKLIST IS MANDATORY FOR ALL ADMINISTRATIVE APPLICATIONS FOR EXCEPTIONS TO DIVISION RULES AND  
 REGULATIONS WHICH REQUIRE PROCESSING AT THE DIVISION LEVEL IN SANTA FE

Applicant: \_\_\_\_\_ OGRID Number: \_\_\_\_\_  
 Well Name: \_\_\_\_\_ API: \_\_\_\_\_  
 Pool: \_\_\_\_\_ Pool Code: \_\_\_\_\_

### SUBMIT ACCURATE AND COMPLETE INFORMATION REQUIRED TO PROCESS THE TYPE OF APPLICATION INDICATED BELOW

1) **TYPE OF APPLICATION:** Check those which apply for [A]

A. Location – Spacing Unit – Simultaneous Dedication

☐ NSL      ☐ NSP (PROJECT AREA)      ☐ NSP (PRORATION UNIT)      ☐ SD

B. Check one only for [ I ] or [ II ]

[ I ] Commingling – Storage – Measurement

☐ DHC    ☐ CTB    ☐ PLC    ☐ PC    ☐ OLS    ☐ OLM

[ II ] Injection – Disposal – Pressure Increase – Enhanced Oil Recovery

☐ WFX    ☐ PMX    ☐ SWD    ☐ IPI    ☐ EOR    ☐ PPR

2) **NOTIFICATION REQUIRED TO:** Check those which apply.

- A. ☐ Offset operators or lease holders
- B. ☐ Royalty, overriding royalty owners, revenue owners
- C. ☐ Application requires published notice
- D. ☐ Notification and/or concurrent approval by SLO
- E. ☐ Notification and/or concurrent approval by BLM
- F. ☐ Surface owner
- G. ☐ For all of the above, proof of notification or publication is attached, and/or,
- H. ☐ No notice required

#### FOR OCD ONLY

- ☐ Notice Complete
- ☐ Application  
Content  
Complete

- 3) **CERTIFICATION:** I hereby certify that the information submitted with this application for administrative approval is **accurate** and **complete** to the best of my knowledge. I also understand that **no action** will be taken on this application until the required information and notifications are submitted to the Division.

**Note: Statement must be completed by an individual with managerial and/or supervisory capacity.**

\_\_\_\_\_  
 Print or Type Name

\_\_\_\_\_  
 Date

\_\_\_\_\_  
 Phone Number

\_\_\_\_\_  
 Signature

\_\_\_\_\_  
 e-mail Address

Submit 1 Copy To Appropriate District Office  
District I - (575) 393-6161  
1625 N. French Dr., Hobbs, NM 88240  
District II - (575) 748-1283  
811 S. First St., Artesia, NM 88210  
District III - (505) 334-6178  
1000 Rio Brazos Rd., Aztec, NM 87410  
District IV - (505) 476-3460  
1220 S. St. Francis Dr., Santa Fe, NM 87505

State of New Mexico  
Energy, Minerals and Natural Resources

Form C-103  
Revised July 18, 2013

OIL CONSERVATION DIVISION  
1220 South St. Francis Dr.  
Santa Fe, NM 87505

WELL API NO. 30-015-44249
5. Indicate Type of Lease STATE <input checked="" type="checkbox"/> FEE <input type="checkbox"/>
6. State Oil & Gas Lease No.
7. Lease Name or Unit Agreement Name Remuda South 25 State
8. Well Number 105H
9. OGRID Number 005380
10. Pool name or Wildcat Purple Sage; Wolfcamp

SUNDRY NOTICES AND REPORTS ON WELLS (DO NOT USE THIS FORM FOR PROPOSALS TO DRILL OR TO DEEPEN OR PLUG BACK TO A DIFFERENT RESERVOIR. USE "APPLICATION FOR PERMIT" (FORM C-101) FOR SUCH PROPOSALS.)	
1. Type of Well: Oil Well <input checked="" type="checkbox"/> Gas Well <input type="checkbox"/> Other <input type="checkbox"/>	
2. Name of Operator XTO Energy, Inc	
3. Address of Operator 6401 Holiday Hill Rd. Bldg 5, Midland, TX 79707	
4. Well Location Unit Letter <u>G</u> : <u>2279</u> feet from the <u>North</u> line and <u>2055</u> feet from the <u>East</u> line Section <u>25</u> Township <u>23S</u> Range <u>29E</u> NMPM County <u>Eddy, NM</u>	
11. Elevation (Show whether DR, RKB, RT, GR, etc.) 3061'	

12. Check Appropriate Box to Indicate Nature of Notice, Report or Other Data

NOTICE OF INTENTION TO:		SUBSEQUENT REPORT OF:	
PERFORM REMEDIAL WORK <input type="checkbox"/>	PLUG AND ABANDON <input type="checkbox"/>	REMEDIAL WORK <input type="checkbox"/>	ALTERING CASING <input type="checkbox"/>
TEMPORARILY ABANDON <input type="checkbox"/>	CHANGE PLANS <input type="checkbox"/>	COMMENCE DRILLING OPNS. <input type="checkbox"/>	P AND A <input type="checkbox"/>
PULL OR ALTER CASING <input type="checkbox"/>	MULTIPLE COMPL <input type="checkbox"/>	CASING/CEMENT JOB <input type="checkbox"/>	
DOWNHOLE COMMINGLE <input type="checkbox"/>			
CLOSED-LOOP SYSTEM <input type="checkbox"/>			
OTHER: <input type="checkbox"/>	Surface Commingle <input checked="" type="checkbox"/>	OTHER: <input type="checkbox"/>	

13. Describe proposed or completed operations. (Clearly state all pertinent details, and give pertinent dates, including estimated date of starting any proposed work). SEE RULE 19.15.7.14 NMAC. For Multiple Completions: Attach wellbore diagram of proposed completion or recompletion.

XTO Operating, Inc. submits this sundry notice to add the following wells to commingle order PLC-572 for the Remuda 100 tank battery.

Remuda South 25 State 105H / 30-015-44249  
Remuda South 25 State 125H / 30-015-44356  
Remudua South 25 State 126H / 30-015-44392  
Remuda South 25 State 166H / 30-015-44391

Interest owners of wells to be added are being furnished a copy of this request concurrent with this filing per 19.15.12.10C(4) (g) and the requirements of the order. Attached are C-102s of wells to be added, lease map of all wells and notice list.

Spud Date:

Rig Release Date:

I hereby certify that the information above is true and complete to the best of my knowledge and belief.

SIGNATURE



TITLE Regulatory Coordinator

DATE

01/17/19

Type or print name Tracie J. Cherry

E-mail address: tracie\_cherry@xtoenergy.com

PHONE: 432-221-7379

**For State Use Only**

APPROVED BY:

TITLE

DATE

Conditions of Approval (if any):

RECEIVED

**District I**  
1625 N. French Dr., Hobbs, NM 88240  
Phone: (575) 393-6161 Fax: (575) 393-0720

**District II**  
811 S. First St., Artesia, NM 88210  
Phone: (575) 748-1283 Fax: (575) 748-9720

**District III**  
1000 Rio Brazos Road, Aztec, NM 87410  
Phone: (505) 334-6178 Fax: (505) 334-6170

**District IV**  
1220 S. St. Francis Dr., Santa Fe, NM 87505  
Phone: (505) 476-3460 Fax: (505) 476-3462

State of New Mexico  
Energy, Minerals & Natural Resources Department

JUN 18 2019

Form C-102

Revised August 1, 2011

## OIL CONSERVATION DIVISION

Submit one copy to appropriate

DISTRICT II-ARTESIA O.C.D.

District Office

1220 South St. Francis Dr.

Santa Fe, NM 87505

☒ AMENDED REPORT

## WELL LOCATION AND ACREAGE DEDICATION PLAT

<sup>1</sup> API Number 30-015-44249	<sup>2</sup> Pool Code 98220	<sup>3</sup> Pool Name PURPLE SAGE; WOLFCAMP
<sup>4</sup> Property Code 317788	<sup>5</sup> Property Name REMUDA SOUTH 25 STATE	<sup>6</sup> Well Number 105H
<sup>7</sup> OGRID No. 005380	<sup>8</sup> Operator Name XTO ENERGY, INC.	<sup>9</sup> Elevation 3,061'

<sup>10</sup> Surface Location

UL or lot no.	Section	Township	Range	Lot Idn	Feet from the	North/South line	Feet from the	East/West line	County
G	25	23 S	29 E		2,279	NORTH	2,055	EAST	EDDY

<sup>11</sup> Bottom Hole Location If Different From Surface

UL or lot no.	Section	Township	Range	Lot Idn	Feet from the	North/South line	Feet from the	East/West line	County
O	36	23 S	29 E		200	SOUTH	2,145	EAST	EDDY

<sup>12</sup> Dedicated Acres	<sup>13</sup> Joint or Infill	<sup>14</sup> Consolidation Code	<sup>15</sup> Order No.
480			

No allowable will be assigned to this completion until all interests have been consolidated or a non-standard unit has been approved by the division.

	<b>16</b> GEODETIC COORDINATES NAD 27 NME SURFACE LOCATION Y= 464,640.4 X= 622,880.4 LAT.= 32.276787°N LONG.= 103.935741°W  FIRST TAKE POINT NAD 27 NME Y= 463,929.4 X= 622,782.7 LAT.= 32.274834°N LONG.= 103.936033°W  CORNER COORDINATES TABLE NAD 27 NME A - Y= 464,259.7 N, X= 622,286.2 E B - Y= 464,258.9 N, X= 623,667.2 E C - Y= 461,808.0 N, X= 622,291.1 E D - Y= 461,809.3 N, X= 623,619.4 E E - Y= 459,948.6 N, X= 622,304.5 E F - Y= 458,948.5 N, X= 623,632.7 E G - Y= 456,287.9 N, X= 622,317.8 E H - Y= 456,290.8 N, X= 623,644.7 E  CORNER COORDINATES TABLE NAD 83 NME A - Y= 464,319.1 N, X= 663,469.2 E B - Y= 464,318.3 N, X= 664,850.2 E C - Y= 461,867.3 N, X= 663,474.1 E D - Y= 461,868.6 N, X= 664,802.5 E E - Y= 459,005.9 N, X= 663,487.6 E F - Y= 459,007.8 N, X= 664,815.8 E G - Y= 456,347.1 N, X= 663,501.0 E H - Y= 456,350.0 N, X= 664,827.9 E  LAST TAKE POINT NAD 27 NME Y= 456,619.0 X= 622,825.2 LAT.= 32.254738°N LONG.= 103.936015°W  BOTTOM HOLE LOCATION NAD 27 NME Y= 456,489.0 X= 622,825.8 LAT.= 32.254380°N LONG.= 103.936015°W	<b>17 OPERATOR CERTIFICATION</b> I hereby certify that the information contained herein is true and complete to the best of my knowledge and belief, and that this organization either owns a working interest or unleased mineral interest in the land including the proposed bottom hole location or has a right to drill this well at this location pursuant to a contract with an owner of such a mineral or working interest, or to a voluntary pooling agreement or a compulsory pooling order heretofore entered by the division.  Kelly Kardos 6.17.19 Signature Date Kelly Kardos Printed Name kelly_kardos@xtoenergy.com E-mail Address
	<b>18 SURVEYOR CERTIFICATION</b> I hereby certify that the well location shown on this plat was plotted from field notes of actual surveys made by me or under my supervision, and that the same is true and correct to the best of my belief.  05-17-2019 Date of Survey Signature and Seal of Professional Surveyor:	
	MARK DILLON HARP 23786 Certificate Number	AW 2019010050
	P:\PROJECTS\2019\2019010050-XTO-REMUDA_SOUTH_25_STATE_105H-EDDY\DWG\2019010050-XTO-REMUDA_SOUTH_25_STATE_105H_C-102.dwg, 5/17/2019 9:07:50 AM, Adobe PDF	

District I  
1625 N. French Dr., Hobbs, NM 88240  
Phone: (575) 393-6161 Fax: (575) 393-0720

District II  
811 S. First St., Artesia, NM 88210  
Phone: (505) 748-1283 Fax: (505) 748-9720

District III  
1000 Rio Brazos Road, Aztec, NM 87410  
Phone: (505) 334-6178 Fax: (505) 334-6170

District IV  
1220 S. St. Francis Dr., Santa Fe, NM 87505  
Phone: (505) 476-3460 Fax: (505) 476-3462

State of New Mexico  
Energy, Minerals & Natural Resources Department  
**OIL CONSERVATION DIVISION**  
1220 South St. Francis Dr. DISTRICT II-ARTESIA O.C.D.  
Santa Fe, NM 87505

Form C-102  
Revised August 1, 2011  
Submit one copy to appropriate District Office  
☐ AMENDED REPORT

**WELL LOCATION AND ACREAGE DEDICATION PLAT**

<sup>1</sup> API Number 30-015-44356	<sup>2</sup> Pool Code 98220	<sup>3</sup> Pool Name PURPLE SAGE; WOLFCAMP
<sup>4</sup> Property Code	<sup>5</sup> Property Name REMUDA SOUTH 25 STATE	
<sup>7</sup> OGRID No. 005380	<sup>8</sup> Operator Name XTO ENERGY, INC.	<sup>6</sup> Well Number 125H
		<sup>9</sup> Elevation 3,061'

<sup>10</sup> Surface Location

UL or lot no.	Section	Township	Range	Lot Idn	Feet from the	North/South line	Feet from the	East/West line	County
G	25	23 S	29 E		2,279	NORTH	2,025	EAST	EDDY

<sup>11</sup> Bottom Hole Location If Different From Surface

UL or lot no.	Section	Township	Range	Lot Idn	Feet from the	North/South line	Feet from the	East/West line	County
O	36	23 S	29 E		200	SOUTH	1,980	EAST	EDDY

<sup>12</sup> Dedicated Acres 480	<sup>13</sup> Joint or Infill	<sup>14</sup> Consolidation Code	<sup>15</sup> Order No.
--------------------------------------	-------------------------------	----------------------------------	-------------------------

No allowable will be assigned to this completion until all interests have been consolidated or a non-standard unit has been approved by the division.

	<p><b>GEODETIC COORDINATES</b> NAD 27 NME SURFACE LOCATION Y= 464,640.4 X= 622,910.2 LAT.= 32.276787°N LONG.= 103.935644°W</p> <p><b>FIRST TAKE POINT</b> NAD 27 NME Y= 463,929.3 X= 622,957.7 LAT.= 32.274832°N LONG.= 103.935450°W</p> <p><b>CORNER COORDINATES TABLE</b> NAD 27 NME</p> <table border="1" style="width: 100%; border-collapse: collapse;"> <tr><td>A - Y= 464,259.7 N, X= 622,286.2 E</td></tr> <tr><td>B - Y= 464,258.9 N, X= 623,667.2 E</td></tr> <tr><td>C - Y= 461,608.0 N, X= 622,291.1 E</td></tr> <tr><td>D - Y= 461,609.3 N, X= 623,619.4 E</td></tr> <tr><td>E - Y= 458,946.6 N, X= 622,304.5 E</td></tr> <tr><td>F - Y= 458,948.5 N, X= 623,632.7 E</td></tr> <tr><td>G - Y= 456,287.9 N, X= 622,317.8 E</td></tr> <tr><td>H - Y= 456,290.8 N, X= 623,644.7 E</td></tr> </table> <p><b>CORNER COORDINATES TABLE</b> NAD 83 NME</p> <table border="1" style="width: 100%; border-collapse: collapse;"> <tr><td>A - Y= 464,319.1 N, X= 663,469.2 E</td></tr> <tr><td>B - Y= 464,318.3 N, X= 664,850.2 E</td></tr> <tr><td>C - Y= 461,667.3 N, X= 663,474.1 E</td></tr> <tr><td>D - Y= 461,668.6 N, X= 664,802.5 E</td></tr> <tr><td>E - Y= 459,005.9 N, X= 663,487.6 E</td></tr> <tr><td>F - Y= 459,007.8 N, X= 664,815.8 E</td></tr> <tr><td>G - Y= 456,347.1 N, X= 663,501.0 E</td></tr> <tr><td>H - Y= 456,350.0 N, X= 664,827.9 E</td></tr> </table> <p><b>LAST TAKE POINT</b> NAD 27 NME Y= 456,619.4 X= 622,990.2 LAT.= 32.254737°N LONG.= 103.935482°W</p> <p><b>BOTTOM HOLE LOCATION</b> NAD 27 NME Y= 456,489.4 X= 622,990.8 LAT.= 32.254380°N LONG.= 103.935481°W</p>	A - Y= 464,259.7 N, X= 622,286.2 E	B - Y= 464,258.9 N, X= 623,667.2 E	C - Y= 461,608.0 N, X= 622,291.1 E	D - Y= 461,609.3 N, X= 623,619.4 E	E - Y= 458,946.6 N, X= 622,304.5 E	F - Y= 458,948.5 N, X= 623,632.7 E	G - Y= 456,287.9 N, X= 622,317.8 E	H - Y= 456,290.8 N, X= 623,644.7 E	A - Y= 464,319.1 N, X= 663,469.2 E	B - Y= 464,318.3 N, X= 664,850.2 E	C - Y= 461,667.3 N, X= 663,474.1 E	D - Y= 461,668.6 N, X= 664,802.5 E	E - Y= 459,005.9 N, X= 663,487.6 E	F - Y= 459,007.8 N, X= 664,815.8 E	G - Y= 456,347.1 N, X= 663,501.0 E	H - Y= 456,350.0 N, X= 664,827.9 E	<p><b><sup>17</sup> OPERATOR CERTIFICATION</b> I hereby certify that the information contained herein is true and complete to the best of my knowledge and belief, and that this organization either owns a working interest or unleased mineral interest in the land including the proposed bottom hole location or has a right to drill this well at this location pursuant to a contract with an owner of such a mineral or working interest, or to a voluntary pooling agreement or a compulsory pooling order heretofore entered by the division.</p> <p style="text-align: right;">Signature: <u>Kelly Kardos</u> Date: <u>6-15-19</u></p> <p>Printed Name: <u>Kelly Kardos</u></p> <p>E-mail Address: <u>kelly_kardos@xtoenergy.com</u></p> <p><b><sup>18</sup> SURVEYOR CERTIFICATION</b> I hereby certify that the well location shown on this plat was plotted from field notes of actual surveys made by me or under my supervision, and that the same is true and correct to the best of my belief.</p> <p>Date of Survey: <u>05-17-2019</u></p> <p>Signature and Seal of Professional Surveyor: </p> <p>MARK DILLON HARP 23786 Certificate Number: <u>AW</u> 2019010051</p>
A - Y= 464,259.7 N, X= 622,286.2 E																		
B - Y= 464,258.9 N, X= 623,667.2 E																		
C - Y= 461,608.0 N, X= 622,291.1 E																		
D - Y= 461,609.3 N, X= 623,619.4 E																		
E - Y= 458,946.6 N, X= 622,304.5 E																		
F - Y= 458,948.5 N, X= 623,632.7 E																		
G - Y= 456,287.9 N, X= 622,317.8 E																		
H - Y= 456,290.8 N, X= 623,644.7 E																		
A - Y= 464,319.1 N, X= 663,469.2 E																		
B - Y= 464,318.3 N, X= 664,850.2 E																		
C - Y= 461,667.3 N, X= 663,474.1 E																		
D - Y= 461,668.6 N, X= 664,802.5 E																		
E - Y= 459,005.9 N, X= 663,487.6 E																		
F - Y= 459,007.8 N, X= 664,815.8 E																		
G - Y= 456,347.1 N, X= 663,501.0 E																		
H - Y= 456,350.0 N, X= 664,827.9 E																		



RECEIVED

District I  
1625 N. French Dr., Hobbs, NM 88240  
Phone: (575) 393-6161 Fax: (575) 393-0720

District II  
811 S. First St., Artesia, NM 88210  
Phone: (575) 748-1283 Fax: (575) 748-9720

District III  
1000 Rio Brazos Road, Aztec, NM 87410  
Phone: (505) 334-6178 Fax: (505) 334-6170

District IV  
1220 S. St. Francis Dr., Santa Fe, NM 87505  
Phone: (505) 476-3460 Fax: (505) 476-3462

State of New Mexico  
Energy, Minerals & Natural Resources Department  
OIL CONSERVATION DIVISION  
1220 South St. Francis Dr.  
Santa Fe, NM 87505

Form C-102  
Revised August 1, 2011  
Submit one copy to appropriate  
District Office  
☒ AMENDED REPORT

## WELL LOCATION AND ACREAGE DEDICATION PLAT

<sup>1</sup> API Number 30-015- 44392	<sup>2</sup> Pool Code 98220	<sup>3</sup> Pool Name PURPLE SAGE; WOLFCAMP
<sup>4</sup> Property Code	<sup>5</sup> Property Name REMUDA SOUTH 25 STATE	<sup>6</sup> Well Number 126H
<sup>7</sup> OGRID No. 005380	<sup>8</sup> Operator Name XTO ENERGY, INC.	<sup>9</sup> Elevation 3,061'

<sup>10</sup> Surface Location

UL or lot no.	Section	Township	Range	Lot Idn	Feet from the	North/South line	Feet from the	East/West line	County
G	25	23 S	29 E		2,280	NORTH	1,965	EAST	EDDY

<sup>11</sup> Bottom Hole Location If Different From Surface

UL or lot no.	Section	Township	Range	Lot Idn	Feet from the	North/South line	Feet from the	East/West line	County
P	36	23 S	29 E		200	SOUTH	1,290	EAST	EDDY

<sup>12</sup> Dedicated Acres	<sup>13</sup> Joint or Infill	<sup>14</sup> Consolidation Code	<sup>15</sup> Order No.
480			

No allowable will be assigned to this completion until all interests have been consolidated or a non-standard unit has been approved by the division.

	<b>GEODETIC COORDINATES</b> NAD 27 NME SURFACE LOCATION Y= 464,640.3 X= 622,970.2 LAT.= 32.276786°N LONG.= 103.935450°W  FIRST TAKE POINT NAD 27 NME Y= 463,929.0 X= 623,647.7 LAT.= 32.274824°N LONG.= 103.933266°W	<b>GEODETIC COORDINATES</b> NAD 83 NME SURFACE LOCATION Y= 464,699.7 X= 664,153.2 LAT.= 32.276909°N LONG.= 103.935841°W  FIRST TAKE POINT NAD 83 NME Y= 463,988.4 X= 664,830.7 LAT.= 32.274946°N LONG.= 103.933757°W	<b><sup>17</sup> OPERATOR CERTIFICATION</b> I hereby certify that the information contained herein is true and complete to the best of my knowledge and belief, and that this organization either owns a working interest or unleased mineral interest in the land including the proposed bottom hole location or has a right to drill this well as this location pursuant to a contract with an owner of such a mineral or working interest, or to a voluntary pooling agreement or a compulsory pooling order heretofore entered by the division.  Kelly Kardos Signature Date 6.17.19 Kelly Kardos Printed Name kelly_kardos@xtoenergy.com E-mail Address
	<b>CORNER COORDINATES TABLE</b> NAD 27 NME A - Y= 464,258.3 N, X= 624,936.3 E B - Y= 464,258.9 N, X= 623,667.2 E C - Y= 461,610.6 N, X= 624,947.7 E D - Y= 461,609.3 N, X= 623,619.4 E E - Y= 458,950.4 N, X= 624,961.0 E F - Y= 458,948.5 N, X= 623,632.7 E G - Y= 456,293.7 N, X= 624,971.6 E H - Y= 456,290.8 N, X= 623,644.7 E	<b>CORNER COORDINATES TABLE</b> NAD 83 NME A - Y= 464,317.7 N, X= 666,119.3 E B - Y= 464,318.3 N, X= 664,850.2 E C - Y= 461,669.9 N, X= 666,130.8 E D - Y= 461,668.6 N, X= 664,802.5 E E - Y= 459,009.7 N, X= 666,144.1 E F - Y= 459,007.8 N, X= 664,815.8 E G - Y= 456,352.9 N, X= 666,154.8 E H - Y= 456,350.0 N, X= 664,827.9 E	<b><sup>18</sup> SURVEYOR CERTIFICATION</b> I hereby certify that the well location shown on this plat was plotted from field notes of actual surveys made by me or under my supervision, and that the same is true and correct to the best of my belief.  05-17-2019 Date of Survey Signature and Seal of Professional Surveyor:  MARK DILLON HARP 23786 Certificate Number AW 2019010053
	<b>LAST TAKE POINT</b> NAD 27 NME Y= 456,620.9 X= 623,680.2 LAT.= 32.254734°N LONG.= 103.933250°W	<b>LAST TAKE POINT</b> NAD 83 NME Y= 456,680.1 X= 664,863.4 LAT.= 32.254857°N LONG.= 103.933739°W	
	<b>BOTTOM HOLE LOCATION</b> NAD 27 NME Y= 456,490.9 X= 623,680.8 LAT.= 32.254377°N LONG.= 103.933249°W	<b>BOTTOM HOLE LOCATION</b> NAD 83 NME Y= 456,550.7 X= 664,864.0 LAT.= 32.254500°N LONG.= 103.933739°W	

District I  
1625 N. French Dr., Hobbs, NM 88240  
Phone: (575) 393-6161 Fax: (575) 393-0720  
District II  
811 S. First St., Artesia, NM 88210  
Phone: (575) 748-1283 Fax: (575) 748-9720  
District III  
1000 Rio Brazos Road, Aztec, NM 87410  
Phone: (505) 334-6178 Fax: (505) 334-6170  
District IV  
1220 S. St. Francis Dr., Santa Fe, NM 87505  
Phone: (505) 476-3460 Fax: (505) 476-3462

State of New Mexico  
Energy, Minerals & Natural Resources Department

RECEIVED

Form C-102

Revised August 1, 2011

## OIL CONSERVATION DIVISION

Submit one copy to appropriate

1220 South St. Francis Dr.

District Office

Santa Fe, NM 87505

DISTRICT II-ARTESIA O.C.D. AMENDED REPORT

## WELL LOCATION AND ACREAGE DEDICATION PLAT

<sup>1</sup> API Number 30-015-44391		<sup>2</sup> Pool Code 98220		<sup>3</sup> Pool Name PURPLE SAGE; WOLFCAMP	
<sup>4</sup> Property Code		<sup>5</sup> Property Name REMUDA SOUTH 36 STATE			<sup>6</sup> Well Number 166H
<sup>7</sup> OGRID No. 005380		<sup>8</sup> Operator Name XTO ENERGY, INC.			<sup>9</sup> Elevation 3,061'
<sup>10</sup> Surface Location					
UL or lot no. G	Section 25	Township 23 S	Range 29 E	Lot Idn	Feet from the 2,279
				North/South line NORTH	Feet from the 1,995
				East/West line EAST	County EDDY
<sup>11</sup> Bottom Hole Location If Different From Surface					
UL or lot no. O	Section 36	Township 23 S	Range 29 E	Lot Idn	Feet from the 200
				North/South line SOUTH	Feet from the 1,650
				East/West line EAST	County EDDY
<sup>12</sup> Dedicated Acres 480		<sup>13</sup> Joint or Infill		<sup>14</sup> Consolidation Code	
<sup>15</sup> Order No.					

No allowable will be assigned to this completion until all interests have been consolidated or a non-standard unit has been approved by the division.

	<p><b>16</b></p> <p>GRID AZ = 153°57'41" HORIZ. DIST. = 791.62'</p> <p>SEC. 25</p> <p>SEC. 30</p> <p>SEC. 31 T23S R30E</p> <p>SEC. 36 T23S R29E</p> <p>GRID AZ = 179°44'38" HORIZ. DIST. = 7,439.31'</p> <p>SEC. 1 T24S R29E</p> <p>SEC. 6 T24S R30E</p>	<p><b>GEODETIC COORDINATES</b> NAD 27 NME SURFACE LOCATION Y = 464,640.4 X = 622,940.2 LAT. = 32.276787°N LONG. = 103.935547°W</p> <p>FIRST TAKE POINT NAD 27 NME Y = 463,929.1 X = 623,287.7 LAT. = 32.274828°N LONG. = 103.934431°W</p> <p><b>CORNER COORDINATES TABLE</b> NAD 27 NME</p> <table border="1"> <tr><td>A</td><td>Y = 464,259.7</td><td>N</td><td>X = 622,286.2</td><td>E</td></tr> <tr><td>B</td><td>Y = 464,258.9</td><td>N</td><td>X = 623,667.2</td><td>E</td></tr> <tr><td>C</td><td>Y = 461,608.0</td><td>N</td><td>X = 622,291.1</td><td>E</td></tr> <tr><td>D</td><td>Y = 461,609.3</td><td>N</td><td>X = 623,619.4</td><td>E</td></tr> <tr><td>E</td><td>Y = 458,946.6</td><td>N</td><td>X = 622,304.5</td><td>E</td></tr> <tr><td>F</td><td>Y = 458,948.5</td><td>N</td><td>X = 623,632.7</td><td>E</td></tr> <tr><td>G</td><td>Y = 458,287.9</td><td>N</td><td>X = 622,317.8</td><td>E</td></tr> <tr><td>H</td><td>Y = 458,290.8</td><td>N</td><td>X = 623,644.7</td><td>E</td></tr> </table> <p><b>CORNER COORDINATES TABLE</b> NAD 83 NME</p> <table border="1"> <tr><td>A</td><td>Y = 464,319.1</td><td>N</td><td>X = 663,469.2</td><td>E</td></tr> <tr><td>B</td><td>Y = 464,318.3</td><td>N</td><td>X = 664,850.2</td><td>E</td></tr> <tr><td>C</td><td>Y = 461,667.3</td><td>N</td><td>X = 663,474.1</td><td>E</td></tr> <tr><td>D</td><td>Y = 461,668.6</td><td>N</td><td>X = 664,802.5</td><td>E</td></tr> <tr><td>E</td><td>Y = 459,005.9</td><td>N</td><td>X = 663,487.6</td><td>E</td></tr> <tr><td>F</td><td>Y = 459,007.8</td><td>N</td><td>X = 664,815.8</td><td>E</td></tr> <tr><td>G</td><td>Y = 456,347.1</td><td>N</td><td>X = 663,501.0</td><td>E</td></tr> <tr><td>H</td><td>Y = 456,350.0</td><td>N</td><td>X = 664,827.9</td><td>E</td></tr> </table> <p><b>LAST TAKE POINT</b> NAD 27 NME Y = 456,620.1 X = 623,320.2 LAT. = 32.254736°N LONG. = 103.934414°W</p> <p><b>BOTTOM HOLE LOCATION</b> NAD 27 NME Y = 456,490.1 X = 623,320.8 LAT. = 32.254378°N LONG. = 103.934414°W</p>	A	Y = 464,259.7	N	X = 622,286.2	E	B	Y = 464,258.9	N	X = 623,667.2	E	C	Y = 461,608.0	N	X = 622,291.1	E	D	Y = 461,609.3	N	X = 623,619.4	E	E	Y = 458,946.6	N	X = 622,304.5	E	F	Y = 458,948.5	N	X = 623,632.7	E	G	Y = 458,287.9	N	X = 622,317.8	E	H	Y = 458,290.8	N	X = 623,644.7	E	A	Y = 464,319.1	N	X = 663,469.2	E	B	Y = 464,318.3	N	X = 664,850.2	E	C	Y = 461,667.3	N	X = 663,474.1	E	D	Y = 461,668.6	N	X = 664,802.5	E	E	Y = 459,005.9	N	X = 663,487.6	E	F	Y = 459,007.8	N	X = 664,815.8	E	G	Y = 456,347.1	N	X = 663,501.0	E	H	Y = 456,350.0	N	X = 664,827.9	E	<p><b>17 OPERATOR CERTIFICATION</b> I hereby certify that the information contained herein is true and complete to the best of my knowledge and belief, and that this organization either owns a working interest or unleased mineral interest in the land including the proposed bottom hole location or has a right to drill this well as this location pursuant to a contract with an owner of such a mineral or working interest, or to a voluntary pooling agreement or a compulsory pooling order heretofore entered by the division.</p> <p>Kelly Kardos 5-30-19 Signature Date</p> <p>Kelly Kardos Printed Name</p> <p>kelly_kardos@xtoenergy.com E-mail Address</p>
	A	Y = 464,259.7	N	X = 622,286.2	E																																																																														
B	Y = 464,258.9	N	X = 623,667.2	E																																																																															
C	Y = 461,608.0	N	X = 622,291.1	E																																																																															
D	Y = 461,609.3	N	X = 623,619.4	E																																																																															
E	Y = 458,946.6	N	X = 622,304.5	E																																																																															
F	Y = 458,948.5	N	X = 623,632.7	E																																																																															
G	Y = 458,287.9	N	X = 622,317.8	E																																																																															
H	Y = 458,290.8	N	X = 623,644.7	E																																																																															
A	Y = 464,319.1	N	X = 663,469.2	E																																																																															
B	Y = 464,318.3	N	X = 664,850.2	E																																																																															
C	Y = 461,667.3	N	X = 663,474.1	E																																																																															
D	Y = 461,668.6	N	X = 664,802.5	E																																																																															
E	Y = 459,005.9	N	X = 663,487.6	E																																																																															
F	Y = 459,007.8	N	X = 664,815.8	E																																																																															
G	Y = 456,347.1	N	X = 663,501.0	E																																																																															
H	Y = 456,350.0	N	X = 664,827.9	E																																																																															
<p><b>18 SURVEYOR CERTIFICATION</b> I hereby certify that the well location shown on this plat was plotted from field notes of actual surveys made by me or under my supervision, and that the same is true and correct to the best of my belief.</p> <p>05-17-2019 Date of Survey</p> <p>Signature and Seal of Professional Surveyor:</p> <p>MARK DILLON HARP 23786 Certificate Number</p> <p>AW 2019010052</p>																																																																																			



Date: 1/17/2020

# REMUDA 100 TANK BATTERY

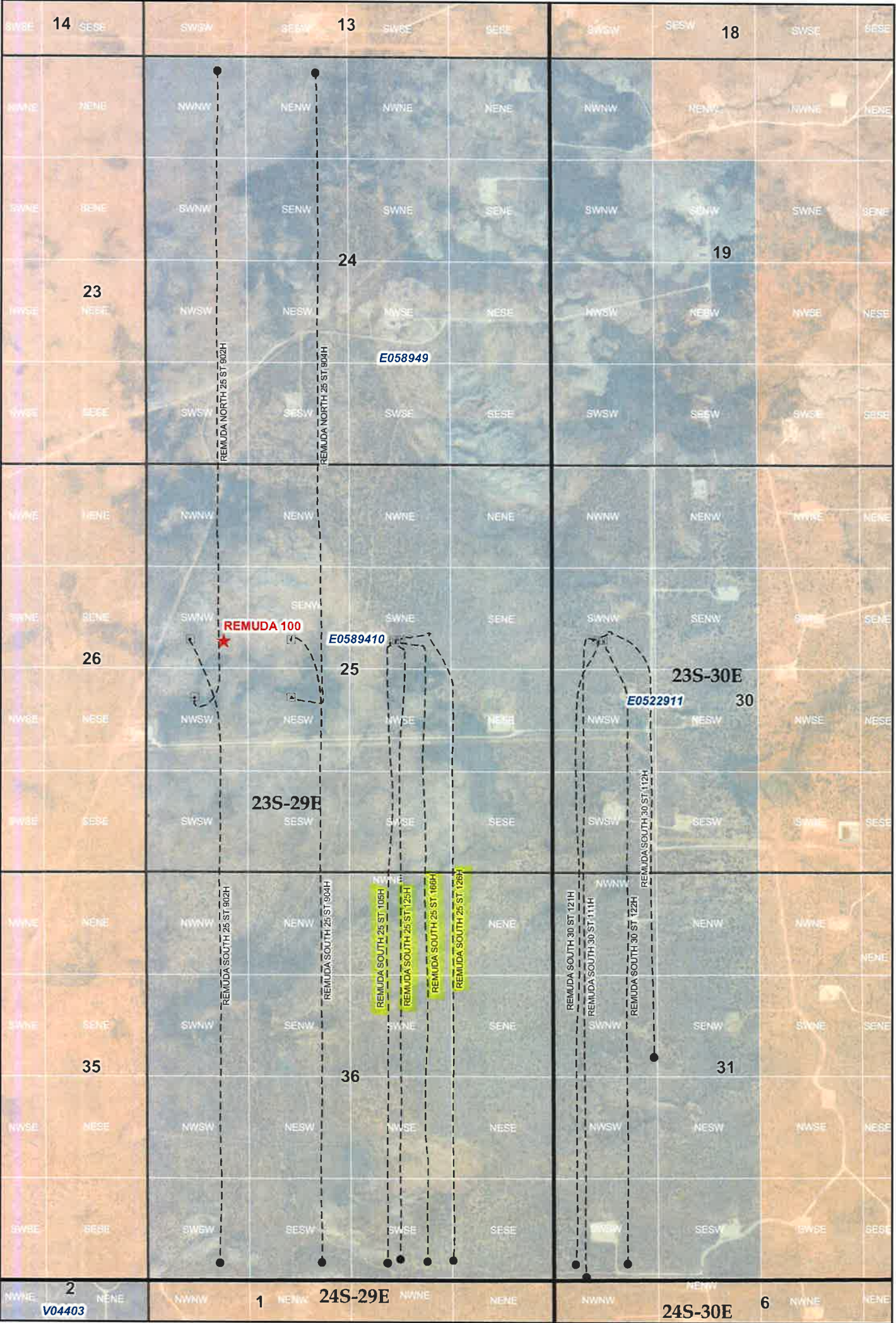

EDDY COUNTY, NEW MEXICO  
NAD 1927 STATE PLANE NEW MEXICO EAST

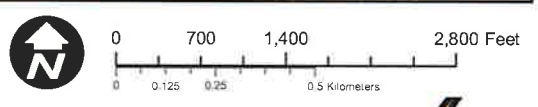

- STATE LEASE
- TOWNSHIP
- SECTION
- TANK BATTERY
- XTO SURFACE
- XTO BOTTOM
- WELLBORE



Copyright 2020 by XTO Energy, an ExxonMobil subsidiary. All rights reserved. This document is the property of XTO Energy and is not to be distributed outside of the company.

CERTIFIED MAILING LIST  
XTO Energy  
Remuda Basin 100 Battery

**Certified #7016 2070 0000 9005 6683**

Smith Exploration, LLP  
1416 J Avenue  
Plano, TX 75074

**Certified #7016 2070 0000 2967 8269**

New Mexico State Land Office  
310 Old Santa Fe Trail  
Santa Fe, NM 87501

**Certified #7016 2070 0000 9005 6676**

Chevron USA  
6301 Deauville Blvd  
Midland, TX 79706

**Certified #7016 2070 0000 2967 8252**

BK Royalties, LLC  
PO Box 52098  
Tulsa, OK 74152-0098

**Certified #7016 2070 0000 9005 6669**

Devon Energy Production Co  
333 West Sheridan Ave  
Oklahoma City, OK 73102-5015

**Certified #7016 2070 0000 9005 6652**

Penroc Oil Corporation  
PO Box 2769  
Hobbs, NM 88241

**Certified #7016 2070 0000 9005 6645**

BEPCO, LP  
Hugh C. Montgomery  
201 Main St, Suite Suite 3100  
Ft. Worth, TX 76102

I, Tracie J Cherry, do hereby certify the interest owners for the wells in the Remuda 100 Battery were furnished, by certified mail, on the date signed below, a copy of the attached letter.

Signed:

  
Tracie J. Cherry

Title: Regulatory Coordinator

Date:

01/17/19





Tracie J Cherry  
Regulatory Coordinator  
XTO Energy Inc.  
6401 Holiday Hill Road, Bldg 5  
Midland, TX 79707  
(432) 221-7379

Received by OCD: 1/17/2020 10:58:11 AM

January 17, 2020

**Via certified mail # 7016 2070 0000 9005 6683**

Smith Exploration, LLP  
1416 J Avenue  
Plano, TX 75074

RE: Application to Amend Lease/Pool Commingle  
PLC-572  
Remuda 100 Battery  
Eddy County, New Mexico

Dear Interest Owner:

XTO Energy, Inc (XTO) was granted approval to commingle production at a central tank battery and allocate production using well tests for the Remuda 100 facility. A copy of the application was sent to you when application was made as you have an interest in the well(s) being commingled. A copy of the original application and approval is attached for referenced.

XTO was also granted approval to add additional wells to the facility without submitting a new application however, owners in the new wells are to be given notice. This letter and the information attached are considered notice of these additions.

If you have any questions or would like additional information, please feel free to contact me at 432-221-7379 or by email at [tracie\\_cherry@xtoenergy.com](mailto:tracie_cherry@xtoenergy.com).

Any objections or requests for a hearing must be filed with the Oil Conservation Division, 1220 South St Frances Dr., Santa Fe, New Mexico 87505 within 20 days of this letter's date.

Sincerely,  
 **COPY**

Tracie J Cherry  
Regulatory Coordinator

Attachments

ATTACHMENT TO CERTIFIED MAILING LIST  
REMUDA 100 Battery

Ann Hyatt Bass Management Trust  
Samantha Sims Bass Management Trust  
BMT I BPEOR NM LLC  
BMT II BPEOR NM LLC  
Keystone (CTAM) BPEOR NM LLC  
Keystone (RMB) BPEOR NM LLC  
LMBI I BPEOR NM LLC  
LMBI II BPEOR NM LLC  
SRBI I BPEOR NM LLC  
SRBI II BPEOR NM LLC  
Thru Line O&G NN LLC

Per the letter attached, interest owners associated with the Bass family of companies, have agreed to a single notice of application sent to Mr. Hugh C. Montgomery, Director of Land rather than be notified individually

BEPCO, L.P.  
201 MAIN ST  
FORT WORTH, TEXAS 76102-3131  
817/390-8400

October 23, 2017

**EMAIL/OVERNIGHT MAIL**

XTO Energy Inc.  
500 West Illinois, Suite 100  
Midland, Texas 79701

Attn: Tracie J. Cherry

Re: New Mexico Regulatory Notifications

Dear Tracie,

Pursuant to our recent discussions concerning notifications required under the rules and regulations of the New Mexico Oil Conservation Division, or any other regulatory body as such situations occur, this letter is to advise you that all notifications can be sent to the following address:

BEPCO, L.P.  
201 Main Street, Suite 3100  
Fort Worth, Texas 76102  
Attn: Hugh C. Montgomery III  
Director of Land

This will be the designated representative for each of the entities listed below:

32 MINERAL I BPEOR NM, LLC;  
32 MINERAL II BPEOR NM, LLC;  
820MT I BPEOR NM, LLC;  
820MT II BPEOR NM, LLC;  
ACB BPEOR NM, LLC;  
ARBGT (SRB) I BPEOR NM, LLC;  
ARBGT (SRB) II BPEOR NM, LLC;  
ARB-LMB PC I BPEOR NM, LLC;  
ARB-LMB PC II BPEOR NM, LLC;  
ARB-RMB PC BPEOR NM, LLC;  
ARB-SRB PC I BPEOR NM, LLC;  
ARB-SRB PC II BPEOR NM, LLC;  
BMT I BPEOR NM, LLC;  
BMT II BPEOR NM, LLC;  
CAPITAL PARTNERSHIP (RMB) BPEOR, LLC;  
CAPITAL PARTNERSHIP (CTAM) BPEOR, LLC;

SRBI I BPEOR NM, LLC;  
SRBI II BPEOR NM, LLC;  
SRBMT I BPEOR NM, LLC;  
SRBMT II BPEOR NM, LLC;  
SSB 1993C I BPEOR NM, LLC;  
SSB 1993C II BPEOR NM, LLC;  
THRU LINE BPEOR NM, LLC;  
TRB BPEOR NM, LLC;  
WD I BPEOR NM, LLC;  
WD II BPEOR NM, LLC;  
BOPCO-LMBI I BPEOR NM, LLC;  
BOPCO-LMBI II BPEOR NM, LLC;  
BOPCO-SRBI I BPEOR NM, LLC;  
BOPCO-SRBI II BPEOR NM, LLC;  
BOPCO-KEYSTONE (RMB) BPEOR NM, LLC;  
BOPCO-KEYSTONE (CTAM) BPEOR NM, LLC;



CAPITAL PARTNERSHIP II (CTAM) BPEOR NM, LLC;	BOPCO-THRU LINE BPEOR NM, LLC;
CMB BPEOR NM, LLC;	DELBASIN-SRB I BPEOR NM, LLC;
CTV-LMB I BPEOR NM, LLC;	DELBASIN-SRB II BPEOR NM, LLC;
CTV-LMB II BPEOR NM, LLC;	DELBASIN-LMB I BPEOR NM, LLC;
CTV-CTAM BPEOR NM, LLC;	DELBASIN-LMB II BPEOR NM, LLC;
CTV-SRB I BPEOR NM, LLC;	DELBASIN-RMB BPEOR NM, LLC;
CTV-SRB II BPEOR NM, LLC;	DELBASIN-EPB BPEOR NM, LLC;
EPB-PC BPEOR NM, LLC;	PRB II 1993A I BPEOR, LLC;
FINE LINE BPEOR NM, LLC;	PRB II 1993A II BPEOR, LLC;
GOLIAD- LMB I BPEOR NM, LLC;	RFB 1993A I BPEOR, LLC;
GOLIAD-LMB II BPEOR NM, LLC;	RFB 1993A II BPEOR, LLC;
GOLIAD-SRB I BPEOR NM, LLC;	SSB 1993A I BPEOR, LLC; and
GOLIAD-SRB II BPEOR NM, LLC;	SSB 1993A II BPEOR, LLC,
KEYSTONE (RMB) BPEOR NM, LLC;	all Texas limited liability companies
KEYSTONE (CTAM) BPEOR NM, LLC;	
LMBI I BPEOR NM, LLC;	
LMBI II BPEOR NM, LLC;	
MLB BPEOR NM, LLC;	
PRB II 1993C I BPEOR NM, LLC;	
PRB II 1993C II BPEOR NM, LLC;	
RFB 1993C I BPEOR NM, LLC;	
RFB 1993C II BPEOR NM, LLC;	
RMB BPEOR NM, LLC;	

In an effort to cut down on unnecessary paper, whenever there is more than one of the entities listed above involved, please send one notification which can be addressed to the affected entities as a group.

Should you have any questions concerning the above, please feel free to contact me at (817)390-8584.

Very truly yours,

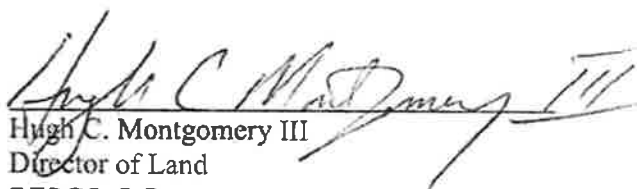
  
 Hugh C. Montgomery III  
 Director of Land  
 BEPCO, L.P.