

Revised March 23, 2017

BJ2X1-201117-C-107B OLM-224

RECEIVED: 11/17/20	REVIEWER: DM	TYPE: OLM	APP NO: pDM2032333297
--------------------	--------------	-----------	-----------------------

ABOVE THIS TABLE FOR QCD DIVISION USE ONLY

**NEW MEXICO OIL CONSERVATION DIVISION**  
- Geological & Engineering Bureau -  
1220 South St. Francis Drive, Santa Fe, NM 87505



## ADMINISTRATIVE APPLICATION CHECKLIST

THIS CHECKLIST IS MANDATORY FOR ALL ADMINISTRATIVE APPLICATIONS FOR EXCEPTIONS TO DIVISION RULES AND REGULATIONS WHICH REQUIRE PROCESSING AT THE DIVISION LEVEL IN SANTA FE

<b>Applicant:</b> <u>FAE II Operating, LLC</u>	<b>OGRID Number:</b> <u>329326</u>
<b>Well Name:</b> <u>Winningham #9</u>	<b>API:</b> <u>30-025-28637</u>
<b>Pool:</b> <u>Jalmat (Gas)</u>	<b>Pool Code:</b> <u>79240</u>

**SUBMIT ACCURATE AND COMPLETE INFORMATION REQUIRED TO PROCESS THE TYPE OF APPLICATION INDICATED BELOW**

- 1) **TYPE OF APPLICATION:** Check those which apply for [A]  
 A. Location – Spacing Unit – Simultaneous Dedication  
☐ NSL ☐ NSP (PROJECT AREA) ☐ NSP (PRORATION UNIT) ☐ SD  
 B. Check one only for [ I ] or [ II ]  
 [ I ] Commingling – Storage – Measurement  
☐ DHC ☐ CTB ☐ PLC ☐ PC ☒ OLS ☒ OLM  
 [ II ] Injection – Disposal – Pressure Increase – Enhanced Oil Recovery  
☐ WFX ☐ PMX ☐ SWD ☐ IPI ☐ EOR ☐ PPR

- 2) **NOTIFICATION REQUIRED TO:** Check those which apply.
- A. ☐ Offset operators or lease holders
- B. ☒ Royalty, overriding royalty owners, revenue owners
- C. ☐ Application requires published notice
- D. ☐ Notification and/or concurrent approval by SLO
- E. ☐ Notification and/or concurrent approval by BLM
- F. ☐ Surface owner
- G. ☐ For all of the above, proof of notification or publication is attached, and/or,
- H. ☐ No notice required
- ☐ Notice  
☐ Application  
Content  
Comments

**FOR OCD ONLY**

☐ Notice Complete

☐ Application  
Content  
Complete

- 3) **CERTIFICATION:** I hereby certify that the information submitted with this application for administrative approval is **accurate** and **complete** to the best of my knowledge. I also understand that **no action** will be taken on this application until the required information and notifications are submitted to the Division.

Note: Statement must be completed by an individual with managerial and/or supervisory capacity.

David Schellstede

Print or Type Name

Date \_\_\_\_\_

Phone Number

Signature

David@FAEnergyus.com

e-mail Address

District I  
1625 N. French Drive, Hobbs, NM 88240  
District II  
811 S. First St., Artesia, NM 88210  
District III  
1000 Rio Brazos Road, Aztec, NM 87410  
District IV  
1220 S. St Francis Dr, Santa Fe, NM  
87505

State of New Mexico  
Energy, Minerals and Natural Resources Department

Form C-107-B  
Revised August 1, 2011

### OIL CONSERVATION DIVISION

1220 S. St Francis Drive  
Santa Fe, New Mexico 87505

Submit the original  
application to the Santa Fe  
office with one copy to the  
appropriate District Office.

#### APPLICATION FOR SURFACE COMMINGLING (DIVERSE OWNERSHIP)

OPERATOR NAME: FAE II Operating, LLC

OPERATOR ADDRESS: 11757 Katy Fwy, Ste. 1000, Houston, TX 77079

APPLICATION TYPE:

☐ Pool Commingling ☐ Lease Commingling ☐ Pool and Lease Commingling ☒ Off-Lease Storage and Measurement (Only if not Surface Commingled)

LEASE TYPE: ☒ Fee ☐ State ☐ Federal

Is this an Amendment to existing Order? ☐ Yes ☒ No If "Yes", please include the appropriate Order No. \_\_\_\_\_

Have the Bureau of Land Management (BLM) and State Land office (SLO) been notified in writing of the proposed commingling

☐ Yes ☒ No

#### (A) POOL COMMINGLING

Please attach sheets with the following information

(1) Pool Names and Codes	Gravities / BTU of Non-Commingled Production	Calculated Gravities / BTU of Commingled Production		Calculated Value of Commingled Production	Volumes

(2) Are any wells producing at top allowables? ☐ Yes ☐ No

(3) Has all interest owners been notified by certified mail of the proposed commingling? ☐ Yes ☐ No.

(4) Measurement type: ☐ Metering ☐ Other (Specify)

(5) Will commingling decrease the value of production? ☐ Yes ☐ No If "yes", describe why commingling should be approved

#### (B) LEASE COMMINGLING

Please attach sheets with the following information

(1) Pool Name and Code.

(2) Is all production from same source of supply? ☐ Yes ☐ No

(3) Has all interest owners been notified by certified mail of the proposed commingling? ☐ Yes ☐ No

(4) Measurement type: ☐ Metering ☐ Other (Specify)

#### (C) POOL and LEASE COMMINGLING

Please attach sheets with the following information

(1) Complete Sections A and E.

#### (D) OFF-LEASE STORAGE and MEASUREMENT

Please attached sheets with the following information

(1) Is all production from same source of supply? ☒ Yes ☐ No

(2) Include proof of notice to all interest owners.

#### (E) ADDITIONAL INFORMATION (for all application types)

Please attach sheets with the following information

(1) A schematic diagram of facility, including legal location.

(2) A plat with lease boundaries showing all well and facility locations. Include lease numbers if Federal or State lands are involved.

(3) Lease Names, Lease and Well Numbers, and API Numbers.

I hereby certify that the information above is true and complete to the best of my knowledge and belief.

SIGNATURE: M Bates TITLE: Engineering Tech DATE: 11/17/2020  
TYPE OR PRINT NAME Marshall Bates TELEPHONE NO.: (832) 241-8080  
E-MAIL ADDRESS: Marshall@FAEnergyus.com

# faeIIoperating

November 17, 2020

**VIA ONLINE FILING**

Mr. Dean McClure  
New Mexico Energy, Minerals and Natural Resources Department  
1220 South St. Francis Drive  
Santa Fe, New Mexico 87505

**Re: Application of FAE II Operating, LLC for Administrative Approval to Store, Meter, and Sell Oil Production from the Jalmat Gas Pool for the Winningham #9 Well at the Sholes B 30 #3 Tank Battery located in Sec. 30, T-25S, R-37E, Lea County, New Mexico**

Dear Mr. McClure:

FAE II Operating LLC, OGRID: 329326, requests administrative approval for surface commingling, off-lease metering, off-lease storage, and off-lease marketing of oil and gas production from the Jalmat Gas Pool for its Winningham #9 well located in Section 30 of Township 25S, Range 37E as shown on the map in Exhibit A. The two separate leases are also identified by outline and legend. Exhibit B offers further detail on the relevant leases and wells.

The attached battery diagrams, Exhibits C and D, are accurate schematics of the current facility and the proposed commingled facility, respectively. A new 3-phase flowline will be laid from the Winningham #9 well to the Sholes B 30 #3 Tank Battery and tie in to its own 3-phase separator. From there, the water and oil flow lines will tie into their own tanks for off-lease metering and storage on the Sholes B 30 #3. The gas flow line, however, will run back to the Winningham #9 well and tie in on the suction side of the compressor. For oil measurement, an individual allocation meter will be utilized for measurement of oil production stemming from the separator. Gas measurement will be taken by the ETC sales meter on the Winningham #9 location.

All relevant parties, in this case just the working interest partners, have been notified of this application by certified mail. Copies of the certified mail receipts are attached as Exhibit F.

This proposed commingling of production is in the interest of conservation and will not result in reduced royalty or improper measurement of production. If there are further questions concerning this application, please feel free to contact the undersigned by email at [marshall@faenergyus.com](mailto:marshall@faenergyus.com) or by telephone at (832) 241-8080.

Very truly yours,



FAE II Operating, LLC



# faeIIoperating

Exhibit A – Lease Boundaries Map

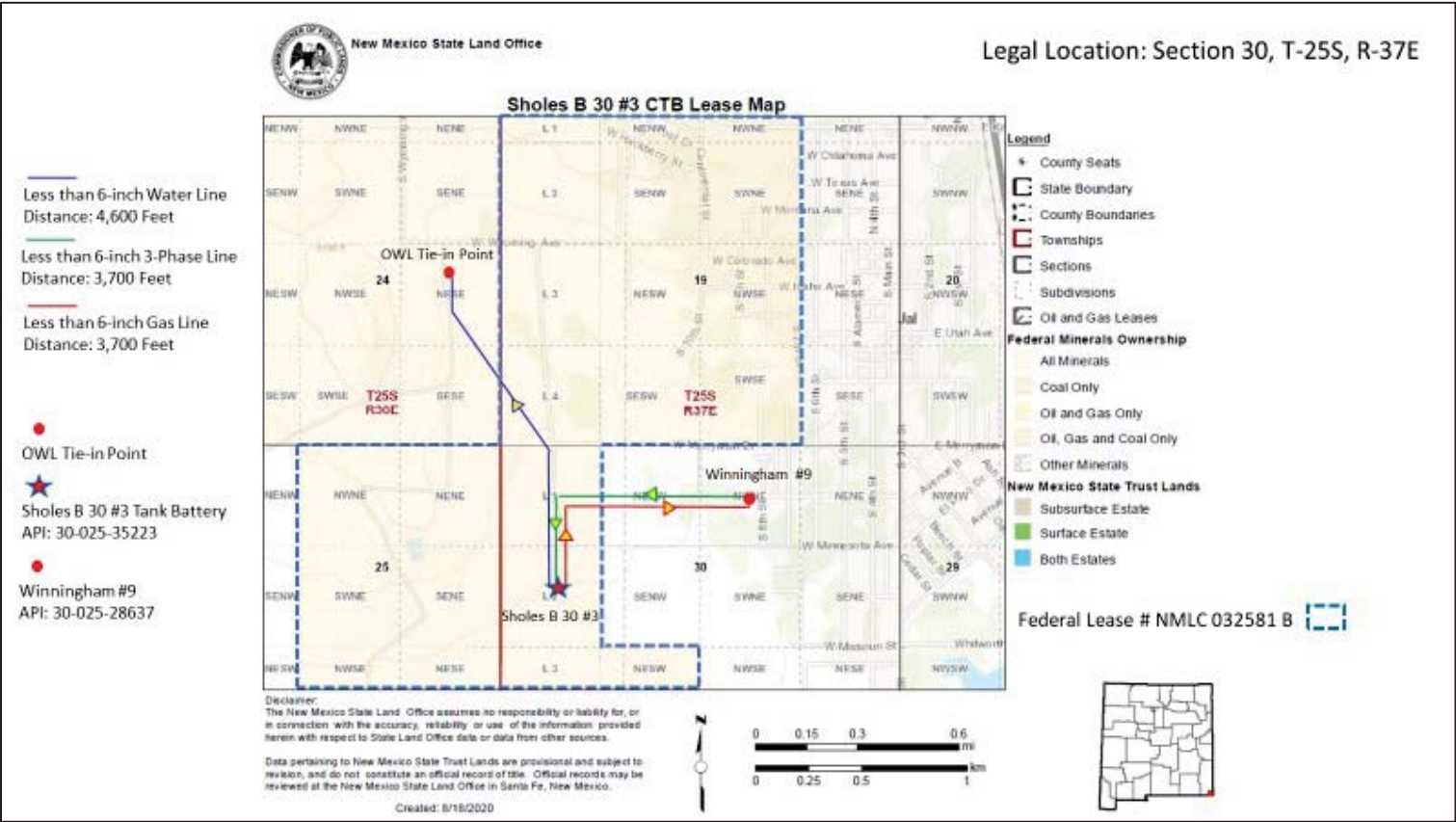
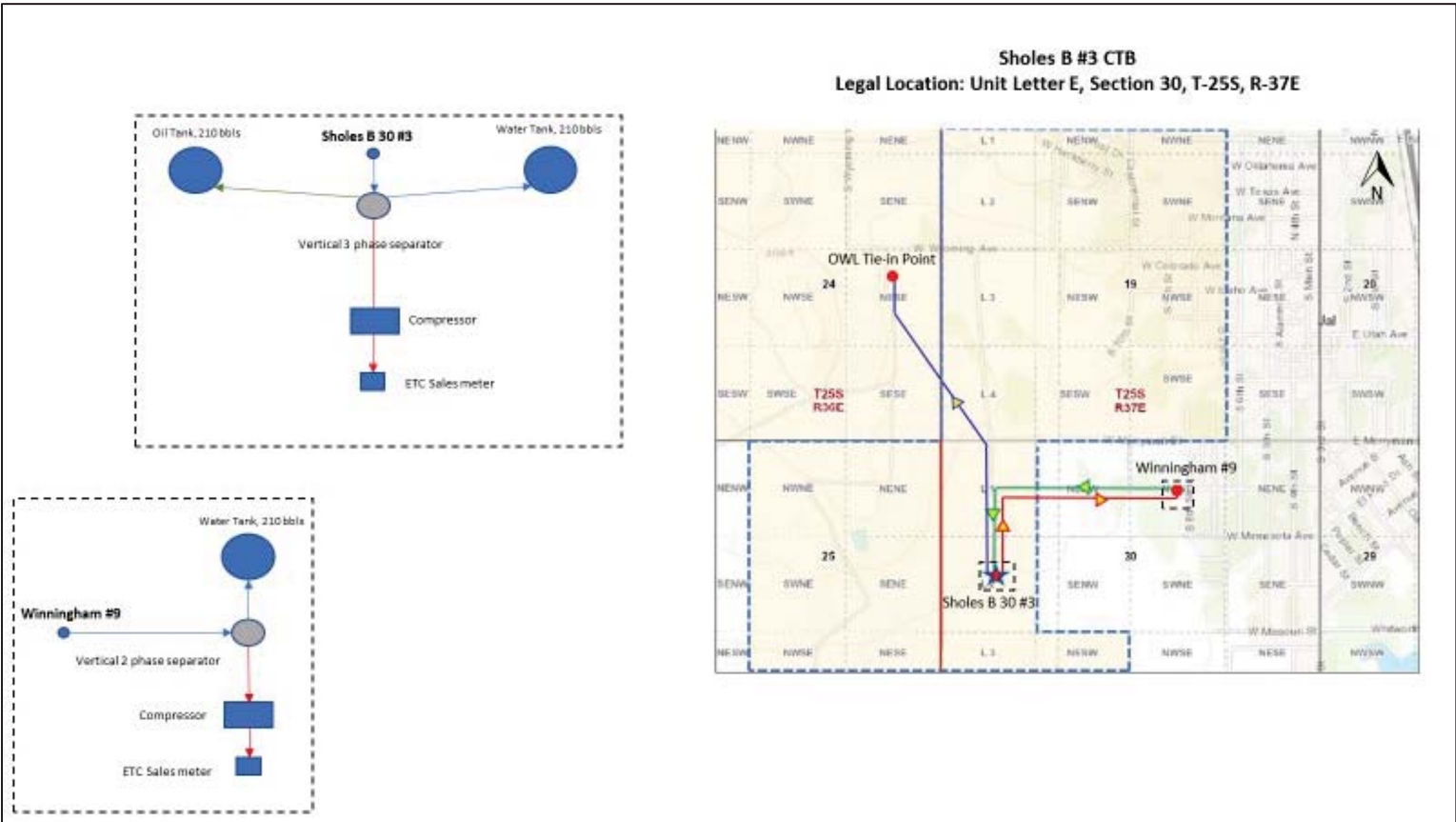

Exhibit B – Lease and Well Information

Well Name	Federal Lease or Property No.	API #	Pool ID
Sholes B 30 #3	NMLC 032581 B	30-025-35223	33820 JALMAT; TAN-YATES-7 RVRS (OIL)
Winningham #9	326422	30-025-28637	79240 JALMAT; TAN-YATES-7 RVRS (GAS)

# faeIIoperating

Exhibit C – Current Facility Layout



# faeIIoperating

## Exhibit D – Proposed Facility Layout

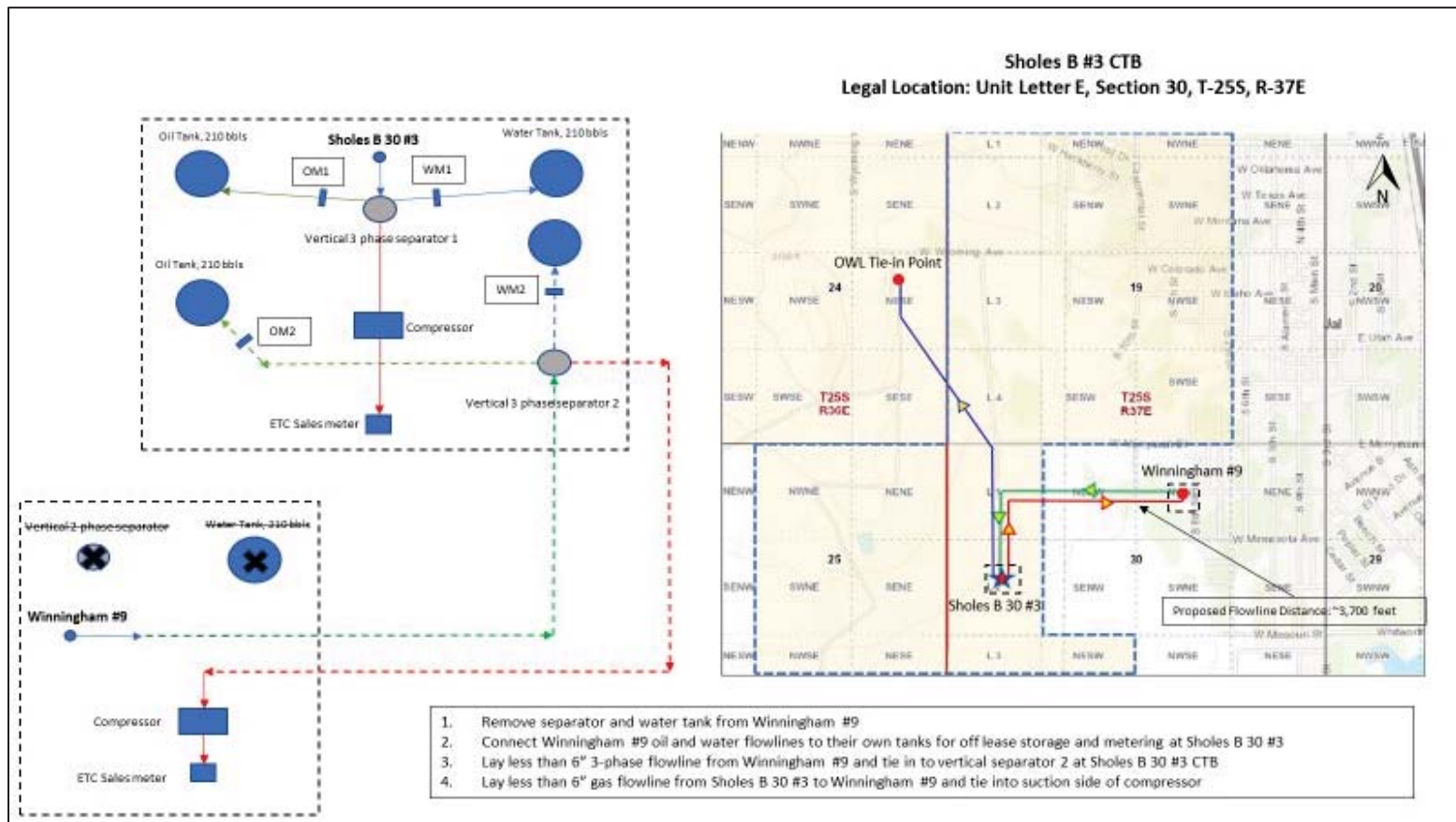

# faeIIoperating

## Exhibit E – Ownership Information

Well Name(s)	Ownership Type	Name	Address
Sholes B 30 #3, Winningham #9	Working	FAE II Operating LLC	11757 Katy Fwy Ste. 1000 Houston, TX 77079-1762
Winningham #9	Working	31 Group	PO Box 1706 Rockwall, TX 75087

## Exhibit F – Certified Mail Receipts

SENDER: COMPLETE THIS SECTION		COMPLETE THIS SECTION ON DELIVERY	
<ul style="list-style-type: none"> <li>Complete items 1, 2, and 3.</li> <li>Print your name and address on the reverse so that we can return the card to you.</li> <li>Attach this card to the back of the mailpiece, or on the front if space permits.</li> </ul>		<p>A. Signature  X <u>C-19</u> <input checked="" type="checkbox"/> Agent  <input type="checkbox"/> Addressee</p>	
<p>1. Article Addressed to:</p> <p>31 Group  PO Box 1706  Rockwall, TX 75087</p>		<p>B. Received by (Printed Name)  <u>CLARK</u></p> <p>C. Date of Delivery  <u>11-4</u></p>	
<p>2. Article Number (Transfer from service label)</p> <p>7020 0090 0000 6900 1341</p>		<p>D. Is delivery address different from item 1? <input type="checkbox"/> Yes  If YES, enter delivery address below: <input type="checkbox"/> No</p>	
<p>3. Service Type</p> <p><input type="checkbox"/> Adult Signature  <input type="checkbox"/> Adult Signature Restricted Delivery  <input type="checkbox"/> Certified Mail®  <input type="checkbox"/> Certified Mail Restricted Delivery  <input type="checkbox"/> Collect on Delivery  <input type="checkbox"/> Collect on Delivery Restricted Delivery  <input type="checkbox"/> Insured Mail  <input type="checkbox"/> Registered Mail Restricted Delivery (\$500)</p>		<p><input type="checkbox"/> Priority Mail Express®  <input type="checkbox"/> Registered Mail™  <input type="checkbox"/> Registered Mail Restricted Delivery  <input checked="" type="checkbox"/> Return Receipt for Merchandise  <input type="checkbox"/> Signature Confirmation™  <input type="checkbox"/> Signature Confirmation Restricted Delivery</p>	
<p>9590 9402 6004 0069 4675 05</p>		<p>PS Form 3811, July 2015 PSN 7530-02-000-9053</p>	
		Domestic Return Receipt	