

# NSL Initial Application

Received: 12/07/20

P.O. No. N5VUD-201207-NSL000

RECEIVED: <b>12/07/20</b>	REVIEWER: <b>LRL</b>	TYPE: <b>NSL</b>	APP NO: <b>pLEL2034238057</b>
---------------------------	----------------------	------------------	-------------------------------

ABOVE THIS TABLE FOR OCD DIVISION USE ONLY

**NEW MEXICO OIL CONSERVATION DIVISION**  
 - Geological & Engineering Bureau -  
 1220 South St. Francis Drive, Santa Fe, NM 87505

**ADMINISTRATIVE APPLICATION CHECKLIST**

THIS CHECKLIST IS MANDATORY FOR ALL ADMINISTRATIVE APPLICATIONS FOR EXCEPTIONS TO DIVISION RULES AND  
 REGULATIONS WHICH REQUIRE PROCESSING AT THE DIVISION LEVEL IN SANTA FE

**Applicant:** Spur Energy Partners LLC **OGRID Number:** 328947  
**Well Name:** Welch A 28 State 20H **API:** 30-015-47741  
**Pool:** Artesia; Glorieta-Yeso (O) **Pool Code:** 96830

**SUBMIT ACCURATE AND COMPLETE INFORMATION REQUIRED TO PROCESS THE TYPE OF APPLICATION  
 INDICATED BELOW**

- 1) **TYPE OF APPLICATION:** Check those which apply for [A]  
 A. Location – Spacing Unit – Simultaneous Dedication  
☒ NSL ☐ NSP (PROJECT AREA) ☐ NSP (PRORATION UNIT) ☐ SD
- B. Check one only for [ I ] or [ II ]  
 [ I ] Commingling – Storage – Measurement  
☐ DHC ☐ CTB ☐ PLC ☐ PC ☐ OLS ☐ OLM  
 [ II ] Injection – Disposal – Pressure Increase – Enhanced Oil Recovery  
☐ WFX ☐ PMX ☐ SWD ☐ IPI ☐ EOR ☐ PPR
- 2) **NOTIFICATION REQUIRED TO:** Check those which apply.  
 A. ☒ Offset operators or lease holders  
 B. ☐ Royalty, overriding royalty owners, revenue owners  
 C. ☐ Application requires published notice  
 D. ☒ Notification and/or concurrent approval by SLO  
 E. ☒ Notification and/or concurrent approval by BLM  
 F. ☐ Surface owner  
 G. ☐ For all of the above, proof of notification or publication is attached, and/or,  
 H. ☐ No notice required

**FOR OCD ONLY**

- ☐ Notice Complete  
☐ Application  
 Content  
 Complete

- 3) **CERTIFICATION:** I hereby certify that the information submitted with this application for administrative approval is **accurate** and **complete** to the best of my knowledge. I also understand that **no action** will be taken on this application until the required information and notifications are submitted to the Division.

**Note: Statement must be completed by an individual with managerial and/or supervisory capacity.**

Sarah Chapman

Print or Type Name

Sarah Chapman  
 Signature

12/07/2020

Date

832-930-8613

Phone Number

schapman@spurepllc.com

e-mail Address



December 7, 2020

New Mexico Oil Conservation Division  
1220 South St. Francis Dr.  
Santa Fe, NM 87505

Attention: Leonard Lowe

RE: ***Application for Administrative Approval of Non- Standard Location  
Welch A 28 State 20H – Artesia; Glorieta-Yeso (O) (96830)  
Surface Hole – 655’ FNL 930’ FWL Unit D Sec 27 T17S R28E  
First Take Point – 1080’ FNL 100’ FEL Unit A Sec 28 T17S R28E  
Last Take Point – 1080’ FNL 100’ FWL Unit D Sec 28 T17S R28E  
Bottom Hole – 1080’ FNL 50’ FWL Unit D Sec 28 T17S R28E  
Eddy County, New Mexico***

Dear Mr. Lowe:

Spur Energy Partners LLC respectfully requests administrative approval of a non-standard location on the Welch A 28 State 20H, API Number 30-015-47741, Property Code 329863. The 20H well is proposed to be completed in the Artesia; Glorieta-Yeso (O) pool, Pool Code 96830. The proposed wellbore is to be completed within 330’ feet of the S/2 of the N/2 of Section 28. The proposed interval is projected as follows:

Surface Hole – 655’ FNL 930’ FWL Unit D Sec 27 T17S R28E  
First Take Point – 1080’ FNL 100’ FEL Unit A Sec 28 T17S R28E  
Last Take Point – 1080’ FNL 100’ FWL Unit D Sec 28 T17S R28E  
Bottom Hole – 1080’ FNL 50’ FWL Unit D Sec 28 T17S R28E

The adjoining units which the unorthodox location encroaches are located in T17S R28E, Section 28, Units E, F, G and H.

Approval of the unorthodox completed interval will allow for efficient spacing of horizontal wells and thereby prevent waste.

To support this request, the following information has been submitted for your review:

1. Application Checklist
2. C-102 Plat for proposed well and an additional plat with offsetting affected units
3. List of affected parties in each of the units in the same pool located closer to the unorthodox well location that the minimum distance prescribed by rule or order, copies of the sign certified return copies will be furnished upon request

If you need any additional information, please call me at 832-930-8613.

Sincerely,

*Sarah Chapman*

Regulatory Director

Attachments  
CC: Service List

District I  
1625 N. French Dr., Hobbs, NM 88240  
Phone: (575) 393-6161 Fax: (575) 393-0720  
District II  
811 S. First St., Artesia, NM 88210  
Phone: (575) 748-1283 Fax: (575) 748-9720  
District III  
1000 Rio Brazos Road, Aztec, NM 87410  
Phone: (505) 334-6178 Fax: (505) 334-6170  
District IV  
1220 S. St. Francis Dr., Santa Fe, NM 87505  
Phone: (505) 476-3460 Fax: (505) 476-3462

State of New Mexico  
Energy, Minerals & Natural Resources Department  
OIL CONSERVATION DIVISION  
1220 South St. Francis Dr.  
Santa Fe, NM 87505

Form C-102  
Revised August 1, 2011  
Submit one copy to appropriate  
District Office

☐ AMENDED REPORT

WELL LOCATION AND ACREAGE DEDICATION PLAT

<sup>1</sup> API Number <b>30-015-47741</b>		<sup>2</sup> Pool Code <b>96830</b>		<sup>3</sup> Pool Name <b>Artesia; Glorieta-Yeso (O)</b>	
<sup>4</sup> Property Code <b>329863</b>		<sup>5</sup> Property Name <b>WELCH A 28 STATE</b>			<sup>6</sup> Well Number <b>20H</b>
<sup>7</sup> OGRID NO. <b>328947</b>		<sup>8</sup> Operator Name <b>SPUR ENERGY PARTNERS LLC.</b>			<sup>9</sup> Elevation <b>3654'</b>

<sup>10</sup> Surface Location

UL or lot no.	Section	Township	Range	Lot Idn	Feet from the	North/South line	Feet From the	East/West line	County
<b>D</b>	<b>27</b>	<b>17S</b>	<b>28E</b>		<b>655</b>	<b>NORTH</b>	<b>930</b>	<b>WEST</b>	<b>EDDY</b>

<sup>11</sup> Bottom Hole Location If Different From Surface

UL or lot no.	Section	Township	Range	Lot Idn	Feet from the	North/South line	Feet from the	East/West line	County
<b>D</b>	<b>28</b>	<b>17S</b>	<b>28E</b>		<b>1080</b>	<b>NORTH</b>	<b>50</b>	<b>WEST</b>	<b>EDDY</b>
<sup>12</sup> Dedicated Acres <b>160</b>	<sup>13</sup> Joint or Infill	<sup>14</sup> Consolidation Code	<sup>15</sup> Order No.						

No allowable will be assigned to this completion until all interest have been consolidated or a non-standard unit has been approved by the division.

<p><sup>16</sup></p> <p><u>GEODETIC DATA</u> NAD 83 GRID — NM EAST</p> <p><u>SURFACE LOCATION (SL)</u> N: 658806.1 — E: 591718.3 LAT: 32.8109797° N LONG: 104.1693487° W</p> <p><u>FIRST TAKE POINT (FTP)</u> 1080' FNL &amp; 100' FEL — SEC 28 N: 658375.0 — E: 590684.3 LAT: 32.8097991° N LONG: 104.1727164° W</p> <p><u>LAST TAKE POINT (LTP)</u> 1080' FNL &amp; 100' FWL — SEC 28 N: 658221.2 — E: 585690.3 LAT: 32.8093961° N LONG: 104.1889719° W</p> <p><u>BOTTOM HOLE (BH)</u> N: 658219.6 — E: 585640.3 LAT: 32.8093921° N LONG: 104.1891346° W</p> <p><u>CORNER DATA</u> NAD 83 GRID — NM EAST</p> <p>A: FOUND BRASS CAP "1941" N: 654104.0 — E: 585547.5</p> <p>B: FOUND BRASS CAP "1941" N: 656702.1 — E: 585573.1</p> <p>C: FOUND BRASS CAP "1941" N: 659297.8 — E: 585602.6</p> <p>D: FOUND BRASS CAP "1941" N: 659377.1 — E: 588198.9</p> <p>E: FOUND BRASS CAP "1941" N: 659457.7 — E: 590794.9</p> <p>F: FOUND BRASS CAP "1941" N: 659466.8 — E: 593406.4</p> <p>G: FOUND BRASS CAP "1941" N: 659475.1 — E: 596017.9</p> <p>H: FOUND BRASS CAP "1941" N: 656886.5 — E: 595997.7</p> <p>I: FOUND BRASS CAP "1941" N: 654298.0 — E: 595977.3</p> <p>J: FOUND BRASS CAP "1941" N: 654266.7 — E: 593360.1</p> <p>K: FOUND BRASS CAP "1941" N: 654235.0 — E: 590741.9</p> <p>L: FOUND BRASS CAP "1941" N: 654169.8 — E: 588139.7</p> <p>M: FOUND BRASS CAP "1941" N: 656846.0 — E: 590769.0</p>	<p><sup>17</sup> <b>OPERATOR CERTIFICATION</b></p> <p><i>I hereby certify that the information contained herein is true and complete to the best of my knowledge and belief, and that this organization either owns a working interest or unleased mineral interest in the land including the proposed bottom hole location or has a right to drill this well at this location pursuant to a contract with an owner of such a mineral or working interest, or to a voluntary pooling agreement or a compulsory pooling order heretofore entered by the division.</i></p> <p><i>Sarah Chapman</i> 11/30/2020 Signature Date</p> <p>Sarah Chapman Printed Name</p> <p><a href="mailto:schapman@spurepllc.com">schapman@spurepllc.com</a> E-mail Address</p> <p><sup>18</sup> <b>SURVEYOR CERTIFICATION</b></p> <p><i>I hereby certify that the well location shown on this plat was plotted from field notes of actual surveys made by me or under my supervision, and that the same is true and correct to the best of my belief.</i></p> <p><b>10-28-2020</b> Date of Survey</p> <p>Signature and Seal of Professional Surveyor</p> <p><b>19680</b> Certificate Number</p> <p><b>PROF. ROBERT M. HOWETT</b> <b>NEW MEXICO</b> <b>19680</b> <b>PROFESSIONAL SURVEYOR</b></p> <p><b>LS20100586</b></p>
---	--

Intent ☒ As Drilled ☐

API # <b>30-015-</b>		
Operator Name: <b>Spur Energy Partners LLC</b>	Property Name: <b>Welch A 28 State</b>	Well Number <b>20H</b>

Kick Off Point (KOP)

UL	Section	Township	Range	Lot	Feet	From N/S	Feet	From E/W	County
Latitude					Longitude				NAD

First Take Point (FTP)

UL <b>A</b>	Section <b>28</b>	Township <b>17S</b>	Range <b>28E</b>	Lot	Feet <b>1080</b>	From N/S <b>NORTH</b>	Feet <b>100</b>	From E/W <b>EAST</b>	County <b>EDDY</b>
Latitude <b>32.8097991</b>					Longitude <b>-104.1727164</b>				NAD <b>NAD83</b>

Last Take Point (LTP)

UL <b>D</b>	Section <b>28</b>	Township <b>17S</b>	Range <b>28E</b>	Lot	Feet <b>1080</b>	From N/S <b>NORTH</b>	Feet <b>100</b>	From E/W <b>WEST</b>	County <b>EDDY</b>
Latitude <b>32.8093961</b>					Longitude <b>-104.1889719</b>				NAD <b>NAD83</b>

Is this well the defining well for the Horizontal Spacing Unit? ☐Is this well an infill well? ☐

If infill is yes please provide API if available, Operator Name and well number for Defining well for Horizontal Spacing Unit.

API #		
Operator Name:	Property Name:	Well Number

KZ 06/29/2018

Spur Energy Partners LLC  
Welch A 28 State 20H  
Section 27 Township 17 South, Range 28 East  
Eddy County, New Mexico

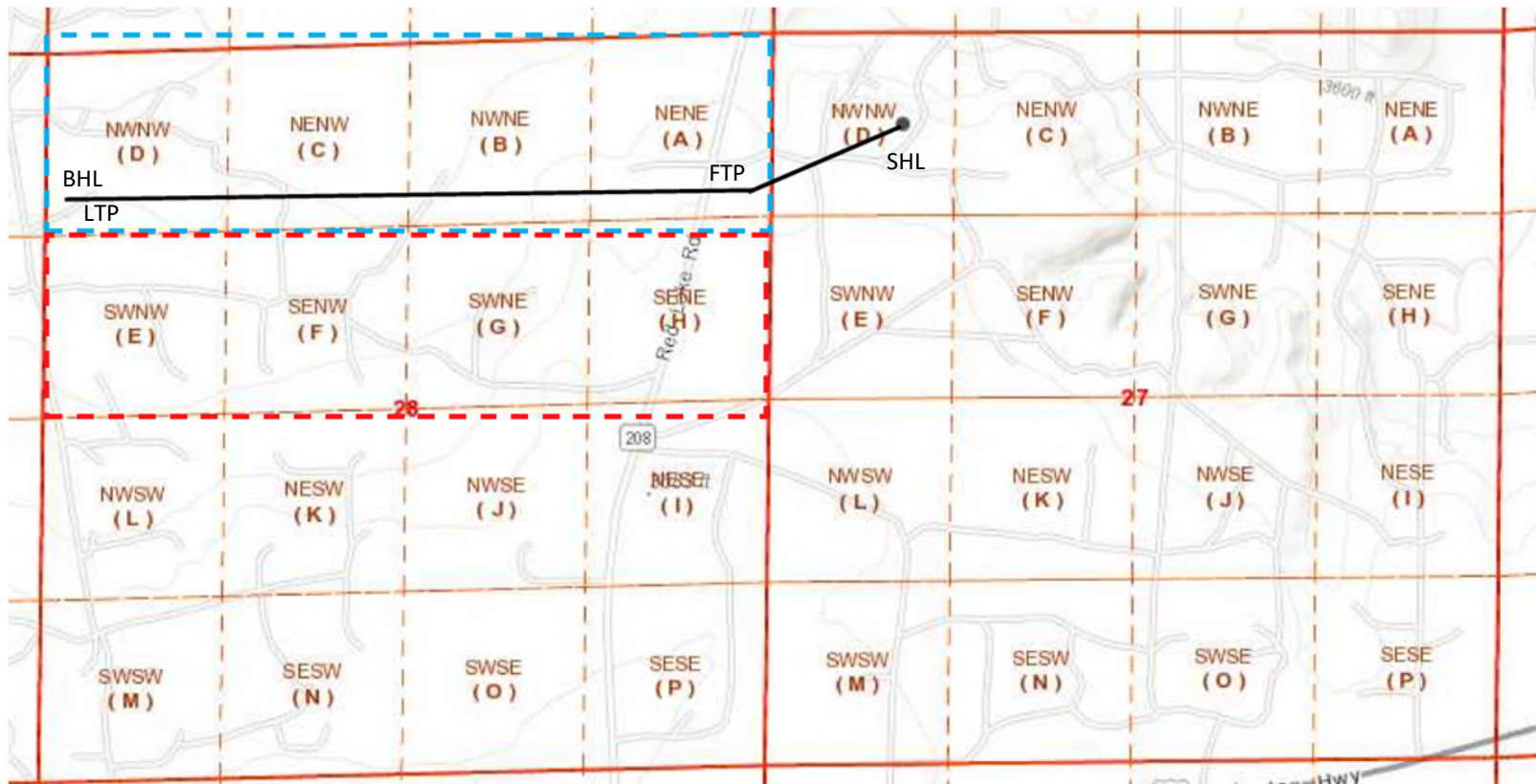

Red Outline – Affected Tracts

Blue Outline – Horizontal Spacing Unit

Application of Non-Standard Location - Service List  
Spur Energy Partners LLC  
Welch A 28 State 20H

New Mexico Oil Conservation Division  
811 S. First St.  
Artesia, NM 88210  
9414 8118 9876 5823 8383 91

New Mexico Oil Conservation Division  
1220 South St. Francis Dr.  
Santa Fe, NM 87505  
Uploaded online

Bureau of Land Management Carlsbad  
620 E. Greene Street  
Carlsbad, NM 88220  
9414 8118 9876 5823 8374 31

New Mexico State Land Office  
310 Old Santa Fe Trail  
Santa Fe. NM 87501  
9414 8118 9876 5823 8377 52

T17S R28E  
Operator: Section 28 - Units E, F, G and H

Grizzly Operating, LLC  
5847 San Felipe, Ste. 3000  
Houston, TX 77057  
9414 8118 9876 5823 8360 14

T17S R28E  
Working Interest Ownership: Section 28 - Units E, F, G and H

SEP Permian LLC  
9655 Katy Freeway, Ste 500  
Houston, TX 77024

SEP Permian Holding Corp  
9655 Katy Freeway, Ste. 500  
Houston, TX 77024

OXY USA WTP LP  
5 Greenway Plaza, Ste. 110  
Houston, TX 77046  
9414 8118 9876 5823 8311 63

WPX Energy Permian, LLC  
c/o Tanner Tepe  
3500 One Williams Cener, MD 35  
Tulsa, OK 74172  
9414 8118 9876 5823 8197 41

Marathon Oil Company  
c/o Janine Salgado  
5555 San Felipe Street  
Houston, TX 77056  
9414 8118 9876 5823 8138 17

Marathon Oil Permian LLC  
c/o Janine Salgado  
5555 San Felipe Street  
Houston, TX 77056  
9414 8118 9876 5823 8134 11

MRC Delaware Resources, LLC  
5400 LBJ Freeway, Ste. 1500  
Dallas, TX 75240  
9414 8118 9876 5823 8141 04

Sharbro Energy, LLC  
c/o Elizabeth Baker  
P.O. Box 840  
Artesia, NM 88211  
9414 8118 9876 5823 8156 99

Longfellow LH, LLC  
c/o Ryan Culpepper  
16803 Dallas Parkway  
Addison, TX 75001  
9414 8118 9876 5823 8129 02

Black Oak Energy, LLC  
c/o Saxby Stradinger  
701 NW 5th Street  
Oklahoma City, OK 73102  
9414 8118 9876 5823 8102 81

TYL Oil and Gas  
c/o LaDonna S. Mourné  
21380 W. Sunrise Lane  
Buckeye, AZ 85396  
9414 8118 9876 5823 8104 65

Jalapeno Corporation  
c/o Kathryn J. Reese  
P.O. Box 1608  
Albuquerque, NM 87103  
9414 8118 9876 5823 8181 33

Copies of the application were mailed to the above individuals, companies and organizations on December 7, 2020.

*Sarah Chapman*  
\_\_\_\_\_  
Spur Energy Partners LLC